

**CERTIFIED SURVEY MAP NO.**

Being a part of Lots Twenty (20) and Twenty-one (21), in Block Two (2), in Uriel B. Smith's Subdivision in the Northeast 1/4 of the Northwest One-quarter (1/4) of Section Nine (9), Township Six (6) North, Range Twenty-two (22) East, in City of Milwaukee, Milwaukee County, Wisconsin.

The North line of the Northwest 1/4, Section 9-6-22

S 88°07'35" W      2654.01'

S 88°07'35" W  
1163.24'

Northeast Corner of the  
Northwest 1/4 of Section  
9-6-22 Conc. Mon.  
w/Brass Cap

Northwest Corner of the  
Northwest 1/4 of Section  
9-6-22 Conc. Mon.  
w/Brass Cap

Tax Key No's  
4991228100

Zoning - RT4

Part of Lots 37-38  
Uriel B. Smith's  
Sub'd Block 2

## VICINITY MAP

E. Lincoln Ave.

C.S.M.  S.T.H. "32"  
Kinnickinni  
Scale:  
1"=2000'

E. Russel Ave.  
NW 1/4  
Sec. 9-6-22

---

*LINE TABLE*

LINE TABLE		
LINE	BEARING	LENGTH
L1	S 57°07'32" W	13.95'
L2	S 32°16'28" E	16.08'
L3	S 00°55'28" E	17.30'
L4	S 32°41'28" E	46.56'

Part of Lots 20 & 21  
 Ariel B. Smith's  
 Sub'd Block 2

*Pipe Found*

Existing Dwelling

**Lot 1**  
770 sq.ft.  
04 acres

Existing Building

***N 88°13'58" E***  
***27.79'***

East Smith Street

(66' R.O.W.)

NOTES:

- ◎ - Denotes 1" iron pipe found and accepted.  
 † - Denotes Chiseled Cross Found

Prepared for:

**Creative Development, LLC**  
**Gregg Pawelski, Member**  
**436-438 East Smith Street**  
**Milwaukee, WI 53207**  
**(414) 430-3502**

Prepared by:

**Dennis C. Sauer P.L.S.-2421**  
Metropolitan Survey Service, Inc.  
8482 S. 76th St.  
Franklin, WI 53132  
(414) 529-5380

GRAPHIC SCALE



( IN FEET )

$$1 \text{ inch} = 30 \text{ ft.}$$

Map bearings refer to Grid North of the Wisconsin State Plane Coordinate System, South Zone (NAD83/2011), with the North line of the NW 1/4 of Section 9, T6N, R22E having an assumed bearing of S 88°07'35"W.

Sheet 1 of 4

### Certification

INFRASTRUCTURE  
SERVICES DIVISION

Y. V. Nat. 7/14/25  
CENTRAL DRAFTING & RECORDS MANAGER

KT S. A. 7-11-25  
ENGR. IN CHARGE ENVIRON. ENGR.

**CORRECT**

K. P. M. 7/14/2025  
CITY ENGINEER

APPROVED

DEPARTMENT OF CITY  
DEVELOPMENT  
CITY OF MILWAUKEE

27 2025  
STAFF APPROVED

CERTIFIED SURVEY MAP NO. \_\_\_\_\_

Being a part of Lots Twenty (20) and Twenty-one (21), in Block Two (2), in Uriel B. Smith's Subdivision in the Northeast 1/4 of the Northwest One-quarter (1/4) of Section Nine (9), Township Six (6) North, Range Twenty-two (22) East, in City of Milwaukee, Milwaukee County, Wisconsin.

SURVEYOR'S CERTIFICATE

STATE OF WISCONSIN)  
MILWAUKEE COUNTY ) SS

I, Dennis C. Sauer, Professional Land Surveyor, do hereby certify:

That I have surveyed and divided a part of Lots Twenty (20) and Twenty-one (21), in Block Two (2), in Uriel B. Smith's Subdivision in the Northeast 1/4 of the Northwest One-quarter (1/4) of Section Nine (9), Township Six (6) North, Range Twenty-two (22) East, in City of Milwaukee, Milwaukee County, Wisconsin. Bounded and described as follows:

Commencing at the Northeast corner of said Northwest 1/4; thence S 88°07'35" W along the North line of said Northwest 1/4, 1163.24 feet; thence S 01°05'50" E, 632.58 feet to a point on the North right-of-way line of East Smith Street and the point of beginning of the lands to be described; thence N 33°06'28" W, 91.70 feet; thence S 57°07'32" W, 13.95 feet; thence S 32°16'28" E, 16.08 feet; thence S 00°55'28" E, 17.30 feet; thence S 32°41'28" E, 46.58 feet to a point on the North right-of-way line of East Smith Street; thence N 88°13'58" E along said north right-of-way line, 27.79 feet to the point of beginning.

Said lands containing 1,770 square feet. (0.04 acres).

That I have made such survey, land division and map by the direction of CREATIVE DEVELOPMENT, LLC, owner of said land.

That such map is a correct representation of all the exterior boundaries of the land surveyed and the land division thereof made.

That I have fully complied with the provisions of Chapter 236 of the Wisconsin Statutes and Chapter 119 of the Milwaukee Code of Ordinances in surveying, dividing and mapping the same. Per Wis. Stat. 236.21 (1), this certificate has the same force and effect as an affidavit.

June 23, 2025

Date

Rev. July 10, 2025

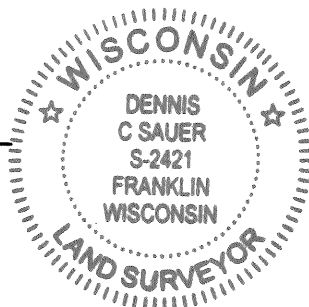

A handwritten signature in black ink, appearing to read "Dennis C. Sauer".

Dennis C. Sauer

Professional Land Surveyor S-2421

PREPARED FOR:  
Creative Development, LLC.  
Gregg Pawelski, Member  
436-438 East Smith Street  
Milwaukee, WI 53207

PREPARED BY: Dennis C. Sauer  
Metropolitan Survey Service, Inc.  
8482 South 76<sup>th</sup> Street  
Franklin, WI 53132

CERTIFIED SURVEY MAP NO. \_\_\_\_\_

Being a part of Lots Twenty (20) and Twenty-one (21), in Block Two (2), in Uriel B. Smith's Subdivision in the Northeast 1/4 of the Northwest One-quarter (1/4) of Section Nine (9), Township Six (6) North, Range Twenty-two (22) East, in City of Milwaukee, Milwaukee County, Wisconsin.

ENTITY OWNER'S CERTIFICATE

CREATIVE DEVELOPMENT, LLC, a corporation duly organized and existing under and by virtue of the laws of the State of Wisconsin, as owner, certifies that said entity caused the land described on this certified survey map to be surveyed, divided, mapped and dedicated as represented on this map in accordance with the requirements of Chapter 236 of the Wisconsin Statutes and Chapter 119 of the Milwaukee Code of Ordinances.

In consideration of the approval of the map by the Milwaukee Common Council, the undersigned agrees:

That all utility lines to provide electric power and telephone service and cable television or communications systems lines or cables to all lots in the certified survey map, other than already existing lines and cables, shall be installed underground in easements provided therefore, where feasible.

This agreement is binding on the undersigned and successors and assigns.

Date: 7/10/25

CREATIVE DEVELOPMENT, LLC

Signature: *Gregg Pawelski*

Print Name: GREGG PAWELSKI

Title: MEMBER

STATE OF WISCONSIN)  
Waukesha COUNTY)

PERSONALLY came before me this 10<sup>th</sup> day of July, 2025, Gregg Pawelski, owner of above-named entity, to me known to be the person who executed the foregoing instrument and acknowledged that he executed the foregoing instrument as such officer on behalf of the entity, CREATIVE DEVELOPMENT, LLC, by its authority.

*Joseph A. Bogenberger*  
Notary Signature

Print Name JOSEPH G BOGENBERGER  
Notary Public-State of Wisconsin  
My Commission Expires: 11/29/2026

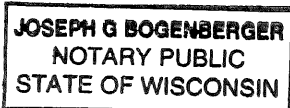
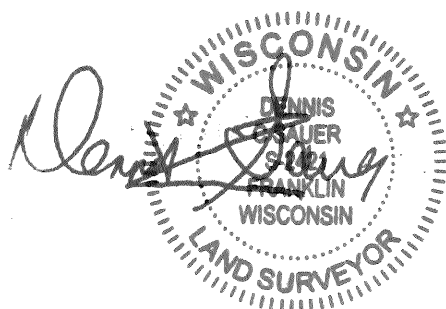

CERTIFIED SURVEY MAP NO. \_\_\_\_\_

Being a part of Lots Twenty (20) and Twenty-one (21), in Block Two (2), in Uriel B. Smith's Subdivision in the Northeast 1/4 of the Northwest One-quarter (1/4) of Section Nine (9), Township Six (6) North, Range Twenty-two (22) East, in City of Milwaukee, Milwaukee County, Wisconsin.

CERTIFICATE OF CITY TREASURER

STATE OF WISCONSIN )  
MILWAUKEE COUNTY ) SS

I, Spencer Coggs, being the duly elected and acting City Treasurer of the City of Milwaukee, certify that in accordance with the records in the office of the City Treasurer of the City of Milwaukee there are no unpaid taxes or unpaid special assessments on the land included in this certified survey map.

Per Wis. Stat. 75.06 and 74.87, the City of Milwaukee collects property taxes and enforces nonpayment of same on parcels in the City of Milwaukee. Per Wis. Stat. 74.83, the City of Milwaukee and Milwaukee County entered into an Intergovernmental Cooperation Agreement approved by Council Resolution 901408, whereby the city is the sole collector and enforcer of property taxes for parcels in the city.

7/15/2025  
Date

LaQuisha Schroeder  
for Spencer Coggs, Treasurer  
City of Milwaukee  
LaQuisha Schroeder  
Deputy Treasurer

CERTIFICATE OF CITY CLERK

I certify that this Certified Survey Map was approved under Resolution File No. \_\_\_\_\_, on this \_\_\_\_\_ day of \_\_\_\_\_, 20\_\_\_\_, by the Common Council of the City of Milwaukee.

\_\_\_\_\_  
James R. Owczarski, City Clerk  
City of Milwaukee

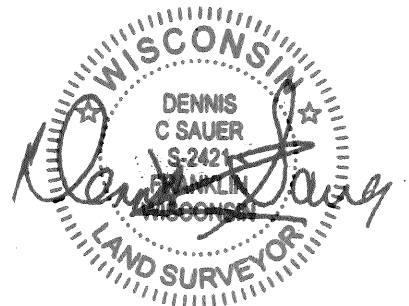

June 23, 2025  
Rev. July 10, 2025

THIS INSTRUMENT WAS DRAFTED BY:  
Dennis C. Sauer, P.L.S. S-2421