



CITY OF MILWAUKEE  
OFFICE OF THE CITY CLERK

Wednesday, September 15, 2021

COMMITTEE MEETING NOTICE

AD 15

SHARMA, Ashwani, Agent  
Lisbon Food & Beer, Inc  
4401 W Lisbon Av

Milwaukee, WI 53208

You are requested to attend a virtual hearing to be held on:

Tuesday, September 28, 2021  11:10 AM

**Regarding:** Your Public Entertainment Premises License Application Requesting 2 Amusement Machines as agent for "Lisbon Food & Beer, Inc" for "Lisbon Food & Beer" at 4401 W Lisbon Av.

This meeting will be held via GoToMeeting. Please see the enclosed best practices document for further instructions. The access code is <https://global.gotomeeting.com/join/284170701>. If you wish to call in, please call +1 (786) 535-3211 and use Access Code: 284-170-701.

There is a possibility that your application may be denied for one or more of the following reasons: The recommendation of the committee regarding the application shall be based on evidence presented at the hearing. Per MCO 85-2.7-4, probative evidence concerning whether or not a new license should be granted may be presented on the following subjects: whether or not the applicant meets the municipal requirements, the appropriateness of the location and premises where the licensed premises is to be located and whether use of the premises for the purposes or activities permitted by the license would tend to facilitate a public or private nuisance or create undesirable neighborhood problems such as disorderly patrons, unreasonably loud noise, litter, and excessive traffic and parking congestion. Probative evidence relating to these matters may be taken from the plan of operation submitted with the license application, if any, but shall not include the content of any music. Evidence regarding the fitness of the location of the premises to be maintained as the principal place of business, including but not limited to whether there is an overconcentration of businesses of the type for which the license is sought; whether the proposal is consistent with any pertinent neighborhood business or development plans, or the location's proximity to areas where children are typically present. The applicant's record in operating similarly licensed premises; and whether or not the applicant has been charged with or convicted of any felony, misdemeanor, municipal offense or other offense, the circumstances of which substantially relate to the activity to be permitted by the license being applied for or any other factor which reasonably relates to the public health, safety or welfare may also be considered. See attached police report or correspondence.

**Notice for applicants with warrants or unpaid fines:**

Proof of warrant satisfaction or payment of fines must be submitted at the hearing on the above date and time. Failure to comply with this requirement may result in a delay of the granting/denial of your application.

Failure to attend this meeting may result in the denial of your license. Individual applicants and partnership applicants must attend or attend by an attorney. The agent or attorney for corporate or limited liability applicants must attend. If you wish to do so and at your own expense, you may be accompanied by an attorney of your choosing to represent you at this hearing.

You will be given an opportunity to speak on behalf of the application and to respond and challenge any charges or reasons given for the denial. No petitions can be accepted by the committee, unless the people who signed the petition attend the virtual hearing and are willing to testify. You may present witnesses under oath and you may also confront and cross-examine opposing witnesses under oath. If you have difficulty with the English language, you should request an interpreter attend the meeting with you, at your expense, so that you can answer questions and participate in your hearing.

PLEASE NOTE: Upon reasonable notice, efforts will be made to accommodate the needs of disabled individuals through sign language interpreters or other auxiliary aids. For additional information or to request this service, contact the Council Services Division ADA Coordinator at (414) 286-2998, Fax - (414) 286-3456, TDD - (414) 286-2025.

JIM OWCZARSKI, CITY CLERK

BY: \_\_\_\_\_

Jim Cooney

License Division Manager

If you have questions regarding this meeting, please contact the staff assistant, Molly Kuether-Steele at (414) 286-2775 or [molly.kuether-steele@milwaukee.gov](mailto:molly.kuether-steele@milwaukee.gov).

200 E. Wells Street, Room 105, City Hall, Milwaukee, WI 53202. [www.milwaukee.gov/license](http://www.milwaukee.gov/license)  
Phone: (414) 286-2238 Fax: (414) 286-3057 Email Address: [License@milwaukee.gov](mailto:License@milwaukee.gov)

# MILWAUKEE POLICE DEPARTMENT LICENSING

## CRIMINAL RECORD/ORDINANCE VIOLATION/INCIDENTS SYNOPSIS

**DATE:** 08/25/2021

**LICENSE TYPE:** Class B Tavern

**NEW:**

**RENEWAL:**

**No. 328579**

**Application Date:** 08/24/2021

**License Location:** 4401 W Lisbon Av

**Business Name:** Lisbon Food & Beer, Inc

**Licensee/Applicant:** SHARMA, Ashwani  
(Last Name, First Name, MI)

**Date of Birth:** 09/23/1978

**Home Address:** 5025 W College Av #86

**City:** Greendale

**State:** WI **Zip Code:** 53129

**Home Phone:** 414-797-5633

This report is written by Police Officer David Novak, assigned to the License Investigation Unit, Days.

The Milwaukee Police Department's investigation regarding this application revealed the following:

1. On 11/05/2019 officers were dispatched to a Battery complaint at 4401 W. Lisbon Av. The caller was the applicant and he stated a known actor came in the store stating the applicant owed him money. The subject was yelling at the applicant, threatening to damage the store. The subject then pushed the applicant. The subject was cited for Disorderly Conduct.
2. On 05/05/2020 at 6:02pm officers were dispatched to a Subject with Gun complaint at 4401 W. Lisbon Av. The caller was a clerk and he stated a subject walked in the store with a knife. There were other subjects outside with guns and knives. The officers located one of the described subjects but did not locate any weapons. The clerk was not threatened and not involved in the argument outside.

=====



Wednesday, September 15, 2021



# Notice of Public Hearing

blank  
notice

---

SHARMA, Ashwani, Agent  
Lisbon Food & Beer at 4401 W Lisbon Av  
Public Entertainment Premises License Application Requesting 2 Amusement Machines

**Tuesday, September 28, 2021 at 11:10 AM**

To whom it may concern:

The above application has been made by the above named applicant(s). This requires approval from the Licenses Committee and the Common Council of the City of Milwaukee. The hearing before the Licenses Committee will take place virtually on 9/28/2021 at 11:10 AM. This is a public hearing. Those wishing to view the proceeding are able to do so via the City Channel – Channel 25 on Spectrum Cable – or on the Internet at <http://city.milwaukee.gov/citychannel>. Those wishing to provide oral testimony will be asked to do so by phone or internet and are asked to contact the staff assistant, Molly Kuether-Steele at (414) 286-2775 or [molly.kuether-steele@milwaukee.gov](mailto:molly.kuether-steele@milwaukee.gov) for necessary information. Please make such requests no later than one business day prior to the start of the meeting. You are not required to attend the hearing, but please see the information below if you would like to provide testimony. Once the Licenses Committee makes its recommendation, this recommendation is forwarded to the full Common Council for approval at its next regularly scheduled hearing.

---

## Important details for those wishing to provide information for the Licenses Committee to consider when making its recommendation:

1. The license application is scheduled to be heard at the above time. Due to other hearings running longer than scheduled, you may have to wait some time to provide your testimony.
2. You must testify as to matters that you have personally experienced or seen. (You cannot provide testimony for your neighbor, parent or anyone else; this is considered hearsay and cannot be considered by the committee.)
3. No letters or petitions can be accepted by the committee (unless the person who wrote the letter or the persons who signed the petition are willing to testify).
4. Persons opposed to the license application are given the opportunity to testify first; supporters may testify after the opponents have finished.
5. When you are called to testify, you will be sworn in and asked to give your name, and address. (If your first and/or last names are uncommon please spell them.)
6. You may then provide testimony.
  - a. Include only information relating to the above license application.
  - b. Include only information you have personally witnessed or seen.
  - c. Provide concise and relevant information detailing how this business has affected or may affect the peaceful enjoyment of your neighborhood.
  - d. If by the time you have the opportunity to testify, the information you wish to share has already been provided to the committee, you may state that you agree with the previous testimony. Redundant or repetitive testimony will not assist the committee in making its recommendation.
7. After giving your testimony, the members of the Licenses Committee and the licensee may ask questions regarding the testimony you have given or other factors relating to the license application.
8. Business Competition is not a valid basis for denial or non-renewal of a license.

**Please Note: If you have submitted an objection to the above application your objection cannot be considered by the committee unless you personally testify at the hearing.**

OCCUPANT	MAIL ADDRESS	CITY STATE ZIP
CURRENT OCCUPANT	2105 N 44TH ST, 1	MILWAUKEE, WI 53208-1247
CURRENT OCCUPANT	2105 N 44TH ST, 2	MILWAUKEE, WI 53208-1247
CURRENT OCCUPANT	2105 N 44TH ST, 3	MILWAUKEE, WI 53208-1247
CURRENT OCCUPANT	2105 N 44TH ST, 4	MILWAUKEE, WI 53208-1247
CURRENT OCCUPANT	2105 N 44TH ST, 5	MILWAUKEE, WI 53208-1247
CURRENT OCCUPANT	2118 N 45TH ST	MILWAUKEE, WI 53208-1223
CURRENT OCCUPANT	2119 N 44TH ST	MILWAUKEE, WI 53208-1217
CURRENT OCCUPANT	2120 N 45TH ST	MILWAUKEE, WI 53208-1223
CURRENT OCCUPANT	2121 N 44TH ST	MILWAUKEE, WI 53208-1217
CURRENT OCCUPANT	2124 N 45TH ST	MILWAUKEE, WI 53208-1223
CURRENT OCCUPANT	2125 N 44TH ST	MILWAUKEE, WI 53208-1217
CURRENT OCCUPANT	2125A N 44TH ST	MILWAUKEE, WI 53208-1217
CURRENT OCCUPANT	2130 N 45TH ST	MILWAUKEE, WI 53208-1223
CURRENT OCCUPANT	2131 N 45TH ST	MILWAUKEE, WI 53208-1224
CURRENT OCCUPANT	2132 N 45TH ST	MILWAUKEE, WI 53208-1223
CURRENT OCCUPANT	2134 N 45TH ST	MILWAUKEE, WI 53208-1223
CURRENT OCCUPANT	2135 N 44TH ST	MILWAUKEE, WI 53208-1217
CURRENT OCCUPANT	2136 N 45TH ST	MILWAUKEE, WI 53208-1223
CURRENT OCCUPANT	2137 N 44TH ST	MILWAUKEE, WI 53208-1217
CURRENT OCCUPANT	2137 N 45TH ST	MILWAUKEE, WI 53208-1224
CURRENT OCCUPANT	2142 N 45TH ST	MILWAUKEE, WI 53208-1223
CURRENT OCCUPANT	2145 N 45TH ST	MILWAUKEE, WI 53208-1224
CURRENT OCCUPANT	2145 N SHERMAN BLVD	MILWAUKEE, WI 53208-1212
CURRENT OCCUPANT	2147 N 45TH ST	MILWAUKEE, WI 53208-1224
CURRENT OCCUPANT	2147 N SHERMAN BLVD	MILWAUKEE, WI 53208-1212
CURRENT OCCUPANT	2149 N 45TH ST	MILWAUKEE, WI 53208-1224
CURRENT OCCUPANT	2151 N 44TH ST	MILWAUKEE, WI 53208-1217
CURRENT OCCUPANT	2153 N 44TH ST	MILWAUKEE, WI 53208-1217
CURRENT OCCUPANT	2153 N SHERMAN BLVD	MILWAUKEE, WI 53208-1212
CURRENT OCCUPANT	2153A N 44TH ST	MILWAUKEE, WI 53208-1217
CURRENT OCCUPANT	2155 N 45TH ST	MILWAUKEE, WI 53208-1224
CURRENT OCCUPANT	2163 N 45TH ST	MILWAUKEE, WI 53208-1224
CURRENT OCCUPANT	2167 N 45TH ST	MILWAUKEE, WI 53208-1224
CURRENT OCCUPANT	2169 N 45TH ST	MILWAUKEE, WI 53208-1224
CURRENT OCCUPANT	2169 N SHERMAN BLVD	MILWAUKEE, WI 53208-1212
CURRENT OCCUPANT	2171 N SHERMAN BLVD	MILWAUKEE, WI 53208-1212
CURRENT OCCUPANT	2172 N 45TH ST	MILWAUKEE, WI 53208-1223
CURRENT OCCUPANT	2174 N 44TH ST	MILWAUKEE, WI 53208-1218
CURRENT OCCUPANT	2175 N SHERMAN BLVD	MILWAUKEE, WI 53208-1212
CURRENT OCCUPANT	2177 N SHERMAN BLVD	MILWAUKEE, WI 53208-1212
CURRENT OCCUPANT	4315 W LISBON AVE, 1	MILWAUKEE, WI 53208-1204
CURRENT OCCUPANT	4315 W LISBON AVE, 10	MILWAUKEE, WI 53208-1204
CURRENT OCCUPANT	4315 W LISBON AVE, 11	MILWAUKEE, WI 53208-1204
CURRENT OCCUPANT	4315 W LISBON AVE, 12	MILWAUKEE, WI 53208-1204
CURRENT OCCUPANT	4315 W LISBON AVE, 14	MILWAUKEE, WI 53208-1204
CURRENT OCCUPANT	4315 W LISBON AVE, 15	MILWAUKEE, WI 53208-1204



CURRENT OCCUPANT	4409 W LISBON AVE, 8	MILWAUKEE, WI 53208-1236
CURRENT OCCUPANT	4409A W GARFIELD AVE	MILWAUKEE, WI 53208-1233
CURRENT OCCUPANT	4410 W LLOYD ST	MILWAUKEE, WI 53208-1207
CURRENT OCCUPANT	4412 W LLOYD ST	MILWAUKEE, WI 53208-1207
CURRENT OCCUPANT	4414 W LLOYD ST	MILWAUKEE, WI 53208-1207
CURRENT OCCUPANT	4415 W LISBON AVE	MILWAUKEE, WI 53208-1236
CURRENT OCCUPANT	4416 W LLOYD ST	MILWAUKEE, WI 53208-1207
CURRENT OCCUPANT	4418 W LISBON AVE	MILWAUKEE, WI 53208-1235
CURRENT OCCUPANT	4420 W LLOYD ST	MILWAUKEE, WI 53208-1207
CURRENT OCCUPANT	4422 W LLOYD ST	MILWAUKEE, WI 53208-1207
CURRENT OCCUPANT	4424 W LLOYD ST	MILWAUKEE, WI 53208-1207
CURRENT OCCUPANT	4426 W LISBON AVE, 1	MILWAUKEE, WI 53208-1235
CURRENT OCCUPANT	4426 W LLOYD ST	MILWAUKEE, WI 53208-1207
CURRENT OCCUPANT	4429 W LISBON AVE	MILWAUKEE, WI 53208-1236
CURRENT OCCUPANT	4431 W LISBON AVE	MILWAUKEE, WI 53208-1236
CURRENT OCCUPANT	4437 W LISBON AVE, 1	MILWAUKEE, WI 53208-1236
CURRENT OCCUPANT	4437 W LISBON AVE, 2	MILWAUKEE, WI 53208-1236
CURRENT OCCUPANT	4443 W LISBON AVE	MILWAUKEE, WI 53208-1236
blank	notice	

Total Records: 111

Radius: 250.0 feet and Center of Circle: 4401 W Lisbon Ave



# BUSINESS LICENSE PLAN OF OPERATION

ccl-busplan 5/12/2020

Office of the City Clerk License Division  
200 E. Wells St. Room 105, Milwaukee, WI 53202  
(414) 286-2238 www.milwaukee.gov/license e-mail address: license@milwaukee.gov

## 1. Type of Business

Applying for:  Extended Hours (12AM to 5AM) - If a food establishment, check all that apply:  Delivery  Drive Thru  Dining Room  
 Self Service Laundry  Massage Establishment  Filling Station  
 Other (supplemental application for specific license also required) CONV-STORE

Provide a detailed description of the type of business you plan on operating:  
I currently operate this store as a small conv-store

Do you have any experience operating this type of business?  No  Yes If yes, explain:

## 2. Business Operations

- a. Proposed Opening Date: currently open
- b. Is this premise under construction?  No  Yes If yes, list estimated completion date: \_\_\_\_\_
- c. Is this a franchise?  No  Yes
- d. Is this premises currently licensed?  No  Yes If yes, list type of license: CIGS - FOOD - WEIGHT & MEASURE CLASS A - BEER MAT
- e. Is the current licensee operating?  No  Yes If no, list date closed: \_\_\_\_\_
- f. Do you have future plans for other businesses, licenses or permits at this location?  No  Yes  
If yes, explain: \_\_\_\_\_
- g. Have you previously held an Extended Hours License in Milwaukee?  No  Yes  
If yes, list address(es): \_\_\_\_\_
- h. Are other businesses operating in the same building?  No  Yes If yes, describe: \_\_\_\_\_

## 3. Litter & Noise

- a. How are grounds kept clean?  Sweep  Pressure Wash  Pick Up Litter  Other: \_\_\_\_\_
- b. How often will grounds be cleaned?  Daily  Weekly  As Needed  Monthly  Other: \_\_\_\_\_
- c. Grounds cleaned by:  Licensee  Building Owner  Employees  Hired Maintenance  Other: \_\_\_\_\_
- d. How are noise issues prevented and/or addressed?  Security  Manager approaches customer(s)  Call Police  
 Signs Posted  Other: \_\_\_\_\_
- e. Will a sound amplification system be used?  No  Yes If yes, describe: \_\_\_\_\_

## 4. Smoking & Sanitation

- a. Are there designated outdoor smoking areas?  No  Yes If yes, describe: \_\_\_\_\_
- b. Number of Garbage Cans: Inside: 2 Locations: BY CASHIER & RESTROOMS  
Outside: 1 Locations: BY MAIN DOOR
- c. Is a crowd control barrier used?  No  Yes If yes, describe: \_\_\_\_\_
- d. How many restrooms are on the premises? 1
- e. Name of solid waste contractor:  Advanced Disposal  Waste Management  Other: \_\_\_\_\_

### 5. Security

a. Are there onsite parking spaces?  No  Yes If yes, how many? \_\_\_\_\_ and describe the parking security plan: Security cameras

b. Is there a loading zone?  No  Yes If yes, describe the loading area security plan: \_\_\_\_\_

c. Will you have security personnel on premise?  No  Yes If yes, how many? \_\_\_\_\_ and answer the following:  
What are their responsibilities? \_\_\_\_\_

Is security equipment used?  No  Yes If yes, describe \_\_\_\_\_

List their licensing, certification, or training credentials \_\_\_\_\_

d. Will there be security cameras?  No  Yes If yes, how many? 8 and list locations: cameras monitors inside & outside store surroundings

e. Will searches/identification checks be done upon entry?  No  Yes If yes, describe \_\_\_\_\_

### 6. Percentage of Sales (must total 100%)

Alcohol <u>BEER</u> <u>20</u> %	Food <u>40</u> %	Secondhand Merchandise _____ %	Precious Metals & Gems _____ %
Entertainment <u>10</u> %	Cigarettes <u>20</u> %	Personal Services (such as tattoo, body piercing, salon, tailor, tanning, etc.) _____ %	Other <u>10</u> % Describe: <u>JEWELRY</u>
Pawnbroker Activity _____ %	Salvaged Materials _____ % (such as scrap metal)		

### 7. Businesses/Licenses on the Premises (check all that apply):

#### Type 1

- Full Service Restaurant
- Night Club
- Banquet Hall
- Hotel/Motel: Number of Floors: \_\_\_\_\_  
Number of Rooms: \_\_\_\_\_
- Cafe/Coffee Shop
- Tavern
- Sports Facility
- Deli or Fast Food Restaurant
- Cocktail Lounge
- Bowling Alley
- Rooming House: Number of Floors: \_\_\_\_\_  
Number of Rooms: \_\_\_\_\_
- Private/Fraternal/Veterans Club
- Teen Club

#### Type 2

- Liquor Store
- Gas Station
- Used Car Dealer
- Corner Store
- Amusement/Phonograph Distributor
- Personal Service Establishment  
(such as tattoo business, hair salon, tailor, etc.)
- Supermarket
- Convenience Store
- Recycling, Salvage or Towing
- Recording Studio

What other licenses/permits will you hold at this location? (check all that apply)

- Occupancy Permit
- Cigarette & Tobacco
- Gas Station
- Extended Hours
- Class "B" Tavern
- Weights & Measures
- Secondhand Dealer
- Precious Metal & Gem
- Other: \_\_\_\_\_

### 8. Legal Capacity (only if a Type 1 premises in #7 above)

Capacity \_\_\_\_\_ (Call the Milwaukee Development Center at 414-286-8211 if you have questions.) NONE



## 9. Premises Description

- a. Identify all area(s) of the premises that will be used in operating this business (include areas used only for storage):  
 1<sup>st</sup> Floor  2<sup>nd</sup> Floor  Basement Storage  Patio  Beer Garden  Sidewalk Café  Deck  Rooftop  
 Other: Describe: \_\_\_\_\_
- b. Describe Location:  Major Thoroughfare  Secondary Street  Other: \_\_\_\_\_
- c. Nearest Major Cross Street: LISBON AVENUE
- d. Describe Building:  Free Standing Building  Strip Mall  Other: \_\_\_\_\_
- e. Describe Premises Structure:  Single Story  Multi-Story - # of Stories \_\_\_\_\_  Other: \_\_\_\_\_
- f. Describe Surrounding Area:  Commercial  Residential  Industrial  Other: \_\_\_\_\_
- g. Building Owner Name: JAMAL SILMT Phone Number: 414-349-3069  
 Building Owner Address: 1865 BRONZE PATINA ST. HENDERSON NV 89044

## 10. Hours of Operation & Customers

Will customers be entering the premises?  No  Yes

Day of the Week	Proposed Hours of Operation:		Estimated Number of Customers expected each day	Potential Age Range of Customers	Class B Tavern Applicant Only: Age Restriction (If none, write 'None')
	Open Time (include a.m. or p.m.)	Close Time (include a.m. or p.m.)			
Sunday	8:00 AM	9:00 PM	250	ALL	
Monday	8:00 AM	9:00 PM	250	ALL	
Tuesday	8:00 AM	9:00 PM	250	ALL	
Wednesday	8:00 AM	9:00 PM	250	ALL	
Thursday	8:00 AM	9:00 PM	250	ALL	
Friday	8:00 AM	9:00 PM	250	ALL	
Saturday	8:00 AM	9:00 PM	250	ALL	

An Extended Hours Establishment License is required for any convenience store, filling station, personal service establishment (such as tattoo, body piercing, salon, tailor, tanning, etc.), recording studio or restaurant which is open between the hours of 12:00 a.m. and 5:00 a.m.

Alcohol Establishments Class A: 8:00 am to 9:00 pm Sunday thru Saturday  
 Permitted Hours of Operation: Class B: 6:00 am to 2:00 am Sunday thru Thursday, 6:00 am to 2:30 am Friday & Saturday

Entertainment Outdoor Closing Hours: 10:00pm Sunday-Thursday; 12:00am Friday & Saturday; unless a different time, either earlier or later, is established by the Common Council in its approval of the licensee's plan of operation.

## 11. Signature(s)

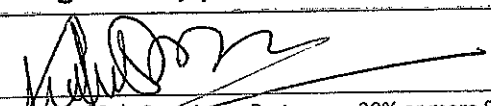
  
 Signature of Sole Proprietor, Partner, or 20% or more Shareholder  
 (If there are no 20% or more shareholders,  
 Corporate Officer-print name/title and sign)

\_\_\_\_\_  
 Signature of additional partner or 20% or more shareholder

See Application Information for a complete list of all required application forms.



# ALCOHOL BEVERAGE & PUBLIC ENTERTAINMENT PREMISES SUPPLEMENTAL APPLICATION

Office of the City Clerk License Division  
200 E. Wells St. Room 105, Milwaukee, WI 53202  
(414) 286-2238 e-mail address: license@milwaukee.gov [www.milwaukee.gov/license](http://www.milwaukee.gov/license)

Legal Entity Name: <u>LISBON FOOD &amp; BEER INC</u>	
Premise Address: <u>1401 W. LISBON AVE MILWAUKEE, WI 53208</u>	
<b>Proximity of Premises to Church, School, Daycare Center or Hospital</b>	
Is the building within 300 feet of any church, school, daycare center or hospital? <input checked="" type="checkbox"/> No <input type="checkbox"/> Yes	
<b>"Service Bar Only" Designation</b>	
If applying for Class B or C license, are you applying for "Service Bar Only"? <input checked="" type="checkbox"/> No <input type="checkbox"/> Yes	
Service Bar Only means customers cannot sit at the bar. Alcohol is served to employees who serve patrons seated at tables. No stools, chairs or other articles of furniture shall be placed at the service bar for patrons to sit upon.	
<b>Business Information</b>	
a) Are you taking out this application for anyone that may not be eligible for a license? <input checked="" type="checkbox"/> No <input type="checkbox"/> Yes	
If yes, list their name and address: _____	
b) Will the agent, a partner or the individual licensee be conducting the day-to-day operations of the business? <input type="checkbox"/> No <input checked="" type="checkbox"/> Yes	
If no, list the name and address of the person(s) who will: _____	
Class B Applicants: If the agent, a partner or the individual licensee will not be conducting the day-to-day operations of the business, the person(s) listed above must obtain a Class B Managers license.	
c) Does anyone else have money invested or any other interest in this business? <input checked="" type="checkbox"/> No <input type="checkbox"/> Yes	
If yes, explain: _____	
d) Have you made an agreement with anyone to repay any loan or any other payments based upon income from the business? <input checked="" type="checkbox"/> No <input type="checkbox"/> Yes	
If yes, list name and address: _____	
<b>Property Information (New &amp; Transfer Applicants Only)</b>	
a) Do you own or lease the building? <input type="checkbox"/> Own <input checked="" type="checkbox"/> Lease	
b) Who owns the fixtures (for example, coolers, etc.)? <u>LICENSEE</u>	
c) Are you purchasing the stock and/or fixtures? <input checked="" type="checkbox"/> No <input type="checkbox"/> Yes If yes, amount paid \$ _____	
d) Total amount paid for business \$ <u>0</u>	
e) Total amount paid for goodwill of the business \$ <u>0</u>	
Goodwill comprises the reputation and customer relationships of an existing business. If the price you pay for the business exceeds the fair market value of all of the rest of the assets of the business, the excess may be considered goodwill.	
f) Have you made arrangements with the seller for payment of personal property taxes? <input type="checkbox"/> No <input checked="" type="checkbox"/> Yes	
<b>Lease Information (New &amp; Transfer Applicants who are leasing the premises only)</b>	
a) Date lease begins <u>SEP 2019</u> Ends <u>AUG 31 2021</u>	
b) Monthly rental \$ <u>1500</u>	
c) Do you have an option to renew the lease? <input type="checkbox"/> No <input checked="" type="checkbox"/> Yes	
d) Does your lease allow for assignment to another party without the consent of the owner? <input checked="" type="checkbox"/> No <input type="checkbox"/> Yes	
e) For what length of time have you been guaranteed occupancy (number of years)? <u>5 YRS</u>	

**Lease Information (Continued)**

- f) In addition to paying the monthly rental, will you have to pay anything additional to the owner of the building to guarantee performance of the lease?  No  Yes If yes, explain \_\_\_\_\_
- g) Does the present owner or occupancy object to the granting of your license?  No  Yes  
If yes, explain \_\_\_\_\_

**Change of Agent Applicants Only**

Have there been any changes to the floor plan since the last application was submitted?  No  Yes  
If no, a new floor plan is not required. If yes, submit a new floor plan and explain the change(s):  
\_\_\_\_\_

**Signature**

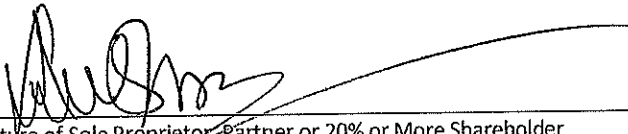

Signature of Sole Proprietor, Partner or 20% or More Shareholder  
(If no 20% or more Shareholder, Corporate Officer - print name/title and sign)

Note: All information contained in this application is subject to approval by the Common Council.  
Deviating from approved plan of operation will subject licensee to citations, and/or suspension or non-renewal of the license.  
Contact the License Division for information on how to request changes.

**New and transfer of premises applicants must submit the following:**

- Detailed floor plan
- If a restaurant, copy of the menu



## PUBLIC ENTERTAINMENT PREMISES LICENSE SUPPLEMENTAL APPLICATION

Office of the City Clerk License Division  
200 E. Wells St. Room 105, Milwaukee, WI 53202  
(414) 286-2238 [www.milwaukee.gov/license](http://www.milwaukee.gov/license) e-mail address: [license@milwaukee.gov](mailto:license@milwaukee.gov)

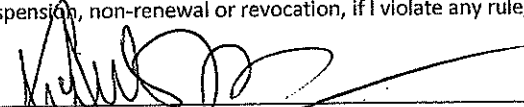
<b>PREMISES ADDRESS:</b> 4401 W. LISBON AVE MILWAUKEE, WI 53208			
<b>TYPES OF ENTERTAINMENT (CHECK ALL THAT APPLY)</b>			
<input type="checkbox"/> Instrumental Musicians	<input type="checkbox"/> Battle of the Bands	<input type="checkbox"/> Dancing by Performers	<input checked="" type="checkbox"/> Amusement Machines How many? <u>2</u>
<input type="checkbox"/> Bands	<input type="checkbox"/> Comedy Acts	<input type="checkbox"/> Adult Entertainment/ Strippers/Erotic Dance	<input type="checkbox"/> Concerts Approx. # per year? _____
<input type="checkbox"/> Bowling Alley How many? _____	<input type="checkbox"/> Disc Jockey	<input type="checkbox"/> Wrestling	<input type="checkbox"/> Theatrical Performances Approx. # per year? _____
<input type="checkbox"/> Pool Tables How many? _____	<input type="checkbox"/> Magic Shows	<input type="checkbox"/> Patron Contests	<input type="checkbox"/> Jukebox
<input type="checkbox"/> Motion Pictures (movies by admission) - How many? _____	<input type="checkbox"/> Poetry Readings	<input type="checkbox"/> Patrons Dancing	<input type="checkbox"/> Karaoke
<input type="checkbox"/> Other: _____			
<i>Entertainment Outdoor Closing Hours: 10:00pm Sunday-Thursdays; 12:00am Friday &amp; Saturday; unless a different time, either earlier or later, is established by the Common Council in its approval of the licensee's plan of operation.</i>			
<b>PROMOTERS/SOUND AMPLIFICATION</b>			
Will promoters ever be used for any of the entertainment? <input checked="" type="checkbox"/> No <input type="checkbox"/> Yes If Yes, Describe: _____			
At any time will sound amplification be used? <input checked="" type="checkbox"/> No <input type="checkbox"/> Yes If Yes, Describe: _____			
<b>LEGAL CAPACITY OF PREMISES</b> <span style="float: right; font-size: 1.2em;">NONE</span>			
_____ (Call the Development Center at 414-286-8211 with questions.) Legal capacity determines the fee for your Public Entertainment Premises License. If you would like to request the license be approved with a lower capacity than that listed above, indicate the lower capacity here: _____. If approved, this lower capacity will print on your license and override the capacity listed on your Occupancy Permit.			
<b>ACKNOWLEDGEMENT/SIGNATURE</b>			
I understand that after the license has been issued, a change to the plan of operation will require a written request to change and approval from the Common Council. I agree to inform the City Clerk within 10 days of any substantial changes in the information supplied in this application. I understand that I shall not willfully refuse to provide the services offered under this license, or add charges or require deposits not required of the general public because of race, color, sex, religion, national origin or ancestry, age, handicap, lawful source of income, marital status, sexual orientation, gender identity or expression, familial status or the fact that a person is now or has been a member of the military service, whether dressed in uniform or not; and shall not seek such information as a condition of employment, or penalize any employee or discriminate in the selection of personnel for training or promotion on the basis of such information.			
I have knowledge of the City Ordinances currently regulating public entertainment, and understand that the license may be subject to suspension, non-renewal or revocation, if I violate any rule, law or regulation of the city of Milwaukee and State of Wisconsin.			
 _____ Signature of Sole Proprietor, Partner or 20% or More Shareholder (If no 20% or more Shareholder, Corporate Officer - print name/title and sign)			

**Office Use Only:**

Initials: \_\_\_\_\_ Filed: \_\_\_\_\_ App: \_\_\_\_\_

Only PEP?  No  Yes If Yes,  Queue to MPD and  Email Mgrs/Team Lead (must be heard w/in 60 days)

FLOOR PLAN OF 4401 W. LISBON AVE. MILWAUKEE - 53208  
 LISBON FOOD & BEER INC.

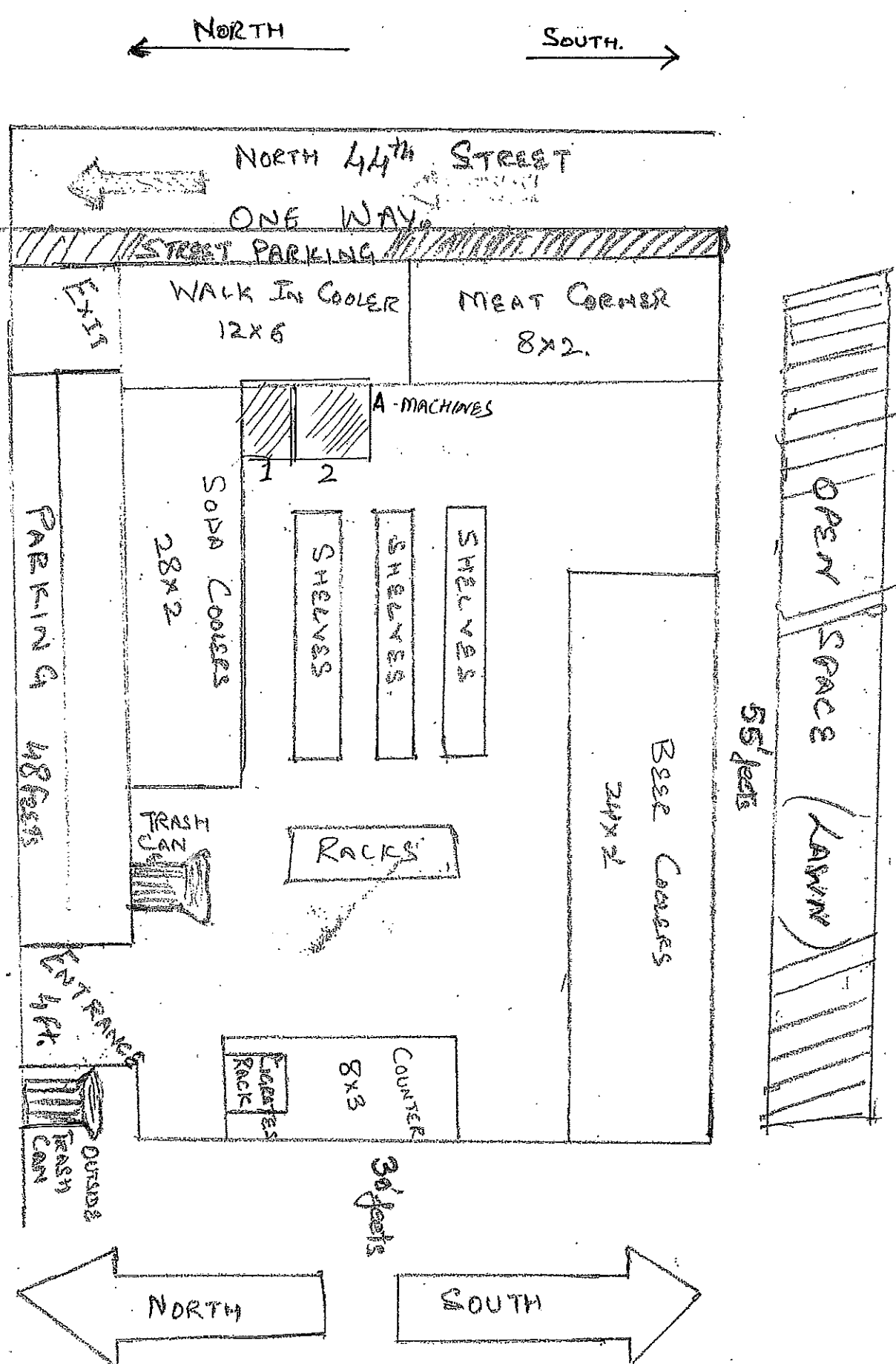

ASHWANI SHARMA  
 AGENT FOR "LISBON FOOD & BEER INC."  
 4401 W. LISBON AVE.  
 MILWAUKEE 53208

NORTH LISBON AVE.  
 DATE: MAY 29th 2019.

TOTAL SQ  
 FOOTAGE =