



CITY OF MILWAUKEE
OFFICE OF THE CITY CLERK

Tuesday, September 01, 2020

COMMITTEE MEETING NOTICE

AD 07

DHILLON, Baljinder S, Agent
Neighborhood Petro, Inc.
3381 N 35TH St

Milwaukee, WI 53216

You are requested to attend a virtual hearing to be held on:

Tuesday, September 08, 2020 at 03:10 PM

Regarding: Your Extended Hours Establishments, Food Dealer, Filling Station, and Weights & Measures License Applications Requesting to be Open 24 Hrs as agent for Neighborhood Petro, Inc." for "Hometown" at 3381 N 35TH St.

This meeting will be held via GoToMeeting. Please see the enclosed best practices document for further instructions. The access code is <https://global.gotomeeting.com/join/530391517>. If you wish to call in, please call +1 (872) 240-3412 and use Access Code: 530-391-517.

There is a possibility that your application may be denied for one or more of the following reasons: The recommendation of the committee regarding the application shall be based on evidence presented at the hearing. Per MCO 85-2.7-4, probative evidence concerning whether or not a new license should be granted may be presented on the following subjects: whether or not the applicant meets the municipal requirements, the appropriateness of the location and premises where the licensed premises is to be located and whether use of the premises for the purposes or activities permitted by the license would tend to facilitate a public or private nuisance or create undesirable neighborhood problems such as disorderly patrons, unreasonably loud noise, litter, and excessive traffic and parking congestion. Probative evidence relating to these matters may be taken from the plan of operation submitted with the license application, if any, but shall not include the content of any music. Evidence regarding the fitness of the location of the premises to be maintained as the principal place of business, including but not limited to whether there is an overconcentration of businesses of the type for which the license is sought; whether the proposal is consistent with any pertinent neighborhood business or development plans, or the location's proximity to areas where children are typically present. The applicant's record in operating similarly licensed premises; and whether or not the applicant has been charged with or convicted of any felony, misdemeanor, municipal offense or other offense, the circumstances of which substantially relate to the activity to be permitted by the license being applied for or any other factor which reasonably relates to the public health, safety or welfare may also be considered. See attached police report or correspondence.

Notice for applicants with warrants or unpaid fines: Proof of warrant satisfaction or payment of fines must be submitted at the hearing on the above date and time. Failure to comply with this requirement may result in a delay of the granting/denial of your application.

Failure to attend this meeting may result in the denial of your license. Individual applicants and partnership applicants must attend or attend by an attorney. The agent or attorney for corporate or limited liability applicants must attend. If you wish to do so and at your own expense, you may be accompanied by an attorney of your choosing to represent you at this hearing.

You will be given an opportunity to speak on behalf of the application and to respond and challenge any charges or reasons given for the denial. No petitions can be accepted by the committee, unless the people who signed the petition attend the virtual hearing and are willing to testify. You may present witnesses under oath and you may also confront and cross-examine opposing witnesses under oath. If you have difficulty with the English language, you should request an interpreter attend the meeting with you, at your expense, so that you can answer questions and participate in your hearing.

PLEASE NOTE: Upon reasonable notice, efforts will be made to accommodate the needs of disabled individuals through sign language interpreters or other auxiliary aids. For additional information or to request this service, contact the Council Services Division ADA Coordinator at (414) 286-2998, Fax - (414) 286-3456, TDD - (414) 286-2025.

JIM OWCZARSKI, CITY CLERK

BY: _____

Jessica Celella

License Division Manager

If you have questions regarding this meeting, please contact the staff assistant, Molly Kuether-Steele at (414) 286-2775 or molly.kuether-steele@milwaukee.gov.

200 E. Wells Street, Room 105, City Hall, Milwaukee, WI 53202. www.milwaukee.gov/license
Phone: (414) 286-2238 Fax: (414) 286-3057 Email Address: License@milwaukee.gov



CITY OF MILWAUKEE
OFFICE OF THE CITY CLERK

Tuesday, September 01, 2020

COMMITTEE MEETING NOTICE

AD 07

DHILLON, Baljinder S, Agent
Neighborhood Petro, Inc.
6595 S 46TH St

Franklin, WI 53132

You are requested to attend a virtual hearing to be held on:

Tuesday, September 08, 2020 at 03:10 PM

Regarding: Your Extended Hours Establishments, Food Dealer, Filling Station, and Weights & Measures License Applications Requesting to be Open 24 Hrs as agent for "Neighborhood Petro, Inc." for "Hometown" at 3381 N 35TH St.

This meeting will be held via GoToMeeting. Please see the enclosed best practices document for further instructions. The access code is <https://global.gotomeeting.com/join/530391517>. If you wish to call in, please call +1 (872) 240-3412 and use Access Code: 530-391-517.

There is a possibility that your application may be denied for one or more of the following reasons: The recommendation of the committee regarding the application shall be based on evidence presented at the hearing. Per MCO 85-2.7-4, probative evidence concerning whether or not a new license should be granted may be presented on the following subjects: whether or not the applicant meets the municipal requirements, the appropriateness of the location and premises where the licensed premises is to be located and whether use of the premises for the purposes or activities permitted by the license would tend to facilitate a public or private nuisance or create undesirable neighborhood problems such as disorderly patrons, unreasonably loud noise, litter, and excessive traffic and parking congestion. Probative evidence relating to these matters may be taken from the plan of operation submitted with the license application, if any, but shall not include the content of any music. Evidence regarding the fitness of the location of the premises to be maintained as the principal place of business, including but not limited to whether there is an overconcentration of businesses of the type for which the license is sought; whether the proposal is consistent with any pertinent neighborhood business or development plans, or the location's proximity to areas where children are typically present. The applicant's record in operating similarly licensed premises; and whether or not the applicant has been charged with or convicted of any felony, misdemeanor, municipal offense or other offense, and circumstances of which substantially relate to the activity to be permitted by the license being applied for or any other factor which reasonably relates to the public health, safety or welfare may also be considered. See attached police report or correspondence.

Notice for applicants with warrants or unpaid fines: Proof of warrant satisfaction or payment of fines must be submitted at the hearing on the above date and time. Failure to comply with this requirement may result in a delay of the granting/denial of your application.

Failure to attend this meeting may result in the denial of your license. Individual applicants and partnership applicants must attend or attend by an attorney. The agent or attorney for corporate or limited liability applicants must attend. If you wish to do so and at your own expense, you may be accompanied by an attorney of your choosing to represent you at this hearing.

You will be given an opportunity to speak on behalf of the application and to respond and challenge any charges or reasons given for the denial. No petitions can be accepted by the committee, unless the people who signed the petition attend the virtual hearing and are willing to testify. You may present witnesses under oath and you may also confront and cross-examine opposing witnesses under oath. If you have difficulty with the English language, you should request an interpreter attend the meeting with you, at your expense, so that you can answer questions and participate in your hearing.

PLEASE NOTE: Upon reasonable notice, efforts will be made to accommodate the needs of disabled individuals through sign language interpreters or other auxiliary aids. For additional information or to request this service, contact the Council Services Division ADA Coordinator at (414) 286-2998, Fax - (414) 286-3456, TDD - (414) 286-2025.

JIM OWCZARSKI, CITY CLERK

BY: _____

Jessica Celella

License Division Manager

If you have questions regarding this meeting, please contact the staff assistant, Molly Kuether-Steele at (414) 286-2775 or molly.kuether-steele@milwaukee.gov.

200 E. Wells Street, Room 105, City Hall, Milwaukee, WI 53202. www.milwaukee.gov/license
Phone: (414) 286-2238 Fax: (414) 286-3057 Email Address: License@milwaukee.gov

310076

Moon Siefert, Linda

From: License
Sent: Monday, June 1, 2020 9:25 AM
To: Moon Siefert, Linda
Cc: Martin, Faviola; Byrd, Yashica; Cooney, Jim
Subject: FW: license for 3381 N 35th St

Follow Up Flag: Follow up
Flag Status: Flagged

Categories: Red Category

REDACTED RECORD

Please add

Jessica Celella
Deputy City Clerk
200 E Wells St Room 205, Milwaukee, WI 53202
(414) 286-2362



From: _____
Sent: Friday, May 29, 2020 12:18 PM
To: License <LICENSE@milwaukee.gov>
Subject: license for 3381 N 35th St

I am opposed to the granting of this license , 1) we don't need a 24 hour station in the inner city we are not on a highway
2) the majority of people that go there don't live in the neighborhood 3) we have been having more breakins I think the
people driving down the alley are looking for things 4)If we didn't have this station there the traffic would be less. 5)We are
tired of the gun shots coming from that area it's almost every night. this station gives nothing to the community they take
from it ,trash coming from there, speeding down the alley etc. I have lived in this house since 1973 we are tired of our
neighborhood being raped. my name is _____ ,I am a voter I objected to the porn movie shot
there with the owner present ,so that shows total disrespect for us as people.

Moon Siefert, Linda

From: Celella, Jessica
Sent: Friday, June 5, 2020 2:24 PM
To: Moon Siefert, Linda
Cc: Martin, Faviola; Byrd, Yashica; Cooney, Jim
Subject: FW: Gas station on 35 street.

Can you add this objection when you are next in? This is for Hometown.

Jessica Celella
Deputy City Clerk
200 E Wells St Room 205, Milwaukee, WI 53202
(414) 286-2362

REDACTED RECORD



From: Celella, Jessica
Sent: Monday, June 01, 2020 11:36 AM
To: John Reid
Subject: Re: Gas station on 35 street.

Good morning,

I received your voicemail and we'll add your objection to the file.

Best regards,

Jessica Celella
Deputy City Clerk
200 E Wells St Room 205, Milwaukee, WI 53202
(414) 286-2362

From: License
Sent: Monday, June 1, 2020 8:13:33 AM
To: License <LICENSE@milwaukee.gov>
Subject: RE: Gas station on 35 street.

Good morning,

Can you please provide the name or address of the business you are in objection to?

Thank you,

Jessica Celella
Deputy City Clerk
200 E Wells St Room 205, Milwaukee, WI 53202
(414) 286-2362



REDACTED RECORD

From:

Sent: Friday, May 29, 2020 5:59 PM

To: License <LICENSE@milwaukee.gov>

Subject: Gas station on 35 street.

We want the gas station closed because of the sex tape, loitering ,drug selling trash everywhere
356 n 36 street

Sent from my iPhone

Sent from my iPhone

MILWAUKEE POLICE DEPARTMENT LICENSING

CRIMINAL RECORD/ORDINANCE VIOLATION/INCIDENTS SYNOPSIS

DATE: 05/22/20
LICENSE TYPE: 24HR/FOOD/FILLING
NEW:
RENEWAL:

No. 310076/310077/310081
Application Date: 05/21/20

License Location: 3381 N. 35th Street
Business Name: Hometown

Licensee/Applicant: Dhillon, Baljinder S.
(Last Name, First Name, MI)

Date of Birth: 04/15/1977

Home Address: 6595 S. 46th Street
City: Franklin **State:** WI **Zip Code:** 53132
Home Phone: 414-303-5719

This report is written by Police Officer Corstan D. COURT, assigned to the License Investigation Unit, Days.

The Milwaukee Police Department's investigation regarding this application revealed the following:

1. On 10/01/16 the applicant was cited in the City of Milwaukee at 3476 N. Holton Ave for Sale of Cigarette to Minor/Underage.

Charge: Sale of Cigarette to Minor/Underage
Finding: Guilty
Sentence: \$280.00 fine
Date: 10/30/17
Case: 16065997

2. On 05/22/19 the applicant was issued a citation in the City of Milwaukee at 103 E. Keefe Avenue for Sale of Cigarette to Minor/Underage which occurred on 08/11/18.

Charge: Sale of Cigarette to Minor/Underage
Finding: Guilty
Sentence: \$500.00 fine
Date: 12/05/19
Case: 19026305

3. On 07/11/19 the applicant was cited in the City of Milwaukee at 103 E. Keefe Avenue for Responsible Person on Premise Required.

Charge: Responsible Person on Premise Required
Finding: Court date 11/03/20
Sentence:
Date:
Case: 19029870



Tuesday, September 1, 2020



Notice of Public Hearing

blank
notice

DHILLON, Baljinder S, Agent
Hometown at 3381 N 35TH St

Extended Hours Establishments, Food Dealer, Filling Station, and Weights & Measures License
Applications Requesting to be Open 24 Hrs

Tuesday, September 08, 2020 at 3:10 PM

To whom it may concern:

The above application has been made by the above named applicant(s). This requires approval from the Licenses Committee and the Common Council of the City of Milwaukee. The hearing before the Licenses Committee will take place virtually on 9/8/2020 at 3:10 PM. This is a public hearing. Those wishing to view the proceeding are able to do so via the City Channel – Channel 25 on Spectrum Cable – or on the Internet at <http://city.milwaukee.gov/citychannel>. Those wishing to provide oral testimony will be asked to do so by phone or internet and are asked to contact the staff assistant, Molly Kuether-Steele at (414) 286-2775 or molly.kuether-steele@milwaukee.gov for necessary information. Please make such requests no later than one business day prior to the start of the meeting. You are not required to attend the hearing, but please see the information below if you would like to provide testimony. Once the Licenses Committee makes its recommendation, this recommendation is forwarded to the full Common Council for approval at its next regularly scheduled hearing.

Important details for those wishing to provide information for the Licenses Committee to consider when making its recommendation:

1. The license application is scheduled to be heard at the above time. Due to other hearings running longer than scheduled, you may have to wait some time to provide your testimony.
2. You must testify as to matters that you have personally experienced or seen. (You cannot provide testimony for your neighbor, parent or anyone else; this is considered hearsay and cannot be considered by the committee.)
3. No letters or petitions can be accepted by the committee (unless the person who wrote the letter or the persons who signed the petition are willing to testify).
4. Persons opposed to the license application are given the opportunity to testify first; supporters may testify after the opponents have finished.
5. When you are called to testify, you will be sworn in and asked to give your name, and address. (If your first and/or last names are uncommon please spell them.)
6. You may then provide testimony.
 - a. Include only information relating to the above license application.
 - b. Include only information you have personally witnessed or seen.
 - c. Provide concise and relevant information detailing how this business has affected or may affect the peaceful enjoyment of your neighborhood.
 - d. If by the time you have the opportunity to testify, the information you wish to share has already been provided to the committee, you may state that you agree with the previous testimony. Redundant or repetitive testimony will not assist the committee in making its recommendation.
7. After giving your testimony, the members of the Licenses Committee and the licensee may ask questions regarding the testimony you have given or other factors relating to the license application.
8. Business Competition is not a valid basis for denial or non-renewal of a license.

Please Note: If you have submitted an objection to the above application your objection cannot be considered by the committee unless you personally testify at the hearing.

OCCUPANT	MAIL ADDRESS	CITY, STATE ZIP
CURRENT OCCUPANT	3380 N 36TH ST	MILWAUKEE, WI 53216
CURRENT OCCUPANT	3362 N 36TH ST	MILWAUKEE, WI 53216
CURRENT OCCUPANT	3352 N 36TH ST	MILWAUKEE, WI 53216
CURRENT OCCUPANT	3422 N 36TH ST	MILWAUKEE, WI 53216
CURRENT OCCUPANT	3403A N 36TH ST	MILWAUKEE, WI 53216
CURRENT OCCUPANT	3376 N 36TH ST	MILWAUKEE, WI 53216
CURRENT OCCUPANT	3349 N 36TH ST	MILWAUKEE, WI 53216
CURRENT OCCUPANT	3361 N 36TH ST	MILWAUKEE, WI 53216
CURRENT OCCUPANT	3367 N 36TH ST	MILWAUKEE, WI 53216
CURRENT OCCUPANT	3375 N 36TH ST	MILWAUKEE, WI 53216
CURRENT OCCUPANT	3336 N 36TH ST	MILWAUKEE, WI 53216
CURRENT OCCUPANT	3351 N 36TH ST	MILWAUKEE, WI 53216
CURRENT OCCUPANT	3367A N 36TH ST	MILWAUKEE, WI 53216
CURRENT OCCUPANT	3342 N 36TH ST	MILWAUKEE, WI 53216
CURRENT OCCUPANT	3416 N 36TH ST	MILWAUKEE, WI 53216
CURRENT OCCUPANT	3527 W TOWNSEND ST	MILWAUKEE, WI 53216
CURRENT OCCUPANT	3366 N 36TH ST	MILWAUKEE, WI 53216
CURRENT OCCUPANT	3387 N 36TH ST	MILWAUKEE, WI 53216
CURRENT OCCUPANT	3403 N 36TH ST	MILWAUKEE, WI 53216
CURRENT OCCUPANT	3524 W TOWNSEND ST	MILWAUKEE, WI 53216
CURRENT OCCUPANT	3370 N 36TH ST	MILWAUKEE, WI 53216
CURRENT OCCUPANT	3515 W TOWNSEND ST	MILWAUKEE, WI 53216
CURRENT OCCUPANT	3371 N 36TH ST	MILWAUKEE, WI 53216
CURRENT OCCUPANT	3346 N 36TH ST	MILWAUKEE, WI 53216
CURRENT OCCUPANT	3406 N 36TH ST	MILWAUKEE, WI 53216
CURRENT OCCUPANT	3380A N 36TH ST	MILWAUKEE, WI 53216
CURRENT OCCUPANT	3356 N 36TH ST	MILWAUKEE, WI 53216
CURRENT OCCUPANT	3409 N 36TH ST	MILWAUKEE, WI 53216
CURRENT OCCUPANT	3383 N 36TH ST	MILWAUKEE, WI 53216
CURRENT OCCUPANT	3355 N 36TH ST	MILWAUKEE, WI 53216
CURRENT OCCUPANT	3357 N 36TH ST	MILWAUKEE, WI 53216
CURRENT OCCUPANT	3363 N 36TH ST	MILWAUKEE, WI 53216
CURRENT OCCUPANT	3412 N 36TH ST	MILWAUKEE, WI 53216
CURRENT OCCUPANT	3402 N 36TH ST	MILWAUKEE, WI 53216
CURRENT OCCUPANT	3384 N 36TH ST	MILWAUKEE, WI 53216

blank

notice

Total Records: 35

Radius: 250.0 feet and Center of Circle: 3381 N 35th St



BUSINESS LICENSE PLAN OF OPERATION

ccl-busplan 3/15/18

Office of the City Clerk License Division
200 E. Wells St. Room 105, Milwaukee, WI 53202
(414) 286-2238 www.milwaukee.gov/license e-mail address: license@milwaukee.gov

1. Type of Business

Applying for: Extended Hours (12AM to 5AM) - If a food establishment, check all that apply: Delivery Drive Thru Dining Room
 Self Service Laundry Massage Establishment Filling Station
 Other (supplemental application for specific license also required)

Provide a detailed description of the type of business you plan on operating:

Fuel Station for Autos And Convenience store with Food share / WIC

Do you have any experience operating this type of business? No Yes If yes, explain: Own and Operate Hometown at

2. Business Operations

3476 N. Holton has same Licenses

- a. Proposed Opening Date: May 1, 2020
- b. Is this premise under construction? No Yes If yes, list estimated completion date: _____
- c. Is this a franchise? No Yes
- d. Is this premises currently licensed? No Yes If yes, list type of license: GAS Station, Food, 24 hours / Convenience store
- e. Is the current licensee operating? No Yes If no, list date closed: _____
- f. Do you have future plans for other businesses, licenses or permits at this location? No Yes
If yes, explain: ~~Yes~~
- g. Have you previously held an Extended Hours license in Milwaukee? No Yes
If yes, list address(es): 3476 N. Holton St. still in operation
- h. Are other businesses operating in the same building? No Yes If yes, describe: _____

3. Litter & Noise

- a. How are grounds kept clean? Sweep Pressure Wash Pick Up Litter Other: _____
- b. How often will grounds be cleaned? Daily Weekly As Needed Monthly Other: _____
- c. Grounds cleaned by: Licensee Building Owner Employees Hired Maintenance Other: _____
- d. How are noise issues prevented and/or addressed? Security Manager approaches customer(s) Call Police
 Signs Posted Other: _____
- e. Will a sound amplification system be used? No Yes If yes, describe: _____

4. Smoking & Sanitation

- a. Are there designated outdoor smoking areas? No Yes If yes, describe: _____
- b. Number of Garbage Cans: Inside: 3 Locations: _____
Outside: 6 Locations: _____
- c. Is a crowd control barrier used? No Yes If yes, describe: _____
- d. How many restrooms are on the premises? 2 1 For Public
- e. Name of solid waste contractor: Advanced Disposal Waste Management Other: _____

5. Security

- a. Are there onsite parking spaces? No Yes If yes, how many? 2 and describe the parking security plan: Camera
- b. Is there a loading zone? No Yes If yes, describe the loading area security plan: _____
- c. Will you have security personnel on premise? No Yes If yes, how many? 1 and answer the following:
 What are their responsibilities? If CUSTOMERS become unruly/stop it, call Alice
 Is security equipment used? No Yes If yes, describe _____
 List their licensing, certification, or training credentials _____
- d. Will there be security cameras? No Yes If yes, how many? 16 and list locations: Entire Fueling Area / BACK Exterior / Side Exterior / Entire Interior
- e. Will searches/identification checks be done upon entry? No Yes If yes, describe _____

6. Percentage of Sales (must total 100%)

Alcohol _____%	Food <u>55</u> %	Secondhand Merchandise _____%	Precious Metals & Gems _____%
Entertainment _____%	Cigarettes <u>10</u> %	Personal Services (such as tattoo, body piercing, salon, tailor, tanning, etc.) _____%	Other <u>35</u> %
Pawnbroker Activity _____%	Salvaged Materials _____% (such as scrap metal)		Describe: <u>Gifts</u>

7. Businesses/Licenses on the Premises (check all that apply):

Type 1

- Full Service Restaurant Cafe/Coffee Shop Deli or Fast Food Restaurant Private/Fraternal/Veterans Club
- Night Club Tavern Cocktail Lounge Teen Club
- Banquet Hall Sports Facility Bowling Alley
- Hotel/Motel: Number of Floors: _____ Rooming House: Number of Floors: _____
 Number of Rooms: _____ Number of Rooms: _____

Type 2

- Liquor Store Corner Store Supermarket Convenience Store
- Gas Station Amusement/Phonograph Distributor Recycling, Salvage or Towing
- Used Car Dealer Personal Service Establishment (such as tattoo business, hair salon, tailor, etc.) Recording Studio

What other licenses/permits will you hold at this location? (check all that apply)

- Occupancy Permit Cigarette & Tobacco Gas Station Extended Hours Class "B" Tavern Weights & Measures
- Secondhand Dealer Precious Metal & Gem Other: _____

8. Legal Capacity (only if a Type 1 premises in #7 above)

Capacity _____ (Call the Milwaukee Development Center at 414-286-8211 if you have questions.)

9. Premises Description

a. Identify all area(s) of the premises that will be used in operating this business (include areas used only for storage):

1st Floor 2nd Floor Basement Storage Patio Beer Garden Sidewalk Café Deck Rooftop

Other: Describe: _____

b. Describe Location: Major Thoroughfare Secondary Street Other: 35th and Townsend

c. Nearest Major Cross Street: Townsend

d. Describe Building: Free Standing Building Strip Mall Other: _____

e. Describe Premises Structure: Single Story Multi-Story - # of Stories 1 Other: _____

f. Describe Surrounding Area: Commercial Residential Industrial Other: _____

g. Building Owner Name: Manwinder Singh Ahagat Phone Number: _____

Business Owner Address: 8929 S. Pond View Dr., OAKCREEK, W.I. 53154

10. Hours of Operation & Customers

Will customers be entering the premises? No Yes

Day of the Week	Proposed Hours of Operation:		Estimated Number of Customers expected each day	Potential Age Range of Customers	Class B Tavern Applicant Only: Age Restriction (If none, write 'None')
	Open Time: (include a.m. or p.m.)	Close Time (include a.m. or p.m.)			
Sunday	12:00 A.M.	None 24 hrs.	100 ±	10-100	
Monday	12:00 A.M.	None 24 hrs.	100 ±	10-100	
Tuesday	12:00 A.M.	None 24 hrs.	100 ±	10-100	
Wednesday	12:00 A.M.	None 24 hrs.	100 ±	10-100	
Thursday	12:00 A.M.	None 24 hrs.	100 ±	10-100	
Friday	12:00 A.M.	None 24 hrs.	100 ±	10-100	
Saturday	12:00 A.M.	None 24 hrs.	100 ±	10-100	

An Extended Hours Establishment License is required for any convenience store, filling station, personal service establishment (such as tattoo, body piercing, salon, tailor, tanning, etc.), recording studio or restaurant which is open between the hours of 12:00 a.m. and 5:00 a.m.

Alcohol Establishments Class A: 8:00 am to 9:00 pm Sunday thru Saturday
Permitted Hours of Operation: Class B: 6:00 am to 2:00 am Sunday thru Thursday, 6:00 am to 2:30 am Friday & Saturday

Entertainment Outdoor Closing Hours: 10:00pm Sunday-Thursday; 12:00am Friday & Saturday; unless a different time, either earlier or later, is established by the Common Council in its approval of the licensee's plan of operation.

11. Signature(s)

B. Shalton Shareholder 95%

Signature of Sole Proprietor, Partner, or 20% or more Shareholder
(If there are no 20% or more shareholders,
Corporate Officer-print name/title and sign)

Signature of additional partner or 20% or more shareholder

See Application Information for a complete list of all required application forms.



**FILLING STATION LICENSE AND
WEIGHTS & MEASURES (RETAIL PETROLEUM METERS)
LICENSE SUPPLEMENTAL APPLICATION**

OFFICE OF THE CITY CLERK, LICENSE DIVISION
CITY HALL, 200 E. WELLS ST, ROOM 105, MILWAUKEE, WI 53202
(414) 286-2238 • license@milwaukee.gov • www.milwaukee.gov/license

Legal Entity Name: <u>Neighborhood Petro, Inc.</u>	
Premise Address: <u>3381 N. 35th St. Milwaukee, WI 53216</u>	
Filling Station License Fee	\$ 275
Weights & Measures License Fee	
Number of Retail Petroleum Meters* <u>8</u>	x \$60 per meter = \$ <u>480.00</u>
<p>*For each nozzle, count the number of grades (not including midgrade if mixed in the pump), add the number of all grades together and that is your number of retail petroleum meters.</p> <p style="margin-left: 40px;"><u>3 grades</u></p>	
<p>Will electronic scanners be used to determine/record the price of items? <input checked="" type="checkbox"/> No <input type="checkbox"/> Yes</p> <p>Will scales be used to price items based on their weight? <input checked="" type="checkbox"/> No <input type="checkbox"/> Yes</p> <p>If yes to either or both questions, a separate Weights & Measures License Application must be submitted for these devices.</p>	
Acknowledgements and Signature	
<p>I confirm that all information is true and correct. I understand any changes to the information in this application must be reported to the City Clerk License Division within 10 days. I have knowledge of the City of Milwaukee ordinances currently regulating the licenses applied for and understand that the licenses may be subject to suspension, non-renewal, or revocation if I violate these regulations.</p>	
<p><u><i>BS Wilson</i></u> <u>Shareholder</u></p> <p>Signature of Sole Proprietor, Partner, or 20% or more Shareholder (If no 20% or more Shareholder, Corporate Officer must sign and provide title)</p>	
<p>_____ Signature of Additional Partner or 20% or more Shareholder</p>	
<p>Submit this form with the following:</p> <ul style="list-style-type: none"> • Business License Application • Business Plan of Operation • Floor plan • License fees <p>Forms can be obtained online at www.milwaukee.gov/licenses</p>	

Office Use Only:		
App# _____	Filed _____	Initials _____
Paid _____	MPD _____	CC _____
HD _____	DNS _____	Lic # _____



FOOD DEALER LICENSE PLAN OF OPERATION

OFFICE OF THE CITY CLERK, LICENSE DIVISION
CITY HALL, 200 E. WELLS ST, ROOM 105, MILWAUKEE, WI 53202
(414) 286-2238 • license@milwaukee.gov • www.milwaukee.gov/license

Legal Entity Name: Neighborhood Petro, Inc.
Premises Address: 3381 N. 35th St, Milwaukee, WI. 53216

SECTION 1 TYPE OF BUSINESS

What will be the majority of your food sales? (check one)

Restaurant Items (meals):
MEALS include, but are not limited to, chicken, ribs, sandwiches, roasted corn, baked potatoes, hot dogs, brats, tacos, nachos w/ cheese and meat, French fries, cooked or deep fried vegetables/fruit, cooked cheese curds, corn dogs, egg rolls, salads.

Retail Items (snacks and beverages):
RETAIL items include, but are not limited to, ice cream/soft serve, lemonade, snow cones, coffee, espresso, cappuccino, tea, fruit juice, smoothies, candy, dispensed soda, fruit cups, bakery, cookies, kettle corn, cotton candy, funnel cakes, fritters, tortilla chips w/ cheese.

Will it be a convenience store? Yes No
A convenience store contains less than 5,000 square feet of retail space and has, as its primary business, the sale of basic food items and in addition, sells household products or is a filling station that sells basic food items and household products.

Bed & Breakfast
 Micro Market

All Applicants: Submit a menu or a list of food items that will be sold. All packaged sandwiches, Candy, Snacks, Hot Dogs, Coffee, Drinks

Will any wholesale business be done? No Yes If yes, what percentage of food sales will be wholesale?

Less than 25%

25% or More AND:
 Restaurant items (meals) will be sold -- Complete this application and also contact DATCP.
 NO restaurant items (meals) will be sold - Do NOT complete this application. Contact DATCP only.

SECTION 2 FOOD PROCESSING

Will any food processing be done? No Yes

Processing is defined as assembling, grinding, cutting, mixing, baking, coating, stuffing, packing, bottling, grilling, canning, extracting, fermenting, distilling, pickling, freezing, drying, smoking, or packaging.

SECTION 3 FOOD REQUIRING TEMPERATURE CONTROL

Will any food that requires temperature control be sold? No Yes
(includes dairy products such as milk, cheese, and ice cream, fish, shellfish, meat, poultry)

If yes, list the types of food items: Dairy, Milk, Cheese, Coffee, Hot Dogs, Cold Drinks, Pre-Packaged Sandwich Food + Burritos Etc.

SECTION 4 DETAILS OF OPERATION

Will you have seating on site for dining? No Yes

Will you be doing any catering? No Yes

Will you be doing any delivery? No Yes

Will you have outdoor activities? No Yes - Check all that apply: Bar Cooking/Grilling Dining

Will you have a drive thru window? No Yes - Are hours different from inside? No Yes
 If Yes, provide drive thru hours: _____

Will scales or barcode scanners be used? No Yes - You must also apply for a Weights & Measures License.

SECTION 5 ADDITIONAL SITES

Where will food be prepared and/or sold? *N/A*

At a single site At multiple sites: How many? _____ (for example, a hotel with several dining rooms or bars)

If multiple sites, attach a Food Dealer Additional Site Addendum (ccl-foodadd) for each additional site.

SECTION 6 CONSTRUCTION OR CHANGES

Are you planning any construction, remodeling or equipment changes?

No If No, SKIP to Section 8

Yes If Yes, check all that apply: New construction of a building Renovation or remodeling
 Construction changes to existing building Equipment changes only

Provide a brief description of the changes: _____

Start date: _____

Name, Address & Phone Number of Architect: _____

Name, Address & Phone Number of Contractor: _____

SECTION 7 ALCOHOL BEVERAGES

Are you applying for an alcohol beverage license?

No If No, SKIP to Section 8

Yes If YES, if your food license is approved prior to the alcohol license, when do you want the food license issued?
 Immediately At the same time as the alcohol license

SECTION 8 ACKNOWLEDGEMENTS & SIGNATURE

You must initial each item confirming your understanding:

I understand the Health Department must conduct an inspection and advise the License Division of their approval before the license may be issued.

I understand I must obtain an occupancy permit from the Department of Neighborhood Services and an inspection may be required. Neighborhood Services must advise the License Division of their approval before the license may be issued.

I understand the district alderperson will review and either support or object to my application. If he/she objects, I may appeal and be scheduled to appear before the Licenses Committee. The Licenses Committee will then make a recommendation to the Common Council. The Common Council must grant the license before it may be issued.

I understand proof of payment for all license fees must be on file in the License Division before the license may be issued and the license must be issued and posted in my establishment prior to opening for business.

I will not operate my food business until the license has been issued and posted in the establishment.

Signature of Sole Proprietor, Partner, or 20% Shareholder: *B. Schmidt*

Signature of Additional Partner: _____

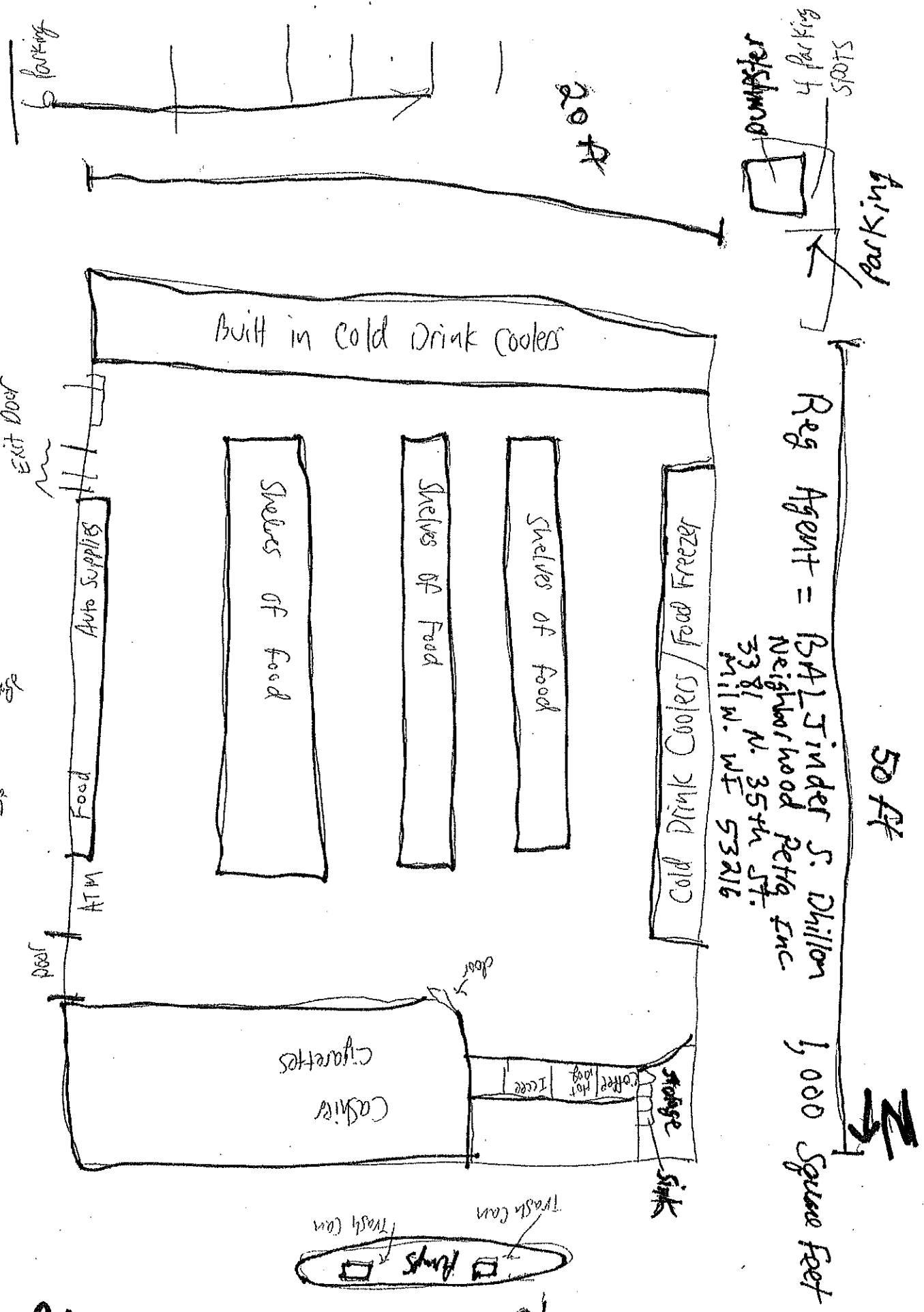

50 FT

Reg Agent = BAL Tinder S. Dhillon
 Neighborhood Petq Inc
 3381 N. 35th St.
 Millw. WI 53216

1,000 Square Feet

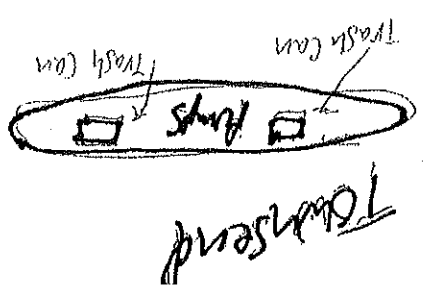

N
 ↓