



CITY OF MILWAUKEE
OFFICE OF THE CITY CLERK

Monday, June 22, 2020

COMMITTEE MEETING NOTICE

AD 09

LEWIS, Kamesha C, Agent
Tk's Smok'n Smoke House, LLC
10701 W Mill Rd

Milwaukee, WI 53225

You are requested to attend a virtual hearing to be held on:

Monday, July 06, 2020 at 09:50 AM

Regarding: Your Food Dealer and Food Peddler License Applications as agent for "Tk's Smok'n Smoke House, LLC" for "Tk's Smok'n Smoke House" at 7330 N 76TH S

This meeting will be held via GoToMeeting. Please see the enclosed best practices document for further instructions. The access code is <https://global.gotomeeting.com/join/832249261>. If you wish to call in, please call +1 (646) 749-3122 and use Access Code: 832-249-261.

There is a possibility that your application may be denied for one or more of the following reasons: The recommendation of the committee regarding the application shall be based on evidence presented at the hearing. Per MCO 85-2.7-4, probative evidence concerning whether or not a new license should be granted may be presented on the following subjects: whether or not the applicant meets the municipal requirements, the appropriateness of the location and premises where the licensed premises is to be located and whether use of the premises for the purposes or activities permitted by the license would tend to facilitate a public or private nuisance or create undesirable neighborhood problems such as disorderly patrons, unreasonably loud noise, litter, and excessive traffic and parking congestion. Probative evidence relating to these matters may be taken from the plan of operation submitted with the license application, if any, but shall not include the content of any music. Evidence regarding the fitness of the location of the premises to be maintained as the principal place of business, including but not limited to whether there is an overconcentration of businesses of the type for which the license is sought; whether the proposal is consistent with any pertinent neighborhood business or development plans, or the location's proximity to areas where children are typically present. The applicant's record in operating similarly licensed premises; and whether or not the applicant has been charged with or convicted of any felony, misdemeanor, municipal offense or other offense, the circumstances of which substantially relate to the activity to be permitted by the license being applied for or any other factor which reasonably relates to the public health, safety or welfare may also be considered. See attached police report or correspondence.

Notice for applicants with warrants or unpaid fines: Proof of warrant satisfaction or payment of fines must be submitted at the hearing on the above date and time. Failure to comply with this requirement may result in a delay of the granting/denial of your application.

Failure to attend this meeting may result in the denial of your license. Individual applicants and partnership applicants must attend or attend by an attorney. The agent or attorney for corporate or limited liability applicants must attend. If you wish to do so and at your own expense, you may be accompanied by an attorney of your choosing to represent you at this hearing.

You will be given an opportunity to speak on behalf of the application and to respond and challenge any charges or reasons given for the denial. No petitions can be accepted by the committee, unless the people who signed the petition attend the virtual hearing and are willing to testify. You may present witnesses under oath and you may also confront and cross-examine opposing witnesses under oath. If you have difficulty with the English language, you should request an interpreter attend the meeting with you, at your expense, so that you can answer questions and participate in your hearing.

PLEASE NOTE: Upon reasonable notice, efforts will be made to accommodate the needs of disabled individuals through sign language interpreters or other auxiliary aids. For additional information or to request this service, contact the Council Services Division ADA Coordinator at (414) 286-2998, Fax - (414) 286-3456, TDD - (414) 286-2025.

JIM OWCZARSKI, CITY CLERK

BY: _____

Jessica Celella
License Division Manager

If you have questions regarding this meeting, please contact the staff assistant, Molly Kuether-Steele at (414) 286-2775 or molly.kuether-steele@milwaukee.gov.

May 13, 2020

License Division
City Hall, Rm 106
200 E Wells Street
Milwaukee, WI
53202

RE: TK's Smok'n Smoke House, LLC
Food Dealer - Restaurant License and Food Peddler license application for 7330 N 76th Street, Milw, WI
53223

Dear License Committee,

I'm writing to appeal to the objection of the Food Dealer - Restaurant License and Food Peddler License application for 7330 N 76th Street, Milw, WI 53223. I never had a chance to sit down with Alderwomen Chantia Lewis face to face but made several attempts thru her assistant Debra to do so. Debra instructed me to send my business plan and goals to her via email for review immediately as I informed Debra, I was planning to have a Grand Opening for TK's Smok'N Smoke House on Saturday, February 29, 2020. I sent everything to Debra that day as requested. It wasn't until Tuesday, February 25, 2020 that I discovered the Alderman changed (at City Hall Licensing Division office when all the applications and fees were paid) as I initially had the address of 10701 W Mill Rd, Milw, WI 53225 for TK's. I had met with Alderwoman Nakiya Dodd in January asking for the support of the food trailer and Dodd welcomed the opportunity into her district. The final inspection was conducted on Friday, February 28, 2020 with Lindy Wiedmeyer at the shared premises location; so now all we needed was the approval from Alderwomen Lewis. I called and called all day and the Licensing Division said, "everything is done just waiting on the Alderwoman's approval. By this time flyers regarding the Grand Opening and social media posts were broadcasted all over the city of Milwaukee in January shortly after I met with Dodd. I was confident that all would be well. It's very unfortunate the tragedy with Tony occurred and was unexpected.

I called several more times after February 29, 2020 and talked to licensing and the approval was still needed from the Alderwoman. I returned to City Hall on March 12, 2020 and was informed by Debra it was Girls Day at City Hall that day where over 300 women attended and it was extremely busy but she was going to get everything taken care of. I never received a response. I called the Licensing Division again on April 30, 2020 and spoke to Linda Moon Siefert and she stated let me try to find out what's going on with the license. Linda called me back an hour later and informed me I need to amend the license removing Tony Taylor and adding myself as agent and 100% stockholder. I sent the document back on May 1, 2020, then the objection letter on May 5, 2020.

My intention for the food trailer is for venue purposes only. For example: Steinhafels reached out to me as they are interested in vending services to serve their employees once per week starting in June 2020. It was initially set for May of 2020 however, COVID19 has caused a delay. The vision for the trailer will be for corporate events and when hired for a venue. My purpose is never to be at the shared kitchen location trying to serve or attract customers. The shared location is for storage and prep purposes only.

I'm asking for reconsideration in supporting TK's Smok'n Smoke House, LLC as this is a dream and vision I wanted to promote in the community. The trailer has full kitchen capabilities and was designed and built to our liking. I sent pictures to Debra along with the business plan. I couldn't image having put so much time, effort and money into this trailer and not being able to utilize it. A denial means I can't receive a return on my investment or provide employment opportunities in the city of Milwaukee.

If the decision is denied after reconsideration would you please allow me time to find another shared kitchen location outside of your district which will allow me not to have to reapply for a license?

Successfully Yours,

Kamesha Lewis Taylor



FOOD DEALER LICENSE APPLICATION FOR SHARED KITCHEN USERS

ccl-foodsharedapp 4/18/19

OFFICE OF THE CITY CLERK, LICENSE DIVISION
CITY HALL, 200 E. WELLS ST, ROOM 105, MILWAUKEE, WI 53202
(414) 286-2238 • license@milwaukee.gov • www.milwaukee.gov/license

Legal Entity Name (Individual, Partnership, Corp or LLC): TK'S SMOK'N Smokehouse LLC
 Business Name: TK'S SMOK'N Smokehouse LLC
 Premises (Shared Kitchen) Address: 7330 N. 76th Street, Milwaukee, WI 53223

BUSINESS OPERATIONS

Base for Mobile Vendor (Peddler) Base for Temporary Event Caterer Other: _____

FOOD PROCESSING

What type of food items will be sold?

- Restaurant Items (meals):**
 MEALS include, but are not limited to, chicken, ribs, sandwiches, roasted corn, baked potatoes, hot dogs, brats, tacos, nachos w/ cheese and meat, French fries, cooked or deep fried vegetables/fruit, cooked cheese curds, corn dogs, egg rolls, salads.
 What percent of food items will be meals? 90 %
- Retail Items (snacks and beverages):**
 RETAIL items include, but are not limited to, ice cream/soft serve, lemonade, snow cones, coffee, espresso, cappuccino, tea, fruit juice, smoothies, candy, dispensed soda, fruit cups, bakery, cookies, kettle corn, cotton candy, funnel cakes, fritters, tortilla chips w/ cheese.
 What percent of food items will be retail? 10 %

All Applicants: Submit a menu or a list of food items sold.

Will any food processing be done at the shared kitchen? No Yes
 Processing is defined as assembling, grinding, cutting, mixing, baking, coating, stuffing, packing, bottling, grilling, canning, extracting, fermenting, distilling, pickling, freezing, drying, smoking, or packaging.

Will any food that requires temperature control be sold? No Yes
 (includes dairy products such as milk, cheese, and ice cream, fish, shellfish, meat, poultry)

If yes, list the types of food items: Ribs, Chicken, Pork, Beef, Fish

PLAN OF OPERATION

- a. How are grounds kept clean? Sweep Pressure Wash Pick Up Litter Other: _____
- b. How often will grounds be cleaned? Daily Weekly As Needed Monthly Other: Trailer cleaned daily
- c. Grounds cleaned by: Licensee Building Owner Employees Hired Maintenance Other: _____
- d. How are noise issues prevented and/or addressed? Security Call Police Signs Posted Other: _____
- e. Will a sound amplification system be used? No Yes If yes, describe: _____
- f. Number of Garbage Cans: Inside: 2 Locations: Under server window / Back of truck close to exit
 Outside: 2 Locations: Front and back of truck
- g. Name of solid waste contractor: Advanced Disposal Waste Management Other: _____
- h. Is there a loading zone? No Yes
- i. Are there security cameras? No Yes If yes, how many? 8 and list locations: Front/back + side of facility + inside

PREMISES DESCRIPTION

a. Are other businesses operating in the same building? No | Yes If Yes, Describe: _____

b. Identify all area(s) of the premises that will be used in operating this business (include areas used only for storage):
 1st Floor 2nd Floor Basement Storage Other: Describe: Kitchen }

c. Describe Location: Major Thoroughfare Secondary Street Other: _____

d. Nearest Major Cross Street: _____

e. Describe Building: Free Standing Building Strip Mall Other: _____

f. Describe Premises Structure: Single Story Multi-Story - # of Stories _____ Other: _____

g. Describe Surrounding Area: Commercial Residential Industrial Other: _____

h. Building Owner Name: OR JENNIFER Phone Number: 262-343-5257
 Building Owner Address: _____

SHARED KITCHEN AGREEMENT

SERVICES/FACILITIES (check all that will be used at the shared kitchen):

<input type="checkbox"/> Dry food storage	<input type="checkbox"/> Handwashing facilities	<input checked="" type="checkbox"/> Refrigeration / frozen food storage
<input checked="" type="checkbox"/> Restroom facilities	<input type="checkbox"/> Equipment / utensil storage	<input type="checkbox"/> Warewashing facilities (3 compartment sink)
<input type="checkbox"/> Chemical storage	<input type="checkbox"/> Facilities to prepare or package food	<input type="checkbox"/> Utilities: electrical connection
<input checked="" type="checkbox"/> Garbage / recycling disposal	<input type="checkbox"/> Potable water connection	<input checked="" type="checkbox"/> Peddlers: overnight parking
<input type="checkbox"/> Waste water tank disposal facilities	<input type="checkbox"/> Waste water tank disposal facilities w/ grease trap	

HOURS OF OPERATION AT THE SHARED KITCHEN

DAY OF WEEK	Start Time (include am / pm)	End Time (include am / pm)
Sunday		12:00
Monday		12:00
Tuesday		12:00
Wednesday		12:00
Thursday		12:00
Friday		12:00
Saturday		12:00 AM

I, the shared kitchen user, will utilize the services/facilities at this kitchen during the days/times indicated above. I will notify the City Clerk's Office (License Division) prior to discontinuing use of the kitchen. I will maintain an updated schedule of use of the kitchen with the City Clerk's Office (License Division) and keep a written log of the dates/times I am actually at the kitchen. (Peddlers: I will report to the facility at least once each operating day for cleaning and servicing.)

Print Name(s): RAY TRU
 Sole Proprietor, Partners or 20% or More Shareholder

Signature(s): [Signature] Date: _____

FOR COMPLETION BY THE SHARED KITCHEN OWNER

Business Name: MISS WITRA Lounge

I, the shared kitchen owner, acknowledge I have entered into an agreement with the user to utilize the services/facilities at this kitchen and agree to provide the user access to the kitchen on the days/times indicated above. I will maintain a written log of the dates/times the user is actually at the facility. I will promptly notify the City Clerk's Office (License Division) if this agreement is terminated or if the user fails to use the kitchen on the days/times they have indicated. I acknowledge that as the primary operator of the kitchen I am responsible for the maintenance and sanitation of the kitchen, and as such, I acknowledge I am responsible for maintaining the services/facilities being provided to the user in compliance with the Wisconsin Food Code.

Print Name: JENNIFER GARCIA

Signature: [Signature] Date: 2/26/20



APPLICATION AMENDMENT

Office of the City Clerk License Division
200 E. Wells Street, Room 105, Milwaukee, WI 53202 (414) 286-2238

Date: 05/01/2020

To the License Division of the City of Milwaukee:

I, Kamesha Lewis Taylor, wish to amend my answer(s) on the application for a
Food Dealer and Packer License license at 7330 N. 76th Street, Milwaukee, WI 53218
(of her name) (type of license) (premises address, if applicable)

by adding or amending the following information (complete only those sections being amended):

- 1. Answer to Question(s) # _____ should be: _____
- 2. Agent should be (full legal name): Kamesha Lewis Taylor Also complete 3, 4, 5 & 6
- 3. Date of birth should be: 12/09/1978
- 4. Home address should be (include city/state/zip): 10701 W Mill Rd
Milwaukee, WI 53225
- 5. Phone number should be (include area code): 414-687-1479
- 6. Driver's license Number/State ID Number should be: L200-5037-8949-05
- 7. Corporation/LLC name should be (full legal name): TK's SmoKN Smoke House LLC
- 8. Business name should be: (Same) TK's SmoKN Smoke House
- 9. Premises address should be (include city/state/zip): 7330 N. 76th Street
Milwaukee, WI 53218
- 10. Business phone number should be (include area code): 414-687-1479
- 11. Mailing address should be (include city/state/zip): 10701 W Mill Rd
Milwaukee, WI 53225
- 12. Email address should be: children.knowledge.2@att.net
- 13. Recycling/salvaging/towing: Location where vehicle will be parked should be (include city/state/zip): 7330 N. 76th Street, Milwaukee, WI 53218

14. Class B Towing: Age Distinction should be: _____
15. Other: Remove Tony Taylor as Agent and 50% Ownership Stockholder. Add Kamesha Lewis-Taylor 100% Stockholder
(Check with the License Division before submitting "Other" amendments using this form.)

Kamesha Lewis Taylor
Signature of licensee (Individual, Partner, or Agent of Corp/LLC)

Application # _____ Date: _____ Initials: _____ To LC: _____
LC Email: MPD NS AD Initials: _____



FOOD PEDDLER PLAN OF OPERATION

OFFICE OF THE CITY CLERK, LICENSE DIVISION

CITY HALL, 200 E. WELLS ST, ROOM 105, MILWAUKEE, WI 53202 •

(414) 286-2238 • license@milwaukee.gov • www.milwaukee.gov/license

Legal Entity: TTC'S Smokin' Smoke House LLC

Premises Address: 10701 W. Mill Road Milwaukee WI 53225

1. Mobile Unit Description

Mobile Unit Type: Motorized Vehicle - includes a peddler truck, vehicle, or trailer that must be pulled by a motorized vehicle
 Pushed, Pedaled, or Pulled Vehicle - does not require a motorized vehicle to move from site to site
 Carried Container

Provide the following information:

Color: MUSTARD/BLK Length 29 ft Width 8 1/2 ft Height 9 ft

Make: 8.5X30TA3 Model: TRAILER Year: 2020

License Plate Number (if applicable): _____ VIN (if applicable): 4S9S1EL24LW364235

2. Food Operations

What type of food items will be sold?

Restaurant Items (meals):
 MEALS include, but are not limited to, chicken, ribs, sandwiches, roasted corn, baked potatoes, hot dogs, brats, tacos, nachos w/ cheese and meat, French fries, cooked or deep fried vegetables/fruit, cooked cheese curds, corn dogs, egg rolls, salads.

Retail Items (snacks and beverages):
 RETAIL items include, but are not limited to, ice cream/soft serve, lemonade, snow cones, coffee, espresso, cappuccino, tea, fruit juice, smoothies, candy, dispensed soda, fruit cups, bakery, cookies, kettle corn, cotton candy, funnel cakes, fritters, tortilla chips w/ cheese.

All Applicants: Submit a menu or a list of food items sold.

Will food processing be done on the mobile unit? No Yes

Processing includes assembling, grinding, cutting, mixing, baking, coating, stuffing, packing, bottling, grilling, canning, extracting, fermenting, distilling, pickling, freezing, drying, smoking, or packaging

Will food that requires temperature control be sold? No Yes Foods requiring temperature control include dairy products such as milk, cheese, and ice cream, fish, shellfish, meat, poultry

If yes, list the food items: Ribs, Chicken, shoulder, BAKE BEANS.

Do you intend to sell ice cream, popsicles, or other frozen confections? No Yes

If yes, you must also obtain an Ice Cream Peddler License. Submit your Ice Cream Peddler License Application with this application. If anyone else will be operating the mobile unit, they must also obtain an Ice Cream Peddler License. ...

3. Service Base

Food peddlers must obtain a Food Dealer License for their service base. If you do not have a base, you must obtain a variance from the Health Dept.

Check one:
 I will obtain a food dealer license for my service base located in the City of Milwaukee.
 I will obtain a food dealer license for my service base located outside the city of Milwaukee in another WI municipality. I will submit copies of the base license and health inspection report completed within the previous 12 month period to the License Division.
 I will contact the City of Milwaukee Health Department to apply for a variance.

4. Affirmation of Understanding – License Needed to Operate & Requirements

Read and initial each item confirming your understanding:
KLTT Health Department inspection and approval is required before my license may be issued.
KLTT A license must be issued for my service base or a variance obtained before my Food Peddler License may be issued.
KLTT The license must be issued and posted on the mobile unit prior to operating
KLTT A current Food Peddler Itinerary must be on file with the License Division and at the service base.
KLTT I must keep a written log of all days I am at the service base, including the time I arrive and leave.

Signature of Sole Proprietor, Partner, or 20% or more Shareholder: _____
 Signature of Additional Partner: _____

FOOD PEDDLER ITINERARY

Business Name: *TK's Smok'in Smokehouse*

List all Vending Location Addresses	Check the Location Type	Circle the Days of the Week at this Location	Start Time (include am/pm)	End Time (include am/pm)
<i>340 W Reservoir Avenue, Milw</i>	<input type="checkbox"/> Public Way <input type="checkbox"/> Event <input checked="" type="checkbox"/> Private Property <input type="checkbox"/> Seasonal Market	Sun Mon Tue Wed Thu Fri Sat	<i>1pm</i>	<i>2am</i>
<i>3424 W North Avenue, Milw</i>	<input type="checkbox"/> Public Way <input type="checkbox"/> Event <input checked="" type="checkbox"/> Private Property <input type="checkbox"/> Seasonal Market	Sun Mon Tue Wed Thu Fri Sat	<i>1pm</i>	<i>2am</i>
<i>6040 N. Le O in Street</i>	<input type="checkbox"/> Public Way <input type="checkbox"/> Event <input checked="" type="checkbox"/> Private Property <input type="checkbox"/> Seasonal Market	Sun Mon Tue Wed Thu Fri Sat	<i>1pm</i>	<i>2am</i>
	<input type="checkbox"/> Public Way <input type="checkbox"/> Event <input type="checkbox"/> Private Property <input type="checkbox"/> Seasonal Market	Sun Mon Tue Wed Thu Fri Sat		
	<input type="checkbox"/> Public Way <input type="checkbox"/> Event <input type="checkbox"/> Private Property <input type="checkbox"/> Seasonal Market	Sun Mon Tue Wed Thu Fri Sat		
	<input type="checkbox"/> Public Way <input type="checkbox"/> Event <input type="checkbox"/> Private Property <input type="checkbox"/> Seasonal Market	Sun Mon Tue Wed Thu Fri Sat		
	<input type="checkbox"/> Public Way <input type="checkbox"/> Event <input type="checkbox"/> Private Property <input type="checkbox"/> Seasonal Market	Sun Mon Tue Wed Thu Fri Sat		
	<input type="checkbox"/> Public Way <input type="checkbox"/> Event <input type="checkbox"/> Private Property <input type="checkbox"/> Seasonal Market	Sun Mon Tue Wed Thu Fri Sat		
	<input type="checkbox"/> Public Way <input type="checkbox"/> Event <input type="checkbox"/> Private Property <input type="checkbox"/> Seasonal Market	Sun Mon Tue Wed Thu Fri Sat		
	<input type="checkbox"/> Public Way <input type="checkbox"/> Event <input type="checkbox"/> Private Property <input type="checkbox"/> Seasonal Market	Sun Mon Tue Wed Thu Fri Sat		
	<input type="checkbox"/> Public Way <input type="checkbox"/> Event <input type="checkbox"/> Private Property <input type="checkbox"/> Seasonal Market	Sun Mon Tue Wed Thu Fri Sat		
	<input type="checkbox"/> Public Way <input type="checkbox"/> Event <input type="checkbox"/> Private Property <input type="checkbox"/> Seasonal Market	Sun Mon Tue Wed Thu Fri Sat		
	<input type="checkbox"/> Public Way <input type="checkbox"/> Event <input type="checkbox"/> Private Property <input type="checkbox"/> Seasonal Market	Sun Mon Tue Wed Thu Fri Sat		

SIGNATURE(S)

I understand that any changes I wish to make must be reported to the City Clerk (License Division) on an updated Itinerary form before any changes can be implemented. I will keep a copy of my current Itinerary on my mobile until and at my service base all times.

I understand that failure to maintain a current itinerary with the City Clerk (License Division) may result in progressive enforcement action including citation and permit suspension and/or revocation.

[Signature]
 Sole Proprietor, Partner, or 20% or more Shareholder

[Signature]
 Additional Partner

TK's Smokin' Smokehouse LLC

Ribs \$30⁰⁰
Full Slab

Half Slab \$15⁰⁰
Ribs

Pork
Shoulder \$12⁰⁰
Sandwich

Chicken \$15⁰⁰
Dinner

Rib Tips \$13⁰⁰

Fried chicken \$10⁰⁰
Dinner

Cole Slaw \$5⁰⁰

Bake Beans \$5⁰⁰

Spaghetti \$5⁰⁰

Greens \$5⁰⁰

Corn Bread \$2⁵⁰

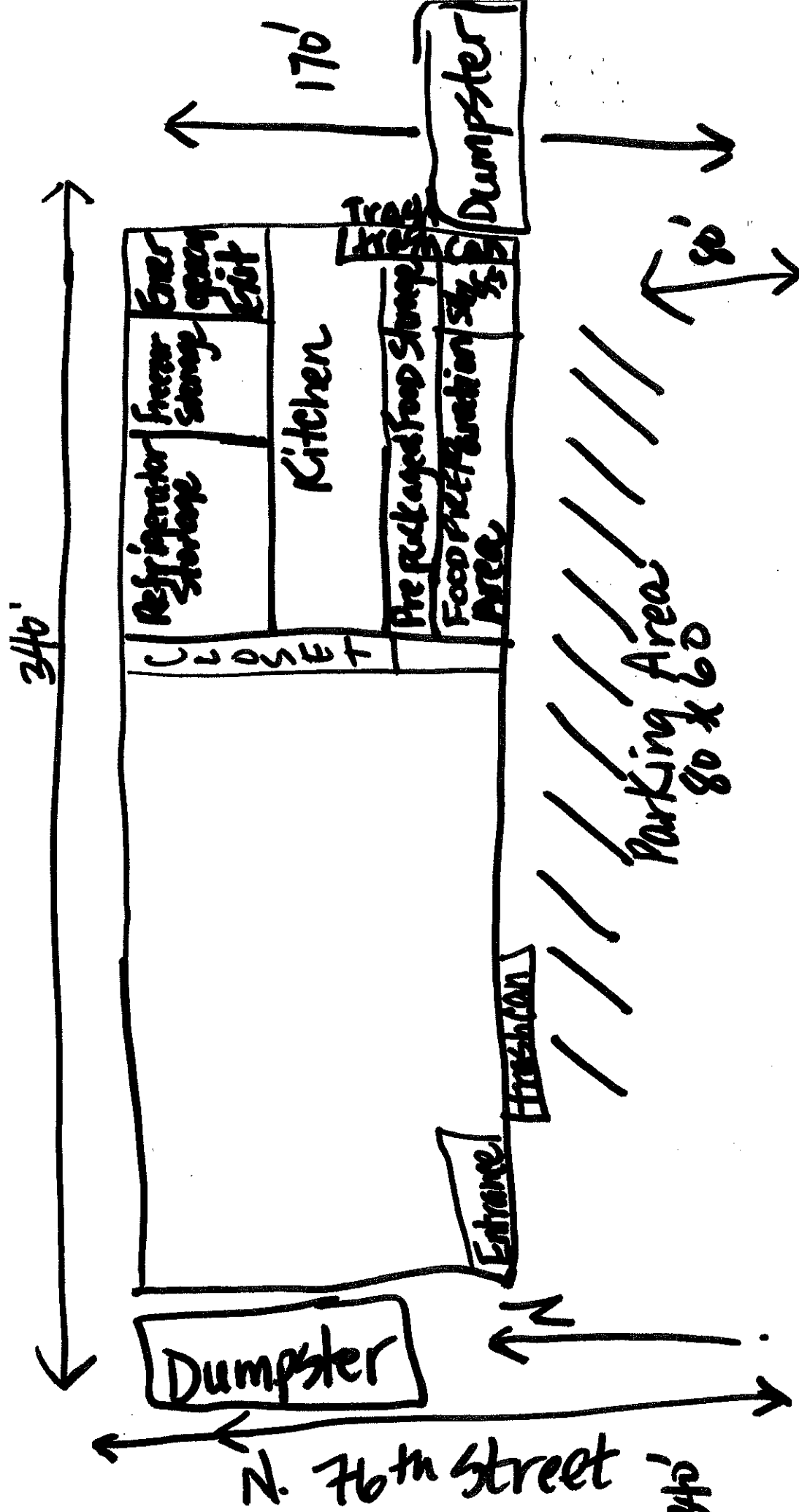

320' North Main St

Agent for Kiss Ultra Lounge

Total Square Footage = 9800'

Tony Taylor
DBA
Trade & Legal

TK'S Smok'n Smoke House LLC
7939 N 76th St, Milwaukee WI 53223