



CITY OF MILWAUKEE
OFFICE OF THE CITY CLERK

Wednesday, June 03, 2020

COMMITTEE MEETING NOTICE

AD 14

MOHAMED YUSUF, Satero B, Agent
Islam Star Enterprise LLC
3355 S 13th St

Milwaukee, WI 53215

You are requested to attend a virtual hearing to be held on:

Monday, June 15, 2020 at  8:50 AM

Regarding: Your Food Dealer License Application as agent for "Islam Star Enterprise LLC" for "Top Star Family" at 3353 S 13th St.

This meeting will be held via GoToMeeting. Please see the enclosed best practices document for further instructions. The access code is <https://global.gotomeeting.com/join/435425765>. If you wish to call in, please call +1 (872) 240-3212 and use Access Code: 435-425-765.

There is a possibility that your application may be denied for one or more of the following reasons: The recommendation of the committee regarding the application shall be based on evidence presented at the hearing. Per MCO 85-2.7-4, probative evidence concerning whether or not a new license should be granted may be presented on the following subjects: whether or not the applicant meets the municipal requirements, the appropriateness of the location and premises where the licensed premises is to be located and whether use of the premises for the purposes or activities permitted by the license would tend to facilitate a public or private nuisance or create undesirable neighborhood problems such as disorderly patrons, unreasonably loud noise, litter, and excessive traffic and parking congestion. Probative evidence relating to these matters may be taken from the plan of operation submitted with the license application, if any, but shall not include the content of any music. Evidence regarding the fitness of the location of the premises to be maintained as the principal place of business, including but not limited to whether there is an overconcentration of businesses of the type for which the license is sought; whether the proposal is consistent with any pertinent neighborhood business or development plans, or the location's proximity to areas where children are typically present. The applicant's record in operating similarly licensed premises; and whether or not the applicant has been charged with or convicted of any felony, misdemeanor, municipal offense or other offense, the circumstances of which substantially relate to the activity to be permitted by the license being applied for or any other factor which reasonably relates to the public health, safety or welfare may also be considered. See attached police report or correspondence.

Notice for applicants with warrants or unpaid fines:

Proof of warrant satisfaction or payment of fines must be submitted at the hearing on the above date and time. Failure to comply with this requirement may result in a delay of the granting/denial of your application.

Failure to attend this meeting may result in the denial of your license. Individual applicants and partnership applicants must attend or attend by an attorney. The agent or attorney for corporate or limited liability applicants must attend. If you wish to do so and at your own expense, you may be accompanied by an attorney of your choosing to represent you at this hearing.

You will be given an opportunity to speak on behalf of the application and to respond and challenge any charges or reasons given for the denial. No petitions can be accepted by the committee, unless the people who signed the petition attend the virtual hearing and are willing to testify. You may present witnesses under oath and you may also confront and cross-examine opposing witnesses under oath. If you have difficulty with the English language, you should request an interpreter attend the meeting with you, at your expense, so that you can answer questions and participate in your hearing.

PLEASE NOTE: Upon reasonable notice, efforts will be made to accommodate the needs of disabled individuals through sign language interpreters or other auxiliary aids. For additional information or to request this service, contact the Council Services Division ADA Coordinator at (414) 286-2998, Fax - (414) 286-3456, TDD - (414) 286-2025.

JIM OWCZARSKI, CITY CLERK

BY: _____

Jessica Celella

License Division Manager

If you have questions regarding this meeting, please contact the staff assistant, Molly Kuether-Steele at (414) 286-2775 or molly.kuether-steele@milwaukee.gov.

303441

Case : 101003000999

Client Info:

Name: 7

Address:

Phone Number:

Email:

Confidential?: Y

Issue: City Clerk License Object/Support Web

Status: open

Address: 3353 S 13TH ST

REDACTED RECORD

Date Submitted: 12/22/2019

Date Completed:

Due Date: 01/21/2020

Reason for request:

Object to License| Top Star Family app'd for a Retail Conv Store Lic. Due to a hair salon doors away the parking on 13th St. is badly crowded already/We've been home owners across the street for 50 yrs. Pls. deny!!

Case notes:

1. entered address: 3353 S 13TH ST

Staff comments:

Agent Created Case.

[Click here to view map and/or images](#)

14

303441

REDACTED RECORD

December 9th, 2019

To Whom It May Concern:

We are writing in regards to the Retail Convenience Store at 3353 South 13th Street to be know as Top Star Family. We are objecting to the license requested for this property:

- 1) This is a residential area !
- 2) No parking lot for their customers !
- 3) We already have more cars parking on both sides of our street, due to the Salon that is just next door to the above property !
- 4) There are more cars and trucks that are making U-turns which will cause more accidents !
- 5) We find it an inconvenience at times that we cannot park in front of our own house !

We would like to keep this area a residential area only, like it has been for a long time !!

Thank You !

2019 DEC 13 A 8:13

CITY OF MILWAUKEE
LICENSE DIVISION

303 441

Objection - 3353 S. 13th St.

Schafer, Nathan

From: Becker, Keren
Sent: Tuesday, December 10, 2019 3:26 PM
To: Schafer, Nathan
Subject: FW: Islam Star (3353 South 13th Street)

REDACTED RECORD

Keren Becker
License Specialist III
City Clerk - License Division
O: (414) 286-2238
F: (414) 286-3057
License@Milwaukee.gov
www.Milwaukee.gov/license



From: Celella, Jessica
Sent: Tuesday, December 10, 2019 2:55 PM
To: Becker, Keren
Cc: Byrd, Yashica
Subject: FW: Islam Star (3353 South 13th Street)

Please add

Jessica Celella
License Division Manager
200 E Wells St Room 105, Milwaukee, WI 53202
(414) 286-2365



From: Santa Anna, April <April.SantaAnna@milwaukee.gov>
Sent: Tuesday, December 10, 2019 2:22 PM
To: Byrd, Yashica <Yashica.Byrd@milwaukee.gov>; Celella, Jessica <Jessica.Celella@milwaukee.gov>; Zielinski, Tony <tzieli@milwaukee.gov>
Subject: Islam Star (3353 South 13th Street)

Good afternoon,

Regarding Islam Star (3353 South 13th Street):

I received a call from _____, who says that she is opposed to the retail store opening. Constituent will be sending licensing a response in the mail, as the letter that she received in the mail asked for her to do.

D #14

Respectfully,

April Santa Anna

Legislative Assistant

Milwaukee Common Council

Alderman T. Anthony Zielinski | 14th District

200 East Wells Street | Room 205

Milwaukee, WI 53202

414.286.2873 | fax 414.286.3456

April.SantaAnna@milwaukee.gov



Concentration Map

3353 S 13th St

Area : 21,862,585.64 ft²

May 26 2020 14:14:06 Central Daylight Time

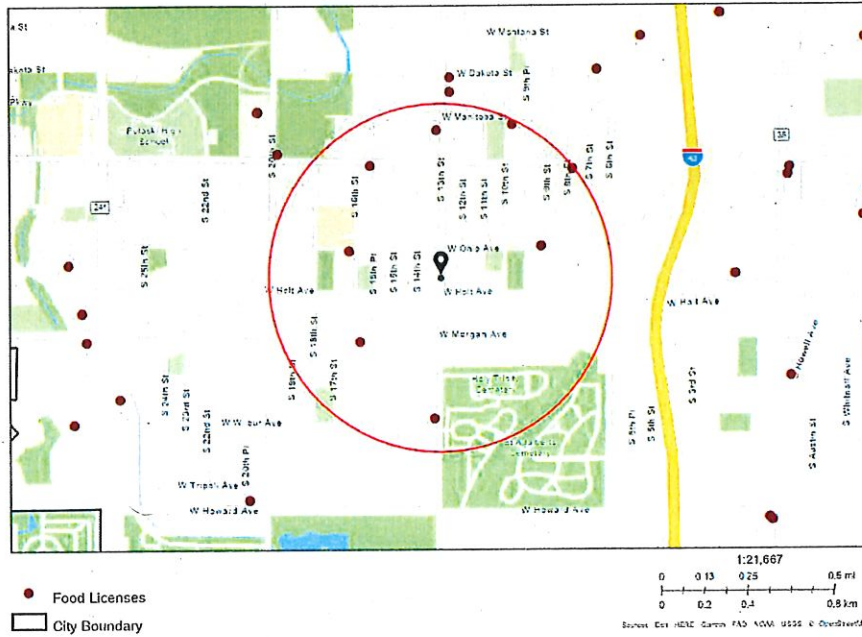

Summary

Name	Count	Area(ft ²)	Length(mi)
Food Licenses	8		

Food Licenses

#	Legal entity	Trade name	Licensee	Address	License type name	Total capacity	Expiration date	Count
1	EI Relajo LLC	EI Relajo	JOSE S VIDRIO, Agt	733 W Oklahoma AV	Public Entertainment Premises License	76	4/1/2021, 7:00 PM	1
2	Sassy Sue's Starlite Saloon	Sassy Sue's Starlite Saloon	SUSAN T KASPRZYK, SP	3279 S 9TH ST	Public Entertainment Premises License		5/1/2021, 7:00 PM	1
3	13th Pour LLC	13th Pour	ERIC B SCHNEEBER G, Agt	3675 S 13th ST	Public Entertainment Premises License		6/2/2020, 7:00 PM	1
4	JOBIN, INC	B & B TAP	PATRICIA L WESTPHAL, Agt	3021 S 13TH ST	Public Entertainment Premises License		6/22/2020, 7:00 PM	1
5	JJ STRIPES	JJ STRIPES	JAMES J DORANGRIC HIA, SR, SP	3101 S 15TH PL	Public Entertainment Premises License		12/16/2020, 6:00 PM	1
6	GARY J'S PUB	GARY J'S PUB	GARY M JASICKI, SP	3303 S 16TH ST	Public Entertainment Premises License		12/19/2020, 6:00 PM	1
7	THE DOCTOR'S INN	THE DOCTOR'S INN	GENE M PEDERSEN, SP	3010 S 10TH ST	Public Entertainment Premises License		6/29/2020, 7:00 PM	1
8	P T G, LLC	COOP'S TAVERN	JASON L MOELLER, Agt	1577 W MORGAN AV	Public Entertainment Premises License		12/10/2020, 6:00 PM	1

Establishments within a 0.5 miles radius centered on area of interest.



Wednesday, June 03, 2020



Notice of Public Hearing

blank
notice

MOHAMED YUSUF, Satera B, Agent
Top Star Family at 3353 S 13th St
Food Dealer License Application

Monday, June 15, 2020 at 10:50 AM

To whom it may concern:

The above application has been made by the above named applicant(s). This requires approval from the Licenses Committee and the Common Council of the City of Milwaukee. The hearing before the Licenses Committee will take place virtually on 6/15/2020 at 10:50 AM. This is a public hearing. Those wishing to view the proceeding are able to do so via the City Channel – Channel 25 on Spectrum Cable – or on the Internet at <http://city.milwaukee.gov/citychannel>. Those wishing to provide oral testimony will be asked to do so by phone or internet and are asked to contact the staff assistant, Molly Kuether-Steele at (414) 286-2775 or molly.kuether-steele@milwaukee.gov for necessary information. Please make such requests no later than one business day prior to the start of the meeting. You are not required to attend the hearing, but please see the information below if you would like to provide testimony. Once the Licenses Committee makes its recommendation, this recommendation is forwarded to the full Common Council for approval at its next regularly scheduled hearing.

Important details for those wishing to provide information for the Licenses Committee to consider when making its recommendation:

1. The license application is scheduled to be heard at the above time. Due to other hearings running longer than scheduled, you may have to wait some time to provide your testimony.
2. You must testify as to matters that you have personally experienced or seen. (You cannot provide testimony for your neighbor, parent or anyone else; this is considered hearsay and cannot be considered by the committee.)
3. No letters or petitions can be accepted by the committee (unless the person who wrote the letter or the persons who signed the petition are willing to testify).
4. Persons opposed to the license application are given the opportunity to testify first; supporters may testify after the opponents have finished.
5. When you are called to testify, you will be sworn in and asked to give your name, and address. (If your first and/or last names are uncommon please spell them.)
6. You may then provide testimony.
 - a. Include only information relating to the above license application.
 - b. Include only information you have personally witnessed or seen.
 - c. Provide concise and relevant information detailing how this business has affected or may affect the peaceful enjoyment of your neighborhood.
 - d. If by the time you have the opportunity to testify, the information you wish to share has already been provided to the committee, you may state that you agree with the previous testimony. Redundant or repetitive testimony will not assist the committee in making its recommendation.
7. After giving your testimony, the members of the Licenses Committee and the licensee may ask questions regarding the testimony you have given or other factors relating to the license application.
8. Business Competition is not a valid basis for denial or non-renewal of a license.

Please Note: If you have submitted an objection to the above application your objection cannot be considered by the committee unless you personally testify at the hearing.

OCCUPANT	MAIL ADDRESS	CITY, STATE ZIP
CURRENT OCCUPANT	3328 S 13TH ST	MILWAUKEE, WI 53215
CURRENT OCCUPANT	3400 S 14TH ST	MILWAUKEE, WI 53215
CURRENT OCCUPANT	3352 S 14TH ST	MILWAUKEE, WI 53215
CURRENT OCCUPANT	3353 S 13TH ST	MILWAUKEE, WI 53215
CURRENT OCCUPANT	3333A S 13TH ST	MILWAUKEE, WI 53215
CURRENT OCCUPANT	3321A S 13TH ST	MILWAUKEE, WI 53215
CURRENT OCCUPANT	3370 S 13TH ST	MILWAUKEE, WI 53215
CURRENT OCCUPANT	1224 W HOLT AVE	MILWAUKEE, WI 53215
CURRENT OCCUPANT	1221 W HOLT AVE	MILWAUKEE, WI 53215
CURRENT OCCUPANT	3354 S 13TH ST	MILWAUKEE, WI 53215
CURRENT OCCUPANT	3348 S 13TH ST	MILWAUKEE, WI 53215
CURRENT OCCUPANT	3345 S 12TH ST	MILWAUKEE, WI 53215
CURRENT OCCUPANT	3338 S 13TH ST	MILWAUKEE, WI 53215
CURRENT OCCUPANT	1332 W HOLT AVE	MILWAUKEE, WI 53215
CURRENT OCCUPANT	3377 S 13TH ST	MILWAUKEE, WI 53215
CURRENT OCCUPANT	3373 S 13TH ST	MILWAUKEE, WI 53215
CURRENT OCCUPANT	3328 S 14TH ST	MILWAUKEE, WI 53215
CURRENT OCCUPANT	3365 S 14TH ST	MILWAUKEE, WI 53215
CURRENT OCCUPANT	3351A S 14TH ST	MILWAUKEE, WI 53215
CURRENT OCCUPANT	3347 S 14TH ST	MILWAUKEE, WI 53215
CURRENT OCCUPANT	3366 S 13TH ST	MILWAUKEE, WI 53215
CURRENT OCCUPANT	3376 S 13TH ST	MILWAUKEE, WI 53215
CURRENT OCCUPANT	3400 S 13TH ST	MILWAUKEE, WI 53215
CURRENT OCCUPANT	3359 S 12TH ST	MILWAUKEE, WI 53215
CURRENT OCCUPANT	3355 S 12TH ST	MILWAUKEE, WI 53215
CURRENT OCCUPANT	3357 S 12TH ST	MILWAUKEE, WI 53215
CURRENT OCCUPANT	3349 S 12TH ST	MILWAUKEE, WI 53215
CURRENT OCCUPANT	3345A S 12TH ST	MILWAUKEE, WI 53215
CURRENT OCCUPANT	3333A S 12TH ST	MILWAUKEE, WI 53215
CURRENT OCCUPANT	3324 S 13TH ST	MILWAUKEE, WI 53215
CURRENT OCCUPANT	1336 W HOLT AVE	MILWAUKEE, WI 53215
CURRENT OCCUPANT	1326A W HOLT AVE	MILWAUKEE, WI 53215
CURRENT OCCUPANT	1326 W HOLT AVE	MILWAUKEE, WI 53215
CURRENT OCCUPANT	1324A W HOLT AVE	MILWAUKEE, WI 53215
CURRENT OCCUPANT	3365 S 13TH ST	MILWAUKEE, WI 53215
CURRENT OCCUPANT	3355 S 13TH ST	MILWAUKEE, WI 53215
CURRENT OCCUPANT	3346 S 14TH ST	MILWAUKEE, WI 53215
CURRENT OCCUPANT	1204A W HOLT AVE	MILWAUKEE, WI 53215
CURRENT OCCUPANT	3361 S 12TH ST	MILWAUKEE, WI 53215
CURRENT OCCUPANT	3351 S 12TH ST	MILWAUKEE, WI 53215
CURRENT OCCUPANT	3334 S 13TH ST	MILWAUKEE, WI 53215
CURRENT OCCUPANT	3370 S 14TH ST	MILWAUKEE, WI 53215
CURRENT OCCUPANT	3340 S 14TH ST	MILWAUKEE, WI 53215
CURRENT OCCUPANT	3340A S 14TH ST	MILWAUKEE, WI 53215
CURRENT OCCUPANT	3324 S 14TH ST	MILWAUKEE, WI 53215
CURRENT OCCUPANT	3321 S 13TH ST	MILWAUKEE, WI 53215

CURRENT OCCUPANT	3318 S 14TH ST	MILWAUKEE, WI 53215
CURRENT OCCUPANT	3343 S 14TH ST	MILWAUKEE, WI 53215
CURRENT OCCUPANT	3367 S 12TH ST	MILWAUKEE, WI 53215
CURRENT OCCUPANT	3365 S 12TH ST	MILWAUKEE, WI 53215
CURRENT OCCUPANT	3360 S 13TH ST	MILWAUKEE, WI 53215
CURRENT OCCUPANT	3344 S 13TH ST	MILWAUKEE, WI 53215
CURRENT OCCUPANT	3339 S 12TH ST	MILWAUKEE, WI 53215
CURRENT OCCUPANT	1304 W HOLT AVE	MILWAUKEE, WI 53215
CURRENT OCCUPANT	3341 S 13TH ST	MILWAUKEE, WI 53215
CURRENT OCCUPANT	3336 S 14TH ST	MILWAUKEE, WI 53215
CURRENT OCCUPANT	3328A S 14TH ST	MILWAUKEE, WI 53215
CURRENT OCCUPANT	3371 S 12TH ST	MILWAUKEE, WI 53215
CURRENT OCCUPANT	3333 S 12TH ST	MILWAUKEE, WI 53215
CURRENT OCCUPANT	3365A S 13TH ST	MILWAUKEE, WI 53215
CURRENT OCCUPANT	3358 S 14TH ST	MILWAUKEE, WI 53215
CURRENT OCCUPANT	3349 S 13TH ST	MILWAUKEE, WI 53215
CURRENT OCCUPANT	3333 S 13TH ST	MILWAUKEE, WI 53215
CURRENT OCCUPANT	3327 S 13TH ST	MILWAUKEE, WI 53215
CURRENT OCCUPANT	3367 S 14TH ST	MILWAUKEE, WI 53215
CURRENT OCCUPANT	3318 S 13TH ST	MILWAUKEE, WI 53215
CURRENT OCCUPANT	1324 W HOLT AVE	MILWAUKEE, WI 53215
CURRENT OCCUPANT	3360 S 14TH ST	MILWAUKEE, WI 53215
CURRENT OCCUPANT	3346A S 14TH ST	MILWAUKEE, WI 53215
CURRENT OCCUPANT	3373 S 14TH ST	MILWAUKEE, WI 53215
CURRENT OCCUPANT	3367A S 14TH ST	MILWAUKEE, WI 53215
CURRENT OCCUPANT	3357 S 14TH ST	MILWAUKEE, WI 53215
CURRENT OCCUPANT	3351 S 14TH ST	MILWAUKEE, WI 53215
CURRENT OCCUPANT	3333 S 14TH ST	MILWAUKEE, WI 53215
CURRENT OCCUPANT	1204 W HOLT AVE	MILWAUKEE, WI 53215
CURRENT OCCUPANT	1324B W HOLT AVE	MILWAUKEE, WI 53215
CURRENT OCCUPANT	3337 S 13TH ST	MILWAUKEE, WI 53215
CURRENT OCCUPANT	3332 S 14TH ST	MILWAUKEE, WI 53215
blank	notice	

Total Records: 78

Radius: 250.0 feet and Center of Circle: 3353 S 13th St



BUSINESS LICENSE PLAN OF OPERATION

ccl-busplan 3/15/18

Office of the City Clerk License Division
200 E. Wells St. Room 105, Milwaukee, WI 53202
(414) 286-2238 www.milwaukee.gov/license e-mail address: license@milwaukee.gov

1. Type of Business

Applying for: Extended Hours (12AM to 5AM) - If a food establishment, check all that apply: Delivery Drive Thru Dining Room
 Self Service Laundry Massage Establishment Filling Station
 Other (supplemental application for specific license also required)

Provide a detailed description of the type of business you plan on operating:

Grocery store Tabacco

Do you have any experience operating this type of business? No Yes If yes, explain: *I used to have store.*

2. Business Operations

- a. Proposed Opening Date: 1/1/2020
- b. Is this premise under construction? No Yes If yes, list estimated completion date: _____
- c. Is this a franchise? No Yes
- d. Is this premises currently licensed? No Yes If yes, list type of license: _____
- e. Is the current licensee operating? No Yes If no, list date closed: _____
- f. Do you have future plans for other businesses, licenses or permits at this location? No Yes
If yes, explain: _____
- g. Have you previously held an Extended Hours License in Milwaukee? No Yes
If yes, list address(es): _____
- h. Are other businesses operating in the same building? No Yes If yes, describe: _____

3. Litter & Noise

- a. How are grounds kept clean? Sweep Pressure Wash Pick Up Litter Other: _____
- b. How often will grounds be cleaned? Daily Weekly As Needed Monthly Other: _____
- c. Grounds cleaned by: Licensee Building Owner Employees Hired Maintenance Other: _____
- d. How are noise issues prevented and/or addressed? Security Manager approaches customer(s) Call Police
 Signs Posted Other: _____
- e. Will a sound amplification system be used? No Yes If yes, describe: _____

4. Smoking & Sanitation

- a. Are there designated outdoor smoking areas? No Yes If yes, describe: _____
- b. Number of Garbage Cans: Inside: 2 Locations: in front of main door & behind the counter
Outside: 0 Locations: N/A
- c. Is a crowd control barrier used? No Yes If yes, describe: _____
- d. How many restrooms are on the premises? 1
- e. Name of solid waste contractor: Advanced Disposal Waste Management Other: _____

5. Security

- a. Are there onsite parking spaces? No Yes If yes, how many? _____ and describe the parking security plan: _____
- b. Is there a loading zone? No Yes If yes, describe the loading area security plan: _____
- c. Will you have security personnel on premise? No Yes If yes, how many? _____ and answer the following:
 What are their responsibilities? _____
 Is security equipment used? No Yes If yes, describe _____
 List their licensing, certification, or training credentials _____
- d. Will there be security cameras? No Yes If yes, how many? 10 and list locations: Inside & outside
- e. Will searches/identification checks be done upon entry? No Yes If yes, describe _____

6. Percentage of Sales (must total 100%)

Alcohol <u>0</u> %	Food <u>80</u> %	Secondhand Merchandise <u>0</u> %	Precious Metals & Gems <u>0</u> %
Entertainment <u>0</u> %	Cigarettes <u>20</u> %	Personal Services (such as tattoo, body piercing, salon, tailor, tanning, etc.) <u>0</u> %	Other <u>0</u> %
Pawnbroker Activity <u>0</u> %	Salvaged Materials (such as scrap metal) <u>0</u> %	Describe: <u>0</u>	

7. Businesses/Licenses on the Premises (check all that apply):

Type 1

Full Service Restaurant Cafe/Coffee Shop Deli or Fast Food Restaurant Private/Fraternal/Veterans Club

Night Club Tavern Cocktail Lounge Teen Club

Banquet Hall Sports Facility Bowling Alley

Hotel/Motel: Number of Floors: _____ Rooming House: Number of Floors: _____
 Number of Rooms: _____ Number of Rooms: _____

Type 2

Liquor Store Corner Store Supermarket Convenience Store

Gas Station Amusement/Phonograph Distributor Recycling, Salvage or Towing

Used Car Dealer Personal Service Establishment (such as tattoo business, hair salon, tailor, etc.) Recording Studio

What other licenses/permits will you hold at this location? (check all that apply)

Occupancy Permit Cigarette & Tobacco Gas Station Extended Hours Class "B" Tavern Weights & Measures

Secondhand Dealer Precious Metal & Gem Other: _____

8. Legal Capacity (only if a Type 1 premises in #7 above)

Capacity _____ (Call the Milwaukee Development Center at 414-286-8211 if you have questions.)

9. Premises Description

- a. Identify all area(s) of the premises that will be used in operating this business (include areas used only for storage):
 1st Floor 2nd Floor Basement Storage Patio Beer Garden Sidewalk Café Deck Rooftop
 Other: Describe: _____
- b. Describe Location: Major Thoroughfare Secondary Street Other: _____
- c. Nearest Major Cross Street: Marquette Street
- d. Describe Building: Free Standing Building Strip Mall Other: _____
- e. Describe Premises Structure: Single Story Multi-Story - # of Stories _____ Other: _____
- f. Describe Surrounding Area: Commercial Residential Industrial Other: _____
- g. Building Owner Name: Satera binti Mohamed Phone Number: 414 241-3172
 Business Owner Address: 3355 S 13th st Mt Waubesa WI 53215

10. Hours of Operation & Customers

Will customers be entering the premises? No Yes

Day of the Week	Proposed Hours of Operation:		Estimated Number of Customers expected each day	Potential Age Range of Customers	Class B Tavern Applicant Only: Age Restriction (If none, write 'None')
	Open Time (include a.m. or p.m.)	Close Time (include a.m. or p.m.)			
Sunday	8:00 AM	10:00 PM	50	40	N/A
Monday	8:00 AM	10:00 PM	50	40	N/A
Tuesday	8:00 AM	10:00 PM	50	40	N/A
Wednesday	8:00 AM	10:00 PM	50	40	N/A
Thursday	8:00 AM	10:00 PM	50	40	N/A
Friday	8:00 AM	10:00 PM	50	40	N/A
Saturday	8:00 AM	10:00 PM	50	40	N/A

An Extended Hours Establishment License is required for any convenience store, filling station, personal service establishment (such as tattoo, body piercing, salon, tailor, tanning, etc.), recording studio or restaurant which is open between the hours of 12:00 a.m. and 5:00 a.m.

Alcohol Establishments Class A: 8:00 am to 9:00 pm Sunday thru Saturday
 Permitted Hours of Operation: Class B: 6:00 am to 2:00 am Sunday thru Thursday, 6:00 am to 2:30 am Friday & Saturday

Entertainment Outdoor Closing Hours: 10:00pm Sunday-Thursday; 12:00am Friday & Saturday; unless a different time, either earlier or later, is established by the Common Council in its approval of the licensee's plan of operation.

11. Signature(s)

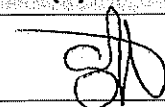
 Signature of Sole Proprietor, Partner, or 20% or more Shareholder
 (If there are no 20% or more shareholders,
 Corporate Officer-print name/title and sign)

Signature of additional partner or 20% or more shareholder

See Application Information for a complete list of all required application forms.



FOOD DEALER LICENSE PLAN OF OPERATION

ccl-foodplan 2/28/19

OFFICE OF THE CITY CLERK, LICENSE DIVISION
CITY HALL, 200 E. WELLS ST, ROOM 105, MILWAUKEE, WI 53202
(414) 286-2238 • license@milwaukee.gov • www.milwaukee.gov/license

Legal Entity Name: Islam Star Enterprise LLC DBA Top Star Family

Premises Address: 3353 813th St Milwaukee WI 53215

SECTION 1 TYPE OF BUSINESS

What will be the majority of your food sales? (check one)

Restaurant Items (meals):
MEALS include, but are not limited to, chicken, ribs, sandwiches, roasted corn, baked potatoes, hot dogs, brats, tacos, nachos w/ cheese and meat, French fries, cooked or deep fried vegetables/fruit, cooked cheese curds, corn dogs, egg rolls, salads.

Retail Items (snacks and beverages):
RETAIL items include, but are not limited to, ice cream/soft serve, lemonade, snow cones, coffee, espresso, cappuccino, tea, fruit juice, smoothies, candy, dispensed soda, fruit cups, bakery, cookies, kettle corn, cotton candy, funnel cakes, fritters, tortilla chips w/ cheese.

Will it be a convenience store? Yes No

A convenience store contains less than 5,000 square feet of retail space and has, as its primary business, the sale of basic food items and in addition, sells household products or is a filling station that sells basic food items and household products.

Bed & Breakfast

Micro Market

All Applicants: Submit a menu or a list of food items that will be sold.

Will any wholesale business be done? No Yes If yes, what percentage of food sales will be wholesale?

Less than 25%

25% or More AND:

Restaurant items (meals) will be sold – Complete this application and also contact DATCP.

NO restaurant items (meals) will be sold - Do NOT complete this application. Contact DATCP only.

SECTION 2 FOOD PROCESSING

Will any food processing be done? No Yes

Processing is defined as assembling, grinding, cutting, mixing, baking, coating, stuffing, packing, bottling, grilling, canning, extracting, fermenting, distilling, pickling, freezing, drying, smoking, or packaging.

SECTION 3 FOOD REQUIRING TEMPERATURE CONTROL

Will any food that requires temperature control be sold? No Yes
(includes dairy products such as milk, cheese, and ice cream, fish, shellfish, meat, poultry)

If yes, list the types of food items: Milk, cheese, Ice cream, fish, meat, poultry.

SECTION 4 DETAILS OF OPERATION

- Will you have seating on site for dining? No Yes
- Will you be doing any catering? No Yes
- Will you be doing any delivery? No Yes
- Will you have outdoor activities? No Yes - Check all that apply: Bar Cooking/Grilling Dining
- Will you have a drive thru window? No Yes - Are hours different from inside? No Yes
 If Yes, provide drive thru hours: _____
- Will scales or barcode scanners be used? No Yes - You must also apply for a Weights & Measures License.

SECTION 5 ADDITIONAL SITES

Where will food be prepared and/or sold?

At a single site At multiple sites: How many? _____ (for example, a hotel with several dining rooms or bars)

If multiple sites, attach a Food Dealer Additional Site Addendum (ccl-foodadd) for each additional site.

SECTION 6 CONSTRUCTION OR CHANGES

Are you planning any construction, remodeling or equipment changes?

No If No, SKIP to Section 8

Yes If Yes, check all that apply: New construction of a building Renovation or remodeling
 Construction changes to existing building Equipment changes only

Provide a brief description of the changes: _____

Start date: _____

Name, Address & Phone Number of Architect: _____

Name, Address & Phone Number of Contractor: _____

SECTION 7 ALCOHOL BEVERAGES

Are you applying for an alcohol beverage license?

No If No, SKIP to Section 9

Yes If YES, if your food license is approved prior to the alcohol license, when do you want the food license issued?
 Immediately At the same time as the alcohol license

SECTION 8 ACKNOWLEDGEMENTS & SIGNATURE

You must initial each item confirming your understanding:

- Sa I understand the Health Department must conduct an inspection and advise the License Division of their approval before the license may be issued.
- Sa I understand I must obtain an occupancy permit from the Department of Neighborhood Services and an inspection may be required. Neighborhood Services must advise the License Division of their approval before the license may be issued.
- Sa I understand the district alderperson will review and either support or object to my application. If he/she objects, I may appeal and be scheduled to appear before the Licenses Committee. The Licenses Committee will then make a recommendation to the Common Council. The Common Council must grant the license before it may be issued.
- Sa I understand proof of payment for all license fees must be on file in the License Division before the license may be issued and the license must be issued and posted in my establishment prior to opening for business.
- Sa I will not operate my food business until the license has been issued and posted in the establishment.

Signature of Sole Proprietor, Partner, or 20% Shareholder: _____ 

Signature of Additional Partner: _____

12/02/19

3353 S 13th St Milwaukee WI 53207

Islam Star

Total Square Footage = 1300 Enterprise LLC

Satara binti Mohamed
Agent's

Top star ~~family~~
family

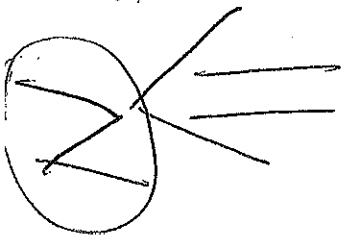

Width ~~400~~ 48

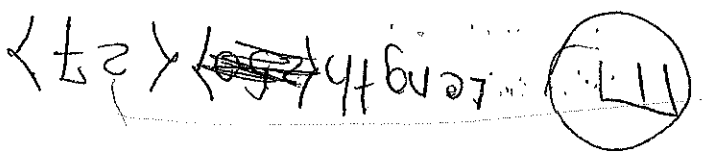
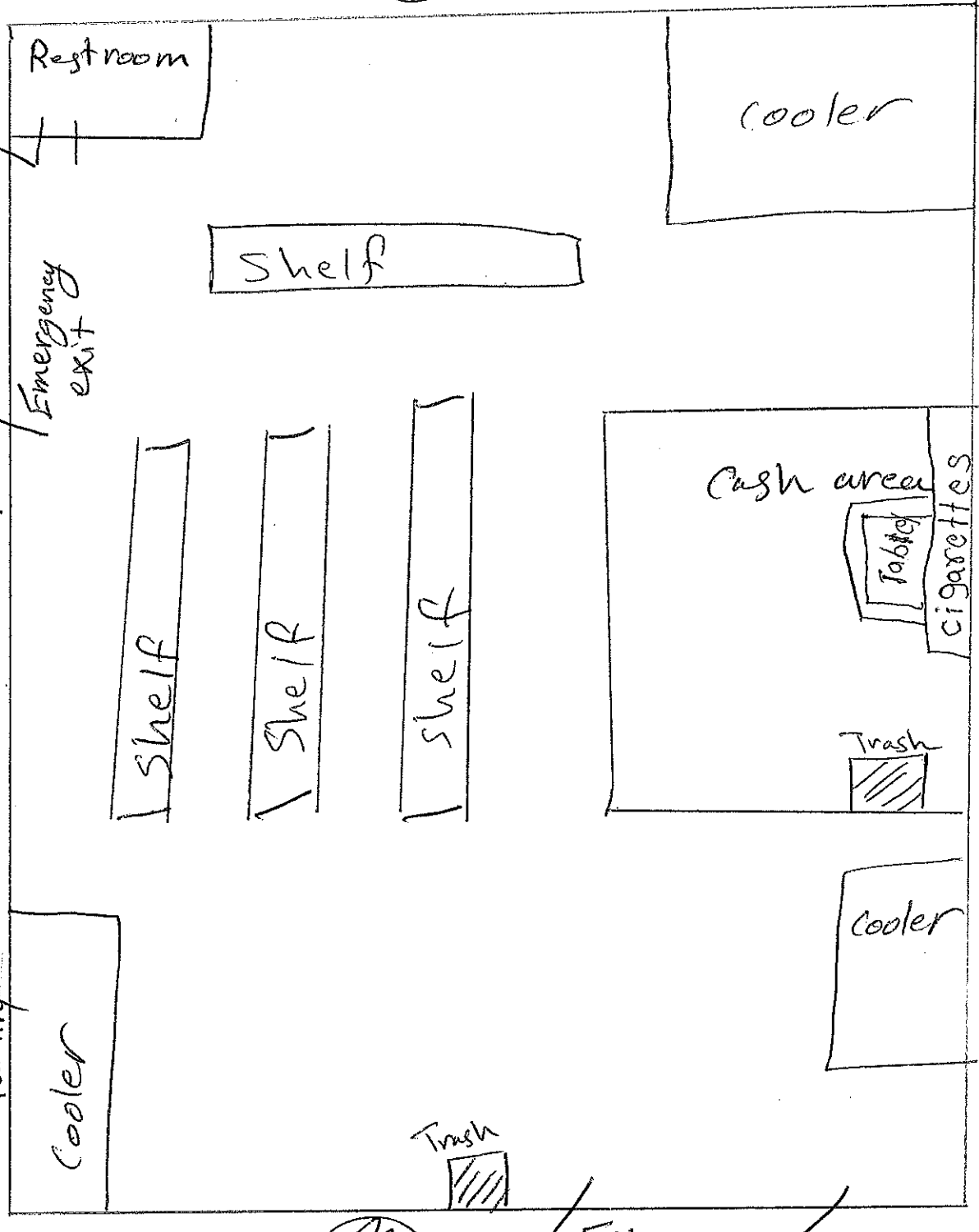

13th St

13th St

Entrance

Cooler

Cash area

Tablet

cigarettes

Trash

Trash

Shelf

Shelf

Shelf

Shelf

Restroom

Emergency exit

Cooler