



**CITY OF MILWAUKEE
OFFICE OF THE CITY CLERK**

Wednesday, June 03, 2020

COMMITTEE MEETING NOTICE

AD 14

DYE, John M, Agent
At Random Cocktail Lounge LLC
3264 N HACKETT AV

Milwaukee, WI 53211

You are requested to attend a virtual hearing to be held on:

Monday, June 15, 2020 at 10:30 AM

Regarding: Your Alcohol Permanent Extension of Premise License Application Adding Beer Garden to South Side of Premises Opening Mon-Fri 4 PM, Sat-Sun 12 PM and Closing Sun-Thurs 10 PM, Fri-Sat 11 PM as agent for "At Random Cocktail Lounge LLC" for "At Random" at 2501 S DELAWARE ST.

This meeting will be held via GoToMeeting. Please see the enclosed best practices document for further instructions. The access code is <https://global.gotomeeting.com/join/435425765>. If you wish to call in, please call +1 (872) 240-3212 and use Access Code: 435-425-765.

There is a possibility that your application may be denied for one or more of the following reasons: you do not meet the statutory and municipal requirements; the fitness and appropriateness of the location to be licensed and whether the location will create undesirable neighborhood problems (such as disorderly congregations of people, excessive litter, unreasonable noise, and traffic and parking problems), whether or not there is an over-concentration of alcohol beverage establishments in the neighborhood; whether or not you have been charged with or convicted of any felony, misdemeanor, municipal offense or other offense, the circumstances of which substantially relate to the licensed activity; and any other factors which reasonably relate to the public health, safety and welfare. See attached police report and/or written correspondence regarding this application. Please be advised the public will be able to provide information to the committee in person or in writing. The committee will receive and consider evidence regarding the above mentioned criteria.

Notice for applicants with warrants or unpaid fines:

Proof of warrant satisfaction or payment of fines must be submitted at the hearing on the above date and time. Failure to comply with this requirement may result in a delay of the granting/denial of your application.

Failure to attend this meeting may result in the denial of your license. Individual applicants and partnership applicants must attend or attend by an attorney. The agent or attorney for corporate or limited liability applicants must attend. If you wish to do so and at your own expense, you may be accompanied by an attorney of your choosing to represent you at this hearing.

You will be given an opportunity to speak on behalf of the application and to respond and challenge any charges or reasons given for the denial. No petitions can be accepted by the committee, unless the people who signed the petition attend the virtual hearing and are willing to testify. You may present witnesses under oath and you may also confront and cross-examine opposing witnesses under oath. If you have difficulty with the English language, you should request an interpreter attend the meeting with you, at your expense, so that you can answer questions and participate in your hearing.

PLEASE NOTE: Upon reasonable notice, efforts will be made to accommodate the needs of disabled individuals through sign language interpreters or other auxiliary aids. For additional information or to request this service, contact the Council Services Division ADA Coordinator at (414) 286-2998, Fax - (414) 286-3456, TDD - (414) 286-2025.

JIM OWCZARSKI, CITY CLERK

BY: _____

Jessica Ceella
License Division Manager

If you have questions regarding this meeting, please contact the staff assistant, Molly Kuether-Steele at (414) 286-2775 or molly.kuether-steele@milwaukee.gov.



Wednesday, June 03, 2020



Notice of Public Hearing

blank
notice

DYE, John M, Agent

At Random at 2501 S DELAWARE Av

Alcohol Permanent Extension of Premise License Application Adding Beer Garden to South Side of Premises Opening Mon-Fri 4 PM, Sat-Sun 12 PM and Closing Sun-Thurs 10 PM, Fri-Sat 11 PM

Monday, June 15, 2020 at 10:30 AM

To whom it may concern:

The above application has been made by the above named applicant(s). This requires approval from the Licenses Committee and the Common Council of the City of Milwaukee. The hearing before the Licenses Committee will take place virtually on 6/15/2020 at 10:30 AM. This is a public hearing. Those wishing to view the proceeding are able to do so via the City Channel – Channel 25 on Spectrum Cable – or on the Internet at <http://city.milwaukee.gov/citychannel>. Those wishing to provide oral testimony will be asked to do so by phone or internet and are asked to contact the staff assistant, Molly Kuether-Steele at (414) 286-2775 or molly.kuether-steele@milwaukee.gov for necessary information. Please make such requests no later than one business day prior to the start of the meeting. You are not required to attend the hearing, but please see the information below if you would like to provide testimony. Once the Licenses Committee makes its recommendation, this recommendation is forwarded to the full Common Council for approval at its next regularly scheduled hearing.

Important details for those wishing to provide information for the Licenses Committee to consider when making its recommendation:

1. The license application is scheduled to be heard at the above time. Due to other hearings running longer than scheduled, you may have to wait some time to provide your testimony.
2. You must testify as to matters that you have personally experienced or seen. (You cannot provide testimony for your neighbor, parent or anyone else; this is considered hearsay and cannot be considered by the committee.)
3. No letters or petitions can be accepted by the committee (unless the person who wrote the letter or the persons who signed the petition are willing to testify).
4. Persons opposed to the license application are given the opportunity to testify first; supporters may testify after the opponents have finished.
5. When you are called to testify, you will be sworn in and asked to give your name, and address. (If your first and/or last names are uncommon please spell them.)
6. You may then provide testimony.
 - a. Include only information relating to the above license application.
 - b. Include only information you have personally witnessed or seen.
 - c. Provide concise and relevant information detailing how this business has affected or may affect the peaceful enjoyment of your neighborhood.
 - d. If by the time you have the opportunity to testify, the information you wish to share has already been provided to the committee, you may state that you agree with the previous testimony. Redundant or repetitive testimony will not assist the committee in making its recommendation.
7. After giving your testimony, the members of the Licenses Committee and the licensee may ask questions regarding the testimony you have given or other factors relating to the license application.
8. Business Competition is not a valid basis for denial or non-renewal of a license.

Please Note: If you have submitted an objection to the above application your objection cannot be considered by the committee unless you personally testify at the hearing.

OCCUPANT	MAIL ADDRESS	CITY, STATE ZIP
CURRENT OCCUPANT	2496 S DELAWARE AVE	MILWAUKEE, WI 53207
CURRENT OCCUPANT	2482 S DELAWARE AVE	MILWAUKEE, WI 53207
CURRENT OCCUPANT	2484A S DELAWARE AVE	MILWAUKEE, WI 53207
CURRENT OCCUPANT	1422 E RUSSELL AVE	MILWAUKEE, WI 53207
CURRENT OCCUPANT	2528 S DELAWARE AVE	MILWAUKEE, WI 53207
CURRENT OCCUPANT	1327 E RUSSELL AVE	MILWAUKEE, WI 53207
CURRENT OCCUPANT	1442 E SEELEY ST	MILWAUKEE, WI 53207
CURRENT OCCUPANT	2481 S DELAWARE AVE A	MILWAUKEE, WI 53207
CURRENT OCCUPANT	2486 S DELAWARE AVE	MILWAUKEE, WI 53207
CURRENT OCCUPANT	2517 S DELAWARE AVE	MILWAUKEE, WI 53207
CURRENT OCCUPANT	2536 S DELAWARE AVE	MILWAUKEE, WI 53207
CURRENT OCCUPANT	1438 E SEELEY ST	MILWAUKEE, WI 53207
CURRENT OCCUPANT	1411 E RUSSELL AVE 3	MILWAUKEE, WI 53207
CURRENT OCCUPANT	2504 S DELAWARE AVE	MILWAUKEE, WI 53207
CURRENT OCCUPANT	1426 E RUSSELL AVE	MILWAUKEE, WI 53207
CURRENT OCCUPANT	2515 S WENTWORTH AVE	MILWAUKEE, WI 53207
CURRENT OCCUPANT	1454 E SEELEY ST	MILWAUKEE, WI 53207
CURRENT OCCUPANT	2487 S DELAWARE AVE	MILWAUKEE, WI 53207
CURRENT OCCUPANT	2492 S DELAWARE AVE A	MILWAUKEE, WI 53207
CURRENT OCCUPANT	2519 S WENTWORTH AVE	MILWAUKEE, WI 53207
CURRENT OCCUPANT	2540 S DELAWARE AVE	MILWAUKEE, WI 53207
CURRENT OCCUPANT	1339 E RUSSELL AVE	MILWAUKEE, WI 53207
CURRENT OCCUPANT	2483 S DELAWARE AVE	MILWAUKEE, WI 53207
CURRENT OCCUPANT	2481 S DELAWARE AVE	MILWAUKEE, WI 53207
CURRENT OCCUPANT	2494 S DELAWARE AVE	MILWAUKEE, WI 53207
CURRENT OCCUPANT	2492 S DELAWARE AVE	MILWAUKEE, WI 53207
CURRENT OCCUPANT	2488 S DELAWARE AVE	MILWAUKEE, WI 53207
CURRENT OCCUPANT	1416 E RUSSELL AVE	MILWAUKEE, WI 53207
CURRENT OCCUPANT	1411 E RUSSELL AVE 4	MILWAUKEE, WI 53207
CURRENT OCCUPANT	1411 E RUSSELL AVE 1	MILWAUKEE, WI 53207
CURRENT OCCUPANT	1419 E RUSSELL AVE	MILWAUKEE, WI 53207
CURRENT OCCUPANT	2522 S DELAWARE AVE	MILWAUKEE, WI 53207
CURRENT OCCUPANT	1327A E RUSSELL AVE	MILWAUKEE, WI 53207
CURRENT OCCUPANT	1448 E SEELEY ST	MILWAUKEE, WI 53207
CURRENT OCCUPANT	2481 S DELAWARE AVE B	MILWAUKEE, WI 53207
CURRENT OCCUPANT	2484 S DELAWARE AVE	MILWAUKEE, WI 53207
CURRENT OCCUPANT	1406A E RUSSELL AVE	MILWAUKEE, WI 53207
CURRENT OCCUPANT	2529 S DELAWARE AVE	MILWAUKEE, WI 53207
CURRENT OCCUPANT	2506 S DELAWARE AVE	MILWAUKEE, WI 53207
CURRENT OCCUPANT	2514 S DELAWARE AVE	MILWAUKEE, WI 53207
CURRENT OCCUPANT	2534 S DELAWARE AVE	MILWAUKEE, WI 53207
CURRENT OCCUPANT	2523 S WENTWORTH AVE	MILWAUKEE, WI 53207
CURRENT OCCUPANT	2545 S DELAWARE AVE	MILWAUKEE, WI 53207
CURRENT OCCUPANT	2535 S DELAWARE AVE	MILWAUKEE, WI 53207
CURRENT OCCUPANT	2491 S DELAWARE AVE	MILWAUKEE, WI 53207
CURRENT OCCUPANT	2490 S DELAWARE AVE	MILWAUKEE, WI 53207

CURRENT OCCUPANT	1406 E RUSSELL AVE	MILWAUKEE, WI 53207
CURRENT OCCUPANT	2513 S DELAWARE AVE	MILWAUKEE, WI 53207
CURRENT OCCUPANT	1411 E RUSSELL AVE 2	MILWAUKEE, WI 53207
CURRENT OCCUPANT	2504A S DELAWARE AVE	MILWAUKEE, WI 53207
CURRENT OCCUPANT	1425 E RUSSELL AVE	MILWAUKEE, WI 53207
CURRENT OCCUPANT	2528A S DELAWARE AVE	MILWAUKEE, WI 53207
CURRENT OCCUPANT	2532 S DELAWARE AVE	MILWAUKEE, WI 53207
CURRENT OCCUPANT	1446 E SEELEY ST	MILWAUKEE, WI 53207
CURRENT OCCUPANT	2489 S DELAWARE AVE	MILWAUKEE, WI 53207
CURRENT OCCUPANT	2508 S DELAWARE AVE	MILWAUKEE, WI 53207
CURRENT OCCUPANT	2540A S DELAWARE AVE	MILWAUKEE, WI 53207
CURRENT OCCUPANT	1333 E RUSSELL AVE	MILWAUKEE, WI 53207
blank	notice	

Total Records: 58

Radius: 250.0 feet and Center of Circle: 2501 S Delaware Ave



**PERMANENT EXTENSION OF PREMISES APPLICATION
FOOD AND ALCOHOL BEVERAGE ESTABLISHMENTS**

OFFICE OF THE CITY CLERK LICENSE DIVISION
200 E. WELLS ST. ROOM 105, MILWAUKEE, WI 53202
(414) 286-2238 E-MAIL ADDRESS: LICENSE@MILWAUKEE.GOV

Section A	Date of Application: <u>5/1/2020</u>	Aldermanic District: <u>14</u>
	Licensee (Name of individual; partners, or agent, if Corp/LLC): <u>At Random Cocktail Lounge LLC</u>	
	Corporation or LLC Name (if applicable): <u>At Random Cocktail Lounge LLC</u>	Business Name: <u>At Random</u>
	Business Address (include city,state,zip): <u>2501 S Delaware Ave., Milwaukee WI 53207</u>	
	(Optional) Mailing Address (include city,state,zip):	Business Telephone Number: <u>(414) 481-8030</u>
Section B	This request is for the permanent extension of premises for a: <input type="checkbox"/> FOOD license <input checked="" type="checkbox"/> ALCOHOL license	
	The Current Premises Description is : <u>1st Floor, Basement Storage</u>	
	Identify the specific area(s) for which the permanent extension of premises is requested. Check all that apply and list for each the relationship of the area to the premises (example: north side, front, etc.)	
	<input type="checkbox"/> Sidewalk café (public sidewalk) at the _____ side of the premises in front of the following street address(es) _____ (area must be contiguous with licensed area and under the licensee's control) (An application for a Siding Dining Facility Permit must also be submitted with this application.)	
	<input type="checkbox"/> Patio (concrete surface) at the _____ side of the premises	
<input checked="" type="checkbox"/> Beer garden (soil/grass surface) at the <u>south</u> side of the premises		
<input type="checkbox"/> Deck (attached to building) at the _____ side of the premises		
<input type="checkbox"/> Addition to the: <input type="checkbox"/> 1 st floor <input type="checkbox"/> 2 nd floor <input type="checkbox"/> 3 rd floor <input type="checkbox"/> Basement <input type="checkbox"/> Other: _____ at the _____ side of the premises		
<input type="checkbox"/> Other: Describe area(s): _____		
Does extension area have an additional street address? <input checked="" type="checkbox"/> No <input type="checkbox"/> Yes If yes, list address: _____		
List all type(s) of business(es) that will operate at this location? <input checked="" type="checkbox"/> Tavern <input type="checkbox"/> Restaurant <input type="checkbox"/> Other: Describe: _____		
Section C	 Signature of Sole Proprietor; a Partner; or if a Corporation or LLC, the Agent must sign	

Office Use Only:

Filed _____ Initials _____ App #: Food _____ Alcohol _____

Queue to:

- | | | |
|--|-----------------------------------|-------------------------------------|
| <input type="checkbox"/> DNS (all) | <input type="checkbox"/> Approved | <input type="checkbox"/> Hold _____ |
| <input type="checkbox"/> HD (all food) | <input type="checkbox"/> Approved | <input type="checkbox"/> Hold _____ |
| <input type="checkbox"/> CC Food Only (no alcohol) | <input type="checkbox"/> Approved | <input type="checkbox"/> Denied |

Email to:

- DPW (sidewalk cafes/parklets) Approved Hold _____ Sidewalk Dining Facility Permit Issued

New Licenses Issued: Food _____ Initials _____ Alcohol _____ Initials _____

DELAWARE AVE.

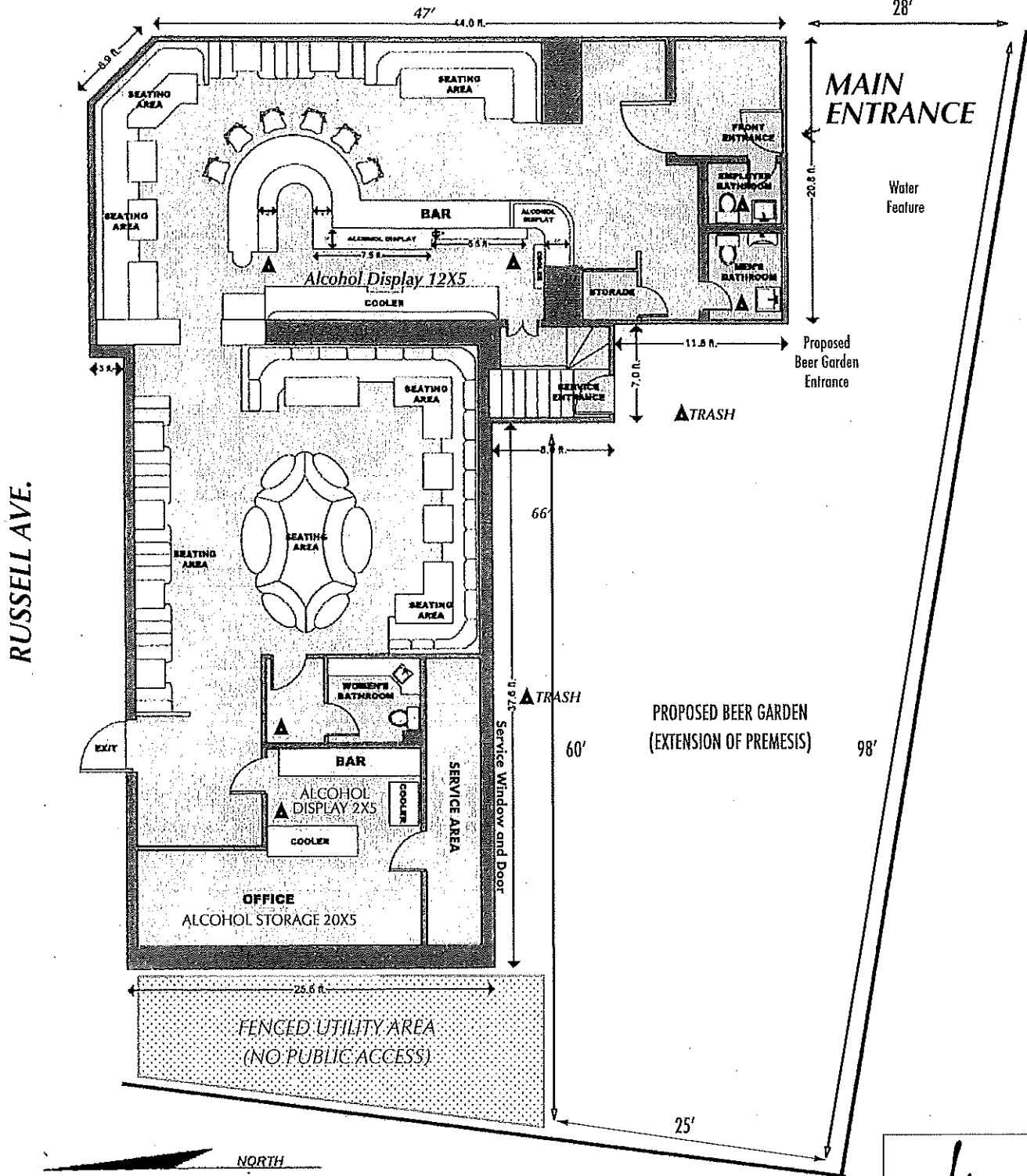

Details:

INSIDE SQUARE FOOTAGE: 2144 Square Feet

BUILDING DIMENSIONS: 47'X66'

LOT SIZE: 0.15 Acres

TRASH LOCATIONS: Bathrooms(3), Bar(2),

Service Bar (1), Outside Back Door (1), Basement

▲ = TRASH

*At
Random*

At Random Cocktail Lounge LLC

John M. Dye - Agent
2501 S Delaware Ave.
Milwaukee WI 53207
May 1, 2020

DELAWARE AVE.

RUSSELL AVE.

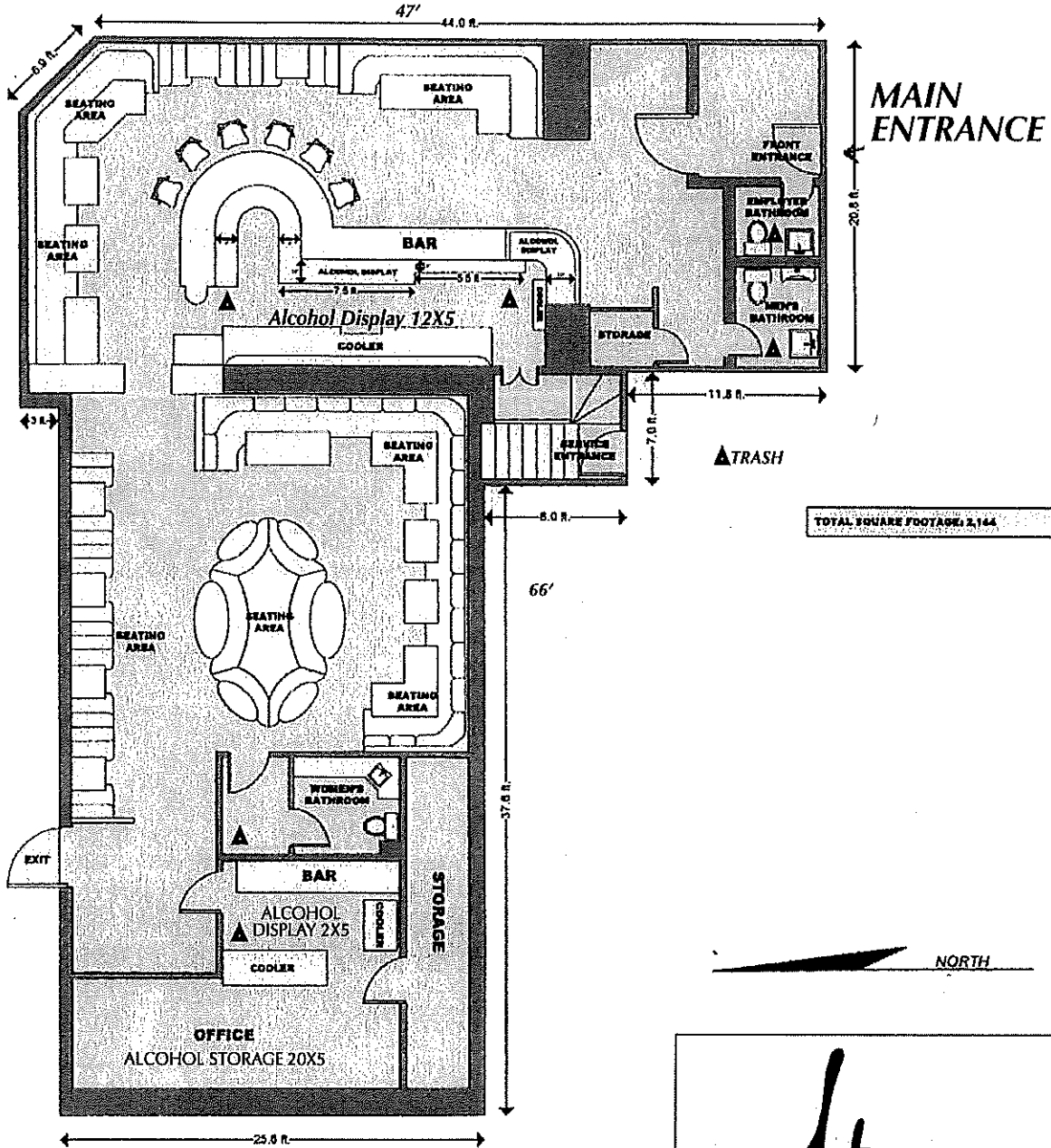

TOTAL SQUARE FOOTAGE: 2,144



Details:

TOTAL SQUARE FOOTAGE: 2144 Square Feet
 BUILDING DIMENSIONS: 47'X66'
 LOT SIZE: 0.15 Acres
 TRASH LOCATIONS: Bathrooms(3), Bar(2),
 Service Bar (1), Outside Back Door (1), Basement
 ▲ = TRASH

*At
 Random*

At Random Cocktail Lounge LLC

John M. Dye- Agent
 2501 S Delaware Ave.
 Milwaukee WI 53207
 July 11, 2018

Delaware Ave.

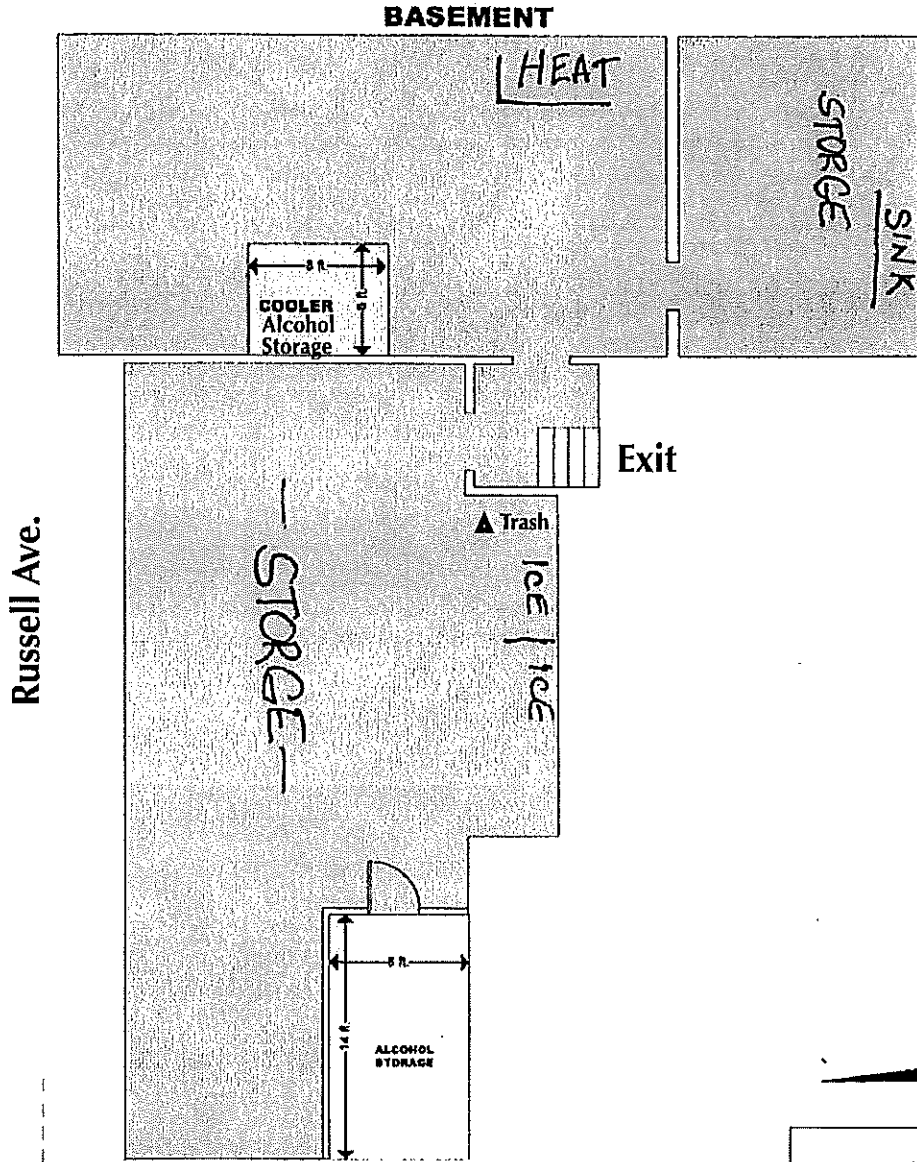

*At
Random*

At Random Cocktail Lounge LLC

John M. Dye- Agent
2501 S Delaware Ave.
Milwaukee WI 53207
July 11, 2018