

**WESTLAWN
REVITALIZATION
- BUILDING 2.3**

6525 W SILVER SPRING DR.
MILWAUKEE WI 53218

Owner
Housing Authority of
the City of Milwaukee
414.286.3629

Torti Gallas and
Partners, Inc.
1300 Spring Street
4th Floor
Silver Spring, MD 20910
301.588.4800
www.tortigallas.com

Local Architect
Quorum Architects
414.265.9265

Local Architect
Eppstein Uhen
Architects
414.271.5350

Structural Engineer:
Pierce
Engineers
414.278.6060

MEP Engineer:
Thunderbird Engineering, Inc.
414.352.2211

Civil Engineer:
raSmith R.A. Smith, Inc.
262.781.1000

Landscape Architect:
AYRES
ASSOCIATES Ayres Associates
608.443.1200

Issue

No.	Date
01 FOOTING & FOUNDATION	07/11/18
02 CONSTRUCTION DOCUMENTS	07/30/18

Revisions

No.	Date
▲	
▲	
▲	
▲	
▲	
▲	
▲	
▲	
▲	
▲	

**OVERALL
SITE PLAN**

Date
07/30/2018
Principal In Charge
M.A.
Project Planner
M.A., S.V.
Project Architect
M.A.
Project Manager
W.F.
Drawn
AJS, DJM, SJD
Job No.
3160080
Scale
1" = 100'
Drawing No.

C430

CONSTRUCTION DOCUMENTS

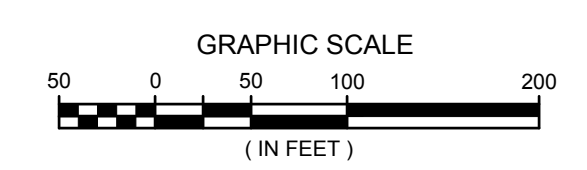
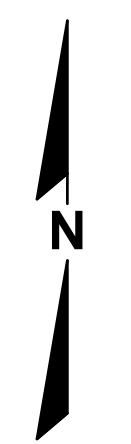
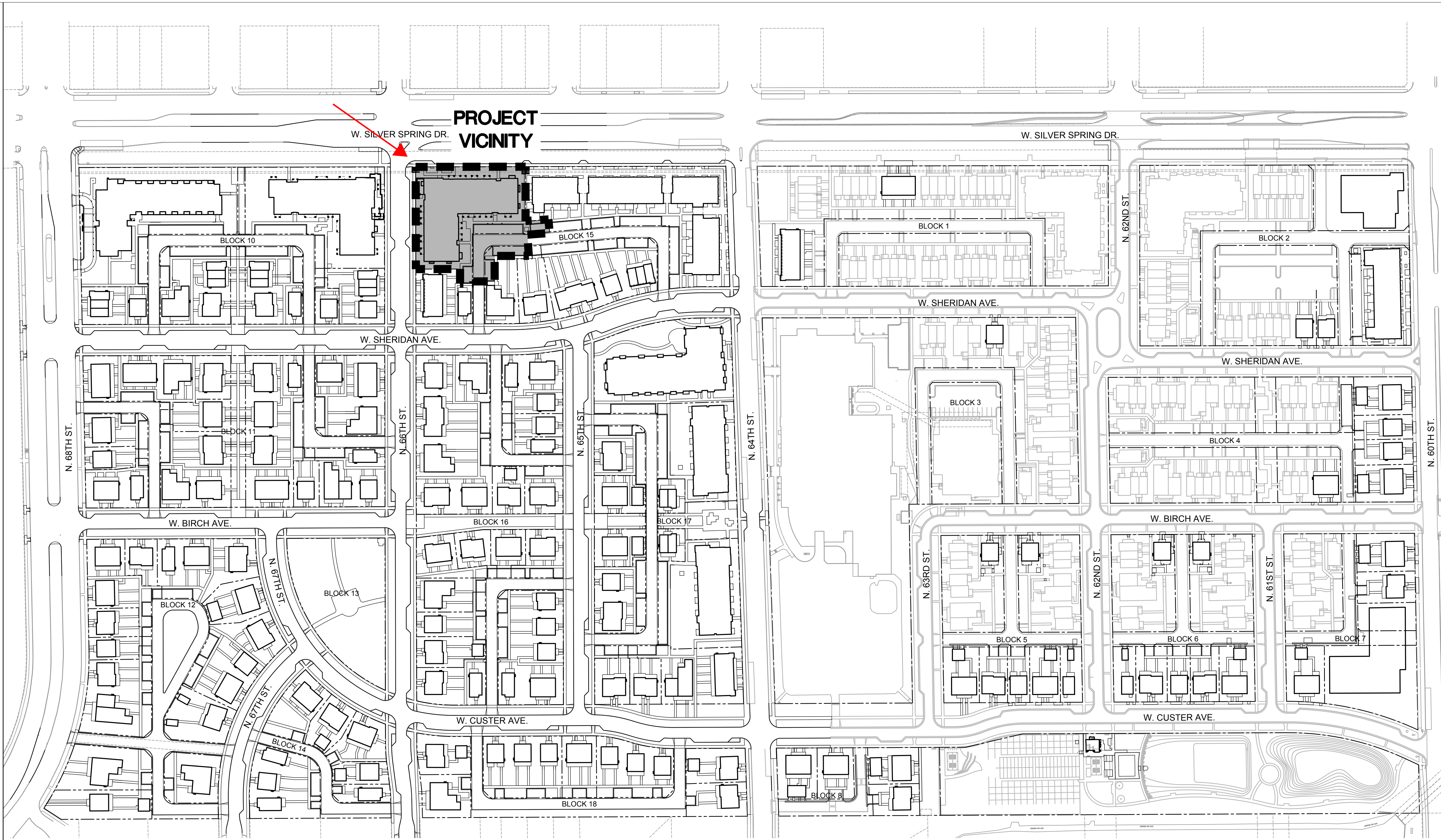

raSmith
CREATIVITY BEYOND ENGINEERING

rasmith.com

DIGGERS HOTLINE
Toll Free (800) 242-8611
Milwaukee Area (414) 259-1181
Hearing Impaired TDD (800) 542-2289
www.DiggersHotline.com

TORTI GALLAS AND PARTNERS, INC. WESTLAWN REVITALIZATION - BUILDING 2.3

P:\3160080\02\Construction Drawing\Private Grading MF\SP1-MF-OVERALL.dwg MF SP Overall 2.3 7/27/2018 12:56:54 PM .djs