



**CITY OF MILWAUKEE
OFFICE OF THE CITY CLERK**

Monday, May 11, 2020

COMMITTEE MEETING NOTICE

AD 07

CHILDS, Cd, Agent
WAZ'S PUB, INC
6972 N 79TH Ct

Milwaukee, WI 53223

You are requested to attend a virtual hearing to be held on:

Friday, May 22, 2020 at 11:30 PM

Regarding: Your Class B Tavern, Food Dealer, and Public Entertainment Premises License Transfer Applications with Change of Agent as agent for "WAZ'S PUB, INC" for "WAZ'S PUB" at 4532 W BURLEIGH St.

This meeting will be held via GoToMeeting. Please see the enclosed best practices document for further instructions. The access code is <https://global.gotomeeting.com/join/570861413>. If you wish to call in, please call +1 (669) 224-3412 and use Access Code: 570-861-413.

There is a possibility that your application may be denied for one or more of the following reasons: The recommendation of the committee regarding the application shall be based on evidence presented at the hearing. Per MCO 85-2.7-4, probative evidence concerning whether or not a new license should be granted may be presented on the following subjects: whether or not the applicant meets the municipal requirements, the appropriateness of the location and premises where the licensed premises is to be located and whether use of the premises for the purposes or activities permitted by the license would tend to facilitate a public or private nuisance or create undesirable neighborhood problems such as disorderly patrons, unreasonably loud noise, litter, and excessive traffic and parking congestion. Probative evidence relating to these matters may be taken from the plan of operation submitted with the license application, if any, but shall not include the content of any music. Evidence regarding the fitness of the location of the premises to be maintained as the principal place of business, including but not limited to whether there is an overconcentration of businesses of the type for which the license is sought; whether the proposal is consistent with any pertinent neighborhood business or development plans, or the location's proximity to areas where children are typically present. The applicant's record in operating similarly licensed premises; and whether or not the applicant has been charged with or convicted of any felony, misdemeanor, municipal offense or other offense, the circumstances of which substantially relate to the activity to be permitted by the license being applied for or any other factor which reasonably relates to the public health, safety or welfare may also be considered. See attached police report or correspondence.

Notice for applicants with warrants or unpaid fines:

Proof of warrant satisfaction or payment of fines must be submitted at the hearing on the above date and time. Failure to comply with this requirement may result in a delay of the granting/denial of your application.

Failure to attend this meeting may result in the denial of your license. Individual applicants and partnership applicants must attend or attend by an attorney. The agent or attorney for corporate or limited liability applicants must attend. If you wish to do so and at your own expense, you may be accompanied by an attorney of your choosing to represent you at this hearing.

You will be given an opportunity to speak on behalf of the application and to respond and challenge any charges or reasons given for the denial. No petitions can be accepted by the committee, unless the people who signed the petition attend the virtual hearing and are willing to testify. You may present witnesses under oath and you may also confront and cross-examine opposing witnesses under oath. If you have difficulty with the English language, you should request an interpreter attend the meeting with you, at your expense, so that you can answer questions and participate in your hearing.

PLEASE NOTE: Upon reasonable notice, efforts will be made to accommodate the needs of disabled individuals through sign language interpreters or other auxiliary aids. For additional information or to request this service, contact the Council Services Division ADA Coordinator at (414) 286-2998, Fax - (414) 286-3456, TDD - (414) 286-2025.

JIM OWCZARSKI, CITY CLERK

BY: _____

Jessica Celella
License Division Manager

If you have questions regarding this meeting, please contact the staff assistant, Molly Kuether-Steele at (414) 286-2775 or molly.kuether-steele@milwaukee.gov.

200 E. Wells Street, Room 105, City Hall, Milwaukee, WI 53202. www.milwaukee.gov/license
Phone: (414) 286-2238 Fax: (414) 286-3057 Email Address: License@milwaukee.gov

MILWAUKEE POLICE DEPARTMENT
LICENSE INVESTIGATION UNIT

CRIMINAL RECORD/ORDINANCE VIOLATION/INCIDENTS
SYNOPSIS

DATE: 05/09/2019

LICENSE TYPE: CLASS B TAVERN

No. 293307

NEW:

Application Date: 05/08/2019

RENEWAL: X

Expiration Date:

License Location: 4532 W Burleigh Street

Aldermanic District:07

Business Name: Waz's Pub

Licensee/Applicant: Wasmund, Shelly R

(Last Name, First Name, MI)

Date of Birth: 06/05/63

Male:

Female:

Home Address: 16630 North Glenbrook Dr W213

City: Jackson

State: Wi

Zip Code: 53037

Home Phone: (414) 677-9414

This report is written by Police Officer David NOVAK, assigned to the License Investigation Unit, Days.

The Milwaukee Police Department's investigation regarding this application revealed the following:

1. On 10/04/06 at 11:05 pm, Milwaukee Police were dispatched to 4425 W Burleigh for a Battery complaint. Investigation revealed an intoxicated patron entered the tavern and was asked to leave due to troubles with her in the past. The patron became disorderly and was being escorted out by the bouncer and the bartender. The patron attempted to hit the bartender and while being escorted out, the patron received a minor scratch to the face.

- =====
2. On 01/24/09 at 9:27 pm, Milwaukee police conducted a License Premise check at 4532 W Burleigh. Officers asked to view the taverns license and the bartender, Yolanda Taylor, had to pull the licenses out from behind a clipboard. Taylor was advised that the licenses for the tavern must be displayed and are to be viewed by patrons in the tavern. No other violations were found.
- =====

3. On 07/08/09 at 2:33 am, while on patrol, Milwaukee police observed a subject down at the corner of 46th and Burleigh. The subject was lying face down and bleeding from the head. Investigation revealed the subject had been drinking at Waz's bar and when he left, was jumped and robbed by two males who were also patrons at the bar. The victim stated the doorman offered to walk him home but the victim refused. The victim was treated at a nearby hospital for his injuries.

Wasmund, Shelly R

- 4. On 09/04/09 at 12:15 am, Milwaukee police conducted a License Premise Check at 4532 W Burleigh. Officers found the licenses were not properly displayed and spoke with the bartender Yolanda Taylor regarding. Taylor attempted to contact the owner David Wasmund but was unable to. A citation was issued for Display of License to David Wasmund.

Charge: Display Of Liquor License Required
 Finding: Guilty
 Sentence: Fined \$356.00
 Date: 12/03/09
 Case: 09129123

=====

- 5. On 11/06/10 at 9:17 pm, Milwaukee police were conducting sales of alcohol to minors and had a police aide who was under the age of 21, enter 4532 W Burleigh in attempts to purchase alcohol. The bartender identified as Yolanda Taylor, sold the aide a Smirnoff ice without asking for any ID. Taylor admitted to selling the alcohol and stated it was busy and she knew she should have. Taylor was issued a citation.

As to Taylor:

Charge: Sale of Alcohol To Underage Person
 Finding: Guilty
 Sentence: Fined \$171.00
 Date: 12/30/10
 Case: 10135696

- 6. On 11/19/10 at 9:59 pm, Milwaukee police conducted a License Premise Check at 4532 W Burleigh. Police found a clear plastic bag, which contained a large chunk of suspected Cocaine base from the kitchen area. The substance tested positive for Cocaine. Also found in the kitchen was marijuana which an employee Robert Sterling admitted was his. Sterling as well as another subject who was in the kitchen of where the cocaine was found was arrested.

- 7. On 03/22/10, David T Wasmund received a citation for Building Code Violations.

Charge: Building Code Violations
 Finding: Guilty
 Sentence: Fined \$150.00
 Date: 01/30/11
 Case: 10068972

=====

8. On 09/15/2013 Milwaukee police responded to a battery complaint at 4532 West Burleigh Street (Waz's Pub). Investigation revealed two patrons of the bar became involved in an altercation creating a disturbance. Both patrons were cited.

=====

9. On 07/28/2015 Milwaukee police were dispatched to a battery-dv complaint at North 46th Street and West Burleigh Street. The caller, Angel Patterson, stated she had been at Waz's (4532 West Burleigh Street) when her sister came into the business and started an altercation with her. The suspect pulled the caller's hair. The bartender, Janita Reed, broke up the fight and told both patrons to leave.

=====

10. On 11/17/2019 at 12:05am officers were dispatched to a shooting at N. 46th and W. Burleigh St. The investigation revealed the shooting occurred inside Waz's Pub, 4532 W. Burleigh St. The victim and suspect were patrons of the bar when an argument occurred. The suspect produced a handgun and shot the victim causing his death. There were cameras operating and recording during the incident.

Item #10 added as part of PREVIOUS PREMISE



Monday, May 11, 2020



Notice of Public Hearing

blank
notice

CHILDS, Cd, Agent
WAZ'S PUB at 4532 W BURLEIGH St
Class B Tavern, Food Dealer, and Public Entertainment Premises License Transfer Applications
with Change of Agent

Friday, May 22, 2020 at 1:30 PM

To whom it may concern:

The above application has been made by the above named applicant(s). This requires approval from the Licenses Committee and the Common Council of the City of Milwaukee. The hearing before the Licenses Committee will take place virtually on 5/22/2020 at 1:30 PM. This is a public hearing. Those wishing to view the proceeding are able to do so via the City Channel – Channel 25 on Spectrum Cable – or on the Internet at <http://city.milwaukee.gov/citychannel>. Those wishing to provide oral testimony will be asked to do so by phone or internet and are asked to contact the staff assistant, Molly Kuether-Steele at (414) 286-2775 or molly.kuether-steele@milwaukee.gov for necessary information. Please make such requests no later than one business day prior to the start of the meeting. You are not required to attend the hearing, but please see the information below if you would like to provide testimony. Once the Licenses Committee makes its recommendation, this recommendation is forwarded to the full Common Council for approval at its next regularly scheduled hearing.

Important details for those wishing to provide information for the Licenses Committee to consider when making its recommendation:

1. The license application is scheduled to be heard at the above time. Due to other hearings running longer than scheduled, you may have to wait some time to provide your testimony.
2. You must testify as to matters that you have personally experienced or seen. (You cannot provide testimony for your neighbor, parent or anyone else; this is considered hearsay and cannot be considered by the committee.)
3. No letters or petitions can be accepted by the committee (unless the person who wrote the letter or the persons who signed the petition are willing to testify).
4. Persons opposed to the license application are given the opportunity to testify first; supporters may testify after the opponents have finished.
5. When you are called to testify, you will be sworn in and asked to give your name, and address. (If your first and/or last names are uncommon please spell them.)
6. You may then provide testimony.
 - a. Include only information relating to the above license application.
 - b. Include only information you have personally witnessed or seen.
 - c. Provide concise and relevant information detailing how this business has affected or may affect the peaceful enjoyment of your neighborhood.
 - d. If by the time you have the opportunity to testify, the information you wish to share has already been provided to the committee, you may state that you agree with the previous testimony. Redundant or repetitive testimony will not assist the committee in making its recommendation.
7. After giving your testimony, the members of the Licenses Committee and the licensee may ask questions regarding the testimony you have given or other factors relating to the license application.
8. Business Competition is not a valid basis for denial or non-renewal of a license.

Please Note: If you have submitted an objection to the above application your objection cannot be considered by the committee unless you personally testify at the hearing.

| OCCUPANT | MAIL ADDRESS | CITY, STATE ZIP |
|------------------|----------------------|---------------------|
| CURRENT OCCUPANT | 3145 N 45TH ST | MILWAUKEE, WI 53216 |
| CURRENT OCCUPANT | 3143 N 45TH ST | MILWAUKEE, WI 53216 |
| CURRENT OCCUPANT | 3125 N 45TH ST | MILWAUKEE, WI 53216 |
| CURRENT OCCUPANT | 3057 N 46TH ST | MILWAUKEE, WI 53210 |
| CURRENT OCCUPANT | 3131 N 46TH ST | MILWAUKEE, WI 53216 |
| CURRENT OCCUPANT | 3152 N 46TH ST | MILWAUKEE, WI 53216 |
| CURRENT OCCUPANT | 3124 N 46TH ST | MILWAUKEE, WI 53216 |
| CURRENT OCCUPANT | 4522 W BURLEIGH ST 2 | MILWAUKEE, WI 53210 |
| CURRENT OCCUPANT | 4522 W BURLEIGH ST 6 | MILWAUKEE, WI 53210 |
| CURRENT OCCUPANT | 3131 N 45TH ST | MILWAUKEE, WI 53216 |
| CURRENT OCCUPANT | 4621A W CARTER PL | MILWAUKEE, WI 53216 |
| CURRENT OCCUPANT | 3127A N 46TH ST | MILWAUKEE, WI 53216 |
| CURRENT OCCUPANT | 3133 N 46TH ST | MILWAUKEE, WI 53216 |
| CURRENT OCCUPANT | 3146 N 46TH ST | MILWAUKEE, WI 53216 |
| CURRENT OCCUPANT | 3064 N 46TH ST | MILWAUKEE, WI 53210 |
| CURRENT OCCUPANT | 3102 N 46TH ST | MILWAUKEE, WI 53216 |
| CURRENT OCCUPANT | 3052 N 46TH ST | MILWAUKEE, WI 53210 |
| CURRENT OCCUPANT | 4621 W CARTER PL | MILWAUKEE, WI 53216 |
| CURRENT OCCUPANT | 3145 N 46TH ST | MILWAUKEE, WI 53216 |
| CURRENT OCCUPANT | 4505 W BURLEIGH ST | MILWAUKEE, WI 53210 |
| CURRENT OCCUPANT | 3102 N 46TH ST A | MILWAUKEE, WI 53216 |
| CURRENT OCCUPANT | 3141 N 45TH ST | MILWAUKEE, WI 53216 |
| CURRENT OCCUPANT | 3059 N 45TH ST | MILWAUKEE, WI 53210 |
| CURRENT OCCUPANT | 3130 N 46TH ST | MILWAUKEE, WI 53216 |
| CURRENT OCCUPANT | 3069 N 45TH ST | MILWAUKEE, WI 53210 |
| CURRENT OCCUPANT | 3135 N 45TH ST | MILWAUKEE, WI 53216 |
| CURRENT OCCUPANT | 3058 N 46TH ST | MILWAUKEE, WI 53210 |
| CURRENT OCCUPANT | 3151 N 46TH ST | MILWAUKEE, WI 53216 |
| CURRENT OCCUPANT | 3147 N 46TH ST | MILWAUKEE, WI 53216 |
| CURRENT OCCUPANT | 3126 N 46TH ST | MILWAUKEE, WI 53216 |
| CURRENT OCCUPANT | 4522 W BURLEIGH ST 1 | MILWAUKEE, WI 53210 |
| CURRENT OCCUPANT | 4522 W BURLEIGH ST 3 | MILWAUKEE, WI 53210 |
| CURRENT OCCUPANT | 3121 N 46TH ST | MILWAUKEE, WI 53216 |
| CURRENT OCCUPANT | 3147 N 45TH ST | MILWAUKEE, WI 53216 |
| CURRENT OCCUPANT | 3057 N 45TH ST | MILWAUKEE, WI 53210 |
| CURRENT OCCUPANT | 3151A N 46TH ST | MILWAUKEE, WI 53216 |
| CURRENT OCCUPANT | 3127 N 46TH ST | MILWAUKEE, WI 53216 |
| CURRENT OCCUPANT | 3140 N 46TH ST | MILWAUKEE, WI 53216 |
| CURRENT OCCUPANT | 3071 N 45TH ST | MILWAUKEE, WI 53210 |
| CURRENT OCCUPANT | 3075 N 45TH ST | MILWAUKEE, WI 53210 |
| CURRENT OCCUPANT | 4627 W CARTER PL | MILWAUKEE, WI 53216 |
| CURRENT OCCUPANT | 4627A W CARTER PL | MILWAUKEE, WI 53216 |
| CURRENT OCCUPANT | 3150 N 46TH ST | MILWAUKEE, WI 53216 |
| CURRENT OCCUPANT | 3146A N 46TH ST | MILWAUKEE, WI 53216 |
| CURRENT OCCUPANT | 3134 N 46TH ST | MILWAUKEE, WI 53216 |
| CURRENT OCCUPANT | 3128 N 46TH ST | MILWAUKEE, WI 53216 |

| | | |
|------------------|----------------|---------------------|
| CURRENT OCCUPANT | 3074 N 46TH ST | MILWAUKEE, WI 53210 |
| CURRENT OCCUPANT | 3120 N 46TH ST | MILWAUKEE, WI 53216 |
| CURRENT OCCUPANT | 3119 N 45TH ST | MILWAUKEE, WI 53216 |

Total Records: 49

Radius: 250.0 feet and Center of Circle: 4532 W Burleigh St

SECTION 7 PLAN OF OPERATION & FLOOR PLAN

Are you filing for a Change of Location?

- Yes If Yes, you must submit a new Plan of Operation and Floor Plan.
- No If No, are you making any changes to the Plan of Operation and/or Floor Plan on record?
 - Yes If Yes, you must submit a new Plan of Operation and/or Floor Plan.
 - No If No, these documents are not needed.

SECTION 8 SIGNATURE(S)

I/we understand that I am/we are required to inform the City Clerk within 10 days of any substantial changes in any of the information supplied in this application.

I/we have knowledge of the City Ordinances currently regulating the license applied for herein, and understand that the license may be subject to suspension, non-renewal or revocation, if I/we violate any rule or regulation relating to this license.

I/we understand that I/we shall not willfully refuse to provide the services offered under this license, or add charges or require deposits not required of the general public because of race, color, sex, religion, national origin or ancestry, age, handicap, lawful source of income, marital status, sexual orientation, gender identity or expression, familial status or the fact that a person is now or has been a member of the military service, whether dressed in uniform or not; and shall not seek such information as a condition of employment, or penalize any employee or discriminate in the selection of personnel for training or promotion on the basis of such information.

I/we certify that I am/we are the applicant and all statements are true and correct.

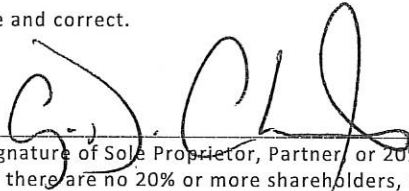

Signature of Sole Proprietor, Partner or 20% or more Shareholder
(If there are no 20% or more shareholders, Corporate Officer -
print name/title and sign)

Signature of Additional Partner(s) or 20% or more Shareholder(s)



**CITY OF MILWAUKEE
OFFICE OF THE CITY CLERK**

Monday, May 11, 2020

COMMITTEE MEETING NOTICE

AD 07

CHILDS, Cd, Agent
Bud's Goldenchilds LLC
4532 W BURLEIGH St

Milwaukee, WI 53210

You are requested to attend a virtual hearing to be held on:

Friday, May 22, 2020 at 01:30 PM

Regarding: Your Class B Tavern, Food Dealer, and Public Entertainment Premises License Applications Requesting Jukebox and 5 Amusement Machines as agent for "Bud's Goldenchilds LLC" for "Bud's Bar & Grill" at 4532 W BURLEIGH St.

This meeting will be held via GoToMeeting. Please see the enclosed best practices document for further instructions. The access code is <https://global.gotomeeting.com/join/570861413>. If you wish to call in, please call +1 (669) 224-3412 and use Access Code: 570-861-413.

There is a possibility that your application may be denied for one or more of the following reasons: The recommendation of the committee regarding the application shall be based on evidence presented at the hearing. Per MCO 85-2.7-4, probative evidence concerning whether or not a new license should be granted may be presented on the following subjects: whether or not the applicant meets the municipal requirements, the appropriateness of the location and premises where the licensed premises is to be located and whether use of the premises for the purposes or activities permitted by the license would tend to facilitate a public or private nuisance or create undesirable neighborhood problems such as disorderly patrons, unreasonably loud noise, litter, and excessive traffic and parking congestion. Probative evidence relating to these matters may be taken from the plan of operation submitted with the license application, if any, but shall not include the content of any music. Evidence regarding the fitness of the location of the premises to be maintained as the principal place of business, including but not limited to whether there is an overconcentration of businesses of the type for which the license is sought; whether the proposal is consistent with any pertinent neighborhood business or development plans, or the location's proximity to areas where children are typically present. The applicant's record in operating similarly licensed premises; and whether or not the applicant has been charged with or convicted of any felony, misdemeanor, municipal offense or other offense, the circumstances of which substantially relate to the activity to be permitted by the license being applied for or any other factor which reasonably relates to the public health, safety or welfare may also be considered. See attached police report or correspondence.

Notice for applicants with warrants or unpaid fines:

Proof of warrant satisfaction or payment of fines must be submitted at the hearing on the above date and time. Failure to comply with this requirement may result in a delay of the granting/denial of your application.

Failure to attend this meeting may result in the denial of your license. Individual applicants and partnership applicants must attend or attend by an attorney. The agent or attorney for corporate or limited liability applicants must attend. If you wish to do so and at your own expense, you may be accompanied by an attorney of your choosing to represent you at this hearing.

You will be given an opportunity to speak on behalf of the application and to respond and challenge any charges or reasons given for the denial. No petitions can be accepted by the committee, unless the people who signed the petition attend the virtual hearing and are willing to testify. You may present witnesses under oath and you may also confront and cross-examine opposing witnesses under oath. If you have difficulty with the English language, you should request an interpreter attend the meeting with you, at your expense, so that you can answer questions and participate in your hearing.

PLEASE NOTE: Upon reasonable notice, efforts will be made to accommodate the needs of disabled individuals through sign language interpreters or other auxiliary aids. For additional information or to request this service, contact the Council Services Division ADA Coordinator at (414) 286-2998, Fax - (414) 286-3456, TDD - (414) 286-2025.

JIM OWCZARSKI, CITY CLERK

BY: _____

Jessica Celella

License Division Manager

If you have questions regarding this meeting, please contact the staff assistant, Molly Kuether-Steele at (414) 286-2775 or molly.kuether-steele@milwaukee.gov.



**CITY OF MILWAUKEE
OFFICE OF THE CITY CLERK**

Monday, May 11, 2020

COMMITTEE MEETING NOTICE

AD 07

CHILDS, Cd, Agent
Bud's Goldenchilds LLC
6972 N 79TH Ct

Milwaukee, WI 53223

You are requested to attend a virtual hearing to be held on:

Friday, May 22, 2020 at 01:30 PM

Regarding: Your Class B Tavern, Food Dealer, and Public Entertainment Premises License Applications Requesting Jukebox and 5 Amusement Machines as agent for "Bud's Goldenchilds LLC" for "Bud's Bar & Grill" at 4532 W BURLEIGH St.

This meeting will be held via GoToMeeting. Please see the enclosed best practices document for further instructions. The access code is <https://global.gotomeeting.com/join/570861413>. If you wish to call in, please call +1 (669) 224-3412 and use Access Code: 570-861-413.

There is a possibility that your application may be denied for one or more of the following reasons: The recommendation of the committee regarding the application shall be based on evidence presented at the hearing. Per MCO 85-2.7-4, probative evidence concerning whether or not a new license should be granted may be presented on the following subjects: whether or not the applicant meets the municipal requirements, the appropriateness of the location and premises where the licensed premises is to be located and whether use of the premises for the purposes or activities permitted by the license would tend to facilitate a public or private nuisance or create undesirable neighborhood problems such as disorderly patrons, unreasonably loud noise, litter, and excessive traffic and parking congestion. Probative evidence relating to these matters may be taken from the plan of operation submitted with the license application, if any, but shall not include the content of any music. Evidence regarding the fitness of the location of the premises to be maintained as the principal place of business, including but not limited to whether there is an overconcentration of businesses of the type for which the license is sought; whether the proposal is consistent with any pertinent neighborhood business or development plans, or the location's proximity to areas where children are typically present. The applicant's record in operating similarly licensed premises; and whether or not the applicant has been charged with or convicted of any felony, misdemeanor, municipal offense or other offense, the circumstances of which substantially relate to the activity to be permitted by the license being applied for or any other factor which reasonably relates to the public health, safety or welfare may also be considered. See attached police report or correspondence.

| | |
|---|--|
| Notice for applicants with warrants or unpaid fines: | Proof of warrant satisfaction or payment of fines must be submitted at the hearing on the above date and time. Failure to comply with this requirement may result in a delay of the granting/denial of your application. |
|---|--|

Failure to attend this meeting may result in the denial of your license. Individual applicants and partnership applicants must attend or attend by an attorney. The agent or attorney for corporate or limited liability applicants must attend. If you wish to do so and at your own expense, you may be accompanied by an attorney of your choosing to represent you at this hearing.

You will be given an opportunity to speak on behalf of the application and to respond and challenge any charges or reasons given for the denial. No petitions can be accepted by the committee, unless the people who signed the petition attend the virtual hearing and are willing to testify. You may present witnesses under oath and you may also confront and cross-examine opposing witnesses under oath. If you have difficulty with the English language, you should request an interpreter attend the meeting with you, at your expense, so that you can answer questions and participate in your hearing.

PLEASE NOTE: Upon reasonable notice, efforts will be made to accommodate the needs of disabled individuals through sign language interpreters or other auxiliary aids. For additional information or to request this service, contact the Council Services Division ADA Coordinator at (414) 286-2998, Fax - (414) 286-3456, TDD - (414) 286-2025.

JIM OWCZARSKI, CITY CLERK

BY: _____
Jessica Celella

License Division Manager

If you have questions regarding this meeting, please contact the staff assistant, Molly Kuether-Steele at (414) 286-2775 or molly.kuether-steele@milwaukee.gov.

200 E. Wells Street, Room 105, City Hall, Milwaukee, WI 53202. www.milwaukee.gov/license
Phone: (414) 286-2238 Fax: (414) 286-3057 Email Address: License@milwaukee.gov

REDACTED RECORD

Martin, Faviola

From: License
Sent: Monday, March 16, 2020 8:58 AM
To: Martin, Faviola
Subject: FW: License Application : CD Childs, Agt Buds Goldenchilds

Follow Up Flag: Follow up
Flag Status: Flagged

Keren Becker
License Specialist III
City Clerk – License Division
O: (414) 286-2238
License@Milwaukee.gov
www.Milwaukee.gov/license



From:
Sent: Monday, March 16, 2020 8:51 AM
To: License
Subject: License Application : CD Childs, Agt Buds Goldenchilds

I am opposed to the issuing of a Class B Tavern license at 4532 W. Burleigh. Existing tavern at the same address already has a negative impact on the neighborhood. Overcrowded street parking limiting spots for residents. Increased litter in street and on yards. Police report of violence.

MILWAUKEE POLICE DEPARTMENT
LICENSE INVESTIGATION UNIT

CRIMINAL RECORD/ORDINANCE VIOLATION/INCIDENTS
SYNOPSIS

DATE: 05/09/2019

LICENSE TYPE: CLASS B TAVERN

NEW:

RENEWAL: X

No. 293307

Application Date: 05/08/2019

Expiration Date:

License Location: 4532 W Burleigh Street

Aldermanic District:07

Business Name: Waz's Pub

Licensee/Applicant: Wasmund, Shelly R

(Last Name, First Name, MI)

Date of Birth: 06/05/63

Male:

Female:

Home Address: 16630 North Glenbrook Dr W213

City: Jackson

State: Wi

Zip Code: 53037

Home Phone: (414) 677-9414

This report is written by Police Officer David NOVAK, assigned to the License Investigation Unit, Days.

The Milwaukee Police Department's investigation regarding this application revealed the following:

1. On 10/04/06 at 11:05 pm, Milwaukee Police were dispatched to 4425 W Burleigh for a Battery complaint. Investigation revealed an intoxicated patron entered the tavern and was asked to leave due to troubles with her in the past. The patron became disorderly and was being escorted out by the bouncer and the bartender. The patron attempted to hit the bartender and while being escorted out, the patron received a minor scratch to the face.

- =====
2. On 01/24/09 at 9:27 pm, Milwaukee police conducted a License Premise check at 4532 W Burleigh. Officers asked to view the taverns license and the bartender, Yolanda Taylor, had to pull the licenses out from behind a clipboard. Taylor was advised that the licenses for the tavern must be displayed and are to be viewed by patrons in the tavern. No other violations were found.

- =====
3. On 07/08/09 at 2:33 am, while on patrol, Milwaukee police observed a subject down at the corner of 46th and Burleigh. The subject was lying face down and bleeding from the head. Investigation revealed the subject had been drinking at Waz's bar and when he left, was jumped and robbed by two males who were also patrons at the bar. The victim stated the doorman offered to walk him home but the victim refused. The victim was treated at a nearby hospital for his injuries.

Wasmund, Shelly R

- 4. On 09/04/09 at 12:15 am, Milwaukee police conducted a License Premise Check at 4532 W Burleigh. Officers found the licenses were not properly displayed and spoke with the bartender Yolanda Taylor regarding. Taylor attempted to contact the owner David Wasmund but was unable to. A citation was issued for Display of License to David Wasmund.

Charge: Display Of Liquor License Required
 Finding: Guilty
 Sentence: Fined \$356.00
 Date: 12/03/09
 Case: 09129123

=====

- 5. On 11/06/10 at 9:17 pm, Milwaukee police were conducting sales of alcohol to minors and had a police aide who was under the age of 21, enter 4532 W Burleigh in attempts to purchase alcohol. The bartender identified as Yolanda Taylor, sold the aide a Smirnoff ice without asking for any ID. Taylor admitted to selling the alcohol and stated it was busy and she knew she should have. Taylor was issued a citation.

As to Taylor:

Charge: Sale of Alcohol To Underage Person
 Finding: Guilty
 Sentence: Fined \$171.00
 Date: 12/30/10
 Case: 10135696

- 6. On 11/19/10 at 9:59 pm, Milwaukee police conducted a License Premise Check at 4532 W Burleigh. Police found a clear plastic bag, which contained a large chunk of suspected Cocaine base from the kitchen area. The substance tested positive for Cocaine. Also found in the kitchen was marijuana which an employee Robert Sterling admitted was his. Sterling as well as another subject who was in the kitchen of where the cocaine was found was arrested.

- 7. On 03/22/10, David T Wasmund received a citation for Building Code Violations.

Charge: Building Code Violations
 Finding: Guilty
 Sentence: Fined \$150.00
 Date: 01/30/11
 Case: 10068972

=====

8. On 09/15/2013 Milwaukee police responded to a battery complaint at 4532 West Burleigh Street (Waz's Pub). Investigation revealed two patrons of the bar became involved in an altercation creating a disturbance. Both patrons were cited.

=====

9. On 07/28/2015 Milwaukee police were dispatched to a battery-dv complaint at North 46th Street and West Burleigh Street. The caller, Angel Patterson, stated she had been at Waz's (4532 West Burleigh Street) when her sister came into the business and started an altercation with her. The suspect pulled the caller's hair. The bartender, Janita Reed, broke up the fight and told both patrons to leave.

=====

10. On 11/17/2019 at 12:05am officers were dispatched to a shooting at N. 46th and W. Burleigh St. The investigation revealed the shooting occurred inside Waz's Pub, 4532 W. Burleigh St. The victim and suspect were patrons of the bar when an argument occurred. The suspect produced a handgun and shot the victim causing his death. There were cameras operating and recording during the incident.

Item #10 added as part of PREVIOUS PREMISE

Date: 3/23/2020

Officer: Lawson Murrell

City of Milwaukee Police Department

90-5-1.5 Crime Prevention Survey

Tavern Inspection

Name of Premise: Bud's Bar and Grill

Address: 4532 W Burleigh

Phone: 414-899-0738

Owner: CD Childs

Owner address: 6972 N 79th Ct

City State Zip: Milwaukee, WI 53223

Owner Phone: 414-206-0013

Owner email: dr.cdchilds@att.net

Licensee/Agent: CD Childs

Home Address: 6972 N 79th Ct

City State Zip: Milwaukee, WI 53223

Phone: 414-206-0013

Email: dr.childs@att.net

Preferred contact: 414-899-0738

Location currently open: YES NO

Projected open date: [Click here to enter a date.](#)

Day's open: S M T W Th F SA ALL

Hours of Operation: Sun: 11A-10P 24 hours Y N

Mon: 7A-10P

Tue: 7A-10P

Wed: 7A-10P

Thu: 7A-10P

Fri: 7A-10P

Sat: 7A-10P

Premise Type: Tavern/Bar
 Restaurant
 Other: [Click here to enter text.](#)

Licenses currently held:

Alcohol: Yes No Class:B #: BTAVN 307852

Tobacco: Yes No #: [Click here to enter text.](#)

Food: Yes No #: FREST 307853

Extended Hours: Yes No #: [Click here to enter text.](#)

Secondhand Dealer: Yes No Type: [Click here to enter text.](#) #: [Click here to enter text.](#)

Other: Yes No Type:Public Entertainment #: PEP 307854

Other: Yes No Type:Click here to enter text. #: Click here to enter text.

Exterior Survey:

1. Is the area around the location clean? Yes No
2. What surrounds the location? (Check all the apply)
 - a. Park
 - b. School
 - c. Youth Center
 - d. Church
 - e. Tavern(s) If so, how many Click here to enter text.
 - f. Residential
 - g. Other businesses
 - h. Other: Click here to enter text.
3. Can you see from the outside of the location into the interior Yes No
4. Can you see the employees inside of the location from the outside Yes No
5. Are exterior windows free of signage Yes No
6. Is there a parking lot Yes No
7. Is the parking lot clean? Yes No
8. Off-Street parking Yes No
9. Is the parking lot well lit? Yes No
10. Valet Parking Yes No
 - a. Will this lot have a guard? Yes No
 - b. Will this lot have cameras? Yes No

11. Are there areas where a person could conceal themselves Yes No
12. Is there exterior lighting? Yes No. Does it appears to be adequate Yes No
13. Exterior Payphone? Yes No
14. Are there No Loitering Signs posted? Yes No
15. Are there exterior security cameras Yes No How Many: 8
16. Are the address numbers prominently displayed and easy to see Yes No

Camera Survey:

17. Does this location have security cameras? Yes No
18. Are they in working order? Yes No
19. What format are the cameras?
- a. Color Yes No
 - b. Digital Yes No
 - c. Recorded Yes No
20. How long is footage stored for later viewing: 7 days
21. Are there exterior cameras Yes No How many: 8
22. Are there interior cameras Yes No How many: 16
23. Do all employees know how to retrieve recorded digital images/footage? Yes No
24. Cameras located in parking lot Yes No How many Click here to enter text.

Interior Survey:

25. What is the planned capacity 65

26. What is the minimum number of employees that will be on premise 3

27. Is the storeowner willing to be a standing complainant regarding loitering? Yes No

a. If yes have them fill out the standing complaint form and give them two of the commercial signs Yes No

28. Is the interior of the location neat and clean? Yes No

29. Does an interior camera face the entrance/exit? Yes No

30. Is there a lockable area that separates employees from customers? Yes No

31. Are emergency and non-emergency numbers posted near the phone? Yes No

32. Does the owner know how to contact their police district directly? Yes No

a. Did you provide a district contact guide to the owner? Yes No

Security

33. How many security personnel are going to be employed: No security
34. How ill they be deployed: Interior Click here to enter text. Exterior Click here to enter text.
35. What days will they be deployed Mon Tue Wed Thu Fri Sat Sun
36. Will the security be managed by business or contracted
37. Will they be armed Yes No
38. What type of security measures to be used:
- Wanding/metal detector Click here to enter text.
 - ID Scanner Click here to enter text.
 - Dress Code Click here to enter text.
 - Cover Charge Click here to enter text.
 - Age restriction 21+
 - Other Click here to enter text.

ADDITIONAL COMMENTS/RECOMMENDATIONS:

Owner stated the establishment will be more of a restaurant.

4532 W Burleigh Street

Area : 21,862,585.68 ft²

Mar 11 2020 14:42:04 Central Daylight Time



- Alcohol Licenses
- Class A Fermented Malt Beverage
 - Class A Liquor and Malt
 - Class B Tavern

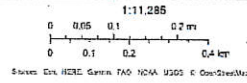

Summary

| Name | Count | Area(ft ²) | Length(mi) |
|------------------|-------|------------------------|------------|
| Alcohol Licenses | 3 | | |

Alcohol Licenses

| # | Legal Entity | Trade Name | Licensee | Address | License Type Name | Total Capacity | Expiration Date | Count |
|---|----------------------------|----------------------------|------------------------|--------------------|---------------------------------------|----------------|--------------------|-------|
| 1 | WAZ'S PUB, INC | WAZ'S PUB | SHELLY R WASMUND, Agt | 4532 W BURLEIGH ST | Class B Tavern License | 65 | 7/26/2020, 7:00 PM | 1 |
| 2 | SRJEWELL ENTERTAINMENT LLC | 42nd Street Bar & Grill | SHERLISE A JEWELL, Agt | 4200 W BURLEIGH ST | Class B Tavern License | 80 | 9/14/2020, 7:00 PM | 1 |
| 3 | Clark's Beer & Liquor INC. | Clark's Beer & Liquor Mart | Prakash Navadia, Agt | 4728 W BURLEIGH ST | Class A Malt & Class A Liquor License | | 3/16/2021, 7:00 PM | 1 |

Establishments within a 0.5 miles radius centered on area of interest.



Monday, May 11, 2020

Licenses Committee Notice of Hearing

DAVID WASMUND
4532 W Burleigh St
Milwaukee, WI 55210

The Licenses Committee will consider the following license application:

Class B Tavern, Food Dealer, and Public Entertainment Premises License
Applications Requesting Jukebox and 5 Amusement Machines
CHILDS, Cd, Agent
Bud's Bar & Grill at 4532 W BURLEIGH St

Date: 5/22/2020

Time: 01:30 PM

Location: The hearing before the Licenses Committee will take place virtually on Friday, May 22, 2020. This is a public hearing. Those wishing to view the proceeding are able to do so via the City Channel – Channel 25 on Spectrum Cable – or on the Internet at <http://city.milwaukee.gov/citychannel>. Those wishing to provide oral testimony will be asked to do so by phone or internet and are asked to contact the staff assistant, Molly Kuether-Steele at (414) 286-2775 or molly.kuether-steele@milwaukee.gov for necessary information. Please make such requests no later than one business day prior to the start of the meeting. You are not required to attend the hearing, but please see the information below if you would like to provide testimony.

Please note this application may be recommended for denial based on fitness of the location due to concentration of alcohol beverage outlets in the area. If the application is denied for this reason, no other application for an alcohol beverage license for this location shall be recommended for approval by the Licenses Committee within three years of the date of denial unless the applicant has demonstrated a change of circumstances since the prior denial.





Monday, May 11, 2020

Licenses Committee Notice of Hearing

CD Childs
6972 N 79th Ct
Milwaukee, WI 55223

The Licenses Committee will consider the following license application:

Class B Tavern, Food Dealer, and Public Entertainment Premises License
Applications Requesting Jukebox and 5 Amusement Machines
CHILDS, Cd, Agent
Bud's Bar & Grill at 4532 W BURLEIGH St

Date: 5/22/2020

Time: 01:30 PM

Location: The hearing before the Licenses Committee will take place virtually on Friday, May 22, 2020. This is a public hearing. Those wishing to view the proceeding are able to do so via the City Channel – Channel 25 on Spectrum Cable – or on the Internet at <http://city.milwaukee.gov/citychannel>. Those wishing to provide oral testimony will be asked to do so by phone or internet and are asked to contact the staff assistant, Molly Kuether-Steele at (414) 286-2775 or molly.kuether-steele@milwaukee.gov for necessary information. Please make such requests no later than one business day prior to the start of the meeting. You are not required to attend the hearing, but please see the information below if you would like to provide testimony.

Please note this application may be recommended for denial based on fitness of the location due to concentration of alcohol beverage outlets in the area. If the application is denied for this reason, no other application for an alcohol beverage license for this location shall be recommended for approval by the Licenses Committee within three years of the date of denial unless the applicant has demonstrated a change of circumstances since the prior denial.





Monday, May 11, 2020



Notice of Public Hearing

blank
notice

CHILDS, Cd, Agent
Bud's Bar & Grill at 4532 W BURLEIGH St
Class B Tavern, Food Dealer, and Public Entertainment Premises License Applications
Requesting Jukebox and 5 Amusement Machines

Friday, May 22, 2020 at 1:30 PM

To whom it may concern:

The above application has been made by the above named applicant(s). This requires approval from the Licenses Committee and the Common Council of the City of Milwaukee. The hearing before the Licenses Committee will take place virtually on 5/22/2020 at 1:30 PM. This is a public hearing. Those wishing to view the proceeding are able to do so via the City Channel – Channel 25 on Spectrum Cable – or on the Internet at <http://city.milwaukee.gov/citychannel>. Those wishing to provide oral testimony will be asked to do so by phone or internet and are asked to contact the staff assistant, Molly Kuether-Steele at (414) 286-2775 or molly.kuether-steele@milwaukee.gov for necessary information. Please make such requests no later than one business day prior to the start of the meeting. You are not required to attend the hearing, but please see the information below if you would like to provide testimony. Once the Licenses Committee makes its recommendation, this recommendation is forwarded to the full Common Council for approval at its next regularly scheduled hearing.

Important details for those wishing to provide information for the Licenses Committee to consider when making its recommendation:

1. The license application is scheduled to be heard at the above time. Due to other hearings running longer than scheduled, you may have to wait some time to provide your testimony.
2. You must testify as to matters that you have personally experienced or seen. (You cannot provide testimony for your neighbor, parent or anyone else; this is considered hearsay and cannot be considered by the committee.)
3. No letters or petitions can be accepted by the committee (unless the person who wrote the letter or the persons who signed the petition are willing to testify).
4. Persons opposed to the license application are given the opportunity to testify first; supporters may testify after the opponents have finished.
5. When you are called to testify, you will be sworn in and asked to give your name, and address. (If your first and/or last names are uncommon please spell them.)
6. You may then provide testimony.
 - a. Include only information relating to the above license application.
 - b. Include only information you have personally witnessed or seen.
 - c. Provide concise and relevant information detailing how this business has affected or may affect the peaceful enjoyment of your neighborhood.
 - d. If by the time you have the opportunity to testify, the information you wish to share has already been provided to the committee, you may state that you agree with the previous testimony. Redundant or repetitive testimony will not assist the committee in making its recommendation.
7. After giving your testimony, the members of the Licenses Committee and the licensee may ask questions regarding the testimony you have given or other factors relating to the license application.
8. Business Competition is not a valid basis for denial or non-renewal of a license.

Please Note: If you have submitted an objection to the above application your objection cannot be considered by the committee unless you personally testify at the hearing.

| OCCUPANT | MAIL ADDRESS | CITY, STATE ZIP |
|------------------|----------------------|---------------------|
| CURRENT OCCUPANT | 3145 N 45TH ST | MILWAUKEE, WI 53216 |
| CURRENT OCCUPANT | 3143 N 45TH ST | MILWAUKEE, WI 53216 |
| CURRENT OCCUPANT | 3125 N 45TH ST | MILWAUKEE, WI 53216 |
| CURRENT OCCUPANT | 3057 N 46TH ST | MILWAUKEE, WI 53210 |
| CURRENT OCCUPANT | 3131 N 46TH ST | MILWAUKEE, WI 53216 |
| CURRENT OCCUPANT | 3152 N 46TH ST | MILWAUKEE, WI 53216 |
| CURRENT OCCUPANT | 3124 N 46TH ST | MILWAUKEE, WI 53216 |
| CURRENT OCCUPANT | 4522 W BURLEIGH ST 2 | MILWAUKEE, WI 53210 |
| CURRENT OCCUPANT | 4522 W BURLEIGH ST 6 | MILWAUKEE, WI 53210 |
| CURRENT OCCUPANT | 3131 N 45TH ST | MILWAUKEE, WI 53216 |
| CURRENT OCCUPANT | 4621A W CARTER PL | MILWAUKEE, WI 53216 |
| CURRENT OCCUPANT | 3127A N 46TH ST | MILWAUKEE, WI 53216 |
| CURRENT OCCUPANT | 3133 N 46TH ST | MILWAUKEE, WI 53216 |
| CURRENT OCCUPANT | 3146 N 46TH ST | MILWAUKEE, WI 53216 |
| CURRENT OCCUPANT | 3064 N 46TH ST | MILWAUKEE, WI 53210 |
| CURRENT OCCUPANT | 3102 N 46TH ST | MILWAUKEE, WI 53216 |
| CURRENT OCCUPANT | 3052 N 46TH ST | MILWAUKEE, WI 53210 |
| CURRENT OCCUPANT | 4621 W CARTER PL | MILWAUKEE, WI 53216 |
| CURRENT OCCUPANT | 3145 N 46TH ST | MILWAUKEE, WI 53216 |
| CURRENT OCCUPANT | 4505 W BURLEIGH ST | MILWAUKEE, WI 53210 |
| CURRENT OCCUPANT | 3102 N 46TH ST A | MILWAUKEE, WI 53216 |
| CURRENT OCCUPANT | 3141 N 45TH ST | MILWAUKEE, WI 53216 |
| CURRENT OCCUPANT | 3059 N 45TH ST | MILWAUKEE, WI 53210 |
| CURRENT OCCUPANT | 3130 N 46TH ST | MILWAUKEE, WI 53216 |
| CURRENT OCCUPANT | 3069 N 45TH ST | MILWAUKEE, WI 53210 |
| CURRENT OCCUPANT | 3135 N 45TH ST | MILWAUKEE, WI 53216 |
| CURRENT OCCUPANT | 3058 N 46TH ST | MILWAUKEE, WI 53210 |
| CURRENT OCCUPANT | 3151 N 46TH ST | MILWAUKEE, WI 53216 |
| CURRENT OCCUPANT | 3147 N 46TH ST | MILWAUKEE, WI 53216 |
| CURRENT OCCUPANT | 3126 N 46TH ST | MILWAUKEE, WI 53216 |
| CURRENT OCCUPANT | 4522 W BURLEIGH ST 1 | MILWAUKEE, WI 53210 |
| CURRENT OCCUPANT | 4522 W BURLEIGH ST 3 | MILWAUKEE, WI 53210 |
| CURRENT OCCUPANT | 3121 N 46TH ST | MILWAUKEE, WI 53216 |
| CURRENT OCCUPANT | 3147 N 45TH ST | MILWAUKEE, WI 53216 |
| CURRENT OCCUPANT | 3057 N 45TH ST | MILWAUKEE, WI 53210 |
| CURRENT OCCUPANT | 3151A N 46TH ST | MILWAUKEE, WI 53216 |
| CURRENT OCCUPANT | 3127 N 46TH ST | MILWAUKEE, WI 53216 |
| CURRENT OCCUPANT | 3140 N 46TH ST | MILWAUKEE, WI 53216 |
| CURRENT OCCUPANT | 3071 N 45TH ST | MILWAUKEE, WI 53210 |
| CURRENT OCCUPANT | 3075 N 45TH ST | MILWAUKEE, WI 53210 |
| CURRENT OCCUPANT | 4627 W CARTER PL | MILWAUKEE, WI 53216 |
| CURRENT OCCUPANT | 4627A W CARTER PL | MILWAUKEE, WI 53216 |
| CURRENT OCCUPANT | 3150 N 46TH ST | MILWAUKEE, WI 53216 |
| CURRENT OCCUPANT | 3146A N 46TH ST | MILWAUKEE, WI 53216 |
| CURRENT OCCUPANT | 3134 N 46TH ST | MILWAUKEE, WI 53216 |
| CURRENT OCCUPANT | 3128 N 46TH ST | MILWAUKEE, WI 53216 |

| | | |
|------------------|----------------|---------------------|
| CURRENT OCCUPANT | 3074 N 46TH ST | MILWAUKEE, WI 53210 |
| CURRENT OCCUPANT | 3120 N 46TH ST | MILWAUKEE, WI 53216 |
| CURRENT OCCUPANT | 3119 N 45TH ST | MILWAUKEE, WI 53216 |

Total Records: 49

Radius: 250.0 feet and Center of Circle: 4532 W Burleigh St



BUSINESS LICENSE PLAN OF OPERATION

ccl-busplan 3/15/18

Office of the City Clerk License Division
200 E. Wells St. Room 105, Milwaukee, WI 53202
(414) 286-2238 www.milwaukee.gov/license e-mail address: license@milwaukee.gov

1. Type of Business

Applying for: Extended Hours (12AM to 5AM) - If a food establishment, check all that apply: Delivery Drive Thru Dining Room
 Self Service Laundry Massage Establishment Filling Station
 Other (supplemental application for specific license also required)

Provide a detailed description of the type of business you plan on operating:

Food Take out & Eat in BAR area & Reg Dining Area

Do you have any experience operating this type of business? No Yes If yes, explain: *Years of Running ^{BAR TENDING} ^{REGULAR} RESTAURANT RESPONSIBLE Lic*

2. Business Operations

- a. Proposed Opening Date: *MAY 1st 2020*
- b. Is this premise under construction? No Yes If yes, list estimated completion date: _____
- c. Is this a franchise? No Yes
- d. Is this premises currently licensed? No Yes If yes, list type of license: *CLASS B TAVORN & Food Service Lic*
- e. Is the current licensee operating? No Yes If no, list date closed: _____
- f. Do you have future plans for other businesses, licenses or permits at this location? No Yes
If yes, explain: _____
- g. Have you previously held an Extended Hours License in Milwaukee? No Yes
If yes, list address(es): _____
- h. Are other businesses operating in the same building? No Yes If yes, describe: _____

3. Litter & Noise

- a. How are grounds kept clean? Sweep Pressure Wash Pick Up Litter Other: _____
- b. How often will grounds be cleaned? Daily Weekly As Needed Monthly Other: _____
- c. Grounds cleaned by: Licensee Building Owner Employees Hired Maintenance Other: _____
- d. How are noise issues prevented and/or addressed? Security Manager approaches customer(s) Call Police
 Signs Posted Other: _____
- e. Will a sound amplification system be used? No Yes If yes, describe: *NORMAL SPEAKERS*

4. Smoking & Sanitation

- a. Are there designated outdoor smoking areas? No Yes If yes, describe: *REG PATIO*
- b. Number of Garbage Cans: Inside: *6* Locations: *Behind BAR, BACKROOMS, KITCHEN, REG DINING*
Outside: *5* Locations: *REG PATIO, FRONT of BUILDING, GARAGE AREA*
- c. Is a crowd control barrier used? No Yes If yes, describe: _____
- d. How many restrooms are on the premises? *2*
- e. Name of solid waste contractor: Advanced Disposal Waste Management Other: _____

5. Security

- a. Are there onsite parking spaces? No Yes If yes, how many? _____ and describe the parking security plan: _____
- b. Is there a loading zone? No Yes If yes, describe the loading area security plan: _____
- c. Will you have security personnel on premise? No Yes If yes, how many? _____ and answer the following:
 What are their responsibilities? _____
 Is security equipment used? No Yes If yes, describe _____
 List their licensing, certification, or training credentials _____
- d. Will there be security cameras? No Yes If yes, how many? 10 and list locations: BAR AREA, Dining
outside on W. Buehler St., N. 46th St., Rear Patio
- e. Will searches/identification checks be done upon entry? No Yes If yes, describe UNUSUAL PATRONS

6. Percentage of Sales (must total 100%)

| | | | |
|--------------------------------|---|--|-------------------------------------|
| Alcohol <u>35</u> % | Food <u>60</u> % | Secondhand Merchandise <u>0</u> % | Precious Metals & Gems <u>0</u> % |
| Entertainment <u>5</u> % | Cigarettes <u>0</u> % | Personal Services (such as tattoo, body piercing, salon, tailor, tanning, etc.) <u>0</u> % | Other <u>0</u> % Describe: _____ |
| Pawnbroker Activity <u>0</u> % | Salvaged Materials (such as scrap metal) <u>0</u> % | | |

7. Businesses/Licenses on the Premises (check all that apply):

Type 1

- Full Service Restaurant Cafe/Coffee Shop Deli or Fast Food Restaurant Private/Fraternal/Veterans Club
- Night Club Tavern Cocktail Lounge Teen Club
- Banquet Hall Sports Facility Bowling Alley
- Hotel/Motel: Number of Floors: 0 Number of Rooms: _____
 Rooming House: Number of Floors: 0 Number of Rooms: _____

Type 2

- Liquor Store Corner Store Supermarket Convenience Store
- Gas Station Amusement/Phonograph Distributor Recycling, Salvage or Towing
- Used Car Dealer Personal Service Establishment (such as tattoo business, hair salon, tailor, etc.) Recording Studio

What other licenses/permits will you hold at this location? (check all that apply)

- Occupancy Permit Cigarette & Tobacco Gas Station Extended Hours Class "B" Tavern Weights & Measures
- Secondhand Dealer Precious Metal & Gem Other: _____

8. Legal Capacity (only if a Type 1 premises in #7 above)

Capacity _____ (Call the Milwaukee Development Center at 414-286-8211 if you have questions.)

9. Premises Description

- a. Identify all area(s) of the premises that will be used in operating this business (include areas used only for storage):
 1st Floor 2nd Floor Basement Storage Patio Beer Garden Sidewalk Café Deck Rooftop
 Other: Describe: _____
- b. Describe Location: Major Thoroughfare Secondary Street Other: _____
- c. Nearest Major Cross Street: W. Bartles St N. 46th St.
- d. Describe Building: Free Standing Building Strip Mall Other: _____
- e. Describe Premises Structure: Single Story Multi-Story - # of Stories 2 Other: _____
- f. Describe Surrounding Area: Commercial Residential Industrial Other: _____
- g. Building Owner Name: City Childs Phone Number: 414-899-0738
 Business Owner Address: 6972 N. 79th St

10. Hours of Operation & Customers

Will customers be entering the premises? No Yes

| Day of the Week | Proposed Hours of Operation: | | Estimated Number of Customers expected each day | Potential Age Range of Customers | Class B Tavern Applicant Only: Age Restriction (If none, write 'None') |
|-----------------|----------------------------------|-----------------------------------|---|----------------------------------|--|
| | Open Time (include a.m. or p.m.) | Close Time (include a.m. or p.m.) | | | |
| Sunday | 7A | 10A | 100 | 18-20 | 18-20 / Food |
| Monday | " | " | | | " |
| Tuesday | " | " | | | " |
| Wednesday | " | " | | | " |
| Thursday | " | " | | | " |
| Friday | " | " | | | " |
| Saturday | " | " | | | " |

An Extended Hours Establishment License is required for any convenience store, filling station, personal service establishment (such as tattoo, body piercing, salon, tailor, tanning, etc.), recording studio or restaurant which is open between the hours of 12:00 a.m. and 5:00 a.m.

Alcohol Establishments Class A: 8:00 am to 9:00 pm Sunday thru Saturday
 Permitted Hours of Operation: Class B: 6:00 am to 2:00 am Sunday thru Thursday, 6:00 am to 2:30 am Friday & Saturday

Entertainment Outdoor Closing Hours: 10:00pm Sunday-Thursday; 12:00am Friday & Saturday; unless a different time, either earlier or later, is established by the Common Council in its approval of the licensee's plan of operation.

11. Signature(s)

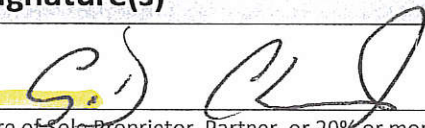
 Signature of Sole Proprietor, Partner, or 20% or more Shareholder
 (If there are no 20% or more shareholders,
 Corporate Officer-print name/title and sign)

 Signature of additional partner or 20% or more shareholder

See Application Information for a complete list of all required application forms.



ALCOHOL BEVERAGE & PUBLIC ENTERTAINMENT PREMISES SUPPLEMENTAL APPLICATION

Office of the City Clerk License Division
200 E. Wells St. Room 105, Milwaukee, WI 53202
(414) 286-2238 e-mail address: license@milwaukee.gov www.milwaukee.gov/license

| |
|--|
| Legal Entity Name: <u>BUD'S BAR & GRILL</u> |
| Premise Address: <u>4532 W. BURLICK ST.</u> |
| Proximity of Premises to Church, School, Daycare Center or Hospital |
| Is the building within 300 feet of any church, school, daycare center or hospital? <input checked="" type="checkbox"/> No <input type="checkbox"/> Yes |
| "Service Bar Only" Designation |
| If applying for Class B or C license, are you applying for "Service Bar Only"? <input checked="" type="checkbox"/> No <input type="checkbox"/> Yes Service Bar Only means customers cannot sit at the bar. Alcohol is served to employees who serve patrons seated at tables. No stools, chairs or other articles of furniture shall be placed at the service bar for patrons to sit upon. |
| Business Information |
| a) Are you taking out this application for anyone that may not be eligible for a license? <input checked="" type="checkbox"/> No <input type="checkbox"/> Yes If yes, list their name and address: _____ |
| b) Will the agent, a partner or the individual licensee be conducting the day-to-day operations of the business? <input type="checkbox"/> No <input checked="" type="checkbox"/> Yes If no, list the name and address of the person(s) who will: _____ Class B Applicants: If the agent, a partner or the individual licensee will not be conducting the day-to-day operations of the business, the person(s) listed above must obtain a Class B Managers license. |
| c) Does anyone else have money invested or any other interest in this business? <input checked="" type="checkbox"/> No <input type="checkbox"/> Yes If yes, explain: _____ |
| d) Have you made an agreement with anyone to repay any loan or any other payments based upon income from the business? <input checked="" type="checkbox"/> No <input type="checkbox"/> Yes If yes, list name and address: _____ |
| Proof of Ownership, Lease, or Offer to Purchase (New & Transfer Applicants Only) |
| Submit proof of ownership, lease, or offer to purchase the building with this application. A lease or offer to purchase must: a) Be in the same legal entity name as that apply for the license b) Reflect the same address as the premises address on this application c) Reflect current dates and d) Be signed by the lessor/seller and lessee/buyer |
| Property Information (New & Transfer Applicants Only) |
| a) Do you own or lease the building? <input checked="" type="checkbox"/> Own <input type="checkbox"/> Lease |
| b) Who owns the fixtures (for example, coolers, etc.)? <u>C.J. CHILDS</u> |
| c) Are you purchasing the stock and/or fixtures? <input checked="" type="checkbox"/> No <input type="checkbox"/> Yes If yes, amount paid \$ _____ |
| d) Total amount paid for business \$ <u>100,000</u> |
| e) Total amount paid for goodwill of the business \$ <u>25,000</u> |
| Goodwill comprises the reputation and customer relationships of an existing business. If the price you pay for the business exceeds the fair market value of all of the rest of the assets of the business, the excess may be considered goodwill. |
| f) Have you made arrangements with the seller for payment of personal property taxes? <input type="checkbox"/> No <input checked="" type="checkbox"/> Yes |

See Application Information for a list of all required application forms.

Lease Information (New & Transfer Applicants who are leasing the premises only)

- a) Date lease begins May 1st 2020 Ends May 1st 2030
- b) Monthly rental \$ 1000.00
- c) Do you have an option to renew the lease? No Yes
- d) Does your lease allow for assignment to another party without the consent of the owner? No Yes
- e) For what length of time have you been guaranteed occupancy (number of years)? ?
- f) In addition to paying the monthly rental, will you have to pay anything additional to the owner of the building to guarantee performance of the lease? No Yes If yes, explain _____
- g) Does the present owner or occupancy object to the granting of your license? No Yes
If yes, explain _____

Change of Agent Applicants Only

Have there been any changes to the floor plan since the last application was submitted? No Yes

If no, a new floor plan is not required. If yes, submit a new floor plan and explain the change(s): _____

Signature

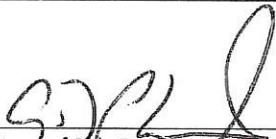

Signature of Sole Proprietor, Partner or 20% or More Shareholder
(If no 20% or more Shareholder, Corporate Officer - print name/title and sign)

Note: All information contained in this application is subject to approval by the Common Council.
Deviating from approved plan of operation will subject licensee to citations, and/or suspension or non-renewal of the license.
Contact the License Division for information on how to request changes.

New and transfer of premises applicants must submit the following:

- Proof of ownership, lease or offer to purchase the building
- Detailed floor plan
- If a restaurant, copy of the menu



FOOD DEALER LICENSE PLAN OF OPERATION

OFFICE OF THE CITY CLERK, LICENSE DIVISION
 CITY HALL, 200 E. WELLS ST, ROOM 105, MILWAUKEE, WI 53202
 (414) 286-2238 • license@milwaukee.gov • www.milwaukee.gov/license

Legal Entity Name: Bud's Golden Childs LLC

Premises Address: 4532 W. Bueliegl St.

SECTION 1 TYPE OF BUSINESS

What will be the majority of your food sales? (check one)

Restaurant Items (meals):
 MEALS include, but are not limited to, chicken, ribs, sandwiches, roasted corn, baked potatoes, hot dogs, brats, tacos, nachos w/ cheese and meat, French fries, cooked or deep fried vegetables/fruit, cooked cheese curds, corn dogs, egg rolls, salads.

Retail Items (snacks and beverages):
 RETAIL items include, but are not limited to, ice cream/soft serve, lemonade, snow cones, coffee, espresso, cappuccino, tea, fruit juice, smoothies, candy, dispensed soda, fruit cups, bakery, cookies, kettle corn, cotton candy, funnel cakes, fritters, tortilla chips w/ cheese.

Will it be a convenience store? Yes No

A convenience store contains less than 5,000 square feet of retail space and has, as its primary business, the sale of basic food items and in addition, sells household products or is a filling station that sells basic food items and household products.

Bed & Breakfast

Micro Market

All Applicants: Submit a menu or a list of food items that will be sold.

Will any wholesale business be done? No Yes If yes, what percentage of food sales will be wholesale?

Less than 25%

25% or More AND:

Restaurant items (meals) will be sold – Complete this application and also contact DATCP.

NO restaurant items (meals) will be sold - Do NOT complete this application. Contact DATCP only.

SECTION 2 FOOD PROCESSING

Will any food processing be done? No Yes

Processing is defined as assembling, grinding, cutting, mixing, baking, coating, stuffing, packing, bottling, grilling, canning, extracting, fermenting, distilling, pickling, freezing, drying, smoking, or packaging.

SECTION 3 FOOD REQUIRING TEMPERATURE CONTROL

Will any food that requires temperature control be sold? No Yes
 (includes dairy products such as milk, cheese, and ice cream, fish, shellfish, meat, poultry)

If yes, list the types of food items: Leggon Meat, Cheese milk, Poultry etc.

SECTION 4 DETAILS OF OPERATION

- Will you have seating on site for dining? No Yes
- Will you be doing any catering? No Yes
- Will you be doing any delivery? No Yes
- Will you have outdoor activities? No Yes - Check all that apply: Bar Cooking/Grilling Dining
- Will you have a drive thru window? No Yes - Are hours different from inside? No Yes
 If Yes, provide drive thru hours: _____
- Will scales or barcode scanners be used? No Yes - You must also apply for a Weights & Measures License.

SECTION 5 ADDITIONAL SITES

Where will food be prepared and/or sold?
 At a single site At multiple sites: How many? _____ (for example, a hotel with several dining rooms or bars)
 If multiple sites, attach a Food Dealer Additional Site Addendum (ccl-foodadd) for each additional site.

SECTION 6 CONSTRUCTION OR CHANGES

Are you planning any construction, remodeling or equipment changes?
 No If No, SKIP to Section 8
 Yes If Yes, check all that apply: New construction of a building Renovation or remodeling
 Construction changes to existing building Equipment changes only

Provide a brief description of the changes: _____
 Start date: _____
 Name, Address & Phone Number of Architect: _____

 Name, Address & Phone Number of Contractor: _____

SECTION 7 ALCOHOL BEVERAGES

Are you applying for an alcohol beverage license?
 No If No, SKIP to Section 8
 Yes If YES, if your food license is approved prior to the alcohol license, when do you want the food license issued?
 Immediately At the same time as the alcohol license

SECTION 8 ACKNOWLEDGEMENTS & SIGNATURE

- You must initial each item confirming your understanding:
- I understand the Health Department must conduct an inspection and advise the License Division of their approval before the license may be issued.
 - I understand I must obtain an occupancy permit from the Department of Neighborhood Services and an inspection may be required. Neighborhood Services must advise the License Division of their approval before the license may be issued.
 - I understand the district alderperson will review and either support or object to my application. If he/she objects, I may appeal and be scheduled to appear before the Licenses Committee. The Licenses Committee will then make a recommendation to the Common Council. The Common Council must grant the license before it may be issued.
 - I understand proof of payment for all license fees must be on file in the License Division before the license may be issued and the license must be issued and posted in my establishment prior to opening for business.
 - I will not operate my food business until the license has been issued and posted in the establishment.

Signature of Sole Proprietor, Partner, or 20% Shareholder: 

Signature of Additional Partner: _____



PUBLIC ENTERTAINMENT PREMISES LICENSE SUPPLEMENTAL APPLICATION

Office of the City Clerk License Division
200 E. Wells St. Room 105, Milwaukee, WI 53202
(414) 286-2238 www.milwaukee.gov/license e-mail address: license@milwaukee.gov

PREMISES ADDRESS: 4532 W. Burling St

TYPES OF ENTERTAINMENT (CHECK ALL THAT APPLY)

| | | | |
|---|--|---|---|
| <input type="checkbox"/> Instrumental Musicians | <input type="checkbox"/> Battle of the Bands | <input type="checkbox"/> Dancing by Performers | <input checked="" type="checkbox"/> Amusement Machines How many? <u>5</u> |
| <input type="checkbox"/> Bands | <input type="checkbox"/> Comedy Acts | <input type="checkbox"/> Adult Entertainment/ Strippers/Erotic Dance | <input type="checkbox"/> Concerts Approx. # per year? _____ |
| <input type="checkbox"/> Bowling Alley How many? _____ | <input type="checkbox"/> Disc Jockey | <input type="checkbox"/> Wrestling | <input type="checkbox"/> Theatrical Performances Approx. # per year? _____ |
| <input type="checkbox"/> Pool Tables How many? _____ | <input type="checkbox"/> Magic Shows | <input type="checkbox"/> Patron Contests | <input checked="" type="checkbox"/> Jukebox |
| <input type="checkbox"/> Motion Pictures (movies by admission) - How many? _____ | <input type="checkbox"/> Poetry Readings | <input type="checkbox"/> Patrons Dancing | <input type="checkbox"/> Karaoke |
| <input type="checkbox"/> Other: _____ | | | |

Entertainment Outdoor Closing Hours: 10:00pm Sunday-Thursdays; 12:00am Friday & Saturday; unless a different time, either earlier or later, is established by the Common Council in its approval of the licensee's plan of operation.

PROMOTERS/SOUND AMPLIFICATION

Will promoters ever be used for any of the entertainment? No Yes If Yes, Describe:

At any time will sound amplification be used? No Yes If Yes, Describe: Regulates inside Saenger

LEGAL CAPACITY OF PREMISES

65 (Call the Development Center at 414-286-8211 with questions.) Legal capacity determines the fee for your Public Entertainment Premises License. If you would like to request the license be approved with a lower capacity than that listed above, indicate the lower capacity here: 65. If approved, this lower capacity will print on your license and override the capacity listed on your Occupancy Permit.

ACKNOWLEDGEMENT/SIGNATURE

I understand that after the license has been issued, a change to the plan of operation will require a written request to change and approval from the Common Council. I agree to inform the City Clerk within 10 days of any substantial changes in the information supplied in this application. I understand that I shall not willfully refuse to provide the services offered under this license, or add charges or require deposits not required of the general public because of race, color, sex, religion, national origin or ancestry, age, handicap, lawful source of income, marital status, sexual orientation, gender identity or expression, familial status or the fact that a person is now or has been a member of the military service, whether dressed in uniform or not; and shall not seek such information as a condition of employment, or penalize any employee or discriminate in the selection of personnel for training or promotion on the basis of such information.

I have knowledge of the City Ordinances currently regulating public entertainment, and understand that the license may be subject to suspension, non-renewal or revocation, if I violate any rule, law or regulation of the city of Milwaukee and State of Wisconsin.

[Signature]
Signature of Sole Proprietor, Partner or 20% or More Shareholder
(If no 20% or more Shareholder, Corporate Officer - print name/title and sign)

Office Use Only:

Initials: _____ Filed: _____ App: _____

Only PEP? No Yes If Yes, Queue to MPD and Email Mgrs/Team Lead (must be heard w/in 60 days)

WAZ'S DINNERS

SERVED W/ CHOISE OF TWO SIDES AND CHOICE OF BREAD

CATFISH FILLETS (3) \$12.50

PORK CHOPS (2) \$10.00

SHRIMP (8) \$13.00

2 PIECE FISH & SHRIMP \$15.00

TILAPIA \$12.50

CHICKEN (4 PIECE DINNER) \$12.00

WAZ'S FAMOUS CAJUN CATFISH OR TALAPIA (SERVED OVER RICE) \$12.50

LOVE OVER RICE \$12.50 W/EXTRA CHICKEN BREAST \$15.50

**** SIDES: VARIES ON DAILY BASIS** SPAGHETTI, GREENS & MAC & CHEESE \$3.00**

WINGS AND FRIES

(3) \$5.00 (4) \$6.00 (6) \$8.00 (9) \$11.00 (13) \$15.00 (20) \$22.00

BREAKFAST

2 EGGS & TOAST \$2.50 + POTATOES \$4.00 ++ MEAT \$6.75

2 EGGS & FRENCH TOAST & MEAT \$6.75

EGG SANDWICH \$3.00 +MEAT \$5.00 ++CHEESE \$5.50

WAZ'S FAMOUS BREAKFAST \$9.00

PORK CHOP, EGGS, POTATOE, TOAST \$10.50

2 POLISH, EGGS, POTATO, TOAST \$9.00

BUILD YOUR OWN OMELETS \$6.00

- ADD HAM, SAUSAGE OR BACON .75 EACH
- ADD G. PEPPER OR MUSHROOM .25 EACH
- ADD CHICKEN \$4.00 CHEESE .50

SIDE TOAST \$1.00 FRENCH TOAST \$1.00

POTATOES, MASHED POTATOES, FRIES, RICE, GRITS \$2.00

HAM, BACON, SAUSAGE, POLISH, TURKEY SAUSAGE \$3.00

EXTRA EGG \$1.00 TEXAS TOAST \$1.00

(FOOD ITEMS SUCH AS HAMBURGERS, OR EGGS CAN BE MADE TO ORDER. HOWEVER, CONSUMING RAW OR UNCOOKED FOODS MAY INCREASE YOUR RISK OF FOOD BORN ILLNESS)

CHECK OUT OUR DAILY SPECIALS

APPETIZERS

| | | | |
|------------------------|---------------|--------------------------|---------------|
| CHICKEN STRIPES | \$5.00 | ONION RINGS | \$4.00 |
| DRUMMETTES | \$6.00 | FRIED OKRA | \$4.00 |
| FRENCH FRIES | \$2.00 | MOZZARELLA STICKS | \$5.50 |
| FF BASKET | \$3.50 | BREADED MUSHROOMS | \$4.00 |

BURGERS

| | |
|---|---------------|
| WAZ UP - (LETTUCE, TOMATO, MUSHROOMS, BACON, CHEESE) | \$6.50 |
| HAMBURGER 1/3lb | \$4.75 |
| DOUBLE 1/3lb | \$6.25 |
| CHEESEBURGER 1/3lb | \$5.25 |
| DOUBLE 1/3lb | \$7.50 |
| PATTY MELT (SWISS ON RYE) | \$6.50 |
| TEXAS TOAST BURGER | \$7.50 |

***ADD FRENCH FRIES FOR \$2.00*ADD \$1.50 - BACON,
.50 - MUSHROOMS OR G. PEPPERS, .25 - LETTUCE OR TOMATO**

SANDWICHES (ADD FRENCH FRIES \$2.00)

| | |
|--|----------------|
| CHICKEN BREAST (6OZ. BREAST W/LETTUCE & TOMATOE) | \$6.50 |
| CATFISH (W / LETTUCE, TOMATOE AND TARTER) | \$7.50 |
| CHICKEN CORDON BLUE (HAM, SWISS, SAUCE) | \$7.00 |
| GRILLED CHEESE | \$3.50 |
| CHICKEN BLT (W/ MAYO) | \$7.50 |
| GRILLED HAM & CHEESE | \$4.50 |
| B.L.T (W/ MAYO) | \$4.50 |
| PORK CHOP (W/ LETTUCE AND TOMATO) | \$5.50 |
| POLISH (HOT/MILD, FRIED ONION & G. PEPPER) | \$4.00 |
| THICK HAM SANDWICH | \$5.50 |
| TURKEY STACK OR MELT | \$6.00 |
| PHILLY CHEESE STEAK (MUSH, ONION, G. PEPPERS, CHEESE) | \$9.00 |
| QUESADILLA: CHICKEN | \$10.00 |

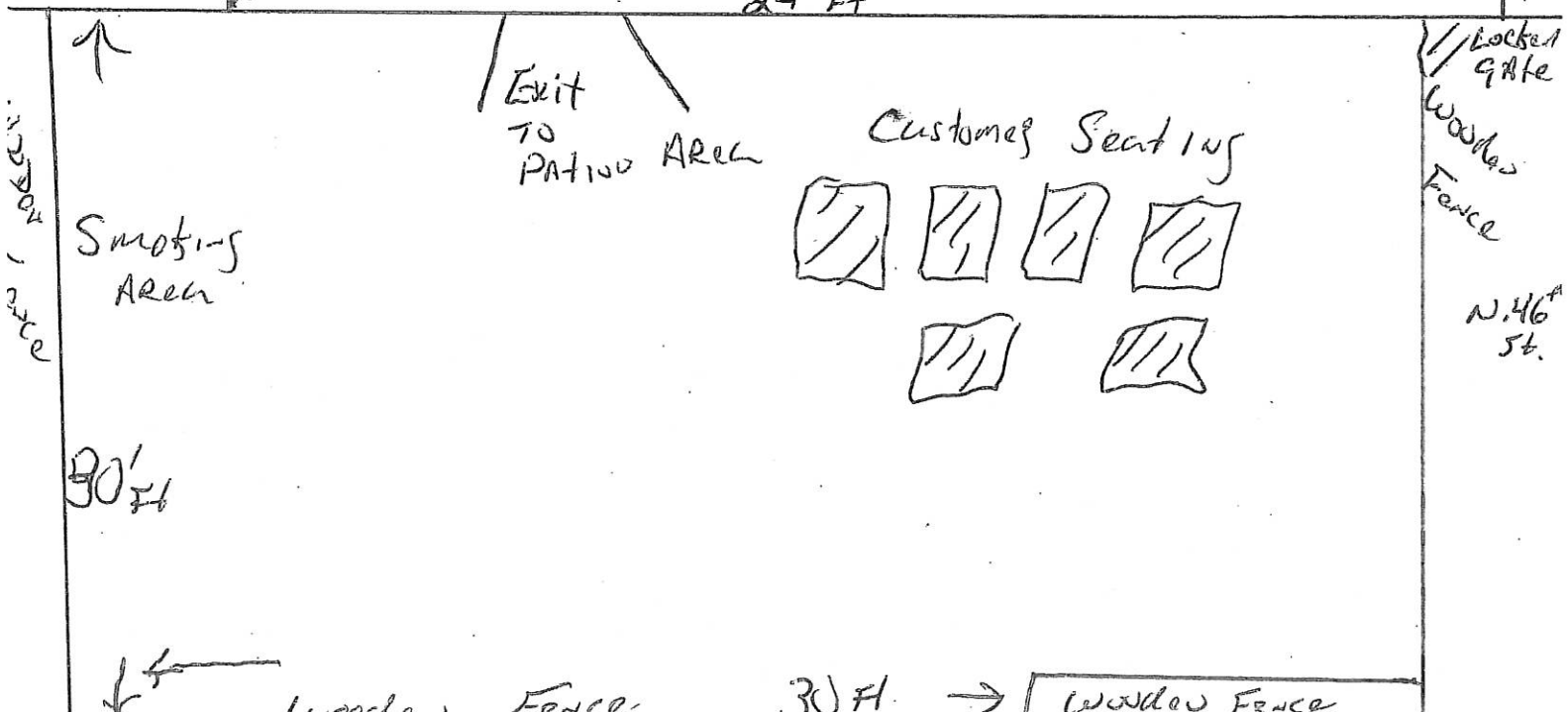
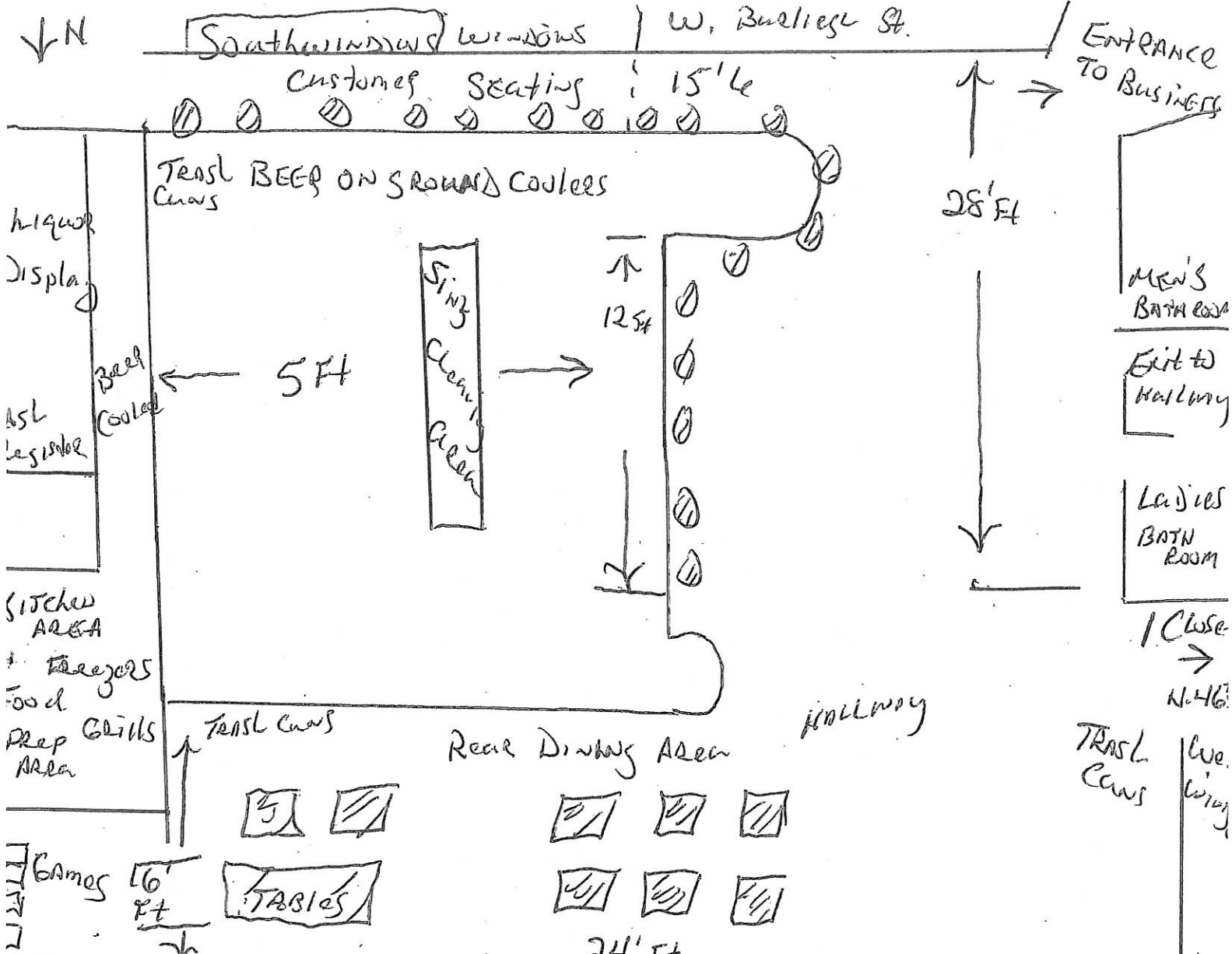

Agent C.D. CHILDS Build's GOLDEN CHILDS LLC GARSAAR
 3-10-2020 4532 W. Buelleg St

Storage Closet

Food Storage Area

Refrigerated
Generators

Basement

&

Storage Area

west
N. 1/6th Sth

5' ft

5

Basement
Door
Entrance

Wine in
Storage
Food
Storage

Office
Area

5' ft

Alcohol Storage

Freezer
Cooler
Freezer

3.10.2020 Storage Area For Food / Kebab's
Agent C.D. CHILDS 4532 W. Buelig St
Dried Soups
BUILT GOLDENCHILD BLDG RENT CO. ETC...

Freezer
Cooler
Freezer

10 ft

Storage
Room

Gas
Power

Food
Storage

8 ft