



Certificate of Appropriateness

Milwaukee Historic Preservation Commission/200 E. Wells Street/Milwaukee, WI 53202/phone 414-286-5712/fax 414-286-3004

Property	939 N. 31 st St. Concordia HD
Description of work	Replace porch guard rails and balusters on the lower front porch. No design changes will be made; new guard rails and balusters will match existing conditions exactly. Porch skirting will remain; structural posts and newel posts will also remain but require some repairs. All repaired and reconstructed elements will be painted to match existing.
Date issued	10/10/2019 PTS ID 114873 COA porch rehab

In accordance with the provisions of Section 320-21 (11) and (12) of the Milwaukee Code of Ordinances, the Milwaukee Historic Preservation Commission has issued a certificate of appropriateness for the work listed above. The work was found to be consistent with preservation guidelines. The following conditions apply to this certificate of appropriateness:

All finish wood must be smooth and free of knots and must be painted or treated with an opaque stain upon completion.

All work must be done in a craftsman-like manner, and must be completed within one year of the date this certificate was issued. Staff must approve any changes or additions to this certificate before work begins. Work that is not completed in accordance with this certificate may be subject to correction orders or citations. If you require technical assistance, please contact Carlen Hatala of the Historic Preservation staff as follows: Phone: (414) 286-5722 E-mail: carlen.hatala@milwaukee.gov.

If permits are required, you are responsible for obtaining them from the Milwaukee Development Center. If you have questions about permit requirements, please consult the Development Center's web site, www.milwaukee.gov/build, or call (414) 286-8210.



City of Milwaukee Historic Preservation Staff

Copies to: Development Center, Ald. Robert Bauman



Photos from the Wisconsin Historical Society
Work to be done on lower front porch ONLY – second photo indicates baluster design to be maintained

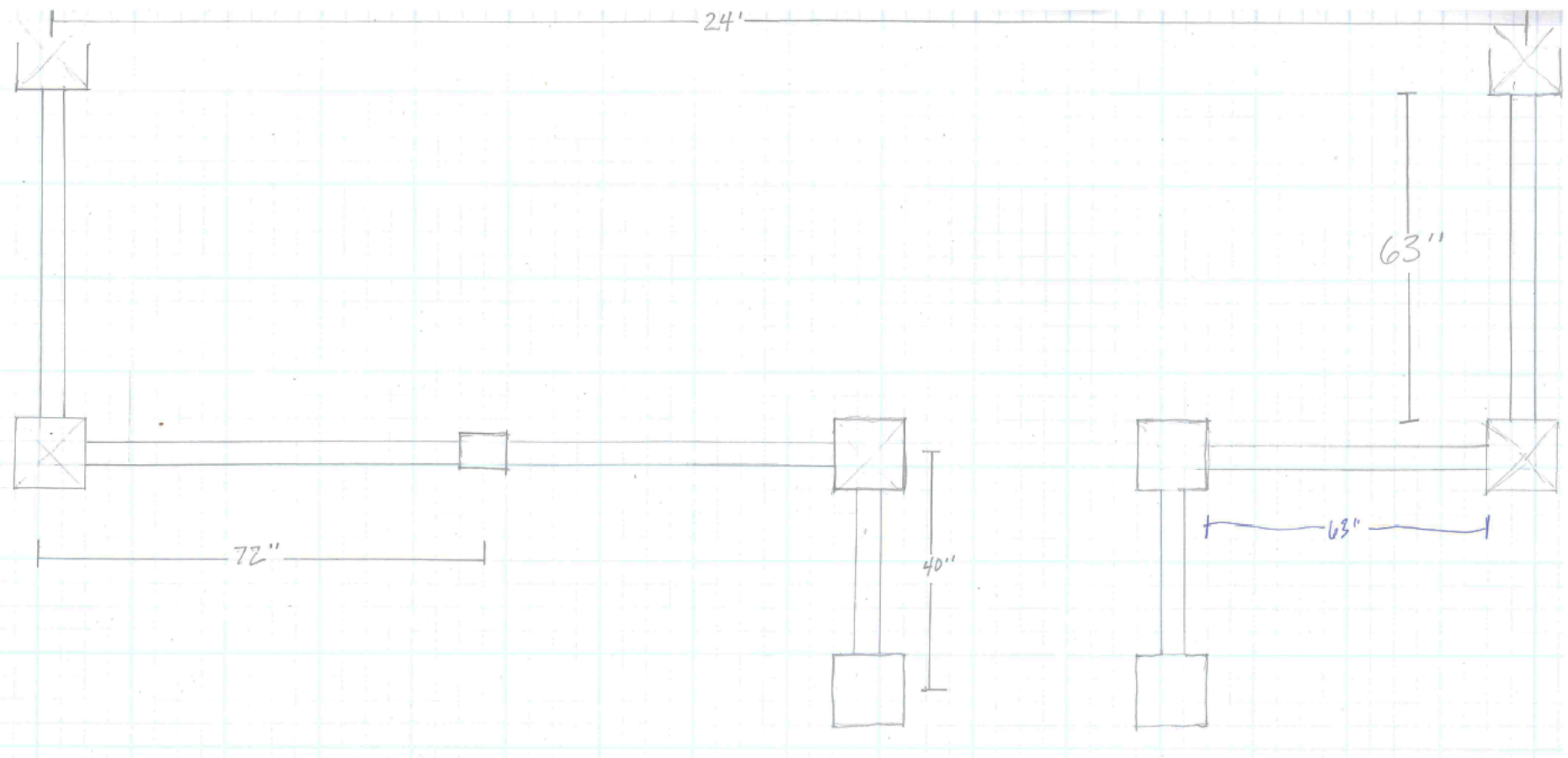

Drawing above indicates dimension for lower front porch

Guard rails and balusters to be replaced to match existing design, painted to match existing condition upon completion.

Structural posts and newel posts will be repaired as needed and painted to match existing condition

Skirting will remain

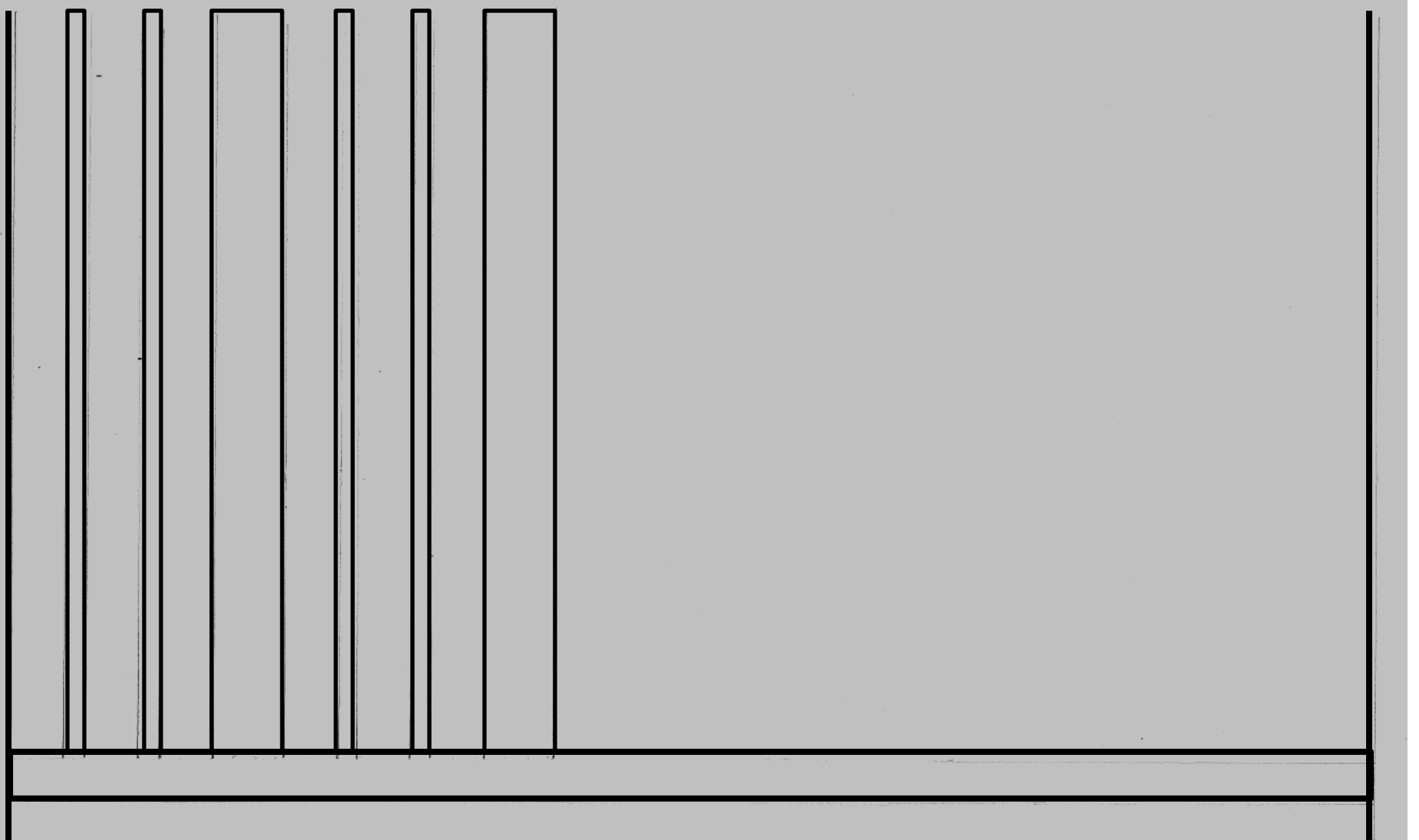

Sketch of baluster profile and design to be maintained – new balusters to **match existing conditions exactly**