



**CITY OF MILWAUKEE
OFFICE OF THE CITY CLERK**

Thursday, May 02, 2019

COMMITTEE MEETING NOTICE

AD 09

ALHAJJEH, Ayman A, Agent
Extreme Wireless & Gifts LLC
9110 W Brown Deer Rd
Milwaukee, WI 53224

You are requested to attend a hearing which is to be held in Room 301-B, Third Floor, City Hall on:

Tuesday, May 14, 2019 at 10:00 AM

Regarding: Your Secondhand Dealer's License Application as agent for "Extreme Wireless & Gifts LLC" for "Extreme Wireless" at 9110 W Brown Deer Rd.

There is a possibility that your application may be denied for one or more of the following reasons: The recommendation of the committee regarding the application shall be based on evidence presented at the hearing. Per MCO 85-2.7-4, probative evidence concerning whether or not a new license should be granted may be presented on the following subjects: whether or not the applicant meets the municipal requirements, the appropriateness of the location and premises where the licensed premises is to be located and whether use of the premises for the purposes or activities permitted by the license would tend to facilitate a public or private nuisance or create undesirable neighborhood problems such as disorderly patrons, unreasonably loud noise, litter, and excessive traffic and parking congestion. Probative evidence relating to these matters may be taken from the plan of operation submitted with the license application, if any, but shall not include the content of any music. Evidence regarding the fitness of the location of the premises to be maintained as the principal place of business, including but not limited to whether there is an overconcentration of businesses of the type for which the license is sought; whether the proposal is consistent with any pertinent neighborhood business or development plans, or the location's proximity to areas where children are typically present. The applicant's record in operating similarly licensed premises; and whether or not the applicant has been charged with or convicted of any felony, misdemeanor, municipal offense or other offense, the circumstances of which substantially relate to the activity to be permitted by the license being applied for or any other factor which reasonably relates to the public health, safety or welfare may also be considered. See attached police report or correspondence.

**Notice for applicants with
warrants or unpaid fines:**

Proof of warrant satisfaction or payment of fines must be submitted at the hearing on the above date and time. Failure to comply with this requirement may result in a delay of the granting/denial of your application.

Failure to appear at this meeting may result in the denial of your license. Individual applicants must appear only in person or by an attorney. Corporate or Limited Liability applicants must appear only by the agent designated on the application or by an attorney. Partnership applicants must appear by a partner listed on the application or by an attorney. If you wish to do so and at your own expense, you may be accompanied by an attorney of your choosing to represent you at this hearing.

You will be given an opportunity to speak on behalf of the application and to respond and challenge any charges or reasons given for the denial. No petitions can be accepted by the committee, unless the people who signed the petition are present at the committee hearing and willing to testify. You may present witnesses under oath and you may also confront and cross-examine opposing witnesses under oath. If you have difficulty with the English language, you should bring an interpreter with you, at your expense, so that you can answer questions and participate in your hearing.

You may examine the application file at this office during regular business hours prior to the hearing date. Inquiries regarding this matter may be directed to the person whose signature appears below.

Limited parking for persons attending meetings in City Hall is available at reduced rates (5 hour limit) at the Milwaukee Center on the southwest corner of East Kilbourn and North Water Street. Parking tickets must be validated in the first floor information booth in City Hall.

PLEASE NOTE: Upon reasonable notice, efforts will be made to accommodate the needs of disabled individuals through sign language interpreters or other auxiliary aids. For additional information or to request this service, contact the Council Services Division ADA Coordinator at (414) 286-2998, Fax - (414) 286-3456, TDD - (414) 286-2025.

JIM OWCZARSKI, CITY CLERK

BY:

Jessica Celella

License Division Manager

If you have questions regarding this notice, please contact the License Division at (414) 286-2238.

200 E. Wells Street, Room 105, City Hall, Milwaukee, WI 53202. www.milwaukee.gov/license
Phone: (414) 286-2238 Fax: (414) 286-3057 Email Address: License@milwaukee.gov



**CITY OF MILWAUKEE
OFFICE OF THE CITY CLERK**

Thursday, May 02, 2019

COMMITTEE MEETING NOTICE

AD 09

ALHAJJEH, Ayman A, Agent
Extreme Wireless & Gifts LLC
5209 S. 13th St., #C
Milwaukee, WI 53221

You are requested to attend a hearing which is to be held in Room 301-B, Third Floor, City Hall on:

Tuesday, May 14, 2019 at 10:00 AM

Regarding: Your Secondhand Dealer's License Application as agent for "Extreme Wireless & Gifts LLC" for "Extreme Wireless" at 9110 W Brown Deer Rd.

There is a possibility that your application may be denied for one or more of the following reasons: The recommendation of the committee regarding the application shall be based on evidence presented at the hearing. Per MCO 85-2.7-4, probative evidence concerning whether or not a new license should be granted may be presented on the following subjects: whether or not the applicant meets the municipal requirements, the appropriateness of the location and premises where the licensed premises is to be located and whether use of the premises for the purposes or activities permitted by the license would tend to facilitate a public or private nuisance or create undesirable neighborhood problems such as disorderly patrons, unreasonably loud noise, litter, and excessive traffic and parking congestion. Probative evidence relating to these matters may be taken from the plan of operation submitted with the license application, if any, but shall not include the content of any music. Evidence regarding the fitness of the location of the premises to be maintained as the principal place of business, including but not limited to whether there is an overconcentration of businesses of the type for which the license is sought; whether the proposal is consistent with any pertinent neighborhood business or development plans, or the location's proximity to areas where children are typically present. The applicant's record in operating similarly licensed premises; and whether or not the applicant has been charged with or convicted of any felony, misdemeanor, municipal offense or other offense, the circumstances of which substantially relate to the activity to be permitted by the license being applied for or any other factor which reasonably relates to the public health, safety or welfare may also be considered. See attached police report or correspondence.

**Notice for applicants with
warrants or unpaid fines:**

Proof of warrant satisfaction or payment of fines must be submitted at the hearing on the above date and time. Failure to comply with this requirement may result in a delay of the granting/denial of your application.

Failure to appear at this meeting may result in the denial of your license. Individual applicants must appear only in person or by an attorney. Corporate or Limited Liability applicants must appear only by the agent designated on the application or by an attorney. Partnership applicants must appear by a partner listed on the application or by an attorney. If you wish to do so and at your own expense, you may be accompanied by an attorney of your choosing to represent you at this hearing.

You will be given an opportunity to speak on behalf of the application and to respond and challenge any charges or reasons given for the denial. No petitions can be accepted by the committee, unless the people who signed the petition are present at the committee hearing and willing to testify. You may present witnesses under oath and you may also confront and cross-examine opposing witnesses under oath. If you have difficulty with the English language, you should bring an interpreter with you, at your expense, so that you can answer questions and participate in your hearing.

You may examine the application file at this office during regular business hours prior to the hearing date. Inquiries regarding this matter may be directed to the person whose signature appears below.

Limited parking for persons attending meetings in City Hall is available at reduced rates (5 hour limit) at the Milwaukee Center on the southwest corner of East Kilbourn and North Water Street. Parking tickets must be validated in the first floor information booth in City Hall.

PLEASE NOTE: Upon reasonable notice, efforts will be made to accommodate the needs of disabled individuals through sign language interpreters or other auxiliary aids. For additional information or to request this service, contact the Council Services Division ADA Coordinator at (414) 286-2998, Fax - (414) 286-3456, TDD - (414) 286-2025.

JIM OW CZARSKI, CITY CLERK

BY:

Jessica Celella

License Division Manager

If you have questions regarding this notice, please contact the License Division at (414) 286-2238.

200 E. Wells Street, Room 105, City Hall, Milwaukee, WI 53202. www.milwaukee.gov/license
Phone: (414) 286-2238 Fax: (414) 286-3057 Email Address: License@milwaukee.gov



Friday, May 03, 2019



Notice of Public Hearing

ALHAJJEH, Ayman A, Agent
Extreme Wireless at 9110 W Brown Deer Rd
Secondhand Dealer's License Application

Tuesday, May 14, 2019 at 10:00 AM

To whom it may concern:

The above application has been made by the above named applicant(s). This requires approval from the Licenses Committee and the Common Council of the City of Milwaukee. The hearing before the Licenses Committee will take place on 5/14/2019 at 10:00 AM, in Room 301-B, Third Floor, City Hall. If you wish, you may provide testimony at the hearing regarding the request; see below for further information. You are not required to attend the hearing. Once the Licenses Committee makes its recommendation, this recommendation is forwarded to the full Common Council for approval at its next regularly scheduled hearing. Please review the information below and if you have further questions regarding this process, please contact the License Division at (414) 286-2238.

Important details for those wishing to provide information for the Licenses Committee to consider when making its recommendation:

1. The license application is scheduled to be heard at the above time. Due to other hearings running longer than scheduled, you may have to wait some time to provide your testimony.
2. You must appear in person and testify as to matters that you have personally experienced or seen. (You cannot provide testimony for your neighbor, parent or anyone else; this is considered hearsay and cannot be considered by the committee.)
3. No letters or petitions can be accepted by the committee (unless the person who wrote the letter or the persons who signed the petition are present at the committee hearing and willing to testify).
4. Persons opposed to the license application are given the opportunity to testify first; supporters may testify after the opponents have finished.
5. When you are called to testify, you will be sworn in and asked to give your name, and address. (If your first and/or last names are uncommon please spell them.)
6. You may then provide testimony.
 - a. Include only information relating to the above license application.
 - b. Include only information you have personally witnessed or seen.
 - c. Provide concise and relevant information detailing how this business has affected or may affect the peaceful enjoyment of your neighborhood.
 - d. If by the time you have the opportunity to testify, the information you wish to share has already been provided to the committee, you may state that you agree with the previous testimony. Redundant or repetitive testimony will not assist the committee in making its recommendation.
7. After giving your testimony, the members of the Licenses Committee and the licensee may ask questions regarding the testimony you have given or other factors relating to the license application.
8. Business Competition is not a valid basis for denial or non-renewal of a license.
Please Note: If you have submitted an objection to the above application your objection cannot be considered by the committee unless you personally testify at the hearing.

OCCUPANT	MAIL ADDRESS	CITY, STATE ZIP
CURRENT OCCUPANT	8827C N 95TH ST	MILWAUKEE, WI 53224
CURRENT OCCUPANT	8931H N SWAN RD	MILWAUKEE, WI 53224
CURRENT OCCUPANT	9001C N SWAN RD	MILWAUKEE, WI 53224
CURRENT OCCUPANT	9011H N 95TH ST	MILWAUKEE, WI 53224
CURRENT OCCUPANT	8859A N SWAN RD	MILWAUKEE, WI 53224
CURRENT OCCUPANT	9001L N SWAN RD	MILWAUKEE, WI 53224
CURRENT OCCUPANT	9060D N 95TH ST	MILWAUKEE, WI 53224
CURRENT OCCUPANT	9010A N 95TH ST	MILWAUKEE, WI 53224
CURRENT OCCUPANT	8951K N 95TH ST	MILWAUKEE, WI 53224
CURRENT OCCUPANT	8860E N 95TH ST	MILWAUKEE, WI 53224
CURRENT OCCUPANT	8860G N 95TH ST	MILWAUKEE, WI 53224
CURRENT OCCUPANT	9070F N 95TH ST	MILWAUKEE, WI 53224
CURRENT OCCUPANT	8860A N 95TH ST	MILWAUKEE, WI 53224
CURRENT OCCUPANT	9097F N 95TH ST	MILWAUKEE, WI 53224
CURRENT OCCUPANT	9021E N SWAN RD	MILWAUKEE, WI 53224
CURRENT OCCUPANT	8854F N 95TH ST	MILWAUKEE, WI 53224
CURRENT OCCUPANT	9070G N 95TH ST	MILWAUKEE, WI 53224
CURRENT OCCUPANT	8941J N SWAN RD	MILWAUKEE, WI 53224
CURRENT OCCUPANT	8854G N 95TH ST	MILWAUKEE, WI 53224
CURRENT OCCUPANT	9070E N 95TH ST	MILWAUKEE, WI 53224
CURRENT OCCUPANT	8859D N SWAN RD	MILWAUKEE, WI 53224
CURRENT OCCUPANT	8872C N 95TH ST	MILWAUKEE, WI 53224
CURRENT OCCUPANT	8883F N SWAN RD	MILWAUKEE, WI 53224
CURRENT OCCUPANT	9060L N 95TH ST	MILWAUKEE, WI 53224
CURRENT OCCUPANT	8871K N SWAN RD	MILWAUKEE, WI 53224
CURRENT OCCUPANT	8931F N SWAN RD	MILWAUKEE, WI 53224
CURRENT OCCUPANT	8970J N 95TH ST	MILWAUKEE, WI 53224
CURRENT OCCUPANT	8866E N 95TH ST	MILWAUKEE, WI 53224
CURRENT OCCUPANT	8910D N 95TH ST	MILWAUKEE, WI 53224
CURRENT OCCUPANT	8854E N 95TH ST	MILWAUKEE, WI 53224
CURRENT OCCUPANT	9010D N 95TH ST	MILWAUKEE, WI 53224
CURRENT OCCUPANT	9241E W ALLYN ST	MILWAUKEE, WI 53224
CURRENT OCCUPANT	8872F N 95TH ST	MILWAUKEE, WI 53224
CURRENT OCCUPANT	9060A N 95TH ST	MILWAUKEE, WI 53224
CURRENT OCCUPANT	9125E W ALLYN ST	MILWAUKEE, WI 53224
CURRENT OCCUPANT	8872H N 95TH ST	MILWAUKEE, WI 53224
CURRENT OCCUPANT	8970A N 95TH ST	MILWAUKEE, WI 53224
CURRENT OCCUPANT	9076J N 95TH ST	MILWAUKEE, WI 53224
CURRENT OCCUPANT	9221E W ALLYN ST	MILWAUKEE, WI 53224
CURRENT OCCUPANT	9031H N SWAN RD	MILWAUKEE, WI 53224
CURRENT OCCUPANT	9031K N SWAN RD	MILWAUKEE, WI 53224
CURRENT OCCUPANT	9076H N 95TH ST	MILWAUKEE, WI 53224
CURRENT OCCUPANT	9241J W ALLYN ST	MILWAUKEE, WI 53224
CURRENT OCCUPANT	9241B W ALLYN ST	MILWAUKEE, WI 53224
CURRENT OCCUPANT	9241C W ALLYN ST	MILWAUKEE, WI 53224
CURRENT OCCUPANT	8853E N SWAN RD	MILWAUKEE, WI 53224

CURRENT OCCUPANT	8859L N SWAN RD	MILWAUKEE, WI 53224
CURRENT OCCUPANT	8889J N SWAN RD	MILWAUKEE, WI 53224
CURRENT OCCUPANT	9325E W ALLYN ST	MILWAUKEE, WI 53224
CURRENT OCCUPANT	8871A N SWAN RD	MILWAUKEE, WI 53224
CURRENT OCCUPANT	8930C N 95TH ST	MILWAUKEE, WI 53224
CURRENT OCCUPANT	9011E N 95TH ST	MILWAUKEE, WI 53224
CURRENT OCCUPANT	9071K N 95TH ST	MILWAUKEE, WI 53224
CURRENT OCCUPANT	9060E N 95TH ST	MILWAUKEE, WI 53224
CURRENT OCCUPANT	8930F N 95TH ST	MILWAUKEE, WI 53224
CURRENT OCCUPANT	8884K N 95TH ST	MILWAUKEE, WI 53224
CURRENT OCCUPANT	8867D N 95TH ST	MILWAUKEE, WI 53224
CURRENT OCCUPANT	8867C N 95TH ST	MILWAUKEE, WI 53224
CURRENT OCCUPANT	8865F N SWAN RD	MILWAUKEE, WI 53224
CURRENT OCCUPANT	9236 W BROWN DEER RD 5	MILWAUKEE, WI 53224
CURRENT OCCUPANT	9236 W BROWN DEER RD 8	MILWAUKEE, WI 53224
CURRENT OCCUPANT	9216 W BROWN DEER RD 8	MILWAUKEE, WI 53224
CURRENT OCCUPANT	8835 N SWAN RD 5	MILWAUKEE, WI 53224
CURRENT OCCUPANT	8835 N SWAN RD 1	MILWAUKEE, WI 53224
CURRENT OCCUPANT	8835 N SWAN RD 7	MILWAUKEE, WI 53224
CURRENT OCCUPANT	9020H N 95TH ST	MILWAUKEE, WI 53224
CURRENT OCCUPANT	8841H N SWAN RD	MILWAUKEE, WI 53224
CURRENT OCCUPANT	8848H N 95TH ST	MILWAUKEE, WI 53224
CURRENT OCCUPANT	8911H N 95TH ST	MILWAUKEE, WI 53224
CURRENT OCCUPANT	8827H N 95TH ST	MILWAUKEE, WI 53224
CURRENT OCCUPANT	9261G W ALLYN ST	MILWAUKEE, WI 53224
CURRENT OCCUPANT	8827E N 95TH ST	MILWAUKEE, WI 53224
CURRENT OCCUPANT	8872E N 95TH ST	MILWAUKEE, WI 53224
CURRENT OCCUPANT	8895G N SWAN RD	MILWAUKEE, WI 53224
CURRENT OCCUPANT	8877C N SWAN RD	MILWAUKEE, WI 53224
CURRENT OCCUPANT	9021H N SWAN RD	MILWAUKEE, WI 53224
CURRENT OCCUPANT	9061D N 95TH ST	MILWAUKEE, WI 53224
CURRENT OCCUPANT	8889D N SWAN RD	MILWAUKEE, WI 53224
CURRENT OCCUPANT	8847J N SWAN RD	MILWAUKEE, WI 53224
CURRENT OCCUPANT	8877A N SWAN RD	MILWAUKEE, WI 53224
CURRENT OCCUPANT	8841G N SWAN RD	MILWAUKEE, WI 53224
CURRENT OCCUPANT	9040F N 95TH ST	MILWAUKEE, WI 53224
CURRENT OCCUPANT	9031D N 95TH ST	MILWAUKEE, WI 53224
CURRENT OCCUPANT	8847G N SWAN RD	MILWAUKEE, WI 53224
CURRENT OCCUPANT	9221A W ALLYN ST	MILWAUKEE, WI 53224
CURRENT OCCUPANT	8847B N SWAN RD	MILWAUKEE, WI 53224
CURRENT OCCUPANT	9076K N 95TH ST	MILWAUKEE, WI 53224
CURRENT OCCUPANT	8950C N 95TH ST	MILWAUKEE, WI 53224
CURRENT OCCUPANT	8847K N SWAN RD	MILWAUKEE, WI 53224
CURRENT OCCUPANT	8990B N 95TH ST	MILWAUKEE, WI 53224
CURRENT OCCUPANT	9125A W ALLYN ST	MILWAUKEE, WI 53224
CURRENT OCCUPANT	8866A N 95TH ST	MILWAUKEE, WI 53224
CURRENT OCCUPANT	9221F W ALLYN ST	MILWAUKEE, WI 53224

CURRENT OCCUPANT	8877F N SWAN RD	MILWAUKEE, WI 53224
CURRENT OCCUPANT	8871E N SWAN RD	MILWAUKEE, WI 53224
CURRENT OCCUPANT	8921E N SWAN RD	MILWAUKEE, WI 53224
CURRENT OCCUPANT	9060J N 95TH ST	MILWAUKEE, WI 53224
CURRENT OCCUPANT	9281A W ALLYN ST	MILWAUKEE, WI 53224
CURRENT OCCUPANT	9011J N SWAN RD	MILWAUKEE, WI 53224
CURRENT OCCUPANT	8854K N 95TH ST	MILWAUKEE, WI 53224
CURRENT OCCUPANT	8911K N SWAN RD	MILWAUKEE, WI 53224
CURRENT OCCUPANT	8866B N 95TH ST	MILWAUKEE, WI 53224
CURRENT OCCUPANT	9020F N 95TH ST	MILWAUKEE, WI 53224
CURRENT OCCUPANT	8911A N SWAN RD	MILWAUKEE, WI 53224
CURRENT OCCUPANT	8847D N SWAN RD	MILWAUKEE, WI 53224
CURRENT OCCUPANT	9011H N SWAN RD	MILWAUKEE, WI 53224
CURRENT OCCUPANT	9071B N 95TH ST	MILWAUKEE, WI 53224
CURRENT OCCUPANT	9011D N 95TH ST	MILWAUKEE, WI 53224
CURRENT OCCUPANT	8884A N 95TH ST	MILWAUKEE, WI 53224
CURRENT OCCUPANT	9241F W ALLYN ST	MILWAUKEE, WI 53224
CURRENT OCCUPANT	8877G N SWAN RD	MILWAUKEE, WI 53224
CURRENT OCCUPANT	8877J N SWAN RD	MILWAUKEE, WI 53224
CURRENT OCCUPANT	8930A N 95TH ST	MILWAUKEE, WI 53224
CURRENT OCCUPANT	9020B N 95TH ST	MILWAUKEE, WI 53224
CURRENT OCCUPANT	8841D N SWAN RD	MILWAUKEE, WI 53224
CURRENT OCCUPANT	9096H N 95TH ST	MILWAUKEE, WI 53224
CURRENT OCCUPANT	9021F N SWAN RD	MILWAUKEE, WI 53224
CURRENT OCCUPANT	8884H N 95TH ST	MILWAUKEE, WI 53224
CURRENT OCCUPANT	8853A N SWAN RD	MILWAUKEE, WI 53224
CURRENT OCCUPANT	8848G N 95TH ST	MILWAUKEE, WI 53224
CURRENT OCCUPANT	9076F N 95TH ST	MILWAUKEE, WI 53224
CURRENT OCCUPANT	9086C N 95TH ST	MILWAUKEE, WI 53224
CURRENT OCCUPANT	8883D N SWAN RD	MILWAUKEE, WI 53224
CURRENT OCCUPANT	8854B N 95TH ST	MILWAUKEE, WI 53224
CURRENT OCCUPANT	8827D N 95TH ST	MILWAUKEE, WI 53224
CURRENT OCCUPANT	8836H N 95TH ST	MILWAUKEE, WI 53224
CURRENT OCCUPANT	8889E N SWAN RD	MILWAUKEE, WI 53224
CURRENT OCCUPANT	8883C N SWAN RD	MILWAUKEE, WI 53224
CURRENT OCCUPANT	8860K N 95TH ST	MILWAUKEE, WI 53224
CURRENT OCCUPANT	8827K N 95TH ST	MILWAUKEE, WI 53224
CURRENT OCCUPANT	9070C N 95TH ST	MILWAUKEE, WI 53224
CURRENT OCCUPANT	8865C N SWAN RD	MILWAUKEE, WI 53224
CURRENT OCCUPANT	9061F N 95TH ST	MILWAUKEE, WI 53224
CURRENT OCCUPANT	8848D N 95TH ST	MILWAUKEE, WI 53224
CURRENT OCCUPANT	8911D N 95TH ST	MILWAUKEE, WI 53224
CURRENT OCCUPANT	8889F N SWAN RD	MILWAUKEE, WI 53224
CURRENT OCCUPANT	9060M N 95TH ST	MILWAUKEE, WI 53224
CURRENT OCCUPANT	8901E N SWAN RD	MILWAUKEE, WI 53224
CURRENT OCCUPANT	8901F N SWAN RD	MILWAUKEE, WI 53224
CURRENT OCCUPANT	9216 W BROWN DEER RD 7	MILWAUKEE, WI 53224

CURRENT OCCUPANT	8835 N SWAN RD 8	MILWAUKEE, WI 53224
CURRENT OCCUPANT	8835 N SWAN RD 2	MILWAUKEE, WI 53224
CURRENT OCCUPANT	9010G N 95TH ST	MILWAUKEE, WI 53224
CURRENT OCCUPANT	9031H N 95TH ST	MILWAUKEE, WI 53224
CURRENT OCCUPANT	9030F N 95TH ST	MILWAUKEE, WI 53224
CURRENT OCCUPANT	8910H N 95TH ST	MILWAUKEE, WI 53224
CURRENT OCCUPANT	8990E N 95TH ST	MILWAUKEE, WI 53224
CURRENT OCCUPANT	9125C W ALLYN ST	MILWAUKEE, WI 53224
CURRENT OCCUPANT	8884F N 95TH ST	MILWAUKEE, WI 53224
CURRENT OCCUPANT	8847E N SWAN RD	MILWAUKEE, WI 53224
CURRENT OCCUPANT	9021D N SWAN RD	MILWAUKEE, WI 53224
CURRENT OCCUPANT	8866F N 95TH ST	MILWAUKEE, WI 53224
CURRENT OCCUPANT	9325G W ALLYN ST	MILWAUKEE, WI 53224
CURRENT OCCUPANT	9070A N 95TH ST	MILWAUKEE, WI 53224
CURRENT OCCUPANT	9125K W ALLYN ST	MILWAUKEE, WI 53224
CURRENT OCCUPANT	9071F N 95TH ST	MILWAUKEE, WI 53224
CURRENT OCCUPANT	8951B N 95TH ST	MILWAUKEE, WI 53224
CURRENT OCCUPANT	8990D N 95TH ST	MILWAUKEE, WI 53224
CURRENT OCCUPANT	9221H W ALLYN ST	MILWAUKEE, WI 53224
CURRENT OCCUPANT	8951E N 95TH ST	MILWAUKEE, WI 53224
CURRENT OCCUPANT	8836B N 95TH ST	MILWAUKEE, WI 53224
CURRENT OCCUPANT	9070D N 95TH ST	MILWAUKEE, WI 53224
CURRENT OCCUPANT	8865E N SWAN RD	MILWAUKEE, WI 53224
CURRENT OCCUPANT	8859J N SWAN RD	MILWAUKEE, WI 53224
CURRENT OCCUPANT	9011M N SWAN RD	MILWAUKEE, WI 53224
CURRENT OCCUPANT	9061B N 95TH ST	MILWAUKEE, WI 53224
CURRENT OCCUPANT	9040B N 95TH ST	MILWAUKEE, WI 53224
CURRENT OCCUPANT	9061L N 95TH ST	MILWAUKEE, WI 53224
CURRENT OCCUPANT	8911J N SWAN RD	MILWAUKEE, WI 53224
CURRENT OCCUPANT	8867B N 95TH ST	MILWAUKEE, WI 53224
CURRENT OCCUPANT	9021B N SWAN RD	MILWAUKEE, WI 53224
CURRENT OCCUPANT	8853F N SWAN RD	MILWAUKEE, WI 53224
CURRENT OCCUPANT	8842E N 95TH ST	MILWAUKEE, WI 53224
CURRENT OCCUPANT	9086G N 95TH ST	MILWAUKEE, WI 53224
CURRENT OCCUPANT	8921K N SWAN RD	MILWAUKEE, WI 53224
CURRENT OCCUPANT	8878B N 95TH ST	MILWAUKEE, WI 53224
CURRENT OCCUPANT	8990C N 95TH ST	MILWAUKEE, WI 53224
CURRENT OCCUPANT	8859M N SWAN RD	MILWAUKEE, WI 53224
CURRENT OCCUPANT	9071E N 95TH ST	MILWAUKEE, WI 53224
CURRENT OCCUPANT	9281C W ALLYN ST	MILWAUKEE, WI 53224
CURRENT OCCUPANT	8854D N 95TH ST	MILWAUKEE, WI 53224
CURRENT OCCUPANT	8970D N 95TH ST	MILWAUKEE, WI 53224
CURRENT OCCUPANT	8841F N SWAN RD	MILWAUKEE, WI 53224
CURRENT OCCUPANT	8866D N 95TH ST	MILWAUKEE, WI 53224
CURRENT OCCUPANT	8871C N SWAN RD	MILWAUKEE, WI 53224
CURRENT OCCUPANT	9096J N 95TH ST	MILWAUKEE, WI 53224
CURRENT OCCUPANT	9011B N SWAN RD	MILWAUKEE, WI 53224

CURRENT OCCUPANT	9061C N 95TH ST	MILWAUKEE, WI 53224
CURRENT OCCUPANT	8853B N SWAN RD	MILWAUKEE, WI 53224
CURRENT OCCUPANT	9031J N SWAN RD	MILWAUKEE, WI 53224
CURRENT OCCUPANT	8931J N SWAN RD	MILWAUKEE, WI 53224
CURRENT OCCUPANT	8871G N SWAN RD	MILWAUKEE, WI 53224
CURRENT OCCUPANT	9050J N 95TH ST	MILWAUKEE, WI 53224
CURRENT OCCUPANT	9060B N 95TH ST	MILWAUKEE, WI 53224
CURRENT OCCUPANT	9060G N 95TH ST	MILWAUKEE, WI 53224
CURRENT OCCUPANT	9031E N SWAN RD	MILWAUKEE, WI 53224
CURRENT OCCUPANT	9076C N 95TH ST	MILWAUKEE, WI 53224
CURRENT OCCUPANT	8878D N 95TH ST	MILWAUKEE, WI 53224
CURRENT OCCUPANT	8951C N 95TH ST	MILWAUKEE, WI 53224
CURRENT OCCUPANT	9281G W ALLYN ST	MILWAUKEE, WI 53224
CURRENT OCCUPANT	8941D N SWAN RD	MILWAUKEE, WI 53224
CURRENT OCCUPANT	8836E N 95TH ST	MILWAUKEE, WI 53224
CURRENT OCCUPANT	9241G W ALLYN ST	MILWAUKEE, WI 53224
CURRENT OCCUPANT	9281F W ALLYN ST	MILWAUKEE, WI 53224
CURRENT OCCUPANT	8910M N 95TH ST	MILWAUKEE, WI 53224
CURRENT OCCUPANT	9010M N 95TH ST	MILWAUKEE, WI 53224
CURRENT OCCUPANT	8836G N 95TH ST	MILWAUKEE, WI 53224
CURRENT OCCUPANT	8910K N 95TH ST	MILWAUKEE, WI 53224
CURRENT OCCUPANT	9020E N 95TH ST	MILWAUKEE, WI 53224
CURRENT OCCUPANT	9261C W ALLYN ST	MILWAUKEE, WI 53224
CURRENT OCCUPANT	8842B N 95TH ST	MILWAUKEE, WI 53224
CURRENT OCCUPANT	9001J N SWAN RD	MILWAUKEE, WI 53224
CURRENT OCCUPANT	9051D N 95TH ST	MILWAUKEE, WI 53224
CURRENT OCCUPANT	8883H N SWAN RD	MILWAUKEE, WI 53224
CURRENT OCCUPANT	9086A N 95TH ST	MILWAUKEE, WI 53224
CURRENT OCCUPANT	9076B N 95TH ST	MILWAUKEE, WI 53224
CURRENT OCCUPANT	8883B N SWAN RD	MILWAUKEE, WI 53224
CURRENT OCCUPANT	9236 W BROWN DEER RD 1	MILWAUKEE, WI 53224
CURRENT OCCUPANT	9236 W BROWN DEER RD 3	MILWAUKEE, WI 53224
CURRENT OCCUPANT	9216 W BROWN DEER RD 2	MILWAUKEE, WI 53224
CURRENT OCCUPANT	9216 W BROWN DEER RD 3	MILWAUKEE, WI 53224
CURRENT OCCUPANT	9130 W BROWN DEER RD 3	MILWAUKEE, WI 53224
CURRENT OCCUPANT	9130 W BROWN DEER RD 11	MILWAUKEE, WI 53224
CURRENT OCCUPANT	9071H N 95TH ST	MILWAUKEE, WI 53224
CURRENT OCCUPANT	8841B N SWAN RD	MILWAUKEE, WI 53224
CURRENT OCCUPANT	8859C N SWAN RD	MILWAUKEE, WI 53224
CURRENT OCCUPANT	8901H N SWAN RD	MILWAUKEE, WI 53224
CURRENT OCCUPANT	9096E N 95TH ST	MILWAUKEE, WI 53224
CURRENT OCCUPANT	9097H N 95TH ST	MILWAUKEE, WI 53224
CURRENT OCCUPANT	8865B N SWAN RD	MILWAUKEE, WI 53224
CURRENT OCCUPANT	9070H N 95TH ST	MILWAUKEE, WI 53224
CURRENT OCCUPANT	9261B W ALLYN ST	MILWAUKEE, WI 53224
CURRENT OCCUPANT	8878E N 95TH ST	MILWAUKEE, WI 53224
CURRENT OCCUPANT	8871F N SWAN RD	MILWAUKEE, WI 53224

CURRENT OCCUPANT	8854H N 95TH ST	MILWAUKEE, WI 53224
CURRENT OCCUPANT	9076A N 95TH ST	MILWAUKEE, WI 53224
CURRENT OCCUPANT	9031F N 95TH ST	MILWAUKEE, WI 53224
CURRENT OCCUPANT	8930D N 95TH ST	MILWAUKEE, WI 53224
CURRENT OCCUPANT	9031J N 95TH ST	MILWAUKEE, WI 53224
CURRENT OCCUPANT	8910B N 95TH ST	MILWAUKEE, WI 53224
CURRENT OCCUPANT	8931K N SWAN RD	MILWAUKEE, WI 53224
CURRENT OCCUPANT	8911C N 95TH ST	MILWAUKEE, WI 53224
CURRENT OCCUPANT	8871B N SWAN RD	MILWAUKEE, WI 53224
CURRENT OCCUPANT	8901K N SWAN RD	MILWAUKEE, WI 53224
CURRENT OCCUPANT	8877D N SWAN RD	MILWAUKEE, WI 53224
CURRENT OCCUPANT	8931G N SWAN RD	MILWAUKEE, WI 53224
CURRENT OCCUPANT	8889K N SWAN RD	MILWAUKEE, WI 53224
CURRENT OCCUPANT	9001F N SWAN RD	MILWAUKEE, WI 53224
CURRENT OCCUPANT	9086F N 95TH ST	MILWAUKEE, WI 53224
CURRENT OCCUPANT	9021A N SWAN RD	MILWAUKEE, WI 53224
CURRENT OCCUPANT	8910A N 95TH ST	MILWAUKEE, WI 53224
CURRENT OCCUPANT	8836A N 95TH ST	MILWAUKEE, WI 53224
CURRENT OCCUPANT	8889G N SWAN RD	MILWAUKEE, WI 53224
CURRENT OCCUPANT	9011C N 95TH ST	MILWAUKEE, WI 53224
CURRENT OCCUPANT	8884B N 95TH ST	MILWAUKEE, WI 53224
CURRENT OCCUPANT	8910E N 95TH ST	MILWAUKEE, WI 53224
CURRENT OCCUPANT	8911G N SWAN RD	MILWAUKEE, WI 53224
CURRENT OCCUPANT	9096G N 95TH ST	MILWAUKEE, WI 53224
CURRENT OCCUPANT	9030E N 95TH ST	MILWAUKEE, WI 53224
CURRENT OCCUPANT	8827J N 95TH ST	MILWAUKEE, WI 53224
CURRENT OCCUPANT	9325F W ALLYN ST	MILWAUKEE, WI 53224
CURRENT OCCUPANT	8836D N 95TH ST	MILWAUKEE, WI 53224
CURRENT OCCUPANT	9011A N SWAN RD	MILWAUKEE, WI 53224
CURRENT OCCUPANT	9325H W ALLYN ST	MILWAUKEE, WI 53224
CURRENT OCCUPANT	9021C N SWAN RD	MILWAUKEE, WI 53224
CURRENT OCCUPANT	8941G N SWAN RD	MILWAUKEE, WI 53224
CURRENT OCCUPANT	8860D N 95TH ST	MILWAUKEE, WI 53224
CURRENT OCCUPANT	8911D N SWAN RD	MILWAUKEE, WI 53224
CURRENT OCCUPANT	8895F N SWAN RD	MILWAUKEE, WI 53224
CURRENT OCCUPANT	8901A N SWAN RD	MILWAUKEE, WI 53224
CURRENT OCCUPANT	8859B N SWAN RD	MILWAUKEE, WI 53224
CURRENT OCCUPANT	8941A N SWAN RD	MILWAUKEE, WI 53224
CURRENT OCCUPANT	9050A N 95TH ST	MILWAUKEE, WI 53224
CURRENT OCCUPANT	9071C N 95TH ST	MILWAUKEE, WI 53224
CURRENT OCCUPANT	9221L W ALLYN ST	MILWAUKEE, WI 53224
CURRENT OCCUPANT	8878A N 95TH ST	MILWAUKEE, WI 53224
CURRENT OCCUPANT	9040J N 95TH ST	MILWAUKEE, WI 53224
CURRENT OCCUPANT	9086K N 95TH ST	MILWAUKEE, WI 53224
CURRENT OCCUPANT	9011A N 95TH ST	MILWAUKEE, WI 53224
CURRENT OCCUPANT	8921G N SWAN RD	MILWAUKEE, WI 53224
CURRENT OCCUPANT	8878G N 95TH ST	MILWAUKEE, WI 53224

CURRENT OCCUPANT	8878F N 95TH ST	MILWAUKEE, WI 53224
CURRENT OCCUPANT	8910G N 95TH ST	MILWAUKEE, WI 53224
CURRENT OCCUPANT	8842K N 95TH ST	MILWAUKEE, WI 53224
CURRENT OCCUPANT	8878H N 95TH ST	MILWAUKEE, WI 53224
CURRENT OCCUPANT	8941E N SWAN RD	MILWAUKEE, WI 53224
CURRENT OCCUPANT	9096A N 95TH ST	MILWAUKEE, WI 53224
CURRENT OCCUPANT	9070B N 95TH ST	MILWAUKEE, WI 53224
CURRENT OCCUPANT	8911B N SWAN RD	MILWAUKEE, WI 53224
CURRENT OCCUPANT	9001D N SWAN RD	MILWAUKEE, WI 53224
CURRENT OCCUPANT	9010B N 95TH ST	MILWAUKEE, WI 53224
CURRENT OCCUPANT	8910L N 95TH ST	MILWAUKEE, WI 53224
CURRENT OCCUPANT	8848C N 95TH ST	MILWAUKEE, WI 53224
CURRENT OCCUPANT	8901B N SWAN RD	MILWAUKEE, WI 53224
CURRENT OCCUPANT	8883A N SWAN RD	MILWAUKEE, WI 53224
CURRENT OCCUPANT	8854A N 95TH ST	MILWAUKEE, WI 53224
CURRENT OCCUPANT	8859H N SWAN RD	MILWAUKEE, WI 53224
CURRENT OCCUPANT	9071D N 95TH ST	MILWAUKEE, WI 53224
CURRENT OCCUPANT	9076D N 95TH ST	MILWAUKEE, WI 53224
CURRENT OCCUPANT	8872D N 95TH ST	MILWAUKEE, WI 53224
CURRENT OCCUPANT	8941C N SWAN RD	MILWAUKEE, WI 53224
CURRENT OCCUPANT	9071L N 95TH ST	MILWAUKEE, WI 53224
CURRENT OCCUPANT	9031D N SWAN RD	MILWAUKEE, WI 53224
CURRENT OCCUPANT	9010L N 95TH ST	MILWAUKEE, WI 53224
CURRENT OCCUPANT	8848B N 95TH ST	MILWAUKEE, WI 53224
CURRENT OCCUPANT	9216 W BROWN DEER RD 1	MILWAUKEE, WI 53224
CURRENT OCCUPANT	9216 W BROWN DEER RD 11	MILWAUKEE, WI 53224
CURRENT OCCUPANT	9216 W BROWN DEER RD 9	MILWAUKEE, WI 53224
CURRENT OCCUPANT	9216 W BROWN DEER RD 10	MILWAUKEE, WI 53224
CURRENT OCCUPANT	9130 W BROWN DEER RD 12	MILWAUKEE, WI 53224
CURRENT OCCUPANT	8911H N SWAN RD	MILWAUKEE, WI 53224
CURRENT OCCUPANT	8884C N 95TH ST	MILWAUKEE, WI 53224
CURRENT OCCUPANT	8877H N SWAN RD	MILWAUKEE, WI 53224
CURRENT OCCUPANT	8842J N 95TH ST	MILWAUKEE, WI 53224
CURRENT OCCUPANT	8877E N SWAN RD	MILWAUKEE, WI 53224
CURRENT OCCUPANT	9050F N 95TH ST	MILWAUKEE, WI 53224
CURRENT OCCUPANT	8871H N SWAN RD	MILWAUKEE, WI 53224
CURRENT OCCUPANT	8827B N 95TH ST	MILWAUKEE, WI 53224
CURRENT OCCUPANT	8970H N 95TH ST	MILWAUKEE, WI 53224
CURRENT OCCUPANT	8930G N 95TH ST	MILWAUKEE, WI 53224
CURRENT OCCUPANT	9001K N SWAN RD	MILWAUKEE, WI 53224
CURRENT OCCUPANT	9096B N 95TH ST	MILWAUKEE, WI 53224
CURRENT OCCUPANT	8865D N SWAN RD	MILWAUKEE, WI 53224
CURRENT OCCUPANT	8911E N SWAN RD	MILWAUKEE, WI 53224
CURRENT OCCUPANT	9050B N 95TH ST	MILWAUKEE, WI 53224
CURRENT OCCUPANT	9061E N 95TH ST	MILWAUKEE, WI 53224
CURRENT OCCUPANT	8884E N 95TH ST	MILWAUKEE, WI 53224
CURRENT OCCUPANT	9060K N 95TH ST	MILWAUKEE, WI 53224

CURRENT OCCUPANT	9097E N 95TH ST	MILWAUKEE, WI 53224
CURRENT OCCUPANT	8970B N 95TH ST	MILWAUKEE, WI 53224
CURRENT OCCUPANT	9096F N 95TH ST	MILWAUKEE, WI 53224
CURRENT OCCUPANT	9261A W ALLYN ST	MILWAUKEE, WI 53224
CURRENT OCCUPANT	9221C W ALLYN ST	MILWAUKEE, WI 53224
CURRENT OCCUPANT	8853C N SWAN RD	MILWAUKEE, WI 53224
CURRENT OCCUPANT	8877B N SWAN RD	MILWAUKEE, WI 53224
CURRENT OCCUPANT	9010H N 95TH ST	MILWAUKEE, WI 53224
CURRENT OCCUPANT	8847C N SWAN RD	MILWAUKEE, WI 53224
CURRENT OCCUPANT	9010K N 95TH ST	MILWAUKEE, WI 53224
CURRENT OCCUPANT	8866J N 95TH ST	MILWAUKEE, WI 53224
CURRENT OCCUPANT	8990G N 95TH ST	MILWAUKEE, WI 53224
CURRENT OCCUPANT	8867F N 95TH ST	MILWAUKEE, WI 53224
CURRENT OCCUPANT	9125G W ALLYN ST	MILWAUKEE, WI 53224
CURRENT OCCUPANT	8883J N SWAN RD	MILWAUKEE, WI 53224
CURRENT OCCUPANT	9050D N 95TH ST	MILWAUKEE, WI 53224
CURRENT OCCUPANT	8931E N SWAN RD	MILWAUKEE, WI 53224
CURRENT OCCUPANT	8911E N 95TH ST	MILWAUKEE, WI 53224
CURRENT OCCUPANT	9281E W ALLYN ST	MILWAUKEE, WI 53224
CURRENT OCCUPANT	9010C N 95TH ST	MILWAUKEE, WI 53224
CURRENT OCCUPANT	9030H N 95TH ST	MILWAUKEE, WI 53224
CURRENT OCCUPANT	8950D N 95TH ST	MILWAUKEE, WI 53224
CURRENT OCCUPANT	8866H N 95TH ST	MILWAUKEE, WI 53224
CURRENT OCCUPANT	9325K W ALLYN ST	MILWAUKEE, WI 53224
CURRENT OCCUPANT	8860F N 95TH ST	MILWAUKEE, WI 53224
CURRENT OCCUPANT	8827A N 95TH ST	MILWAUKEE, WI 53224
CURRENT OCCUPANT	9031A N SWAN RD	MILWAUKEE, WI 53224
CURRENT OCCUPANT	9076E N 95TH ST	MILWAUKEE, WI 53224
CURRENT OCCUPANT	8884D N 95TH ST	MILWAUKEE, WI 53224
CURRENT OCCUPANT	8950E N 95TH ST	MILWAUKEE, WI 53224
CURRENT OCCUPANT	9086D N 95TH ST	MILWAUKEE, WI 53224
CURRENT OCCUPANT	9221K W ALLYN ST	MILWAUKEE, WI 53224
CURRENT OCCUPANT	9096D N 95TH ST	MILWAUKEE, WI 53224
CURRENT OCCUPANT	9125F W ALLYN ST	MILWAUKEE, WI 53224
CURRENT OCCUPANT	8848J N 95TH ST	MILWAUKEE, WI 53224
CURRENT OCCUPANT	8930B N 95TH ST	MILWAUKEE, WI 53224
CURRENT OCCUPANT	9061H N 95TH ST	MILWAUKEE, WI 53224
CURRENT OCCUPANT	8872B N 95TH ST	MILWAUKEE, WI 53224
CURRENT OCCUPANT	8827G N 95TH ST	MILWAUKEE, WI 53224
CURRENT OCCUPANT	8889B N SWAN RD	MILWAUKEE, WI 53224
CURRENT OCCUPANT	9020C N 95TH ST	MILWAUKEE, WI 53224
CURRENT OCCUPANT	8911F N 95TH ST	MILWAUKEE, WI 53224
CURRENT OCCUPANT	8950B N 95TH ST	MILWAUKEE, WI 53224
CURRENT OCCUPANT	8877K N SWAN RD	MILWAUKEE, WI 53224
CURRENT OCCUPANT	9061A N 95TH ST	MILWAUKEE, WI 53224
CURRENT OCCUPANT	8931B N SWAN RD	MILWAUKEE, WI 53224
CURRENT OCCUPANT	9061M N 95TH ST	MILWAUKEE, WI 53224

CURRENT OCCUPANT	9125B W ALLYN ST	MILWAUKEE, WI 53224
CURRENT OCCUPANT	9086B N 95TH ST	MILWAUKEE, WI 53224
CURRENT OCCUPANT	8854J N 95TH ST	MILWAUKEE, WI 53224
CURRENT OCCUPANT	8842F N 95TH ST	MILWAUKEE, WI 53224
CURRENT OCCUPANT	9051F N 95TH ST	MILWAUKEE, WI 53224
CURRENT OCCUPANT	9021K N SWAN RD	MILWAUKEE, WI 53224
CURRENT OCCUPANT	9060H N 95TH ST	MILWAUKEE, WI 53224
CURRENT OCCUPANT	9241H W ALLYN ST	MILWAUKEE, WI 53224
CURRENT OCCUPANT	9325D W ALLYN ST	MILWAUKEE, WI 53224
CURRENT OCCUPANT	8895A N SWAN RD	MILWAUKEE, WI 53224
CURRENT OCCUPANT	8827F N 95TH ST	MILWAUKEE, WI 53224
CURRENT OCCUPANT	9241A W ALLYN ST	MILWAUKEE, WI 53224
CURRENT OCCUPANT	9031B N SWAN RD	MILWAUKEE, WI 53224
CURRENT OCCUPANT	8895H N SWAN RD	MILWAUKEE, WI 53224
CURRENT OCCUPANT	9261K W ALLYN ST	MILWAUKEE, WI 53224
CURRENT OCCUPANT	8842A N 95TH ST	MILWAUKEE, WI 53224
CURRENT OCCUPANT	9216 W BROWN DEER RD 6	MILWAUKEE, WI 53224
CURRENT OCCUPANT	9130 W BROWN DEER RD 10	MILWAUKEE, WI 53224
CURRENT OCCUPANT	9130 W BROWN DEER RD 2	MILWAUKEE, WI 53224
CURRENT OCCUPANT	8835 N SWAN RD 6	MILWAUKEE, WI 53224
CURRENT OCCUPANT	8835 N SWAN RD 4	MILWAUKEE, WI 53224
CURRENT OCCUPANT	8835 N SWAN RD 9	MILWAUKEE, WI 53224
CURRENT OCCUPANT	9221J W ALLYN ST	MILWAUKEE, WI 53224
CURRENT OCCUPANT	8860B N 95TH ST	MILWAUKEE, WI 53224
CURRENT OCCUPANT	8871J N SWAN RD	MILWAUKEE, WI 53224
CURRENT OCCUPANT	8860H N 95TH ST	MILWAUKEE, WI 53224
CURRENT OCCUPANT	9031A N 95TH ST	MILWAUKEE, WI 53224
CURRENT OCCUPANT	8941F N SWAN RD	MILWAUKEE, WI 53224
CURRENT OCCUPANT	8866C N 95TH ST	MILWAUKEE, WI 53224
CURRENT OCCUPANT	8930H N 95TH ST	MILWAUKEE, WI 53224
CURRENT OCCUPANT	9001A N SWAN RD	MILWAUKEE, WI 53224
CURRENT OCCUPANT	8951D N 95TH ST	MILWAUKEE, WI 53224
CURRENT OCCUPANT	8872K N 95TH ST	MILWAUKEE, WI 53224
CURRENT OCCUPANT	9097C N 95TH ST	MILWAUKEE, WI 53224
CURRENT OCCUPANT	8847F N SWAN RD	MILWAUKEE, WI 53224
CURRENT OCCUPANT	9060C N 95TH ST	MILWAUKEE, WI 53224
CURRENT OCCUPANT	8950A N 95TH ST	MILWAUKEE, WI 53224
CURRENT OCCUPANT	9011B N 95TH ST	MILWAUKEE, WI 53224
CURRENT OCCUPANT	9021J N SWAN RD	MILWAUKEE, WI 53224
CURRENT OCCUPANT	8872J N 95TH ST	MILWAUKEE, WI 53224
CURRENT OCCUPANT	9261H W ALLYN ST	MILWAUKEE, WI 53224
CURRENT OCCUPANT	9030B N 95TH ST	MILWAUKEE, WI 53224
CURRENT OCCUPANT	8895B N SWAN RD	MILWAUKEE, WI 53224
CURRENT OCCUPANT	8836F N 95TH ST	MILWAUKEE, WI 53224
CURRENT OCCUPANT	9096K N 95TH ST	MILWAUKEE, WI 53224
CURRENT OCCUPANT	8895C N SWAN RD	MILWAUKEE, WI 53224
CURRENT OCCUPANT	8951A N 95TH ST	MILWAUKEE, WI 53224

CURRENT OCCUPANT	8865H N SWAN RD	MILWAUKEE, WI 53224
CURRENT OCCUPANT	9040A N 95TH ST	MILWAUKEE, WI 53224
CURRENT OCCUPANT	9325A W ALLYN ST	MILWAUKEE, WI 53224
CURRENT OCCUPANT	9241D W ALLYN ST	MILWAUKEE, WI 53224
CURRENT OCCUPANT	8921D N SWAN RD	MILWAUKEE, WI 53224
CURRENT OCCUPANT	8911G N 95TH ST	MILWAUKEE, WI 53224
CURRENT OCCUPANT	8853G N SWAN RD	MILWAUKEE, WI 53224
CURRENT OCCUPANT	8941K N SWAN RD	MILWAUKEE, WI 53224
CURRENT OCCUPANT	8889C N SWAN RD	MILWAUKEE, WI 53224
CURRENT OCCUPANT	8889H N SWAN RD	MILWAUKEE, WI 53224
CURRENT OCCUPANT	8921J N SWAN RD	MILWAUKEE, WI 53224
CURRENT OCCUPANT	9125H W ALLYN ST	MILWAUKEE, WI 53224
CURRENT OCCUPANT	9097B N 95TH ST	MILWAUKEE, WI 53224
CURRENT OCCUPANT	8901G N SWAN RD	MILWAUKEE, WI 53224
CURRENT OCCUPANT	8872A N 95TH ST	MILWAUKEE, WI 53224
CURRENT OCCUPANT	8931D N SWAN RD	MILWAUKEE, WI 53224
CURRENT OCCUPANT	8930E N 95TH ST	MILWAUKEE, WI 53224
CURRENT OCCUPANT	8866G N 95TH ST	MILWAUKEE, WI 53224
CURRENT OCCUPANT	8848K N 95TH ST	MILWAUKEE, WI 53224
CURRENT OCCUPANT	8990A N 95TH ST	MILWAUKEE, WI 53224
CURRENT OCCUPANT	8910F N 95TH ST	MILWAUKEE, WI 53224
CURRENT OCCUPANT	8921C N SWAN RD	MILWAUKEE, WI 53224
CURRENT OCCUPANT	8910J N 95TH ST	MILWAUKEE, WI 53224
CURRENT OCCUPANT	8951J N 95TH ST	MILWAUKEE, WI 53224
CURRENT OCCUPANT	8841C N SWAN RD	MILWAUKEE, WI 53224
CURRENT OCCUPANT	8970F N 95TH ST	MILWAUKEE, WI 53224
CURRENT OCCUPANT	8841E N SWAN RD	MILWAUKEE, WI 53224
CURRENT OCCUPANT	8941H N SWAN RD	MILWAUKEE, WI 53224
CURRENT OCCUPANT	8911F N SWAN RD	MILWAUKEE, WI 53224
CURRENT OCCUPANT	9050E N 95TH ST	MILWAUKEE, WI 53224
CURRENT OCCUPANT	9261E W ALLYN ST	MILWAUKEE, WI 53224
CURRENT OCCUPANT	9071A N 95TH ST	MILWAUKEE, WI 53224
CURRENT OCCUPANT	8921A N SWAN RD	MILWAUKEE, WI 53224
CURRENT OCCUPANT	9020G N 95TH ST	MILWAUKEE, WI 53224
CURRENT OCCUPANT	9281B W ALLYN ST	MILWAUKEE, WI 53224
CURRENT OCCUPANT	8841A N SWAN RD	MILWAUKEE, WI 53224
CURRENT OCCUPANT	8950F N 95TH ST	MILWAUKEE, WI 53224
CURRENT OCCUPANT	9061J N 95TH ST	MILWAUKEE, WI 53224
CURRENT OCCUPANT	9236 W BROWN DEER RD 4	MILWAUKEE, WI 53224
CURRENT OCCUPANT	9236 W BROWN DEER RD 2	MILWAUKEE, WI 53224
CURRENT OCCUPANT	9236 W BROWN DEER RD 6	MILWAUKEE, WI 53224
CURRENT OCCUPANT	9236 W BROWN DEER RD 7	MILWAUKEE, WI 53224
CURRENT OCCUPANT	8835 N SWAN RD 10	MILWAUKEE, WI 53224
CURRENT OCCUPANT	8835 N SWAN RD 11	MILWAUKEE, WI 53224
CURRENT OCCUPANT	8835 N SWAN RD 12	MILWAUKEE, WI 53224
CURRENT OCCUPANT	8847A N SWAN RD	MILWAUKEE, WI 53224
CURRENT OCCUPANT	8970G N 95TH ST	MILWAUKEE, WI 53224

CURRENT OCCUPANT	9021G N SWAN RD	MILWAUKEE, WI 53224
CURRENT OCCUPANT	9020D N 95TH ST	MILWAUKEE, WI 53224
CURRENT OCCUPANT	9086H N 95TH ST	MILWAUKEE, WI 53224
CURRENT OCCUPANT	9001B N SWAN RD	MILWAUKEE, WI 53224
CURRENT OCCUPANT	9051E N 95TH ST	MILWAUKEE, WI 53224
CURRENT OCCUPANT	9001M N SWAN RD	MILWAUKEE, WI 53224
CURRENT OCCUPANT	9001G N SWAN RD	MILWAUKEE, WI 53224
CURRENT OCCUPANT	9061K N 95TH ST	MILWAUKEE, WI 53224
CURRENT OCCUPANT	8931C N SWAN RD	MILWAUKEE, WI 53224
CURRENT OCCUPANT	9221B W ALLYN ST	MILWAUKEE, WI 53224
CURRENT OCCUPANT	9040G N 95TH ST	MILWAUKEE, WI 53224
CURRENT OCCUPANT	9031B N 95TH ST	MILWAUKEE, WI 53224
CURRENT OCCUPANT	8854C N 95TH ST	MILWAUKEE, WI 53224
CURRENT OCCUPANT	8867J N 95TH ST	MILWAUKEE, WI 53224
CURRENT OCCUPANT	9221D W ALLYN ST	MILWAUKEE, WI 53224
CURRENT OCCUPANT	8867A N 95TH ST	MILWAUKEE, WI 53224
CURRENT OCCUPANT	9011G N SWAN RD	MILWAUKEE, WI 53224
CURRENT OCCUPANT	9051B N 95TH ST	MILWAUKEE, WI 53224
CURRENT OCCUPANT	8865G N SWAN RD	MILWAUKEE, WI 53224
CURRENT OCCUPANT	9097G N 95TH ST	MILWAUKEE, WI 53224
CURRENT OCCUPANT	8883K N SWAN RD	MILWAUKEE, WI 53224
CURRENT OCCUPANT	8901J N SWAN RD	MILWAUKEE, WI 53224
CURRENT OCCUPANT	8951G N 95TH ST	MILWAUKEE, WI 53224
CURRENT OCCUPANT	8970C N 95TH ST	MILWAUKEE, WI 53224
CURRENT OCCUPANT	9040H N 95TH ST	MILWAUKEE, WI 53224
CURRENT OCCUPANT	9125D W ALLYN ST	MILWAUKEE, WI 53224
CURRENT OCCUPANT	9071J N 95TH ST	MILWAUKEE, WI 53224
CURRENT OCCUPANT	9050G N 95TH ST	MILWAUKEE, WI 53224
CURRENT OCCUPANT	8859K N SWAN RD	MILWAUKEE, WI 53224
CURRENT OCCUPANT	8853D N SWAN RD	MILWAUKEE, WI 53224
CURRENT OCCUPANT	8990H N 95TH ST	MILWAUKEE, WI 53224
CURRENT OCCUPANT	8895D N SWAN RD	MILWAUKEE, WI 53224
CURRENT OCCUPANT	9040D N 95TH ST	MILWAUKEE, WI 53224
CURRENT OCCUPANT	8853H N SWAN RD	MILWAUKEE, WI 53224
CURRENT OCCUPANT	8867E N 95TH ST	MILWAUKEE, WI 53224
CURRENT OCCUPANT	9030A N 95TH ST	MILWAUKEE, WI 53224
CURRENT OCCUPANT	8871D N SWAN RD	MILWAUKEE, WI 53224
CURRENT OCCUPANT	8872G N 95TH ST	MILWAUKEE, WI 53224
CURRENT OCCUPANT	9261D W ALLYN ST	MILWAUKEE, WI 53224
CURRENT OCCUPANT	9011F N 95TH ST	MILWAUKEE, WI 53224
CURRENT OCCUPANT	8842D N 95TH ST	MILWAUKEE, WI 53224
CURRENT OCCUPANT	9050K N 95TH ST	MILWAUKEE, WI 53224
CURRENT OCCUPANT	9051C N 95TH ST	MILWAUKEE, WI 53224
CURRENT OCCUPANT	9030K N 95TH ST	MILWAUKEE, WI 53224
CURRENT OCCUPANT	8866K N 95TH ST	MILWAUKEE, WI 53224
CURRENT OCCUPANT	9261J W ALLYN ST	MILWAUKEE, WI 53224
CURRENT OCCUPANT	8911C N SWAN RD	MILWAUKEE, WI 53224

CURRENT OCCUPANT	9325B W ALLYN ST	MILWAUKEE, WI 53224
CURRENT OCCUPANT	9001E N SWAN RD	MILWAUKEE, WI 53224
CURRENT OCCUPANT	9011D N SWAN RD	MILWAUKEE, WI 53224
CURRENT OCCUPANT	9040K N 95TH ST	MILWAUKEE, WI 53224
CURRENT OCCUPANT	8842C N 95TH ST	MILWAUKEE, WI 53224
CURRENT OCCUPANT	8951F N 95TH ST	MILWAUKEE, WI 53224
CURRENT OCCUPANT	9051A N 95TH ST	MILWAUKEE, WI 53224
CURRENT OCCUPANT	9040E N 95TH ST	MILWAUKEE, WI 53224
CURRENT OCCUPANT	8889A N SWAN RD	MILWAUKEE, WI 53224
CURRENT OCCUPANT	8860C N 95TH ST	MILWAUKEE, WI 53224
CURRENT OCCUPANT	9060F N 95TH ST	MILWAUKEE, WI 53224
CURRENT OCCUPANT	8848F N 95TH ST	MILWAUKEE, WI 53224
CURRENT OCCUPANT	9030D N 95TH ST	MILWAUKEE, WI 53224
CURRENT OCCUPANT	9325J W ALLYN ST	MILWAUKEE, WI 53224
CURRENT OCCUPANT	9281H W ALLYN ST	MILWAUKEE, WI 53224
CURRENT OCCUPANT	9241K W ALLYN ST	MILWAUKEE, WI 53224
CURRENT OCCUPANT	9011F N SWAN RD	MILWAUKEE, WI 53224
CURRENT OCCUPANT	9040C N 95TH ST	MILWAUKEE, WI 53224
CURRENT OCCUPANT	9031C N 95TH ST	MILWAUKEE, WI 53224
CURRENT OCCUPANT	8950G N 95TH ST	MILWAUKEE, WI 53224
CURRENT OCCUPANT	8931A N SWAN RD	MILWAUKEE, WI 53224
CURRENT OCCUPANT	8990F N 95TH ST	MILWAUKEE, WI 53224
CURRENT OCCUPANT	8859E N SWAN RD	MILWAUKEE, WI 53224
CURRENT OCCUPANT	9216 W BROWN DEER RD 12	MILWAUKEE, WI 53224
CURRENT OCCUPANT	9130 W BROWN DEER RD 7	MILWAUKEE, WI 53224
CURRENT OCCUPANT	9130 W BROWN DEER RD 1	MILWAUKEE, WI 53224
CURRENT OCCUPANT	9130 W BROWN DEER RD 5	MILWAUKEE, WI 53224
CURRENT OCCUPANT	9130 W BROWN DEER RD 4	MILWAUKEE, WI 53224
CURRENT OCCUPANT	8878C N 95TH ST	MILWAUKEE, WI 53224
CURRENT OCCUPANT	9011E N SWAN RD	MILWAUKEE, WI 53224
CURRENT OCCUPANT	8867K N 95TH ST	MILWAUKEE, WI 53224
CURRENT OCCUPANT	9071M N 95TH ST	MILWAUKEE, WI 53224
CURRENT OCCUPANT	9010E N 95TH ST	MILWAUKEE, WI 53224
CURRENT OCCUPANT	8921B N SWAN RD	MILWAUKEE, WI 53224
CURRENT OCCUPANT	8847H N SWAN RD	MILWAUKEE, WI 53224
CURRENT OCCUPANT	9001H N SWAN RD	MILWAUKEE, WI 53224
CURRENT OCCUPANT	8848A N 95TH ST	MILWAUKEE, WI 53224
CURRENT OCCUPANT	8970K N 95TH ST	MILWAUKEE, WI 53224
CURRENT OCCUPANT	8865A N SWAN RD	MILWAUKEE, WI 53224
CURRENT OCCUPANT	9031K N 95TH ST	MILWAUKEE, WI 53224
CURRENT OCCUPANT	9030G N 95TH ST	MILWAUKEE, WI 53224
CURRENT OCCUPANT	8884G N 95TH ST	MILWAUKEE, WI 53224
CURRENT OCCUPANT	8842G N 95TH ST	MILWAUKEE, WI 53224
CURRENT OCCUPANT	9011L N SWAN RD	MILWAUKEE, WI 53224
CURRENT OCCUPANT	8883E N SWAN RD	MILWAUKEE, WI 53224
CURRENT OCCUPANT	9011K N SWAN RD	MILWAUKEE, WI 53224
CURRENT OCCUPANT	8836C N 95TH ST	MILWAUKEE, WI 53224

CURRENT OCCUPANT	9086J N 95TH ST	MILWAUKEE, WI 53224
CURRENT OCCUPANT	8910C N 95TH ST	MILWAUKEE, WI 53224
CURRENT OCCUPANT	9051H N 95TH ST	MILWAUKEE, WI 53224
CURRENT OCCUPANT	8911B N 95TH ST	MILWAUKEE, WI 53224
CURRENT OCCUPANT	9097A N 95TH ST	MILWAUKEE, WI 53224
CURRENT OCCUPANT	9010F N 95TH ST	MILWAUKEE, WI 53224
CURRENT OCCUPANT	8895E N SWAN RD	MILWAUKEE, WI 53224
CURRENT OCCUPANT	8941B N SWAN RD	MILWAUKEE, WI 53224
CURRENT OCCUPANT	8848E N 95TH ST	MILWAUKEE, WI 53224
CURRENT OCCUPANT	9071G N 95TH ST	MILWAUKEE, WI 53224
CURRENT OCCUPANT	9325C W ALLYN ST	MILWAUKEE, WI 53224
CURRENT OCCUPANT	8884J N 95TH ST	MILWAUKEE, WI 53224
CURRENT OCCUPANT	8859F N SWAN RD	MILWAUKEE, WI 53224
CURRENT OCCUPANT	9221M W ALLYN ST	MILWAUKEE, WI 53224
CURRENT OCCUPANT	8950H N 95TH ST	MILWAUKEE, WI 53224
CURRENT OCCUPANT	9076G N 95TH ST	MILWAUKEE, WI 53224
CURRENT OCCUPANT	8901C N SWAN RD	MILWAUKEE, WI 53224
CURRENT OCCUPANT	9051G N 95TH ST	MILWAUKEE, WI 53224
CURRENT OCCUPANT	9031E N 95TH ST	MILWAUKEE, WI 53224
CURRENT OCCUPANT	9020A N 95TH ST	MILWAUKEE, WI 53224
CURRENT OCCUPANT	8867H N 95TH ST	MILWAUKEE, WI 53224
CURRENT OCCUPANT	8867G N 95TH ST	MILWAUKEE, WI 53224
CURRENT OCCUPANT	9221G W ALLYN ST	MILWAUKEE, WI 53224
CURRENT OCCUPANT	9096C N 95TH ST	MILWAUKEE, WI 53224
CURRENT OCCUPANT	9097D N 95TH ST	MILWAUKEE, WI 53224
CURRENT OCCUPANT	8860J N 95TH ST	MILWAUKEE, WI 53224
CURRENT OCCUPANT	8883G N SWAN RD	MILWAUKEE, WI 53224
CURRENT OCCUPANT	9031F N SWAN RD	MILWAUKEE, WI 53224
CURRENT OCCUPANT	8951H N 95TH ST	MILWAUKEE, WI 53224
CURRENT OCCUPANT	9030C N 95TH ST	MILWAUKEE, WI 53224
CURRENT OCCUPANT	9261F W ALLYN ST	MILWAUKEE, WI 53224
CURRENT OCCUPANT	8911A N 95TH ST	MILWAUKEE, WI 53224
CURRENT OCCUPANT	9031G N 95TH ST	MILWAUKEE, WI 53224
CURRENT OCCUPANT	9281D W ALLYN ST	MILWAUKEE, WI 53224
CURRENT OCCUPANT	9030J N 95TH ST	MILWAUKEE, WI 53224
CURRENT OCCUPANT	9010J N 95TH ST	MILWAUKEE, WI 53224
CURRENT OCCUPANT	9011C N SWAN RD	MILWAUKEE, WI 53224
CURRENT OCCUPANT	9061G N 95TH ST	MILWAUKEE, WI 53224
CURRENT OCCUPANT	8921F N SWAN RD	MILWAUKEE, WI 53224
CURRENT OCCUPANT	9050H N 95TH ST	MILWAUKEE, WI 53224
CURRENT OCCUPANT	9050C N 95TH ST	MILWAUKEE, WI 53224
CURRENT OCCUPANT	9125J W ALLYN ST	MILWAUKEE, WI 53224
CURRENT OCCUPANT	8970E N 95TH ST	MILWAUKEE, WI 53224
CURRENT OCCUPANT	8842H N 95TH ST	MILWAUKEE, WI 53224
CURRENT OCCUPANT	8901D N SWAN RD	MILWAUKEE, WI 53224
CURRENT OCCUPANT	8921H N SWAN RD	MILWAUKEE, WI 53224
CURRENT OCCUPANT	8859G N SWAN RD	MILWAUKEE, WI 53224

CURRENT OCCUPANT	9011G N 95TH ST	MILWAUKEE, WI 53224
CURRENT OCCUPANT	9086E N 95TH ST	MILWAUKEE, WI 53224
CURRENT OCCUPANT	9216 W BROWN DEER RD 4	MILWAUKEE, WI 53224
CURRENT OCCUPANT	9216 W BROWN DEER RD 5	MILWAUKEE, WI 53224
CURRENT OCCUPANT	9130 W BROWN DEER RD 6	MILWAUKEE, WI 53224
CURRENT OCCUPANT	9130 W BROWN DEER RD 9	MILWAUKEE, WI 53224
CURRENT OCCUPANT	9130 W BROWN DEER RD 8	MILWAUKEE, WI 53224
CURRENT OCCUPANT	8835 N SWAN RD 3	MILWAUKEE, WI 53224
CURRENT OCCUPANT	9031G N SWAN RD	MILWAUKEE, WI 53224
CURRENT OCCUPANT	9031C N SWAN RD	MILWAUKEE, WI 53224

Total Records: 620

Radius: 250.0 feet and Center of Circle: 9110 W Brown Deer Rd



BUSINESS LICENSE PLAN OF OPERATION

ccl-busplan 3/15/18

Office of the City Clerk License Division
200 E. Wells St. Room 105, Milwaukee, WI 53202
(414) 286-2238 www.milwaukee.gov/license e-mail address: license@milwaukee.gov

1. Type of Business

Applying for: ☐ Extended Hours (12AM to 5AM) - If a food establishment, check all that apply: ☐ Delivery ☐ Drive Thru ☐ Dining Room
☐ Self Service Laundry ☐ Massage Establishment ☐ Filling Station
☒ Other (supplemental application for specific license also required)

Provide a detailed description of the type of business you plan on operating:

2nd hand license

Do you have any experience operating this type of business? ☒ No ☐ Yes If yes, explain:

2. Business Operations

- a. Proposed Opening Date: 03/1/19
- b. Is this premise under construction? ☒ No ☐ Yes If yes, list estimated completion date: _____
- c. Is this a franchise? ☒ No ☐ Yes
- d. Is this premises currently licensed? ☐ No ☒ Yes If yes, list type of license: tobacco, and retail
- e. Is the current licensee operating? ☒ No ☐ Yes If no, list date closed: _____
- f. Do you have future plans for other businesses, licenses or permits at this location? ☒ No ☐ Yes
If yes, explain: _____
- g. Have you previously held an Extended Hours License in Milwaukee? ☒ No ☐ Yes
If yes, list address(es): _____
- h. Are other businesses operating in the same building? ☐ No ☒ Yes If yes, describe: Liquor, grocery, Restaurant

3. Litter & Noise

- a. How are grounds kept clean? ☒ Sweep ☐ Pressure Wash ☐ Pick Up Litter ☐ Other: _____
- b. How often will grounds be cleaned? ☒ Daily ☐ Weekly ☐ As Needed ☐ Monthly ☐ Other: _____
- c. Grounds cleaned by: ☐ Licensee ☐ Building Owner ☒ Employees ☒ Hired Maintenance ☐ Other: _____
- d. How are noise issues prevented and/or addressed? ☒ Security ☒ Manager approaches customer(s) ☒ Call Police
☐ Signs Posted ☐ Other: _____
- e. Will a sound amplification system be used? ☐ No ☒ Yes If yes, describe: Speakers

4. Smoking & Sanitation

- a. Are there designated outdoor smoking areas? ☒ No ☐ Yes If yes, describe: _____
- b. Number of Garbage Cans: Inside: 2 Locations: By Counter, and By the Front door
Outside: _____ Locations: By the In Front of every Business
- c. Is a crowd control barrier used? ☒ No ☐ Yes If yes, describe: _____
- d. How many restrooms are on the premises? 1
- e. Name of solid waste contractor: ☐ Advanced Disposal ☒ Waste Management ☐ Other: _____

5. Security

- a. Are there onsite parking spaces? ☐ No ☒ Yes If yes, how many? 35 and describe the parking security plan: in front of door Reserved spots
- b. Is there a loading zone? ☒ No ☐ Yes If yes, describe the loading area security plan: _____
- c. Will you have security personnel on premise? ☐ No ☒ Yes If yes, how many? 1 and answer the following:
What are their responsibilities? watch the building
Is security equipment used? ☒ No ☒ Yes If yes, describe gun, AA guns, tazer,
List their licensing, certification, or training credentials _____
- d. Will there be security cameras? ☐ No ☒ Yes If yes, how many? 5 and list locations: 915 and brown
All corners and By register
- e. Will searches/identification checks be done upon entry? ☒ No ☐ Yes If yes, describe _____

6. Percentage of Sales (must total 100%)

Alcohol <u>0</u> %	Food <u>0</u> %	Secondhand Merchandise <u>30</u> %	Precious Metals & Gems <u>0</u> %
Entertainment <u>0</u> %	Cigarettes <u>5</u> %		
Pawnbroker Activity <u>0</u> %	Salvaged Materials <u>0</u> % (such as scrap metal)	Personal Services (such as tattoo, body piercing, salon, tailor, tanning, etc.) <u>10</u> %	Other <u>60 65</u> % Describe: <u>cellphones</u>

7. Businesses/Licenses on the Premises (check all that apply):

Type 1

- ☐ Full Service Restaurant ☐ Cafe/Coffee Shop ☐ Deli or Fast Food Restaurant ☐ Private/Fraternal/Veterans Club
- ☐ Night Club ☐ Tavern ☐ Cocktail Lounge ☐ Teen Club
- ☐ Banquet Hall ☐ Sports Facility ☐ Bowling Alley
- ☐ Hotel/Motel : Number of Floors: _____ Number of Rooms: _____
☐ Rooming House: Number of Floors: _____ Number of Rooms: _____

Type 2

- ☐ Liquor Store ☐ Corner Store ☐ Supermarket ☐ Convenience Store
- ☐ Gas Station ☐ Amusement/Phonograph Distributor ☐ Recycling, Salvage or Towing
- ☐ Used Car Dealer ☐ Personal Service Establishment (such as tattoo business, hair salon, tailor, etc.) ☐ Recording Studio

What other licenses/permits will you hold at this location? (check all that apply)

- ☒ Occupancy Permit ☒ Cigarette & Tobacco ☐ Gas Station ☐ Extended Hours ☐ Class "B" Tavern ☐ Weights & Measures
- ☐ Secondhand Dealer ☐ Precious Metal & Gem ☒ Other: Retail

8. Legal Capacity (only if a Type 1 premises in #7 above)

Capacity _____ (Call the Milwaukee Development Center at 414-286-8211 if you have questions.)

9. Premises Description

a. Identify all area(s) of the premises that will be used in operating this business (include areas used only for storage):

☒ 1st Floor ☐ 2nd Floor ☐ Basement Storage ☐ Patio ☐ Beer Garden ☐ Sidewalk Café ☐ Deck ☐ Rooftop

☐ Other: Describe: _____

b. Describe Location: ☒ Major Thoroughfare ☐ Secondary Street ☐ Other: _____

c. Nearest Major Cross Street: Brown Deer Rd

d. Describe Building: ☐ Free Standing Building ☒ Strip Mall ☐ Other: _____

e. Describe Premises Structure: ☒ Single Story ☐ Multi-Story - # of Stories _____ ☐ Other: _____

f. Describe Surrounding Area: ☒ Commercial ☐ Residential ☐ Industrial ☐ Other: _____

g. Building Owner Name: Vipen Mula Kashmi Phone Number: 414 288 1670

Business Owner Address: 9108 W Brown Deer Rd Milwaukee WI, 53224

10. Hours of Operation & Customers

Will customers be entering the premises? ☐ No ☐ Yes

Day of the Week	Proposed Hours of Operation:		Estimated Number of Customers expected each day	Potential Age Range of Customers	Class B Tavern Applicant Only: Age Restriction (If none, write 'None')
	Open Time (include a.m. or p.m.)	Close Time (include a.m. or p.m.)			
Sunday	11 am	5 pm	80 20	20-40	None
Monday	9 am	8 pm	60	20-40	None
Tuesday	9 am	8 pm	60	20-40	None
Wednesday	9 am	8 pm	80	20-40	None
Thursday	9 am	8 pm	80	20-40	None
Friday	9 am	8 pm	800	20-40	None
Saturday	10 am	8 pm	100	20-40	None

An Extended Hours Establishment License is required for any convenience store, filling station, personal service establishment (such as tattoo, body piercing, salon, tailor, tanning, etc.), recording studio or restaurant which is open between the hours of 12:00 a.m. and 5:00 a.m.

Alcohol Establishments Class A: 8:00 am to 9:00 pm Sunday thru Saturday
Permitted Hours of Operation: Class B: 6:00 am to 2:00 am Sunday thru Thursday, 6:00 am to 2:30 am Friday & Saturday

Entertainment Outdoor Closing Hours: 10:00pm Sunday-Thursday; 12:00am Friday & Saturday; unless a different time, either earlier or later, is established by the Common Council in its approval of the licensee's plan of operation.

11. Signature(s)

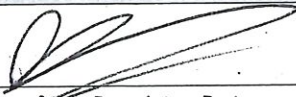
Signature of Sole Proprietor, Partner, or 20% or more Shareholder
(If there are no 20% or more shareholders,
Corporate Officer-print name/title and sign)

Signature of additional partner or 20% or more shareholder

See Application Information for a complete list of all required application forms.



SECONDHAND DEALER LICENSE SUPPLEMENTAL PLAN OF OPERATION

ccl-shdpla 12/12/17

Office of the City Clerk License Division
200 E. Wells St. Room 105, Milwaukee, WI 53202
(414) 286-2238 e-mail: license@milwaukee.gov

Legal Entity Name: Extreme Wireless 8 gifts LLC

Premises Address: 9110 W. Brown Deer Rd Milwaukee WI 53226

What type of license are you applying for? (check one)

☒ Secondhand Dealer ☐ Secondhand Dealer-Bicycles Only ☐ Secondhand Dealer Mail

INDIVIDUAL, ALL PARTNERS, OR AGENT OF CORP/LLC

Place of birth: ☐ WI ☒ Other: ND

Have you been living in Wisconsin for at least 90 days prior to filing this application?

☐ No If no, you are not eligible to apply for this license at this time. Per MCO 92-2-5-c, the individual, both partners, or agent of a corporation or limited liability company must be a resident of the state of Wisconsin for at least 90 days before the date of application.

☒ Yes If yes, list all address(es) where you lived within the last year:

☒ Current Address Only

☐ Other: _____

MERCHANDISE & SALES

List all items you will be selling:

Boost mobile, used phones, tablets, iPads, speakers

Will a scale be used for items being sold by weight (price per pound, ounce, gram, etc.)?

☒ No ☒ Yes
☒ No ☒ Yes

Will a barcode scanner be used to determine the price of items?

If yes to either question, a Weights & Measures License is also required.

An application can be obtained from www.milwaukee.gov/license or by contacting our office.

MANAGER OF BUSINESS

☒ Same as individual, partner, or agent of corporation/limited liability company

☐ Other: Name: _____ Date of Birth: _____

Address (include, city, state, zip code): _____

LIST ANY OTHER LICENSES YOU HOLD AT THIS ADDRESS AND THE STATUS

☒ Occupancy Permit

☒ Active ☐ Suspended

☐ Other: _____

☒ Wisconsin State Seller's Permit

☒ Active ☐ Suspended

☐ Other: _____

☐ Other(s): _____

☐ Active ☐ Suspended

☐ Other: _____

SECURITY

What are your plans to provide security for business records?

☒ Kept in safe ☐ Kept in locked cabinet ☐ Other: _____

What are your plans to ensure that business is not conducted with minors?

☒ Check ID ☐ Other: _____

ANNUAL SALES

What is your estimated sales volume for the calendar year in US Dollars?

\$ 120,000.00

AFFIRMATION OF UNDERSTANDING – REGULATIONS

Read and initial each item confirming your understanding:

1. AA I understand no purchase or exchange of any property may be made without obtaining the seller's identification information, as stipulated in 92-11 of the Milwaukee Code of Ordinances (MCO).
2. AA I understand no item may be received with an altered or obliterated serial number.
3. AA I understand description records of any item purchased or exchanged must be maintained as stipulated in 92-12 of the MCO.
4. AA I understand that each transaction description record must be reported as stipulated in 92-13 of the MCO, including color photographs and color video recordings as required in 92-12-3 MCO.
5. AA I understand that every item purchased or exchanged must be available for inspection by the police department at any reasonable time.
6. AA I understand that every item exchanged or purchased or accepted on consignment must be kept on the dealer's premises separate and apart from any other property, unchanged and unaltered, for 10 days for inspection by the police department; additional holding periods may be requested by the department.
7. AA I understand that the police may extend the 10 day holding period if there is reason to believe that the item purchased or exchanged was not sold or exchanged by the rightful owner.
8. AA I understand that no transactions may be conducted with a minor less than 18 years of age unless the minor is with a parent or guardian, or the dealer has a written consent on file signed in the dealer's presence by the parent or guardian.
9. AA I understand secondhand dealer must report to the police department any item presented in the course of business if there is reason to believe the item was stolen.

REQUIRED SIGNATURE(S)

I understand that a NEWPRS account (a database to manage and store purchase information) must be obtained prior to operating and utilized for all business transactions.

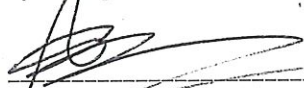

Signature of Sole Proprietor, Partner, or 20% or more Shareholder (If there are no 20% or more shareholders, Corporate Officer-print name/title and sign)

Signature of additional partner(s) or 20% or more shareholder(s)

**SUBMIT THIS FORM ALONG WITH THE
BUSINESS LICENSE APPLICATION & BUSINESS LICENSE PLAN OF OPERATION**

Office Use Only:

Initials	Filed	App #	Paid
<input type="checkbox"/> Q to MPD	<input type="checkbox"/> Q to DNS	LC Required	ReQ to LIU after LC
CC Required	LIU Approval (NEWPRS)	Issued 1yr/Bikes Only 2yr	License #



**CITY OF MILWAUKEE
OFFICE OF THE CITY CLERK**

Friday, May 03, 2019

COMMITTEE MEETING NOTICE

AD 09

HILL, Joyce, Agent
Retox Martini Lounge LLC
8555 N SERVITE DR
Milwaukee, WI 53223

You are requested to attend a hearing which is to be held in Room 301-B, Third Floor, City Hall on:

Tuesday, May 14, 2019 at 10:00 AM

Regarding: Your Alcohol and Food - Permanent Extension of Premise License Applications Adding 6905 W. Brown Deer Rd. as agent for "Retox Martini Lounge LLC" for "Retox Martini Lounge" at 6901 W Brown Deer Rd.

There is a possibility that your application may be denied  one or more of the following reasons: you do not meet the statutory and municipal requirements; the fitness and appropriateness of the location to be licensed and whether the location will create undesirable neighborhood problems (such as disorderly congregations of people, excessive litter, unreasonable noise, and traffic and parking problems), whether or not there is an over-concentration of alcohol beverage establishments in the neighborhood; whether or not you have been charged with or convicted of any felony, misdemeanor, municipal offense or other offense, the circumstances of which substantially relate to the licensed activity; and any other factors which reasonably relate to the public health, safety and welfare. See attached police report and/or written correspondence regarding this application. Please be advised the public will be able to provide information to the committee in person or in writing. The committee will receive and consider evidence regarding the above mentioned criteria.

**Notice for applicants with
warrants or unpaid fines:**

Proof of warrant satisfaction or payment of fines must be submitted at the hearing on the above date and time. Failure to comply with this requirement may result in a delay of the granting/denial of your application.

Failure to appear at this meeting may result in the denial of your license. Individual applicants must appear only in person or by an attorney. Corporate or Limited Liability applicants must appear only by the agent designated on the application or by an attorney. Partnership applicants must appear by a partner listed on the application or by an attorney. If you wish to do so and at your own expense, you may be accompanied by an attorney of your choosing to represent you at this hearing.

You will be given an opportunity to speak on behalf of the application and to respond and challenge any charges or reasons given for the denial. No petitions can be accepted by the committee, unless the people who signed the petition are present at the committee hearing and willing to testify. You may present witnesses under oath and you may also confront and cross-examine opposing witnesses under oath. If you have difficulty with the English language, you should bring an interpreter with you, at your expense, so that you can answer questions and participate in your hearing.

You may examine the application file at this office during regular business hours prior to the hearing date. Inquiries regarding this matter may be directed to the person whose signature appears below.

Limited parking for persons attending meetings in City Hall is available at reduced rates (5 hour limit) at the Milwaukee Center on the southwest corner of East Kilbourn and North Water Street. Parking tickets must be validated in the first floor information booth in City Hall.

PLEASE NOTE: Upon reasonable notice, efforts will be made to accommodate the needs of disabled individuals through sign language interpreters or other auxiliary aids. For additional information or to request this service, contact the Council Services Division ADA Coordinator at (414) 286-2998, Fax - (414) 286-3456, TDD - (414) 286-2025.

JIM OW CZARSKI, CITY CLERK

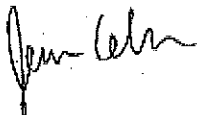

BY:

Jessica Celella
License Division Manager

If you have questions regarding this notice, please contact the License Division at (414) 286-2238.



Friday, May 03, 2019

Licenses Committee Notice of Hearing

SEQUOIA BACELINE LLC
1391 SPEER BL #800
DENVER, CO 80204

Date: 5/14/2019
Time: 10:00 AM
Location: Room 301-B, Third Floor, City Hall

The Licenses Committee will consider the following license application:

Alcohol and Food - Permanent Extension of Premise License Applications Adding
6905 W. Brown Deer Rd.
HILL, Joyce, Agent
Retox Martini Lounge at 6901 W Brown Deer Rd

Please note this application may be recommended for denial based on fitness of the location due to concentration of Alcohol and Food - Permanent Extension of Premise License Applications Adding 6905 W. Brown Deer Rd. in the area. If the application is denied for this reason, no other application for a Alcohol and Food - Permanent Extension of Premise License Applications Adding 6905 W. Brown Deer Rd. license for this location shall be recommended for approval by the Licenses Committee within three years of the date of denial unless the applicant has demonstrated a change of circumstances since the prior denial.

If you have any questions, please call (414) 286-2238.





Friday, May 03, 2019



Notice of Public Hearing

HILL, Joyce, Agent
Retox Martini Lounge at 6901 W Brown Deer Rd
Alcohol and Food - Permanent Extension of Premise License Applications Adding 6905 W. Brown Deer Rd.

Tuesday, May 14, 2019 at 10:00 AM

To whom it may concern:

The above application has been made by the above named applicant(s). This requires approval from the Licenses Committee and the Common Council of the City of Milwaukee. The hearing before the Licenses Committee will take place on 5/14/2019 at 10:00 AM, in Room 301-B, Third Floor, City Hall. If you wish, you may provide testimony at the hearing regarding the request; see below for further information. You are not required to attend the hearing. Once the Licenses Committee makes its recommendation, this recommendation is forwarded to the full Common Council for approval at its next regularly scheduled hearing. Please review the information below and if you have further questions regarding this process, please contact the License Division at (414) 286-2238.

Important details for those wishing to provide information for the Licenses Committee to consider when making its recommendation:

1. The license application is scheduled to be heard at the above time. Due to other hearings running longer than scheduled, you may have to wait some time to provide your testimony.
2. You must appear in person and testify as to matters that you have personally experienced or seen. (You cannot provide testimony for your neighbor, parent or anyone else; this is considered hearsay and cannot be considered by the committee.)
3. No letters or petitions can be accepted by the committee (unless the person who wrote the letter or the persons who signed the petition are present at the committee hearing and willing to testify).
4. Persons opposed to the license application are given the opportunity to testify first; supporters may testify after the opponents have finished.
5. When you are called to testify, you will be sworn in and asked to give your name, and address. (If your first and/or last names are uncommon please spell them.)
6. You may then provide testimony.
 - a. Include only information relating to the above license application.
 - b. Include only information you have personally witnessed or seen.
 - c. Provide concise and relevant information detailing how this business has affected or may affect the peaceful enjoyment of your neighborhood.
 - d. If by the time you have the opportunity to testify, the information you wish to share has already been provided to the committee, you may state that you agree with the previous testimony. Redundant or repetitive testimony will not assist the committee in making its recommendation.
7. After giving your testimony, the members of the Licenses Committee and the licensee may ask questions regarding the testimony you have given or other factors relating to the license application.
8. Business Competition is not a valid basis for denial or non-renewal of a license.
Please Note: If you have submitted an objection to the above application your objection cannot be considered by the committee unless you personally testify at the hearing.

[illegible]

CURRENT OCCUPANT	6840 W GRANVILLE CIR 313	MILWAUKEE, WI 53223
CURRENT OCCUPANT	6840 W GRANVILLE CIR 201	MILWAUKEE, WI 53223
CURRENT OCCUPANT	6840 W GRANVILLE CIR 107	MILWAUKEE, WI 53223
CURRENT OCCUPANT	6840 W GRANVILLE CIR 113	MILWAUKEE, WI 53223
CURRENT OCCUPANT	6840 W GRANVILLE CIR 202	MILWAUKEE, WI 53223
CURRENT OCCUPANT	6840 W GRANVILLE CIR 204	MILWAUKEE, WI 53223
CURRENT OCCUPANT	6840 W GRANVILLE CIR 213	MILWAUKEE, WI 53223
CURRENT OCCUPANT	6840 W GRANVILLE CIR 214	MILWAUKEE, WI 53223
CURRENT OCCUPANT	6840 W GRANVILLE CIR 216	MILWAUKEE, WI 53223
CURRENT OCCUPANT	6840 W GRANVILLE CIR 219	MILWAUKEE, WI 53223
CURRENT OCCUPANT	6840 W GRANVILLE CIR 305	MILWAUKEE, WI 53223
CURRENT OCCUPANT	6840 W GRANVILLE CIR 309	MILWAUKEE, WI 53223
CURRENT OCCUPANT	6840 W GRANVILLE CIR 318	MILWAUKEE, WI 53223
CURRENT OCCUPANT	6840 W GRANVILLE CIR 320	MILWAUKEE, WI 53223
CURRENT OCCUPANT	6840 W GRANVILLE CIR 122	MILWAUKEE, WI 53223
CURRENT OCCUPANT	6840 W GRANVILLE CIR 206	MILWAUKEE, WI 53223
CURRENT OCCUPANT	6840 W GRANVILLE CIR 321	MILWAUKEE, WI 53223

Total Records: 63

Radius: 250.0 feet and Center of Circle: 6901 W Brown Deer Rd



PERMANENT EXTENSION OF PREMISES APPLICATION FOOD AND ALCOHOL BEVERAGE ESTABLISHMENTS

OFFICE OF THE CITY CLERK LICENSE DIVISION
200 E. WELLS ST. ROOM 105, MILWAUKEE, WI 53202
(414) 286-2238 E-MAIL ADDRESS: LICENSE@MILWAUKEE.GOV

Section A	Date of Application: <u>2/20/19</u>	Aldermanic District: <u>District 9</u>
	Licensee (Name of individual; partners, or agent, if Corp/LLC): <u>Joyce Hill</u>	
	Corporation or LLC Name (if applicable): <u>Retox Martini Lounge LLC</u>	Business Name: <u>ReTox</u>
	Business Address (include city, state, zip): <u>6901 - 6905 West Brown Dr Rd.</u>	
	(Optional) Mailing Address (include city, state, zip): <u>8555 North Servite Dr.</u>	Business Telephone Number: <u>414-206-4107</u>
Section B	This request is for the permanent extension of premises for a: <input checked="" type="checkbox"/> FOOD license <input checked="" type="checkbox"/> ALCOHOL license	
	The Current Premises Description is: <u>First Floor + Storage</u>	
	Identify the specific area(s) for which the permanent extension of premises is requested. Check all that apply and list for each the relationship of the area to the premises (example: north side, front, etc.)	
	<input type="checkbox"/> Sidewalk café (public sidewalk) at the _____ side of the premises in front of the following street address(es) _____ (area must be contiguous with licensed area and under the licensee's control) (An application for a Siding Dining Facility Permit must also be submitted with this application.)	
	<input type="checkbox"/> Patio (concrete surface) at the _____ side of the premises <input type="checkbox"/> Beer garden (soil/grass surface) at the _____ side of the premises <input type="checkbox"/> Deck (attached to building) at the _____ side of the premises <input checked="" type="checkbox"/> Addition to the: <input type="checkbox"/> 1 st floor <input type="checkbox"/> 2 nd floor <input type="checkbox"/> 3 rd floor <input type="checkbox"/> Basement <input checked="" type="checkbox"/> Other: <u>1st floor</u> at the _____ side of the premises <input checked="" type="checkbox"/> Other: Describe area(s): <u>Adding 6905 W. Brown Deer Rd.</u>	
Section C	Does extension area have an additional street address? <input type="checkbox"/> No <input checked="" type="checkbox"/> Yes If yes, list address: <u>6905</u>	
	List all type(s) of business(es) that will operate at this location? <input checked="" type="checkbox"/> Tavern <input checked="" type="checkbox"/> Restaurant <input type="checkbox"/> Other: Describe: _____	
	Signature of Sole Proprietor; a Partner; or if a Corporation or LLC, the Agent must sign <u>Joyce Hill</u>	

Office Use Only:

Filed 2/20/19 Initials OU App #s: Food FDEXT 289348 Alcohol PERNEX 289347

Queue to:

☒ DNS (all)☒ HD (all food)☒ CC Food Only (no alcohol)

Email to:

☐ DPW (sidewalk cafes/parklets)

New Licenses Issued: Food _____

☐ Approved☐ Hold☐ Approved☐ Hold☐ Approved☐ Denied☐ Approved☐ Hold

Alcohol _____

☐ Sidewalk Dining Facility Permit Issued

Initials _____

6901 W. Browndeer Rd Milwaukee, WI 53223 Retox Martini Lounge LLC
6901 W. Browndeer Rd Milwaukee, WI 53223

05/28/2017

Joyce Hill owners

Dumpster

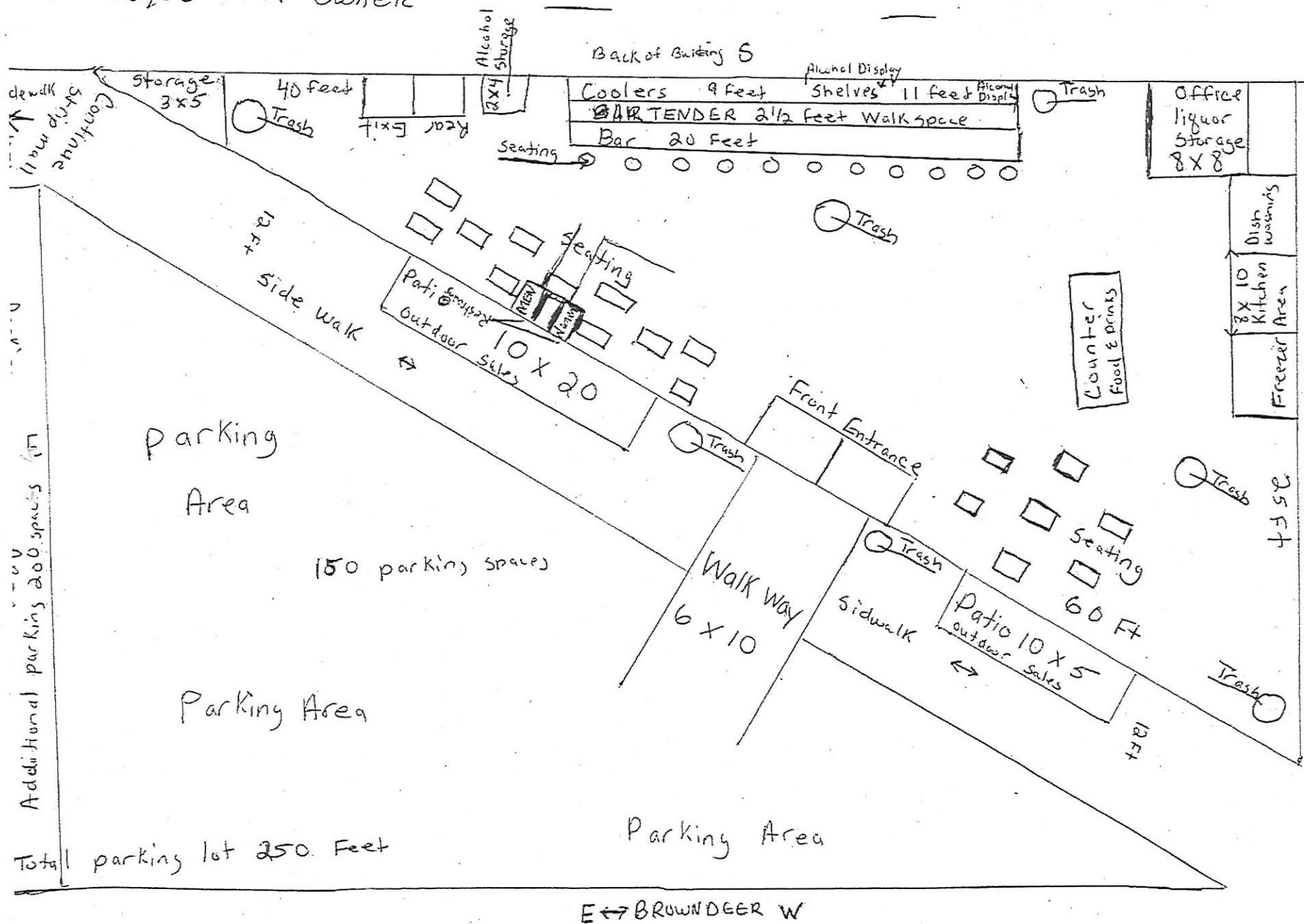

Coilrent Floor Plain

W

Total square feet 3500
05/28/2017

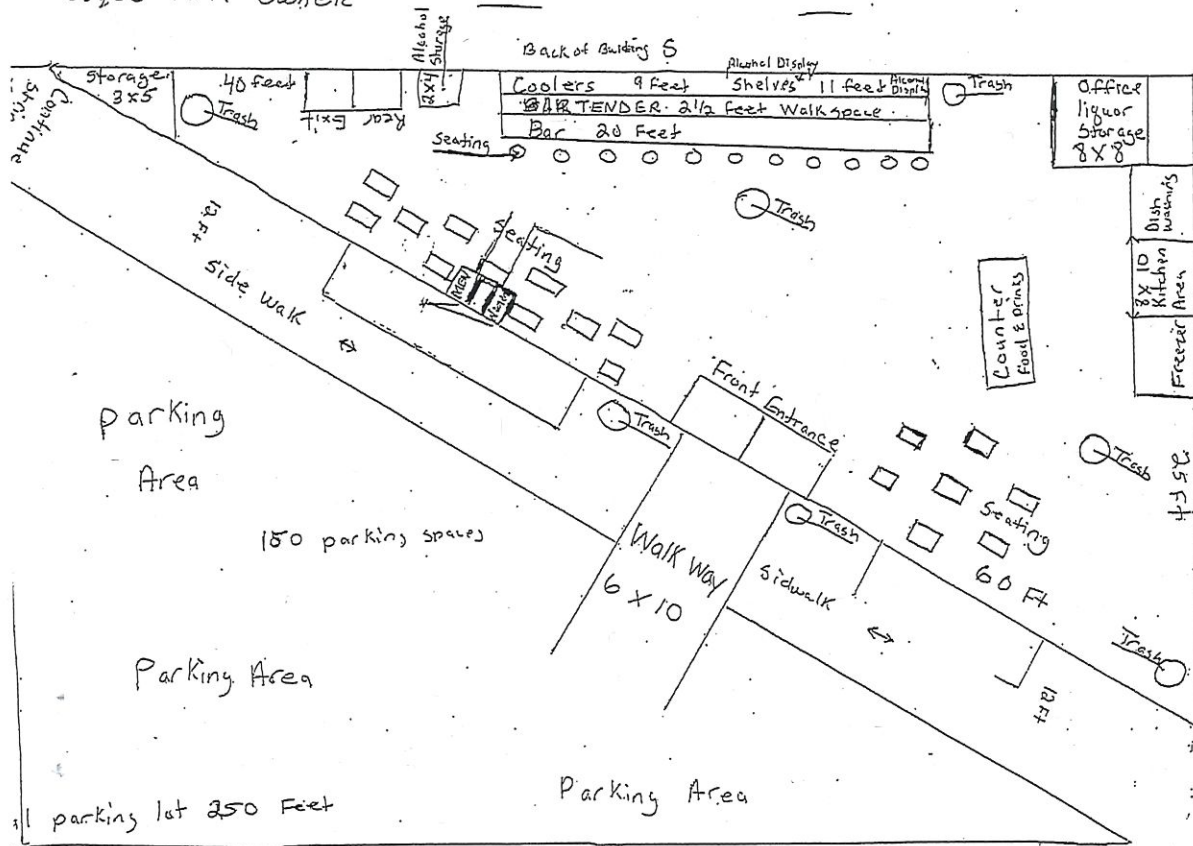

CURRENT FLOOR PLAN

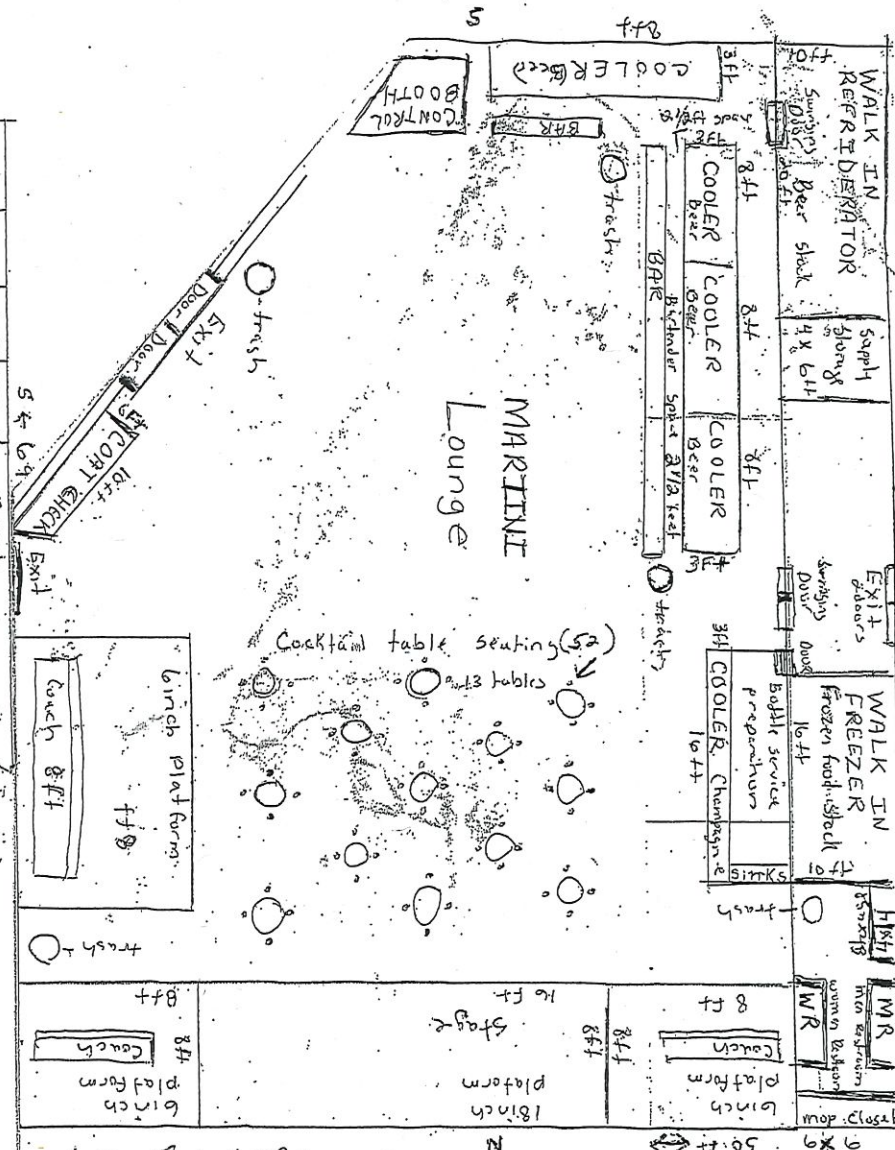

6905 W. Brown Deer Rd
Joyce Hill (Agent)

Retox martini Lounge
LLC

Trade Name

ReTox martini Lounge

2/20/19

Proposed
Adding 6905
To Current Flood



CITY OF MILWAUKEE
OFFICE OF THE CITY CLERK

Thursday, May 02, 2019

COMMITTEE MEETING NOTICE

AD 09

ROSE, David R, Agent
The Rose Group LLC
4909 W Edgerton Av #216
Greenfield, WI 53220

You are requested to attend a hearing which is to be held in Room 301-B, Third Floor, City Hall on:

Tuesday, May 14, 2019 at 10:00 AM

Regarding: Your Secondhand Motor Vehicle Dealer's - Wholesale Only License Application as agent for "The Rose Group LLC" for "514 Exclusive Auto" at 9310 N 107TH St #B104.

There is a possibility that your application may be denied for  or more of the following reasons: Neighborhood Objections to the granting of such a license due to the creation of undesirable neighborhood problems, such as: parking and traffic problems which cause the normal flow of traffic on roadways and alleys to be impeded, loitering, littering, noise, loud music, and conduct which will have an adverse impact on the public health, safety and welfare of the community. Additionally, the over concentration of secondhand motor vehicle dealers in the neighborhood such that the concentration will have an adverse impact on the public health, safety and welfare of the neighborhood. you do not meet the statutory and municipal requirements; the appropriateness of the location to be licensed and whether the location will create undesirable neighborhood problems, whether or not you have been charged with or convicted of any felony, misdemeanor, municipal offense or other offense, the circumstances of which substantially relate to the licensed activity; and any other factors which reasonably relate to the public health, safety and welfare. See attached police report and/or written correspondence regarding this application. Please be advised the public will be able to provide information to the committee in person or in writing. The committee will receive and consider evidence regarding the above mentioned criteria.

**Notice for applicants with
warrants or unpaid fines:**

Proof of warrant satisfaction or payment of fines must be submitted at the hearing on the above date and time. Failure to comply with this requirement may result in a delay of the granting/denial of your application.

Failure to appear at this meeting may result in the denial of your license. Individual applicants must appear only in person or by an attorney. Corporate or Limited Liability applicants must appear only by the agent designated on the application or by an attorney. Partnership applicants must appear by a partner listed on the application or by an attorney. If you wish to do so and at your own expense, you may be accompanied by an attorney of your choosing to represent you at this hearing.

You will be given an opportunity to speak on behalf of the application and to respond and challenge any charges or reasons given for the denial. No petitions can be accepted by the committee, unless the people who signed the petition are present at the committee hearing and willing to testify. You may present witnesses under oath and you may also confront and cross-examine opposing witnesses under oath. If you have difficulty with the English language, you should bring an interpreter with you, at your expense, so that you can answer questions and participate in your hearing.

You may examine the application file at this office during regular business hours prior to the hearing date. Inquiries regarding this matter may be directed to the person whose signature appears below.

Limited parking for persons attending meetings in City Hall is available at reduced rates (5 hour limit) at the Milwaukee Center on the southwest corner of East Kilbourn and North Water Street. Parking tickets must be validated in the first floor information booth in City Hall.

PLEASE NOTE: Upon reasonable notice, efforts will be made to accommodate the needs of disabled individuals through sign language interpreters or other auxiliary aids. For additional information or to request this service, contact the Council Services Division ADA Coordinator at (414) 286-2998, Fax - (414) 286-3456, TDD - (414) 286-2025.

JIM OWCZARSKI, CITY CLERK

BY:

Jessica Celella
License Division Manager

If you have questions regarding this notice, please contact the License Division at (414) 286-2238.

200 E. Wells Street, Room 105, City Hall, Milwaukee, WI 53202. www.milwaukee.gov/license
Phone: (414) 286-2238 Fax: (414) 286-3057 Email Address: License@milwaukee.gov



BUSINESS LICENSE PLAN OF OPERATION

ccl-busplan 3/15/18

Office of the City Clerk License Division
200 E. Wells St. Room 105, Milwaukee, WI 53202
(414) 286-2238 www.milwaukee.gov/license e-mail address: license@milwaukee.gov

1. Type of Business

Applying for: ☐ Extended Hours (12AM to 5AM) - If a food establishment, check all that apply: ☐ Delivery ☐ Drive Thru ☐ Dining Room
☐ Self-Service Laundry ☐ Massage Establishment ☐ Filling Station
☒ Other (supplemental application for specific license also required)

Provide a detailed description of the type of business you plan on operating:

Second hand motor vehicle

Do you have any experience operating this type of business? ☐ No ☐ Yes If yes, explain:

2. Business Operations

- a. Proposed Opening Date: June 1st
- b. Is this premise under construction? ☒ No ☐ Yes If yes, list estimated completion date: _____
- c. Is this a franchise? ☒ No ☐ Yes
- d. Is this premises currently licensed? ☐ No ☐ Yes If yes, list type of license: _____
- e. Is the current licensee operating? ☐ No ☐ Yes If no, list date closed: _____
- f. Do you have future plans for other businesses, licenses or permits at this location? ☒ No ☐ Yes
If yes, explain: _____
- g. Have you previously held an Extended Hours License in Milwaukee? ☒ No ☐ Yes
If yes, list address(es): _____
- h. Are other businesses operating in the same building? ☐ No ☒ Yes If yes, describe: Second hand motor vehicles

3. Litter & Noise

- a. How are grounds kept clean? ☒ Sweep ☒ Pressure Wash ☒ Pick Up Litter ☐ Other: _____
- b. How often will grounds be cleaned? ☐ Daily ☒ Weekly ☐ As Needed ☐ Monthly ☐ Other: _____
- c. Grounds cleaned by: ☐ Licensee ☒ Building Owner ☐ Employees ☒ Hired Maintenance ☐ Other: _____
- d. How are noise issues prevented and/or addressed? ☐ Security ☒ Manager approaches customer(s) ☒ Call Police
☐ Signs Posted ☐ Other: _____
- e. Will a sound amplification system be used? ☒ No ☐ Yes If yes, describe: _____

4. Smoking & Sanitation

- a. Are there designated outdoor smoking areas? ☐ No ☒ Yes If yes, describe: Smoke trays in Back
- b. Number of Garbage Cans: Inside: 1 Locations: Next to Desk
Outside: 2 Locations: North Parking lot
- c. Is a crowd control barrier used? ☒ No ☐ Yes If yes, describe: _____
- d. How many restrooms are on the premises? 1
- e. Name of solid waste contractor: ☐ Advanced Disposal ☐ Waste Management ☒ Other: goosh

5. Security

- a. Are there onsite parking spaces? ☐ No ☒ Yes If yes, how many? 4 and describe the parking security plan: NONE
- b. Is there a loading zone? ☒ No ☐ Yes If yes, describe the loading area security plan: _____
- c. Will you have security personnel on premise? ☒ No ☐ Yes If yes, how many? _____ and answer the following:
What are their responsibilities? _____
Is security equipment used? ☐ No ☐ Yes If yes, describe _____
List their licensing, certification, or training credentials _____
- d. Will there be security cameras? ☒ No ☐ Yes If yes, how many? _____ and list locations: _____
- e. Will searches/identification checks be done upon entry? ☒ No ☐ Yes If yes, describe _____

6. Percentage of Sales (must total 100%)

Alcohol _____%	Food _____%	Secondhand Merchandise <u>100</u> %	Precious Metals & Gems _____ %
Entertainment _____%	Cigarettes _____%		
Pawnbroker Activity _____%	Salvaged Materials _____% (such as scrap metal)	Personal Services (such as tattoo, body piercing, salon, tailor, tanning, etc.) _____%	Other _____% Describe: _____

7. Businesses/Licenses on the Premises (check all that apply):

Type 1

- | | | | |
|--|---|---|--|
| <input type="checkbox"/> Full Service Restaurant | <input type="checkbox"/> Cafe/Coffee Shop | <input type="checkbox"/> Deli or Fast Food Restaurant | <input type="checkbox"/> Private/Fraternal/Veterans Club |
| <input type="checkbox"/> Night Club | <input type="checkbox"/> Tavern | <input type="checkbox"/> Cocktail Lounge | <input type="checkbox"/> Teen Club |
| <input type="checkbox"/> Banquet Hall | <input type="checkbox"/> Sports Facility | <input type="checkbox"/> Bowling Alley | |
| <input type="checkbox"/> Hotel/Motel : Number of Floors: _____
Number of Rooms: _____ | <input type="checkbox"/> Rooming House: Number of Floors: _____
Number of Rooms: _____ | | |

Type 2

- | | | | |
|--|--|---|--|
| <input type="checkbox"/> Liquor Store | <input type="checkbox"/> Corner Store | <input type="checkbox"/> Supermarket | <input type="checkbox"/> Convenience Store |
| <input type="checkbox"/> Gas Station | <input type="checkbox"/> Amusement/Phonograph Distributor | <input type="checkbox"/> Recycling, Salvage or Towing | |
| <input type="checkbox"/> Used Car Dealer | <input type="checkbox"/> Personal Service Establishment
(such as tattoo business, hair salon, tailor, etc.) | <input type="checkbox"/> Recording Studio | |

What other licenses/permits will you hold at this location? (check all that apply)

- ☒ Occupancy Permit ☐ Cigarette & Tobacco ☐ Gas Station ☐ Extended Hours ☐ Class "B" Tavern ☐ Weights & Measures
☒ Secondhand Dealer ☐ Precious Metal & Gem ☐ Other: _____

8. Legal Capacity (only if a Type 1 premises in #7 above)

Capacity _____ (Call the Milwaukee Development Center at 414-286-8211 if you have questions.)

9. Premises Description

a. Identify all area(s) of the premises that will be used in operating this business (include areas used only for storage):

☒ 1st Floor ☐ 2nd Floor ☐ Basement Storage ☐ Patio ☐ Beer Garden ☐ Sidewalk Café ☐ Deck ☐ Rooftop

☒ Other: Describe: ~~Beauti Deek~~ B-104

b. Describe Location: ☐ Major Thoroughfare ☒ Secondary Street ☐ Other: 107th

c. Nearest Major Cross Street: Brown Deek

d. Describe Building: ☒ Free Standing Building ☐ Strip Mall ☐ Other:

e. Describe Premises Structure: ☒ Single Story ☐ Multi-Story - # of Stories ☐ Other:

f. Describe Surrounding Area: ☒ Commercial ☐ Residential ☐ Industrial ☐ Other:

g. Building Owner Name: Wayne Stank Phone Number:

Business Owner Address: 9310 N 107th St Milwaukee, WI suite B-104

10. Hours of Operation & Customers

Will customers be entering the premises? ☐ No ☒ Yes

Day of the Week	Proposed Hours of Operation:		Estimated Number of Customers expected each day	Potential Age Range of Customers	Class B Tavern Applicant Only: Age Restriction (If none, write 'None')
	Open Time (include a.m. or p.m.)	Close Time (include a.m. or p.m.)			
Sunday	Close	close			
Monday	Close	close			
Tuesday	Close	close			
Wednesday	Close	close			
Thursday	9:00 AM	5:00 PM	2	18 & up	
Friday	9:00 AM	5:00 PM	2	18 & up	
Saturday	12:00 PM	4:00 PM	2	18 & up	

An Extended Hours Establishment License is required for any convenience store, filling station, personal service establishment (such as tattoo, body piercing, salon, tailor, tanning, etc.), recording studio or restaurant which is open between the hours of 12:00 a.m. and 5:00 a.m.

Alcohol Establishments Class A: 8:00 am to 9:00 pm Sunday thru Saturday
Permitted Hours of Operation: Class B: 6:00 am to 2:00 am Sunday thru Thursday, 6:00 am to 2:30 am Friday & Saturday

Entertainment Outdoor Closing Hours: 10:00pm Sunday-Thursday; 12:00am Friday & Saturday; unless a different time, either earlier or later, is established by the Common Council in its approval of the licensee's plan of operation.

11. Signature(s)

Signature of Sole Proprietor, Partner, or 20% or more Shareholder
(If there are no 20% or more shareholders,
Corporate Officer-print name/title and sign)

Signature of additional partner or 20% or more shareholder

See Application Information for a complete list of all required application forms.



SECONDHAND MOTOR VEHICLE DEALER LICENSE SUPPLEMENTAL PLAN OF OPERATION

Office of the City Clerk License Division
200 E. Wells St. Room 105, Milwaukee, WI 53202
(414) 286-2238 e-mail address: license@milwaukee.gov

Legal Entity Name:

The Rose group LLC

Premises Address:

9310 N. 107th suite #107 Milwaukee, WI 53224

SECTION 1 LICENSE TYPE

What type of license are you applying for? (check one) ☐ Retail ☒ Wholesale

SECTION 2

Will you also be dealing in secondhand vehicle parts? ☐ Yes ☒ No

If wholesale, is the premises address a residential (home) address? ☐ Yes ☒ No

If yes, you must obtain a Home Occupational Statement from the Department of Neighborhood Services (414) 286-3874.

No vehicles can be parked and no customers are allowed at the premises.

The following questions in Section 2 do not apply to wholesale from a residential address. Go to Section 3.

Number of parking spaces available to customers/employees 1

Number of parking spaces that will be used for display/storage of Secondhand Motor Vehicles 3

Do you understand that all vehicles associated with the business must be stored on the licensed premise? ☒ Yes ☐ No

What are your plans to ensure this requirement is met (check all that apply)?

☐ Employee Training

☐ Supervisor Monitoring

☐ Fenced Lot

☒ Keys Kept in Locked Box

☐ Other: _____

Do you understand all maintenance/repair work to these vehicles must be confined to the licensed premise? ☒ Yes ☐ No

What are your plans to ensure this requirement is met (check all that apply)?

☒ Employee Training

☐ Supervisor Monitoring

☐ Designated Repair Area

☐ Other: _____

Do you understand all keys to used motor vehicles offered for sale must be kept in a secure lockbox inside the dealership building at all times when the dealership is not open for business? ☒ Yes ☐ No

What are your plans to ensure this requirement is met (check all that apply)?

☒ Employee Training

☐ Supervisor Monitoring

☐ Other: _____

SECTION 3 DISCLOSURE

Has any person on the application ever had a license relating to the activities licensed in Milwaukee Code of Ordinances Chapter 92 denied, not renewed, suspended, or revoked? ☒ No ☐ Yes

If yes, provide the circumstances and jurisdiction in which the event occurred (including a record of any actions from the State Department of Transportation and Financial Institutions relating to suspensions, revocations, forfeitures and warnings imposed by these departments relating to the operation of any automotive sales business by the applicant):

SECTION 4 SIGNATURES

Sole Proprietor, Partner, or 20% or more Shareholder
(If there are no 20% or more shareholders,
Corporate Officer-print name/title and sign)

Additional partner or 20% or more shareholder