



**CITY OF MILWAUKEE
OFFICE OF THE CITY CLERK**

Wednesday, July 11, 2018

COMMITTEE MEETING NOTICE

AD 06

HALSELL, Kenneth R, Agent
Ludhiana Inc
233 W Center St
Milwaukee, WI 53212

You are requested to attend a hearing which is to be held in Room 301-B, Third Floor, City Hall on:

Tuesday, July 17, 2018 at 02:00 PM

Regarding: Your Class A Malt, Class A Liquor-Cider Only, Food Dealer,  & Measures, and Public Entertainment Premises License Applications Requesting Phone Charging Kiosks as agent for "Ludhiana Inc" for "Li'l General" at 233 W Center St.

There is a possibility that your application may be denied for one or more of the following reasons: The recommendation of the committee regarding the application shall be based on evidence presented at the hearing. Per MCO 85-2.7-4, probative evidence concerning whether or not a new license should be granted may be presented on the following subjects: whether or not the applicant meets the municipal requirements, the appropriateness of the location and premises where the licensed premises is to be located and whether use of the premises for the purposes or activities permitted by the license would tend to facilitate a public or private nuisance or create undesirable neighborhood problems such as disorderly patrons, unreasonably loud noise, litter, and excessive traffic and parking congestion. Probative evidence relating to these matters may be taken from the plan of operation submitted with the license application, if any, but shall not include the content of any music. Evidence regarding the fitness of the location of the premises to be maintained as the principal place of business, including but not limited to whether there is an overconcentration of businesses of the type for which the license is sought; whether the proposal is consistent with any pertinent neighborhood business or development plans, or the location's proximity to areas where children are typically present. The applicant's record in operating similarly licensed premises; and whether or not the applicant has been charged with or convicted of any felony, misdemeanor, municipal offense or other offense, the circumstances of which substantially relate to the activity to be permitted by the license being applied for or any other factor which reasonably relates to the public health, safety or welfare may also be considered. See attached police report or correspondence.

**Notice for applicants with
warrants or unpaid fines:**

Proof of warrant satisfaction or payment of fines must be submitted at the hearing on the above date and time. Failure to comply with this requirement may result in a delay of the granting/denial of your application.

Failure to appear at this meeting may result in the denial of your license. Individual applicants must appear only in person or by an attorney. Corporate or Limited Liability applicants must appear only by the agent designated on the application or by an attorney. Partnership applicants must appear by a partner listed on the application or by an attorney. If you wish to do so and at your own expense, you may be accompanied by an attorney of your choosing to represent you at this hearing.

You will be given an opportunity to speak on behalf of the application and to respond and challenge any charges or reasons given for the denial. No petitions can be accepted by the committee, unless the people who signed the petition are present at the committee hearing and willing to testify. You may present witnesses under oath and you may also confront and cross-examine opposing witnesses under oath. If you have difficulty with the English language, you should bring an interpreter with you, at your expense, so that you can answer questions and participate in your hearing.

You may examine the application file at this office during regular business hours prior to the hearing date. Inquiries regarding this matter may be directed to the person whose signature appears below.

Limited parking for persons attending meetings in City Hall is available at reduced rates (5 hour limit) at the Milwaukee Center on the southwest corner of East Kilbourn and North Water Street. Parking tickets must be validated in the first floor information booth in City Hall.

PLEASE NOTE: Upon reasonable notice, efforts will be made to accommodate the needs of disabled individuals through sign language interpreters or other auxiliary aids. For additional information or to request this service, contact the Council Services Division ADA Coordinator at (414) 286-2998, Fax - (414) 286-3456, TDD - (414) 286-2025.

JIM OWCZARSKI, CITY CLERK

BY: _____

Jessica Celella

License Division Manager

If you have questions regarding this notice, please contact the License Division at (414) 286-2238.

200 E. Wells Street, Room 105, City Hall, Milwaukee, WI 53202. www.milwaukee.gov/license
Phone: (414) 286-2238 Fax: (414) 286-3057 Email Address: License@milwaukee.gov



**CITY OF MILWAUKEE
OFFICE OF THE CITY CLERK**

Wednesday, July 11, 2018

COMMITTEE MEETING NOTICE

AD 06

HALSELL, Kenneth R, Agent
Ludhiana Inc
2465 N 23rd St
Milwaukee, WI 53206

You are requested to attend a hearing which is to be held in Room 301-B, Third Floor, City Hall on:

Tuesday, July 17, 2018 at 02:00 PM

Regarding: Your Class A Malt, Class A Liquor-Cider Only, Food Dealer, Weights & Measures, and Public Entertainment Premises License Applications Requesting Phone Charging Kiosks as agent for "Ludhiana Inc" for "Li'l General" at 233 W Center St.

There is a possibility that your application may be denied for one or more of the following reasons: The recommendation of the committee regarding the application shall be based on evidence presented at the hearing. Per MCO 85-2.7-4, probative evidence concerning whether or not a new license should be granted may be presented on the following subjects: whether or not the applicant meets the municipal requirements, the appropriateness of the location and premises where the licensed premises is to be located and whether use of the premises for the purposes or activities permitted by the license would tend to facilitate a public or private nuisance or create undesirable neighborhood problems such as disorderly patrons, unreasonably loud noise, litter, and excessive traffic and parking congestion. Probative evidence relating to these matters may be taken from the plan of operation submitted with the license application, if any, but shall not include the content of any music. Evidence regarding the fitness of the location of the premises to be maintained as the principal place of business, including but not limited to whether there is an overconcentration of businesses of the type for which the license is sought; whether the proposal is consistent with any pertinent neighborhood business or development plans, or the location's proximity to areas where children are typically present. The applicant's record in operating similarly licensed premises; and whether or not the applicant has been charged with or convicted of any felony, misdemeanor, municipal offense or other offense, the circumstances of which substantially relate to the activity to be permitted by the license being applied for or any other factor which reasonably relates to the public health, safety or welfare may also be considered. See attached police report or correspondence.

**Notice for applicants with
warrants or unpaid fines:**

Proof of warrant satisfaction or payment of fines must be submitted at the hearing on the above date and time. Failure to comply with this requirement may result in a delay of the granting/denial of your application.

Failure to appear at this meeting may result in the denial of your license. Individual applicants must appear only in person or by an attorney. Corporate or Limited Liability applicants must appear only by the agent designated on the application or by an attorney. Partnership applicants must appear by a partner listed on the application or by an attorney. If you wish to do so and at your own expense, you may be accompanied by an attorney of your choosing to represent you at this hearing.

You will be given an opportunity to speak on behalf of the application and to respond and challenge any charges or reasons given for the denial. No petitions can be accepted by the committee, unless the people who signed the petition are present at the committee hearing and willing to testify. You may present witnesses under oath and you may also confront and cross-examine opposing witnesses under oath. If you have difficulty with the English language, you should bring an interpreter with you, at your expense, so that you can answer questions and participate in your hearing.

You may examine the application file at this office during regular business hours prior to the hearing date. Inquiries regarding this matter may be directed to the person whose signature appears below.

Limited parking for persons attending meetings in City Hall is available at reduced rates (5 hour limit) at the Milwaukee Center on the southwest corner of East Kilbourn and North Water Street. Parking tickets must be validated in the first floor information booth in City Hall.

PLEASE NOTE: Upon reasonable notice, efforts will be made to accommodate the needs of disabled individuals through sign language interpreters or other auxiliary aids. For additional information or to request this service, contact the Council Services Division ADA Coordinator at (414) 286-2998, Fax - (414) 286-3456, TDD - (414) 286-2025.

JIM OWCZARSKI, CITY CLERK

BY: _____

Jessica Celella

License Division Manager

If you have questions regarding this notice, please contact the License Division at (414) 286-2238.

200 E. Wells Street, Room 105, City Hall, Milwaukee, WI 53202. www.milwaukee.gov/license
Phone: (414) 286-2238 Fax: (414) 286-3057 Email Address: License@milwaukee.gov

Date: 5/29/18
Officer: Brown

City of Milwaukee Police Department
90-5-1.5 Crime Prevention Survey
Convenience Store/Liquor Store Inspection

Name of Premise: Lil General
Address: 233 W. Center St.
Phone: 414-374-3473

Owner: Halsell, Kenneth R.
Owner address: 2465 N. 23rd St.
City State Zip: Milwaukee, WI 53206
Owner Phone: 414-736-6949
Owner email:

Manager: Same
Home Address:
City State Zip:
Phone:
Email:

Preferred contact: Same

Location currently open: ☒ YES ☐ NO

Projected open date: 05/01/18

Day's open: ☐S ☐M ☐T ☐W ☐Th ☐F ☐SA ☒ALL

Hours of Operation: Sun: 8A-12A ☐24 hours ☐Y ☒N
Mon: "
Tue: "
Wed: "
Thu: "
Fri: "
Sat: "

Premise Type: ☐Liquor Store
☒Convenience Store
☐Other:

Licenses currently held:

Alcohol: ☒ Yes ☐ No Class: #:
Tobacco: ☒ Yes ☐ No #:
Food: ☒ Yes ☐ No #:
Extended Hours: ☐ Yes ☒ No #:
Secondhand Dealer: ☐ Yes ☐ No Type: #:
Other: ☐ Yes ☐ No Type: #:
Other: ☐ Yes ☐ No Type: #:

Exterior Survey:

1. Is the area around the location clean? ☒ Yes ☐ No
2. What surrounds the location? (Check all the apply)
 - a. ☐ Park
 - b. ☐ School
 - c. ☐ Youth Center
 - d. ☐ Church
 - e. ☐ Tavern(s) If so, how many
 - f. ☒ Residential
 - g. ☒ Other businesses
 - h. ☐ Other:
3. Can you see from the outside of the location into the interior ☐ Yes ☒ No
4. Can you see the employees inside of the location from the outside ☐ Yes ☒ No
5. Are exterior windows free of signage ☐ Yes ☒ No
6. Is there a parking lot ☒ Yes ☐ No
7. Is the parking lot clean? ☒ Yes ☐ No
8. Is the parking lot well lit? ☒ Yes ☐ No
9. Are there areas where a person could conceal themselves ☐ Yes ☒ No
10. Is there exterior lighting? ☒ Yes ☐ No. Does it appears to be adequate ☒ Yes ☐ No
11. Exterior Payphone? ☐ Yes ☒ No
12. Are there No Loitering Signs posted? ☐ Yes ☒ No
13. Are there exterior security cameras ☒ Yes ☐ No How Many: 4
14. Are the address numbers prominently displayed and easy to see ☐ Yes ☒ No

Camera Survey:

15. Does this location have security cameras? ☒ Yes ☐ No
16. Are they in working order? ☒ Yes ☐ No
17. What format are the cameras?
 - a. Color ☒ Yes ☐ No
 - b. Digital ☒ Yes ☐ No
 - c. VCR ☐ Yes ☐ No
 - d. Recorded ☒ Yes ☐ No
18. How long is footage stored for later viewing: 6 WKS
19. Are there exterior cameras ☒ Yes ☐ No How many: 4
20. Are there interior cameras ☒ Yes ☐ No How many: 8
21. Do all employees know how to retrieve recorded digital images/footage? ☒ Yes ☐ No

Interior Survey:

22. Is the storeowner willing to be a standing complainant regarding loitering? ☒ Yes ☐ No
a. If yes have them fill out the standing complaint form and give them two of the commercial signs ☐ Yes ☐ No
23. Is the interior of the location neat and clean? ☒ Yes ☐ No
24. Does an interior camera face the entrance/exit? ☒ Yes ☐ No
25. Is there a lockable area that separates employees from customers? ☐ Yes ☒ No
26. Does the store sell single chore boy? ☒ Yes ☐ No
27. Does the store sell blunt wraps? ☒ Yes ☐ No
28. Does the store sell scales? ☐ Yes ☒ No
29. Does the store sell items that may be used as crack pipes? ☐ Yes ☒ No
a. Describe item
30. Does the store have an over abundance of sandwich baggies? ☐ Yes ☒ No
31. Does the owner understand that these items are often used for drug use? ☒ Yes ☐ No
32. Do the products in the store appear to be new and rotated often? ☒ Yes ☐ No
33. Are emergency and non-emergency numbers posted near the phone? ☒ Yes ☐ No
34. Does the owner know how to contact their police district directly? ☒ Yes ☐ No
a. Did you provide a district contact guide to the owner? ☐ Yes ☒ No

Complete this section if alcohol establishment is a convenience store:

(** Read full ordinance for all details "68-4.3 Convenience Food Stores")

All convenience food stores not exempted under sub. 3 shall:

1. Is the cash register located in a manner so that at the time of a sales transaction, the employee and customer are both visible from the sidewalk? ☐ Yes ☒ No **
2. Are the glass entrance and exit doors clear of any signs or advertisements with the exception of a sign which states that the cash register contains \$50 or less and that the safe is no accessible to employees? ☐ Yes ☒ No
3. Does the store maintain one of the following on the licensed premise:
 - a. A safe that was in use at the convenience food store on August 17, 1994? ☒ Yes ☐ No
 - b. A drop-safe or time release safe that weighs at least 500 pounds or which is attached to or set into the floor in a manner approved by the police department? ☒ Yes ☐ No
4. Is lighting provided for the store's parking area during all hours of darkness when employees or customers are on the premises at a minimum average of 2-foot candles per square foot, unless the store is not open for business after sunset and before sunrise? ☒ Yes ☐ No ☐ N/A
5. Are at least two high-resolution surveillance security cameras installed? ☒ Yes ☐ No
6. Are the security cameras in working order? ☒ Yes ☐ No
7. Does one camera show an overall view of the counter and register area? ☒ Yes ☐ No
8. Does one camera show a clear, identifiable, full frame image of the face of each person entering and leaving the store? ☒ Yes ☐ No
9. Are the camera views obstructed by fixtures or displays? ☐ Yes ☒ No
10. Is the recorded footage stored for at least 30 days? ☒ Yes ☐ No
11. Do all store employees know how to record footage from the camera system to media capable of being transferred to police custody? ☒ Yes ☐ No

12. Are customer entrances/exits made of glass or other transparent material? ☒ Yes ☐ No
a. Exception: A store that does not have such doors on August 17, 1994 shall not be required to install such doors until the holder of the store's food dealer license changes.
13. Has the owner and their employees attended the Robbery Prevention Training within 120 days of ownership or employment? ☒ Yes ☐ No
a. Contact Community Outreach and Education at 935-7836 for schedule.

Sub 3. Exemptions. The requirements of this section do not apply to a convenience food store that conforms to either of the following descriptions:

- a-1. The store is located in an enclosed shopping structure, enclosed commercial building or hospital. A convenience food store is not in an enclosed structure or building if a customer can enter it directly from the outside.
Does store conform to a-1? ☐ Yes ☒ No
- a-2. The store physically separates employees from customers with a solid partition that bars a person from entering the employee area from the customer area, has a secure lock on the employee side of any door between the employee area and the customer, and conducts all transaction through a service window or similar arrangement.
Does store conform to a-2? ☐ Yes ☒ No
- a. At the commissioner's discretion, a convenience store may be exempted from any or all of the regulations specified in sub 2.
Does this location hold an exemption from the commissioner regarding any of the requirements of Sub 2? ☐ Yes ☒ No

ADDITIONAL COMMENTS/RECOMMENDATIONS:

Advised to remove signs in window, doors, and clean for more visibility from outside.
Advised to post address

MILWAUKEE POLICE DEPARTMENT
LICENSE INVESTIGATION UNIT

CRIMINAL RECORD/ORDINANCE VIOLATION/INCIDENTS
SYNOPSIS

DATE: 10/04/2017
LICENSE TYPE: AMALT
NEW:
RENEWAL: X

No. 262908
Application Date: 10/02/2017
Expiration Date:

License Location: 233 W. Center St.
Business Name: Li'l General

Aldermanic District: 06

Licensee/Applicant: Sekhon, Parminder S.
(Last Name, First Name, MI)
Date of Birth: 01/19/1964

Home Address: 8120 W. Beechwood Ave.
City: Milwaukee **State: WI** **Zip Code: 53223**
Home Phone: (414) 358-9245

This report is written by Police Officer David NOVAK, assigned to the License Investigation Unit, Days.

The Milwaukee Police Department's investigation regarding this application revealed the following:

1. On 04/27/07, Milwaukee Police, along with an agent from Department of Revenue, conducted a tobacco law compliance inspection at the premise of 233 W Center. The owner, Parminder Sekhon was present. The inspection found missing receipts for blunt wraps and hollow tobacco tubes and Sekhon didn't know why there weren't any receipts for them. All blunt wrap tubes were seized by the agent for violation of state law.

=====

2. On 04/30/2008 a 19-year-old police aide, working with Milwaukee Police, was able to purchase a 4 pack of Steel Reserve malt beverage from a clerk at 233 W. Center St. (Li'l General). The clerk that made the sale, Samuel L. Hoskins, was cited.

Charge: Sale of Alcohol to Underage Person
Finding: Guilty
Sentence: \$160.00 fine
Date: 06/18/2008
Case: 08057929

3. On 06/26/2008 a 16-year-old, working with Milwaukee Police on the Wisconsin WINS tobacco initiative, was able to purchase a pack of Newport Light 100 cigarettes from a clerk at 233 W. Center St. (Li'l General). The clerk that made the sale, Karamjit K. Sekmon, was cited.

Charge: Sale of Cigarettes to Minor/Underage
Finding: Guilty
Sentence: \$70.00
Date: 09/26/2008
Case: 08085990

=====

4. On 12/02/2008 at 8:38PM, a Milwaukee Police Department squad conducted a field interview of a subject at 233 W Center Street. The subject was observed inside a Chevy Suburban parked in front of the business. Numerous subjects approached the vehicle and conducted a hand-to-hand transaction. Thirty bags of marijuana were recovered from inside the glove compartment as well as \$1171.00 dollars from the subject. Subject was taken into custody and admitted to possessing the narcotics.
5. On 07/27/2009 a 16-year-old, working with Milwaukee Police on the Wisconsin WINS tobacco initiative, was able to purchase a pack of Newport Light 100 cigarettes from a clerk at 233 W. Center St. (Lil General). The licensee was cited for:

Charge: Sale of Cigarettes to Minor/Underage
Finding: Guilty
Sentence: Fined \$100.00
Date: 11/06/2009
Case: 09110426

=====

Item # 5 previously reported, disposition now added on 10/21/10.

=====

6. On 11/07/2015 a 17 year old, working in conjunction with Milwaukee police, was able to purchase a 2 pack of Swisher Diamond Cigars from the cashier at 233 West Center Street. The cashier, Kenneht Halsell, was advised a letter to enroll in the M.A.R.T.S. program would be sent. On 05/05/2016, the officer was advised that the agent had enrolled in the M.A.R.T.S program, but failed to successfully complete it. The agent was written a citation for sale of cigarettes to minor/underage. On 05/23/2016 the city attorney's office refused to issue charges related to this citation.

=====

PREVIOUS PREMISE

Alcohol Concentration for 233 W. Center St.

City of Milwaukee, Wisconsin

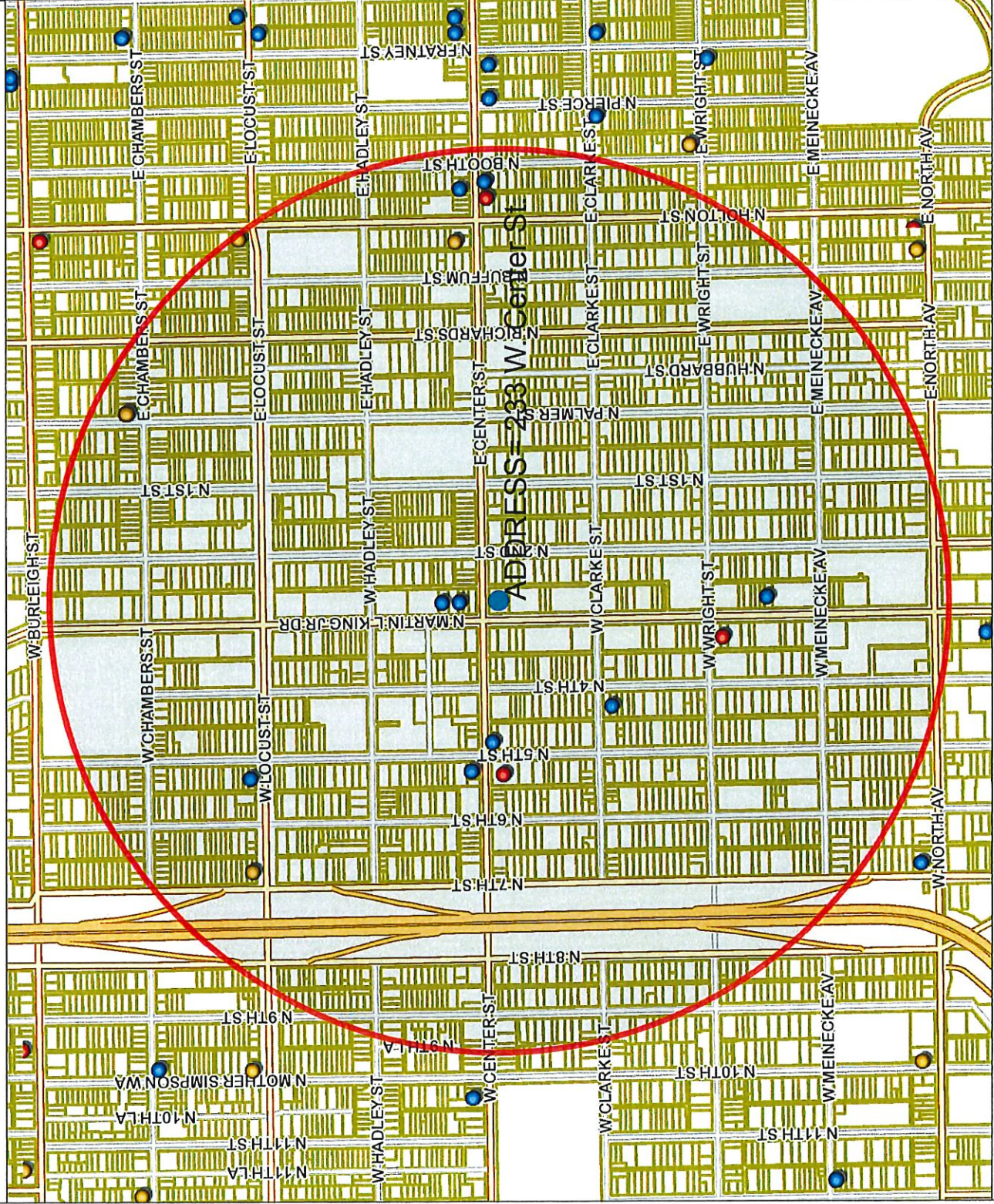

Map Scale: 1: 10,000

833.3 0 416.67 833.3Feet

© City of Milwaukee, Wisconsin
Map Milwaukee: Property Information
4/16/2018

[Disclaimer](#)



- Legend -

- Street names 10,000
- City limits
- Freeways 15,000
- Freeways
- Exit ramps
- Entry ramps
- Ramps
- Major streets 10,000
- Streets 10,000
- Waterways
- Parcels - MPROP_lite
- Parcels - MPROP_lite
- Street names 10,000
- Alcohol licenses
- Class A intoxicating liquor
- Class A fermented malt beverage
- Class A liquor and malt
- Class B fermented malt beverage
- Class B tavern
- Class C wine retailer

- Notes -

Alcohol Establishments within a .5 Mile Radius Centered on 233 W. Center St. as of 4/16/18



Department of Administration - ITMD

Licensed Alcohol Beverage Establishments within a .5 Mile Radius Centered on 233 W. Center Street as of 4/16/18									
License Summary									Total
Class A Fermented Malt Beverage Retailer's License									5
Class A Malt & Class A Liquor License									3
Class A Retailer's Intoxicating Liquor License									1
Class B Tavern License									9
									18
Legal entity	Trade name	Licensee	License type name	Total capacity	Address	Expiration date			
Chamber East Food Market LLC	Chamber East Food	Davinderjit Kaur, Agt	Class A Fermented Malt Beverage		200 E Chambers ST	4/20/19			
PATIALA, INC	LIL GENERAL	PARMINDER S SEKHON, Agt	Class A Fermented Malt Beverage		233 W CENTER ST	1/15/19			
SINGH & WADE, INC	7TH STREET FOODS	JATINDER SINGH, Agt	Class A Fermented Malt Beverage		2900 N 7TH ST	1/13/19			
Freedom Grocery LLC	Freedom Grocery	SAED A NABHAN, Agt	Class A Fermented Malt Beverage		2909 N Holton ST	1/19/19			
Loves Supermarket II LLC	Loves Supermarket	HARIINDER S BRAICH, Agt	Class A Fermented Malt Beverage		418 E CENTER ST	11/25/18			
AJ Liquor & Food Inc	AJ Liquor	KULWINDER SINGH, Agt	Class A Malt & Class A Liquor License		2469 N MARTIN L KING JR DR	10/16/18			
Cypress Lane LLC	Center Street Food and Liquor	Gurinder S Nagra, Agt	Class A Malt & Class A Liquor License		2667 N 5th ST	3/25/19			
Center Street Liquor Store Inc	Center Street Liquor Store	Charanjit kaur, Agt	Class A Malt & Class A Liquor License		513 E Center ST	12/15/18			
PATIALA, INC	LIL GENERAL	PARMINDER S SEKHON, Agt	Class A Retailer's Intoxicating Liquor		233 W CENTER ST	1/15/19			
Great Day Investments, Inc.	Tee's Lounge	Timothy Day, Agt	Class B Tavern License		2436 N MARTIN L KING JR DR	11/5/18			
BETTIE'S & EDDIE'S CLUB MANHATTAN	BETTIE'S & EDDIE'S CLUB MANHATTAN	VALARIE J WINGO, SP	Class B Tavern License	80	2573 N 4TH ST	7/12/18			
ED'S LOUNGE	ED'S LOUNGE	Larissa L Sharkey, SP	Class B Tavern License	80	2678 N 5TH ST	2/28/19			
Lux2 LLC	TJ's Place	THOMAS J HOLMES, Agt	Class B Tavern License		2712 N MARTIN L KING JR DR	11/21/18			
4th Quarter	4th Quarter	Devinda M Glover, SP	Class B Tavern License		2722 N MARTIN L KING JR DR	7/30/18			
REDHEAD, INC	SAVOY'S	DIANA L CONDON, Agt	Class B Tavern License	160	2901 N 5TH ST	7/23/18			
TWISTERS INN	TWISTERS INN	MILEY HOWARD, SP	Class B Tavern License	100	508 W CENTER ST	5/12/18			
KISMAYO, LLC	CLUB TIMBUKTU	YOUSOUF KOMARA, Agt	Class B Tavern License	160	520 E CENTER ST	12/19/18			
THE MAD PLANET, INC	THE MAD PLANET	ROSEMARY S SILAGY, Agt	Class B Tavern License	299	533 E CENTER ST	6/29/18			



Wednesday, July 11, 2018

Licenses Committee Notice of Hearing

PATIALA INC
233 W Center St

Milwaukee, WI 53212

Date: 7/17/2018
Time: 02:00 PM
Location: Room 301-B, Third Floor, City Hall

The Licenses Committee will consider the following license application:

Class A Malt, Class A Liquor-Cider Only, Food Dealer, Weights & Measures, and
Public Entertainment Premises License Applications Requesting Phone Charging
Kiosks

HALSELL, Kenneth R, Agent
Li'l General at 233 W Center St

Please note this application may be recommended for denial based on fitness of the location due to concentration of alcohol beverage outlets in the area. If the application is denied for this reason, no other application for an alcohol beverage license for this location shall be recommended for approval by the Licenses Committee within three years of the date of denial unless the applicant has demonstrated a change of circumstances since the prior denial.

If you have any questions, please call (414) 286-2238.





Wednesday, July 11, 2018

Licenses Committee Notice of Hearing

PATIALA INC
W133N6205 Hummingbird Way

Menomonee Falls, WI 53051

Date: 7/17/2018
Time: 02:00 PM
Location: Room 301-B, Third Floor, City Hall

The Licenses Committee will consider the following license application:

Class A Malt, Class A Liquor-Cider Only, Food Dealer, Weights & Measures, and
Public Entertainment Premises License Applications Requesting Phone Charging
Kiosks

HALSELL, Kenneth R, Agent
Li'l General at 233 W Center St

Please note this application may be recommended for denial based on fitness of the location due to concentration of alcohol beverage outlets in the area. If the application is denied for this reason, no other application for an alcohol beverage license for this location shall be recommended for approval by the Licenses Committee within three years of the date of denial unless the applicant has demonstrated a change of circumstances since the prior denial.

If you have any questions, please call (414) 286-2238.





Wednesday, July 11, 2018



Notice of Public Hearing

HALSELL, Kenneth R, Agent

Li'l General at 233 W Center St

Class A Malt, Class A Liquor-Cider Only, Food Dealer, Weights & Measures, and Public
Entertainment Premises License Applications Requesting Phone Charging Kiosks

Tuesday, July 17, 2018 at 2:00 PM

To whom it may concern:

The above application has been made by the above named applicant(s). This requires approval from the Licenses Committee and the Common Council of the City of Milwaukee. The hearing before the Licenses Committee will take place on 7/17/2018 at 2:00 PM, in Room 301-B, Third Floor, City Hall. If you wish, you may provide testimony at the hearing regarding the request; see below for further information. You are not required to attend the hearing. Once the Licenses Committee makes its recommendation, this recommendation is forwarded to the full Common Council for approval at its next regularly scheduled hearing. Please review the information below and if you have further questions regarding this process, please contact the License Division at (414) 286-2238.

Important details for those wishing to provide information for the Licenses Committee to consider when making its recommendation:

1. The license application is scheduled to be heard at the above time. Due to other hearings running longer than scheduled, you may have to wait some time to provide your testimony.
2. You must appear in person and testify as to matters that you have personally experienced or seen. (You cannot provide testimony for your neighbor, parent or anyone else; this is considered hearsay and cannot be considered by the committee.)
3. No letters or petitions can be accepted by the committee (unless the person who wrote the letter or the persons who signed the petition are present at the committee hearing and willing to testify).
4. Persons opposed to the license application are given the opportunity to testify first; supporters may testify after the opponents have finished.
5. When you are called to testify, you will be sworn in and asked to give your name, and address. (If your first and/or last names are uncommon please spell them.)
6. You may then provide testimony.
 - a. Include only information relating to the above license application.
 - b. Include only information you have personally witnessed or seen.
 - c. Provide concise and relevant information detailing how this business has affected or may affect the peaceful enjoyment of your neighborhood.
 - d. If by the time you have the opportunity to testify, the information you wish to share has already been provided to the committee, you may state that you agree with the previous testimony. Redundant or repetitive testimony will not assist the committee in making its recommendation.
7. After giving your testimony, the members of the Licenses Committee and the licensee may ask questions regarding the testimony you have given or other factors relating to the license application.
8. Business Competition is not a valid basis for denial or non-renewal of a license.
Please Note: If you have submitted an objection to the above application your objection cannot be considered by the committee unless you personally testify at the hearing.

OCCUPANT	MAIL ADDRESS	CITY, STATE ZIP
CURRENT OCCUPANT	2724 N DR MARTIN LUTHER KING DR 4	MILWAUKEE, WI 53212
CURRENT OCCUPANT	2724 N DR MARTIN LUTHER KING DR 3	MILWAUKEE, WI 53212
CURRENT OCCUPANT	2719 N DR MARTIN LUTHER KING DR 303	MILWAUKEE, WI 53212
CURRENT OCCUPANT	2719 N DR MARTIN LUTHER KING DR 203	MILWAUKEE, WI 53212
CURRENT OCCUPANT	2719 N DR MARTIN LUTHER KING DR 305	MILWAUKEE, WI 53212
CURRENT OCCUPANT	2719 N DR MARTIN LUTHER KING DR 307	MILWAUKEE, WI 53212
CURRENT OCCUPANT	310 W CENTER ST C	MILWAUKEE, WI 53212
CURRENT OCCUPANT	2663A N 2ND ST	MILWAUKEE, WI 53212
CURRENT OCCUPANT	2635 N 2ND ST	MILWAUKEE, WI 53212
CURRENT OCCUPANT	2629 N 2ND ST	MILWAUKEE, WI 53212
CURRENT OCCUPANT	2719 N DR MARTIN LUTHER KING DR 205	MILWAUKEE, WI 53212
CURRENT OCCUPANT	2719 N DR MARTIN LUTHER KING DR 301	MILWAUKEE, WI 53212
CURRENT OCCUPANT	2670 N 4TH ST	MILWAUKEE, WI 53212
CURRENT OCCUPANT	329 W CENTER ST	MILWAUKEE, WI 53212
CURRENT OCCUPANT	216 W CENTER ST	MILWAUKEE, WI 53212
CURRENT OCCUPANT	2673 N 2ND ST	MILWAUKEE, WI 53212
CURRENT OCCUPANT	2665 N 2ND ST	MILWAUKEE, WI 53212
CURRENT OCCUPANT	2653 N 2ND ST	MILWAUKEE, WI 53212
CURRENT OCCUPANT	2637 N 2ND ST	MILWAUKEE, WI 53212
CURRENT OCCUPANT	2705 N 2ND ST	MILWAUKEE, WI 53212
CURRENT OCCUPANT	2724 N DR MARTIN LUTHER KING DR 1	MILWAUKEE, WI 53212
CURRENT OCCUPANT	2660 N 4TH ST	MILWAUKEE, WI 53212
CURRENT OCCUPANT	2663 N DR MARTIN LUTHER KING DR	MILWAUKEE, WI 53212
CURRENT OCCUPANT	2671 N 2ND ST	MILWAUKEE, WI 53212
CURRENT OCCUPANT	2663 N 2ND ST	MILWAUKEE, WI 53212
CURRENT OCCUPANT	212 W CENTER ST	MILWAUKEE, WI 53212
CURRENT OCCUPANT	2670 N 2ND ST	MILWAUKEE, WI 53212
CURRENT OCCUPANT	2719 N DR MARTIN LUTHER KING DR 209	MILWAUKEE, WI 53212
CURRENT OCCUPANT	2705 N DR MARTIN LUTHER KING DR D	MILWAUKEE, WI 53212
CURRENT OCCUPANT	2661 N DR MARTIN LUTHER KING DR	MILWAUKEE, WI 53212
CURRENT OCCUPANT	2672 N 2ND ST	MILWAUKEE, WI 53212
CURRENT OCCUPANT	2719 N DR MARTIN LUTHER KING DR 204	MILWAUKEE, WI 53212
CURRENT OCCUPANT	2719 N DR MARTIN LUTHER KING DR 304	MILWAUKEE, WI 53212
CURRENT OCCUPANT	2719 N DR MARTIN LUTHER KING DR 311	MILWAUKEE, WI 53212
CURRENT OCCUPANT	2661 N 2ND ST	MILWAUKEE, WI 53212
CURRENT OCCUPANT	2666 N 2ND ST	MILWAUKEE, WI 53212
CURRENT OCCUPANT	2714 N DR MARTIN LUTHER KING DR	MILWAUKEE, WI 53212
CURRENT OCCUPANT	2724 N DR MARTIN LUTHER KING DR 2	MILWAUKEE, WI 53212
CURRENT OCCUPANT	2719 N DR MARTIN LUTHER KING DR 206	MILWAUKEE, WI 53212
CURRENT OCCUPANT	2719 N DR MARTIN LUTHER KING DR 309	MILWAUKEE, WI 53212
CURRENT OCCUPANT	2719 N DR MARTIN LUTHER KING DR 310	MILWAUKEE, WI 53212
CURRENT OCCUPANT	333 W CENTER ST	MILWAUKEE, WI 53212
CURRENT OCCUPANT	2710 N DR MARTIN LUTHER KING DR	MILWAUKEE, WI 53212
CURRENT OCCUPANT	2633 N 2ND ST	MILWAUKEE, WI 53212
CURRENT OCCUPANT	2719 N DR MARTIN LUTHER KING DR 201	MILWAUKEE, WI 53212
CURRENT OCCUPANT	2719 N DR MARTIN LUTHER KING DR 306	MILWAUKEE, WI 53212

CURRENT OCCUPANT	2719 N DR MARTIN LUTHER KING DR 308	MILWAUKEE, WI 53212
CURRENT OCCUPANT	2670A N 4TH ST	MILWAUKEE, WI 53212
CURRENT OCCUPANT	2670C N 4TH ST	MILWAUKEE, WI 53212
CURRENT OCCUPANT	2705 N DR MARTIN LUTHER KING DR E	MILWAUKEE, WI 53212
CURRENT OCCUPANT	310 W CENTER ST B	MILWAUKEE, WI 53212
CURRENT OCCUPANT	2639 N 2ND ST	MILWAUKEE, WI 53212
CURRENT OCCUPANT	2719 N DR MARTIN LUTHER KING DR 202	MILWAUKEE, WI 53212
CURRENT OCCUPANT	2719 N DR MARTIN LUTHER KING DR 211	MILWAUKEE, WI 53212
CURRENT OCCUPANT	2719 N DR MARTIN LUTHER KING DR 312	MILWAUKEE, WI 53212
CURRENT OCCUPANT	2719 N DR MARTIN LUTHER KING DR 302	MILWAUKEE, WI 53212
CURRENT OCCUPANT	2719 N DR MARTIN LUTHER KING DR 207	MILWAUKEE, WI 53212
CURRENT OCCUPANT	2670B N 4TH ST	MILWAUKEE, WI 53212
CURRENT OCCUPANT	310 W CENTER ST A	MILWAUKEE, WI 53212
CURRENT OCCUPANT	2705 N DR MARTIN LUTHER KING DR F	MILWAUKEE, WI 53212
CURRENT OCCUPANT	200 W CENTER ST	MILWAUKEE, WI 53212
CURRENT OCCUPANT	2705 N 2ND ST A	MILWAUKEE, WI 53212
CURRENT OCCUPANT	2664 N 2ND ST	MILWAUKEE, WI 53212

Total Records: 63

Radius: 250.0 feet and Center of Circle: 233 W Center St



BUSINESS LICENSE PLAN OF OPERATION

ccl-busplan 12/14/17

Office of the City Clerk License Division
200 E. Wells St. Room 105, Milwaukee, WI 53202
(414) 286-2238 www.milwaukee.gov/license e-mail address: license@milwaukee.gov

1. Type of Business

Applying for: ☐ Extended Hours (12AM to 5AM) - If a food establishment, check all that apply: ☐ Delivery ☐ Drive Thru ☐ Dining Room
☐ Self Service Laundry ☐ Massage Establishment ☐ Filling Station
☒ Other (supplemental application for specific license also required)

Provide a detailed description of the type of business you plan on operating:

GROCERY STORE

Do you have any experience operating this type of business? ☐ No ☒ Yes If yes, explain: Working at the same location 15 YRS.

2. Business Operations

- a. Proposed Opening Date: May 1st 2018
- b. Is this premise under construction? ☒ No ☐ Yes If yes, list estimated completion date: _____
- c. Is this a franchise? ☒ No ☐ Yes
- d. Is this premises currently licensed? ☐ No ☒ Yes If yes, list type of license: Beer, Cig, Food
- e. Is the current licensee operating? ☐ No ☒ Yes If no, list date closed: _____
- f. Do you have future plans for other businesses, licenses or permits at this location? ☒ No ☐ Yes
If yes, explain: _____
- g. Have you previously held an Extended Hours License in Milwaukee? ☒ No ☐ Yes
If yes, list address(es): _____
- h. Are other businesses operating in the same building? ☒ No ☐ Yes If yes, describe: _____

3. Litter & Noise

- a. How are grounds kept clean? ☒ Sweep ☐ Pressure Wash ☒ Pick Up Litter ☐ Other: _____
- b. How often will grounds be cleaned? ☒ Daily ☐ Weekly ☐ As Needed ☐ Monthly ☐ Other: _____
- c. Grounds cleaned by: ☐ Licensee ☐ Building Owner ☒ Employees ☐ Hired Maintenance ☐ Other: _____
- d. How are noise issues prevented and/or addressed? ☐ Security ☒ Manager approaches customer(s) ☐ Call Police
☐ Signs Posted ☐ Other: _____
- e. Will a sound amplification system be used? ☒ No ☐ Yes If yes, describe: _____

4. Smoking & Sanitation

- a. Are there designated outdoor smoking areas? ☒ No ☐ Yes If yes, describe: _____
- b. Number of Garbage Cans: Inside: 3 Locations: By entry door / Behind counter
Outside: 2 Locations: By Exit Door
- c. Is a crowd control barrier used? ☒ No ☐ Yes If yes, describe: _____
- d. How many restrooms are on the premises? 1
- e. Name of solid waste contractor: ☐ Advanced Disposal ☐ Waste Management ☒ Other: Eagle Disposal

5. Security

- a. Are there onsite parking spaces? ☐ No ☒ Yes If yes, indicate how many? 20 and describe the parking security plan: Security Camera's
- b. Is there a loading zone? ☒ No ☐ Yes If yes, describe the loading area security plan: _____
- c. Will you have security personnel on premise? ☒ No ☐ Yes If yes, how many? _____ and answer the following:
What are their responsibilities? _____
Is security equipment used? ☐ No ☐ Yes If yes, describe _____
List their licensing, certification, or training credentials _____
- d. Will there be security cameras? ☐ No ☒ Yes If yes, where? 4 outside 12 Inside.
- e. Will searches/identification checks be done upon entry? ☒ No ☐ Yes If yes, describe _____

6. Percentage of Sales (must total 100%)

Alcohol <u>15</u> %	Food <u>65</u> %	Secondhand Merchandise _____ %	Precious Metals & Gems _____ %
Entertainment _____ %	Cigarettes <u>20</u> %		
Pawnbroker Activity _____ %	Salvaged Materials _____ % (such as scrap metal)	Personal Services (such as tattoo, body piercing, salon, tailor, tanning, etc.) _____ %	Other _____ % Describe: _____

7. Businesses/Licenses on the Premises (check all that apply):

Type 1

- | | | | |
|--|---|---|--|
| <input type="checkbox"/> Full Service Restaurant | <input type="checkbox"/> Cafe/Coffee Shop | <input type="checkbox"/> Deli or Fast Food Restaurant | <input type="checkbox"/> Private/Fraternal/Veterans Club |
| <input type="checkbox"/> Night Club | <input type="checkbox"/> Tavern | <input type="checkbox"/> Cocktail Lounge | <input type="checkbox"/> Teen Club |
| <input type="checkbox"/> Banquet Hall | <input type="checkbox"/> Sports Facility | <input type="checkbox"/> Bowling Alley | |
| <input type="checkbox"/> Hotel/Motel : Number of Floors: _____
Number of Rooms: _____ | <input type="checkbox"/> Rooming House: Number of Floors: _____
Number of Rooms: _____ | | |

Type 2

- | | | | |
|--|--|--------------------------------------|---|
| <input type="checkbox"/> Liquor Store | <input type="checkbox"/> Corner Store | <input type="checkbox"/> Supermarket | <input checked="" type="checkbox"/> Convenience Store |
| <input type="checkbox"/> Gas Station | <input type="checkbox"/> Amusement/Phonograph Distributor | | <input type="checkbox"/> Recycling, Salvage or Towing |
| <input type="checkbox"/> Used Car Dealer | <input type="checkbox"/> Personal Service Establishment
(such as tattoo business, hair salon, tailor, etc.) | | <input type="checkbox"/> Recording Studio |

What other licenses/permits will you hold at this location? (check all that apply)

- ☐ Occupancy Permit ☐ Cigarette & Tobacco ☐ Gas Station ☐ Extended Hours ☐ Class "B" Tavern ☐ Weights & Measures
☐ Secondhand Dealer ☐ Precious Metal & Gem ☐ Other: _____

8. Legal Capacity (only if a Type 1 premises in #7 above)

Capacity _____ (Call the Milwaukee Development Center at 414-286-8211 if you have questions.)

9. Premises Description

a. Identify all area(s) of the premises that will be used in operating this business (include areas used only for storage):

☒ 1st Floor ☐ 2nd Floor ☐ Basement Storage ☐ Patio ☐ Beer Garden ☐ Sidewalk Café ☐ Deck ☐ Rooftop

☐ Other: Describe: _____

b. Describe Location: ☒ Major Thoroughfare ☐ Secondary Street ☐ Other: _____

c. Nearest Major Cross Street: MLK Drive

d. Describe Building: ☒ Free Standing Building ☐ Strip Mail ☐ Other: _____

e. Describe Premises Structure: ☒ Single Story ☐ Multi-Story - # of Stories _____ ☐ Other: _____

f. Describe Surrounding Area: ☒ Commercial ☐ Residential ☐ Industrial ☐ Other: _____

g. Building Owner Name: PATIALA INC. Phone Number: (414) 350-7431

Business Owner Address: W133 N 6205 Hummingbird Way, Menomonee Falls, WI 53051

10. Hours of Operation & Customers

Will customers be entering the premises? ☐ No ☒ Yes

ALL Beer Cooler are locked at 8:55 PM.

Day of the Week	Proposed Hours of Operation:		Estimated Number of Customers expected each day	Potential Age Range of Customers	Class B Tavern Applicant Only: Age Restriction (If none, write 'None')
	Open Time (include a.m. or p.m.)	Close Time (include a.m. or p.m.)			
Sunday	8:00 AM	12:00 AM	125	10 YRS & +	
Monday	8:00 AM	12:00 AM	150	80 YRS	
Tuesday	8:00 AM	12:00 AM	150		
Wednesday	8:00 AM	12:00 AM	150		
Thursday	8:00 AM	12:00 AM	150		
Friday	8:00 AM	12:00 AM	200		
Saturday	8:00 AM	12:00 AM	150		

An Extended Hours Establishment License is required for any convenience store, filling station, personal service establishment (such as tattoo, body piercing, salon, tailor, tanning, etc.), recording studio or restaurant which is open between the hours of 12:00 a.m. and 5:00 a.m.

Alcohol Establishments Class A: 8:00 am to 9:00 pm Sunday thru Saturday

Permitted Hours of Operation: Class B: 6:00 am to 2:00 am Sunday thru Thursday, 6:00 am to 2:30 am Friday & Saturday

Entertainment Outdoor Closing Hours: 10:00pm Sunday-Thursday; 12:00am Friday & Saturday; unless a different time, either earlier or later, is established by the Common Council in its approval of the licensee's plan of operation.

11. Signature(s)

Kenneth R. Habel

Signature of Sole Proprietor, Partner, or 20% or more Shareholder

(If there are no 20% or more shareholders,
Corporate Officer-print name/title and sign)

Signature of additional partner or 20% or more shareholder

See Application Information for a complete list of all required application forms.



ALCOHOL BEVERAGE & PUBLIC ENTERTAINMENT PREMISES SUPPLEMENTAL APPLICATION

Office of the City Clerk License Division

200 E. Wells St. Room 105, Milwaukee, WI 53202

(414) 286-2238 e-mail address: license@milwaukee.gov www.milwaukee.gov/licenseLegal Entity Name: LUDHIANA INCPremise Address: 233 W Center St. Milwaukee, WI 53212**Proximity of Premises to Church, School, Daycare Center or Hospital**Is the building within 300 feet of any church, school, daycare center or hospital? ☐ No ☒ Yes**"Service Bar Only" Designation**If applying for Class B or C license, are you applying for "Service Bar Only"? ☒ No ☐ Yes

Service Bar Only means customers cannot sit at the bar. Alcohol is served to patrons seated at tables. No stools, chairs or other articles of furniture shall be placed at the service bar for patrons to sit upon.

Business Informationa) Are you taking out this application for anyone that may not be eligible for a license? ☒ No ☐ Yes

If yes, list their name and address: _____

b) Will the agent, a partner or the individual licensee be conducting the day-to-day operations of the business? ☐ No ☒ Yes

If no, list the name and address of the person(s) who will: _____

Class B Applicants: If the agent, a partner or the individual licensee will not be conducting the day-to-day operations of the business, the person(s) listed above must obtain a Class B Managers license.

c) Does anyone else have money invested or any other interest in this business? ☒ No ☐ Yes

If yes, explain: _____

d) Have you made an agreement with anyone to repay any loan or any other payments based upon income from the business?

☒ No ☐ Yes If yes, list name and address: _____**Proof of Ownership, Lease, or Offer to Purchase (New & Transfer Applicants Only)**

Submit proof of ownership, lease, or offer to purchase the building with this application.

A lease or offer to purchase must:

- a) Be in the same legal entity name as that apply for the license
- b) Reflect the same address as the premises address on this application
- c) Reflect current dates and
- d) Be signed by the lessor/seller and lessee/buyer

Property Information (New & Transfer Applicants Only)a) Do you own or lease the building? ☐ Own ☒ Leaseb) Who owns the fixtures (for example, coolers, etc.)? PATIALA INCc) Are you purchasing the stock and/or fixtures? ☒ No ☐ Yes If yes, amount paid \$ _____d) Total amount paid for business \$ 0e) Total amount paid for goodwill of the business \$ 0

Goodwill comprises the reputation and customer relationships of an existing business. If the price you pay for the business exceeds the fair market value of all of the rest of the assets of the business, the excess may be considered goodwill.

f) Have you made arrangements with the seller for payment of personal property taxes? ☐ No ☒ Yes*See Application Information for a list of all required application forms.*

Lease Information (New & Transfer Applicants who are leasing the premises only)

- a) Date lease begins May 1st 2018 Ends April 30, 2023
- b) Monthly rental \$ 2500.00
- c) Do you have an option to renew the lease? ☒ No ☐ Yes
- d) Does your lease allow for assignment to another party without the consent of the owner? ☒ No ☐ Yes
- e) For what length of time have you been guaranteed occupancy (number of years)? 5 YRS
- f) In addition to paying the monthly rental, will you have to pay anything additional to the owner of the building to guarantee performance of the lease? ☐ No ☒ Yes If yes, explain Property Tax
- g) Does the present owner or occupancy object to the granting of your license? ☒ No ☐ Yes
If yes, explain _____

Change of Agent Applicants Only

Have there been any changes to the floor plan since the last application was submitted? ☐ No ☐ Yes

If no, a new floor plan is not required. If yes, submit a new floor plan and explain the change(s): _____

Notarized Signatures of Applicants

SUBSCRIBE AND SWORN TO BEFORE ME
This 10/17/18 day of April

(Clerk/Notary Public)

My Commission Expires _____
*Notary Seal must be affixed.

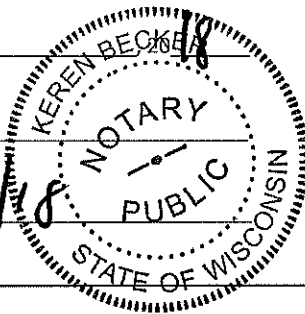

Kenneth E. Walcott
Sole Proprietor, Partner, 20% or more Shareholder, or
Agent – only if there are no 20% or more shareholders

Additional partner or 20% or more shareholder

Note: All information contained in this application is subject to approval by the Common Council.
Deviating from approved plan of operation will subject licensee to citations, and/or suspension or non-renewal of the license.
Contact the License Division for information on how to request changes.

New and transfer of premise applicants must submit the following:

- ☐ Proof of ownership, lease or offer to purchase the building
- ☐ Detailed floor plan
- ☐ If a restaurant, copy of the menu

**FOOD DEALER LICENSE PLAN OF OPERATION**

OFFICE OF THE CITY CLERK, LICENSE DIVISION
CITY HALL, 200 E. WELLS ST, ROOM 105, MILWAUKEE, WI 53202
(414) 286-2238 • license@milwaukee.gov • www.milwaukee.gov/license

Legal Entity Name:	LUDHIANA INC
Premises Address:	233 W CENTER ST. MILWAUKEE, WI 53212.
SECTION 1 TYPE OF BUSINESS	
Type of application (check one):	<input checked="" type="checkbox"/> taking over a currently operating business <input type="checkbox"/> starting a new business
Anticipated opening date?	May 30 th 2018
Check the type that best describes your business (check only one): See Food Dealer License Information sheet for definitions. <input type="checkbox"/> Restaurant <input type="checkbox"/> Bed & Breakfast <input checked="" type="checkbox"/> Retail Establishment <input type="checkbox"/> Base for Food Peddler If retail, will it be a convenience store? <input checked="" type="checkbox"/> Yes <input type="checkbox"/> No <input type="checkbox"/> Base for Temporary/Seasonal Food Stand (Convenience Stores have less than 5,000 sq ft of retail space, primary business is the sale of basic food items, and in addition sells household products) In addition, will any wholesale business be done? <input type="checkbox"/> Yes <input checked="" type="checkbox"/> No If yes, what percentage of the business will be wholesale? <input type="checkbox"/> Less than 25% <input type="checkbox"/> 25% or More (Contact DATCP)* Will retail items be sold? <input type="checkbox"/> No <input checked="" type="checkbox"/> Yes If Yes, indicate percentage of food sales <u>65</u> % Will restaurant items be sold? <input checked="" type="checkbox"/> No* <input type="checkbox"/> Yes If Yes, indicate percentage of food sales _____ % * If you checked "25% or More" of the business will be wholesale and answered "No" to restaurant items being sold, do not continue completing this application. A City of Milwaukee License is not required. Contact DATCP only.	
SECTION 2 FOOD PROCESSING	
Will any food processing be done? <input checked="" type="checkbox"/> No <input type="checkbox"/> Yes <i>Processing is defined as assembling, grinding, cutting, mixing, baking, coating, stuffing, packing, bottling, grilling, canning, extracting, fermenting, distilling, pickling, freezing, drying, smoking, or packaging.</i> If Yes, check the types of food items: <input type="checkbox"/> SNACKS & BEVERAGES <i>includes, but is not limited to, ice cream/soft serve, lemonade, snow cones, coffee, espresso, cappuccino, tea, fruit juice, smoothies, candy, dispensed soda, fruit cups, bakery, cookies, popcorn, kettle corn, cotton candy, funnel cakes, fritters, tortilla chips w/ cheese</i> <input type="checkbox"/> MEALS <i>includes, but is not limited to, chicken, ribs, sandwiches, roasted corn, baked potatoes, hot dogs, brats, tacos, nachos w/ cheese and meat, French fries, cooked or deep fried vegetables/fruit, cooked cheese curds, corn dogs, egg rolls, salads</i>	
SECTION 3 FOOD REQUIRING TEMPERATURE CONTROL	
Will any food that requires temperature control be sold? <input type="checkbox"/> No <input checked="" type="checkbox"/> Yes (includes dairy products such as milk, cheese, and ice cream, fish, shellfish, meat, poultry) If yes, list the types of food items: <u>Milk, poultry, cheese, Ice Cream</u>	

SECTION 4 SHARED KITCHEN

Will you be sharing kitchen space with another operator?

☒ No

If No, SKIP to Section 5

☐ Yes

If Yes, check one:

☐ I will rent space from another operator ("Shared Kitchen Agreement" is required)☐ I will rent space to another operator (peddler/caterer)**SECTION 5 DETAILS OF OPERATION**

Answer the following questions:

Will you have seating on site for dining?

☒ No ☐ Yes

Will you be doing any catering?

☒ No ☐ Yes

Will you be doing any delivery?

☒ No ☐ Yes

Will you have outdoor activities?

☒ No ☐ Yes

If Yes to outdoor activities, check all that apply:

☐ Bar☐ Cooking/Grilling☐ Dining

Will you have a drive thru window?

☒ No ☐ Yes

If Yes to drive thru, are hours different from inside?

☐ No ☐ Yes

If Yes, provide drive thru hours: _____

Will any scales or barcode scanners be used?

☐ No ☒ Yes

If Yes, a Weights & Measures application must be completed and a license obtained.

SECTION 6 ADDITIONAL SITES

Where will food be prepared and/or sold?

☒ At a single site☐ At multiple sites (for example, a hotel with several dining rooms or bars)

How many? _____

If multiple sites, attach a Food Dealer Additional Site Addendum (ccl-foodadd) for each additional site.

SECTION 7 CONSTRUCTION OR CHANGES

Are you planning any construction, remodeling or equipment changes?

☒ No

If No, SKIP to Section 8

☐ Yes

If Yes, check all that apply:

☐ New construction of a building☐ Construction changes to an existing building☐ Renovation or remodeling☐ Equipment changes only (installation or replacement)

Provide a brief description of the changes: _____

Start date: _____

Name, Address & Phone Number of Architect: _____

Name, Address & Phone Number of Contractor: _____

SECTION 8 ALCOHOL BEVERAGES

Are you applying for an alcohol beverage license?

☐ No If No, SKIP to Section 9☒ Yes If YES, if your food license is approved prior to the alcohol beverage license, when do you want the food license issued? ☐ Immediately ☒ At the same time as the alcohol license**SECTION 9 ACKNOWLEDGEMENTS & SIGNATURE**

You must initial each item confirming your understanding:

KH
KH

I understand the Health Department must conduct an inspection and advise the License Division of their approval before the license may be issued.

KH

I understand I must obtain an occupancy permit from the Department of Neighborhood Services and an inspection may be required. Neighborhood Services must advise the License Division of their approval before the license may be issued.

KH

I understand the district alderperson will review and either approve or deny my application. If denied, I may appeal and be scheduled to appear before the Licenses Committee. The Licenses Committee will then make a recommendation to the Common Council. The Common Council must grant the license before it may be issued.

KH

I understand proof of payment for all license fees must be on file in the License Division before the license may be issued.

KH

I understand the license must be issued and posted in my establishment prior to opening for business.

I will not operate my food business until the license has been issued and posted in the establishment.

Signature of sole proprietor, partner, agent or 20% shareholder:

Kenneth D. Habel

Signature of additional partner(s): _____



PUBLIC ENTERTAINMENT PREMISES LICENSE SUPPLEMENTAL APPLICATION

Office of the City Clerk License Division

200 E. Wells St. Room 105, Milwaukee, WI 53202

(414) 286-2238 www.milwaukee.gov/license e-mail address: license@milwaukee.gov

PREMISES ADDRESS: 233 W Center St. Milwaukee, WI 53212.

TYPES OF ENTERTAINMENT (CHECK ALL THAT APPLY)

<input type="checkbox"/> Instrumental Musicians	<input type="checkbox"/> Bands	<input type="checkbox"/> Battle of the Bands	<input type="checkbox"/> Comedy Acts
<input type="checkbox"/> Disc Jockey	<input type="checkbox"/> Magic Shows	<input type="checkbox"/> Poetry Readings	<input type="checkbox"/> Dancing by Performers
<input type="checkbox"/> Jukebox	<input type="checkbox"/> Wrestling	<input type="checkbox"/> Patron Contests	<input type="checkbox"/> Patrons Dancing
<input type="checkbox"/> Adult Entertainment/ Strippers/Erotic Dance	<input type="checkbox"/> Karaoke	<input type="checkbox"/> Bowling Alley	<input type="checkbox"/> Pool Tables
<input type="checkbox"/> Motion Pictures on Projection Screens – How many? _____	<input type="checkbox"/> Amusement Machines – How many? _____	<input type="checkbox"/> Concerts Approx. # per year? _____	<input type="checkbox"/> Theatrical Performances Approx. # per year? _____
<input checked="" type="checkbox"/> Other: <u>Phone Charging Kiosk's.</u>			

Entertainment Outdoor Closing Hours: 10:00pm Sunday-Thursday; 12:00am Friday & Saturday; unless a different time, either earlier or later, is established by the Common Council in its approval of the licensee's plan of operation.

PROMOTERS/SOUND AMPLIFICATION

Will promoters ever be used for any of the entertainment? ☒ No ☐ Yes If Yes, Describe:

At any time will sound amplification be used? ☒ No ☐ Yes If Yes, Describe:

LEGAL CAPACITY OF PREMISES

_____ (Call the Development Center at 414-286-8211 with questions.) Legal capacity determines the fee for your Public Entertainment Premises License. If you would like to request the license be approved with a lower capacity than that listed above, indicate the lower capacity here: _____. If approved, this lower capacity will print on your license and override the capacity listed on your Occupancy Permit.

NOTARIZED SIGNATURES

I understand that after the license has been issued, a change to the plan of operation will require a written request to change and approval from the Common Council. I agree to inform the City Clerk within 10 days of any substantial changes in the information supplied in this application.

I understand that I shall not willfully refuse to provide the services offered under this license, or add charges or require deposits not required of the general public because of race, color, sex, religion, national origin or ancestry, age, handicap, lawful source of income, marital status, sexual orientation, gender identity or expression, familial status or the fact that a person is now or has been a member of the military service, whether dressed in uniform or not; and shall not seek such information as a condition of employment, or penalize any employee or discriminate in the selection of personnel for training or promotion on the basis of such information.

I have knowledge of the City Ordinances currently regulating public entertainment, and understand that the license may be subject to suspension, non-renewal or revocation, if I violate any rule, law or regulation of the city of Milwaukee and State of Wisconsin.

SUBSCRIBED AND SWORN TO BEFORE ME

This 10th day of April

(Clerk/Notary Public)

My Commission Expires 10/7/18
Notary Seal must be affixed

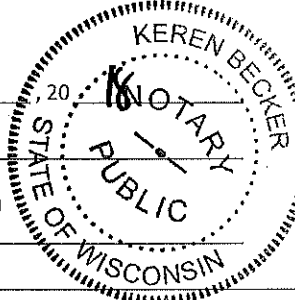

Kenneth R. Holzel
Sole Proprietor, Partner or 20% or More Shareholder
(If no 20% or more shareholder, Corporate Officer-
print name/title and sign)

Additional partner or 20% or more shareholder

Office Use Only:

Initials: _____ Filed: _____ App: _____

☐ Check if only PEP (must be heard w/in 60 days) Granted _____ License # _____



WEIGHTS & MEASURES LICENSE SUPPLEMENTAL APPLICATION

OFFICE OF THE CITY CLERK, LICENSE DIVISION

CITY HALL, 200 E. WELLS ST, ROOM 105, MILWAUKEE, WI 53202

(414) 286-2238 • license@milwaukee.gov • www.milwaukee.gov/license

Office Use Only:

App# _____
 Filed _____
 Initials _____
 Paid _____
 Lic # _____

Legal Entity Name: **LUDHIANA INC**Premise Address: **233 W Center St. Milwaukee, WI 53212.**

Device Type(s)

- Check all device types for which you need a license.
 - For each device type checked, indicate how many you have in the Number of Devices column (b).
 - Calculate the Total Fee Per Device Type by multiplying the Fee Per Device Type (a) by the Number of Devices (b).
 - Add all Total Fee Per Device Type amounts together and that will be your Total Fee Due.
- * **Exception:** The Scanner fee is not per device. Check the box for the appropriate range.
 If you have 1-3 scanners, the total due is \$130. If you have 4 or more scanners, the total due is \$250.
 Check the Number of Devices (b).

Device Type	License Period	Fee Per Device Type (a)	Number of Devices (b)	Total Fee Per Device Type (a x b)
Liquid Measuring Devices				
<input type="checkbox"/> Retail Petroleum Meters	12 months	\$60		
<input type="checkbox"/> 0 to 30 gallons per minute	24 months	\$60		
<input type="checkbox"/> 31 to 200 gallons per minute	24 months	\$250		
<input type="checkbox"/> Over 200 gallons per minute	24 months	\$250		
Scales				
<input checked="" type="checkbox"/> 0 to 300 pounds	24 months	\$55	1	\$55.00
<input type="checkbox"/> 301 to 5,000 pounds	24 months	\$190		
<input type="checkbox"/> 5,001 to 40,000 pounds	24 months	\$300		
<input type="checkbox"/> Over 40,000 pounds	24 months	\$400		
Scanners				
		Fee for scanners is by range	Check how many scanners you have	
<input type="checkbox"/> Up to 3 scanners	24 months	\$130 total*	<input type="checkbox"/> 1 <input type="checkbox"/> 2 <input type="checkbox"/> 3	
<input type="checkbox"/> Four or more scanners	24 months	\$250 total*	<input type="checkbox"/> 4 <input type="checkbox"/> Other	
Other Devices				
<input type="checkbox"/> Length Measuring Device	24 months	\$60		
<input type="checkbox"/> Timing Device	24 months	\$30		
Total Fee Due				\$55.00

Signature

I hereby agree that I will comply with the applicable sections of the Wisconsin State Statutes, Administrative Code and the Milwaukee Code of Ordinances regarding the operation of weighing and measuring devices.

I understand that all devices must be operated within the specifications, tolerances and other technical requirements set forth in the National Institute of Standards and Technology Handbook 44. I understand that the license for which I am applying must be posted on the premises or in my vehicle prior to opening for business or operating the device.

I understand that these device licenses are not transferable (with the exception of scanners). If the device is replaced or needs to be resealed, I must apply for and receive a new license so that an inspection of the device can be performed prior to its use.

I acknowledge that as a condition of being issued this license, I must allow the Health Department into the establishment to test the device to validate its specifications/tolerances. If my devices are found out of compliance, I may be charged inspection fees.

I have read, understand, and will adhere to all the above acknowledgments.

Signature of Sole Proprietor, Partner, 20% or more Shareholder
 or Agent – if there are no 20% or more shareholders

W Center St

FLOOR PLAN

4/2/2018

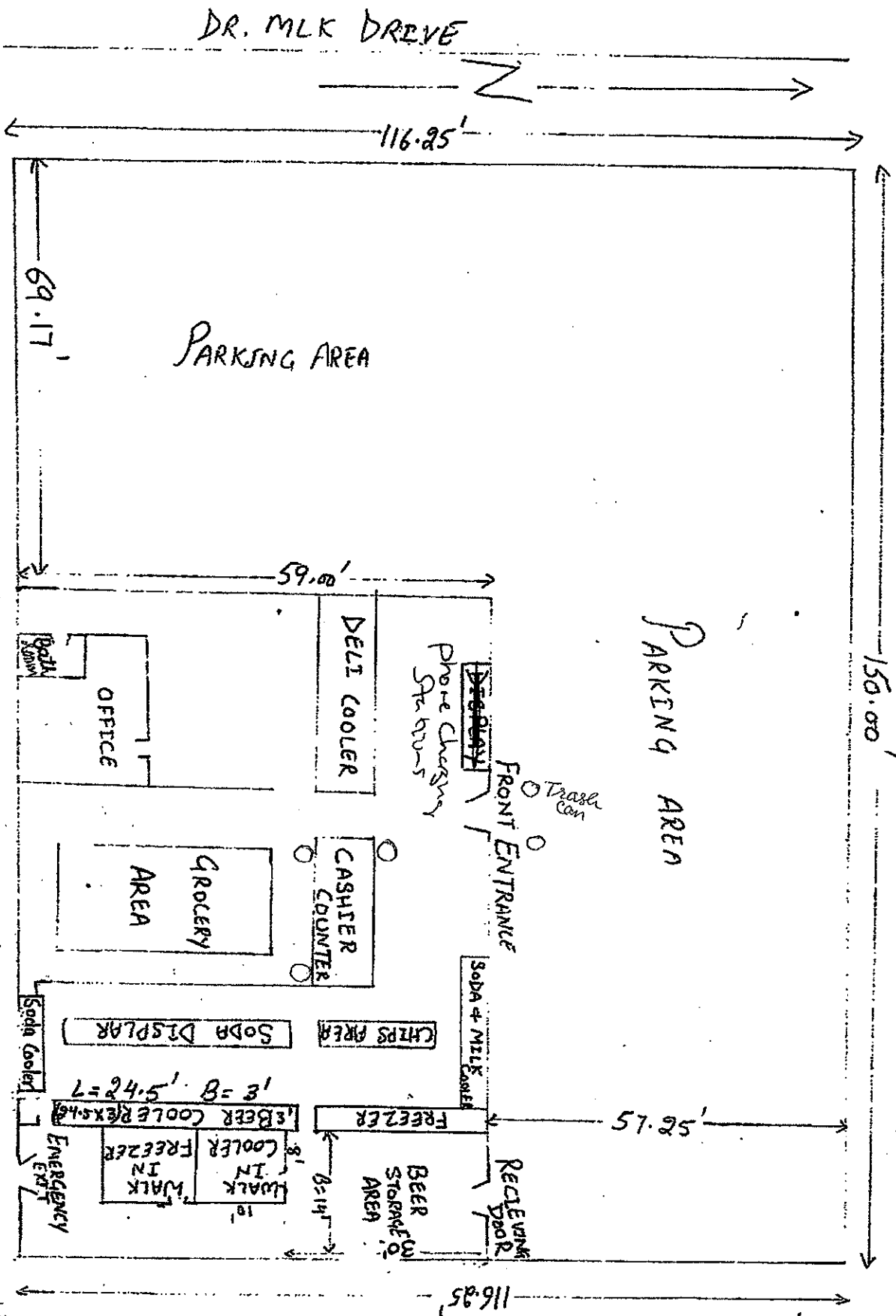

Total Square
Footage
17,437.5'

LUDHIANA INC

LT'L General

233 W Center St

Milwaukee

Kenneth & Hall



**CITY OF MILWAUKEE
OFFICE OF THE CITY CLERK**

Tuesday, July 10, 2018

COMMITTEE MEETING NOTICE

AD 06

NAGRA, Gurinder S, Agent
N. Port Food & Liquor Inc
3876 N Port Washington Av

Milwaukee, WI 53212

You are requested to attend a hearing which is to be held in Room 301-B, Third Floor, City Hall on:

Tuesday, July 17, 2018 at 02:00 PM

Regarding: Your Class A Malt & Class A Liquor and Food  License Renewal Applications as agent for "N. Port Food & Liquor Inc" for "N. Port Food & Liquor" at 3876 N Port Washington Av.

There is a possibility that your application may be denied for one or more of the following reasons: The recommendation of the committee regarding the application shall be based on evidence presented at the hearing. Per MCO 85-4-4, unless otherwise specified in the code, probative evidence concerning non-renewal, suspension or revocation may include evidence of the following: failure of the applicant to meet municipal qualifications, pending charges against or the conviction of any felony, misdemeanor, municipal offense or other offense, the circumstances of which substantially relate to the circumstances of the particular licensed or permitted activity, by the applicant or by any employee or other agent of the applicant. If the activities of the applicant involve a licensed premises, whether the premises tends to facilitate a public or private nuisance or has been the source of congregations of persons which have resulted in any of the following: disturbance of the peace; illegal drug activity; public drunkenness; drinking in public; harassment of passers-by; gambling; prostitution; sale of stolen goods; public urination; theft; assaults; battery; acts of vandalism including graffiti, excessive littering, loitering, illegal parking, loud noise at times when the licensed premise is open for business; traffic violations; curfew violations; lewd conduct; display of materials harmful to minors, pursuant to s. 106-9.6; or any other factor which reasonably relates to the public health, safety and welfare, or failure to comply with the approved plan of operation. See attached police report or correspondence.

**Notice for applicants with
warrants or unpaid fines:**

Proof of warrant satisfaction or payment of fines must be submitted at the hearing on the above date and time. Failure to comply with this requirement may result in a delay of the granting/denial of your application.

Failure to appear at this meeting may result in the denial of your license. Individual applicants must appear only in person or by an attorney. Corporate or Limited Liability applicants must appear only by the agent designated on the application or by an attorney. Partnership applicants must appear by a partner listed on the application or by an attorney. If you wish to do so and at your own expense, you may be accompanied by an attorney of your choosing to represent you at this hearing.

You will be given an opportunity to speak on behalf of the application and to respond and challenge any charges or reasons given for the denial. No petitions can be accepted by the committee, unless the people who signed the petition are present at the committee hearing and willing to testify. You may present witnesses under oath and you may also confront and cross-examine opposing witnesses under oath. If you have difficulty with the English language, you should bring an interpreter with you, at your expense, so that you can answer questions and participate in your hearing.

You may examine the application file at this office during regular business hours prior to the hearing date. Inquiries regarding this matter may be directed to the person whose signature appears below.

Limited parking for persons attending meetings in City Hall is available at reduced rates (5 hour limit) at the Milwaukee Center on the southwest corner of East Kilbourn and North Water Street. Parking tickets must be validated in the first floor information booth in City Hall.

PLEASE NOTE: Upon reasonable notice, efforts will be made to accommodate the needs of disabled individuals through sign language interpreters or other auxiliary aids. For additional information or to request this service, contact the Council Services Division ADA Coordinator at (414) 286-2998, Fax - (414) 286-3456, TDD - (414) 286-2025.

JIM OWCZARSKI, CITY CLERK

BY:

Jessica Celella

License Division Manager

If you have questions regarding this notice, please contact the License Division at (414) 286-2238.

200 E. Wells Street, Room 105, City Hall, Milwaukee, WI 53202. www.milwaukee.gov/license
Phone: (414) 286-2238 Fax: (414) 286-3057 Email Address: License@milwaukee.gov

MILWAUKEE POLICE DEPARTMENT

LICENSING

CRIMINAL RECORD/ORDINANCE VIOLATION/INCIDENTS SYNOPSIS

DATE: 06/13/2018

LICENSE TYPE: ALQML

NEW: ☐

RENEWAL: ☒

No. 276357

Application Date: 06/13/2018

License Location: 3876 N. Port Washington Ave.

Business Name: N. Port Food & Liquor

Licensee/Applicant: Nagra, Gurinder S
(Last Name, First Name, MI)

Date of Birth: 07/30/70

Home Address: 3776 Cypress Lane

City: Milwaukee

State: WI **Zip Code:** 53132

Home Phone: (414)

This report is written by Police Officer David NOVAK, assigned to the License Investigation Unit, Days.

The Milwaukee Police Department's investigation regarding this application revealed the following:

1. On 02/25/2014 the applicant was cited at 2667 North 5th Street in the city of Milwaukee for Responsible Person on Premises Required.

Charge: Responsible Person on Premises Required

Finding: Guilty

Sentence: \$368.00 fine

Date: 04/17/2014

Case: 14018997

2. On 05/15/2014 the applicant was cited at 2029 North Holton Street in the city of Milwaukee for Building Code Violations.

Charge: Building Code Violations

Finding: Guilty

Sentence: \$280.00 fine

Date: 01/15/2015

Case: 14062301

3. On 01/26/2016 the applicant was cited in the City of Milwaukee at 4839 N. Green Bay Av for Building Code Violations.

Charge: Building Code Violations
Finding: Guilty
Sentence: Fined \$980.00
Date: 01/05/2017
Case: 13033149

4. On 06/16/2016 the applicant was cited in the City of Milwaukee at 4110 W. Martin Dr for Building Code Violations.

Charge: Building Code Violations
Finding: Guilty
Sentence: Fined \$280.00
Date: 01/17/2017
Case: 16051366

=====

5. On 11/17/2017 officers were dispatched to an Armed Robbery complaint at North Port Food, 3876 N. Port Washington Av. The investigation revealed approx. \$500-600 dollars and 25 bottles of liquor were taken. There were no cameras in the business and the licenses were not posted.

6. On 08/02/2017 the applicant was cited in the City of Milwaukee at 4839 N. Green Bay Av for

Charge: Building Code Violations
Finding: Guilty
Sentence: Fined \$330.00
Date: 01/25/2018
Case: 17074331

7. On 08/22/2017 the applicant was cited in the City of Milwaukee at 2667 N. 5th St for

Charge: Responsible Person on Premises Required
Finding: Guilty
Sentence: Fined \$190.00
Date: 02/22/2008
Case: 17042400

8. On 08/26/2017 the applicant was cited in the City of Milwaukee at 2667 N. 5th St for

Charge: Sale of Cigarettes to Minor/Underage
Finding: pending further proceedings on 06/27/2018
Sentence:
Date:
Case: 17051220

9. On 08/26/2017 the applicant was cited in the City of Milwaukee at 6811 N. Teutonia Av for

Charge: Sale of Cigarettes to Minor/Underage
Finding: pending further proceedings on 06/27/2018
Sentence:
Date:
Case: 17051221

MILWAUKEE POLICE DEPARTMENT

REPORT OF INCIDENTS INVOLVING LICENSED PERSONS OR PREMISES

TO: Captain Timothy HEIER

Business Name: N. Port Food & Liquor Inc.

Address of Licensed Premises: 3876 N. Port Washington Ave.

District: 5

Business Phone: 414-372-2232

Type of License: ALQML 199416

☐ Violation / ☒ Incident # 17-319-0143

Date of Incident: 11-15-17

Licensee or Manager on premises at time of violation / incident? ☐ Yes ☒ NoLicensee cooperative? ☒ Yes ☐ No (If no, explain in narrative section)

Licensee Notified by Officer: PO Russell MACRAE

Date: 11-17-17

Time: 8:00 p.m.

Licensee or Agent's Name: NAGRA, Gurinder

Date of Birth: 07/30/70

Home Address: 6980 S. 35th St. Franklin WI 53132

Home Phone: 414-467-2795

Co-Licensee Name:

Date of Birth:

Home Address:

Home Phone:

Class S License Number:

Bartender Name:

Date of Birth:

Home Address:

Home Phone:

Class D License Number:

Licensed Person / Public Pass. Vehicle, etc.:

Date of Birth:

Home Address:

Home Phone:

Class D License Number:

VIOLATION/INCIDENT - DESCRIBE FACTS AND CIRCUMSTANCES IN NARRATIVE SECTION

Name of Person Cited:

Date of Birth:

Citation Number:

Violation & Ord. / Statue No.:

Court Date:

Name of Person Cited:

Date of Birth:

Citation Number:

Violation & Ord. / Statue No.:

Court Date:

Name of Person Cited:

Date of Birth:

Citation Number:

Violation & Ord. / Statue No.:

Court Date:

Name of Person Cited:

Date of Birth:

Citation Number:

Violation & Ord. / Statue No.:

Court Date:

Name of Person Cited:

Date of Birth:

Citation Number:

Violation & Ord. / Statue No.:

Court Date:

Investigating Officer: P.O. Daniel SCOTT

District / Bureau: 54

Date: 12-07-17

Commanding Officer

Date

DISPOSITION - FOR LICENSING ONLY

Citation No.	Case Number	Disposition	Judge	Date
			LICENSE INVESTIGATION UNIT	
		Received	1-2-18	
		Referred		
		By		

PA-33E Narrative

This report is written by P.O. Daniel SCOTT, assigned to District 5, Early Shift.

On Wednesday, November 15th, 2017 at 7:53 PM, Squad 5222 (P.O. Tyler SEELOW and myself) was dispatched to an Armed Robbery complaint at 3876 N Port Washington Rd, North Port Food & Liquor.

We arrived at 7:56 PM and found the business occupied by 2 employees, Sukhdev SINGH (w/m 03-23-94) and Maurice HAROLD (b/m 11-20-60). SINGH had been working behind the register as a cashier and HAROLD was working as security/greeter.

During the course of the armed robbery, approximately \$500-\$600 dollars was taken from the register along with approximately 25 bottles of liquor from behind the cashier's counter. I observed that the store seemed to be only half way stocked with large open spaces including the entire south wall. Approximately half of the ceiling tiles had yet to be installed. No security cameras were installed at the location. SINGH was unable to provide me with any license information at the time. The store licenses was not on his person nor was it displayed anywhere in the store.



Tuesday, July 10, 2018



Notice of Public Hearing

NAGRA, Gurinder S, Agent
N. Port Food & Liquor at 3876 N Port Washington Av
Class A Malt & Class A Liquor and Food Dealer License Renewal Applications

Tuesday, July 17, 2018 at 2:00 PM

To whom it may concern:

The above application has been made by the above named applicant(s). This requires approval from the Licenses Committee and the Common Council of the City of Milwaukee. The hearing before the Licenses Committee will take place on 7/17/2018 at 2:00 PM, in Room 301-B, Third Floor, City Hall. If you wish, you may provide testimony at the hearing regarding the request; see below for further information. You are not required to attend the hearing. Once the Licenses Committee makes its recommendation, this recommendation is forwarded to the full Common Council for approval at its next regularly scheduled hearing. Please review the information below and if you have further questions regarding this process, please contact the License Division at (414) 286-2238.

Important details for those wishing to provide information for the Licenses Committee to consider when making its recommendation:

1. The license application is scheduled to be heard at the above time. Due to other hearings running longer than scheduled, you may have to wait some time to provide your testimony.
2. You must appear in person and testify as to matters that you have personally experienced or seen. (You cannot provide testimony for your neighbor, parent or anyone else; this is considered hearsay and cannot be considered by the committee.)
3. No letters or petitions can be accepted by the committee (unless the person who wrote the letter or the persons who signed the petition are present at the committee hearing and willing to testify).
4. Persons opposed to the license application are given the opportunity to testify first; supporters may testify after the opponents have finished.
5. When you are called to testify, you will be sworn in and asked to give your name, and address. (If your first and/or last names are uncommon please spell them.)
6. You may then provide testimony.
 - a. Include only information relating to the above license application.
 - b. Include only information you have personally witnessed or seen.
 - c. Provide concise and relevant information detailing how this business has affected or may affect the peaceful enjoyment of your neighborhood.
 - d. If by the time you have the opportunity to testify, the information you wish to share has already been provided to the committee, you may state that you agree with the previous testimony. Redundant or repetitive testimony will not assist the committee in making its recommendation.
7. After giving your testimony, the members of the Licenses Committee and the licensee may ask questions regarding the testimony you have given or other factors relating to the license application.
8. Business Competition is not a valid basis for denial or non-renewal of a license.
Please Note: If you have submitted an objection to the above application your objection cannot be considered by the committee unless you personally testify at the hearing.

OCCUPANT	MAIL ADDRESS	CITY, STATE ZIP
CURRENT OCCUPANT	3872 N PORT WASHINGTON AVE A	MILWAUKEE, WI 53212
CURRENT OCCUPANT	3893A N 5TH ST	MILWAUKEE, WI 53212
CURRENT OCCUPANT	3887 N 5TH ST	MILWAUKEE, WI 53212
CURRENT OCCUPANT	508 W ABERT PL	MILWAUKEE, WI 53212
CURRENT OCCUPANT	3888 N 5TH ST	MILWAUKEE, WI 53212
CURRENT OCCUPANT	3870 N 5TH ST	MILWAUKEE, WI 53212
CURRENT OCCUPANT	3892A N PORT WASHINGTON AVE	MILWAUKEE, WI 53212
CURRENT OCCUPANT	3876 N 6TH ST	MILWAUKEE, WI 53212
CURRENT OCCUPANT	3866 N 6TH ST	MILWAUKEE, WI 53212
CURRENT OCCUPANT	3860 N 6TH ST	MILWAUKEE, WI 53212
CURRENT OCCUPANT	3888 N PORT WASHINGTON AVE 4	MILWAUKEE, WI 53212
CURRENT OCCUPANT	3872 N PORT WASHINGTON AVE	MILWAUKEE, WI 53212
CURRENT OCCUPANT	3846 N PORT WASHINGTON AVE 5	MILWAUKEE, WI 53212
CURRENT OCCUPANT	3883 N 5TH ST	MILWAUKEE, WI 53212
CURRENT OCCUPANT	3867 N 5TH ST	MILWAUKEE, WI 53212
CURRENT OCCUPANT	3851 N 5TH ST	MILWAUKEE, WI 53212
CURRENT OCCUPANT	3853 N 5TH ST	MILWAUKEE, WI 53212
CURRENT OCCUPANT	3886 N 5TH ST	MILWAUKEE, WI 53212
CURRENT OCCUPANT	3876 N 5TH ST	MILWAUKEE, WI 53212
CURRENT OCCUPANT	3864 N 5TH ST	MILWAUKEE, WI 53212
CURRENT OCCUPANT	3892 N 5TH ST	MILWAUKEE, WI 53212
CURRENT OCCUPANT	3872 N 6TH ST	MILWAUKEE, WI 53212
CURRENT OCCUPANT	3874 N 6TH ST	MILWAUKEE, WI 53212
CURRENT OCCUPANT	3888 N PORT WASHINGTON AVE 1	MILWAUKEE, WI 53212
CURRENT OCCUPANT	3846 N PORT WASHINGTON AVE 2	MILWAUKEE, WI 53212
CURRENT OCCUPANT	3873 N 5TH ST	MILWAUKEE, WI 53212
CURRENT OCCUPANT	3862 N 5TH ST	MILWAUKEE, WI 53212
CURRENT OCCUPANT	3894 N PORT WASHINGTON AVE	MILWAUKEE, WI 53212
CURRENT OCCUPANT	3846 N PORT WASHINGTON AVE 3	MILWAUKEE, WI 53212
CURRENT OCCUPANT	3846 N PORT WASHINGTON AVE 1	MILWAUKEE, WI 53212
CURRENT OCCUPANT	3893 N 5TH ST	MILWAUKEE, WI 53212
CURRENT OCCUPANT	3886 N 6TH ST	MILWAUKEE, WI 53212
CURRENT OCCUPANT	3878 N 6TH ST	MILWAUKEE, WI 53212
CURRENT OCCUPANT	3851 N PORT WASHINGTON AVE	MILWAUKEE, WI 53212
CURRENT OCCUPANT	3881 N PORT WASHINGTON AVE	MILWAUKEE, WI 53212
CURRENT OCCUPANT	3888 N PORT WASHINGTON AVE 8	MILWAUKEE, WI 53212
CURRENT OCCUPANT	3878 N PORT WASHINGTON AVE	MILWAUKEE, WI 53212
CURRENT OCCUPANT	3846 N PORT WASHINGTON AVE 6	MILWAUKEE, WI 53212
CURRENT OCCUPANT	3847 N 5TH ST	MILWAUKEE, WI 53212
CURRENT OCCUPANT	3892 N PORT WASHINGTON AVE	MILWAUKEE, WI 53212
CURRENT OCCUPANT	3882 N 6TH ST	MILWAUKEE, WI 53212
CURRENT OCCUPANT	3861 N 5TH ST	MILWAUKEE, WI 53212
CURRENT OCCUPANT	3870A N 5TH ST	MILWAUKEE, WI 53212
CURRENT OCCUPANT	3890 N 5TH ST	MILWAUKEE, WI 53212
CURRENT OCCUPANT	3895 N 5TH ST	MILWAUKEE, WI 53212
CURRENT OCCUPANT	3870 N 6TH ST	MILWAUKEE, WI 53212

CURRENT OCCUPANT	3883 N PORT WASHINGTON AVE	MILWAUKEE, WI 53212
CURRENT OCCUPANT	3888 N PORT WASHINGTON AVE 6	MILWAUKEE, WI 53212
CURRENT OCCUPANT	3888 N PORT WASHINGTON AVE 7	MILWAUKEE, WI 53212
CURRENT OCCUPANT	3846 N PORT WASHINGTON AVE 7	MILWAUKEE, WI 53212
CURRENT OCCUPANT	3897 N 5TH ST	MILWAUKEE, WI 53212
CURRENT OCCUPANT	3864 N 6TH ST	MILWAUKEE, WI 53212
CURRENT OCCUPANT	3888 N PORT WASHINGTON AVE 5	MILWAUKEE, WI 53212
CURRENT OCCUPANT	3888 N PORT WASHINGTON AVE 3	MILWAUKEE, WI 53212
CURRENT OCCUPANT	3880 N PORT WASHINGTON AVE	MILWAUKEE, WI 53212
CURRENT OCCUPANT	3870A N PORT WASHINGTON AVE	MILWAUKEE, WI 53212
CURRENT OCCUPANT	3846 N PORT WASHINGTON AVE 8	MILWAUKEE, WI 53212
CURRENT OCCUPANT	3846 N PORT WASHINGTON AVE 4	MILWAUKEE, WI 53212
CURRENT OCCUPANT	3871 N 5TH ST	MILWAUKEE, WI 53212
CURRENT OCCUPANT	3882 N 5TH ST	MILWAUKEE, WI 53212
CURRENT OCCUPANT	3896 N PORT WASHINGTON AVE	MILWAUKEE, WI 53212
CURRENT OCCUPANT	3890 N 6TH ST	MILWAUKEE, WI 53212
CURRENT OCCUPANT	3888 N PORT WASHINGTON AVE 2	MILWAUKEE, WI 53212

Total Records: 63

Radius: 250.0 feet and Center of Circle: 3876 N Port Washington Av

2018-2019 Plan of Operation for 3876 N PORT WASHINGTON AV

1. Litter & Security Plans

How are the grounds kept clean? ☒ Sweep ☐ Pressure Wash ☒ Pick Up Litter ☐ Other:

How often will grounds be cleaned? ☒ Daily ☐ Weekly ☐ Other:

Who cleans the grounds? ☒ Licensee ☐ Building Owner ☒ Employees ☐ Hired Maintenance ☐ Other:

How are noise issues prevented and/or addressed? ☐ Security ☒ Manager approaches customer(s) ☐ Call Police ☒ Signs Posted ☐ Other:

Are there designated outdoor smoking areas? ☒ No ☐ Yes If Yes, Describe:

Number of garbage cans: Inside 2 Locations: BY CASH REGISTER & RESTROOM
Outside 1 Locations: BY FRONT DOOR

Is a crowd control barrier used? ☒ No ☐ Yes If Yes, Describe:

Number of restrooms: 1 Name of solid waste contractor: WASTE MANAGEMENT

Are there parking spaces on the premises? ☒ No ☐ Yes If Yes, list number of spaces: _____ and describe security plans:

Are there designated loading areas? ☒ No ☐ Yes If Yes, describe security plans:

Do you have security personnel on the premise? ☒ No ☐ Yes If Yes, how many? _____

AND What are their responsibilities? _____

What security equipment do they use? _____

List their licensing, certification or training credentials: _____

Are there security cameras? ☐ No ☒ Yes If Yes, list all locations: MONITORS INSIDE & STORE SURROUNDINGS

Are searches and/or identification checks conducted upon entry? ☒ No ☐ Yes If Yes, describe:

2. Percentage of Sales (must total 100%)

Alcohol 30 % Food Sales 50 % Entertainment _____ % Other 20 % CIG.

3. Businesses On The Premises (choose all that apply):

☐ Restaurant ☐ Cafe/Coffee Shop ☐ Cocktail Lounge ☐ Convenience Store ☐ Night Club ☒ Liquor Store ☐ Tavern ☐ Sports Facility
☐ Hotel ☐ Banquet Hall ☐ Supermarket ☐ Private/Fraternal/Veterans' Club ☐ Other:

4. Hours of Operation and Age Restriction

Are there any changes to the current hours of operation or age restriction? ☒ No ☐ Yes If Yes, Describe:

Please Note: If you will be open earlier or later than the hours listed on your current license for even one event or holiday (for example, St. Patrick's Day, Brewers Opening Day, etc.) during the license period, this must be reported and printed on your license.

Your hours of operation and age restriction are listed on your current license.

5. Floor Plan and Capacity

Are you requesting any changes to your capacity or floor plan? ☒ No ☐ Yes If yes, describe: _____ and submit a new floor plan with this renewal application. A sample plan can be found online at www.milwaukee.gov/licenses under License Forms and Related Information.

Alcohol/Food Establishments: A "Permanent Extension of Premises Application" is required if you are adding any square footage to the licensed premises.

6. Sidewalk Dining: Fee:

Are there any changes to the sidewalk dining site plan? ☒ No ☐ Yes If Yes, submit an updated site plan with this application.

7. Food License: FOOD 8152 Fee: \$300.00

Your current food license includes the following food operations: No Processing, Hazardous Foods, Sales \$20,001 - \$200,000, Convenience. Are there any changes to your food operations as listed above? ☒ No ☐ Yes, if Yes, explain _____

8. Weights and Measures: Fee:

Number/Type of Devices:
Are there any changes to the number or types of devices? ☒ No ☐ Yes
If yes, contact our office for further instructions.