



**CITY OF MILWAUKEE
OFFICE OF THE CITY CLERK**

Thursday, May 03, 2018

COMMITTEE MEETING NOTICE

AD 07

Ricky J Grandberry

3508 W Glendale Av

Milwaukee, WI 53209

You are requested to attend a hearing which is to be held in Room 301-B, Third Floor, City Hall on:

Tuesday, May 15, 2018 01:15 PM

Regarding: Your Food Dealer License Application for "Upscale Bluez Cafe" at 3710 W BURLEIGH St.

There is a possibility that your application may be denied for one or more of the following reasons: The recommendation of the committee regarding the application shall be based on evidence presented at the hearing. Per MCO 85-2.7-4, probative evidence concerning whether or not a new license should be granted may be presented on the following subjects: whether or not the applicant meets the municipal requirements, the appropriateness of the location and premises where the licensed premises is to be located and whether use of the premises for the purposes or activities permitted by the license would tend to facilitate a public or private nuisance or create undesirable neighborhood problems such as disorderly patrons, unreasonably loud noise, litter, and excessive traffic and parking congestion. Probative evidence relating to these matters may be taken from the plan of operation submitted with the license application, if any, but shall not include the content of any music. Evidence regarding the fitness of the location of the premises to be maintained as the principal place of business, including but not limited to whether there is an overconcentration of businesses of the type for which the license is sought; whether the proposal is consistent with any pertinent neighborhood business or development plans, or the location's proximity to areas where children are typically present. The applicant's record in operating similarly licensed premises; and whether or not the applicant has been charged with or convicted of any felony, misdemeanor, municipal offense or other offense, the circumstances of which substantially relate to the activity to be permitted by the license being applied for or any other factor which reasonably relates to the public health, safety or welfare may also be considered.

**Notice for applicants with
warrants or unpaid fines:**

Proof of warrant satisfaction or payment of fines must be submitted at the hearing on the above date and time. Failure to comply with this requirement may result in a delay of the granting/denial of your application.

Failure to appear at this meeting may result in the denial of your license. Individual applicants must appear only in person or by an attorney. Corporate or Limited Liability applicants must appear only by the agent designated on the application or by an attorney. Partnership applicants must appear by a partner listed on the application or by an attorney. If you wish to do so and at your own expense, you may be accompanied by an attorney of your choosing to represent you at this hearing.

You will be given an opportunity to speak on behalf of the application and to respond and challenge any charges or reasons given for the denial. No petitions can be accepted by the committee, unless the people who signed the petition are present at the committee hearing and willing to testify. You may present witnesses under oath and you may also confront and cross-examine opposing witnesses under oath. If you have difficulty with the English language, you should bring an interpreter with you, at your expense, so that you can answer questions and participate in your hearing.

You may examine the application file at this office during regular business hours prior to the hearing date. Inquiries regarding this matter may be directed to the person whose signature appears below.

Limited parking for persons attending meetings in City Hall is available at reduced rates (5 hour limit) at the Milwaukee Center on the southwest corner of East Kilbourn and North Water Street. Parking tickets must be validated in the first floor information booth in City Hall.

PLEASE NOTE: Upon reasonable notice, efforts will be made to accommodate the needs of disabled individuals through sign language interpreters or other auxiliary aids. For additional information or to request this service, contact the Council Services Division ADA Coordinator at (414) 286-2998, Fax - (414) 286-3456, TDD - (414) 286-2025.

JIM OW CZARSKI, CITY CLERK

BY:

Jessica Celella

License Division Manager

If you have questions regarding this notice, please contact the License Division at (414) 286-2238.



Thursday, May 03, 2018



Notice of Public Hearing

GRANDBERRY, Ricky J
Upscale Bluez Cafe at 3710 W BURLEIGH St
Food Dealer License Application

Tuesday, May 15, 2018 at 1:15 PM

To whom it may concern:

The above application has been made by the above named applicant(s). This requires approval from the Licenses Committee and the Common Council of the City of Milwaukee. The hearing before the Licenses Committee will take place on 5/15/2018 at 1:15 PM, in Room 301-B, Third Floor, City Hall. If you wish, you may provide testimony at the hearing regarding the request; see below for further information. You are not required to attend the hearing. Once the Licenses Committee makes its recommendation, this recommendation is forwarded to the full Common Council for approval at its next regularly scheduled hearing. Please review the information below and if you have further questions regarding this process, please contact the License Division at (414) 286-2238.

Important details for those wishing to provide information for the Licenses Committee to consider when making its recommendation:

1. The license application is scheduled to be heard at the above time. Due to other hearings running longer than scheduled, you may have to wait some time to provide your testimony.
2. You must appear in person and testify as to matters that you have personally experienced or seen. (You cannot provide testimony for your neighbor, parent or anyone else; this is considered hearsay and cannot be considered by the committee.)
3. No letters or petitions can be accepted by the committee (unless the person who wrote the letter or the persons who signed the petition are present at the committee hearing and willing to testify).
4. Persons opposed to the license application are given the opportunity to testify first; supporters may testify after the opponents have finished.
5. When you are called to testify, you will be sworn in and asked to give your name, and address. (If your first and/or last names are uncommon please spell them.)
6. You may then provide testimony.
 - a. Include only information relating to the above license application.
 - b. Include only information you have personally witnessed or seen.
 - c. Provide concise and relevant information detailing how this business has affected or may affect the peaceful enjoyment of your neighborhood.
 - d. If by the time you have the opportunity to testify, the information you wish to share has already been provided to the committee, you may state that you agree with the previous testimony. Redundant or repetitive testimony will not assist the committee in making its recommendation.
7. After giving your testimony, the members of the Licenses Committee and the licensee may ask questions regarding the testimony you have given or other factors relating to the license application.
8. Business Competition is not a valid basis for denial or non-renewal of a license.
Please Note: If you have submitted an objection to the above application your objection cannot be considered by the committee unless you personally testify at the hearing.

OCCUPANT	MAIL ADDRESS	CITY, STATE ZIP
CURRENT OCCUPANT	3057 N 37TH ST	MILWAUKEE, WI 53210
CURRENT OCCUPANT	3063 N 37TH ST	MILWAUKEE, WI 53210
CURRENT OCCUPANT	3068 N 37TH ST	MILWAUKEE, WI 53210
CURRENT OCCUPANT	3080 N 37TH ST	MILWAUKEE, WI 53210
CURRENT OCCUPANT	3106 N 37TH ST	MILWAUKEE, WI 53216
CURRENT OCCUPANT	3618 W BURLEIGH ST	MILWAUKEE, WI 53210
CURRENT OCCUPANT	3123 N 37TH ST	MILWAUKEE, WI 53216
CURRENT OCCUPANT	3109 N 38TH ST 4	MILWAUKEE, WI 53216
CURRENT OCCUPANT	3714A W BURLEIGH ST	MILWAUKEE, WI 53210
CURRENT OCCUPANT	3137A N 37TH ST	MILWAUKEE, WI 53216
CURRENT OCCUPANT	3710B W BURLEIGH ST	MILWAUKEE, WI 53210
CURRENT OCCUPANT	3626 W BURLEIGH ST	MILWAUKEE, WI 53210
CURRENT OCCUPANT	3120 N 37TH ST	MILWAUKEE, WI 53216
CURRENT OCCUPANT	3126A N 37TH ST	MILWAUKEE, WI 53216
CURRENT OCCUPANT	3130 N 37TH ST	MILWAUKEE, WI 53216
CURRENT OCCUPANT	3073 N 38TH ST	MILWAUKEE, WI 53210
CURRENT OCCUPANT	3109 N 38TH ST 9	MILWAUKEE, WI 53216
CURRENT OCCUPANT	3080 N 38TH ST	MILWAUKEE, WI 53210
CURRENT OCCUPANT	3072 N 38TH ST	MILWAUKEE, WI 53210
CURRENT OCCUPANT	3112 N 38TH ST 1	MILWAUKEE, WI 53216
CURRENT OCCUPANT	3138A N 38TH ST	MILWAUKEE, WI 53216
CURRENT OCCUPANT	3141A N 37TH ST	MILWAUKEE, WI 53216
CURRENT OCCUPANT	3148 N 38TH ST	MILWAUKEE, WI 53216
CURRENT OCCUPANT	3067 N 37TH ST	MILWAUKEE, WI 53210
CURRENT OCCUPANT	3074 N 37TH ST	MILWAUKEE, WI 53210
CURRENT OCCUPANT	3120A N 37TH ST	MILWAUKEE, WI 53216
CURRENT OCCUPANT	3131 N 38TH ST	MILWAUKEE, WI 53216
CURRENT OCCUPANT	3125 N 38TH ST	MILWAUKEE, WI 53216
CURRENT OCCUPANT	3109 N 38TH ST 2	MILWAUKEE, WI 53216
CURRENT OCCUPANT	3109 N 38TH ST 5	MILWAUKEE, WI 53216
CURRENT OCCUPANT	3066 N 38TH ST	MILWAUKEE, WI 53210
CURRENT OCCUPANT	3112 N 38TH ST 4	MILWAUKEE, WI 53216
CURRENT OCCUPANT	3062 N 38TH ST	MILWAUKEE, WI 53210
CURRENT OCCUPANT	3134 N 38TH ST	MILWAUKEE, WI 53216
CURRENT OCCUPANT	3137 N 37TH ST	MILWAUKEE, WI 53216
CURRENT OCCUPANT	3141 N 37TH ST	MILWAUKEE, WI 53216
CURRENT OCCUPANT	3073 N 37TH ST	MILWAUKEE, WI 53210
CURRENT OCCUPANT	3123A N 37TH ST	MILWAUKEE, WI 53216
CURRENT OCCUPANT	3119 N 38TH ST	MILWAUKEE, WI 53216
CURRENT OCCUPANT	3109 N 38TH ST 1	MILWAUKEE, WI 53216
CURRENT OCCUPANT	3109 N 38TH ST 11	MILWAUKEE, WI 53216
CURRENT OCCUPANT	3112 N 38TH ST 2	MILWAUKEE, WI 53216
CURRENT OCCUPANT	3058 N 38TH ST	MILWAUKEE, WI 53210
CURRENT OCCUPANT	3147 N 37TH ST	MILWAUKEE, WI 53216
CURRENT OCCUPANT	3622 W BURLEIGH ST	MILWAUKEE, WI 53210
CURRENT OCCUPANT	3126 N 37TH ST	MILWAUKEE, WI 53216

CURRENT OCCUPANT	3109 N 38TH ST 7	MILWAUKEE, WI 53216
CURRENT OCCUPANT	3109 N 38TH ST 6	MILWAUKEE, WI 53216
CURRENT OCCUPANT	3109 N 38TH ST 3	MILWAUKEE, WI 53216
CURRENT OCCUPANT	3128 N 38TH ST	MILWAUKEE, WI 53216
CURRENT OCCUPANT	3130 N 38TH ST	MILWAUKEE, WI 53216
CURRENT OCCUPANT	3129 N 38TH ST	MILWAUKEE, WI 53216
CURRENT OCCUPANT	3109 N 38TH ST 12	MILWAUKEE, WI 53216
CURRENT OCCUPANT	3109 N 38TH ST 10	MILWAUKEE, WI 53216
CURRENT OCCUPANT	3118 N 38TH ST	MILWAUKEE, WI 53216
CURRENT OCCUPANT	3112 N 38TH ST 3	MILWAUKEE, WI 53216
CURRENT OCCUPANT	3718A W BURLEIGH ST	MILWAUKEE, WI 53210
CURRENT OCCUPANT	3150 N 38TH ST	MILWAUKEE, WI 53216
CURRENT OCCUPANT	3079 N 37TH ST	MILWAUKEE, WI 53210
CURRENT OCCUPANT	3078 N 37TH ST	MILWAUKEE, WI 53210
CURRENT OCCUPANT	3121 N 37TH ST	MILWAUKEE, WI 53216
CURRENT OCCUPANT	3127 N 37TH ST	MILWAUKEE, WI 53216
CURRENT OCCUPANT	3131 N 37TH ST	MILWAUKEE, WI 53216
CURRENT OCCUPANT	3109 N 38TH ST 8	MILWAUKEE, WI 53216
CURRENT OCCUPANT	3120 N 38TH ST	MILWAUKEE, WI 53216
CURRENT OCCUPANT	3132 N 38TH ST	MILWAUKEE, WI 53216
CURRENT OCCUPANT	3062 N 37TH ST	MILWAUKEE, WI 53210
CURRENT OCCUPANT	3710A W BURLEIGH ST	MILWAUKEE, WI 53210
CURRENT OCCUPANT	3133 N 38TH ST	MILWAUKEE, WI 53216
CURRENT OCCUPANT	3079 N 38TH ST	MILWAUKEE, WI 53210
CURRENT OCCUPANT	3718 W BURLEIGH ST	MILWAUKEE, WI 53210
CURRENT OCCUPANT	3714 W BURLEIGH ST	MILWAUKEE, WI 53210
CURRENT OCCUPANT	3138 N 38TH ST	MILWAUKEE, WI 53216
CURRENT OCCUPANT	3144 N 38TH ST	MILWAUKEE, WI 53216

Total Records: 74

Radius: 250.0 feet and Center of Circle: 3710 W Burleigh St



BUSINESS LICENSE PLAN OF OPERATION

ccl-busplan 9/26/16

Office of the City Clerk License Division
200 E. Wells St. Room 105, Milwaukee, WI 53202
(414) 286-2238 www.milwaukee.gov/license e-mail address: license@milwaukee.gov

1. Type of Business

Applying for: ☒ Extended Hours (12AM to 5AM) - If a food establishment, check all that apply: ☐ Delivery ☐ Drive Thru ☒ Dining Room
☐ Self Service Laundry ☐ Massage Establishment ☐ Filling Station
☐ Other (supplemental application for specific license also required)

Provide a detailed description of the type of business you plan on operating:

Deli Cafe, Hot & Cold Food

Do you have any experience operating this type of business? ☐ No ☒ Yes If yes, explain: 10 years of management in food service

2. Business Operations

- a. Proposed Opening Date: June 1, 2018
- b. Is this premise under construction? ☒ No ☐ Yes If yes, list estimated completion date: _____
- c. Is this a franchise? ☒ No ☐ Yes
- d. Is this premises currently licensed? ☐ No ☒ Yes If yes, list type of license: BAR
- e. Is the current licensee operating? ☒ No ☐ Yes If no, list date closed: yes
- f. Do you have future plans for other businesses, licenses or permits at this location? ☒ No ☐ Yes
If yes, explain: _____
- g. Have you previously held an Extended Hours License in Milwaukee? ☒ No ☐ Yes
If yes, list address(es): _____
- h. Are other businesses operating in the same building? ☒ No ☐ Yes If yes, describe: _____

3. Litter & Noise

- a. How are grounds kept clean? ☒ Sweep ☒ Pressure Wash ☒ Pick Up Litter ☐ Other: _____
- b. How often will grounds be cleaned? ☒ Daily ☐ Weekly ☐ As Needed ☐ Monthly ☐ Other: _____
- c. Grounds cleaned by: ☐ Licensee ☐ Building Owner ☒ Employees ☒ Hired Maintenance ☐ Other: _____
- d. How are noise issues prevented and/or addressed? ☒ Security ☒ Manager approaches customer(s) ☐ Call Police
☒ Signs Posted ☐ Other: _____
- e. Will a sound amplification system be used? ☐ No ☒ Yes If yes, describe: Small Surround house system

4. Smoking & Sanitation

- a. Are there designated outdoor smoking areas? ☒ No ☐ Yes If yes, describe: _____
- b. Number of Garbage Cans: Inside: 4 Locations: 2 bathroom, Kitchen, Dining Area
Outside: 2 Locations: Back of Building
- c. Is a crowd control barrier used? ☒ No ☐ Yes If yes, describe: _____
- d. How many restrooms are on the premises? 2
- e. Name of solid waste contractor: ☐ Advanced Disposal ☒ Waste Management ☐ Other: _____

5. Security

- a. Are there onsite parking spaces? ☒ No ☐ Yes If yes, indicate how many? _____ and describe the parking security plan: _____
- b. Is there a loading zone? ☒ No ☐ Yes If yes, describe the loading area security plan: _____
- c. Will you have security personnel on premise? ☐ No ☒ Yes If yes, how many? 1 and answer the following:
What are their responsibilities? To Secure premises
Is security equipment used? ☐ No ☒ Yes If yes, describe Security Cameras
List their licensing, certification, or training credentials CCW licence to carry
- d. Will there be security cameras? ☐ No ☒ Yes If yes, where? front door, back door, inside
- e. Will searches/identification checks be done upon entry? ☒ No ☐ Yes If yes, describe by register

6. Percentage of Sales (must total 100%)

Alcohol _____%	Food <u>100</u> %	Secondhand Merchandise _____%	Precious Metals & Gems _____%
Entertainment _____%	Cigarettes _____%		
Pawnbroker Activity _____%	Salvaged Materials _____% (such as scrap metal)	Personal Services (such as tattoo, body piercing, salon, tailor, tanning, etc.) _____%	Other _____% Describe: _____

7. Businesses/Licenses on the Premises (check all that apply):

Type 1

- ☒ Full Service Restaurant ☐ Cafe/Coffee Shop ☐ Deli or Fast Food Restaurant ☐ Private/Fraternal/Veterans Club
- ☐ Night Club ☐ Tavern ☐ Cocktail Lounge ☐ Teen Club
- ☐ Banquet Hall ☐ Sports Facility ☐ Bowling Alley
- ☐ Hotel/Motel : Number of Floors: _____ Number of Rooms: _____
- ☐ Rooming House: Number of Floors: _____ Number of Rooms: _____

Type 2

- ☐ Liquor Store ☐ Corner Store ☐ Supermarket ☐ Convenience Store
- ☐ Gas Station ☐ Amusement/Phonograph Distributor ☐ Recycling, Salvage or Towing
- ☐ Used Car Dealer ☐ Personal Service Establishment
(such as tattoo business, hair salon, tailor, etc.) ☐ Recording Studio

What other licenses/permits will you hold at this location? (check all that apply)

- ☒ Occupancy Permit ☐ Cigarette & Tobacco ☐ Gas Station ☐ Extended Hours ☐ Class "B" Tavern ☐ Weights & Measures
- ☐ Secondhand Dealer ☐ Precious Metal & Gem ☐ Other: _____

8. Legal Capacity (only if a Type 1 premises in #7 above)

Capacity _____ (Call the Milwaukee Development Center at 414-286-8211 if you have questions.)

9. Premises Description

a. Identify all area(s) of the premises that will be used in operating this business (include areas used only for storage):

☒ 1st Floor ☐ 2nd Floor ☐ Basement Storage ☐ Patio ☐ Beer Garden ☐ Sidewalk Café ☐ Deck ☐ Rooftop

☐ Other: Describe: _____

b. Describe Location: ☒ Major Thoroughfare ☐ Secondary Street ☐ Other: _____

c. Nearest Major Cross Street: Fond du Lac & Bonhues

d. Describe Building: ☒ Free Standing Building ☐ Strip Mall ☐ Other: _____

e. Describe Premises Structure: ☐ Single Story ☒ Multi-Story - # of Stories _____ ☐ Other: _____

f. Describe Surrounding Area: ☒ Commercial ☐ Residential ☐ Industrial ☐ Other: _____

g. Building Owner Name: Dannin Moune Phone Number (414) 982-0763

Business Owner Address: 2810 - W - Belmont State St.

10. Hours of Operation & Customers

Will customers be entering the premises? ☐ No ☒ Yes

Day of the Week	Proposed Hours of Operation:		Estimated Number of Customers expected each day	Potential Age Range of Customers	Class B Tavern Applicant Only: Age Restriction (If none, write 'None')
	Open Time (include a.m. or p.m.)	Close Time (include a.m. or p.m.)			
Sunday	Closed	Closed	25	—	—
Monday	9am	9pm	25	0-100 yrs	
Tuesday	9am	9pm	25	0-100 yrs	
Wednesday	9am	9pm	25	0-100 yrs	
Thursday	9am	9pm	25	0-100 yrs	
Friday	9am	9pm	25	0-100 yrs	
Saturday	10am	6pm	25	0-100 yrs	

An Extended Hours Establishment License is required for any convenience store, filling station, personal service establishment (such as tattoo, body piercing, salon, tailor, tanning, etc.), recording studio or restaurant which is open between the hours of 12:00 a.m. and 5:00 a.m.

Alcohol Establishments Class A: 8:00 am to 9:00 pm Sunday thru Saturday
Permitted Hours of Operation: Class B: 6:00 am to 2:00 am Sunday thru Thursday, 6:00 am to 2:30 am Friday & Saturday

Entertainment Closing Hours: Indoors: Alcohol beverage establishments: Same as alcohol license hours
Non-alcohol establishments: 1:00 am Sunday thru Thursday, 1:30 am Friday & Saturday
Outdoors: All establishments: 10:00 pm Sunday thru Thursday, 12:00 am Friday & Saturday
(unless otherwise approved by the Common Council in licensee's plan of operation)

11. Signature(s)

R. J. [Signature]
Sole Proprietor, Partner, Agent, or 20% or more Shareholder

Signature of additional partner or 20% or more Shareholder

See Application Information for a complete list of all required application forms.

**FOOD DEALER LICENSE PLAN OF OPERATION**

OFFICE OF THE CITY CLERK, LICENSE DIVISION
CITY HALL, 200 E. WELLS ST, ROOM 105, MILWAUKEE, WI 53202
(414) 286-2238 • license@milwaukee.gov • www.milwaukee.gov/license

Legal Entity Name: Joe & SamsRicky Grundberry, JPremises Address: 3710 W Bunleigh**SECTION 1 TYPE OF BUSINESS**

Type of application (check one): ☐ taking over a currently operating business ☒ starting a new business
Anticipated opening date? June 12, 2018

Check the type that best describes your business (check only one):

See Food Dealer License Information sheet for definitions.

☒ Restaurant☐ Bed & Breakfast☐ Retail Establishment☐ Base for Food PeddlerIf retail, will it be a convenience store? ☐ Yes ☐ No☐ Base for Temporary/Seasonal Food Stand

(Convenience Stores have less than 5,000 sq ft of retail space,
primary business is the sale of basic food items, and in addition sells household products)

In addition, will any wholesale business be done? ☐ Yes ☒ NoIf yes, what percentage of the business will be wholesale? ☐ Less than 25% ☐ 25% or More (Contact DATCP)*Will retail items be sold? ☐ No ☒ Yes If Yes, indicate percentage of food sales 50 %Will restaurant items be sold? ☐ No* ☒ Yes If Yes, indicate percentage of food sales 50 %

* If you checked "25% or More" of the business will be wholesale and answered "No" to restaurant items being sold,
do not continue completing this application. A City of Milwaukee License is not required. Contact DATCP only.

SECTION 2 FOOD PROCESSINGWill any food processing be done? ☐ No ☒ Yes

Processing is defined as assembling, grinding, cutting, mixing, baking, coating, stuffing, packing, bottling,
grilling, canning, extracting, fermenting, distilling, pickling, freezing, drying, smoking, or packaging.

If Yes, check the types of food items:

☒ SNACKS & BEVERAGES

includes, but is not limited to, ice cream/soft serve, lemonade, snow cones, coffee, espresso, cappuccino,
tea, fruit juice, smoothies, candy, dispensed soda, fruit cups, bakery, cookies, popcorn, kettle corn, cotton
candy, funnel cakes, fritters, tortilla chips w/ cheese

☒ MEALS

includes, but is not limited to, chicken, ribs, sandwiches, roasted corn, baked potatoes, hot dogs, brats,
tacos, nachos w/ cheese and meat, French fries, cooked or deep fried vegetables/fruit, cooked cheese
curds, corn dogs, egg rolls, salads

SECTION 3 FOOD REQUIRING TEMPERATURE CONTROL

Will any food that requires temperature control be sold? ☐ No ☒ Yes
(includes dairy products such as milk, cheese, and ice cream, fish, shellfish, meat, poultry)

If yes, list the types of food items: meat, ham, Turkey, cheese, milk, tuna,

SECTION 4 SHARED KITCHEN

Will you be sharing kitchen space with another operator?

☒ No

If No, SKIP to Section 5

☐ Yes

If Yes, check one:

☐ I will rent space from another operator ("Shared Kitchen Agreement" is required)☐ I will rent space to another operator (peddler/caterer)**SECTION 5 DETAILS OF OPERATION**

Answer the following questions:

Will you have seating on site for dining?

☐ No ☒ Yes

Will you be doing any catering?

☐ No ☒ Yes

Will you be doing any delivery?

☒ No ☐ Yes

Will you have outdoor activities?

☒ No ☐ Yes

If Yes to outdoor activities, check all that apply:

☐ Bar ☐ Cooking/Grilling ☐ Dining

Will you have a drive thru window?

☒ No ☐ Yes

If Yes to drive thru, are hours different from inside?

☐ No ☐ Yes

If Yes, provide drive thru hours: _____

Will any scales or barcode scanners be used?

☒ No ☐ Yes

If Yes, a Weights & Measures application must be completed and a license obtained.

SECTION 6 ADDITIONAL SITES

Where will food be prepared and/or sold?

☒ At a single site☐ At multiple sites (for example, a hotel with several dining rooms or bars) How many? _____

If multiple sites, attach a Food Dealer Additional Site Addendum (ccl-foodadd) for each additional site.

SECTION 7 CONSTRUCTION OR CHANGES

Are you planning any construction, remodeling or equipment changes?

☒ No

If No, SKIP to Section 8

☐ Yes

If Yes, check all that apply:

☐ New construction of a building☐ Construction changes to an existing building☐ Renovation or remodeling☐ Equipment changes only (installation or replacement)

Provide a brief description of the changes: _____

Start date: _____

Name, Address & Phone Number of Architect: _____

Name, Address & Phone Number of Contractor: _____

SECTION 8 ALCOHOL BEVERAGES

Are you applying for an alcohol beverage license?

☒ No

If No, SKIP to Section 9

☐ YesIf YES, if your food license is approved prior to the alcohol beverage license, when do you want the food license issued? ☐ Immediately ☐ At the same time as the alcohol license**SECTION 9 ACKNOWLEDGEMENTS & SIGNATURE**

You must initial each item confirming your understanding:

RG

I understand the Health Department must conduct an inspection and advise the License Division of their approval before the license may be issued.

RG

I understand I must obtain an occupancy permit from the Department of Neighborhood Services and an inspection may be required. Neighborhood Services must advise the License Division of their approval before the license may be issued.

RG

I understand the district alderperson will review and either approve or deny my application. If denied, I may appeal and be scheduled to appear before the Licenses Committee. The Licenses Committee will then make a recommendation to the Common Council. The Common Council must grant the license before it may be issued.

RG

I understand proof of payment for all license fees must be on file in the License Division before the license may be issued.

RG

I understand the license must be issued and posted in my establishment prior to opening for business.

RG

I will not operate my food business until the license has been issued and posted in the establishment.

Signature of sole proprietor, partner, agent or 20% shareholder: Rachel Anderson

Signature of additional partner(s): _____

* Upscale Bluez Cafe Menu *

- Soups

Broccoli & cheese

Chicken noodle

Chicken & Dumplings

Ham & cheese

Clam Chowder

Chicken & Rice

- Sandwiches (Hot and cold)

Grilled cheese Wraps - Hot & Cold

Turkey

Ham

BLT

- Coffee

Hot & cold

- Beverages · Pepsi Products

- Salads

Open Salad Bar

- Desserts

Apple pie

Cherry Pie

Cheese cake

Chocolate Cake

Danishes

cookies

- Dips : 1/2 cup

French Onion

Spinach

Salsa

Guacamole

- Chips - Frito Lay Baked Chips

Tortilla Chips

A hand-drawn floor plan of a building layout. The plan is oriented with the front entrance at the top. The overall dimensions are 46 ft North-South and 34 ft 78 39 ft East-West. The layout includes the following areas and features:

- Front Entrance:** Located at the top center, with a width of 26 ft N.
- Karaoke Area:** Located at the top right, measuring 18 x 4.
- Bathrooms:** Located on the right side, measuring 11 x 5.
- Open Area:** A large central area measuring 27 ft.
- Seating Area:** Located on the left side, measuring 26 x 9.
- Serving Counter:** Located in the center, measuring 18 ft x 24 ft.
- Kitchen:** Located at the bottom right, measuring 9 x 6.
- Back of Building:** Located at the bottom, with a width of 26 ft W.
- Exit:** Located at the bottom center, with a width of 34 ft 78 39 ft.
- Side Walk:** Located on the left side, measuring 46 ft.
- Other Features:** Includes a "Trash can" near the back entrance, a "Dumpster" near the back entrance, and a "Back" entrance near the back entrance.

A hand-drawn floor plan of a building layout. The plan is oriented with the front entrance at the top. The overall dimensions are 46 ft North-South and 34 ft 78 39 ft East-West. The layout includes the following areas and features:

- Front Entrance:** Located at the top center, with a width of 26 ft N.
- Karaoke Area:** Located at the top right, measuring 18 x 4.
- Bathrooms:** Located on the right side, measuring 11 x 5.
- Open Area:** A large central area measuring 27 ft.
- Seating Area:** Located on the left side, measuring 26 x 9.
- Serving Counter:** Located in the center, measuring 18 ft x 24 ft.
- Kitchen:** Located at the bottom right, measuring 9 x 6.
- Back of Building:** Located at the bottom, with a width of 26 ft W.
- Exit:** Located at the bottom center, with a width of 34 ft 78 39 ft.
- Side Walk:** Located on the left side, measuring 46 ft.
- Other Features:** Includes a "Trash can" near the back entrance, a "Dumpster" near the back entrance, and a "Back" entrance near the back entrance.

A hand-drawn floor plan of a building layout. The plan is oriented with the front entrance at the top. The overall dimensions are 46 ft wide and 34.78 to 39 ft deep. The layout includes the following areas and features:

- Front Entrance:** Located at the top center, with a width of 26 ft.
- Karaoke Area:** Located at the top right, measuring 18 x 4.
- Bathrooms:** Located on the right side, measuring 11 x 5.
- Open Area:** A large central area, measuring 27 ft wide.
- Seating Area:** Located on the left side, featuring four square tables and a 26 x 9 rectangular area.
- Serving Counter:** A long counter located in the center-right area.
- Kitchen:** Located at the bottom right, measuring 6 x 6.
- Back of Building:** The bottom edge of the plan, measuring 26 ft wide.
- Side Walk:** A walkway on the left side, measuring 46 ft wide.
- Exit:** An exit door is marked at the bottom left, with a width of 34.78 to 39 ft.
- Other Features:** The plan also shows a "Door Entrance", "Trash can", "Dishes", "Back", "Kitchen", "Lobby", and "Dumpster".

A hand-drawn floor plan of a building layout. The plan is oriented with the front entrance at the top. The overall dimensions are 46 ft wide and 34.78 to 39 ft deep. The layout includes the following areas and features:

- Front Entrance:** Located at the top center, with a width of 26 ft.
- Karaoke Area:** Located at the top right, measuring 18 x 4.
- Bathrooms:** Located on the right side, measuring 11 x 5.
- Open Area:** A large central area measuring 27 ft wide.
- Seating Area:** Located on the left side, featuring four square tables and a 26 x 9 rectangular area.
- Serving Counter:** A long counter located in the center of the open area.
- Kitchen:** Located at the bottom right, measuring 6 x 6.
- Back of Building:** The bottom edge of the plan, with a width of 26 ft.
- Exit:** An exit door is marked at the bottom center, with a width of 34.78 to 39 ft.
- Side Walk:** A side walk is indicated on the left side, measuring 46 ft.
- Other Features:** The plan also shows a "Trash can" area, a "Dumpster" area, and a "Back" area.

A hand-drawn floor plan of a building layout. The plan is oriented with the front entrance at the top. The overall dimensions are 46 ft wide and 34.78 to 39 ft deep. The layout includes the following areas and features:

- Front Entrance:** Located at the top center, with a width of 26 ft.
- Karaoke Area:** Located at the top right, measuring 18 x 4.
- Bathrooms:** Located on the right side, measuring 11 x 5.
- Open Area:** A large central area measuring 27 ft wide.
- Seating Area:** Located on the left side, featuring four square tables and a 26 x 9 rectangular area.
- Serving Counter:** A long counter located in the center of the open area.
- Kitchen:** Located at the bottom right, measuring 6 x 6.
- Back of Building:** The bottom edge of the plan, with a width of 26 ft.
- Exit:** An exit door is marked at the bottom center, with a width of 34.78 to 39 ft.
- Side Walk:** A side walk is indicated on the left side, measuring 46 ft.
- Other Features:** The plan also shows a "Trash can" area, a "Dumpster" area, and a "Back" area.

A hand-drawn floor plan of a building layout. The plan is oriented with the front entrance at the top. The overall dimensions are 46 ft North-South and 34 ft 78 39 ft East-West. The layout includes the following areas and features:

- Front Entrance:** Located at the top center, with a width of 26 ft N.
- Karaoke Area:** Located at the top right, measuring 18 x 4.
- Bathrooms:** Located on the right side, measuring 11 x 5.
- Open Area:** A large central area, measuring 27 ft.
- Seating Area:** Located on the left side, measuring 26 x 9.
- Serving Counter:** Located in the center, measuring 18 ft x 24 ft.
- Kitchen:** Located at the bottom right, measuring 9 x 6.
- Back of Building:** Located at the bottom, with a width of 26 ft W.
- Side Walk:** Located on the left side, measuring 46 ft.
- Exit:** Located at the bottom left, with a width of 34 ft 78 39 ft.
- Other Features:** Includes a "Trash can" near the back entrance, a "Dumpster" near the back entrance, and a "Back" entrance near the back entrance.



**CITY OF MILWAUKEE
OFFICE OF THE CITY CLERK**

Thursday, May 03, 2018

COMMITTEE MEETING NOTICE

AD 07

RANDOLPH, Jason M, Agent
Jays Food LLC
4402 W Center St

Milwaukee, WI 53210

You are requested to attend a hearing which is to be held in Room 301-B, Third Floor, City Hall on:

Tuesday, May 15, 2018 at 01:15 PM

Regarding: Your Food Dealer License Application agent for "Jays Food LLC" for "Jays Food LLC" at 4402 W Center St.

There is a possibility that your application may be denied for one or more of the following reasons: The recommendation of the committee regarding the application shall be based on evidence presented at the hearing. Per MCO 85-2.7-4, probative evidence concerning whether or not a new license should be granted may be presented on the following subjects: whether or not the applicant meets the municipal requirements, the appropriateness of the location and premises where the licensed premises is to be located and whether use of the premises for the purposes or activities permitted by the license would tend to facilitate a public or private nuisance or create undesirable neighborhood problems such as disorderly patrons, unreasonably loud noise, litter, and excessive traffic and parking congestion. Probative evidence relating to these matters may be taken from the plan of operation submitted with the license application, if any, but shall not include the content of any music. Evidence regarding the fitness of the location of the premises to be maintained as the principal place of business, including but not limited to whether there is an overconcentration of businesses of the type for which the license is sought; whether the proposal is consistent with any pertinent neighborhood business or development plans, or the location's proximity to areas where children are typically present. The applicant's record in operating similarly licensed premises; and whether or not the applicant has been charged with or convicted of any felony, misdemeanor, municipal offense or other offense, the circumstances of which substantially relate to the activity to be permitted by the license being applied for or any other factor which reasonably relates to the public health, safety or welfare may also be considered. See attached police report or correspondence.

**Notice for applicants with
warrants or unpaid fines:**

Proof of warrant satisfaction or payment of fines must be submitted at the hearing on the above date and time. Failure to comply with this requirement may result in a delay of the granting/denial of your application.

Failure to appear at this meeting may result in the denial of your license. Individual applicants must appear only in person or by an attorney. Corporate or Limited Liability applicants must appear only by the agent designated on the application or by an attorney. Partnership applicants must appear by a partner listed on the application or by an attorney. If you wish to do so and at your own expense, you may be accompanied by an attorney of your choosing to represent you at this hearing.

You will be given an opportunity to speak on behalf of the application and to respond and challenge any charges or reasons given for the denial. No petitions can be accepted by the committee, unless the people who signed the petition are present at the committee hearing and willing to testify. You may present witnesses under oath and you may also confront and cross-examine opposing witnesses under oath. If you have difficulty with the English language, you should bring an interpreter with you, at your expense, so that you can answer questions and participate in your hearing.

You may examine the application file at this office during regular business hours prior to the hearing date. Inquiries regarding this matter may be directed to the person whose signature appears below.

Limited parking for persons attending meetings in City Hall is available at reduced rates (5 hour limit) at the Milwaukee Center on the southwest corner of East Kilbourn and North Water Street. Parking tickets must be validated in the first floor information booth in City Hall.

PLEASE NOTE: Upon reasonable notice, efforts will be made to accommodate the needs of disabled individuals through sign language interpreters or other auxiliary aids. For additional information or to request this service, contact the Council Services Division ADA Coordinator at (414) 286-2998, Fax - (414) 286-3456, TDD - (414) 286-2025.

JIM OWCZARSKI, CITY CLERK

BY:

Jessica Celella

License Division Manager

If you have questions regarding this notice, please contact the License Division at (414) 286-2238.



**CITY OF MILWAUKEE
OFFICE OF THE CITY CLERK**

Thursday, May 03, 2018

COMMITTEE MEETING NOTICE

AD 07

RANDOLPH, Jason M, Agent
Jays Food LLC
4819 N 36th St

Milwaukee, WI 53209

You are requested to attend a hearing which is to be held in Room 301-B, Third Floor, City Hall on:

Tuesday, May 15, 2018 at 01:15 PM

Regarding: Your Food Dealer License Application as agent for "Jays Food LLC" for "Jays Food LLC" at 4402 W Center St.

There is a possibility that your application may be denied for one or more of the following reasons: The recommendation of the committee regarding the application shall be based on evidence presented at the hearing. Per MCO 85-2.7-4, probative evidence concerning whether or not a new license should be granted may be presented on the following subjects: whether or not the applicant meets the municipal requirements, the appropriateness of the location and premises where the licensed premises is to be located and whether use of the premises for the purposes or activities permitted by the license would tend to facilitate a public or private nuisance or create undesirable neighborhood problems such as disorderly patrons, unreasonably loud noise, litter, and excessive traffic and parking congestion. Probative evidence relating to these matters may be taken from the plan of operation submitted with the license application, if any, but shall not include the content of any music. Evidence regarding the fitness of the location of the premises to be maintained as the principal place of business, including but not limited to whether there is an overconcentration of businesses of the type for which the license is sought; whether the proposal is consistent with any pertinent neighborhood business or development plans, or the location's proximity to areas where children are typically present. The applicant's record in operating similarly licensed premises; and whether or not the applicant has been charged with or convicted of any felony, misdemeanor, municipal offense or other offense, the circumstances of which substantially relate to the activity to be permitted by the license being applied for or any other factor which reasonably relates to the public health, safety or welfare may also be considered. See attached police report or correspondence.

**Notice for applicants with
warrants or unpaid fines:**

Proof of warrant satisfaction or payment of fines must be submitted at the hearing on the above date and time. Failure to comply with this requirement may result in a delay of the granting/denial of your application.

Failure to appear at this meeting may result in the denial of your license. Individual applicants must appear only in person or by an attorney. Corporate or Limited Liability applicants must appear only by the agent designated on the application or by an attorney. Partnership applicants must appear by a partner listed on the application or by an attorney. If you wish to do so and at your own expense, you may be accompanied by an attorney of your choosing to represent you at this hearing.

You will be given an opportunity to speak on behalf of the application and to respond and challenge any charges or reasons given for the denial. No petitions can be accepted by the committee, unless the people who signed the petition are present at the committee hearing and willing to testify. You may present witnesses under oath and you may also confront and cross-examine opposing witnesses under oath. If you have difficulty with the English language, you should bring an interpreter with you, at your expense, so that you can answer questions and participate in your hearing.

You may examine the application file at this office during regular business hours prior to the hearing date. Inquiries regarding this matter may be directed to the person whose signature appears below.

Limited parking for persons attending meetings in City Hall is available at reduced rates (5 hour limit) at the Milwaukee Center on the southwest corner of East Kilbourn and North Water Street. Parking tickets must be validated in the first floor information booth in City Hall.

PLEASE NOTE: Upon reasonable notice, efforts will be made to accommodate the needs of disabled individuals through sign language interpreters or other auxiliary aids. For additional information or to request this service, contact the Council Services Division ADA Coordinator at (414) 286-2998, Fax - (414) 286-3456, TDD - (414) 286-2025.

JIM OWCZARSKI, CITY CLERK

BY:

Jessica Celella

License Division Manager

If you have questions regarding this notice, please contact the License Division at (414) 286-2238.

MILWAUKEE POLICE DEPARTMENT

LICENSING

CRIMINAL RECORD/ORDINANCE VIOLATION/INCIDENTS SYNOPSIS

DATE: 03/09/18

LICENSE TYPE: FOOD

NEW: ☒

RENEWAL: ☐

No. 271087

Application Date:

License Location: 4402 W Center Street

Business Name: Jays Food

Licensee/Applicant: Randolph, Jason M
(Last Name, First Name, MI)

Date of Birth: 05/08/86

Home Address: 4819 N 36th Street

City: Milwaukee

State: WI **Zip Code:** 53209

Home Phone:

This report is written by Police Officer KUKOWSKI, assigned to the License Investigation Unit, Days.

The Milwaukee Police Department's investigation regarding this application revealed the following:

1. On 08/21/14, applicant was cited for Resisting/Obstructing Police Officer at 400 E Burleigh.

Charge:	Resisting/Obstructing Police Officer
Finding:	Guilty
Sentence:	Fined \$196.00
Date:	10/30/14
Case:	14066451



Thursday, May 03, 2018



Notice of Public Hearing

RANDOLPH, Jason M, Agent
Jays Food LLC at 4402 W Center St
Food Dealer License Application

Tuesday, May 15, 2018 at 1:15 PM

To whom it may concern:

The above application has been made by the above named applicant(s). This requires approval from the Licenses Committee and the Common Council of the City of Milwaukee. The hearing before the Licenses Committee will take place on 5/15/2018 at 1:15 PM, in Room 301-B, Third Floor, City Hall. If you wish, you may provide testimony at the hearing regarding the request; see below for further information. You are not required to attend the hearing. Once the Licenses Committee makes its recommendation, this recommendation is forwarded to the full Common Council for approval at its next regularly scheduled hearing. Please review the information below and if you have further questions regarding this process, please contact the License Division at (414) 286-2238.

Important details for those wishing to provide information for the Licenses Committee to consider when making its recommendation:

1. The license application is scheduled to be heard at the above time. Due to other hearings running longer than scheduled, you may have to wait some time to provide your testimony.
2. You must appear in person and testify as to matters that you have personally experienced or seen. (You cannot provide testimony for your neighbor, parent or anyone else; this is considered hearsay and cannot be considered by the committee.)
3. No letters or petitions can be accepted by the committee (unless the person who wrote the letter or the persons who signed the petition are present at the committee hearing and willing to testify).
4. Persons opposed to the license application are given the opportunity to testify first; supporters may testify after the opponents have finished.
5. When you are called to testify, you will be sworn in and asked to give your name, and address. (If your first and/or last names are uncommon please spell them.)
6. You may then provide testimony.
 - a. Include only information relating to the above license application.
 - b. Include only information you have personally witnessed or seen.
 - c. Provide concise and relevant information detailing how this business has affected or may affect the peaceful enjoyment of your neighborhood.
 - d. If by the time you have the opportunity to testify, the information you wish to share has already been provided to the committee, you may state that you agree with the previous testimony. Redundant or repetitive testimony will not assist the committee in making its recommendation.
7. After giving your testimony, the members of the Licenses Committee and the licensee may ask questions regarding the testimony you have given or other factors relating to the license application.
8. Business Competition is not a valid basis for denial or non-renewal of a license.
Please Note: If you have submitted an objection to the above application your objection cannot be considered by the committee unless you personally testify at the hearing.

OCCUPANT	MAIL ADDRESS	CITY, STATE ZIP
CURRENT OCCUPANT	2734 N 45TH ST	MILWAUKEE, WI 53210
CURRENT OCCUPANT	2722 N 44TH ST	MILWAUKEE, WI 53210
CURRENT OCCUPANT	2668 N 45TH ST	MILWAUKEE, WI 53210
CURRENT OCCUPANT	2677 N 45TH ST	MILWAUKEE, WI 53210
CURRENT OCCUPANT	2661 N 44TH ST	MILWAUKEE, WI 53210
CURRENT OCCUPANT	2677 N 44TH ST	MILWAUKEE, WI 53210
CURRENT OCCUPANT	2730 N 44TH ST	MILWAUKEE, WI 53210
CURRENT OCCUPANT	2738 N 44TH ST	MILWAUKEE, WI 53210
CURRENT OCCUPANT	2662 N 45TH ST	MILWAUKEE, WI 53210
CURRENT OCCUPANT	2672 N 45TH ST	MILWAUKEE, WI 53210
CURRENT OCCUPANT	2702 N 45TH ST	MILWAUKEE, WI 53210
CURRENT OCCUPANT	2718 N 45TH ST	MILWAUKEE, WI 53210
CURRENT OCCUPANT	2735 N 44TH ST	MILWAUKEE, WI 53210
CURRENT OCCUPANT	2723 N 44TH ST	MILWAUKEE, WI 53210
CURRENT OCCUPANT	2724 N 44TH ST	MILWAUKEE, WI 53210
CURRENT OCCUPANT	2665 N 45TH ST	MILWAUKEE, WI 53210
CURRENT OCCUPANT	2673 N 45TH ST	MILWAUKEE, WI 53210
CURRENT OCCUPANT	2700 N 45TH ST	MILWAUKEE, WI 53210
CURRENT OCCUPANT	2708 N 45TH ST	MILWAUKEE, WI 53210
CURRENT OCCUPANT	2712 N 45TH ST	MILWAUKEE, WI 53210
CURRENT OCCUPANT	2655 N 44TH ST	MILWAUKEE, WI 53210
CURRENT OCCUPANT	2702 N 44TH ST	MILWAUKEE, WI 53210
CURRENT OCCUPANT	2719 N 45TH ST	MILWAUKEE, WI 53210
CURRENT OCCUPANT	2716 N 45TH ST	MILWAUKEE, WI 53210
CURRENT OCCUPANT	2729 N 44TH ST	MILWAUKEE, WI 53210
CURRENT OCCUPANT	2667 N 45TH ST	MILWAUKEE, WI 53210
CURRENT OCCUPANT	2666 N 45TH ST	MILWAUKEE, WI 53210
CURRENT OCCUPANT	2670 N 45TH ST	MILWAUKEE, WI 53210
CURRENT OCCUPANT	2676 N 45TH ST	MILWAUKEE, WI 53210
CURRENT OCCUPANT	2706 N 45TH ST	MILWAUKEE, WI 53210
CURRENT OCCUPANT	2713 N 45TH ST	MILWAUKEE, WI 53210
CURRENT OCCUPANT	2714 N 45TH ST	MILWAUKEE, WI 53210
CURRENT OCCUPANT	2663 N 44TH ST	MILWAUKEE, WI 53210
CURRENT OCCUPANT	2669 N 44TH ST	MILWAUKEE, WI 53210
CURRENT OCCUPANT	2736 N 45TH ST	MILWAUKEE, WI 53210
CURRENT OCCUPANT	2741 N 44TH ST	MILWAUKEE, WI 53210
CURRENT OCCUPANT	2725 N 44TH ST	MILWAUKEE, WI 53210
CURRENT OCCUPANT	2717 N 44TH ST	MILWAUKEE, WI 53210
CURRENT OCCUPANT	2719 N 44TH ST	MILWAUKEE, WI 53210
CURRENT OCCUPANT	2728 N 44TH ST	MILWAUKEE, WI 53210
CURRENT OCCUPANT	2671 N 45TH ST	MILWAUKEE, WI 53210
CURRENT OCCUPANT	2712 N 44TH ST	MILWAUKEE, WI 53210
CURRENT OCCUPANT	2739 N 44TH ST	MILWAUKEE, WI 53210
CURRENT OCCUPANT	2716 N 44TH ST	MILWAUKEE, WI 53210
CURRENT OCCUPANT	2740 N 44TH ST	MILWAUKEE, WI 53210
CURRENT OCCUPANT	2679 N 45TH ST	MILWAUKEE, WI 53210

CURRENT OCCUPANT	2707 N 45TH ST	MILWAUKEE, WI 53210
CURRENT OCCUPANT	2709 N 45TH ST	MILWAUKEE, WI 53210
CURRENT OCCUPANT	2667 N 44TH ST	MILWAUKEE, WI 53210
CURRENT OCCUPANT	2713 N 44TH ST	MILWAUKEE, WI 53210
CURRENT OCCUPANT	2723 N 45TH ST	MILWAUKEE, WI 53210
CURRENT OCCUPANT	2725 N 45TH ST	MILWAUKEE, WI 53210
CURRENT OCCUPANT	2728 N 45TH ST	MILWAUKEE, WI 53210
CURRENT OCCUPANT	2722 N 45TH ST	MILWAUKEE, WI 53210
CURRENT OCCUPANT	2724 N 45TH ST	MILWAUKEE, WI 53210
CURRENT OCCUPANT	2678 N 45TH ST	MILWAUKEE, WI 53210
CURRENT OCCUPANT	2715 N 45TH ST	MILWAUKEE, WI 53210
CURRENT OCCUPANT	2673 N 44TH ST	MILWAUKEE, WI 53210
CURRENT OCCUPANT	2708 N 44TH ST	MILWAUKEE, WI 53210
CURRENT OCCUPANT	2717 N 45TH ST	MILWAUKEE, WI 53210
CURRENT OCCUPANT	2738 N 45TH ST	MILWAUKEE, WI 53210
CURRENT OCCUPANT	2730 N 45TH ST	MILWAUKEE, WI 53210
CURRENT OCCUPANT	2737 N 44TH ST	MILWAUKEE, WI 53210
CURRENT OCCUPANT	2718 N 44TH ST	MILWAUKEE, WI 53210
CURRENT OCCUPANT	2660 N 45TH ST	MILWAUKEE, WI 53210
CURRENT OCCUPANT	2679 N 44TH ST	MILWAUKEE, WI 53210
CURRENT OCCUPANT	2715 N 44TH ST	MILWAUKEE, WI 53210
CURRENT OCCUPANT	2712A N 44TH ST	MILWAUKEE, WI 53210

Total Records: 68

Radius: 250.0 feet and Center of Circle: 4402 W Center St



BUSINESS LICENSE PLAN OF OPERATION

ccl-busplan 12/14/17

Office of the City Clerk License Division
200 E. Wells St. Room 105, Milwaukee, WI 53202
(414) 286-2238 www.milwaukee.gov/license e-mail address: license@milwaukee.gov

1. Type of Business

Applying for: ☐ Extended Hours (12AM to 5AM) - If a food establishment, check all that apply: ☐ Delivery ☐ Drive Thru ☐ Dining Room
☐ Self Service Laundry ☐ Massage Establishment ☐ Filling Station
☒ Other (supplemental application for specific license also required)

Provide a detailed description of the type of business you plan on operating:

Grocery store

Do you have any experience operating this type of business? ☐ No ☒ Yes If yes, explain: Worked IN Business for few years

2. Business Operations

- a. Proposed Opening Date: 04 01 2018
- b. Is this premise under construction? ☒ No ☐ Yes If yes, list estimated completion date: _____
- c. Is this a franchise? ☒ No ☐ Yes
- d. Is this premises currently licensed? ☐ No ☒ Yes If yes, list type of license: Grocery store
- e. Is the current licensee operating? ☐ No ☒ Yes If no, list date closed: _____
- f. Do you have future plans for other businesses, licenses or permits at this location? ☒ No ☐ Yes
If yes, explain: _____
- g. Have you previously held an Extended Hours License in Milwaukee? ☒ No ☐ Yes
If yes, list address(es): _____
- h. Are other businesses operating in the same building? ☐ No ☒ Yes If yes, describe: Cell phone shop

3. Litter & Noise

- a. How are grounds kept clean? ☒ Sweep ☐ Pressure Wash ☒ Pick Up Litter ☐ Other: _____
- b. How often will grounds be cleaned? ☒ Daily ☐ Weekly ☐ As Needed ☐ Monthly ☐ Other: _____
- c. Grounds cleaned by: ☐ Licensee ☒ Building Owner ☒ Employees ☐ Hired Maintenance ☐ Other: _____
- d. How are noise issues prevented and/or addressed? ☐ Security ☒ Manager approaches customer(s) ☐ Call Police
☐ Signs Posted ☐ Other: _____
- e. Will a sound amplification system be used? ☒ No ☐ Yes If yes, describe: _____

4. Smoking & Sanitation

- a. Are there designated outdoor smoking areas? ☒ No ☐ Yes If yes, describe: _____
- b. Number of Garbage Cans: Inside: 2 Locations: Back and front
Outside: 2 Locations: front and back of Building
- c. Is a crowd control barrier used? ☒ No ☐ Yes If yes, describe: _____
- d. How many restrooms are on the premises? 1
- e. Name of solid waste contractor: ☒ Advanced Disposal ☐ Waste Management ☐ Other: _____

5. Security

- a. Are there onsite parking spaces? ☐ No ☒ Yes If yes, indicate how many? 2 and describe the parking security plan: Lights cameras
- b. Is there a loading zone? ☒ No ☐ Yes If yes, describe the loading area security plan: _____
- c. Will you have security personnel on premise? ☒ No ☐ Yes If yes, how many? _____ and answer the following:
What are their responsibilities? _____
Is security equipment used? ☐ No ☐ Yes If yes, describe _____
List their licensing, certification, or training credentials _____
- d. Will there be security cameras? ☐ No ☒ Yes If yes, where? 4 outside 12 inside
- e. Will searches/identification checks be done upon entry? ☒ No ☐ Yes If yes, describe _____

6. Percentage of Sales (must total 100%)

Alcohol _____%	Food <u>80</u> %	Secondhand Merchandise _____%	Precious Metals & Gems _____%
Entertainment _____%	Cigarettes <u>10</u> %		
Pawnbroker Activity _____%	Salvaged Materials _____% (such as scrap metal)	Personal Services (such as tattoo, body piercing, salon, tailor, tanning, etc.) _____%	Other _____% Describe: _____

7. Businesses/Licenses on the Premises (check all that apply):

Type 1

- ☐ Full Service Restaurant ☐ Cafe/Coffee Shop ☐ Deli or Fast Food Restaurant ☐ Private/Fraternal/Veterans Club
- ☐ Night Club ☐ Tavern ☐ Cocktail Lounge ☐ Teen Club
- ☐ Banquet Hall ☐ Sports Facility ☐ Bowling Alley
- ☐ Hotel/Motel : Number of Floors: _____ ☐ Rooming House: Number of Floors: _____
 Number of Rooms: _____ Number of Rooms: _____

Type 2

- ☐ Liquor Store ☒ Corner Store ☐ Supermarket ☒ Convenience Store
- ☐ Gas Station ☐ Amusement/Phonograph Distributor ☐ Recycling, Salvage or Towing
- ☐ Used Car Dealer ☐ Personal Service Establishment
(such as tattoo business, hair salon, tailor, etc.) ☐ Recording Studio

What other licenses/permits will you hold at this location? (check all that apply)

- ☒ Occupancy Permit ☒ Cigarette & Tobacco ☐ Gas Station ☐ Extended Hours ☐ Class "B" Tavern ☐ Weights & Measures
☐ Secondhand Dealer ☐ Precious Metal & Gem ☐ Other: _____

8. Legal Capacity (only if a Type 1 premises in #7 above)

Capacity _____ (Call the Milwaukee Development Center at 414-286-8211 if you have questions.)

9. Premises Description

- a. Identify all area(s) of the premises that will be used in operating this business (include areas used only for storage):
☒ 1st Floor ☐ 2nd Floor ☐ Basement Storage ☐ Patio ☐ Beer Garden ☐ Sidewalk Café ☐ Deck ☐ Rooftop
☐ Other: Describe: _____
- b. Describe Location: ☒ Major Thoroughfare ☐ Secondary Street ☐ Other: _____
- c. Nearest Major Cross Street: 43rd St.
- d. Describe Building: ☒ Free Standing Building ☐ Strip Mall ☐ Other: _____
- e. Describe Premises Structure: ☒ Single Story ☐ Multi-Story - # of Stories _____ ☐ Other: _____
- f. Describe Surrounding Area: ☒ Commercial ☒ Residential ☐ Industrial ☐ Other: _____
- g. Building Owner Name: Rabi Hussein Phone Number: 414-687-5374
 Business Owner Address: 4819 N. 26th St. Milwaukee, WI 53209

10. Hours of Operation & Customers

Will customers be entering the premises? ☐ No ☐ Yes

Day of the Week	Proposed Hours of Operation:		Estimated Number of Customers expected each day	Potential Age Range of Customers	Class B Tavern Applicant Only: Age Restriction (If none, write 'None')
	Open Time (include a.m. or p.m.)	Close Time (include a.m. or p.m.)			
Sunday	8 am	9 pm	200	16+	
Monday	8 am	9 pm	200	16+	
Tuesday	8 am	9 pm	200	16+	
Wednesday	8 am	9 pm	200	16+	
Thursday	8 am	9 pm	200	16+	
Friday	8 am	9 pm	250	16+	
Saturday	8 am	9 pm	250	16+	

An Extended Hours Establishment License is required for any convenience store, filling station, personal service establishment (such as tattoo, body piercing, salon, tailor, tanning, etc.), recording studio or restaurant which is open between the hours of 12:00 a.m. and 5:00 a.m.

Alcohol Establishments Class A: 8:00 am to 9:00 pm Sunday thru Saturday
 Permitted Hours of Operation: Class B: 6:00 am to 2:00 am Sunday thru Thursday, 6:00 am to 2:30 am Friday & Saturday

Entertainment Outdoor Closing Hours: 10:00pm Sunday-Thursday; 12:00am Friday & Saturday; unless a different time, either earlier or later, is established by the Common Council in its approval of the licensee's plan of operation.

11. Signature(s)

Josh Norde
 Signature of Sole Proprietor, Partner, or 20% or more Shareholder
 (If there are no 20% or more shareholders,
 Corporate Officer-print name/title and sign)

 Signature of additional partner or 20% or more shareholder

See Application Information for a complete list of all required application forms.

**FOOD DEALER LICENSE PLAN OF OPERATION**

OFFICE OF THE CITY CLERK, LICENSE DIVISION
CITY HALL, 200 E. WELLS ST, ROOM 105, MILWAUKEE, WI 53202
(414) 286-2238 • license@milwaukee.gov • www.milwaukee.gov/license

Legal Entity Name:

Jay's Food LLC

Premises Address:

4402 W. Center St. Milwaukee, WI 53210

SECTION 1 TYPE OF BUSINESS

Type of application (check one):



taking over a currently operating business



starting a new business

Anticipated opening date? _____

Check the type that best describes your business (check only one):

See Food Dealer License Information sheet for definitions.

☐ Restaurant☐ Bed & Breakfast☒ Retail Establishment☐ Base for Food PeddlerIf retail, will it be a convenience store? ☒ Yes ☐ No☐ Base for Temporary/Seasonal Food Stand

(Convenience Stores have less than 5,000 sq ft of retail space,

primary business is the sale of basic food items, and in addition sells household products)

In addition, will any wholesale business be done? ☐ Yes ☒ NoIf yes, what percentage of the business will be wholesale? ☐ Less than 25% ☐ 25% or More (Contact DATCP)*

Will retail items be sold?

☐ No☒ YesIf Yes, indicate percentage of food sales 70 %

Will restaurant items be sold?

☐ No*☒ YesIf Yes, indicate percentage of food sales 30 %

* If you checked "25% or More" of the business will be wholesale and answered "No" to restaurant items being sold, do not continue completing this application. A City of Milwaukee License is not required. Contact DATCP only.

SECTION 2 FOOD PROCESSINGWill any food processing be done? ☐ No ☒ Yes

Processing is defined as assembling, grinding, cutting, mixing, baking, coating, stuffing, packing, bottling, grilling, canning, extracting, fermenting, distilling, pickling, freezing, drying, smoking, or packaging.

If Yes, check the types of food items:

☒ SNACKS & BEVERAGES

includes, but is not limited to, ice cream/soft serve, lemonade, snow cones, coffee, espresso, cappuccino, tea, fruit juice, smoothies, candy, dispensed soda, fruit cups, bakery, cookies, popcorn, kettle corn, cotton candy, funnel cakes, fritters, tortilla chips w/ cheese

☒ MEALS

includes, but is not limited to, chicken, ribs, sandwiches, roasted corn, baked potatoes, hot dogs, brats, tacos, nachos w/ cheese and meat, French fries, cooked or deep fried vegetables/fruit, cooked cheese curds, corn dogs, egg rolls, salads

SECTION 3 FOOD REQUIRING TEMPERATURE CONTROL

Will any food that requires temperature control be sold?

☐ No☒ Yes

(includes dairy products such as milk, cheese, and ice cream, fish, shellfish, meat, poultry)

If yes, list the types of food items: milk, cheese, Ice cream

SECTION 4 SHARED KITCHEN

Will you be sharing kitchen space with another operator?

☒ No

If No, SKIP to Section 5

☐ Yes

If Yes, check one:

☐

I will rent space from another operator ("Shared Kitchen Agreement" is required)

☐

I will rent space to another operator (peddler/caterer)

SECTION 5 DETAILS OF OPERATION

Answer the following questions:

Will you have seating on site for dining?

☒ No ☐ Yes

Will you be doing any catering?

☒ No ☐ Yes

Will you be doing any delivery?

☒ No ☐ Yes

Will you have outdoor activities?

☒ No ☐ Yes

If Yes to outdoor activities, check all that apply:

☐ Bar☐ Cooking/Grilling☐ Dining

Will you have a drive thru window?

☒ No ☐ Yes

If Yes to drive thru, are hours different from inside?

☐ No ☐ Yes

If Yes, provide drive thru hours: _____

Will any scales or barcode scanners be used?

☒ No ☐ Yes

If Yes, a Weights & Measures application must be completed and a license obtained.

SECTION 6 ADDITIONAL SITES

Where will food be prepared and/or sold?

☒ At a single site☐ At multiple sites (for example, a hotel with several dining rooms or bars)

How many? _____

If multiple sites, attach a Food Dealer Additional Site Addendum (ccl-foodadd) for each additional site.

SECTION 7 CONSTRUCTION OR CHANGES

Are you planning any construction, remodeling or equipment changes?

☒ No

If No, SKIP to Section 8

☐ Yes

If Yes, check all that apply:

☐ New construction of a building☐ Construction changes to an existing building☐ Renovation or remodeling☐ Equipment changes only (installation or replacement)

Provide a brief description of the changes: _____

Start date: _____

Name, Address & Phone Number of Architect: _____

Name, Address & Phone Number of Contractor: _____

SECTION 8 ALCOHOL BEVERAGES

Are you applying for an alcohol beverage license?

☒ No If No, SKIP to Section 9☐ Yes If YES, if your food license is approved prior to the alcohol beverage license, when do you want the food license issued? ☐ Immediately ☐ At the same time as the alcohol license**SECTION 9 ACKNOWLEDGEMENTS & SIGNATURE**

You must initial each item confirming your understanding:

JA I understand the Health Department must conduct an inspection and advise the License Division of their approval before the license may be issued.JA I understand I must obtain an occupancy permit from the Department of Neighborhood Services and an inspection may be required. Neighborhood Services must advise the License Division of their approval before the license may be issued.JA I understand the district alderperson will review and either approve or deny my application. If denied, I may appeal and be scheduled to appear before the Licenses Committee. The Licenses Committee will then make a recommendation to the Common Council. The Common Council must grant the license before it may be issued.FR I understand proof of payment for all license fees must be on file in the License Division before the license may be issued.JA I understand the license must be issued and posted in my establishment prior to opening for business.JA I will not operate my food business until the license has been issued and posted in the establishment.Signature of sole proprietor, partner, agent or 20% shareholder: Josh Rader

Signature of additional partner(s): _____

Jason ~ Randolph agent

Center Street

4402 W Center St

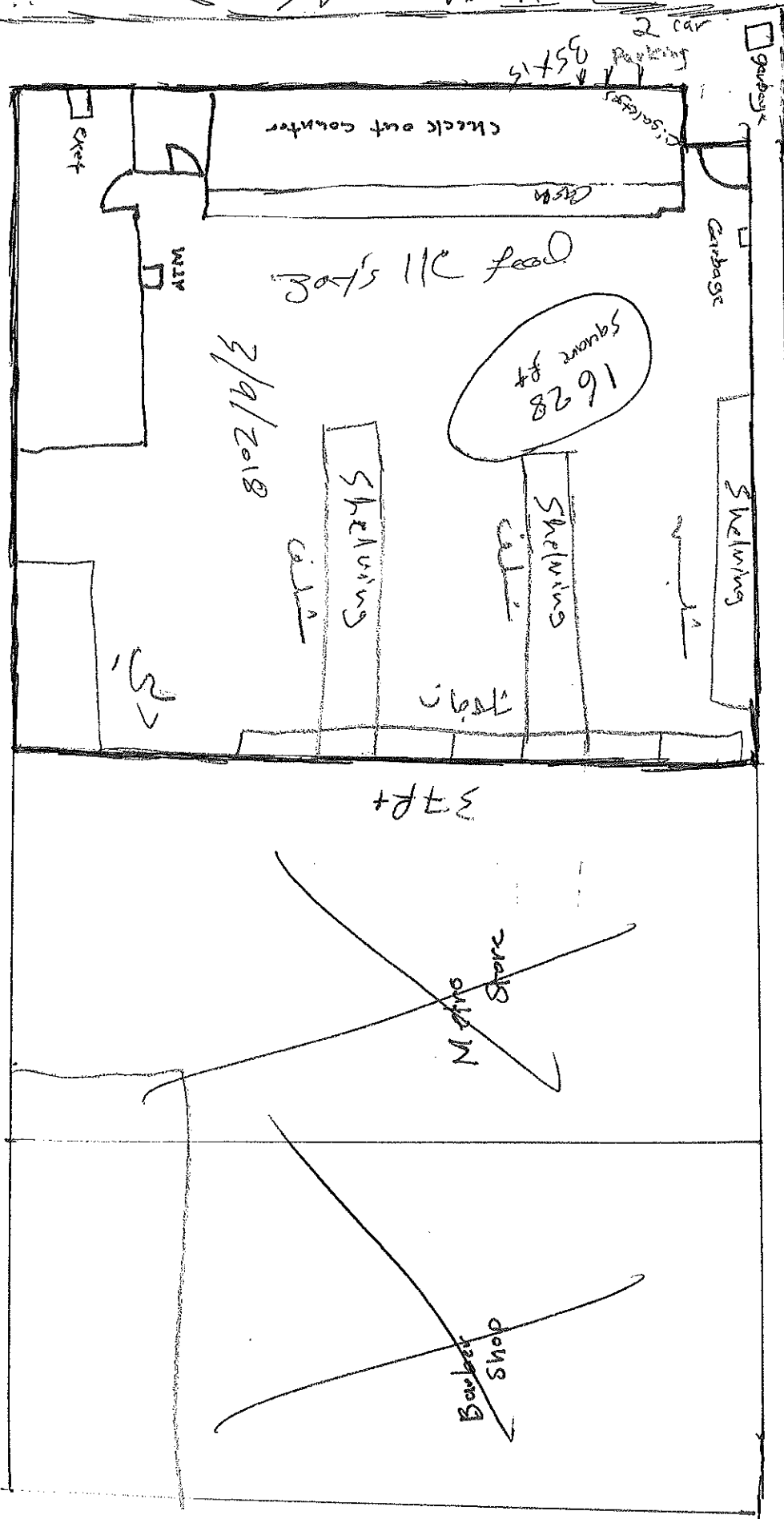

44th



**CITY OF MILWAUKEE
OFFICE OF THE CITY CLERK**

Friday, May 04, 2018

COMMITTEE MEETING NOTICE

AD 07

TOOR, Davinder S, Agent
Toor Stores LLC
5009 W Hampton Av

Milwaukee, WI 53218

You are requested to attend a hearing which is to be held in Room 301-B, Third Floor, City Hall on:

Tuesday, May 15, 2018 at 01:15 PM

Regarding: Your Class A Malt & Class A Liquor and Food Dealer License Renewal Applications as agent for "Toor Stores LLC" for "Jack's Liquor" at 5009 W Hampton Av.

There is a possibility that your application may be denied  one or more of the following reasons: The recommendation of the committee regarding the application shall be based on evidence presented at the hearing. Per MCO 85-4-4, unless otherwise specified in the code, probative evidence concerning non-renewal, suspension or revocation may include evidence of the following: failure of the applicant to meet municipal qualifications, pending charges against or the conviction of any felony, misdemeanor, municipal offense or other offense, the circumstances of which substantially relate to the circumstances of the particular licensed or permitted activity, by the applicant or by any employee or other agent of the applicant. If the activities of the applicant involve a licensed premises, whether the premises tends to facilitate a public or private nuisance or has been the source of congregations of persons which have resulted in any of the following: disturbance of the peace; illegal drug activity; public drunkenness; drinking in public; harassment of passers-by; gambling; prostitution; sale of stolen goods; public urination; theft; assaults; battery; acts of vandalism including graffiti, excessive littering, loitering, illegal parking, loud noise at times when the licensed premise is open for business; traffic violations; curfew violations; lewd conduct; display of materials harmful to minors, pursuant to s. 106-9.6; or any other factor which reasonably relates to the public health, safety and welfare, or failure to comply with the approved plan of operation. See attached police report or correspondence.

**Notice for applicants with
warrants or unpaid fines:**

Proof of warrant satisfaction or payment of fines must be submitted at the hearing on the above date and time. Failure to comply with this requirement may result in a delay of the granting/denial of your application.

Failure to appear at this meeting may result in the denial of your license. Individual applicants must appear only in person or by an attorney. Corporate or Limited Liability applicants must appear only by the agent designated on the application or by an attorney. Partnership applicants must appear by a partner listed on the application or by an attorney. If you wish to do so and at your own expense, you may be accompanied by an attorney of your choosing to represent you at this hearing.

You will be given an opportunity to speak on behalf of the application and to respond and challenge any charges or reasons given for the denial. No petitions can be accepted by the committee, unless the people who signed the petition are present at the committee hearing and willing to testify. You may present witnesses under oath and you may also confront and cross-examine opposing witnesses under oath. If you have difficulty with the English language, you should bring an interpreter with you, at your expense, so that you can answer questions and participate in your hearing.

You may examine the application file at this office during regular business hours prior to the hearing date. Inquiries regarding this matter may be directed to the person whose signature appears below.

Limited parking for persons attending meetings in City Hall is available at reduced rates (5 hour limit) at the Milwaukee Center on the southwest corner of East Kilbourn and North Water Street. Parking tickets must be validated in the first floor information booth in City Hall.

PLEASE NOTE: Upon reasonable notice, efforts will be made to accommodate the needs of disabled individuals through sign language interpreters or other auxiliary aids. For additional information or to request this service, contact the Council Services Division ADA Coordinator at (414) 286-2998, Fax - (414) 286-3456, TDD - (414) 286-2025.

JIM OW CZARSKI, CITY CLERK

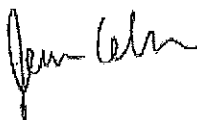

BY:

Jessica Celella

License Division Manager

If you have questions regarding this notice, please contact the License Division at (414) 286-2238.

200 E. Wells Street, Room 105, City Hall, Milwaukee, WI 53202. www.milwaukee.gov/license
Phone: (414) 286-2238 Fax: (414) 286-3057 Email Address: License@milwaukee.gov

MILWAUKEE POLICE DEPARTMENT
LICENSE INVESTIGATION UNIT

CRIMINAL RECORD/ORDINANCE VIOLATION/INCIDENTS
SYNOPSIS

DATE: 03/26/2018

LICENSE TYPE: CLASS A MALT & LIQUOR

NEW:

RENEWAL: X

No. 271635

Application Date: 03/23/2018

Expiration Date:

License Location: 5009 W. Hampton Avenue

Business Name: Toor Stores

Licensee/Applicant: Toor, Davinder S.

(Last Name, First Name, MI)

Date of Birth: 04/23/1983

Male:

Female:

Home Address: 10315 S. George Dr.

City: Oak Creek

State: WI

Zip Code: 53154

Home Phone: (414) 698-4896

This report is written by Police Officer David NOVAK, assigned to the License Investigation Unit, Days.

The Milwaukee Police Department's investigation regarding this application revealed the following:

1. On 06/08/2008 the applicant was cited in Kenosha County for Violate Public Swimming Pool Regulations.

Charge: Violate Public Swimming Pool Regulations

Finding: Guilty

Sentence: Fine

Date: 06/18/2008

Case: 2008FO000563

=====

2. On 05/05/2014 Milwaukee police were dispatched to a strong armed robbery complaint at 5009 West Hampton Avenue. Investigation revealed that a subject was stealing bottles of wine from the business. When this subject was confronted, a struggle ensued during which both the suspect and the intervening parties were struck in the head with a bottle. Milwaukee police incident report #141250098 filed.

3. On 06/03/2014 Milwaukee police conducted follow up at Jack's Liquor (5009 West Hampton Avenue) regarding a complaint received from a city of Milwaukee health inspector that neither the owner nor any employee had attended robbery prevention training as required by ordinance. Surjit Toor told officers that he had attended the training and he thought that only one person had to participate. Officers informed Toor that this is incorrect and that all employees need to attend the training.
4. On 07/19/2014 the applicant was cited at 3565 North Teutonia Avenue in the city of Milwaukee for Sale of Cigarettes to Minor/Underage.

Charge: Sale of Cigarettes to Minor/Underage
Finding: Guilty
Sentence: \$130.00 fine
Date: 10/28/2014
Case: 14054187

=====

5. On 10/08/2016 a 17 year old, working in conjunction with Milwaukee police, was able to purchase a 2 pack of Swisher Sweet brand cigars from the cashier at 5009 W. Hampton Avenue (Jack's Liquor). The officer advised the cashier that a notice would be mailed to the applicant regarding the M.A.R.T.S. program. As of 11/26/2016, the applicant had not registered for the M.A.R.T.S. program and a citation was mailed. This citation cannot be found in the City of Milwaukee Municipal Court Case Information Website.

Charge: Sale of Cigarettes to Minor/Underage
Finding: Guilty
Sentence: Fined \$260.00
Date: 09/18/2017
Case: 17034918

=====

Item #5 updated with citation information after applicant did not enroll in the MARTS program.

Type of License: Class A

Date _____

[illegible]

PA-33E Narrative

This report is written by PO Penny BROWN assigned to the License Investigation Unit. On Saturday, October 8, 2016, I was assigned to work the Wisconsin WINS Youth Tobacco Initiative, which checks area vendors for age compliance tobacco purchases. Assisting in this assignment was: Cleveland EASLEY B/M 03/27/99 2517 N. 15th St. phone #414-458-5957. EASLEY is 17 years old and not of legal age to purchase tobacco.

At approximately 12:02P EASLEY entered Jack's Liquor, located at 5009 W. Hampton Ave., and purchased a 2 pack of regular flavor Swisher Sweet Cigars for .99. Based on the description given to me by EASLEY, I was able to immediately identify the cashier: Paramjit TOOR A/M 6/16/70. TOOR admitted to the sale and apologized. I advised TOOR I would be mailing out a notice to enroll in the M.A.R.T.S. program to the registered agent.

The agent, Davinder S. Toor, did enroll in the M.A.R.T.S. program, however, failed a mystery inspection on February 21, 2017. Therefore a citation for the initial violation was issued.



Friday, May 04, 2018



Notice of Public Hearing

TOOR, Davinder S, Agent
Jack's Liquor at 5009 W Hampton Av
Class A Malt & Class A Liquor and Food Dealer License Renewal Applications

Tuesday, May 15, 2018 at 1:15 PM

To whom it may concern:

The above application has been made by the above named applicant(s). This requires approval from the Licenses Committee and the Common Council of the City of Milwaukee. The hearing before the Licenses Committee will take place on 5/15/2018 at 1:15 PM, in Room 301-B, Third Floor, City Hall. If you wish, you may provide testimony at the hearing regarding the request; see below for further information. You are not required to attend the hearing. Once the Licenses Committee makes its recommendation, this recommendation is forwarded to the full Common Council for approval at its next regularly scheduled hearing. Please review the information below and if you have further questions regarding this process, please contact the License Division at (414) 286-2238.

Important details for those wishing to provide information for the Licenses Committee to consider when making its recommendation:

1. The license application is scheduled to be heard at the above time. Due to other hearings running longer than scheduled, you may have to wait some time to provide your testimony.
2. You must appear in person and testify as to matters that you have personally experienced or seen. (You cannot provide testimony for your neighbor, parent or anyone else; this is considered hearsay and cannot be considered by the committee.)
3. No letters or petitions can be accepted by the committee (unless the person who wrote the letter or the persons who signed the petition are present at the committee hearing and willing to testify).
4. Persons opposed to the license application are given the opportunity to testify first; supporters may testify after the opponents have finished.
5. When you are called to testify, you will be sworn in and asked to give your name, and address. (If your first and/or last names are uncommon please spell them.)
6. You may then provide testimony.
 - a. Include only information relating to the above license application.
 - b. Include only information you have personally witnessed or seen.
 - c. Provide concise and relevant information detailing how this business has affected or may affect the peaceful enjoyment of your neighborhood.
 - d. If by the time you have the opportunity to testify, the information you wish to share has already been provided to the committee, you may state that you agree with the previous testimony. Redundant or repetitive testimony will not assist the committee in making its recommendation.
7. After giving your testimony, the members of the Licenses Committee and the licensee may ask questions regarding the testimony you have given or other factors relating to the license application.
8. Business Competition is not a valid basis for denial or non-renewal of a license.
Please Note: If you have submitted an objection to the above application your objection cannot be considered by the committee unless you personally testify at the hearing.

OCCUPANT	MAIL ADDRESS	CITY, STATE ZIP
CURRENT OCCUPANT	4938 W HAMPTON AVE 2	MILWAUKEE, WI 53218
CURRENT OCCUPANT	4822 N 51ST BLVD	MILWAUKEE, WI 53218
CURRENT OCCUPANT	4764 N 50TH ST	MILWAUKEE, WI 53218
CURRENT OCCUPANT	4948 W HAMPTON AVE 5	MILWAUKEE, WI 53218
CURRENT OCCUPANT	4948 W HAMPTON AVE 11	MILWAUKEE, WI 53218
CURRENT OCCUPANT	4938 W HAMPTON AVE 9	MILWAUKEE, WI 53218
CURRENT OCCUPANT	4948 W HAMPTON AVE 9	MILWAUKEE, WI 53218
CURRENT OCCUPANT	4777 N 50TH ST	MILWAUKEE, WI 53218
CURRENT OCCUPANT	4741 N 50TH ST	MILWAUKEE, WI 53218
CURRENT OCCUPANT	4938 W HAMPTON AVE 6	MILWAUKEE, WI 53218
CURRENT OCCUPANT	4938 W HAMPTON AVE 5	MILWAUKEE, WI 53218
CURRENT OCCUPANT	4948 W HAMPTON AVE 7	MILWAUKEE, WI 53218
CURRENT OCCUPANT	4948 W HAMPTON AVE 3	MILWAUKEE, WI 53218
CURRENT OCCUPANT	4938 W HAMPTON AVE 12	MILWAUKEE, WI 53218
CURRENT OCCUPANT	4769 N 51ST BLVD	MILWAUKEE, WI 53218
CURRENT OCCUPANT	4938 W HAMPTON AVE 1	MILWAUKEE, WI 53218
CURRENT OCCUPANT	4938 W HAMPTON AVE 3	MILWAUKEE, WI 53218
CURRENT OCCUPANT	4938 W HAMPTON AVE 4	MILWAUKEE, WI 53218
CURRENT OCCUPANT	4938 W HAMPTON AVE 10	MILWAUKEE, WI 53218
CURRENT OCCUPANT	4948 W HAMPTON AVE 8	MILWAUKEE, WI 53218
CURRENT OCCUPANT	4948 W HAMPTON AVE 4	MILWAUKEE, WI 53218
CURRENT OCCUPANT	4763 N 49TH ST	MILWAUKEE, WI 53218
CURRENT OCCUPANT	4777A N 50TH ST	MILWAUKEE, WI 53218
CURRENT OCCUPANT	4938 W HAMPTON AVE 7	MILWAUKEE, WI 53218
CURRENT OCCUPANT	4948 W HAMPTON AVE 2	MILWAUKEE, WI 53218
CURRENT OCCUPANT	4948 W HAMPTON AVE 6	MILWAUKEE, WI 53218
CURRENT OCCUPANT	4761A N 51ST BLVD	MILWAUKEE, WI 53218
CURRENT OCCUPANT	4756 N 51ST BLVD	MILWAUKEE, WI 53218
CURRENT OCCUPANT	4816 N 51ST BLVD	MILWAUKEE, WI 53218
CURRENT OCCUPANT	4757 N 50TH ST	MILWAUKEE, WI 53218
CURRENT OCCUPANT	4938 W HAMPTON AVE 8	MILWAUKEE, WI 53218
CURRENT OCCUPANT	4761 N 51ST BLVD	MILWAUKEE, WI 53218
CURRENT OCCUPANT	4744 N 51ST BLVD	MILWAUKEE, WI 53218
CURRENT OCCUPANT	4745 N 50TH ST	MILWAUKEE, WI 53218
CURRENT OCCUPANT	4742 N 50TH ST	MILWAUKEE, WI 53218
CURRENT OCCUPANT	4948 W HAMPTON AVE 10	MILWAUKEE, WI 53218
CURRENT OCCUPANT	4948 W HAMPTON AVE 12	MILWAUKEE, WI 53218
CURRENT OCCUPANT	4755 N 51ST BLVD	MILWAUKEE, WI 53218
CURRENT OCCUPANT	4750 N 51ST BLVD	MILWAUKEE, WI 53218
CURRENT OCCUPANT	4773 N 50TH ST	MILWAUKEE, WI 53218
CURRENT OCCUPANT	4763 N 50TH ST	MILWAUKEE, WI 53218
CURRENT OCCUPANT	4756 N 50TH ST	MILWAUKEE, WI 53218
CURRENT OCCUPANT	4748 N 50TH ST	MILWAUKEE, WI 53218
CURRENT OCCUPANT	4938 W HAMPTON AVE 11	MILWAUKEE, WI 53218
CURRENT OCCUPANT	4948 W HAMPTON AVE 1	MILWAUKEE, WI 53218
CURRENT OCCUPANT	4761 N 49TH ST	MILWAUKEE, WI 53218

Total Records: 46

Radius: 250.0 feet and Center of Circle: 5009 W Hampton Av

2018-2019 Plan of Operation for 5009 W HAMPTON AV

1. Litter & Security Plans

How are the grounds kept clean? ☒ Sweep ☐ Pressure Wash ☒ Pick Up Litter ☒ Other: GARBAGE CANS outside

How often will grounds be cleaned? ☒ Daily ☐ Weekly ☒ Other: AS NEEDED

Who cleans the grounds? ☒ Licensee ☐ Building Owner ☐ Employees ☒ Hired Maintenance ☐ Other:

How are noise issues prevented and/or addressed? ☒ Security ☒ Manager approaches customer(s) ☐ Call Police ☒ Signs Posted ☐ Other:

Are there designated outdoor smoking areas? ☒ No ☐ Yes If Yes, Describe:

Number of garbage cans: Inside 3 Locations: BY ENTRANCE, BY CASHIER, IN THE STORE
Outside 2 Locations: BY THE DOOR, BY THE PARKING

Is a crowd control barrier used? ☒ No ☐ Yes If Yes, Describe:

Number of restrooms: 2 Name of solid waste contractor: A-1 SERVICES

Are there parking spaces on the premises? ☐ No ☒ Yes If Yes, list number of spaces: 8 and describe security plans: Security cameras

Are there designated loading areas? ☒ No ☐ Yes If Yes, describe security plans:

Do you have security personnel on the premise? ☒ No ☐ Yes If Yes, how many? _____
AND What are their responsibilities? _____
What security equipment do they use? _____
List their licensing, certification or training credentials: _____

Are there security cameras? ☐ No ☒ Yes If Yes, list all locations: INSIDE AND OUTSIDE THE STORE

Are searches and/or identification checks conducted upon entry? ☒ No ☐ Yes If Yes, describe:

2. Percentage of Sales (must total 100%)

Alcohol 95 % Food Sales 3 % Entertainment _____ % Other 2 %

3. Businesses On The Premises (choose all that apply):

- ☐ Restaurant ☐ Cafe/Coffee Shop ☐ Cocktail Lounge ☐ Convenience Store ☐ Night Club ☒ Liquor Store ☐ Tavern ☐ Sports Facility
☐ Hotel ☐ Banquet Hall ☐ Supermarket ☐ Private/Fraternal/Veterans' Club ☐ Other:

4. Hours of Operation and Age Restriction

Are there any changes to the current hours of operation or age restriction? ☒ No ☐ Yes If Yes, Describe:

Please Note: If you will be open earlier or later than the hours listed on your current license for even one event or holiday (for example, St. Patrick's Day, Brewers Opening Day, etc.) during the license period, this must be reported and printed on your license.

Your hours of operation and age restriction are listed on your current license.

5. Floor Plan and Capacity

Are you requesting any changes to the floor plan or capacity? ☒ No ☐ Yes If Yes, Describe:

If requesting changes to the floor plan, submit a new floor plan with this application. Changes in floor plan include changing the location of tables, games, etc. within your current licensed premises. If your changes include adding any additional areas or square footage to your premises, or any renovations to the building will be done, a Permanent Extension of Premises application must be filed.

6. Sidewalk Dining: Fee:

Are there any changes to the sidewalk dining site plan? ☒ No ☐ Yes If Yes, submit an updated site plan with this application.

7. Food License: FOOD 7956 Fee: \$200.00

Your current food license includes the following food operations: No Processing, Hazardous Foods, Sales < \$20,000, Convenience. Are there any changes to your food operations as listed above? ☒ No ☐ Yes, if Yes, explain _____

8. Weights and Measures: Fee:

Number/Type of Devices:
Are there any changes to the number or types of devices? ☒ No ☐ Yes
If yes, contact our office for further instructions.



CITY OF MILWAUKEE
OFFICE OF THE CITY CLERK

Thursday, May 03, 2018

COMMITTEE MEETING NOTICE

AD 15

Alaa T Hamed

1802 W Center St

Milwaukee, WI 53206

You are requested to attend a hearing which is to be held in Room 301-B, Third Floor, City Hall on:

Tuesday, May 15, 2018 at 01:15 PM

Regarding: Your Class A Malt and Food Dealer License Renewal Applications for "Sams Food Market" at 1802 W Center St.

There is a possibility that your application may be denied for one or more of the following reasons: The recommendation of the committee regarding the application shall be based on evidence presented at the hearing. Per MCO 85-4-4, unless otherwise specified in the code, probative evidence concerning non-renewal, suspension or revocation may include evidence of the following: failure of the applicant to meet municipal qualifications, pending charges against or the conviction of any felony, misdemeanor, municipal offense or other offense, the circumstances of which substantially relate to the circumstances of the particular licensed or permitted activity, by the applicant or by any employee or other agent of the applicant. If the activities of the applicant involve a licensed premises, whether the premises tends to facilitate a public or private nuisance or has been the source of congregations of persons which have resulted in any of the following: disturbance of the peace; illegal drug activity; public drunkenness; drinking in public; harassment of passers-by; gambling; prostitution; sale of stolen goods; public urination; theft; assaults; battery; acts of vandalism including graffiti, excessive littering, loitering, illegal parking, loud noise at times when the licensed premise is open for business; traffic violations; curfew violations; lewd conduct; display of materials harmful to minors, pursuant to s. 106-9.6; or any other factor which reasonably relates to the public health, safety and welfare, or failure to comply with the approved plan of operation. See attached police report or correspondence.

**Notice for applicants with
warrants or unpaid fines:**

Proof of warrant satisfaction or payment of fines must be submitted at the hearing on the above date and time. Failure to comply with this requirement may result in a delay of the granting/denial of your application.

Failure to appear at this meeting may result in the denial of your license. Individual applicants must appear only in person or by an attorney. Corporate or Limited Liability applicants must appear only by the agent designated on the application or by an attorney. Partnership applicants must appear by a partner listed on the application or by an attorney. If you wish to do so and at your own expense, you may be accompanied by an attorney of your choosing to represent you at this hearing.

You will be given an opportunity to speak on behalf of the application and to respond and challenge any charges or reasons given for the denial. No petitions can be accepted by the committee, unless the people who signed the petition are present at the committee hearing and willing to testify. You may present witnesses under oath and you may also confront and cross-examine opposing witnesses under oath. If you have difficulty with the English language, you should bring an interpreter with you, at your expense, so that you can answer questions and participate in your hearing.

You may examine the application file at this office during regular business hours prior to the hearing date. Inquiries regarding this matter may be directed to the person whose signature appears below.

Limited parking for persons attending meetings in City Hall is available at reduced rates (5 hour limit) at the Milwaukee Center on the southwest corner of East Kilbourn and North Water Street. Parking tickets must be validated in the first floor information booth in City Hall.

PLEASE NOTE: Upon reasonable notice, efforts will be made to accommodate the needs of disabled individuals through sign language interpreters or other auxiliary aids. For additional information or to request this service, contact the Council Services Division ADA Coordinator at (414) 286-2998, Fax - (414) 286-3456, TDD - (414) 286-2025.

JIM OW CZARSKI, CITY CLERK

BY:

Jessica Celella

License Division Manager

If you have questions regarding this notice, please contact the License Division at (414) 286-2238.

200 E. Wells Street, Room 105, City Hall, Milwaukee, WI 53202. www.milwaukee.gov/license
Phone: (414) 286-2238 Fax: (414) 286-3057 Email Address: License@milwaukee.gov

MILWAUKEE POLICE DEPARTMENT

LICENSING

CRIMINAL RECORD/ORDINANCE VIOLATION/INCIDENTS SYNOPSIS

DATE: 04/13/2018
LICENSE TYPE: AMALT
NEW: ☐
RENEWAL: ☒

No. 272590
Application Date: 04/12/2018

License Location: 1802 West Center Street
Business Name: Sams Food

Licensee/Applicant: Hamed, Alaa T.
(Last Name, First Name, MI)
Date of Birth: 11/11/1981

Home Address: 5420 South Tuckaway Lane
City: Greenfield State: WI Zip Code: 53221
Home Phone: 414-243-0042

This report is written by Police Officer David NOVAK, assigned to the License Investigation Unit, Days.

The Milwaukee Police Department's investigation regarding this application revealed the following:

1. On 12/12/2015 a 17 year old, working in conjunction with Milwaukee police, was able to purchase a Black and Mild cigar from the cashier at 1802 West Center Street (Sam's Food Market). As of 01/29/2016, the agent had not enrolled in the M.A.R.T.S. program and a citation for Sale of Cigarettes to Minor/Underage was mailed to him.

Charge: Sale of Cigarettes to Minor/Underage
Finding: Dismissed without prejudice
Sentence:
Date: 03/02/2016
Case: 16010031

- =====
2. On 10/21/2016 a 20 year old, working in conjunction with Milwaukee police, purchased a can of Four Loco Applesour from the cashier, Tyrone Shavers, at 1802 West Center Street (Sam's Food Market). The officer asked Shavers for his Class D Operator's License, who stated he did not have one. The officer then contacted the applicant, who was advised of both violations and told that Respect 21 enrollment forms would be mailed. As of 01/06/2017, the applicant had not enrolled in Respect 21. The applicant received two citations.

Charge	1:	Responsible Person on Premise Required
	2:	Sale of Alcohol to Underage Person
Finding	1:	Guilty
	2:	Guilty
Sentence	1:	\$378.00 fine
	2:	\$181.00 fine
Date	1:	12/21/2016
	2:	02/24/2017
Case	1:	16061172
	2:	17003419

- =====
3. On 03/20/2018 officers conducted a license premise check at Sam's Food, 1802 W. Center St. The sole employee Mohammad SOBOH did not have a Class D Operators license. The applicant was called and when advised what was going on he stated he knew he need a class D Operator but he just had to run an errand.

Charge: Responsible Person on Premise
Finding: court date 05/04/2018
Sentence:
Date:
Citation: J981007D6S9

Citation No.	Case Number	Disposition	Judge	Date

PA-33E Narrative

This report is written by PO Penny Brown assigned to the License Investigation Unit.

On Tuesday, March 20, 2018 at approximately 10:30a.m., PO Denise RUEDA and I conducted a license premise check at Sam's Food, located at 1802 W. Center St. Immediately upon entering the store and introducing ourselves to the sole employee on scene (Mohammad S. SOBOH A/M 2/14/89), SOBOH stated I will call the owner. I advised SOBOH that would not be necessary, unless we were to find a violation. SOBOH then stated "I'm just watching the store for a few minutes". Since this was a Class A establishment, I requested to see SOBOH's Operator's License. SOBOH then stated "I don't understand", however, SOBOH seemed to understand all of the previous conversation.

Officers then requested SOBOH contact the agent since we suspected he did not have an Operator's License. SOBOH then contacted Alaa T. HAMED via the telephone. Immediately upon my announcing who I was and why I was at the store, HAMED stated "I will be there in a few minutes, I just had to run a quick errand". I advised HAMED that as the agent he is aware that he can not leave an employee without a Class D in the store alone. HAMED stated "I know, so what was I supposed to do, close the store down"? I advised HAMED that he should always make sure he is on premise or an employee with a Class D, and that at no time when the store is open for business should a non licensed employee be left alone.

I also observed an ashtray in the locked cashier area and advised SOBOH that there should be no smoking on the licensed premise.



Thursday, May 03, 2018



Notice of Public Hearing

HAMED, Alaa T
Sams Food Market at 1802 W Center St
Class A Malt and Food Dealer License Renewal Applications

Tuesday, May 15, 2018 at 1:15 PM

To whom it may concern:

The above application has been made by the above named applicant(s). This requires approval from the Licenses Committee and the Common Council of the City of Milwaukee. The hearing before the Licenses Committee will take place on 5/15/2018 at 1:15 PM, in Room 301-B, Third Floor, City Hall. If you wish, you may provide testimony at the hearing regarding the request; see below for further information. You are not required to attend the hearing. Once the Licenses Committee makes its recommendation, this recommendation is forwarded to the full Common Council for approval at its next regularly scheduled hearing. Please review the information below and if you have further questions regarding this process, please contact the License Division at (414) 286-2238.

Important details for those wishing to provide information for the Licenses Committee to consider when making its recommendation:

1. The license application is scheduled to be heard at the above time. Due to other hearings running longer than scheduled, you may have to wait some time to provide your testimony.
2. You must appear in person and testify as to matters that you have personally experienced or seen. (You cannot provide testimony for your neighbor, parent or anyone else; this is considered hearsay and cannot be considered by the committee.)
3. No letters or petitions can be accepted by the committee (unless the person who wrote the letter or the persons who signed the petition are present at the committee hearing and willing to testify).
4. Persons opposed to the license application are given the opportunity to testify first; supporters may testify after the opponents have finished.
5. When you are called to testify, you will be sworn in and asked to give your name, and address. (If your first and/or last names are uncommon please spell them.)
6. You may then provide testimony.
 - a. Include only information relating to the above license application.
 - b. Include only information you have personally witnessed or seen.
 - c. Provide concise and relevant information detailing how this business has affected or may affect the peaceful enjoyment of your neighborhood.
 - d. If by the time you have the opportunity to testify, the information you wish to share has already been provided to the committee, you may state that you agree with the previous testimony. Redundant or repetitive testimony will not assist the committee in making its recommendation.
7. After giving your testimony, the members of the Licenses Committee and the licensee may ask questions regarding the testimony you have given or other factors relating to the license application.
8. Business Competition is not a valid basis for denial or non-renewal of a license.
Please Note: If you have submitted an objection to the above application your objection cannot be considered by the committee unless you personally testify at the hearing.

OCCUPANT	MAIL ADDRESS	CITY, STATE ZIP
CURRENT OCCUPANT	1729 W CENTER ST	MILWAUKEE, WI 53206
CURRENT OCCUPANT	1714 W CENTER ST	MILWAUKEE, WI 53206
CURRENT OCCUPANT	1735 W CENTER ST	MILWAUKEE, WI 53206
CURRENT OCCUPANT	2713 N 18TH ST	MILWAUKEE, WI 53206
CURRENT OCCUPANT	1731 W CENTER ST	MILWAUKEE, WI 53206
CURRENT OCCUPANT	1726 W CENTER ST	MILWAUKEE, WI 53206
CURRENT OCCUPANT	2822 N 15TH ST	MILWAUKEE, WI 53206
CURRENT OCCUPANT	2818 N 15TH ST	MILWAUKEE, WI 53206
CURRENT OCCUPANT	2830 N 15TH ST	MILWAUKEE, WI 53206
CURRENT OCCUPANT	1821 W CENTER ST	MILWAUKEE, WI 53206
CURRENT OCCUPANT	2723 N 18TH ST	MILWAUKEE, WI 53206
CURRENT OCCUPANT	2739 N 18TH ST	MILWAUKEE, WI 53206
CURRENT OCCUPANT	2741 N 18TH ST	MILWAUKEE, WI 53206
CURRENT OCCUPANT	2736 N 19TH ST	MILWAUKEE, WI 53206
CURRENT OCCUPANT	1818 W CENTER ST	MILWAUKEE, WI 53206
CURRENT OCCUPANT	2834 N 15TH ST	MILWAUKEE, WI 53206
CURRENT OCCUPANT	1728 W CENTER ST	MILWAUKEE, WI 53206
CURRENT OCCUPANT	1710 W CENTER ST	MILWAUKEE, WI 53206
CURRENT OCCUPANT	1725 W CENTER ST	MILWAUKEE, WI 53206
CURRENT OCCUPANT	2826 N 15TH ST	MILWAUKEE, WI 53206
CURRENT OCCUPANT	1730 W CENTER ST	MILWAUKEE, WI 53206
CURRENT OCCUPANT	2661 N 18TH ST	MILWAUKEE, WI 53206
CURRENT OCCUPANT	1823 W CENTER ST	MILWAUKEE, WI 53206
CURRENT OCCUPANT	1817A W CENTER ST	MILWAUKEE, WI 53206
CURRENT OCCUPANT	1819 W CENTER ST	MILWAUKEE, WI 53206
CURRENT OCCUPANT	2659 N 19TH ST	MILWAUKEE, WI 53206
CURRENT OCCUPANT	1917 W CENTER ST	MILWAUKEE, WI 53206
CURRENT OCCUPANT	1712 W CENTER ST	MILWAUKEE, WI 53206
CURRENT OCCUPANT	2723 N 17TH ST	MILWAUKEE, WI 53206
CURRENT OCCUPANT	2729 N 17TH ST	MILWAUKEE, WI 53206
CURRENT OCCUPANT	2731 N 17TH ST	MILWAUKEE, WI 53206
CURRENT OCCUPANT	2718 N 19TH ST	MILWAUKEE, WI 53206
CURRENT OCCUPANT	2716 N 19TH ST	MILWAUKEE, WI 53206
CURRENT OCCUPANT	1706 W CENTER ST	MILWAUKEE, WI 53206
CURRENT OCCUPANT	1721 W CENTER ST	MILWAUKEE, WI 53206
CURRENT OCCUPANT	2838 N 15TH ST	MILWAUKEE, WI 53206
CURRENT OCCUPANT	2842 N 15TH ST	MILWAUKEE, WI 53206
CURRENT OCCUPANT	1723 W CENTER ST	MILWAUKEE, WI 53206
CURRENT OCCUPANT	2729 N 18TH ST	MILWAUKEE, WI 53206
CURRENT OCCUPANT	2731 N 18TH ST	MILWAUKEE, WI 53206
CURRENT OCCUPANT	2740A N 18TH ST	MILWAUKEE, WI 53206
CURRENT OCCUPANT	1818A W CENTER ST	MILWAUKEE, WI 53206
CURRENT OCCUPANT	1708 W CENTER ST	MILWAUKEE, WI 53206
CURRENT OCCUPANT	2729A N 17TH ST	MILWAUKEE, WI 53206
CURRENT OCCUPANT	2732 N 18TH ST	MILWAUKEE, WI 53206
CURRENT OCCUPANT	2734 N 18TH ST	MILWAUKEE, WI 53206

CURRENT OCCUPANT	2737 N 18TH ST	MILWAUKEE, WI 53206
CURRENT OCCUPANT	1919 W CENTER ST	MILWAUKEE, WI 53206
CURRENT OCCUPANT	2846 N 15TH ST	MILWAUKEE, WI 53206
CURRENT OCCUPANT	1702 W CENTER ST	MILWAUKEE, WI 53206
CURRENT OCCUPANT	2724 N 18TH ST	MILWAUKEE, WI 53206
CURRENT OCCUPANT	2740 N 18TH ST	MILWAUKEE, WI 53206
CURRENT OCCUPANT	2736A N 19TH ST	MILWAUKEE, WI 53206
CURRENT OCCUPANT	1722 W CENTER ST	MILWAUKEE, WI 53206
CURRENT OCCUPANT	2724 N 19TH ST	MILWAUKEE, WI 53206
CURRENT OCCUPANT	2726 N 19TH ST	MILWAUKEE, WI 53206

Total Records: 56

Radius: 250.0 feet and Center of Circle: 1802 W Center St

2018-2019 Plan of Operation for 1802 W CENTER ST

1. Litter & Security Plans

How are the grounds kept clean? ☒ Sweep ☐ Pressure Wash ☒ Pick Up Litter ☐ Other:

How often will grounds be cleaned? ☒ Daily ☐ Weekly ☐ Other:

Who cleans the grounds? ☒ Licensee ☐ Building Owner ☐ Employees ☐ Hired Maintenance ☐ Other:

How are noise issues prevented and/or addressed? ☐ Security ☒ Manager approaches customer(s) ☐ Call Police ☒ Signs Posted ☐ Other:

Are there designated outdoor smoking areas? ☒ No ☐ Yes If Yes, Describe:

Number of garbage cans: Inside 3 Locations: Front door, back room behind the counter
Outside 1 Locations: Front of the store

Is a crowd control barrier used? ☒ No ☐ Yes If Yes, Describe:

Number of restrooms: one Name of solid waste contractor: Eagle Disposal

Are there parking spaces on the premises? ☒ No ☐ Yes If Yes, list number of spaces: _____ and describe security plans:

Are there designated loading areas? ☒ No ☐ Yes If Yes, describe security plans:

Do you have security personnel on the premise? ☒ No ☐ Yes If Yes, how many? _____

AND What are their responsibilities? _____

What security equipment do they use? _____

List their licensing, certification or training credentials: _____

Are there security cameras? ☐ No ☒ Yes If Yes, list all locations: 7 inside the store 2 outside

Are searches and/or identification checks conducted upon entry? ☐ No ☐ Yes If Yes, describe:

2. Percentage of Sales (must total 100%)

Alcohol 20 % Food Sales 55 % Entertainment _____ % Other 25 %

3. Businesses On The Premises (choose all that apply):

☐ Restaurant ☐ Cafe/Coffee Shop ☐ Cocktail Lounge ☒ Convenience Store ☐ Night Club ☐ Liquor Store ☐ Tavern ☐ Sports Facility
☐ Hotel ☐ Banquet Hall ☐ Supermarket ☐ Private/Fraternal/Veterans' Club ☐ Other:

4. Hours of Operation and Age Restriction

Are there any changes to the current hours of operation or age restriction? ☒ No ☐ Yes If Yes, Describe:

Please Note: If you will be open earlier or later than the hours listed on your current license for even one event or holiday (for example, St. Patrick's Day, Brewers Opening Day, etc.) during the license period, this must be reported and printed on your license.
Your hours of operation and age restriction are listed on your current license.

5. Floor Plan and Capacity

Are you requesting any changes to the floor plan or capacity? ☒ No ☐ Yes If Yes, Describe:

If requesting changes to the floor plan, submit a new floor plan with this application. Changes in floor plan include changing the location of tables, games, etc. within your current licensed premises. If your changes include adding any additional areas or square footage to your premises, or any renovations to the building will be done, a Permanent Extension of Premises application must be filed.

6. Sidewalk Dining: Fee

Are there any changes to the sidewalk dining site plan? ☒ No ☐ Yes If Yes, submit an updated site plan with this application.

7. Food License: FOOD 7770 Fee: \$300.00

Your current food license includes the following food operations: No Processing, Hazardous Foods, Sales \$20,001 - \$200,000, Convenience, Food Store. Are there any changes to your food operations as listed above? ☒ No ☐ Yes, if Yes, explain _____

8. Weights and Measures: Fee:

Number/Type of Devices:
Are there any changes to the number or types of devices? ☐ No ☐ Yes
If yes, contact our office for further instructions.



**CITY OF MILWAUKEE
OFFICE OF THE CITY CLERK**

Thursday, May 03, 2018

COMMITTEE MEETING NOTICE

AD 15

MC ROBERTS, Christine R, Agent
MC BOB'S PUB & GRILL, INC
4919 W NORTH Av

MILWAUKEE, WI 53208

You are requested to attend a hearing which is to be held in Room 301-B, Third Floor, City Hall on:

Tuesday, May 15, 2018 at 01:15 PM

Regarding: Your Class B Tavern, Food Dealer, and Public Entertainment Premises License Renewal Applications as agent for "MC BOB'S PUB & GRILL, INC" for "MC BOB'S PUB & GRILL" at 4919 W NORTH Av.

There is a possibility that your application may be denied for one or more of the following reasons: The recommendation of the committee regarding the application shall be based on evidence presented at the hearing. Per MCO 85-4-4, unless otherwise specified in the code, probative evidence concerning non-renewal, suspension or revocation may include evidence of the following: failure of the applicant to meet municipal qualifications, pending charges against or the conviction of any felony, misdemeanor, municipal offense or other offense, the circumstances of which substantially relate to the circumstances of the particular licensed or permitted activity, by the applicant or by any employee or other agent of the applicant. If the activities of the applicant involve a licensed premises, whether the premises tends to facilitate a public or private nuisance or has been the source of congregations of persons which have resulted in any of the following: disturbance of the peace; illegal drug activity; public drunkenness; drinking in public; harassment of passers-by; gambling; prostitution; sale of stolen goods; public urination; theft; assaults; battery; acts of vandalism including graffiti, excessive littering, loitering, illegal parking, loud noise at times when the licensed premise is open for business; traffic violations; curfew violations; lewd conduct; display of materials harmful to minors, pursuant to s. 106-9.6; or any other factor which reasonably relates to the public health, safety and welfare, or failure to comply with the approved plan of operation. See attached police report or correspondence.

**Notice for applicants with
warrants or unpaid fines:**

Proof of warrant satisfaction or payment of fines must be submitted at the hearing on the above date and time. Failure to comply with this requirement may result in a delay of the granting/denial of your application.

Failure to appear at this meeting may result in the denial of your license. Individual applicants must appear only in person or by an attorney. Corporate or Limited Liability applicants must appear only by the agent designated on the application or by an attorney. Partnership applicants must appear by a partner listed on the application or by an attorney. If you wish to do so and at your own expense, you may be accompanied by an attorney of your choosing to represent you at this hearing.

You will be given an opportunity to speak on behalf of the application and to respond and challenge any charges or reasons given for the denial. No petitions can be accepted by the committee, unless the people who signed the petition are present at the committee hearing and willing to testify. You may present witnesses under oath and you may also confront and cross-examine opposing witnesses under oath. If you have difficulty with the English language, you should bring an interpreter with you, at your expense, so that you can answer questions and participate in your hearing.

You may examine the application file at this office during regular business hours prior to the hearing date. Inquiries regarding this matter may be directed to the person whose signature appears below.

Limited parking for persons attending meetings in City Hall is available at reduced rates (5 hour limit) at the Milwaukee Center on the southwest corner of East Kilbourn and North Water Street. Parking tickets must be validated in the first floor information booth in City Hall.

PLEASE NOTE: Upon reasonable notice, efforts will be made to accommodate the needs of disabled individuals through sign language interpreters or other auxiliary aids. For additional information or to request this service, contact the Council Services Division ADA Coordinator at (414) 286-2998, Fax - (414) 286-3456, TDD - (414) 286-2025.

JIM OWCZARSKI, CITY CLERK

BY:

Jessica Celella

License Division Manager

If you have questions regarding this notice, please contact the License Division at (414) 286-2238.

MILWAUKEE POLICE DEPARTMENT

LICENSE INVESTIGATION UNIT

CRIMINAL RECORD/ORDINANCE VIOLATION/INCIDENTS SYNOPSIS

DATE: 03/29/2018
LICENSE TYPE: BTAVN
NEW:
RENEWAL: X

No. 271858
Application Date: 03/28/2018
Expiration Date:

License Location: 4919 W North Avenue
Business Name: Mc Bob's Pub & Grill

Aldermanic District: 15

Licensee/Applicant: Mc Roberts, Christine R
(Last Name, First Name, MI)
Date of Birth: 05/09/59

Male:

Female:

Home Address: 2235 N 54th Street
City: Milwaukee
Home Phone: (414) 801-5462

State: Wi Zip Code: 53208

This report is written by Police Officer David NOVAK, assigned to the License Investigation Unit, Days.

The Milwaukee Police Department's investigation regarding this application revealed the following:

1. On 10/29/09 at 7:00 pm, Milwaukee police were dispatched to 4919 W North Avenue for a Trouble With Subject complaint. Police spoke to the manager Jacob Vianes who stated his bartender asked a patron to provide some ID and this upset the patron. The subject made threats and was refusing to leave however was gone once police arrived.

- =====
2. On 09/13/2016 officers were dispatched to Mc Bob's Pub & Grill, 4919 W. North Av for an Armed Robbery. The victim stated a subject she has known for 4 years pushed her against the wall and punched her in the face. The subject then went through her pockets removing property. The parties had been inside Mc Bob's just prior to the incident which occurred outside.

3. On 12/27/2016 officers were dispatched to Mc Bob's Pub & Grill, 4919 W. North Av for a Property Damage complaint. The bar manager, Samuel JOHNSON, stated there had been two subjects in the bar complaining about their food order. The subjects damaged part of the bar and fled the scene.

- =====
4. On 09/13/2017 at 9:30am officers investigated a theft complaint at 4919 W. North Av. A subject went into Mc Bob's and ordered \$40.10 worth of food and exited without paying for the items. The subject was located and arrested.

5. On 12/01/2017 at 3:05pm officers were dispatched to McBob's at 4919 W. North Av, for a fight. The applicant stated she was fixing something in the restroom when she was confronted by a female stating she was rude. When she got out of the restroom she was confronted by the subject and two other patrons causing her to fear for her safety. Another employee stepped in the middle and the three subjects pushed that employee. When the employee pushed back the three subjects began punching him. The three subjects were arrested and cited for Assault and Battery.
6. On 01/16/2018 at 9:43pm officers were dispatched to a trouble with subject at McBob's, 4919 W. North Av. The officers interviewed the bartender who stated they were having trouble with a subject and wanted him removed. The subject was outside when the officer arrived and he advised to leave and not return.

Citation No.	Case Number	Disposition	Judge	Date
			LICENSE INVESTIGATION UNIT	
		Received	<i>[Signature]</i>	
		Referred		
		By	<i>[Signature]</i>	

THIS REPORT WAS WRITTEN BY PO LIBRADO BRACERO, ASSIGNED TO DISTRICT THREE EARLY POWER SHIFT. ON WEDNESDAY SEPTEMBER 13, 2017 AT APPROXIMATELY 9:30AM LISTED SUBJECT JAMIKA J BRADFORD B/F 10/05/1993 WENT INTO MCBOB'S PUB AND GRILL LOCATED AT 4919 WEST NORTH AVE, ORDERED \$40.10 OF FOOD AND DRINK, THEN LEFT THE BUSINESS WITHOUT PAYING. SHE THEN WENT ACROSS THE STREET TO 4924 WEST NORTH AVE TO THE NAIL CENTRAL SALON AND HAD \$20.00 WORTH OF SERVICE THEN WALKED OUT WITHOUT PAYING FOR SERVICES. EMPLOYEES FROM BOTH BUSINESSES GAVE A GOOD DESCRIPTION OF BRADFORD, WHICH HELPED US IN LOCATING HER. BRADFORD WAS LOCATED WALKING WESTBOUND ON WEST NORTH AVE AT NORTH 51ST STREET, WHERE SHE WAS DETAINED THEN ARRESTED AND CONVEYED TO DISTRICT THREE FOR PROCESSING.

MILWAUKEE POLICE DEPARTMENT

REPORT OF INCIDENTS INVOLVING LICENSED PERSONS OR PREMISES

TO: Captain Shunta BOSTON-SMITH

Business Name: McBob' Pub & Grill

Address of Licensed Premises: 4919 W North Ave

Business Phone: 871-5050

Type of License: Class B Tavern, PEP

District: 3

☐ Violation / ☒ Incident # 173351713

Date of Incident: 12/01/2017

Licensee or Manager on premises at time of violation / Incident? ☒ Yes ☐ NoLicensee cooperative? ☒ Yes ☐ No (If no, explain in narrative section)

Licensee Notified by Officer: Devon WILLIAMS

Date: 12-01-17

Time: 4:30 P.M.

Licensee or Agent's Name: MCROBERTS, Christine R.
Home Address: 2235 N 54th St Milwaukee, WI 53208Date of Birth: 05/09/59
Home Phone: 801-5462Co-Licensee Name:
Home Address:
Class S License Number:Date of Birth:
Home Phone:Bartender Name:
Home Address:
Class D License Number:Date of Birth:
Home Phone:Licensed Person / Public Pass. Vehicle, etc.:
Home Address:
Class D License Number:Date of Birth:
Home Phone:**VIOLATION/INCIDENT – DESCRIBE FACTS AND CIRCUMSTANCES IN NARRATIVE SECTION**

Name of Person Cited: Hollis, Lois N

Citation Number: J9811R2KVL

Violation & Ord. / Statue No.: assault battery 105-2

Date of Birth: 11/17/1993
Court Date: 01/17/18

Name of Person Cited: Clements, Kierra A

Citation Number: J9811R2KVJ

Violation & Ord. / Statue No.: Juv assault battery 105-2

Date of Birth: 02/16/2001
Court Date: 01/16/18

Name of Person Cited: Irving, Tyrese J

Citation Number: J9811R2KVP

Violation & Ord. / Statue No.: Obstructing 105-138

Date of Birth: 07/19/1996
Court Date: 01/17/18

Name of Person Cited: Clements, Keshana A

Citation Number: J9811R2KVM

Violation & Ord. / Statue No.: assault battery 105-2

Date of Birth: 12/12/1996
Court Date: 01/17/18

Name of Person Cited:

Citation Number:



Violation & Ord. / Statue No.:

Date of Birth:
Court Date:

Investigating Officer: Devon Williams

District / Bureau: MILWPD 3

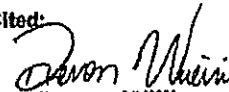
Date: 12/01/2017



 Commanding Officer

 12/7/17
 Date
DISPOSITION – FOR LICENSING ONLY INVESTIGATION UNIT

Citation No.	Case Number	Disposition	Received	Judge	Date
		Referred			
		By			

PA-33E Narrative

This report is written by P.O. Stephen DOMBROWSKI assigned to District #3, Early Shift. On Friday 12-01-17 at 3:05 P.M., P.O. WILLIAMS, P.O. LEE, P.O. GALLENBERG and I were dispatched to 4919 W North Ave for a fight. This is located in the City and County of Milwaukee, State of Wisconsin. Upon arrival it was a chaotic scene with a lot of yelling outside Mcbobs Tavern at 4919 W North Ave. I spoke to the victim/Mcbobs employee Steve J SCHMICH (w/m, 02-02-56) who stated that he was downstairs the basement when a waitress came down to tell him that another employee Christine R MCROBERTS (w/f, 05-09-59) was being confronted by some patrons and things are about to get physical. SCHMICH stated he went upstairs and observed three females yelling at MCROBERTS and they were very close to her. These females were identified as Lois N HOLLIS (b/f, 11-17-93), Kierra A CLEMENTS (b/f, 02-16-01) and Keshana A CLEMENTS (b/f, 12-12-96). SCHMICH stated he got in-between the parties as the three females were yelling obscenities towards MCROBERTS. SCHMICH stated he was chest bumped by one of the females, but could not remember which one it was so he pushed that same person back and everyone started fighting. SCHMICH stated he was intentionally punched to the head and face several times during the bar fight by all three females causing pain and wished to press charges. On video surveillance I observed Keshana CLEMENTS, Lois HOLLIS and Kierra CLEMENTS all punching SCHMICH during the bar fight. The video showed a chaotic scene with a lot of people in a group and several people falling down. All three females were taken into custody and conveyed to District #3 for processing where they were cited and released with a future court date. Outside the tavern more family showed up. One person identified as Tyrese J IRVING (b/m, 07-19-96) was ordered several times by uniformed police officers to leave the scene so we could conduct an investigation, but he failed to comply with our lawful order. IRVING was taken into custody and conveyed to District #3 for a citation and released with a future court date. MCROBERTS stated she was trying to fix something in the woman's bathroom when she was approached by a female later determined to be Kierra CLEMENTS. MCROBERTS stated the juvenile was telling her how disrespectful her wait staff was and MCROBERTS said she told Kierra how disrespectful she was being. MCROBERTS stated she left the bathroom and was then confronted by Kierra, Lois HOLLIS and Keshana CLEMENTS. MCROBERTS stated all three females were getting in her face and saying how disrespectful she was to their little sister, whom MCROBERTS did not know was a juvenile due to her height and appearance of an older female. MCROBERTS stated she felt threatened by all three females who were close to her and she feared she would be assaulted. MCROBERTS stated SCHMICH arrived from downstairs and got in the middle. MCROBERTS stated the females would not listen and kept swearing and making threats to do bodily harm to them. MCROBERTS stated SCHMICH was pushed by one of the females whom she believed was Kierra and SCHMICH pushed her back and then Keshana punched SCHMICH and then the other two females started punching him near the bar as SCHMICH was trying to restrain Keshana. SCHMICH stated they were all told to leave prior to any physical altercation, but they would not leave. The three females who were arrested deny any pushing to SCHMICH.

MILWAUKEE POLICE DEPARTMENT

REPORT OF INCIDENTS INVOLVING LICENSED PERSONS OR PREMISES

TO: Captain Shunta BOSTON-SMITH

Business Name: McBob's Pub & Grill

Address of Licensed Premises: 4919 W North Ave

Business Phone: 871-5050

Type of License: Class B Tavern, PEP

District: 3

☐ Violation / ☐ Incident # CAD#180163229

Date of Incident: 01-16-18

Licensee or Manager on premises at time of violation / incident? ☐ Yes ☒ NoLicensee cooperative? ☒ Yes ☐ No (if no, explain in narrative section)

Licensee Notified by Officer:

Date:

Time:

Licensee or Agent's Name: MCROBERTS, Christine R.

Home Address: 2235 N 54th St Milwaukee, WI 53208

Date of Birth: 05/09/59

Home Phone: 801-5462

Co-Licensee Name:

Home Address:

Class S License Number:

Date of Birth:

Home Phone:

Bartender Name:

Home Address:

Class D License Number:

Date of Birth:

Home Phone:

Licensed Person / Public Pass. Vehicle, etc.:

Home Address:

Class D License Number:

Date of Birth:

Home Phone:

VIOLATION/INCIDENT - DESCRIBE FACTS AND CIRCUMSTANCES IN NARRATIVE SECTION

Name of Person Cited:

Citation Number:

Violation & Ord. / Statue No.:

Date of Birth:

Court Date:

Name of Person Cited:

Citation Number:

Violation & Ord. / Statue No.:

Date of Birth:

Court Date:

Name of Person Cited:

Citation Number:

Violation & Ord. / Statue No.:

Date of Birth:

Court Date:

Name of Person Cited:

Citation Number:

Violation & Ord. / Statue No.:

Date of Birth:

Court Date:

Name of Person Cited:

Citation Number:

Violation & Ord. / Statue No.:

Date of Birth:

Court Date:

Investigating Officer: Police Officer Ethan SCHLAX

District / Bureau: 32

Date: 03-16-18



Commanding Officer

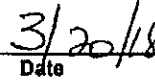

Date
DISPOSITION - FOR LICENSING ONLY

Citation No.	Case Number	Disposition	Judge	Date

LICENSE INVESTIGATION UNIT

Received

3-21-18

Referred

By



PA-33E Narrative

This report is written by Police Officer Ethan SCHLAX, assigned to District 3, Early Shift.

On Tuesday, January 16, 2018, at approximately 9:43 PM, squad 3220 (PO Tammy TONDU and I) and squad 3257 (PO Stephen DOMBROWSKI and PO Dennis RYAN) were dispatched to 4919 W. North Ave. for a Trouble with Subject complaint. This location is McBob's Pub and Grill and is located in the City and County of Milwaukee, Wisconsin.

Upon arrival, we observed a black male with a black hat and a black coat standing outside of the location. This person matched the description given by the caller. PO DOMBROWSKI and PO RYAN stayed with this subject while PO TONDU and I went in to the location to confirm if that was the subject that they wanted removed. PO TONDU spoke with the bartender who did confirm that the subject outside was the person they were having trouble with and wanted removed from the location. PO DOMBROWSKI and PO RYAN identified the subject as Dewey A. QUALLS (b/m, 08-04-69). A wanted check revealed that QUALLS did not have any warrants out for his arrest. QUALLS was advised to leave the location and that he was not welcome back. QUALLS then left the location without incident.

End of Report.

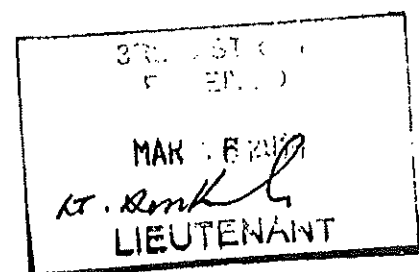



Thursday, May 03, 2018



Notice of Public Hearing

MC ROBERTS, Christine R, Agent
MC BOB'S PUB & GRILL at 4919 W NORTH Av
Class B Tavern, Food Dealer, and Public Entertainment Premises License Renewal Applications

Tuesday, May 15, 2018 at 1:15 PM

To whom it may concern:

The above application has been made by the above named applicant(s). This requires approval from the Licenses Committee and the Common Council of the City of Milwaukee. The hearing before the Licenses Committee will take place on 5/15/2018 at 1:15 PM, in Room 301-B, Third Floor, City Hall. If you wish, you may provide testimony at the hearing regarding the request; see below for further information. You are not required to attend the hearing. Once the Licenses Committee makes its recommendation, this recommendation is forwarded to the full Common Council for approval at its next regularly scheduled hearing. Please review the information below and if you have further questions regarding this process, please contact the License Division at (414) 286-2238.

Important details for those wishing to provide information for the Licenses Committee to consider when making its recommendation:

1. The license application is scheduled to be heard at the above time. Due to other hearings running longer than scheduled, you may have to wait some time to provide your testimony.
2. You must appear in person and testify as to matters that you have personally experienced or seen. (You cannot provide testimony for your neighbor, parent or anyone else; this is considered hearsay and cannot be considered by the committee.)
3. No letters or petitions can be accepted by the committee (unless the person who wrote the letter or the persons who signed the petition are present at the committee hearing and willing to testify).
4. Persons opposed to the license application are given the opportunity to testify first; supporters may testify after the opponents have finished.
5. When you are called to testify, you will be sworn in and asked to give your name, and address. (If your first and/or last names are uncommon please spell them.)
6. You may then provide testimony.
 - a. Include only information relating to the above license application.
 - b. Include only information you have personally witnessed or seen.
 - c. Provide concise and relevant information detailing how this business has affected or may affect the peaceful enjoyment of your neighborhood.
 - d. If by the time you have the opportunity to testify, the information you wish to share has already been provided to the committee, you may state that you agree with the previous testimony. Redundant or repetitive testimony will not assist the committee in making its recommendation.
7. After giving your testimony, the members of the Licenses Committee and the licensee may ask questions regarding the testimony you have given or other factors relating to the license application.
8. Business Competition is not a valid basis for denial or non-renewal of a license.
Please Note: If you have submitted an objection to the above application your objection cannot be considered by the committee unless you personally testify at the hearing.

OCCUPANT	MAIL ADDRESS	CITY, STATE ZIP
CURRENT OCCUPANT	2240 N 49TH ST	MILWAUKEE, WI 53208
CURRENT OCCUPANT	2225A N HI MOUNT BLVD	MILWAUKEE, WI 53208
CURRENT OCCUPANT	5009 W NORTH AVE 2	MILWAUKEE, WI 53208
CURRENT OCCUPANT	2254 N HI MOUNT BLVD	MILWAUKEE, WI 53208
CURRENT OCCUPANT	2250 N HI MOUNT BLVD	MILWAUKEE, WI 53208
CURRENT OCCUPANT	2236 N HI MOUNT BLVD	MILWAUKEE, WI 53208
CURRENT OCCUPANT	2229 N 49TH ST	MILWAUKEE, WI 53208
CURRENT OCCUPANT	2230 N 49TH ST	MILWAUKEE, WI 53208
CURRENT OCCUPANT	2234 N 49TH ST	MILWAUKEE, WI 53208
CURRENT OCCUPANT	5009 W NORTH AVE 4	MILWAUKEE, WI 53208
CURRENT OCCUPANT	2245 N HI MOUNT BLVD	MILWAUKEE, WI 53208
CURRENT OCCUPANT	2247 N HI MOUNT BLVD	MILWAUKEE, WI 53208
CURRENT OCCUPANT	2230 N HI MOUNT BLVD	MILWAUKEE, WI 53208
CURRENT OCCUPANT	2237 N 49TH ST	MILWAUKEE, WI 53208
CURRENT OCCUPANT	2236 N 49TH ST	MILWAUKEE, WI 53208
CURRENT OCCUPANT	2246 N 49TH ST	MILWAUKEE, WI 53208
CURRENT OCCUPANT	2237 N HI MOUNT BLVD	MILWAUKEE, WI 53208
CURRENT OCCUPANT	2218 N HI MOUNT BLVD	MILWAUKEE, WI 53208
CURRENT OCCUPANT	2212 N HI MOUNT BLVD	MILWAUKEE, WI 53208
CURRENT OCCUPANT	2214 N HI MOUNT BLVD	MILWAUKEE, WI 53208
CURRENT OCCUPANT	2222 N 49TH ST	MILWAUKEE, WI 53208
CURRENT OCCUPANT	2228 N 49TH ST	MILWAUKEE, WI 53208
CURRENT OCCUPANT	2241 N 49TH ST	MILWAUKEE, WI 53208
CURRENT OCCUPANT	2251 N 49TH ST	MILWAUKEE, WI 53208
CURRENT OCCUPANT	2225 N HI MOUNT BLVD	MILWAUKEE, WI 53208
CURRENT OCCUPANT	2240 N HI MOUNT BLVD	MILWAUKEE, WI 53208
CURRENT OCCUPANT	2206 N HI MOUNT BLVD	MILWAUKEE, WI 53208
CURRENT OCCUPANT	2225 N 49TH ST	MILWAUKEE, WI 53208
CURRENT OCCUPANT	2243 N HI MOUNT BLVD	MILWAUKEE, WI 53208
CURRENT OCCUPANT	2220 N HI MOUNT BLVD	MILWAUKEE, WI 53208
CURRENT OCCUPANT	2215 N 49TH ST	MILWAUKEE, WI 53208
CURRENT OCCUPANT	2238 N 49TH ST	MILWAUKEE, WI 53208
CURRENT OCCUPANT	2257 N 49TH ST	MILWAUKEE, WI 53208
CURRENT OCCUPANT	2252 N HI MOUNT BLVD	MILWAUKEE, WI 53208
CURRENT OCCUPANT	2248 N HI MOUNT BLVD	MILWAUKEE, WI 53208
CURRENT OCCUPANT	2242 N HI MOUNT BLVD	MILWAUKEE, WI 53208
CURRENT OCCUPANT	2222 N HI MOUNT BLVD	MILWAUKEE, WI 53208
CURRENT OCCUPANT	2208 N HI MOUNT BLVD	MILWAUKEE, WI 53208
CURRENT OCCUPANT	2224 N 49TH ST	MILWAUKEE, WI 53208
CURRENT OCCUPANT	2247 N 49TH ST	MILWAUKEE, WI 53208
CURRENT OCCUPANT	2244 N 49TH ST	MILWAUKEE, WI 53208
CURRENT OCCUPANT	2231 N HI MOUNT BLVD	MILWAUKEE, WI 53208
CURRENT OCCUPANT	5009 W NORTH AVE 1	MILWAUKEE, WI 53208
CURRENT OCCUPANT	5009 W NORTH AVE 3	MILWAUKEE, WI 53208
CURRENT OCCUPANT	2221 N 49TH ST	MILWAUKEE, WI 53208

Total Records: 45

Radius: 250.0 feet and Center of Circle: 4919 W North Av

2018-2019 Plan of Operation for 4919 W NORTH AV

1. Litter & Security Plans

How are the grounds kept clean? ☒ Sweep ☐ Pressure Wash ☐ Pick Up Litter ☐ Other:

How often will grounds be cleaned? ☒ Daily ☐ Weekly ☐ Other:

Who cleans the grounds? ☒ Licensee ☐ Building Owner ☐ Employees ☒ Hired Maintenance ☐ Other:

How are noise issues prevented and/or addressed? ☐ Security ☒ Manager approaches customer(s) ☐ Call Police ☐ Signs Posted ☐ Other:

Are there designated outdoor smoking areas? ☐ No ☒ Yes If Yes, Describe: BACK PATIO

Number of garbage cans: Inside 4 Locations: FRONT BAR BACK KITCHEN
Outside 1 Locations: BACK PATIO

Is a crowd control barrier used? ☒ No ☐ Yes If Yes, Describe:

Number of restrooms: 8 Name of solid waste contractor: EAGLE

Are there parking spaces on the premises? ☐ No ☒ Yes If Yes, list number of spaces: 16 and describe security plans: CAMERAS

Are there designated loading areas? ☐ No ☒ Yes If Yes, describe security plans:

Do you have security personnel on the premise? ☒ No ☐ Yes If Yes, how many? _____

AND What are their responsibilities? _____

What security equipment do they use? _____

List their licensing, certification or training credentials: _____

Are there security cameras? ☐ No ☒ Yes If Yes, list all locations: FRONT - BACK - PATIO

Are searches and/or identification checks conducted upon entry? ☒ No ☐ Yes If Yes, describe:

2. Percentage of Sales (must total 100%)

Alcohol 35 % Food Sales 65 % Entertainment _____ % Other _____ %

3. Businesses On The Premises (choose all that apply):

☒ Restaurant ☐ Cafe/Coffee Shop ☐ Cocktail Lounge ☐ Convenience Store ☐ Night Club ☐ Liquor Store ☐ Tavern ☐ Sports Facility
☐ Hotel ☐ Banquet Hall ☐ Supermarket ☐ Private/Fraternal/Veterans' Club ☐ Other:

4. Hours of Operation and Age Restriction

Are there any changes to the current hours of operation or age restriction? ☒ No ☐ Yes If Yes, Describe:

Please Note: If you will be open earlier or later than the hours listed on your current license for even one event or holiday (for example, St. Patrick's Day, Brewers Opening Day, etc.) during the license period, this must be reported and printed on your license.

Your hours of operation and age restriction are listed on your current license.

5. Floor Plan and Capacity

Are you requesting any changes to the floor plan or capacity? ☒ No ☐ Yes If Yes, Describe:

If requesting changes to the floor plan, submit a new floor plan with this application. Changes in floor plan include changing the location of tables, games, etc. within your current licensed premises. If your changes include adding any additional areas or square footage to your premises, or any renovations to the building will be done, a Permanent Extension of Premises application must be filed.

6. Sidewalk Dining: Fee:

Are there any changes to the sidewalk dining site plan? ☒ No ☐ Yes If Yes, submit an updated site plan with this application.

7. Food License: FREST 9587 Fee: \$1,250.00

Your current food license includes the following food operations: DHS - COMPLEX, Sales \$200,001 - \$2,000,000, Tavern Restaurant. Are there any changes to your food operations as listed above? ☒ No ☐ Yes, if Yes, explain _____

8. Weights and Measures: Fee:

Number/Type of Devices:
Are there any changes to the number or types of devices? ☐ No ☐ Yes
If yes, contact our office for further instructions.

1. CURRENT APPROVED ENTERTAINMENT

The following types of entertainment have been approved for your current Public Entertainment Premises license:

Jukebox, Instrumental Musicians, Bands, 2 Amusement Machines

2. ADDING ENTERTAINMENT

If applicable, check any entertainment you wish to add: **ONLY CHECK ENTERTAINMENT TYPE(S) YOU ARE ADDING. YOUR CURRENT APPROVED ENTERTAINMENT IS LISTED ABOVE.**

- | | | | |
|---|---|--|--|
| <input type="checkbox"/> Instrumental Musicians | <input type="checkbox"/> Bands | <input type="checkbox"/> Battle of the Bands | <input type="checkbox"/> Comedy Acts |
| <input type="checkbox"/> Disc Jockey | <input type="checkbox"/> Magic Shows | <input type="checkbox"/> Poetry Readings | <input type="checkbox"/> Dancing by Performers |
| <input type="checkbox"/> Jukebox | <input type="checkbox"/> Wrestling | <input type="checkbox"/> Patron Contests | <input type="checkbox"/> Patrons Dancing |
| <input type="checkbox"/> Adult Entertainment/
Strippers/Erotic Dance | <input type="checkbox"/> Karaoke | <input type="checkbox"/> Bowling Alley | <input type="checkbox"/> Pool Tables |
| <input type="checkbox"/> Motion Pictures | <input type="checkbox"/> Amusement Machines — | How many? _____ | How many? _____ |
| How many screens? _____ | How many? _____ | <input type="checkbox"/> Concerts | <input type="checkbox"/> Theatrical Performances |
| | | Approx. # per year? _____ | Approx. # per year? _____ |
| <input type="checkbox"/> Other: _____ | | | |

No entertainment changes can take place until approved by Common Council and a new license has been issued and posted on the premises.

3. REMOVING ENTERTAINMENT

If applicable, list any entertainment you wish to remove:

4. PROMOTERS/SOUND AMPLIFICATION

Will promoters ever be used for any of the entertainment? ☒ No ☐ Yes If Yes, Describe:

At any time will sound amplification be used? ☒ No ☐ Yes If Yes, Describe:

5. NOTARIZED SIGNATURE

I understand that after the license has been issued, a change to the plan of operation will require a written request to change and approval from the Common Council.

I agree to inform the City Clerk within 10 days of any substantial changes in the information supplied in this application.

I understand that I shall not willfully refuse to provide the services offered under this license, or add charges or require deposits not required of the general public because of race, color, sex, religion, national origin or ancestry, age, handicap, lawful source of income, marital status, sexual orientation, gender identity or expression, familial status or the fact that a person is now or has been a member of the military service, whether dressed in uniform or not; and shall not seek such information as a condition of employment, or penalize any employee or discriminate in the selection of personnel for training or promotion on the basis of such information.

I have knowledge of the City Ordinances currently regulating public entertainment, and understand that the license may be subject to suspension, non-renewal or revocation, if I violate any rule, law or regulation of the city of Milwaukee and State of Wisconsin.

SUBSCRIBED AND SWORN TO BEFORE ME

This 28th day of May, 20

(Clerk/Notary Public)

My Commission Expires

*Notary Seal must be affixed.

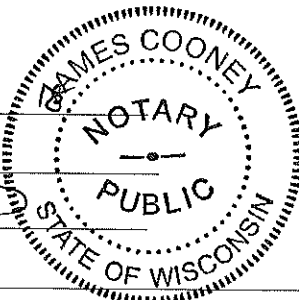

Sole Proprietor, a Partner, or if a Corporation or LLC, the Agent must sign