



Certificate of Appropriateness

Milwaukee Historic Preservation Commission/200 E. Wells Street/Milwaukee, WI 53202/phone 414-286-5712/fax 414-286-3004

Property 1401 E. BRADY ST. Brady Street Historic Distr
Description of work Install permanent shed roof over previously approved semi-mobile outdoor bar in lot facing N. Warren Avenue. Remove some existing fence and replace with one-hour fire-rated wall. Wall will be L-shaped and extend 2'3" south from corner of Nomad building and then extend 7'2 5/8" east at a height of 17'6". Wall will be clad in cedar lap siding and painted. Construct per attached drawings.
Date issued 6/14/2017 PTS ID 114281 COA: Bar canopy and fire-rated wall

In accordance with the provisions of Section 320-21 (11) and (12) of the Milwaukee Code of Ordinances, the Milwaukee Historic Preservation Commission has issued a certificate of appropriateness for the work listed above. The work was found to be consistent with preservation guidelines. The following conditions apply to this certificate of appropriateness:

Any pressure-treated wood used in construction must be hidden by rotating it such that indentations are not visible to the public and it must be painted.

All work must be done in a craftsman-like manner, and must be completed within one year of the date this certificate was issued. Staff must approve any changes or additions to this certificate before work begins. Work that is not completed in accordance with this certificate may be subject to correction orders or citations. If you require technical assistance, please contact Tim Askin of the Historic Preservation staff as follows: Phone: (414) 286-5712 E-mail: HPC@milwaukee.gov.

If permits are required, you are responsible for obtaining them from the Milwaukee Development Center. If you have questions about permit requirements, please consult the Development Center's web site, www.milwaukee.gov/build, or call (414) 286-8210.

City of Milwaukee Historic Preservation Staff

Copies to: Development Center, Ald. Nik Kovac, Contractor, Inspector John Cunningham (286-2538)

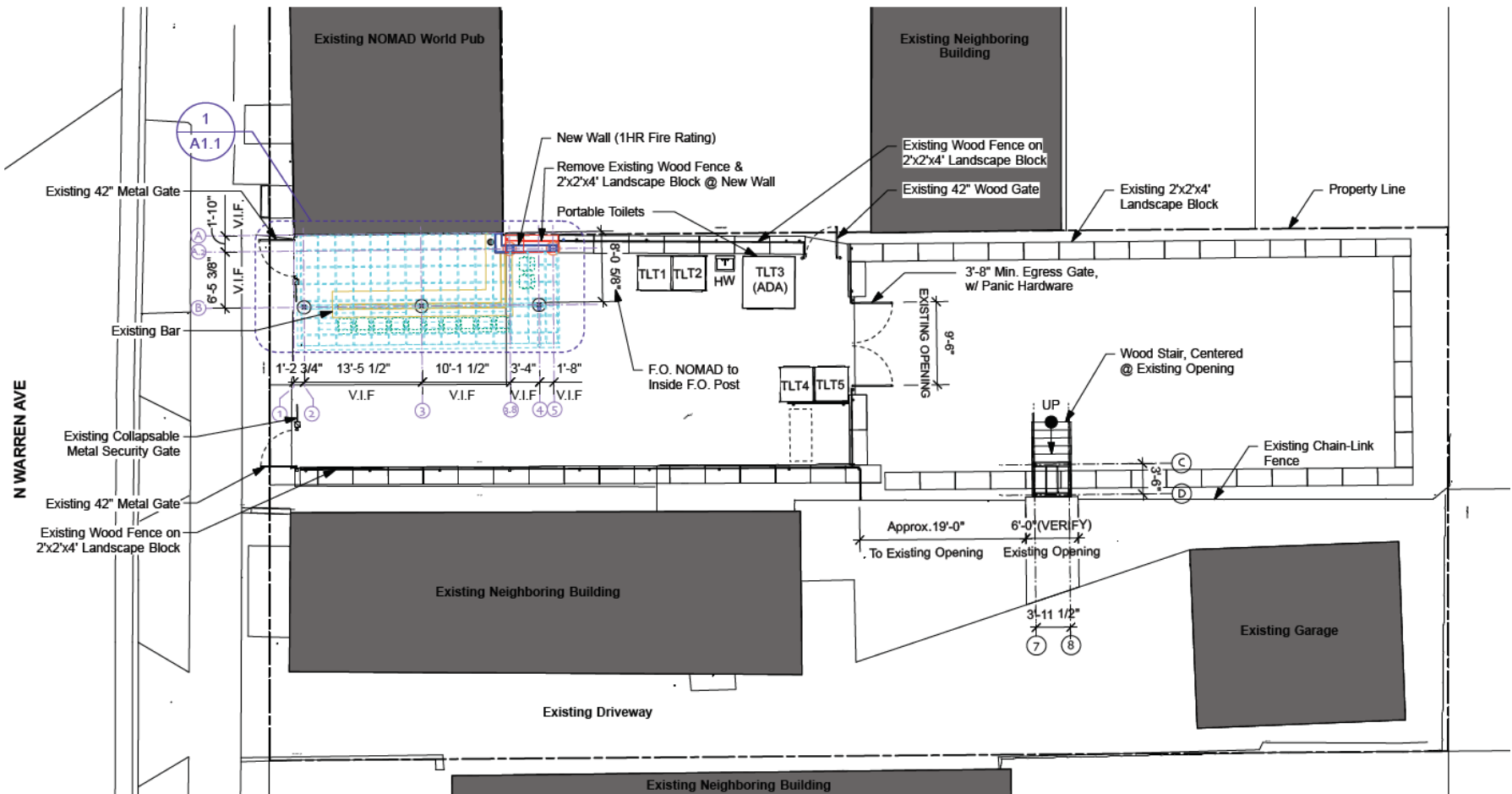

1
A1.0 **SITE PLAN**
Scale: 3/32" = 1'-0"





1 **BACK BAR CANOPY - FROM WARREN AVE (LOOKING EAST)**



1 **BACK BAR CANOPY - FROM BEERGARDEN (LOOKING WEST)**



From E. Warren Ave, Looking East



From E. Warren Ave, Looking East

Existing conditions