



Certificate of Appropriateness

Milwaukee Historic Preservation Commission/200 E. Wells Street/Milwaukee, WI 53202/phone 414-286-5712/fax 414-286-3004

Property

2925 W. STATE ST. Concordia Historic District

Description of work

1. Prune various trees as needed. Install mulch around around pruned trees.
2. Remove various trees around property, primarily from the front entrance area. These include arborvitae, invasive Norway maple, volunteer ash tree, and a mulberry. Grind stumps.
3. Plant 5 rosebushes, 5 arrowwood viburnum, 1 Chalet Swiss Stone Pine, 2 Bluepoint upright junipers, and variues lilies in existing and new planting beds per site diagram. Some will be used to screen an existing A/C unit.

Date issued

5/5/2017

PTS ID 114270 COA: landscaping

In accordance with the provisions of Section 320-21 (11) and (12) of the Milwaukee Code of Ordinances, the Milwaukee Historic Preservation Commission has issued a certificate of appropriateness for the work listed above. The work was found to be consistent with preservation guidelines. The following conditions apply to this certificate of appropriateness: N/A

All work must be done in a craftsman-like manner, and must be completed within one year of the date this certificate was issued. Staff must approve any changes or additions to this certificate before work begins. Work that is not completed in accordance with this certificate may be subject to correction orders or citations. If you require technical assistance, please contact Tim Askin of the Historic Preservation staff as follows: Phone: (414) 286-5712 E-mail: HPC@milwaukee.gov.

If permits are required, you are responsible for obtaining them from the Milwaukee Development Center. If you have questions about permit requirements, please consult the Development Center's web site, city.milwaukee.gov/permits, or call (414) 286-8210.

City of Milwaukee Historic Preservation Staff

Copies to: Development Center, Ald. Robert Bauman, Contractor , Inspector Dave Pedersen (286-2540)



Current conditions, looking southwest



Current conditions, looking southeast

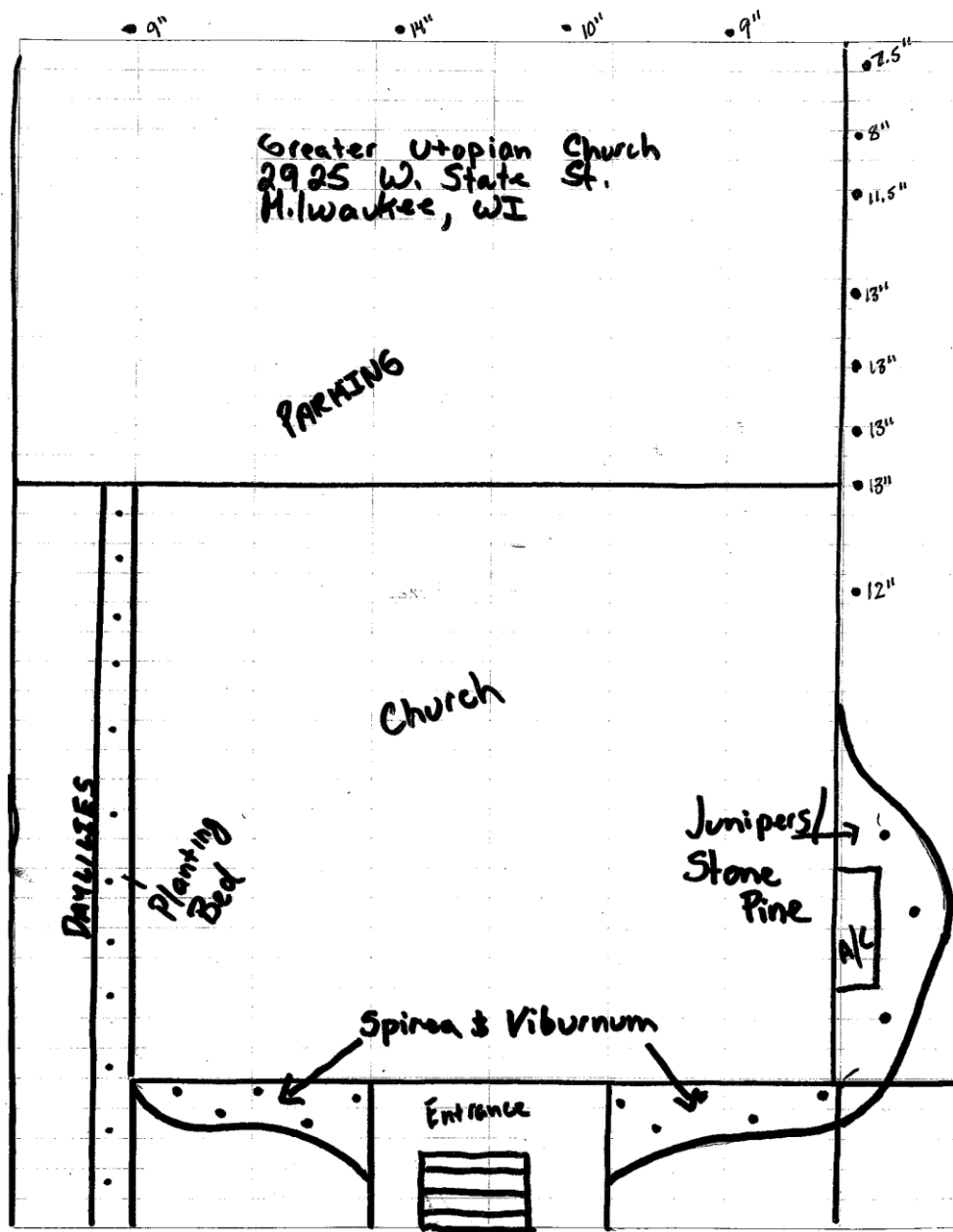

Approved landscaping plan