



# Certificate of Appropriateness

Milwaukee Historic Preservation Commission/200 E. Wells Street/Milwaukee, WI 53202/phone 414-286-5712/fax 414-286-3004

**Property** 3373 N. SHERMAN BL.

**Description of work** Construct 12'x 12' wooden deck in side yard, 35' behind fence, which is even with front of house.

**Date issued** 5/1/2017

PTS ID 114269 COA: side yard deck

In accordance with the provisions of Section 320-21 (11) and (12) of the Milwaukee Code of Ordinances, the Milwaukee Historic Preservation Commission has issued a certificate of appropriateness for the work listed above. The work was found to be consistent with preservation guidelines. The following conditions apply to this certificate of appropriateness:

Deck shall be designed as below, but with larger entrance area on north end. Balusters in the railing must be undermounted to top rail and may not be side mounted. All finish wood must be smooth and free of knots and must be painted or stained with an opaque stain upon completion. Vinyl railings are not permitted. Note: when new, bare wood is left exposed to the exterior elements for a period of only a week or two, the life of the paint job subsequently applied to it will be decreased. The use of a naturally decay-resistant wood species for exterior finish applications is highly recommended but not required.

All work must be done in a craftsman-like manner, and must be completed within one year of the date this certificate was issued. Staff must approve any changes or additions to this certificate before work begins. Work that is not completed in accordance with this certificate may be subject to correction orders or citations. If you require technical assistance, please contact Tim Askin of the Historic Preservation staff as follows: Phone: (414) 286-5712 E-mail: HPC@milwaukee.gov.

If permits are required, you are responsible for obtaining them from the Milwaukee Development Center. If you have questions about permit requirements, please consult the Development Center's web site [city.milwaukee.gov/permits](http://city.milwaukee.gov/permits), or call (414) 286-8210.

City of Milwaukee Historic Preservation Staff

Copies to: Development Center, Ald. Willie Wade, Contractor, Inspector Bob McInnes (286-2518)

Site plan

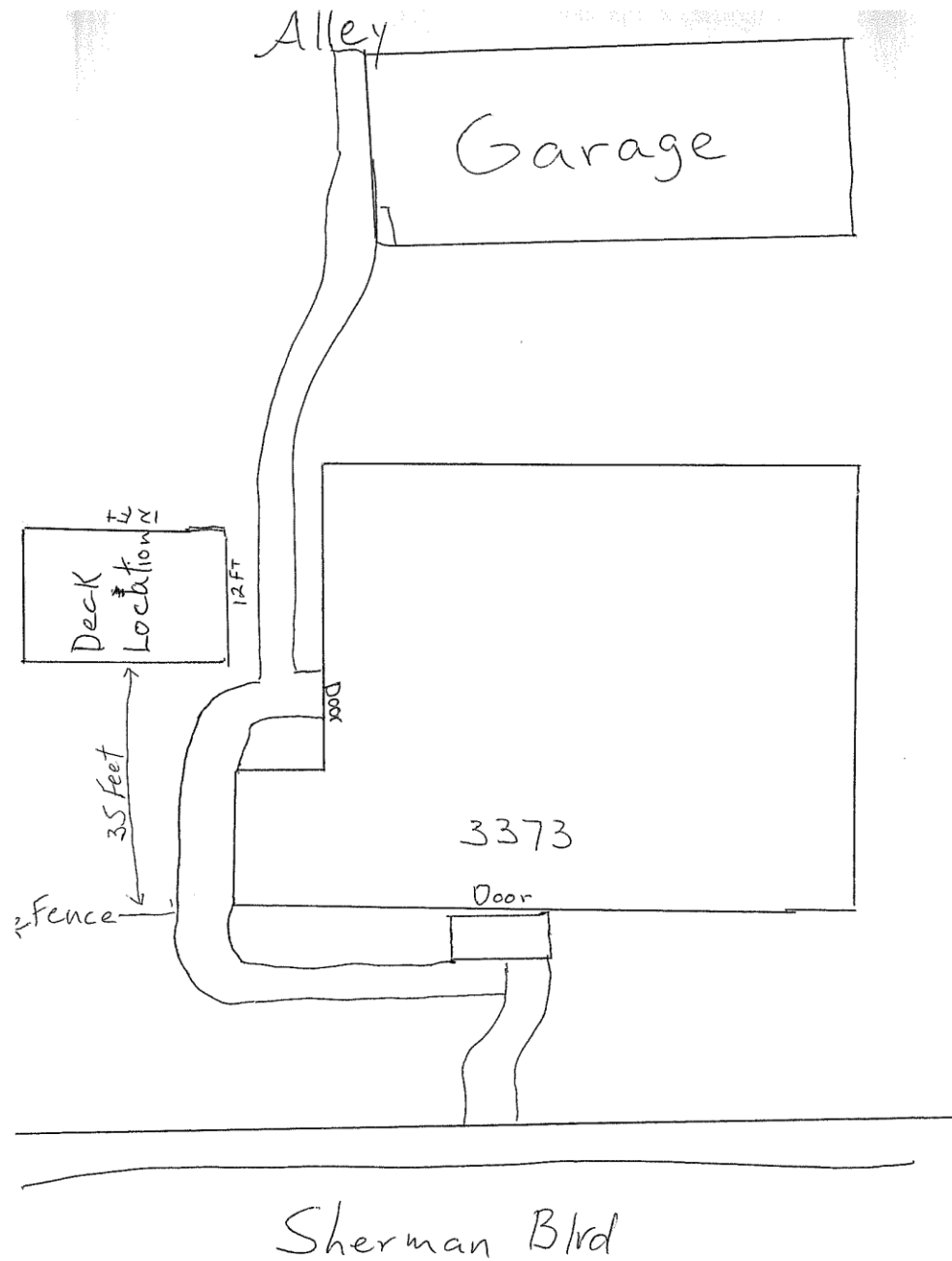



View of yard from approximate location of deck  
looking towards Sherman Boulevard



View of back yard



This type of railing with side-mounted balusters is not permitted.



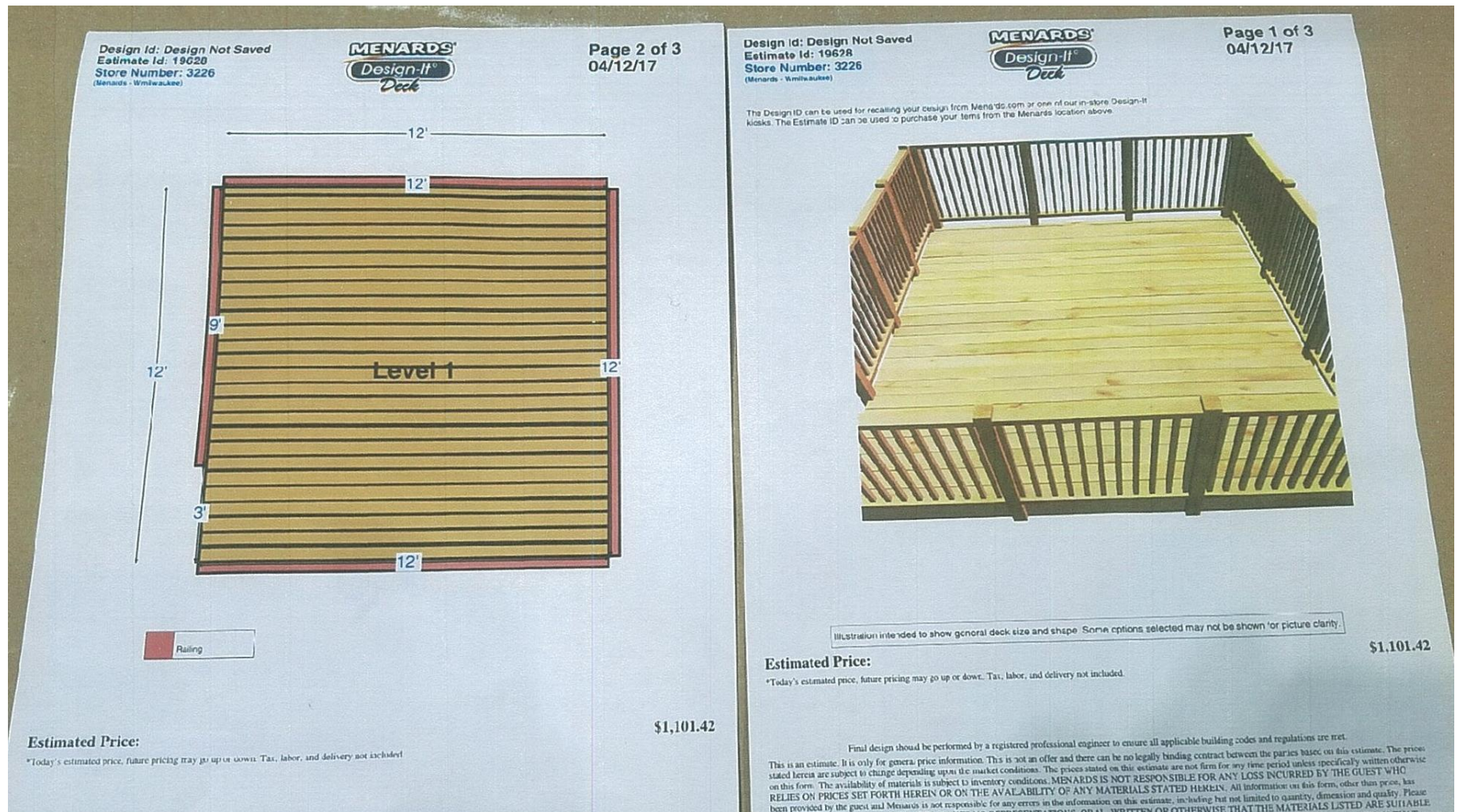

Diagram of deck as proposed. Entry area at left (north) will be wider.