



Certificate of Appropriateness

Milwaukee Historic Preservation Commission/200 E. Wells Street/Milwaukee, WI 53202/phone 414-286-5712/fax 414-286-3004

Property 2288 N. LAKE DR. North Point Water Tower in the North Point South Historic District
Description of work Replace all of 24 existing incandescent/halogen lights and fixtures that serve as night accent lighting for the water tower. The lights are currently mounted atop four nearby power poles and the replacement LED fixtures will be installed in the same locations atop the same four poles.
Date issued 1/31/2017 PTS ID 114204 COA: replace architectural lighting

In accordance with the provisions of Section 320-21 (11) and (12) of the Milwaukee Code of Ordinances, the Milwaukee Historic Preservation Commission has issued a certificate of appropriateness for the work listed above. The work was found to be consistent with preservation guidelines. The following conditions apply to this certificate of appropriateness:

Product design and description shall be as show in attached materials and according to attached site plan. Product is available in multiple standard finishes including satin black, classic bronze, green, textured black, and white. White is not acceptable and green is discouraged. Color temperature should be 3000-4500K, with 4000-4500K encouraged, a higher color temperature will better highlight the color of the stone.

All work must be done in a craftsman-like manner, and must be completed within one year of the date this certificate was issued. Staff must approve any changes or additions to this certificate before work begins. Work that is not completed in accordance with this certificate may be subject to correction orders or citations. If you require technical assistance, please contact Tim Askin of the Historic Preservation staff as follows: Phone: (414) 286-5712 E-mail: Tim.Askin@milwaukee.gov.

If permits are required, you are responsible for obtaining them from the Milwaukee Development Center. If you have questions about permit requirements, please consult the Development Center's web site, www.milwaukee.gov/build, or call (414) 286-8210.

City of Milwaukee Historic Preservation Staff

Copies to: Development Center, Ald. Nik Kovac, Contractor , Inspector Paul Wolfgramm (286-2590)



Existing fixtures as currently installed on one of the four towers. All installations are identical, except for angle of light.



FL2/FLC2

Angled view of LED replacement

VARIETA

TWO ARRAY LED FLOOD LIGHT

APPLICATION:

Accent lighting for exterior retail, commercial and hospitality environments

CONSTRUCTION:

- Die-Cast aluminum faceplate
- Extruded aluminum enclosure
- IP67 sealed optical modules

MOUNTING:

- Cast aluminum pivot
- 180° tilt
- 360° rotation

ELECTRICAL:

Integral driver
Input voltage 120v-277v auto-sensing
Power consumption 62W
1/2" NPT wire entry
Standard product is shipped as non-dimming unless specified

OPTICS:

- Lumen maintenance: 70% @ 50,000 hours
- 2 lens modules containing 16 LEDs each available in a number of symmetric or asymmetric axial beam spread patterns

OPERATING TEMP:

-30°C to 40°C

WEIGHT:

11 lbs

EPA:

0.47

FINISH:

Premium quality thermoset polyester powdercoat for a durable finish in the following:

BLK -Satin Black
CLB -Classic Bronze
GRN -Green

TBK -Textured Black
WHT -White

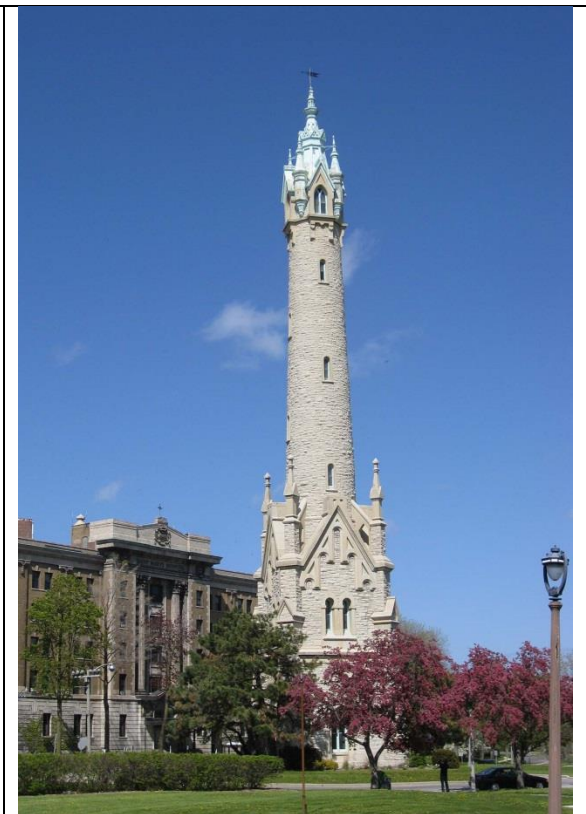
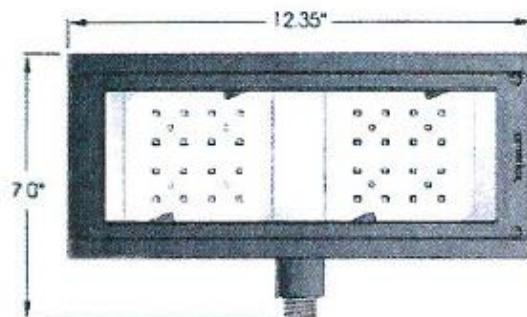

Product specifications and measurements

North Point Water Tower in 2009

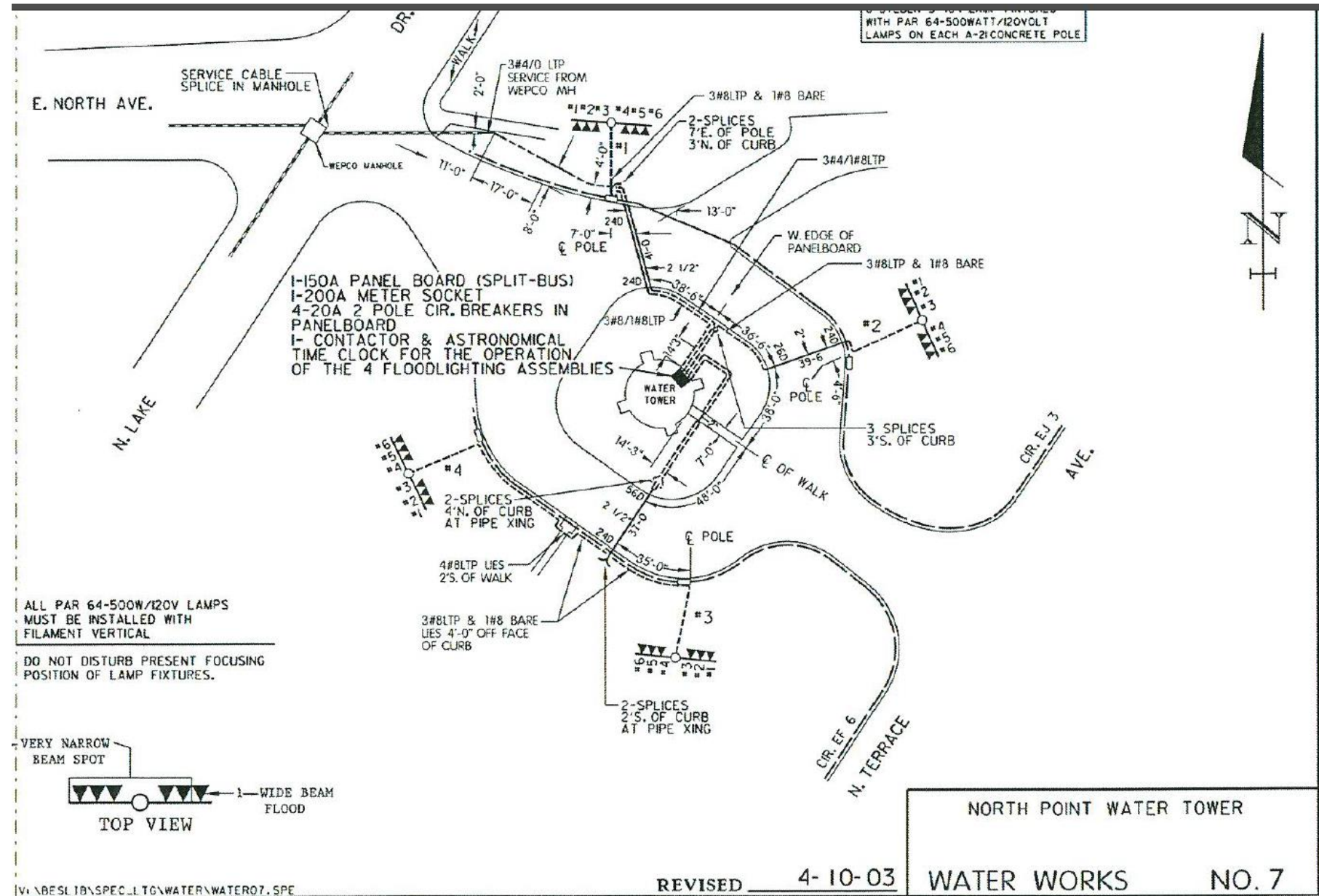

Site Electrical Plan from 2003 showing installation sites (noted with triangles and numbers 1-6) for light poles.