



Certificate of Appropriateness

Milwaukee Historic Preservation Commission/200 E. Wells Street/Milwaukee, WI 53202/phone 414-286-5712/fax 414-286-3004

Property 3008 W. KILBOURN AV. Concordia Historic District
Description of work Install new fence to surround property. Applicant verbally revised application from shadowbox style to French gothic picket. This COA is retroactive to the date of application in 2011.
Date issued 1/26/2017 PTS ID 114200 COA: Replace fence

In accordance with the provisions of Section 320-21 (11) and (12) of the Milwaukee Code of Ordinances, the Milwaukee Historic Preservation Commission has issued a certificate of appropriateness for the work listed above. The work was found to be consistent with preservation guidelines. The following conditions apply to this certificate of appropriateness:

Fence will match details shown below.

All work must be done in a craftsman-like manner, and must be completed within one year of the date this certificate was issued. Staff must approve any changes or additions to this certificate before work begins. Work that is not completed in accordance with this certificate may be subject to correction orders or citations. If you require technical assistance, please contact Tim Askin of the Historic Preservation staff as follows: Phone: (414) 286-5712 E-mail: Tim.Askin@milwaukee.gov.

If permits are required, you are responsible for obtaining them from the Milwaukee Development Center. If you have questions about permit requirements, please consult the Development Center's web site, www.milwaukee.gov/build, or call (414) 286-8210.

City of Milwaukee Historic Preservation Staff

Copies to: Development Center, Ald. Robert Bauman, Contractor

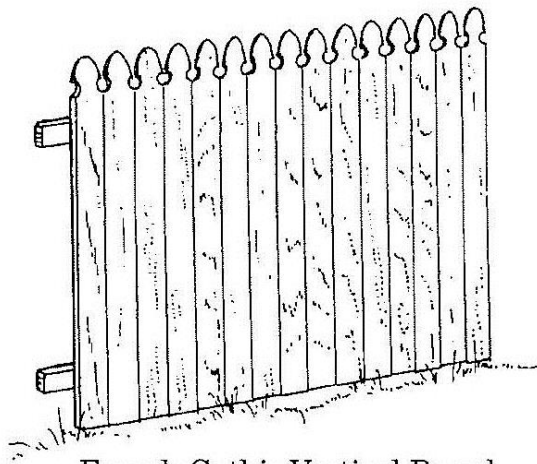

French Gothic Vertical Board

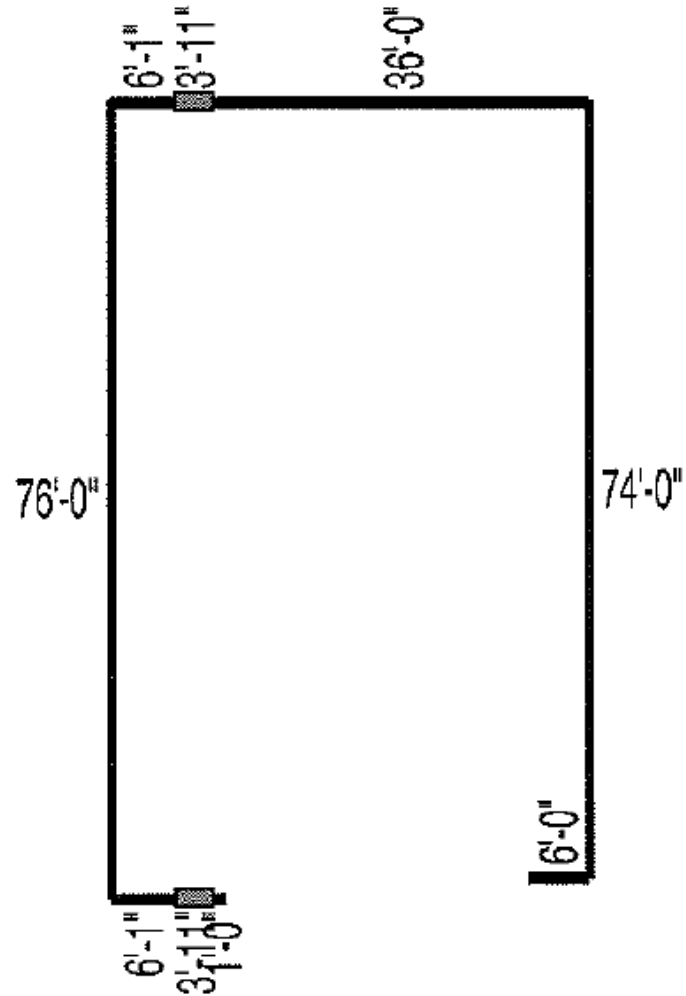

Fence will match this board design at a lower 3 to 4 foot height and spaced as individual pickets.

Fence dimensions/site plan



State of existing fence in 2011

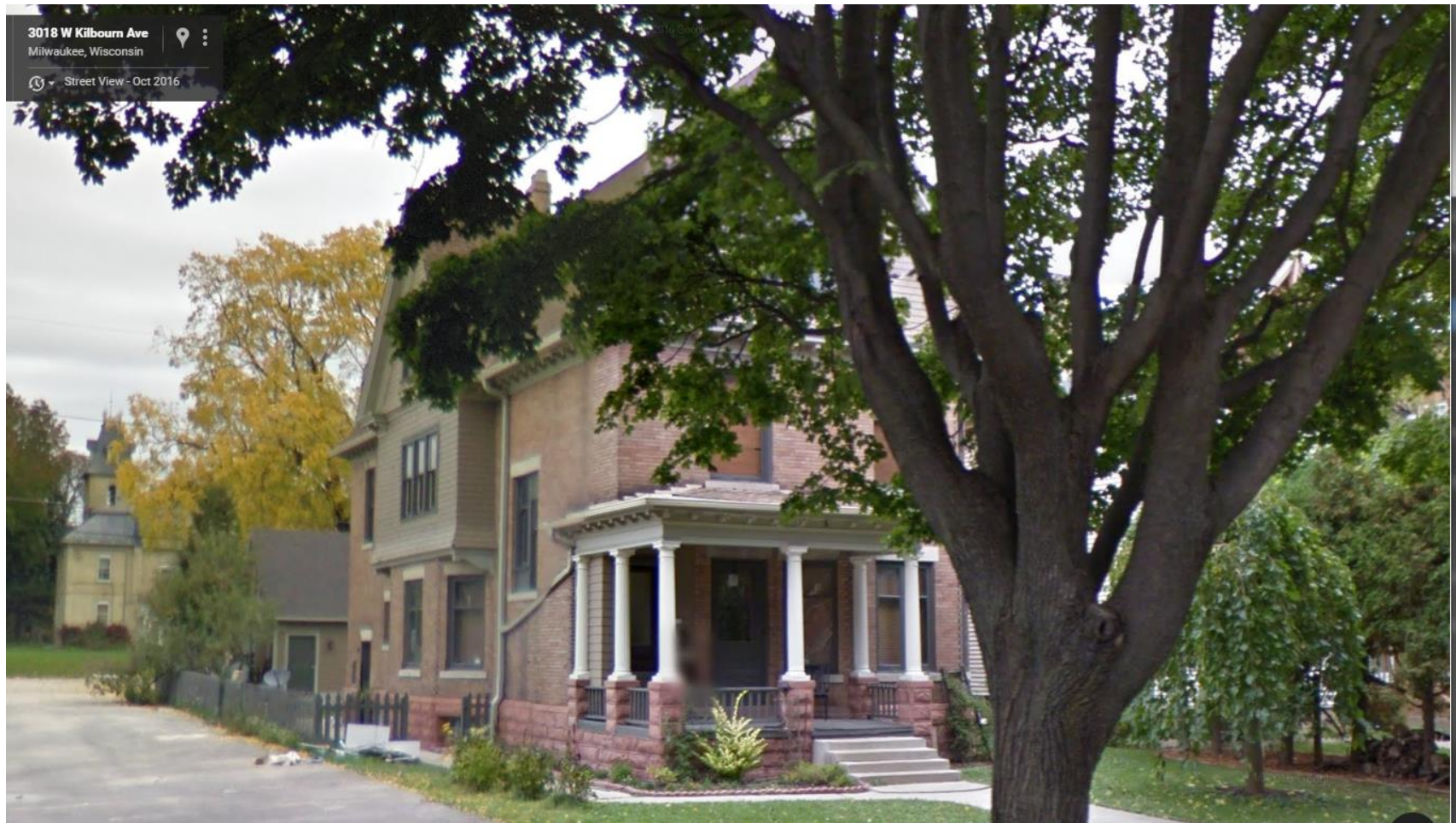

Fence as built, as seen in October 2016, per Google Streetview.