



# Certificate of Appropriateness

Milwaukee Historic Preservation Commission/200 E. Wells Street/Milwaukee, WI 53202/phone 414-286-5712/fax 414-286-3004

**Property** 1927 N. 2ND ST. Brewers Hill Historic District  
**Description of work** Remove and existing small porch canopy over south wall door and construct new shed roof to match depth of porch and extend along wall 10 feet. End detail/bracket to duplicate existing or reuse existing.  
**Date issued** 1/10/2017 PTS ID 114195 COA

In accordance with the provisions of Section 320-21 (11) and (12) of the Milwaukee Code of Ordinances, the Milwaukee Historic Preservation Commission has issued a certificate of appropriateness for the work listed above. The work was found to be consistent with preservation guidelines. The following conditions apply to this certificate of appropriateness:

Roofing to be standard asphalt composition or true wood shake or shingle. Gutters, if required by code or desired by applicant is approved as half-round or K-type.

All work must be done in a craftsman-like manner, and must be completed within one year of the date this certificate was issued. Staff must approve any changes or additions to this certificate before work begins. Work that is not completed in accordance with this certificate may be subject to correction orders or citations. If you require technical assistance, please contact Tim Askin of the Historic Preservation staff as follows: Phone: (414) 286-5712 E-mail: Tim.Askin@Milwaukee.gov.

If permits are required, you are responsible for obtaining them from the Milwaukee Development Center. If you have questions about permit requirements, please consult the Development Center's web site, [www.milwaukee.gov/build](http://www.milwaukee.gov/build), or call (414) 286-8210.

City of Milwaukee Historic Preservation Staff

Copies to: Development Center, Ald. Milele Coggs, Contractor, Inspector John Cunningham (286-2538)

1927 N. 2nd

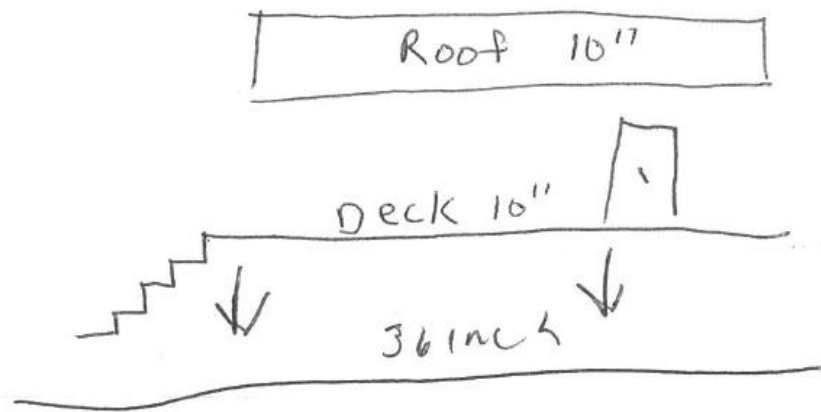

Application drawing



Approximate current conditions. New 10-foot porch has already been constructed. Porch canopy shown will be removed and its construction details reproduced in new roof.