



CITY OF MILWAUKEE
OFFICE OF THE CITY CLERK

Wednesday, April 27, 2016

COMMITTEE MEETING NOTICE

AD 02

SINGH, Avtar, Agent
Pantry 2015 Inc
6934 S Carmel Dr

Franklin, WI 53132

You are requested to attend a hearing which is to be held in Room 301-B, Third Floor, City Hall on:

Tuesday, May 10, 2016 at 08:30 AM

Regarding: Your Extended Hours Establishments, Filling Station, Food Dealer, and Weights & Measures Applications as agent for "Pantry 2015 Inc" for "One Stop Pantry" at 9627 Fond Du Lac Av.

There is a possibility that your application may be denied for one or more of the following reasons: The recommendation of the committee regarding the application shall be based on evidence presented at the hearing. Per MCO 85-2.7-4, probative evidence concerning whether or not a new license should be granted may be presented on the following subjects: whether or not the applicant meets the municipal requirements, the appropriateness of the location and premises where the licensed premises is to be located and whether use of the premises for the purposes or activities permitted by the license would tend to facilitate a public or private nuisance or create undesirable neighborhood problems such as disorderly patrons, unreasonably loud noise, litter, and excessive traffic and parking congestion. Probative evidence relating to these matters may be taken from the plan of operation submitted with the license application, if any, but shall not include the content of any music. Evidence regarding the fitness of the location of the premises to be maintained as the principal place of business, including but not limited to whether there is an overconcentration of businesses of the type for which the license is sought; whether the proposal is consistent with any pertinent neighborhood business or development plans, or the location's proximity to areas where children are typically present. The applicant's record in operating similarly licensed premises; and whether or not the applicant has been charged with or convicted of any felony, misdemeanor, municipal offense or other offense, the circumstances of which substantially relate to the activity to be permitted by the license being applied for or any other factor which reasonably relates to the public health, safety or welfare may also be considered. See attached police report or correspondence.

Notice for applicants with warrants or unpaid fines:

Proof of warrant satisfaction or payment of fines must be submitted at the hearing on the above date and time. Failure to comply with this requirement may result in a delay of the granting/denial of your application.

Failure to appear at this meeting may result in the denial of your license. Individual applicants must appear only in person or by an attorney. Corporate or Limited Liability applicants must appear only by the agent designated on the application or by an attorney. Partnership applicants must appear by a partner listed on the application or by an attorney. If you wish to do so and at your own expense, you may be accompanied by an attorney of your choosing to represent you at this hearing.

You will be given an opportunity to speak on behalf of the application and to respond and challenge any charges or reasons given for the denial. No petitions can be accepted by the committee, unless the people who signed the petition are present at the committee hearing and willing to testify. You may present witnesses under oath and you may also confront and cross-examine opposing witnesses under oath. If you have difficulty with the English language, you should bring an interpreter with you, at your expense, so that you can answer questions and participate in your hearing.

You may examine the application file at this office during regular business hours prior to the hearing date. Inquiries regarding this matter may be directed to the person whose signature appears below.

Limited parking for persons attending meetings in City Hall is available at reduced rates (5 hour limit) at the Milwaukee Center on the southwest corner of East Kilbourn and North Water Street. Parking tickets must be validated in the first floor information booth in City Hall.

PLEASE NOTE Upon reasonable notice, efforts will be made to accommodate the needs of disabled individuals through sign language interpreters or other auxiliary aids. For additional information or to request this service, contact the Council Services Division ADA Coordinator at (414) 286-2998, Fax - (414) 286-3456, TDD - (414) 286-2025.

JIM OWCZARSKI, CITY CLERK

BY:

Jason Schunk
License Division Manager

If you have questions regarding this notice, please contact the License Division at (414) 286-2238.



CITY OF MILWAUKEE
OFFICE OF THE CITY CLERK

Wednesday, April 27, 2016

COMMITTEE MEETING NOTICE

AD 02

SINGH, Avtar, Agent
Pantry 2015 Inc
9622 W Fond Du Lac Av

Milwaukee, WI 53225

You are requested to attend a hearing which is to be held in Room 301-B, Third Floor, City Hall on:

Tuesday, May 10, 2016 at 08:30 AM

Regarding: Your Extended Hours Establishments, Filling Station, Food Dealer, and Weights & Measures Applications as agent for "Pantry 2015 Inc" for "One Stop Pantry" at 9622 W Fond Du Lac Av.

There is a possibility that your application may be denied for one or more of the following reasons: The recommendation of the committee regarding the application shall be based on evidence presented at the hearing. Per MCO 85-2.7-4, probative evidence concerning whether or not a new license should be granted may be presented on the following subjects: whether or not the applicant meets the municipal requirements, the appropriateness of the location and premises where the licensed premises is to be located and whether use of the premises for the purposes or activities permitted by the license would tend to facilitate a public or private nuisance or create undesirable neighborhood problems such as disorderly patrons, unreasonably loud noise, litter, and excessive traffic and parking congestion. Probative evidence relating to these matters may be taken from the plan of operation submitted with the license application, if any, but shall not include the content of any music. Evidence regarding the fitness of the location of the premises to be maintained as the principal place of business, including but not limited to whether there is an overconcentration of businesses of the type for which the license is sought; whether the proposal is consistent with any pertinent neighborhood business or development plans, or the location's proximity to areas where children are typically present. The applicant's record in operating similarly licensed premises; and whether or not the applicant has been charged with or convicted of any felony, misdemeanor, municipal offense or other offense, the circumstances of which substantially relate to the activity to be permitted by the license being applied for or any other factor which reasonably relates to the public health, safety or welfare may also be considered. See attached police report or correspondence.

Notice for applicants with warrants or unpaid fines:

Proof of warrant satisfaction or payment of fines must be submitted at the hearing on the above date and time. Failure to comply with this requirement may result in a delay of the granting/denial of your application.

Failure to appear at this meeting may result in the denial of your license. Individual applicants must appear only in person or by an attorney. Corporate or Limited Liability applicants must appear only by the agent designated on the application or by an attorney. Partnership applicants must appear by a partner listed on the application or by an attorney. If you wish to do so and at your own expense, you may be accompanied by an attorney of your choosing to represent you at this hearing.

You will be given an opportunity to speak on behalf of the application and to respond and challenge any charges or reasons given for the denial. No petitions can be accepted by the committee, unless the people who signed the petition are present at the committee hearing and willing to testify. You may present witnesses under oath and you may also confront and cross-examine opposing witnesses under oath. If you have difficulty with the English language, you should bring an interpreter with you, at your expense, so that you can answer questions and participate in your hearing.

You may examine the application file at this office during regular business hours prior to the hearing date. Inquiries regarding this matter may be directed to the person whose signature appears below.

Limited parking for persons attending meetings in City Hall is available at reduced rates (5 hour limit) at the Milwaukee Center on the southwest corner of East Kilbourn and North Water Street. Parking tickets must be validated in the first floor information booth in City Hall.

PLEASE NOTE: Upon reasonable notice, efforts will be made to accommodate the needs of disabled individuals through sign language interpreters or other auxiliary aids. For additional information or to request this service, contact the Council Services Division ADA Coordinator at (414) 286-2998, Fax - (414) 286-3456, TDD - (414) 286-2025.

JIM OWCZARSKI, CITY CLERK

BY: _____

Jason Schunk

License Division Manager

If you have questions regarding this notice, please contact the License Division at (414) 286-2238.

200 E. Wells Street, Room 105, City Hall, Milwaukee, WI 53202. www.milwaukee.gov/license
Phone: (414) 286-2238 Fax: (414) 286-3057 Email Address: License@milwaukee.gov

**MILWAUKEE POLICE DEPARTMENT
LICENSE INVESTIGATION UNIT**

**CRIMINAL RECORD/ORDINANCE VIOLATION/INCIDENTS
SYNOPSIS**

DATE: 03/17/2016

LICENSE TYPE: FILLING STATION, 24HRS

NEW:

RENEWAL: X

No. 226880, 226919

Application Date: 03/17/2016

Expiration Date:

License Location: 9622 W Fond Du Lac Av

Aldermanic District:05

Business Name: One Stop Pantry

Licensee/Applicant: Singh, Avtar

(Last Name, First Name, MI)

Date of Birth: 04/02/1955

Home Address: 6934 S Carmel Dr

City: Franklin

State: WI

Zip Code: 53132

Home Phone: (414) 795-4456

This report is written by Police Officer David NOVAK, assigned to the License Investigation Unit, Days.

The Milwaukee Police Department's investigation regarding this application revealed the following:

1. On 02/27/2007, a Milwaukee Police Department squad was dispatched to Kwik Pantry 9622 W Fond Du Lac Av for a trouble with subject complaint. Spoke to caller PATEL, Rajendrahai (W/M 08/10/1974) regarding an individual who is constantly harassing the customers.

- =====
2. On 05/10/10 at 11:54 pm, Milwaukee police were dispatched to 9622 W FDL for a Battery complaint. Investigation revealed the clerk argued with his wife, who was also working in the gas station, over a show they were watching. The victim went outside and her husband followed pulling her hair with a witness calling police. The victim was stated she was not hurt nor wanted to prosecute. Officers observed a bruise to the victim's arm and arrested the husband for disorderly conduct/domestic violence related. Photos of the victim were taken.
- =====

3. On 10/27/2012 a 17 year old, working with Milwaukee police on the Wisconsin WINS Youth Tobacco Initiative, was able to purchase a cigar from the clerk (Amritpal Singh) at Kwik Pantry located at 9622 West Fond du Lac Avenue in Milwaukee. The applicant was cited.

Charge: Sale of Cigarettes to Minor/Underage
Finding: Guilty
Sentence: \$171.00 fine
Date: 12/28/2012
Case: 12128565



Wednesday, April 27, 2016



Notice of Public Hearing

SINGH, Avtar, Agent
One Stop Pantry at 9622 W Fond Du Lac Av
Extended Hours Establishments, Filling Station, Food Dealer, and Weights & Measures
Applications

Tuesday, May 10, 2016 at 8:30 AM

To whom it may concern:

The above application has been made by the above named applicant(s). This requires approval from the Licenses Committee and the Common Council of the City of Milwaukee. The hearing before the Licenses Committee will take place on 5/10/2016 at 8:30 AM, in Room 301-B, Third Floor, City Hall. If you wish, you may provide testimony at the hearing regarding the request; see below for further information. You are not required to attend the hearing. Once the Licenses Committee makes its recommendation, this recommendation is forwarded to the full Common Council for approval at its next regularly scheduled hearing. Please review the information below and if you have further questions regarding this process, please contact the License Division at (414) 286-2238.

Important details for those wishing to provide information for the Licenses Committee to consider when making its recommendation:

1. The license application is scheduled to be heard at the above time. Due to other hearings running longer than scheduled, you may have to wait some time to provide your testimony.
2. You must appear in person and testify as to matters that you have personally experienced or seen. (You cannot provide testimony for your neighbor, parent or anyone else; this is considered hearsay and cannot be considered by the committee.)
3. No letters or petitions can be accepted by the committee (unless the person who wrote the letter or the persons who signed the petition are present at the committee hearing and willing to testify).
4. Persons opposed to the license application are given the opportunity to testify first; supporters may testify after the opponents have finished.
5. When you are called to testify, you will be sworn in and asked to give your name, and address. (If your first and/or last names are uncommon please spell them.)
6. You may then provide testimony.
 - a. Include only information relating to the above license application.
 - b. Include only information you have personally witnessed or seen.
 - c. Provide concise and relevant information detailing how this business has affected or may affect the peaceful enjoyment of your neighborhood.
 - d. If by the time you have the opportunity to testify, the information you wish to share has already been provided to the committee, you may state that you agree with the previous testimony. Redundant or repetitive testimony will not assist the committee in making its recommendation.
7. After giving your testimony, the members of the Licenses Committee and the licensee may ask questions regarding the testimony you have given or other factors relating to the license application.
8. Business Competition is not a valid basis for denial or non-renewal of a license.
Please Note: If you have submitted an objection to the above application your objection cannot be considered by the committee unless you personally testify at the hearing.

RESIDENT	MAIL ADDRESS	CITY AND ZIP CODE
CURRENT RESIDENT	9580 W FOND DU LAC AVE 1	MILWAUKEE, WI 53225-1643
CURRENT RESIDENT	9580 W FOND DU LAC AVE 10	MILWAUKEE, WI 53225-1637
CURRENT RESIDENT	9580 W FOND DU LAC AVE 11	MILWAUKEE, WI 53225-1637
CURRENT RESIDENT	9580 W FOND DU LAC AVE 12	MILWAUKEE, WI 53225-1638
CURRENT RESIDENT	9580 W FOND DU LAC AVE 14	MILWAUKEE, WI 53225-1638
CURRENT RESIDENT	9580 W FOND DU LAC AVE 15	MILWAUKEE, WI 53225-1638
CURRENT RESIDENT	9580 W FOND DU LAC AVE 16	MILWAUKEE, WI 53225-1638
CURRENT RESIDENT	9580 W FOND DU LAC AVE 17	MILWAUKEE, WI 53225-1638
CURRENT RESIDENT	9580 W FOND DU LAC AVE 18	MILWAUKEE, WI 53225-1638
CURRENT RESIDENT	9580 W FOND DU LAC AVE 19	MILWAUKEE, WI 53225-1642
CURRENT RESIDENT	9580 W FOND DU LAC AVE 2	MILWAUKEE, WI 53225-1643
CURRENT RESIDENT	9580 W FOND DU LAC AVE 20	MILWAUKEE, WI 53225-1642
CURRENT RESIDENT	9580 W FOND DU LAC AVE 21	MILWAUKEE, WI 53225-1642
CURRENT RESIDENT	9580 W FOND DU LAC AVE 22	MILWAUKEE, WI 53225-1642
CURRENT RESIDENT	9580 W FOND DU LAC AVE 23	MILWAUKEE, WI 53225-1642
CURRENT RESIDENT	9580 W FOND DU LAC AVE 24	MILWAUKEE, WI 53225-1642
CURRENT RESIDENT	9580 W FOND DU LAC AVE 3	MILWAUKEE, WI 53225-1643
CURRENT RESIDENT	9580 W FOND DU LAC AVE 4	MILWAUKEE, WI 53225-1643
CURRENT RESIDENT	9580 W FOND DU LAC AVE 5	MILWAUKEE, WI 53225-1637
CURRENT RESIDENT	9580 W FOND DU LAC AVE 6	MILWAUKEE, WI 53225-1637
CURRENT RESIDENT	9580 W FOND DU LAC AVE 7	MILWAUKEE, WI 53225-1637
CURRENT RESIDENT	9580 W FOND DU LAC AVE 8	MILWAUKEE, WI 53225-1637
CURRENT RESIDENT	9580 W FOND DU LAC AVE 9	MILWAUKEE, WI 53225-1637

Total Records: 24
Radius: 300.0 feet and Center of Circle: 9622 W Fond Du Lac AV



BUSINESS LICENSE PLAN OF OPERATION

ccl-busplan 10/21/2015

Office of the City Clerk License Division
200 E. Wells St. Room 105, Milwaukee, WI 53202
(414) 286-2238 www.milwaukee.gov/license e-mail address: license@milwaukee.gov

1. Type of Business

Applying for: Extended Hours Establishment Filling Station
 Self Service Laundry Rooming House: Number of Units: _____ Hotel/Motel: Number of Units: _____
 Massage Establishment Other (supplemental application for specific license also required)

Provide a detailed description of the type of business you plan on operating:

24 HOUR SELF SERVICE GAS STATION WITH CONVENIENCE STORE

Do you have any experience operating this type of business? No Yes If yes, explain: Currently Managing

2. Business Operations

- a. Proposed Opening Date: 4/1/2016
- b. Is this premise under construction? No Yes If yes, list estimated completion date: _____
- c. Is this a franchise? No Yes
- d. Is this premises currently licensed? No Yes If yes, list type of license: Cig. Food, 24HR, occupancy
- e. Is the current licensee operating? No Yes If no, list date closed: _____
- f. Do you have future plans for other businesses, licenses or permits at this location? No Yes
If yes, explain: _____
- g. Have you previously held an Extended Hours License in Milwaukee? No Yes
If yes, list address(es): _____
- h. Are other businesses operating in the same building? No Yes If yes, describe: _____

3. Litter & Noise

- a. How are grounds kept clean? Sweep Pressure Wash Pick Up Litter Other: _____
- b. How often will grounds be cleaned? Daily Weekly As Needed Monthly Other: _____
- c. Grounds cleaned by: Licensee Building Owner Employees Hired Maintenance Other: _____
- d. How are noise issues prevented and/or addressed? Security Manager approaches customer(s) Call Police
 Signs Posted Other: _____
- e. Will a sound amplification system be used? No Yes If yes, describe: _____

4. Smoking & Sanitation

- f. Are there designated outdoor smoking areas? No Yes If yes, describe: _____
- g. Number of Garbage Cans: Inside: 2 Locations: Main Counter and Coffee Counter
Outside: 5 Locations: By Pumps, Entrance, By Vacuum
- h. Is a crowd control barrier used? No Yes If yes, describe: _____
- i. Describe sanitation facilities (restrooms): Restroom in NE corner of Building
Name of solid waste contractor: Advanced Disposal Waste Management Other: _____

5. Security

- a. Are there onsite parking spaces? No Yes If yes, how many? 10
Describe parking security plan: Security Camera.
- b. Is there a loading zone? No Yes If yes, describe loading area security plan _____
- c. Will you have security personnel on premise? No Yes If yes, how many? _____
What are their responsibilities? _____
Is security equipment used? No Yes If yes, describe _____
List their licensing, certification, or training credentials _____
Will there be security cameras? No Yes If yes, where? Entry, Counter, Tables, outside Event/Back
Will searches/identification verification be conducted upon entry? No Yes if yes, describe _____

6. Percentage of Sales (must total 100%)

Alcohol _____%	Food <u>32</u> %	Secondhand Merchandise _____%	Precious Metals & Gems _____%
Entertainment _____%	Cigarettes <u>12</u> %	Personal Services (such as tattoo, body piercing, salon, tailor, tanning, etc.) _____%	Other <u>56</u> % Describe: <u>Gas/Lottery/Grocery</u>
Pawnbroker Activity _____%	Salvaged Materials _____% (such as scrap metal)		

7. Businesses/Licenses on the Premises (check all that apply):

Type 1

- Full Service Restaurant Cafe/Coffee Shop Deli or Fast Food Restaurant Private/Fraternal/Veterans Club
- Night Club Tavern Cocktail Lounge Teen Club
- Banquet Hall Sports Facility Bowling Alley
- Hotel/Motel – Number of Rooms: _____ Rooming House – Number of Rooms: _____

Type 2

- Liquor Store Corner Store Supermarket Convenience Store
- Gas Station Amusement/Phonograph Distributor Recycling, Salvage or Towing
- Used Car Dealer Personal Service Establishment (such as tattoo business, hair salon, tailor, etc.) Recording Studio

What other licenses/permits will you hold at this location? (check all that apply)

- Occupancy Permit Cigarette & Tobacco Gas Station Extended Hours Class "B" Tavern Weights & Measures
- Secondhand Dealer Precious Metal & Gem Other: _____

8. Legal Capacity (only if a Type 1 premises in #6 above)

Capacity _____ (Call the Milwaukee Development Center at 414-286-8211 if you have questions.)

9. Premises Description

d. Identify all area(s) of the premises that will be used in operating this business (include areas used only for storage):

1st Floor 2nd Floor Basement Storage Patio Beer Garden Sidewalk Café Deck Rooftop

Other: Describe: _____

e. Describe Location: Major Thoroughfare Secondary Street Other: Fond du Lac & Mill Rd

f. Nearest Major Cross Street: Mill Rd & 91st

g. Describe Building: Free Standing Building Strip Mall Other: _____

h. Describe Premises Structure: Single Story Multi-Story - # of Stories _____ Other: _____

i. Describe Surrounding Area: Commercial Residential Industrial Other: _____

j. Building Owner Name: AKAAL LLC Phone Number: 414-759-4456

Business Owner Address: 6934 S Camel Dr, Franklin WI 53132

10. Hours of Operation & Customers

Will customers be entering the premises? No Yes

Day of the Week	Proposed Hours of Operation:		Estimated Number of Customers expected each day	Potential Age Range of Customers	Class B Applicants: Age Restriction (If none, write 'None')
	Open Time (include a.m. or p.m.)	Close Time (include a.m. or p.m.)			
Sunday	24 hrs	24 hrs	200	8-90	
Monday	24 hrs	24 hrs	200	8-90	
Tuesday	24 hrs	24 hrs	200	8-90	
Wednesday	24 hrs	24 hrs	200	8-90	
Thursday	24 hrs	24 hrs	200	8-90	
Friday	24 hrs	24 hrs	250	8-90	
Saturday	24 hrs	24 hrs	250	8-90	

Extended Hours Establishment License is required for any convenience store, filling station, personal service establishment (such as tattoo, body piercing, salon, tailor, tanning, etc.), recording studio or restaurant which is open between the hours of 12 a.m. and 5 a.m.

Entertainment Indoor Closing Hours - If alcohol beverage establishment, same as alcohol license hours.
If non-alcohol establishment 1:00 am Sunday to Thursday; 1:30 am Friday and Saturday.

Entertainment Outdoor Closing Hours - 10:00 pm Sunday - Thursday; 12:00 am Friday and Saturday,
unless otherwise approved by Common Council in licensee's plan of operation.

11. Signature(s)

X Artur Siegl
Sole Proprietor, Partner, Agent, or 20% or more Shareholder

Signature of additional partner or 20% or more Shareholder

See Application Information for a list of all required application forms.



FOOD DEALER LICENSE PLAN OF OPERATION

OFFICE OF THE CITY CLERK, LICENSE DIVISION
 CITY HALL, 200 E. WELLS ST, ROOM 105, MILWAUKEE, WI 53202 •
 (414) 286-2238 • license@milwaukee.gov • www.milwaukee.gov/license

Legal Entity Name: PANTRY 2015 INC.

Premises Address: 9622 W Ford Dr AAC Ave Milwaukee WI 53225

1. Application Type

Is this a new food business or are you taking over a food business which is currently operating?

- Taking over a currently operating, licensed food business
- New business (includes taking over a closed food business)

Will you be sharing kitchen space with another food establishment?

- Yes, I intend to rent space in my kitchen to other food businesses
- Yes, I am renting space from another food business which will also be using the kitchen*
- No, I will be the only food business using the space

*If renting space in a commercial kitchen with another operator, a completed and signed Shared Kitchen Agreement is required.
 The form is available at www.milwaukee.gov/license

Provide a brief description of the food establishment.

C-store w/ gas station. Selling packaged food like candy, chips, soda, coffee, household items like tissue paper, toilet paper, soap etc. Lottery, pharmacies etc.

Attach a copy of your menu or general listing of the types of food products that will be sold. Indicate what information you will be including:

- Menu
- List of the types of products (for example: packaged foods, deli case, meat department)

candy, chips, soda, coffee, pizza
 soap, hand soap, toilet paper etc.

What is the anticipated opening date or date of change of ownership: 5/1/2016

2. Construction, Remodeling and Equipment

Are any construction, remodeling or equipment changes planned? Yes No *If no, skip to section 3.*

Scope of the planned project?

- New construction or conversion of an existing structure to be used as a food establishment
- Renovation/remodeling of a food establishment, which may or may not include equipment changes
- Renovation/remodeling limited to the installation/change/replacement of food equipment

Provide a brief summary of the proposed construction, remodeling and/or equipment change:

Note: Building permits may be required. Contact the City of Milwaukee Development Center.

Date alterations/changes planned to begin

Name, address and phone number of architect

Name, address and phone number of general contractor

3. Premises Description

Will food be prepared/sold at a single site or at multiple sites? (multiple site example: a hotel with multiple dining rooms or bars):

- Single Multiple

- If multiple sites will be used, how many separate sites will be used?

List all sites and briefly describe the nature of the food activities at each site:

Are any outdoor operations planned? Yes No

- If yes, what activities will be conducted outdoors (check all that apply):

- Bar Cooking/Grilling Dining – Patio Dining – Sidewalk (DPW permit required) Storage

Other, Specify

Is seating provided on site for dining? Yes No

- If yes, are there additional banquet facilities other than the main dining area? Yes No

Total square footage of the establishment (exclude space used for other purposes other than food)

Number of Full Time Employees

Number of Part Time Employees

4. Business Type

Select the one that best describes the proposed business:

Bed & Breakfast

Community Food Program – A meal site or food pantry where food is provided free of cost to persons in need, or to organizations serving persons in need.

Distiller or Brewer – Facility primarily engaged in the production of alcohol beverages.

Food Distributor – A business that transports food for sale to retail and wholesale establishments, and does not prepare any food items

- Is food stored on site? Yes No

Food Manufacturer – A commercial operation that produces, packages, labels, or stores food, but primarily does not provide food directly to a consumer. Food is sold to distributors, retailers or restaurants. There may be a small retail store onsite where only the manufacturers products are sold, but the majority of product is sold to other licensed food establishments.

- Is there a retail store onsite? Yes No

Food Store – An establishment in which the majority of food sales consist of beverages or multi-serving food products requiring further preparation prior to consumption. Examples of food stores include bakeries, grocery stores, convenience stores, coffee shops, liquor stores. Food stores include businesses whose primary business is other than food (book store, pharmacy, etc.), but offer convenience food items.

- If a food store, are you considered a convenience food store (see definition below)? Yes No

A convenience food store contains less than 5,000 sq. ft. of retail sales space AND has as its primary business the sale of basic food items and in addition sells household products. Basic food items may include, but are not limited to, milk and dairy products, bread products, prepared sandwiches, frozen entrees, refrigerated food and baby food. Household products may include, but are not limited to, cleaning products, paper products, baby products and pet food.

School Lunch Program – Lunch program operated by an outside contractor. (If directly operated by the school, this license is not needed.)

Restaurant – An establishment in which the majority food sales consist of meals or other items ready for immediate consumption.

Shared Kitchen, Commissary or Base – A commercial kitchen used for the production of food to be served or sold at another location; a base of operations for a food peddler, caterer or seasonal market vendor.

- Will meals make up greater than 50% of your sales? Yes No

4. Business Type (Continued)

Type of sales (check all that apply, even if it reflects a small percentage of the proposed business)

- Made directly to the general public or end consumer (includes internet sales)
- Made to other food establishments (wholesaler, distributors, retail or restaurants) who will resell your product(s)

What percentage of your planned food sales will be meals versus grocery items?

% from meals (ready-to-eat food)

100 % from grocery items (foods typically requiring preparation before serving, includes typical grocery items, beverages, bakery items and raw produce)

Will customers be able to purchase food through a drive through? Yes No

Will customers be able to purchase food from a self-service salad or food bar? Yes No

Will food be prepared on site and then transported for sale or consumption at another location? Yes No

If yes, check all the reasons why the food will be transported:

- Catering
- Delivery
- Base for Mobile Food Peddler
- Base for temporary or seasonal food stand

Other-Describe: _____

5. ISSUANCE OF LICENSE

Will any alcohol or intoxicating beverages be sold at the establishment? Yes No

If yes, what type of license do you have or will you be applying for?

- Class A fermented malt beverage license
- Class B fermented malt beverage licenses
- Class C wine license
- Class A liquor license
- Class B liquor license

If yes, if your food license is approved prior to the alcohol license, when would you like the food license issued?

- immediately so you can open your food business
- at the same time as the alcohol license

6. AFFIRMATION OF UNDERSTANDING - PERMIT NEEDED TO OPERATE

Read and initial each item confirming your understanding:

AS

I understand that an inspection and sign off by the Health Department is required before my permit may be issued.

AS

I understand that the Health Department will review my application and will update the application based on what is observed during my onsite inspection. My representative onsite at the time of inspection must have the authority to approve corrections to my application.

AS

I understand that an occupancy permit must be issued and an inspection may be required from the Department of Neighborhood Services before my permit may be issued.

AS

I understand that the Department of Neighborhood Services must sign off on my application with the License Division before my permit may be issued.

AS

I understand the local council member must approve or deny my request before my permit is eligible to be issued. If denied, I understand that I may appeal and be scheduled for a hearing before the License Committee of the Common Council.

AS

I understand that the License Division must have proof of payment for the associated permit fees before my permit may be issued.

AS

I understand that all of the above must be complete before my permit is eligible to be issued.

AS

I understand that the license for which I am applying must be issued and posted in my business premises prior to opening for business.

I, AVTAR SINGH

Name of Applicant

, will not operate my food business, until the permit has been issued and posted in the establishment.

Signature of Applicant:

Avtar Singh

Date: 03-04-16



WEIGHTS & MEASURES LICENSE SUPPLEMENTAL APPLICATION
OFFICE OF THE CITY CLERK, LICENSE DIVISION
CITY HALL, 200 E. WELLS ST, ROOM 105, MILWAUKEE, WI 53202 •
(414) 286-2238 • license@milwaukee.gov • www.milwaukee.gov/license

Legal Entity Name: Pantry 2015 Inc

Premise Address: 9622 W. Fond Du Lac Ave Mil WI 53225

1. Device Type(s)

- Check all device types for which you need a license.
 - For each device type checked, indicate how many you have in the Number of Devices column (b).
 - Calculate the Total Fee Per Device Type by multiplying the Fee Per Device Type (a) by the Number of Devices (b).
 - Add all Total Fee Per Device Type amounts together and that will be your Total Fee Due.
- * **Exception:** The Scanner fee is not per device. Check the box for the appropriate range.
If you have 1-3 scanners, the total due is \$130. If you have 4 or more scanners, the total due is \$250.
Check the Number of Devices (b).

Device Type	License Period	Fee Per Device Type (a)	Number of Devices (b)	Total Fee Per Device Type (a x b)
Liquid Measuring Devices				
<input type="checkbox"/> Retail Petroleum Meters	12 months	\$60	18	
<input type="checkbox"/> 0 to 30 gallons per minute	24 months	\$60		
<input type="checkbox"/> 31 to 200 gallons per minute	24 months	\$250		
<input type="checkbox"/> Over 200 gallons per minute	24 months	\$250		
Scales				
<input type="checkbox"/> 0 to 300 pounds	24 months	\$55		
<input type="checkbox"/> 301 to 5,000 pounds	24 months	\$190		
<input type="checkbox"/> 5,001 to 40,000 pounds	24 months	\$300		
<input type="checkbox"/> Over 40,000 pounds	24 months	\$400		
Scanners				
<input type="checkbox"/> Up to 3 scanners	24 months	\$130 total*	Fee for scanners is by range Check how many scanners you have <input type="checkbox"/> 1 <input type="checkbox"/> 2 <input type="checkbox"/> 3	
<input type="checkbox"/> Four or more scanners	24 months	\$250 total*	<input type="checkbox"/> 4 <input type="checkbox"/> Other _____	
Other Devices				
<input type="checkbox"/> Length Measuring Device	24 months	\$60		
<input type="checkbox"/> Taxi Cab Meter	24 months	\$130		
<input type="checkbox"/> Timing Device	24 months	\$30		
Total Fee Due				<u>1060</u>

2. Establishment Type

Provide a brief description of the establishment/business:
C-store and gas station.

Other licenses may be required depending on the type of business you are operating.

3. Acknowledgements and Signature

I hereby agree that I will comply with the applicable sections of the Wisconsin State Statutes, Administrative Code and the Milwaukee Code of Ordinances regarding the operation of weighing and measuring devices.

I understand that all devices must be operated within the specifications, tolerances and other technical requirements set forth in the National Institute of Standards and Technology Handbook 44.

I understand that the license for which I am applying must be posted on the premises or in my vehicle prior to opening for business or operating the device.

I understand that these device licenses are not transferable (with the exception of scanners). If the device is replaced or needs to be resealed, I must apply for and receive a new license so that an inspection of the device can be performed prior to its use.

I acknowledge that as a condition of being issued this license, I must allow the Health Department into the establishment to test the device to validate its specifications/tolerances. If my devices are found out of compliance, I may be charged inspection fees.

I have read, understand, and will adhere to all the above acknowledgments.

x Avtar Singh

Date: 03-15-16

Signature of Sole Proprietor, Partner, 20% or more Shareholder
or Agent – if there are no 20% or more shareholders

212 ft

132 ft

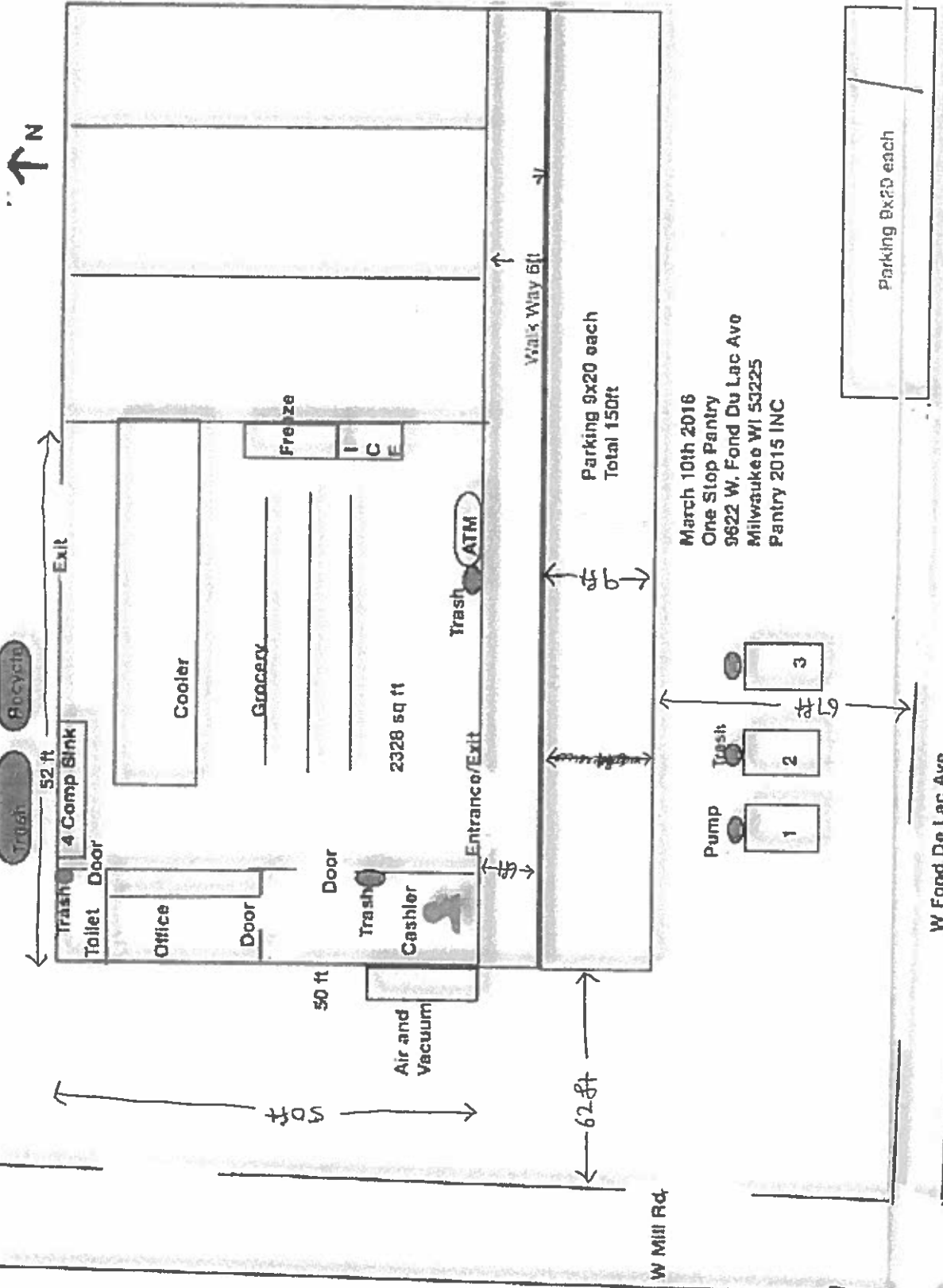

March 10th 2016
 One Stop Pantry
 3622 W. Fond Du Lac Ave
 Milwaukee WI 53225
 Pantry 2015 INC

Parking 9x20 each

W Fond De Lac Ave

W Mill Rd.



CITY OF MILWAUKEE
OFFICE OF THE CITY CLERK

Wednesday, April 27, 2016

COMMITTEE MEETING NOTICE

AD 08

JIMENEZ SEGURA, Martin, Agent
MC Jimenez LLC
2537 W National Av

Milwaukee, WI 53204

You are requested to attend a hearing which is to be held in Room 301-B, Third Floor, City Hall on:

Tuesday, May 10, 2016 at 08:30 AM

Regarding: Your Class B Tavern, Public Entertainment Premises, and Food Dealer License Renewal Applications as agent for "MC Jimenez LLC" for "Candelas" at 2537 W National Av.

There is a possibility that your application may be denied for one or more of the following reasons: The recommendation of the committee regarding the application shall be based on evidence presented at the hearing. Per MCO 85-4-4, unless otherwise specified in the code, probative evidence concerning non-renewal, suspension or revocation may include evidence of the following: failure of the applicant to meet municipal qualifications, pending charges against or the conviction of any felony, misdemeanor, municipal offense or other offense, the circumstances of which substantially relate to the circumstances of the particular licensed or permitted activity, by the applicant or by any employee or other agent of the applicant. If the activities of the applicant involve a licensed premises, whether the premises tends to facilitate a public or private nuisance or has been the source of congregations of persons which have resulted in any of the following: disturbance of the peace; illegal drug activity; public drunkenness; drinking in public; harassment of passers-by; gambling; prostitution; sale of stolen goods; public urination; theft; assaults; battery; acts of vandalism including graffiti, excessive littering, loitering, illegal parking, loud noise at times when the licensed premise is open for business; traffic violations; curfew violations; lewd conduct; display of materials harmful to minors, pursuant to s. 106-9.6; or any other factor which reasonably relates to the public health, safety and welfare, or failure to comply with the approved plan of operation. See attached police report or correspondence.

Notice for applicants with warrants or unpaid fines: Proof of warrant satisfaction or payment of fines must be submitted at the hearing on the above date and time. Failure to comply with this requirement may result in a delay of the granting/denial of your application.

Failure to appear at this meeting may result in the denial of your license. Individual applicants must appear only in person or by an attorney. Corporate or Limited Liability applicants must appear only by the agent designated on the application or by an attorney. Partnership applicants must appear by a partner listed on the application or by an attorney. If you wish to do so and at your own expense, you may be accompanied by an attorney of your choosing to represent you at this hearing.

You will be given an opportunity to speak on behalf of the application and to respond and challenge any charges or reasons given for the denial. No petitions can be accepted by the committee, unless the people who signed the petition are present at the committee hearing and willing to testify. You may present witnesses under oath and you may also confront and cross-examine opposing witnesses under oath. If you have difficulty with the English language, you should bring an interpreter with you, at your expense, so that you can answer questions and participate in your hearing.

You may examine the application file at this office during regular business hours prior to the hearing date. Inquiries regarding this matter may be directed to the person whose signature appears below.

Limited parking for persons attending meetings in City Hall is available at reduced rates (5 hour limit) at the Milwaukee Center on the southwest corner of East Kilbourn and North Water Street. Parking tickets must be validated in the first floor information booth in City Hall.

PLEASE NOTE: Upon reasonable notice, efforts will be made to accommodate the needs of disabled individuals through sign language interpreters or other auxiliary aids. For additional information or to request this service, contact the Council Services Division ADA Coordinator at (414) 286-2998, Fax - (414) 286-3456, TDD - (414) 286-2025.

JIM OWCZARSKI, CITY CLERK

BY:

Jason Schunk
License Division Manager

If you have questions regarding this notice, please contact the License Division at (414) 286-2238.

200 E. Wells Street, Room 105, City Hall, Milwaukee, WI 53202. www.milwaukee.gov/license
Phone: (414) 286-2238 Fax: (414) 286-3057 Email Address: License@milwaukee.gov

MILWAUKEE POLICE DEPARTMENT LICENSING

CRIMINAL RECORD/ORDINANCE VIOLATION/INCIDENTS SYNOPSIS

DATE: 03/30/2016

LICENSE TYPE: Class B Tavern

NEW:

RENEWAL:

No. 227444

Application Date: 03/29/2016

License Location: 2537 W National Avenue

Business Name: MC Jimenez, LLC

Licensee/Applicant: Jimenez-Segura, Martin
(Last Name, First Name, MI)

Date of Birth: 09/17/1979

Home Address: 2539 W National Avenue

City: Milwaukee

State: WI **Zip Code:** 53204

Home Phone: (414) 467-8826

This report is written by Police Officer Gilbert Gwinn, assigned to the License Investigation Unit, Days.

The Milwaukee Police Department's investigation regarding this application revealed the following:

1. On 09/13/2004, the applicant was convicted of Operating While Intoxicated (1st) in West Allis City Municipal Court license was revoked for 6 months.

The following applies to corporate officer Claudia Jimenez also known as (TORRES, Claudia):

2. On 01/07/2005, the corporate officer under the name (TORRES, Claudia) was arrested by West Allis Police Department for:

Charge: Retail Theft D. Value Greater Than \$10.00
Finding: Convicted – West Allis Municipal Court
Sentence: Fine
Date: 02/07/2005

3. On 03/14/2006, the corporate officer (Jimenez) was charged by Milwaukee County for:

Charge: Retail Theft-Intentional Conceal (<=2500)
Finding: Guilty – Milwaukee County Circuit Court
Sentence: House of Correction – Imposed and Stayed 6 months / Probation, Sentence Imposed 1 year
Date: 07/28/2006
Case#: 2006CM002042

4. On 11/30/2007 at 1:50 pm, the corporate officer (Jimenez) was cited by Milwaukee Police Department at 3557 S 27th St for:

Charge: Retail Theft
Finding: Guilty – Milwaukee Municipal Court
Sentence: \$349.00 Penalty
Date: 01/25/2008
Case#: 08002409

5. On 12/24/2009, the corporate officer (Jimenez) was arrested by West Allis Police Department for:

Charge: Retail Theft D. Value Greater Than \$10.00
Finding: Convicted
Sentence: Fine
Date: 01/25/2010

-
-
6. On 11/24/2013 the applicant was cited at 2537 West National Avenue in the city of Milwaukee for Presence of Minor at Licensed Premises (2 counts).

Charge: Presence of Minor at Licensed Premises (2 counts)
Finding: Guilty (2 counts)
Sentence: \$374.00 fine (each count)
Date: 01/31/2014
Case: 13110774
: 13110775

7. On 12/13/2014 Milwaukee police conducted a licensed premise check at 2537 West National Avenue. No violations were observed.
8. On 01/31/2015 Milwaukee police responded to a loud music complaint at 2537 West National Avenue (Candelas). Officers could hear music while standing outside at the rear of the business. They spoke to the applicant who indicated he would ask the DJ to turn down the base on the speakers and he would look into having the rear of the building sound proofed. No violations were observed and no citations were issued.

-
-
9. On 11/25/2015 Milwaukee police conducted a licensed premise check at 2537 West National Avenue. No violations were observed.

10. On 12/26/2015 Milwaukee police responded to a shots fired complaint at 2537 West National Avenue (Candela's Bar). Milwaukee police incident report #153600005 was filed regarding a casing recovered outside the premise. Upon arrival, officers discovered the front door to the business was locked and they had to knock to gain entry. Once inside, officers discovered several patrons under the legal drinking age of 21 and that the number of patrons exceeded the posted authorized occupancy of 99. Officers counted 290 patrons as they exited the business. The applicant, who was on the scene during this incident, received several citations.

Charge	1:	Presence of Minor at Licensed Premise
	2:	Licensed Premise-Immediate Police Entry Required
	3:	Licensed Premise-Exceeding Occupancy Limit
	4:	Disorderly Premises Prohibited
Finding	1:	Guilty
	2:	Guilty
	3:	Guilty
	4:	Guilty
Sentence	1:	\$150.00 fine
	2:	\$150.00 fine
	3:	\$5000.00 fine
	4:	\$150.00 fine
Date	:	03/17/2016
Case	1:	16003061
	2:	16003062
	3:	16003063
	4:	16003064

MILWAUKEE POLICE DEPARTMENT

REPORT OF INCIDENTS INVOLVING LICENSED PERSONS OR PREMISES

TO: Captain Heather WURTH

Business Name: Candelas Bar

Address of Licensed Premises: 2537 W. National Ave

District: 2

Business Phone: (414)763-898

Type of License: Class B Tavern

Violation / Incident #

Date of Incident:

Licensee or Manager on premises at time of violation / incident? Yes No

Licensee cooperative? Yes No (if no, explain in narrative section)

Licensee Notified by Officer: P.O. Shalyn ROMENS

Date: 11/25/15

Time: 10:39pm

Licensee or Agent's Name: Martin JIMENEZ SEGURA

Date of Birth: 09/17/79

Home Address: 2537 W. National Ave #Upper

Home Phone: (414)467-8826

Co-Licensee Name:

Date of Birth:

Home Address:

Home Phone:

Class S License Number:

Bartender Name:

Date of Birth:

Home Address:

Home Phone:

Class D License Number:

Licensed Person / Public Pass. Vehicle, etc.:

Date of Birth:

Home Address:

Home Phone:

Class D License Number:

VIOLATION/INCIDENT - DESCRIBE FACTS AND CIRCUMSTANCES IN NARRATIVE SECTION

Name of Person Cited:

Date of Birth:

Citation Number:

Violation & Ord. / Status No.:

Court Date:

Name of Person Cited:

Date of Birth:

Citation Number:

Violation & Ord. / Status No.:

Court Date:

Name of Person Cited:

Date of Birth:

Citation Number:

Violation & Ord. / Status No.:

Court Date:

Name of Person Cited:

Date of Birth:

Citation Number:

Violation & Ord. / Status No.:

Court Date:

Name of Person Cited:

Date of Birth:

Citation Number:

Violation & Ord. / Status No.:

Court Date:

Investigating Officer: P.O. Shalyn ROMENS *[Signature]* District / Bureau: 24

Date: 11/28/15

[Signature]
Commanding Officer

1.7.16
Date

DISPOSITION - FOR LICENSING ONLY

Citation No.	Case Number	Disposition	Judge	Date

LICENSE INVESTIGATION UNIT

Received *11/16*

Retired

By *[Signature]*

PA-33E Narrative

This report is written by P.O. Shalyn ROMENS assigned to Dist 2, Late Power Shift. On Wednesday, November 25, 2015, at approximately 10:29pm Squad 2420 (P.O. Salvador HERNANDEZ and myself) and Squad 2472 (P.O. William BAKER and David CABRAL) conducted a license premis check at ~~201 W.~~ ^{2537 W. National} Mitchell St.

Upon arrival I spoke with the Licensee, Martin JIMENEZ SEGURA. I informed JIMENEZ SEGURA of the license premis check and that no current complaints had been made.

While on the premises I did not observe any violations and JIMENEZ SEGURA was cooperative. No citations were issued. End of Report.

BWS

MILWAUKEE POLICE DEPARTMENT

REPORT OF INCIDENTS INVOLVING LICENSED PERSONS OR PREMISES

TO: Captain Heather WURTH

Business Name: Candela's Bar
Address of Licensed Premises: 2537 W National Ave
Business Phone: 414 764-8826

District: 2

Type of License: Class B

Violation / Incident # 15-360-0005 Date of Incident: 12-25-15

Licensee or Manager on premises at time of violation / Incident? Yes No

Licensee cooperative? Yes No (if no, explain in narrative section)

Licensee Notified by Officer: Salvador HERNANDEZ Date: 12-25-15 Time: 12:30AM

Licensee or Agent's Name: Martin JIMENEZ-SEGURA Date of Birth: 09-17-79
Home Address: 2539 W National Ave Home Phone: 764-8826

Co-Licensee Name: Date of Birth:
Home Address: Home Phone:
Class S License Number:

Bartender Name: Date of Birth:
Home Address: Home Phone:
Class D License Number:

Licensed Person / Public Pass. Vehicle, etc.: Date of Birth:
Home Address: Home Phone:
Class D License Number:

VIOLATION/INCIDENT - DESCRIBE FACTS AND CIRCUMSTANCES IN NARRATIVE SECTION

Name of Person Cited: Martin JIMENEZ-SEGURA Date of Birth: 09-17-79
Citation Number: 48969611281 Violation & Ord. / Statue No.: 90-19-1 Court Date: 2-10-16

Name of Person Cited: Martin JIMENEZ-SEGURA Date of Birth: 09-17-79
Citation Number: 48969611282 Violation & Ord. / Statue No.: 90-27-1-c Court Date: 2-10-16

Name of Person Cited: Martin JIMENEZ-SEGURA Date of Birth: 09-17-79
Citation Number: 48969611283 Violation & Ord. / Statue No.: 85-23-4-a Court Date: 2-10-16

Name of Person Cited: Martin JIMENEZ-SEGURA Date of Birth: 09-17-79
Citation Number: 48969611284 Violation & Ord. / Statue No.: 90-21 Court Date: 2-10-16

Name of Person Cited: Date of Birth:
Citation Number: Violation & Ord. / Statue No.: Court Date:

Investigating Officer: PO Salvador HERNANDEZ District / Bureau: 24 Date: 12-26-15

[Signature]

Commanding Officer

[Signature]

Date

DISPOSITION - FOR LICENSING ONLY

Citation No.	Case Number	Disposition	Judge	Date

LICENSE INVESTIGATION UNIT
Received *[Signature]*
Referred
By *[Signature]*

This report was typed by PO Salvador HERNANDEZ, assigned to D2, Late Power Shift. On Saturday, December 26, 2015 at 12:22am while on Squad 2464 with PO KAZACHENKO we responded to 2537 W. National Ave, regarding a shots fired complaint along with multiple other squads. All squads on scene were Squad 951 PO BORCHERT/ PO FEDERER, Squad 762 PO WILKINSON/PO KOWALIK, Squad 2340 PO BOEHN/PO RATKOWSKI, Squad 2350 PO PICENO/PO SPINATO, Squad 2472 PO JACKSON/PO JUSTUS, Squad 757 PO BURGER, Squad 761 PO MURRAY/PO RITTNER, Squad 2390 PO SPINATO, and Squad 2412 Sgt. PANNING. A total of 10 squads responded and assisted with this investigation.

The address of 2537 W. National Ave. is a licensed premise by the name of Candela's Bar. The licensee who was on the premises is Martin JIMENEZ-SEGURA w/m 09-17-79. Upon arrival, I observed many police vehicles and a large crowd outside the premises. The front door to the premises was locked and I had to knock in order to be let inside. While inside, I spoke to JIMENEZ-SEGURA who was behind the bar. I expressed to JIMENEZ-SEGURA that there appeared to be many patrons under 21 years of age. JIMENEZ-SEGURA stated there were patrons inside the establishment that were not 21 years of age but were not drinking and were not allowed by the bar. JIMENEZ-SEGURA confirmed to me that he had patrons less than 21 years of age and patrons 21 and over having a "pajama" party at his establishment. JIMENEZ-SEGURA could not assure me that the underage patrons were not drinking alcoholic beverages. I was unable to get any names of the minors due to the large amount of patrons on the premise. JIMENEZ-SEGURA was also unable to provide proof of a special permit for this event. JIMENEZ-SEGURA became bothered after I advised him that the patrons leaving his establishment were causing a disturbance, disturbing the peace outside. I advised JIMENEZ-SEGURA that police was called because shots were fired outside of his establishment by possibly patrons leaving.

JIMENEZ-SEGURA stated we were harassing him and that we should pay attention to the bars selling drugs and not his. I explained to JIMENEZ-SEGURA that I personally have responded to his establishment multiple times due to the patrons leaving his premise fighting, being loud, cruising, and discharging weapons disturbing the peace and creating a disturbance. JIMENEZ-SEGURA stated he was renting the hall to a second party and they were in charge of the party not him. I explained to JIMENEZ-SEGURA that he was the licensee and he was ultimately responsible for what occurred inside and immediately outside his door in regards to his patrons.

The maximum authorized occupancy posted was 99 patrons. JIMENEZ-SEGURA decided to end the "pajama" party while officers were on scene and asked security to start escorting patrons out. I stood with my body camera on, near the exit and began to count the number of patrons exiting. I counted 290 patrons exiting the premise excluding the patrons that were escorted out before police arrival and employees on scene. For purposes of determining the amount for this violation the court may treat each person found to have been on the premises in excess of the permitted limit as a separate violation, but not to exceed \$25,000. This violation could have had an amount of \$59,783 for 191 patrons over the posted limit but it exceeds the maximum per city ordinance. I advised JIMENEZ-SEGURA that I would be citing him for multiple violations I had observed in the establishment.

Squad 2472 PO JUSTUS/PO JACKSON located a casing outside the premise on the southwest corner of the building on the sidewalk. A separate report was filed under incident #15-360-0005. I checked the call history going back to July of 2015 and found multiple calls as follows:

- 07-27-15 The call was for a battery complaint, patrons fighting.
- 07-31-15 The call was for a battery complaint, patrons fighting.
- 08-14-15 The call was for a loud music complaint regarding the premise.
- 08-14-15 The call was for trouble with a subject, patrons fighting.
- 10-03-15 the call was for a loud music complaint regarding the premise.

JIMENEZ-SEGURA was cited for allowing underage on premises, not allowing immediate entry to police during an investigation, exceeding occupy limit by 191 patrons, and disorderly premise.

BCS



Wednesday, April 27, 2016



Notice of Public Hearing

JIMENEZ SEGURA, Martin, Agent
Candelas at 2537 W National Av

Class B Tavern, Public Entertainment Premises, and Food Dealer License Renewal Applications

Tuesday, May 10, 2016 at 8:30 AM

To whom it may concern:

The above application has been made by the above named applicant(s). This requires approval from the Licenses Committee and the Common Council of the City of Milwaukee. The hearing before the Licenses Committee will take place on 5/10/2016 at 8:30 AM, in Room 301-B, Third Floor, City Hall. If you wish, you may provide testimony at the hearing regarding the request; see below for further information. You are not required to attend the hearing. Once the Licenses Committee makes its recommendation, this recommendation is forwarded to the full Common Council for approval at its next regularly scheduled hearing. Please review the information below and if you have further questions regarding this process, please contact the License Division at (414) 286-2238.

Important details for those wishing to provide information for the Licenses Committee to consider when making its recommendation:

1. The license application is scheduled to be heard at the above time. Due to other hearings running longer than scheduled, you may have to wait some time to provide your testimony.
2. You must appear in person and testify as to matters that you have personally experienced or seen. (You cannot provide testimony for your neighbor, parent or anyone else; this is considered hearsay and cannot be considered by the committee.)
3. No letters or petitions can be accepted by the committee (unless the person who wrote the letter or the persons who signed the petition are present at the committee hearing and willing to testify).
4. Persons opposed to the license application are given the opportunity to testify first; supporters may testify after the opponents have finished.
5. When you are called to testify, you will be sworn in and asked to give your name, and address. (If your first and/or last names are uncommon please spell them.)
6. You may then provide testimony.
 - a. Include only information relating to the above license application.
 - b. Include only information you have personally witnessed or seen.
 - c. Provide concise and relevant information detailing how this business has affected or may affect the peaceful enjoyment of your neighborhood.
 - d. If by the time you have the opportunity to testify, the information you wish to share has already been provided to the committee, you may state that you agree with the previous testimony. Redundant or repetitive testimony will not assist the committee in making its recommendation.
7. After giving your testimony, the members of the Licenses Committee and the licensee may ask questions regarding the testimony you have given or other factors relating to the license application.
8. Business Competition is not a valid basis for denial or non-renewal of a license.
Please Note: If you have submitted an objection to the above application your objection cannot be considered by the committee unless you personally testify at the hearing.

CURRENT RESIDENT 908B S 26TH ST	MILWAUKEE, WI 53204-1048
CURRENT RESIDENT 909 S 25TH ST	MILWAUKEE, WI 53204-1041
CURRENT RESIDENT 909A S 25TH ST	MILWAUKEE, WI 53204-1041
CURRENT RESIDENT 911 S 25TH ST	MILWAUKEE, WI 53204-1041
CURRENT RESIDENT 911 S 26TH ST	MILWAUKEE, WI 53204-1049
CURRENT RESIDENT 911A S 25TH ST	MILWAUKEE, WI 53204-1041
CURRENT RESIDENT 915 S 25TH ST	MILWAUKEE, WI 53204-1041
CURRENT RESIDENT 917 S 25TH ST	MILWAUKEE, WI 53204-1041
CURRENT RESIDENT 921 S 25TH ST	MILWAUKEE, WI 53204-1041
CURRENT RESIDENT 925 S 25TH ST	MILWAUKEE, WI 53204-1041
CURRENT RESIDENT 926 S LAYTON BLVD	MILWAUKEE, WI 53215-1631
CURRENT RESIDENT 928 S LAYTON BLVD	MILWAUKEE, WI 53215-1631

Total Records: 180

Radius: 250.0 feet and Center of Circle: 2537 W National AV

2015-2016 Plan of Operation for 2537 W NATIONAL AV

1. Litter and Noise			
How are the grounds kept clean? <input checked="" type="checkbox"/> Sweep <input type="checkbox"/> Pressure Wash <input checked="" type="checkbox"/> Pick Up Litter <input type="checkbox"/> Other: _____			
How often will grounds be cleaned? <input checked="" type="checkbox"/> Daily <input checked="" type="checkbox"/> Weekly <input type="checkbox"/> Other: _____			
Grounds Cleaned By: <input checked="" type="checkbox"/> Licensee <input type="checkbox"/> Building Owner <input checked="" type="checkbox"/> Employees <input type="checkbox"/> Hired Maintenance <input type="checkbox"/> Other: _____			
How are noise issues prevented and/or addressed? <input checked="" type="checkbox"/> Security <input checked="" type="checkbox"/> Manager approaches customer(s) <input checked="" type="checkbox"/> Call Police <input type="checkbox"/> Signs Posted <input type="checkbox"/> Other: _____			
2. Smoking and Sanitation			
Are there designated outdoor smoking areas? <input checked="" type="checkbox"/> No <input type="checkbox"/> Yes If yes, describe the area(s) and provide location(s): _____			
Number of Garbage Cans: Inside: <u>5</u> Locations: <u>Bar, Restaurant, Kitchen</u> Outside: <u>2</u> Locations: <u>Rear part of building</u>			
Is a Crowd Control Barrier used? <input checked="" type="checkbox"/> No <input type="checkbox"/> Yes If yes, describe: _____			
Describe sanitation facilities (restrooms): <u>body cleaning</u>			
Provide name of solid waste contractor: <u>Waste Management.</u>			
3. Security			
Are there parking spaces on the premises? <input type="checkbox"/> No <input checked="" type="checkbox"/> Yes If yes, number of spaces: <u>3</u> and describe security provisions: <u>cameras</u>			
Are there designated loading areas? <input type="checkbox"/> No <input checked="" type="checkbox"/> Yes If yes, describe security provisions <u>cameras</u>			
Do you have security personnel on the premise? <input type="checkbox"/> No <input checked="" type="checkbox"/> Yes If yes, how many? <u>1</u> AND What are their responsibilities? <u>Card for under age & for arms.</u> What security equipment do they use? <u>metal detectors.</u> List their licensing, certification or training credentials: <u>none.</u>			
Are there security cameras? <input type="checkbox"/> No <input checked="" type="checkbox"/> Yes If yes, list all locations: <u>indoor & out doors.</u>			
Are searches and/or identification checks conducted upon entry? <input type="checkbox"/> No <input checked="" type="checkbox"/> Yes If yes, describe: _____			
4. Percentage of Sales (must total 100%)			
Alcohol <u>40</u> %	Food Sales <u>40</u> %	Entertainment <u>20</u> %	Other _____ %
5. Businesses On The Premise (choose all that apply):			
<input checked="" type="checkbox"/> Full Service Restaurant	<input type="checkbox"/> Cafe/Coffee Shop	<input type="checkbox"/> Deli or Fast Food Rest.	<input type="checkbox"/> Private/Fraternal/Veterans' Club
<input checked="" type="checkbox"/> Night Club	<input checked="" type="checkbox"/> Tavern	<input type="checkbox"/> Cocktail Lounge	<input type="checkbox"/> Teen Club
<input type="checkbox"/> Bowling Alley	<input type="checkbox"/> Hotel	<input checked="" type="checkbox"/> Banquet Hall	<input type="checkbox"/> Sports Facility
<input type="checkbox"/> Liquor Store	<input type="checkbox"/> Corner Store	<input type="checkbox"/> Supermarket	<input type="checkbox"/> Convenience Store
<input type="checkbox"/> Gas Station	<input type="checkbox"/> Other _____		
6. Hours of Operation and Age Restriction			
Are there any changes to the current hours of operation or age restriction? <input checked="" type="checkbox"/> No <input type="checkbox"/> Yes If yes, describe _____			
Please Note: If you will be open earlier or later than the hours listed on your current license for even one event or holiday (for example, St. Patrick's Day, Brewers Opening Day, etc.) during the license period, this must be reported and printed on your license. Your hours of operation and age restriction are listed on your current license.			
7. Floor Plan			
Are there any changes to the current floor plan? <input checked="" type="checkbox"/> No <input type="checkbox"/> Yes If yes, describe _____			
AND submit a new floor plan with this application. Changes in floor plan include changing the location of tables, games, etc. within your current licensed premises. If your changes include adding any additional areas or square footage to your premises, or any renovations to the building will be done, a Permanent Extension of Premises application must be filed.			

(1) CURRENT ENTERTAINMENT

The following types of entertainment have been approved for your current Public Entertainment Premises license: Disc Jockey, Instrumental Musicians, Bands, Jukebox, Karaoke, Pool Tables

(2) SELECT ANY TYPES OF ENTERTAINMENT THAT YOU ARE REQUESTING TO ADD *No changes in entertainment shall take place until approved by the Common Council and a new license has been issued and posted on the premises.

Grid of checkboxes for entertainment types: Instrumental Musicians, Bands, Battle of the Bands, Comedy Acts, Disc Jockey, Magic Shows, Poetry Readings, Dancing by Performers, Jukebox, Wrestling, Patron Contests, Patrons Dancing, Adult Entertainment/Strippers/Erotic Dance, Karaoke, Bowling Alley, Pool Tables, Motion Pictures, Amusement Machines - Concerts, Theatrical Performances. Includes fields for 'How many screens?' and 'Approx. # per year?'.

(3) REMOVE ENTERTAINMENT

If applicable, list any entertainment you wish to remove:

(4) WILL PROMOTERS EVER BE USED FOR ANY OF THE ENTERTAINMENT?

[X] No [] Yes, describe:

(5) LEGAL CAPACITY OF PREMISES

99 (Call the Milwaukee Development Center at 414-286-8211 if you have questions.) Your legal capacity will determine the license fee for your Public Entertainment Premise License. If you would like to request that the license be approved with a lower capacity than that listed above, indicate lower capacity. If approved, this lower capacity will print on your license and override the capacity listed on your Occupancy Permit.

(6) IDENTIFY IF SOUND AMPLIFICATION IS USED

[] No [X] Yes, describe: amplifier used by DJs & groups.

(7) DECLARATIONS, ACKNOWLEDGEMENTS, & DISCLOSURES

Read And Initial Each Item Confirming Your Understanding:

- 1. [X] I understand that after the license has been issued, a change to the plan of operation will require a written request to change and approval from the Common Council.
2. [X] I agree to inform the City Clerk within 10 days of any substantial changes in the information supplied in this application.
3. [X] I understand that I shall not willfully refuse to provide the services offered under this license, or add charges or require deposits not required of the general public because of race, color, sex, religion, national origin or ancestry, age, handicap, lawful source of income, marital status, sexual orientation, gender identity or expression, familial status or the fact that a person is now or has been a member of the military service, whether dressed in uniform or not; and shall not seek such information as a condition of employment, or penalize any employee or discriminate in the selection of personnel for training or promotion on the basis of such information.
4. [X] I have knowledge of the City Ordinances currently regulating public entertainment, and understand that the license may be subject to suspension, non-renewal or revocation, if I violate any rule, law or regulation of the city of Milwaukee and State of Wisconsin.

(8) NOTARIZED SIGNATURES OF APPLICANTS

SUBSCRIBED AND SWORN TO BEFORE ME

This 25 day of March, 2017

(Clerk/Notary Public) My Commission Expires 11/17/17

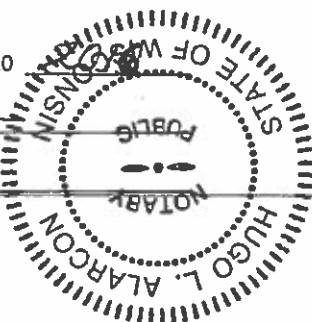

Handwritten signatures of Agent/Owner/Partner and Additional Owner/Partner.

*Notary Seal must be affixed.



FOOD DEALER LICENSE SUPPLEMENTAL RENEWAL APPLICATION

Office of the City Clerk License Division
200 E. Wells St. Room 105, Milwaukee, WI 53202
(414) 286-2238 license@milwaukee.gov www.milwaukee.gov/license

JIMENEZ SEGURA, Martin, Agent
MC Jimenez LLC
2537 W NATIONAL AV
Milwaukee WI 53204

Current License Expiration Date: 6/30/2016
Application Due Date: 4/14/2016
\$75 Late Fee Begins: 4/15/2016
Aligned to Expire with your: Class B Tavern License on: 5/20/2016

RENEWAL FEE: ~~\$733.37~~ 800.00
FREST 6638
previously aligned

SECTION 1 - HOURS OF OPERATION

Are there any changes to the current hours of operation? NO IF NO, SKIP THIS SECTION
 YES IF YES, DESCRIBE: 11:00 am to
Sunday to Monday 1.45 a.m.

Your current hours of operation are listed on your current license.
Please note: If you will be open earlier or later than the hours listed on your current license for even one event or holiday (for example, St. Patrick's Day, Brewers Opening Day, etc.) during the license period, this must be reported and printed on your license.

SECTION 2 - LITTER & NOISE

Are there any changes to your Litter/Noise plan? NO IF NO, SKIP THIS SECTION
 YES IF YES, ANSWER QUESTIONS BELOW

What are your plans to keep the grounds clean? Sweep Pressure Wash Pick Up Litter Hired Maintenance
 Building Owner's Responsibility Garbage Cans Outside Other _____

How often will the grounds be cleaned? Daily Weekly As Needed Monthly Other _____

Who will keep the grounds clean? Licensee Building Owner Employees Hired Maintenance Other _____

How are noise issues prevented/addressed? Security Manager approaches customer(s) Call police Signs posted
 Other _____

SECTION 3 - ACKNOWLEDGEMENT & SIGNATURE

The current license includes the following business operations: **DHS - COMPLEX, Sales \$20,001 - \$200,000, Tavern Restaurant, Caterer**

Except for any changes of hours of operation listed in Section 1, I confirm that no changes are being made to the business operations for the 2016-2017 renewal period.

Signature of Individual, Partner, Agent or 20% or More Shareholder