



**CITY OF MILWAUKEE
OFFICE OF THE CITY CLERK**

Monday, December 21, 2015

COMMITTEE MEETING NOTICE

AD 02

GRIFFIN, Angela D, Agent
White Elephant Catering Co.
PO Box 240378

Milwaukee, WI 53224

You are requested to attend a hearing which is to be held in Room 301-B, Third Floor, City Hall on:

Tuesday, January 05, 2016 at 08:30 AM

Regarding: Your Food Dealer -Restaurant Renewal Application with Change of Agent and Shareholder as agent for "White Elephant Catering Co." for "White Elephant Catering Company" at 6005 W Villard Av.

There is a possibility that your application may be denied for one or more of the following reasons: The recommendation of the committee regarding the application shall be based on evidence presented at the hearing. Per  O 85-4-4, unless otherwise specified in the code, probative evidence concerning non-renewal, suspension or revocation may include evidence of the following: failure of the applicant to meet municipal qualifications, pending charges against or the conviction of any felony, misdemeanor, municipal offense or other offense, the circumstances of which substantially relate to the circumstances of the particular licensed or permitted activity, by the applicant or by any employee or other agent of the applicant. If the activities of the applicant involve a licensed premises, whether the premises tends to facilitate a public or private nuisance or has been the source of congregations of persons which have resulted in any of the following: disturbance of the peace; illegal drug activity; public drunkenness; drinking in public; harassment of passers-by; gambling; prostitution; sale of stolen goods; public urination; theft; assaults; battery; acts of vandalism including graffiti, excessive littering, loitering, illegal parking, loud noise at times when the licensed premise is open for business; traffic violations; curfew violations; lewd conduct; display of materials harmful to minors, pursuant to s. 106-9.6; or any other factor which reasonably relates to the public health, safety and welfare, or failure to comply with the approved plan of operation. See attached police report or correspondence.

**Notice for applicants with
warrants or unpaid fines:**

Proof of warrant satisfaction or payment of fines must be submitted at the hearing on the above date and time. Failure to comply with this requirement may result in a delay of the granting/denial of your application.

Failure to appear at this meeting may result in the denial of your license. Individual applicants must appear only in person or by an attorney. Corporate or Limited Liability applicants must appear only by the agent designated on the application or by an attorney. Partnership applicants must appear by a partner listed on the application or by an attorney. If you wish to do so and at your own expense, you may be accompanied by an attorney of your choosing to represent you at this hearing.

You will be given an opportunity to speak on behalf of the application and to respond and challenge any charges or reasons given for the denial. No petitions can be accepted by the committee, unless the people who signed the petition are present at the committee hearing and willing to testify. You may present witnesses under oath and you may also confront and cross-examine opposing witnesses under oath. If you have difficulty with the English language, you should bring an interpreter with you, at your expense, so that you can answer questions and participate in your hearing.

You may examine the application file at this office during regular business hours prior to the hearing date. Inquiries regarding this matter may be directed to the person whose signature appears below.

Limited parking for persons attending meetings in City Hall is available at reduced rates (5 hour limit) at the Milwaukee Center on the southwest corner of East Kilbourn and North Water Street. Parking tickets must be validated in the first floor information booth in City Hall.

PLEASE NOTE: Upon reasonable notice, efforts will be made to accommodate the needs of disabled individuals through sign language interpreters or other auxiliary aids. For additional information or to request this service, contact the Council Services Division ADA Coordinator at (414) 286-2998, Fax - (414) 286-3456, TDD - (414) 286-2025.

JIM OWCZARSKI, CITY CLERK

BY: _____

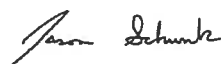

Jason Schunk
License Division Manager

If you have questions regarding this notice, please contact the License Division at (414) 286-2238.

200 E. Wells Street, Room 105, City Hall, Milwaukee, WI 53202. www.milwaukee.gov/license
Phone: (414) 286-2238 Fax: (414) 286-3057 Email Address: License@milwaukee.gov

MILWAUKEE POLICE DEPARTMENT

LICENSING

CRIMINAL RECORD/ORDINANCE VIOLATION/INCIDENTS SYNOPSIS

DATE: 11/30/2015

LICENSE TYPE: FOOD DEALER-RESTAURANT

NEW: ☐

RENEWAL: ☒

No. 222087

Application Date: 11/25/2015

License Location: 6005 W Villard Av

Business Name: White Elephant Catering Co.

Licensee/Applicant: GRIFFIN, Angela D
(Last Name, First Name, MI)

Date of Birth: 03/02/1978

Home Address:

City: Milwaukee

State: WI **Zip Code:** 53212

Home Phone:

This report is written by Police Officer David NOVAK, assigned to the License Investigation Unit, Days.

The Milwaukee Police Department's investigation regarding this application revealed the following:

1. On 01/23/2009 the applicant was cited in the City of Milwaukee at 945 N. 12th St for

Charge: PP Vehicle-Driver's license Required
Finding: Guilty
Sentence: Fined \$361.00
Date: 03/17/2009
Case: 0902655

2. On 03/29/2014 the applicant was cited in the City of Milwaukee at 3526 W. Villard Av for 2 counts of Responsibility of Parents (curfew)

Charge: Responsibility of Parents (curfew)
Responsibility of Parents (curfew)
Finding: Guilty (Both charges)
Sentence: Fined \$185.00 each charge
Date: 05/19/2014
Case: 14028399
14028400



Monday, December 21, 2015



Notice of Public Hearing

GRIFFIN, Angela D, Agent
White Elephant Catering Company at 6005 W Villard Av
Food Dealer -Restaurant Renewal Application with Change of Agent and Shareholder

Tuesday, January 05, 2016 at 8:30 AM

To whom it may concern:

The above application has been made by the above named applicant(s). This requires approval from the Licenses Committee and the Common Council of the City of Milwaukee. The hearing before the Licenses Committee will take place on 1/5/2016 at 8:30 AM, in Room 301-B, Third Floor, City Hall. If you wish, you may provide testimony at the hearing regarding the request; see below for further information. You are not required to attend the hearing. Once the Licenses Committee makes its recommendation, this recommendation is forwarded to the full Common Council for approval at its next regularly scheduled hearing. Please review the information below and if you have further questions regarding this process, please contact the License Division at (414) 286-2238.

Important details for those wishing to provide information for the Licenses Committee to consider when making its recommendation:

1. The license application is scheduled to be heard at the above time. Due to other hearings running longer than scheduled, you may have to wait some time to provide your testimony.
2. You must appear in person and testify as to matters that you have personally experienced or seen. (You cannot provide testimony for your neighbor, parent or anyone else; this is considered hearsay and cannot be considered by the committee.)
3. No letters or petitions can be accepted by the committee (unless the person who wrote the letter or the persons who signed the petition are present at the committee hearing and willing to testify).
4. Persons opposed to the license application are given the opportunity to testify first; supporters may testify after the opponents have finished.
5. When you are called to testify, you will be sworn in and asked to give your name, and address. (If your first and/or last names are uncommon please spell them.)
6. You may then provide testimony.
 - a. Include only information relating to the above license application.
 - b. Include only information you have personally witnessed or seen.
 - c. Provide concise and relevant information detailing how this business has affected or may affect the peaceful enjoyment of your neighborhood.
 - d. If by the time you have the opportunity to testify, the information you wish to share has already been provided to the committee, you may state that you agree with the previous testimony. Redundant or repetitive testimony will not assist the committee in making its recommendation.
7. After giving your testimony, the members of the Licenses Committee and the licensee may ask questions regarding the testimony you have given or other factors relating to the license application.
8. Business Competition is not a valid basis for denial or non-renewal of a license.
Please Note: If you have submitted an objection to the above application your objection cannot be considered by the committee unless you personally testify at the hearing.

RESIDENT	MAIL ADDRESS	CITY AND ZIP CODE
CURRENT RESIDENT	5131 N 60TH ST	MILWAUKEE, WI 53218-4104
CURRENT RESIDENT	5132 N 60TH ST	MILWAUKEE, WI 53218-4103
CURRENT RESIDENT	5138 N 60TH ST	MILWAUKEE, WI 53218-4103
CURRENT RESIDENT	5145 N 60TH ST	MILWAUKEE, WI 53218-4104
CURRENT RESIDENT	5146 N 60TH ST	MILWAUKEE, WI 53218-4103
CURRENT RESIDENT	5147 N 58TH ST	MILWAUKEE, WI 53218-4251
CURRENT RESIDENT	5150 N 61ST ST	MILWAUKEE, WI 53218-4111
CURRENT RESIDENT	5151 N 58TH ST	MILWAUKEE, WI 53218-4251
CURRENT RESIDENT	5153 N 60TH ST	MILWAUKEE, WI 53218-4104
CURRENT RESIDENT	5156 N 60TH ST	MILWAUKEE, WI 53218-4103
CURRENT RESIDENT	5156 N 61ST ST	MILWAUKEE, WI 53218-4111
CURRENT RESIDENT	5157 N 58TH ST	MILWAUKEE, WI 53218-4251
CURRENT RESIDENT	5158 N 61ST ST	MILWAUKEE, WI 53218-4111
CURRENT RESIDENT	5161 N 60TH ST	MILWAUKEE, WI 53218-4104
CURRENT RESIDENT	5162 N 60TH ST	MILWAUKEE, WI 53218-4103
CURRENT RESIDENT	5163 N 58TH ST	MILWAUKEE, WI 53218-4251
CURRENT RESIDENT	5163 N 61ST ST	MILWAUKEE, WI 53218-4112
CURRENT RESIDENT	5164 N 61ST ST	MILWAUKEE, WI 53218-4111
CURRENT RESIDENT	5167 N 61ST ST	MILWAUKEE, WI 53218-4112
CURRENT RESIDENT	5168 N 61ST ST	MILWAUKEE, WI 53218-4111
CURRENT RESIDENT	5169 N 61ST ST	MILWAUKEE, WI 53218-4112
CURRENT RESIDENT	5173 N 61ST ST	MILWAUKEE, WI 53218-4112
CURRENT RESIDENT	5174 N 61ST ST	MILWAUKEE, WI 53218-4111
CURRENT RESIDENT	5175 N 61ST ST	MILWAUKEE, WI 53218-4112
CURRENT RESIDENT	5182 N 61ST ST	MILWAUKEE, WI 53218-4111
CURRENT RESIDENT	5183 N 61ST ST	MILWAUKEE, WI 53218-4112
CURRENT RESIDENT	5211 N 61ST ST	MILWAUKEE, WI 53218-3102
CURRENT RESIDENT	5216 N 60TH ST	MILWAUKEE, WI 53218-3257
CURRENT RESIDENT	5221 N 60TH ST	MILWAUKEE, WI 53218-3258
CURRENT RESIDENT	5221A N 60TH ST	MILWAUKEE, WI 53218-3258
CURRENT RESIDENT	5222 N 60TH ST	MILWAUKEE, WI 53218-3257
CURRENT RESIDENT	5222 N 61ST ST 1	MILWAUKEE, WI 53218-3103
CURRENT RESIDENT	5222 N 61ST ST 2	MILWAUKEE, WI 53218-3103
CURRENT RESIDENT	5222 N 61ST ST 3	MILWAUKEE, WI 53218-3103
CURRENT RESIDENT	5222 N 61ST ST 4	MILWAUKEE, WI 53218-3103
CURRENT RESIDENT	5222 N 61ST ST 5	MILWAUKEE, WI 53218-3103
CURRENT RESIDENT	5222 N 61ST ST 6	MILWAUKEE, WI 53218-3103
CURRENT RESIDENT	5224 N 60TH ST	MILWAUKEE, WI 53218-3257
CURRENT RESIDENT	6100 W VILLARD AVE	MILWAUKEE, WI 53218-4142
CURRENT RESIDENT	6101 W VILLARD AVE	MILWAUKEE, WI 53218-4143
CURRENT RESIDENT	6109 W VILLARD AVE	MILWAUKEE, WI 53218-4143

Total Records: 42

Radius: 250.0 feet and Center of Circle: 6005 W Villard AV



FOOD DEALER LICENSE SUPPLEMENTAL RENEWAL APPLICATION

Office of the City Clerk License Division

200 E. Wells St. Room 105, Milwaukee, WI 53202

(414) 286-2238 license@milwaukee.gov www.milwaukee.gov/license

THIGPEN, Willie, Agent
White Elephant Catering Co.
PO BOX 241400
Milwaukee WI 53224

RENEWAL FEE = \$800

FREST 6046

Current License Expiration Date: 11/24/2015

Application Due Date 9/11/2015

\$75 Late Fee Begins 9/25/2015

\$125 Late Fee Begins 11/14/2015

SECTION 1 – BUSINESS OPERATIONS

Are there any changes to the current hours of operation? ☒ NO ☐ YES If yes, describe changes:

Your current hours of operation are listed on your current license.

Please note: If you will be open earlier or later than the hours listed on your current license for even one event or holiday (for example, St. Patrick's Day, Brewers Opening Day, etc.) during the license period, this must be reported and printed on your license.

Do you purchase, sell or exchange any secondhand articles of personal property (including used cell phones)?

☒ NO ☐ YES If yes, you must also apply for a Secondhand Dealer License.

SECTION 2 – PLAN OF OPERATION (LITTER/NOISE ISSUES)

Are there any changes to your Litter/Noise plan? ☒ NO ☐ YES If yes, answer all questions below:

What are your plans to keep the grounds clean? (check all that apply)

☒ Sweep ☐ Pressure Wash ☒ Pick Up Litter ☒ Hired Maintenance ☒ Building Owner's Responsibility ☒ Garbage Cans Outside
☐ Other _____

How often will the grounds be cleaned?

☒ Daily ☐ Weekly ☐ As Needed ☐ Monthly ☐ Other _____

Who is responsible to keep the grounds clean? (check all that apply)

☒ Licensee ☒ Building Owner ☒ Employees ☒ Hired Maintenance ☐ Other _____

How are noise issues prevented/addressed? (check all that apply)

☐ Security ☐ Manager approaches customer(s) ☐ Call police ☐ Signs posted ☒ Other No Public Noise

SECTION 3 - SIGNATURE

By signing below, I certify that all the information on this application is correct and acknowledge that any change in the information on the application shall be reported to the City Clerk's License Division within 10 days of the change. I shall promptly notify the City Clerk's License Division in writing if my establishment ceases operation. If a restaurant, I shall not willfully refuse to provide those services offered under this license to add charges or required deposits not required of the general public because of race, color sex, religion, national origin or ancestry, age handicap, lawful source of income, marital status, sexual orientation, gender identity or expression, familial status or the fact that the person is now or has been a member of military service, whether dressed in uniform or not.

The current license includes the following business operations: **DHS - COMPLEX, Restaurant**

Except for any changes of hours of operation listed in Section 1, I confirm that no changes are being made to the business operations for the 2015-2016 license period.

SIGNATURE OF INDIVIDUAL, PARTNER, AGENT OR 20% OR MORE SHAREHOLDER

[Handwritten Signature]

ALSO COMPLETE REVERSE SIDE →



**CITY OF MILWAUKEE
OFFICE OF THE CITY CLERK**

Monday, December 21, 2015

COMMITTEE MEETING NOTICE

AD 05

NGUYEN, Jack V, Agent
PPHO LLC
315 Stonebrook DR

Waukesha, WI 53186

You are requested to attend a hearing which is to be held in Room 301-B, Third Floor, City Hall on:

Tuesday, January 05, 2016 at 08:30 AM

Regarding: Your Class B Beer License Application as agent for "PPHO LLC" for "Pho Lovers" at 5430 N LOVERS LANE.

There is a possibility that your application may be denied for one or more of the following reasons: The recommendation of the committee regarding the application shall be based on evidence presented at the hearing. MCO 85-2.7-4, probative evidence concerning whether or not a new license should be granted may be presented on the following subjects: whether or not the applicant meets the municipal requirements, the appropriateness of the location and premises where the licensed premises is to be located and whether use of the premises for the purposes or activities permitted by the license would tend to facilitate a public or private nuisance or create undesirable neighborhood problems such as disorderly patrons, unreasonably loud noise, litter, and excessive traffic and parking congestion. Probative evidence relating to these matters may be taken from the plan of operation submitted with the license application, if any, but shall not include the content of any music. Evidence regarding the fitness of the location of the premises to be maintained as the principal place of business, including but not limited to whether there is an overconcentration of businesses of the type for which the license is sought; whether the proposal is consistent with any pertinent neighborhood business or development plans, or the location's proximity to areas where children are typically present. The applicant's record in operating similarly licensed premises; and whether or not the applicant has been charged with or convicted of any felony, misdemeanor, municipal offense or other offense, the circumstances of which substantially relate to the activity to be permitted by the license being applied for or any other factor which reasonably relates to the public health, safety or welfare may also be considered. See attached police report or correspondence.

**Notice for applicants with
warrants or unpaid fines:**

Proof of warrant satisfaction or payment of fines must be submitted at the hearing on the above date and time. Failure to comply with this requirement may result in a delay of the granting/denial of your application.

Failure to appear at this meeting may result in the denial of your license. Individual applicants must appear only in person or by an attorney. Corporate or Limited Liability applicants must appear only by the agent designated on the application or by an attorney. Partnership applicants must appear by a partner listed on the application or by an attorney. If you wish to do so and at your own expense, you may be accompanied by an attorney of your choosing to represent you at this hearing.

You will be given an opportunity to speak on behalf of the application and to respond and challenge any charges or reasons given for the denial. No petitions can be accepted by the committee, unless the people who signed the petition are present at the committee hearing and willing to testify. You may present witnesses under oath and you may also confront and cross-examine opposing witnesses under oath. If you have difficulty with the English language, you should bring an interpreter with you, at your expense, so that you can answer questions and participate in your hearing.

You may examine the application file at this office during regular business hours prior to the hearing date. Inquiries regarding this matter may be directed to the person whose signature appears below.

Limited parking for persons attending meetings in City Hall is available at reduced rates (5 hour limit) at the Milwaukee Center on the southwest corner of East Kilbourn and North Water Street. Parking tickets must be validated in the first floor information booth in City Hall.

PLEASE NOTE: Upon reasonable notice, efforts will be made to accommodate the needs of disabled individuals through sign language interpreters or other auxiliary aids. For additional information or to request this service, contact the Council Services Division ADA Coordinator at (414) 286-2998, Fax - (414) 286-3456, TDD - (414) 286-2025.

JIM OWCZARSKI, CITY CLERK

BY: _____

Jason Schunk
License Division Manager

If you have questions regarding this notice, please contact the License Division at (414) 286-2238.

MILWAUKEE POLICE DEPARTMENT

LICENSING

CRIMINAL RECORD/ORDINANCE VIOLATION/INCIDENTS SYNOPSIS

DATE: 11/05/2015

LICENSE TYPE: BBEER

NEW: ☒

RENEWAL: ☐

No. 221017

Application Date: 11/04/2015

License Location: 5430 North Lovers Lane

Business Name: PPHO LLC

Licensee/Applicant: Nguyen, Jack V.
(Last Name, First Name, MI)

Date of Birth: 07/10/1978

Home Address: 315 Stonebrook Drive

City: Waukesha

State: WI **Zip Code:** 53186

Home Phone: 414-839-8904

This report is written by Police Officer Gilbert Gwinn, assigned to the License Investigation Unit, Days.

The Milwaukee Police Department's investigation regarding this application revealed the following:

1. On 06/24/2014 the Wisconsin Department of Transportation revoked Phuc Nguyen's driver's license for 6 months for Operating While Intoxicated. Phuc Nguyen is listed on the application as 50% shareholder.

Date: 11/24/15
Officer: Tracey Geniesse

City of Milwaukee Police Department
90-5-1.5 Crime Prevention Survey
Tavern Inspection

Name of Premise: Pho Lovers
Address: 5430 N Lovers Lane Rd
Phone: 414-466-6880

Owner: Jack V. Nguyen 10/8/73
Owner address: 315 Stonebrook Dr
City State Zip: Waukesha, WI 53186
Owner Phone: 414-839-8904
Owner email: jacknquyen78@gmail.com

Licensee/Agent: Jack V. Nguyen
Home Address: 315 Stonebrook Dr
City State Zip: Waukesha, WI. 53186
Phone: 414-839-8904
Email: jacknguyen78@gmail.com

Preferred contact: Jack Nguyen

Location currently open: ☒ YES ☐ NO

Projected open date:

Day's open: ☒S ☒M ☒T ☒W ☐Th ☐F ☒SA ☐ALL

Hours of Operation: Sun: 10a-8p 24 hours ☐Y ☒N
Mon: 10a-9p
Tue: 10a-9p
Wed: 10a-9p
Thu: closed
Fri: 10a-9p
Sat: 10a-9p

Premise Type: ☐ Tavern/Bar
☒ Restaurant
☐ Other:

23. Do all employees know how to retrieve recorded digital images/footage? ☐Yes ☒No
24. Cameras located in parking lot ☐Yes ☒No How many0

Interior Survey:

25. What is the planned/posted capacity 65
26. What is the minimum number of employees that will be on premise unknown
27. Is the storeowner willing to be a standing complainant regarding loitering? ☐Yes ☐No
a. If yes have them fill out the standing complaint form and give them two of the commercial signs ☐Yes ☐No
28. Is the interior of the location neat and clean? ☒Yes ☐No
29. Does an interior camera face the entrance/exit? ☒Yes ☐No
30. Are emergency and non-emergency numbers posted near the phone? ☐Yes ☒No
31. Does the owner know how to contact their police district directly? ☐Yes ☒No
a. Did you provide a district contact guide to the owner? ☒Yes ☐No

Security

32. How many security personnel are going to be employed: 0
33. How will they be deployed: Interior 0 Exterior0
34. What days will they be deployed ☐Mon☐Tue☐Wed☐Thu☐Fri☐Sat☐Sun
35. Will the security be managed by business ☐or contracted☐
36. Will they be armed ☐Yes ☐No
37. What type of security measures will be used:
☐Wanding/metal detector
☐ID Scanner
☐Dress Code
☐Cover Charge
☐Age restriction
☐Other
38. When at capacity, how will the overflow crowd be managed? 0
39. Will a guard monitor the overflow crowd at all times? ☐Yes ☐No

ADDITIONAL COMMENTS/RECOMMENDATIONS:

The following recommendations were made: Have cameras placed in the parking lot, post no loitering signs on the exterior of the building, as well as standing complaint form. Storage for cameras to be stored for thirty days.

Jack was not there, however I spoke with Phue Van Nguyen A/M 10/08/73 1517 S Wildwood Dr. New Berlin, WI 53151 414-520-5774, who is part owner of the business as well. He stated he did not have all of the information, but would make sure to have Jack provide the rest of the information.

Alcohol License Concentration for 5430 N Lovers Lane Rd

City of Milwaukee, Wisconsin

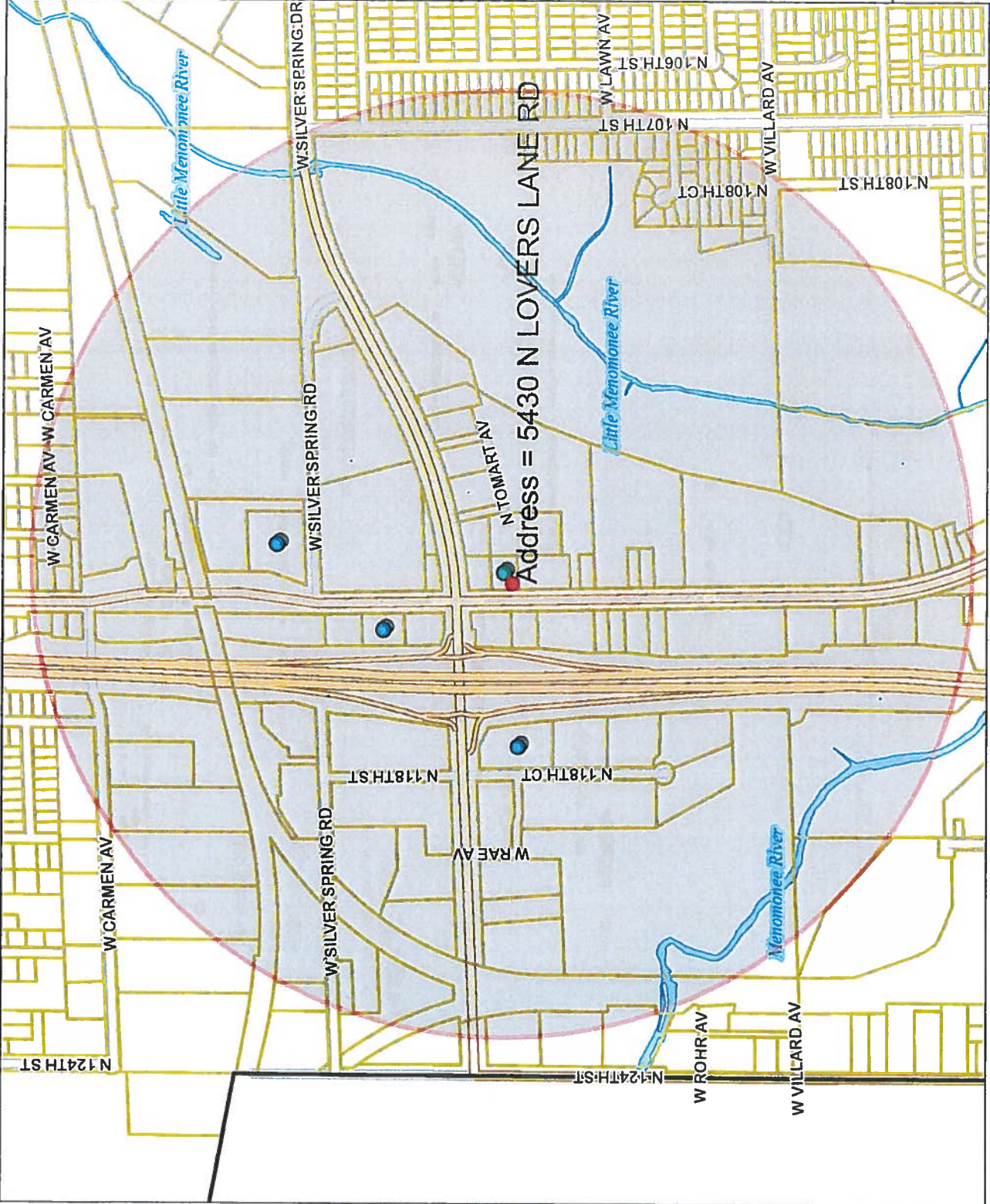

- Legend -

- City limits
- Parcels
- Freeways
- Exit ramps
- Entry ramps
- Ramps
- Major streets
- Streets
- Waterways
- Alcohol licenses
 - Class A intoxicating liquor
 - Class A fermented malt beverage
 - Class A liquor and malt
 - Class B fermented malt beverage
 - Class B tavern
 - Class C wine retailer

- Notes -

Licensed Alcohol Establishments Within a .5 Mile Radius Centered on 5430 N Lovers Lane Rd on 11/04/2015



Department of Administration - ITMD



Map Scale: 1: 9,525



Monday, December 21, 2015

Licenses Committee Notice of Hearing

Recycling Richards Street LLC c/o Holzem
2557 Whispering Oak Ct

De Pere, WI 54115

Date: 1/5/2016
Time: 08:30 AM
Location: Room 301-B, Third Floor, City Hall

The Licenses Committee will consider the following license application:

Class B Beer License Application
NGUYEN, Jack V, Agent
Pho Lovers at 5430 N LOVERS LANE

Please note this application may be recommended for denial based on fitness of the location due to concentration of alcohol beverage outlets in the area. If the application is denied for this reason, no other application for an alcohol beverage license for this location shall be recommended for approval by the Licenses Committee within three years of the date of denial unless the applicant has demonstrated a change of circumstances since the prior denial.

If you have any questions, please call (414) 286-2238.





Monday, December 21, 2015

Licenses Committee Notice of Hearing

Michael Truong
8010 N 61st St

Milwaukee, WI 53223

Date: 1/5/2016
Time: 08:30 AM
Location: Room 301-B, Third Floor, City Hall

The Licenses Committee will consider the following license application:

Class B Beer License Application
NGUYEN, Jack V, Agent
Pho Lovers at 5430 N LOVERS LANE

Please note this application may be recommended for denial based on fitness of the location due to concentration of alcohol beverage outlets in the area. If the application is denied for this reason, no other application for an alcohol beverage license for this location shall be recommended for approval by the Licenses Committee within three years of the date of denial unless the applicant has demonstrated a change of circumstances since the prior denial.

If you have any questions, please call (414) 286-2238.





BUSINESS LICENSE PLAN OF OPERATION

Office of the City Clerk License Division

200 E. Wells St. Room 105, Milwaukee, WI 53202

(414) 286-2238 www.milwaukee.gov/license e-mail address: license@milwaukee.gov

ccl-busplan 7/24/15

1. Type of Business

- Applying for: ☐ Extended Hours Establishment ☐ Filling Station ☐ Waste Tire Transporter ☐ Massage Establishment
☐ Self Service Laundry ☐ Rooming House: Number of Units: _____ ☐ Hotel/Motel: Number of Units: _____
☒ Other (supplemental application for specific license also required)

Provide a detailed description of the type of business you plan on operating:

Sit down family restaurant

Do you have any experience operating this type of business? ☒ No ☐ Yes If yes, explain:

2. Business Operations

- a. Proposed Opening Date: 9/1/2015
- b. Is this premise under construction? ☒ No ☐ Yes If yes, list estimated completion date: _____
- c. Is this a franchise? ☒ No ☐ Yes
- d. Is this premises currently licensed? ☐ No ☒ Yes If yes, list type of license: food license
- e. Is the current licensee operating? ☐ No ☒ Yes If no, list date closed: 8/31/2015
- f. Do you have future plans for other businesses, licenses or permits at this location? ☒ No ☐ Yes
If yes, explain: _____
- g. Have you previously held an Extended Hours License in Milwaukee? ☒ No ☐ Yes
If yes, list address(es): _____
- h. Are other businesses operating in the same building? ☒ No ☐ Yes If yes, describe: _____

3. Litter & Noise Control

- a. How are grounds kept clean? ☒ Sweep ☐ Pressure Wash ☒ Pick Up Litter ☐ Hired Maintenance
☐ Building Owner Responsibility ☒ Garbage Cans Outside ☐ Other: _____
- b. How often will grounds be cleaned? ☒ Daily ☐ Weekly ☐ As Needed ☐ Monthly ☐ Other: _____
- c. Grounds cleaned by: ☒ Licensee ☐ Building Owner ☒ Employees ☐ Hired Maintenance ☐ Other: _____
- d. How are noise issues prevented and/or addressed? ☐ Security ☒ Manager approaches customer(s) ☐ Call Police
☐ Signs Posted ☐ Other: _____
Will a sound amplification system be used? ☒ No ☐ Yes If yes, describe: _____
- e. Are there designated outdoor smoking areas? ☒ No ☐ Yes If yes, describe: _____
- f. Number of Garbage Cans: Inside: 5 Locations: kitchen, prep, wash, front
Outside: 2 Locations: in the back
- g. Is a crowd control barrier used? ☒ No ☐ Yes If yes, describe: _____
- h. Describe sanitation facilities (restrooms): 2 restrooms with stalls and sinks
- i. Name of solid waste contractor: ☐ Advanced Disposal ☒ Waste Management ☐ Other: _____

4. Parking & Security

- a. Are there off-street parking places? ☐ No ☒ Yes If yes, how many? 30
Describe security plan for parking lot: lights
- b. Is there a loading zone? ☒ No ☐ Yes If yes, describe security for loading zone _____
- c. Will you have security personnel on premise? ☒ No ☐ Yes If yes, how many? _____
What are their responsibilities? _____
Is security equipment used? ☒ No ☐ Yes If yes, describe _____
List their licensing, certification, or training credentials _____
Will there be security cameras? ☐ No ☒ Yes If yes, where? inter whole store
Will searches or identification checks be conducted upon entry? ☒ No ☐ Yes If yes, describe _____

5. Percentage of Sales (must total 100%)

Alcohol <u>1</u> %	Food <u>99</u> %	Secondhand Merchandise <u>0</u> %	Precious Metals & Gems <u>0</u> %
Entertainment <u>0</u> %	Cigarettes <u>0</u> %		
Pawnbroker Activity <u>0</u> %	Salvaged Materials <u>0</u> % (such as scrap metal)	Personal Services (such as tattoo, body piercing, salon, tailor, tanning, etc.) <u>0</u> %	Other <u>0</u> % Describe: _____

6. Businesses/Licenses on the Premises (check all that apply):

Type 1

- ☒ Full Service Restaurant ☐ Cafe/Coffee Shop ☐ Deli or Fast Food Restaurant ☐ Private/Fraternal/Veterans Club
☐ Night Club ☐ Tavern ☐ Cocktail Lounge ☐ Teen Club
☐ Banquet Hall ☐ Sports Facility
☐ Hotel/Motel - Number of Rooms: _____ ☐ Rooming House - Number of Rooms: _____

Type 2

- ☐ Liquor Store ☐ Corner Store ☐ Supermarket ☐ Convenience Store
☐ Gas Station ☐ Amusement/Phonograph Distributor ☐ Auto Wrecker
☐ Used Car Dealer ☐ Used Auto Parts ☐ Personal Service Establishment (such as tattoo business, hair salon, tailor, etc.) ☐ Recording Studio

What other types of licenses/permits will you hold at this location? (check all that apply)

- ☒ Occupancy Permit ☐ Cigarette & Tobacco ☐ Gas Station ☐ Extended Hours ☐ Class "B" Tavern ☐ Weights & Measures
☐ Secondhand Dealer ☐ Precious Metal & Gem ☐ Other: _____

7. Legal Capacity (only if a Type 1 premises in #6 above)

Capacity 65 (Call the Milwaukee Development Center at 414-286-8211 if you have questions.)

8. Premises Description

d. Identify all area(s) of the premises that will be used in operating this business (include areas used only for storage):

☒ 1st Floor ☐ 2nd Floor ☐ Basement Storage ☐ Patio ☐ Beer Garden ☐ Sidewalk Café ☐ Deck ☐ Rooftop

☐ Other: Describe: _____

e. Describe Location: ☒ Major Thoroughfare ☐ Secondary Street ☐ Other: _____

f. Nearest Major Cross Street: Silver Spring & Mayfair Rd (Lovers Lane Rd)

g. Describe Building: ☒ Free Standing Building ☐ Strip Mall ☐ Other: _____

h. Describe Premises Structure: ☒ Single Story ☐ Multi-Story - # of Stories _____ ☐ Other: _____

i. Describe Surrounding Area: ☒ Commercial ☐ Residential ☐ Industrial ☐ Other: _____

j. Property Owner's Name: Michael Truong Phone Number: 414-732-9920

Address: 8010 N. 61st Milwaukee, WI 53223

9. Hours of Operation & Customers

Will customers be entering the premises? ☐ No ☒ Yes

Day of the Week	Proposed Hours of Operation:		Number of Customers expected each day	Potential Age Range of Customers	Class B Applicants: Age Restriction (If none, write 'None')
	Open (Include a.m. or p.m.)	Close (Include a.m. or p.m.)			
Sunday	10 am	8 pm	50		None
Monday	10 am	9 pm	50		None
Tuesday	10 am	9 pm	50		None
Wednesday	10 am	9 pm	50		None
Thursday	10 am	9 pm	50		None
Friday	10 am	10 pm	50		None
Saturday	10 am	10 pm	70		None

Extended Hours Establishment License is required for any convenience store, filling station, personal service establishment (such as tattoo, body piercing, salon, tailor, tanning, etc.), recording studio or restaurant which is open between the hours of 12 a.m. and 5 a.m.

Entertainment Indoor Closing Hours - If alcohol beverage establishment, same as alcohol license hours.
If non-alcohol establishment 1:00 am Sunday to Thursday; 1:30 am Friday and Saturday.

Entertainment Outdoor Closing Hours - 10:00 pm Sunday - Thursday; 12:00 am Friday and Saturday,
unless otherwise approved by Common Council in licensee's plan of operation.

10. Signature(s)

[Signature]
Sole Proprietor, Partner, Agent, or 20% or more Shareholder

[Signature]
Signature of additional partner or 20% or more Shareholder

See Application Information for a list of all required application forms.



ALCOHOL BEVERAGE & PUBLIC ENTERTAINMENT PREMISES SUPPLEMENTAL PLAN OF OPERATION

Office of the City Clerk License Division

200 E. Wells St. Room 105, Milwaukee, WI 53202

(414) 286-2238 e-mail address: license@milwaukee.gov www.milwaukee.gov/license

Legal Entity Name:

PPHO LLC

Premise Address:

5430 N. Lovers Lane ~~Dr~~ Rd

Proximity of Premises to Church, School, Daycare Center or Hospital

Is there at least 300 feet between the building and any church, school, daycare center or hospital? ☒ Yes ☐ No

"Service Bar Only" Designation

If applying for Class B or C license, are you applying for "Service Bar Only"? ☐ No ☒ Yes

Service Bar Only means customers cannot sit at the bar. Alcohol is served to patrons seated at tables. No stools, chairs or other articles of furniture shall be placed at the service bar for patrons to sit upon.

Business Information

a) Are you taking out this application for anyone that may not be eligible for a license? ☒ No ☐ Yes

If yes, list name and address: _____

b) Will the agent, a partner or the individual licensee be conducting the day-to-day operations of the business? ☐ No ☒ Yes

If no, list the name and address of the person(s) who will: _____

Class B Applicants: If the agent, a partner or the individual licensee will not be conducting the day-to-day operations of the business, the person(s) listed above must obtain a Class B Managers license.

c) Does anyone else have money invested or any other interest in this business? ☒ No ☐ Yes

If yes, explain: _____

d) Have you made an agreement with anyone to repay any loan or any other payments based upon income from the business?

☒ No ☐ Yes If yes, list name and address: _____

Proof of Ownership, Lease, or Offer to Purchase (new & transfer applicants only)

Submit proof of ownership, lease, or offer to purchase the building with this application.

A lease or offer to purchase must:

- a) Be in the same legal entity name as that apply for the license
- b) Reflect the same address as the premises address on this application
- c) Reflect current dates and
- d) Be signed by the lessor/seller and lessee/buyer

Property Information (new & transfer applicants only)

a) Do you own or lease the building? ☐ Own ☒ Lease

b) Who owns the fixtures (for example, coolers, etc.)? PPHO LLC

c) Are you purchasing the stock and/or fixtures? ☒ No ☐ Yes If yes, amount paid \$ _____

d) Total amount paid for business \$ 30,000

e) Total amount paid for goodwill of the business \$ 0

Goodwill comprises the reputation and customer relationships of an existing business. If the price you pay for the business exceeds the fair market value of all of the rest of the assets of the business, the excess may be considered goodwill.

f) Have you made arrangements with the seller for payment of personal property taxes? ☐ No ☒ Yes

See Application Information for a list of all required application forms.

Lease Information (new & transfer applicants who are leasing the premises only)

- a) Date lease begins 9/07/15 Ends 9/07/18
b) Monthly rental \$ 3250
c) Do you have an option to renew the lease? ☐ No ☒ Yes
d) Does your lease allow for assignment to another party without the consent of the owner? ☒ No ☐ Yes
e) For what length of time have you been guaranteed occupancy (number of years)? 3 yrs
f) In addition to paying the monthly rental, will you have to pay anything additional to the owner of the building to guarantee performance of the lease? ☒ No ☐ Yes If yes, explain _____
g) Does the present owner or occupancy object to the granting of your license? ☒ No ☐ Yes
If yes, explain _____

Change of Agent Applicants Only

- Have there been any changes to the floor plan since the last application was submitted? ☒ No ☐ Yes
If no, a new floor plan is not required. If yes, submit a new floor plan and explain the change(s): _____

Notarized Signatures of Applicants

SUBSCRIBED AND SWORN TO BEFORE ME

This 4th day of November, 20 15



(Clerk/Notary Public)

My Commission Expires MARCH 22, 2019

*Notary Seal must be affixed.

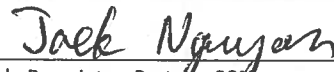

Sole Proprietor, Partner, 20% or more Shareholder, or
Agent – only if there are no 20% or more shareholders

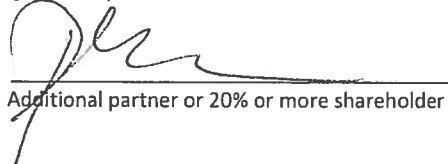

Additional partner or 20% or more shareholder

Note: All information contained in this application is subject to approval by the Common Council.
Deviating from approved plan of operation will subject licensee to citations, and/or suspension or non-renewal of the license.
Contact the License Division for information on how to request changes.

New and transfer of premise applicants must submit the following:

- ☐ Proof of ownership, lease or offer to purchase the building ☐ Detailed floor plan ☐ If a restaurant, copy of the menu

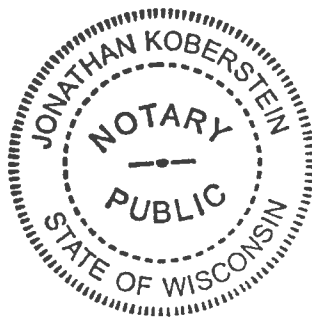

Jack v NGUYEN, Agent

PPHO LLC

d/b/a Pho Lovers

5430 Lovers Lane Rd

Milwaukee, WI 53225

Date: 8/20/2015

Total 3750 sqft.

