



CITY OF MILWAUKEE  
OFFICE OF THE CITY CLERK

Friday, October 30, 2015

COMMITTEE MEETING NOTICE

AD 06

EL-HASSAN, Mohammad I, Agent  
KRAYEM, INC  
416 E NORTH Av

MILWAUKEE, WI 53202

You are requested to attend a hearing which is to be held in Room 301-B, Third Floor, City Hall on:

**Tuesday, November 10, 2015 at 10:45 AM**

**Regarding:** Your Class A Fermented Malt Beverage Retailer's License Renewal Application as agent for "KRAYEM, INC" for "QUICK STOP FOODS" at 416 E NORTH Av.

There is a possibility that your application may be denied for one or more of the following reasons: The recommendation of the committee regarding the application shall be based on evidence presented at the hearing. Per MCO 85-4-4, unless otherwise specified in the code, probative evidence concerning non-renewal, suspension or revocation may include evidence of the following: failure of the applicant to meet municipal qualifications, pending charges against or the conviction of any felony, misdemeanor, municipal offense or other offense, the circumstances of which substantially relate to the circumstances of the particular licensed or permitted activity, by the applicant or by any employee or other agent of the applicant. If the activities of the applicant involve a licensed premises, whether the premises tends to facilitate a public or private nuisance or has been the source of congregations of persons which have resulted in any of the following: disturbance of the peace; illegal drug activity; public drunkenness; drinking in public; harassment of passers-by; gambling; prostitution; sale of stolen goods; public urination; theft; assaults; battery; acts of vandalism including graffiti, excessive littering, loitering, illegal parking, loud noise at times when the licensed premise is open for business; traffic violations; curfew violations; lewd conduct; display of materials harmful to minors, pursuant to s. 106-9.6; or any other factor which reasonably relates to the public health, safety and welfare, or failure to comply with the approved plan of operation. See attached police report or correspondence.

**Notice for applicants with warrants or unpaid fines:**

Proof of warrant satisfaction or payment of fines must be submitted at the hearing on the above date and time. Failure to comply with this requirement may result in a delay of the granting/denial of your application.

Failure to appear at this meeting may result in the denial of your license. Individual applicants must appear only in person or by an attorney. Corporate or Limited Liability applicants must appear only by the agent designated on the application or by an attorney. Partnership applicants must appear by a partner listed on the application or by an attorney. If you wish to do so and at your own expense, you may be accompanied by an attorney of your choosing to represent you at this hearing.

You will be given an opportunity to speak on behalf of the application and to respond and challenge any charges or reasons given for the denial. No petitions can be accepted by the committee, unless the people who signed the petition are present at the committee hearing and willing to testify. You may present witnesses under oath and you may also confront and cross-examine opposing witnesses under oath. If you have difficulty with the English language, you should bring an interpreter with you, at your expense, so that you can answer questions and participate in your hearing.

You may examine the application file at this office during regular business hours prior to the hearing date. Inquiries regarding this matter may be directed to the person whose signature appears below.

Limited parking for persons attending meetings in City Hall is available at reduced rates (5 hour limit) at the Milwaukee Center on the southwest corner of East Kilbourn and North Water Street. Parking tickets must be validated in the first floor information booth in City Hall.

PLEASE NOTE: Upon reasonable notice, efforts will be made to accommodate the needs of disabled individuals through sign language interpreters or other auxiliary aids. For additional information or to request this service, contact the Council Services Division ADA Coordinator at (414) 286-2998, Fax - (414) 286-3456, TDD - (414) 286-2025.

JIM OWCZARSKI, CITY CLERK

BY:

Jason Schunk  
License Division Manager

**If you have questions regarding this notice, please contact the License Division at (414) 286-2238.**

200 E. Wells Street, Room 105, City Hall, Milwaukee, WI 53202. [www.milwaukee.gov/license](http://www.milwaukee.gov/license)  
Phone: (414) 286-2238 Fax: (414) 286-3057 Email Address: [License@milwaukee.gov](mailto:License@milwaukee.gov)

MILWAUKEE POLICE DEPARTMENT  
LICENSE INVESTIGATION UNIT

CRIMINAL RECORD/ORDINANCE VIOLATION/INCIDENTS  
SYNOPSIS

DATE: 09/01/2015  
LICENSE TYPE: CLASS A MALT  
NEW:  
RENEWAL: X

No. 217028  
Application Date: 08/31/2015  
Expiration Date:

License Location: 416 E North Ave  
Business Name: Quick Stop Foods

Aldermanic District: 06

Licensee/Applicant: El Hassan, Mohammad I  
(Last Name, First Name, MI)  
Date of Birth: 6-28-1972

Male: x

Female:

Home Address: 3815 S 5<sup>th</sup> Pl  
City: Milwaukee  
Home Phone: 414-383-9272

State: Wi

Zip Code: 53207

This report is written by Police Officer Gilbert Gwinn, assigned to the License Investigation Unit, Days.

The Milwaukee Police Department's investigation regarding this application revealed the following:

1. On 12/02/1999 the applicant was arrested for Battery and Disorderly Conduct. No Further Information Available

Charge	:	Battery (Misdemeanor) Disorderly Conduct Misdemeanor)
Finding	:	Guilty-Amended to Disorderly Conduct,(Forfeiture) Circuit Court Guilty
Sentence	:	Fined Fined \$200.00 plus 60 Days H.O.C., 9 Months Probation
Date	:	02/16/2000
Case	:	99CM011812

2. On 01/01/2003 at 3:18 PM officers responded to the licensed premises at 416 E North regarding trouble with a customer. Investigation revealed that a customer had been causing trouble and was kicked out of the store. The customer, however, states that he was battered by a store employee. When officers tried to check the store video tape, the machine had run out of tape and the incident was not recorded. (The store employee, Hassan I El-Hassan was convicted 03/26/2003 for Disorderly Conduct. The applicant was cited for Convenient Store Security Camera Required.

Charge : Convenient Store Security Camera Required  
 Finding : Guilty, Municipal Court  
 Sentence : Fined \$165.00  
 Date : 02/27/2003  
 Case : 03017321

3. On 03/14/2003 at 4:30 PM a 20 year old police-aide, under the direction of police officers purchased a 12-pack of beer from a clerk at the licensed premises at 416 E North Av. The clerk, Mustafa MOUNIR was convicted of Sale to Underage on 05/08/2003 and fined \$100.00. The applicant was not cited.
4. On 10-29-2003 an underage Milwaukee police aide enter Quick Stop Foods at 416 E North Ave., at the direction of Milwaukee police officers. The aide was able to purchase a 4 pack of Miller High Life from the clerk, Michael G Yarbrough. The clerk was charged with the following:

Charge : Sale To Underage  
 Finding : Guilty  
 Sentence : \$100.00  
 Date : 12-18-2003  
 Case : 03163689

5. On 4-16-2005 at 6:45pm, an underage Milwaukee police aide entered Quick Stop Foods, 416 E North Ave., at the direction of Milwaukee police officers. The aide was able to purchase 4 6 packs of beer from the cashier Christina D Edwards, who did not possess a Class d Bartenders license.

The Licensee, Mohammad I El Hassan was charged with the following:

Charge : Sale To Underage  
**Finding: Dismissed w/o prejudice**  
 Case : 05052017

The Cashier, Christina D Edwards was charged with the following:

Charge : Class D Bartenders License Required  
 Finding : Guilty  
 Sentence : \$343.00  
 Date : 6-9-2005  
 Case : 05051996

=====

Item # 5 previously reported, disposition now added.

6. On 07/22/06, Milwaukee Police were conducting sales of tobacco products sold to underage persons. Officers sent in an underage person to 416 E North Avenue and the underage was able to purchase tobacco without being asked for ID. The clerk was identified as Mohammad El-Hassan and he received a citation for Sale Tobacco Product to Minor. The citation was dismissed by the city attorney.

7. On 10/27/12, Milwaukee police were working the Wisconsin WINS Tobacco Initiative and had an underage student enter 416 E North Avenue in attempts to purchase tobacco products. The student was able to purchase a Swisher Sweet cigar without being asked for ID. The clerk was identified as Mohammad El-Hassan and El-Hassan was cited for the violation.

Charge: Sale of Cigarette To Underage/Minor  
Finding: Guilty  
Sentence: Fined \$171.00  
Date: 12/20/12  
Case: 12125737

8. On 06/02/13 at 12:30 pm, Milwaukee police conducted a Licensed Premise Check at 416 E North Avenue. No violations were observed and officers provided Mohammad El-Hassan a copy of MCO Chapter 92, as well as a copy of the NEWPRS manual.
9. On 07/13/13, Milwaukee police were working the Wisconsin WINS Tobacco Initiative and had an underage student enter 416 E North Avenue in attempts to purchase tobacco products. The student was able to purchase a pack of Newport cigarettes without being asked for ID. The clerk was identified as Mohammad El-Hassan and El-Hassan was cited for the violation.

Charge: Sale of Cigarette To Underage/Minor  
Finding: Guilty  
Sentence: Fined \$171.00  
Date: 09/10/13  
Case: 13075008

10. On 08/09/2013 the applicant was cited at 3815 South 5<sup>th</sup> Place in the city of Milwaukee for Building Code Violations.

Charge: Building Code Violations  
Finding: Guilty  
Sentence: \$150.00 fine  
Date: 09/10/2014  
Case: 14054067

11. On 12/13/2014 a 17 year old, working in conjunction with Milwaukee police, was able to purchase two Swisher Sweet cigars from the cashier at 416 East North Avenue. The applicant was cited.

Charge:	Sale of Cigarettes to Minor/Underage
Finding:	Guilty
Sentence:	\$260.00 fine
Date:	02/11/2015
Case:	15000904

Business Name: Quick Stop Foods  
Address of Licensed Premises: 416 E. North Ave.  
Business Phone: 414-265-5500

Type of License: Class A

Date of Incident: 12/13/14

Licensee cooperative? ☒ Yes ☐ No (If no, explain in narrative section)

Time: 1005

Date of Birth: 06/28/72  
Home Phone: 414-469-4792

Date of Birth: \_\_\_\_\_  
Home Phone: \_\_\_\_\_

Date of Birth: \_\_\_\_\_  
Home Phone: \_\_\_\_\_

Date of Birth: 09/19/77  
Home Phone:

**VIOLATION/INCIDENT – DESCRIBE FACTS AND CIRCUMSTANCES IN NARRATIVE SECTION**

**Date of Birth:** 06/28/72

Court Date: 01/30/15

**Date of Birth:**

**Court Date:**

**Date of Birth:**

**Court Date:**

Date of Birth:

**Court Date:**

Date of Birth:

**Court Date:**

Date: 12/15/14

12-17-14

Date \_\_\_\_\_

**DISPOSITION – FOR LICENSING ONLY**

Citation No.	Case Number	Disposition	Judge	Date

This report was written by P.O. Dean DRAJKOWSKI assigned to the License Unit day shift.

On Saturday, December 13, 2014, I was assigned to the Wisconsin WINS Youth Tobacco Initiative, which checks area vendors for age compliance tobacco purchases. I was working with Xavier T. ASHFORD, B/M, 04-07-97, of 618 W. Locust St., phone #262-617-1811, who is 17 years old and not of legal age to purchase tobacco. A photo of ASHFORD was taken at the beginning of the assignment for identification.

At about 10:05 AM, ASHFORD entered the Quick Stop Foods located at 416 E. North Ave. and purchased two Swisher Sweets grape cigars for \$0.99. ASHFORD provided a description of the cashier that sold him the tobacco. I entered the store and identified the cashier as Hassan I. EL-HASSAN, A/M, 09-19-77, of 3815 S. 5<sup>th</sup> Pl. EL-HASSAN admitted selling tobacco to ASHFORD. EL-HASSAN stated ASHFORD looked at least 20 years old and old enough to purchase tobacco. EL-HASSAN stated he did not check ASHFORD for id. EL-HASSAN stated his brother is the owner of the store.

The licensee/agent for Quick Stop Foods was Mohamad I. EL-HASSAN, A/M, 06-28-72, of 3815 S. 5<sup>th</sup> Pl. EL-HASSAN was issued a citation for adult sell tobacco to person under 18.



Friday, October 30, 2015



# Notice of Public Hearing

---

EL-HASSAN, Mohammad I, Agent  
QUICK STOP FOODS at 416 E NORTH Av  
Class A Fermented Malt Beverage Retailer's License Renewal Application

**Tuesday, November 10, 2015 at 10:45 AM**

To whom it may concern:

The above application has been made by the above named applicant(s). This requires approval from the Licenses Committee and the Common Council of the City of Milwaukee. The hearing before the Licenses Committee will take place on 11/10/2015 at 10:45 AM, in Room 301-B, Third Floor, City Hall. If you wish, you may provide testimony at the hearing regarding the request; see below for further information. You are not required to attend the hearing. Once the Licenses Committee makes its recommendation, this recommendation is forwarded to the full Common Council for approval at its next regularly scheduled hearing. Please review the information below and if you have further questions regarding this process, please contact the License Division at (414) 286-2238.

---

## Important details for those wishing to provide information for the Licenses Committee to consider when making its recommendation:

1. The license application is scheduled to be heard at the above time. Due to other hearings running longer than scheduled, you may have to wait some time to provide your testimony.
2. You must appear in person and testify as to matters that you have personally experienced or seen. (You cannot provide testimony for your neighbor, parent or anyone else; this is considered hearsay and cannot be considered by the committee.)
3. No letters or petitions can be accepted by the committee (unless the person who wrote the letter or the persons who signed the petition are present at the committee hearing and willing to testify).
4. Persons opposed to the license application are given the opportunity to testify first; supporters may testify after the opponents have finished.
5. When you are called to testify, you will be sworn in and asked to give your name, and address. (If your first and/or last names are uncommon please spell them.)
6. You may then provide testimony.
  - a. Include only information relating to the above license application.
  - b. Include only information you have personally witnessed or seen.
  - c. Provide concise and relevant information detailing how this business has affected or may affect the peaceful enjoyment of your neighborhood.
  - d. If by the time you have the opportunity to testify, the information you wish to share has already been provided to the committee, you may state that you agree with the previous testimony. Redundant or repetitive testimony will not assist the committee in making its recommendation.
7. After giving your testimony, the members of the Licenses Committee and the licensee may ask questions regarding the testimony you have given or other factors relating to the license application.
8. Business Competition is not a valid basis for denial or non-renewal of a license.  
**Please Note: If you have submitted an objection to the above application your objection cannot be considered by the committee unless you personally testify at the hearing.**



RESIDENT	MAIL ADDRESS	CITY AND ZIP CODE
CURRENT RESIDENT	2224 N BUFFUM ST	MILWAUKEE, WI 53212-3328
CURRENT RESIDENT	2224A N BUFFUM ST	MILWAUKEE, WI 53212-3328
CURRENT RESIDENT	2228 N BUFFUM ST	MILWAUKEE, WI 53212-3328
CURRENT RESIDENT	2232 N BUFFUM ST	MILWAUKEE, WI 53212-3328
CURRENT RESIDENT	2241 N BUFFUM ST	MILWAUKEE, WI 53212-3327
CURRENT RESIDENT	2244 N BUFFUM ST	MILWAUKEE, WI 53212-3328
CURRENT RESIDENT	2305 N BUFFUM ST	MILWAUKEE, WI 53212-3305
CURRENT RESIDENT	2307 N BUFFUM ST	MILWAUKEE, WI 53212-3305
CURRENT RESIDENT	2308 N BUFFUM ST	MILWAUKEE, WI 53212-3306
CURRENT RESIDENT	2311 N BUFFUM ST	MILWAUKEE, WI 53212-3305
CURRENT RESIDENT	2313 N HOLTON ST	MILWAUKEE, WI 53212-3355
CURRENT RESIDENT	2313A N HOLTON ST	MILWAUKEE, WI 53212-3355
CURRENT RESIDENT	2313B N HOLTON ST	MILWAUKEE, WI 53212-3355
CURRENT RESIDENT	2316 N HOLTON ST	MILWAUKEE, WI 53212-3356
CURRENT RESIDENT	2316A N HOLTON ST	MILWAUKEE, WI 53212-3356
CURRENT RESIDENT	2321 N BUFFUM ST	MILWAUKEE, WI 53212-3305
CURRENT RESIDENT	2321A N BUFFUM ST	MILWAUKEE, WI 53212-3305
CURRENT RESIDENT	2323 N HOLTON ST	MILWAUKEE, WI 53212-3355
CURRENT RESIDENT	2327 N BUFFUM ST	MILWAUKEE, WI 53212-3305
CURRENT RESIDENT	2327A N BUFFUM ST	MILWAUKEE, WI 53212-3305
CURRENT RESIDENT	2331 N BUFFUM ST	MILWAUKEE, WI 53212-3305
CURRENT RESIDENT	2334 N BUFFUM ST	MILWAUKEE, WI 53212-3306
CURRENT RESIDENT	2337 N HOLTON ST	MILWAUKEE, WI 53212-3355
CURRENT RESIDENT	2339 N BUFFUM ST	MILWAUKEE, WI 53212-3305
CURRENT RESIDENT	2339 N HOLTON ST	MILWAUKEE, WI 53212-3355
CURRENT RESIDENT	2339A N BUFFUM ST	MILWAUKEE, WI 53212-3305
CURRENT RESIDENT	338 E NORTH AVE	MILWAUKEE, WI 53212-3318

**Total Records: 28**

**Radius: 250.0 feet and Center of Circle: 416 E North AV**

## 2015-2016 Plan of Operation for 416 E NORTH AV

**1. Litter and Noise**How are the grounds kept clean? ☒ Sweep ☐ Pressure Wash ☒ Pick Up Litter ☐ Other: \_\_\_\_\_How often will grounds be cleaned? ☒ Daily ☐ Weekly ☐ Other: \_\_\_\_\_Grounds Cleaned By: ☒ Licensee ☐ Building Owner ☒ Employees ☐ Hired Maintenance ☐ Other: \_\_\_\_\_How are noise issues prevented and/or addressed? ☒ Security ☒ Manager approaches customer(s) ☒ Call Police  
☒ Signs Posted ☐ Other: \_\_\_\_\_**2. Smoking and Sanitation**Are there designated outdoor smoking areas? ☒ No ☐ Yes

If yes, describe the area(s) and provide location(s): \_\_\_\_\_

Number of Garbage Cans: Inside: 1 Locations: By front Counter  
Outside: 1 Locations: in front of storeIs a Crowd Control Barrier used? ☒ No ☐ Yes If yes, describe: \_\_\_\_\_Describe sanitation facilities (restrooms): 1 restroom at back of storeProvide name of solid waste contractor: Advanced Disposal**3. Security**Are there parking spaces on the premises? ☒ No ☐ Yes If yes, number of spaces: \_\_\_\_\_ and describe security provisions: \_\_\_\_\_Are there designated loading areas? ☒ No ☐ Yes If yes, describe security provisions: \_\_\_\_\_Do you have security personnel on the premise? ☒ No ☐ Yes If yes, how many? 2

AND What are their responsibilities? \_\_\_\_\_

What security equipment do they use? \_\_\_\_\_

List their licensing, certification or training credentials: \_\_\_\_\_

Are there security cameras? ☐ No ☒ Yes If yes, list all locations: 2 inside front & back, 1 OutsideAre searches and/or identification checks conducted upon entry? ☒ No ☐ Yes If yes, describe: \_\_\_\_\_**4. Percentage of Sales (must total 100%)**Alcohol 35 % Food Sales 45 % Entertainment 0 % Other 20 %**5. Businesses On The Premise (choose all that apply):**

- |  |  |  |   |
|--|--|--|---|
| <input type="checkbox"/> Full Service Restaurant | <input type="checkbox"/> Cafe/Coffee Shop        | <input type="checkbox"/> Deli or Fast Food Rest. | <input type="checkbox"/> Private/Fraternal/Veterans' Club |
| <input type="checkbox"/> Night Club              | <input type="checkbox"/> Tavern                  | <input type="checkbox"/> Cocktail Lounge         | <input type="checkbox"/> Teen Club                        |
| <input type="checkbox"/> Bowling Alley           | <input type="checkbox"/> Hotel                   | <input type="checkbox"/> Banquet Hall            | <input type="checkbox"/> Sports Facility                  |
| <input type="checkbox"/> Liquor Store            | <input checked="" type="checkbox"/> Corner Store | <input type="checkbox"/> Supermarket             | <input type="checkbox"/> Convenience Store                |
| <input type="checkbox"/> Gas Station             | <input type="checkbox"/> Other _____             |  |   |

**6. Hours of Operation and Age Restriction**Are there any changes to the current hours of operation or age restriction? ☒ No ☐ Yes If yes, describe: \_\_\_\_\_**Please Note:** If you will be open earlier or later than the hours listed on your current license for even one event or holiday (for example, St. Patrick's Day, Brewers Opening Day, etc.) during the license period, this must be reported and printed on your license.

Your hours of operation and age restriction are listed on your current license.

**7. Floor Plan**Are there any changes to the current floor plan? ☒ No ☐ Yes If yes, describe: \_\_\_\_\_

AND submit a new floor plan with this application. Changes in floor plan include changing the location of tables, games, etc. within your current licensed premises. If your changes include adding any additional areas or square footage to your premises, or any renovations to the building will be done, a Permanent Extension of Premises application must be filed.



**CITY OF MILWAUKEE  
OFFICE OF THE CITY CLERK**

Friday, October 30, 2015

**COMMITTEE MEETING NOTICE**

AD 06

FARES, Jehad A, Agent  
Freez Food Mart LLC  
2526 W Hopkins St

Milwaukee, WI 53206

You are requested to attend a hearing which is to be held in Room 301-B, Third Floor, City Hall on:

**Tuesday, November 10, 2015 at 10:45 AM**

**Regarding:** Your Class A Malt & Class A Liquor and Food Dealer's License Applications as agent for "Freez Food Mart LLC" for "Freez Food Mart" at 2526 W Hopkins St.

There is a possibility that your application may be denied for one or more of the following ns: The recommendation of the committee regarding the application shall be based on evidence presented at the hearing. Per MCO 85-2.7-4, probative evidence concerning whether or not a new license should be granted may be presented on the following subjects: whether or not the applicant meets the municipal requirements, the appropriateness of the location and premises where the licensed premises is to be located and whether use of the premises for the purposes or activities permitted by the license would tend to facilitate a public or private nuisance or create undesirable neighborhood problems such as disorderly patrons, unreasonably loud noise, litter, and excessive traffic and parking congestion. Probative evidence relating to these matters may be taken from the plan of operation submitted with the license application, if any, but shall not include the content of any music. Evidence regarding the fitness of the location of the premises to be maintained as the principal place of business, including but not limited to whether there is an overconcentration of businesses of the type for which the license is sought; whether the proposal is consistent with any pertinent neighborhood business or development plans, or the location's proximity to areas where children are typically present. The applicant's record in operating similarly licensed premises; and whether or not the applicant has been charged with or convicted of any felony, misdemeanor, municipal offense or other offense, the circumstances of which substantially relate to the activity to be permitted by the license being applied for or any other factor which reasonably relates to the public health, safety or welfare may also be considered. See attached police report or correspondence.

**Notice for applicants with  
warrants or unpaid fines:**

**Proof of warrant satisfaction or payment of fines must be submitted at the hearing on the above date and time. Failure to comply with this requirement may result in a delay of the granting/denial of your application.**

Failure to appear at this meeting may result in the denial of your license. Individual applicants must appear only in person or by an attorney. Corporate or Limited Liability applicants must appear only by the agent designated on the application or by an attorney. Partnership applicants must appear by a partner listed on the application or by an attorney. If you wish to do so and at your own expense, you may be accompanied by an attorney of your choosing to represent you at this hearing.

You will be given an opportunity to speak on behalf of the application and to respond and challenge any charges or reasons given for the denial. No petitions can be accepted by the committee, unless the people who signed the petition are present at the committee hearing and willing to testify. You may present witnesses under oath and you may also confront and cross-examine opposing witnesses under oath. If you have difficulty with the English language, you should bring an interpreter with you, at your expense, so that you can answer questions and participate in your hearing.

You may examine the application file at this office during regular business hours prior to the hearing date. Inquiries regarding this matter may be directed to the person whose signature appears below.

Limited parking for persons attending meetings in City Hall is available at reduced rates (5 hour limit) at the Milwaukee Center on the southwest corner of East Kilbourn and North Water Street. Parking tickets must be validated in the first floor information booth in City Hall.

PLEASE NOTE: Upon reasonable notice, efforts will be made to accommodate the needs of disabled individuals through sign language interpreters or other auxiliary aids. For additional information or to request this service, contact the Council Services Division ADA Coordinator at (414) 286-2998, Fax - (414) 286-3456, TDD - (414) 286-2025.

**JIM OWCZARSKI, CITY CLERK**

BY: \_\_\_\_\_



**Jason Schunk  
License Division Manager**

**If you have questions regarding this notice, please contact the License Division at (414) 286-2238.**

200 E. Wells Street, Room 105, City Hall, Milwaukee, WI 53202. [www.milwaukee.gov/license](http://www.milwaukee.gov/license)  
Phone: (414) 286-2238 Fax: (414) 286-3057 Email Address: [License@milwaukee.gov](mailto:License@milwaukee.gov)



**CITY OF MILWAUKEE  
OFFICE OF THE CITY CLERK**

Friday, October 30, 2015

**COMMITTEE MEETING NOTICE**

AD 06

FARES, Jehad A, Agent  
Freez Food Mart LLC  
6422 S 35<sup>th</sup> St

Franklin, WI 53132

You are requested to attend a hearing which is to be held in Room 301-B, Third Floor, City Hall on:

**Tuesday, November 10, 2015 at 10:45 AM**

**Regarding:** Your Class A Malt & Class A Liquor and Food Dealer's License Applications as agent for "Freez Food Mart LLC" for "Freez Food Mart" at 2526 W Hopkins St.

There is a possibility that your application may be denied for one or more of the following reasons: The recommendation of the committee regarding the application shall be based on evidence presented at the hearing. Per MCO 85-2.7-4, probative evidence concerning whether or not a new license should be granted may be presented on the following subjects: whether or not the applicant meets the municipal requirements, the appropriateness of the location and premises where the licensed premises is to be located and whether use of the premises for the purposes or activities permitted by the license would tend to facilitate a public or private nuisance or create undesirable neighborhood problems such as disorderly patrons, unreasonably loud noise, litter, and excessive traffic and parking congestion. Probative evidence relating to these matters may be taken from the plan of operation submitted with the license application, if any, but shall not include the content of any music. Evidence regarding the fitness of the location of the premises to be maintained as the principal place of business, including but not limited to whether there is an overconcentration of businesses of the type for which the license is sought; whether the proposal is consistent with any pertinent neighborhood business or development plans, or the location's proximity to areas where children are typically present. The applicant's record in operating similarly licensed premises; and whether or not the applicant has been charged with or convicted of any felony, misdemeanor, municipal offense or other offense, the circumstances of which substantially relate to the activity to be permitted by the license being applied for or any other factor which reasonably relates to the public health, safety or welfare may also be considered. See attached police report or correspondence.

**Notice for applicants with  
warrants or unpaid fines:**

**Proof of warrant satisfaction or payment of fines must be submitted at the hearing on the above date and time. Failure to comply with this requirement may result in a delay of the granting/denial of your application.**

Failure to appear at this meeting may result in the denial of your license. Individual applicants must appear only in person or by an attorney. Corporate or Limited Liability applicants must appear only by the agent designated on the application or by an attorney. Partnership applicants must appear by a partner listed on the application or by an attorney. If you wish to do so and at your own expense, you may be accompanied by an attorney of your choosing to represent you at this hearing.

You will be given an opportunity to speak on behalf of the application and to respond and challenge any charges or reasons given for the denial. No petitions can be accepted by the committee, unless the people who signed the petition are present at the committee hearing and willing to testify. You may present witnesses under oath and you may also confront and cross-examine opposing witnesses under oath. If you have difficulty with the English language, you should bring an interpreter with you, at your expense, so that you can answer questions and participate in your hearing.

You may examine the application file at this office during regular business hours prior to the hearing date. Inquiries regarding this matter may be directed to the person whose signature appears below.

Limited parking for persons attending meetings in City Hall is available at reduced rates (5 hour limit) at the Milwaukee Center on the southwest corner of East Kilbourn and North Water Street. Parking tickets must be validated in the first floor information booth in City Hall.

PLEASE NOTE: Upon reasonable notice, efforts will be made to accommodate the needs of disabled individuals through sign language interpreters or other auxiliary aids. For additional information or to request this service, contact the Council Services Division ADA Coordinator at (414) 286-2998, Fax - (414) 286-3456, TDD - (414) 286-2025.

JIM OWCZARSKI, CITY CLERK

BY:

Jason Schunk  
License Division Manager

**If you have questions regarding this notice, please contact the License Division at (414) 286-2238.**

200 E. Wells Street, Room 105, City Hall, Milwaukee, WI 53202. [www.milwaukee.gov/license](http://www.milwaukee.gov/license)  
Phone: (414) 286-2238 Fax: (414) 286-3057 Email Address: [License@milwaukee.gov](mailto:License@milwaukee.gov)

**MILWAUKEE POLICE DEPARTMENT**  
**LICENSE INVESTIGATION UNIT**

**CRIMINAL RECORD/ORDINANCE VIOLATION/INCIDENTS**  
**SYNOPSIS**

**DATE:** 11/19/11  
**LICENSE TYPE:** AMALT  
**NEW:**  
**RENEWAL:** X

**No.** 137206  
**Application Date:** 11/18  
**Expiration Date:**

**License Location:** 2526 West Hopkins St.

**Aldermanic District:** 06

**Business Name:** Sparkle Foods

**Licensee/Applicant:** Fares, Rami a.  
(Last Name, First Name, MI)

**Date of Birth:** 10/06/1977

**Home Address:** 5040 S. 23<sup>rd</sup> St.

**City:** Milwaukee

**State:** WI

**Zip Code:** 53221

**Home Phone:** (414) 803-7003

This report is written by Police Officer Kristyn KUKOWSKI, assigned to the License Investigation Unit, Days.

The Milwaukee Police Department's investigation regarding this application revealed the following:

1. On 12/09/2008 at 4:27pm Milwaukee Police conducted a license premise check at 2526 W. Hopkins Street (Sparkle Foods) following a complaint received regarding the selling of single cigarettes from this business. Milwaukee Police discovered a box behind the counter containing single cigarettes. The applicant was advised that selling single cigarettes was illegal and that any future complaints would result in the issuance of a citation. No citations or additional police reports were filed regarding this incident.
2. On 08/10/2009 at 5:41pm Milwaukee Police were dispatched to a property damage complaint at 2526 W. Hopkins Street (Sparkle Foods). Investigation revealed an unknown actor(s) broke two of the windows on the business sometime during the overnight hours. Police incident report #092220132 filed.

=====

**Previous premise**

Date: 07/13/2015  
Officer: L. Lammers

City of Milwaukee Police Department  
90-5-1.5 Crime Prevention Survey  
Convenience Store/Liquor Store Inspection

Name of Premise: Freez Food Mart  
Address: 2526 W Hopkins St, Milwaukee, WI  
Phone: 414-444-4480

Owner: Hopkins 25, LLC c/o Harbhajan Singh  
Owner address: 8301 W Nash  
City State Zip: Milwaukee, WI 53222  
Owner Phone: 262-703-9015 or 414-708-2034  
Owner email:

Manager: Jehad Fares  
Home Address: 6422 S. 35<sup>th</sup> St. #3  
City State Zip: Franklin, WI 53132  
Phone: 954-798-1947  
Email:

Preferred contact: 414-444-4480

Location currently open: ☒ YES ☐ NO

Projected open date:

Day's open: ☐ S ☐ M ☐ T ☐ W ☐ Th ☐ F ☐ SA ☒ ALL

Hours of Operation: Sun: 9 am – 9 pm ☐ 24 hours ☐ Y ☒ N  
Mon: same  
Tue: same  
Wed: same  
Thu: same  
Fri: same  
Sat: same

Premise Type: ☐ Liquor Store  
☒ Convenience Store  
☐ Other:

Licenses currently held:  
Alcohol: ☐ Yes ☐ No Class: #:  
Tobacco: ☐ Yes ☐ No #:



Food: ☐ Yes ☐ No #:   
 Extended Hours: ☐ Yes ☐ No #:   
 Secondhand Dealer: ☐ Yes ☐ No Type: #:  
 Other: ☐ Yes ☐ No Type: #:  
 Other: ☐ Yes ☐ No Type: #:

Who is your alcohol distributor – Beer Capitol, and Beechwood

### Exterior Survey:

1. Is the area around the location clean? x ☐ Yes ☐ No
2. What surrounds the location? (Check all the apply)
  - a. ☐ Park
  - b. ☐ School
  - c. ☐ Youth Center
  - d. ☐ Church
  - e. x ☐ Tavern(s) If so, how many 1; Warren's Lounge
  - f. x ☐ Residential
  - g. x ☐ Other businesses
  - h. ☐ Other:
3. Can you see from the outside of the location into the interior ☐ Yes x ☐ No
4. Can you see the employees inside of the location from the outside ☐ Yes x ☐ No
5. Are exterior windows free of signage ☐ Yes x ☐ No
6. Is there a parking lot ☐ Yes x ☐ No
7. Is the parking lot clean? ☐ Yes ☐ No
8. Is the parking lot well lit? ☐ Yes ☐ No
9. Are there areas where a person could conceal themselves ☐ Yes x ☐ No
10. Is there exterior lighting? x ☐ Yes ☐ No. Does it appears to be adequate ☐ Yes ☐ No
11. Exterior Payphone? ☐ Yes x ☐ No
12. Are there No Loitering Signs posted? x ☐ Yes ☐ No
13. Are there exterior security cameras x ☐ Yes ☐ No How Many: 4
14. Are the address numbers prominently displayed and easy to see x ☐ Yes ☐ No

### Camera Survey:

15. Does this location have security cameras? x ☐ Yes ☐ No
16. Are they in working order? x ☐ Yes ☐ No
17. What format are the cameras?
  - a. Color x ☐ Yes ☐ No
  - b. Digital x ☐ Yes ☐ No
  - c. VCR ☐ Yes ☐ No
  - d. Recorded x ☐ Yes ☐ No
18. How long is footage stored for later viewing: unsure
19. Are there exterior cameras x ☐ Yes ☐ No How many: 4
20. Are there interior cameras x ☐ Yes ☐ No How many: 12
21. Do all employees know how to retrieve recorded digital images/footage? x ☐ Yes ☐ No

### Interior Survey:

22. Is the storeowner willing to be a standing complainant regarding loitering? x ☐ Yes ☐ No

- a. If yes have them fill out the standing complaint form and give them two of the commercial signs x ☐ Yes ☐ No
23. Is the interior of the location neat and clean? x ☐ Yes ☐ No
24. Does an interior camera face the entrance/exit? x ☐ Yes ☐ No
25. Is there a lockable area that separates employees from customers? ☐ Yes x ☐ No
26. Does the store sell single chore boy? ☐ Yes x ☐ No
27. Does the store sell blunt wraps? x ☐ Yes ☐ No
28. Does the store sell scales? ☐ Yes x ☐ No
29. Does the store sell items that may be used as crack pipes? ☐ Yes x ☐ No
- a. Describe item N/A
30. Does the store have an over abundance of sandwich baggies: ☐ Yes x ☐ No
31. Does the owner understand that these items are often used for drug use? x ☐ Yes ☐ No
32. Do the products in the store appear to be new and rotated often? x ☐ Yes ☐ No
33. Are emergency and non-emergency numbers posted near the phone? x ☐ Yes ☐ No
34. Does the owner know how to contact their police district directly? x ☐ Yes ☐ No
- a. Did you provide a district contact guide to the owner? x ☐ Yes ☐ No

**Complete this section if alcohol establishment is a convenience store:**

(\*\* Read full ordinance for all details "68-55 Convenience Food Stores")

All convenience food stores not exempted under sub. 3 shall:

1. Is the cash register located in a manner so that at the time of a sales transaction, the employee and customer are both visible from the sidewalk? x ☐ Yes ☐ No \*\*
2. Are the glass entrance and exit doors clear of any signs or advertisements with the exception of a sign which states that the cash register contains \$50 or less and that the safe is no accessible to employees? ☐ Yes x ☐ No
3. Does the store maintain one of the following on the licensed premise:
  - a. A safe that was in use at the convenience food store on August 17, 1994? x ☐ Yes ☐ No
  - b. A drop-safe or time release safe that weighs at least 500 pounds or which is attached to or set into the floor in a manner approved by the police department? ☐ Yes x ☐ No
4. Is lighting provided for the store's parking area during all hours of darkness when employees or customers are on the premises at a minimum average of 2-foot candles per square foot, unless the store is not open for business after sunset and before sunrise? ☐ Yes ☐ No ☐ N/A
5. Are at least two high-resolution surveillance security cameras installed? x ☐ Yes ☐ No
6. Are the security cameras in working order? x ☐ Yes ☐ No
7. Does one camera show an overall view of the counter and register area? x ☐ Yes ☐ No
8. Does one camera show a clear, identifiable, full frame image of the face of each person entering and leaving the store? x ☐ Yes ☐ No
9. Are the camera views obstructed by fixtures or displays? ☐ Yes x ☐ No
10. Is the recorded footage stored for at least 30 days? ☐ Yes ☐ No
11. Do all store employees know how to record footage from the camera system to media capable of being transferred to police custody? x ☐ Yes ☐ No
12. Are customer entrances/exits made of glass or other transparent material? x ☐ Yes ☐ No
  - a. Exception: A store that does not have such doors on August 17, 1994 shall not be required to install such doors until the holder of the store's food dealer license changes.
13. Has the owner and their employees attended the Robbery Prevention Training within 120 days of ownership or employment? ☐ Yes x ☐ No
  - a. Contact Community Outreach and Education at 935-7836 for schedule.



**Sub 3. Exemptions.** The requirements of this section do not apply to a convenience food store that conforms to either of the following descriptions:

- a-1. The store is located in an enclosed shopping structure, enclosed commercial building or hospital. A convenience food store is not in an enclosed structure or building if a customer can enter it directly from the outside.  
Does store conform to a-1 ☐ Yes x ☒ No
- a-2 The store physically separates employees from customers with a solid partition that bars a person from entering the employee area from the customer area, has a secure lock on the employee side of any door between the employee area and the customer, and conducts all transaction through a service window or similar arrangement.  
Does store conform to a-2 ☐ Yes x ☒ No
- a. At the commissioner's discretion, a convenience store may be exempted from any or all of the regulations specified in sub 2.  
Does this location hold an exemption from the commissioner regarding any of the requirements of Sub 2? ☐ Yes x ☒ No

**ADDITIONAL COMMENTS/RECOMMENDATIONS:**

This supplementary report is written by P.O. Laurel Lammers, assigned as the Community Liaison Officer for District Five. On Monday, July 13th, 2015 at 1:00 pm, I met with Mr. Cathie Fares regarding his new liquor license application for Freez Food Mart, which is already operating as Sparkle Foods at the address of 2526 W. Hopkins St. This survey was conducted at that location.

Upon arrival, I found that the building is zoned as a grocery store or convenience store. The main entrance to the store is on the south side of the building and opens towards Hopkins St. I observed two large lights on the exterior of the building to either side of the main entrance door. Also on the front of the building to both sides of the door, is a set of three windows each. There are however several signs in each of the windows. I observed four exterior security cameras. Posted inside of the west window are "No Loitering" signs. The building itself is situated between two properties on either side. To the west is a tavern (2534 W. Hopkins St.) To the east is a residential/commercial building, 2516 W. Hopkins St. which is owned by COGIC Inc, New Life New Beginnings. There is no parking lot. Patrons park on W. Hopkins St., which is a very busy main street.

The interior of the business was clean and appeared recently stocked. They do sell blunt wraps, but they are behind the counter area. I did observe their camera system to be in good working order. Mr. Fares did not know how long footage was stored for though. There is no partition to separate patrons from the store employees, just a counter. They do have a safe. Mr. Fares stated that he has attended the robbery prevention class, but that some of his employees have not. I did provide the phone number to him to have his employees schedule that training.

## City of Milwaukee, Wisconsin



- Notes -



[illegible]



Friday, October 30, 2015



# Notice of Public Hearing

---

FARES, Jehad A, Agent  
Freez Food Mart at 2526 W Hopkins St  
Class A Malt & Class A Liquor and Food Dealer's License Applications

**Tuesday, November 10, 2015 at 10:45 AM**

To whom it may concern:

The above application has been made by the above named applicant(s). This requires approval from the Licenses Committee and the Common Council of the City of Milwaukee. The hearing before the Licenses Committee will take place on 11/10/2015 at 10:45 AM, in Room 301-B, Third Floor, City Hall. If you wish, you may provide testimony at the hearing regarding the request; see below for further information. You are not required to attend the hearing. Once the Licenses Committee makes its recommendation, this recommendation is forwarded to the full Common Council for approval at its next regularly scheduled hearing. Please review the information below and if you have further questions regarding this process, please contact the License Division at (414) 286-2238.

---

## Important details for those wishing to provide information for the Licenses Committee to consider when making its recommendation:

1. The license application is scheduled to be heard at the above time. Due to other hearings running longer than scheduled, you may have to wait some time to provide your testimony.
2. You must appear in person and testify as to matters that you have personally experienced or seen. (You cannot provide testimony for your neighbor, parent or anyone else; this is considered hearsay and cannot be considered by the committee.)
3. No letters or petitions can be accepted by the committee (unless the person who wrote the letter or the persons who signed the petition are present at the committee hearing and willing to testify).
4. Persons opposed to the license application are given the opportunity to testify first; supporters may testify after the opponents have finished.
5. When you are called to testify, you will be sworn in and asked to give your name, and address. (If your first and/or last names are uncommon please spell them.)
6. You may then provide testimony.
  - a. Include only information relating to the above license application.
  - b. Include only information you have personally witnessed or seen.
  - c. Provide concise and relevant information detailing how this business has affected or may affect the peaceful enjoyment of your neighborhood.
  - d. If by the time you have the opportunity to testify, the information you wish to share has already been provided to the committee, you may state that you agree with the previous testimony. Redundant or repetitive testimony will not assist the committee in making its recommendation.
7. After giving your testimony, the members of the Licenses Committee and the licensee may ask questions regarding the testimony you have given or other factors relating to the license application.
8. Business Competition is not a valid basis for denial or non-renewal of a license.  
**Please Note: If you have submitted an objection to the above application your objection cannot be considered by the committee unless you personally testify at the hearing.**

RESIDENT	MAIL ADDRESS	CITY AND ZIP CODE
CURRENT RESIDENT	2459 W KEEFE AVE	MILWAUKEE, WI 53206-1315
CURRENT RESIDENT	2461 W KEEFE AVE	MILWAUKEE, WI 53206-1315
CURRENT RESIDENT	2467 W KEEFE AVE	MILWAUKEE, WI 53206-1315
CURRENT RESIDENT	2469 W KEEFE AVE	MILWAUKEE, WI 53206-1315
CURRENT RESIDENT	2470 W KEEFE AVE	MILWAUKEE, WI 53206-1314
CURRENT RESIDENT	2474 W KEEFE AVE	MILWAUKEE, WI 53206-1314
CURRENT RESIDENT	2474A W KEEFE AVE	MILWAUKEE, WI 53206-1314
CURRENT RESIDENT	2475 W KEEFE AVE	MILWAUKEE, WI 53206-1315
CURRENT RESIDENT	2478 W KEEFE AVE	MILWAUKEE, WI 53206-1314
CURRENT RESIDENT	2479 W KEEFE AVE	MILWAUKEE, WI 53206-1315
CURRENT RESIDENT	2479A W KEEFE AVE	MILWAUKEE, WI 53206-1315
CURRENT RESIDENT	2534 W HOPKINS ST	MILWAUKEE, WI 53206-1309
CURRENT RESIDENT	3407 N 25TH ST	MILWAUKEE, WI 53206-1306
CURRENT RESIDENT	3435 N 24TH PL	MILWAUKEE, WI 53206-1302
CURRENT RESIDENT	3435A N 24TH PL	MILWAUKEE, WI 53206-1302
CURRENT RESIDENT	3439 N 24TH PL	MILWAUKEE, WI 53206-1302
CURRENT RESIDENT	3441 N 24TH PL	MILWAUKEE, WI 53206-1302
CURRENT RESIDENT	3501 N 25TH ST	MILWAUKEE, WI 53206-1328
CURRENT RESIDENT	3503 N 25TH ST	MILWAUKEE, WI 53206-1328
CURRENT RESIDENT	3509 N 25TH ST	MILWAUKEE, WI 53206-1328
CURRENT RESIDENT	3512 N 26TH ST	MILWAUKEE, WI 53206-1333
CURRENT RESIDENT	3512A N 26TH ST	MILWAUKEE, WI 53206-1333
CURRENT RESIDENT	3513 N 25TH ST	MILWAUKEE, WI 53206-1328
CURRENT RESIDENT	3520 N 25TH ST	MILWAUKEE, WI 53206-1327

**Total Records: 25**

**Radius: 250.0 feet and Center of Circle: 2526 W Hopkins ST**



Friday, October 30, 2015

## Licenses Committee Notice of Hearing

Hopkins 25 LLC  
N61 W 16526 Edgemont DR

Menomonee Falls, WI 53051

Date: 11/10/2015  
Time: 10:45 AM  
Location: Room 301-B, Third Floor, City Hall

The Licenses Committee will consider the following license application:

Class A Malt & Class A Liquor and Food Dealer's License Applications  
FARES, Jehad A, Agent  
Freez Food Mart at 2526 W Hopkins St

Please note this application may be recommended for denial based on fitness of the location due to concentration of alcohol beverage outlets in the area. If the application is denied for this reason, no other application for an alcohol beverage license for this location shall be recommended for approval by the Licenses Committee within three years of the date of denial unless the applicant has demonstrated a change of circumstances since the prior denial.

If you have any questions, please call (414) 286-2238.





## BUSINESS LICENSE PLAN OF OPERATION

ccl-busplan 2/5/15

Office of the City Clerk License Division  
200 E. Wells St. Room 105, Milwaukee, WI 53202  
(414) 286-2238 www.milwaukee.gov/license e-mail address: [license@milwaukee.gov](mailto:license@milwaukee.gov)

### 1. Type of Business

Applying for: ☐ Extended Hours Establishment License ☐ Filling Station License ☒ Other (plan of operation for specific license also required)

Provide a detailed description of the type of business you plan on operating:

*Retail Grocery Stores*

Do you have any experience operating this type of business? ☐ No ☒ Yes

If yes, explain: *Managed same type of business for many years*

### 2. Business Operations

- a) Proposed Opening Date: 6-1-15
- b) Is this premise under construction? ☒ No ☐ Yes If yes, list estimated completion date: \_\_\_\_\_
- c) Is this a franchise? ☒ No ☐ Yes
- d) Is this premises currently licensed? ☐ No ☒ Yes If yes, list type of license: Food, Beer, Cigarette & Tobacco
- e) Is the current licensee operating? ☐ No ☒ Yes If no, list date closed: \_\_\_\_\_
- f) What other types of licenses/permits will you hold at this location? (check all that apply)  
☒ Occupancy Permit ☒ Cigarette & Tobacco ☐ Gas Station ☐ Extended Hours ☐ Class "B" Tavern ☒ Weights & Measures  
☐ Secondhand Dealer ☐ Precious Metal & Gem ☐ Other: \_\_\_\_\_
- g) Do you have future plans for other businesses, licenses or permits at this location? ☒ No ☐ Yes  
If yes, explain: \_\_\_\_\_
- h) Have you previously held an Extended Hours License in Milwaukee? ☒ No ☐ Yes  
If yes, list address(es): \_\_\_\_\_
- i) Are other businesses operating in the same building? ☒ No ☐ Yes If yes, describe: \_\_\_\_\_

### 3. Premises Description

- a) Identify all area(s) of the premises that will be used in operating this business (include areas used only for storage):  
☒ 1<sup>st</sup> Floor ☐ 2<sup>nd</sup> Floor ☐ Basement Storage ☐ Patio ☐ Beer Garden ☐ Sidewalk Café ☐ Deck ☐ Rooftop  
☐ Other: Describe: \_\_\_\_\_
- b) Describe Location: ☒ Major Thoroughfare ☐ Secondary Street ☐ Other: \_\_\_\_\_
- c) Nearest Major Cross Street: Hopkins St.
- d) Describe Building: ☒ Free Standing Building ☐ Strip Mall ☐ Other: \_\_\_\_\_
- e) Describe Premises Structure: ☐ Single Story ☒ Multi-Story - # of Stories 2 ☐ Other: \_\_\_\_\_
- f) Describe Surrounding Area: ☒ Commercial ☐ Residential ☐ Industrial ☐ Other: \_\_\_\_\_
- g) Are there off-street parking places? ☒ No ☐ Yes If yes, how many? \_\_\_\_\_
- h) Property Owner's Name: Hopkins 25 LLC Phone Number: 414-708-2034  
Address: N61 W15326 Edgermont Dr. Menomonee Falls WI 53051

#### 4. Businesses On The Premises (check all that apply):

##### Type 1

- |  |   |   |  |
|--|---|---|--|
| <input type="checkbox"/> Full Service Restaurant | <input type="checkbox"/> Cafe/Coffee Shop | <input type="checkbox"/> Deli or Fast Food Restaurant | <input type="checkbox"/> Private/Fraternal/Veterans Club |
| <input type="checkbox"/> Night Club              | <input type="checkbox"/> Tavern           | <input type="checkbox"/> Cocktail Lounge              | <input type="checkbox"/> Teen Club                       |
| <input type="checkbox"/> Bowling Alley           | <input type="checkbox"/> Hotel            | <input type="checkbox"/> Banquet Hall                 | <input type="checkbox"/> Sports Facility                 |

##### Type 2

- |  |   |   |  |
|--|---|---|--|
| <input type="checkbox"/> Liquor Store    | <input type="checkbox"/> Corner Store                     | <input checked="" type="checkbox"/> Supermarket         | <input type="checkbox"/> Convenience Store |
| <input type="checkbox"/> Gas Station     | <input type="checkbox"/> Amusement/Phonograph Distributor | <input type="checkbox"/> Auto Wrecker                   |  |
| <input type="checkbox"/> Used Car Dealer | <input type="checkbox"/> Used Auto Parts                  | <input type="checkbox"/> Personal Service Establishment | <input type="checkbox"/> Recording Studio  |

#### 5. Legal Capacity (only if a Type 1 premises in #4 above)

Capacity \_\_\_\_\_ (Call the Milwaukee Development Center at 414-286-8211 if you have questions.)

#### 6. Percentage of Sales (must total 100%)

Alcohol <u>25</u> %	Cigarettes <u>20</u> %	Secondhand Merchandise _____ %	Precious Metals & Gems _____ %
Food <u>55</u> %	Entertainment _____ %		
Pawnbroker Activity _____ %	Salvaged Materials _____ % (such as scrap metal)	Other _____ % Describe: _____	

#### 7. Litter and Noise Control

- a. How are grounds kept clean? ☒ Sweep ☐ Pressure Wash ☒ Pick Up Litter ☐ Other: \_\_\_\_\_
- b. How often will grounds be cleaned? ☒ Daily ☐ Weekly ☐ Other: \_\_\_\_\_
- c. Grounds cleaned by: ☒ Licensee ☐ Building Owner ☒ Employees ☐ Hired Maintenance ☐ Other: \_\_\_\_\_
- d. Number of Garbage Cans: Inside: 1 Locations: By Entrance  
Outside: 1 Locations: By Entrance Counter
- e. Describe sanitation facilities (restrooms): One in back
- f. Name of solid waste contractor: Waste Management
- g. How are noise issues prevented and/or addressed? ☒ Security ☒ Manager approaches customer(s) ☒ Call Police  
☒ Signs Posted ☐ Other: \_\_\_\_\_
- h. Will a sound amplification system be used? ☒ No ☐ Yes If yes, describe: \_\_\_\_\_

#### 8. Security

- a. Will you have security personnel on premise? ☒ No ☐ Yes If yes, how many? \_\_\_\_\_
- What are their responsibilities? \_\_\_\_\_
- Is security equipment used? ☒ No ☐ Yes If yes, describe \_\_\_\_\_
- List their licensing, certification, or training credentials \_\_\_\_\_



- b. Will there be security cameras? ☐ No ☒ Yes If yes, where? 13 inside 3 outside
- c. Will searches or identification checks be conducted upon entry? ☒ No ☐ Yes If yes, describe \_\_\_\_\_

## 9. Customers

- a. Will customers be entering the premises? ☐ No ☒ Yes
- b. Are there designated outdoor smoking areas? ☒ No ☐ Yes If yes, describe: \_\_\_\_\_
- c. Is a crowd control barrier used? ☒ No ☐ Yes If yes, describe: \_\_\_\_\_

## 10. Hours of Operation

Day of the Week	Proposed Hours of Operation:		Number of Customers expected each day	Potential Age Range of Customers	Class B Applicants: Age Restriction (If none, write 'None')
	Open (include a.m. or p.m.)	Close (include a.m. or p.m.)			
Sunday	9 am	9 pm	300	10-80	
Monday	"	"	300	"	
Tuesday	"	"	"	"	
Wednesday	"	"	"	"	
Thursday	"	"	"	"	
Friday	"	"	"	"	
Saturday	"	"	"	"	

Entertainment Indoor Closing Hours - If alcohol beverage establishment, same as alcohol license hours.  
If non-alcohol establishment 1:00 am Sunday to Thursday; 1:30 am Friday and Saturday.

Entertainment Outdoor Closing Hours - 10:00 pm Sunday - Thursday; 12:00 am Friday and Saturday, unless otherwise approved by Common Council in licensee's plan of operation.

## 11. Required Signature(s)

Jehdi Fames

Sole Proprietor, Partner, 20% or more Shareholder, or Agent - only if there are no 20% or more shareholders

Jehdi Fames

Signature of additional partner or 20% or more shareholder

See Application Information for a list of all required application forms.

FREEZ FOOD MART LLC, D/3/4  
MEMBER/AGENT: JEHAD FARES  
2526 WEST HOPKINS STREET  
MILWAUKEE WI 53206  
114-444-4489  
Signature: *Jehad Fares*

Signature: Jedid Fanes

TOTAL SQUARE FEET – 3,600 SF  
STORAGE SQUARE FOOTAGE – 600 SF  
Date: 07/02/2015

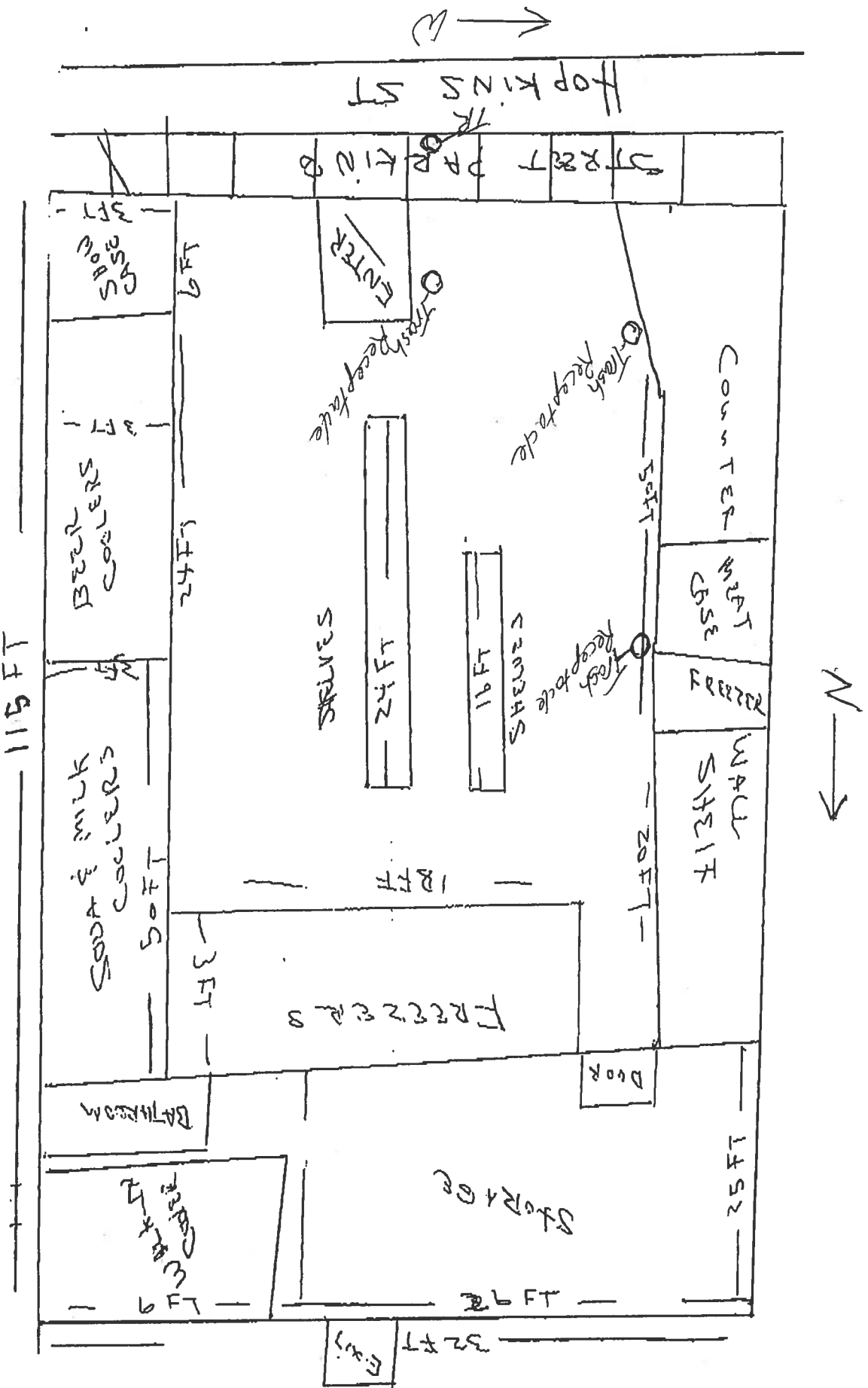



# ALCOHOL BEVERAGE & PUBLIC ENTERTAINMENT PREMISES SUPPLEMENTAL PLAN OF OPERATION

Office of the City Clerk License Division

200 E. Wells St. Room 105, Milwaukee, WI 53202

(414) 286-2238 e-mail address: [license@milwaukee.gov](mailto:license@milwaukee.gov) [www.milwaukee.gov/license](http://www.milwaukee.gov/license)Legal Entity Name: Freez Food Mart LLCPremise Address: 2526 W. Hopkins St. Milw., WI. 53206**Proximity of Premises to Church, School, Daycare Center or Hospital**Is there at least 300 feet between the building and any church, school, daycare center or hospital? ☒ Yes ☐ No**"Service Bar Only" Designation**If applying for Class B or C license, are you applying for "Service Bar Only"? ☐ No ☐ Yes

Service Bar Only means customers cannot sit at the bar. Alcohol is served to patrons seated at tables. No stools, chairs or other articles of furniture shall be placed at the service bar for patrons to sit upon.

**Business Information**a) Are you taking out this application for anyone that may not be eligible for a license? ☒ No ☐ Yes

If yes, list name and address: \_\_\_\_\_

b) Will the agent, a partner or the individual licensee be conducting the day-to-day operations of the business? ☐ No ☒ Yes

If no, list the name and address of the person(s) who will: \_\_\_\_\_

Class B Applicants: If the agent, a partner or the individual licensee will not be conducting the day-to-day operations of the business, the person(s) listed above must obtain a Class B Managers license.

c) Does anyone else have money invested or any other interest in this business? ☒ No ☐ Yes

If yes, explain: \_\_\_\_\_

d) Have you made an agreement with anyone to repay any loan or any other payments based upon income from the business?

☒ No ☐ Yes If yes, list name and address: \_\_\_\_\_**Proof of Ownership, Lease, or Offer to Purchase (new & transfer applicants only)**

Submit proof of ownership, lease, or offer to purchase the building with this application.

A lease or offer to purchase must:

- a) Be in the same legal entity name as that apply for the license
- b) Reflect the same address as the premises address on this application
- c) Reflect current dates and
- d) Be signed by the lessor/seller and lessee/buyer

**Property Information (new & transfer applicants only)**a) Do you own or lease the building? ☐ Own ☒ Leaseb) Who owns the fixtures (for example, coolers, etc.)? Applicantc) Are you purchasing the stock and/or fixtures? ☐ No ☒ Yes If yes, amount paid \$ 55,000d) Total amount paid for business \$ 75,000e) Total amount paid for goodwill of the business \$ 0

Goodwill comprises the reputation and customer relationships of an existing business. If the price you pay for the business exceeds the fair market value of all of the rest of the assets of the business, the excess may be considered goodwill.

f) Have you made arrangements with the seller for payment of personal property taxes? ☐ No ☒ Yes**See Application Information for a list of all required application forms.**

**Lease Information (new & transfer applicants who are leasing the premises only)**

- a) Date lease begins 6-1-15 Ends 5-31-20
- b) Monthly rental \$ 2,500
- c) Do you have an option to renew the lease? ☐ No ☒ Yes
- d) Does your lease allow for assignment to another party without the consent of the owner? ☒ No ☐ Yes
- e) For what length of time have you been guaranteed occupancy (number of years)? 5
- f) In addition to paying the monthly rental, will you have to pay anything additional to the owner of the building to guarantee performance of the lease? ☒ No ☐ Yes If yes, explain \_\_\_\_\_
- g) Does the present owner or occupancy object to the granting of your license? ☒ No ☐ Yes  
If yes, explain \_\_\_\_\_

**Change of Agent Applicants Only**

Have there been any changes to the floor plan since the last application was submitted? ☒ No ☐ Yes

If no, a new floor plan is not required. If yes, submit a new floor plan and explain the change(s): \_\_\_\_\_

**Notarized Signatures of Applicants**

SUBSCRIBED AND SWORN TO BEFORE ME

This 2nd day of April

(Clerk/Notary Public)

My Commission Expires

\*Notary Seal must be affixed.

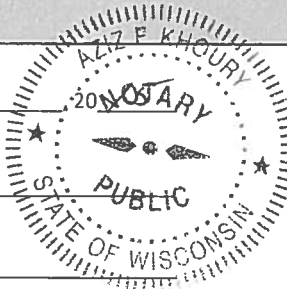

Johel F. Amos

Sole Proprietor, Partner, 20% or more Shareholder, or  
Agent – only if there are no 20% or more shareholders

Additional partner or 20% or more shareholder

Note: All information contained in this application is subject to approval by the Common Council.

Deviating from approved plan of operation will subject licensee to citations, and/or suspension or non-renewal of the license.

Contact the License Division for information on how to request changes.

**New and transfer of premise applicants must submit the following:**

- ☐ Proof of ownership, lease or offer to purchase the building ☐ Detailed floor plan ☐ If a restaurant, copy of the menu



# FOOD DEALER LICENSE PLAN OF OPERATION

OFFICE OF THE CITY CLERK, LICENSE DIVISION

CITY HALL, 200 E. WELLS ST, ROOM 105, MILWAUKEE, WI 53202 •

(414) 286-2238 • [license@milwaukee.gov](mailto:license@milwaukee.gov) • [www.milwaukee.gov/license](http://www.milwaukee.gov/license)Legal Entity Name: Freez Food Mart LLCPremise Address: 2526 W. Hopkins St. Milw. WI. 53206

## 1. Application Type

Indicate the application type and complete the corresponding section.

☒ **New application** (fee is \$300). For new applications, answer questions below and then continue on to section 2.

Is this a simple change of ownership (no change in food operation) or a new establishment?

- ☒ Taking over existing operating licensed food business  
☐ New establishment (anything other than a simple change of ownership)

Provide a brief description of the food establishment

Retail Grocery Store

What is the anticipated opening date or date of change of ownership:

6-1-15
☐ **Site Evaluation - Optional** (fee is \$100) Site evaluations are optional, and done only upon request. The purpose of the site evaluation is to assess the suitability of a prospective site for use as a food establishment.

☐ **Modification or amendment** to an existing food license or public health approved operational plan. For modifications/amendments to existing establishments, both the operator and establishment cannot be different than on existing license or the application is considered new. Answer the two questions below (including the follow up detail if applicable) and then continue on to section 2.

What facilities (equipment or building) change(s) are you planning (check all that apply):

- ☐ Construction or renovation (fee is \$200)  
☐ Significant equipment change without construction or renovation (fee is \$50)  
☐ Adding an additional site at the same premises where food will be prepared/processed or sold (fee is \$100 per additional site)  
☒ No equipment or renovations are being planned

What changes are being proposed to the food operation or specialized approvals are being requested (Note: \$75 operational change fee is charged only once even if multiple items are checked):

- ☐ Substantial changes to the menu including the type or complexity of food processing (fee is \$75)

Briefly describe proposed changes

- ☐ Adding processing when no processing was previously performed, or adding additional types of processing (fee is \$75)

- ☐ Requests for modifications or variances to public health food code requirements or the review of a specialized process requiring health department approval prior to implementation (fee is \$75)

Indicate specialized processes/variances requested (check all that apply):

- |  |  |
|--|--|
| <input type="checkbox"/> Acidified Rice                          | <input type="checkbox"/> Sale without Consumer Advisory  |
| <input type="checkbox"/> Bare Hand Contact to Ready to Eat Foods | <input type="checkbox"/> Shellfish - Comingling          |
| <input type="checkbox"/> Curing                                  | <input type="checkbox"/> Shellfish - Display Tanks       |
| <input type="checkbox"/> Dogs in Outside Dining Areas            | <input type="checkbox"/> Smoking                         |
| <input type="checkbox"/> Non-continuous Cooking                  | <input type="checkbox"/> Sprouting                       |
| <input type="checkbox"/> Peddler Base                            | <input type="checkbox"/> Time as a Public Health Control |
| <input type="checkbox"/> Reduced Oxygen Packaging                | <input type="checkbox"/> Wild Game                       |
| <input type="checkbox"/> Other, specify                          |  |

- ☐ Amending existing license to reflect an increase in annual gross sales or change in food operation (fee is the difference in the cost between the food licenses plus \$25 for transfer fee)

- ☒ No significant changes are being proposed in how food is prepared/processed or substantial menu changes. No addition of specialized process or activities requiring approval is being requested (no fee)

## 2. Premises Description

Will food be prepared or sold at a single or multiple food preparation and/or sale sites: ☒ Single ☐ Multiple

If multiple sites will be used, how many distinct sites will be used?

List all sites and briefly describe the nature of the food activities at each site:

*Application Location - Grocery & Meats packaged*

Note: Multiple sites may require more than one license or an additional site license depending upon the food activity conducted at any one site.

Indicate where on the premises food will be sold, served, consumed and/or stored: ☒ 1<sup>st</sup> Floor ☐ 2<sup>nd</sup> Floor ☐ Rooftop ☐ Basement

☐ Other Floor, specify \_\_\_\_\_

☐ Other location, specify \_\_\_\_\_

Are any outdoor operations planned? ☐ Yes ☒ No ☐ Unknown

What activities will be conducted outdoors (check all that apply)

☐ Bar

☐ Cooking/grilling

☐ Dining - Patio

☐ Dining - Sidewalk (DPW permit required)

☐ Storage

☐ Other, specify \_\_\_\_\_

Seating provided on site for dining? ☐ Yes ☒ No

If yes, what is the seating capacity both inside and outside?

If yes, are there additional banquet facilities other than the main dining area? ☐ Yes ☐ No

Total square footage of the establishment (exclude space utilized for other purposes other than food)

Annual Gross Food Sales:

Sales Based on: ☐ Previous Year ☐ Previous Establishment ☒ Best Estimate

Note: Inspector will request to review receipts periodically to validate if establishment has the appropriate license.

Number of Full Time Employees

Number of Part Time Employees

The following items must be included with a new application at the time of filing:

☒ Site Plan/Floor Plan: Site plan must identify the building in relation to streets, sidewalks, parking & garbage area, see sample and instructions. Food manufacturers, distributors, commissaries, and meal service establishments as defined in section 4 are exempt.

☐ Shared Kitchen Agreement, if applicable: If not using your own establishment as your base, provide a written and signed commissary agreement. The agreement must include a list of all services provided by the commissary, such as restroom use, dry goods storage, use of refrigerator space (including the number of cubic feet of refrigeration space allocated to you), etc.

The following items must be submitted to inspector, prior to approval of inspection.

☐ Floor Plan: The plan must show the location of all equipment (sinks, refrigeration, stoves, ware-washing, etc.), plumbing, electrical services, mechanical ventilation, storage areas and restrooms. Plans must be a minimum of 11 X 14 inches in size including the layout of the floor plan accurately drawn to a minimum scale of 1/4 inch = 1 foot. Plans may be submitted in an electronic format.

☐ Equipment List: Provide the make and model number of all significant equipment (cooking, cooling, warewashing, etc.) All food equipment must be ANSI/NSF certified. No home-style equipment is allowed. Equipment specification sheets do not have to be provided at the time of submission, but must be provided upon Health Department request

☐ Finish Materials List: Provide a list of all finish materials (floors, walls, ceilings, counter tops). Surfaces must be smooth, nonabsorbent and easily cleanable, and ceramic, porcelain or quarry tile must have set in base cove.

☐ Lighting Plan: Provide a list of all light fixtures to be used in the food establishment. All light used in any food prep or storage areas must be shielded or covered and flush or integral to the ceiling. Lighting in food preparation area must meet minimum illumination standards defined in the WI Food Code.

☐ Pest Management Plan: Describe the establishments integrated pest management plan. Describe strategies to prevent pest entry into the food establishment & harborage of pests Identify if a licensed pest control service has been contracted, provide the name of the company and frequency of service.

### 3. Construction, Renovations, Kitchen Equipment Changes or Remodeling

Any construction, remodeling or equipment changes planned? ☐ Yes ☒ No If no, skip to section 4.

Scope of the planned project?

- ☐ New construction or conversion of an existing structure to be used as a food establishment
- ☐ Renovation/remodeling impacting 300ft<sup>2</sup> or more than of food preparation or display area
- ☐ Renovation/remodeling impacting less than 300ft<sup>2</sup> of food preparation or display area
- ☐ Renovation/remodeling limited to the instillation/change/replacement of food equipment

Provide a brief summary of the proposed construction, remodeling and/or equipment change:

Note: Building permits may be required, contact the Department of Neighborhood Services

Date alterations/changes planned to begin \_\_\_\_\_

Contact information for general contractor \_\_\_\_\_

Contact information for architect \_\_\_\_\_

### 4. BUSINESS TYPE

Overall Establishment Type (select the one that best describes the proposed business)

- ☐ Bed and Breakfast
- ☐ Commissary or Mobile Food Peddler Base – a commercial kitchen used for the production of food to be served or sold at another location; a base of operations for a mobile food peddler where the vehicle, cart or unit which is used at a minimum for the service or cleaning of the peddler vehicle, cart or container. A base of operations for a caterer or seasonal market vendor for the preparation of food.
- ☐ Community Food Program – free meal site or food pantry. Any site in which all food is provided free of cost to those in need or to organizations who serve person's in need.
- ☐ Distiller or Brewer – facilities that are primarily engaged in the production of alcoholic beverages
- ☐ Food Distributor – a business that transports food for sale to retail and wholesale establishments and does not perform any processing or repacking of food items  
Is food stored on site ☐ Yes ☐ No
- ☐ Food Manufacturer - commercial operation that produces, packages, labels, or stores food for human consumption, but primarily does not provide food directly to a consumer, food is sole to distributors, retailers or restaurants, there may be a small store on site where only the manufacturers products are sold, but the majority of product is sold to other licensed food establishments  
Is there a retail store onsite? ☐ Yes ☐ No
- ☒ Food Store – a food establishment either mobile or permanent in which the majority of food sales consist of beverages or multi-serving food products requiring further preparation prior to consumption, examples of food stores include bakeries, grocery stores, convenience stores, coffee shops, liquor stores. Food stores include business whose primary business is other than food, but offer convenience food items.

Are you considered a convenience food store? ☒ Yes ☐ No

A convenience food store contains less than 5,000 sq ft of retail sales space AND has as its primary business the sale of basic food items and in addition sells household products. Basic food items may include, but are not limited to, milk and dairy products, bread products, prepared sandwiches, frozen entrees, refrigerated food and baby food. Household products may include, but are not limited to, cleaning products, paper products, baby products and pet food

- ☐ School – educational institution including elementary, middle and high schools, technical schools, colleges and university, where food service is limited to students (no sales to faculty or general public)
- ☐ Restaurant – a food establishment either mobile or permanent in which the majority food sales consist of meals

### 5. FOOD OPERATION SCOPE

Type of Sales (check all that apply, even if it reflects a small percentage of the proposed business)

- ☒ Made directly to the general public or end consumer (includes internet sales)
- ☐ Made to other food establishments (wholesaler, distributors, retail or restaurants) who will resell your product(s)

What percentage of your planned food sales will be meals versus grocery items?

☐ % from meals (ready-to-eat food sold to in single portions)

☒ % from grocery items (multi-serving food products, typically requiring preparation before serving, includes beverages, bakery items and raw produce)

Will 25% or more of your sales be to highly susceptible populations (defined as persons with medical conditions, elderly, or preschool age children)? ☐ Yes ☒ No

Will customers be able to purchase food through a drive through? ☐ Yes ☒ No

Will customers be able to purchase food from a self-service salad or food bar? ☐ Yes ☒ No

Will food be prepared on site and then transported for sale or consumption at another location? ☐ Yes ☒ No

If yes, check all the reason why the food will be transported

☐ Catering ☐ Delivery ☐ Base for Mobile Food Peddler ☐ Base for temporary or seasonal food stand

☐ Other, specify

## 6. FOOD, FOOD PREPERATION, FOOD PROCESSING

For restaurants provide a copy of the proposed menu or a detailed menu of all the foods and drinks you will be serving.

For all other establishments provide a summary below of the brief types of food products being sold.

Will any potentially hazardous food (food that requires temperature control) be offered for sale? ☒ Yes ☐ No

Examples of potentially hazardous foods are meats, dairy, poultry, eggs, cut tomatoes or leafy greens, cut melons, cooked rice, beans or potatoes, or garlic in oil.

Will food be prepared or processed on site? ☐ Yes ☒ No

Examples of processing are assembling, grinding, cutting, mixing, baking, grilling, frying, coating, stuffing, packing, bottling, packaging, canning, extracting, fermenting, distilling, pickling, freezing, drying, smoking.

If yes, indicate the type of food processing that will be conducted:

If performing processing, will there be any processing of potentially hazardous food? ☐ Yes ☐ No

## 7. WEIGHTS AND MEASURES

Will any items be offered for sale by weight or by volume? ☒ Yes ☐ No

If yes, describe number and type of devices used:

Fruits + Vegetables

A separate weights and measures license is required for each scale.

Will electronic scanning devices be used for pricing/check out? ☐ Yes ☒ No

If yes, how many devices will be used

A scanner license is required if using an electronic scanning device.

## 8. ISSUANCE OF LICENSE

Will any alcohol or intoxicating beverages be sold at the establishment? ☒ Yes ☐ No

If yes, what type of license do you have or will you be applying for (check all that apply)?

- ☒ Class A fermented malt beverage licenses
- ☐ Class A liquor licenses
- ☐ Class B fermented malt beverage licenses
- ☐ Class B liquor licenses
- ☐ Class C wine licenses

If yes, if your food license is approved prior to the alcohol license, would you like the food license issued (check one)

- ☐ immediately so you can open your food business
- ☒ at the same time as the alcohol license



## 9. Affirmation of Understanding – Permit Needed to Operate

READ AND INITIAL EACH ITEM CONFIRMING YOUR UNDERSTANDING:

1. JF I understand that an inspection and sign off by the Health Department is required before my permit may be issued.
2. JF I understand that an occupancy permit must be issued and an inspection may be required from the Department of Neighborhood Services before my permit may be issued.
3. JF I understand that the Department of Neighborhood Services must sign off on my application with the License Division before my permit may be issued.
4. JF I understand the local council member must approve or deny my request before my permit is eligible to be issued. If denied, I understand that I may be scheduled for a hearing before the License Committee of the Common Council.
5. JF I understand that I must pay and the License Division must have proof of payment for the associated permit fees before my permit may be issued.
6. JF I understand that all of the above must be complete before my permit is eligible to be issued.
7. JF I understand that the license/permit for which I am applying must be issued and posted in my business premises prior to opening for business.
8. JF I will not operate my food business until the permit has been issued and posted in the establishment.

## 10. Required Signature(s)

John Fones

Sole Proprietor, Partner, 20% or more Shareholder,  
or the Agent - only if there are no 20% or more shareholders

John Fones

Signature of additional partner or 20% or more shareholder

**SUBMIT THIS FORM ALONG WITH THE  
"BUSINESS LICENSE APPLICATION" & "BUSINESS LICENSE PLAN OF OPERATION"**



**CITY OF MILWAUKEE  
OFFICE OF THE CITY CLERK**

Monday, November 02, 2015

**COMMITTEE MEETING NOTICE**

AD 06

KAUR, Charanjit, Agent  
Center Street Liquor Store Inc  
513 E Center St

Milwaukee, WI 53212

You are requested to attend a hearing which is to be held in Room 301-B, Third Floor, City Hall on:

**Tuesday, November 10, 2015 at 10:45 AM**

**Regarding:** Your Class A Malt & Class A Liquor and Food Dealer's License Renewal Applications as agent for "Center Street Liquor Store Inc" for "Center Street Liquor Store" at 513 E Center St.

There is a possibility that your application may be denied for one or more of the following reasons. The recommendation of the committee regarding the application shall be based on evidence presented at the hearing. Per MCO 85-4-4, unless otherwise specified in the code, probative evidence concerning non-renewal, suspension or revocation may include evidence of the following: failure of the applicant to meet municipal qualifications, pending charges against or the conviction of any felony, misdemeanor, municipal offense or other offense, the circumstances of which substantially relate to the circumstances of the particular licensed or permitted activity, by the applicant or by any employee or other agent of the applicant. If the activities of the applicant involve a licensed premises, whether the premises tends to facilitate a public or private nuisance or has been the source of congregations of persons which have resulted in any of the following: disturbance of the peace; illegal drug activity; public drunkenness; drinking in public; harassment of passers-by; gambling; prostitution; sale of stolen goods; public urination; theft; assaults; battery; acts of vandalism including graffiti, excessive littering, loitering, illegal parking, loud noise at times when the licensed premise is open for business; traffic violations; curfew violations; lewd conduct; display of materials harmful to minors, pursuant to s. 106-9.6; or any other factor which reasonably relates to the public health, safety and welfare, or failure to comply with the approved plan of operation. See attached police report or correspondence.

**Notice for applicants with  
warrants or unpaid fines:**

Proof of warrant satisfaction or payment of fines must be submitted at the hearing on the above date and time. Failure to comply with this requirement may result in a delay of the granting/denial of your application.

Failure to appear at this meeting may result in the denial of your license. Individual applicants must appear only in person or by an attorney. Corporate or Limited Liability applicants must appear only by the agent designated on the application or by an attorney. Partnership applicants must appear by a partner listed on the application or by an attorney. If you wish to do so and at your own expense, you may be accompanied by an attorney of your choosing to represent you at this hearing.

You will be given an opportunity to speak on behalf of the application and to respond and challenge any charges or reasons given for the denial. No petitions can be accepted by the committee, unless the people who signed the petition are present at the committee hearing and willing to testify. You may present witnesses under oath and you may also confront and cross-examine opposing witnesses under oath. If you have difficulty with the English language, you should bring an interpreter with you, at your expense, so that you can answer questions and participate in your hearing.

You may examine the application file at this office during regular business hours prior to the hearing date. Inquiries regarding this matter may be directed to the person whose signature appears below.

Limited parking for persons attending meetings in City Hall is available at reduced rates (5 hour limit) at the Milwaukee Center on the southwest corner of East Kilbourn and North Water Street. Parking tickets must be validated in the first floor information booth in City Hall.

PLEASE NOTE: Upon reasonable notice, efforts will be made to accommodate the needs of disabled individuals through sign language interpreters or other auxiliary aids. For additional information or to request this service, contact the Council Services Division ADA Coordinator at (414) 286-2998, Fax - (414) 286-3456, TDD - (414) 286-2025.

**JIM OWCZARSKI, CITY CLERK**

BY:

Jason Schunk  
License Division Manager

**If you have questions regarding this notice, please contact the License Division at (414) 286-2238.**

200 E. Wells Street, Room 105, City Hall, Milwaukee, WI 53202. [www.milwaukee.gov/license](http://www.milwaukee.gov/license)  
Phone: (414) 286-2238 Fax: (414) 286-3057 Email Address: [License@milwaukee.gov](mailto:License@milwaukee.gov)

# MILWAUKEE POLICE DEPARTMENT

## LICENSING

### CRIMINAL RECORD/ORDINANCE VIOLATION/INCIDENTS SYNOPSIS

**DATE:** 09/29/2015

**LICENSE TYPE:** ALQML

**NEW:** ☐

**RENEWAL:** ☒

**No. 218261**

**Application Date:** 09/29/2015

**License Location:** 513 East Center Street

**Business Name:** Center Street Liquor Store

**Licensee/Applicant:** Kaur, Charanjit  
(Last Name, First Name, MI)

**Date of Birth:** 08/24/1965

**Home Address:** 2518 West Wisconsin Ave. #402

**City:** Milwaukee

**State:** WI **Zip Code:** 53233

**Home Phone:** (414) 323-0387

This report is written by Police Officer Gilbert Gwinn, assigned to the License Investigation Unit, Days.

The Milwaukee Police Department's investigation regarding this application revealed the following:

1. On 07/19/2014 a 17 year old, working in conjunction with Milwaukee police on the Wisconsin WINS tobacco initiative, was able to purchase a Black and Mild brand cigar from the cashier at Center Street Liquor (513 East Center Street). The applicant was cited.

**Charge:** Sale of Cigarette to Minor/Underage

**Finding:** Guilty

**Sentence:** \$260.00 fine

**Date:** 02/02/2015

**Case:** 14054163

=====

Item #1 previously reported, disposition added 09/29/2015.



Monday, November 02, 2015



# Notice of Public Hearing

---

KAUR, Charanjit, Agent  
Center Street Liquor Store at 513 E Center St  
Class A Malt & Class A Liquor and Food Dealer's License Renewal Applications

**Tuesday, November 10, 2015 at 10:45 AM**

To whom it may concern:

The above application has been made by the above named applicant(s). This requires approval from the Licenses Committee and the Common Council of the City of Milwaukee. The hearing before the Licenses Committee will take place on 11/10/2015 at 10:45 AM, in Room 301-B, Third Floor, City Hall. If you wish, you may provide testimony at the hearing regarding the request; see below for further information. You are not required to attend the hearing. Once the Licenses Committee makes its recommendation, this recommendation is forwarded to the full Common Council for approval at its next regularly scheduled hearing. Please review the information below and if you have further questions regarding this process, please contact the License Division at (414) 286-2238.

---

## Important details for those wishing to provide information for the Licenses Committee to consider when making its recommendation:

1. The license application is scheduled to be heard at the above time. Due to other hearings running longer than scheduled, you may have to wait some time to provide your testimony.
2. You must appear in person and testify as to matters that you have personally experienced or seen. (You cannot provide testimony for your neighbor, parent or anyone else; this is considered hearsay and cannot be considered by the committee.)
3. No letters or petitions can be accepted by the committee (unless the person who wrote the letter or the persons who signed the petition are present at the committee hearing and willing to testify).
4. Persons opposed to the license application are given the opportunity to testify first; supporters may testify after the opponents have finished.
5. When you are called to testify, you will be sworn in and asked to give your name, and address. (If your first and/or last names are uncommon please spell them.)
6. You may then provide testimony.
  - a. Include only information relating to the above license application.
  - b. Include only information you have personally witnessed or seen.
  - c. Provide concise and relevant information detailing how this business has affected or may affect the peaceful enjoyment of your neighborhood.
  - d. If by the time you have the opportunity to testify, the information you wish to share has already been provided to the committee, you may state that you agree with the previous testimony. Redundant or repetitive testimony will not assist the committee in making its recommendation.
7. After giving your testimony, the members of the Licenses Committee and the licensee may ask questions regarding the testimony you have given or other factors relating to the license application.
8. Business Competition is not a valid basis for denial or non-renewal of a license.  
**Please Note: If you have submitted an objection to the above application your objection cannot be considered by the committee unless you personally testify at the hearing.**

RESIDENT	MAIL ADDRESS	CITY AND ZIP CODE
CURRENT RESIDENT	2637 N BOOTH ST	MILWAUKEE, WI 53212-2908
CURRENT RESIDENT	2639 N BOOTH ST	MILWAUKEE, WI 53212-2908
CURRENT RESIDENT	2640 N HOLTON ST	MILWAUKEE, WI 53212-2929
CURRENT RESIDENT	2641 N BOOTH ST	MILWAUKEE, WI 53212-2908
CURRENT RESIDENT	2643 N HOLTON ST	MILWAUKEE, WI 53212-2928
CURRENT RESIDENT	2645 N BOOTH ST	MILWAUKEE, WI 53212-2908
CURRENT RESIDENT	2647 N BOOTH ST	MILWAUKEE, WI 53212-2908
CURRENT RESIDENT	2647 N HOLTON ST	MILWAUKEE, WI 53212-2928
CURRENT RESIDENT	2648 N HOLTON ST	MILWAUKEE, WI 53212-2929
CURRENT RESIDENT	2648A N HOLTON ST	MILWAUKEE, WI 53212-2929
CURRENT RESIDENT	2648B N HOLTON ST	MILWAUKEE, WI 53212-2929
CURRENT RESIDENT	2649 N BOOTH ST	MILWAUKEE, WI 53212-2908
CURRENT RESIDENT	2649 N HOLTON ST	MILWAUKEE, WI 53212-2928
CURRENT RESIDENT	2650 N HOLTON ST	MILWAUKEE, WI 53212-2929
CURRENT RESIDENT	2650A N HOLTON ST	MILWAUKEE, WI 53212-2929
CURRENT RESIDENT	2651 N BOOTH ST	MILWAUKEE, WI 53212-2908
CURRENT RESIDENT	2652 N BOOTH ST	MILWAUKEE, WI 53212-2909
CURRENT RESIDENT	2652 N HOLTON ST	MILWAUKEE, WI 53212-2929
CURRENT RESIDENT	2652A N BOOTH ST	MILWAUKEE, WI 53212-2909
CURRENT RESIDENT	2653 N HOLTON ST	MILWAUKEE, WI 53212-2928
CURRENT RESIDENT	2655 N HOLTON ST	MILWAUKEE, WI 53212-2928
CURRENT RESIDENT	2656 N BOOTH ST	MILWAUKEE, WI 53212-2909
CURRENT RESIDENT	2656 N HOLTON ST	MILWAUKEE, WI 53212-2929
CURRENT RESIDENT	2657 N BOOTH ST	MILWAUKEE, WI 53212-2908
CURRENT RESIDENT	2657 N HOLTON ST	MILWAUKEE, WI 53212-2928
CURRENT RESIDENT	2657A N BOOTH ST	MILWAUKEE, WI 53212-2908
CURRENT RESIDENT	2658 N BOOTH ST	MILWAUKEE, WI 53212-2909
CURRENT RESIDENT	2658 N HOLTON ST	MILWAUKEE, WI 53212-2929
CURRENT RESIDENT	2660 N BOOTH ST	MILWAUKEE, WI 53212-2909
CURRENT RESIDENT	2663 N BOOTH ST	MILWAUKEE, WI 53212-2908
CURRENT RESIDENT	2663A N BOOTH ST	MILWAUKEE, WI 53212-2908
CURRENT RESIDENT	2663A N HOLTON ST	MILWAUKEE, WI 53212-2928
CURRENT RESIDENT	2664 N BOOTH ST	MILWAUKEE, WI 53212-2909
CURRENT RESIDENT	2665 N HOLTON ST	MILWAUKEE, WI 53212-2928
CURRENT RESIDENT	2668 N HOLTON ST	MILWAUKEE, WI 53212-2929
CURRENT RESIDENT	2668A N HOLTON ST	MILWAUKEE, WI 53212-2929
CURRENT RESIDENT	2669 N BOOTH ST	MILWAUKEE, WI 53212-2908
CURRENT RESIDENT	2669A N HOLTON ST	MILWAUKEE, WI 53212-2928
CURRENT RESIDENT	2669B N HOLTON ST	MILWAUKEE, WI 53212-2928
CURRENT RESIDENT	2672 N HOLTON ST A	MILWAUKEE, WI 53212-2929
CURRENT RESIDENT	2674 N HOLTON ST	MILWAUKEE, WI 53212-2929
CURRENT RESIDENT	2675 N BOOTH ST	MILWAUKEE, WI 53212-2908
CURRENT RESIDENT	2675 N HOLTON ST	MILWAUKEE, WI 53212-2928
CURRENT RESIDENT	2676 N HOLTON ST A	MILWAUKEE, WI 53212-2929
CURRENT RESIDENT	2678 N HOLTON ST	MILWAUKEE, WI 53212-2929
CURRENT RESIDENT	2704 N BOOTH ST 1	MILWAUKEE, WI 53212-2558
CURRENT RESIDENT	2704 N BOOTH ST 2	MILWAUKEE, WI 53212-2558
CURRENT RESIDENT	2704 N BOOTH ST 3	MILWAUKEE, WI 53212-2558
CURRENT RESIDENT	2704 N BOOTH ST 4	MILWAUKEE, WI 53212-2558
CURRENT RESIDENT	2707 N BOOTH ST	MILWAUKEE, WI 53212-2532
CURRENT RESIDENT	2707A N BOOTH ST	MILWAUKEE, WI 53212-2532
CURRENT RESIDENT	2717 N BOOTH ST	MILWAUKEE, WI 53212-2532
CURRENT RESIDENT	2717A N HOLTON ST	MILWAUKEE, WI 53212-2519
CURRENT RESIDENT	2723 N BOOTH ST	MILWAUKEE, WI 53212-2532
CURRENT RESIDENT	2723A N BOOTH ST	MILWAUKEE, WI 53212-2532

CURRENT RESIDENT	2723B N BOOTH ST	MILWAUKEE, WI 53212-2532
CURRENT RESIDENT	2725 N BOOTH ST	MILWAUKEE, WI 53212-2532
CURRENT RESIDENT	427 E CENTER ST	MILWAUKEE, WI 53212-2916
CURRENT RESIDENT	504 E CENTER ST	MILWAUKEE, WI 53212-2957
CURRENT RESIDENT	505 E CENTER ST	MILWAUKEE, WI 53212-2956
CURRENT RESIDENT	506 E CENTER ST	MILWAUKEE, WI 53212-2957
CURRENT RESIDENT	510 E CENTER ST	MILWAUKEE, WI 53212-2957
CURRENT RESIDENT	512 E CENTER ST	MILWAUKEE, WI 53212-2957
CURRENT RESIDENT	514 E CENTER ST	MILWAUKEE, WI 53212-2957
CURRENT RESIDENT	518 E CENTER ST	MILWAUKEE, WI 53212-2957
CURRENT RESIDENT	524 E CENTER ST	MILWAUKEE, WI 53212-2957
CURRENT RESIDENT	524A E CENTER ST	MILWAUKEE, WI 53212-2957
CURRENT RESIDENT	524B E CENTER ST	MILWAUKEE, WI 53212-2957

**Total Records: 69**

**Radius: 250.0 feet and Center of Circle: 513 E Center ST**

**2015-2016 Plan of Operation for 513 E CENTER ST****1. Litter and Noise**How are the grounds kept clean? ☒ Sweep ☐ Pressure Wash ☒ Pick Up Litter ☐ Other: \_\_\_\_\_How often will grounds be cleaned? ☒ Daily ☐ Weekly ☐ Other: \_\_\_\_\_Grounds Cleaned By: ☒ Licensee ☐ Building Owner ☒ Employees ☐ Hired Maintenance ☐ Other: \_\_\_\_\_How are noise issues prevented and/or addressed? ☐ Security ☒ Manager approaches customer(s) ☐ Call Police☒ Signs Posted ☐ Other: \_\_\_\_\_**2. Smoking and Sanitation**Are there designated outdoor smoking areas? ☒ No ☐ Yes

If yes, describe the area(s) and provide location(s): \_\_\_\_\_

Number of Garbage Cans: Inside: 2 Locations: BY CASH REGISTER / IN BATHROOMOutside: 1 Locations: BY FRONT DOORIs a Crowd Control Barrier used? ☒ No ☐ Yes If yes, describe: \_\_\_\_\_Describe sanitation facilities (restrooms): 1 REST ROOMProvide name of solid waste contractor: WASTE MANAGEMENT**3. Security**Are there parking spaces on the premises? ☒ No ☐ Yes If yes, number of spaces: \_\_\_\_\_ and describe security provisions: \_\_\_\_\_Are there designated loading areas? ☒ No ☐ Yes If yes, describe security provisions: \_\_\_\_\_Do you have security personnel on the premise? ☒ No ☐ Yes If yes, how many? 2

AND What are their responsibilities? \_\_\_\_\_

What security equipment do they use? \_\_\_\_\_

List their licensing, certification or training credentials: \_\_\_\_\_

Are there security cameras? ☐ No ☒ Yes If yes, list all locations: MONITORS INSIDE / STORE SURROUNDINGSAre searches and/or identification checks conducted upon entry? ☒ No ☐ Yes If yes, describe: \_\_\_\_\_**4. Percentage of Sales (must total 100%)**Alcohol 80 % Food Sales 20 % Entertainment 0 % Other 0 %**5. Businesses On The Premise (choose all that apply):**

- |  |   |  |   |
|--|---|--|---|
| <input type="checkbox"/> Full Service Restaurant | <input type="checkbox"/> Cafe/Coffee Shop | <input type="checkbox"/> Deli or Fast Food Rest. | <input type="checkbox"/> Private/Fraternal/Veterans' Club |
| <input type="checkbox"/> Night Club              | <input type="checkbox"/> Tavern           | <input type="checkbox"/> Cocktail Lounge         | <input type="checkbox"/> Teen Club                        |
| <input type="checkbox"/> Bowling Alley           | <input type="checkbox"/> Hotel            | <input type="checkbox"/> Banquet Hall            | <input type="checkbox"/> Sports Facility                  |
| <input checked="" type="checkbox"/> Liquor Store | <input type="checkbox"/> Corner Store     | <input type="checkbox"/> Supermarket             | <input type="checkbox"/> Convenience Store                |
| <input type="checkbox"/> Gas Station             | <input type="checkbox"/> Other _____      |  |   |

**6. Hours of Operation and Age Restriction**Are there any changes to the current hours of operation or age restriction? ☒ No ☐ Yes If yes, describe: \_\_\_\_\_

**Please Note:** If you will be open earlier or later than the hours listed on your current license for even one event or holiday (for example, St. Patrick's Day, Brewers Opening Day, etc.) during the license period, this must be reported and printed on your license.

Your hours of operation and age restriction are listed on your current license.

**7. Floor Plan**Are there any changes to the current floor plan? ☒ No ☐ Yes If yes, describe: \_\_\_\_\_

AND submit a new floor plan with this application. Changes in floor plan include changing the location of tables, games, etc. within your current licensed premises. If your changes include adding any additional areas or square footage to your premises, or any renovations to the building will be done, a Permanent Extension of Premises application must be filed.