



**CITY OF MILWAUKEE
OFFICE OF THE CITY CLERK**

Friday, October 09, 2015

COMMITTEE MEETING NOTICE

AD 09

HUBBARD, Bryant K, Agent
HUBBARD & ASSOCIATES NA, INC
6901 W BROWN DEER Rd

MILWAUKEE, WI 53223

You are requested to attend a hearing which is to be held in Room 301-B, Third Floor, City Hall on:

Tuesday, October 20, 2015 at 10:45 AM

Regarding: Your Class B Tavern and Public Entertainment License Renewal Applications as agent for "HUBBARD & ASSOCIATES NA, INC" for "Brew City Cafe" at 6901 W BROWN DEER Rd

There is a possibility that your application may be denied for one or more of the following reasons: The recommendation of the committee regarding the application shall be based on evidence presented at the hearing. Per MCO 85-4-4, unless otherwise specified in the code, probative evidence concerning non-renewal, suspension or revocation may include evidence of the following: failure of the applicant to meet municipal qualifications, pending charges against or the conviction of any felony, misdemeanor, municipal offense or other offense, the circumstances of which substantially relate to the circumstances of the particular licensed or permitted activity, by the applicant or by any employee or other agent of the applicant. If the activities of the applicant involve a licensed premises, whether the premises tends to facilitate a public or private nuisance or has been the source of congregations of persons which have resulted in any of the following: disturbance of the peace; illegal drug activity; public drunkenness; drinking in public; harassment of passers-by; gambling; prostitution; sale of stolen goods; public urination; theft; assaults; battery; acts of vandalism including graffiti, excessive littering, loitering, illegal parking, loud noise at times when the licensed premise is open for business; traffic violations; curfew violations; lewd conduct; display of materials harmful to minors, pursuant to s. 106-9.6; or any other factor which reasonably relates to the public health, safety and welfare, or failure to comply with the approved plan of operation. See attached police report or correspondence.

**Notice for applicants with
warrants or unpaid fines:**

Proof of warrant satisfaction or payment of fines must be submitted at the hearing on the above date and time. Failure to comply with this requirement may result in a delay of the granting/denial of your application.

Failure to appear at this meeting may result in the denial of your license. Individual applicants must appear only in person or by an attorney. Corporate or Limited Liability applicants must appear only by the agent designated on the application or by an attorney. Partnership applicants must appear by a partner listed on the application or by an attorney. If you wish to do so and at your own expense, you may be accompanied by an attorney of your choosing to represent you at this hearing.

You will be given an opportunity to speak on behalf of the application and to respond and challenge any charges or reasons given for the denial. No petitions can be accepted by the committee, unless the people who signed the petition are present at the committee hearing and willing to testify. You may present witnesses under oath and you may also confront and cross-examine opposing witnesses under oath. If you have difficulty with the English language, you should bring an interpreter with you, at your expense, so that you can answer questions and participate in your hearing.

You may examine the application file at this office during regular business hours prior to the hearing date. Inquiries regarding this matter may be directed to the person whose signature appears below.

Limited parking for persons attending meetings in City Hall is available at reduced rates (5 hour limit) at the Milwaukee Center on the southwest corner of East Kilbourn and North Water Street. Parking tickets must be validated in the first floor information booth in City Hall.

PLEASE NOTE: Upon reasonable notice, efforts will be made to accommodate the needs of disabled individuals through sign language interpreters or other auxiliary aids. For additional information or to request this service, contact the Council Services Division ADA Coordinator at (414) 286-2998, Fax - (414) 286-3456, TDD - (414) 286-2025.

JIM OWCZARSKI, CITY CLERK

BY:

Jason Schunk
License Division Manager

If you have questions regarding this notice, please contact the License Division at (414) 286-2238.

200 E. Wells Street, Room 105, City Hall, Milwaukee, WI 53202. www.milwaukee.gov/license
Phone: (414) 286-2238 Fax: (414) 286-3057 Email Address: License@milwaukee.gov

MILWAUKEE POLICE DEPARTMENT
LICENSE INVESTIGATION UNIT

CRIMINAL RECORD/ORDINANCE VIOLATION/INCIDENTS
SYNOPSIS

DATE: 09/16/2015
LICENSE TYPE: BTAVN
NEW:
RENEWAL: X

No. 217791
Application Date: 09/15/2015
Expiration Date:

License Location: 6901 W Brown Deer Rd
Business Name: MJ Café

Aldermanic District: 09

Licensee/Applicant: Hubbard, Bryant K
(Last Name, First Name, MI)
Date of Birth: 09/19/79

Male:

Female:

Home Address: 6984 D N Raintree Court
City: Milwaukee
Home Phone: (414) 397-1564

State: Wi **Zip Code: 53223**

This report is written by Police Officer Gilbert Gwinn, assigned to the License Investigation Unit, Days.

The Milwaukee Police Department's investigation regarding this application revealed the following:

1. On 05/03/05, applicant received two citations for Building Code Violations at 5864 N 41st Street and 4423 N 36th Street.

Charge: Building Code Violations (two citations)
Finding: Guilty on both
Sentence: Fined \$3,520.00
 Fined \$920.00
Date: 04/04/06
Case: 05117492
 05117695

2. On 05/11/05, applicant received a citation for Building Code Violations at 3935 N 30th Street.

Charge: Building Code Violations
Finding: Guilty
Sentence: Fined \$220.00
Date: 04/18/06
Case: 05127099

The following applies to corporate officer Karen Hubbard:

3. On 08/16/06, Karen Hubbard received a citation for Building Code Violations at 4405 N 36th Street.

Charge: Building Code Violations
Finding: Guilty
Sentence: Fined \$1,130.00
Date: 07/17/07
Case: 07017689

=====

4. On 02/20/2013 Karen Hubbard was cited at 4405 North 36th Street in the city of Milwaukee for Building Code Violations. Karen Hubbard is listed on the application as 100% shareholder.

Charge: Building Code Violations
Finding: Guilty
Sentence: \$1680.00 fine *****THIS ITEM IS IN WARRANT STATUS*****
Date: 11/20/2013
Case: 13093138

5. On 04/30/2013 the applicant was cited at 3935 North 30th Street in the city of Milwaukee for Building Code Violations.

Charge: Building Code Violations
Finding: Guilty
Sentence: \$680.00 fine
Date: 04/17/2014
Case: 13104777

=====

6. Item #4 remains in warrant status.

7. On 03/20/2015 Milwaukee police, along with an agent from the Wisconsin Department of Revenue, conducted a licensed premise check at 6901 West Brown Deer Road (Brew City Café). Several bottles of liquor that had been purchased illegally, as well as one bottle of liquor that was contaminated, were disposed of. The bartender, Karen Hubbard, received warnings regarding the proper purchase of liquor, the illegal refilling of liquor bottles and the need for a licensed bartender to be on the premises.

MILWAUKEE POLICE DEPARTMENT

REPORT OF INCIDENTS INVOLVING LICENSED PERSONS OR PREMISES

TO: +Captain Victor BEECHER

Business Name: Brew City Cafe

Address of Licensed Premises: 6901 W. Brown Deer Road

District: 4

Business Phone:

Type of License: Class B Tavern License

☐ Violation / ☐ Incident #

Date of Incident: 03-20-15

Licensee or Manager on premises at time of violation / Incident? ☒ Yes ☐ NoLicensee cooperative? ☒ Yes ☐ No (if no, explain in narrative section)

Licensee Notified by Officer: Agents Uhlig & Altuzar

Date: 03-20-15

Time: 5:30pm

Licensee or Agent's Name: Hubbard and Associates Inc.

Home Address: 6901 W. Brown Deer Road, Milwaukee, WI. 53225

Date of Birth:

Home Phone:

Co-Licensee Name:

Home Address:

Class S License Number:

Date of Birth:

Home Phone:

Bartender Name: Karen D. HUBBARD

Home Address: 7234 N. 76th Street

Class D License Number:

Date of Birth: 10-22-59

Home Phone:

Licensed Person / Public Pass. Vehicle, etc.:

Home Address:

Class D License Number:

Date of Birth:

Home Phone:

VIOLATION/INCIDENT – DESCRIBE FACTS AND CIRCUMSTANCES IN NARRATIVE SECTION

Name of Person Cited:

Citation Number:

Violation & Ord. / Statue No.:

Date of Birth:

Court Date:

Name of Person Cited:

Citation Number:

Violation & Ord. / Statue No.:

Date of Birth:

Court Date:

Name of Person Cited:

Citation Number:

Violation & Ord. / Statue No.:

Date of Birth:

Court Date:

Name of Person Cited:

Citation Number:

Violation & Ord. / Statue No.:

Date of Birth:

Court Date:

Name of Person Cited:

Citation Number:

Violation & Ord. / Statue No.:

Date of Birth:

Court Date:

Investigating Officer: P.O. Jim KLUSMANN

District / Bureau: NTF

Date: 06-20-15

LT  SE12

Commanding Officer

06.21.15

Date

DISPOSITION – FOR LICENSING ONLY

Citation No.	Case Number	Disposition	Judge	Date

LICENSE INVESTIGATION UNIT

Received

Referred

By



PA-33E Narrative

This report is written by P.O. Joseph SPINGOLA JR., assigned to District Four, Early Shift.

On Friday, 03-20-15, at approximately 5:30pm, Squad 4281 (P.O. James KLUSMANN and I), along with Squad 4283 (P.O. Richard FREDERICKS and P.O. Matthew RITTNER), were asked to assist the Wisconsin Department of Revenue – Alcohol and Tobacco Enforcement with several establishment/premise checks.

During this time period from 2pm-10pm, numerous establishments were visited, where business documents, alcoholic beverages, and tobacco products were inspected and verified.

Our third visit was at the establishment Brew City Cafe, located at 6901 W. Brown Deer Road, which is subsequently located within the City and County of Milwaukee. During this business contact, we identified the bar tender as Karen D. HUBBARD (b/f, 10-22-59). HUBBARD was fully cooperative with our investigation, providing us full access to the few business records and documents on scene. HUBBARD was then given a verbal warning for some of alcohol in the establishment not covered by legal invoices and obtained through wholesalers. HUBBARD was then given a verbal warning about some of the bottles being combined or refilled with cheaper or lower quality substance. These few bottles were then disposed of in front of agents and officers by HUBBARD. An additional bottle was then disposed of by HUBBARD in front of agents and officers, due to deceased bugs floating inside of liquor. HUBBARD was then given an additional warning that a licensed bar tender must be on scene at all times.



Friday, October 09, 2015



Notice of Public Hearing

HUBBARD, Bryant K, Agent
Brew City Cafe at 6901 W BROWN DEER Rd
Class B Tavern and Public Entertainment License Renewal Applications

Tuesday, October 20, 2015 at 10:45 AM

To whom it may concern:

The above application has been made by the above named applicant(s). This requires approval from the Licenses Committee and the Common Council of the City of Milwaukee. The hearing before the Licenses Committee will take place on 10/20/2015 at 10:45 AM, in Room 301-B, Third Floor, City Hall. If you wish, you may provide testimony at the hearing regarding the request; see below for further information. You are not required to attend the hearing. Once the Licenses Committee makes its recommendation, this recommendation is forwarded to the full Common Council for approval at its next regularly scheduled hearing. Please review the information below and if you have further questions regarding this process, please contact the License Division at (414) 286-2238.

Important details for those wishing to provide information for the Licenses Committee to consider when making its recommendation:

1. The license application is scheduled to be heard at the above time. Due to other hearings running longer than scheduled, you may have to wait some time to provide your testimony.
2. You must appear in person and testify as to matters that you have personally experienced or seen. (You cannot provide testimony for your neighbor, parent or anyone else; this is considered hearsay and cannot be considered by the committee.)
3. No letters or petitions can be accepted by the committee (unless the person who wrote the letter or the persons who signed the petition are present at the committee hearing and willing to testify).
4. Persons opposed to the license application are given the opportunity to testify first; supporters may testify after the opponents have finished.
5. When you are called to testify, you will be sworn in and asked to give your name, and address. (If your first and/or last names are uncommon please spell them.)
6. You may then provide testimony.
 - a. Include only information relating to the above license application.
 - b. Include only information you have personally witnessed or seen.
 - c. Provide concise and relevant information detailing how this business has affected or may affect the peaceful enjoyment of your neighborhood.
 - d. If by the time you have the opportunity to testify, the information you wish to share has already been provided to the committee, you may state that you agree with the previous testimony. Redundant or repetitive testimony will not assist the committee in making its recommendation.
7. After giving your testimony, the members of the Licenses Committee and the licensee may ask questions regarding the testimony you have given or other factors relating to the license application.
8. Business Competition is not a valid basis for denial or non-renewal of a license.
Please Note: If you have submitted an objection to the above application your objection cannot be considered by the committee unless you personally testify at the hearing.

[illegible]

CURRENT RESIDENT 6840 W GRANVILLE CIR 313 MILWAUKEE, WI 53223-2776
CURRENT RESIDENT 6840 W GRANVILLE CIR 314 MILWAUKEE, WI 53223-2776
CURRENT RESIDENT 6840 W GRANVILLE CIR 315 MILWAUKEE, WI 53223-2776
CURRENT RESIDENT 6840 W GRANVILLE CIR 316 MILWAUKEE, WI 53223-2776
CURRENT RESIDENT 6840 W GRANVILLE CIR 317 MILWAUKEE, WI 53223-2776
CURRENT RESIDENT 6840 W GRANVILLE CIR 318 MILWAUKEE, WI 53223-2776
CURRENT RESIDENT 6840 W GRANVILLE CIR 319 MILWAUKEE, WI 53223-2776
CURRENT RESIDENT 6840 W GRANVILLE CIR 320 MILWAUKEE, WI 53223-2776
CURRENT RESIDENT 6840 W GRANVILLE CIR 321 MILWAUKEE, WI 53223-2776

Total Records: 65

Radius: 250.0 feet and Center of Circle: 6901 W Brown Deer RD

2015-2016 Plan of Operation for 6901 W BROWN DEER RD**1. Litter and Noise**How are the grounds kept clean? ☒ Sweep ☐ Pressure Wash ☒ Pick Up Litter ☐ Other: _____How often will grounds be cleaned? ☒ Daily ☐ Weekly ☐ Other: _____Grounds Cleaned By: ☒ Licensee ☒ Building Owner ☒ Employees ☒ Hired Maintenance ☐ Other: _____How are noise issues prevented and/or addressed? ☐ Security ☐ Manager approaches customer(s) ☐ Call Police
☐ Signs Posted ☐ Other: _____**2. Smoking and Sanitation**Are there designated outdoor smoking areas? ☐ No ☒ YesIf yes, describe the area(s) and provide location(s): outside front entrance

Number of Garbage Cans: Inside: _____ Locations: _____

Outside: _____ Locations: _____

Is a Crowd Control Barrier used? ☐ No ☐ Yes If yes, describe: _____Describe sanitation facilities (restrooms): very cleanProvide name of solid waste contractor: Waste Management**3. Security**Are there parking spaces on the premises? ☐ No ☒ Yes If yes, number of spaces: 90 and describe security provisions:Security at front parking lot weekdaysAre there designated loading areas? ☐ No ☐ Yes If yes, describe security provisions: _____Do you have security personnel on the premise? ☐ No ☒ Yes If yes, how many? oneAND What are their responsibilities? check IDs - watch over premiseWhat security equipment do they use? Flash light, cell phone, Note padList their licensing, certification or training credentials: Must have 3 years training & experienceAre there security cameras? ☐ No ☒ Yes If yes, list all locations: Front door & Bar areaAre searches and/or identification checks conducted upon entry? ☐ No ☐ Yes If yes, describe: check IDs & Search**4. Percentage of Sales (must total 100%)**Alcohol 60 % Food Sales 40 % Entertainment 0 % Other 0 %**5. Businesses On The Premise (choose all that apply):**

- | | | | |
|--|--|---|---|
| <input type="checkbox"/> Full Service Restaurant | <input checked="" type="checkbox"/> Cafe/Coffee Shop | <input type="checkbox"/> Deli or Fast Food Rest. | <input type="checkbox"/> Private/Fraternal/Veterans' Club |
| <input type="checkbox"/> Night Club | <input checked="" type="checkbox"/> Tavern | <input checked="" type="checkbox"/> Cocktail Lounge | <input type="checkbox"/> Teen Club |
| <input type="checkbox"/> Bowling Alley | <input type="checkbox"/> Hotel | <input checked="" type="checkbox"/> Banquet Hall | <input type="checkbox"/> Sports Facility |
| <input type="checkbox"/> Liquor Store | <input type="checkbox"/> Corner Store | <input type="checkbox"/> Supermarket | <input type="checkbox"/> Convenience Store |
| <input type="checkbox"/> Gas Station | <input type="checkbox"/> Other _____ | | |

6. Hours of Operation and Age RestrictionAre there any changes to the current hours of operation or age restriction? ☒ No ☐ Yes If yes, describe: _____**Please Note:** If you will be open earlier or later than the hours listed on your current license for even one event or holiday (for example, St. Patrick's Day, Brewers Opening Day, etc.) during the license period, this must be reported and printed on your license.

Your hours of operation and age restriction are listed on your current license.

7. Floor PlanAre there any changes to the current floor plan? ☒ No ☐ Yes If yes, describe: _____

AND submit a new floor plan with this application. Changes in floor plan include changing the location of tables, games, etc. within your current licensed premises. If your changes include adding any additional areas or square footage to your premises, or any renovations to the building will be done, a Permanent Extension of Premises application must be filed.

PUBLIC ENTERTAINMENT PREMISES RENEWAL SUPPLEMENTARY APPLICATION

CCL-PEP3 2/18/15

(1) CURRENT ENTERTAINMENT

The following types of entertainment have been approved for your current Public Entertainment Premises license:

Disc Jockey, Jukebox, Karaoke, 4 Amusement Machines, 1 Pool Table

(2) SELECT ANY TYPES OF ENTERTAINMENT THAT YOU ARE REQUESTING TO ADD *No changes in entertainment shall take place until approved by the Common Council and a new license has been issued and posted on the premises.

<input type="checkbox"/> Instrumental Musicians	<input type="checkbox"/> Bands	<input type="checkbox"/> Battle of the Bands	<input type="checkbox"/> Comedy Acts
<input type="checkbox"/> Disc Jockey	<input type="checkbox"/> Magic Shows	<input type="checkbox"/> Poetry Readings	<input type="checkbox"/> Dancing by Performers
<input type="checkbox"/> Jukebox	<input type="checkbox"/> Wrestling	<input type="checkbox"/> Patron Contests	<input type="checkbox"/> Patrons Dancing
<input type="checkbox"/> Adult Entertainment/ Strippers/Erotic Dance	<input type="checkbox"/> Karaoke	<input type="checkbox"/> Bowling Alley	<input type="checkbox"/> Pool Tables
<input type="checkbox"/> Motion Pictures	<input type="checkbox"/> Amusement Machines –	<input type="checkbox"/> Concerts	<input type="checkbox"/> Theatrical Performances
How many screens? _____	How many? _____	Approx. # per year? _____	Approx. # per year? _____
<input type="checkbox"/> Other: _____			

(3) REMOVE ENTERTAINMENT

If applicable, list any entertainment you wish to remove: _____

(4) WILL PROMOTERS EVER BE USED FOR ANY OF THE ENTERTAINMENT?☐ No ☐ Yes, describe: _____**(5) LEGAL CAPACITY OF PREMISES**

99 (Call the Milwaukee Development Center at 414-286-8211 if you have questions.) Your legal capacity will determine the license fee for your Public Entertainment Premise License. If you would like to request that the license be approved with a lower capacity than that listed above, indicate lower capacity _____. If approved, this lower capacity will print on your license and override the capacity listed on your Occupancy Permit.

(6) IDENTIFY IF SOUND AMPLIFICATION IS USED☒ No ☐ Yes, describe: _____**(7) DECLARATIONS, ACKNOWLEDGEMENTS, & DISCLOSURES****Read And Initial Each Item Confirming Your Understanding:**

- _____ I understand that after the license has been issued, a change to the plan of operation will require a written request to change and approval from the Common Council.
- _____ I agree to inform the City Clerk within 10 days of any substantial changes in the information supplied in this application.
- _____ I understand that I shall not willfully refuse to provide the services offered under this license, or add charges or require deposits not required of the general public because of race, color, sex, religion, national origin or ancestry, age, handicap, lawful source of income, marital status, sexual orientation, gender identity or expression, familial status or the fact that a person is now or has been a member of the military service, whether dressed in uniform or not; and shall not seek such information as a condition of employment, or penalize any employee or discriminate in the selection of personnel for training or promotion on the basis of such information.
- _____ I have knowledge of the City Ordinances currently regulating public entertainment, and understand that the license may be subject to suspension, non-renewal or revocation, if I violate any rule, law or regulation of the city of Milwaukee and State of Wisconsin.

(8) NOTARIZED SIGNATURES OF APPLICANTS**SUBSCRIBED AND SWORN TO BEFORE ME**

This 10th day of September, 2015
Kahlil D. Williams
 (Clerk/Notary Public)
 My Commission Expires October 25, 2015

Kurt H. H. H.
 Agent/Owner/Partner

Additional Owner/Partner

*Notary Seal must be affixed.



**CITY OF MILWAUKEE
OFFICE OF THE CITY CLERK**

Monday, October 12, 2015

COMMITTEE MEETING NOTICE

AD 09

KAUR, Ramandeep, Agent
Harleen Market LLC
7919 N 60th St

Milwaukee, WI 53223

You are requested to attend a hearing which is to be held in Room 301-B, Third Floor, City Hall on:

Tuesday, October 20, 2015 at 10:45 AM

Regarding: Your Class A Malt & Class A Liquor License Application as agent for "Harleen Market LLC" for "Kwik Pantry" at 7919 N 60th St.

There is a possibility that your application may be denied for one or more of the following reasons: The recommendation of the committee regarding the application shall be based on evidence presented at the hearing. Per MCO 85-2.7-4, probative evidence concerning whether or not a new license should be granted may be presented on the following subjects: whether or not the applicant meets the municipal requirements, the appropriateness of the location and premises where the licensed premises is to be located and whether use of the premises for the purposes or activities permitted by the license would tend to facilitate a public or private nuisance or create undesirable neighborhood problems such as disorderly patrons, unreasonably loud noise, litter, and excessive traffic and parking congestion. Probative evidence relating to these matters may be taken from the plan of operation submitted with the license application, if any, but shall not include the content of any music. Evidence regarding the fitness of the location of the premises to be maintained as the principal place of business, including but not limited to whether there is an overconcentration of businesses of the type for which the license is sought; whether the proposal is consistent with any pertinent neighborhood business or development plans, or the location's proximity to areas where children are typically present. The applicant's record in operating similarly licensed premises; and whether or not the applicant has been charged with or convicted of any felony, misdemeanor, municipal offense or other offense, the circumstances of which substantially relate to the activity to be permitted by the license being applied for or any other factor which reasonably relates to the public health, safety or welfare may also be considered. See attached police report or correspondence.

**Notice for applicants with
warrants or unpaid fines:**

Proof of warrant satisfaction or payment of fines must be submitted at the hearing on the above date and time. Failure to comply with this requirement may result in a delay of the granting/denial of your application.

Failure to appear at this meeting may result in the denial of your license. Individual applicants must appear only in person or by an attorney. Corporate or Limited Liability applicants must appear only by the agent designated on the application or by an attorney. Partnership applicants must appear by a partner listed on the application or by an attorney. If you wish to do so and at your own expense, you may be accompanied by an attorney of your choosing to represent you at this hearing.

You will be given an opportunity to speak on behalf of the application and to respond and challenge any charges or reasons given for the denial. No petitions can be accepted by the committee, unless the people who signed the petition are present at the committee hearing and willing to testify. You may present witnesses under oath and you may also confront and cross-examine opposing witnesses under oath. If you have difficulty with the English language, you should bring an interpreter with you, at your expense, so that you can answer questions and participate in your hearing.

You may examine the application file at this office during regular business hours prior to the hearing date. Inquiries regarding this matter may be directed to the person whose signature appears below.

Limited parking for persons attending meetings in City Hall is available at reduced rates (5 hour limit) at the Milwaukee Center on the southwest corner of East Kilbourn and North Water Street. Parking tickets must be validated in the first floor information booth in City Hall.

PLEASE NOTE: Upon reasonable notice, efforts will be made to accommodate the needs of disabled individuals through sign language interpreters or other auxiliary aids. For additional information or to request this service, contact the Council Services Division ADA Coordinator at (414) 286-2998, Fax - (414) 286-3456, TDD - (414) 286-2025.

JIM OWCZARSKI, CITY CLERK

BY:

Jason Schunk
License Division Manager

If you have questions regarding this notice, please contact the License Division at (414) 286-2238.

200 E. Wells Street, Room 105, City Hall, Milwaukee, WI 53202. www.milwaukee.gov/license
Phone: (414) 286-2238 Fax: (414) 286-3057 Email Address: License@milwaukee.gov



**CITY OF MILWAUKEE
OFFICE OF THE CITY CLERK**

Monday, October 12, 2015

COMMITTEE MEETING NOTICE

AD 09

KAUR, Ramandeep, Agent
Harleen Market LLC
8052 N 65th ST

Milwaukee, WI 53223

You are requested to attend a hearing which is to be held in Room 301-B, Third Floor, City Hall on:

Tuesday, October 20, 2015 at 10:45 AM

Regarding: Your Class A Malt & Class A Liquor License Application as agent for "Harleen Market LLC" for "Kwik Pantry" at 7919 N 60th St.

There is a possibility that your application may be denied for one or more of the following reasons: The recommendation of the committee regarding the application shall be based on evidence presented at the hearing. Per MCO 85-2.7-4, probative evidence concerning whether or not a new license should be granted may be presented on the following subjects: whether or not the applicant meets the municipal requirements, the appropriateness of the location and premises where the licensed premises is to be located and whether use of the premises for the purposes or activities permitted by the license would tend to facilitate a public or private nuisance or create undesirable neighborhood problems such as disorderly patrons, unreasonably loud noise, litter, and excessive traffic and parking congestion. Probative evidence relating to these matters may be taken from the plan of operation submitted with the license application, if any, but shall not include the content of any music. Evidence regarding the fitness of the location of the premises to be maintained as the principal place of business, including but not limited to whether there is an overconcentration of businesses of the type for which the license is sought; whether the proposal is consistent with any pertinent neighborhood business or development plans, or the location's proximity to areas where children are typically present. The applicant's record in operating similarly licensed premises; and whether or not the applicant has been charged with or convicted of any felony, misdemeanor, municipal offense or other offense, the circumstances of which substantially relate to the activity to be permitted by the license being applied for or any other factor which reasonably relates to the public health, safety or welfare may also be considered. See attached police report or correspondence.

**Notice for applicants with
warrants or unpaid fines:**

Proof of warrant satisfaction or payment of fines must be submitted at the hearing on the above date and time. Failure to comply with this requirement may result in a delay of the granting/denial of your application.

Failure to appear at this meeting may result in the denial of your license. Individual applicants must appear only in person or by an attorney. Corporate or Limited Liability applicants must appear only by the agent designated on the application or by an attorney. Partnership applicants must appear by a partner listed on the application or by an attorney. If you wish to do so and at your own expense, you may be accompanied by an attorney of your choosing to represent you at this hearing.

You will be given an opportunity to speak on behalf of the application and to respond and challenge any charges or reasons given for the denial. No petitions can be accepted by the committee, unless the people who signed the petition are present at the committee hearing and willing to testify. You may present witnesses under oath and you may also confront and cross-examine opposing witnesses under oath. If you have difficulty with the English language, you should bring an interpreter with you, at your expense, so that you can answer questions and participate in your hearing.

You may examine the application file at this office during regular business hours prior to the hearing date. Inquiries regarding this matter may be directed to the person whose signature appears below.

Limited parking for persons attending meetings in City Hall is available at reduced rates (5 hour limit) at the Milwaukee Center on the southwest corner of East Kilbourn and North Water Street. Parking tickets must be validated in the first floor information booth in City Hall.

PLEASE NOTE: Upon reasonable notice, efforts will be made to accommodate the needs of disabled individuals through sign language interpreters or other auxiliary aids. For additional information or to request this service, contact the Council Services Division ADA Coordinator at (414) 286-2998, Fax - (414) 286-3456, TDD - (414) 286-2025.

JIM OWCZARSKI, CITY CLERK

BY: _____

**Jason Schunk
License Division Manager**

If you have questions regarding this notice, please contact the License Division at (414) 286-2238.

200 E. Wells Street, Room 105, City Hall, Milwaukee, WI 53202. www.milwaukee.gov/license
Phone: (414) 286-2238 Fax: (414) 286-3057 Email Address: License@milwaukee.gov

Date:10/10/15
Officer: PO Tracey Geniesse

City of Milwaukee Police Department
90-5-1.5 Crime Prevention Survey
Convenience Store/Liquor Store Inspection

Name of Premise: Harleen Market
Address: 7919 N 60th St
Phone: 414-357-8475

Owner: Ramandeep Kaur
Owner address: 8052 N 65th St
City State Zip: Milwaukee, WI. 53223
Owner Phone: 414-702-4737
Owner email: kaur.ramandeep81@yahoo.com

Manager: Ramandeep Kaur
Home Address: 8052 N 65th St
City State Zip: Milwaukee, WI. 53223
Phone: 414-702-4737
Email: kaur.ramandeep81@yahoo.com

Preferred contact: Ramandeep Kaur

Location currently open: ☒ YES ☐ NO

Projected open date:

Day's open: ☐S ☐M ☐T ☐W ☐Th ☐F ☐SA ☒ALL

Hours of Operation: Sun: 9a-9p 24 hours ☐Y ☒N
Mon: 9a-9p
Tue: 9a-9p
Wed: 9a-9p
Thu: 9a-9p
Fri: 9a-9p
Sat: 9a-9p

Premise Type: ☐Liquor Store
☒Convenience Store
☐Other:

Licenses currently held:

Alcohol: ☒ Yes ☐ No Class: amalt #: 0198499
Tobacco: ☒ Yes ☐ No #: cig-1024337
Food: ☐ Yes ☐ No #: food-0005573
Extended Hours: ☐ Yes ☒ No #:
Secondhand Dealer: ☐ Yes ☒ No Type: #:
Other: ☒ Yes ☐ No Type: bart #: 0209662
Other: ☐ Yes ☐ No Type: #:

Exterior Survey:

1. Is the area around the location clean? ☒ Yes ☐ No
2. What surrounds the location? (Check all the apply)
 - a. ☐ Park
 - b. ☒ School
 - c. ☐ Youth Center
 - d. ☐ Church
 - e. ☐ Tavern(s) If so, how many
 - f. ☒ Residential
 - g. ☒ Other businesses
 - h. ☐ Other:
3. Can you see from the outside of the location into the interior ☒ Yes ☐ No
4. Can you see the employees inside of the location from the outside ☒ Yes ☐ No
5. Are exterior windows free of signage ☐ Yes ☒ No
6. Is there a parking lot ☒ Yes ☐ No
7. Is the parking lot clean? ☒ Yes ☐ No
8. Is the parking lot well lit? ☒ Yes ☐ No
9. Are there areas where a person could conceal themselves ☐ Yes ☒ No
10. Is there exterior lighting? ☒ Yes ☐ No. Does it appears to be adequate ☒ Yes ☐ No
11. Exterior Payphone? ☐ Yes ☒ No
12. Are there No Loitering Signs posted? ☐ Yes ☒ No
13. Are there exterior security cameras ☐ Yes ☒ No How Many: 0
14. Are the address numbers prominently displayed and easy to see ☒ Yes ☐ No

Camera Survey:

15. Does this location have security cameras? ☒ Yes ☐ No
16. Are they in working order? ☒ Yes ☐ No
17. What format are the cameras?
 - a. Color ☐ Yes ☐ No
 - b. Digital ☒ Yes ☐ No
 - c. VCR ☐ Yes ☐ No
 - d. Recorded ☐ Yes ☐ No
18. How long is footage stored for later viewing: 30 days
19. Are there exterior cameras ☐ Yes ☒ No How many:
20. Are there interior cameras ☒ Yes ☐ No How many: 10
21. Do all employees know how to retrieve recorded digital images/footage? ☒ Yes ☐ No

Interior Survey:

22. Is the storeowner willing to be a standing complainant regarding loitering? ☒ Yes ☐ No
a. If yes have them fill out the standing complaint form and give them two of the commercial signs ☐ Yes ☐ No
23. Is the interior of the location neat and clean? ☒ Yes ☐ No
24. Does an interior camera face the entrance/exit? ☒ Yes ☐ No
25. Is there a lockable area that separates employees from customers? ☒ Yes ☐ No
26. Does the store sell single chore boy? ☒ Yes ☐ No
27. Does the store sell blunt wraps? ☒ Yes ☐ No
28. Does the store sell scales? ☒ Yes ☐ No
29. Does the store sell items that may be used as crack pipes? ☒ Yes ☐ No
a. Describe item glass tire guages
30. Does the store have an over abundance of sandwich baggies: ☐ Yes ☒ No
31. Does the owner understand that these items are often used for drug use? ☒ Yes ☐ No
32. Do the products in the store appear to be new and rotated often? ☒ Yes ☐ No
33. Are emergency and non-emergency numbers posted near the phone? ☒ Yes ☐ No
34. Does the owner know how to contact their police district directly? ☒ Yes ☐ No
a. Did you provide a district contact guide to the owner? ☒ Yes ☐ No

Complete this section if alcohol establishment is a convenience store:

(** Read full ordinance for all details "68-4.3 Convenience Food Stores")

All convenience food stores not exempted under sub. 3 shall:

1. Is the cash register located in a manner so that at the time of a sales transaction, the employee and customer are both visible from the sidewalk? ☐ Yes ☒ No **
2. Are the glass entrance and exit doors clear of any signs or advertisements with the exception of a sign which states that the cash register contains \$50 or less and that the safe is no accessible to employees? ☐ Yes ☒ No
3. Does the store maintain one of the following on the licensed premise:
 - a. A safe that was in use at the convenience food store on August 17, 1994? ☒ Yes ☐ No
 - b. A drop-safe or time release safe that weighs at least 500 pounds or which is attached to or set into the floor in a manner approved by the police department? ☒ Yes ☐ No
4. Is lighting provided for the store's parking area during all hours of darkness when employees or customers are on the premises at a minimum average of 2-foot candles per square foot, unless the store is not open for business after sunset and before sunrise? ☒ Yes ☐ No ☐ N/A
5. Are at least two high-resolution surveillance security cameras installed? ☒ Yes ☐ No
6. Are the security cameras in working order? ☒ Yes ☐ No
7. Does one camera show an overall view of the counter and register area? ☒ Yes ☐ No
8. Does one camera show a clear, identifiable, full frame image of the face of each person entering and leaving the store? ☒ Yes ☐ No
9. Are the camera views obstructed by fixtures or displays? ☐ Yes ☒ No
10. Is the recorded footage stored for at least 30 days? ☒ Yes ☐ No
11. Do all store employees know how to record footage from the camera system to media capable of being transferred to police custody? ☒ Yes ☐ No

12. Are customer entrances/exits made of glass or other transparent material? ☒ Yes ☐ No
a. Exception: A store that does not have such doors on August 17, 1994 shall not be required to install such doors until the holder of the store's food dealer license changes.
13. Has the owner and their employees attended the Robbery Prevention Training within 120 days of ownership or employment? ☒ Yes ☐ No
a. Contact Community Outreach and Education at 935-7836 for schedule.

Sub 3. Exemptions. The requirements of this section do not apply to a convenience food store that conforms to either of the following descriptions:

- a-1. The store is located in an enclosed shopping structure, enclosed commercial building or hospital. A convenience food store is not in an enclosed structure or building if a customer can enter it directly from the outside.
Does store conform to a-1 ☐ Yes ☐ No
- a-2 The store physically separates employees from customers with a solid partition that bars a person from entering the employee area from the customer area, has a secure lock on the employee side of any door between the employee area and the customer, and conducts all transaction through a service window or similar arrangement.
Does store conform to a-2 ☐ Yes ☐ No
- a. At the commissioner's discretion, a convenience store may be exempted from any or all of the regulations specified in sub 2.
Does this location hold an exemption from the commissioner regarding any of the requirements of Sub 2? ☐ Yes ☐ No

ADDITIONAL COMMENTS/RECOMMENDATIONS:

I made the following recommendations: Post "No Loitering Signs"

Alcohol Concentration for 7919 N. 60th Street

City of Milwaukee, Wisconsin

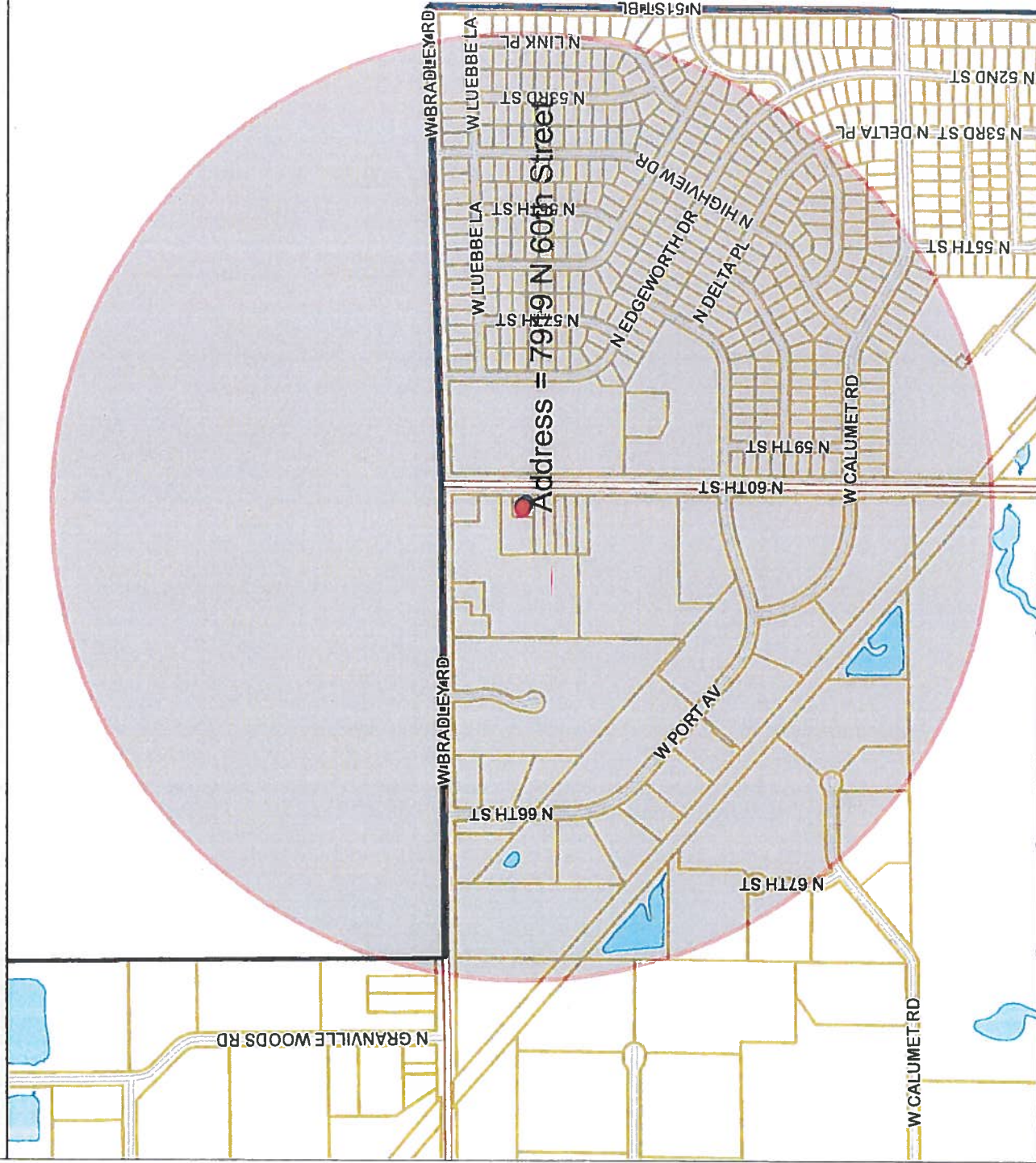

- Legend -

City limits

Parcels

Freeways

Exit ramps

Entry ramps

Ramps

Major streets

Streets

Waterways

Alcohol licenses

Class A intoxicating liquor

Class A fermented malt beverage

Class A liquor and malt

Class B fermented malt beverage

Class B tavern

Class C wine retailer

- Notes -

Alcohol establishments within a .5 mile radius centered on 7919 N. 60th Street on 9/22/15



Department of Administration - ITMD

833.3 0 416.67 833.3 Feet

Map Scale: 1: 10,000

[illegible]



Monday, October 12, 2015



Notice of Public Hearing

KAUR, Ramandeep, Agent
Kwik Pantry at 7919 N 60th St
Class A Malt & Class A Liquor License Application

Tuesday, October 20, 2015 at 10:45 AM

To whom it may concern:

The above application has been made by the above named applicant(s). This requires approval from the Licenses Committee and the Common Council of the City of Milwaukee. The hearing before the Licenses Committee will take place on 10/20/2015 at 10:45 AM, in Room 301-B, Third Floor, City Hall. If you wish, you may provide testimony at the hearing regarding the request; see below for further information. You are not required to attend the hearing. Once the Licenses Committee makes its recommendation, this recommendation is forwarded to the full Common Council for approval at its next regularly scheduled hearing. Please review the information below and if you have further questions regarding this process, please contact the License Division at (414) 286-2238.

Important details for those wishing to provide information for the Licenses Committee to consider when making its recommendation:

1. The license application is scheduled to be heard at the above time. Due to other hearings running longer than scheduled, you may have to wait some time to provide your testimony.
2. You must appear in person and testify as to matters that you have personally experienced or seen. (You cannot provide testimony for your neighbor, parent or anyone else; this is considered hearsay and cannot be considered by the committee.)
3. No letters or petitions can be accepted by the committee (unless the person who wrote the letter or the persons who signed the petition are present at the committee hearing and willing to testify).
4. Persons opposed to the license application are given the opportunity to testify first; supporters may testify after the opponents have finished.
5. When you are called to testify, you will be sworn in and asked to give your name, and address. (If your first and/or last names are uncommon please spell them.)
6. You may then provide testimony.
 - a. Include only information relating to the above license application.
 - b. Include only information you have personally witnessed or seen.
 - c. Provide concise and relevant information detailing how this business has affected or may affect the peaceful enjoyment of your neighborhood.
 - d. If by the time you have the opportunity to testify, the information you wish to share has already been provided to the committee, you may state that you agree with the previous testimony. Redundant or repetitive testimony will not assist the committee in making its recommendation.
7. After giving your testimony, the members of the Licenses Committee and the licensee may ask questions regarding the testimony you have given or other factors relating to the license application.
8. Business Competition is not a valid basis for denial or non-renewal of a license.
Please Note: If you have submitted an objection to the above application your objection cannot be considered by the committee unless you personally testify at the hearing.

[illegible]

[illegible]

[illegible]

CURRENT RESIDENT	7929 N 60TH ST 4	MILWAUKEE, WI 53223-4141
CURRENT RESIDENT	7931 N 60TH ST 1	MILWAUKEE, WI 53223-4140
CURRENT RESIDENT	7931 N 60TH ST 2	MILWAUKEE, WI 53223-4140
CURRENT RESIDENT	7931 N 60TH ST 3	MILWAUKEE, WI 53223-4140
CURRENT RESIDENT	7931 N 60TH ST 4	MILWAUKEE, WI 53223-4140
CURRENT RESIDENT	7933 N 60TH ST 1	MILWAUKEE, WI 53223-4139
CURRENT RESIDENT	7933 N 60TH ST 2	MILWAUKEE, WI 53223-4139
CURRENT RESIDENT	7933 N 60TH ST 3	MILWAUKEE, WI 53223-4139
CURRENT RESIDENT	7933 N 60TH ST 4	MILWAUKEE, WI 53223-4139
CURRENT RESIDENT	7935 N 60TH ST 1	MILWAUKEE, WI 53223-4138
CURRENT RESIDENT	7935 N 60TH ST 2	MILWAUKEE, WI 53223-4138
CURRENT RESIDENT	7935 N 60TH ST 3	MILWAUKEE, WI 53223-4138
CURRENT RESIDENT	7935 N 60TH ST 4	MILWAUKEE, WI 53223-4138

Total Records: 181

Radius: 250.0 feet and Center of Circle: 7919 N 60th ST



Monday, October 12, 2015

Licenses Committee Notice of Hearing

RAMANDEEP KAUR
6011 W Bradley Rd

Milwaukee, WI 53223

Date: 10/20/2015
Time: 10:45 AM
Location: Room 301-B, Third Floor, City Hall

The Licenses Committee will consider the following license application:

Class A Malt & Class A Liquor License Application
KAUR, Ramandeep, Agent
Kwik Pantry at 7919 N 60th St

Please note this application may be recommended for denial based on fitness of the location due to concentration of alcohol beverage outlets in the area. If the application is denied for this reason, no other application for an alcohol beverage license for this location shall be recommended for approval by the Licenses Committee within three years of the date of denial unless the applicant has demonstrated a change of circumstances since the prior denial.

If you have any questions, please call (414) 286-2238.





BUSINESS LICENSE PLAN OF OPERATION

ccl-busplan 7/24/15

Office of the City Clerk License Division

200 E. Wells St. Room 105, Milwaukee, WI 53202

(414) 286-2238 www.milwaukee.gov/license e-mail address: license@milwaukee.gov

1. Type of Business

Applying for: ☐ Extended Hours Establishment ☐ Filling Station ☐ Waste Tire Transporter ☐ Massage Establishment
☐ Self Service Laundry ☐ Rooming House: Number of Units: _____ ☐ Hotel/Motel: Number of Units: _____
☒ Other (supplemental application for specific license also required)

Provide a detailed description of the type of business you plan on operating:

Grocery Store: selling beer, liquor, lottery & Grocery and Household

Do you have any experience operating this type of business? ☐ No ☒ Yes If yes, explain: I am managing Gas Station & State & Grocery Store

2. Business Operations

- a. Proposed Opening Date: 12/04/2015
- b. Is this premise under construction? ☒ No ☐ Yes If yes, list estimated completion date: _____
- c. Is this a franchise? ☒ No ☐ Yes
- d. Is this premises currently licensed? ☐ No ☒ Yes If yes, list type of license: Food, malt class A beer, Cig. Lic.
- e. Is the current licensee operating? ☐ No ☒ Yes If no, list date closed: _____
- f. Do you have future plans for other businesses, licenses or permits at this location? ☒ No ☐ Yes
If yes, explain: _____
- g. Have you previously held an Extended Hours License in Milwaukee? ☐ No ☒ Yes
If yes, list address(es): 6011 W. Bradley Rd. Milwaukee WI 53223
- h. Are other businesses operating in the same building? ☒ No ☐ Yes If yes, describe: _____

3. Litter & Noise Control

- a. How are grounds kept clean? ☒ Sweep ☒ Pressure Wash ☒ Pick Up Litter ☐ Hired Maintenance
☒ Building Owner Responsibility ☒ Garbage Cans Outside ☐ Other: As Needed
- b. How often will grounds be cleaned? ☒ Daily ☐ Weekly ☐ As Needed ☐ Monthly ☒ Other: As Needed
- c. Grounds cleaned by: ☒ Licensee ☒ Building Owner ☒ Employees ☐ Hired Maintenance ☐ Other: _____
- d. How are noise issues prevented and/or addressed? ☐ Security ☒ Manager approaches customer(s) ☒ Call Police
☒ Signs Posted ☐ Other: _____
- Will a sound amplification system be used? ☒ No ☐ Yes If yes, describe: _____
- e. Are there designated outdoor smoking areas? ☒ No ☐ Yes If yes, describe: _____
- f. Number of Garbage Cans: Inside: 2 Locations: Restroom, Near Lottery
Outside: 2 Locations: Curb Side
- g. Is a crowd control barrier used? ☒ No ☐ Yes If yes, describe: _____
- h. Describe sanitation facilities (restrooms): 1 Restroom
- i. Name of solid waste contractor: ☒ Advanced Disposal ☐ Waste Management ☐ Other: _____

4. Parking & Security

- a. Are there off-street parking places? ☐ No ☒ Yes If yes, how many? 10

Describe security plan for parking lot: Cameras Installed

- b. Is there a loading zone? ☒ No ☐ Yes If yes, describe security for loading zone: _____

- c. Will you have security personnel on premise? ☒ No ☐ Yes If yes, how many? _____

What are their responsibilities? _____

Is security equipment used? ☐ No ☒ Yes If yes, describe Camera

List their licensing, certification, or training credentials _____

Will there be security cameras? ☐ No ☒ Yes If yes, where? Inside building

Will searches or identification checks be conducted upon entry? ☒ No ☐ Yes If yes, describe _____

5. Percentage of Sales (must total 100%)

Alcohol <u>20</u> %	Food <u>50</u> %	Secondhand Merchandise	Precious Metals & Gems
Entertainment <u>0</u> %	Cigarettes <u>20</u> %	<u>0</u> %	<u>0</u> %
Pawnbroker Activity <u>0</u> %	Salvaged Materials <u>0</u> % (such as scrap metal)	Personal Services (such as tattoo, body piercing, salon, tailor, tanning, etc.) <u>0</u> %	Other <u>10</u> % Describe: <u>Lottery</u>

6. Businesses/Licenses on the Premises (check all that apply):

Type 1

- | | | | |
|---|---|---|--|
| <input type="checkbox"/> Full Service Restaurant | <input type="checkbox"/> Cafe/Coffee Shop | <input type="checkbox"/> Deli or Fast Food Restaurant | <input type="checkbox"/> Private/Fraternal/Veterans Club |
| <input type="checkbox"/> Night Club | <input type="checkbox"/> Tavern | <input type="checkbox"/> Cocktail Lounge | <input type="checkbox"/> Teen Club |
| <input type="checkbox"/> Banquet Hall | <input type="checkbox"/> Sports Facility | | |
| <input type="checkbox"/> Hotel/Motel – Number of Rooms: _____ | | <input type="checkbox"/> Rooming House – Number of Rooms: _____ | |

Type 2

- | | | | |
|--|---|---|---|
| <input checked="" type="checkbox"/> Liquor Store | <input checked="" type="checkbox"/> Corner Store | <input type="checkbox"/> Supermarket | <input checked="" type="checkbox"/> Convenience Store |
| <input type="checkbox"/> Gas Station | <input type="checkbox"/> Amusement/Phonograph Distributor | | <input type="checkbox"/> Auto Wrecker |
| <input type="checkbox"/> Used Car Dealer | <input type="checkbox"/> Used Auto Parts | <input type="checkbox"/> Personal Service Establishment
(such as tattoo business, hair
salon, tailor, etc.) | <input type="checkbox"/> Recording Studio |

What other types of licenses/permits will you hold at this location? (check all that apply)

- ☒ Occupancy Permit ☒ Cigarette & Tobacco ☐ Gas Station ☐ Extended Hours ☐ Class "B" Tavern ☐ Weights & Measures
☐ Secondhand Dealer ☐ Precious Metal & Gem ☐ Other: _____

7. Legal Capacity (only if a Type 1 premises in #6 above)

Capacity 100 (Call the Milwaukee Development Center at 414-286-8211 if you have questions.)

8. Premises Description

d. Identify all area(s) of the premises that will be used in operating this business (include areas used only for storage):

☒ 1st Floor ☐ 2nd Floor ☐ Basement Storage ☐ Patio ☐ Beer Garden ☐ Sidewalk Café ☐ Deck ☐ Rooftop

☐ Other: Describe: _____

e. Describe Location: ☒ Major Thoroughfare ☐ Secondary Street ☐ Other: _____

f. Nearest Major Cross Street: W. Bradley Rd.

g. Describe Building: ☐ Free Standing Building ☒ Strip Mall ☐ Other: _____

h. Describe Premises Structure: ☒ Single Story ☐ Multi-Story - # of Stories _____ ☐ Other: _____

i. Describe Surrounding Area: ☐ Commercial ☒ Residential ☐ Industrial ☐ Other: _____

j. Property Owner's Name: Ramandeep Kaur Phone Number: 414-702-4737

Address: 8052 N. 65th St. Milwaukee WI 53223

9. Hours of Operation & Customers

Will customers be entering the premises? ☐ No ☒ Yes

Day of the Week	Proposed Hours of Operation:		Number of Customers expected each day	Potential Age Range of Customers	Class B Applicants: Age Restriction (If none, write 'None')
	Open (include a.m. or p.m.)	Close (include a.m. or p.m.)			
Sunday	8 am	9 pm	500	6-100	
Monday					
Tuesday					
Wednesday					
Thursday					
Friday					
Saturday	8 am	9 pm			

Extended Hours Establishment License is required for any convenience store, filling station, personal service establishment (such as tattoo, body piercing, salon, tailor, tanning, etc.), recording studio or restaurant which is open between the hours of 12 a.m. and 5 a.m.

Entertainment Indoor Closing Hours - If alcohol beverage establishment, same as alcohol license hours.
If non-alcohol establishment 1:00 am Sunday to Thursday; 1:30 am Friday and Saturday.

Entertainment Outdoor Closing Hours - 10:00 pm Sunday - Thursday; 12:00 am Friday and Saturday,
unless otherwise approved by Common Council in licensee's plan of operation.

10. Signature(s)

Ramandeep Kaur
Sole Proprietor, Partner, Agent, or 20% or more Shareholder

Ramandeep Kaur
Signature of additional partner or 20% or more Shareholder

See Application Information for a list of all required application forms.

2500

7919 N. 60th Street

Cajun

EXIT

Bathroom

Walk-in Beer Cooler

Door

Door

Soda Cooler

Storage

Alcohol Storage

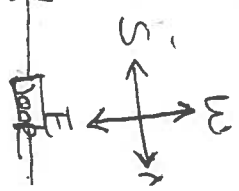

Trash

11' x 6'

ENTRY Door

Aisle 1
Aisle 2
Aisle 3
Aisle 4
Frozen Food Cooler
Trash

Liquor Shelves
Cashier Counter

10' x 18'

Window 35'

711 Cajon

50'

30'

Parking lot

40'

50'

3'

9/22/15

Parmapack Farm Market
Green LLC

60th Street

100'±



ALCOHOL BEVERAGE & PUBLIC ENTERTAINMENT PREMISES SUPPLEMENTAL PLAN OF OPERATION

Office of the City Clerk License Division

200 E. Wells St. Room 105, Milwaukee, WI 53202

(414) 286-2238 e-mail address: license@milwaukee.gov www.milwaukee.gov/licenseLegal Entity Name: Harleen Market LLCPremise Address: 7919 N. 60th street, Milwaukee WI 53223**Proximity of Premises to Church, School, Daycare Center or Hospital**Is there at least 300 feet between the building and any church, school, daycare center or hospital? ☐ Yes ☒ No**"Service Bar Only" Designation**If applying for Class B or C license, are you applying for "Service Bar Only"? ☐ No ☐ Yes

Service Bar Only means customers cannot sit at the bar. Alcohol is served to patrons seated at tables. No stools, chairs or other articles of furniture shall be placed at the service bar for patrons to sit upon.

Business Informationa) Are you taking out this application for anyone that may not be eligible for a license? ☒ No ☐ Yes

If yes, list name and address: _____

b) Will the agent, a partner or the individual licensee be conducting the day-to-day operations of the business? ☐ No ☒ Yes

If no, list the name and address of the person(s) who will: _____

Class B Applicants: If the agent, a partner or the individual licensee will not be conducting the day-to-day operations of the business, the person(s) listed above must obtain a Class B Managers license.

c) Does anyone else have money invested or any other interest in this business? ☒ No ☐ Yes

If yes, explain: _____

d) Have you made an agreement with anyone to repay any loan or any other payments based upon income from the business?

☒ No ☐ Yes If yes, list name and address: _____**Proof of Ownership, Lease, or Offer to Purchase (new & transfer applicants only)**

Submit proof of ownership, lease, or offer to purchase the building with this application.

A lease or offer to purchase must:

- a) Be in the same legal entity name as that apply for the license
- b) Reflect the same address as the premises address on this application
- c) Reflect current dates and
- d) Be signed by the lessor/seller and lessee/buyer

Property Information (new & transfer applicants only)a) Do you own or lease the building? ☒ Own ☐ Leaseb) Who owns the fixtures (for example, coolers, etc.)? Ownerc) Are you purchasing the stock and/or fixtures? ☐ No ☒ Yes If yes, amount paid \$ 1200.00d) Total amount paid for business \$ 10,000e) Total amount paid for goodwill of the business \$ 0

Goodwill comprises the reputation and customer relationships of an existing business. If the price you pay for the business exceeds the fair market value of all of the rest of the assets of the business, the excess may be considered goodwill.

f) Have you made arrangements with the seller for payment of personal property taxes? ☒ No ☐ Yes**See Application Information for a list of all required application forms.**

Lease Information (new & transfer applicants who are leasing the premises only)

- a) Date lease begins 1-1-17 Ends 12-31-17
- b) Monthly rental \$ 1000
- c) Do you have an option to renew the lease? ☐ No ☐ Yes
- d) Does your lease allow for assignment to another party without the consent of the owner? ☐ No ☒ Yes
- e) For what length of time have you been guaranteed occupancy (number of years)? 1
- f) In addition to paying the monthly rental, will you have to pay anything additional to the owner of the building to guarantee performance of the lease? ☐ No ☐ Yes If yes, explain _____
- g) Does the present owner or occupancy object to the granting of your license? ☒ No ☐ Yes
If yes, explain _____

Change of Agent Applicants Only

Have there been any changes to the floor plan since the last application was submitted? ☒ No ☐ Yes

If no, a new floor plan is not required. If yes, submit a new floor plan and explain the change(s): _____

Notarized Signatures of Applicants

SUBSCRIBED AND SWORN TO BEFORE ME

This 22nd day of September, 20 15

David Harris

(Clerk/Notary Public)

My Commission Expires 2/19/17

*Notary Seal must be affixed.

Ramandeep Kaur

Sole Proprietor, Partner, 20% or more Shareholder, or
Agent – only if there are no 20% or more shareholders

Additional partner or 20% or more shareholder

Note: All information contained in this application is subject to approval by the Common Council.
Deviating from approved plan of operation will subject licensee to citations, and/or suspension or non-renewal of the license.
Contact the License Division for information on how to request changes.

New and transfer of premise applicants must submit the following:

- ☐ Proof of ownership, lease or offer to purchase the building ☐ Detailed floor plan ☐ If a restaurant, copy of the menu



CITY OF MILWAUKEE
OFFICE OF THE CITY CLERK

Wednesday, October 07, 2015

COMMITTEE MEETING NOTICE

AD 15

CURRY, De Juan E, Agent
Supreme 1 Auto LLC
3846 W Wisconsin Av #112

Milwaukee, WI 53208

You are requested to attend a hearing which is to be held in Room 301-B, Third Floor, City Hall on:

Tuesday, October 20, 2015 at 10:45 AM

Regarding: Your Secondhand Motor Vehicle Dealer's Wholesale Only License Application as agent for "Supreme 1 Auto LLC" for "Supreme 1 Auto" at 3846 W Wisconsin Av #112.

There is a possibility that your application may be denied for one or more of the following reasons: Neighborhood Objections to the granting of such a license due to the creation of undesirable neighborhood problems, such as: parking and traffic problems which cause the normal flow of traffic on roadways and alleys to be impeded, loitering, littering, noise, loud music, and conduct which will have an adverse impact on the public health, safety and welfare of the community. Additionally, the over concentration of secondhand motor vehicle dealers in the neighborhood such that the concentration will have an adverse impact on the public health, safety and welfare of the neighborhood. you do not meet the statutory and municipal requirements; the appropriateness of the location to be licensed and whether the location will create undesirable neighborhood problems, whether or not you have been charged with or convicted of any felony, misdemeanor, municipal offense or other offense, the circumstances of which substantially relate to the licensed activity; and any other factors which reasonably relate to the public health, safety and welfare. See attached police report and/or written correspondence regarding this application. Please be advised the public will be able to provide information to the committee in person or in writing. The committee will receive and consider evidence regarding the above mentioned criteria.

Notice for applicants with warrants or unpaid fines:

Proof of warrant satisfaction or payment of fines must be submitted at the hearing on the above date and time. Failure to comply with this requirement may result in a delay of the granting/denial of your application.

Failure to appear at this meeting may result in the denial of your license. Individual applicants must appear only in person or by an attorney. Corporate or Limited Liability applicants must appear only by the agent designated on the application or by an attorney. Partnership applicants must appear by a partner listed on the application or by an attorney. If you wish to do so and at your own expense, you may be accompanied by an attorney of your choosing to represent you at this hearing.

You will be given an opportunity to speak on behalf of the application and to respond and challenge any charges or reasons given for the denial. No petitions can be accepted by the committee, unless the people who signed the petition are present at the committee hearing and willing to testify. You may present witnesses under oath and you may also confront and cross-examine opposing witnesses under oath. If you have difficulty with the English language, you should bring an interpreter with you, at your expense, so that you can answer questions and participate in your hearing.

You may examine the application file at this office during regular business hours prior to the hearing date. Inquiries regarding this matter may be directed to the person whose signature appears below.

Limited parking for persons attending meetings in City Hall is available at reduced rates (5 hour limit) at the Milwaukee Center on the southwest corner of East Kilbourn and North Water Street. Parking tickets must be validated in the first floor information booth in City Hall.

PLEASE NOTE: Upon reasonable notice, efforts will be made to accommodate the needs of disabled individuals through sign language interpreters or other auxiliary aids. For additional information or to request this service, contact the Council Services Division ADA Coordinator at (414) 286-2998, Fax - (414) 286-3456, TDD - (414) 286-2025.

JIM OWCZARSKI, CITY CLERK

BY:

Jason Schunk
License Division Manager

If you have questions regarding this notice, please contact the License Division at (414) 286-2238.

200 E. Wells Street, Room 105, City Hall, Milwaukee, WI 53202. www.milwaukee.gov/license
Phone: (414) 286-2238 Fax: (414) 286-3057 Email Address: License@milwaukee.gov



**CITY OF MILWAUKEE
OFFICE OF THE CITY CLERK**

Wednesday, October 07, 2015

COMMITTEE MEETING NOTICE

AD 15

CURRY, De Juan E, Agent
Supreme 1 Auto LLC
928 S 77th St

Milwaukee, WI 53214

You are requested to attend a hearing which is to be held in Room 301-B, Third Floor, City Hall on:

Tuesday, October 20, 2015 at 10:45 AM

Regarding: Your Secondhand Motor Vehicle Dealer's Wholesale Only License Application as agent for "Supreme 1 Auto LLC" for "Supreme 1 Auto" at 3846 W Wisconsin Av #112.

There is a possibility that your application may be denied for one or more of the following reasons: Neighborhood Objections to the granting of such a license due to the creation of undesirable neighborhood problems, such as: parking and traffic problems which cause the normal flow of traffic on roadways and alleys to be impeded, loitering, littering, noise, loud music, and conduct which will have an adverse impact on the public health, safety and welfare of the community. Additionally, the over concentration of secondhand motor vehicle dealers in the neighborhood such that the concentration will have an adverse impact on the public health, safety and welfare of the neighborhood. you do not meet the statutory and municipal requirements; the appropriateness of the location to be licensed and whether the location will create undesirable neighborhood problems, whether or not you have been charged with or convicted of any felony, misdemeanor, municipal offense or other offense, the circumstances of which substantially relate to the licensed activity; and any other factors which reasonably relate to the public health, safety and welfare. See attached police report and/or written correspondence regarding this application. Please be advised the public will be able to provide information to the committee in person or in writing. The committee will receive and consider evidence regarding the above mentioned criteria.

**Notice for applicants with
warrants or unpaid fines:**

Proof of warrant satisfaction or payment of fines must be submitted at the hearing on the above date and time. Failure to comply with this requirement may result in a delay of the granting/denial of your application.

Failure to appear at this meeting may result in the denial of your license. Individual applicants must appear only in person or by an attorney. Corporate or Limited Liability applicants must appear only by the agent designated on the application or by an attorney. Partnership applicants must appear by a partner listed on the application or by an attorney. If you wish to do so and at your own expense, you may be accompanied by an attorney of your choosing to represent you at this hearing.

You will be given an opportunity to speak on behalf of the application and to respond and challenge any charges or reasons given for the denial. No petitions can be accepted by the committee, unless the people who signed the petition are present at the committee hearing and willing to testify. You may present witnesses under oath and you may also confront and cross-examine opposing witnesses under oath. If you have difficulty with the English language, you should bring an interpreter with you, at your expense, so that you can answer questions and participate in your hearing.

You may examine the application file at this office during regular business hours prior to the hearing date. Inquiries regarding this matter may be directed to the person whose signature appears below.

Limited parking for persons attending meetings in City Hall is available at reduced rates (5 hour limit) at the Milwaukee Center on the southwest corner of East Kilbourn and North Water Street. Parking tickets must be validated in the first floor information booth in City Hall.

PLEASE NOTE: Upon reasonable notice, efforts will be made to accommodate the needs of disabled individuals through sign language interpreters or other auxiliary aids. For additional information or to request this service, contact the Council Services Division ADA Coordinator at (414) 286-2998, Fax - (414) 286-3456, TDD - (414) 286-2025.

JIM OWCZARSKI, CITY CLERK

BY:

Jason Schunk
License Division Manager

If you have questions regarding this notice, please contact the License Division at (414) 286-2238.

200 E. Wells Street, Room 105, City Hall, Milwaukee, WI 53202. www.milwaukee.gov/license
Phone: (414) 286-2238 Fax: (414) 286-3057 Email Address: License@milwaukee.gov

MILWAUKEE POLICE DEPARTMENT

LICENSING

CRIMINAL RECORD/ORDINANCE VIOLATION/INCIDENTS SYNOPSIS

DATE: 08/13/2015

LICENSE TYPE: USED CAR

NEW: ☒

RENEWAL: ☐

No. 216019

Application Date: 08/12/2015

License Location: 3846 W Wisconsin Ave #112

Business Name: Supreme 1 Auto LLC

Licensee/Applicant: CURRY, Dejuan E
(Last Name, First Name, MI)

Date of Birth: 04/08/1979

Home Address: 928 S 77th St

City: Milwaukee

State: WI Zip Code: 53214

Home Phone:

This report is written by Police Officer David NOVAK, assigned to the License Investigation Unit, Days.

The Milwaukee Police Department's investigation regarding this application revealed the following:

1. On 06/15/2006 the applicant was cited for Operating While Intoxicated. On 09/15/2006 he was convicted and his license was revoked for 9 months
2. On 08/28/2010 the applicant was cited for Operating While Intoxicated. On 10/06/2010 he was convicted and his license was revoked for 1 year and 35 days jail.
3. On 01/23/2011 the applicant was cited for Operating While Intoxicated. On 04/29/2011 he was convicted and his license was revoked for 3 years plus 90 days jail.
4. On 00/22/2013 the applicant was charged in Milwaukee County with Operating While Intoxicated (4th w/in 5 years) (Felony).

Charge: Operating While Intoxicated 4th

Finding: Guilty

Sentence: 2 years prison with 2 years extended supervision (Imposed and Stayed), 3 years probation imposed, 24 months ignition interlock

Date: 08/02/2013

Case: 2013CF000895

5. The applicant is on probation for #4 above. Email notification sent to the Wisconsin Department of Correction on 08/13/2015 requesting they provide information to the License Division regarding the probation/parole status and the end date of the status.

Evioon Siefert, Linda

From: Schunk, Jason
Sent: Tuesday, September 15, 2015 7:16 PM
To: Moon Siefert, Linda
Cc: Wagner, Janice; Celella, Jessica
Subject: Fwd: Probation/Parole License Requests

If you could please attach to his record and redact the other individuals information it would be appreciated.

Thanks

Sent from my iPhone

Begin forwarded message:

From: "Thoreson, Niel - DOC" <Niel.Thoreson@wisconsin.gov>
Date: September 15, 2015 at 5:59:14 PM CDT
To: "Schunk, Jason" <LICMGR@milwaukee.gov>
Subject: RE: Probation/Parole License Requests

Dejan Curry is ok for a license.

Niel L. Thoreson
Regional Chief - Milwaukee County

----- Original message -----

From: "Schunk, Jason" <LICMGR@milwaukee.gov>
Date: 09/14/2015 1:56 PM (GMT-06:00)
To: "Thoreson, Niel - DOC" <Niel.Thoreson@wisconsin.gov>
Subject: Probation/Parole License Requests

Good afternoon,

I am following up on the following individuals and their request for a City of Milwaukee license. The individuals are all on probation or parole and we would like to know if the DOC would support or object to the issuance of a license for these individuals:

*

*



Wednesday, October 07, 2015



Notice of Public Hearing

CURRY, De Juan E, Agent
Supreme 1 Auto at 3846 W Wisconsin Av #112
Secondhand Motor Vehicle Dealer's Wholesale Only License Application

Tuesday, October 20, 2015 at 10:45 AM

To whom it may concern:

The above application has been made by the above named applicant(s). This requires approval from the Licenses Committee and the Common Council of the City of Milwaukee. The hearing before the Licenses Committee will take place on 10/20/2015 at 10:45 AM, in Room 301-B, Third Floor, City Hall. If you wish, you may provide testimony at the hearing regarding the request; see below for further information. You are not required to attend the hearing. Once the Licenses Committee makes its recommendation, this recommendation is forwarded to the full Common Council for approval at its next regularly scheduled hearing. Please review the information below and if you have further questions regarding this process, please contact the License Division at (414) 286-2238.

Important details for those wishing to provide information for the Licenses Committee to consider when making its recommendation:

1. The license application is scheduled to be heard at the above time. Due to other hearings running longer than scheduled, you may have to wait some time to provide your testimony.
2. You must appear in person and testify as to matters that you have personally experienced or seen. (You cannot provide testimony for your neighbor, parent or anyone else; this is considered hearsay and cannot be considered by the committee.)
3. No letters or petitions can be accepted by the committee (unless the person who wrote the letter or the persons who signed the petition are present at the committee hearing and willing to testify).
4. Persons opposed to the license application are given the opportunity to testify first; supporters may testify after the opponents have finished.
5. When you are called to testify, you will be sworn in and asked to give your name, and address. (If your first and/or last names are uncommon please spell them.)
6. You may then provide testimony.
 - a. Include only information relating to the above license application.
 - b. Include only information you have personally witnessed or seen.
 - c. Provide concise and relevant information detailing how this business has affected or may affect the peaceful enjoyment of your neighborhood.
 - d. If by the time you have the opportunity to testify, the information you wish to share has already been provided to the committee, you may state that you agree with the previous testimony. Redundant or repetitive testimony will not assist the committee in making its recommendation.
7. After giving your testimony, the members of the Licenses Committee and the licensee may ask questions regarding the testimony you have given or other factors relating to the license application.
8. Business Competition is not a valid basis for denial or non-renewal of a license.
Please Note: If you have submitted an objection to the above application your objection cannot be considered by the committee unless you personally testify at the hearing.

[illegible]

CURRENT RESIDENT	3808 W WISCONSIN AVE 405	MILWAUKEE, WI 53208-3154
CURRENT RESIDENT	3808 W WISCONSIN AVE 407	MILWAUKEE, WI 53208-3154
CURRENT RESIDENT	3808 W WISCONSIN AVE 408	MILWAUKEE, WI 53208-3154
CURRENT RESIDENT	3808 W WISCONSIN AVE 409	MILWAUKEE, WI 53208-3154
CURRENT RESIDENT	3808 W WISCONSIN AVE 410	MILWAUKEE, WI 53208-3154
CURRENT RESIDENT	3808 W WISCONSIN AVE 412	MILWAUKEE, WI 53208-3154
CURRENT RESIDENT	3808 W WISCONSIN AVE 414	MILWAUKEE, WI 53208-3154
CURRENT RESIDENT	3808 W WISCONSIN AVE 416	MILWAUKEE, WI 53208-3154
CURRENT RESIDENT	3808 W WISCONSIN AVE 417	MILWAUKEE, WI 53208-3154
CURRENT RESIDENT	3808 W WISCONSIN AVE 418	MILWAUKEE, WI 53208-3154
CURRENT RESIDENT	3808 W WISCONSIN AVE 420	MILWAUKEE, WI 53208-3154

Total Records: 67

Radius: 250.0 feet and Center of Circle: 3846 W Wisconsin AV



BUSINESS LICENSE PLAN OF OPERATION

ccl-busplan 7/24/15

Office of the City Clerk License Division

200 E. Wells St. Room 105, Milwaukee, WI 53202

(414) 286-2238 www.milwaukee.gov/license e-mail address: license@milwaukee.gov

1. Type of Business

Applying for: ☐ Extended Hours Establishment ☐ Filling Station ☐ Waste Tire Transporter ☐ Massage Establishment
☐ Self Service Laundry ☐ Rooming House: Number of Units: _____ ☐ Hotel/Motel: Number of Units: _____
☒ Other (supplemental application for specific license also required)

Provide a detailed description of the type of business you plan on operating:

Wholesale Dealership

Do you have any experience operating this type of business? ☐ No ☒ Yes If yes, explain: I work for a few dealerships

2. Business Operations

- a. Proposed Opening Date: 9-15-15
- b. Is this premise under construction? ☒ No ☐ Yes If yes, list estimated completion date: _____
- c. Is this a franchise? ☒ No ☐ Yes
- d. Is this premises currently licensed? ☒ No ☐ Yes If yes, list type of license: _____
- e. Is the current licensee operating? ☒ No ☐ Yes If no, list date closed: _____
- f. Do you have future plans for other businesses, licenses or permits at this location? ☒ No ☐ Yes
If yes, explain: _____
- g. Have you previously held an Extended Hours License in Milwaukee? ☒ No ☐ Yes
If yes, list address(es): _____
- h. Are other businesses operating in the same building? ☐ No ☒ Yes If yes, describe: Another wholesale dealership

3. Litter & Noise Control

- a. How are grounds kept clean? ☐ Sweep ☐ Pressure Wash ☐ Pick Up Litter ☒ Hired Maintenance
☐ Building Owner Responsibility ☐ Garbage Cans Outside ☐ Other: _____
- b. How often will grounds be cleaned? ☒ Daily ☐ Weekly ☐ As Needed ☐ Monthly ☐ Other: _____
- c. Grounds cleaned by: ☐ Licensee ☐ Building Owner ☐ Employees ☒ Hired Maintenance ☐ Other: _____
- d. How are noise issues prevented and/or addressed? ☐ Security ☒ Manager approaches customer(s) ☐ Call Police
☐ Signs Posted ☐ Other: _____
Will a sound amplification system be used? ☒ No ☐ Yes If yes, describe: _____
- e. Are there designated outdoor smoking areas? ☐ No ☒ Yes If yes, describe: _____
- f. Number of Garbage Cans: Inside: 10+ Locations: _____
Outside: _____ Locations: _____
- g. Is a crowd control barrier used? ☒ No ☐ Yes If yes, describe: _____
- h. Describe sanitation facilities (restrooms): Very clean
- i. Name of solid waste contractor: ☐ Advanced Disposal ☐ Waste Management ☐ Other: City

4. Parking & Security

- a. Are there off-street parking places? ☒ No ☐ Yes If yes, how many? _____

Describe security plan for parking lot: _____

- b. Is there a loading zone? ☒ No ☐ Yes If yes, describe security for loading zone _____

- c. Will you have security personnel on premise? ☒ No ☐ Yes If yes, how many? _____

What are their responsibilities? _____

Is security equipment used? ☐ No ☒ Yes If yes, describe there 8 cameras surrounding building

List their licensing, certification, or training credentials _____

Will there be security cameras? ☐ No ☒ Yes If yes, where? inside and outside building

Will searches or identification checks be conducted upon entry? ☒ No ☐ Yes If yes, describe _____

5. Percentage of Sales (must total 100%)

Alcohol _____%	Food _____%	Secondhand Merchandise _____%	Precious Metals & Gems _____%
Entertainment _____%	Cigarettes _____%		
Pawnbroker Activity _____%	Salvaged Materials _____% (such as scrap metal)	Personal Services (such as tattoo, body piercing, salon, tailor, tanning, etc.) _____%	Other <u>X 100%</u> Describe: <u>used cars</u>

6. Businesses/Licenses on the Premises (check all that apply):

Type 1

- | | | | |
|---|---|---|--|
| <input type="checkbox"/> Full Service Restaurant | <input type="checkbox"/> Cafe/Coffee Shop | <input type="checkbox"/> Deli or Fast Food Restaurant | <input type="checkbox"/> Private/Fraternal/Veterans Club |
| <input type="checkbox"/> Night Club | <input type="checkbox"/> Tavern | <input type="checkbox"/> Cocktail Lounge | <input type="checkbox"/> Teen Club |
| <input type="checkbox"/> Banquet Hall | <input type="checkbox"/> Sports Facility | | |
| <input type="checkbox"/> Hotel/Motel – Number of Rooms: _____ | | <input type="checkbox"/> Rooming House – Number of Rooms: _____ | |

Type 2

- | | | | |
|---|---|--|--|
| <input type="checkbox"/> Liquor Store | <input type="checkbox"/> Corner Store | <input type="checkbox"/> Supermarket | <input type="checkbox"/> Convenience Store |
| <input type="checkbox"/> Gas Station | <input type="checkbox"/> Amusement/Phonograph Distributor | | <input type="checkbox"/> Auto Wrecker |
| <input checked="" type="checkbox"/> Used Car Dealer | <input type="checkbox"/> Used Auto Parts | <input type="checkbox"/> Personal Service Establishment
(such as tattoo business, hair salon, tailor, etc.) | <input type="checkbox"/> Recording Studio |

What other types of licenses/permits will you hold at this location? (check all that apply)

- | | | | | | |
|--|---|---------------------------------------|---|---|---|
| <input type="checkbox"/> Occupancy Permit | <input type="checkbox"/> Cigarette & Tobacco | <input type="checkbox"/> Gas Station | <input type="checkbox"/> Extended Hours | <input type="checkbox"/> Class "B" Tavern | <input type="checkbox"/> Weights & Measures |
| <input type="checkbox"/> Secondhand Dealer | <input type="checkbox"/> Precious Metal & Gem | <input type="checkbox"/> Other: _____ | | | |

7. Legal Capacity (only if a Type 1 premises in #6 above)

Capacity _____ (Call the Milwaukee Development Center at 414-286-8211 if you have questions.)

8. Premises Description

d. Identify all area(s) of the premises that will be used in operating this business (include areas used only for storage):

☒ 1st Floor ☐ 2nd Floor ☐ Basement Storage ☐ Patio ☐ Beer Garden ☐ Sidewalk Café ☐ Deck ☐ Rooftop

☐ Other: Describe: _____

e. Describe Location: ☒ Major Thoroughfare ☐ Secondary Street ☐ Other: _____

f. Nearest Major Cross Street: 37th St

g. Describe Building: ☒ Free Standing Building ☐ Strip Mall ☐ Other: _____

h. Describe Premises Structure: ☐ Single Story ☒ Multi-Story - # of Stories 3 ☐ Other: _____

i. Describe Surrounding Area: ☒ Commercial ☒ Residential ☐ Industrial ☐ Other: _____

j. Property Owner's Name: _____ Phone Number: _____

Address: _____

9. Hours of Operation & Customers

Will customers be entering the premises? ☒ No ☐ Yes

Day of the Week	Proposed Hours of Operation:		Number of Customers expected each day	Potential Age Range of Customers	Class B Applicants: Age Restriction (If none, write 'None')
	Open (include a.m. or p.m.)	Close (include a.m. or p.m.)			
Sunday					
Monday	10am	5pm	0		
Tuesday	10am	5pm	0		
Wednesday	10am	5pm	0		
Thursday	10am	5pm	0		
Friday	10am	5pm	0		
Saturday	10am	5pm	0		

Extended Hours Establishment License is required for any convenience store, filling station, personal service establishment (such as tattoo, body piercing, salon, tailor, tanning, etc.), recording studio or restaurant which is open between the hours of 12 a.m. and 5 a.m.

Entertainment Indoor Closing Hours - If alcohol beverage establishment, same as alcohol license hours.
If non-alcohol establishment 1:00 am Sunday to Thursday; 1:30 am Friday and Saturday.

Entertainment Outdoor Closing Hours - 10:00 pm Sunday – Thursday; 12:00 am Friday and Saturday, unless otherwise approved by Common Council in licensee's plan of operation.

10. Signature(s)

Sole Proprietor, Partner, Agent, or 20% or more Shareholder

Signature of additional partner or 20% or more Shareholder

See Application Information for a list of all required application forms.



**SECONDHAND MOTOR VEHICLE DEALER,
USED MOTOR VEHICLE DEALER-PARTS ONLY &
USED BIKE, TIRE & BATTERY LICENSE
SUPPLEMENTAL PLAN OF OPERATION**

Office of the City Clerk License Division

200 E. Wells St. Room 105, Milwaukee, WI 53202

(414) 286-2238 e-mail address: license@milwaukee.gov www.milwaukee.gov/license

Legal Entity Name: Supreme 1 Auto LLC

Premise Address: 3846 W. Wisconsin Ave Suite 112 53208

Type of License applied for (check one):

- ☐ Secondhand Motor Vehicle Retail Dealer
☒ Secondhand Motor Vehicle Wholesale Dealer
☐ Used Motor Vehicle Retail Dealer – Parts Only
☐ Used Motor Vehicle Wholesale Dealer – Parts Only

- ☐ Used Bike, Tire & Battery Retail Dealer
☐ Used Bike, Tire & Battery Wholesale Dealer

RETAIL DEALERS ONLY

Total Number of Parking Spaces (including customer/employee parking) _____

Number of Parking Spaces that will be used for Display/Storage of Secondhand Motor Vehicles _____

STORAGE, MAINTENANCE & REPAIR

Do you understand that all vehicles associated with the business must be stored on the licensed premise? ☒ Yes ☐ No

List your plans to ensure this requirement is met: I have occupancy permit on premise

Do you understand all maintenance/repair work to these vehicles must be confined to the licensed premise? ☒ Yes ☐ No

List your plans to ensure this requirement is met: I have several dealerships who would do work.

DISCLOSURE

Has the applicant ever had a license relating to the activities licensed in Milwaukee Code of Ordinances Chapter 93 denied, not renewed, suspended, or revoked? ☒ No ☐ Yes

If yes, provide the circumstances and jurisdiction in which the event occurred (including a record of any actions from the State Department of Transportation and Financial Institutions relating to suspensions, revocations, forfeitures and warnings imposed by these departments relating to the operation of any automotive sales business by the applicant:

REQUIRED SIGNATURE(S)

Sole Proprietor, Partner, 20% or more Shareholder,
or the Agent - only if there are no 20% or more shareholders

Signature of additional partner or 20% or more shareholder

**SUBMIT THIS FORM ALONG WITH THE
BUSINESS LICENSE APPLICATION & BUSINESS LICENSE PLAN OF OPERATION**

Office Use Only:

Initials _____ Filed _____ App# _____



**CITY OF MILWAUKEE
OFFICE OF THE CITY CLERK**

Thursday, October 08, 2015

COMMITTEE MEETING NOTICE

AD 15

SKWAREK, David S, Agent
Run Management LLC
3916-3918 W KISSLICH PI

Milwaukee, WI 53208

You are requested to attend a hearing which is to be held in Room 301-B, Third Floor, City Hall on:

Tuesday, October 20, 2015 at 10:45 AM

Regarding: Your Secondhand Motor Vehicle Dealer's License Application as agent for "Run Management LLC" for "Aria Auto's" at 3916-3918 W KISSLICH PI.

There is a possibility that your application may be denied for one or more of the following reasons: Neighborhood Objections to the granting of such a license due to the creation of undesirable neighborhood problems, such as: parking and traffic problems which cause the normal flow of traffic on roadways and alleys to be impeded, loitering, littering, noise, loud music, and conduct which will have an adverse impact on the public health, safety and welfare of the community. Additionally, the over concentration of secondhand motor vehicle dealers in the neighborhood such that the concentration will have an adverse impact on the public health, safety and welfare of the neighborhood. you do not meet the statutory and municipal requirements; the appropriateness of the location to be licensed and whether the location will create undesirable neighborhood problems, whether or not you have been charged with or convicted of any felony, misdemeanor, municipal offense or other offense, the circumstances of which substantially relate to the licensed activity; and any other factors which reasonably relate to the public health, safety and welfare. See attached police report and/or written correspondence regarding this application. Please be advised the public will be able to provide information to the committee in person or in writing. The committee will receive and consider evidence regarding the above mentioned criteria.

**Notice for applicants with
warrants or unpaid fines:**

Proof of warrant satisfaction or payment of fines must be submitted at the hearing on the above date and time. Failure to comply with this requirement may result in a delay of the granting/denial of your application.

Failure to appear at this meeting may result in the denial of your license. Individual applicants must appear only in person or by an attorney. Corporate or Limited Liability applicants must appear only by the agent designated on the application or by an attorney. Partnership applicants must appear by a partner listed on the application or by an attorney. If you wish to do so and at your own expense, you may be accompanied by an attorney of your choosing to represent you at this hearing.

You will be given an opportunity to speak on behalf of the application and to respond and challenge any charges or reasons given for the denial. No petitions can be accepted by the committee, unless the people who signed the petition are present at the committee hearing and willing to testify. You may present witnesses under oath and you may also confront and cross-examine opposing witnesses under oath. If you have difficulty with the English language, you should bring an interpreter with you, at your expense, so that you can answer questions and participate in your hearing.

You may examine the application file at this office during regular business hours prior to the hearing date. Inquiries regarding this matter may be directed to the person whose signature appears below.

Limited parking for persons attending meetings in City Hall is available at reduced rates (5 hour limit) at the Milwaukee Center on the southwest corner of East Kilbourn and North Water Street. Parking tickets must be validated in the first floor information booth in City Hall.

PLEASE NOTE: Upon reasonable notice, efforts will be made to accommodate the needs of disabled individuals through sign language interpreters or other auxiliary aids. For additional information or to request this service, contact the Council Services Division ADA Coordinator at (414) 286-2998, Fax - (414) 286-3456, TDD - (414) 286-2025.

JIM OWCZARSKI, CITY CLERK

BY:

Jason Schunk
License Division Manager

If you have questions regarding this notice, please contact the License Division at (414) 286-2238.

200 E. Wells Street, Room 105, City Hall, Milwaukee, WI 53202. www.milwaukee.gov/license
Phone: (414) 286-2238 Fax: (414) 286-3057 Email Address: License@milwaukee.gov



**CITY OF MILWAUKEE
OFFICE OF THE CITY CLERK**

Thursday, October 08, 2015

COMMITTEE MEETING NOTICE

AD 15

SKWAREK, David S, Agent
Run Management LLC
914 S 4th St

Milwaukee, WI 53204

You are requested to attend a hearing which is to be held in Room 301-B, Third Floor, City Hall on:

Tuesday, October 20, 2015 at 10:45 AM

Regarding: Your Secondhand Motor Vehicle Dealer's License Application as agent for "Run Management LLC" for "Aria Auto's" at 3916-3918 W KISSLICH PL.

There is a possibility that your application may be denied for one or more of the following reasons: Neighborhood Objections to the granting of such a license due to the creation of undesirable neighborhood problems, such as: parking and traffic problems which cause the normal flow of traffic on roadways and alleys to be impeded, loitering, littering, noise, loud music, and conduct which will have an adverse impact on the public health, safety and welfare of the community. Additionally, the over concentration of secondhand motor vehicle dealers in the neighborhood such that the concentration will have an adverse impact on the public health, safety and welfare of the neighborhood. you do not meet the statutory and municipal requirements; the appropriateness of the location to be licensed and whether the location will create undesirable neighborhood problems, whether or not you have been charged with or convicted of any felony, misdemeanor, municipal offense or other offense, the circumstances of which substantially relate to the licensed activity; and any other factors which reasonably relate to the public health, safety and welfare. See attached police report and/or written correspondence regarding this application. Please be advised the public will be able to provide information to the committee in person or in writing. The committee will receive and consider evidence regarding the above mentioned criteria.

**Notice for applicants with
warrants or unpaid fines:**

Proof of warrant satisfaction or payment of fines must be submitted at the hearing on the above date and time. Failure to comply with this requirement may result in a delay of the granting/denial of your application.

Failure to appear at this meeting may result in the denial of your license. Individual applicants must appear only in person or by an attorney. Corporate or Limited Liability applicants must appear only by the agent designated on the application or by an attorney. Partnership applicants must appear by a partner listed on the application or by an attorney. If you wish to do so and at your own expense, you may be accompanied by an attorney of your choosing to represent you at this hearing.

You will be given an opportunity to speak on behalf of the application and to respond and challenge any charges or reasons given for the denial. No petitions can be accepted by the committee, unless the people who signed the petition are present at the committee hearing and willing to testify. You may present witnesses under oath and you may also confront and cross-examine opposing witnesses under oath. If you have difficulty with the English language, you should bring an interpreter with you, at your expense, so that you can answer questions and participate in your hearing.

You may examine the application file at this office during regular business hours prior to the hearing date. Inquiries regarding this matter may be directed to the person whose signature appears below.

Limited parking for persons attending meetings in City Hall is available at reduced rates (5 hour limit) at the Milwaukee Center on the southwest corner of East Kilbourn and North Water Street. Parking tickets must be validated in the first floor information booth in City Hall.

PLEASE NOTE: Upon reasonable notice, efforts will be made to accommodate the needs of disabled individuals through sign language interpreters or other auxiliary aids. For additional information or to request this service, contact the Council Services Division ADA Coordinator at (414) 286-2998, Fax - (414) 286-3456, TDD - (414) 286-2025.

JIM OWCZARSKI, CITY CLERK

BY: _____

Jason Schunk
License Division Manager

If you have questions regarding this notice, please contact the License Division at (414) 286-2238.

200 E. Wells Street, Room 105, City Hall, Milwaukee, WI 53202. www.milwaukee.gov/license
Phone: (414) 286-2238 Fax: (414) 286-3057 Email Address: License@milwaukee.gov

MILWAUKEE POLICE DEPARTMENT

LICENSING

CRIMINAL RECORD/ORDINANCE VIOLATION/INCIDENTS SYNOPSIS

DATE: 02/03/2015
LICENSE TYPE: USED CAR
NEW: ☒
RENEWAL: ☐

No. 204161
Application Date: 01/30/2015

License Location: 3916-3918 Kisslich Place
Business Name: Run Management

Licensee/Applicant: Skwarek, David R.
(Last Name, First Name, MI)

Date of Birth: 09/04/1963

Home Address: 914 South 4th Street
City: Milwaukee
Home Phone: 383-3920

State: WI Zip Code: 53204

This report is written by Police Officer Gilbert Gwinn, assigned to the License Investigation Unit, Days.

The Milwaukee Police Department's investigation regarding this application revealed the following:

1. On 04/09/2007 the applicant was cited at 3916 West Kisslich Place in the city of Milwaukee for Building Code Violations.

Charge: Building Code Violations
Finding: Guilty
Sentence: \$2480.00 fine
Date: 05/20/2008
Case: 08016626

2. On 04/03/2009 the Wisconsin Department of Transportation revoked the applicant's driver's license for 6 months for Operating While Intoxicated.
3. On 06/07/2012 the applicant was cited at McKinley Marina in the city of Milwaukee for Boating-Adoption of State Statute.

Charge: Boating-Adoption of State Statute
Finding: Guilty
Sentence: \$97.00 fine
Date: 08/13/2012
Case: 12077394

#204161

Redacted

Moon Siefert, Linda

From: License
Sent: Friday, April 24, 2015 8:13 AM
To: Moon Siefert, Linda
Subject: FW: 3916 W. Kisslich Place - Second Hand Vehicle Shop

Could you add as an objection?

From:
Sent: Thursday, April 23, 2015 5:41 PM
To: License; Stamper II, Russell
Subject: 3916 W. Kisslich Place - Second Hand Vehicle Shop

I object to this change in zoning or licensing.

This property is surround by residential homes. It should not be used for a second hand vehicle shop. A alley, auto shop is not what we want for the neighborhood.

--
Thanks,



Thursday, October 08, 2015



Notice of Public Hearing

SKWAREK, David S, Agent
Aria Auto's at 3916-3918 W KISSLICH PI
Secondhand Motor Vehicle Dealer's License Application

Tuesday, October 20, 2015 at 10:45 AM

To whom it may concern:

The above application has been made by the above named applicant(s). This requires approval from the Licenses Committee and the Common Council of the City of Milwaukee. The hearing before the Licenses Committee will take place on 10/20/2015 at 10:45 AM, in Room 301-B, Third Floor, City Hall. If you wish, you may provide testimony at the hearing regarding the request; see below for further information. You are not required to attend the hearing. Once the Licenses Committee makes its recommendation, this recommendation is forwarded to the full Common Council for approval at its next regularly scheduled hearing. Please review the information below and if you have further questions regarding this process, please contact the License Division at (414) 286-2238.

Important details for those wishing to provide information for the Licenses Committee to consider when making its recommendation:

1. The license application is scheduled to be heard at the above time. Due to other hearings running longer than scheduled, you may have to wait some time to provide your testimony.
2. You must appear in person and testify as to matters that you have personally experienced or seen. (You cannot provide testimony for your neighbor, parent or anyone else; this is considered hearsay and cannot be considered by the committee.)
3. No letters or petitions can be accepted by the committee (unless the person who wrote the letter or the persons who signed the petition are present at the committee hearing and willing to testify).
4. Persons opposed to the license application are given the opportunity to testify first; supporters may testify after the opponents have finished.
5. When you are called to testify, you will be sworn in and asked to give your name, and address. (If your first and/or last names are uncommon please spell them.)

6. You may then provide testimony.
 - a. Include only information relating to the above license application.
 - b. Include only information you have personally witnessed or seen.
 - c. Provide concise and relevant information detailing how this business has affected or may affect the peaceful enjoyment of your neighborhood.
 - d. If by the time you have the opportunity to testify, the information you wish to share has already been provided to the committee, you may state that you agree with the previous testimony. Redundant or repetitive testimony will not assist the committee in making its recommendation.
7. After giving your testimony, the members of the Licenses Committee and the licensee may ask questions regarding the testimony you have given or other factors relating to the license application.

8. Business Competition is not a valid basis for denial or non-renewal of a license.

Please Note: If you have submitted an objection to the above application your objection cannot be considered by the committee unless you personally testify at the hearing.

RESIDENT	MAIL ADDRESS	CITY AND ZIP CODE
CURRENT RESIDENT	1418 N 39TH ST	MILWAUKEE, WI 53208-2330
CURRENT RESIDENT	1420 N 39TH ST	MILWAUKEE, WI 53208-2330
CURRENT RESIDENT	1420 N 40TH ST 1	MILWAUKEE, WI 53208-2334
CURRENT RESIDENT	1420 N 40TH ST 2	MILWAUKEE, WI 53208-2334
CURRENT RESIDENT	1420 N 40TH ST 3	MILWAUKEE, WI 53208-2334
CURRENT RESIDENT	1424 N 39TH ST	MILWAUKEE, WI 53208-2330
CURRENT RESIDENT	1425 N 39TH ST	MILWAUKEE, WI 53208-2339
CURRENT RESIDENT	1426 N 39TH ST	MILWAUKEE, WI 53208-2330
CURRENT RESIDENT	1427 N 39TH ST	MILWAUKEE, WI 53208-2339
CURRENT RESIDENT	1428 N 39TH ST	MILWAUKEE, WI 53208-2330
CURRENT RESIDENT	1430 N 39TH ST	MILWAUKEE, WI 53208-2330
CURRENT RESIDENT	1430 N 40TH ST	MILWAUKEE, WI 53208-2334
CURRENT RESIDENT	1432 N 39TH ST	MILWAUKEE, WI 53208-2330
CURRENT RESIDENT	1433 N 39TH ST	MILWAUKEE, WI 53208-2339
CURRENT RESIDENT	1434 N 39TH ST	MILWAUKEE, WI 53208-2330
CURRENT RESIDENT	1435 N 39TH ST	MILWAUKEE, WI 53208-2339
CURRENT RESIDENT	1438 N 39TH ST	MILWAUKEE, WI 53208-2330
CURRENT RESIDENT	1438 N 40TH ST	MILWAUKEE, WI 53208-2334
CURRENT RESIDENT	1439 N 39TH ST	MILWAUKEE, WI 53208-2339
CURRENT RESIDENT	1440 N 39TH ST	MILWAUKEE, WI 53208-2330
CURRENT RESIDENT	1440 N 40TH ST	MILWAUKEE, WI 53208-2334
CURRENT RESIDENT	1441 N 39TH ST	MILWAUKEE, WI 53208-2339
CURRENT RESIDENT	1447 N 39TH ST	MILWAUKEE, WI 53208-2339
CURRENT RESIDENT	1450 N 40TH ST	MILWAUKEE, WI 53208-2334
CURRENT RESIDENT	1455 N 39TH ST	MILWAUKEE, WI 53208-2339
CURRENT RESIDENT	1456 N 40TH ST	MILWAUKEE, WI 53208-2334
CURRENT RESIDENT	1457 N 39TH ST	MILWAUKEE, WI 53208-2339
CURRENT RESIDENT	1502 N 40TH ST	MILWAUKEE, WI 53208-2335
CURRENT RESIDENT	1504 N 40TH ST	MILWAUKEE, WI 53208-2335
CURRENT RESIDENT	3903 W VLIET ST	MILWAUKEE, WI 53208-2851
CURRENT RESIDENT	3905 W VLIET ST	MILWAUKEE, WI 53208-2851
CURRENT RESIDENT	3906 W VLIET ST	MILWAUKEE, WI 53208-2850
CURRENT RESIDENT	3911 W VLIET ST	MILWAUKEE, WI 53208-2851
CURRENT RESIDENT	3911A W VLIET ST	MILWAUKEE, WI 53208-2851
CURRENT RESIDENT	3912 W VLIET ST	MILWAUKEE, WI 53208-2850
CURRENT RESIDENT	3913 W VLIET ST	MILWAUKEE, WI 53208-2851
CURRENT RESIDENT	3913A W VLIET ST	MILWAUKEE, WI 53208-2851
CURRENT RESIDENT	3915 W CHERRY ST	MILWAUKEE, WI 53208-2337
CURRENT RESIDENT	3915A W CHERRY ST	MILWAUKEE, WI 53208-2337
CURRENT RESIDENT	3919 W CHERRY ST	MILWAUKEE, WI 53208-2337
CURRENT RESIDENT	3919 W VLIET ST	MILWAUKEE, WI 53208-2851
CURRENT RESIDENT	3921 W CHERRY ST	MILWAUKEE, WI 53208-2337
CURRENT RESIDENT	3921 W VLIET ST	MILWAUKEE, WI 53208-2851
CURRENT RESIDENT	3922 W CHERRY ST	MILWAUKEE, WI 53208-2336
CURRENT RESIDENT	3922A W CHERRY ST	MILWAUKEE, WI 53208-2336
CURRENT RESIDENT	3923 W VLIET ST	MILWAUKEE, WI 53208-2851
CURRENT RESIDENT	3925 W VLIET ST	MILWAUKEE, WI 53208-2851
CURRENT RESIDENT	3926 W VLIET ST	MILWAUKEE, WI 53208-2850
CURRENT RESIDENT	3927 W CHERRY ST	MILWAUKEE, WI 53208-2337
CURRENT RESIDENT	3927 W VLIET ST	MILWAUKEE, WI 53208-2851
CURRENT RESIDENT	3927A W CHERRY ST	MILWAUKEE, WI 53208-2337
CURRENT RESIDENT	3929 W VLIET ST	MILWAUKEE, WI 53208-2851
CURRENT RESIDENT	3930 W CHERRY ST	MILWAUKEE, WI 53208-2336
CURRENT RESIDENT	3930 W VLIET ST	MILWAUKEE, WI 53208-2850
CURRENT RESIDENT	3932 W CHERRY ST	MILWAUKEE, WI 53208-2336

CURRENT RESIDENT	3932 W VLIET ST	MILWAUKEE, WI 53208-2850
CURRENT RESIDENT	3933 W CHERRY ST	MILWAUKEE, WI 53208-2337
CURRENT RESIDENT	3934 W VLIET ST	MILWAUKEE, WI 53208-2850
CURRENT RESIDENT	3935 W CHERRY ST	MILWAUKEE, WI 53208-2337
CURRENT RESIDENT	3935 W VLIET ST	MILWAUKEE, WI 53208-2851
CURRENT RESIDENT	3936 W VLIET ST	MILWAUKEE, WI 53208-2850
CURRENT RESIDENT	3937 W CHERRY ST	MILWAUKEE, WI 53208-2337
CURRENT RESIDENT	3938 W VLIET ST	MILWAUKEE, WI 53208-2850
CURRENT RESIDENT	3942 W VLIET ST	MILWAUKEE, WI 53208-2850
CURRENT RESIDENT	3942A W VLIET ST	MILWAUKEE, WI 53208-2850
CURRENT RESIDENT	3944 W VLIET ST	MILWAUKEE, WI 53208-2850
CURRENT RESIDENT	3946 W VLIET ST	MILWAUKEE, WI 53208-2850
CURRENT RESIDENT	3946A W VLIET ST	MILWAUKEE, WI 53208-2850
CURRENT RESIDENT	3948 W VLIET ST	MILWAUKEE, WI 53208-2850

Total Records: 70

Radius: 250.0 feet and Center of Circle: 3916 W Kisslich I



BUSINESS LICENSE PLAN OF OPERATION

ccl-busplan 12/8/14

Office of the City Clerk License Division

200 E. Wells St. Room 105, Milwaukee, WI 53202

(414) 286-2238 www.milwaukee.gov/license e-mail address: license@milwaukee.gov

1. Type of Business

Is this application for an Extended Hours Establishment License? ☒ No ☐ Yes

Provide a detailed description of the type of business you plan on operating: Sales of Use Vehicles

Do you have any experience operating this type of business? ☐ No ☒ Yes

If yes, explain: Electric, Heat, workers, Tool - Equipment -

2. Business Operations

a) Proposed Opening Date: March

b) Is this premise under construction? ☒ No ☐ Yes If yes, list estimated completion date: _____

c) Is this a franchise? ☒ No ☐ Yes

d) Is this premises currently licensed? ☒ No ☐ Yes If yes, list type of license: _____

e) Is the current licensee operating? ☒ No ☐ Yes If no, list date closed: not until I have a lic

f) What other types of licenses/permits will you hold at this location? (check all that apply)

☒ Occupancy Permit ☐ Cigarette & Tobacco ☐ Gas Station ☐ Extended Hours ☐ Class "B" Tavern ☐ Weights & Measures

☒ Secondhand Dealer ☐ Precious Metal & Gem ☐ Other: _____

g) Do you have future plans for other businesses, licenses or permits at this location? ☐ No ☒ Yes

If yes, explain: have one other occupancy permit there, building Bars - Wood

h) Have you previously held an Extended Hours License in Milwaukee? ☒ No ☐ Yes

If yes, list address(es): _____

i) Are other businesses operating in the same building? ☐ No ☒ Yes If yes, describe: (one) different Garage

3. Premises Description

a) Identify all area(s) of the premises that will be used in operating this business (include areas used only for storage):

☒ 1st Floor ☒ 2nd Floor ☐ Basement Storage ☐ Patio ☐ Beer Garden ☐ Sidewalk Café ☐ Deck ☐ Rooftop

☐ Other: Describe: office

b) Describe Location: ☐ Major Thoroughfare ☒ Secondary Street ☐ Other: _____

c) Nearest Major Cross Street: 40 + 39th Street Vliet St.

d) Describe Building: ☒ Free Standing Building ☐ Strip Mall ☐ Other: _____

e) Describe Premises Structure: ☐ Single Story ☐ Multi-Story - # of Stories _____ ☐ Other: _____

f) Describe Surrounding Area: ☒ Commercial ☒ Residential ☐ Industrial ☐ Other: _____

g) Are there off-street parking places? ☐ No ☒ Yes If yes, how many? on 40 and 39th street

h) Property Owner's Name: Rodman Management LLC Phone Number: 414 (308-6997)

Address: 914 S 4th mile, wt 53204

Agent David Skowroch

4. Businesses On The Premises (check all that apply):

Type 1

- | | | | |
|--|---|---|--|
| <input type="checkbox"/> Full Service Restaurant | <input type="checkbox"/> Cafe/Coffee Shop | <input type="checkbox"/> Deli or Fast Food Restaurant | <input type="checkbox"/> Private/Fraternal/Veterans Club |
| <input type="checkbox"/> Night Club | <input type="checkbox"/> Tavern | <input type="checkbox"/> Cocktail Lounge | <input type="checkbox"/> Teen Club |
| <input type="checkbox"/> Bowling Alley | <input type="checkbox"/> Hotel | <input type="checkbox"/> Banquet Hall | <input type="checkbox"/> Sports Facility |

Type 2

- | | | | |
|---|---|---|--|
| <input type="checkbox"/> Liquor Store | <input type="checkbox"/> Corner Store | <input type="checkbox"/> Supermarket | <input type="checkbox"/> Convenience Store |
| <input type="checkbox"/> Gas Station | <input type="checkbox"/> Amusement/Phonograph Distributor | <input type="checkbox"/> Auto Wrecker | |
| <input checked="" type="checkbox"/> Used Car Dealer | <input type="checkbox"/> Used Auto Parts | <input type="checkbox"/> Personal Service Establishment | <input type="checkbox"/> Recording Studio |

5. Legal Capacity (only if a Type 1 premises in #4 above)

Capacity _____ (Call the Milwaukee Development Center at 414-286-8211 if you have questions.)

6. Percentage of Sales (must total 100%)

Alcohol _____%	Cigarettes _____%	Secondhand Merchandise <u>100</u> %	Precious Metals & Gems _____%
Food _____%	Entertainment _____%		
Pawnbroker Activity _____%	Salvaged Materials _____% (such as scrap metal)	Other _____% Describe: _____	

7. Litter and Noise Control

- a. How are grounds kept clean? ☒ Sweep ☒ Pressure Wash ☒ Pick Up Litter ☐ Other: _____
- b. How often will grounds be cleaned? ☒ Daily ☐ Weekly ☐ Other: _____
- c. Grounds cleaned by: ☒ Licensee ☐ Building Owner ☒ Employees ☐ Hired Maintenance ☐ Other: _____
- d. Number of Garbage Cans: Inside: _____ Locations: _____
Outside: 3 Locations: Side of building
- e. Describe sanitation facilities (restrooms): one
- f. Name of solid waste contractor: None
- g. How are noise issues prevented and/or addressed? ☐ Security ☐ Manager approaches customer(s) ☒ Call Police
☐ Signs Posted ☐ Other: _____
- h. Will a sound amplification system be used? ☒ No ☐ Yes If yes, describe: _____

8. Security

- a. Will you have security personnel on premise? ☒ No ☐ Yes If yes, how many? _____
- What are their responsibilities? _____
- Is security equipment used? ☐ No ☒ Yes If yes, describe Cameras - around the building
- List their licensing, certification, or training credentials _____

- b. Will there be security cameras? ☐ No ☒ Yes If yes, where? The hole building
- c. Will searches or identification checks be conducted upon entry? ☒ No ☐ Yes If yes, describe _____

9. Customers

- a. Will customers be entering the premises? ☐ No ☒ Yes
- b. Are there designated outdoor smoking areas? ☒ No ☐ Yes If yes, describe: NO Smoking
- c. Is a crowd control barrier used? ☒ No ☐ Yes If yes, describe: _____

10. Hours of Operation

Day of the Week	Proposed Hours of Operation:		Number of Customers expected each day	Potential Age Range of Customers	Class B Applicants: Age Restriction (If none, write 'None')
	Open (include a.m. or p.m.)	Close (include a.m. or p.m.)			
Sunday					
Monday	8 00 am		4	18-20	
Tuesday					
Wednesday					
Thursday					
Friday					
Saturday					

Entertainment Indoor Closing Hours - If alcohol beverage establishment, same as alcohol license hours.
If non-alcohol establishment 1:00 am Sunday to Thursday; 1:30 am Friday and Saturday.

Entertainment Outdoor Closing Hours - 10:00 pm Sunday - Thursday; 12:00 am Friday and Saturday,
unless otherwise approved by Common Council in licensee's plan of operation.

11. Required Signature(s)

David E. Shwartz
Sole Proprietor, Partner, 20% or more Shareholder, or
Agent - only if there are no 20% or more shareholders

Signature of additional partner or 20% or more
shareholder

See Application Information for a list of all required application forms.



**SECONDHAND MOTOR VEHICLE DEALER,
USED MOTOR VEHICLE DEALER-PARTS ONLY &
USED BIKE, TIRE & BATTERY LICENSE
SUPPLEMENTAL PLAN OF OPERATION**

Office of the City Clerk License Division

200 E. Wells St. Room 105, Milwaukee, WI 53202

(414) 286-2238 e-mail address: license@milwaukee.gov www.milwaukee.gov/license

ccl-ucarplan 10/20/14

CITY OF MILWAUKEE
LICENSE DIVISION
2015 JAN 29 P 12:40

Legal Entity Name:

Premise Address:

Type of License applied for (check one):

- ☒ Secondhand Motor Vehicle Retail Dealer
☐ Secondhand Motor Vehicle Wholesale Dealer
☐ Used Motor Vehicle Retail Dealer – Parts Only
☐ Used Motor Vehicle Wholesale Dealer – Parts Only
☐ Used Bike, Tire & Battery Retail Dealer
☐ Used Bike, Tire & Battery Wholesale Dealer

RETAIL DEALERS ONLY

Total Number of Parking Spaces (including customer/employee parking) 7

Number of Parking Spaces that will be used for Display/Storage of Secondhand Motor Vehicles 20

STORAGE, MAINTENANCE & REPAIR

Do you understand that all vehicles associated with the business must be stored on the licensed premise? ☒ Yes ☐ No

List your plans to ensure this requirement is met: have a lot - fence area

Do you understand all maintenance/repair work to these vehicles must be confined to the licensed premise? ☒ Yes ☐ No

List your plans to ensure this requirement is met: have a repair shop

DISCLOSURE

Has the applicant ever had a license relating to the activities licensed in Milwaukee Code of Ordinances Chapter 93 denied, not renewed, suspended, or revoked? ☒ No ☐ Yes

If yes, provide the circumstances and jurisdiction in which the event occurred (including a record of any actions from the State Department of Transportation and Financial Institutions relating to suspensions, revocations, forfeitures and warnings imposed by these departments relating to the operation of any automotive sales business by the applicant:

REQUIRED SIGNATURE(S)

David Skwarek

Sole Proprietor, Partner, 20% or more Shareholder,
or the Agent - only if there are no 20% or more shareholders

Signature of additional partner or 20% or more shareholder

**SUBMIT THIS FORM ALONG WITH THE
BUSINESS LICENSE APPLICATION & BUSINESS LICENSE PLAN OF OPERATION**

Office Use Only:

Initials _____ Filed _____ App# _____