



CITY OF MILWAUKEE
OFFICE OF THE CITY CLERK

Thursday, August 27, 2015

COMMITTEE MEETING NOTICE

AD 12

KAUR, Lakhwinder, Agent
Nam Food and Beer Center LLC
7325 S 38th St

Franklin, WI 53132

You are requested to attend a hearing which is to be held in Room 301-B, Third Floor, City Hall on:

Tuesday, September 08, 2015 at 02:00 PM

Regarding: Your Class A Malt & Class A Liquor and Food Dealer License Applications as agent for "Nam Food and Beer Center LLC" for "Lucky's" at 1933 W Windlake Av.

There is a possibility that your application may be denied for one or more of the following reasons: The recommendation of the committee regarding the application shall be based on evidence presented at the hearing. Per MCO 85-2.7-4, probative evidence concerning whether or not a new license should be granted may be presented on the following subjects: whether or not the applicant meets the municipal requirements, the appropriateness of the location and premises where the licensed premises is to be located and whether use of the premises for the purposes or activities permitted by the license would tend to facilitate a public or private nuisance or create undesirable neighborhood problems such as disorderly patrons, unreasonably loud noise, litter, and excessive traffic and parking congestion. Probative evidence relating to these matters may be taken from the plan of operation submitted with the license application, if any, but shall not include the content of any music. Evidence regarding the fitness of the location of the premises to be maintained as the principal place of business, including but not limited to whether there is an overconcentration of businesses of the type for which the license is sought; whether the proposal is consistent with any pertinent neighborhood business or development plans, or the location's proximity to areas where children are typically present. The applicant's record in operating similarly licensed premises; and whether or not the applicant has been charged with or convicted of any felony, misdemeanor, municipal offense or other offense, the circumstances of which substantially relate to the activity to be permitted by the license being applied for or any other factor which reasonably relates to the public health, safety or welfare may also be considered. See attached police report or correspondence.

**Notice for applicants with
warrants or unpaid fines:**

Proof of warrant satisfaction or payment of fines must be submitted at the hearing on the above date and time. Failure to comply with this requirement may result in a delay of the granting/denial of your application.

Failure to appear at this meeting may result in the denial of your license. Individual applicants must appear only in person or by an attorney. Corporate or Limited Liability applicants must appear only by the agent designated on the application or by an attorney. Partnership applicants must appear by a partner listed on the application or by an attorney. If you wish to do so and at your own expense, you may be accompanied by an attorney of your choosing to represent you at this hearing.

You will be given an opportunity to speak on behalf of the application and to respond and challenge any charges or reasons given for the denial. No petitions can be accepted by the committee, unless the people who signed the petition are present at the committee hearing and willing to testify. You may present witnesses under oath and you may also confront and cross-examine opposing witnesses under oath. If you have difficulty with the English language, you should bring an interpreter with you, at your expense, so that you can answer questions and participate in your hearing.

You may examine the application file at this office during regular business hours prior to the hearing date. Inquiries regarding this matter may be directed to the person whose signature appears below.

Limited parking for persons attending meetings in City Hall is available at reduced rates (5 hour limit) at the Milwaukee Center on the southwest corner of East Kilbourn and North Water Street. Parking tickets must be validated in the first floor information booth in City Hall.

PLEASE NOTE: Upon reasonable notice, efforts will be made to accommodate the needs of disabled individuals through sign language interpreters or other auxiliary aids. For additional information or to request this service, contact the Council Services Division ADA Coordinator at (414) 286-2998, Fax - (414) 286-3456, TDD - (414) 286-2025.

JIM OWCZARSKI, CITY CLERK

BY: _____

Jason Schunk
License Division Manager

If you have questions regarding this notice, please contact the License Division at (414) 286-2238.

200 E. Wells Street, Room 105, City Hall, Milwaukee, WI 53202. www.milwaukee.gov/license
Phone: (414) 286-2238 Fax: (414) 286-3057 Email Address: License@milwaukee.gov

MILWAUKEE POLICE DEPARTMENT

LICENSING

CRIMINAL RECORD/ORDINANCE VIOLATION/INCIDENTS SYNOPSIS

DATE: 03/25/2015

LICENSE TYPE: Class B Tavern

NEW: ☐

RENEWAL: ☐

No. 205859

Application Date: 03/05/2015

License Location: 1933 West Windlake

Business Name: PSR Petro Mart

Licensee/Applicant: Rojas, Martha (Change of Agent)
(Last Name, First Name, MI)

Date of Birth: 11/02/1981

Home Address: 2434 South 5th Place

City: Milwaukee

State: WI Zip Code: 53207

Home Phone: 262-484-1087

This report is written by Police Officer Gilbert Gwinn, assigned to the License Investigation Unit, Days.

The Milwaukee Police Department's investigation regarding this application revealed the following:

1. On 10/17/2014 Jaswinder Singh was cited at 1933 West Windlake Avenue in the city of Milwaukee for Liquor License Required. Jaswinder Singh is listed on the application as 100% shareholder.

Charge: Liquor License Required

Finding: **Not adjudicated***in warrant status for failure to appear*****

Sentence:

Date: 03/25/2015

Case: 15010067

2. On 02/09/2015 Jaswinder Singh was cited at 1933 West Windlake Avenue in the city of Milwaukee for Liquor License Required. Jaswinder Singh is listed on the application as 100% shareholder.

Charge: Liquor License Required

Finding: **Not adjudicated***in warrant status for failure to appear*****

Sentence:

Date: 03/25/2015

Case: 15010068

Previous premise

MILWAUKEE POLICE DEPARTMENT

LICENSE INVESTIGATION UNIT

CRIMINAL RECORD/ORDINANCE VIOLATION/INCIDENTS SYNOPSIS

DATE: 06/19/2014
LICENSE TYPE: BTAVN
NEW:
RENEWAL: X

No. 189558
Application Date: 06/18/2014
Expiration Date:

License Location: 1933 W Windlake Ave
Business Name: Jassi's Place

Aldermanic District: 13

Licensee/Applicant: Singh, Jaswinder
(Last Name, First Name, MI)
Date of Birth: 04/06/66

Male: X

Female:

Home Address: 1933 W Windlake Ave
City: Milwaukee
Home Phone: (414) 263-1083

State: WI Zip Code: 53215

This report is written by Police Officer Gilbert Gwinn, assigned to the License Investigation Unit, Days.

The Milwaukee Police Department's investigation regarding this application revealed the following:

1. On 10/24/2004 at 11:44 PM officers made a lawful inspection of the licensed premises at 1933 W Windlake Av. Officers discovered that the tavern licenses were not displayed. The applicant gave officer conflicting statements as to why the licenses were not posted.

Charge : Display of Licenses
Finding : Guilty, Municipal Court
Sentence : Fined \$175.00
Date : 01/05/2005
Case : 04126403

2. On 04/16/2005 at 4:19 AM officers responded to the licensed premises at 1933 W Windlake to investigate the report of a loud party. Officers discovered the door locked and people inside the licensed premises yelling that the police were there. The applicant was observed standing at the bar. Officers asked the applicant to open the door, which he refused to do. After several minutes and pounding on the door, the applicant open the door and allowed officer in. The applicant denied that there were people in the bar after hours. Officers observed beers on the bar. The applicant then told officers there were people in the bar, but not drinking. He then told officers the people ran up-stairs because they were afraid of the police. The applicant was very uncooperative with officers on the scene.

Charge : Immediate Entry for Officers
: Patrons After Hours
Finding : Guilty
: Dismissed without Prejudice
Sentence : Fined \$343.00
Date : 06/29/2005
: 06/29/2005
Case : 05050477
: 05050478

Note: Above incident was reported on previous renewal. Disposition now added.

****Applicant currently has two open warrants with the Milwaukee Police Department.
(06119268 & 08035369) Letter was mailed on 06/30/08.**

3. On 02/11/08, applicant received a citation for Collusive Agreement Involving Liquor License at 1933 W Windlake Avenue.

Charge: Collusive Agreement Involving Liquor License
Finding: Guilty
Sentence: Fined \$200.00
Date: 07/22/08
Case: 08035369

Incident # 3 previously reported, disposition now added on 06/02/09.

4. On 09/26/08 at 1:11 am, Milwaukee police were dispatched to 20th and Windlake for a Shots Fired complaint. Investigation revealed no shots were fired but that two subjects were cut by bottles from patrons who had exited the tavern. The victims stated to police that they were about to enter the Jassi's bar but stopped to talk to a female patron who had just exited the tavern. Shortly after, 3-5 males exited the tavern carrying bottles. These subjects initiated the confrontation between the victim and his friend and a fight started. One victim was struck over the head with an unopened beer bottle, which caused several lacerations and required stitches to close. The second victim stated he was almost run over by a car driven by one of the suspects when the suspect exited the auto and began striking the victim with a metal baseball bat. The second victim suffered a puncture wound to the back from falling on broken beer bottle glass, which required stitches. Attempts to contact the licensee were unsuccessful.

- =====
5. On 10/17/2014 Milwaukee police responded to an anonymous tip of a subject with a gun in the at South 19th Street and West Windlake Avenue in a bar named Jesse's Tavern (1933 West Windlake Avenue). Officers discovered two handguns in trash cans inside the business. The owner of the bar, Ayshe Ahmed, stated there were no problems inside the business and was discovered any weapons had been recovered.
6. On 02/09/2015 Milwaukee police conducted a licensed premise check of Jesse's Tavern (1933 West Windlake Avenue). Officers found the business to be open, but the only person on the premise was Ayshe Ahmed, who identified herself as the wife of the applicant. Later, a check revealed that the business's class B tavern license and public entertainment license had been rendered null and void and the business was operating without these licenses since 08/22/2014. Officers issued citations to the applicant for being open without the appropriate license on 10/17/2014 and 02/09/2015.

Charge: Liquor License Required
Finding: Not guilty plea entered
Sentence:
Date:
Case: 15010067

Charge: Liquor License Required
Finding: Not guilty plea entered
Sentence:
Date:
Case: 15010068

Items #5 and #6 added 05/06/2015 as part of previous premise

Date:05/22/15
Officer: Efrain Cornejo

City of Milwaukee Police Department
90-5-1.5 Crime Prevention Survey
Convenience Store/Liquor Store Inspection

Name of Premise: Lucky's
Address: 1933 W Windlake Ave
Phone: pending

Owner: Nam Food and Beer Center LLC
Owner address: 7325 S 38th St
City State Zip: Franklin, WI 53132
Owner Phone: (414) 430-4243
Owner email: ghotralucky21@yahoo.com

Manager: Lakhwinder Kaur
Home Address: 7325 S 38th St
City State Zip: Franklin, WI 53132
Phone: (414) 430-4243
Email: ghotralucky21@yahoo.com

Preferred contact: Lakhwinder Kaur

Location currently open: ☐ YES ☒ NO

Projected open date: August 2015

Day's open: ☐S ☐M ☐T ☐W ☐Th ☐F ☐SA ☒ALL

Hours of Operation: Sun: 9AM-9PM 24 hours ☐Y ☒N
Mon: 9AM-9PM
Tue: 9AM-9PM
Wed: 9AM-9PM
Thu: 9AM-9PM
Fri: 9AM-9PM
Sat: 9AM-9PM

Premise Type: ☐Liquor Store
☒Convenience Store
☐Other:

Licenses currently held:

Alcohol: ☐ Yes ☒ No Class: #:
Tobacco: ☐ Yes ☒ No #:
Food: ☐ Yes ☒ No #:
Extended Hours: ☐ Yes ☒ No #:
Secondhand Dealer: ☐ Yes ☒ No Type: #:
Other: ☐ Yes ☒ No Type: #:
Other: ☐ Yes ☒ No Type: #:

Exterior Survey:

1. Is the area around the location clean? ☒ Yes ☐ No
2. What surrounds the location? (Check all the apply)
 - a. ☒ Park
 - b. ☒ School
 - c. ☐ Youth Center
 - d. ☒ Church
 - e. ☐ Tavern(s) If so, how many
 - f. ☒ Residential
 - g. ☐ Other businesses
 - h. ☐ Other:
3. Can you see from the outside of the location into the interior ☒ Yes ☐ No
4. Can you see the employees inside of the location from the outside ☒ Yes ☐ No
5. Are exterior windows free of signage ☒ Yes ☐ No
6. Is there a parking lot ☒ Yes ☐ No
7. Is the parking lot clean? ☒ Yes ☐ No
8. Is the parking lot well lit? ☒ Yes ☐ No
9. Are there areas where a person could conceal themselves ☐ Yes ☒ No
10. Is there exterior lighting? ☒ Yes ☐ No. Does it appears to be adequate ☒ Yes ☐ No
11. Exterior Payphone? ☐ Yes ☒ No
12. Are there No Loitering Signs posted? ☐ Yes ☒ No
13. Are there exterior security cameras ☐ Yes ☒ No How Many:
14. Are the address numbers prominently displayed and easy to see ☒ Yes ☐ No

Camera Survey:

15. Does this location have security cameras? ☐ Yes ☒ No
16. Are they in working order? ☐ Yes ☒ No
17. What format are the cameras?
 - a. Color ☐ Yes ☒ No
 - b. Digital ☐ Yes ☒ No
 - c. VCR ☐ Yes ☒ No
 - d. Recorded ☐ Yes ☒ No
18. How long is footage stored for later viewing:
19. Are there exterior cameras ☐ Yes ☒ No How many:
20. Are there interior cameras ☐ Yes ☒ No How many:
21. Do all employees know how to retrieve recorded digital images/footage? ☐ Yes ☒ No

Interior Survey:

22. Is the storeowner willing to be a standing complainant regarding loitering? ☐Yes ☒No
a. If yes have them fill out the standing complaint form and give them two of the commercial signs ☐Yes ☒No
23. Is the interior of the location neat and clean? ☒Yes ☐No
24. Does an interior camera face the entrance/exit? ☐Yes ☒No
25. Is there a lockable area that separates employees from customers? ☐Yes ☒No
26. Does the store sell single chore boy? ☐Yes ☒No
27. Does the store sell blunt wraps? ☐Yes ☒No
28. Does the store sell scales? ☐Yes ☒No
29. Does the store sell items that may be used as crack pipes? ☐Yes ☒No
a. Describe item
30. Does the store have an over abundance of sandwich baggies: ☐Yes ☒No
31. Does the owner understand that these items are often used for drug use? ☒Yes ☐No
32. Do the products in the store appear to be new and rotated often? ☐Yes ☒No
33. Are emergency and non-emergency numbers posted near the phone? ☐Yes ☒No
34. Does the owner know how to contact their police district directly? ☐Yes ☒No
a. Did you provide a district contact guide to the owner? ☒Yes ☐No

Complete this section if alcohol establishment is a convenience store:

(** Read full ordinance for all details "68-4.3 Convenience Food Stores")

All convenience food stores not exempted under sub. 3 shall:

1. Is the cash register located in a manner so that at the time of a sales transaction, the employee and customer are both visible from the sidewalk? ☐Yes ☒No **
2. Are the glass entrance and exit doors clear of any signs or advertisements with the exception of a sign which states that the cash register contains \$50 or less and that the safe is no accessible to employees? ☒Yes ☐No
3. Does the store maintain one of the following on the licensed premise:
 - a. A safe that was in use at the convenience food store on August 17, 1994? ☐Yes ☒No
 - b. A drop-safe or time release safe that weighs at least 500 pounds or which is attached to or set into the floor in a manner approved by the police department? ☐Yes ☒No
4. Is lighting provided for the store's parking area during all hours of darkness when employees or customers are on the premises at a minimum average of 2-foot candles per square foot, unless the store is not open for business after sunset and before sunrise? ☒Yes ☐No ☐N/A
5. Are at least two high-resolution surveillance security cameras installed? ☐Yes ☒No
6. Are the security cameras in working order? ☐Yes ☒No
7. Does one camera show an overall view of the counter and register area? ☐Yes ☒No
8. Does one camera show a clear, identifiable, full frame image of the face of each person entering and leaving the store? ☐Yes ☒No
9. Are the camera views obstructed by fixtures or displays? ☐Yes ☒No
10. Is the recorded footage stored for at least 30 days? ☐Yes ☒No
11. Do all store employees know how to record footage from the camera system to media capable of being transferred to police custody? ☐Yes ☒No

12. Are customer entrances/exits made of glass or other transparent material? ☒ Yes ☐ No
a. Exception: A store that does not have such doors on August 17, 1994 shall not be required to install such doors until the holder of the store's food dealer license changes.
13. Has the owner and their employees attended the Robbery Prevention Training within 120 days of ownership or employment? ☐ Yes ☒ No
a. Contact Community Outreach and Education at 935-7836 for schedule.

Sub 3. Exemptions. The requirements of this section do not apply to a convenience food store that conforms to either of the following descriptions:

- a-1. The store is located in an enclosed shopping structure, enclosed commercial building or hospital. A convenience food store is not in an enclosed structure or building if a customer can enter it directly from the outside.
Does store conform to a-1 ☐ Yes ☒ No
- a-2. The store physically separates employees from customers with a solid partition that bars a person from entering the employee area from the customer area, has a secure lock on the employee side of any door between the employee area and the customer, and conducts all transaction through a service window or similar arrangement.
Does store conform to a-2 ☐ Yes ☒ No
- a. At the commissioner's discretion, a convenience store may be exempted from any or all of the regulations specified in sub 2.
Does this location hold an exemption from the commissioner regarding any of the requirements of Sub 2? ☐ Yes ☒ No

ADDITIONAL COMMENTS/RECOMMENDATIONS:

Applicant stated she recently had an offer excepted to purchase this building which is a tavern. She stated the purchase is contingent on her obtaining her liquor license. Applicant stated she will remodel the old tavern and turn it into a convenience store. Applicant stated she will have a drop safe, an enclosed register area, and will be installing exterior and interior surveillance system. I observed the location, it is currently setup as a tavern. There aren't any shelves or retail products on display. Applicant stated she has another convenience store located at 2638 W Lincoln Ave. She stated she has 4 years of experience running that store and would like to open a new store at this location.

Alcohol Concentration for 1933 W Windlake Ave

City of Milwaukee, Wisconsin



- Legend -

- City limits
- Parcels
- Freeways
- Freeways
- Exit ramps
- Entry ramps
- Ramps
- Major streets
- Streets
- Waterways
- Alcohol licenses
- Class A intoxicating liquor
- Class A fermented malt beverage
- Class A liquor and malt
- Class B fermented malt beverage
- Class B tavern
- Class C wine retailer

- Notes -

Alcohol establishments within a .5 mile radius centered on 1933 W. Windlake Avenue on 5/6/15



Department of Administration - ITMD

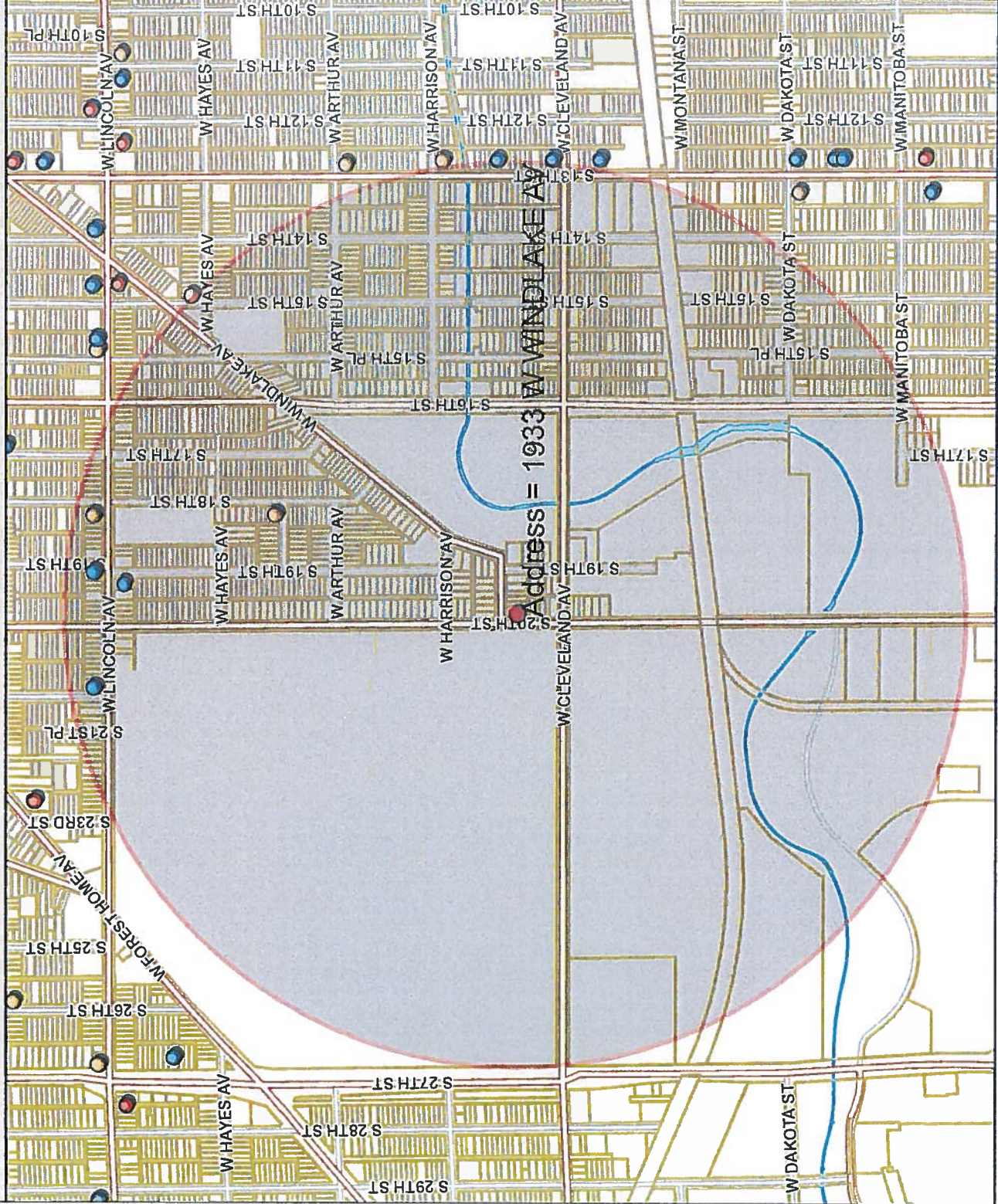

833.3 0 416.67 833.3 Feet

Map Scale: 1: 10,000

Licensed Alcohol Beverage Establishments within a .5 Mile Radius Centered on 1933 W. Windlake Avenue, 5/5/15									
Legal entity	Trade name	Licensee	Address	License type	License type name	Total capacity	Room capacity	Expiration date	
ROMANS FOODS	ROMANS FOODS	NEDAL K ASSAD, SP	2441 S 18TH ST	AMALT	Class A Fermented Malt Beverage Retailer's License			5/15/2016	
PEAK CORPORATION	EXPRESS PANTRY	RAFIQUE I ABDULLAH, Agt	1804 W LINCOLN AV	AMALT	Class A Fermented Malt Beverage Retailer's License			5/14/2016	
HOLLER HOUSE	HOLLER HOUSE	TODD C STUCKERT, SP	2042 W LINCOLN AV	BTAVN	Class B Tavern License	50		6/30/2015	
PSR PETRO MART, LLC	JASSI'S PLACE	JASWINDER SINGH, Agt	1933 W WINDLAKE AV	BTAVN	Class B Tavern License	60		7/29/2015	
Irene's Catering Service, Inc	Irene's Catering Service, Inc	JOEL A REWOLINSKI, Agt	1901 W Lincoln AV	BTAVN	Class B Tavern License			10/19/2015	
EL CAMINANTE SPORTS BAR	EL CAMINANTE SPORTS BAR	Josephine Vargas, SP	1900 W LINCOLN AV	BTAVN	Class B Tavern License	51		7/30/2015	
License Summary									
Class A Fermented Malt Beverage Retailer's License			Total						
			2						
Class B Tavern License			4						
Grand Total			6						

We the neighbors object to a liquor store or convenience store being zoned and operating at 1933 W. Windlake, (20th & Windlake).

The proposed store will add car traffic to the congested area along with additional foot traffic to our quiet neighborhood, possibly endangering the safety of all, including our children as well as create opportunities for vagrants and thieves.

Name

Address

Phone



Thursday, August 27, 2015



Notice of Public Hearing

KAUR, Lakhwinder, Agent
Lucky's at 1933 W Windlake Av
Class A Malt & Class A Liquor and Food Dealer License Applications

Tuesday, September 08, 2015 at 2:00 PM

To whom it may concern:

The above application has been made by the above named applicant(s). This requires approval from the Licenses Committee and the Common Council of the City of Milwaukee. The hearing before the Licenses Committee will take place on 9/8/2015 at 2:00 PM, in Room 301-B, Third Floor, City Hall. If you wish, you may provide testimony at the hearing regarding the request; see below for further information. You are not required to attend the hearing. Once the Licenses Committee makes its recommendation, this recommendation is forwarded to the full Common Council for approval at its next regularly scheduled hearing. Please review the information below and if you have further questions regarding this process, please contact the License Division at (414) 286-2238.

Important details for those wishing to provide information for the Licenses Committee to consider when making its recommendation:

1. The license application is scheduled to be heard at the above time. Due to other hearings running longer than scheduled, you may have to wait some time to provide your testimony.
2. You must appear in person and testify as to matters that you have personally experienced or seen. (You cannot provide testimony for your neighbor, parent or anyone else; this is considered hearsay and cannot be considered by the committee.)
3. No letters or petitions can be accepted by the committee (unless the person who wrote the letter or the persons who signed the petition are present at the committee hearing and willing to testify).
4. Persons opposed to the license application are given the opportunity to testify first; supporters may testify after the opponents have finished.
5. When you are called to testify, you will be sworn in and asked to give your name, and address. (If your first and/or last names are uncommon please spell them.)
6. You may then provide testimony.
 - a. Include only information relating to the above license application.
 - b. Include only information you have personally witnessed or seen.
 - c. Provide concise and relevant information detailing how this business has affected or may affect the peaceful enjoyment of your neighborhood.
 - d. If by the time you have the opportunity to testify, the information you wish to share has already been provided to the committee, you may state that you agree with the previous testimony. Redundant or repetitive testimony will not assist the committee in making its recommendation.
7. After giving your testimony, the members of the Licenses Committee and the licensee may ask questions regarding the testimony you have given or other factors relating to the license application.
8. Business Competition is not a valid basis for denial or non-renewal of a license.
Please Note: If you have submitted an objection to the above application your objection cannot be considered by the committee unless you personally testify at the hearing.

RESIDENT	MAIL ADDRESS	CITY AND ZIP CODE
CURRENT RESIDENT	1874 W WINDLAKE AVE	MILWAUKEE, WI 53215-3054
CURRENT RESIDENT	1878 W WINDLAKE AVE	MILWAUKEE, WI 53215-3054
CURRENT RESIDENT	1878A W WINDLAKE AVE	MILWAUKEE, WI 53215-3054
CURRENT RESIDENT	1882 W WINDLAKE AVE	MILWAUKEE, WI 53215-3054
CURRENT RESIDENT	1901 W HARRISON AVE	MILWAUKEE, WI 53215-3023
CURRENT RESIDENT	1901 W WINDLAKE AVE	MILWAUKEE, WI 53215-3033
CURRENT RESIDENT	1901A W HARRISON AVE	MILWAUKEE, WI 53215-3023
CURRENT RESIDENT	1905 W HARRISON AVE	MILWAUKEE, WI 53215-3023
CURRENT RESIDENT	1906 W WINDLAKE AVE	MILWAUKEE, WI 53215-3034
CURRENT RESIDENT	1906A W WINDLAKE AVE	MILWAUKEE, WI 53215-3034
CURRENT RESIDENT	1910 W WINDLAKE AVE	MILWAUKEE, WI 53215-3034
CURRENT RESIDENT	1910A W WINDLAKE AVE	MILWAUKEE, WI 53215-3034
CURRENT RESIDENT	1911 W HARRISON AVE	MILWAUKEE, WI 53215-3023
CURRENT RESIDENT	1911 W WINDLAKE AVE	MILWAUKEE, WI 53215-3033
CURRENT RESIDENT	1911A W WINDLAKE AVE	MILWAUKEE, WI 53215-3033
CURRENT RESIDENT	1916 W WINDLAKE AVE	MILWAUKEE, WI 53215-3034
CURRENT RESIDENT	1917 W HARRISON AVE	MILWAUKEE, WI 53215-3023
CURRENT RESIDENT	1919 W WINDLAKE AVE	MILWAUKEE, WI 53215-3033
CURRENT RESIDENT	1920 W WINDLAKE AVE	MILWAUKEE, WI 53215-3034
CURRENT RESIDENT	1923 W WINDLAKE AVE	MILWAUKEE, WI 53215-3033
CURRENT RESIDENT	1926 W WINDLAKE AVE	MILWAUKEE, WI 53215-3034
CURRENT RESIDENT	1930 W WINDLAKE AVE	MILWAUKEE, WI 53215-3034
CURRENT RESIDENT	1933 W WINDLAKE AVE	MILWAUKEE, WI 53215-3033
CURRENT RESIDENT	2409 W FOREST HOME AVE	MILWAUKEE, WI 53215-2526
CURRENT RESIDENT	2602 S 20TH ST	MILWAUKEE, WI 53215-3015
CURRENT RESIDENT	2606 S 20TH ST	MILWAUKEE, WI 53215-3015
CURRENT RESIDENT	2612 S 20TH ST	MILWAUKEE, WI 53215-3015
CURRENT RESIDENT	2644 S 19TH ST	MILWAUKEE, WI 53215-3063
CURRENT RESIDENT	2644A S 19TH ST	MILWAUKEE, WI 53215-3063
CURRENT RESIDENT	2658 S 19TH ST	MILWAUKEE, WI 53215-3063
CURRENT RESIDENT	2658A S 19TH ST	MILWAUKEE, WI 53215-3063
CURRENT RESIDENT	2664 S 20TH ST	MILWAUKEE, WI 53215-3053
CURRENT RESIDENT	2664A S 20TH ST	MILWAUKEE, WI 53215-3053
CURRENT RESIDENT	2666 S 19TH ST	MILWAUKEE, WI 53215-3063
CURRENT RESIDENT	2666A S 19TH ST	MILWAUKEE, WI 53215-3063
CURRENT RESIDENT	2667 S 19TH ST	MILWAUKEE, WI 53215-3011
CURRENT RESIDENT	2668 S 20TH ST	MILWAUKEE, WI 53215-3053
CURRENT RESIDENT	2670 S 19TH ST	MILWAUKEE, WI 53215-3063
CURRENT RESIDENT	2670 S 20TH ST	MILWAUKEE, WI 53215-3053
CURRENT RESIDENT	2671 S 19TH ST	MILWAUKEE, WI 53215-3011
CURRENT RESIDENT	2672 S 19TH ST	MILWAUKEE, WI 53215-3063
CURRENT RESIDENT	2673 S 19TH ST	MILWAUKEE, WI 53215-3011
CURRENT RESIDENT	2675 S 19TH ST	MILWAUKEE, WI 53215-3011
CURRENT RESIDENT	2675A S 19TH ST	MILWAUKEE, WI 53215-3011
CURRENT RESIDENT	2676 S 20TH ST	MILWAUKEE, WI 53215-3053
CURRENT RESIDENT	2678 S 20TH ST	MILWAUKEE, WI 53215-3053
CURRENT RESIDENT	2678A S 20TH ST	MILWAUKEE, WI 53215-3053
CURRENT RESIDENT	2679 S 19TH ST	MILWAUKEE, WI 53215-3011
CURRENT RESIDENT	2700 S 20TH ST	MILWAUKEE, WI 53215-3708
CURRENT RESIDENT	2704 S 20TH ST	MILWAUKEE, WI 53215-3708

Total Records: 51

Radius: 300.0 feet and Center of Circle: 1933 W Windlake AV



Friday, August 28, 2015

Licenses Committee Notice of Hearing

Jaswinder Singh
1933 W WINDLAKE Av

Milwaukee, WI 53215

Date: 9/8/2015
Time: 02:00 PM
Location: Room 301-B, Third Floor, City Hall

The Licenses Committee will consider the following license application:

Class A Malt & Class A Liquor and Food Dealer License Applications
KAUR, Lakhwinder, Agent
Lucky's at 1933 W Windlake Av

Please note this application may be recommended for denial based on fitness of the location due to concentration of alcohol beverage outlets in the area. If the application is denied for this reason, no other application for an alcohol beverage license for this location shall be recommended for approval by the Licenses Committee within three years of the date of denial unless the applicant has demonstrated a change of circumstances since the prior denial.

If you have any questions, please call (414) 286-2238.





Friday, August 28, 2015

Licenses Committee Notice of Hearing

Nam Food and Beer Center LLC
7325 S 38th St

Franklin, WI 53132

Date: 9/8/2015
Time: 02:00 PM
Location: Room 301-B, Third Floor, City Hall

The Licenses Committee will consider the following license application:

Class A Malt & Class A Liquor and Food Dealer License Applications
KAUR, Lakhwinder, Agent
Lucky's at 1933 W Windlake Av

Please note this application may be recommended for denial based on fitness of the location due to concentration of alcohol beverage outlets in the area. If the application is denied for this reason, no other application for an alcohol beverage license for this location shall be recommended for approval by the Licenses Committee within three years of the date of denial unless the applicant has demonstrated a change of circumstances since the prior denial.

If you have any questions, please call (414) 286-2238.





BUSINESS LICENSE PLAN OF OPERATION

ccl-busplan 3/17/15

Office of the City Clerk License Division

200 E. Wells St. Room 105, Milwaukee, WI 53202

(414) 286-2238 www.milwaukee.gov/license e-mail address: license@milwaukee.gov

1. Type of Business

Applying for: ☐ Extended Hours Establishment License ☐ Filling Station License ☒ Other (plan of operation for specific license also required)

Provide a detailed description of the type of business you plan on operating:

Convenience store and beer/liquor store.

Do you have any experience operating this type of business? ☐ No ☒ Yes

If yes, explain: *My LLC operates the business called "Lucky Food and Beer" located at 2638 W. Lincoln Ave., Milwaukee, WI 53215*

2. Business Operations

- a. Proposed Opening Date: 7/01/2015
- b. Is this premise under construction? ☒ No ☐ Yes If yes, list estimated completion date: _____
- c. Is this a franchise? ☒ No ☐ Yes
- d. Is this premises currently licensed? ☐ No ☒ Yes If yes, list type of license: Class "A" Liquor and Malt
- e. Is the current licensee operating? ☐ No ☒ Yes If no, list date closed: _____
- f. Do you have future plans for other businesses, licenses or permits at this location? ☒ No ☐ Yes
If yes, explain: _____
- g. Have you previously held an Extended Hours License in Milwaukee? ☒ No ☐ Yes
If yes, list address(es): _____
- h. Are other businesses operating in the same building? ☒ No ☐ Yes If yes, describe: _____

3. Litter & Noise Control

- a. How are grounds kept clean? ☒ Sweep ☐ Pressure Wash ☒ Pick Up Litter ☐ Hired Maintenance
☐ Building Owner Responsibility ☒ Garbage Cans Outside ☒ Other: Garbage Cans inside
- b. How often will grounds be cleaned? ☒ Daily ☐ Weekly ☐ As Needed ☐ Monthly ☐ Other: _____
- c. Grounds cleaned by: ☒ Licensee ☐ Building Owner ☐ Employees ☐ Hired Maintenance ☒ Other: Family Members
- d. How are noise issues prevented and/or addressed? ☐ Security ☒ Manager approaches customer(s) ☐ Call Police
☒ Signs Posted ☐ Other: _____
- Will a sound amplification system be used? ☒ No ☐ Yes If yes, describe: _____
- e. Are there designated outdoor smoking areas? ☒ No ☐ Yes If yes, describe: _____
- f. Number of Garbage Cans: Inside: 2 Locations: 1 by check-out; 1 in rest room.
Outside: 2 Locations: Both on East Side - By front door entrance
- g. Is a crowd control barrier used? ☒ No ☐ Yes If yes, describe: _____
- h. Describe sanitation facilities (restrooms): 1 unisex restroom with toilet and sink - Northwest corner of premises across the room from entrance door.
- i. Name of solid waste contractor: ☐ Advanced Disposal ☒ Waste Management ☐ Other: _____

4. Parking & Security

- a. Are there off-street parking places? ☐ No ☒ Yes If yes, how many? Seven (7)

Describe security plan for parking lot: Security cameras

- b. Is there a loading zone? ☐ No ☒ Yes If yes, describe security for loading zone security cameras monitoring

- c. Will you have security personnel on premise? ☒ No ☐ Yes If yes, how many? _____

What are their responsibilities? _____

Is security equipment used? ☐ No ☒ Yes If yes, describe Security alarm with motion sensors.

List their licensing, certification, or training credentials N/A

Will there be security cameras? ☐ No ☒ Yes If yes, where? 10 inside ; 4 outside (1 on each side of building including parking area)

Will searches or identification checks be conducted upon entry? ☒ No ☐ Yes If yes, describe _____

5. Percentage of Sales (must total 100%)

Alcohol 50 %

Food 30 %

Secondhand Merchandise

N/A %

Precious Metals & Gems

N/A %

Entertainment N/A %

Cigarettes 20 %

Pawnbroker Activity N/A %

Salvaged Materials N/A %
(such as scrap metal)

Other N/A % Describe: _____

6. Businesses/Licenses on the Premises (check all that apply):

Type 1

- | | | | |
|--|---|---|--|
| <input type="checkbox"/> Full Service Restaurant | <input type="checkbox"/> Cafe/Coffee Shop | <input type="checkbox"/> Deli or Fast Food Restaurant | <input type="checkbox"/> Private/Fraternal/Veterans Club |
| <input type="checkbox"/> Night Club | <input type="checkbox"/> Tavern | <input type="checkbox"/> Cocktail Lounge | <input type="checkbox"/> Teen Club |
| <input type="checkbox"/> Bowling Alley | <input type="checkbox"/> Hotel | <input type="checkbox"/> Banquet Hall | <input type="checkbox"/> Sports Facility |

Type 2

- | | | | |
|--|---|---|---|
| <input checked="" type="checkbox"/> Liquor Store | <input type="checkbox"/> Corner Store | <input type="checkbox"/> Supermarket | <input checked="" type="checkbox"/> Convenience Store |
| <input type="checkbox"/> Gas Station | <input type="checkbox"/> Amusement/Phonograph Distributor | <input type="checkbox"/> Auto Wrecker | |
| <input type="checkbox"/> Used Car Dealer | <input type="checkbox"/> Used Auto Parts | <input type="checkbox"/> Personal Service Establishment | <input type="checkbox"/> Recording Studio |

What other types of licenses/permits will you hold at this location? (check all that apply)

- ☒ Occupancy Permit ☒ Cigarette & Tobacco ☐ Gas Station ☐ Extended Hours ☐ Class "B" Tavern ☐ Weights & Measures
☐ Secondhand Dealer ☐ Precious Metal & Gem ☐ Other: _____

7. Legal Capacity (only if a Type 1 premises in #6 above)

Capacity 10 (Call the Milwaukee Development Center at 414-286-8211 if you have questions.)

8. Premises Description

d. Identify all area(s) of the premises that will be used in operating this business (include areas used only for storage):

☒ 1st Floor ☐ 2nd Floor ☒ Basement Storage ☐ Patio ☐ Beer Garden ☐ Sidewalk Café ☐ Deck ☐ Rooftop

☐ Other: Describe: _____

e. Describe Location: ☒ Major Thoroughfare ☐ Secondary Street ☐ Other: _____

f. Nearest Major Cross Street: South 20th Street

g. Describe Building: ☒ Free Standing Building ☐ Strip Mall ☐ Other: _____

h. Describe Premises Structure: ☐ Single Story ☒ Multi-Story - # of Stories 2 ☐ Other: _____

i. Describe Surrounding Area: ☒ Commercial ☒ Residential ☐ Industrial ☐ Other: _____

j. Property Owner's Name: Nam Food and Beer Center LLC Phone Number: (414) 430-4243

Address: 7325 S. 38th Street, Franklin, WI 53132

9. Hours of Operation & Customers

Will customers be entering the premises? ☐ No ☒ Yes

Day of the Week	Proposed Hours of Operation:		Number of Customers expected each day	Potential Age Range of Customers	Class B Applicants: Age Restriction (If none, write 'None')
	Open (include a.m. or p.m.)	Close (include a.m. or p.m.)			
Sunday	9:00 a.m.	9:00 p.m.	50	21-80	
Monday	9:00 a.m.	9:00 p.m.	60	" "	
Tuesday	9:00 a.m.	9:00 p.m.	60	" "	
Wednesday	9:00 a.m.	9:00 p.m.	60	" "	
Thursday	9:00 a.m.	9:00 p.m.	60	" "	
Friday	9:00 a.m.	9:00 p.m.	60	" "	
Saturday	9:00 a.m.	9:00 p.m.	60	" "	

Entertainment Indoor Closing Hours - If alcohol beverage establishment, same as alcohol license hours.
If non-alcohol establishment 1:00 am Sunday to Thursday; 1:30 am Friday and Saturday.

Entertainment Outdoor Closing Hours - 10:00 pm Sunday - Thursday; 12:00 am Friday and Saturday,
unless otherwise approved by Common Council in licensee's plan of operation.

10. Required Signature(s)

L. Khunee Kun
Sole Proprietor, Partner, Agent, or 20% or more Shareholder

Signature of additional partner or 20% or more Shareholder

See Application Information for a list of all required application forms.



ALCOHOL BEVERAGE & PUBLIC ENTERTAINMENT PREMISES SUPPLEMENTAL PLAN OF OPERATION

Office of the City Clerk License Division

200 E. Wells St. Room 105, Milwaukee, WI 53202

(414) 286-2238 e-mail address: license@milwaukee.gov www.milwaukee.gov/licenseLegal Entity Name: NAM FOOD AND BEER CENTER LLCPremise Address: 1933 W. Windlake Ave., Milwaukee, WI 53215

Proximity of Premises to Church, School, Daycare Center or Hospital

Is there at least 300 feet between the building and any church, school, daycare center or hospital? ☒ Yes ☐ No

"Service Bar Only" Designation

If applying for Class B or C license, are you applying for "Service Bar Only"? ☐ No ☐ Yes

Service Bar Only means customers cannot sit at the bar. Alcohol is served to patrons seated at tables. No stools, chairs or other articles of furniture shall be placed at the service bar for patrons to sit upon.

Business Information

a) Are you taking out this application for anyone that may not be eligible for a license? ☒ No ☐ Yes

If yes, list name and address: _____

b) Will the agent, a partner or the individual licensee be conducting the day-to-day operations of the business? ☐ No ☒ Yes

If no, list the name and address of the person(s) who will: _____

Class B Applicants: If the agent, a partner or the individual licensee will not be conducting the day-to-day operations of the business, the person(s) listed above must obtain a Class B Managers license.

c) Does anyone else have money invested or any other interest in this business? ☒ No ☐ Yes

If yes, explain: _____

d) Have you made an agreement with anyone to repay any loan or any other payments based upon income from the business?

☒ No ☐ Yes If yes, list name and address: _____

Proof of Ownership, Lease, or Offer to Purchase (new & transfer applicants only)

Submit proof of ownership, lease, or offer to purchase the building with this application.

A lease or offer to purchase must:

- a) Be in the same legal entity name as that apply for the license
- b) Reflect the same address as the premises address on this application
- c) Reflect current dates and
- d) Be signed by the lessor/seller and lessee/buyer

Property Information (new & transfer applicants only)

a) Do you own or lease the building? ☒ Own ☐ Lease (see Offer to Purchase)b) Who owns the fixtures (for example, coolers, etc.)? My LLC (Nam Food and Beer Center LLC)c) Are you purchasing the stock and/or fixtures? ☒ No ☐ Yes If yes, amount paid \$ _____d) Total amount paid for business \$ 150,000.00 (Purchase is the building/real estatee) Total amount paid for goodwill of the business \$ -0- only - not the existing business)

Goodwill comprises the reputation and customer relationships of an existing business. If the price you pay for the business exceeds the fair market value of all of the rest of the assets of the business, the excess may be considered goodwill.

f) Have you made arrangements with the seller for payment of personal property taxes? ☐ No ☒ Yes

See Application Information for a list of all required application forms.

Lease Information (new & transfer applicants who are leasing the premises only)

- a) Date lease begins _____ Ends _____
- b) Monthly rental \$ _____
- c) Do you have an option to renew the lease? ☐ No ☐ Yes
- d) Does your lease allow for assignment to another party without the consent of the owner? ☐ No ☐ Yes
- e) For what length of time have you been guaranteed occupancy (number of years)? _____
- f) In addition to paying the monthly rental, will you have to pay anything additional to the owner of the building to guarantee performance of the lease? ☐ No ☐ Yes If yes, explain _____
- g) Does the present owner or occupancy object to the granting of your license? ☐ No ☐ Yes
If yes, explain _____

Change of Agent Applicants Only

Have there been any changes to the floor plan since the last application was submitted? ☐ No ☐ Yes

If no, a new floor plan is not required. If yes, submit a new floor plan and explain the change(s): _____

Notarized Signatures of Applicants

SUBSCRIBED AND SWORN TO BEFORE ME

This 27th day of April, 2015

Dan C. Banger
(Clerk/Notary Public)

My Commission Expires is permanent
*Notary Seal must be affixed.

Lothwinder Kim

Sole Proprietor, Partner, 20% or more Shareholder, or
Agent – only if there are no 20% or more shareholders

Additional partner or 20% or more shareholder

Note: All information contained in this application is subject to approval by the Common Council.

Deviating from approved plan of operation will subject licensee to citations, and/or suspension or non-renewal of the license.
Contact the License Division for information on how to request changes.

New and transfer of premise applicants must submit the following:

- ☒ Proof of ownership, lease or offer to purchase the building ☒ Detailed floor plan ☐ If a restaurant, copy of the menu

W. WINDLAKE AVENUE

SOUTH
20TH
STREET

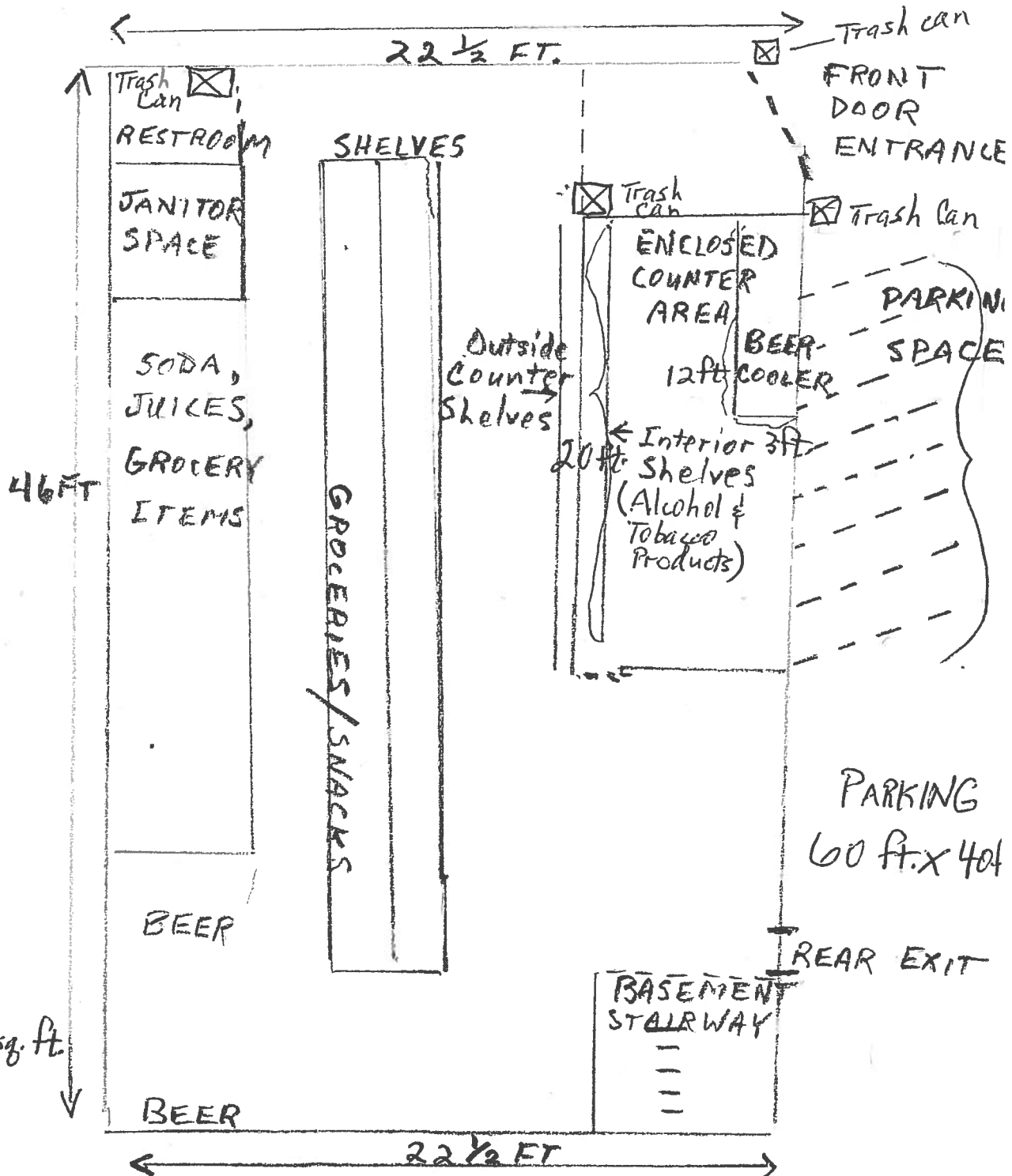

TOTAL SQUARE
FOOTAGE \approx 1,035 sq. ft.

Lakhwinder Kaur, Agent for Nam Food and Beer Center LLC
DBA "LUCKY'S"
1933 W. Windlake Avenue
Milwaukee, WI 53215
Telephone: (414) 430-4243
Date: April 28, 2015

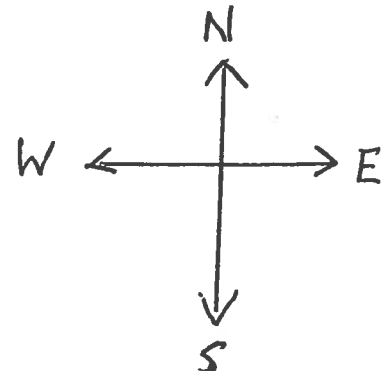

W. WINDLAKE AVENUE

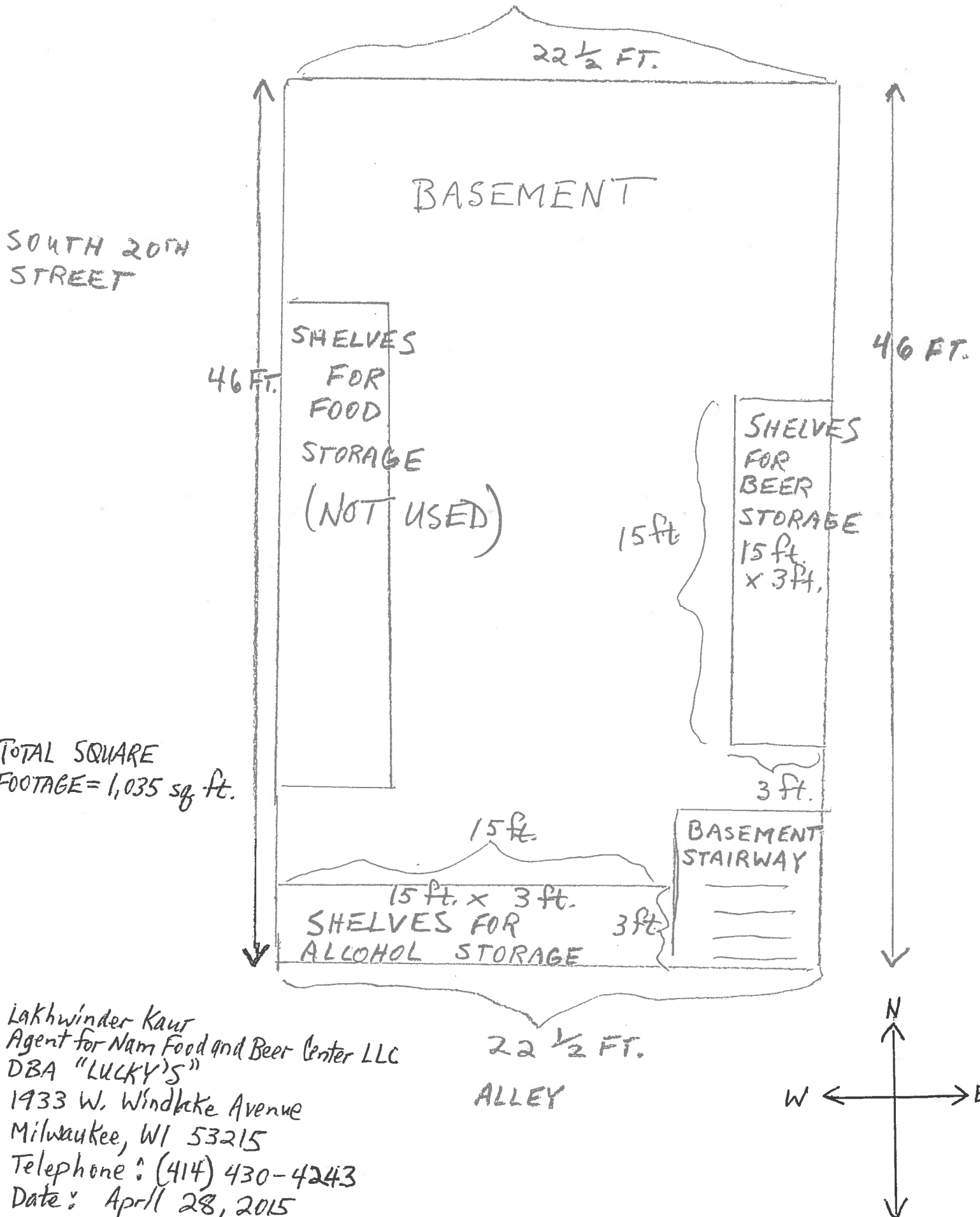

TOTAL SQUARE FOOTAGE = 1,035 sq. ft.

Lakhwinder Kaur
Agent for Nam Food and Beer Center LLC
DBA "LUCKY'S"
1933 W. Windlake Avenue
Milwaukee, WI 53215
Telephone: (414) 430-4243
Date: April 28, 2015



FOOD DEALER LICENSE PLAN OF OPERATION

OFFICE OF THE CITY CLERK, LICENSE DIVISION

CITY HALL, 200 E. WELLS ST, ROOM 105, MILWAUKEE, WI 53202 •

(414) 286-2238 • license@milwaukee.gov • www.milwaukee.gov/licenseLegal Entity Name: NAM FOOD AND BEER CENTER LLCPremises Address: 1933 W. Windlake Ave.

1. Application Type

Is this a new food business or are you taking over a food business which is currently operating?

☐ Taking over a currently operating, licensed food business☒ New business (includes taking over a closed food business)

Will you be sharing kitchen space with another food establishment?

☐ Yes, I intend to rent space in my kitchen to other food businesses☐ Yes, I am renting space from another food business which will also be using the kitchen*☐ No, I will be the only food business using the space(NO KITCHEN)

*If renting space in a commercial kitchen with another operator, a completed and signed Shared Kitchen Agreement is required.

The form is available at www.milwaukee.gov/license

Provide a brief description of the food establishment.

Convenience store (only pre-packaged food items)

Attach a copy of your menu or general listing of the types of food products that will be sold. Indicate what information you will be including:

☐ Menu☒ List of the types of products (for example: packaged foods, deli case, meat department)Packaged Foods.

What is the anticipated opening date or date of change of ownership:

7-01-15

2. Construction, Remodeling and Equipment

Are any construction, remodeling or equipment changes planned? ☒ Yes ☐ No If no, skip to section 3.

Scope of the planned project?

☒ New construction or conversion of an existing structure to be used as a food establishment☐ Renovation/remodeling of a food establishment, which may or may not include equipment changes☐ Renovation/remodeling limited to the installation/change/replacement of food equipment

Provide a brief summary of the proposed construction, remodeling and/or equipment change:

The premises are currently used for a tavern/bar. My plan is to "gut" the interior tavern premises and remodel to make the premises a nice convenience store/liquor store.

Note: Building permits may be required. Contact the City of Milwaukee Development Center.

Date alterations/changes planned to begin

6-01-15

Name, address and phone number of architect

None hired yet - I have an accepted offer to purchase that is contingent upon obtaining necessary licenses.

Name, address and phone number of general contractor

None hired yet.

3. Premises Description

Will food be prepared or sold at a single or multiple food preparation and/or sale sites (for example a hotel with multiple dining rooms or bars):

☒ Single ☐ Multiple

If multiple sites will be used, how many distinct sites will be used?

List all sites and briefly describe the nature of the food activities at each site:

Convenience store food items will be sold at the store's check-out counter.

Are any outdoor operations planned? ☐ Yes ☒ No

If yes, what activities will be conducted outdoors (check all that apply):

☐ Bar ☐ Cooking/Grilling ☐ Dining – Patio ☐ Dining – Sidewalk (DPW permit required) ☐ Storage

☐ Other, specify

Seating provided on site for dining? ☐ Yes ☒ No

If yes, are there additional banquet facilities other than the main dining area? ☐ Yes ☐ No

Total square footage of the establishment (exclude space utilized for other purposes other than food)

Number of Full Time Employees

Number of Part Time Employees

4. Business Type

Establishment Type (select the one that best describes the proposed business)

☐ **Bed and Breakfast**

☐ **Community Food Program** – free meal site or food pantry. Any site where all food is provided free of cost to those in need, or to organizations serving persons in need.

☐ **Distiller or Brewer** – facilities that are primarily engaged in the production of alcoholic beverages

☐ **Food Distributor** – a business that transports food for sale to retail and wholesale establishments and does not perform any food items

If distributor, is food stored on site? ☐ Yes ☐ No

☐ **Food Manufacturer** – commercial operation that produces, packages, labels, or stores food for human consumption, but primarily does not provide food directly to a consumer. Food is sold to distributors, retailers or restaurants. There may be a small store on site where only the manufacturers products are sold, but the majority of product is sold to other licensed food establishments.

If manufacturer, is there a retail store onsite? ☐ Yes ☐ No

☒ **Food Store** – a food establishment in which the majority of food sales consist of beverages or multi-serving food products requiring further preparation prior to consumption, examples of food stores include bakeries, grocery stores, convenience stores, coffee shops, liquor stores. Food stores include businesses whose primary business is other than food (book store, pharmacy, etc.), but offer convenience food items.

If Food store, are you considered a convenience food store (see definition below)? ☒ Yes ☐ No

A convenience food store contains less than 5,000 sq. ft. of retail sales space AND has as its primary business the sale of basic food items and in addition sells household products. Basic food items may include, but are not limited to, milk and dairy products, bread products, prepared sandwiches, frozen entrees, refrigerated food and baby food. Household products may include, but are not limited to, cleaning products, paper products, baby products and pet food

☐ **School** – educational institution including elementary, middle and high schools. Check type:

☐ **Satellite Kitchen** is a school kitchen with limited food preparation including reheating or holding of cooked food, storage of cold ready-to-eat food items and portioning and serving of bulk requiring no on-site preparation for service

☐ **Production Kitchen** is a school kitchen in which food preparation activities beyond reheating, portioning and hot and cold holding are performed

☐ **Restaurant** is a school kitchen operated by an outside entity or contractor, any school meal program not directly operated by the schools

☐ **Restaurant** – a food establishment in which the majority food sales consist of meals or other items ready for immediate consumption

☐ **Shared Kitchen, Commissary or Base** – a commercial kitchen used for the production of food to be served or sold at another location; a base of operations for a food peddler caterer or seasonal market vendor

☐ **Tavern** – a food establishment in which food sales are limited to beverages, primarily intoxicating beverages

4. Business Type (Continued)

Type of sales (check all that apply, even if it reflects a small percentage of the proposed business)

- ☒ Made directly to the general public or end consumer (includes internet sales)
☐ Made to other food establishments (wholesaler, distributors, retail or restaurants) who will resell your product(s)

What percentage of your planned food sales will be meals versus grocery items?

☐ % from meals (ready-to-eat food)

☒ 100% from grocery items (foods typically requiring preparation before serving, includes typical grocery items, beverages, bakery items and raw produce)

Will customers be able to purchase food through a drive through? ☐ Yes ☒ No

Will customers be able to purchase food from a self-service salad or food bar? ☐ Yes ☒ No

Will food be prepared on site and then transported for sale or consumption at another location? ☐ Yes ☒ No

If yes, check all the reasons why the food will be transported:

- ☐ Catering ☐ Delivery ☐ Base for Mobile Food Peddler ☐ Base for temporary or seasonal food stand

☐ Other-Describe:

5. ISSUANCE OF LICENSE

Will any alcohol or intoxicating beverages be sold at the establishment? ☒ Yes ☐ No

If yes, what type of license do you have or will you be applying for?

- ☐ Class A fermented malt beverage license ☒ Class A liquor license
☐ Class B fermented malt beverage licenses ☐ Class B liquor license
☐ Class C wine license

If yes, if your food license is approved prior to the alcohol license, when would you like the food license issued?

- ☐ immediately so you can open your food business ☒ at the same time as the alcohol license

6. AFFIRMATION OF UNDERSTANDING – PERMIT NEEDED TO OPERATE

Read and initial each item confirming your understanding:

LK

I understand that an inspection and sign off by the Health Department is required before my permit may be issued.

LK

I understand that the Health Department will review my application and will update the application based on what is observed during my onsite inspection. My representative onsite at the time of inspection must have the authority to approve corrections to my application.

LK

I understand that an occupancy permit must be issued and an inspection may be required from the Department of Neighborhood Services before my permit may be issued.

LK

I understand that the Department of Neighborhood Services must sign off on my application with the License Division before my permit may be issued.

LK

I understand the local council member must approve or deny my request before my permit is eligible to be issued. If denied, I understand that I may appeal and be scheduled for a hearing before the License Committee of the Common Council.

LK

I understand that the License Division must have proof of payment for the associated permit fees before my permit may be issued.

LK

I understand that all of the above must be complete before my permit is eligible to be issued.

LK

I understand that the license for which I am applying must be issued and posted in my business premises prior to opening for business.

I, LAKHWINDER KAUR, will not operate my food business, until the permit has been issued and posted in the establishment.
Name of Applicant

Signature of
Applicant:

Lakhwinder Kaur

Date:

04.28.15



**CITY OF MILWAUKEE
OFFICE OF THE CITY CLERK**

Monday, August 31, 2015

COMMITTEE MEETING NOTICE

AD 12

RANGSY, Bouaphat, Agent
WAT PATH LAO BUDDHIST TEMPLE CORP
1925 W NATIONAL Av

MILWAUKEE, WI 53204

You are requested to attend a hearing which is to be held in Room 301-B, Third Floor, City Hall on:

Tuesday, September 08, 2015 at 02:00 PM



Regarding: Your Class B Fermented Malt Beverage Retailer's and Public Entertainment Premises License Renewal Applications with Change of Agent as agent for "WAT PATH LAO BUDDHIST TEMPLE CORP" for "WAT PATHOUMMAPHOUTHARAM LAO BUDDHIST TEMPLE CORP" at 1925 W NATIONAL Av.

There is a possibility that your application may be denied for one or more of the following reasons: failure of the applicant to meet the statutory and municipal license qualifications; pending charges against or the conviction of any felony, misdemeanor, municipal offense or other offense, the circumstances of which substantially relate to the circumstances of the particular licensed activity, on behalf of the licensee, his or her employees, or patrons (if the licensee is a corporation or licensed limited partnership, the conviction of the corporate agent, officers, directors, members or any shareholder holding 20% or more of the corporation's total or voting stock, or proxies for that amount of stock, of any of the offenses enumerated in s. 125.12(2)(ag), Wis. Stats., as amended); the appropriateness of tavern location and premises; neighborhood problems due to management or location; failure of the licensee to operate the premise in accordance with the floor plan and plan of operation submitted pursuant to s. 90-5-1-c. of the Milwaukee Code of Ordinances; and any factors which reasonably relate to the public health, safety and welfare. See attached police report and/or written correspondence regarding this application. Please be advised the public will be able to provide information to the committee in person. The committee will receive and consider evidence regarding the above mentioned criteria.

**Notice for applicants with
warrants or unpaid fines:**

Proof of warrant satisfaction or payment of fines must be submitted at the hearing on the above date and time. Failure to comply with this requirement may result in a delay of the granting/denial of your application.

Failure to appear at this meeting may result in the denial of your license. Individual applicants must appear only in person or by an attorney. Corporate or Limited Liability applicants must appear only by the agent designated on the application or by an attorney. Partnership applicants must appear by a partner listed on the application or by an attorney. If you wish to do so and at your own expense, you may be accompanied by an attorney of your choosing to represent you at this hearing.

You will be given an opportunity to speak on behalf of the application and to respond and challenge any charges or reasons given for the denial. No petitions can be accepted by the committee, unless the people who signed the petition are present at the committee hearing and willing to testify. You may present witnesses under oath and you may also confront and cross-examine opposing witnesses under oath. If you have difficulty with the English language, you should bring an interpreter with you, at your expense, so that you can answer questions and participate in your hearing.

You may examine the application file at this office during regular business hours prior to the hearing date. Inquiries regarding this matter may be directed to the person whose signature appears below.

Limited parking for persons attending meetings in City Hall is available at reduced rates (5 hour limit) at the Milwaukee Center on the southwest corner of East Kilbourn and North Water Street. Parking tickets must be validated in the first floor information booth in City Hall.

PLEASE NOTE: Upon reasonable notice, efforts will be made to accommodate the needs of disabled individuals through sign language interpreters or other auxiliary aids. For additional information or to request this service, contact the Council Services Division ADA Coordinator at (414) 286-2998, Fax - (414) 286-3456, TDD - (414) 286-2025.

JIM OWCZARSKI, CITY CLERK

BY: _____

**Jason Schunk
License Division Manager**

If you have questions regarding this notice, please contact the License Division at (414) 286-2238.

200 E. Wells Street, Room 105, City Hall, Milwaukee, WI 53202. www.milwaukee.gov/license
Phone: (414) 286-2238 Fax: (414) 286-3057 Email Address: License@milwaukee.gov



**CITY OF MILWAUKEE
OFFICE OF THE CITY CLERK**

Monday, August 31, 2015

COMMITTEE MEETING NOTICE

AD 12

RANGSY, Bouaphat, Agent
WAT PATH LAO BUDDHIST TEMPLE CORP
1127 S 18th St

MILWAUKEE, WI 53204

You are requested to attend a hearing which is to be held in Room 301-8, Third Floor, City Hall on:

Tuesday, September 08, 2015 at 02:00 PM

Regarding: Your Class B Fermented Malt Beverage Retailer's and Public Entertainment Premises License Renewal Applications with Change of Agent as agent for "WAT PATH LAO BUDDHIST TEMPLE CORP" for "WAT PATHOUMMAPHOUTHARAM LAO BUDDHIST TEMPLE CORP" at 1925 W NATIONAL Av.

There is a possibility that your application may be denied for one or more of the following reasons: failure of the applicant to meet the statutory and municipal license qualifications; pending charges against or the conviction of any felony, misdemeanor, municipal offense or other offense, the circumstances of which substantially relate to the circumstances of the particular licensed activity, on behalf of the licensee, his or her employees, or patrons (if the licensee is a corporation or licensed limited partnership, the conviction of the corporate agent, officers, directors, members or any shareholder holding 20% or more of the corporation's total or voting stock, or proxies for that amount of stock, of any of the offenses enumerated in s. 125.12(2)(ag), Wis. Stats., as amended); the appropriateness of tavern location and premises; neighborhood problems due to management or location; failure of the licensee to operate the premise in accordance with the floor plan and plan of operation submitted pursuant to s. 90-5-1-c. of the Milwaukee Code of Ordinances; and any factors which reasonably relate to the public health, safety and welfare. See attached police report and/or written correspondence regarding this application. Please be advised the public will be able to provide information to the committee in person. The committee will receive and consider evidence regarding the above mentioned criteria.

**Notice for applicants with
warrants or unpaid fines:**

Proof of warrant satisfaction or payment of fines must be submitted at the hearing on the above date and time. Failure to comply with this requirement may result in a delay of the granting/denial of your application.

Failure to appear at this meeting may result in the denial of your license. Individual applicants must appear only in person or by an attorney. Corporate or Limited Liability applicants must appear only by the agent designated on the application or by an attorney. Partnership applicants must appear by a partner listed on the application or by an attorney. If you wish to do so and at your own expense, you may be accompanied by an attorney of your choosing to represent you at this hearing.

You will be given an opportunity to speak on behalf of the application and to respond and challenge any charges or reasons given for the denial. No petitions can be accepted by the committee, unless the people who signed the petition are present at the committee hearing and willing to testify. You may present witnesses under oath and you may also confront and cross-examine opposing witnesses under oath. If you have difficulty with the English language, you should bring an interpreter with you, at your expense, so that you can answer questions and participate in your hearing.

You may examine the application file at this office during regular business hours prior to the hearing date. Inquiries regarding this matter may be directed to the person whose signature appears below.

Limited parking for persons attending meetings in City Hall is available at reduced rates (5 hour limit) at the Milwaukee Center on the southwest corner of East Kilbourn and North Water Street. Parking tickets must be validated in the first floor information booth in City Hall.

PLEASE NOTE: Upon reasonable notice, efforts will be made to accommodate the needs of disabled individuals through sign language interpreters or other auxiliary aids. For additional information or to request this service, contact the Council Services Division ADA Coordinator at (414) 286-2998, Fax - (414) 286-3456, TDD - (414) 286-2025.

JIM OWCZARSKI, CITY CLERK

BY: _____

**Jason Schunk
License Division Manager**

If you have questions regarding this notice, please contact the License Division at (414) 286-2238.

200 E. Wells Street, Room 105, City Hall, Milwaukee, WI 53202. www.milwaukee.gov/license
Phone: (414) 286-2238 Fax: (414) 286-3057 Email Address: License@milwaukee.gov

MILWAUKEE POLICE DEPARTMENT

LICENSING

CRIMINAL RECORD/ORDINANCE VIOLATION/INCIDENTS SYNOPSIS

DATE: 08/12/2015
LICENSE TYPE: BMALT
NEW: ☐
RENEWAL: ☒

No. 214689
Application Date: 07/17/2015

License Location: 1925 West National Avenue
Business Name: Wat Path Lao Buddhist Temple

Licensee/Applicant: Rangsy, Bouaphat
(Last Name, First Name, MI)

Date of Birth: 12/29/1950

Home Address: 1127 South 18th Street
City: Milwaukee State: WI Zip Code: 53204
Home Phone: 414-803-7794

This report is written by Police Officer Gilbert Gwinn, assigned to the License Investigation Unit, Days.

The Milwaukee Police Department's investigation regarding this application revealed the following:

1. On 05/17/2015 the applicant was cited at 1925 West National Avenue in the city of Milwaukee for Disorderly Conduct.

Charge: Disorderly Conduct
Finding: Guilty
Sentence: \$195.00 fine
Date: 08/12/2015
Case: 15035359

MILWAUKEE POLICE DEPARTMENT
LICENSE INVESTIGATION UNIT

CRIMINAL RECORD/ORDINANCE VIOLATION/INCIDENTS
SYNOPSIS

DATE: 07/25/2014

LICENSE TYPE: BBEER

No. 190923

NEW:

Application Date: 07/24/2014

RENEWAL: X

Expiration Date:

License Location: 1925 W National Avenue

Aldermanic District: 12

Business Name: Wat Path Lao Buddhist Temple Corp

Licensee/Applicant: Thikey, Southp

(Last Name, First Name, MI)

Date of Birth: 02/01/54

Male:

Female:

Home Address: 3615 S 92nd Street

City: Milwaukee

State: Wi

Zip Code: 53228

Home Phone: (414) 543-2105

This report is written by Police Officer Gilbert Gwinn, assigned to the License Investigation Unit, Days.

The Milwaukee Police Department's investigation regarding this application revealed the following:

1. On 01/08/10 at 4:35 pm, Milwaukee police, per an aldermanic request, investigated the license status of Laos Buddhist Temple located at 1925 W National Avenue. The license was granted but not issued due to a hold that was placed from the Department of Revenue. Officers were advised that the temple was holding events without a valid liquor license. Officers followed up at 1925 W National Avenue and found the licensee was not on scene but spoke to one of the crew members who stated they were hosting a "Mexican party" that would start at 9 pm. This employee was able to contact the licensee Southp Thikey by phone who then spoke to officers. Thikey was advised the he was unable to host any events because he did not possess a valid license due to a hold by the Dept of Revenue. Thikey was also advised that police would follow up later that night to make sure there were no events going on. Police returned at 9:48 pm and noticed a handful of people and a band setting up. Southp Thikey was on scene and when officers asked what was going on, Thikey stated to officers that he renewed his license and that he was able to operate. It was again explained to Thikey about the Dept of Revenue hold and Thikey stated he misunderstood the officers and that he would shut down. Thikey was issued a warning but told that if any more events were held, citations would be issued.

=====

2. On 03/01/2015 Milwaukee police responded to a subject with a gun complaint at 1925 West National Avenue (Wat Path Lao Buddhist Temple). Investigation revealed an armed security guard pointed a firearm at the crowd during an event. Milwaukee police incident report #150600012 filed.
3. On 03/06/2015 Milwaukee police responded to 1925 West National Avenue (Lao Buddhist Temple) to issue citations. During this encounter, officers observed beer being sold and consumed during an event that included attendees both under and over the age of 21. Officers told the applicant he must either terminate the event, or stop selling beer. The applicant chose to stop selling beer.
4. On 06/09/2015 Milwaukee police met with the applicant at Milwaukee police district #2 to serve a notice of nuisance premises and to determine what actions had been taken to abate nuisance activity occurring at the location. The applicant told officers an abatement plan would be would be drafted and submitted.

Items #2, #3 and #4 added 07/20/2015 as part of previous premise.



Monday, August 31, 2015



Notice of Public Hearing

RANGSY, Bouaphat, Agent

WAT PATHOUMMAPHOUTHARAM LAO BUDDHIST TEMPLE CORP at 1925 W NATIONAL Av
Class B Fermented Malt Beverage Retailer's and Public Entertainment Premises License Renewal
Applications with Change of Agent

Tuesday, September 08, 2015 at 2:00 PM

To whom it may concern:

The above application has been made by the above named applicant(s). This requires approval from the Licenses Committee and the Common Council of the City of Milwaukee. The hearing before the Licenses Committee will take place on 9/8/2015 at 2:00 PM, in Room 301-B, Third Floor, City Hall. If you wish, you may provide testimony at the hearing regarding the request; see below for further information. You are not required to attend the hearing. Once the Licenses Committee makes its recommendation, this recommendation is forwarded to the full Common Council for approval at its next regularly scheduled hearing. Please review the information below and if you have further questions regarding this process, please contact the License Division at (414) 286-2238.

Important details for those wishing to provide information for the Licenses Committee to consider when making its recommendation:

1. The license application is scheduled to be heard at the above time. Due to other hearings running longer than scheduled, you may have to wait some time to provide your testimony.
2. You must appear in person and testify as to matters that you have personally experienced or seen. (You cannot provide testimony for your neighbor, parent or anyone else; this is considered hearsay and cannot be considered by the committee.)
3. No letters or petitions can be accepted by the committee (unless the person who wrote the letter or the persons who signed the petition are present at the committee hearing and willing to testify).
4. Persons opposed to the license application are given the opportunity to testify first; supporters may testify after the opponents have finished.
5. When you are called to testify, you will be sworn in and asked to give your name, and address. (If your first and/or last names are uncommon please spell them.)
6. You may then provide testimony.
 - a. Include only information relating to the above license application.
 - b. Include only information you have personally witnessed or seen.
 - c. Provide concise and relevant information detailing how this business has affected or may affect the peaceful enjoyment of your neighborhood.
 - d. If by the time you have the opportunity to testify, the information you wish to share has already been provided to the committee, you may state that you agree with the previous testimony. Redundant or repetitive testimony will not assist the committee in making its recommendation.
7. After giving your testimony, the members of the Licenses Committee and the licensee may ask questions regarding the testimony you have given or other factors relating to the license application.
8. Business Competition is not a valid basis for denial or non-renewal of a license.
Please Note: If you have submitted an objection to the above application your objection cannot be considered by the committee unless you personally testify at the hearing.

RESIDENT	MAIL ADDRESS	CITY AND ZIP CODE
CURRENT RESIDENT	2006 W NATIONAL AVE	MILWAUKEE, WI 53204-1157
CURRENT RESIDENT	2008 W NATIONAL AVE	MILWAUKEE, WI 53204-1157
CURRENT RESIDENT	2023 W NATIONAL AVE	MILWAUKEE, WI 53204-1158
CURRENT RESIDENT	2025 W NATIONAL AVE	MILWAUKEE, WI 53204-1158
CURRENT RESIDENT	737 S 20TH ST	MILWAUKEE, WI 53204-1142
CURRENT RESIDENT	737A S 20TH ST	MILWAUKEE, WI 53204-1142
CURRENT RESIDENT	739 S 20TH ST	MILWAUKEE, WI 53204-1142
CURRENT RESIDENT	739A S 20TH ST	MILWAUKEE, WI 53204-1142
CURRENT RESIDENT	816 S 21ST ST	MILWAUKEE, WI 53204-1149
CURRENT RESIDENT	816A S 21ST ST	MILWAUKEE, WI 53204-1149
CURRENT RESIDENT	818 S 20TH ST	MILWAUKEE, WI 53204-1143
CURRENT RESIDENT	819 S 20TH ST	MILWAUKEE, WI 53204-1144
CURRENT RESIDENT	819A S 20TH ST	MILWAUKEE, WI 53204-1144
CURRENT RESIDENT	820 S 20TH ST	MILWAUKEE, WI 53204-1143
CURRENT RESIDENT	820 S 21ST ST	MILWAUKEE, WI 53204-1149
CURRENT RESIDENT	820A S 21ST ST	MILWAUKEE, WI 53204-1149
CURRENT RESIDENT	820B S 21ST ST	MILWAUKEE, WI 53204-1149
CURRENT RESIDENT	821 S 19TH ST	MILWAUKEE, WI 53204-1166
CURRENT RESIDENT	821 S 20TH ST	MILWAUKEE, WI 53204-1144
CURRENT RESIDENT	821A S 20TH ST	MILWAUKEE, WI 53204-1144
CURRENT RESIDENT	822 S 19TH ST	MILWAUKEE, WI 53204-1165
CURRENT RESIDENT	822 S 20TH ST	MILWAUKEE, WI 53204-1143
CURRENT RESIDENT	824 S 20TH ST	MILWAUKEE, WI 53204-1143
CURRENT RESIDENT	824 S 21ST ST	MILWAUKEE, WI 53204-1149
CURRENT RESIDENT	825 S 20TH ST	MILWAUKEE, WI 53204-1144
CURRENT RESIDENT	826 S 21ST ST	MILWAUKEE, WI 53204-1149
CURRENT RESIDENT	827 S 18TH ST A	MILWAUKEE, WI 53204-4106
CURRENT RESIDENT	827 S 18TH ST B	MILWAUKEE, WI 53204-4106
CURRENT RESIDENT	827 S 18TH ST C	MILWAUKEE, WI 53204-4106
CURRENT RESIDENT	827 S 18TH ST D	MILWAUKEE, WI 53204-4106
CURRENT RESIDENT	828 S 20TH ST	MILWAUKEE, WI 53204-1143
CURRENT RESIDENT	828 S 21ST ST	MILWAUKEE, WI 53204-1149
CURRENT RESIDENT	829 S 19TH ST 1	MILWAUKEE, WI 53204-1100
CURRENT RESIDENT	829 S 19TH ST 2	MILWAUKEE, WI 53204-1100
CURRENT RESIDENT	829 S 19TH ST 3	MILWAUKEE, WI 53204-1100
CURRENT RESIDENT	829 S 19TH ST 4	MILWAUKEE, WI 53204-1100
CURRENT RESIDENT	829 S 19TH ST 5	MILWAUKEE, WI 53204-1100
CURRENT RESIDENT	829 S 19TH ST 6	MILWAUKEE, WI 53204-1100
CURRENT RESIDENT	829 S 20TH ST	MILWAUKEE, WI 53204-1144
CURRENT RESIDENT	830 S 20TH ST	MILWAUKEE, WI 53204-1143
CURRENT RESIDENT	833 S 18TH ST	MILWAUKEE, WI 53204-1126
CURRENT RESIDENT	834 S 19TH ST	MILWAUKEE, WI 53204-1165
CURRENT RESIDENT	835 S 18TH ST	MILWAUKEE, WI 53204-1126
CURRENT RESIDENT	836 S 19TH ST	MILWAUKEE, WI 53204-1165
CURRENT RESIDENT	900 S 20TH ST	MILWAUKEE, WI 53204-1145
CURRENT RESIDENT	902 S 19TH ST	MILWAUKEE, WI 53204-1167
CURRENT RESIDENT	903 S 20TH ST	MILWAUKEE, WI 53204-1146
CURRENT RESIDENT	904 S 19TH ST	MILWAUKEE, WI 53204-1167
CURRENT RESIDENT	906 S 19TH ST	MILWAUKEE, WI 53204-1167
CURRENT RESIDENT	906 S 20TH ST	MILWAUKEE, WI 53204-1145
CURRENT RESIDENT	907 S 19TH ST	MILWAUKEE, WI 53204-1168
CURRENT RESIDENT	907A S 19TH ST	MILWAUKEE, WI 53204-1168
CURRENT RESIDENT	908 S 19TH ST	MILWAUKEE, WI 53204-1167
CURRENT RESIDENT	909 S 20TH ST	MILWAUKEE, WI 53204-1146
CURRENT RESIDENT	910 S 20TH ST	MILWAUKEE, WI 53204-1145

CURRENT RESIDENT	912 S 19TH ST	MILWAUKEE, WI 53204-1167
CURRENT RESIDENT	913 S 19TH ST	MILWAUKEE, WI 53204-1168
CURRENT RESIDENT	914 S 20TH ST	MILWAUKEE, WI 53204-1145
CURRENT RESIDENT	915 S 20TH ST	MILWAUKEE, WI 53204-1146
CURRENT RESIDENT	917 S 19TH ST A	MILWAUKEE, WI 53204-1168
CURRENT RESIDENT	917 S 19TH ST B	MILWAUKEE, WI 53204-1168
CURRENT RESIDENT	917 S 19TH ST C	MILWAUKEE, WI 53204-1168
CURRENT RESIDENT	917 S 19TH ST D	MILWAUKEE, WI 53204-1168
CURRENT RESIDENT	921 S 19TH ST 1	MILWAUKEE, WI 53204-1168
CURRENT RESIDENT	921 S 19TH ST 2	MILWAUKEE, WI 53204-1168
CURRENT RESIDENT	921 S 19TH ST 3	MILWAUKEE, WI 53204-1168
CURRENT RESIDENT	921 S 19TH ST 4	MILWAUKEE, WI 53204-1168

Total Records: 68

Radius: 250.0 feet and Center of Circle: 1925 W National AV

2015-2016 Plan of Operation for 1925 W NATIONAL AV**1. Litter and Noise**How are the grounds kept clean? ☐ Sweep ☐ Pressure Wash ☒ Pick Up Litter ☐ Other: _____How often will grounds be cleaned? ☐ Daily ☒ Weekly ☐ Other: _____Grounds Cleaned By: ☐ Licensee ☒ Building Owner ☐ Employees ☐ Hired Maintenance ☐ Other: _____How are noise issues prevented and/or addressed? ☐ Security ☐ Manager approaches customer(s) ☐ Call Police
☒ Signs Posted ☐ Other: _____**2. Smoking and Sanitation**Are there designated outdoor smoking areas? ☐ No ☒ YesIf yes, describe the area(s) and provide location(s): outdoorNumber of Garbage Cans: Inside: 5 Locations: bar, hall
Outside: 1 Locations: frontIs a Crowd Control Barrier used? ☒ No ☐ Yes If yes, describe: _____Describe sanitation facilities (restrooms): 2 stallsProvide name of solid waste contractor: Waste**3. Security**Are there parking spaces on the premises? ☐ No ☒ Yes If yes, number of spaces: 4 and describe security provisions:Beside of the BuildingAre there designated loading areas? ☒ No ☐ Yes If yes, describe security provisions _____Do you have security personnel on the premise? ☒ No ☐ Yes If yes, how many? 2

AND What are their responsibilities? _____

What security equipment do they use? _____

List their licensing, certification or training credentials: _____

Are there security cameras? ☐ No ☒ Yes If yes, list all locations: inside building, parking lotAre searches and/or identification checks conducted upon entry? ☐ No ☒ Yes If yes, describe: when party starting**4. Percentage of Sales (must total 100%)**Alcohol 100 % Food Sales _____ % Entertainment _____ % Other _____ %**5. Businesses On The Premise (choose all that apply):**

- | | | | |
|--|---|--|---|
| <input type="checkbox"/> Full Service Restaurant | <input type="checkbox"/> Cafe/Coffee Shop | <input type="checkbox"/> Deli or Fast Food Rest. | <input type="checkbox"/> Private/Fraternal/Veterans' Club |
| <input type="checkbox"/> Night Club | <input type="checkbox"/> Tavern | <input type="checkbox"/> Cocktail Lounge | <input type="checkbox"/> Teen Club |
| <input type="checkbox"/> Bowling Alley | <input type="checkbox"/> Hotel | <input checked="" type="checkbox"/> Banquet Hall | <input type="checkbox"/> Sports Facility |
| <input type="checkbox"/> Liquor Store | <input type="checkbox"/> Corner Store | <input type="checkbox"/> Supermarket | <input type="checkbox"/> Convenience Store |
| <input type="checkbox"/> Gas Station | <input type="checkbox"/> Other _____ | | |

6. Hours of Operation and Age RestrictionAre there any changes to the current hours of operation or age restriction? ☒ No ☐ Yes If yes, describe _____**Please Note: If you will be open earlier or later than the hours listed on your current license for even one event or holiday (for example, St. Patrick's Day, Brewers Opening Day, etc.) during the license period, this must be reported and printed on your license.**

Your hours of operation and age restriction are listed on your current license.

7. Floor PlanAre there any changes to the current floor plan? ☒ No ☐ Yes If yes, describe _____

AND submit a new floor plan with this application. Changes in floor plan include changing the location of tables, games, etc. within your current licensed premises. If your changes include adding any additional areas or square footage to your premises, or any renovations to the building will be done, a Permanent Extension of Premises application must be filed.

(1) CURRENT ENTERTAINMENT

The following types of entertainment have been approved for your current Public Entertainment Premises license:

Bands, Patrons Dancing

(2) SELECT ANY TYPES OF ENTERTAINMENT THAT YOU ARE REQUESTING TO ADD *No changes in entertainment shall take place until approved by the Common Council and a new license has been issued and posted on the premises.

<input type="checkbox"/> Instrumental Musicians	<input type="checkbox"/> Bands	<input type="checkbox"/> Battle of the Bands	<input type="checkbox"/> Comedy Acts
<input type="checkbox"/> Disc Jockey	<input type="checkbox"/> Magic Shows	<input type="checkbox"/> Poetry Readings	<input type="checkbox"/> Dancing by Performers
<input type="checkbox"/> Jukebox	<input type="checkbox"/> Wrestling	<input type="checkbox"/> Patron Contests	<input type="checkbox"/> Patrons Dancing
<input type="checkbox"/> Adult Entertainment/ Strippers/Erotic Dance	<input type="checkbox"/> Karaoke	<input type="checkbox"/> Bowling Alley	<input type="checkbox"/> Pool Tables
<input type="checkbox"/> Motion Pictures	<input type="checkbox"/> Amusement Machines –	<input type="checkbox"/> Concerts	<input type="checkbox"/> Theatrical Performances
How many screens? _____	How many? _____	Approx. # per year? _____	Approx. # per year? _____
<input type="checkbox"/> Other: _____			

(3) REMOVE ENTERTAINMENT

If applicable, list any entertainment you wish to remove: _____

(4) WILL PROMOTERS EVER BE USED FOR ANY OF THE ENTERTAINMENT?

☒ No ☐ Yes, describe: _____

(5) LEGAL CAPACITY OF PREMISES

_____ (Call the Milwaukee Development Center at 414-286-8211 if you have questions.) Your legal capacity will determine the license fee for your Public Entertainment Premise License. If you would like to request that the license be approved with a lower capacity than that listed above, indicate lower capacity _____. If approved, this lower capacity will print on your license and override the capacity listed on your Occupancy Permit.

(6) IDENTIFY IF SOUND AMPLIFICATION IS USED

☒ No ☐ Yes, describe: _____

(7) DECLARATIONS, ACKNOWLEDGEMENTS, & DISCLOSURES

Read And Initial Each Item Confirming Your Understanding:

- 1 ☒ I understand that after the license has been issued, a change to the plan of operation will require a written request to change and approval from the Common Council.
- 2 ☒ I agree to inform the City Clerk within 10 days of any substantial changes in the information supplied in this application.
- 3 ☒ I understand that I shall not willfully refuse to provide the services offered under this license, or add charges or require deposits not required of the general public because of race, color, sex, religion, national origin or ancestry, age, handicap, lawful source of income, marital status, sexual orientation, gender identity or expression, familial status or the fact that a person is now or has been a member of the military service, whether dressed in uniform or not; and shall not seek such information as a condition of employment, or penalize any employee or discriminate in the selection of personnel for training or promotion on the basis of such information.
- 4 ☒ I have knowledge of the City Ordinances currently regulating public entertainment, and understand that the license may be subject to suspension, non-renewal or revocation, if I violate any rule, law or regulation of the city of Milwaukee and State of Wisconsin.

(8) NOTARIZED SIGNATURES OF APPLICANTS

SUBSCRIBED AND SWORN TO BEFORE ME

This 17 day of July 2018

(Clerk/Notary Public)

My Commission Expires 9/21/18

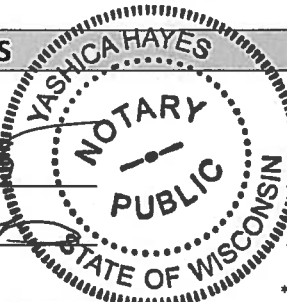

Bouaphat Rangny
Agent/Owner/Partner

Additional Owner/Partner

*Notary Seal must be affixed.



CITY OF MILWAUKEE
OFFICE OF THE CITY CLERK

Monday, August 31, 2015

COMMITTEE MEETING NOTICE

AD 12

GUDIEL, Byron F, Agent
Siervito Properties LLC
2200 S 12TH St

Milwaukee, WI 53215

You are requested to attend a hearing which is to be held in City Hall, Room 301-B on:

Tuesday, September 08, 2015 at 02:00 PM

Regarding: Your Class B Tavern and Public Entertainment License Renewal Applications as agent for "Siervito Properties LLC" for "La Casa Vieja" at 1629 S 10th St.

There is a possibility that your application may be denied for one or more of the following reasons: The recommendation of the committee regarding the application shall be based on evidence presented at the hearing. Per MCO 85-4-4, unless otherwise specified in the code, probative evidence concerning non-renewal, suspension or revocation may include evidence of the following: failure of the applicant to meet municipal qualifications, pending charges against or the conviction of any felony, misdemeanor, municipal offense or other offense, the circumstances of which substantially relate to the circumstances of the particular licensed or permitted activity, by the applicant or by any employee or other agent of the applicant. If the activities of the applicant involve a licensed premises, whether the premises tends to facilitate a public or private nuisance or has been the source of congregations of persons which have resulted in any of the following: disturbance of the peace; illegal drug activity; public drunkenness; drinking in public; harassment of passers-by; gambling; prostitution; sale of stolen goods; public urination; theft; assaults; battery; acts of vandalism including graffiti, excessive littering, loitering, illegal parking, loud noise at times when the licensed premise is open for business; traffic violations; curfew violations; lewd conduct; display of materials harmful to minors, pursuant to s. 106-9.6; or any other factor which reasonably relates to the public health, safety and welfare, or failure to comply with the approved plan of operation. See attached police report or correspondence.

Notice for applicants with warrants or unpaid fines:

Proof of warrant satisfaction or payment of fines must be submitted at the hearing on the above date and time. Failure to comply with this requirement may result in a delay of the granting/denial of your application.

Failure to appear at this meeting may result in the denial of your license. Individual applicants must appear only in person or by an attorney. Corporate or Limited Liability applicants must appear only by the agent designated on the application or by an attorney. Partnership applicants must appear by a partner listed on the application or by an attorney. If you wish to do so and at your own expense, you may be accompanied by an attorney of your choosing to represent you at this hearing.

You will be given an opportunity to speak on behalf of the application and to respond and challenge any charges or reasons given for the denial. No petitions can be accepted by the committee, unless the people who signed the petition are present at the committee hearing and willing to testify. You may present witnesses under oath and you may also confront and cross-examine opposing witnesses under oath. If you have difficulty with the English language, you should bring an interpreter with you, at your expense, so that you can answer questions and participate in your hearing.

You may examine the application file at this office during regular business hours prior to the hearing date. Inquiries regarding this matter may be directed to the person whose signature appears below.

Limited parking for persons attending meetings in City Hall is available at reduced rates (5 hour limit) at the Milwaukee Center on the southwest corner of East Kilbourn and North Water Street. Parking tickets must be validated in the first floor information booth in City Hall.

PLEASE NOTE: Upon reasonable notice, efforts will be made to accommodate the needs of disabled individuals through sign language interpreters or other auxiliary aids. For additional information or to request this service, contact the Council Services Division ADA Coordinator at (414) 286-2998, Fax - (414) 286-3456, TDD - (414) 286-2025.

JIM OWCZARSKI, CITY CLERK

BY: _____

Jason Schunk
License Division Manager

If you have questions regarding this notice, please contact the License Division at (414) 286-2238.

200 E. Wells Street, Room 105, City Hall, Milwaukee, WI 53202. www.milwaukee.gov/license
Phone: (414) 286-2238 Fax: (414) 286-3057 Email Address: License@milwaukee.gov

MILWAUKEE POLICE DEPARTMENT

LICENSING

CRIMINAL RECORD/ORDINANCE VIOLATION/INCIDENTS SYNOPSIS

DATE: 05/25/2015**LICENSE TYPE:** Class B Tavern**NEW:** ☐**RENEWAL:** ☒**No.** 211467**Application Date:** 05/21/2015**License Location:** 1629 S. 10th Street**Business Name:** La Casa Vieja**Licensee/Applicant:** Gudiel, Byron F.
(Last Name, First Name, MI)**Date of Birth:** 08/09/1970**Home Address:** 2200 South 12th Street**City:** Milwaukee**State:** WI **Zip Code:** 53215**Home Phone:** (414) 517-1318

This report is written by Police Officer David Novak, assigned to the License Investigation Unit, Days.

The Milwaukee Police Department's investigation regarding this application revealed the following:

1. On 03/31/2008 the Wisconsin Department of Transportation revoked the applicant's driver's license for 6 months for Operating While Intoxicated.
=====
2. On 03/19/13 at 1:10 pm, Byron Gudiel met with Milwaukee police to discuss complaints of shots fired and public drinking which were associated with the bar located at 1029 S 10th Street. Gudiel assured police that he stays on the premise until after bar closing and has never witnessed any patron or security guard discharge a firearm in the immediate area. Gudiel did express concern with public drinking and stated that he is in the process of installing security cameras on the exterior and interior of this tavern and will have his security monitor the parking lot during his business hours.
=====
3. On 03/23/2014 Milwaukee police responded to a Battery complaint at 3979 South 51st Street. Investigation revealed the victim had been at Casa Vieja (1629 South 10th Street) on 03/22/2014. As he was exiting the bar, he and a young Hispanic male sitting in an auto exchanged nods. The male exited his auto and punched the victim, causing him to lose consciousness. When he regained consciousness, he was on the ground and people were kicking him. The victim went to the hospital on 03/23/2014 where he was treated for numerous injuries. Milwaukee police incident report #140820078 filed.
4. On 05/05/2014 Milwaukee police responded to a Shots Fired complaint at 1629 South 10th Street (La Casa Vieja). The bar manager, Gustavo Brenes-Ortiz, told police that several

regular patrons of the business did not want to leave when the bar closed for the night at 2:00am. These patrons were escorted out by security, but returned to the business with baseball bats around 3:35am and smashed the business's windows. Around this time, Brenes-Ortiz heard gunshots and glass shattering and ran into the basement while calling police. Milwaukee police incident report #141250023 filed.

=====

5. On 09/02/2014 officers met with the applicant at LA Casa Vieja, 1629 S 10th St, to discuss the recent Nuisance Premises letter. The applicant provided a list of changes that have or will be instituted. The applicant has hired a new manager and more security guards, installed more cameras, posted a "No Drinking" sign outside the business, put in place a new dress code, requires ID for entrance, will stagger the let out of patrons, will retrain the employees and raise the age to 25.
6. On 10/11/2014 at 12:04am officers went to La Casa Vieja, 1629 S 10th St for a tavern check. There were no violations observed.
7. On 12/18/2014 at 12:25am officers responded to La Casa Vieja, 1629 S 10th St, for a child neglect complaint. Officers spoke with the manager Samuel RODRIGUEZ, who was the caller. He stated that a patron came into the bar at about 10:21pm and ordered drinks. At 10:42pm RODRIGUEZ was notified that the patron had left his kids in the car while he was inside drinking. RODRIGUEZ went to the car and found the kids. He brought them in from the cold and called the police. RODRIGUEZ was very cooperative and provided video of the incident. Milwaukee Police Department report #143520159 filed.



Monday, August 31, 2015



Notice of Public Hearing

GUDIEL, Byron F, Agent
La Casa Vieja at 1629 S 10th St
Class B Tavern and Public Entertainment License Renewal Applications

Tuesday, September 08, 2015 at 2:00 PM

To whom it may concern:

The above application has been made by the above named applicant(s). This requires approval from the Licenses Committee and the Common Council of the City of Milwaukee. The hearing before the Licenses Committee will take place on 9/8/2015 at 2:00 PM, in City Hall, Room 301-B. If you wish, you may provide testimony at the hearing regarding the request; see below for further information. You are not required to attend the hearing. Once the Licenses Committee makes its recommendation, this recommendation is forwarded to the full Common Council for approval at its next regularly scheduled hearing. Please review the information below and if you have further questions regarding this process, please contact the License Division at (414) 286-2238.

Important details for those wishing to provide information for the Licenses Committee to consider when making its recommendation:

1. The license application is scheduled to be heard at the above time. Due to other hearings running longer than scheduled, you may have to wait some time to provide your testimony.
2. You must appear in person and testify as to matters that you have personally experienced or seen. (You cannot provide testimony for your neighbor, parent or anyone else; this is considered hearsay and cannot be considered by the committee.)
3. No letters or petitions can be accepted by the committee (unless the person who wrote the letter or the persons who signed the petition are present at the committee hearing and willing to testify).
4. Persons opposed to the license application are given the opportunity to testify first; supporters may testify after the opponents have finished.
5. When you are called to testify, you will be sworn in and asked to give your name, and address. (If your first and/or last names are uncommon please spell them.)
6. You may then provide testimony.
 - a. Include only information relating to the above license application.
 - b. Include only information you have personally witnessed or seen.
 - c. Provide concise and relevant information detailing how this business has affected or may affect the peaceful enjoyment of your neighborhood.
 - d. If by the time you have the opportunity to testify, the information you wish to share has already been provided to the committee, you may state that you agree with the previous testimony. Redundant or repetitive testimony will not assist the committee in making its recommendation.
7. After giving your testimony, the members of the Licenses Committee and the licensee may ask questions regarding the testimony you have given or other factors relating to the license application.
8. Business Competition is not a valid basis for denial or non-renewal of a license.
Please Note: If you have submitted an objection to the above application your objection cannot be considered by the committee unless you personally testify at the hearing.

[illegible]

[illegible]

CURRENT RESIDENT	921 W LAPHAM BLVD 304	MILWAUKEE, WI 53204-3434
CURRENT RESIDENT	921 W LAPHAM BLVD 305	MILWAUKEE, WI 53204-3434
CURRENT RESIDENT	921 W LAPHAM BLVD 306	MILWAUKEE, WI 53204-3434
CURRENT RESIDENT	921 W LAPHAM BLVD 307	MILWAUKEE, WI 53204-3434
CURRENT RESIDENT	921 W LAPHAM BLVD 308	MILWAUKEE, WI 53204-3434
CURRENT RESIDENT	921 W LAPHAM BLVD 309	MILWAUKEE, WI 53204-3434
CURRENT RESIDENT	921 W LAPHAM BLVD 310	MILWAUKEE, WI 53204-3434
CURRENT RESIDENT	921 W LAPHAM BLVD 311	MILWAUKEE, WI 53204-3434
CURRENT RESIDENT	921 W LAPHAM BLVD 312	MILWAUKEE, WI 53204-3434
CURRENT RESIDENT	921 W LAPHAM BLVD 313	MILWAUKEE, WI 53204-3434
CURRENT RESIDENT	921 W LAPHAM BLVD 314	MILWAUKEE, WI 53204-3434
CURRENT RESIDENT	921 W LAPHAM BLVD 315	MILWAUKEE, WI 53204-3434
CURRENT RESIDENT	921 W LAPHAM BLVD 316	MILWAUKEE, WI 53204-3434
CURRENT RESIDENT	921 W LAPHAM BLVD 317	MILWAUKEE, WI 53204-3434
CURRENT RESIDENT	921 W LAPHAM BLVD 318	MILWAUKEE, WI 53204-3434
CURRENT RESIDENT	921 W LAPHAM BLVD 319	MILWAUKEE, WI 53204-3434
CURRENT RESIDENT	921 W LAPHAM BLVD 320	MILWAUKEE, WI 53204-3434
CURRENT RESIDENT	921 W LAPHAM BLVD 321	MILWAUKEE, WI 53204-3434
CURRENT RESIDENT	921 W LAPHAM BLVD 322	MILWAUKEE, WI 53204-3434
CURRENT RESIDENT	921 W LAPHAM BLVD 323	MILWAUKEE, WI 53204-3434
CURRENT RESIDENT	921 W LAPHAM BLVD 324	MILWAUKEE, WI 53204-3434
CURRENT RESIDENT	921 W LAPHAM BLVD 325	MILWAUKEE, WI 53204-3434
CURRENT RESIDENT	921 W LAPHAM BLVD 326	MILWAUKEE, WI 53204-3434
CURRENT RESIDENT	921 W LAPHAM BLVD 4	MILWAUKEE, WI 53204-3434
CURRENT RESIDENT	921 W LAPHAM BLVD 5	MILWAUKEE, WI 53204-3434
CURRENT RESIDENT	921 W LAPHAM BLVD 6	MILWAUKEE, WI 53204-3434
CURRENT RESIDENT	921 W LAPHAM BLVD 7	MILWAUKEE, WI 53204-3434
CURRENT RESIDENT	921 W LAPHAM BLVD 8	MILWAUKEE, WI 53204-3434
CURRENT RESIDENT	921 W LAPHAM BLVD 9	MILWAUKEE, WI 53204-3434

Total Records: 197

Radius: 250.0 feet and Center of Circle: 1629 S 10th ST

2015-2016 Plan of Operation for 1629 S 10TH ST

1. Litter and Noise

How are the grounds kept clean? ☒ Sweep ☐ Pressure Wash ☒ Pick Up Litter ☐ Other: _____

How often will grounds be cleaned? ☒ Daily ☒ Weekly ☐ Other: _____

Grounds Cleaned By: ☒ Licensee ☒ Building Owner ☒ Employees ☐ Hired Maintenance ☐ Other: _____

How are noise issues prevented and/or addressed? ☒ Security ☒ Manager approaches customer(s) ☐ Call Police
☒ Signs Posted ☐ Other: _____

2. Smoking and Sanitation

Are there designated outdoor smoking areas? ☐ No ☒ Yes

If yes, describe the area(s) and provide location(s): Outside Porch

Number of Garbage Cans: Inside: 9 Locations: Bar, Bathrooms, Common Area
 Outside: 2 Locations: Rear of Building

Is a Crowd Control Barrier used? ☐ No ☒ Yes If yes, describe: Count Entry #

Describe sanitation facilities (restrooms): Clean Daily

Provide name of solid waste contractor: Waste Management

3. Security

Are there parking spaces on the premises? ☐ No ☒ Yes If yes, number of spaces: 6 and describe security provisions:
Cameras

Are there designated loading areas? ☒ No ☐ Yes If yes, describe security provisions _____

Do you have security personnel on the premise? ☐ No ☒ Yes If yes, how many? 4

AND What are their responsibilities? Control # of Customers to Enter check ID, Control over any problems

What security equipment do they use? Fire Alarm, Metal Detector, Spray Pepper

List their licensing, certification or training credentials: WA Security License

Are there security cameras? ☐ No ☒ Yes If yes, list all locations: Inside + Outside

Are searches and/or identification checks conducted upon entry? ☐ No ☒ Yes If yes, describe: Check ID For Identification and age Verification

4. Percentage of Sales (must total 100%)

Alcohol 90 % Food Sales _____ % Entertainment 10 % Other _____ %

5. Businesses On The Premise (choose all that apply):

- | | | | |
|--|--|---|---|
| <input type="checkbox"/> Full Service Restaurant | <input type="checkbox"/> Cafe/Coffee Shop | <input type="checkbox"/> Deli or Fast Food Rest. | <input type="checkbox"/> Private/Fraternal/Veterans' Club |
| <input checked="" type="checkbox"/> Night Club | <input checked="" type="checkbox"/> Tavern | <input checked="" type="checkbox"/> Cocktail Lounge | <input type="checkbox"/> Teen Club |
| <input type="checkbox"/> Bowling Alley | <input type="checkbox"/> Hotel | <input type="checkbox"/> Banquet Hall | <input type="checkbox"/> Sports Facility |
| <input type="checkbox"/> Liquor Store | <input type="checkbox"/> Corner Store | <input type="checkbox"/> Supermarket | <input type="checkbox"/> Convenience Store |
| <input type="checkbox"/> Gas Station | <input type="checkbox"/> Other _____ | | |

6. Hours of Operation and Age Restriction

Are there any changes to the current hours of operation or age restriction? ☒ No ☐ Yes If yes, describe _____

Please Note: If you will be open earlier or later than the hours listed on your current license for even one event or holiday (for example, St. Patrick's Day, Brewers Opening Day, etc.) during the license period, this must be reported and printed on your license.

Your hours of operation and age restriction are listed on your current license.

7. Floor Plan

Are there any changes to the current floor plan? ☒ No ☐ Yes If yes, describe _____

AND submit a new floor plan with this application. Changes in floor plan include changing the location of tables, games, etc. within your current licensed premises. If your changes include adding any additional areas or square footage to your premises, or any renovations to the building will be done, a Permanent Extension of Premises application must be filed.

PUBLIC ENTERTAINMENT PREMISES RENEWAL SUPPLEMENTARY APPLICATION

CCL-PEP3 2/18/15

(1) CURRENT ENTERTAINMENT

The following types of entertainment have been approved for your current Public Entertainment Premises license:

Instrumental Musicians, Disc Jockey, Bands, Karaoke, Patrons Dancing, Jukebox, 2 Pool Tables

(2) SELECT ANY TYPES OF ENTERTAINMENT THAT YOU ARE REQUESTING TO ADD *No changes in entertainment shall take place until approved by the Common Council and a new license has been issued and posted on the premises.

<input checked="" type="checkbox"/> Instrumental Musicians	<input checked="" type="checkbox"/> Bands	<input type="checkbox"/> Battle of the Bands	<input type="checkbox"/> Comedy Acts
<input checked="" type="checkbox"/> Disc Jockey	<input type="checkbox"/> Magic Shows	<input type="checkbox"/> Poetry Readings	<input checked="" type="checkbox"/> Dancing by Performers
<input checked="" type="checkbox"/> Jukebox	<input type="checkbox"/> Wrestling	<input type="checkbox"/> Patron Contests	<input checked="" type="checkbox"/> Patrons Dancing
<input type="checkbox"/> Adult Entertainment/ Strippers/Erotic Dance	<input checked="" type="checkbox"/> Karaoke	<input type="checkbox"/> Bowling Alley	<input checked="" type="checkbox"/> Pool Tables
<input type="checkbox"/> Motion Pictures	<input type="checkbox"/> Amusement Machines -	<input type="checkbox"/> Concerts	<input type="checkbox"/> Theatrical Performances
How many screens? _____	How many? _____	Approx. # per year? _____	Approx. # per year? <u>2</u>
<input type="checkbox"/> Other: _____			

(3) REMOVE ENTERTAINMENT

If applicable, list any entertainment you wish to remove: _____

(4) WILL PROMOTERS EVER BE USED FOR ANY OF THE ENTERTAINMENT?☒ No ☐ Yes, describe: _____**(5) LEGAL CAPACITY OF PREMISES**

150 (Call the Milwaukee Development Center at 414-286-8211 if you have questions.) Your legal capacity will determine the license fee for your Public Entertainment Premise License. If you would like to request that the license be approved with a lower capacity than that listed above, indicate lower capacity _____. If approved, this lower capacity will print on your license and override the capacity listed on your Occupancy Permit.

(6) IDENTIFY IF SOUND AMPLIFICATION IS USED☒ No ☐ Yes, describe: _____**(7) DECLARATIONS, ACKNOWLEDGEMENTS, & DISCLOSURES**

Read And Initial Each Item Confirming Your Understanding:

- BE I understand that after the license has been issued, a change to the plan of operation will require a written request to change and approval from the Common Council.
- BE I agree to inform the City Clerk within 10 days of any substantial changes in the information supplied in this application.
- BE I understand that I shall not willfully refuse to provide the services offered under this license, or add charges or require deposits not required of the general public because of race, color, sex, religion, national origin or ancestry, age, handicap, lawful source of income, marital status, sexual orientation, gender identity or expression, familial status or the fact that a person is now or has been a member of the military service, whether dressed in uniform or not; and shall not seek such information as a condition of employment, or penalize any employee or discriminate in the selection of personnel for training or promotion on the basis of such information.
- BE I have knowledge of the City Ordinances currently regulating public entertainment, and understand that the license may be subject to suspension, non-renewal or revocation, if I violate any rule, law or regulation of the city of Milwaukee and State of Wisconsin.

(8) NOTARIZED SIGNATURES OF APPLICANTS

SUBSCRIBED AND SWORN TO BEFORE ME

This 14 day of May

(Clerk/Notary Public)

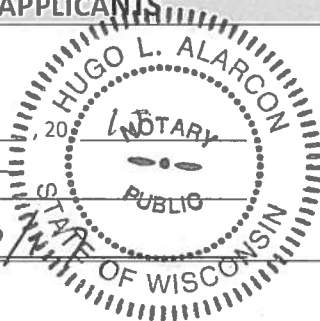
My Commission Expires 10/17/2017

Byram Gidif
Agent/Owner/Partner

Additional Owner/Partner

*Notary Seal must be affixed.



**CITY OF MILWAUKEE
OFFICE OF THE CITY CLERK**

Monday, August 31, 2015

COMMITTEE MEETING NOTICE

AD 12

JANYZ, Terry L, Agent
NATIONAL HOTEL MILWAUKEE, LLC
1515 W NATIONAL Av

MILWAUKEE, WI 53204

You are requested to attend a hearing which is to be held in Room 301-B, Third Floor, City Hall on:

Tuesday, September 08, 2015 at 02:00 PM

Regarding: Your Rooming House Renewal Application as agent for "NATIONAL HOTEL MILWAUKEE, LLC" for "NATIONAL HOTEL MILWAUKEE" at 1515 W NATIONAL Av.

There is a possibility that your application may be denied for one or more of the following reasons: The recommendation of the committee regarding the application shall be based on evidence presented at the hearing. Per MCO 85-4-4, unless otherwise specified in the code, probative evidence concerning non-renewal, suspension or revocation may include evidence of the following: failure of the applicant to meet municipal qualifications, pending charges against or the conviction of any felony, misdemeanor, municipal offense or other offense, the circumstances of which substantially relate to the circumstances of the particular licensed or permitted activity, by the applicant or by any employee or other agent of the applicant. If the activities of the applicant involve a licensed premises, whether the premises tends to facilitate a public or private nuisance or has been the source of congregations of persons which have resulted in any of the following: disturbance of the peace; illegal drug activity; public drunkenness; drinking in public; harassment of passers-by; gambling; prostitution; sale of stolen goods; public urination; theft; assaults; battery; acts of vandalism including graffiti, excessive littering, loitering, illegal parking, loud noise at times when the licensed premise is open for business; traffic violations; curfew violations; lewd conduct; display of materials harmful to minors, pursuant to s. 106-9.6; or any other factor which reasonably relates to the public health, safety and welfare, or failure to comply with the approved plan of operation. See attached police report or correspondence.

**Notice for applicants with
warrants or unpaid fines:**

Proof of warrant satisfaction or payment of fines must be submitted at the hearing on the above date and time. Failure to comply with this requirement may result in a delay of the granting/denial of your application.

Failure to appear at this meeting may result in the denial of your license. Individual applicants must appear only in person or by an attorney. Corporate or Limited Liability applicants must appear only by the agent designated on the application or by an attorney. Partnership applicants must appear by a partner listed on the application or by an attorney. If you wish to do so and at your own expense, you may be accompanied by an attorney of your choosing to represent you at this hearing.

You will be given an opportunity to speak on behalf of the application and to respond and challenge any charges or reasons given for the denial. No petitions can be accepted by the committee, unless the people who signed the petition are present at the committee hearing and willing to testify. You may present witnesses under oath and you may also confront and cross-examine opposing witnesses under oath. If you have difficulty with the English language, you should bring an interpreter with you, at your expense, so that you can answer questions and participate in your hearing.

You may examine the application file at this office during regular business hours prior to the hearing date. Inquiries regarding this matter may be directed to the person whose signature appears below.

Limited parking for persons attending meetings in City Hall is available at reduced rates (5 hour limit) at the Milwaukee Center on the southwest corner of East Kilbourn and North Water Street. Parking tickets must be validated in the first floor information booth in City Hall.

PLEASE NOTE: Upon reasonable notice, efforts will be made to accommodate the needs of disabled individuals through sign language interpreters or other auxiliary aids. For additional information or to request this service, contact the Council Services Division ADA Coordinator at (414) 286-2998, Fax - (414) 286-3456, TDD - (414) 286-2025.

JIM OWCZARSKI, CITY CLERK

BY:

Jason Schunk
License Division Manager

If you have questions regarding this notice, please contact the License Division at (414) 286-2238.

200 E. Wells Street, Room 105, City Hall, Milwaukee, WI 53202. www.milwaukee.gov/license
Phone: (414) 286-2238 Fax: (414) 286-3057 Email Address: License@milwaukee.gov



**CITY OF MILWAUKEE
OFFICE OF THE CITY CLERK**

Monday, August 31, 2015

COMMITTEE MEETING NOTICE

AD 12

JANYZ, Terry L, Agent
NATIONAL HOTEL MILWAUKEE, LLC
2901 W Coyle Ave

Chicago, IL 60645

You are requested to attend a hearing which is to be held in Room 301-B, Third Floor, City Hall on:

Tuesday, September 08, 2015 at 02:00 PM

Regarding: Your Rooming House Renewal Application as agent for "NATIONAL HOTEL MILWAUKEE, LLC" for "NATIONAL HOTEL MILWAUKEE" at 1515 W NATIONAL Av.

There is a possibility that your application may be denied for one or more of the following reasons: The recommendation of the committee regarding the application shall be based on evidence presented at the hearing. Per MCO 85-4-4, unless otherwise specified in the code, probative evidence concerning non-renewal, suspension or revocation may include evidence of the following: failure of the applicant to meet municipal qualifications, pending charges against or the conviction of any felony, misdemeanor, municipal offense or other offense, the circumstances of which substantially relate to the circumstances of the particular licensed or permitted activity, by the applicant or by any employee or other agent of the applicant. If the activities of the applicant involve a licensed premises, whether the premises tends to facilitate a public or private nuisance or has been the source of congregations of persons which have resulted in any of the following: disturbance of the peace; illegal drug activity; public drunkenness; drinking in public; harassment of passers-by; gambling; prostitution; sale of stolen goods; public urination; theft; assaults; battery; acts of vandalism including graffiti, excessive littering, loitering, illegal parking, loud noise at times when the licensed premise is open for business; traffic violations; curfew violations; lewd conduct; display of materials harmful to minors, pursuant to s. 106-9.6; or any other factor which reasonably relates to the public health, safety and welfare, or failure to comply with the approved plan of operation. See attached police report or correspondence.

**Notice for applicants with
warrants or unpaid fines:**

Proof of warrant satisfaction or payment of fines must be submitted at the hearing on the above date and time. Failure to comply with this requirement may result in a delay of the granting/denial of your application.

Failure to appear at this meeting may result in the denial of your license. Individual applicants must appear only in person or by an attorney. Corporate or Limited Liability applicants must appear only by the agent designated on the application or by an attorney. Partnership applicants must appear by a partner listed on the application or by an attorney. If you wish to do so and at your own expense, you may be accompanied by an attorney of your choosing to represent you at this hearing.

You will be given an opportunity to speak on behalf of the application and to respond and challenge any charges or reasons given for the denial. No petitions can be accepted by the committee, unless the people who signed the petition are present at the committee hearing and willing to testify. You may present witnesses under oath and you may also confront and cross-examine opposing witnesses under oath. If you have difficulty with the English language, you should bring an interpreter with you, at your expense, so that you can answer questions and participate in your hearing.

You may examine the application file at this office during regular business hours prior to the hearing date. Inquiries regarding this matter may be directed to the person whose signature appears below.

Limited parking for persons attending meetings in City Hall is available at reduced rates (5 hour limit) at the Milwaukee Center on the southwest corner of East Kilbourn and North Water Street. Parking tickets must be validated in the first floor information booth in City Hall.

PLEASE NOTE: Upon reasonable notice, efforts will be made to accommodate the needs of disabled individuals through sign language interpreters or other auxiliary aids. For additional information or to request this service, contact the Council Services Division ADA Coordinator at (414) 286-2998, Fax - (414) 286-3456, TDD - (414) 286-2025.

JIM OWCZARSKI, CITY CLERK

BY: _____

**Jason Schunk
License Division Manager**

If you have questions regarding this notice, please contact the License Division at (414) 286-2238.

200 E. Wells Street, Room 105, City Hall, Milwaukee, WI 53202. www.milwaukee.gov/license
Phone: (414) 286-2238 Fax: (414) 286-3057 Email Address: License@milwaukee.gov

Becker, Keren

From: Schunk, Jason
Sent: Friday, August 07, 2015 2:04 PM
To: Becker, Keren
Cc: Wagner, Janice; Celella, Jessica
Subject: FW: 1515 W National Ave

Follow Up Flag: Follow up
Flag Status: Flagged

Please add to the file

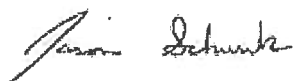

Jason Schunk, License Division Manager, CPM
200 E. Wells Street Room 105, Milwaukee, WI 53202
(414) 286-2238 (p)
(414) 286-3057 (f)



From: Velasquez, Guadalupe
Sent: Friday, August 07, 2015 12:52 PM
To: Murillo, Maribel; DeSiato, Nicholas; Ann Lopez Community Prosecutor; Gutmann, Marissa; Vodicka, Kevin; Cornejo, Efrain; Diener, Matthew; Perez, Jose; Lewandowski, Erica; Blunt, Archie; Molina, Manuel
Cc: Morales, Alfonso; Stein, Richard; Kaltenbrun, John; Henry, Craig; Schlei, Bradley; Raden, Chad; Schunk, Jason; Celella, Jessica; Neal, Willis; Gallup, Lorie; Zyszkiewicz, Greg
Subject: Re: 1515 W National Ave

Maribel,

There have been 8 nuisance related calls to the property since the beginning of the year, and not all of them required a police response. Out of the calls that MPD responded to only one was verified for a battery. That incident occurred on 01/20/2015 so if another qualifying incident occurs within a year the property will become nuisance eligible.

DNS Inspector Lorie Gallup stated the Commerical Building Inspection conducted an inspection on 08/04/2015 and 6 violations were found.

I only located one call from [redacted] on 03/10/15. P.O. Cornejo and I have spoken to [redacted] a couple of times regarding similar complaints and he always states that he does not have time to call the police all the time because he is at work. While doing the CAD search I did observe that officers are conducting several traffic stops, subject stops and probation/ parole checks. I will re-enter an extra patrol request for this area.

P.O. Guadalupe VELASQUEZ
District 2, Community Prosecution Unit
245 W. Lincoln Ave, Milwaukee, WI 53207

From: Perez, Jose on behalf of Murillo, Maribel

Sent: Friday, July 24, 2015 11:22 AM

To: DeSiato, Nicholas; Ann Lopez Community Prosecutor; Gutmann, Marissa; Velasquez, Guadalupe; Vodicka, Kevin; Cornejo, Efrain; Diener, Matthew; Cornejo, Efrain; Perez, Jose; Lewandowski, Erica; Blunt, Archie; Molina, Manuel

Cc: Morales, Alfonso; Stein, Richard; Kaltenbrun, John; Henry, Craig; Schlei, Bradley; Raden, Chad; Schunk, Jason; Celella, Jessica; Neal, Willis; Gallup, Lorie; Zyszkiewicz, Greg

Subject: 1515 W National Ave

Good Afternoon,

I would like to inform you that _____ located at _____ contacted the office of Alderman Pérez.

He stated that there are 6 registered sex offenders residing at 1515 W National Ave, and there are other sex offenders who are there that are not registered at this property.

_____ is concerned that this is located 2 blocks from Notre Dame Middle School (All-girls school)-1420 W Scott St. He stated that the owner of 1515 lives in Chicago, the manager does not care who he rents to.

_____ stated there is a high amount of prostitution at this location and that his clients have been approached by prostitutes.

This rooming house is coming before license soon, do you have any CAD calls in this matter. Also can you please have someone look into this matter.

If you need to contact

José G. Pérez

Alderman - 12th District



Monday, August 31, 2015



Notice of Public Hearing

JANYZ, Terry L, Agent
NATIONAL HOTEL MILWAUKEE at 1515 W NATIONAL Av
Rooming House Renewal Application

Tuesday, September 08, 2015 at 2:00 PM

To whom it may concern:

The above application has been made by the above named applicant(s). This requires approval from the Licenses Committee and the Common Council of the City of Milwaukee. The hearing before the Licenses Committee will take place on 9/8/2015 at 2:00 PM, in Room 301-B, Third Floor, City Hall. If you wish, you may provide testimony at the hearing regarding the request; see below for further information. You are not required to attend the hearing. Once the Licenses Committee makes its recommendation, this recommendation is forwarded to the full Common Council for approval at its next regularly scheduled hearing. Please review the information below and if you have further questions regarding this process, please contact the License Division at (414) 286-2238.

Important details for those wishing to provide information for the Licenses Committee to consider when making its recommendation:

1. The license application is scheduled to be heard at the above time. Due to other hearings running longer than scheduled, you may have to wait some time to provide your testimony.
2. You must appear in person and testify as to matters that you have personally experienced or seen. (You cannot provide testimony for your neighbor, parent or anyone else; this is considered hearsay and cannot be considered by the committee.)
3. No letters or petitions can be accepted by the committee (unless the person who wrote the letter or the persons who signed the petition are present at the committee hearing and willing to testify).
4. Persons opposed to the license application are given the opportunity to testify first; supporters may testify after the opponents have finished.
5. When you are called to testify, you will be sworn in and asked to give your name, and address. (If your first and/or last names are uncommon please spell them.)
6. You may then provide testimony.
 - a. Include only information relating to the above license application.
 - b. Include only information you have personally witnessed or seen.
 - c. Provide concise and relevant information detailing how this business has affected or may affect the peaceful enjoyment of your neighborhood.
 - d. If by the time you have the opportunity to testify, the information you wish to share has already been provided to the committee, you may state that you agree with the previous testimony. Redundant or repetitive testimony will not assist the committee in making its recommendation.
7. After giving your testimony, the members of the Licenses Committee and the licensee may ask questions regarding the testimony you have given or other factors relating to the license application.
8. Business Competition is not a valid basis for denial or non-renewal of a license.
Please Note: If you have submitted an objection to the above application your objection cannot be considered by the committee unless you personally testify at the hearing.

[illegible]

CURRENT RESIDENT	1528 W WALKER ST 310	MILWAUKEE, WI 53204-2171
CURRENT RESIDENT	1528 W WALKER ST 311	MILWAUKEE, WI 53204-2171
CURRENT RESIDENT	1528 W WALKER ST 401	MILWAUKEE, WI 53204-2171
CURRENT RESIDENT	1528 W WALKER ST 402	MILWAUKEE, WI 53204-2171
CURRENT RESIDENT	1528 W WALKER ST 403	MILWAUKEE, WI 53204-2171
CURRENT RESIDENT	1528 W WALKER ST 404	MILWAUKEE, WI 53204-2171
CURRENT RESIDENT	1528 W WALKER ST 405	MILWAUKEE, WI 53204-2171
CURRENT RESIDENT	1528 W WALKER ST 406	MILWAUKEE, WI 53204-2171
CURRENT RESIDENT	1528 W WALKER ST 407	MILWAUKEE, WI 53204-2171
CURRENT RESIDENT	1528 W WALKER ST 408	MILWAUKEE, WI 53204-2171
CURRENT RESIDENT	1528 W WALKER ST 409	MILWAUKEE, WI 53204-2171
CURRENT RESIDENT	1528 W WALKER ST 410	MILWAUKEE, WI 53204-2171
CURRENT RESIDENT	1529 W WALKER ST	MILWAUKEE, WI 53204-2143
CURRENT RESIDENT	1531 W WALKER ST	MILWAUKEE, WI 53204-2143
CURRENT RESIDENT	1535 W WALKER ST	MILWAUKEE, WI 53204-2143
CURRENT RESIDENT	1538 W WALKER ST	MILWAUKEE, WI 53204-2142
CURRENT RESIDENT	1538A W WALKER ST	MILWAUKEE, WI 53204-2142
CURRENT RESIDENT	1538B W WALKER ST	MILWAUKEE, WI 53204-2142
CURRENT RESIDENT	1539 W WALKER ST	MILWAUKEE, WI 53204-2143
CURRENT RESIDENT	1542 W WALKER ST	MILWAUKEE, WI 53204-2142
CURRENT RESIDENT	1543 W WALKER ST	MILWAUKEE, WI 53204-2143
CURRENT RESIDENT	1546 W WALKER ST	MILWAUKEE, WI 53204-2142
CURRENT RESIDENT	1552 W WALKER ST	MILWAUKEE, WI 53204-2142
CURRENT RESIDENT	1552A W WALKER ST	MILWAUKEE, WI 53204-2142
CURRENT RESIDENT	811 S 15TH ST	MILWAUKEE, WI 53204-2106
CURRENT RESIDENT	813 S 15TH ST	MILWAUKEE, WI 53204-2106
CURRENT RESIDENT	817 S 15TH ST	MILWAUKEE, WI 53204-2106
CURRENT RESIDENT	819 S 15TH ST	MILWAUKEE, WI 53204-2106
CURRENT RESIDENT	823 S 15TH ST	MILWAUKEE, WI 53204-2106

Total Records: 85

Radius: 250.0 feet and Center of Circle: 1515 W National AV



CITY OF MILWAUKEE
OFFICE OF THE CITY CLERK

Monday, August 31, 2015

COMMITTEE MEETING NOTICE

AD 12

KIECKBUSCH, Gregory A, Agent
The Merge Group LLC
721 S Cesar E Chavez DR

Milwaukee, WI 53204

You are requested to attend a hearing which is to be held in Room 301-B, Third Floor, City Hall on:

Tuesday, September 08, 2015 at 02:00 PM

Regarding: Your Class B Tavern License and Public Entertainment Premises Renewal Application as agent for "The Merge Group LLC" for "Mango's" at 721 S Cesar E Chavez DR.

There is a possibility that your application may be denied for one or more of the following reasons: The recommendation of the committee regarding the application shall be based on evidence presented at the hearing. Per MCO 85-4-4, unless otherwise specified in the code, probative evidence concerning non-renewal, suspension or revocation may include evidence of the following: failure of the applicant to meet municipal qualifications, pending charges against or the conviction of any felony, misdemeanor, municipal offense or other offense, the circumstances of which substantially relate to the circumstances of the particular licensed or permitted activity, by the applicant or by any employee or other agent of the applicant. If the activities of the applicant involve a licensed premises, whether the premises tends to facilitate a public or private nuisance or has been the source of congregations of persons which have resulted in any of the following: disturbance of the peace; illegal drug activity; public drunkenness; drinking in public; harassment of passers-by; gambling; prostitution; sale of stolen goods; public urination; theft; assaults; battery; acts of vandalism including graffiti, excessive littering, loitering, illegal parking, loud noise at times when the licensed premise is open for business; traffic violations; curfew violations; lewd conduct; display of materials harmful to minors, pursuant to s. 106-9.6; or any other factor which reasonably relates to the public health, safety and welfare, or failure to comply with the approved plan of operation. See attached police report or correspondence.

**Notice for applicants with
warrants or unpaid fines:**

Proof of warrant satisfaction or payment of fines must be submitted at the hearing on the above date and time. Failure to comply with this requirement may result in a delay of the granting/denial of your application.

Failure to appear at this meeting may result in the denial of your license. Individual applicants must appear only in person or by an attorney. Corporate or Limited Liability applicants must appear only by the agent designated on the application or by an attorney. Partnership applicants must appear by a partner listed on the application or by an attorney. If you wish to do so and at your own expense, you may be accompanied by an attorney of your choosing to represent you at this hearing.

You will be given an opportunity to speak on behalf of the application and to respond and challenge any charges or reasons given for the denial. No petitions can be accepted by the committee, unless the people who signed the petition are present at the committee hearing and willing to testify. You may present witnesses under oath and you may also confront and cross-examine opposing witnesses under oath. If you have difficulty with the English language, you should bring an interpreter with you, at your expense, so that you can answer questions and participate in your hearing.

You may examine the application file at this office during regular business hours prior to the hearing date. Inquiries regarding this matter may be directed to the person whose signature appears below.

Limited parking for persons attending meetings in City Hall is available at reduced rates (5 hour limit) at the Milwaukee Center on the southwest corner of East Kilbourn and North Water Street. Parking tickets must be validated in the first floor information booth in City Hall.

PLEASE NOTE: Upon reasonable notice, efforts will be made to accommodate the needs of disabled individuals through sign language interpreters or other auxiliary aids. For additional information or to request this service, contact the Council Services Division ADA Coordinator at (414) 286-2998, Fax - (414) 286-3456, TDD - (414) 286-2025.

JIM OWCZARSKI, CITY CLERK

BY: _____

Jason Schunk
License Division Manager

If you have questions regarding this notice, please contact the License Division at (414) 286-2238.

200 E. Wells Street, Room 105, City Hall, Milwaukee, WI 53202. www.milwaukee.gov/license
Phone: (414) 286-2238 Fax: (414) 286-3057 Email Address: License@milwaukee.gov



CITY OF MILWAUKEE
OFFICE OF THE CITY CLERK

Monday, August 31, 2015

COMMITTEE MEETING NOTICE

AD 12

KIECKBUSCH, Gregory A, Agent
The Merge Group LLC
2361 S 82nd St

West Allis, WI 53219

You are requested to attend a hearing which is to be held in Room 301-B, Third Floor, City Hall on:

Tuesday, September 08, 2015 at 02:00 PM

Regarding: Your Class B Tavern License and Public Entertainment Premises Renewal Application as agent for "The Merge Group LLC" for "Mango's" at 721 S Cesar E Chavez DR.

There is a possibility that your application may be denied for one or more of the following reasons: The recommendation of the committee regarding the application shall be based on evidence presented at the hearing. Per MCO 85-4-4, unless otherwise specified in the code, probative evidence concerning non-renewal, suspension or revocation may include evidence of the following: failure of the applicant to meet municipal qualifications, pending charges against or the conviction of any felony, misdemeanor, municipal offense or other offense, the circumstances of which substantially relate to the circumstances of the particular licensed or permitted activity, by the applicant or by any employee or other agent of the applicant. If the activities of the applicant involve a licensed premises, whether the premises tends to facilitate a public or private nuisance or has been the source of congregations of persons which have resulted in any of the following: disturbance of the peace; illegal drug activity; public drunkenness; drinking in public; harassment of passers-by; gambling; prostitution; sale of stolen goods; public urination; theft; assaults; battery; acts of vandalism including graffiti, excessive littering, loitering, illegal parking, loud noise at times when the licensed premise is open for business; traffic violations; curfew violations; lewd conduct; display of materials harmful to minors, pursuant to s. 106-9.6; or any other factor which reasonably relates to the public health, safety and welfare, or failure to comply with the approved plan of operation. See attached police report or correspondence.

Notice for applicants with warrants or unpaid fines:

Proof of warrant satisfaction or payment of fines must be submitted at the hearing on the above date and time. Failure to comply with this requirement may result in a delay of the granting/denial of your application.

Failure to appear at this meeting may result in the denial of your license. Individual applicants must appear only in person or by an attorney. Corporate or Limited Liability applicants must appear only by the agent designated on the application or by an attorney. Partnership applicants must appear by a partner listed on the application or by an attorney. If you wish to do so and at your own expense, you may be accompanied by an attorney of your choosing to represent you at this hearing.

You will be given an opportunity to speak on behalf of the application and to respond and challenge any charges or reasons given for the denial. No petitions can be accepted by the committee, unless the people who signed the petition are present at the committee hearing and willing to testify. You may present witnesses under oath and you may also confront and cross-examine opposing witnesses under oath. If you have difficulty with the English language, you should bring an interpreter with you, at your expense, so that you can answer questions and participate in your hearing.

You may examine the application file at this office during regular business hours prior to the hearing date. Inquiries regarding this matter may be directed to the person whose signature appears below.

Limited parking for persons attending meetings in City Hall is available at reduced rates (5 hour limit) at the Milwaukee Center on the southwest corner of East Kilbourn and North Water Street. Parking tickets must be validated in the first floor information booth in City Hall.

PLEASE NOTE: Upon reasonable notice, efforts will be made to accommodate the needs of disabled individuals through sign language interpreters or other auxiliary aids. For additional information or to request this service, contact the Council Services Division ADA Coordinator at (414) 286-2998, Fax - (414) 286-3456, TDD - (414) 286-2025.

JIM OWCZARSKI, CITY CLERK

BY: _____

Jason Schunk
License Division Manager

If you have questions regarding this notice, please contact the License Division at (414) 286-2238.

200 E. Wells Street, Room 105, City Hall, Milwaukee, WI 53202. www.milwaukee.gov/license
Phone: (414) 286-2238 Fax: (414) 286-3057 Email Address: License@milwaukee.gov

MILWAUKEE POLICE DEPARTMENT

LICENSING

CRIMINAL RECORD/ORDINANCE VIOLATION/INCIDENTS SYNOPSIS

DATE: 08/19/2015

LICENSE TYPE: BTAVN

NEW: ☒

RENEWAL: ☐

No. 215376

Application Date: 07/31/2015

License Location: 721 South Cesar E. Chavez Drive

Business Name: Mango's

Licensee/Applicant: Kieckbusch, Gregory A.
(Last Name, First Name, MI)

Date of Birth: 06/25/1980

Home Address: 2361 South 82nd Street

City: West Allis

State: WI **Zip Code:** 53219

Home Phone: (414) 559-2363

This report is written by Police Officer Gilbert Gwinn, assigned to the License Investigation Unit, Days.

The Milwaukee Police Department's investigation regarding this application revealed the following:

1. On 11/08/2009 at 10:00AM Francisco Sandino-Badillo was issued (4) citations for:

Charge: Precious Metal/Gem Dealer Regulations (4 counts)
Finding: Guilty – Milwaukee Municipal Court (4 counts)
Sentence: \$200.00 Penalty on each count
Date: 08/30/2010
Case #'s: 09156510, 09156511, 09156512, 09156513

2. On 11/09/2009 at 10:00AM Francisco Sandino-Badillo was issued (4) citations for:

Charge: Precious Metal/Gem Dealer Regulations (4 counts)
Finding: Guilty – Milwaukee Municipal Court (4 counts)
Sentence: \$200.00 Penalty on each count
Date: 08/30/2010
Case #'s: 09156514, 09156515, 09156516, 09156552

3. On 11/10/2009 at 10:00AM Francisco Sandino-Badillo was issued (4) citations for:

Charge: Precious Metal/Gem Dealer Regulations (4 counts)
Finding: Guilty – Milwaukee Municipal Court (4 counts)
Sentence: \$200.00 Penalty on each count
Date: 08/30/2010
Case #'s: 09156553, 09156554, 09156555, 09156556

4. On 11/11/2009 at 10:00 Francisco Sandino-Badillo was issued (4) citations for:

Charge: Precious Metal/Gem Dealer Regulations (4 counts)
Finding: Guilty – Milwaukee Municipal Court (4 counts)
Sentence: \$200.00 Penalty on each count
Date: 08/30/2010
Case #'s: 09156505, 09156508, 09156509, 09156570

5. On 11/12/2009 at 10:00AM Francisco Sandino-Badillo was issued (4) citations for:

Charge: Precious Metal/Gem Dealer Regulations (4 counts)
Finding: Guilty – Milwaukee Municipal Court (4 counts)
Sentence: \$200.00 Penalty on each count
Date: 08/30/2010
Case #'s: 09156557, 09156558, 09156559, 09156560

6. On 11/13/2009 at 10:00AM Francisco Sandino-Badillo was issued (4) citations for:

Charge: Precious Metal/Gem Dealer Regulations (4 counts)
Finding: Guilty – Milwaukee Municipal Court (4 counts)
Sentence: \$200.00 Penalty on each count
Date: 08/30/2010
Case #'s: 09156537, 09156538, 09156539, 09156561

7. On 11/14/2009 at 10:00AM Francisco Sandino-Badillo was issued (4) citations for:

Charge: Precious Metal/Gem Dealer Regulations (4 counts)
Finding: Guilty – Milwaukee Municipal Court (4 counts)
Sentence: \$200.00 Penalty on each count
Date: 08/30/2010
Case #'s: 09156540, 09156541, 09156542, 09156543

8. On 11/16/2009 at 10:00AM Francisco Sandino-Badillo was issued (4) citations for:

Charge: Precious Metal/Gem Dealer Regulations (4 counts)
Finding: Guilty – Milwaukee Municipal Court (4 counts)
Sentence: \$200.00 Penalty on each count
Date: 08/30/2010
Case #'s: 09156517, 09156544, 09156545, 09156546

9. On 11/17/2009 at 10:00AM Francisco Sandino-Badillo was issued (4) citations for:

Charge: Precious Metal/Gem Dealer Regulations (4 counts)
Finding: Guilty – Milwaukee Municipal Court (4 counts)
Sentence: \$200.00 Penalty on each count
Date: 08/30/2010
Case #'s: 09156518, 09156519, 09156520, 09156521

10. On 11/18/2009 at 10:00AM Francisco Sandino-Badillo was issued (4) citations for:

Charge: Precious Metal/Gem Dealer Regulations (4 counts)
Finding: Guilty – Milwaukee Municipal Court (4 counts)
Sentence: \$200.00 Penalty on each count
Date: 08/30/2010
Case #'s: 09156522, 09156523, 09156524, 09156525

11. On 11/19/2009 at 10:00AM Francisco Sandino-Badillo was issued (4) citations for:

Charge: Precious Metal/Gem Dealer Regulations (4 counts)
Finding: Guilty – Milwaukee Municipal Court (4 counts)
Sentence: \$200.00 Penalty on each count
Date: 08/30/2010
Case #'s: 09156526, 09156527, 09156528, 09156529

12. On 11/20/2009 at 10:00AM Francisco Sandino-Badillo was issued (4) citations for:

Charge: Precious Metal/Gem Dealer Regulations (4 counts)
Finding: Guilty – Milwaukee Municipal Court (4 counts)
Sentence: \$200.00 Penalty on each count
Date: 08/30/2010
Case #'s: 09156530, 09156531, 09156532, 0915652133

13. On 11/21/2009 at 10:00AM Francisco Sandino-Badillo was issued (4) citations for:

Charge: Precious Metal/Gem Dealer Regulations (4 counts)
Finding: Guilty – Milwaukee Municipal Court (4 counts)
Sentence: \$200.00 Penalty on each count
Date: 08/30/2010
Case #'s: 09156534, 09156535, 09156536, 09156547

14. On 11/23/2009 at 10:00AM Francisco Sandino-Badillo was issued (4) citations for:

Charge: Precious Metal/Gem Dealer Regulations (4 counts)
Finding: Guilty – Milwaukee Municipal Court (4 counts)
Sentence: \$200.00 Penalty on each count
Date: 08/30/2010
Case #'s: 09156548, 09156549, 09156550, 09156551

Items 1-14 above apply to Francisco Sandino-Badillo. Francisco Sandino-Badillo is listed on the application as a 50% shareholder.

- =====
15. On 12/05/2014 Milwaukee police conducted a licensed premise check at 721 South Cesar E Chavez Drive (Mangos Bar and Grill). No violations were observed.
 16. On 12/26/2014 Milwaukee police observed a large crowd and traffic congestion occurring around 1:17am during closing for Mangos Bar and Grill (721 South Cesar E Chavez Drive). In addition, a fight broke out among a group of female patrons leaving the business. One patron was cited for Resist/Obstruct an Officer. After the crowd was dispersed, officers spoke to the applicant regarding the incident. The applicant told officers the business had hosted a birthday party with members of the Green Bay Packers in attendance and that created a larger crowd than the business usually has. The applicant was cooperative with officers and no tavern violations were observed.
 17. On 01/20/2015 the applicant and Milwaukee police met regarding the incident that occurred at the business on 12/26/2014 as well as several aldermanic complaints. Milwaukee police were advised by the applicant and his representative that the business features Miami-Style music. The business transitions from a restaurant to a club at 10:00pm and at that time they check to make sure all remaining patrons are over 21. Additionally, the business utilizes 12-15 security guards while it is operating as a club, and that all male patrons are scanned with a metal detector and all purses are checked. Officers suggested that all patrons be checked with a metal detector, not just males and that Milwaukee police district #2 be contacted if the business is going to host parties with VIP's or when they expect a larger than normal crowd.
 18. On 03/13/2015 at 3:30am Milwaukee police conducted a licensed premise check at Mango's Tavern (721 South Cesar E Chavez Drive). Approximately 25 people were observed in the business, co-owner Francisco Sandino-Badillo told officers that all of the people were employee's waiting for their paychecks. Both Sandino-Badillo and the applicant were cited for Class B Premises Allow Patron After Hours. Both citations (#15016675 for the applicant and #15016674 for Sandino-Badillo) were later dismissed without prejudice.
 19. On 08/16/2015 Milwaukee police responded to a shooting complaint at 721 South Cesar E. Chavez Drive (Mango's Bar and Grill). Investigation revealed a fight occurred inside the business and the individuals involved were escorted out of the establishment. Shortly after this incident five to six gunshots were fired east of the bar, striking two victims who were standing outside the front entrance of the business. During this incident, officers discovered approximately 10, underage patrons inside the business while conducting interviews. One of these underage subjects, Robels-Cartagnea, (19yoa) was questioned how she got into the establishment. She stated she knew the owner and he allowed her in. During the investigation the crowd became unruly and began pushing their way out, allowing Robels-Cartagena to leave. The applicant was also cited for permitting an underage person on licensed premise.
 20. On 08/17/2015 Milwaukee Police conducted follow-up at Mango's, 721 S Cesar Chavez. The follow up was regarding a sexual assault that occurred on 08/08/15. The investigation revealed that the sexual assault did not occur at Mango's but that the victim had a VIP Birthday Party at Mango's prior to the incident and she was only 20 years old. It was believed that the victim and the suspect might have crossed paths at the club but video surveillance revealed that it did not occur. The agent stated the VIP rooms are rented by phone and customers attending the VIP room are carded. When asked about the 20 year old holding the party he stated she probably was let in because she is an employee. The agent stated he was told the VIP room was requested by the 20 year olds mother and that the parents were present for the party. Officers

interviewed the 20yr old who stated she texted Francisco Sandino-Badillo, who is business partner with the agent, to set up the VIP room. She stated her family was not at the party and that they knew she was 20 yrs. old because she works for them at the Bamboo House. While reviewing the video officers observed patrons walking around the establishment with bottles and pouring their own drinks. The applicant was cited for Presence of Minor, which has a future court date of 10/07/15.

MILWAUKEE POLICE DEPARTMENT

REPORT OF INCIDENTS INVOLVING LICENSED PERSONS OR PREMISES

ORIGINAL

TO: Captain Alfonso MORALES

Business Name: Mangos Bar and Grill

Address of Licensed Premises: 721 S Cesar E Chavez Dr.

Business Phone: 414 559-2363

Type of License: Class B Tavern

District: 2

☐ Violation / ☐ Incident #

Date of Incident:

Licensee or Manager on premises at time of violation / incident? ☒ Yes ☐ NoLicensee cooperative? ☒ Yes ☐ No (If no, explain in narrative section)

Licensee Notified by Officer: PO Elie CONTRERAS

Date: 12-5-14

Time: 20:48

Licensee or Agent's Name: Gregory A KIECKBUSH

Home Address: 2361 S 82nd St Milwaukee, WI 53219

Date of Birth: 06-25-80

Home Phone: 414 559-2363

Co-Licensee Name:

Home Address:

Class S License Number:

Date of Birth:

Home Phone:

Bartender Name:

Home Address:

Class D License Number:

Date of Birth:

Home Phone:

Licensed Person / Public Pass. Vehicle, etc.:

Home Address:

Class D License Number:

Date of Birth:

Home Phone:

VIOLATION/INCIDENT – DESCRIBE FACTS AND CIRCUMSTANCES IN NARRATIVE SECTION

Name of Person Cited:

Citation Number:

Violation & Ord. / Statue No.:

Date of Birth:

Court Date:

Name of Person Cited:

Citation Number:

Violation & Ord. / Statue No.:

Date of Birth:

Court Date:

Name of Person Cited:

Citation Number:

Violation & Ord. / Statue No.:

Date of Birth:

Court Date:

Name of Person Cited:

Citation Number:

Violation & Ord. / Statue No.:

Date of Birth:

Court Date:

Name of Person Cited:

Citation Number:

Violation & Ord. / Statue No.:

Date of Birth:

Court Date:

Investigating Officer: PO Elie CONTRERAS

District / Bureau: D24

Date: 12-12-14

 Commanding Officer

 Date

DISPOSITION – FOR LICENSING ONLY

Citation No.	Case Number	Disposition	Judge	Date

LICENSE INVESTIGATION UNIT

Received

Referred

By

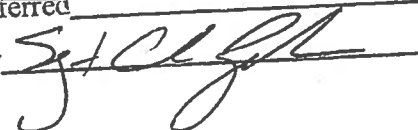

PA-33E Narrative

This report is written by PO Eliel CONTRERAS assigned to District 2, Late Power Shift. On Friday, 12-5-14 at approximately 8:48pm Squad 2479 (PO Roman MARTINEZ and I) conducted a tavern premise check at said location. There were no violations observed during the premise check and the license agent, Gregory A KIECKBUSH (W/M 6-25-80), was very cooperative.

MILWAUKEE POLICE DEPARTMENT

REPORT OF INCIDENTS INVOLVING LICENSED PERSONS OR PREMISES

ORIGINAL

TO: Captain Alforiso MORALES

Business Name: Mango's

Address of Licensed Premises: 721 S Ceasr E Chavez Dr, Milwaukee, WI, 53204

District: 2

Business Phone: 414-467-8189

Type of License: CLASS "B" TAVERN (202291)

☐ Violation / ☐ Incident #

Date of Incident: 12-26-14

Licensee or Manager on premises at time of violation / incident? ☒ Yes ☐ NoLicensee cooperative? ☒ Yes ☐ No (If no, explain in narrative section)

Licensee Notified by Officer: P.O Roman MARTINEZ

Date: 12-26-14

Time: 02:00A

Licensee or Agent's Name: SANDINO-BADILLO, Francisco

Date of Birth: 03-16-85

Home Address: 7104 S 47th Pl

Home Phone:

KIRCKBUSH, Gregory

Co-Licensee Name:

Date of Birth:

Home Address:

Home Phone:

Class S License Number:

Bartender Name:

Date of Birth:

Home Address:

Home Phone:

Class D License Number:

Licensed Person / Public Pass. Vehicle, etc.:

Date of Birth:

Home Address:

Home Phone:

Class D License Number:

VIOLATION/INCIDENT – DESCRIBE FACTS AND CIRCUMSTANCES IN NARRATIVE SECTION

Name of Person Cited: Colette A. MAHAN

Date of Birth: 04-03-83

Citation Number: 48919311304

Violation & Ord. / Statue No.: Resist/Obstruct 105-138-2

Court Date: 02-11-15

Name of Person Cited:

Date of Birth:

Citation Number:

Violation & Ord. / Statue No.:

Court Date:

Name of Person Cited:

Date of Birth:

Citation Number:

Violation & Ord. / Statue No.:

Court Date:

Name of Person Cited:

Date of Birth:

Citation Number:

Violation & Ord. / Statue No.:

Court Date:

Name of Person Cited:

Date of Birth:

Citation Number:

Violation & Ord. / Statue No.:

Court Date:

Investigating Officer: P.O. Roman MARTINEZ

District / Bureau: 24

Date: 01-01-15

Alforiso Morales
Commanding Officer

1/28/15
Date

DISPOSITION – FOR LICENSING ONLY

Citation No.	Case Number	Disposition	Judge	Date
		LICENSE INVESTIGATION UNIT		
		Received		
		Referred		
		By		

PA-33 Narrative

This report was written by P.O. Roman MARTINEZ, assigned to District Two/Late Power Shift.

On Monday, December 26th, 2014 at approximately 1:17AM, Squad 2411 (Sgt. SCHLEI) requested additional squads to monitor closing time of Mango's Bar and Grill (721 S Ceasar E. Chavez Dr.) as there was a large crowd gathering and traffic congestion was occurring. Squad 2451 (P.O. MARTINEZ/P.O. CORDOVA) and Squad 2440 (P.O. CARTAGENA/P.O. KOOPMEINERS) responded to monitor the bar closing. Security blocked several exits from the parking lot and only allowed vehicles to exit the lot from the northeast exit, near the entrance of the tavern. As vehicles left, several cars remained in the area cruising (driving around the block numerous times/refusing to leave the area) and blocking traffic, which added to additional traffic congestion.

At approximately 1:38AM, a group of female patrons leaving the tavern engaged in a fight in the parking lot, which also spilled into the street. A crowd grew from the exiting patrons as they stopped from exiting the lot due to the fight blocking the exit and street area. This impacted the surrounding neighborhood because of the loud noise, large crowds, and added traffic, which forced a major intersection (S Ceasar E Chavez Dr/W. National Av) to be closed for duration of time.

Due to the growing crowd and numerous fighting subjects, officers requested additional squads to respond to stop the fight and control the crowd/traffic. Squad 2341, Squad 2390, Squad 2490, and Squad 2313 responded to assist.

While attempting to halt the fight, several female subjects refused to cooperate with police lawful order to disperse, which resulted in one arrest for Resist/Obstruct a Police Officer (Arrestee: Colette A. MAHAN - B/F 04-03-83). MAHAN was cited and later released from the scene after the bar closed and crowds dispersed.

No injuries or battery victims came fourth regarding the fight that occurred.

After the crowds disperse and the scene was under control, I (P.O. MARTINEZ) spoke with the tavern owner, Francisco SANDINO-BADILLO (W/M 03-16-85), regarding the incident that unfolded in front of his establishment. I was informed by SANDINO-BADILLO that they were hosting a birthday party for several VIPs (Green Bay Packer players – Sam SHIELDS and Haha CLINTON-DIX), which brought a larger crowd to his business than expected. SANDINO-BADILLO stated that he did not think to notify the Milwaukee Police Department of the event or the VIPS that were present. SANDINO-BADILLO stated that one part of the group of females engaged in the fight were kicked out of the tavern earlier and must of waited for the other half to leave the tavern afterwards. SANDINO-BADILLO stated that there were no other issues within the tavern that night besides the incident outside. I did inform SANDINO-BADILLO that a tavern report would be filed regarding the incident.

I did not observe any visible tavern violations within the establishment at closing time during this investigation and the staff was cooperative with police.

End of Report

(Ref: CAD# 143600130)

MILWAUKEE POLICE DEPARTMENT

REPORT OF INCIDENTS INVOLVING LICENSED PERSONS OR PREMISES

TO: Captain Alfonso MORALES

Business Name: Mango's

Address of Licensed Premises: 721 S. Cesar E. Chavez Dr.

District: 2

Business Phone: 414-467-8189

Type of License: Class B Tavern

☐ Violation / ☐ Incident #

Date of Incident:

Licensee or Manager on premises at time of violation / Incident? ☐ Yes ☐ NoLicensee cooperative? ☒ Yes ☐ No (if no, explain in narrative section)**ORIGINAL**

Licensee Notified by Officer: P.O. Guadalupe VELASQUEZ

Date: 01/14/2015

Time: 12:30 p.m.

Licensee or Agent's Name: Gregory A. KIECKBUSCH
Home Address: 2361 S. 82nd St., West Allis, WI 53219Date of Birth: 06/25/80
Home Phone: 414-559-2363Co-Licensee Name: Francisco SANDINO-BADILLO
Home Address: 7104 S. 47th Pl., Franklin, WI 53132
Class S License Number:Date of Birth: 03/16/85
Home Phone: 414-467-8189Bartender Name:
Home Address:
Class D License Number:Date of Birth:
Home Phone:Licensed Person / Public Pass. Vehicle, etc.:
Home Address:
Class D License Number:Date of Birth:
Home Phone:**VIOLATION/INCIDENT - DESCRIBE FACTS AND CIRCUMSTANCES IN NARRATIVE SECTION**Name of Person Cited:
Citation Number:

Violation & Ord. / Statue No.:

Date of Birth:
Court Date:Name of Person Cited:
Citation Number:

Violation & Ord. / Statue No.:

Date of Birth:
Court Date:Name of Person Cited:
Citation Number:

Violation & Ord. / Statue No.:

Date of Birth:
Court Date:Name of Person Cited:
Citation Number:

Violation & Ord. / Statue No.:

Date of Birth:
Court Date:Name of Person Cited:
Citation Number:

Violation & Ord. / Statue No.:

Date of Birth:
Court Date:Investigating Officer: *P.O. Guadalupe VELASQUEZ*

District / Bureau: 22

Date: 01/20/15

*Commanding Officer**1/27/15*
Date**DISPOSITION - FOR LICENSING ONLY**

Citation No.	Case Number	Disposition	Judge	Date

By

This report is written by P.O. Guadalupe VELASQUEZ, assigned to District 2, Early Shift, Community Prosecution Unit.

On Monday, January 20, 2015 I contacted Gregory A. KIECKBUSCH and advised him that the Milwaukee Police Department was requesting a meeting with Mango's. I explained to him by phone that we wanted to meet with him because of the fight that occurred when they had a VIP Event on 12/26/14 and because we have received aldermanic complaints. The aldermanic complaints were:

11/05/14- citizen upset that Mango's is operating as another hip-hop venue and utilizing V-100 as a promoter. The citizen also stated that he has witnessed fights, traffic congestion, and loud noise coming from the club.

12/10/14- citizen stated that his underage daughter has been at Mango's. He also stated that she has been intoxicated and alleged that the club is serving minors.

The meeting was attended by Sergeant Marissa GUTMANN-GNADT, Sergeant Brad SCHLEI, P.O. Guadalupe VELASQUEZ, Assistant City Attorney Nick DESIATO, Gregory A. KIECKBUSCH, Francisco SANDINO-BADILLO, Attorney Michael L. CHERNIN, Julio C. MALDONADO, and Alderman Jose PEREZ.

During the meeting, KIECKBUSCH, SANDINO-BADILLO, and MALDONADO advised the Milwaukee Police Department that they are not operating a Hip-Hop Club and that they play Miami-Style Music. They also stressed that Mango's is a tropical bar and grill and that they intend to increase their restaurant sales but that the restaurant business takes longer to establish. They explained the restaurant transitions to a club at 10 p.m. Prior to opening the club they make sure that any of the restaurant customers that are still at the location are over 21. We were advised that they create one entrance and one exit in their parking lot at bar time in an effort to alleviate traffic congestion. They also stated they utilized 12-15 security guards when the club is operating. An id scanner is used before every patron enters the location and if they cause problem the system allows for the patron to be flagged. We were also informed that all male patrons are checked with a metal detector hand wand and a pat down is conducted and that female's purses are checked with a flashlight.

KIECKBUSCH requested suggestions on what could be done to avoid problems in the future. The following things were suggested: to pat down and check all patrons (male and female) with the hand wand, contact District 2 on VIP Event Nights or when they have a larger crowd, and posting signs that state "Respect our Neighbors" to avoid noise complaints.

MILWAUKEE POLICE DEPARTMENT

REPORT OF INCIDENTS INVOLVING LICENSED PERSONS OR PREMISES

TO: Captain Alfonso MORALES

Business Name: Mango's Tavern

Address of Licensed Premises: 721 S Ceasar E Chavez Dr

Business Phone:

Type of License: Class B

District: 2

☒ Violation / ☐ Incident #

Date of Incident: 3/15/15

Licensee or Manager on premises at time of violation / incident? ☒ Yes ☐ NoLicensee cooperative? ☒ Yes ☐ No (if no, explain in narrative section)

Licensee Notified by Officer: PO Andrew WILKIEWICZ

Date: 3/15/15

Time: 3:35 AM

Licensee or Agent's Name: KIECKBUSCH, Gregory A

Home Address: 2361 S 82nd St, Milwaukee WI, 53219

Date of Birth: 6/25/80

Home Phone:

Co-Licensee Name: BADILLO-SANDINO, Francisco JR

Home Address: 7104 S 47th St, Franklin WI 53132

Class S License Number:

Date of Birth: 3/16/85

Home Phone: 414-467-8189

Bartender Name:

Home Address:

Class D License Number:

Date of Birth:

Home Phone:

Licensed Person / Public Pass. Vehicle, etc.:

Home Address:

Class D License Number:

Date of Birth:

Home Phone:

VIOLATION/INCIDENT – DESCRIBE FACTS AND CIRCUMSTANCES IN NARRATIVE SECTION

Name of Person Cited: KIECKBUSCH, Gregory A

Citation Number: 6149091 4

Violation & Ord. / Statue No.: 90-15-3-a-1

Date of Birth: 6/25/80

Court Date: 4/20/15

Name of Person Cited: BADILLO-SANDINO, Francisco JR

Citation Number: 6149092 5

Violation & Ord. / Statue No.: 90-15-3-a-1

Date of Birth: 3/16/85

Court Date: 4/20/15

Name of Person Cited:

Citation Number:

Violation & Ord. / Statue No.:

Date of Birth:

Court Date:

Name of Person Cited:

Citation Number:

Violation & Ord. / Statue No.:

Date of Birth:

Court Date:

Name of Person Cited:

Citation Number:

Violation & Ord. / Statue No.:

Date of Birth:

Court Date:

Investigating Officer: PO Andrew WILKIEWICZ

District / Bureau: 23

Date: 3/26/15



Commanding Officer



Date

DISPOSITION – FOR LICENSING ONLY

Citation No.	Case Number	Disposition	Judge	Date
		LICENSE INVESTIGATION UNIT		
		Received	6-12-15	
		Referred		
		By		

This report is written by PO Andrew WILKIEWICZ assigned to District 2, Late Shift.

On Sunday March 13, 2015 at approximately 3:30 AM, squad 2330, PO Adam LUEBBE and myself, were sent to Mango's tavern at 721 S Ceasar E Chavez Dr by Sgt Jason WALTZ to assist in taking the names of the individuals that were in the tavern.

Upon arrival, I observed several vehicles in the parking lot of the tavern and conducted a licence premises check. I observed approximately 25 people in the tavern with alcoholic beverages in front of them. There were people on the first level as well as the second level.

PO LUEBBE spoke to the bartender/co-owner, Francisco SANDINO-BADILLO (M/W, 3/16/85), who stated that all of the people in the tavern were employee's waiting on their paychecks. All of the names of the individuals in the establishment were recorded by officers.

Gregory A KIECKBUSCH (M/W, 6/25/80) and BADILLO-SANDINO, the licencees of the premise, were both cited for allowing patrons in the premises after the hours of 2:30 AM (Ordinance 90-15-3-a-1).

UFO
Santitas

Date _____

PA-33E Narrative

This report is written by PO Eliel CONTRERAS assigned to District 2, Late Power Shift.

On Sunday, 8-16-15, at approximately 2:05am Squad 2490 (PO James COLLINS and I) responded to 721 S Cesar E Chavez Dr (Mango's Bar and Grill) for a Shooting Complaint (IR# 152280023). Upon arriving on scene, it was determined that a shooting had occurred at the establishment. It was also determined that two individuals had been shot and injured during the incident.

During the preliminary investigation, it was determined a fight had occurred inside the establishment between few individuals. Security escorted the individuals out of the establishment. Shortly after the individuals were escorted off the premises, five to six gunshots were heard east of Mangos, striking the victims who were standing outside the front entrance.

The two victims injured in the shooting were, Rainee M PAVLIK (W/F 12-21-80) and Lana C MARTINEZ (W/F 11-25-85). PAVLIK received a gunshot injury to her lower back and MARTINEZ received a gunshot injury to her rear right thigh. Both PAVLIK and MARTINEZ were standing in front of the main entrance to Mangos.

Due to the nature of the call, additional squads were requested from District 6 and District 1 to help with the incident and pending assignments, which included numerous priority one assignments because all District 2 Squads were dispatched to assist with this shooting investigation. District 2 and District 6 Squads were on scene at Mango's assisting with crowd control, scene containment, and witness interviews.

District 2 and District 6 Squads on scene were, Squad 2330, Squad 2390, Squad 2371, Squad 2470, Squad 2314, Squad 2320, Squad 2321, Squad 2341, Squad 2313, Squad 2472, Squad 2410, Squad 6353, and Squad 6341.

The following detective squads on scene were, Squad 9302, Squad 9328, Squad 9334, Squad 9359, and Squad 9294.

There were a total of 15 police officers, 3 patrol supervisors, 4 detectives, 1 detective supervisor, and 1 forensic investigator.

While on scene several underage individuals were inside the establishment. Due to the number of unruly patrons attempting to leave and multiple scenes, the underage individuals could not be detained except for one individual, who was temporarily detained by PO JACKSON.

The following officers were able to write down the names of individuals who were underage as they were leaving Mangos Bar and Grill.

PO Adam RUSCH

1. ALFARO-MATAMOROS, Cristian Nathaneal (W/M 11-5-95) 1436 W Washington St Milwaukee, WI
2. KNEISZEL Tamara R (W/F 9-22-95) 6171 S 31st St #1 Greenfield, WI 53221
3. ULLERICH, Desiree A (W/F 1-14-96) 8020 S Wildwood Wauwatosa, WI 53709
4. BAMBA, Rensielle G (W/F 11-23-95) 3301 S 84th St #3 Milwaukee, WI
5. MENDIETA, Cheyenne N (W/F 5-23-95) 2214 S 4th St Milwaukee, WI
6. ESPADA III, Jorge Luis (W/M 1-25-95) 6160 S 6th St #1 Milwaukee, WI

PO Erin JACKSON

1. ROBLES-CARTAGENA, Anntsh M (W/F 7-21-96) 1809 S 3rd St Milwaukee, WI

The underage individual, Anntsh Marie ROBLES CARTAGENA (W/F 7-21-1996), gave PO JACKSON her Wisconsin Identification Card, which showed she was nineteen years old. PO JACKSON asked ROBLES how she was able to enter the establishment and ROBLES stated she knew the owner and the owner allowed her to enter the establishment.

PO JACKSON instructed ROBLES CARTAGENA to stand to the side of the main entrance area because the patrons inside the establishment were becoming impatient and started to push their way to the front of the entrance in attempt to leave. While attempting to maintain control of the crowd, PO JACKSON stated ROBLES CARTAGENA was able to blend into the crowd and left the establishment against officer's instructions. PO JACKSON still had ROBLES CARTAGENA's identification card in her possession.

PO Kenneth JUSTUS

1. AVINA, Eduardo (W/M 11-11-95) 2933 W Hayes Milwaukee, WI

PO Radivoje PUPOVAC

1. BASTARDO, Emilio J (W/M 5-22-95) 1966 S 13th St Milwaukee, WI

While on scene, I conducted a license premise check and spoke with Santiago A DIEZ (W/M 9-21-88) who stated he was the general manager for Mangos. I informed DIEZ a license premise report would be filed regarding the incident. While on scene I did not see any additional visible violations and DIEZ was cooperative.

All the underage individuals will be cited for underage person who enters or is on premises licensed for the sale of alcohol beverages (90-19-1). Each officer who wrote down the information of each underage individual will be issuing the citations.

The licensee, Gregory A KIECKBUSCH (W/M 6-25-80), will be cited for each underage individual that was inside his establishment, which serves alcoholic beverages.

All citations are currently pending.

Type of License: Class B

Date of Incident: 08/08/2015

Licensee cooperative? ☒ Yes ☐ No (If no, explain in narrative section)

Time: 1:30 p.m.

Home Phone: 414-559-2363

Home Phone:

Home Phone:

Date of Birth:

Home Phone:

Date of Birth:

Home Phone:

VIOLATION/INCIDENT – DESCRIBE FACTS AND CIRCUMSTANCES IN NARRATIVE SECTION

Court Date: 10/07/15

Court Date: 10/07/15

Court Date:

Court Date:

Court Date:

Date: 08/19/2015

Date _____

DISPOSITION – FOR LICENSING ONLY

[illegible]

PA-3311 Narrative

This report is written by P.O. Guadalupe VELASQUEZ, assigned to District 2, Early Shift, Community Prosecution Unit.

On Monday, August 17, 2015, at 11:00 a.m., District 2 Captain Alfonso MORALES ordered Squad 2268 (P.O. VODICKA and P.O. VELASQUEZ) to recover video at Mango's, 721 S. Cesar E. Chavez Dr. regarding the above incident (sexual assault). The investigation revealed that the sexual assault did not occur at Mango's but that a victim had a VIP Birthday Party at Mango's prior to the incident and she was only 20 years old. It was believed that the victim and the suspect might have crossed paths at the club but video surveillance revealed that did not occur.

I contacted the licensee, Gregory A. KIECKBUSCH, who stated he could meet me at Mango's at 1:00 p.m. to review the video. At approximately 1:30 p.m. I met with KIECKBUSCH who retrieved the video. KIECKBUSCH was shown a picture of a possible suspect and he stated he was a regular VIP customer at the club but he stated that he spoke to his partner Frank, and that he was made aware that he was not at the location on August 8, 2015. KIECKBUSCH was also asked about the victim, who he stated he knew as an employee from Bamboo Lounge. P.O. VODICKA told KIECKBUSCH, that a PA-33 would be filed regarding the incident and stated that her age (having not yet turned 21) is a problem and KIECKBUSCH acknowledged by stating, "yea."

While downloading the video I asked KIECKBUSCH how the VIP Program worked and he stated that patrons call 414-939-4VIP. I then asked KIECKBUSCH if VIP parties are not carded when they enter the club and he stated they are. I asked KIECKBUSCH why the victim was able to enter the club without being 21 and he stated she might have been let in because she was an employee. I then asked KIECKBUSCH if he could verify who requested the VIP Party and he said no. KIECKBUSCH then stated that he believed it was the victim's sister. KIECKBUSCH asked if it would make a difference if her parents were present and I stated that would be something that could be investigated. KIECKBUSCH then stated he was told that the victim's mother had requested the VIP Party and that the victim's parents were present during the party. While at the location KIECKBUSCH stated that Frank had spoken to victim. I became concerned that Frank contacted the victim to request that the victim lie about her presence at the club or who rented the VIP Party Area.

I spoke to the victim of this incident, [REDACTED], who stated that she had her 20th birthday party at Mango's on Saturday, August 8, 2015. [REDACTED] stated that she texted Frank two weeks before her birthday to request the VIP room. She stated Frank was not going to charge her and that she was just expected to tip out the waitress. She stated that Frank was made aware that her party would be between 30-40 people. I asked [REDACTED] if her parents or sister were involved in the planning of the party and she stated they were not. [REDACTED] stated her sister was present the night of the party but that her parents were not. [REDACTED] stated that Frank and Greg are both aware that she is 20 because she is an employee at Bamboo Lounge. She stated Greg hired her and she had to provide her Wisconsin Driver's License when she was hired. I asked [REDACTED] if Frank had contacted her on 08/17/2015 and she stated yes. [REDACTED] stated she received a phone call from 467-8189, which she knows as Frank's cell number. She stated she responded with a text message that she was at work and that Frank requested a phone call asap. I instructed [REDACTED] that if Frank or KIECKBUSCH contacted her and requested that she lie to the police to contact me.

Frank was identified as Francisco SANDINO-BADILLO (W/M 03/16/85). He is KIECKBUSCH's partner in the Merge Group LLC and the licensee of Bamboo Lounge where [REDACTED] is employed.

I reviewed video from 08/08/15-08/09/15 and observed SOSA in Mango's. I also observed patrons walking with champagne bottles and pouring their own mixed drinks in the VIP Area. I observed Francisco SANDINO-BADILLO conversing and hugging a patron that had a champagne bottle in her hand. KIECKBUSCH was present in the room when the video was reviewed and the violations were present. He did state that all clubs do bottle service.

Koberstein, Jonathan

From: Schunk, Jason
Sent: Thursday, December 11, 2014 8:03 AM
To: Raden, Chad; Koberstein, Jonathan
Cc: Perez, Jose; Murillo, Maribel; Grill, Rebecca
Subject: FW: Tavern complaint

Good morning,

Sergeant Raden could you please look into this matter?

Jonathan please add to the file.

Thanks,

Jason

REDACTED RECORD

From: Murillo, Maribel
Sent: Wednesday, December 10, 2014 7:32 PM
To: Wagner, Janice; Schunk, Jason; Grill, Rebecca
Cc: Perez, Jose
Subject: FW: Tavern complaint

FYI. Angie Ward

Thank you,

Maribel Marillo

Legislative Assistant to
12th District
Alderman José Pérez
Office of the City Clerk
200 E. Wells St, Room 205
Milwaukee, WI 53212
414-286-2861
Dist12aide@milwaukee.gov

From: Perez, Jose
Sent: Wednesday, December 10, 2014 3:05 PM
To: Frank Sandino
Cc: Murillo, Maribel
Subject: Fwd: Tavern complaint

Sent from my Verizon Wireless 4G LTE smartphone

----- Original message -----

From: "Doherty, Patricia" <pdoherty@milwaukee.gov>

Date: 12/10/2014 2:57 PM (GMT-06:00)

To: "Perez, Jose" <JoseG.Perez@milwaukee.gov>

Subject: Tavern complaint

Hi Ald. Perez,

The post below was on our facebook page. We responded and let him know that this was not in our District and we'd be referring it to you. He got back to us and said that's fine.

Dec 6th, 12:55pm

Aldermen Donovan, please tell me why Club Mango on 16th and National is allowing under age kids in their club and why they are serving alcohol to minors. My daughter has been there the past few weekends and has come home blitzed each time. Unacceptable..... Please keep this confidential, and do what you can to rectify this issue. I will bug you each time she comes home this way until it ceases to happen. Thanks

Patty Doherty

Legislative Aide

Alderman Donovan

8th District

(414) 286-3533

Koberstein, Jonathan

From: License
Sent: Friday, November 07, 2014 2:23 PM
To: Koberstein, Jonathan
Subject: FW: Mango's Nightclub
Attachments: 4B220A32-B91C-405F-833D-EBC5784CB403.PNG; 926851_745321852205685_1029113539_a.jpg; 10729392_737399059663873_1845673710_a.jpg; IMG_0130.JPG

From: Pérez, Jose On Behalf Of Murillo, Maribel
Sent: Thursday, November 06, 2014 5:17 PM
To: License
Subject: FW: Mango's Nightclub

Can you please place this on file.

Thank you,

REDACTED RECORD

From the Office of:
Alderman Pérez

Maribel Murillo

Legislative Assistant to
José G. Pérez
Alderman-12th District
414-286-2861
MaribelMurillo@milwaukee.gov

From:
Sent: Wednesday, November 05, 2014 1:04 PM
To: Perez, Jose
Subject: Mango's Nightclub

Alderman Perez,

I am writing you this email and attaching advertisements for the new Mango's Nightclub at 16th and National. I am a resident of the area and was very concerned that Mango's would operate similar to Club International. I remember you saying at their License Application meeting that they would have a "different concept". Well I'm here to tell you that you were fooled. I have attached ads that clearly show that they are going down the Club International road and having Hip Hop after Hip Hop nights at their establishment. I thought they were going to be a Tropical themed venue, not a Hip Hop club with V100. There has been loud noise, traffic congestion and fights that I have personally witnessed. Can you please do something about this?

Thanks for your time,



selfmade_wigg

2h



414mostbeautiful

2h

FRIDAY
NOVEMBER
14TH

414 MOST BEAUTIFUL PRESENTS

1 YEAR ANNIVERSARY
HOOKAH PARTY

HOSTED BY
KAYLIN GARCIA

CO-HOSTED BY
SGATEZ

MUSIC BY
DJ.O

MANGOS

721 S CESAR E. DIAZ DRIVE
MILWAUKEE WI 53204
DOORS OPEN @ 9PM

HOOKAH PENS
WILL BE AVAILABLE
AT THE EVENT



1X



MENAGE A TRIO FRIDAY

\$10 FROZEN LANYARDS
\$3 TALL TEQUILA SUNRISE
\$5 CANCUN COLADAS

FREE CHERRY BOMBS 11-12PM
[FROM THE MCILLICUDDIES GIRLS]
\$100 VODKA BOTTLES

Bacon
BY THE BACON

\$200

1 Bottle of Melet
1 Bottle of Vodka
100 Shots
2 Accessories

FREE SHOTS FROM M.A.T. PROMOTIONAL GIRLS



Monday, August 31, 2015



Notice of Public Hearing

KIECKBUSCH, Gregory A, Agent
Mango's at 721 S Cesar E Chavez DR
Class B Tavern License and Public Entertainment Premises Renewal Application

Tuesday, September 08, 2015 at 2:00 PM

To whom it may concern:

The above application has been made by the above named applicant(s). This requires approval from the Licenses Committee and the Common Council of the City of Milwaukee. The hearing before the Licenses Committee will take place on 9/8/2015 at 2:00 PM, in Room 301-B, Third Floor, City Hall. If you wish, you may provide testimony at the hearing regarding the request; see below for further information. You are not required to attend the hearing. Once the Licenses Committee makes its recommendation, this recommendation is forwarded to the full Common Council for approval at its next regularly scheduled hearing. Please review the information below and if you have further questions regarding this process, please contact the License Division at (414) 286-2238.

Important details for those wishing to provide information for the Licenses Committee to consider when making its recommendation:

1. The license application is scheduled to be heard at the above time. Due to other hearings running longer than scheduled, you may have to wait some time to provide your testimony.
2. You must appear in person and testify as to matters that you have personally experienced or seen. (You cannot provide testimony for your neighbor, parent or anyone else; this is considered hearsay and cannot be considered by the committee.)
3. No letters or petitions can be accepted by the committee (unless the person who wrote the letter or the persons who signed the petition are present at the committee hearing and willing to testify).
4. Persons opposed to the license application are given the opportunity to testify first; supporters may testify after the opponents have finished.
5. When you are called to testify, you will be sworn in and asked to give your name, and address. (If your first and/or last names are uncommon please spell them.)
6. You may then provide testimony.
 - a. Include only information relating to the above license application.
 - b. Include only information you have personally witnessed or seen.
 - c. Provide concise and relevant information detailing how this business has affected or may affect the peaceful enjoyment of your neighborhood.
 - d. If by the time you have the opportunity to testify, the information you wish to share has already been provided to the committee, you may state that you agree with the previous testimony. Redundant or repetitive testimony will not assist the committee in making its recommendation.
7. After giving your testimony, the members of the Licenses Committee and the licensee may ask questions regarding the testimony you have given or other factors relating to the license application.
8. Business Competition is not a valid basis for denial or non-renewal of a license.
Please Note: If you have submitted an objection to the above application your objection cannot be considered by the committee unless you personally testify at the hearing.

[illegible]

CURRENT RESIDENT	1560 W PIERCE ST 412	MILWAUKEE, WI 53204-1239
CURRENT RESIDENT	1560 W PIERCE ST 413	MILWAUKEE, WI 53204-1239
CURRENT RESIDENT	1560 W PIERCE ST 414	MILWAUKEE, WI 53204-1239
CURRENT RESIDENT	1560 W PIERCE ST 501	MILWAUKEE, WI 53204-1239
CURRENT RESIDENT	1560 W PIERCE ST 502	MILWAUKEE, WI 53204-1239
CURRENT RESIDENT	1560 W PIERCE ST 503	MILWAUKEE, WI 53204-1239
CURRENT RESIDENT	1560 W PIERCE ST 504	MILWAUKEE, WI 53204-1239
CURRENT RESIDENT	1560 W PIERCE ST 505	MILWAUKEE, WI 53204-1239
CURRENT RESIDENT	1560 W PIERCE ST 506	MILWAUKEE, WI 53204-1239
CURRENT RESIDENT	1560 W PIERCE ST 507	MILWAUKEE, WI 53204-1239
CURRENT RESIDENT	1560 W PIERCE ST 508	MILWAUKEE, WI 53204-1239
CURRENT RESIDENT	1560 W PIERCE ST 509	MILWAUKEE, WI 53204-1239
CURRENT RESIDENT	1560 W PIERCE ST 510	MILWAUKEE, WI 53204-1239
CURRENT RESIDENT	1560 W PIERCE ST 512	MILWAUKEE, WI 53204-1239
CURRENT RESIDENT	1560 W PIERCE ST 513	MILWAUKEE, WI 53204-1239
CURRENT RESIDENT	1560 W PIERCE ST 514	MILWAUKEE, WI 53204-1239
CURRENT RESIDENT	1630 W NATIONAL AVE 101	MILWAUKEE, WI 53204-1132
CURRENT RESIDENT	1630 W NATIONAL AVE 102	MILWAUKEE, WI 53204-1132
CURRENT RESIDENT	1630 W NATIONAL AVE 103	MILWAUKEE, WI 53204-1132
CURRENT RESIDENT	1630 W NATIONAL AVE 104	MILWAUKEE, WI 53204-1132
CURRENT RESIDENT	1630 W NATIONAL AVE 105	MILWAUKEE, WI 53204-1132
CURRENT RESIDENT	1630 W NATIONAL AVE 106	MILWAUKEE, WI 53204-1132
CURRENT RESIDENT	1630 W NATIONAL AVE 107	MILWAUKEE, WI 53204-1177
CURRENT RESIDENT	1630 W NATIONAL AVE 201	MILWAUKEE, WI 53204-1177
CURRENT RESIDENT	1630 W NATIONAL AVE 202	MILWAUKEE, WI 53204-1177
CURRENT RESIDENT	1630 W NATIONAL AVE 203	MILWAUKEE, WI 53204-1177
CURRENT RESIDENT	1630 W NATIONAL AVE 204	MILWAUKEE, WI 53204-1177
CURRENT RESIDENT	1630 W NATIONAL AVE 205	MILWAUKEE, WI 53204-1177
CURRENT RESIDENT	1630 W NATIONAL AVE 206	MILWAUKEE, WI 53204-1133
CURRENT RESIDENT	1630 W NATIONAL AVE 207	MILWAUKEE, WI 53204-1133
CURRENT RESIDENT	1630 W NATIONAL AVE 208	MILWAUKEE, WI 53204-1133
CURRENT RESIDENT	1630 W NATIONAL AVE 209	MILWAUKEE, WI 53204-1133
CURRENT RESIDENT	1630 W NATIONAL AVE 301	MILWAUKEE, WI 53204-1178
CURRENT RESIDENT	1630 W NATIONAL AVE 302	MILWAUKEE, WI 53204-1178
CURRENT RESIDENT	1630 W NATIONAL AVE 304	MILWAUKEE, WI 53204-1178
CURRENT RESIDENT	1630 W NATIONAL AVE 305	MILWAUKEE, WI 53204-1178
CURRENT RESIDENT	1630 W NATIONAL AVE 306	MILWAUKEE, WI 53204-1134
CURRENT RESIDENT	1630 W NATIONAL AVE 307	MILWAUKEE, WI 53204-1134
CURRENT RESIDENT	1630 W NATIONAL AVE 308	MILWAUKEE, WI 53204-1134
CURRENT RESIDENT	1630 W NATIONAL AVE 309	MILWAUKEE, WI 53204-1134
CURRENT RESIDENT	1636 W NATIONAL AVE	MILWAUKEE, WI 53204-1129
CURRENT RESIDENT	1643 W PIERCE ST	MILWAUKEE, WI 53204-1109
CURRENT RESIDENT	1704 W NATIONAL AVE	MILWAUKEE, WI 53204-1137
CURRENT RESIDENT	1706 W NATIONAL AVE	MILWAUKEE, WI 53204-1137
CURRENT RESIDENT	1708 W NATIONAL AVE	MILWAUKEE, WI 53204-1137
CURRENT RESIDENT	1710 W NATIONAL AVE	MILWAUKEE, WI 53204-1137
CURRENT RESIDENT	714 S BETTINGER CT	MILWAUKEE, WI 53204-1101
CURRENT RESIDENT	714A S BETTINGER CT	MILWAUKEE, WI 53204-1101
CURRENT RESIDENT	715 S BETTINGER CT	MILWAUKEE, WI 53204-1102
CURRENT RESIDENT	715 S BETTINGER CT A	MILWAUKEE, WI 53204-1102
CURRENT RESIDENT	720 S BETTINGER CT	MILWAUKEE, WI 53204-1101
CURRENT RESIDENT	720A S BETTINGER CT	MILWAUKEE, WI 53204-1101
CURRENT RESIDENT	721 S BETTINGER CT	MILWAUKEE, WI 53204-1102
CURRENT RESIDENT	721A S BETTINGER CT	MILWAUKEE, WI 53204-1102

Total Records: 110

Radius: 250.0 feet and Center of Circle: 721 S Cesar E Chavez DR

2015-2016 Plan of Operation for 721 S CESAR E CHAVEZ DR

1. Litter and Noise

How are the grounds kept clean? ☒ Sweep ☐ Pressure Wash ☒ Pick Up Litter ☐ Other: _____

How often will grounds be cleaned? ☒ Daily ☐ Weekly ☐ Other: _____

Grounds Cleaned By: ☐ Licensee ☐ Building Owner ☒ Employees ☐ Hired Maintenance ☐ Other: _____

How are noise issues prevented and/or addressed? ☒ Security ☒ Manager approaches customer(s) ☐ Call Police

☐ Signs Posted ☐ Other: _____

2. Smoking and Sanitation

Are there designated outdoor smoking areas? ☐ No ☒ Yes

If yes, describe the area(s) and provide location(s): outside westside of building

Number of Garbage Cans: Inside: 10 Locations: bedrooms, kitchen, lobby, bar

Outside: 1 Locations: outside of building

Is a Crowd Control Barrier used? ☒ No ☐ Yes If yes, describe: _____

Describe sanitation facilities (restrooms): 17 restrooms

Provide name of solid waste contractor: Eagle disposal

3. Security

Are there parking spaces on the premises? ☐ No ☒ Yes If yes, number of spaces: 60 and describe security provisions:

outside security in parking area

Are there designated loading areas? ☒ No ☐ Yes If yes, describe security provisions _____

Do you have security personnel on the premise? ☐ No ☒ Yes If yes, how many? 6-20

AND What are their responsibilities? Maintain safety, premise clean, keep patrons under control

What security equipment do they use? security wands and radios

List their licensing, certification or training credentials: CPR

Are there security cameras? ☐ No ☒ Yes If yes, list all locations: _____

Are searches and/or identification checks conducted upon entry? ☐ No ☒ Yes If yes, describe: outside I.D. check

and wands and/or pat downs search.

4. Percentage of Sales (must total 100%)

Alcohol 60 % Food Sales 30 % Entertainment 10 % Other _____ %

5. Businesses On The Premise (choose all that apply):

- | | | | |
|---|--|---|---|
| <input checked="" type="checkbox"/> Full Service Restaurant | <input type="checkbox"/> Cafe/Coffee Shop | <input type="checkbox"/> Deli or Fast Food Rest. | <input type="checkbox"/> Private/Fraternal/Veterans' Club |
| <input checked="" type="checkbox"/> Night Club | <input checked="" type="checkbox"/> Tavern | <input checked="" type="checkbox"/> Cocktail Lounge | <input type="checkbox"/> Teen Club |
| <input type="checkbox"/> Bowling Alley | <input type="checkbox"/> Hotel | <input type="checkbox"/> Banquet Hall | <input type="checkbox"/> Sports Facility |
| <input type="checkbox"/> Liquor Store | <input type="checkbox"/> Corner Store | <input type="checkbox"/> Supermarket | <input type="checkbox"/> Convenience Store |
| <input type="checkbox"/> Gas Station | <input type="checkbox"/> Other _____ | | |

6. Hours of Operation and Age Restriction

Are there any changes to the current hours of operation or age restriction? ☒ No ☐ Yes If yes, describe _____

Please Note: If you will be open earlier or later than the hours listed on your current license for even one event or holiday (for example, St. Patrick's Day, Brewers Opening Day, etc.) during the license period, this must be reported and printed on your license.

Your hours of operation and age restriction are listed on your current license.

7. Floor Plan

Are there any changes to the current floor plan? ☒ No ☐ Yes If yes, describe _____

AND submit a new floor plan with this application. Changes in floor plan include changing the location of tables, games, etc. within your current licensed premises. If your changes include adding any additional areas or square footage to your premises, or any renovations to the building will be done, a Permanent Extension of Premises application must be filed.

PUBLIC ENTERTAINMENT PREMISES RENEWAL SUPPLEMENTARY APPLICATION

CCL-PEP3 2/18/15

(1) CURRENT ENTERTAINMENT

The following types of entertainment have been approved for your current Public Entertainment Premises license:
Instrumental Musicians, Bands, Battle of the Bands, Comedy Acts, Disc Jockey, Poetry Readings, Dancing by Performer(s), Patrons
Dancing, Jukebox, Karaoke

(2) SELECT ANY TYPES OF ENTERTAINMENT THAT YOU ARE REQUESTING TO ADD *No changes in entertainment shall take place until approved by the Common Council and a new license has been issued and posted on the premises.

<input type="checkbox"/> Instrumental Musicians	<input type="checkbox"/> Bands	<input type="checkbox"/> Battle of the Bands	<input type="checkbox"/> Comedy Acts
<input checked="" type="checkbox"/> Disc Jockey	<input type="checkbox"/> Magic Shows	<input type="checkbox"/> Poetry Readings	<input type="checkbox"/> Dancing by Performers
<input type="checkbox"/> Jukebox	<input type="checkbox"/> Wrestling	<input type="checkbox"/> Patron Contests	<input checked="" type="checkbox"/> Patrons Dancing
<input type="checkbox"/> Adult Entertainment/ Strippers/Erotic Dance	<input type="checkbox"/> Karaoke	<input type="checkbox"/> Bowling Alley	<input type="checkbox"/> Pool Tables
<input type="checkbox"/> Motion Pictures	<input type="checkbox"/> Amusement Machines –	<input type="checkbox"/> Concerts	<input type="checkbox"/> Theatrical Performances
How many screens? _____	How many? _____	Approx. # per year? _____	Approx. # per year? _____
<input type="checkbox"/> Other: _____			

(3) REMOVE ENTERTAINMENT

If applicable, list any entertainment you wish to remove: _____

(4) WILL PROMOTERS EVER BE USED FOR ANY OF THE ENTERTAINMENT?

☐ No ☒ Yes, describe: Special Events

(5) LEGAL CAPACITY OF PREMISES

299 (Call the Milwaukee Development Center at 414-286-8211 if you have questions.) Your legal capacity will determine the license fee for your Public Entertainment Premise License. If you would like to request that the license be approved with a lower capacity than that listed above, indicate lower capacity _____. If approved, this lower capacity will print on your license and override the capacity listed on your Occupancy Permit.

(6) IDENTIFY IF SOUND AMPLIFICATION IS USED

☒ No ☐ Yes, describe: _____

(7) DECLARATIONS, ACKNOWLEDGEMENTS, & DISCLOSURES

Read And Initial Each Item Confirming Your Understanding:

- 1 ☒ I understand that after the license has been issued, a change to the plan of operation will require a written request to change and approval from the Common Council.
- 2 ☒ I agree to inform the City Clerk within 10 days of any substantial changes in the information supplied in this application.
- 3 ☒ I understand that I shall not willfully refuse to provide the services offered under this license, or add charges or require deposits not required of the general public because of race, color, sex, religion, national origin or ancestry, age, handicap, lawful source of income, marital status, sexual orientation, gender identity or expression, familial status or the fact that a person is now or has been a member of the military service, whether dressed in uniform or not; and shall not seek such information as a condition of employment, or penalize any employee or discriminate in the selection of personnel for training or promotion on the basis of such information.
- 4 ☒ I have knowledge of the City Ordinances currently regulating public entertainment, and understand that the license may be subject to suspension, non-renewal or revocation, if I violate any rule, law or regulation of the city of Milwaukee and State of Wisconsin.

(8) NOTARIZED SIGNATURES OF APPLICANTS

SUBSCRIBED AND SWORN TO BEFORE ME

This 30 day of JULY, 20 18

Teresa Hernandez
(Clerk/Notary Public)
My Commission Expires 7/26/2018

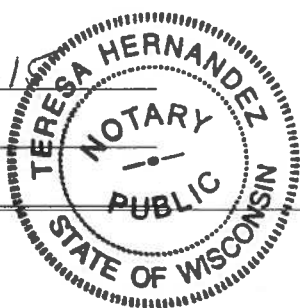

Gregory A. Kieckbush

Agent/Owner/Partner

Francisco Sandoval

Additional Owner/Partner

*Notary Seal must be affixed.