



CITY OF MILWAUKEE
OFFICE OF THE CITY CLERK

Monday, August 31, 2015

COMMITTEE MEETING NOTICE

AD 08

ZARATE, Mario J, Agent
MJZARATE, LLC
3101 W LINCOLN Av

MILWAUKEE, WI 53215

You are requested to attend a hearing which is to be held in Room 301-B, Third Floor, City Hall on:

Tuesday, September 08, 2015 at 09:00 AM

Regarding: Your Class B Tavern and Public Entertainment Premises License Renewal Applications as agent for "MJZARATE, LLC" for "GRADY'S SALOON" at 3101 W LINCOLN Av.

There is a possibility that your application may be denied for one or more of the following reasons: The recommendation of the committee regarding the application shall be based on evidence presented at the hearing. Per MCO 85-2.7-4, probative evidence concerning whether or not a new license should be granted may be presented on the following subjects: whether or not the applicant meets the municipal requirements, the appropriateness of the location and premises where the licensed premises is to be located and whether use of the premises for the purposes or activities permitted by the license would tend to facilitate a public or private nuisance or create undesirable neighborhood problems such as disorderly patrons, unreasonably loud noise, litter, and excessive traffic and parking congestion. Probative evidence relating to these matters may be taken from the plan of operation submitted with the license application, if any, but shall not include the content of any music. Evidence regarding the fitness of the location of the premises to be maintained as the principal place of business, including but not limited to whether there is an overconcentration of businesses of the type for which the license is sought; whether the proposal is consistent with any pertinent neighborhood business or development plans, or the location's proximity to areas where children are typically present. The applicant's record in operating similarly licensed premises; and whether or not the applicant has been charged with or convicted of any felony, misdemeanor, municipal offense or other offense, the circumstances of which substantially relate to the activity to be permitted by the license being applied for or any other factor which reasonably relates to the public health, safety or welfare may also be considered. See attached police report or correspondence.

**Notice for applicants with
warrants or unpaid fines:**

Proof of warrant satisfaction or payment of fines must be submitted at the hearing on the above date and time. Failure to comply with this requirement may result in a delay of the granting/denial of your application.

Failure to appear at this meeting may result in the denial of your license. Individual applicants must appear only in person or by an attorney. Corporate or Limited Liability applicants must appear only by the agent designated on the application or by an attorney. Partnership applicants must appear by a partner listed on the application or by an attorney. If you wish to do so and at your own expense, you may be accompanied by an attorney of your choosing to represent you at this hearing.

You will be given an opportunity to speak on behalf of the application and to respond and challenge any charges or reasons given for the denial. No petitions can be accepted by the committee, unless the people who signed the petition are present at the committee hearing and willing to testify. You may present witnesses under oath and you may also confront and cross-examine opposing witnesses under oath. If you have difficulty with the English language, you should bring an interpreter with you, at your expense, so that you can answer questions and participate in your hearing.

You may examine the application file at this office during regular business hours prior to the hearing date. Inquiries regarding this matter may be directed to the person whose signature appears below.

Limited parking for persons attending meetings in City Hall is available at reduced rates (5 hour limit) at the Milwaukee Center on the southwest corner of East Kilbourn and North Water Street. Parking tickets must be validated in the first floor information booth in City Hall.

PLEASE NOTE: Upon reasonable notice, efforts will be made to accommodate the needs of disabled individuals through sign language interpreters or other auxiliary aids. For additional information or to request this service, contact the Council Services Division ADA Coordinator at (414) 286-2998, Fax - (414) 286-3456, TDD - (414) 286-2025.

JIM OWCZARSKI, CITY CLERK

BY:

Jason Schunk

License Division Manager

If you have questions regarding this notice, please contact the License Division at (414) 286-2238.

200 E. Wells Street, Room 105, City Hall, Milwaukee, WI 53202. www.milwaukee.gov/license
Phone: (414) 286-2238 Fax: (414) 286-3057 Email Address: License@milwaukee.gov



**CITY OF MILWAUKEE
OFFICE OF THE CITY CLERK**

Monday, August 31, 2015

COMMITTEE MEETING NOTICE

AD 08

ZARATE, Mario J, Agent
MJZARATE, LLC
1963 S Layton Ave

MILWAUKEE, WI 53215

You are requested to attend a hearing which is to be held in Room 301-B, Third Floor, City Hall on:

Tuesday, September 08, 2015 at 09:00 AM

Regarding: Your Class B Tavern and Public Entertainment Premises License Renewal Applications as agent for "MJZARATE, LLC" for "GRADY'S SALOON" at 3101 W LINCOLN Av.

There is a possibility that your application may be denied for one or more of the following reasons: The recommendation of the committee regarding the application shall be based on evidence presented at the hearing. Per MCO 85-2.7-4, probative evidence concerning whether or not a new license should be granted may be presented on the following subjects: whether or not the applicant meets the municipal requirements, the appropriateness of the location and premises where the licensed premises is to be located and whether use of the premises for the purposes or activities permitted by the license would tend to facilitate a public or private nuisance or create undesirable neighborhood problems such as disorderly patrons, unreasonably loud noise, litter, and excessive traffic and parking congestion. Probative evidence relating to these matters may be taken from the plan of operation submitted with the license application, if any, but shall not include the content of any music. Evidence regarding the fitness of the location of the premises to be maintained as the principal place of business, including but not limited to whether there is an overconcentration of businesses of the type for which the license is sought; whether the proposal is consistent with any pertinent neighborhood business or development plans, or the location's proximity to areas where children are typically present. The applicant's record in operating similarly licensed premises; and whether or not the applicant has been charged with or convicted of any felony, misdemeanor, municipal offense or other offense, the circumstances of which substantially relate to the activity to be permitted by the license being applied for or any other factor which reasonably relates to the public health, safety or welfare may also be considered. See attached police report or correspondence.

**Notice for applicants with
warrants or unpaid fines:**

Proof of warrant satisfaction or payment of fines must be submitted at the hearing on the above date and time. Failure to comply with this requirement may result in a delay of the granting/denial of your application.

Failure to appear at this meeting may result in the denial of your license. Individual applicants must appear only in person or by an attorney. Corporate or Limited Liability applicants must appear only by the agent designated on the application or by an attorney. Partnership applicants must appear by a partner listed on the application or by an attorney. If you wish to do so and at your own expense, you may be accompanied by an attorney of your choosing to represent you at this hearing.

You will be given an opportunity to speak on behalf of the application and to respond and challenge any charges or reasons given for the denial. No petitions can be accepted by the committee, unless the people who signed the petition are present at the committee hearing and willing to testify. You may present witnesses under oath and you may also confront and cross-examine opposing witnesses under oath. If you have difficulty with the English language, you should bring an interpreter with you, at your expense, so that you can answer questions and participate in your hearing.

You may examine the application file at this office during regular business hours prior to the hearing date. Inquiries regarding this matter may be directed to the person whose signature appears below.

Limited parking for persons attending meetings in City Hall is available at reduced rates (5 hour limit) at the Milwaukee Center on the southwest corner of East Kilbourn and North Water Street. Parking tickets must be validated in the first floor information booth in City Hall.

PLEASE NOTE: Upon reasonable notice, efforts will be made to accommodate the needs of disabled individuals through sign language interpreters or other auxiliary aids. For additional information or to request this service, contact the Council Services Division ADA Coordinator at (414) 286-2998, Fax - (414) 286-3456, TDD - (414) 286-2025.

JIM OWCZARSKI, CITY CLERK

BY:

Jason Schunk
License Division Manager

If you have questions regarding this notice, please contact the License Division at (414) 286-2238.

200 E. Wells Street, Room 105, City Hall, Milwaukee, WI 53202. www.milwaukee.gov/license
Phone: (414) 286-2238 Fax: (414) 286-3057 Email Address: License@milwaukee.gov

MILWAUKEE POLICE DEPARTMENT
LICENSE INVESTIGATION UNIT

CRIMINAL RECORD/ORDINANCE VIOLATION/INCIDENTS
SYNOPSIS

DATE: 06/30/2015

LICENSE TYPE: CLASS B TAVERN

NEW:

RENEWAL: X

No. 213830

Application Date: 06/29/2015

Expiration Date:

License Location: 3101 WEST LINCOLN AVENUE

Aldermanic District: 08

Business Name: GRADY'S SALOON

Licensee/Applicant: ZARATE, MARIO

(Last Name, First Name, MI)

Date of Birth: 11-12-1973

Male: X **Female:**

Home Address: 1963 SOUTH LAYTON BLVD

City: MILWAUKEE

State: WIS

Zip Code: 53215

Home Phone: 313—0829

This report is written by Police Officer David NOVAK, assigned to the License Investigation Unit, Days.

The Milwaukee Police Department's investigation regarding this application revealed the following:

1. Applicant has conviction for Operating Auto Intoxicated 1991 – license suspended 6 months

2. On 11-4-05, Police officers, along with an underage police aide, conducted a premises check at Grady's Saloon, 3101 W Lincoln Avenue. The police aide approached the bartender and ordered three bottles of Miller Lite beer. The bartender asked the police aide for ID which he produced. It clearly stated he was under 21, until 12-05. The bartender sold the beer to the police aide. The licensee was issued the following citation.

Charge: Sale to Underage
Finding: guilty
Sentence: Suspended sentence
Date: 2-27-06
Case: 05123233
Citation: 59113563

3. On 04/18/07 at 10:35 pm, Milwaukee police were dispatched to 3101 W Lincoln for a Fight complaint. Police spoke to the bartender, Yolanda Sanchez, who stated several patrons started to argue with another when it escalated with ashtrays and glasses being thrown. The patrons who started the fight were thrown out of the tavern when one subject grabbed a pipe and broke the front windows to the tavern. That subject then fled in an auto. A report was filed regarding the property damage.

4. On 07/18/08 at 11:29 pm, Milwaukee police were flagged down at 3101 W Lincoln for a Trouble With Subject complaint. Officers spoke to Mario Zarate who stated a patron inside the tavern was asking customers for drugs and knocking things off the bar causing a disturbance. Zarate stated he did not want a ticket issued however wanted the patron to know that she was not welcomed in the bar. Officers spoke to the patron who stated she did have a couple of drinks and was looking for some drugs because she was told she could get drugs from inside Grady's Saloon. The patron was arrested on a probation violation.
5. On 07/27/08 at 12:47 am, Milwaukee police were dispatched to 3101 W Lincoln for a Fight complaint. Officers spoke to the bartender Rosalinda Zarate who stated that two patrons were intoxicated and began to argue with her and other customers in the tavern. Zarate stated she told the subjects that she would no longer serve and that they should leave. As the patrons left they began yelling that they had guns and would shoot up the tavern. Zarate stated the subjects were outside of the tavern when she locked the front door and the subjects began banging on the doors and windows causing damage to a window. The actors were gone when police arrived. A report was filed.
6. On 09/27/08 at 11:47 pm, Milwaukee police were conducting Sales of Alcohol To Underage Persons and had a police aide who is under the age of 21 enter 3101 W Lincoln in attempts to purchase alcohol. The bartender, identified as Jesse Zarate, sold a Jagerbomb without asking for any identification. A citation was issued to Jesse Zarate for Sale to Underage Prohibited and the licensee, Mario Zarate, was issued a citation for Presence of Minor At Licensed Premise.

As to Jesse Zarate:

Charge:	Sale of Alcohol To Underage
Finding:	Guilty
Sentence:	Fined \$160.00
Date:	11/21/08
Case:	08131292

As to Mario Zarate:

Charge:	Presence of Minor At Licensed Premise
Finding:	Dismissed w/o prejudice
Date:	03/05/09
Case:	08131293

=====

7. On 10/24/2013 the applicant was cited in the City of Milwaukee at 1963 S Layton Av for Building Code Violations.

Charge:	Building Code Violations
Finding:	Guilty
Sentence:	Fined \$2000.00
Date:	04/16/2015
Case:	14075915

8. On 05/04/2014 at 1:11am officer were dispatched to 3102 W. Lincoln Ave to investigate a shots fired complaint, which is directly across the street from Grady's Saloon. The victim stated he had exited Grady's Saloon and was driving westbound on W. Lincoln Av when a known subject started shooting at him. He continued to drive westbound. The victim's auto was hit but the victim was uninjured. The victim stated he had no problems while inside Grady's Saloon.
9. On 05/11/2014 at 12:49am officer went to Grady's salon at 3101 W. Lincoln Av for a tavern check. During the check the officer was not able to observe an occupancy sign. The bartender Shannon HEREDIA called the applicant who advised her where the sign was located, which was behind a cooler. The officer also observed 5 amusement machines. The PEP for the business allowed 2 amusement machine. The applicant was given a warning on the amusement machines and issued a citation for the Occupancy must be posted.

Charge: Occupancy must be posted

Finding: Refused by City Attorney

Sentence:

Date:

Case: 48968711045

10. On 10/21/2014 at 4:43pm officers were dispatched to Grady's Saloon at 3101 W. Lincoln Av for an entry complaint. The investigation revealed that someone entered through the patio door between the hours of 2:00am and 4:00pm. Taken was 10 bottles of alcohol. The applicant was cooperative during the investigation. The bar has cameras but they were not working at the time of the incident.
11. On 12/14/2014 at 2:07am officers were dispatched to a subject with gun complaint at Grady's Saloon, 3101 W. Lincoln Av. Upon arrival officers spoke with Vanessa ZARATE. She stated the call was placed by a patron who believed a subject that shot at him earlier in the year was outside. The patron and subject were gone when the police arrived. Follow up was conducted on 02/05/2015. Officers again spoke with Vanessa ZARATE who stated she was taking over management of the tavern from her father. She stated that a bartender has been fired and a patron named "Meni" has been banned.
12. On 01/31/2015 at 1:31am officers were dispatched to Grady's Saloon at 3101 W. Lincoln Av for a shots fired complaint. Upon arrival the bar was locked and appeared closed. A bullet hole was located in the lower portion of the front door. There were 7 casings located across the street. A bartender Shannon HEREDIA eventually came to the door. She stated she was the only one in the bar but she was unable to let police in because the door locked behind her when she closed the door. Vanessa ZARATE was contacted by phone and she stated her father was aware of the incident but was no coming out since he was told the tavern was not involved. Vanessa ZARATE did come out and let the officers inside to continue the investigation. They recovered the bullet that entered the building. It is not known if the business or any of the patrons were the target.
13. On 02/05/2015 there was a meeting at District 2 regarding Grady's Saloon, 3101 W. Lincoln Av. Mario ZARATE and his daughter Vanessa ZARATE were in attendance. ZARATE was advised that his tavern was being investigated for nuisance eligibility based on three incidents. ZARATE stated both parties involved in the May shooting have been banned from the bar. He stated that in the January shooting it was the bartender that would not cooperate and she was fired. He stated he would provide police with names of patron in the bar that night. ZARATE stated the bartenders are responsible for checking ID's if there is no doorman. He has 5

cameras but they are not currently working. He was advised to call the police when there are problems and cooperating will not be used against him later.

14. On 02/11/2015 officers went along with the Department of Revenue to Grady's Saloon at 3101 W. Lincoln Ave. for a tavern check. The agent found 5 contaminated bottle of liquor and confiscated 50 bottles of liquor that were purchased at a grocery store instead of a wholesaler. The agent was cooperative but upset his liquor was confiscated.

MILWAUKEE POLICE DEPARTMENT**REPORT OF INCIDENTS INVOLVING LICENSED PERSONS OR PREMISES**

TO: Captain Alfonso MORALES

Business Name: Grady's Saloon

Address of Licensed Premises: 3101 W Lincoln Ave

Business Phone: 643-9819

Type of License: Class B Tavern License

District: 2

☐ Violation / ☒ Incident # 14-124-0016

Date of Incident: 5-4-14

Licensee or Manager on premises at time of violation / incident? ☒ Yes ☐ NoLicensee cooperative? ☐ Yes ☐ No (if no, explain in narrative section)

Licensee Notified by Officer: PO Joleen LOPEZ

Date: 5-4-14

Time: 2:00am

Licensee or Agent's Name: Mario J ZARATE

Home Address: 1963 S Layton Blvd

Date of Birth: 11-12-73

Home Phone: 313-0829

Co-Licensee Name:

Home Address:

Class S License Number:

Date of Birth:

Home Phone:

Bartender Name:

Home Address:

Class D License Number:

Date of Birth:

Home Phone:

Licensed Person / Public Pass. Vehicle, etc.:

Home Address:

Class D License Number:

Date of Birth:

Home Phone:

VIOLATION/INCIDENT – DESCRIBE FACTS AND CIRCUMSTANCES IN NARRATIVE SECTION

Name of Person Cited:

Citation Number:

Violation & Ord. / Statue No.:

Date of Birth:

Court Date:

Name of Person Cited:

Citation Number:

Violation & Ord. / Statue No.:

Date of Birth:

Court Date:

Name of Person Cited:

Citation Number:

Violation & Ord. / Statue No.:

Date of Birth:

Court Date:

Name of Person Cited:

Citation Number:

Violation & Ord. / Statue No.:

Date of Birth:

Court Date:

Name of Person Cited:

Citation Number:

Violation & Ord. / Statue No.:

Date of Birth:

Court Date:

Investigating Officer: PO Eliel CONTRERAS

District / Bureau: 24

Date: 3-2-15

Commanding Officer

Date

DISPOSITION – FOR LICENSING ONLY

Citation No.	Case Number	Disposition	Judge	Date

LICENSE INVESTIGATION UNIT

Received 5-27-15

Referred

By

This report is written by PO Eliel CONTRERAS assigned to District 2, Late Power Shift.

On Sunday, 5-4-14, at approximately 1:11am Squad 2490 (PO Jolene LOPEZ) was dispatched to 3102 W Lincoln Ave for a shots fired complaint (IR# 141240016), which was directly across the street from Grady's Saloon (3101 W Lincoln Ave). While investigating the incident, it was determined, that the victims, Herminio VEGA (W/M 11-4-74) and Madeline CRESPO (W/F 1-22-83) who were at Grady's saloon, left Grady's at approximately 1:08am and got into his 1970, green in color with gray stripes, 2dr Chevy Nova. As VEGA and CRESPO drove off westbound on Lincoln Ave, a known subject stood in the roadway of eastbound traffic and started shooting at him. Prior to being shot at, VEGA stated he observed the known subject standing on a church stairwell at 3102 W Lincoln Ave. After hearing the gun shots, VEGA stated he concealed himself in the vehicle by positioning his body in a low seated position. VEGA also stated he pushed CRESPO's head down towards the floor of the vehicle to protect her. VEGA then stated he drove westbound on W Lincoln Ave until he reached S 35th St and W Lincoln Ave. VEGA described the firearm used in the offense as a black in color semi-automatic .45 caliber pistol. At the time of the incident, VEGA did not want to reveal the subject's identity involved in the incident because he feared for his and his family's safety. While at Grady's Saloon, VEGA stated he did not have any altercations with anyone. VEGA's vehicle had large caliber bullet holes to the trunk and driver's side. End of report.

SAT
BIG

MILWAUKEE POLICE DEPARTMENT

REPORT OF INCIDENTS INVOLVING LICENSED PERSONS OR PREMISES

TO: Captain Alfonso MORALES

Business Name: Grady's Saloon

Address of Licensed Premises: 3101 W Lincoln Ave

Business Phone: 643-9819

Type of License: Class B 0201261

**ORIGINAL**

District: 2

☒ Violation / ☐ Incident #

Date of Incident: 5-11-14

Licensee or Manager on premises at time of violation / incident? ☐ Yes ☒ NoLicensee cooperative? ☐ Yes ☒ No (if no, explain in narrative section)

Licensee Notified by Officer: PO CONTRERAS

Date: 5-12-14

Time: 1:00am

Licensee or Agent's Name: Mario J ZARATE

Home Address: 3101 W Lincoln Ave

Date of Birth: 11-12-73

Home Phone: 414-313-0829

Co-Licensee Name:

Home Address:

Class S License Number:

Date of Birth:

Home Phone:

Bartender Name: Shannon M HEREDIA

Home Address: 5335 W Forest Home Ave #3

Class D License Number: 0207624

Date of Birth: 12-08-80

Home Phone: 628-1510

Licensed Person / Public Pass. Vehicle, etc.:

Home Address:

Class D License Number:

Date of Birth:

Home Phone:

VIOLATION/INCIDENT - DESCRIBE FACTS AND CIRCUMSTANCES IN NARRATIVE SECTION

Name of Person Cited: Mario J ZARATE

Citation Number: 48968711045

Violation & Ord. / Statue No.: Limit Posting 85-23-2

Date of Birth: 11-12-73

Court Date: 07-09-14

Name of Person Cited:

Citation Number:

Violation & Ord. / Statue No.:

Date of Birth:

Court Date:

Name of Person Cited:

Citation Number:

Violation & Ord. / Statue No.:

Date of Birth:

Court Date:

Name of Person Cited:

Citation Number:

Violation & Ord. / Statue No.:

Date of Birth:

Court Date:

Name of Person Cited:

Citation Number:

Violation & Ord. / Statue No.:

Date of Birth:

Court Date:

Investigating Officer: PO Eliel CONTRERAS

District / Bureau: 24

Date: 05-12-14

Commanding Officer

Date

DISPOSITION - FOR LICENSING ONLY

Citation No.	Case Number	Disposition	Judge	Date

LICENSE INVESTIGATION UNIT

Received

Referred

By

This report is written by PO Eliel CONTRERAS assigned to District 2, Late Power Shift. On Sunday, 5-11-14 at approximately 12:49am Squad 2441 (PO Keith MILLER and I) and Squad 2410 (Sgt. Hollis SMITH) responded to 3101 W Lincoln Ave to conduct a tavern check at this location. Upon arriving on scene, I spoke with the bartender, Shannon M HEREDIA (W/F 12-8-80), HEREDIA was very cooperative and provided all the information needed for this inspection. While on scene, I asked HEREDIA if she could show me where the occupancy sign was visibly posted and she was not able to locate it. HEREDIA then called the owner, who then told her the location of the occupancy sign. The occupancy sign was located on the southeast end of the bar barely hanging vertically from a wall and being obstructed by a large cooler (approximately 6x4 feet tall and wide).

Their Class D Tavern License permitted 1 Jukebox, 2 Amusement Machines, and 1 Pool Table. While on scene I observed five amusement machines located on the southeast end of the tavern.

The following are the amusement machines that I observed at the tavern.

1. Boxer knockout amusement machine
2. Big Buck Hunter 2 amusement machine
3. Video slot amusement machine
4. Power Player Big Daddy Games LLC amusement machine
5. Electronic Dart Game amusement machine

HEREDIA was informed that the owner would be cited for the violations, which were observed during our inspection. A check with the Department listed Mario J ZARATE (W/M/11-12-73) as the licensee of the establishment. A telephone was made to ZARATE and a voice message was left. ZARATE spoke with P.O. Keith MILLER via telephone on 05-17-14. During that conversation ZARATE stated he did not know that he needed to add additional game machines to his license. ZARATE was cited for the occupancy posting and advised regarding the game machines.

MILWAUKEE POLICE DEPARTMENT

REPORT OF INCIDENTS INVOLVING LICENSED PERSONS OR PREMISES

TO: Captain of Police Alfonso MORALES

Business Name: Grady's Salon

Address of Licensed Premises: 3101 W. Lincoln Ave

Business Phone: 643-9819

Type of License: Class B Tavern 0202251

District: 2

☐ Violation / ☐ Incident # 14-294-0112

Date of Incident: 10/21/14

Licensee or Manager on premises at time of violation / incident? ☐ Yes ☒ NoLicensee cooperative? ☒ Yes ☐ No (if no, explain in narrative section)

Licensee Notified by Officer: PO PANFIL

Date: 10/21/14

Time: 4:43pm

Licensee or Agent's Name: Mario J. ZARATE

Home Address: 1963 S. Layton Bl.

Date of Birth: 11/12/1973

Home Phone: 313-0829

Co-Licensee Name:

Home Address:

Class S License Number:

Date of Birth:

Home Phone:

Bartender Name:

Home Address:

Class D License Number:

Date of Birth:

Home Phone:

Licensed Person / Public Pass. Vehicle, etc.:

Home Address:

Class D License Number:

Date of Birth:

Home Phone:

VIOLATION/INCIDENT – DESCRIBE FACTS AND CIRCUMSTANCES IN NARRATIVE SECTION

Name of Person Cited:

Citation Number:

Violation & Ord. / Statue No.:

Date of Birth:

Court Date:

Name of Person Cited:

Citation Number:

Violation & Ord. / Statue No.:

Date of Birth:

Court Date:

Name of Person Cited:

Citation Number:

Violation & Ord. / Statue No.:

Date of Birth:

Court Date:

Name of Person Cited:

Citation Number:

Violation & Ord. / Statue No.:

Date of Birth:

Court Date:

Name of Person Cited:

Citation Number:

Violation & Ord. / Statue No.:

Date of Birth:

Court Date:

Investigating Officer: PO Kevin PANFIL

District / Bureau: 22

Date: 10/21/2014

 Commanding Officer

 Date
DISPOSITION – FOR LICENSING ONLY

Citation No.	Case Number	Disposition	Judge	Date

LICENSE INVESTIGATION UNIT

Received

Referred

By

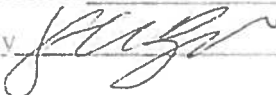

PA-33E Narrative

This report is written by PO Kevin PANFIL, assigned to District 2, early shift. On Tuesday, October 21, 2014 at 4:43pm, I along with my partner PO Marisa JIMENEZ, squad 2221, were dispatched to an entry complaint at Grady's Saloon located at 3101 W. Lincoln Avenue.

Upon arrival, I spoke to the owner, who was identified as Mario J. ZARATE, who stated that he dropped off his wife at the location at approximately 4:00pm to open the bar and she then advised him that the back door was open, which had been closed when they last left the location on Monday, October 20, 2014 at approximately 2:00am. ZARATE stated that his wife then called 911 to report the incident.

ZARATE stated that he then went to the location and observed that entry was possibly gained through the side patio doors near the beer garden which is located on the west side of the business. ZARATE stated that 10 bottles of liquor were taken from behind the bar and that nothing else was obtained.

ZARATE stated that the interior of the bar does have cameras but they are not working at this time because the computer that they are connected to does not work. ZARATE stated that he has owned the bar for 9 year, never had a burglary before at the location, and has Badger Mutual Insurance.

ZARATE and his wife were cooperative during the investigation and all licenses were properly posted and valid.

MILWAUKEE POLICE DEPARTMENT

REPORT OF INCIDENTS INVOLVING LICENSED PERSONS OR PREMISES

TO: Captain Alfonso Morales

ORIGINAL

Business Name: Grady's Saloon

Address of Licensed Premises: 3101 W. Lincoln Ave.

Business Phone: 643-9819

Type of License: Class B Tavern

District: 2

☐ Violation / ☐ Incident #

Date of Incident: 12/14/2014

Licensee or Manager on premises at time of violation / incident? ☒ Yes ☐ NoLicensee cooperative? ☒ Yes ☐ No (If no, explain in narrative section)

Licensee Notified by Officer: P.O. Joseph Ratkowski

Date: 12/14/2014

Time: 02:30 am

Licensee or Agent's Name: Mario J. Zarate

Home Address: 1963 S. Layton Blvd.

Date of Birth: 11/12/1973

Home Phone: 313-0829

Co-Licensee Name:

Home Address:

Class S License Number:

Date of Birth:

Home Phone:

Bartender Name: Mario J. Zarate

Home Address: 1963 S. Layton Blvd.

Class D License Number: 0208091

Date of Birth: 11/12/1973

Home Phone: 313-0829

Licensed Person / Public Pass. Vehicle, etc.:

Home Address:

Class D License Number:

Date of Birth:

Home Phone:

VIOLATION/INCIDENT – DESCRIBE FACTS AND CIRCUMSTANCES IN NARRATIVE SECTION

Name of Person Cited:

Citation Number:

Violation & Ord. / Statue No.:

Date of Birth:

Court Date:

Name of Person Cited:

Citation Number:

Violation & Ord. / Statue No.:

Date of Birth:

Court Date:

Name of Person Cited:

Citation Number:

Violation & Ord. / Statue No.:

Date of Birth:

Court Date:

Name of Person Cited:

Citation Number:

Violation & Ord. / Statue No.:

Date of Birth:

Court Date:

Name of Person Cited:

Citation Number:

Violation & Ord. / Statue No.:

Date of Birth:

Court Date:

Investigating Officer: PO Joseph Ratkowski

District / Bureau: 23

Date: 2/5/15

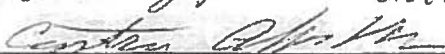

Commanding Officer

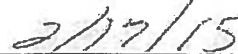

Date

DISPOSITION – FOR LICENSING ONLY

Citation No.	Case Number	Disposition	Judge	Date

LICENSE INVESTIGATION UNIT

Received

Referred

By

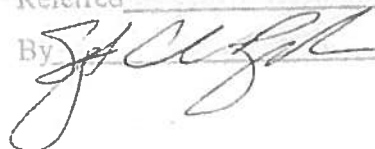

This report is written by P.O. Joseph Ratkowski assigned to District Two, Late Shift. On 12/14/14 I was assigned to squad 2340, at 2:07 am we were dispatched to a subject with gun compalint at 3101 W. Lincoln Ave Grady's Saloon. Upon arrival we spoke with the Tavern owner's daughter identified as Vanessa M. Zarate w/f, 10/20/93. Zarate related to us that the call had been placed to police because a patron believed that a subject that had fired a gun at him earlier in the year in the neighborhood was outside of the tavern. Zarate related that the patron, and the aleged subject with a gun had left prior to our arrival. At the time of out arrival, 2:15 am the tavern was in the process of closing and most of the patrons left upon our arrival to the tavern. There was no description of the suspect by the unidentified caller to police, with no call back number. Neither party was located at that time. The owner of the tavern Mario J Zarate was at the taven at that time and he and his daughter were cooperative with police. I observed no violations at that time.

We conducted follow up regarding this incident on 2/5/15. We again spoke with Vanessa Zarate regarding the incident. Zarate admitted that several incidents have occurred at, or outside of the tavern involving patrons having a gun, or firing shots outside of the tavern. Zarate related that recently a bartender had been let go, and that she was taking over management of the tavern from her father, Mario. Zarate related that a subject known to her as "Meni" has been banned from being served at the bar, and may have been involved in some of these recent incidents. Zarate was coopertive with the police, and noted that she wishes to continue to cooperate and has a meeting scheduled with officers working with the CPU at District Two.

MILWAUKEE POLICE DEPARTMENT

REPORT OF INCIDENTS INVOLVING LICENSED PERSONS OR PREMISES

TO: Captain Alfonso MORALES



Business Name: Grady's Saloon

Address of Licensed Premises: 3101 W. Lincoln Av.

Business Phone: 643-9819

Type of License: Class "B" Tavern

District: 2

☐ Violation / ☒ Incident # 15-031-0010

Date of Incident: 01-31-15

Licensee or Manager on premises at time of violation / incident? ☐ Yes ☒ NoLicensee cooperative? ☐ Yes ☒ No (if no, explain in narrative section)

Licensee Notified by Officer: P.O. J. GONZALEZ

Date: 01-31-15

Time: 2:15am

Licensee or Agent's Name: ZARATE, Mario J

Home Address: 1963 S. Layton Blvd.

Date of Birth: 11/12/73

Home Phone:

Co-Licensee Name:

Home Address:

Class S License Number:

Date of Birth:

Home Phone:

Bartender Name:

Home Address:

Class D License Number:

Date of Birth:

Home Phone:

Licensed Person / Public Pass. Vehicle, etc.:

Home Address:

Class D License Number:

Date of Birth:

Home Phone:

VIOLATION/INCIDENT – DESCRIBE FACTS AND CIRCUMSTANCES IN NARRATIVE SECTION

Name of Person Cited:

Citation Number:

Violation & Ord. / Statute No.:

Date of Birth:

Court Date:

Name of Person Cited:

Citation Number:

Violation & Ord. / Statute No.:

Date of Birth:

Court Date:

Name of Person Cited:

Citation Number:

Violation & Ord. / Statute No.:

Date of Birth:

Court Date:

Name of Person Cited:

Citation Number:

Violation & Ord. / Statute No.:

Date of Birth:

Court Date:

Name of Person Cited:

Citation Number:

Violation & Ord. / Statute No.:

Date of Birth:

Court Date:

Investigating Officer: J. GONZALEZ

District / Bureau: 23

Date: 1-31-15



Commanding Officer

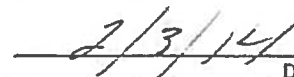

Date

DISPOSITION – FOR LICENSING ONLY

Citation No.	Case Number	Disposition	Judge	Date

LICENSE INVESTIGATION UNIT

Received

Referred

By



This report is written by P.O. Jeremy GONZALEZ, assigned to District 2, late shift. On 01-31-15 at 1:31am, I was dispatched to a shots fired complaint at 3101 W. Lincoln Av. Upon arrival the bar was closed, locked, and did not appear to have anyone inside. A bullet hole was located in the lower portion of the front door to Grady's Saloon. There were 7 casing located across the street on the northwest corner of S. 31st St. and W. Lincoln Av. I spoke to Shannon M. HEREDIA, w/f, 12-08-80, who eventually came out of the tavern. She stated she was the bartender and was the only one locked inside after there were shots fired outside of the location. HEREDIA could not let us inside the tavern since she locked the door when she came out because she does not have keys to the tavern. I spoke to Vanessa M. ZARATE, w/f 10-20-93, by phone and she stated her father, Mario J. ZARATE, w/m, 11-12-73, was the tavern owner. Vanessa stated her father knew about the incident but was not going to come to the tavern to assist police because he was told the tavern was not involved. I explained to Vanessa that the tavern was directly struck by a bullet and that we needed to get inside the tavern to continue our investigation. Vanessa stated she would contact her father again and try to get him to go to the tavern. A short while later Vanessa arrived at the tavern to let me inside to continue investigating. Once inside I was able to find the bullet that travelled through the front door. The bullet was laying on the floor inside the tavern after it went through the wall, struck a chair leg, and struck the bar. I spoke to Vanessa and she stated her father refused to come to the tavern so she came to the location to let police inside.

At this time it is not known if the suspect in this incident was inside the tavern at any point or if the tavern or any of its patrons were a direct target. This incident was filed under MPD IR# 15-031-0010.

MILWAUKEE POLICE DEPARTMENT

REPORT OF INCIDENTS INVOLVING LICENSED PERSONS OR PREMISES

TO: Captain Alfonso MORALES

Business Name: Grady's Saloon

Address of Licensed Premises: 3101 W. Lincoln Av.

Business Phone: 414-643-9819

Type of License: Class B

District: 2

☐ Violation / ☒ Incident # 15-031-0010

Date of Incident: 01/31/15

ORIGINALLicensee or Manager on premises at time of violation / incident? ☐ Yes ☒ NoLicensee cooperative? ☐ Yes ☒ No (if no, explain in narrative section)

Licensee Notified by Officer: P.O. Guadalupe VELASQUEZ

Date: 02/05/2015

Time: 2:00 p.m.

Licensee or Agent's Name: Mario J. ZARATE

Home Address: 1963 S. Layton Bl. Milw., WI 53215

Date of Birth: 11/12/1973

Home Phone: 414-313-0829

Co-Licensee Name:

Home Address:

Class S License Number:

Date of Birth:

Home Phone:

Bartender Name:

Home Address:

Class D License Number:

Date of Birth:

Home Phone:

Licensed Person / Public Pass. Vehicle, etc.:

Home Address:

Class D License Number:

Date of Birth:

Home Phone:

VIOLATION/INCIDENT - DESCRIBE FACTS AND CIRCUMSTANCES IN NARRATIVE SECTION

Name of Person Cited:

Citation Number:

Violation & Ord. / Statue No.:

Date of Birth:

Court Date:

Name of Person Cited:

Citation Number:

Violation & Ord. / Statue No.:

Date of Birth:

Court Date:

Name of Person Cited:

Citation Number:

Violation & Ord. / Statue No.:

Date of Birth:

Court Date:

Name of Person Cited:

Citation Number:

Violation & Ord. / Statue No.:

Date of Birth:

Court Date:

Name of Person Cited:

Citation Number:

Violation & Ord. / Statue No.:

Date of Birth:

Court Date:

Investigating Officer: P.O. Guadalupe VELASQUEZ

District / Bureau: 22

Date: 02/10/2015

P.O. Guadalupe Velasquez
Commanding Officer

2/17/15
 Date

DISPOSITION - FOR LICENSING ONLY

Citation No.	Case Number	Disposition	Judge	Date

LICENSE INVESTIGATION UNIT

Received

Referred

By

[Signature]

This report is written by P.O. Guadalupe VELASQUEZ, assigned to District 2, Early Shift, Community Prosecution Unit.

On Thursday, February 5, 2015, at 2:00 p.m., Mario J. ZARATE, was ordered in to the District 2 Police Station for a meeting. I had informed ZARATE that I wanted to discuss several violent incidents associated to his tavern. The meeting was attended by Captain Alfonso MORALES, P.O. Guadalupe VELASQUEZ, P.O. Kevin VODICKA, A.D.A. Ann LOPEZ, Safe and Sound Coordinator Maritza UGARTE, Mario ZARATE and his daughter, Vanessa ZARATE.

I advised ZARATE that his tavern was being investigated for nuisance eligibility and that there were at least three incidents that may qualify for a nuisance designation. ZARATE was also informed that we are aware that several members of the Latin Kings Gang frequent his establishment and that the Milwaukee Police Department suspects that is the reason for the problems. I also explained to ZARATE that our main concern was that after the incident in January the bartender would not allow officers into the tavern and he refused to come to the location to cooperate with the officers' investigation. The incidents discussed were a shooting from May of 2014, a subject with a gun complaint from December of 2014, and a shots fired complaint from January of 2015. ZARATE was also advised that these same incidents may make him eligible for a Camera Requirement Letter under City Ordinance 105-91. ZARATE stated that the subjects involved in the shooting incident were both banned from the bar and if they come to the tavern they are not suppose to be served. ZARATE stated that the victim from the shooting was in the tavern in December for the bartender's birthday and that the suspect's family members were the ones outside with the gun waiting to retaliate. Regarding the shots fired complaint from January ZARATE stated that the bartender was the one who refused to cooperate with the police and that she has been fired. ZARATE stated he will work with the police department to help identify the suspect and that he was willing to provide the names and phone numbers for the patrons who were at the tavern that night.

I then asked ZARATE about his plan of operation. He stated the bar is open from Tuesday to Saturday 4 p.m. to bar close and on Sunday from 12 p.m. to bar close. He stated he employs 2 bartenders, his daughter Vanessa is one of them. He also stated Vanessa will eventually take over the tavern. He stated the bartender is in charge of checking identification cards unless there is a door man. The door man only works when they have scheduled a bigger event or party. He stated they have 5 surveillance cameras at the location but they currently are not working.

Alderman DONOVAN and Captain MORALES both stressed to ZARATE that having a license for his tavern is a privilege and that these kinds of incidents would not be tolerated. ZARATE was also told that he will be held accountable for his patron's actions and that as a licensee he will be held to a higher standard.

CPU advised ZARATE to repair his cameras and to use a door man to check his patrons for weapons. He was also advised to screen his employees better so they do not reflect badly on his business. ZARATE was also advised to contact the police department when there are problems at his tavern. He was reassured that his cooperation with the police department would not be used against him at a later time.

ZARATE stated that the bartender involved in the January incident has been fired and will no longer work at his tavern. He stated that the two men involved in the shooting incident from May will not be allowed into his tavern anymore and that he will call the police if they enter his tavern. ZARATE stated he will also have the cameras fixed.

ZARATE was provided with the CPU's contact information in case he had any questions.

MILWAUKEE POLICE DEPARTMENT

REPORT OF INCIDENTS INVOLVING LICENSED PERSONS OR PREMISES

TO: Captain Alfonso Morales

Business Name: Grady's Saloon

Address of Licensed Premises: 3101 W Lincoln Ave

Business Phone: 414-643-9819

Type of License: Class B

District: 2

☐ Violation / ☐ Incident #

Date of Incident: 2/11/15

Licensee or Manager on premises at time of violation / incident? ☒ Yes ☐ NoLicensee cooperative? ☒ Yes ☐ No (if no, explain in narrative section)

Licensee Notified by Officer: P.O. Efrain Cornejo

Date: 2/11/15 Time: 4:10 PM

Licensee or Agent's Name: Mario J Zarate

Home Address: 1963 S Layton Bl Milwaukee, WI 53215

Date of Birth: 11/12/73

Home Phone: 414-313-0829

Co-Licensee Name:

Home Address:

Class S License Number:

Date of Birth:

Home Phone:

Bartender Name:

Home Address:

Class D License Number:

Date of Birth:

Home Phone:

Licensed Person / Public Pass. Vehicle, etc.:

Home Address:

Class D License Number:

Date of Birth:

Home Phone:

VIOLATION/INCIDENT – DESCRIBE FACTS AND CIRCUMSTANCES IN NARRATIVE SECTION

Name of Person Cited:

Citation Number:

Violation & Ord. / Statue No.:

Date of Birth:

Court Date:

Name of Person Cited:

Citation Number:

Violation & Ord. / Statue No.:

Date of Birth:

Court Date:

Name of Person Cited:

Citation Number:

Violation & Ord. / Statue No.:

Date of Birth:

Court Date:

Name of Person Cited:

Citation Number:

Violation & Ord. / Statue No.:

Date of Birth:

Court Date:

Name of Person Cited:

Citation Number:

Violation & Ord. / Statue No.:

Date of Birth:

Court Date:

Investigating Officer: P.O. Efrain Cornejo

District / Bureau: 22

Date: 02/12/15

 Commanding Officer

 Date

DISPOSITION – FOR LICENSING ONLY

Citation No.	Case Number	Disposition	Judge	Date

LICENSE INVESTIGATION UNIT

 Received 2-17-15

Referred

 By 

This report is written by P.O. Efrain Cornejo assigned to District Two, Early Shift CPU.

On Wednesday, February 11, 2015 at 4:10 PM, while on squad 2266, P.O. Matthew Diener and I, along with squad 2268, P.O. Kevin Vodicka responded to 3101 W Lincoln Ave (Grady's Saloon) to assist State Agent Georgeann King with a tavern inspection.

Agent King found 5 contaminated liquor bottles and confiscated over 50 bottles of liquor that were purchased at grocery stores instead of a wholesaler. There were also liquor bottles that were being married from brand to brand. Agent King filed a field report regarding the investigation and inventory receipts regarding all the confiscated liquor.

The agent of Grady's Saloon, Mario J Zarate (W/M, 11/12/73) admitted to buying liquor from the grocery store and marrying bottles. Zarate was unhappy that the majority of his liquor was being confiscated but cooperated with the investigation. I advised Zarate that I would be filing a PA-33. There weren't any other violations.

Attached is a copy of Agent King's field report.



Monday, August 31, 2015



Notice of Public Hearing

ZARATE, Mario J, Agent
GRADY'S SALOON at 3101 W LINCOLN Av
Class B Tavern and Public Entertainment Premises License Renewal Applications

Tuesday, September 08, 2015 at 9:00 AM

To whom it may concern:

The above application has been made by the above named applicant(s). This requires approval from the Licenses Committee and the Common Council of the City of Milwaukee. The hearing before the Licenses Committee will take place on 9/8/2015 at 9:00 AM, in Room 301-B, Third Floor, City Hall. If you wish, you may provide testimony at the hearing regarding the request; see below for further information. You are not required to attend the hearing. Once the Licenses Committee makes its recommendation, this recommendation is forwarded to the full Common Council for approval at its next regularly scheduled hearing. Please review the information below and if you have further questions regarding this process, please contact the License Division at (414) 286-2238.

Important details for those wishing to provide information for the Licenses Committee to consider when making its recommendation:

1. The license application is scheduled to be heard at the above time. Due to other hearings running longer than scheduled, you may have to wait some time to provide your testimony.
2. You must appear in person and testify as to matters that you have personally experienced or seen. (You cannot provide testimony for your neighbor, parent or anyone else; this is considered hearsay and cannot be considered by the committee.)
3. No letters or petitions can be accepted by the committee (unless the person who wrote the letter or the persons who signed the petition are present at the committee hearing and willing to testify).
4. Persons opposed to the license application are given the opportunity to testify first; supporters may testify after the opponents have finished.
5. When you are called to testify, you will be sworn in and asked to give your name, and address. (If your first and/or last names are uncommon please spell them.)
6. You may then provide testimony.
 - a. Include only information relating to the above license application.
 - b. Include only information you have personally witnessed or seen.
 - c. Provide concise and relevant information detailing how this business has affected or may affect the peaceful enjoyment of your neighborhood.
 - d. If by the time you have the opportunity to testify, the information you wish to share has already been provided to the committee, you may state that you agree with the previous testimony. Redundant or repetitive testimony will not assist the committee in making its recommendation.
7. After giving your testimony, the members of the Licenses Committee and the licensee may ask questions regarding the testimony you have given or other factors relating to the license application.
8. Business Competition is not a valid basis for denial or non-renewal of a license.
Please Note: If you have submitted an objection to the above application your objection cannot be considered by the committee unless you personally testify at the hearing.

RESIDENT	MAIL ADDRESS	CHY AND ZIP CODE
CURRENT RESIDENT	2252 S 31ST ST	MILWAUKEE, WI 53215-2436
CURRENT RESIDENT	2254 S 31ST ST	MILWAUKEE, WI 53215-2436
CURRENT RESIDENT	2258 S 31ST ST	MILWAUKEE, WI 53215-2436
CURRENT RESIDENT	2258A S 31ST ST	MILWAUKEE, WI 53215-2436
CURRENT RESIDENT	2305 S 31ST ST	MILWAUKEE, WI 53215-2853
CURRENT RESIDENT	2313 S 31ST ST	MILWAUKEE, WI 53215-2853
CURRENT RESIDENT	2313A S 31ST ST	MILWAUKEE, WI 53215-2853
CURRENT RESIDENT	2318 S 32ND ST	MILWAUKEE, WI 53215-2802
CURRENT RESIDENT	2319 S 30TH ST	MILWAUKEE, WI 53215-2849
CURRENT RESIDENT	2319 S 31ST ST	MILWAUKEE, WI 53215-2853
CURRENT RESIDENT	2319A S 30TH ST	MILWAUKEE, WI 53215-2849
CURRENT RESIDENT	2320 S 31ST ST	MILWAUKEE, WI 53215-2854
CURRENT RESIDENT	2322 S 32ND ST	MILWAUKEE, WI 53215-2802
CURRENT RESIDENT	2323 S 30TH ST	MILWAUKEE, WI 53215-2849
CURRENT RESIDENT	2323 S 31ST ST	MILWAUKEE, WI 53215-2853
CURRENT RESIDENT	2324 S 31ST ST	MILWAUKEE, WI 53215-2854
CURRENT RESIDENT	2327 S 30TH ST	MILWAUKEE, WI 53215-2849
CURRENT RESIDENT	2327 S 31ST ST	MILWAUKEE, WI 53215-2853
CURRENT RESIDENT	2327A S 30TH ST	MILWAUKEE, WI 53215-2849
CURRENT RESIDENT	2328 S 31ST ST	MILWAUKEE, WI 53215-2854
CURRENT RESIDENT	2328 S 32ND ST	MILWAUKEE, WI 53215-2802
CURRENT RESIDENT	2328A S 32ND ST	MILWAUKEE, WI 53215-2802
CURRENT RESIDENT	2330 S 32ND ST	MILWAUKEE, WI 53215-2802
CURRENT RESIDENT	2330A S 32ND ST	MILWAUKEE, WI 53215-2802
CURRENT RESIDENT	2331 S 30TH ST	MILWAUKEE, WI 53215-2849
CURRENT RESIDENT	2331 S 31ST ST	MILWAUKEE, WI 53215-2853
CURRENT RESIDENT	2334 S 31ST ST	MILWAUKEE, WI 53215-2854
CURRENT RESIDENT	2335 S 31ST ST	MILWAUKEE, WI 53215-2853
CURRENT RESIDENT	2336 S 32ND ST	MILWAUKEE, WI 53215-2802
CURRENT RESIDENT	2338 S 32ND ST	MILWAUKEE, WI 53215-2802
CURRENT RESIDENT	2339 S 31ST ST	MILWAUKEE, WI 53215-2853
CURRENT RESIDENT	2340 S 31ST ST	MILWAUKEE, WI 53215-2854
CURRENT RESIDENT	2340A S 31ST ST	MILWAUKEE, WI 53215-2854
CURRENT RESIDENT	2344 S 31ST ST	MILWAUKEE, WI 53215-2854
CURRENT RESIDENT	3007 W LINCOLN AVE	MILWAUKEE, WI 53215-2417
CURRENT RESIDENT	3010 W LINCOLN AVE	MILWAUKEE, WI 53215-2418
CURRENT RESIDENT	3012 W LINCOLN AVE	MILWAUKEE, WI 53215-2418
CURRENT RESIDENT	3013 W LINCOLN AVE	MILWAUKEE, WI 53215-2417
CURRENT RESIDENT	3018 W LINCOLN AVE	MILWAUKEE, WI 53215-2418
CURRENT RESIDENT	3019 W LINCOLN AVE	MILWAUKEE, WI 53215-2417
CURRENT RESIDENT	3020 W LINCOLN AVE	MILWAUKEE, WI 53215-2418
CURRENT RESIDENT	3023 W LINCOLN AVE	MILWAUKEE, WI 53215-2417
CURRENT RESIDENT	3026 W LINCOLN AVE	MILWAUKEE, WI 53215-2418
CURRENT RESIDENT	3109 W LINCOLN AVE	MILWAUKEE, WI 53215-2419
CURRENT RESIDENT	3113 W LINCOLN AVE	MILWAUKEE, WI 53215-2419
CURRENT RESIDENT	3123 W LINCOLN AVE	MILWAUKEE, WI 53215-2419
CURRENT RESIDENT	3123A W LINCOLN AVE	MILWAUKEE, WI 53215-2419
CURRENT RESIDENT	3125 W LINCOLN AVE	MILWAUKEE, WI 53215-2419
CURRENT RESIDENT	3129 W LINCOLN AVE	MILWAUKEE, WI 53215-2419
CURRENT RESIDENT	3131 W LINCOLN AVE	MILWAUKEE, WI 53215-2419
CURRENT RESIDENT	3135 W LINCOLN AVE	MILWAUKEE, WI 53215-2419

Total Records: 52

Radius: 250.0 feet and Center of Circle: 3101 W Lincoln AV

2015-2016 Plan of Operation for 3101 W LINCOLN AV

1. Litter and NoiseHow are the grounds kept clean? ☒ Sweep ☐ Pressure Wash ☒ Pick Up Litter ☐ Other: _____How often will grounds be cleaned? ☒ Daily ☐ Weekly ☐ Other: _____Grounds Cleaned By: ☐ Licensee ☐ Building Owner ☒ Employees ☐ Hired Maintenance ☐ Other: _____How are noise issues prevented and/or addressed? ☒ Security ☒ Manager approaches customer(s) ☐ Call Police☐ Signs Posted ☐ Other: _____**2. Smoking and Sanitation**Are there designated outdoor smoking areas? ☐ No ☒ YesIf yes, describe the area(s) and provide location(s): Outside rear patio areaNumber of Garbage Cans: Inside: 5/2 Locations: 2 behind bar 3 seating area 1 each restroom
Outside: 2 Locations: North west side outsideIs a Crowd Control Barrier used? ☒ No ☐ Yes If yes, describe: _____Describe sanitation facilities (restrooms): Female 2 sit/stalls 2 sinks / male 1 sit/stal 2 urinalsProvide name of solid waste contractor: waste management 1 sink**3. Security**Are there parking spaces on the premises? ☐ No ☒ Yes If yes, number of spaces: 1 and describe security provisions:along with street parking.Are there designated loading areas? ☒ No ☐ Yes If yes, describe security provisions: _____Do you have security personnel on the premise? ☐ No ☒ Yes If yes, how many? 2AND What are their responsibilities? check ID's, check restrooms, prevent arguing, assisting clients out after last callWhat security equipment do they use? NONEList their licensing, certification or training credentials: 3-6 years monkey bar, whiskey bar,Are there security cameras? ☐ No ☒ Yes If yes, list all locations: entry, sitting area, bar area, pool areaAre searches and/or identification checks conducted upon entry? ☐ No ☒ Yes If yes, describe: security at door checks ID's & conduct searches upon entry**4. Percentage of Sales (must total 100%)**Alcohol 100 % Food Sales _____ % Entertainment _____ % Other _____ %**5. Businesses On The Premise (choose all that apply):**

- | | | | |
|--|--|--|---|
| <input type="checkbox"/> Full Service Restaurant | <input type="checkbox"/> Cafe/Coffee Shop | <input type="checkbox"/> Deli or Fast Food Rest. | <input type="checkbox"/> Private/Fraternal/Veterans' Club |
| <input type="checkbox"/> Night Club | <input checked="" type="checkbox"/> Tavern | <input type="checkbox"/> Cocktail Lounge | <input type="checkbox"/> Teen Club |
| <input type="checkbox"/> Bowling Alley | <input type="checkbox"/> Hotel | <input type="checkbox"/> Banquet Hall | <input type="checkbox"/> Sports Facility |
| <input type="checkbox"/> Liquor Store | <input type="checkbox"/> Corner Store | <input type="checkbox"/> Supermarket | <input type="checkbox"/> Convenience Store |
| <input type="checkbox"/> Gas Station | <input type="checkbox"/> Other _____ | | |

6. Hours of Operation and Age RestrictionAre there any changes to the current hours of operation or age restriction? ☒ No ☐ Yes If yes, describe _____

Please Note: If you will be open earlier or later than the hours listed on your current license for even one event or holiday (for example, St. Patrick's Day, Brewers Opening Day, etc.) during the license period, this must be reported and printed on your license.

Your hours of operation and age restriction are listed on your current license.

7. Floor PlanAre there any changes to the current floor plan? ☒ No ☐ Yes If yes, describe _____

AND submit a new floor plan with this application. Changes in floor plan include changing the location of tables, games, etc. within your current licensed premises. If your changes include adding any additional areas or square footage to your premises, or any renovations to the building will be done, a Permanent Extension of Premises application must be filed.

(1) CURRENT ENTERTAINMENT

The following types of entertainment have been approved for your current Public Entertainment Premises license:

Jukebox, 2 Amusement Machines, 1 Pool Table.

(2) SELECT ANY TYPES OF ENTERTAINMENT THAT YOU ARE REQUESTING TO ADD *No changes in entertainment shall take place until approved by the Common Council and a new license has been issued and posted on the premises.

<input type="checkbox"/> Instrumental Musicians	<input type="checkbox"/> Bands	<input type="checkbox"/> Battle of the Bands	<input type="checkbox"/> Comedy Acts
<input checked="" type="checkbox"/> Disc Jockey	<input type="checkbox"/> Magic Shows	<input type="checkbox"/> Poetry Readings	<input type="checkbox"/> Dancing by Performers
<input checked="" type="checkbox"/> Jukebox	<input type="checkbox"/> Wrestling	<input type="checkbox"/> Patron Contests	<input type="checkbox"/> Patrons Dancing
<input type="checkbox"/> Adult Entertainment/ Strippers/Erotic Dance	<input type="checkbox"/> Karaoke	<input type="checkbox"/> Bowling Alley	<input checked="" type="checkbox"/> Pool Tables
<input type="checkbox"/> Motion Pictures	<input checked="" type="checkbox"/> Amusement Machines -	How many? _____	How many? _____
How many screens? _____	How many? _____	<input type="checkbox"/> Concerts	<input type="checkbox"/> Theatrical Performances
		Approx. # per year? _____	Approx. # per year? _____
<input type="checkbox"/> Other: _____			

(3) REMOVE ENTERTAINMENT

If applicable, list any entertainment you wish to remove: _____

(4) WILL PROMOTERS EVER BE USED FOR ANY OF THE ENTERTAINMENT?

☒ No ☐ Yes, describe: _____

(5) LEGAL CAPACITY OF PREMISES

99 (Call the Milwaukee Development Center at 414-286-8211 if you have questions.) Your legal capacity will determine the license fee for your Public Entertainment Premise License. If you would like to request that the license be approved with a lower capacity than that listed above, indicate lower capacity _____. If approved, this lower capacity will print on your license and override the capacity listed on your Occupancy Permit.

(6) IDENTIFY IF SOUND AMPLIFICATION IS USED

☐ No ☒ Yes, describe: normal DISC Jockey soundings

(7) DECLARATIONS, ACKNOWLEDGEMENTS, & DISCLOSURES

Read And Initial Each Item Confirming Your Understanding:

- WZ I understand that after the license has been issued, a change to the plan of operation will require a written request to change and approval from the Common Council.
- WZ I agree to inform the City Clerk within 10 days of any substantial changes in the information supplied in this application.
- WZ I understand that I shall not willfully refuse to provide the services offered under this license, or add charges or require deposits not required of the general public because of race, color, sex, religion, national origin or ancestry, age, handicap, lawful source of income, marital status, sexual orientation, gender identity or expression, familial status or the fact that a person is now or has been a member of the military service, whether dressed in uniform or not; and shall not seek such information as a condition of employment, or penalize any employee or discriminate in the selection of personnel for training or promotion on the basis of such information.
- WZ I have knowledge of the City Ordinances currently regulating public entertainment, and understand that the license may be subject to suspension, non-renewal or revocation, if I violate any rule, law or regulation of the city of Milwaukee and State of Wisconsin.

(8) NOTARIZED SIGNATURES OF APPLICANTS

SUBSCRIBED AND SWORN TO BEFORE ME

This 29th day of June, 20 15

David Harris

(Clerk/Notary Public)

My Commission Expires 2/19/17

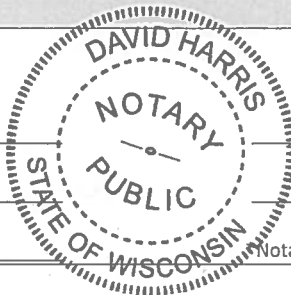

Mauro...
Agent/Owner/Partner

Additional Owner/Partner

Notary Seal must be affixed.



**CITY OF MILWAUKEE
OFFICE OF THE CITY CLERK**

Monday, August 31, 2015

COMMITTEE MEETING NOTICE

AD 14

BAGASRAWALA, Farrukh, Agent
Kinnick Mart Inc
3087 S KINNICKINNIC Av

Milwaukee, WI 53207

You are requested to attend a hearing which is to be held in Room 301-B, Third Floor, City Hall on:

Tuesday, September 08, 2015 at 09:00 AM

Regarding: Your Extended Hours Establishment, Food Dealer, and Filling Station License Applications Requesting to be Open 24 Hours Per Day as agent for "Kinnick Mart Inc" for "Kinnick Mart" at 3087 S KINNICKINNIC Av.

There is a possibility that your application may be denied for one or more of the following reasons: The recommendation of the committee regarding the application shall be based on evidence presented at the hearing. Per MCO 85-2.7-4, probative evidence concerning whether or not a new license should be granted may be presented on the following subjects: whether or not the applicant meets the municipal requirements, the appropriateness of the location and premises where the licensed premises is to be located and whether use of the premises for the purposes or activities permitted by the license would tend to facilitate a public or private nuisance or create undesirable neighborhood problems such as disorderly patrons, unreasonably loud noise, litter, and excessive traffic and parking congestion. Probative evidence relating to these matters may be taken from the plan of operation submitted with the license application, if any, but shall not include the content of any music. Evidence regarding the fitness of the location of the premises to be maintained as the principal place of business, including but not limited to whether there is an overconcentration of businesses of the type for which the license is sought; whether the proposal is consistent with any pertinent neighborhood business or development plans, or the location's proximity to areas where children are typically present. The applicant's record in operating similarly licensed premises; and whether or not the applicant has been charged with or convicted of any felony, misdemeanor, municipal offense or other offense, the circumstances of which substantially relate to the activity to be permitted by the license being applied for or any other factor which reasonably relates to the public health, safety or welfare may also be considered. See attached police report or correspondence.

Notice for applicants with warrants or unpaid fines:

Proof of warrant satisfaction or payment of fines must be submitted at the hearing on the above date and time. Failure to comply with this requirement may result in a delay of the granting/denial of your application.

Failure to appear at this meeting may result in the denial of your license. Individual applicants must appear only in person or by an attorney. Corporate or Limited Liability applicants must appear only by the agent designated on the application or by an attorney. Partnership applicants must appear by a partner listed on the application or by an attorney. If you wish to do so and at your own expense, you may be accompanied by an attorney of your choosing to represent you at this hearing.

You will be given an opportunity to speak on behalf of the application and to respond and challenge any charges or reasons given for the denial. No petitions can be accepted by the committee, unless the people who signed the petition are present at the committee hearing and willing to testify. You may present witnesses under oath and you may also confront and cross-examine opposing witnesses under oath. If you have difficulty with the English language, you should bring an interpreter with you, at your expense, so that you can answer questions and participate in your hearing.

You may examine the application file at this office during regular business hours prior to the hearing date. Inquiries regarding this matter may be directed to the person whose signature appears below.

Limited parking for persons attending meetings in City Hall is available at reduced rates (5 hour limit) at the Milwaukee Center on the southwest corner of East Kilbourn and North Water Street. Parking tickets must be validated in the first floor information booth in City Hall.

PLEASE NOTE: Upon reasonable notice, efforts will be made to accommodate the needs of disabled individuals through sign language interpreters or other auxiliary aids. For additional information or to request this service, contact the Council Services Division ADA Coordinator at (414) 286-2998, Fax - (414) 286-3456, TDD - (414) 286-2025.

JIM OWCZARSKI, CITY CLERK

BY:

Jason Schunk
License Division Manager

If you have questions regarding this notice, please contact the License Division at (414) 286-2238.

200 E. Wells Street, Room 105, City Hall, Milwaukee, WI 53202. www.milwaukee.gov/license
Phone: (414) 286-2238 Fax: (414) 286-3057 Email Address: License@milwaukee.gov



**CITY OF MILWAUKEE
OFFICE OF THE CITY CLERK**

Monday, August 31, 2015

COMMITTEE MEETING NOTICE

AD 14

BAGASRAWALA, Farrukh, Agent
Kinnick Mart Inc
15 Terra Vita Ct

Barrington, IL 60010

You are requested to attend a hearing which is to be held in Room 301-B, Third Floor, City Hall on:

Tuesday, September 08, 2015 at 09:00 AM

Regarding: Your Extended Hours Establishment, Food Dealer, and Filling Station License Applications Requesting to be Open 24 Hours Per Day as agent for "Kinnick Mart Inc" for "Kinnick Mart" at 3087 S KINNICKINNIC Av.

There is a possibility that your application may be denied for one or more of the following reasons: The recommendation of the committee regarding the application shall be based on evidence presented at the hearing. Per MCO 85-2.7-4, probative evidence concerning whether or not a new license should be granted may be presented on the following subjects: whether or not the applicant meets the municipal requirements, the appropriateness of the location and premises where the licensed premises is to be located and whether use of the premises for the purposes or activities permitted by the license would tend to facilitate a public or private nuisance or create undesirable neighborhood problems such as disorderly patrons, unreasonably loud noise, litter, and excessive traffic and parking congestion. Probative evidence relating to these matters may be taken from the plan of operation submitted with the license application, if any, but shall not include the content of any music. Evidence regarding the fitness of the location of the premises to be maintained as the principal place of business, including but not limited to whether there is an overconcentration of businesses of the type for which the license is sought; whether the proposal is consistent with any pertinent neighborhood business or development plans, or the location's proximity to areas where children are typically present. The applicant's record in operating similarly licensed premises; and whether or not the applicant has been charged with or convicted of any felony, misdemeanor, municipal offense or other offense, the circumstances of which substantially relate to the activity to be permitted by the license being applied for or any other factor which reasonably relates to the public health, safety or welfare may also be considered. See attached police report or correspondence.

**Notice for applicants with
warrants or unpaid fines:**

Proof of warrant satisfaction or payment of fines must be submitted at the hearing on the above date and time. Failure to comply with this requirement may result in a delay of the granting/denial of your application.

Failure to appear at this meeting may result in the denial of your license. Individual applicants must appear only in person or by an attorney. Corporate or Limited Liability applicants must appear only by the agent designated on the application or by an attorney. Partnership applicants must appear by a partner listed on the application or by an attorney. If you wish to do so and at your own expense, you may be accompanied by an attorney of your choosing to represent you at this hearing.

You will be given an opportunity to speak on behalf of the application and to respond and challenge any charges or reasons given for the denial. No petitions can be accepted by the committee, unless the people who signed the petition are present at the committee hearing and willing to testify. You may present witnesses under oath and you may also confront and cross-examine opposing witnesses under oath. If you have difficulty with the English language, you should bring an interpreter with you, at your expense, so that you can answer questions and participate in your hearing.

You may examine the application file at this office during regular business hours prior to the hearing date. Inquiries regarding this matter may be directed to the person whose signature appears below.

Limited parking for persons attending meetings in City Hall is available at reduced rates (5 hour limit) at the Milwaukee Center on the southwest corner of East Kilbourn and North Water Street. Parking tickets must be validated in the first floor information booth in City Hall.

PLEASE NOTE: Upon reasonable notice, efforts will be made to accommodate the needs of disabled individuals through sign language interpreters or other auxiliary aids. For additional information or to request this service, contact the Council Services Division ADA Coordinator at (414) 286-2998, Fax - (414) 286-3456, TDD - (414) 286-2025.

JIM OWCZARSKI, CITY CLERK

BY:

**Jason Schunk
License Division Manager**

If you have questions regarding this notice, please contact the License Division at (414) 286-2238.

200 E. Wells Street, Room 105, City Hall, Milwaukee, WI 53202. www.milwaukee.gov/license
Phone: (414) 286-2238 Fax: (414) 286-3057 Email Address: License@milwaukee.gov

Cooney, James

From: License
Sent: Monday, June 01, 2015 7:31 AM
To: Cooney, James
Subject: FW: Kinnick Mart

Jonathan Koberstein
License Specialist III
City Clerk's Office – License Division
City Hall Rm 105
200 E Wells St
Milwaukee, WI 53202
(414)286-2238 Office
(414)286-3057 Fax

-----Original Message-----

From: [REDACTED]@gmail.com [mailto:[REDACTED]@gmail.com]
Sent: Sunday, May 31, 2015 12:20 PM
To: License
Subject: Kinnick Mart

Concerning the 24-hr operation of the Kinnick Mart my objections are:

Noise, namely loud music and loud talking/yelling by some patrons that is allowed on the property. The property is in close proximity to an apartment building and homes to the north and west. I have had to personally call the noise hotline on several occasions because of people loitering while loud music played on their car systems.

Homeowners have to pick up all the trash that patrons throw out their car windows. It blows west down Oklahoma and onto private property. Patrons also fling cans, bottles and other trash onto lawns along Oklahoma. 24-hr operation will just increase the problem.

There are no fences along the property line, therefore car lights shine into the windows of the homes on Oklahoma and apartment building to the north. This is especially a problem along the parking spaces that face west. Extending the hours will make this a terrible nuisance during the night.

The Kinnick Mart property is not well maintained. Trash is not picked up daily. What passes for landscaping is minimally maintained and is overgrown with weeds. It's an eyesore that greets visitors for the Bay View area along it's main streets. Frankly, it's an embarrassment.

Lastly, the opportunity for robbery in the late hours should be taken into consideration. There already have been many instances of the Kinnick Mart and Walgreens being robbed during their current open hours.

I don't see how 24-hr operation of this establishment will not intensify the negative impact on the welfare of the public and neighborhood. Thanks for hearing my concerns.

Food Dealer License Concentration for 3087 S Kinnickinnic Ave

City of Milwaukee, Wisconsin



- Legend -

- City limits
- Parcels
- Freeways
- Freeways
- Exit ramps
- Entry ramps
- Ramps
- Major streets
- Streets
- Waterways
- Food licenses
 - Food dealer - retail
 - Food dealer - restaurant
 - Food distributor
 - Meal service establishment/commnu
 - Food manufacturer

- Notes -

Licensed food dealers within a half mile radius centered on 3087 S Kinnickinnic Ave on August 31, 2015

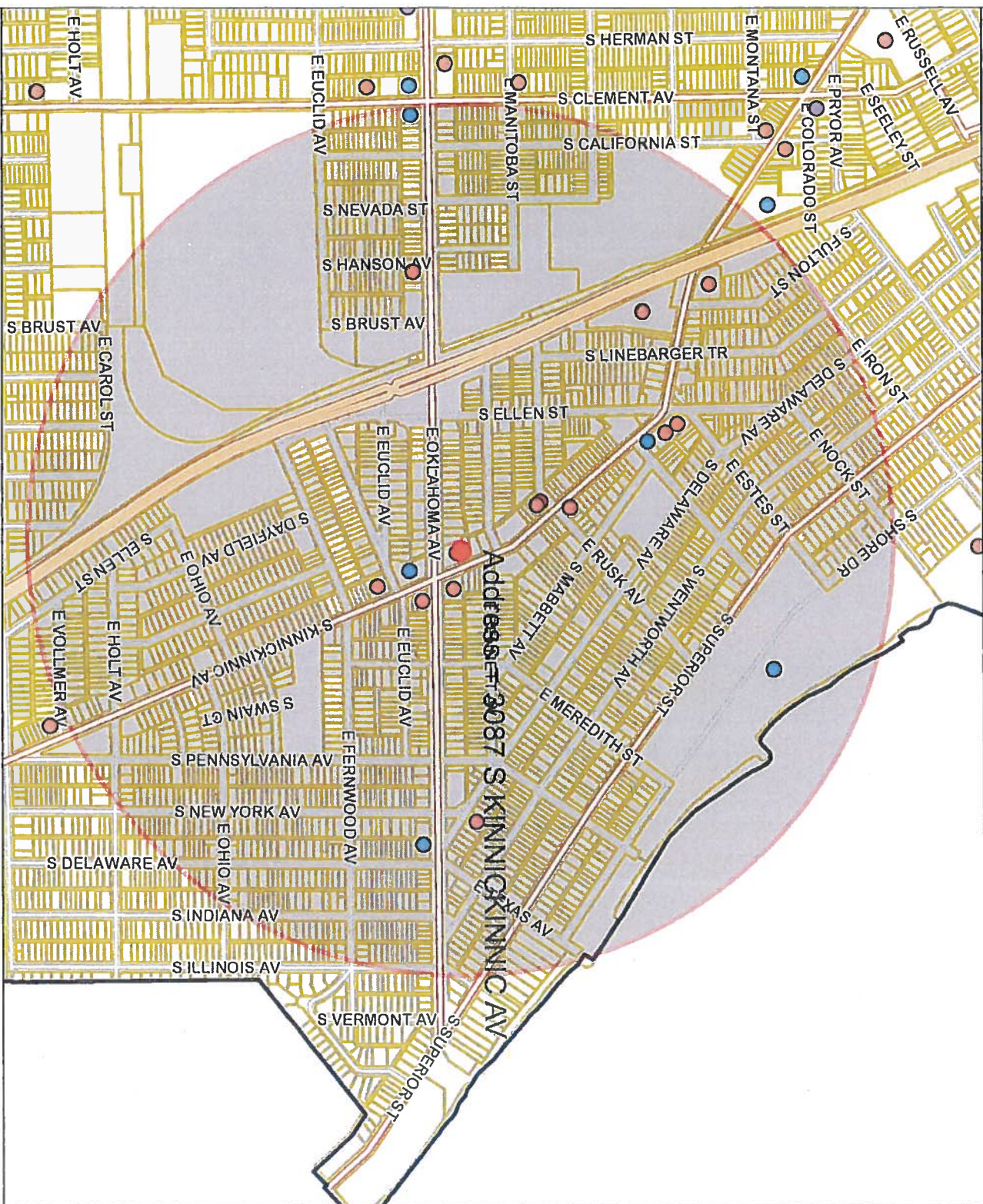

Licensed Food Dealers Within a Half Mile Radius Centered on 3087 S Kinnickinnic Ave						
License Summary						
Food Dealer Retail			Total			
				5		
Food Dealer Restaurant				12		
Legal entity	Trade name	Licensee	Address	License type name	Expiration date	
Clutch Corp.	Anodyne Coffee Roasting Co.	Matthew J McClutchy, Agt	2920 S Kinnickinnic AV	Food Dealer Retail	6/30/2016	
CMAK, LLC	BERT'S LIQUOR IN BAY VIEW	RICHARD G FRENCH, JR, Agt	2523 E OKLAHOMA AV	Food Dealer Retail	3/23/2015	
Kinnick Management, Inc	Marathon Gas Station	Seema Bagasrawala, Agt	3087 S Kinnickinnic AV	Food Dealer Retail	1/31/2016	
Milwaukee County Department of Parks	Milwaukee County Parks South Shore	Andrea G Wallace, Agt	2900 S Shore DR	Food Dealer Retail	6/30/2015	
WALGREEN CO	WALGREENS #01652	Robin E Van Cleave, Agt	3109 S KINNICKINNIC AV	Food Dealer Retail	6/30/2016	
BLACKBIRD BAR, INC	BLACKBIRD BAR	HOLLY C DOAR, Agt	3007 S KINNICKINNIC AV	Food Dealer - Restaurant	6/30/2016	
FRANCISCO, INC	CRABBY'S BAR & GRILL	FRANCIS DANIELS, Agt	2109-13 E OKLAHOMA AV	Food Dealer - Restaurant	6/30/2016	
HEAD SOUTH, LLC	R&D Pub	ROBERT H MESSINGER, Agt	3040 S DELAWARE AV	Food Dealer - Restaurant	7/11/2016	
JOG Maya, LLC	Cousins Subs	Ashaben Patel, Agt	2867 S KINNICKINNIC AV	Food Dealer - Restaurant	6/30/2016	
Kozera Properties LLC	Straight Shots	Kyle E Kozera, Agt	1503 E OKLAHOMA AV	Food Dealer - Restaurant	7/5/2016	
Little DeMarinis Pizza, LLC	Little DeMarinis Pizza	Joseph J Cieslak, Agt	2860 S Kinnickinnic AV	Food Dealer - Restaurant	10/14/2015	
LLAMA, INC	THE WHITE HOUSE	SEAN A RAFFAELLI, Agt	2900 S KINNICKINNIC AV	Food Dealer - Restaurant	1/16/2016	
PASTICHE, LLC	PASTICHE BISTRO	MICHAEL C ENGEL, Agt	3001 S KINNICKINNIC AV	Food Dealer - Restaurant	1/19/2016	
PH HOSPITALITY GROUP, LLC	PIZZA HUT - 8	MARK L DILLON, Agt	3131 S Kinnickinnic AV	Food Dealer - Restaurant	4/30/2016	
Pietro's Pizza LLC	Pietro's Pizza	Enrichetta Tarantino Woytal, Agt	2912 S Kinnickinnic AV	Food Dealer - Restaurant	8/19/2016	
Rocket 44 Corporation	Subway	Daniel J Shewmake, Agt	2110 E OKLAHOMA AV	Food Dealer - Restaurant	7/1/2016	
SONS OF ANDER LLC	LEE'S LUXURY LOUNGE	JASON J ANDERSON, Agt	2988 S KINNICKINNIC AV	Food Dealer - Restaurant	5/24/2016	



Monday, August 31, 2015



Notice of Public Hearing

BAGASRAWALA, Farrukh, Agent
Kinnick Mart at 3087 S KINNICKINNIC Av
Extended Hours Establishment, Food Dealer, and Filling Station License Applications Requesting
to be Open 24 Hours Per Day

Tuesday, September 08, 2015 at 9:00 AM

To whom it may concern:

The above application has been made by the above named applicant(s). This requires approval from the Licenses Committee and the Common Council of the City of Milwaukee. The hearing before the Licenses Committee will take place on 9/8/2015 at 9:00 AM, in Room 301-B, Third Floor, City Hall. If you wish, you may provide testimony at the hearing regarding the request; see below for further information. You are not required to attend the hearing. Once the Licenses Committee makes its recommendation, this recommendation is forwarded to the full Common Council for approval at its next regularly scheduled hearing. Please review the information below and if you have further questions regarding this process, please contact the License Division at (414) 286-2238.

Important details for those wishing to provide information for the Licenses Committee to consider when making its recommendation:

1. The license application is scheduled to be heard at the above time. Due to other hearings running longer than scheduled, you may have to wait some time to provide your testimony.
2. You must appear in person and testify as to matters that you have personally experienced or seen. (You cannot provide testimony for your neighbor, parent or anyone else; this is considered hearsay and cannot be considered by the committee.)
3. No letters or petitions can be accepted by the committee (unless the person who wrote the letter or the persons who signed the petition are present at the committee hearing and willing to testify).
4. Persons opposed to the license application are given the opportunity to testify first; supporters may testify after the opponents have finished.
5. When you are called to testify, you will be sworn in and asked to give your name, and address. (If your first and/or last names are uncommon please spell them.)
6. You may then provide testimony.
 - a. Include only information relating to the above license application.
 - b. Include only information you have personally witnessed or seen.
 - c. Provide concise and relevant information detailing how this business has affected or may affect the peaceful enjoyment of your neighborhood.
 - d. If by the time you have the opportunity to testify, the information you wish to share has already been provided to the committee, you may state that you agree with the previous testimony. Redundant or repetitive testimony will not assist the committee in making its recommendation.
7. After giving your testimony, the members of the Licenses Committee and the licensee may ask questions regarding the testimony you have given or other factors relating to the license application.
8. Business Competition is not a valid basis for denial or non-renewal of a license.
Please Note: If you have submitted an objection to the above application your objection cannot be considered by the committee unless you personally testify at the hearing.

RESIDENT	MAIL ADDRESS	CITY AND ZIP CODE
CURRENT RESIDENT	1919 E BENNETT AVE	MILWAUKEE, WI 53207-2962
CURRENT RESIDENT	1920 E OKLAHOMA AVE	MILWAUKEE, WI 53207-2952
CURRENT RESIDENT	1925 E BENNETT AVE	MILWAUKEE, WI 53207-2962
CURRENT RESIDENT	1927 E BENNETT AVE	MILWAUKEE, WI 53207-2962
CURRENT RESIDENT	1928 E OKLAHOMA AVE	MILWAUKEE, WI 53207-2952
CURRENT RESIDENT	1929 E BENNETT AVE	MILWAUKEE, WI 53207-2962
CURRENT RESIDENT	1931 E BENNETT AVE	MILWAUKEE, WI 53207-2962
CURRENT RESIDENT	1932 E BENNETT AVE	MILWAUKEE, WI 53207-2963
CURRENT RESIDENT	1932 E OKLAHOMA AVE	MILWAUKEE, WI 53207-2952
CURRENT RESIDENT	1933 E OKLAHOMA AVE 1	MILWAUKEE, WI 53207-2951
CURRENT RESIDENT	1933 E OKLAHOMA AVE 2	MILWAUKEE, WI 53207-2951
CURRENT RESIDENT	1933 E OKLAHOMA AVE 3	MILWAUKEE, WI 53207-2951
CURRENT RESIDENT	1934 E BENNETT AVE	MILWAUKEE, WI 53207-2963
CURRENT RESIDENT	1935 E BENNETT AVE	MILWAUKEE, WI 53207-2962
CURRENT RESIDENT	1936 E OKLAHOMA AVE	MILWAUKEE, WI 53207-2952
CURRENT RESIDENT	1938 E BENNETT AVE	MILWAUKEE, WI 53207-2963
CURRENT RESIDENT	1938A E BENNETT AVE	MILWAUKEE, WI 53207-2963
CURRENT RESIDENT	1939 E BENNETT AVE	MILWAUKEE, WI 53207-2962
CURRENT RESIDENT	1939 E OKLAHOMA AVE	MILWAUKEE, WI 53207-2951
CURRENT RESIDENT	1939A E OKLAHOMA AVE	MILWAUKEE, WI 53207-2951
CURRENT RESIDENT	1942 E EUCLID AVE	MILWAUKEE, WI 53207-2946
CURRENT RESIDENT	1945 E BENNETT AVE	MILWAUKEE, WI 53207-2962
CURRENT RESIDENT	1945A E BENNETT AVE	MILWAUKEE, WI 53207-2962
CURRENT RESIDENT	2000 E EUCLID AVE	MILWAUKEE, WI 53207-2948
CURRENT RESIDENT	2000 E EUCLID AVE A	MILWAUKEE, WI 53207-2948
CURRENT RESIDENT	2000 E OKLAHOMA AVE	MILWAUKEE, WI 53207-2954
CURRENT RESIDENT	2001 E OKLAHOMA AVE	MILWAUKEE, WI 53207-2953
CURRENT RESIDENT	2001A E OKLAHOMA AVE	MILWAUKEE, WI 53207-2953
CURRENT RESIDENT	2006 E OKLAHOMA AVE	MILWAUKEE, WI 53207-2954
CURRENT RESIDENT	2007 E OKLAHOMA AVE	MILWAUKEE, WI 53207-2953
CURRENT RESIDENT	2008 E EUCLID AVE	MILWAUKEE, WI 53207-2948
CURRENT RESIDENT	2009 E OKLAHOMA AVE	MILWAUKEE, WI 53207-2953
CURRENT RESIDENT	2010 E OKLAHOMA AVE	MILWAUKEE, WI 53207-2954
CURRENT RESIDENT	2010A E OKLAHOMA AVE	MILWAUKEE, WI 53207-2954
CURRENT RESIDENT	2014 E EUCLID AVE	MILWAUKEE, WI 53207-2948
CURRENT RESIDENT	2015 E OKLAHOMA AVE	MILWAUKEE, WI 53207-2953
CURRENT RESIDENT	2019 E OKLAHOMA AVE	MILWAUKEE, WI 53207-2953
CURRENT RESIDENT	2019A E OKLAHOMA AVE	MILWAUKEE, WI 53207-2953
CURRENT RESIDENT	2020 E EUCLID AVE	MILWAUKEE, WI 53207-2948
CURRENT RESIDENT	2112 E BENNETT AVE	MILWAUKEE, WI 53207-2916
CURRENT RESIDENT	2113 E OKLAHOMA AVE	MILWAUKEE, WI 53207-2921
CURRENT RESIDENT	2118 E OKLAHOMA AVE	MILWAUKEE, WI 53207-2922
CURRENT RESIDENT	2120 E BENNETT AVE	MILWAUKEE, WI 53207-2916
CURRENT RESIDENT	2120A E BENNETT AVE	MILWAUKEE, WI 53207-2916
CURRENT RESIDENT	2126 E BENNETT AVE	MILWAUKEE, WI 53207-2916
CURRENT RESIDENT	2133 E BENNETT AVE	MILWAUKEE, WI 53207-2915
CURRENT RESIDENT	2137 E BENNETT AVE	MILWAUKEE, WI 53207-2915
CURRENT RESIDENT	2200 E OKLAHOMA AVE	MILWAUKEE, WI 53207-2924
CURRENT RESIDENT	3059 S KINNICKINNIC AVE 1	MILWAUKEE, WI 53207-2965
CURRENT RESIDENT	3059 S KINNICKINNIC AVE 2	MILWAUKEE, WI 53207-2965
CURRENT RESIDENT	3059 S KINNICKINNIC AVE 3	MILWAUKEE, WI 53207-2965
CURRENT RESIDENT	3059 S KINNICKINNIC AVE 4	MILWAUKEE, WI 53207-2965
CURRENT RESIDENT	3059 S KINNICKINNIC AVE 5	MILWAUKEE, WI 53207-2965
CURRENT RESIDENT	3059 S KINNICKINNIC AVE 6	MILWAUKEE, WI 53207-2965
CURRENT RESIDENT	3059 S KINNICKINNIC AVE 7	MILWAUKEE, WI 53207-2965

CURRENT RESIDENT	3059 S KINNICKINNIC AVE 8	MILWAUKEE, WI 53207-2965
CURRENT RESIDENT	3069 S KINNICKINNIC AVE 1	MILWAUKEE, WI 53207-2965
CURRENT RESIDENT	3069 S KINNICKINNIC AVE 2	MILWAUKEE, WI 53207-2965
CURRENT RESIDENT	3069 S KINNICKINNIC AVE 3	MILWAUKEE, WI 53207-2965
CURRENT RESIDENT	3069 S KINNICKINNIC AVE 4	MILWAUKEE, WI 53207-2965
CURRENT RESIDENT	3069 S KINNICKINNIC AVE 5	MILWAUKEE, WI 53207-2965
CURRENT RESIDENT	3069 S KINNICKINNIC AVE 6	MILWAUKEE, WI 53207-2965
CURRENT RESIDENT	3069 S KINNICKINNIC AVE 7	MILWAUKEE, WI 53207-2965
CURRENT RESIDENT	3069 S KINNICKINNIC AVE 8	MILWAUKEE, WI 53207-2965
CURRENT RESIDENT	3072 S KINNICKINNIC AVE	MILWAUKEE, WI 53207-2966
CURRENT RESIDENT	3074 S KINNICKINNIC AVE	MILWAUKEE, WI 53207-2966
CURRENT RESIDENT	3078 S KINNICKINNIC AVE	MILWAUKEE, WI 53207-2966
CURRENT RESIDENT	3078A S KINNICKINNIC AVE	MILWAUKEE, WI 53207-2966

Total Records: 69

Radius: 250.0 feet and Center of Circle: 3087 S Kinnickinnic AV



BUSINESS LICENSE PLAN OF OPERATION

cci-busplan 3/17/15

Office of the City Clerk License Division
200 E. Wells St. Room 105, Milwaukee, WI 53202
(414) 286-2238 www.milwaukee.gov/license e-mail address: license@milwaukee.gov

1. Type of Business

Applying for: ☒ Extended Hours Establishment License ☒ Filling Station License ☐ Other (plan of operation for specific license also required)

Provide a detailed description of the type of business you plan on operating:

Convenience Store & Gas Filling Station

Do you have any experience operating this type of business? ☐ No ☒ Yes

If yes, explain: 2 other gas filling stations owned and operated

2. Business Operations

- a. Proposed Opening Date: ASAP
- b. Is this premise under construction? ☒ No ☐ Yes If yes, list estimated completion date: _____
- c. Is this a franchise? ☒ No ☐ Yes
- d. Is this premises currently licensed? ☐ No ☒ Yes If yes, list type of license: Cigarette / extended / No rights & means
- e. Is the current licensee operating? ☐ No ☒ Yes If no, list date closed: _____
- f. Do you have future plans for other businesses, licenses or permits at this location? ☒ No ☐ Yes
If yes, explain: _____
- g. Have you previously held an Extended Hours License in Milwaukee? ☒ No ☐ Yes
If yes, list address(es): _____
- h. Are other businesses operating in the same building? ☒ No ☐ Yes If yes, describe: _____

3. Litter & Noise Control

- a. How are grounds kept clean? ☒ Sweep ☒ Pressure Wash ☒ Pick Up Litter ☒ Hired Maintenance
☒ Building Owner Responsibility ☒ Garbage Cans Outside ☐ Other: _____
- b. How often will grounds be cleaned? ☒ Daily ☐ Weekly ☐ As Needed ☐ Monthly ☐ Other: _____
- c. Grounds cleaned by: ☒ Licensee ☒ Building Owner ☒ Employees ☒ Hired Maintenance ☐ Other: All have certain duties
- d. How are noise issues prevented and/or addressed? ☐ Security ☐ Manager approaches customer(s) ☒ Call Police
☒ Signs Posted ☐ Other: _____
Will a sound amplification system be used? ☒ No ☐ Yes If yes, describe: _____
- e. Are there designated outdoor smoking areas? ☒ No ☐ Yes If yes, describe: _____
- f. Number of Garbage Cans: Inside: _____ Locations: _____
Outside: 5 Locations: By the filling stations and C-Store exit/entry
- g. Is a crowd control barrier used? ☒ No ☐ Yes If yes, describe: _____
- h. Describe sanitation facilities (restrooms): _____
- i. Name of solid waste contractor: ☐ Advanced Disposal ☐ Waste Management ☐ Other: _____

4. Parking & Security

- a. Are there off-street parking places? ☒ No ☐ Yes If yes, how many? _____

Describe security plan for parking lot: Cameras

- b. Is there a loading zone? ☒ No ☐ Yes If yes, describe security for loading zone _____

- c. Will you have security personnel on premise? ☒ No ☐ Yes If yes, how many? _____

What are their responsibilities? _____

Is security equipment used? ☐ No ☒ Yes If yes, describe Cameras and recorder

List their licensing, certification, or training credentials _____

Will there be security cameras? ☐ No ☒ Yes If yes, where? at fueling stations and C-store

Will searches or identification checks be conducted upon entry? ☒ No ☐ Yes If yes, describe _____

5. Percentage of Sales (must total 100%)

Alcohol _____%	Food <u>60</u> %	Secondhand Merchandise _____%	Precious Metals & Gems _____%
Entertainment _____%	Cigarettes <u>40</u> %		
Pawnbroker Activity _____%	Salvaged Materials _____% (such as scrap metal)	Other _____% Describe: _____	

6. Businesses/Licenses on the Premises (check all that apply):

Type 1

- | | | | |
|--|---|---|--|
| <input type="checkbox"/> Full Service Restaurant | <input type="checkbox"/> Cafe/Coffee Shop | <input type="checkbox"/> Deli or Fast Food Restaurant | <input type="checkbox"/> Private/Fraternal/Veterans Club |
| <input type="checkbox"/> Night Club | <input type="checkbox"/> Tavern | <input type="checkbox"/> Cocktail Lounge | <input type="checkbox"/> Teen Club |
| <input type="checkbox"/> Bowling Alley | <input type="checkbox"/> Hotel | <input type="checkbox"/> Banquet Hall | <input type="checkbox"/> Sports Facility |

Type 2

- | | | | |
|---|---|---|---|
| <input type="checkbox"/> Liquor Store | <input type="checkbox"/> Corner Store | <input type="checkbox"/> Supermarket | <input checked="" type="checkbox"/> Convenience Store |
| <input checked="" type="checkbox"/> Gas Station | <input type="checkbox"/> Amusement/Phonograph Distributor | <input type="checkbox"/> Auto Wrecker | |
| <input type="checkbox"/> Used Car Dealer | <input type="checkbox"/> Used Auto Parts | <input type="checkbox"/> Personal Service Establishment | <input type="checkbox"/> Recording Studio |

What other types of licenses/permits will you hold at this location? (check all that apply)

- | | | | | | |
|--|---|---|--|---|--|
| <input checked="" type="checkbox"/> Occupancy Permit | <input checked="" type="checkbox"/> Cigarette & Tobacco | <input checked="" type="checkbox"/> Gas Station | <input checked="" type="checkbox"/> Extended Hours | <input type="checkbox"/> Class "B" Tavern | <input checked="" type="checkbox"/> Weights & Measures |
| <input type="checkbox"/> Secondhand Dealer | <input type="checkbox"/> Precious Metal & Gem | <input type="checkbox"/> Other: _____ | | | |

7. Legal Capacity (only if a Type 1 premises in #6 above)

Capacity _____ (Call the Milwaukee Development Center at 414-286-8211 if you have questions.)

8. Premises Description

d. Identify all area(s) of the premises that will be used in operating this business (include areas used only for storage):

☒ 1st Floor ☐ 2nd Floor ☐ Basement Storage ☐ Patio ☐ Beer Garden ☐ Sidewalk Café ☐ Deck ☐ Rooftop

☐ Other: Describe: _____

e. Describe Location: ☐ Major Thoroughfare ☐ Secondary Street ☐ Other: _____

f. Nearest Major Cross Street: _____

g. Describe Building: ☒ Free Standing Building ☐ Strip Mall ☐ Other: _____

h. Describe Premises Structure: ☒ Single Story ☐ Multi-Story - # of Stories _____ ☐ Other: _____

i. Describe Surrounding Area: ☒ Commercial ☐ Residential ☐ Industrial ☐ Other: _____

j. Property Owner's Name: Kinnick Real Estate LLC Phone Number: 847-886-4016

Address: 1701 E. WOODFIELD RD #327, Schaumburg, IL 60173

9. Hours of Operation & Customers

Will customers be entering the premises? ☐ No ☒ Yes

Day of the Week	Proposed Hours of Operation:		Number of Customers expected each day	Potential Age Range of Customers	Class B Applicants: Age Restriction (If none, write 'None')
	Open (Include a.m. or p.m.)	Close (Include a.m. or p.m.)			
Sunday	24 hours		100	18+	
Monday	24 hours				
Tuesday	24 hours				
Wednesday	24 hours				
Thursday	24 hours				
Friday	24 hours				
Saturday	24 hours				

Entertainment Indoor Closing Hours - If alcohol beverage establishment, same as alcohol license hours.
If non-alcohol establishment 1:00 am Sunday to Thursday; 1:30 am Friday and Saturday.

Entertainment Outdoor Closing Hours - 10:00 pm Sunday - Thursday; 12:00 am Friday and Saturday,
unless otherwise approved by Common Council in licensee's plan of operation.

10. Required Signature(s)

[Signature]
Sole Proprietor, Partner, Agent, or 20% or more Shareholder

Signature of additional partner or 20% or more Shareholder

See Application Information for a list of all required application forms.

3087 S. KINNICKINNIC

FLOOR PLAN

605 #2

7/22/15



NTS

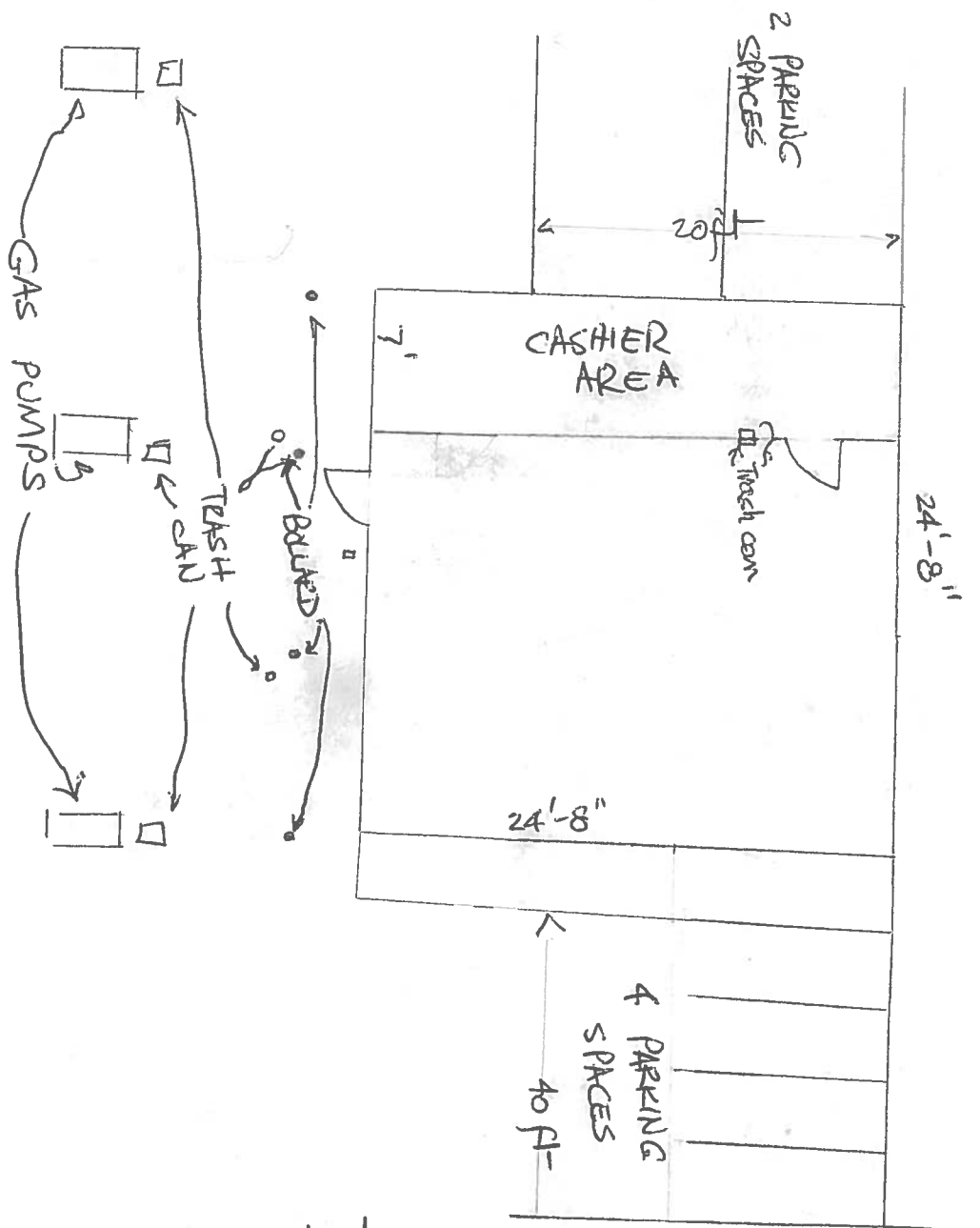

S. KINNICKINNIC AVE

AVE WYOMING
LEGAL ENTITY : FARUKH BAGASARA WALA
AGENT : SALEEM BAGASARA WALA



FOOD DEALER LICENSE PLAN OF OPERATION

OFFICE OF THE CITY CLERK, LICENSE DIVISION

CITY HALL, 200 E. WELLS ST, ROOM 105, MILWAUKEE, WI 53202 •

(414) 286-2238 • license@milwaukee.gov • www.milwaukee.gov/licenseLegal Entity Name: **Kinnick MART**Premises Address: **3087 S Kinnickinnic ave Milwaukee WI-53207**

1. Application Type

Is this a new food business or are you taking over a food business which is currently operating?

- ☒ Taking over a currently operating, licensed food business
☐ New business (includes taking over a closed food business)

Will you be sharing kitchen space with another food establishment?

- ☐ Yes, I intend to rent space in my kitchen to other food businesses
☐ Yes, I am renting space from another food business which will also be using the kitchen*
☒ No, I will be the only food business using the space

*If renting space in a commercial kitchen with another operator, a completed and signed Shared Kitchen Agreement is required.

The form is available at www.milwaukee.gov/license

Provide a brief description of the food establishment.

??
Coppacino & Ready Sandwich

Attach a copy of your menu or general listing of the types of food products that will be sold. Indicate what information you will be including:

- ☐ Menu ☐ List of the types of products (for example: packaged foods, deli case, meat department)

What is the anticipated opening date or date of change of ownership:

2. Construction, Remodeling and Equipment

Are any construction, remodeling or equipment changes planned? ☐ Yes ☒ No *If no, skip to section 3.*

Scope of the planned project?

- ☐ New construction or conversion of an existing structure to be used as a food establishment
☐ Renovation/remodeling of a food establishment, which may or may not include equipment changes
☐ Renovation/remodeling limited to the installation/change/replacement of food equipment

Provide a brief summary of the proposed construction, remodeling and/or equipment change:

Note: Building permits may be required. Contact the City of Milwaukee Development Center.

Date alterations/changes planned to begin

Name, address and phone number of architect

Name, address and phone number of general contractor

3. Premises Description

Will food be prepared or sold at a single or multiple food preparation and/or sale sites (for example a hotel with multiple dining rooms or bars):

☒ Single ☐ Multiple

If multiple sites will be used, how many distinct sites will be used? N/A

List all sites and briefly describe the nature of the food activities at each site:

Are any outdoor operations planned? ☐ Yes ☒ No

If yes, what activities will be conducted outdoors (check all that apply):

☐ Bar ☐ Cooking/Grilling ☐ Dining – Patio ☐ Dining – Sidewalk (DPW permit required) ☐ Storage

☐ Other, specify

Seating provided on site for dining? ☐ Yes ☒ No

If yes, are there additional banquet facilities other than the main dining area? ☐ Yes ☒ No

Total square footage of the establishment (exclude space utilized for other purposes other than food) 605

Number of Full Time Employees

23

Number of Part Time Employees

NONE

4. Business Type

Establishment Type (select the one that best describes the proposed business)

☐ Bed and Breakfast

☐ Community Food Program – free meal site or food pantry. Any site where all food is provided free of cost to those in need, or to organizations serving persons in need.

☐ Distiller or Brewer – facilities that are primarily engaged in the production of alcoholic beverages

☐ Food Distributor – a business that transports food for sale to retail and wholesale establishments and does not perform any food items
If distributor, is food stored on site? ☐ Yes ☐ No

☐ Food Manufacturer – commercial operation that produces, packages, labels, or stores food for human consumption, but primarily does not provide food directly to a consumer. Food is sold to distributors, retailers or restaurants. There may be a small store on site where only the manufacturers products are sold, but the majority of product is sold to other licensed food establishments.

If manufacturer, is there a retail store onsite? ☐ Yes ☐ No

☒ Food Store – a food establishment in which the majority of food sales consist of beverages or multi-serving food products requiring further preparation prior to consumption, examples of food stores include bakeries, grocery stores, convenience stores, coffee shops, liquor stores. Food stores include businesses whose primary business is other than food (book store, pharmacy, etc.), but offer convenience food items.

If Food store, are you considered a convenience food store (see definition below)? ☒ Yes ☐ No

A convenience food store contains less than 5,000 sq. ft. of retail sales space AND has as its primary business the sale of basic food items and in addition sells household products. Basic food items may include, but are not limited to, milk and dairy products, bread products, prepared sandwiches, frozen entrees, refrigerated food and baby food. Household products may include, but are not limited to, cleaning products, paper products, baby products and pet food

☐ School – educational institution including elementary, middle and high schools. Check type:

☐ Satellite Kitchen is a school kitchen with limited food preparation including reheating or holding of cooked food, storage of cold ready-to-eat food items and portioning and serving of bulk requiring no on-site preparation for service

☐ Production Kitchen is a school kitchen in which food preparation activities beyond reheating, portioning and hot and cold holding are performed

☐ Restaurant is a school kitchen operated by an outside entity or contractor, any school meal program not directly operated by the schools

☐ Restaurant – a food establishment in which the majority food sales consist of meals or other items ready for immediate consumption

☐ Shared Kitchen, Commissary or Base – a commercial kitchen used for the production of food to be served or sold at another location; a base of operations for a food peddler caterer or seasonal market vendor

☐ Tavern – a food establishment in which food sales are limited to beverages, primarily intoxicating beverages

4. Business Type (Continued)

Type of sales (check all that apply, even if it reflects a small percentage of the proposed business)

- ☒ Made directly to the general public or end consumer (includes internet sales)
☐ Made to other food establishments (wholesaler, distributors, retail or restaurants) who will resell your product(s)

What percentage of your planned food sales will be meals versus grocery items?

1 % from meals (ready-to-eat food)

99 % from grocery items (foods typically requiring preparation before serving, includes typical grocery items, beverages, bakery items and raw produce)

Will customers be able to purchase food through a drive through? ☐ Yes ☒ No

Will customers be able to purchase food from a self-service salad or food bar? ☐ Yes ☒ No

Will food be prepared on site and then transported for sale or consumption at another location? ☐ Yes ☒ No

If yes, check all the reasons why the food will be transported:

- ☐ Catering ☐ Delivery ☐ Base for Mobile Food Peddler ☐ Base for temporary or seasonal food stand

☒ Other-Describe:

Cappacino, Ready Sandwich
Its a Gas Station & Convenience Store

5. ISSUANCE OF LICENSE

Will any alcohol or intoxicating beverages be sold at the establishment? ☐ Yes ☒ No

If yes, what type of license do you have or will you be applying for?

- ☐ Class A fermented malt beverage license ☐ Class A liquor license
☐ Class B fermented malt beverage licenses ☐ Class B liquor license
☐ Class C wine license

N/A

If yes, if your food license is approved prior to the alcohol license, when would you like the food license issued?

- ☐ immediately so you can open your food business ☐ at the same time as the alcohol license

6. AFFIRMATION OF UNDERSTANDING – PERMIT NEEDED TO OPERATE

Read and initial each item confirming your understanding:

FB
FB

I understand that an inspection and sign off by the Health Department is required before my permit may be issued.

I understand that the Health Department will review my application and will update the application based on what is observed during my onsite inspection. My representative onsite at the time of inspection must have the authority to approve corrections to my application.

FB

I understand that an occupancy permit must be issued and an inspection may be required from the Department of Neighborhood Services before my permit may be issued.

FB

I understand that the Department of Neighborhood Services must sign off on my application with the License Division before my permit may be issued.

FB

I understand the local council member must approve or deny my request before my permit is eligible to be issued. If denied, I understand that I may appeal and be scheduled for a hearing before the License Committee of the Common Council.

FB

I understand that the License Division must have proof of payment for the associated permit fees before my permit may be issued.

FB

I understand that all of the above must be complete before my permit is eligible to be issued.

FB

I understand that the license for which I am applying must be issued and posted in my business premises prior to opening for business.

Farrukh Bagasrawala
Name of Applicant

, will not operate my food business, until the permit has been issued and posted in the establishment.

Signature of
Applicant:

Farrukh Bagasrawala

Date:

7/21/15



**CITY OF MILWAUKEE
OFFICE OF THE CITY CLERK**

Monday, August 31, 2015

COMMITTEE MEETING NOTICE

AD 14

LUCKS, Valeri A, Agent
Palomino Inc
2491 S SUPERIOR St

Milwaukee, WI 53207

You are requested to attend a hearing which is to be held in Room 301-B, Third Floor, City Hall on:

Tuesday, September 08, 2015 at 09:00 AM

Regarding: Your Class B Tavern and Public Entertainment Premises License Renewal Application With Change of Agent and Shareholder, Reorganization of Legal Entity, Change of Hours to Close at 2:30 AM Instead of 2 AM Fri and Adding 4 Pinball Machines as agent for "Palomino Inc" for "Palomino Bar" at 2491 S SUPERIOR St.

There is a possibility that your application may be denied for one or more of the following reasons: The recommendation of the committee regarding the application shall be based on evidence presented at the hearing. Per MCO 85-4-4, unless otherwise specified in the code, probative evidence concerning non-renewal, suspension or revocation may include evidence of the following: failure of the applicant to meet municipal qualifications, pending charges against or the conviction of any felony, misdemeanor, municipal offense or other offense, the circumstances of which substantially relate to the circumstances of the particular licensed or permitted activity, by the applicant or by any employee or other agent of the applicant. If the activities of the applicant involve a licensed premises, whether the premises tends to facilitate a public or private nuisance or has been the source of congregations of persons which have resulted in any of the following: disturbance of the peace; illegal drug activity; public drunkenness; drinking in public; harassment of passers-by; gambling; prostitution; sale of stolen goods; public urination; theft; assaults; battery; acts of vandalism including graffiti, excessive littering, loitering, illegal parking, loud noise at times when the licensed premise is open for business; traffic violations; curfew violations; lewd conduct; display of materials harmful to minors, pursuant to s. 106-9.6; or any other factor which reasonably relates to the public health, safety and welfare, or failure to comply with the approved plan of operation. See attached police report or correspondence.

**Notice for applicants with
warrants or unpaid fines:**

Proof of warrant satisfaction or payment of fines must be submitted at the hearing on the above date and time. Failure to comply with this requirement may result in a delay of the granting/denial of your application.

Failure to appear at this meeting may result in the denial of your license. Individual applicants must appear only in person or by an attorney. Corporate or Limited Liability applicants must appear only by the agent designated on the application or by an attorney. Partnership applicants must appear by a partner listed on the application or by an attorney. If you wish to do so and at your own expense, you may be accompanied by an attorney of your choosing to represent you at this hearing.

You will be given an opportunity to speak on behalf of the application and to respond and challenge any charges or reasons given for the denial. No petitions can be accepted by the committee, unless the people who signed the petition are present at the committee hearing and willing to testify. You may present witnesses under oath and you may also confront and cross-examine opposing witnesses under oath. If you have difficulty with the English language, you should bring an interpreter with you, at your expense, so that you can answer questions and participate in your hearing.

You may examine the application file at this office during regular business hours prior to the hearing date. Inquiries regarding this matter may be directed to the person whose signature appears below.

Limited parking for persons attending meetings in City Hall is available at reduced rates (5 hour limit) at the Milwaukee Center on the southwest corner of East Kilbourn and North Water Street. Parking tickets must be validated in the first floor information booth in City Hall.

PLEASE NOTE: Upon reasonable notice, efforts will be made to accommodate the needs of disabled individuals through sign language interpreters or other auxiliary aids. For additional information or to request this service, contact the Council Services Division ADA Coordinator at (414) 286-2998, Fax - (414) 286-3456, TDD - (414) 286-2025.

JIM OWCZARSKI, CITY CLERK

BY: _____

**Jason Schunk
License Division Manager**

If you have questions regarding this notice, please contact the License Division at (414) 286-2238.

MILWAUKEE POLICE DEPARTMENT

LICENSING

CRIMINAL RECORD/ORDINANCE VIOLATION/INCIDENTS SYNOPSIS

DATE: 05/28/2015

LICENSE TYPE: Class B Tavern

NEW: ☐

RENEWAL: ☒

No. 211870

Application Date: 05/27/2015

License Location: 2491 S Superior St

Business Name: Palomino Bar

Licensee/Applicant: Johnson, Scott M
(Last Name, First Name, MI)

Date of Birth: 11/04/1966

Home Address: 1622 N Astor St

City: Milwaukee

State: WI **Zip Code:** 53202

Home Phone: (414) 305-3081

This report is written by Police Officer Gilbert Gwinn, assigned to the License Investigation Unit, Days.

The Milwaukee Police Department's investigation regarding this application revealed the following:

1. On 05-27-04 at 9:35pm, Leslie Montemurro, who is a corporate officer for The Palmomino Bar, received three citations at 1701 N Arlington Place. (Display Of Liquor/Tavern License, Sale of Alcohol to Underage Person and Presence of Minor Prohibited.)

Charge: Display of Liquor/Tavern License
Sale of Alcohol to Underage Person
Presence of Minor Prohibited

Finding: Dismissed w/o Prejudice
Guilty Suspended Sentence
Guilty

Sentence: Fined \$150.00 for Presence of Minor Prohibited

Date: 09-15-04

Case: 04072829
04072830
04072831

2. On 12-12-2004 at 5:35pm an underage Milwaukee police aide, at the direction of Milwaukee police officers, entered the Palamino Club, 3279 S Superior St, where Scott M Johnson, corporate officer of Comet Café, Inc., is the Class B Licensee. The aide was able to purchase an alcoholic beverage from a bartender. (Included in summary for BTAVN0010700 04/01/2005).

Charge : Sale To Underage
Finding : Guilty
Sentence : Suspended Sentence
Date : 2-3-2005
Case : 05003859

=====

3. On 10/21/06, Milwaukee Police were working on a tobacco initiative regarding sales of tobacco products to underage persons. A 16 year old entered Palomino's located at 2491 S Superior and asked the bartender if he sold cigarettes. The bartender directed the 16 year old to the cigarette machine where the minor purchased a pack of Camel cigarettes. The bartender was identified as William Rouleau and he received a citation for Cigarette Sale To Minor.

As to William Rouleau:

Charge: Cigarette Sale To Minor
Finding: Guilty
Sentence: Fined \$100.00
Date: 01/18/07
Case: 06118123

=====

4. On 01/07/2013 at 12:52am, Milwaukee Police conducted a license premise check at the Palomino Bar, 2491 S Superior. The bartender was asked to see his bartender's license, which he stated he did not have on him and the bar, did not have a copy. The bartender voluntarily closed the bar and said he would provide a copy of his license at a later date. The licensee was notified of the violation via phone.

- =====
5. On 05/03/2014 the applicant was cited at 1716 North Arlington Place in the city of Milwaukee for Sale of Alcohol to Underage Person.

Charge: Sale of Alcohol to Underage Person
Finding: Guilty
Sentence: \$181.00 fine
Date: 07/02/2014
Case: 14041915

previous premise

6. On 05/03/2014 Leslie Montemurro was cited at 1701 North Arlington Place in the city of Milwaukee for Sale of Alcohol to Underage Person

previous premise

Charge: Sale of Alcohol to Underage Person
Finding: Guilty
Sentence: \$181.00 fine
Date: 07/02/2014
Case: 14041921

7. On 03/14/2015 Milwaukee police responded to a fight complaint at the Palomino Tavern. Investigation revealed a group of 4 patrons became loud and belligerent when the bartender refused to serve them. This group left the premise when officers arrived.

MILWAUKEE POLICE DEPARTMENT

REPORT OF INCIDENTS INVOLVING LICENSED PERSONS OR PREMISES

TO: Cpt. Diana ROWE

Business Name: The Palomino

Address of Licensed Premises: 2941 S Superior St

District: 6

Business Phone: 414-747-1700

Type of License: Class B

☐ Violation / ☒ Incident # CAD 15-073-0212

Date of Incident: 03/14/2015

Licensee or Manager on premises at time of violation / incident? ☒ Yes ☐ NoLicensee cooperative? ☒ Yes ☐ No (If no, explain in narrative section)

Licensee Notified by Officer: PO Ryan REDISKE

Date: 03/15/2015

Time: 0700

Licensee or Agent's Name: Scott M Johnson

Date of Birth: 11/4/66

Home Address: 1622 N Astor St, Milwaukee WI 53202

Home Phone: 278-1235

Co-Licensee Name: Leslie J Montemurro

Date of Birth: 2/14/65

Home Address: 1626 N Astor St, Milwaukee, WI 53202

Home Phone: 276-7111

Class S License Number:

Bartender Name: Peter Malley

Date of Birth: 04/02/1981

Home Address: 3421 S. 12th St

Home Phone: 414-935-8107

Class D License Number: 0213482

Licensed Person / Public Pass. Vehicle, etc.:

Date of Birth:

Home Address:

Home Phone:

Class D License Number:

VIOLATION/INCIDENT – DESCRIBE FACTS AND CIRCUMSTANCES IN NARRATIVE SECTION

Name of Person Cited:

Date of Birth:

Citation Number:

Violation & Ord. / Statue No.:

Court Date:

Name of Person Cited:

Date of Birth:

Citation Number:

Violation & Ord. / Statue No.:

Court Date:

Name of Person Cited:

Date of Birth:

Citation Number:

Violation & Ord. / Statue No.:

Court Date:

Name of Person Cited:

Date of Birth:

Citation Number:

Violation & Ord. / Statue No.:

Court Date:

Name of Person Cited:

Date of Birth:

Citation Number:

Violation & Ord. / Statue No.:

Court Date:

Investigating Officer: REDISKE, Ryan

District / Bureau:

Date: 3/15/2015

Cpt. Diana Rowe

MAR 20 2015

Commanding Officer

Date

DISPOSITION – FOR LICENSING ONLY

Citation No.	Case Number	Disposition	Judge	Date

LICENSE INVESTIGATION UNIT

Received

Referred

By

This report is written by PO Ryan REDISKE, assigned to District 6, Late Shift.

On 3/14/15, while working on sqd. 6340, I was dispatched to "fight" call at the Palomino Tavern (CAD 15-073-0212). Upon arrival, I spoke to the bar manager and caller, Peter D MALLEY. MALLEY stated at about 1:15AM he had refused service to a party of 4 who appeared very intoxicated. MALLEY stated when he refused service to them, they began to become biligerant and swear at him and threaten to "beat his ass". At this time, MALLEY again refused to serve the party, and they became louder and more boisterous. At this time, MALLEY called the police to remove the party. Upon my arrival at the location, there were 4 adults that MALLEY pointed out to be the party he was having problems with. He stated he simply wanted them off the premises and for them to not come back, and stated he did not want any citations issued. The party willingly complied with his request when I arrived, and the party left the location without incident.



Monday, August 31, 2015



Notice of Public Hearing

LUCKS, Valeri A, Agent

Palomino Bar at 2491 S SUPERIOR St

Class B Tavern and Public Entertainment Premises License Renewal Application With Change of Agent and Shareholder, Reorganization of Legal Entity, Change of Hours to Close at 2:30 AM Instead of 2 AM Fri and Adding 4 Pinball Machines

Tuesday, September 08, 2015 at 9:00 AM

To whom it may concern:

The above application has been made by the above named applicant(s). This requires approval from the Licenses Committee and the Common Council of the City of Milwaukee. The hearing before the Licenses Committee will take place on 9/8/2015 at 9:00 AM, in Room 301-B, Third Floor, City Hall. If you wish, you may provide testimony at the hearing regarding the request; see below for further information. You are not required to attend the hearing. Once the Licenses Committee makes its recommendation, this recommendation is forwarded to the full Common Council for approval at its next regularly scheduled hearing. Please review the information below and if you have further questions regarding this process, please contact the License Division at (414) 286-2238.

Important details for those wishing to provide information for the Licenses Committee to consider when making its recommendation:

1. The license application is scheduled to be heard at the above time. Due to other hearings running longer than scheduled, you may have to wait some time to provide your testimony.
2. You must appear in person and testify as to matters that you have personally experienced or seen. (You cannot provide testimony for your neighbor, parent or anyone else; this is considered hearsay and cannot be considered by the committee.)
3. No letters or petitions can be accepted by the committee (unless the person who wrote the letter or the persons who signed the petition are present at the committee hearing and willing to testify).
4. Persons opposed to the license application are given the opportunity to testify first; supporters may testify after the opponents have finished.
5. When you are called to testify, you will be sworn in and asked to give your name, and address. (If your first and/or last names are uncommon please spell them.)
6. You may then provide testimony.
 - a. Include only information relating to the above license application.
 - b. Include only information you have personally witnessed or seen.
 - c. Provide concise and relevant information detailing how this business has affected or may affect the peaceful enjoyment of your neighborhood.
 - d. If by the time you have the opportunity to testify, the information you wish to share has already been provided to the committee, you may state that you agree with the previous testimony. Redundant or repetitive testimony will not assist the committee in making its recommendation.
7. After giving your testimony, the members of the Licenses Committee and the licensee may ask questions regarding the testimony you have given or other factors relating to the license application.
8. Business Competition is not a valid basis for denial or non-renewal of a license.

Please Note: If you have submitted an objection to the above application your objection cannot be considered by the committee unless you personally testify at the hearing.

RESIDENT	MAIL ADDRESS	CITY AND ZIP CODE
CURRENT RESIDENT	1411 E POTTER AVE	MILWAUKEE, WI 53207-1918
CURRENT RESIDENT	1422 E RUSSELL AVE	MILWAUKEE, WI 53207-1924
CURRENT RESIDENT	1426 E RUSSELL AVE	MILWAUKEE, WI 53207-1924
CURRENT RESIDENT	1427 E RUSSELL AVE	MILWAUKEE, WI 53207-1923
CURRENT RESIDENT	1430 E RUSSELL AVE A	MILWAUKEE, WI 53207-1983
CURRENT RESIDENT	1430 E RUSSELL AVE B	MILWAUKEE, WI 53207-1983
CURRENT RESIDENT	1430 E RUSSELL AVE C	MILWAUKEE, WI 53207-1983
CURRENT RESIDENT	1436 E RUSSELL AVE	MILWAUKEE, WI 53207-1924
CURRENT RESIDENT	1440 E RUSSELL AVE	MILWAUKEE, WI 53207-1924
CURRENT RESIDENT	2457 S SUPERIOR ST	MILWAUKEE, WI 53207-1953
CURRENT RESIDENT	2463 S SUPERIOR ST	MILWAUKEE, WI 53207-1953
CURRENT RESIDENT	2463 S SUPERIOR ST A	MILWAUKEE, WI 53207-1953
CURRENT RESIDENT	2465 S WENTWORTH AVE	MILWAUKEE, WI 53207-1955
CURRENT RESIDENT	2467 S SUPERIOR ST	MILWAUKEE, WI 53207-1953
CURRENT RESIDENT	2470 S WENTWORTH AVE	MILWAUKEE, WI 53207-1956
CURRENT RESIDENT	2471 S SUPERIOR ST	MILWAUKEE, WI 53207-1953
CURRENT RESIDENT	2471 S WENTWORTH AVE	MILWAUKEE, WI 53207-1955
CURRENT RESIDENT	2472 S WENTWORTH AVE	MILWAUKEE, WI 53207-1956
CURRENT RESIDENT	2473 S WENTWORTH AVE	MILWAUKEE, WI 53207-1955
CURRENT RESIDENT	2473A S WENTWORTH AVE	MILWAUKEE, WI 53207-1955
CURRENT RESIDENT	2476 S WENTWORTH AVE	MILWAUKEE, WI 53207-1956
CURRENT RESIDENT	2476 S WENTWORTH AVE A	MILWAUKEE, WI 53207-1956
CURRENT RESIDENT	2477 S SUPERIOR ST	MILWAUKEE, WI 53207-1953
CURRENT RESIDENT	2479 S WENTWORTH AVE	MILWAUKEE, WI 53207-1955
CURRENT RESIDENT	2481 S SUPERIOR ST	MILWAUKEE, WI 53207-1953
CURRENT RESIDENT	2481 S SUPERIOR ST A	MILWAUKEE, WI 53207-1953
CURRENT RESIDENT	2482 S WENTWORTH AVE	MILWAUKEE, WI 53207-1956
CURRENT RESIDENT	2483 S WENTWORTH AVE	MILWAUKEE, WI 53207-1955
CURRENT RESIDENT	2484 S WENTWORTH AVE	MILWAUKEE, WI 53207-1956
CURRENT RESIDENT	2488 S WENTWORTH AVE	MILWAUKEE, WI 53207-1956
CURRENT RESIDENT	2488A S WENTWORTH AVE	MILWAUKEE, WI 53207-1956
CURRENT RESIDENT	2491 S SUPERIOR ST A	MILWAUKEE, WI 53207-1953
CURRENT RESIDENT	2494 S WENTWORTH AVE	MILWAUKEE, WI 53207-1956
CURRENT RESIDENT	2496 S WENTWORTH AVE A	MILWAUKEE, WI 53207-1956
CURRENT RESIDENT	2500 S WENTWORTH AVE	MILWAUKEE, WI 53207-1935
CURRENT RESIDENT	2502 S WENTWORTH AVE	MILWAUKEE, WI 53207-1935
CURRENT RESIDENT	2502A S WENTWORTH AVE	MILWAUKEE, WI 53207-1935
CURRENT RESIDENT	2506 S SUPERIOR ST	MILWAUKEE, WI 53207-1931
CURRENT RESIDENT	2507 S SUPERIOR ST	MILWAUKEE, WI 53207-1930
CURRENT RESIDENT	2508 S SUPERIOR ST	MILWAUKEE, WI 53207-1931
CURRENT RESIDENT	2509 S SUPERIOR ST	MILWAUKEE, WI 53207-1930
CURRENT RESIDENT	2511 S SUPERIOR ST	MILWAUKEE, WI 53207-1930
CURRENT RESIDENT	2512 S SUPERIOR ST	MILWAUKEE, WI 53207-1931
CURRENT RESIDENT	2515 S WENTWORTH AVE	MILWAUKEE, WI 53207-1934
CURRENT RESIDENT	2518 S SUPERIOR ST	MILWAUKEE, WI 53207-1931
CURRENT RESIDENT	2518 S WENTWORTH AVE	MILWAUKEE, WI 53207-1935
CURRENT RESIDENT	2519 S SUPERIOR ST	MILWAUKEE, WI 53207-1930
CURRENT RESIDENT	2519 S WENTWORTH AVE	MILWAUKEE, WI 53207-1934
CURRENT RESIDENT	2522 S SUPERIOR ST	MILWAUKEE, WI 53207-1931
CURRENT RESIDENT	2525 S SHORE DR 10A	MILWAUKEE, WI 53207-1925
CURRENT RESIDENT	2525 S SHORE DR 10B	MILWAUKEE, WI 53207-1925
CURRENT RESIDENT	2525 S SHORE DR 10C	MILWAUKEE, WI 53207-1925
CURRENT RESIDENT	2525 S SHORE DR 10D	MILWAUKEE, WI 53207-1925
CURRENT RESIDENT	2525 S SHORE DR 10E	MILWAUKEE, WI 53207-1925
CURRENT RESIDENT	2525 S SHORE DR 10F	MILWAUKEE, WI 53207-1925

CURRENT RESIDENT	2525 S SHORE DR 11A
CURRENT RESIDENT	2525 S SHORE DR 11B
CURRENT RESIDENT	2525 S SHORE DR 11C
CURRENT RESIDENT	2525 S SHORE DR 11D
CURRENT RESIDENT	2525 S SHORE DR 11E
CURRENT RESIDENT	2525 S SHORE DR 11F
CURRENT RESIDENT	2525 S SHORE DR 12A
CURRENT RESIDENT	2525 S SHORE DR 12B
CURRENT RESIDENT	2525 S SHORE DR 12C
CURRENT RESIDENT	2525 S SHORE DR 12E
CURRENT RESIDENT	2525 S SHORE DR 12F
CURRENT RESIDENT	2525 S SHORE DR 13A
CURRENT RESIDENT	2525 S SHORE DR 13B
CURRENT RESIDENT	2525 S SHORE DR 13C
CURRENT RESIDENT	2525 S SHORE DR 13D
CURRENT RESIDENT	2525 S SHORE DR 13E
CURRENT RESIDENT	2525 S SHORE DR 13F
CURRENT RESIDENT	2525 S SHORE DR 14A
CURRENT RESIDENT	2525 S SHORE DR 14B
CURRENT RESIDENT	2525 S SHORE DR 14C
CURRENT RESIDENT	2525 S SHORE DR 14D
CURRENT RESIDENT	2525 S SHORE DR 14E
CURRENT RESIDENT	2525 S SHORE DR 14F
CURRENT RESIDENT	2525 S SHORE DR 15A
CURRENT RESIDENT	2525 S SHORE DR 15B
CURRENT RESIDENT	2525 S SHORE DR 15C
CURRENT RESIDENT	2525 S SHORE DR 15D
CURRENT RESIDENT	2525 S SHORE DR 15E
CURRENT RESIDENT	2525 S SHORE DR 15F
CURRENT RESIDENT	2525 S SHORE DR 16A
CURRENT RESIDENT	2525 S SHORE DR 16B
CURRENT RESIDENT	2525 S SHORE DR 16C
CURRENT RESIDENT	2525 S SHORE DR 16D
CURRENT RESIDENT	2525 S SHORE DR 16E
CURRENT RESIDENT	2525 S SHORE DR 16F
CURRENT RESIDENT	2525 S SHORE DR 17A
CURRENT RESIDENT	2525 S SHORE DR 17B
CURRENT RESIDENT	2525 S SHORE DR 17C
CURRENT RESIDENT	2525 S SHORE DR 17D
CURRENT RESIDENT	2525 S SHORE DR 17E
CURRENT RESIDENT	2525 S SHORE DR 17F
CURRENT RESIDENT	2525 S SHORE DR 18A
CURRENT RESIDENT	2525 S SHORE DR 18B
CURRENT RESIDENT	2525 S SHORE DR 18C
CURRENT RESIDENT	2525 S SHORE DR 18D
CURRENT RESIDENT	2525 S SHORE DR 18E
CURRENT RESIDENT	2525 S SHORE DR 18F
CURRENT RESIDENT	2525 S SHORE DR 19A
CURRENT RESIDENT	2525 S SHORE DR 19B
CURRENT RESIDENT	2525 S SHORE DR 19C
CURRENT RESIDENT	2525 S SHORE DR 19D
CURRENT RESIDENT	2525 S SHORE DR 19E
CURRENT RESIDENT	2525 S SHORE DR 19F
CURRENT RESIDENT	2525 S SHORE DR 1C
CURRENT RESIDENT	2525 S SHORE DR 1D

[illegible]

[illegible]

CURRENT RESIDENT	2525 S SHORE DR 5A	MILWAUKEE, WI 53207-1925
CURRENT RESIDENT	2525 S SHORE DR 5B	MILWAUKEE, WI 53207-1925
CURRENT RESIDENT	2525 S SHORE DR 5C	MILWAUKEE, WI 53207-1925
CURRENT RESIDENT	2525 S SHORE DR 5D	MILWAUKEE, WI 53207-1925
CURRENT RESIDENT	2525 S SHORE DR 5E	MILWAUKEE, WI 53207-1925
CURRENT RESIDENT	2525 S SHORE DR 5F	MILWAUKEE, WI 53207-1925
CURRENT RESIDENT	2525 S SHORE DR 6A	MILWAUKEE, WI 53207-1925
CURRENT RESIDENT	2525 S SHORE DR 6B	MILWAUKEE, WI 53207-1925
CURRENT RESIDENT	2525 S SHORE DR 6C	MILWAUKEE, WI 53207-1925
CURRENT RESIDENT	2525 S SHORE DR 6D	MILWAUKEE, WI 53207-1925
CURRENT RESIDENT	2525 S SHORE DR 6E	MILWAUKEE, WI 53207-1925
CURRENT RESIDENT	2525 S SHORE DR 6F	MILWAUKEE, WI 53207-1925
CURRENT RESIDENT	2525 S SHORE DR 7A	MILWAUKEE, WI 53207-1925
CURRENT RESIDENT	2525 S SHORE DR 7B	MILWAUKEE, WI 53207-1925
CURRENT RESIDENT	2525 S SHORE DR 7C	MILWAUKEE, WI 53207-1925
CURRENT RESIDENT	2525 S SHORE DR 7D	MILWAUKEE, WI 53207-1925
CURRENT RESIDENT	2525 S SHORE DR 7E	MILWAUKEE, WI 53207-1925
CURRENT RESIDENT	2525 S SHORE DR 7F	MILWAUKEE, WI 53207-1925
CURRENT RESIDENT	2525 S SHORE DR 8A	MILWAUKEE, WI 53207-1925
CURRENT RESIDENT	2525 S SHORE DR 8B	MILWAUKEE, WI 53207-1925
CURRENT RESIDENT	2525 S SHORE DR 8C	MILWAUKEE, WI 53207-1925
CURRENT RESIDENT	2525 S SHORE DR 8D	MILWAUKEE, WI 53207-1925
CURRENT RESIDENT	2525 S SHORE DR 8E	MILWAUKEE, WI 53207-1925
CURRENT RESIDENT	2525 S SHORE DR 8F	MILWAUKEE, WI 53207-1925
CURRENT RESIDENT	2525 S SHORE DR 9A	MILWAUKEE, WI 53207-1925
CURRENT RESIDENT	2525 S SHORE DR 9B	MILWAUKEE, WI 53207-1925
CURRENT RESIDENT	2525 S SHORE DR 9C	MILWAUKEE, WI 53207-1925
CURRENT RESIDENT	2525 S SHORE DR 9D	MILWAUKEE, WI 53207-1925
CURRENT RESIDENT	2525 S SHORE DR 9E	MILWAUKEE, WI 53207-1925
CURRENT RESIDENT	2525 S SHORE DR 9F	MILWAUKEE, WI 53207-1925
CURRENT RESIDENT	2525 S SUPERIOR ST	MILWAUKEE, WI 53207-1930
CURRENT RESIDENT	2530 S SUPERIOR ST	MILWAUKEE, WI 53207-1931

Total Records: 200

Radius: 250.0 feet and Center of Circle: 2491 S Superior ST



PLAN OF OPERATION

1. Premises Location

☒ Free Standing Building ☐ Strip Mall ☐ Other _____

2. Describe Premises Structure

☐ Single Story ☒ Multi-Story - # of Stories 2 ☐ Other _____

3. Describe Surrounding Area

☐ Commercial ☒ Residential ☐ Industrial ☐ Other _____

4. Premises Location

a) ☒ Major Thoroughfare ☐ Secondary Street ☐ Other _____

b) Nearest Cross Street RUSSELL ST. & SUPERIOR ST.

5. Proximity of Premises to Church, School, or Hospital

Is there at least 300 feet between the building and any church, school or hospital? ☒ Yes ☐ No

6. Miscellaneous Business Questions

a) Proposed Opening Date: _____

b) Is this premise under construction? ☐ Yes ☒ No If yes, list estimated completion date: _____

c) Is this a franchise? ☐ Yes ☒ No

d) Is this premises currently licensed? ☒ Yes ☐ No If yes, list type of license: CLASS B TAVERN

e) Is the current licensee operating? ☒ Yes ☐ No If no, list date closed: _____

f) What other types of licenses/permits will you or do you hold at this location? (check all that apply)

☒ Occupancy Permit ☐ Cigarette & Tobacco ☐ Gas Station ☐ Extended Hours

☐ Other: _____

g) Do you have future plans for other businesses, licenses or permits at this location? ☐ Yes ☒ No

If yes, explain: _____

7. Food

Will food be served on the premises? ☐ No ☒ Yes If yes, a Food Dealer license is required.

Check all that apply: ☐ Prepackaged Food ☐ Shacks ☐ Appetizers ☐ Catered Events

☒ Full Meals - Hours of Food Service: From 10am To 10pm

A menu must be submitted with this Plan of Operation for all restaurants.

8. Type of Business

Briefly describe the type of business you plan to operate if granted a license (attached additional sheets as necessary.)

Full Service restaurant serving from scratch
locally grown food.

9. Litter and Noise

How are the grounds kept clean? ☒ Sweep ☒ Pressure Wash ☒ Pick Up Litter ☐ Other: _____How often will grounds be cleaned? ☒ Daily ☒ Weekly ☐ Other: _____Grounds Cleaned By: ☒ Licensee ☒ Building Owner ☒ Employees ☒ Hired Maintenance ☐ Other: _____How are noise issues prevented and/or addressed? ☐ Security ☒ Manager approaches customer(s) ☐ Call Police☐ Signs Posted ☒ Other: STAFF APPROACHES

10. Smoking and Sanitation

Are there designated outdoor smoking areas? ☒ No ☐ Yes

If yes, describe the area(s) and provide location(s): _____

Number of Garbage Cans: Inside: 8 Locations: AT BAR AND AT SEWER STATION, BATHROOMS, KITCHENOutside: 2 Locations: ON PATIO BY TABLESIs a Crowd Control Barrier used? ☒ No ☐ Yes If yes, describe: _____Describe sanitation facilities (restrooms): 2 SINGLE PERSON RESTROOMSProvide name of solid waste contractor: EAGLE

11. Security

Are there parking spaces on the premises? ☒ No ☐ Yes If yes, number of spaces: _____ and describe security provisions: _____Are there designated loading areas? ☒ No ☐ Yes If yes, describe security provisions: _____Do you have security personnel on the premise? ☒ No ☐ Yes If yes, how many? _____

AND What are their responsibilities? _____

What security equipment do they use? _____

List their licensing, certification or training credentials: _____

Are there security cameras? ☐ No ☒ Yes If yes, list all locations: 2 INSIDE, 2 OUTSIDE ON DOORS (BET. AND BAR)Are searches and/or identification checks conducted upon entry? ☒ No ☐ Yes If yes, describe: _____

12. Percentage of Sales (must total 100%)

Alcohol 35 % Food Sales 65 % Entertainment 0 % Other 0 %

13. Businesses On The Premise (choose all that apply):

Type 1

☒ Full Service Restaurant ☐ Cafe/Coffee Shop ☐ Deli or Fast Food Restaurant ☐ Private/Fraternal/Veterans Club☐ Night Club ☐ Tavern ☐ Cocktail Lounge ☐ Teen Club☐ Bowling Alley ☐ Hotel ☐ Banquet Hall ☐ Sports Facility

Type 2

☐ Liquor Store ☐ Corner Store ☐ Supermarket ☐ Convenience Store☐ Gas Station ☐ Other: _____

14. Legal Capacity of Premises (Only premises identified as Type I in Question #13)

80 (Call the Milwaukee Development Center at 414-286-8211 if you have questions.)

15. Hours of Operation

Day of the Week	Proposed Hours of Operation:		Number of Customers expected each day	Potential Age Range of Customers	Class B Applicants: Age Restriction (If none, write 'None')
	Open	Close			
Sunday	10:00 AM	2 AM	250	18+	AAAA UNDER 21
Monday	10:00 AM	2 AM	150		
Tuesday	10:00 AM	2 AM	150		
Wednesday	10:00 AM	2 AM	150		
Thursday	10:00 AM	2 AM	250		
Friday	10:00 AM	2:30 AM	300		
Saturday	10:00 AM	2:30 AM	300		

NOT PERMITTED
AFTER 10 PM

Entertainment Indoor Closing Hours - If alcohol beverage establishment, same as alcohol license hours.
If non-alcohol establishment 1:00 am Sunday to Thursday; 1:30 am Friday and Saturday.

Entertainment Outdoor Closing Hours - 10:00 pm Sunday - Thursday; 12:00 am Friday and Saturday,
unless otherwise approved by Common Council in licensee's plan of operation.

16. This Section to be Completed by Alcohol Applicants Only

a) Property Owners Name: SCOTT JOHNSON Phone Number: 414.305.3081
Address: 1622 ASTOR ST. MILWAUKEE, WI 53207

b) Are you taking out this application for anyone that may not be eligible for a license? ☒ No ☐ Yes

If yes, list name and address: _____

c) Will the agent, a partner or the individual licensee be conducting the day-to-day operations of the business? ☐ No ☒ Yes

If no, list the name and address of the person(s) who will: _____

Class B Applicants: If the agent, a partner or the individual licensee will not be conducting the day-to-day operations of the business, the person(s) listed above must obtain a Class B Managers license.

d) Does anyone else have money invested or any other interest in this business? ☒ No ☐ Yes

If yes, explain: _____

e) Have you made an agreement with anyone to repay any loan or any other payments based upon income from the business?

☒ No ☐ Yes If yes, list name and address: _____

f) Will any of the following types of businesses be conducted at this location? (check all that apply)

- ☐ Bed & Breakfast ☐ Billiard/Pool Hall ☐ Comedy Club ☐ Indoor Golf Facility
☐ Video Game Center (6 or more games) ☐ Brew Pub ☐ Volleyball Court ☐ Theater ☐ Wine Tasting Room
☐ Department Store ☐ Pharmacy ☐ Gift Shop ☐ Museum ☐ Center for the Visual & Performing Arts

g) If applying for Class B or C license, are you applying for "Service Bar Only"? ☒ No ☐ Yes

Service Bar Only means customers cannot sit at the bar. Alcohol is served to patrons seated at tables. No stools, chairs or other articles of furniture shall be placed at the service bar for patrons to sit upon.

17. Proof of Ownership, Lease, or Offer to Purchase (new & transfer applicants only)

Submit proof of ownership, lease, or offer to purchase the building with this application.

A lease or offer to purchase must:

- a) Be in the same legal entity name as that apply for the license
b) Reflect the same address as the premises address on this application
c) Reflect current dates and
d) Be signed by the lessor/seller and lease/buyer

18. Property Information (new & transfer applicants only)

- a) Do you own or lease the building? ☐ Own ☒ Lease
- b) Who owns the fixtures (for example, coolers, etc.)? BUSINESS
- c) Are you purchasing the stock and/or fixtures? ☐ No ☒ Yes If yes, amount paid \$ \$200,000
- d) Total amount paid for business \$ \$200,000
- e) Total amount paid for goodwill of the business \$ 0

Goodwill comprises the reputation and customer relationships of an existing business. If the price you pay for the business exceeds the fair market value of all of the rest of the assets of the business, the excess may be considered goodwill.

- f) Have you made arrangements with the seller for payment of personal property taxes? ☒ No ☐ Yes

19. Lease Information (new & transfer applicants who are leasing the premises only)

- a) Date lease begins 7/1/15 Ends 6/30/20
- b) Monthly rental \$ 4500 -
- c) Do you have an option to renew the lease? ☐ No ☒ Yes
- d) Does your lease allow for assignment to another party without the consent of the owner? ☒ No ☐ Yes
- e) For what length of time have you been guaranteed occupancy (number of years)? 10 yrs
- f) In addition to paying the monthly rental, will you have to pay anything additional to the owner of the building to guarantee performance of the lease? ☒ No ☐ Yes If yes, explain _____
- g) Does the present owner or occupancy object to the granting of your license? ☒ No ☐ Yes
If yes, explain _____

20. Change of Agent Applicants Only

- Have there been any changes to the floor plan since the last application was submitted? ☒ No ☐ Yes

If no, a new floor plan is not required. If yes, submit a new floor plan and explain the change(s): _____

21. Notarized Signatures of Applicants

SUBSCRIBED AND SWORN TO BEFORE ME

This 10th day of July

(Clerk/Notary Public)

My Commission Expires 07-08-2017

*Notary Seal must be affixed

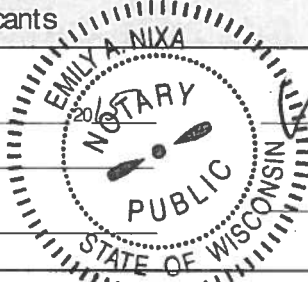

Agent/Owner/Partner

Additional Owner/Partner

Note: All information contained in this application is subject to approval by the Common Council.
Deviating from approved plan of operation will subject licensee to citations, and/or suspension or non-renewal of the license.
Contact the License Division for information on how to request changes.

New and transfer of premise applicants must submit the following:

- ☐ Proof of ownership, lease or offer to purchase the building
- ☐ Detailed floor plan
- ☐ If a restaurant, copy of the menu

If you do not provide all required information, your application will be returned to you.

(1) CURRENT ENTERTAINMENT

The following types of entertainment have been approved for your current Public Entertainment Premises license:

4 Pinball Machines

(2) SELECT ANY TYPES OF ENTERTAINMENT THAT YOU ARE REQUESTING TO ADD *No changes in entertainment shall take place until approved by the Common Council and a new license has been issued and posted on the premises.

- | | | | |
|---|---|--|--|
| <input type="checkbox"/> Instrumental Musicians | <input type="checkbox"/> Bands | <input type="checkbox"/> Battle of the Bands | <input type="checkbox"/> Comedy Acts |
| <input checked="" type="checkbox"/> Disc Jockey | <input type="checkbox"/> Magic Shows | <input type="checkbox"/> Poetry Readings | <input type="checkbox"/> Dancing by Performers |
| <input type="checkbox"/> Jukebox | <input type="checkbox"/> Wrestling | <input type="checkbox"/> Patron Contests | <input type="checkbox"/> Patrons Dancing |
| <input type="checkbox"/> Adult Entertainment/
Strippers/Erotic Dance | <input type="checkbox"/> Karaoke | <input type="checkbox"/> Bowling Alley | <input type="checkbox"/> Pool Tables |
| <input type="checkbox"/> Motion Pictures | <input type="checkbox"/> Amusement Machines – | <input type="checkbox"/> Concerts | <input type="checkbox"/> Theatrical Performances |
| How many screens? _____ | How many? _____ | Approx. # per year? _____ | Approx. # per year? _____ |
| <input type="checkbox"/> Other: _____ | | | |

(3) REMOVE ENTERTAINMENT

If applicable, list any entertainment you wish to remove: _____

(4) WILL PROMOTERS EVER BE USED FOR ANY OF THE ENTERTAINMENT?

☒ No ☐ Yes, describe: _____

(5) LEGAL CAPACITY OF PREMISES

80 (Call the Milwaukee Development Center at 414-286-8211 if you have questions.) Your legal capacity will determine the license fee for your Public Entertainment Premise License. If you would like to request that the license be approved with a lower capacity than that listed above, indicate lower capacity _____. If approved, this lower capacity will print on your license and override the capacity listed on your Occupancy Permit.

(6) IDENTIFY IF SOUND AMPLIFICATION IS USED

☒ No ☐ Yes, describe: _____

(7) DECLARATIONS, ACKNOWLEDGEMENTS, & DISCLOSURES

Read And Initial Each Item Confirming Your Understanding:

- ☒ I understand that after the license has been issued, a change to the plan of operation will require a written request to change and approval from the Common Council.
- ☒ I agree to inform the City Clerk within 10 days of any substantial changes in the information supplied in this application.
- ☒ I understand that I shall not willfully refuse to provide the services offered under this license, or add charges or require deposits not required of the general public because of race, color, sex, religion, national origin or ancestry, age, handicap, lawful source of income, marital status, sexual orientation, gender identity or expression, familial status or the fact that a person is now or has been a member of the military service, whether dressed in uniform or not; and shall not seek such information as a condition of employment, or penalize any employee or discriminate in the selection of personnel for training or promotion on the basis of such information.
- ☒ I have knowledge of the City Ordinances currently regulating public entertainment, and understand that the license may be subject to suspension, non-renewal or revocation, if I violate any rule, law or regulation of the city of Milwaukee and State of Wisconsin.

(8) NOTARIZED SIGNATURES OF APPLICANTS

SUBSCRIBED AND SWORN TO BEFORE ME

This 26th day of MAY, 20 15

[Signature]
(Clerk/Notary Public)
My Commission Expires 2/18/18

[Signature]
Agent/Owner/Partner

Additional Owner/Partner

*Notary Seal must be affixed.

