



LIVING WITH HISTORY

# Certificate of Appropriateness

Milwaukee Historic Preservation Commission/200 E. Wells Street/Milwaukee, WI 53202/phone 414-286-5712/fax 414-286-3004

**Property** 210 E. MICHIGAN ST. East Side Commercial Historic District  
**Description of work** Scope of work involves securing guardrails, new stringers, treads, and other miscellaneous structural support as required.  
**Date issued** 3/28/2014 PTS ID 93499 COA, fire escape repairs

In accordance with the provisions of Section 320-21 (11) and (12) of the Milwaukee Code of Ordinances, the Milwaukee Historic Preservation Commission has issued a certificate of appropriateness for the work listed above. The work was found to be consistent with preservation guidelines. The following conditions apply to this certificate of appropriateness:

All work will be done according to the specifications and drawings contained in this COA. Replacement of deteriorated treads and other components on fire escape on north and east elevations will be done as needed and the new parts will match the existing ones.

All work must be done in a craftsman-like manner, and must be completed within one year of the date this certificate was issued. Staff must approve any changes or additions to this certificate before work begins. Work that is not completed in accordance with this certificate may be subject to correction orders or citations. If you require technical assistance, please contact Paul Jakubovich of the Historic Preservation staff as follows: Phone: (414) 286-5712 Fax: (414) 286-3004 E-mail: [pjakub@milwaukee.gov](mailto:pjakub@milwaukee.gov).

If permits are required, you are responsible for obtaining them from the Milwaukee Development Center. If you have questions about permit requirements, please consult the Development Center's web site, [www.milwaukee.gov/build](http://www.milwaukee.gov/build), or call (414) 286-8210.

City of Milwaukee Historic Preservation

Copies to: Development Center, Ald. Robert Bauman, Inspector Bill Richter (286-2518), Inspector Heidi Weed

Deteriorated treads and other parts of existing fire escape will be replaced in-kind with new materials. No design changes.

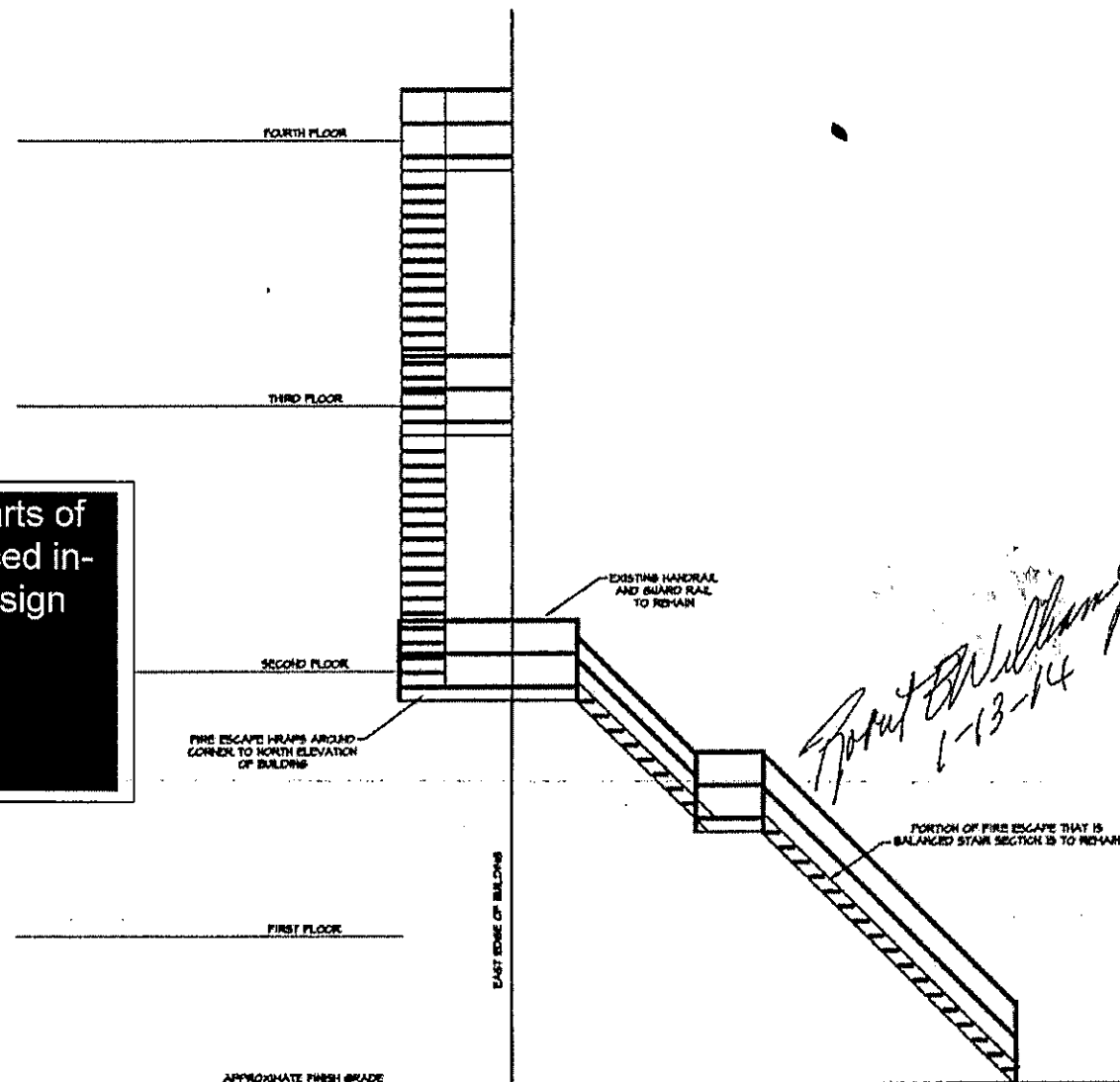

NORTH ELEVATION

OPTION 2

*Robert E. Williams*  
1-13-14

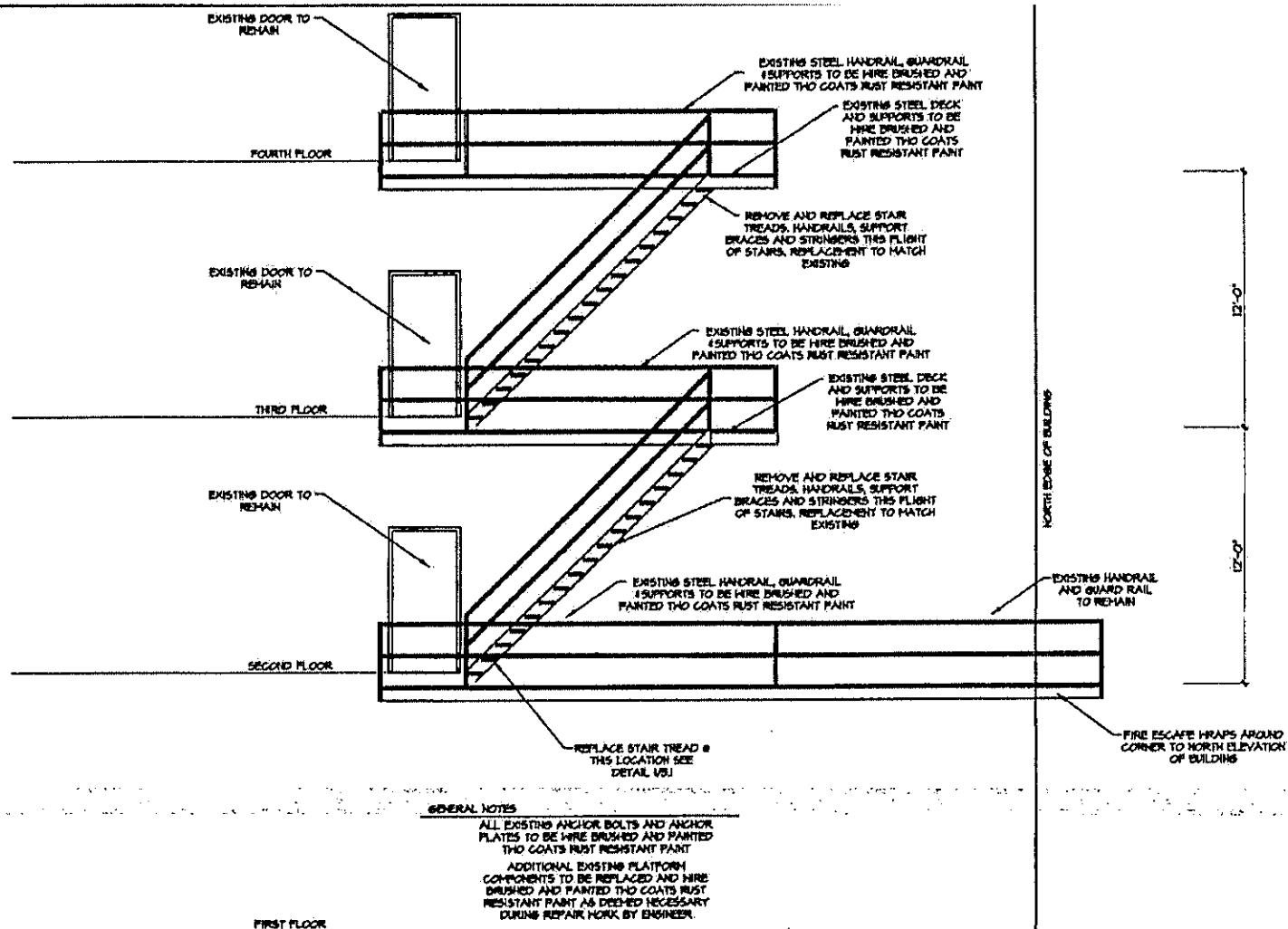

#### GENERAL NOTES

ALL EXISTING ANCHOR BOLTS AND ANCHOR PLATES TO BE WIRE BRUSHED AND PAINTED TWO COATS RUST RESISTANT PAINT

ADDITIONAL EXISTING PLATFORM COMPONENTS TO BE REPLACED AND WIRE BRUSHED AND PAINTED TWO COATS RUST RESISTANT PAINT AS DEEMED NECESSARY DURING REPAIR WORK BY ENGINEER

1  
A31  
EAST ELEVATION  
OPTION 2

Deteriorated treads and other parts of existing fire escape will be replaced in-kind with new materials. No design changes.