



Certificate of Appropriateness

Milwaukee Historic Preservation Commission/200 E. Wells Street/Milwaukee, WI 53202/phone 414-286-5712/fax 414-286-3004

| | | |
|----------------------------|---|---|
| Property | 301 E. WISCONSIN AV. | East side Commerical historic District |
| Description of work | Install new storefront doors and glazing at entry on east end of Wisconsin Avenue storefront. | |
| Date issued | 3/12/2014 | PTS ID 93259 COA, storefront doors |

In accordance with the provisions of Section 320-21 (11) and (12) of the Milwaukee Code of Ordinances, the Milwaukee Historic Preservation Commission has issued a certificate of appropriateness for the work listed above. The work was found to be consistent with preservation guidelines. The following conditions apply to this certificate of appropriateness:

All work will be done according to attached drawings.

All work must be done in a craftsman-like manner, and must be completed within one year of the date this certificate was issued. Staff must approve any changes or additions to this certificate before work begins. Work that is not completed in accordance with this certificate may be subject to correction orders or citations. If you require technical assistance, please contact Paul Jakubovich of the Historic Preservation staff as follows: Phone: (414) 286-5712 Fax: (414) 286-3004 E-mail: pjakub@milwaukee.gov.

If permits are required, you are responsible for obtaining them from the Milwaukee Development Center. If you have questions about permit requirements, please consult the Development Center's web site, www.milwaukee.gov/build, or call (414) 286-8210.

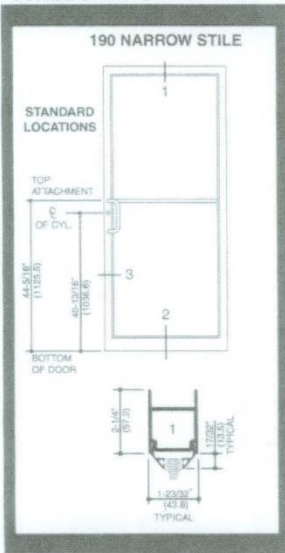
City of Milwaukee Historic Preservation

Copies to: Development Center, Ald. Robert Bauman, Inspector Bill Richter (286-2518), Inspector Heidi Weed

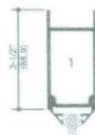
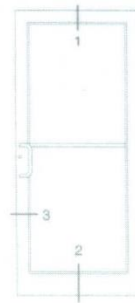


**ILLUSTRATION OF AREA TO BE FITTED WITH NEW ENTRY
DOORS AND RELATED STOREFRONT GLAZING.**

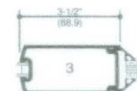
SCALE 3" = 1' 0"



350 MEDIUM STILE

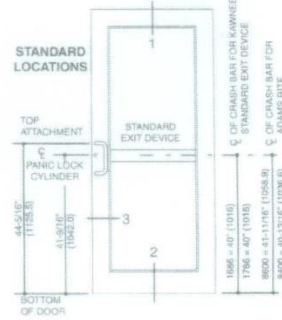


SINGLE ACTING

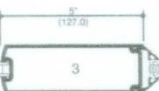


DOUBLE ACTING

500 WIDE STILE



SINGLE ACTING



DOUBLE ACTING

Labels and building and safety codes governing the design and use of glazed entrance, window, and curtain wall products vary widely. KAWNEER does not warrant that the products shown in this document are suitable for use in all jurisdictions and assumes no responsibility therefor.

Kawneer reserves the right to change configuration without prior notice when deemed necessary for product improvement.

© Kawneer Companies, Inc. 2011

kawneer.com

KAWNEER
AN ALCOA COMPANY

Entrance doors to be installed