



**CITY OF MILWAUKEE  
OFFICE OF THE CITY CLERK**

Thursday, April 25, 2024

**COMMITTEE MEETING NOTICE**

AD 13

PATEL, Bhavin G, Agent  
BKS FOOD LLC  
1591 E Arbor Creek DR  
Oak Creek, WI 53154

You are requested to attend a hearing which is to be held in Room 301-B, Third Floor, City Hall or you may attend virtually using the link below.

**Tuesday, May 07, 2024 at 10:40 AM**

The access code is <https://meet.goto.com/335080869>. If you wish to call in: **+1 (408) 650-3123** and use Access Code: **335-080-869**  
Please see the enclosed best practices document for further instructions.

**Regarding:** Your Class B Tavern and Food Dealer License Applications as agent for "BKS FOOD LLC" for "HONEST PAVBHAI" at 3400 S 27TH St.

There is a possibility that your application may be denied for one or more of the following reasons: The recommendation of the committee regarding the application shall be based on evidence presented at the hearing. Per MCO 85-2.7-4, probative evidence concerning whether or not a new license should be granted may be presented on the following subjects: whether or not the applicant meets the municipal requirements, the appropriateness of the location and premises where the licensed premises is to be located and whether use of the premises for the purposes or activities permitted by the license would tend to facilitate a public or private nuisance or create undesirable neighborhood problems such as disorderly patrons, unreasonably loud noise, litter, and excessive traffic and parking congestion. Probative evidence relating to these matters may be taken from the plan of operation submitted with the license application, if any, but shall not include the content of any music. Evidence regarding the fitness of the location of the premises to be maintained as the principal place of business, including but not limited to whether there is an overconcentration of businesses of the type for which the license is sought; whether the proposal is consistent with any pertinent neighborhood business or development plans, or the location's proximity to areas where children are typically present. The applicant's record in operating similarly licensed premises; and whether or not the applicant has been charged with or convicted of any felony, misdemeanor, municipal offense or other offense, the circumstances of which substantially relate to the activity to be permitted by the license being applied for or any other factor which reasonably relates to the public health, safety or welfare may also be considered. See attached police report or correspondence.

**Notice for applicants with warrants or unpaid fines:**

**Proof of warrant satisfaction or payment of fines must be submitted at the hearing on the above date and time. Failure to comply with this requirement may result in a delay of the granting/denial of your application.**

Failure to appear at this meeting may result in the denial of your license. Individual applicants must appear only in person or by an attorney. Corporate or Limited Liability applicants must appear only by the agent designated on the application or by an attorney. Partnership applicants must appear by a partner listed on the application or by an attorney. If you wish to do so and at your own expense, you may be accompanied by an attorney of your choosing to represent you at this hearing.

You will be given an opportunity to speak on behalf of the application and to respond and challenge any charges or reasons given for the denial. No petitions can be accepted by the committee, unless the people who signed the petition are present at the committee hearing and willing to testify. You may present witnesses under oath and you may also confront and cross-examine opposing witnesses under oath. If you have difficulty with the English language, you should bring an interpreter with you, at your expense, so that you can answer questions and participate in your hearing.

You may examine the application file at this office during regular business hours prior to the hearing date. Inquiries regarding this matter may be directed to the person whose signature appears below.

Limited parking for persons attending meetings during normal business hours is available at reduced rates (5 hour limit) at the Milwaukee Center on the southwest corner of Kilbourn Avenue and Water Street. You must present a copy of the meeting notice to the parking cashier.

PLEASE NOTE: Upon reasonable notice, efforts will be made to accommodate the needs of disabled individuals through sign language interpreters or other auxiliary aids. For additional information or to request this service, contact the Council Services Division ADA Coordinator at (414) 286-2998, Fax - (414) 286-3456, TDD - (414) 286-2025.

JIM OWCZARSKI, CITY CLERK

BY: \_\_\_\_\_

Jim Cooney  
License Division Manager

**If you have questions regarding this notice, please contact the License Division at (414) 286-2238.**

200 E. Wells Street, Room 105, City Hall, Milwaukee, WI 53202. [www.milwaukee.gov/license](http://www.milwaukee.gov/license)  
Phone: (414) 286-2238 Fax: (414) 286-3057 Email Address: [License@milwaukee.gov](mailto:License@milwaukee.gov)

# MILWAUKEE POLICE DEPARTMENT LICENSING

## CRIMINAL RECORD/ORDINANCE VIOLATION/INCIDENTS SYNOPSIS

**DATE:** 03/28/24

**LICENSE TYPE:** Class B Tavern

**NEW:**

**RENEWAL:**

**No. 363435**

**Application Date:**

**License Location:** 3400 S 27<sup>th</sup> St

**Business Name:** Honest Pavbhaji

**Licensee/Applicant:** Patel, Bhavin  
(Last Name, First Name, MI)

**Date of Birth:** 05/05/80

**Home Address:** 1591 E Arbor Creek Dr

**City:** Oak Creek

**State:** WI **Zip Code:** 53154

**Home Phone:**

This report is written by Police Officer Penny Monreal, assigned to the License Investigation Unit, Days.

The Milwaukee Police Department's investigation regarding this application revealed the following:

1. On 06/17/19, the applicant was cited at 2008 W. Layton Ave., for Responsible Person of Premise Required.

**Charge:** Responsible Person on Premise  
**Finding:** Guilty  
**Sentence:** Fine  
**Date:** 09/12/19  
**Case:** 19027833

2. On 10/26/19, the applicant was cited at 2008 W. Layton Ave., for Sale of Cigarettes to Minor.

**Charge:** Sale of Cigarette to Minor/Underage  
**Finding:** Guilty  
**Sentence:** Fine  
**Date:** 01/02/2020  
**Case:** 19054632

# MILWAUKEE POLICE DEPARTMENT LICENSING

## CRIMINAL RECORD/ORDINANCE VIOLATION/INCIDENTS SYNOPSIS

**DATE:** 03/28/24

**LICENSE TYPE:** BTAVN

**NEW:**

**RENEWAL:**

**No. 363435**

**Application Date:**

**License Location:** 3400 S. 27<sup>th</sup> Street

**Business Name:** Royal India Bar and Grill

**Licensee/Applicant:** KAUR, Parajjit  
(Last Name, First Name, MI)

**Date of Birth:** 02/09/1989

**Home Address:** 3420 S. 26<sup>th</sup> Street

**City:** Milwaukee

**State:** WI    **Zip Code:** 53215

**Home Phone:** 414-458-3337

This report is written by Police Officer Corstan D. COURT, assigned to the License Investigation Unit, Days.

The Milwaukee Police Department's investigation regarding this application revealed the following:

1. On 04/08/19 at 10:49pm, Milwaukee Police investigated a fight which occurred at 3400 S. 27<sup>th</sup> Street. Investigation revealed that a customer entered the establishment angry and charged toward the workers in the back of the establishment who were eating and started fighting them. The customer was held back by a female and they left the restaurant.

=====

**PREVIOUS PREMISE**

Date: 4/3/2024  
Officer: P.O. Fabian Garcia

City of Milwaukee Police Department  
90-5-1.5 Crime Prevention Survey  
Tavern Inspection

Name of Premise: BKS Food  
Address: 3400 S. 27<sup>th</sup> St.  
Phone: Will add phone and internet

Owner:  
Owner address:  
City State Zip:  
Owner Phone:  
Owner email:

Licensee/Agent: Bhavin Patel  
Home Address: 1591 E. Arbor Creek Dr.  
City State Zip: Oak Creek, WI, 53154  
Phone: 414-469-5288  
Email: dvana4u@gmail.com

Preferred contact: either or

Location currently open:  YES  NO

Projected open date: 2<sup>nd</sup> week of May

Day's open: S M T W Th F SA ALL

Hours of Operation: Sun: 10am-10pm 24 hours Y N  
Mon: 10am-10pm  
Tue: 10am-10pm  
Wed: 10am-10pm  
Thu: 10am-10pm  
Fri: 10am-11pm  
Sat: 10am-11pm

Premise Type:  Tavern/Bar  
 Restaurant  
 Other:

Licenses currently held:

- Alcohol:  Yes  No Class: #:  
Tobacco:  Yes  No #:  
Food:  Yes  No #:  
Extended Hours:  Yes  No #:  
Secondhand Dealer:  Yes  No Type: #:  
Other:  Yes  No Type: #:  
Other:  Yes  No Type: #:

**Exterior Survey:**

1. Is the area around the location clean?  Yes  No
2. What surrounds the location? (Check all the apply)
  - a.  Park
  - b.  School
  - c.  Youth Center
  - d.  Church
  - e.  Tavern(s) If so, how many
  - f.  Residential
  - g.  Other businesses
  - h.  Other:
3. Can you see from the outside of the location into the interior  Yes  No
4. Can you see the employees inside of the location from the outside  Yes  No
5. Are exterior windows free of signage  Yes  No
6. Is there a parking lot  Yes  No
7. Is the parking lot clean?  Yes  No
8. Off-Street parking  Yes  No –Residential streets
9. Is the parking lot well lit?  Yes  No –Not observed
10. Valet Parking  Yes  No
  - a. Will this lot have a guard?  Yes  No
  - b. Will this lot have cameras?  Yes  No
11. Are there areas where a person could conceal themselves  Yes  No
12. Is there exterior lighting?  Yes  No. Does it appears to be adequate  Yes  No –  
Not observed
13. Exterior Payphone?  Yes  No
14. Are there No Loitering Signs posted?  Yes  No
15. Are there exterior security cameras  Yes  No How Many: 1
16. Are the address numbers prominently displayed and easy to see  Yes  No

**Camera Survey:**

17. Does this location have security cameras?  Yes  No –Will add
18. Are they in working order?  Yes  No
19. What format are the cameras?
  - a. Color  Yes  No
  - b. Digital  Yes  No
  - c. Recorded  Yes  No
20. How long is footage stored for later viewing:
21. Are there exterior cameras  Yes  No How many: 4

22. Are there interior cameras  Yes  No How many: Will add approx. 8  
 23. Do all employees know how to retrieve recorded digital images/footage?  Yes  No  
 24. Cameras located in parking lot  Yes  No How many 1

**Interior Survey:**

25. What is the planned capacity Approx. 80  
 26. What is the minimum number of employees That will be on premise 3  
 27. Is the storeowner willing to be a standing complainant regarding loitering?  Yes  No  
 a. If yes have them fill out the standing complaint form and give them two of the commercial signs  Yes  No  
 28. Is the interior of the location neat and clean?  Yes  No –Still under renovation  
 29. Does an interior camera face the entrance/exit?  Yes  No –Will add  
 30. Is there a lockable area that separates employees from customers?  Yes  No –In back  
 31. Are emergency and non-emergency numbers posted near the phone?  Yes  No –Will add  
 32. Does the owner know how to contact their police district directly?  Yes  No  
 a. Did you provide a district contact guide to the owner?  Yes  No

**Security** No Security

33. How many security personnel are going to be employed:  
 34. How will they be deployed: Interior Exterior  
 35. What days will they be deployed  Mon  Tue  Wed  Thu  Fri  Sat  Sun  
 36. Will the security be managed by business  or contracted   
 37. Will they be armed  Yes  No  
 38. What type of security measures to be used:  
 Wanding/metal detector  
 ID Scanner  
 Dress Code  
 Cover Charge  
 Age restriction  
 Other

**ADDITIONAL COMMENTS/RECOMMENDATIONS:**

This report was written by Police Officer Fabian Garcia assigned to District 6-Community Partnership Unit.

On Wednesday, April 3<sup>rd</sup>, 2024, at 12pm, my partner Police Officer Michael Ward and I conducted a CPTED at 3400 S. 27<sup>th</sup> St. and spoke to the licensee/agent Bhavin Patel. Patel stated that he plan on opening up every day and plans on opening up the second week of May. The

location will be strictly a restaurant and is currently under renovations. Currently, the location does not have interior cameras, but Patel plans on installing approximately 8 interior cameras which will face the entry and exit points, as well as the cash register area. The restaurant is attached to another business, which is located to the south and has shared parking. The location does have 3 exterior cameras which are not operated by Mr. Patel. The exterior lighting was not observed at this time, but Mr. Patel stated that there was adequate lighting. Mr. Patel stated that he is willing to be a standing complainant and was provided the standing complainant form which he will return to us at a later date.





## Summary

Name	Count	Area(ft <sup>2</sup> )	Length(mi)
Alcohol Licenses	11		

## Alcohol Licenses

#	Legal Entity	Trade Name	Licensee	Address	License Type Name	Total Capacity	Expiration Date	Count
1	OUR LADY QUEEN OF PEACE CONGREGATION	OUR LADY QUEEN OF PEACE CONGREGATION	ANN DARGIS, Agt	3222 S 29TH ST	Class B Fermented Malt Beverage Retailer's License		3/27/2024, 7:00 PM	1
2	JSJK Inc	Royal India Bar & Grill	Paramjit Kaur, Agt	3400 S 27th ST	Class B Tavern License		5/30/2024, 7:00 PM	1
3	DUAL FOOD SYSTEMS, INC	NED'S PIZZA SOUTH	SCOTT O STOLZ, Agt	3246 S 27TH ST	Class B Fermented Malt Beverage Retailer's License	40	6/18/2024, 7:00 PM	1
4	DUAL FOOD SYSTEMS, INC	NED'S PIZZA SOUTH	SCOTT O STOLZ, Agt	3246 S 27TH ST	Class C Wine Retailer's License	40	6/18/2024, 7:00 PM	1
5	MEGA MARTS, LLC	PICK 'N SAVE #6845	DEBRA L HANSING, Agt	3701 S 27TH ST	Class A Malt & Class A Liquor License		1/17/2025, 6:00 PM	1
6	GURU BEER & LIQUOR, LLC	GURU BEER & LIQUOR	Iqbal K Ghotra, Agt	3404 S 27TH ST	Class A Malt & Class A Liquor License		2/7/2025, 6:00 PM	1
7	Sran Beer and Liquor Inc	Wilson Park Beverage Mart	Gagandeep S Sran, Agt	3511 S 20TH ST	Class A Malt & Class A Liquor License		2/8/2025, 6:00 PM	1
8	GK&D Enterprises, Inc	Omega Family Restaurant	Debbie Koutromanos, Agt	3473 S 27th ST	Class B Tavern License	250	1/19/2025, 6:00 PM	1
9	LP LIMIT MANAGER, INC	ZEBB'S RESTAURANT	PROKOPIOS P LIAPIS, Agt	2701 W MORGAN AV	Class B Tavern License	152	3/13/2025, 7:00 PM	1
10	OUR LADY QUEEN OF PEACE CONGREGATION	OUR LADY QUEEN OF PEACE CONGREGATION	ANN DARGIS, Agt	3222 S 29TH ST	Class B Fermented Malt Beverage Retailer's License		3/27/2025, 7:00 PM	1
11	Blazin Wings, Inc	Buffalo Wild Wings #415	Scott D Page, Agt	3636 S 27th ST	Class B Tavern License		3/20/2025, 7:00 PM	1

Establishments within a 0.5 miles radius centered on area of interest.



Thursday, April 25, 2024



# Notice of Public Hearing

Blank Notice

---

PATEL, Bhavin G, Agent  
HONEST PAVBHAI at 3400 S 27TH St  
Class B Tavern and Food Dealer License Applications

**Tuesday, May 07, 2024 at 10:40 AM**

To whom it may concern:

The above application has been made by the above named applicant(s). This requires approval from the Licenses Committee and the Common Council of the City of Milwaukee. The hearing before the Licenses Committee will take place on 5/7/2024 at 10:40 AM in Room 301-B, Third Floor, City Hall. This is a public hearing. Those wishing to view the proceeding are able to do so via the City Channel – Channel 25 on Spectrum Cable – or on the Internet at <http://city.milwaukee.gov/citychannel>. Those wishing to provide oral testimony via phone or internet are asked to contact the staff assistant, Yadira Melendez at (414) 286-2775 or [stasst5@milwaukee.gov](mailto:stasst5@milwaukee.gov) for necessary information. Please make such requests no later than one business day prior to the start of the meeting. You are not required to attend the hearing, but please see the information below if you would like to provide testimony. Once the Licenses Committee makes its recommendation, this recommendation is forwarded to the full Common Council for approval at its next regularly scheduled hearing.

---

## Important details for those wishing to provide information for the Licenses Committee to consider when making its recommendation:

1. The license application is scheduled to be heard at the above time. Due to other hearings running longer than scheduled, you may have to wait some time to provide your testimony.
2. You must appear in person and testify as to matters that you have personally experienced or seen. (You cannot provide testimony for your neighbor, parent or anyone else; this is considered hearsay and cannot be considered by the committee.)
3. No letters or petitions can be accepted by the committee (unless the person who wrote the letter or the persons who signed the petition are present at the committee hearing and willing to testify).
4. Persons opposed to the license application are given the opportunity to testify first; supporters may testify after the opponents have finished.
5. When you are called to testify, you will be sworn in and asked to give your name, and address. (If your first and/or last names are uncommon please spell them.)
6. You may then provide testimony.
  - a. Include only information relating to the above license application.
  - b. Include only information you have personally witnessed or seen.
  - c. Provide concise and relevant information detailing how this business has affected or may affect the peaceful enjoyment of your neighborhood.
  - d. If by the time you have the opportunity to testify, the information you wish to share has already been provided to the committee, you may state that you agree with the previous testimony. Redundant or repetitive testimony will not assist the committee in making its recommendation.
7. After giving your testimony, the members of the Licenses Committee and the licensee may ask questions regarding the testimony you have given or other factors relating to the license application.
8. Business Competition is not a valid basis for denial or non-renewal of a license.

**Please Note: If you have submitted an objection to the above application your objection cannot be considered by the committee unless you personally testify at the hearing.**

OCCUPANT	MAIL ADDRESS	CITY STATE ZIP
CURRENT OCCUPANT	2600 W HOLT AVE# 1	MILWAUKEE, WI 53215-4830
CURRENT OCCUPANT	2600 W HOLT AVE# 2	MILWAUKEE, WI 53215-4830
CURRENT OCCUPANT	2600 W HOLT AVE# 3	MILWAUKEE, WI 53215-4830
CURRENT OCCUPANT	2600 W HOLT AVE# 4	MILWAUKEE, WI 53215-4830
CURRENT OCCUPANT	3355 S 26TH ST	MILWAUKEE, WI 53215-4821
CURRENT OCCUPANT	3355 S 26TH ST# A	MILWAUKEE, WI 53215-4821
CURRENT OCCUPANT	3355 S 26TH ST# B	MILWAUKEE, WI 53215-4821
CURRENT OCCUPANT	3363 S 26TH ST	MILWAUKEE, WI 53215-4821
CURRENT OCCUPANT	3366 S 26TH ST	MILWAUKEE, WI 53215-4822
CURRENT OCCUPANT	3371 S 26TH ST	MILWAUKEE, WI 53215-4821
CURRENT OCCUPANT	3372 S 26TH ST	MILWAUKEE, WI 53215-4822
CURRENT OCCUPANT	3372A S 26TH ST	MILWAUKEE, WI 53215-4822
CURRENT OCCUPANT	3376 S 26TH ST	MILWAUKEE, WI 53215-4822
CURRENT OCCUPANT	3400 S 26TH ST	MILWAUKEE, WI 53215-4824
CURRENT OCCUPANT	3402 S 26TH ST	MILWAUKEE, WI 53215-4824
CURRENT OCCUPANT	3404 S 26TH ST	MILWAUKEE, WI 53215-4824
CURRENT OCCUPANT	3410 S 26TH ST	MILWAUKEE, WI 53215-4824
CURRENT OCCUPANT	3412 S 26TH ST	MILWAUKEE, WI 53215-4824
CURRENT OCCUPANT	3413 S 26TH ST# 1	MILWAUKEE, WI 53215-4858
CURRENT OCCUPANT	3413 S 26TH ST# 10	MILWAUKEE, WI 53215-4858
CURRENT OCCUPANT	3413 S 26TH ST# 11	MILWAUKEE, WI 53215-4859
CURRENT OCCUPANT	3413 S 26TH ST# 12	MILWAUKEE, WI 53215-4859
CURRENT OCCUPANT	3413 S 26TH ST# 13	MILWAUKEE, WI 53215-4859
CURRENT OCCUPANT	3413 S 26TH ST# 14	MILWAUKEE, WI 53215-4859
CURRENT OCCUPANT	3413 S 26TH ST# 15	MILWAUKEE, WI 53215-4859
CURRENT OCCUPANT	3413 S 26TH ST# 16	MILWAUKEE, WI 53215-4859
CURRENT OCCUPANT	3413 S 26TH ST# 17	MILWAUKEE, WI 53215-4859
CURRENT OCCUPANT	3413 S 26TH ST# 18	MILWAUKEE, WI 53215-4859
CURRENT OCCUPANT	3413 S 26TH ST# 19	MILWAUKEE, WI 53215-4859
CURRENT OCCUPANT	3413 S 26TH ST# 2	MILWAUKEE, WI 53215-4858
CURRENT OCCUPANT	3413 S 26TH ST# 3	MILWAUKEE, WI 53215-4858
CURRENT OCCUPANT	3413 S 26TH ST# 4	MILWAUKEE, WI 53215-4858
CURRENT OCCUPANT	3413 S 26TH ST# 5	MILWAUKEE, WI 53215-4858
CURRENT OCCUPANT	3413 S 26TH ST# 6	MILWAUKEE, WI 53215-4858
CURRENT OCCUPANT	3413 S 26TH ST# 7	MILWAUKEE, WI 53215-4858
CURRENT OCCUPANT	3413 S 26TH ST# 8	MILWAUKEE, WI 53215-4858
CURRENT OCCUPANT	3413 S 26TH ST# 9	MILWAUKEE, WI 53215-4858
CURRENT OCCUPANT	3414 S 26TH ST	MILWAUKEE, WI 53215-4824
CURRENT OCCUPANT	3416 S 26TH ST	MILWAUKEE, WI 53215-4824
CURRENT OCCUPANT	3420 S 26TH ST	MILWAUKEE, WI 53215-4824
CURRENT OCCUPANT	3422 S 26TH ST	MILWAUKEE, WI 53215-4824
CURRENT OCCUPANT	3426 S 26TH ST	MILWAUKEE, WI 53215-4824
CURRENT OCCUPANT	3428 S 26TH ST	MILWAUKEE, WI 53215-4824
CURRENT OCCUPANT	3430 S 26TH ST	MILWAUKEE, WI 53215-4824
CURRENT OCCUPANT	3432 S 26TH ST	MILWAUKEE, WI 53215-4824
CURRENT OCCUPANT	3439 S 26TH ST# 1	MILWAUKEE, WI 53215-4823

CURRENT OCCUPANT	3439 S 26TH ST# 10	MILWAUKEE, WI 53215-4823
CURRENT OCCUPANT	3439 S 26TH ST# 11	MILWAUKEE, WI 53215-4823
CURRENT OCCUPANT	3439 S 26TH ST# 12	MILWAUKEE, WI 53215-4823
CURRENT OCCUPANT	3439 S 26TH ST# 14	MILWAUKEE, WI 53215-4823
CURRENT OCCUPANT	3439 S 26TH ST# 15	MILWAUKEE, WI 53215-4823
CURRENT OCCUPANT	3439 S 26TH ST# 16	MILWAUKEE, WI 53215-4823
CURRENT OCCUPANT	3439 S 26TH ST# 17	MILWAUKEE, WI 53215-4823
CURRENT OCCUPANT	3439 S 26TH ST# 18	MILWAUKEE, WI 53215-4823
CURRENT OCCUPANT	3439 S 26TH ST# 19	MILWAUKEE, WI 53215-4823
CURRENT OCCUPANT	3439 S 26TH ST# 2	MILWAUKEE, WI 53215-4823
CURRENT OCCUPANT	3439 S 26TH ST# 20	MILWAUKEE, WI 53215-4823
CURRENT OCCUPANT	3439 S 26TH ST# 3	MILWAUKEE, WI 53215-4823
CURRENT OCCUPANT	3439 S 26TH ST# 4	MILWAUKEE, WI 53215-4823
CURRENT OCCUPANT	3439 S 26TH ST# 5	MILWAUKEE, WI 53215-4823
CURRENT OCCUPANT	3439 S 26TH ST# 6	MILWAUKEE, WI 53215-4823
CURRENT OCCUPANT	3439 S 26TH ST# 7	MILWAUKEE, WI 53215-4823
CURRENT OCCUPANT	3439 S 26TH ST# 8	MILWAUKEE, WI 53215-4823
CURRENT OCCUPANT	3439 S 26TH ST# 9	MILWAUKEE, WI 53215-4823

Blank Notice

Total Records: 64

Radius 250.0 feet and Center of the Circle: 3400 S 27th St



# BUSINESS LICENSE PLAN OF OPERATION

cci-busplan 5/12/2020

Office of the City Clerk License Division  
200 E. Wells St. Room 105, Milwaukee, WI 53202  
(414) 286-2238 www.milwaukee.gov/license e-mail address: [license@milwaukee.gov](mailto:license@milwaukee.gov)

## 1. Type of Business

Applying for:  Extended Hours (12AM to 5AM) - If a food establishment, check all that apply:  Delivery  Drive Thru  Dining Room  
 Self Service Laundry  Massage Establishment  Filling Station  
 Other (supplemental application for specific license also required)

Provide a detailed description of the type of business you plan on operating:

FULL SERVICE RESTAURANT

Do you have any experience operating this type of business?  No  Yes If yes, explain:

## 2. Business Operations

- a. Proposed Opening Date: 05/01/2024
- b. Is this premise under construction?  No  Yes If yes, list estimated completion date: \_\_\_\_\_
- c. Is this a franchise?  No  Yes
- d. Is this premises currently licensed?  No  Yes If yes, list type of license: \_\_\_\_\_
- e. Is the current licensee operating?  No  Yes If no, list date closed: \_\_\_\_\_
- f. Do you have future plans for other businesses, licenses or permits at this location?  No  Yes  
If yes, explain: \_\_\_\_\_
- g. Have you previously held an Extended Hours License in Milwaukee?  No  Yes  
If yes, list address(es): \_\_\_\_\_
- h. Are other businesses operating in the same building?  No  Yes If yes, describe: \_\_\_\_\_

## 3. Litter & Noise

- a. How are grounds kept clean?  Sweep  Pressure Wash  Pick Up Litter  Other: \_\_\_\_\_
- b. How often will grounds be cleaned?  Daily  Weekly  As Needed  Monthly  Other: \_\_\_\_\_
- c. Grounds cleaned by:  Licensee  Building Owner  Employees  Hired Maintenance  Other: \_\_\_\_\_
- d. How are noise issues prevented and/or addressed?  Security  Manager approaches customer(s)  Call Police  
 Signs Posted  Other: \_\_\_\_\_
- e. Will a sound amplification system be used?  No  Yes If yes, describe: \_\_\_\_\_

## 4. Smoking & Sanitation

- a. Are there designated outdoor smoking areas?  No  Yes If yes, describe: \_\_\_\_\_
- b. Number of Garbage Cans: Inside: 2 Locations: BEHIND CORNER, BY FRONT DOOR  
Outside: 2 Locations: NORTH SIDE OF BUILDING
- c. Is a crowd control barrier used?  No  Yes If yes, describe: \_\_\_\_\_
- d. How many restrooms are on the premises? 2
- e. Name of solid waste contractor:  Advanced Disposal  Waste Management  Other: \_\_\_\_\_

## 5. Security

- a. Are there onsite parking spaces?  No  Yes If yes, how many? 6 and describe the parking security plan: \_\_\_\_\_
- b. Is there a loading zone?  No  Yes If yes, describe the loading area security plan: \_\_\_\_\_
- c. Will you have security personnel on premise?  No  Yes If yes, how many? \_\_\_\_\_ and answer the following:  
 What are their responsibilities? \_\_\_\_\_  
 Is security equipment used?  No  Yes If yes, describe \_\_\_\_\_  
 List their licensing, certification, or training credentials \_\_\_\_\_
- d. Will there be security cameras?  No  Yes If yes, how many? 8 and list locations: \_\_\_\_\_  
SURROUNDING BUILDING & INSIDE
- e. Will searches/identification checks be done upon entry?  No  Yes If yes, describe \_\_\_\_\_

## 6. Percentage of Sales (must total 100%)

Alcohol <u>5</u> %	Food <u>95</u> %	Secondhand Merchandise _____ %	Precious Metals & Gems _____ %
Entertainment _____ %	Cigarettes _____ %	Personal Services (such as tattoo, body piercing, salon, tailor, tanning, etc.) _____ %	Other _____ % Describe: _____
Pawnbroker Activity _____ %	Salvaged Materials _____ % (such as scrap metal)		

## 7. Businesses/Licenses on the Premises (check all that apply):

### Type 1

- Full Service Restaurant  Cafe/Coffee Shop  Deli or Fast Food Restaurant  Private/Fraternal/Veterans Club
- Night Club  Tavern  Cocktail Lounge  Teen Club
- Banquet Hall  Sports Facility  Bowling Alley
- Hotel/Motel : Number of Floors: \_\_\_\_\_ Number of Rooms: \_\_\_\_\_  
 Rooming House: Number of Floors: \_\_\_\_\_ Number of Rooms: \_\_\_\_\_

### Type 2

- Liquor Store  Corner Store  Supermarket  Convenience Store
- Gas Station  Amusement/Phonograph Distributor  Recycling, Salvage or Towing
- Used Car Dealer  Personal Service Establishment (such as tattoo business, hair salon, tailor, etc.)  Recording Studio

What other licenses/permits will you hold at this location? (check all that apply)

- Occupancy Permit  Cigarette & Tobacco  Gas Station  Extended Hours  Class "B" Tavern  Weights & Measures
- Secondhand Dealer  Precious Metal & Gem  Other: \_\_\_\_\_

## 8. Legal Capacity (only if a Type 1 premises in #7 above)

Capacity 80 (Call the Milwaukee Development Center at 414-286-8211 if you have questions.)

## 9. Premises Description

a. Identify all area(s) of the premises that will be used in operating this business (include areas used only for storage):

1<sup>st</sup> Floor  2<sup>nd</sup> Floor  Basement Storage  Patio  Beer Garden  Sidewalk Café  Deck  Rooftop

Other: Describe: \_\_\_\_\_

b. Describe Location:  Major Thoroughfare  Secondary Street  Other: \_\_\_\_\_

c. Nearest Major Cross Street: 27th & MORGAN

d. Describe Building:  Free Standing Building  Strip Mall  Other: \_\_\_\_\_

e. Describe Premises Structure:  Single Story  Multi-Story - # of Stories \_\_\_\_\_  Other: \_\_\_\_\_

f. Describe Surrounding Area:  Commercial  Residential  Industrial  Other: \_\_\_\_\_

g. Building Owner Name: BALWINDER DHILLON Phone Number: \_\_\_\_\_

Building Owner Address: 936 W RIVERSIDE DR, OAK CREEK, WI-53154

## 10. Hours of Operation & Customers

Will customers be entering the premises?  No  Yes

Day of the Week	Proposed Hours of Operation:		Estimated Number of Customers expected each day	Potential Age Range of Customers	Class B Tavern Applicant Only: Age Restriction (If none, write 'None')
	Open Time (include a.m. or p.m.)	Close Time (include a.m. or p.m.)			
Sunday	10:00 AM	11:00 PM	50	16 & older	
Monday	10:00 AM	10:00 PM	50	"	
Tuesday	10:00 AM	10:00 PM	50	"	
Wednesday	10:00 AM	10:00 PM	50	"	
Thursday	10:00 AM	10:00 AM P.M.	50	"	
Friday	10:00 AM	11:00 PM	50	"	
Saturday	10:00 AM	11:00 PM	50	"	

An Extended Hours Establishment License is required for any convenience store, filling station, personal service establishment (such as tattoo, body piercing, salon, tailor, tanning, etc.), recording studio or restaurant which is open between the hours of 12:00 a.m. and 5:00 a.m.

Alcohol Establishments Permitted Hours of Operation: Class A: 8:00 am to 9:00 pm Sunday thru Saturday  
Class B: 6:00 am to 2:00 am Sunday thru Thursday, 6:00 am to 2:30 am Friday & Saturday

Entertainment Outdoor Closing Hours: 10:00pm Sunday-Thursday; 12:00am Friday & Saturday; unless a different time, either earlier or later, is established by the Common Council in its approval of the licensee's plan of operation.

## 11. Signature(s)

  
Signature of Sole Proprietor, Partner, or 20% or more Shareholder  
(If there are no 20% or more shareholders, Corporate Officer-print name/title and sign)

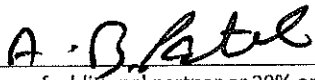
  
Signature of additional partner or 20% or more shareholder

See Application Information for a complete list of all required application forms.



# ALCOHOL BEVERAGE & PUBLIC ENTERTAINMENT PREMISES SUPPLEMENTAL APPLICATION

Office of the City Clerk License Division  
200 E. Wells St. Room 105, Milwaukee, WI 53202  
(414) 286-2238 e-mail address: license@milwaukee.gov [www.milwaukee.gov/license](http://www.milwaukee.gov/license)

Legal Entity Name: BKS FOOD LLC

Premise Address: 3400 S 27th ST, MILWAUKEE, WI-53215

### Proximity of Premises to Church, School, Daycare Center or Hospital

Is the building within 300 feet of any church, school, daycare center or hospital?  No  Yes

### "Service Bar Only" Designation

If applying for Class B or C license, are you applying for "Service Bar Only"?  No  Yes

Service Bar Only means customers cannot sit at the bar. Alcohol is served to employees who serve patrons seated at tables. No stools, chairs or other articles of furniture shall be placed at the service bar for patrons to sit upon.

### Business Information

a) Are you taking out this application for anyone that may not be eligible for a license?  No  Yes

If yes, list their name and address: \_\_\_\_\_

b) Will the agent, a partner or the individual licensee be conducting the day-to-day operations of the business?  No  Yes

If no, list the name and address of the person(s) who will: \_\_\_\_\_

Class B Applicants: If the agent, a partner or the individual licensee will not be conducting the day-to-day operations of the business, the person(s) listed above must obtain a Class B Managers license.

c) Does anyone else have money invested or any other interest in this business?  No  Yes

If yes, explain: \_\_\_\_\_

d) Have you made an agreement with anyone to repay any loan or any other payments based upon income from the business?

No  Yes If yes, list name and address: \_\_\_\_\_

### Property Information (New & Transfer Applicants Only)

a) Do you own or lease the building?  Own  Lease

b) Who owns the fixtures (for example, coolers, etc.)? \_\_\_\_\_

c) Are you purchasing the stock and/or fixtures?  No  Yes If yes, amount paid \$ \_\_\_\_\_

d) Total amount paid for business \$ \_\_\_\_\_

e) Total amount paid for goodwill of the business \$ \_\_\_\_\_

Goodwill comprises the reputation and customer relationships of an existing business. If the price you pay for the business exceeds the fair market value of all of the rest of the assets of the business, the excess may be considered goodwill.

f) Have you made arrangements with the seller for payment of personal property taxes?  No  Yes

### Lease Information (New & Transfer Applicants who are leasing the premises only)

a) Date lease begins 04/01/24 Ends 3/31/2027

b) Monthly rental \$ 4500.00

c) Do you have an option to renew the lease?  No  Yes

d) Does your lease allow for assignment to another party without the consent of the owner?  No  Yes

e) For what length of time have you been guaranteed occupancy (number of years)? \_\_\_\_\_



### Lease Information (Continued)

- f) In addition to paying the monthly rental, will you have to pay anything additional to the owner of the building to guarantee performance of the lease?  No  Yes If yes, explain \_\_\_\_\_
- g) Does the present owner or occupant object to the granting of your license?  No  Yes  
If yes, explain \_\_\_\_\_

### Change of Agent Applicants Only

Have there been any changes to the floor plan since the last application was submitted?  No  Yes  
If no, a new floor plan is not required. If yes, submit a new floor plan and explain the change(s):  
\_\_\_\_\_

### Signature

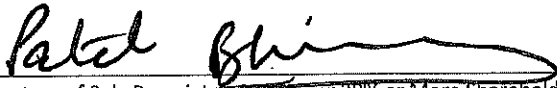

Signature of Sole Proprietor, Partner or 20% or More Shareholder  
(If no 20% or more Shareholder, Corporate Officer - print name/title and sign)

Note: All information contained in this application is subject to approval by the Common Council.  
Deviating from approved plan of operation will subject licensee to citations, and/or suspension or non-renewal of the license.  
Contact the License Division for information on how to request changes.

### New and transfer of premises applicants must submit the following:

- Detailed floor plan
- If a restaurant, copy of the menu



# FOOD DEALER LICENSE PLAN OF OPERATION

ccl-foodplan 2/28/19

OFFICE OF THE CITY CLERK, LICENSE DIVISION  
CITY HALL, 200 E. WELLS ST, ROOM 105, MILWAUKEE, WI 53202  
(414) 286-2238 • [license@milwaukee.gov](mailto:license@milwaukee.gov) • [www.milwaukee.gov/license](http://www.milwaukee.gov/license)

Legal Entity Name:	BKS FOOD LLC
Premises Address:	3400 S 27th ST, MILWAUKEE, WI-53215
<b>SECTION 1 TYPE OF BUSINESS</b>	
What will be the majority of your food sales? (check one)	
<input checked="" type="checkbox"/> Restaurant Items (meals): MEALS include, but are not limited to, chicken, ribs, sandwiches, roasted corn, baked potatoes, hot dogs, brats, tacos, nachos w/ cheese and meat, French fries, cooked or deep fried vegetables/fruit, cooked cheese curds, corn dogs, egg rolls, salads.	
<input type="checkbox"/> Retail Items (snacks and beverages): RETAIL items include, but are not limited to, ice cream/soft serve, lemonade, snow cones, coffee, espresso, cappuccino, tea, fruit juice, smoothies, candy, dispensed soda, fruit cups, bakery, cookies, kettle corn, cotton candy, funnel cakes, fritters, tortilla chips w/ cheese.	
Will it be a convenience store? <input type="checkbox"/> Yes <input checked="" type="checkbox"/> No A convenience store contains less than 5,000 square feet of retail space and has, as its primary business, the sale of basic food items and in addition, sells household products or is a filling station that sells basic food items and household products.	
<input type="checkbox"/> Bed & Breakfast <input type="checkbox"/> Micro Market	
All Applicants: Submit a menu or a list of food items that will be sold.	
Will any wholesale business be done? <input checked="" type="checkbox"/> No <input type="checkbox"/> Yes If yes, what percentage of food sales will be wholesale?	
<input type="checkbox"/> Less than 25%	
<input type="checkbox"/> 25% or More AND:	
<input type="checkbox"/> Restaurant items (meals) will be sold – Complete this application and also contact DATCP.	
<input type="checkbox"/> NO restaurant items (meals) will be sold - Do NOT complete this application. Contact DATCP only.	
<b>SECTION 2 FOOD PROCESSING</b>	
Will any food processing be done? <input type="checkbox"/> No <input checked="" type="checkbox"/> Yes	
Processing is defined as assembling, grinding, cutting, mixing, baking, coating, stuffing, packing, bottling, grilling, canning, extracting, fermenting, distilling, pickling, freezing, drying, smoking, or packaging.	
<b>SECTION 3 FOOD REQUIRING TEMPERATURE CONTROL</b>	
Will any food that requires temperature control be sold? <input type="checkbox"/> No <input checked="" type="checkbox"/> Yes (includes dairy products such as milk, cheese, and ice cream, fish, shellfish, meat, poultry)	
If yes, list the types of food items: ICE CREAM	

**SECTION 4 DETAILS OF OPERATION**

Will you have seating on site for dining?  No  Yes

Will you be doing any catering?  No  Yes

Will you be doing any delivery?  No  Yes

Will you have outdoor activities?  No  Yes - Check all that apply:  Bar  Cooking/Grilling  Dining

Will you have a drive thru window?  No  Yes - Are hours different from inside?  No  Yes  
 If Yes, provide drive thru hours: \_\_\_\_\_

Will scales or barcode scanners be used?  No  Yes - You must also apply for a Weights & Measures License.

**SECTION 5 ADDITIONAL SITES**

Where will food be prepared and/or sold?  
 At a single site  At multiple sites: How many? \_\_\_\_\_ (for example, a hotel with several dining rooms or bars)  
 If multiple sites, attach a Food Dealer Additional Site Addendum (ccl-foodadd) for each additional site.

**SECTION 6 CONSTRUCTION OR CHANGES**

Are you planning any construction, remodeling or equipment changes?  
 No If No, SKIP to Section 7  
 Yes If Yes, check all that apply:  New construction of a building  Renovation or remodeling  
 Construction changes to existing building  Equipment changes only

Provide a brief description of the changes: \_\_\_\_\_

Start date: \_\_\_\_\_

Name, Address & Phone Number of Architect: \_\_\_\_\_

Name, Address & Phone Number of Contractor: \_\_\_\_\_

**SECTION 7 ALCOHOL BEVERAGES**

Are you applying for an alcohol beverage license?  
 No If No, SKIP to Section 8  
 Yes If YES, if your food license is approved prior to the alcohol license, when do you want the food license issued?  
 Immediately  At the same time as the alcohol license

**SECTION 8 ACKNOWLEDGEMENTS & SIGNATURE**

You must initial each item confirming your understanding:

RP I understand the Health Department must conduct an inspection and advise the License Division of their approval before the license may be issued.

RP I understand I must obtain an occupancy permit from the Department of Neighborhood Services and an inspection may be required. Neighborhood Services must advise the License Division of their approval before the license may be issued.

RP I understand the district alderperson will review and either support or object to my application. If he/she objects, I may appeal and be scheduled to appear before the Licenses Committee. The Licenses Committee will then make a recommendation to the Common Council. The Common Council must grant the license before it may be issued.

RP I understand proof of payment for all license fees must be on file in the License Division before the license may be issued and the license must be issued and posted in my establishment prior to opening for business.

RP I will not operate my food business until the license has been issued and posted in the establishment.

Signature of Sole Proprietor, Partner, or 20% Shareholder: Patel Blinn

Signature of Additional Partner: A.B. Patel

Holt Ave

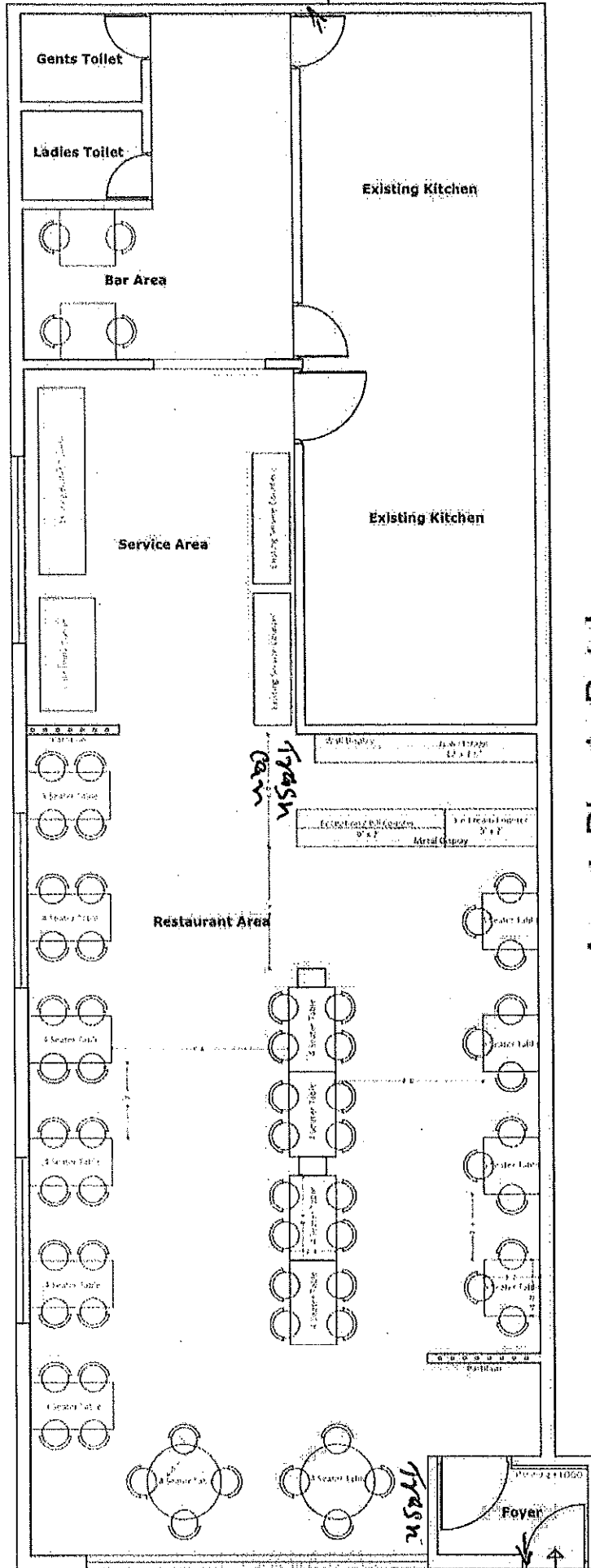

27th St

Agent: Bhavin Patel  
 BKS Food LLC  
 3400 S 27th St, Milwaukee, WI 53215

Total square feet: 2560 ft

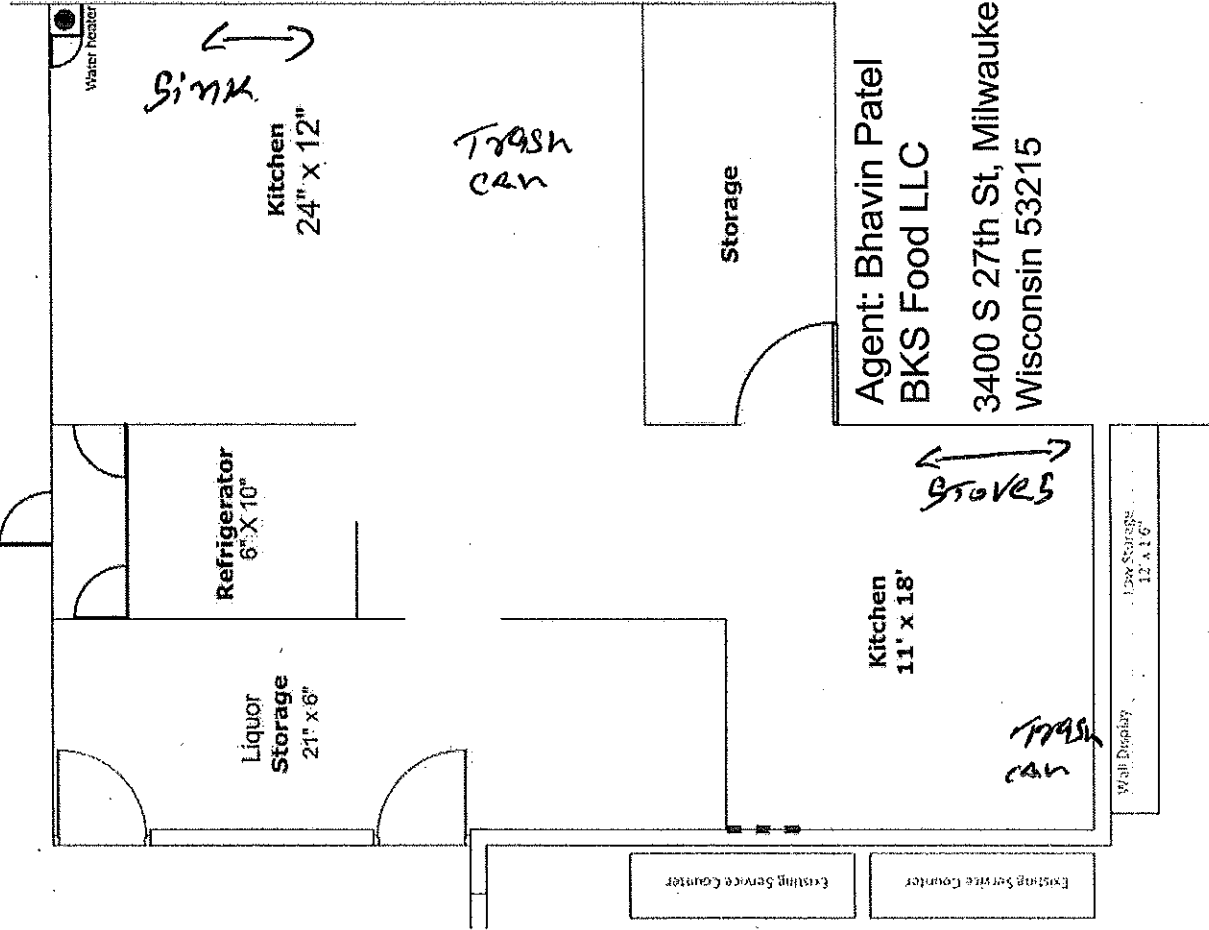

Agent: Bhavin Patel  
BKS Food LLC

3400 S 27th St, Milwaukee,  
Wisconsin 53215

# SOUTH INDIAN

(Served with Sambar, Coconut and Tomato Chutney)

**Plain Dosa** \$9.99  
Rice lentil crepe

**Masala Dosa** \$10.99  
Rice and lentil crepe filled with potatoes, onions, and spices

**Cheese Plain Dosa** \$11.99  
Dosa with Amul cheese

**Paper Dosa** \$10.99  
Thin and crispy rice lentil crepe

**Mysore Dosa** \$9.99  
Rice crepe with a layer of hot chutney

**Mysore Masala Dosa** \$10.99  
Rice crepe with a layer of hot chutney filled with potatoes & onion

**Schezwan Dosa** \$10.99  
Dosa topped with schezwan sauce

**Spring Dosa** \$10.99  
Dosa filled with thinly sliced carrot, cabbage, onions, green pepper & potato masala with spices

**Dabang Dosa** \$13.99  
Chef's special fusion dosa with veggies, cheese & spices

**Rava Plain Dosa** \$10.99  
Cracked wheat crepe

**Rava Masala Dosa** \$11.99  
Cracked wheat crepe filled with potatoes, onion & spices

**Rava Onion Dosa** \$11.99  
Cracked wheat crepe with onions & spices

**Rava Onion Chili Dosa** \$12.99  
Cracked wheat crepe filled with chili, potato, onion & spices

**Plain Uttapam** \$9.99  
Rice lentil pancake

**Masala Uttapam** \$12.99  
Rice lentil pancake topped with onion, tomato, green peas & spices

**Onion Chili Uttapam** \$10.99  
Rice lentil pancake topped with onion, green pepper & spices

**Vegetable Uttapam** \$11.99  
Rice lentil pancake topped with vegetables

**Steam Idli** \$5.99  
Steamed rice cake

**Medu Vada** \$5.99  
Indian crispy spiced doughnut of black lentile

**Idli and Vada** \$6.99

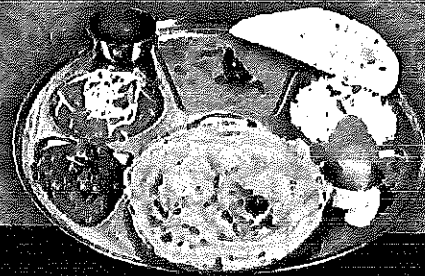
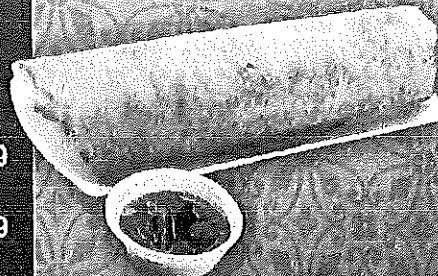

**Punjabi Thali** \$14.99  
(Curry subji, veg. subji, naan, dal, rice, salad, papad, gulab jamun with a choice of mango lassi or masala chasa)

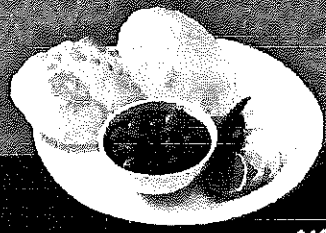

**Chole Bhature / Puri** \$12.99  
Chickpeas cooked in Indian gravy and spices, served with puffed bread (puri), achar, salad

**Extra Bhature** \$2.49

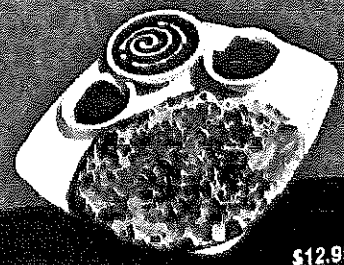

**Chur Chur Naan** \$12.99  
Paneer stuffed naan served with hot masala, achar, salad and yogurt



All items can be made in Cheese with additional charge of \$1.99  
Most option can be prepared (Mild, Regular & Hot)

Sent from my iPhone

*For the perfect Texture and Taste*

THE UNMATCHED  
COOKING INGREDIENT\*



We proudly use  
Amul Butter & Cheese



FRESH VEGETABLES



PERFECT BLEND OF SPICES

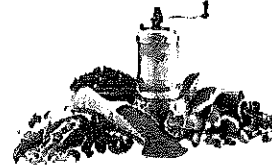

Vegan option available, please ask while you order

# BHAJI PAV

**Bhaji Pav** \$10.99

Signature spiced vegetable and potato mash, served with warm buttered pav (bread)

**Cheese Bhaji Pav** \$11.99

Bhaji pav served with Amul cheese

**Honest Special Bhaji Pav** \$11.99

Bhaji pav with cashews and raisins (Contains nuts)

**Masala Pav Mixed with Bhaji** \$10.99

Spicy, garlic butter tossed pav (bread) with signature bhaji

**Cheese Masala Pav Mixed with Bhaji** \$11.99

Masala pav (bread) mixed with bhaji and Amul cheese

**Masala Pav Dry** \$7.99

Pav (bread) toss with signature spices

# PULAV

**Pulav** \$10.99

Steamed basmati rice with signature spices and vegetables

**Cheese Pulav** \$11.99

Pulav topped with Amul cheese

**Honest Special Pulav** \$11.99

Pulav with cashews and raisins (Contains nuts)

# EXTRAS

**Extra Pav** \$1.99

**Extra Bhature** \$2.49

**Spicy Garlic Chutney** \$3.49

**Extra Sambar** \$1.29

**Extra Amul Cheese** \$1.29

# BHAJI PAV / PULAV TRAY

**Full Tray (for 35 to 40 people)** \$249.99

**Full Tray (for 16 to 20 people)** \$149.99



Add Extra Amul Cheese or Butter \$1.29



Made in Amul Butter

Sent from my iPhone

# INDO CHINESE

<b>Paneer 65</b> Batter fried paneer in a spicy tangy sauce	\$10.99
<b>Veg. Manchurian (Gravy)</b> Deep fried vegetable dumplings, simmered in Indo-Chinese spices gravy	\$11.99
<b>Veg. Manchurian (Dry)</b> Deep fried vegetable dumplings, stir fried with Indo-Chinese spices	\$10.99
<b>Gobi Manchurian (Gravy)</b> Batter fried cauliflower, simmered in Indo-Chinese spices gravy	\$11.99
<b>Gobi Manchurian (Dry)</b> Batter fried cauliflower, stir fried with Indo-Chinese spices	\$10.99
<b>Paneer Chilli (Gravy)</b> Paneer and peppers simmered in a spicy-tangy gravy	\$12.99
<b>Paneer Chilli (Dry)</b> Paneer with green papper cooked in Indo-Chinese spices	\$11.99
<b>Veg. Hakka Noodle</b> Noodles stir fried with vegetables and Indo-Chinese spices	\$10.99
<b>Veg. Noodles with Manchurian</b> Hakka noodles tossed with fried manchurian	\$11.99
<b>Schezwan Noodles</b> Noodles tossed with select vegetables and Indo-Chinese spices in Schezwan sauce	\$11.99
<b>Veg. Chilli Garlic Noodle</b> Noodles stir fried with chili, garlic and Indo-Chinese spices	\$11.99
<b>Triple Schezwan Noodles</b> Schezwan noodles stir fried with veg manchurian, gobi manchurian and paneer	\$11.99
<b>Veg. Fried Rice</b> Rice stir fried with vegetables and Indo-Chinese seasonings	\$10.99
<b>Veg. Fried Rice with Manchurian</b> Rice stir fried with vegetables, manchurian and Indo-Chinese seasonings	\$11.99
<b>Schezwan Fried Rice</b> Rice tossed with vegetables and in-house made garlic Schezwan sauce	\$11.99
<b>Veg. Chilli Garlic Fried Rice</b> Rice tossed with chili, garlic and Indo-Chinese spices	\$11.99
<b>Triple Schezwan Rice</b> Veg manchurian, gobi manchurian and paneer stir fried with Schezwan fried rice	\$12.99
<b>Chinese Bhel</b> Crispy noodles with manchurian, cauliflower and paneer in a sweet and sour sauce	\$11.99
<b>Cheese Chinese Bhel</b> Chinese bhel with Amul cheese	\$12.99

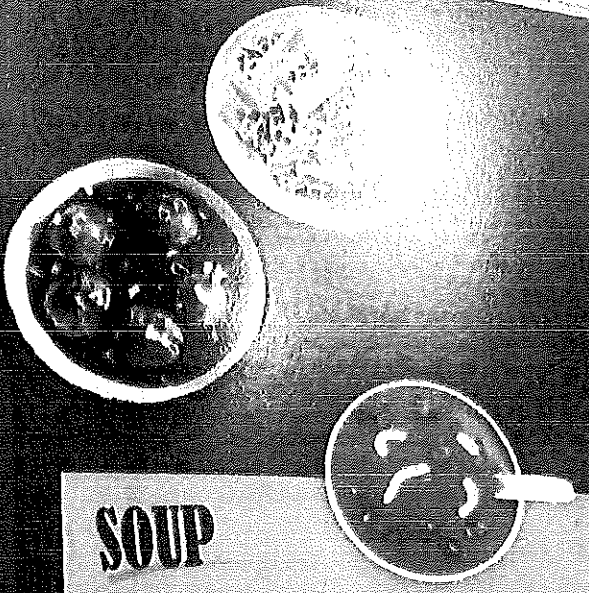

## SOUP

<b>Sweet Corn Soup</b>	\$ 4.99
<b>Hot &amp; Sour Soup</b>	\$ 4.99
<b>Veg. Manchow Soup</b>	\$ 4.99
<b>Sweet Corn Vegetable Soup</b>	\$ 4.99
<b>Tomato Soup</b>	\$ 4.99

## STARTERS

<b>Paneer Tikka</b>	\$11.99
<b>Paneer Pudina Tikka</b>	\$11.99
<b>French Fries</b>	\$ 3.99
<b>Cheese Bread</b>	\$ 5.99
<b>Sizzler Paneer Tikka</b>	\$13.99
<b>Sizzler Paneer Pudina Tikka</b>	\$13.99
<b>Chinese Sizzler</b>	\$17.99
<b>Veg. Spring Rolls</b>	\$ 6.99

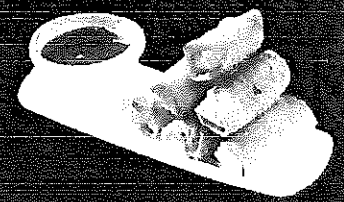

Jain/Vegetarian preparation are available on request for most items

Sent from my iPhone



# PIZZA

- Indian Style Bhaktri Pizza** \$9.99  
Crunchy Battered (Battered) topped with tomato sauce, onion, bell peppers and Amul cheese
- Double Cheese Pizza** \$10.99  
Bhaktri pizza with extra Amul cheese
- Honest Special Pizza** \$10.99  
Cheese-topped pizza with onion, bell peppers

# SANDWICH

- |  | Regular | Grilled |
|--|---------|---------|
| <b>Aloo Mutter</b><br>Tomato, green peas mixture with spices   | \$7.99  | \$8.99  |
| <b>Aloo Mutter Cheese</b><br>Aloo Mutter sandwich with Amul cheese   | \$8.99  | \$9.99  |
| <b>Vegetable Sandwich</b><br>Tomato, cucumber and green chutney  | \$7.99  | \$8.99  |
| <b>Vegetable Cheese</b><br>Vegetable sandwich with Amul cheese   | \$8.99  | \$9.99  |
| <b>Cheese Chutney</b><br>Green chutney and Amul cheese   | \$7.99  | \$8.99  |
| <b>Cheese Jam</b><br>Pineapple jam and Amul cheese   | \$7.99  | \$8.99  |
| <b>Veg Cheese Masala Grill</b><br>Spicy onion and peas mixture, kuzundir, tomatoes, green chutney and Amul cheese                      | \$9.99  | \$9.99  |
| <b>Honest Special Grill</b><br>Pineapple jam, cheese, tomatoes, cucumber and green chutney   | \$9.99  | \$9.99  |
| <b>Bahubali Sandwich</b><br>Grilled 4 layer sandwich, each layered with different sauces, jam, cheese and veggies, served with chutney | \$15.49 | \$15.49 |
| <b>Kattappa Sandwich</b><br>Grilled 4 layer sandwich, each layered with different sauces, cheese and veggies, served with chutney      | \$15.49 | \$15.49 |
| <b>Chocolate Pineapple Sandwich</b>  | \$9.99  | \$9.99  |

# BOMBAY CHAAT

- Dhal** \$7.99  
Fried rice, crunchy puri and vegetables tossed with sweet date chutney, green chutney and paneer chutney, topped with sev
- Cheese Bites** \$8.99  
Dhal with Amul cheese
- Pani Puri (10 pcs)** \$8.99  
Crispy farisala puris, black gram and potato, sweet date chutney with a spicy refreshing mint-chaandro water
- Sev Puri** \$7.99  
Crispy puris topped with assorted chutneys and sev
- Cheese Sev Puri** \$8.99  
Sev puri with Amul cheese
- Chutney Puri** \$7.99  
Puffed crispy semolina shells stuffed with potato-chickpea and assorted chutneys
- Papdi Chaat** \$7.99  
Crispy wheat strips, black gram and potato, assorted chutneys and yogurt
- Cheese Papdi Chaat** \$8.99  
Papdi chaat with Amul cheese
- Dahl Puri** \$7.99  
Puffed crispy wheat shells stuffed with potato-chickpea, sev, assorted chutneys and sweet yogurt
- Samosa (2 pcs)** \$5.99  
Savory pastry with spiced potato and green peas mixture
- Samosa Chaat** \$7.99  
Samosa topped with tomatoes, onions, chickpea noodles, assorted chutneys and yogurt
- Samosa Chaat with Chole** \$9.99  
Samosa topped with chickpea gravy, tomatoes, assorted chutneys and yogurt
- Amul Butter Vada Pav (1 pc)** \$4.99  
Butter fried spicy potato dumpling served in bun with green chutney and spicy garlic chutney
- Amul Cheese Vada Pav (1 pc)** \$5.99  
Vada pav with topped amul cheese
- Dabell (1 pc)** \$4.99  
Mashed potato cooked in traditional spices with pomegranate, onions, peanuts and garlic chutney
- Cheese Dabell (1 pc)** \$5.99  
Dabell with Amul cheese

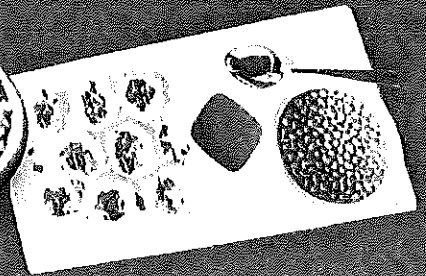

Swaminarayan Jain Vegan

Sent from my iPhone