

CONTINUATION SHEET

Historic Preservation Certification Application – Part 1

Geuder, Paeschke & Frey Company
324 N. 15th Street, Milwaukee, WI

NPS Project Number: Not yet assigned

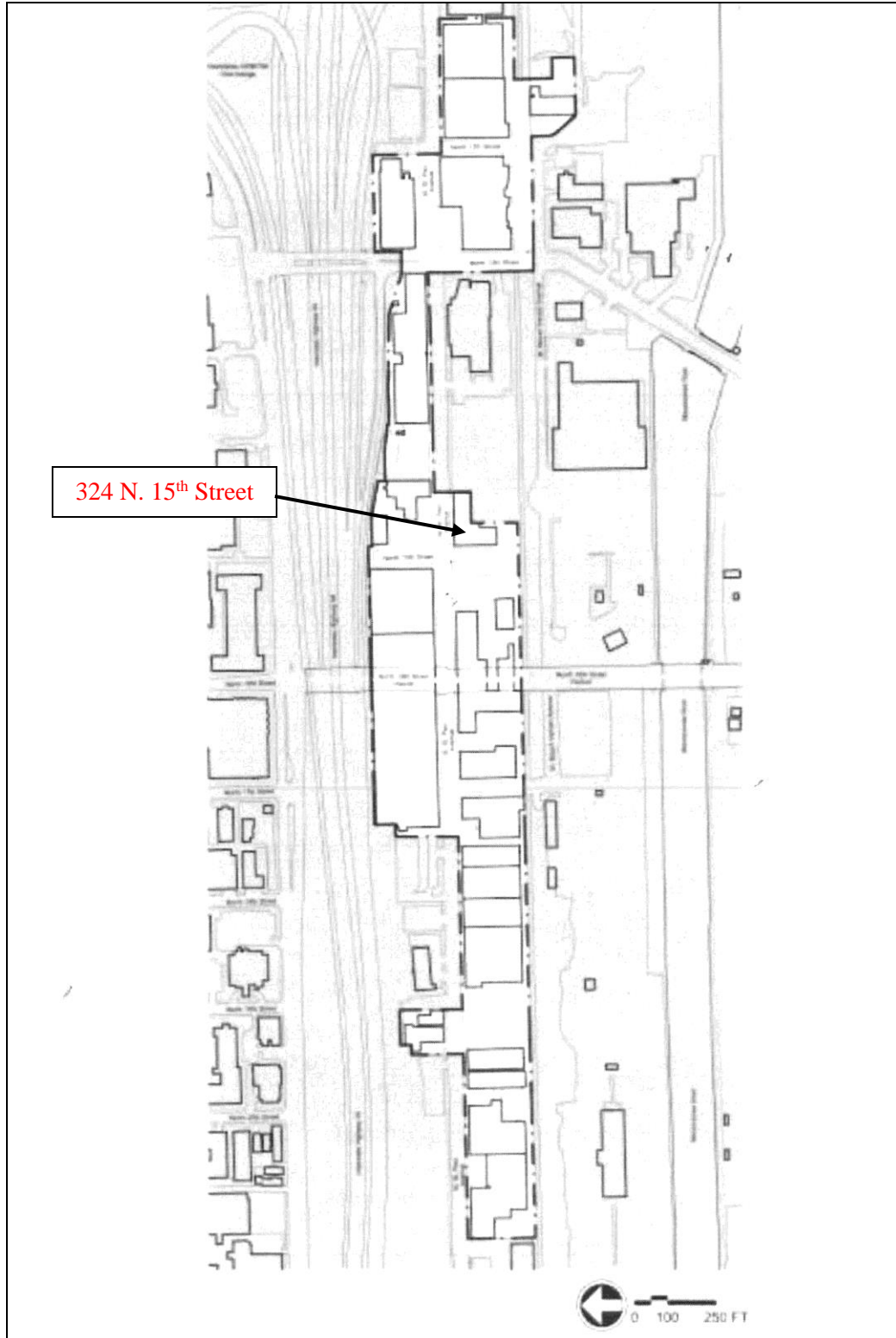

West St. Paul Avenue Industrial Historic District, Milwaukee, WI (NRHP #100002198, listed 3/12/2018)

CONTINUATION SHEET

Historic Preservation Certification Application – Part 1

Geuder, Paeschke & Frey Company

324 N. 15th Street, Milwaukee, WI

NPS Project Number: Not yet assigned

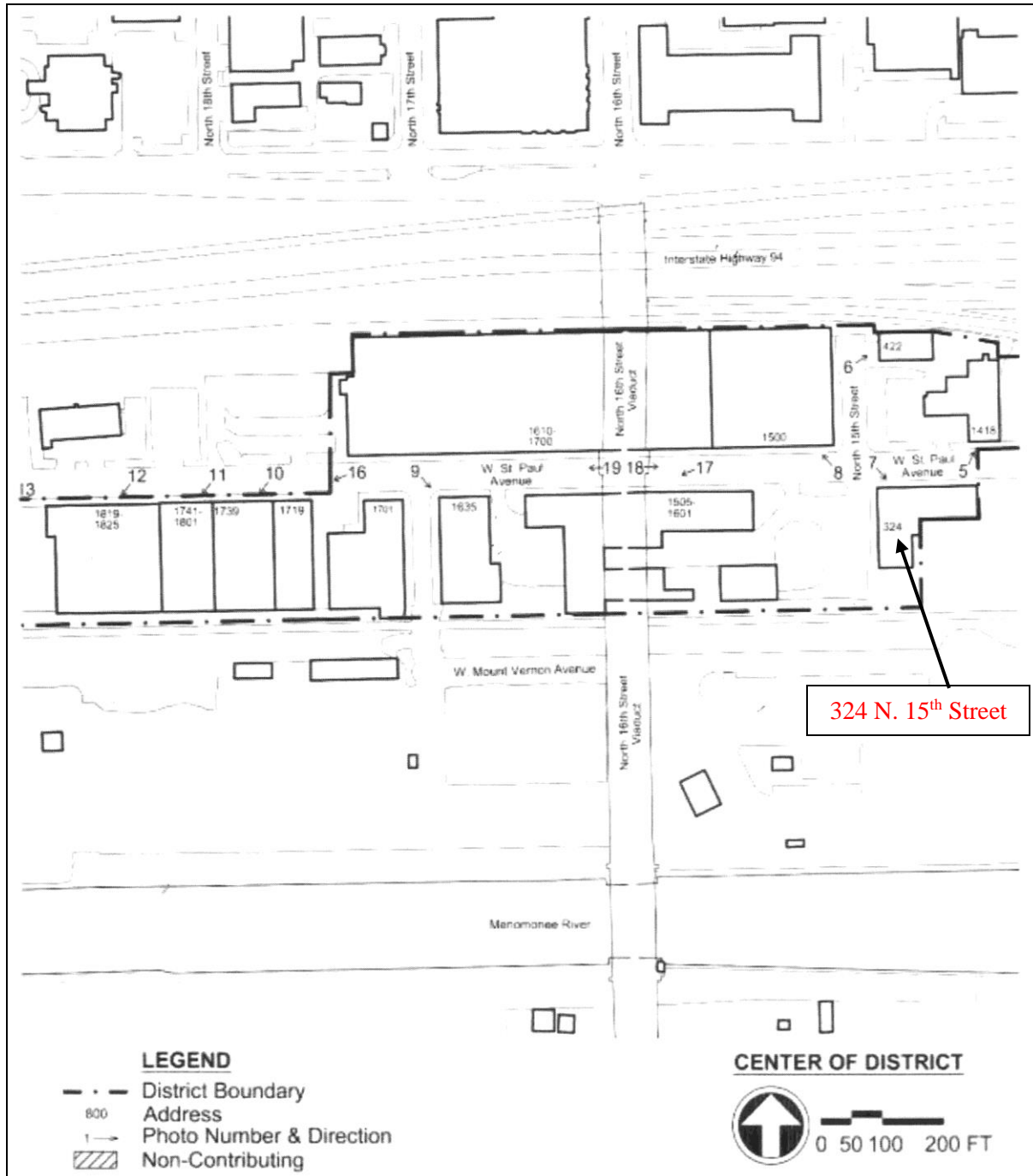

West St. Paul Avenue Industrial Historic District, Milwaukee, WI [historic district map detail – center of district] (NRHP #100002198, listed 3/12/2018)

CONTINUATION SHEET

Historic Preservation Certification Application – Part 1

Geuder, Paeschke & Frey Company
324 N. 15th Street, Milwaukee, WI

NPS Project Number: Not yet assigned



Wisconsin Historic Preservation Database, March 1980 photograph (WHPD #110095)
North & west elevations

CONTINUATION SHEET

Historic Preservation Certification Application – Part 1

Geuder, Paeschke & Frey Company
324 N. 15th Street, Milwaukee, WI

NPS Project Number: Not yet assigned



Wisconsin Historic Preservation Database, 2018 photograph (WHPD #110095)

North & west elevations – appearance of the building when National Register-listed in 2018

CONTINUATION SHEET

Historic Preservation Certification Application – Part 1

Geuder, Paeschke & Frey Company
324 N. 15th Street, Milwaukee, WI

NPS Project Number: Not yet assigned



Wisconsin Historic Preservation Database, 2018 photograph (WHPD #110095)

West elevation – appearance of the building when National Register-listed in 2018

CONTINUATION SHEET

Historic Preservation Certification Application – Part 1

Geuder, Paeschke & Frey Company
324 N. 15th Street, Milwaukee, WI

NPS Project Number: Not yet assigned



Wisconsin Historic Preservation Database, 2018 photograph (WHPD #110095)

South elevation – appearance of the building when National Register-listed in 2018

CONTINUATION SHEET

Historic Preservation Certification Application – Part 1

Geuder, Paeschke & Frey Company
324 N. 15th Street, Milwaukee, WI

NPS Project Number: Not yet assigned



Wisconsin Historic Preservation Database, 2018 photograph (WHPD #110095)
East elevation – appearance of the building when National Register-listed in 2018

CONTINUATION SHEET

Historic Preservation Certification Application – Part 1

Geuder, Paeschke & Frey Company
324 N. 15th Street, Milwaukee, WI

NPS Project Number: Not yet assigned



Wisconsin Historic Preservation Database, 2018 photograph (WHPD #110095)

East & south elevations – appearance of the building when National Register-listed in 2018