



**CITY OF MILWAUKEE  
OFFICE OF THE CITY CLERK**

Wednesday, July 05, 2023

**COMMITTEE MEETING NOTICE**

AD 04

ORR, Jessica J, Agent  
ELECTRIC LIME MILWAUKEE LLC  
1345 N JEFFERSON St #126  
Milwaukee, WI 53202

You are requested to attend a hearing which is to be held in Room 301-B, Third Floor, City Hall or you may attend virtually using the link below.

**Tuesday, July 18, 2023 at 09:50 AM**

The access code is <https://meet.goto.com/646911493>. If you wish to call in: **+1 (646) 749-3122** and use Access Code: **646-911-493**.  
Please see the enclosed best practices document for further instructions.

**Regarding:** Your Class B Tavern, Public Entertainment Premises, Food Dealer and Sidewalk Dining License Applications Requesting Instrumental Musicians, Disc Jockey, Bands, Magic Shows, 5 Amusement Machines, Poetry Readings, Comedy Acts and 12 Theater Performances/yr as agent for "ELECTRIC LIME MILWAUKEE LLC" for "Electric Lime" at 811-813 N JEFFERSON St.

There is a possibility that your application may be denied for one or more of the following reasons: The recommendation of the committee regarding the application shall be based on evidence presented at the hearing. Per MCO 85-2.7-4, probative evidence concerning whether or not a new license should be granted may be presented on the following subjects: whether or not the applicant meets the municipal requirements, the appropriateness of the location and premises where the licensed premises is to be located and whether use of the premises for the purposes or activities permitted by the license would tend to facilitate a public or private nuisance or create undesirable neighborhood problems such as disorderly patrons, unreasonably loud noise, litter, and excessive traffic and parking congestion. Probative evidence relating to these matters may be taken from the plan of operation submitted with the license application, if any, but shall not include the content of any music. Evidence regarding the fitness of the location of the premises to be maintained as the principal place of business, including but not limited to whether there is an overconcentration of businesses of the type for which the license is sought; whether the proposal is consistent with any pertinent neighborhood business or development plans, or the location's proximity to areas where children are typically present. The applicant's record in operating similarly licensed premises; and whether or not the applicant has been charged with or convicted of any felony, misdemeanor, municipal offense or other offense, the circumstances of which substantially relate to the activity to be permitted by the license being applied for or any other factor which reasonably relates to the public health, safety or welfare may also be considered. See attached police report or correspondence.

**Notice for applicants with  
warrants or unpaid fines:**

**Proof of warrant satisfaction or payment of fines must be submitted at the hearing on the above date and time. Failure to comply with this requirement may result in a delay of the granting/denial of your application.**

Failure to appear at this meeting may result in the denial of your license. Individual applicants must appear only in person or by an attorney. Corporate or Limited Liability applicants must appear only by the agent designated on the application or by an attorney. Partnership applicants must appear by a partner listed on the application or by an attorney. If you wish to do so and at your own expense, you may be accompanied by an attorney of your choosing to represent you at this hearing. You will be given an opportunity to speak on behalf of the application and to respond and challenge any charges or reasons given for the denial. No petitions can be accepted by the committee, unless the people who signed the petition are present at the committee hearing and willing to testify. You may present witnesses under oath and you may also confront and cross-examine opposing witnesses under oath. If you have difficulty with the English language, you should bring an interpreter with you, at your expense, so that you can answer questions and participate in your hearing.

You may examine the application file at this office during regular business hours prior to the hearing date. Inquiries regarding this matter may be directed to the person whose signature appears below.

Limited parking for persons attending meetings during normal business hours is available at reduced rates (5 hour limit) at the Milwaukee Center on the southwest corner of Kilbourn Avenue and Water Street. You must present a copy of the meeting notice to the parking cashier.

PLEASE NOTE: Upon reasonable notice, efforts will be made to accommodate the needs of disabled individuals through sign language interpreters or other auxiliary aids. For additional information or to request this service, contact the Council Services Division ADA Coordinator at (414) 286-2998, Fax - (414) 286-3456, TDD - (414) 286-2025.

**JIM OWCZARSKI, CITY CLERK**

BY: \_\_\_\_\_

**Jim Cooney**  
License Division Manager

**If you have questions regarding this notice, please contact the License Division at (414) 286-2238.**

200 E. Wells Street, Room 105, City Hall, Milwaukee, WI 53202. [www.milwaukee.gov/license](http://www.milwaukee.gov/license)  
Phone: (414) 286-2238 Fax: (414) 286-3057 Email Address: [License@milwaukee.gov](mailto:License@milwaukee.gov)



**CITY OF MILWAUKEE  
OFFICE OF THE CITY CLERK**

Wednesday, July 05, 2023

**COMMITTEE MEETING NOTICE**

AD 04

ORR, Jessica J, Agent  
ELECTRIC LIME MILWAUKEE LLC  
7320 N BEACH DR  
Fox Point, WI 53217

You are requested to attend a hearing which is to be held in Room 301-B, Third Floor, City Hall or you may attend virtually using the link below.

**Tuesday, July 18, 2023 at 09:50 AM**

The access code is <https://meet.goto.com/646911493>. If you wish to call in: **+1 (646) 749-3122** and use Access Code: **646-911-493**.  
Please see the enclosed best practices document for further instructions.

**Regarding:** Your Class B Tavern, Public Entertainment Premises, Food Dealer and Sidewalk Dining License Applications Requesting Instrumental Musicians, Disc Jockey, Bands, Magic Shows, 5 Amusement Machines, Poetry Readings, Comedy Acts and 12 Theater Performances/yr as agent for "ELECTRIC LIME MILWAUKEE LLC" for "Electric Lime" at 811-813 N JEFFERSON St.

There is a possibility that your application may be denied for one or more of the following reasons: The recommendation of the committee regarding the application shall be based on evidence presented at the hearing. Per MCO 85-2.7-4, probative evidence concerning whether or not a new license should be granted may be presented on the following subjects: whether or not the applicant meets the municipal requirements, the appropriateness of the location and premises where the licensed premises is to be located and whether use of the premises for the purposes or activities permitted by the license would tend to facilitate a public or private nuisance or create undesirable neighborhood problems such as disorderly patrons, unreasonably loud noise, litter, and excessive traffic and parking congestion. Probative evidence relating to these matters may be taken from the plan of operation submitted with the license application, if any, but shall not include the content of any music. Evidence regarding the fitness of the location of the premises to be maintained as the principal place of business, including but not limited to whether there is an overconcentration of businesses of the type for which the license is sought; whether the proposal is consistent with any pertinent neighborhood business or development plans, or the location's proximity to areas where children are typically present. The applicant's record in operating similarly licensed premises; and whether or not the applicant has been charged with or convicted of any felony, misdemeanor, municipal offense or other offense, the circumstances of which substantially relate to the activity to be permitted by the license being applied for or any other factor which reasonably relates to the public health, safety or welfare may also be considered. See attached police report or correspondence.

**Notice for applicants with  
warrants or unpaid fines:**

**Proof of warrant satisfaction or payment of fines must be submitted at the hearing on the above date and time. Failure to comply with this requirement may result in a delay of the granting/denial of your application.**

Failure to appear at this meeting may result in the denial of your license. Individual applicants must appear only in person or by an attorney. Corporate or Limited Liability applicants must appear only by the agent designated on the application or by an attorney. Partnership applicants must appear by a partner listed on the application or by an attorney. If you wish to do so and at your own expense, you may be accompanied by an attorney of your choosing to represent you at this hearing. You will be given an opportunity to speak on behalf of the application and to respond and challenge any charges or reasons given for the denial. No petitions can be accepted by the committee, unless the people who signed the petition are present at the committee hearing and willing to testify. You may present witnesses under oath and you may also confront and cross-examine opposing witnesses under oath. If you have difficulty with the English language, you should bring an interpreter with you, at your expense, so that you can answer questions and participate in your hearing.

You may examine the application file at this office during regular business hours prior to the hearing date. Inquiries regarding this matter may be directed to the person whose signature appears below.

Limited parking for persons attending meetings during normal business hours is available at reduced rates (5 hour limit) at the Milwaukee Center on the southwest corner of Kilbourn Avenue and Water Street. You must present a copy of the meeting notice to the parking cashier.

PLEASE NOTE: Upon reasonable notice, efforts will be made to accommodate the needs of disabled individuals through sign language interpreters or other auxiliary aids. For additional information or to request this service, contact the Council Services Division ADA Coordinator at (414) 286-2998, Fax - (414) 286-3456, TDD - (414) 286-2025.

**JIM OWCZARSKI, CITY CLERK**

BY: \_\_\_\_\_

**Jim Cooney**  
License Division Manager

**If you have questions regarding this notice, please contact the License Division at (414) 286-2238.**

200 E. Wells Street, Room 105, City Hall, Milwaukee, WI 53202. [www.milwaukee.gov/license](http://www.milwaukee.gov/license)  
Phone: (414) 286-2238 Fax: (414) 286-3057 Email Address: [License@milwaukee.gov](mailto:License@milwaukee.gov)

# MILWAUKEE POLICE DEPARTMENT

## LICENSING

### CRIMINAL RECORD/ORDINANCE VIOLATION/INCIDENTS SYNOPSIS

DATE: 04/29/2019  
LICENSE TYPE: BTAVN  
NEW: ☐  
RENEWAL: ☒

No. 292634  
Application Date: 04/26/2019

License Location: 811 North Jefferson Street  
Business Name: Mi-Key's

Licensee/Applicant: McLean, Joseph  
(Last Name, First Name, MI)  
Date of Birth: 05/01/1979

Home Address: 5329 Hwy 38  
City: Franksville  
Home Phone: 414-406-8363

State: WI Zip Code: 53216

This report is written by Police Officer David NOVAK, assigned to the License Investigation Unit, Days.

The Milwaukee Police Department's investigation regarding this application revealed the following:

1. On 03/03/2008 the Wisconsin Department of Transportation revoked the applicant's driver's license for 6 months for Operating While Intoxicated.

=====

2. On 03/31/2017 officers conducted underage tavern enforcement in District 1. An underage Police Aid attempted to gain entry to Mi-Key's, 811 N. Jefferson St. The Police Aid was stopped at the door where security requested her ID. She stated she did not have it and he allowed her inside anyways. She then ordered and was served a Miller Lite for \$4.00.
3. On 06/23/2017 at 1:45am an officer was flagged down for a battery at Mi-Key's, 811 N. Jefferson St. The manager, Victoria HOEFFLER, stated she saw a patron stealing from a waitress's shot tray. She asked the patron to leave and he became upset and threw a glass bottle at her. She was struck in the leg and had pain. Security detained the patron for police and he was cited.
4. On 03/14/2018 officers were dispatched to a battery at Mi-Key's, 811 N. Jefferson St. The manager, Hunter KOTTKE, stated there was no fight but appeared to be an argument between a couple. The officers then received a call for a battery at 1029 N. Jackson St. The victim stated he was at Mi-Key's with his girlfriend and they got into an agreement when they left. He

stated while walking home she attacked him. The female was found to be under the age of 21. She was arrested for battery and cited for possession of alcohol by underage.

5. On 03/17/2018 the applicant was cited in the City of Milwaukee at 218 N. Water St for

Charge: Excessive Noise Prohibited  
Finding: Guilty  
Sentence: Fined \$240.00  
Date: 05/04/2018  
Case: 18037241

=====  
Item #5 updated with disposition on 04/29/2019

6. On 11/29/2018 officers conducted underage tavern enforcement in District 1 at 811 N. Jefferson St. This tavern passed the initiative.

=====

## PREVIOUS PREMISE

Date: 5/19/2023  
Officer: PLUMLEY

City of Milwaukee Police Department  
90-5-1.5 Crime Prevention Survey  
Tavern Inspection

Name of Premise: Electric Lime  
Address: 811-813 N Jefferson St  
Phone:

Owner: Jessica J. ORR  
Owner address: 7320 N Beach Dr.  
City State Zip: Fox Point WI 53217  
Owner Phone: 646-469-1200  
Owner email: [Jessica@JessicaOrr.com](mailto:Jessica@JessicaOrr.com)

Licensee/Agent: Jessica J. Orr  
Home Address: 7320 N Beach Dr.  
City State Zip: Fox Point WI 53217  
Phone: 646-469-1200  
Email: [Jessica@JessicaOrr.com](mailto:Jessica@JessicaOrr.com)

Preferred contact: Phone

Location currently open: ☐ YES ☒ NO

Projected open date: 7/1/2023

Day's open: ☐S ☐M ☐T ☐W ☐Th ☐F ☐SA ☒ALL

Hours of Operation: Sun: 9A-6P ☐24 hours ☐Y ☒N  
Mon: 10A-2A  
Tue: 10A-2A  
Wed: 10A-2A  
Thu: 10A-2A  
Fri: 10A-230A  
Sat: 10A-230A

Premise Type: ☐ Tavern/Bar  
☒ Restaurant  
☐ Other:

Licenses currently held:

Alcohol: ☐ Yes ☒ No Class: #:  
 Tobacco: ☐ Yes ☒ No #:  
 Food: ☐ Yes ☒ No #:  
 Extended Hours: ☐ Yes ☒ No #:  
 Secondhand Dealer: ☐ Yes ☒ No Type: #:  
 Other: ☐ Yes ☐ No Type: #:  
 Other: ☐ Yes ☐ No Type: #:

### **Exterior Survey:**

1. Is the area around the location clean? ☒ Yes ☐ No
2. What surrounds the location? (Check all the apply)
  - a. ☐ Park
  - b. ☐ School
  - c. ☐ Youth Center
  - d. ☐ Church
  - e. ☐ Tavern(s) If so, how many
  - f. ☐ Residential
  - g. ☒ Other businesses
  - h. ☐ Other:
3. Can you see from the outside of the location into the interior ☒ Yes ☐ No
4. Can you see the employees inside of the location from the outside ☒ Yes ☐ No
5. Are exterior windows free of signage ☒ Yes ☐ No
6. Is there a parking lot ☐ Yes ☒ No
7. Is the parking lot clean? ☐ Yes ☐ No
8. Off-Street parking ☐ Yes ☒ No
9. Is the parking lot well lit? ☐ Yes ☐ No
10. Valet Parking ☐ Yes ☒ No
  - a. Will this lot have a guard? ☐ Yes ☐ No
  - b. Will this lot have cameras? ☐ Yes ☐ No
11. Are there areas where a person could conceal themselves ☐ Yes ☒ No
12. Is there exterior lighting? ☒ Yes ☐ No. Does it appears to be adequate ☒ Yes ☐ No
13. Exterior Payphone? ☐ Yes ☒ No
14. Are there No Loitering Signs posted? ☒ Yes ☐ No
15. Are there exterior security cameras ☐ Yes ☒ No How Many:
16. Are the address numbers prominently displayed and easy to see ☒ Yes ☐ No

### **Camera Survey:**

17. Does this location have security cameras? ☐ Yes ☒ No
18. Are they in working order? ☐ Yes ☐ No
19. What format are the cameras?
  - a. Color ☐ Yes ☐ No
  - b. Digital ☐ Yes ☐ No
  - c. Recorded ☐ Yes ☐ No
20. How long is footage stored for later viewing:
21. Are there exterior cameras ☐ Yes ☐ No How many:
22. Are there interior cameras ☐ Yes ☐ No How many:
23. Do all employees know how to retrieve recorded digital images/footage? ☐ Yes ☐ No

24. Cameras located in parking lot ☐ Yes ☐ No How many

**Interior Survey:**

25. What is the planned capacity N/A

26. What is the minimum number of employees That will be on premise 8

27. Is the storeowner willing to be a standing complainant regarding loitering? ☐ Yes ☒ No

a. If yes have them fill out the standing complaint form and give them two of the commercial signs ☐ Yes ☐ No

28. Is the interior of the location neat and clean? ☒ Yes ☐ No

29. Does an interior camera face the entrance/exit? ☐ Yes ☒ No

30. Is there a lockable area that separates employees from customers? ☒ Yes ☐ No

31. Are emergency and non-emergency numbers posted near the phone? ☒ Yes ☐ No

32. Does the owner know how to contact their police district directly? ☒ Yes ☐ No

a. Did you provide a district contact guide to the owner? ☒ Yes ☐ No

**Security**

33. How many security personnel are going to be employed: 0

34. How ill they be deployed: Interior Exterior

35. What days will they be deployed ☐ Mon ☐ Tue ☐ Wed ☐ Thu ☐ Fri ☐ Sat ☐ Sun

36. Will the security be managed by business ☐ or contracted ☐

37. Will they be armed ☐ Yes ☐ No

38. What type of security measures to be used:

☐ Wandering/metal detector

☐ ID Scanner

☐ Dress Code

☐ Cover Charge

☐ Age restriction

☐ Other

**ADDITIONAL COMMENTS/RECOMMENDATIONS:**

This business is still under construction. The owner is currently working on having a new surveillance camera system put in that should have at least 15 new cameras recording. The owner will be sure that the new surveillance cameras cover the entrances/exits for the restaurant and that shows a good view of the patrons entering the establishment. This restaurant will have a host/hostess at the front entrance to help with customer seating and provide natural surveillance for the front entrance. The owner will also consider hiring contracted security for special events. A survey was conducted of alcohol storage and the owner is providing a well secured and locked area away from customers for alcohol storage.



# Concentration Map 811 N Jefferson St

## Area of Interest (AOI) Information

Area : 21,862,585.81 ft<sup>2</sup>

Apr 27 2023 12:03:43 Central Daylight Time

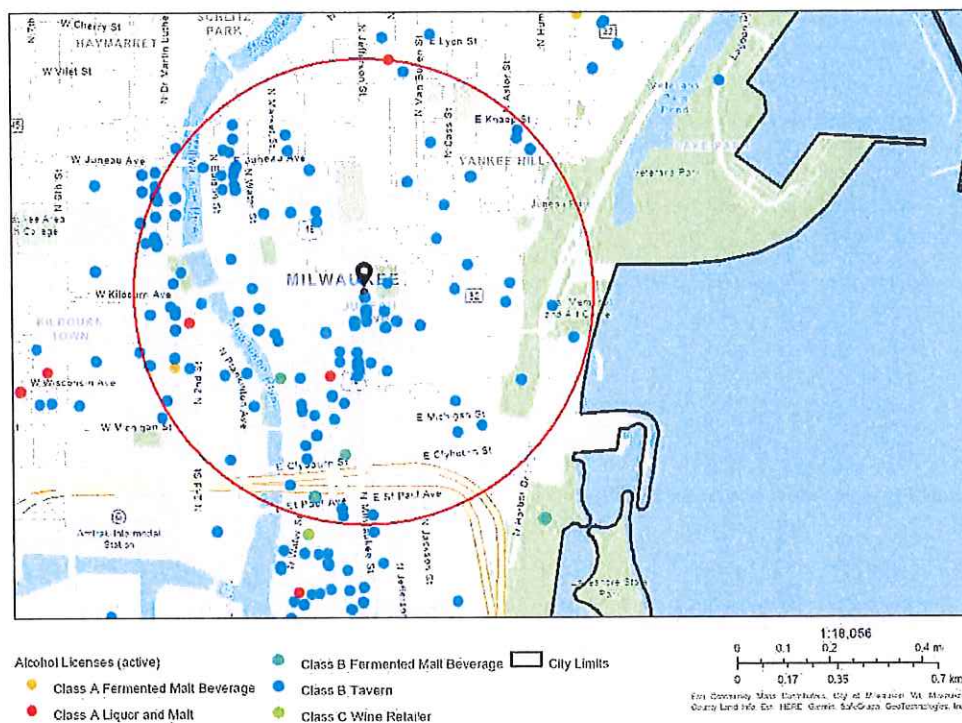

811 N Jefferson St

Summary

Name	Count	Area(ft²)	Length(mi)
Alcohol Licenses	159		

Alcohol Licenses

#	Legal Entity	Trade Name	Licensee	Address	License Type Name	Total Capacity	Expiration Date	Count
1	Benelux Third Ward, LLC	Cafe Benelux	ERIC G WAGNER, Agt	346 N Broadway	Class B Tavern License	455	5/1/2023, 7:00 PM	1
2	V & V PARTNERS, LLC	BENIHANA	SABAH M LIDDAWYEH, Agt	850 N PLANKINTON AV	Class B Tavern License	180	5/17/2023, 7:00 PM	1
3	PTM VENTURES LLC	State Street Pizza Pub	JACOB E DEHNE, Agt	322 W STATE ST	Class B Tavern License		5/18/2023, 7:00 PM	1
4	GRANDVIEW MANAGEMEN T, INC	ZILLI LAKE & GARDENS	ROBERT J ZILLI, Agt	931 E WISCONSIN AV	Class B Tavern License	450	5/18/2023, 7:00 PM	1
5	Milwaukee School of Engineering	Milwaukee School of Engineering	Beth M Luedtke-Williams, Agt	1000 N BROADWAY	Class B Tavern License	480	5/18/2023, 7:00 PM	1
6	Milwaukee School of Engineering	Milwaukee School of Engineering	Beth M Luedtke-Williams, Agt	1025 N BROADWAY	Class B Tavern License		5/18/2023, 7:00 PM	1
7	MILWAUKEE SCHOOL OF ENGINEERIN G	MILWAUKEE SCHOOL OF ENGINEERIN G	Beth M Luedtke-Williams, Agt	1120 N BROADWAY	Class B Tavern License	208	5/18/2023, 7:00 PM	1
8	Olive Tree LLC	Convenience +	Jamal T Shawar, Agt	308 E Wisconsin AV	Class A Malt & Class A Liquor License		5/19/2023, 7:00 PM	1
9	JSWD Wisconsin Venture I LLC	The Westin Milwaukee	Melinda K Niketh, Agt	550 N Van Buren ST	Class B Tavern License		5/22/2023, 7:00 PM	1
10	WESTOWN ASSOCIATIO N OF MILW, INC	WESTOWN ASSOCIATIO N	STACIE J CALLIES, Agt	950 N Dr Martin L King Jr DR	Class B Tavern License		5/22/2023, 7:00 PM	1
11	Cheese Mart, Inc	Wisconsin Cheese Mart	KENNETH J MC NULTY, Agt	215 W Highland AV	Class B Tavern License	133	5/22/2023, 7:00 PM	1
12	Wisconsin & Milwaukee Hotel, LLC	Milwaukee Marriott Downtown/Sta rbucks	Benjamin A Risseuw, Agt	323 E Wisconsin AV	Class B Tavern License	312	5/23/2023, 7:00 PM	1
13	ZARLETTI, LLC	ZARLETTI	BRIAN C ZARLETTI, Agt	741 N MILWAUKEE ST 1	Class B Tavern License		5/23/2023, 7:00 PM	1
14	PPH Properties I LLC	Silk Exotic Gentlemen's Club	SCOTT A KRAHN, Agt	730 N Dr Martin L King Jr DR	Class B Tavern License	297	5/25/2023, 7:00 PM	1
15	Grandview Management Inc	Zilli Hospitality Group	ROBERT J ZILLI, Agt	910 N Martin L King Jr DR	Class B Tavern License		5/25/2023, 7:00 PM	1
16	12AM Management Group, LLC	Room Seven	Andre B Lewis, Agt	780 N Jefferson ST	Class B Tavern License	240	5/25/2023, 7:00 PM	1
17	Truth Lounge, LLC	Truth Lounge	Tino K Bates, Agt	1111 N Martin L King DR	Class B Tavern License	90	5/25/2023, 7:00 PM	1
18	HTWA MARKET PROJECT, LLC	MILWAUKEE PUBLIC MARKET	MICHAEL GARDNER, Agt	400 N WATER ST	Class B Tavern License	320	5/28/2023, 7:00 PM	1

19	Foltz Family Market, Inc	Foltz Family Market	Casey C Foltz, Agt	400 N WATER ST 6	Class B Tavern License		5/29/2023, 7:00 PM	1
20	NOBLE BEVERAGE MANAGEMENT, LLC	HYATT REGENCY MILWAUKEE	Joshua S Schoggins, Agt	333 W KILBOURN AV	Class B Tavern License	930	5/30/2023, 7:00 PM	1
21	RIVER HOUSE RESTAURANT, INC	VagaBond	ROBERT C SCHMIDT, JR, Agt	1122 N EDISON ST	Class B Tavern License	150	6/1/2023, 7:00 PM	1
22	GRAND CONVENIENT, LLC	GRAND CONVENIENT STORE	AHMED K YAFAI, Agt	724 N Martin L King Jr DR	Class A Fermented Malt Beverage Retailer's License		6/13/2023, 7:00 PM	1
23	HB Milwaukee Inc	Old German Beer Hall	HANS WEISSGERBER, III, Agt	1009 N MARTIN L KING JR DR	Class B Tavern License	120	6/13/2023, 7:00 PM	1
24	First MKD, LLC	Hilton Garden Inn	Sarah I Frost, Agt	611 N BROADWAY	Class B Tavern License		6/15/2023, 7:00 PM	1
25	DJ ENTERPRISE S I, INC	GRACE CENTER	JOAN M GROH, Agt	250 E JUNEAU AV	Class B Tavern License	330	6/17/2023, 7:00 PM	1
26	CAPITAL GRILLE HOLDINGS, INC	THE CAPITAL GRILLE OF MILW #8027	Lindsey R FitzMaurice, Agt	310 W WISCONSIN AV 100	Class B Tavern License	200	6/18/2023, 7:00 PM	1
27	MILWAUKEE SCHOOL OF ENGINEERING	MILWAUKEE SCHOOL OF ENGINEERING	Beth M Luedtke-Williams, Agt	1245 N BROADWAY	Class B Tavern License	2,759	6/19/2023, 7:00 PM	1
28	SORFCO, LTD	THE KNICK	ELIAS G CHEDID, Agt	1030 E JUNEAU AV	Class B Tavern License		6/27/2023, 7:00 PM	1
29	THIEF WINE, LLC	THIEF WINE SHOP & BAR	PHILIP M BILODEAU, Agt	400 N WATER ST	Class B Tavern License	42	6/29/2023, 7:00 PM	1
30	ELSA'S ON THE PARK, LTD	ELSA'S ON THE PARK	KARL R KOPP, Agt	833 N JEFFERSON ST	Class B Tavern License	100	6/29/2023, 7:00 PM	1
31	THIS IS IT, INC	THIS IS IT	GEORGE R SCHNEIDER, Agt	418 E WELLS ST	Class B Tavern License	160	6/29/2023, 7:00 PM	1
32	MILWAUKEE COUNTY WAR MEMORIAL, INC	MILWAUKEE COUNTY WAR MEMORIAL CENTER	Laurieann Kildegaard, Agt	750 N LINCOLN MEMORIAL DR	Class B Tavern License	240	6/29/2023, 7:00 PM	1
33	WA Cheese & Sausage Shoppe, Inc	WA Cheese & Sausage Shoppe	Mark S Lutz, Agt	400 N WATER ST 24	Class B Tavern License		6/29/2023, 7:00 PM	1
34	THE MILWAUKEE CLUB	THE MILWAUKEE CLUB	Molly J Schick, Agt	706 N JEFFERSON ST	Class B Tavern License	180	6/29/2023, 7:00 PM	1
35	BRICK 3 PIZZA, LLC	BRICK 3 PIZZA	RICHARD J BARRETT, Agt	1107 N Martin L King Jr DR	Class B Tavern License	57	7/5/2023, 7:00 PM	1
36	Fenix Milwaukee LLC	Rodizio Grill	Renan Utrera De Paula, Agt	777 N WATER ST	Class B Tavern License		7/5/2023, 7:00 PM	1

37	PABST THEATER CONCESSIONS, LLC	THE PABST THEATER	Richard J Ryan, Agt	144 E WELLS ST	Class B Tavern License		7/5/2023, 7:00 PM	1
38	MARCUS HOTELS HOSPITALITY, LLC	Saint Kate-The Arts Hotel	David J Metz, Agt	139 E KILBOURN AV	Class B Tavern License		7/5/2023, 7:00 PM	1
39	UNIVERSITY CLUB OF MILWAUKEE	UNIVERSITY CLUB OF MILWAUKEE	JOSEPH G CORAGGIO, Agt	924 E WELLS ST	Class B Tavern License	150	7/9/2023, 7:00 PM	1
40	MP On Wheels Catering Service	MP On Wheels Catering Service	DULCE M ALARCON, SP	400 N WATER ST	Class B Tavern License	320	7/11/2023, 7:00 PM	1
41	Bollywood Grill, LLC	Bollywood Grill	MANJIT SINGH, Agt	1028-30 N Jackson ST	Class B Tavern License		7/21/2023, 7:00 PM	1
42	Wild Rogues LLC	Elwood's Liquor & Tap	Nathan S Showers, Agt	1111 N Water ST	Class B Tavern License		7/25/2023, 7:00 PM	1
43	DOS BONITAS, LLC	CUBANITAS	MARTA C BIANCHINI, Agt	728 N MILWAUKEE ST	Class B Tavern License	50	7/25/2023, 7:00 PM	1
44	Art's Performing Center, LLC	Silk on Water	SCOTT A KRAHN, Agt	144 E Juneau AV	Class B Tavern License	80	7/25/2023, 7:00 PM	1
45	ARBED, LLC	MO'S IRISH PUB	JAMES A VASSALLO, Agt	142-44 W Wisconsin AV	Class B Tavern License	480	7/26/2023, 7:00 PM	1
46	WALGREEN CO	WALGREENS #1200	Nicole R Davis, Agt	275 W WISCONSIN AV 1108	Class A Malt & Class A Liquor License		7/27/2023, 7:00 PM	1
47	RIVERWALK COMMONS LLC	Riverwalk Commons	PAUL H SCHWARTZ, Agt	423 N WATER ST	Class B Tavern License		7/28/2023, 7:00 PM	1
48	FLANNERY'S PUB, INC	FLANNERY'S BAR & RESTAURANT	STEVEN W SMITH, Agt	425-29 E WELLS ST	Class B Tavern License	270	7/29/2023, 7:00 PM	1
49	MARCUS HOTELS HOSPITALITY, LLC	Pfister Hotel & Tower	David J Metz, Agt	424 E WISCONSIN AV	Class B Tavern License	419	7/29/2023, 7:00 PM	1
50	BUCKLEY'S KISKEAM INN, LLC	Buckley's	MICHAEL V BUCKLEY, Agt	801-09 N CASS ST	Class B Tavern License	65	7/29/2023, 7:00 PM	1
51	PTG Live Events LLC	The Riverside	Richard J Ryan, Agt	116 W Wisconsin AV	Class B Tavern License	2,480	7/29/2023, 7:00 PM	1
52	Central Standard LLC	Central Standard Craft Distillery	William P McQuillian, Agt	320 E Clybourn ST	Class B Fermented Malt Beverage Retailer's License		8/4/2023, 7:00 PM	1
53	TACO MIKES LLC	Taco Mikes LLC	Michael P Holz, Agt	1001 N MARTIN L KING JR DR	Class B Tavern License		8/11/2023, 7:00 PM	1
54	MAC PARTNERS, LLC	Milwaukee Athletic Club - 4th Floor	Maikel Correa, Agt	758 N BROADWAY	Class B Tavern License		8/15/2023, 7:00 PM	1

55	LC MKE LLC	The Lucky Clover Pub	JACOB E DEHNE, Agt	1048 N MARTIN L KING JR DR	Class B Tavern License		8/16/2023, 7:00 PM	1
56	Edith LLC	Edith	Rhondi M Love, Agt	228 W WELLS ST	Class B Tavern License		8/22/2023, 7:00 PM	1
57	Sunstone Studios Inc	Sunstone Studios	Amber J Regan, Agt	127 E Wells ST	Class B Tavern License		8/30/2023, 7:00 PM	1
58	Hotel Metro Operator, LLC	Hotel Metro	Andrew R Cordes, Agt	411 E Mason ST	Class B Tavern License	150	8/30/2023, 7:00 PM	1
59	INDULGE WINE ROOMS, LLC	INDULGE	MARC R BIANCHINI, Agt	708 N MILWAUKEE ST	Class B Tavern License	60	8/30/2023, 7:00 PM	1
60	The Loft Mini Mart LLC	The Loft Mini Mart	Larry J Courtney, Agt	823 N 2ND ST 007	Class A Malt & Class A Liquor License		8/30/2023, 7:00 PM	1
61	VICTOR'S ON VAN BUREN, INC	VICTOR'S	Vic R Jones, Agt	1230 N VAN BUREN ST	Class B Tavern License	420	8/30/2023, 7:00 PM	1
62	MEGA MARTS, LLC	METRO MARKET #371	ANTHONY M KUCHINSKY, Agt	1123 N VAN BUREN ST	Class B Tavern License	65	8/30/2023, 7:00 PM	1
63	Sirk Steak LLC	Mo's A Place for Steaks	JAMES A VASSALLO, Agt	720 N Plankinton AV	Class B Tavern License		9/2/2023, 7:00 PM	1
64	MILWAUKEE REPERTORY THEATER, INC	MILWAUKEE REPERTORY THEATER	Melissa N Vartanian-Mikaelian, Agt	108 E WELLS ST	Class B Tavern License		9/7/2023, 7:00 PM	1
65	Water Street Brewery Inc	Water Street Brewery	MATTHEW R SCHMIDT, Agt	1101 N WATER ST	Class B Tavern License	300	9/13/2023, 7:00 PM	1
66	MILWAUKEE BRAT HOUSE, LLC	MILWAUKEE BRAT HOUSE	SCOTT A SCHAEFER, Agt	1013 N Martin L King Jr DR	Class B Tavern License	191	9/14/2023, 7:00 PM	1
67	THE HARP IRISH PUB, INC	THE HARP	ROBERT C SCHMIDT, JR, Agt	113 E JUNEAU AV	Class B Tavern License	325	9/14/2023, 7:00 PM	1
68	HARP AND EAGLE, LTD	COUNTY CLARE	GREGG W STEFFKE, Agt	1234 N ASTOR ST	Class B Tavern License	160	9/19/2023, 7:00 PM	1
69	ST. PAUL SEAFOOD, LLC	ST. PAUL FISH CO.	TIMOTHY G COLLINS, Agt	400 N WATER ST	Class B Tavern License		9/20/2023, 7:00 PM	1
70	TUDY-BART, LLC	BACCHUS-A BARTOLOTTA RESTAURANT	CHRISTIAN M DAMIANO, Agt	925 E WELLS ST	Class B Tavern License	200	9/21/2023, 7:00 PM	1
71	BRG 777 E Wisconsin LLC	Downtown Kitchen	CHRISTIAN M DAMIANO, Agt	777 E WISCONSIN AV	Class B Tavern License	483	9/21/2023, 7:00 PM	1
72	BRG 1000 Water St LLC	Room @ The Rumpus Room	CHRISTIAN M DAMIANO, Agt	1020 N Water ST	Class B Tavern License		9/21/2023, 7:00 PM	1
73	BARTOLOTTA CATERING - GRAIN EXCHANGE LLC	BARTOLOTTA CATERING - GRAIN EXCHANGE LLC	CHRISTIAN M DAMIANO, Agt	225 E MICHIGAN ST	Class B Tavern License	299	9/21/2023, 7:00 PM	1

74	BRG 1000 Water Street, LLC	Rumpus Room - A Bartolotta Gastropub	CHRISTIAN M DAMIANO, Agt	1030 N Water ST	Class B Tavern License	254	9/21/2023, 7:00 PM	1
75	LUKE'S OF MILWAUKEE, LTD	RED ROCK SALOON MILWAUKEE	JEFFREY A KOVACOVICH, JR, Agt	1225 N WATER ST	Class B Tavern License	390	9/24/2023, 7:00 PM	1
76	WELLS-JEFFERSON CORPORATION	TAYLOR'S	DANIEL R TAYLOR, Agt	795 N JEFFERSON ST	Class B Tavern License	160	9/25/2023, 7:00 PM	1
77	THE WESTOWN ASSOCIATION OF MILWAUKEE, INC.	Westown Association	STACIE J CALLIES, Agt	310 W WISCONSIN AV	Class B Tavern License		9/25/2023, 7:00 PM	1
78	Artisan Ramen LLC	Artisan Ramen	Zoe F Gagliano, Agt	530 E Mason ST	Class B Tavern License	93	9/29/2023, 7:00 PM	1
79	Drury Hotels Company, LLC	Drury Plaza Hotel - Milwaukee Downtown	Chris Palid, Agt	700 N Water ST	Class B Tavern License		10/2/2023, 7:00 PM	1
80	REAL CHILI OF MILWAUKEE, INC	REAL CHILI	STEPHEN J KASTELIC, Agt	419 E WELLS ST	Class B Tavern License	80	10/2/2023, 7:00 PM	1
81	SINCERESWAN, LLC	SWINGIN DOOR EXCHANGE	MICHELLE M SINCERE, Agt	219 E MICHIGAN ST	Class B Tavern License	80	10/10/2023, 7:00 PM	1
82	BAR NONE MILWAUKEE, LLC	BAR NONE	AMY M BLADOW, Agt	1139 N WATER ST	Class B Tavern License	60	10/11/2023, 7:00 PM	1
83	BREW CITY BAR B Q, INC	TRINITY THREE IRISH PUBS	ROBERT C SCHMIDT, JR, Agt	125 E JUNEAU AV	Class B Tavern License	833	10/16/2023, 7:00 PM	1
84	ASCENT BAR MKE LLC	Ascent Bar	TIM B GOKHMAN, Agt	700 E KILBOURN AV	Class B Tavern License		10/17/2023, 7:00 PM	1
85	PTG Live Events LLC	Pabst Theater Group	RICHARD J RYAN, Agt	1119 N Marshall ST	Class B Tavern License		10/31/2023, 7:00 PM	1
86	BW HOLDINGS, LLC	WARD'S HOUSE OF PRIME	BRIAN J WARD, Agt	540 E MASON ST	Class B Tavern License	260	11/1/2023, 7:00 PM	1
87	MKE Events LLC	Red White and Blue	JACOB E DEHNE, Agt	1044 N MARTIN L KING JR DR	Class B Tavern License	824	11/5/2023, 6:00 PM	1
88	3rd Street Market LLC	3rd St Market Hall	Jaime A Jacobs-Schroeder, Agt	275 W Wisconsin AV 100	Class B Tavern License		11/9/2023, 6:00 PM	1
89	HDS 777, LLC	The Sofie	DAVID J SAFINA, Agt	777 N JEFFERSON ST	Class B Tavern License		11/20/2023, 6:00 PM	1
90	CALDERONE CLUB	CALDERONE CLUB	GIORGIO G FAZZARI, SP	842 N Martin L king Jr DR	Class B Tavern License	100	11/21/2023, 6:00 PM	1
91	Dubbel Dutch, LLC	Dubbel Dutch Hotel	Kaelyn M Cervero, Agt	817-819 N MARSHALL ST	Class B Tavern License		11/21/2023, 6:00 PM	1

92	Integrated Plankinton Milwaukee LLC	Cambria Milwaukee Downtown	Christopher R Torres, Agt	503 N Plankinton AV	Class B Tavern License		11/21/2023, 6:00 PM	1
93	JCTH, INC	CAFE AT THE PLAZA	BENJAMIN T CRICHTON, Agt	1007 N CASS ST	Class B Tavern License		11/23/2023, 6:00 PM	1
94	KEN ELLIOT'S, INC	SCOOTERS PUB / DUKES ON WATER	JAMES A BAADE, Agt	150-58 E JUNEAU AV	Class B Tavern License	400	11/24/2023, 6:00 PM	1
95	The Brownstone LLC	The Brownstone	COREY L SMITH, Agt	524 N Water ST	Class B Tavern License		11/27/2023, 6:00 PM	1
96	Tourist Convenience LLC	Racks Full of Snacks	AHMED K YAFAI, Agt	240 W Wells ST	Class A Malt & Class A Liquor License		11/28/2023, 6:00 PM	1
97	BOOBY JDK, LLC	McGillycuddy's Bar & Grill	ANDREW C DEUSTER, Agt	1133-37 N Water ST	Class B Tavern License	300	11/28/2023, 6:00 PM	1
98	OUZO CAFE	OUZO CAFE	NICKEY G PAPPAS, Agt	776 N MILWAUKEE ST	Class B Tavern License	40	11/29/2023, 6:00 PM	1
99	S'LUSH LLC	S'Lush Daiquiri Lounge & Event Space	Tiana M Razaa, Agt	1110 N MARTIN L KING JR DR Suite #100	Class B Tavern License		12/6/2023, 6:00 PM	1
100	Pat's Rib Place 2, LLC	Pat's Rib Place 2	Tyodus D Hayes, Agt	400 N WATER ST	Class B Fermented Malt Beverage Retailer's License		12/11/2023, 6:00 PM	1
101	CSM Milwaukee Downtown LLC	Residence Inn - Milwaukee	Thys V Jones, Agt	101 W Wisconsin AV 3	Class B Tavern License		12/12/2023, 6:00 PM	1
102	Mader's German Restaurant, Inc	Mader's German Restaurant	DANIEL J HAZARD, Agt	1037 N Dr Martin L King Jr DR	Class B Tavern License	370	12/12/2023, 6:00 PM	1
103	TRIPLE CROWN, INC	BUCK BRADLEY'S EATERY & SALOON	WALTER PAGET, Agt	1019 N Dr Martin L King Jr DR	Class B Tavern License	599	12/16/2023, 6:00 PM	1
104	MKE Water Street LLC	ELMNT Lounge	HABIB MANJEE, Agt	618 N WATER ST	Class B Tavern License		12/17/2023, 6:00 PM	1
105	DEER CAMP, LLC	Deer Camp	Paul C Hackbarth, Agt	1023-1027 N Dr Martin L King Jr DR	Class B Tavern License		12/21/2023, 6:00 PM	1
106	THE KING AND I RESTAURANT, INC	THE KING AND I RESTAURANT	DEREK E PHOUNGPHO L, Agt	830 N Dr Martin L King Jr DR	Class B Tavern License	240	12/25/2023, 6:00 PM	1
107	Tua Pasta LLC	Tua Pasta	Alvaro Nino de Guzman Ramirez, Agt	100 E WISCONSIN AV LL101	Class B Fermented Malt Beverage Retailer's License		12/28/2023, 6:00 PM	1
108	Tua Pasta LLC	Tua Pasta	Alvaro Nino de Guzman Ramirez, Agt	100 E WISCONSIN AV LL101	Class C Wine Retailer's License		12/28/2023, 6:00 PM	1

109	Fazzari & Company, LLC	San Giorgio Pizzeria Napoletana	GIORGIO G FAZZARI, Agt	838 N Martin L King Jr DR	Class B Tavern License	99	1/1/2024, 6:00 PM	1
110	ALEM ETHIOPIAN RESTAURANT, LLC	ALEM ETHIOPIAN VILLAGE	MULU H HABTESILAS SIE, Agt	307 E WISCONSIN AV	Class B Tavern License	98	1/16/2024, 6:00 PM	1
111	Button Block Holdings LLC	Homewood Suites Hotel	Travis M Gitter, Agt	500 N Water ST	Class B Tavern License		1/16/2024, 6:00 PM	1
112	CHINA GOURMET, INC	CHINA GOURMET RESTAURANT	ROBERT C TSAO, Agt	117 E WELLS ST	Class B Tavern License	165	1/17/2024, 6:00 PM	1
113	APARTMENT 720, LLC	APARTMENT 720	Tony T Skoufis, Agt	720 N MILWAUKEE ST	Class B Tavern License	299	1/24/2024, 6:00 PM	1
114	Carnivoras Inc	Carnevor	Joseph McLean, Agt	718 N Milwaukee ST	Class B Tavern License	99	1/25/2024, 6:00 PM	1
115	Oak Barrel Public House LLC	Oak Barrel	ROBERT L WILTGEN, Agt	1033 N Martin L King Jr DR	Class B Tavern License		1/29/2024, 6:00 PM	1
116	MEGA MARTS, LLC	PICK 'N SAVE #868	NEIL F WALLACE, Agt	605 E LYON ST	Class A Malt & Class A Liquor License		2/5/2024, 6:00 PM	1
117	MAC PARTNERS, LLC	Milwaukee Athletic Club - Roof Top	Thomas James McGinty, Agt	758 N BROADWAY	Class B Tavern License		2/5/2024, 6:00 PM	1
118	MAC PARTNERS, LLC	Milwaukee Athletic Club - 3rd Floor	Thomas James McGinty, Agt	758 N BROADWAY	Class B Tavern License		2/5/2024, 6:00 PM	1
119	GRANDVIEW MANAGEMENT, INC	ZILLI HOSPITALITY GROUP	ROBERT J ZILLI, Agt	910 E MICHIGAN ST	Class B Tavern License	450	2/6/2024, 6:00 PM	1
120	The Belmont Tavern, Inc	The Belmont Tavern	MICHAEL J VITUCCI, Agt	784 N Jefferson ST	Class B Tavern License	160	2/6/2024, 6:00 PM	1
121	Smoke Shack Mke, LLC	Smoke Shack	David J Marcus, Agt	332 N Milwaukee ST	Class B Tavern License	91	2/6/2024, 6:00 PM	1
122	AJ Bombers MKE, LLC	AJ Bombers	David J Marcus, Agt	1245 N WATER ST	Class B Tavern License	160	2/6/2024, 6:00 PM	1
123	Pourman's LLC	Pourman's	BENJAMIN A HEBL, Agt	1127 N Water ST	Class B Tavern License	80	2/7/2024, 6:00 PM	1
124	Double Dragon MKE LLC	White Tail	NATHAN T TUSLER, Agt	1110 N MARTIN L KING JR DR	Class B Tavern License	80	2/8/2024, 6:00 PM	1
125	WOMANS CLUB OF WISCONSIN	WOMANS CLUB OF WISCONSIN	Patti L Muccio, Agt	813 E KILBOURN AV	Class B Tavern License	500	2/9/2024, 6:00 PM	1
126	3CP LLC	Third Coast Provisions	Andrew H Miller, Agt	724 N Milwaukee ST	Class B Tavern License		2/14/2024, 6:00 PM	1
127	STEE V GEE LLC	Sportclub Nomad	MICHAEL J EITEL, Agt	750 N Jefferson ST	Class B Tavern License	240	2/14/2024, 6:00 PM	1

128	Lucille's Dueling Piano Bar, LLC	Thlrd Street Tavern	Jack Roman, Agt	1110 N MARTIN L KING JR DR	Class B Tavern License	320	2/17/2024, 6:00 PM	1
129	Mojo MKE LLC	Mojo MKE	Todd M Wargula, Agt	134 E JUNEAU AV	Class B Tavern License	239	2/21/2024, 6:00 PM	1
130	MILWAUKEE WATERFRONT DELI, INC	MILWAUKEE WATERFRONT DELI	JEREMIAH D PANDL, Agt	761 N WATER ST	Class B Tavern License		2/26/2024, 6:00 PM	1
131	Ninja MKE Steak House, Inc	Ninja MKE Japanese Steak House	Lichai Chen, Agt	770-772 N MILWAUKEE ST	Class B Tavern License		2/26/2024, 6:00 PM	1
132	Levy @ Milwaukee Symphony	Levy @ Milwaukee Symphony	Joshua J Langenohl, Agt	212 W WISCONSIN AV	Class B Tavern License		2/26/2024, 6:00 PM	1
133	Milwaukee Art Museum, Inc	Milwaukee Art Museum	Christina M Gaskey, Agt	700 N Art Museum DR	Class B Tavern License	2,133	2/28/2024, 6:00 PM	1
134	THE WICKED HOP, LLC	THE WICKED HOP	MILES E O'NEIL, Agt	343-45 N BROADWAY	Class B Tavern License	160	2/29/2024, 6:00 PM	1
135	Who's Milwaukee LLC	Who's on Third, Milwaukee's Pub	ROBERT L WILTGEN, Agt	1003&1007 N Martin L King Jr DR	Class B Tavern License		3/2/2024, 6:00 PM	1
136	FLOUR POWER LLC	Flourchild	Andrew H Miller, Agt	722 N MILWAUKEE ST	Class B Tavern License		3/5/2024, 6:00 PM	1
137	International Exports LLC	The Safe House	David J Metz, Agt	779 N Front ST	Class B Tavern License	248	3/8/2024, 6:00 PM	1
138	Foot Paw LLC	Amilinda	Gregory R Leon, Agt	315 E Wisconsin AV	Class B Tavern License		3/9/2024, 6:00 PM	1
139	Xankia LLC	Xankia	Vang Thao, Agt	222 W WELLS ST	Class B Tavern License		3/12/2024, 7:00 PM	1
140	Allure MKE LLC	Allure MKE	Tino K Bates, Agt	787-789 N Jefferson ST	Class B Tavern License		3/15/2024, 7:00 PM	1
141	CHIPOTLE MEXICAN GRILL OF CO, LLC	CHIPOTLE MEXICAN GRILL #313	Brian J Bushaw, Agt	600 E OGDEN AV	Class B Tavern License	99	3/19/2024, 7:00 PM	1
142	Discourse Coffee, LLC	Discourse Coffee	Ryan S Castelaz, Agt	1020 N BROADWAY	Class B Tavern License	110	3/20/2024, 7:00 PM	1
143	Charro Latino, LLC	The Garden/Lucid	Michael B Byers-Dent, Agt	725-729 N Milwaukee ST	Class B Tavern License	490	3/21/2024, 7:00 PM	1
144	SAZAMA'S FINE CATERING, INC	SAZAMA'S FINE CATERING	Stephanie L Sazama-Schneck, Agt	929 N WATER ST	Class B Tavern License		4/4/2024, 7:00 PM	1
145	M DE PALMA, LLC	MONICA'S ON ASTOR	MONICA J DE PALMA, Agt	1228 N ASTOR ST	Class B Tavern License	159	4/9/2024, 7:00 PM	1
146	Higbee's MKE LLC	BODEGA	PATSY SMITH-JAMES, Agt	628 N Water ST	Class B Tavern License	225	4/13/2024, 7:00 PM	1

147	Steakhouse Milwaukee LLC	Rare Steakhouse	Mark D Burish, Agt	833 E MICHIGAN ST	Class B Tavern License		4/16/2024, 7:00 PM	1
148	Jay Squared LLC	The Box	Jamie A Berger, Agt	311 E Wisconsin AV	Class B Tavern License	270	4/17/2024, 7:00 PM	1
149	BRUNCH MKE LLC	BRUNCH	Morgan K Schnabl, Agt	714 N MILWAUKEE ST	Class B Tavern License	160	4/17/2024, 7:00 PM	1
150	HOWL MILWAUKEE, LLC	Howl At The Moon	Michael A Wabiszewski, Agt	1103 N MARTIN L KING JR DR	Class B Tavern License		4/17/2024, 7:00 PM	1
151	East Town Association, Inc	East Town Association	Edgar L Sturkey, Agt	520 E WELLS ST	Class B Tavern License		4/17/2024, 7:00 PM	1
152	Benelux Third Ward, LLC	Cafe Benelux	ERIC G WAGNER, Agt	346 N Broadway	Class B Tavern License	455	5/1/2024, 7:00 PM	1
153	Kinn GH LL LLC	Kinn MKE Guesthouse	Michael Dietrich, Agt	600 N BROADWAY	Class B Tavern License	258	5/1/2024, 7:00 PM	1
154	LUPI & IRIS, LLC	Lupi & Iris/Andiamo	Michael D DeMichele, Agt	777 N VAN BUREN ST	Class B Tavern License		5/7/2024, 7:00 PM	1
155	LUPI & IRIS, LLC	Lupi & Iris/Andiamo	Michael D DeMichele, Agt	777 N VAN BUREN ST	Class A Malt & Class A Liquor License		5/7/2024, 7:00 PM	1
156	Milwaukee School of Engineering	Milwaukee School of Engineering	Beth M Luedtke-Williams, Agt	1000 N BROADWAY	Class B Tavern License	480	5/18/2024, 7:00 PM	1
157	Milwaukee School of Engineering	Milwaukee School of Engineering	Beth M Luedtke-Williams, Agt	1025 N BROADWAY	Class B Tavern License		5/18/2024, 7:00 PM	1
158	MILWAUKEE SCHOOL OF ENGINEERING	MILWAUKEE SCHOOL OF ENGINEERING	Beth M Luedtke-Williams, Agt	1120 N BROADWAY	Class B Tavern License	208	5/18/2024, 7:00 PM	1
159	PPH Properties I LLC	Silk Exotic Gentlemen's Club	SCOTT A KRAHN, Agt	730 N Dr Martin L King Jr DR	Class B Tavern License	297	5/25/2024, 7:00 PM	1

Establishments within a 0.5 miles radius centered on area of interest.



Wednesday, July 05, 2023



# Notice of Public Hearing

Blank Notice

---

ORR, Jessica J, Agent  
Electric Lime at 811-813 N JEFFERSON St  
Class B Tavern, Public Entertainment Premises, Food Dealer and Sidewalk Dining License  
Applications Requesting Instrumental Musicians, Disc Jockey, Bands, Magic Shows, 5  
Amusement Machines, Poetry Readings, Comedy Acts and 12 Theater Performances/yr

**Tuesday, July 18, 2023 at 9:50 AM**

To whom it may concern:

The above application has been made by the above named applicant(s). This requires approval from the Licenses Committee and the Common Council of the City of Milwaukee. The hearing before the Licenses Committee will take place on 7/18/2023 at 9:50 AM in Room 301-B, Third Floor, City Hall. This is a public hearing. Those wishing to view the proceeding are able to do so via the City Channel – Channel 25 on Spectrum Cable – or on the Internet at <http://city.milwaukee.gov/citychannel>. Those wishing to provide oral testimony via phone or internet are asked to contact the staff assistant, Yadira Melendez at (414) 286-2775 or [stasst5@milwaukee.gov](mailto:stasst5@milwaukee.gov) for necessary information. Please make such requests no later than one business day prior to the start of the meeting. You are not required to attend the hearing, but please see the information below if you would like to provide testimony. Once the Licenses Committee makes its recommendation, this recommendation is forwarded to the full Common Council for approval at its next regularly scheduled hearing.

---

## Important details for those wishing to provide information for the Licenses Committee to consider when making its recommendation:

1. The license application is scheduled to be heard at the above time. Due to other hearings running longer than scheduled, you may have to wait some time to provide your testimony.
2. You must appear in person and testify as to matters that you have personally experienced or seen. (You cannot provide testimony for your neighbor, parent or anyone else; this is considered hearsay and cannot be considered by the committee.)
3. No letters or petitions can be accepted by the committee (unless the person who wrote the letter or the persons who signed the petition are present at the committee hearing and willing to testify).
4. Persons opposed to the license application are given the opportunity to testify first; supporters may testify after the opponents have finished.
5. When you are called to testify, you will be sworn in and asked to give your name, and address. (If your first and/or last names are uncommon please spell them.)
6. You may then provide testimony.
  - a. Include only information relating to the above license application.
  - b. Include only information you have personally witnessed or seen.
  - c. Provide concise and relevant information detailing how this business has affected or may affect the peaceful enjoyment of your neighborhood.
  - d. If by the time you have the opportunity to testify, the information you wish to share has already been provided to the committee, you may state that you agree with the previous testimony. Redundant or repetitive testimony will not assist the committee in making its recommendation.
7. After giving your testimony, the members of the Licenses Committee and the licensee may ask questions regarding the testimony you have given or other factors relating to the license application.
8. Business Competition is not a valid basis for denial or non-renewal of a license.  
**Please Note: If you have submitted an objection to the above application your objection cannot be considered by the committee unless you personally testify at the hearing.**

OCCUPANT	MAIL ADDRESS	CITY STATE ZIP
CURRENT OCCUPANT	828 N MILWAUKEE ST# 1	MILWAUKEE, WI 53202-3606
CURRENT OCCUPANT	828 N MILWAUKEE ST# 10	MILWAUKEE, WI 53202-3606
CURRENT OCCUPANT	828 N MILWAUKEE ST# 11	MILWAUKEE, WI 53202-3606
CURRENT OCCUPANT	828 N MILWAUKEE ST# 12	MILWAUKEE, WI 53202-3606
CURRENT OCCUPANT	828 N MILWAUKEE ST# 14	MILWAUKEE, WI 53202-3606
CURRENT OCCUPANT	828 N MILWAUKEE ST# 15	MILWAUKEE, WI 53202-3606
CURRENT OCCUPANT	828 N MILWAUKEE ST# 16	MILWAUKEE, WI 53202-3606
CURRENT OCCUPANT	828 N MILWAUKEE ST# 17	MILWAUKEE, WI 53202-3606
CURRENT OCCUPANT	828 N MILWAUKEE ST# 2	MILWAUKEE, WI 53202-3606
CURRENT OCCUPANT	828 N MILWAUKEE ST# 3	MILWAUKEE, WI 53202-3606
CURRENT OCCUPANT	828 N MILWAUKEE ST# 4	MILWAUKEE, WI 53202-3606
CURRENT OCCUPANT	828 N MILWAUKEE ST# 5	MILWAUKEE, WI 53202-3606
CURRENT OCCUPANT	828 N MILWAUKEE ST# 6	MILWAUKEE, WI 53202-3606
CURRENT OCCUPANT	828 N MILWAUKEE ST# 7	MILWAUKEE, WI 53202-3606
CURRENT OCCUPANT	828 N MILWAUKEE ST# 8	MILWAUKEE, WI 53202-3606
CURRENT OCCUPANT	828 N MILWAUKEE ST# 9	MILWAUKEE, WI 53202-3606
CURRENT OCCUPANT	828 N MILWAUKEE ST# A	MILWAUKEE, WI 53202-3606
CURRENT OCCUPANT	828 N MILWAUKEE ST# B	MILWAUKEE, WI 53202-3606

Blank Notice

Total Records: 18

Radius 250.0 feet and Center of the Circle: 811 N Jefferson St



## BUSINESS LICENSE PLAN OF OPERATION

ccl-busplan 5/12/2020

Office of the City Clerk License Division  
200 E. Wells St. Room 105, Milwaukee, WI 53202  
(414) 286-2238 www.milwaukee.gov/license e-mail address: [license@milwaukee.gov](mailto:license@milwaukee.gov)

### 1. Type of Business

Applying for: ☐ Extended Hours (12AM to 5AM) - If a food establishment, check all that apply: ☐ Delivery ☐ Drive Thru ☒ Dining Room  
☐ Self Service Laundry ☐ Massage Establishment ☐ Filling Station  
☒ Other (supplemental application for specific license also required) **BAR / TAVERN / RESTAURANT**

Provide a detailed description of the type of business you plan on operating:

**MEXICAN RESTAURANT - BAR**

Do you have any experience operating this type of business? ☐ No ☒ Yes If yes, explain: **HOSPITALITY DESIGN - BARTENDER**

### 2. Business Operations

**SERVER**

- a. Proposed Opening Date: **N-A**
- b. Is this premise under construction? ☐ No ☒ Yes If yes, list estimated completion date: **N-A**
- c. Is this a franchise? ☒ No ☐ Yes
- d. Is this premises currently licensed? ☒ No ☐ Yes If yes, list type of license: \_\_\_\_\_
- e. Is the current licensee operating? ☒ No ☐ Yes If no, list date closed: \_\_\_\_\_
- f. Do you have future plans for other businesses, licenses or permits at this location? ☒ No ☐ Yes  
If yes, explain: \_\_\_\_\_
- g. Have you previously held an Extended Hours License in Milwaukee? ☒ No ☐ Yes  
If yes, list address(es): \_\_\_\_\_
- h. Are other businesses operating in the same building? ☐ No ☒ Yes If yes, describe: **2ND FLOOR OFFICE SPACE**

### 3. Litter & Noise

- a. How are grounds kept clean? ☒ Sweep ☒ Pressure Wash ☒ Pick Up Litter ☐ Other: \_\_\_\_\_
- b. How often will grounds be cleaned? ☒ Daily ☐ Weekly ☐ As Needed ☐ Monthly ☐ Other: \_\_\_\_\_
- c. Grounds cleaned by: ☐ Licensee ☐ Building Owner ☒ Employees ☐ Hired Maintenance ☐ Other: \_\_\_\_\_
- d. How are noise issues prevented and/or addressed? ☐ Security ☒ Manager approaches customer(s) ☐ Call Police  
☐ Signs Posted ☐ Other: \_\_\_\_\_
- e. Will a sound amplification system be used? ☐ No ☒ Yes If yes, describe: **RESTAURANT SOUND SYSTEM**

### 4. Smoking & Sanitation

- a. Are there designated outdoor smoking areas? ☒ No ☐ Yes If yes, describe: \_\_\_\_\_
- b. Number of Garbage Cans: Inside: **11** Locations: **SEE ATTACHED** **WOMENS RESTROOM BAR BACK**  
Outside: **1** Locations: **DUMPSTER SEE ATTACHED** **MENS RESTROOM BAR DINING**  
**KITCHEN BEHIND BAR**
- c. Is a crowd control barrier used? ☒ No ☐ Yes If yes, describe: \_\_\_\_\_
- d. How many restrooms are on the premises? **2**
- e. Name of solid waste contractor: ☐ Advanced Disposal ☒ Waste Management ☐ Other: **WMA**

## 5. Security

- a. Are there onsite parking spaces? ☒ No ☐ Yes If yes, how many? \_\_\_\_\_ and describe the parking security plan: \_\_\_\_\_
- b. Is there a loading zone? ☒ No ☐ Yes If yes, describe the loading area security plan: \_\_\_\_\_
- c. Will you have security personnel on premise? ☒ No ☐ Yes If yes, how many? \_\_\_\_\_ and answer the following:  
What are their responsibilities? \_\_\_\_\_  
Is security equipment used? ☐ No ☐ Yes If yes, describe \_\_\_\_\_  
List their licensing, certification, or training credentials \_\_\_\_\_
- d. Will there be security cameras? ☐ No ☒ Yes If yes, how many? 16 and list locations: Throughout BAR AREA - DINING ROOM - OUTSIDE FRONT AND BACK - LIQUOR ROOM
- e. Will searches/identification checks be done upon entry? ☒ No ☐ Yes If yes, describe \_\_\_\_\_

## 6. Percentage of Sales (must total 100%)

Alcohol <u>35</u> %	Food <u>65</u> %	Secondhand Merchandise _____ %	Precious Metals & Gems _____ %
Entertainment _____ %	Cigarettes _____ %		
Pawnbroker Activity _____ %	Salvaged Materials _____ % (such as scrap metal)	Personal Services (such as tattoo, body piercing, salon, tailor, tanning, etc.) _____ %	Other _____ % Describe: _____

## 7. Businesses/Licenses on the Premises (check all that apply):

### Type 1

- ☒ Full Service Restaurant ☐ Cafe/Coffee Shop ☐ Deli or Fast Food Restaurant ☐ Private/Fraternal/Veterans Club
- ☐ Night Club ☒ Tavern ☒ Cocktail Lounge ☐ Teen Club
- ☐ Banquet Hall ☐ Sports Facility ☐ Bowling Alley
- ☐ Hotel/Motel: Number of Floors: \_\_\_\_\_ Number of Rooms: \_\_\_\_\_  
Rooming House: Number of Floors: \_\_\_\_\_ Number of Rooms: \_\_\_\_\_

### Type 2

- ☐ Liquor Store ☐ Corner Store ☐ Supermarket ☐ Convenience Store
- ☐ Gas Station ☐ Amusement/Phonograph Distributor ☐ Recycling, Salvage or Towing
- ☐ Used Car Dealer ☐ Personal Service Establishment  
(such as tattoo business, hair salon, tailor, etc.) ☐ Recording Studio

What other licenses/permits will you hold at this location? (check all that apply)

- ☐ Occupancy Permit ☐ Cigarette & Tobacco ☐ Gas Station ☐ Extended Hours ☐ Class "B" Tavern ☐ Weights & Measures
- ☐ Secondhand Dealer ☐ Precious Metal & Gem ☐ Other: \_\_\_\_\_

## 8. Legal Capacity (only if a Type 1 premises in #7 above)

Capacity N/A TBD (Call the Milwaukee Development Center at 414-286-8211 if you have questions.)

## 9. Premises Description

a. Identify all area(s) of the premises that will be used in operating this business (include areas used only for storage):

☒ 1<sup>st</sup> Floor ☐ 2<sup>nd</sup> Floor ☒ Basement Storage ☐ Patio ☐ Beer Garden ☒ Sidewalk Café ☐ Deck ☐ Rooftop

☐ Other: Describe: PARK LOT

b. Describe Location: ☐ Major Thoroughfare ☒ Secondary Street ☐ Other: \_\_\_\_\_

c. Nearest Major Cross Street: WELLS ST

d. Describe Building: ☒ Free Standing Building ☐ Strip Mall ☐ Other: \_\_\_\_\_

e. Describe Premises Structure: ☐ Single Story ☒ Multi-Story - # of Stories 2 ☐ Other: \_\_\_\_\_

f. Describe Surrounding Area: ☒ Commercial ☒ Residential ☐ Industrial ☐ Other: \_\_\_\_\_

g. Building Owner Name: CATHEDRAL SQUARE LIMITED PARTNERSHIP Phone: 414-224 5010

Building Owner Address: 788 NORTH JEFFERSON ST MILWAUKEE WI 53202

## 10. Hours of Operation & Customers

Will customers be entering the premises? ☐ No ☒ Yes

Day of the Week	Proposed Hours of Operation:		Estimated Number of Customers expected each day	Potential Age Range of Customers	Class B Tavern Applicant Only: Age Restriction (If none, write 'None')
	Open Time (include a.m. or p.m.)	Close Time (include a.m. or p.m.)			
Sunday	9:00 AM - 2:00 AM	2:00 AM	150	21 and up	NONE
Monday	11:00 PM - 2:00 AM	2:00 AM	100	21 and up	NONE
Tuesday	11:00 PM - 2:00 AM	2:00 AM	100	21 and up	NONE
Wednesday	11:00 PM - 2:00 AM	2:00 AM	100	21 and up	NONE
Thursday	11:00 PM - 2:00 AM	2:00 AM	100	21 and up	NONE
Friday	11:00 PM - 2:30 AM	2:30 AM	100	21 and up	NONE
Saturday	9:00 AM - 2:30 AM	2:30 AM	150	21 and up	NONE

An Extended Hours Establishment License is required for any convenience store, filling station, personal service establishment (such as tattoo, body piercing, salon, tailor, tanning, etc.), recording studio or restaurant which is open between the hours of 12:00 a.m. and 5:00 a.m.

Alcohol Establishments Class A: 8:00 am to 9:00 pm Sunday thru Saturday  
Permitted Hours of Operation: Class B: 6:00 am to 2:00 am Sunday thru Thursday, 6:00 am to 2:30 am Friday & Saturday

Entertainment Outdoor Closing Hours: 10:00pm Sunday-Thursday; 12:00am Friday & Saturday; unless a different time, either earlier or later, is established by the Common Council in its approval of the licensee's plan of operation.

## 11. Signature(s)

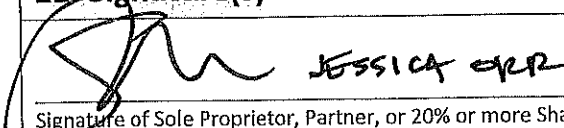
 JESSICA ORR  
Signature of Sole Proprietor, Partner, or 20% or more Shareholder  
(If there are no 20% or more shareholders, Corporate Officer-print name/title and sign)

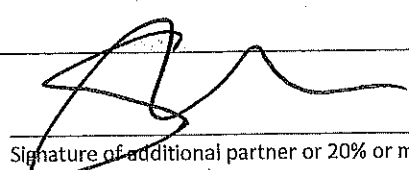
  
Signature of additional partner or 20% or more shareholder

See Application Information for a complete list of all required application forms.



# ALCOHOL BEVERAGE & PUBLIC ENTERTAINMENT PREMISES SUPPLEMENTAL APPLICATION

Office of the City Clerk License Division

200 E. Wells St. Room 105, Milwaukee, WI 53202

(414) 286-2238 e-mail address: license@milwaukee.gov [www.milwaukee.gov/license](http://www.milwaukee.gov/license)Legal Entity Name: ELECTRIC LINE MILWAUKEE WI 53202Premise Address: 811 - 813 N. JEFFERSON STREET MILWAUKEE WI 53202**Proximity of Premises to Church, School, Daycare Center or Hospital**Is the building within 300 feet of any church, school, daycare center or hospital? ☒ No ☐ Yes**"Service Bar Only" Designation**If applying for Class B or C license, are you applying for "Service Bar Only"? ☒ No ☐ Yes

Service Bar Only means customers cannot sit at the bar. Alcohol is served to employees who serve patrons seated at tables. No stools, chairs or other articles of furniture shall be placed at the service bar for patrons to sit upon.

**Business Information**a) Are you taking out this application for anyone that may not be eligible for a license? ☒ No ☐ Yes

If yes, list their name and address: \_\_\_\_\_

b) Will the agent, a partner or the individual licensee be conducting the day-to-day operations of the business? ☐ No ☒ Yes

If no, list the name and address of the person(s) who will: \_\_\_\_\_

Class B Applicants: If the agent, a partner or the individual licensee will not be conducting the day-to-day operations of the business, the person(s) listed above must obtain a Class B Managers license.

c) Does anyone else have money invested or any other interest in this business? ☒ No ☐ Yes

If yes, explain: \_\_\_\_\_

d) Have you made an agreement with anyone to repay any loan or any other payments based upon income from the business?

☒ No ☐ Yes If yes, list name and address: \_\_\_\_\_**Property Information (New & Transfer Applicants Only)**a) Do you own or lease the building? ☐ Own ☒ Leaseb) Who owns the fixtures (for example, coolers, etc.)? ELECTRIC LINE MILWAUKEE LLCc) Are you purchasing the stock and/or fixtures? ☒ No ☐ Yes If yes, amount paid \$ \_\_\_\_\_d) Total amount paid for business \$ 0e) Total amount paid for goodwill of the business \$ 0

Goodwill comprises the reputation and customer relationships of an existing business. If the price you pay for the business exceeds the fair market value of all of the rest of the assets of the business, the excess may be considered goodwill.

f) Have you made arrangements with the seller for payment of personal property taxes? ☒ No ☐ Yes**Lease Information (New & Transfer Applicants who are leasing the premises only)**a) Date lease begins April 1 2023 Ends April 1 2028b) Monthly rental \$ 6062.73c) Do you have an option to renew the lease? ☐ No ☒ Yesd) Does your lease allow for assignment to another party without the consent of the owner? ☒ No ☐ Yese) For what length of time have you been guaranteed occupancy (number of years)? 5 YEARS

### Lease Information (Continued)

- f) In addition to paying the monthly rental, will you have to pay anything additional to the owner of the building to guarantee performance of the lease? ☐ No ☒ Yes If yes, explain 2.5% over 1.5 Million Dollars
- g) Does the present owner or occupant object to the granting of your license? ☒ No ☐ Yes  
If yes, explain \_\_\_\_\_

### Change of Agent Applicants Only

Have there been any changes to the floor plan since the last application was submitted? ☐ No ☐ Yes  
If no, a new floor plan is not required. If yes, submit a new floor plan and explain the change(s):  
\_\_\_\_\_

### Signature

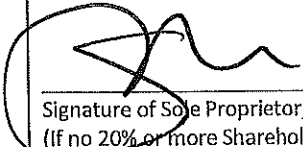
 JESSICA ORR  
Signature of Sole Proprietor, Partner or 20% or More Shareholder  
(If no 20% or more Shareholder, Corporate Officer - print name/title and sign)

Note: All Information contained in this application is subject to approval by the Common Council.  
Deviating from approved plan of operation will subject licensee to citations, and/or suspension or non-renewal of the license.  
Contact the License Division for information on how to request changes.

### New and transfer of premises applicants must submit the following:

- ☐ Detailed floor plan  
☐ If a restaurant, copy of the menu



## FOOD DEALER LICENSE PLAN OF OPERATION

OFFICE OF THE CITY CLERK, LICENSE DIVISION  
CITY HALL, 200 E. WELLS ST, ROOM 105, MILWAUKEE, WI 53202  
(414) 286-2238 • [license@milwaukee.gov](mailto:license@milwaukee.gov) • [www.milwaukee.gov/license](http://www.milwaukee.gov/license)

ccl-foodplan 2/28/19

Legal Entity Name:

**ELECTRIC LINE MILWAUKEE LLC**

Premises Address:

**811-813 N JEFFERSON ST Milwaukee WI 53202**

### SECTION 1 TYPE OF BUSINESS

What will be the majority of your food sales? (check one)

☒ Restaurant Items (meals):

MEALS include, but are not limited to, chicken, ribs, sandwiches, roasted corn, baked potatoes, hot dogs, brats, tacos, nachos w/ cheese and meat, French fries, cooked or deep fried vegetables/fruit, cooked cheese curds, corn dogs, egg rolls, salads.

☐ Retail Items (snacks and beverages):

RETAIL items include, but are not limited to, ice cream/soft serve, lemonade, snow cones, coffee, espresso, cappuccino, tea, fruit juice, smoothies, candy, dispensed soda, fruit cups, bakery, cookies, kettle corn, cotton candy, funnel cakes, fritters, tortilla chips w/ cheese.

Will it be a convenience store? ☐ Yes ☒ No

A convenience store contains less than 5,000 square feet of retail space and has, as its primary business, the sale of basic food items and in addition, sells household products or is a filling station that sells basic food items and household products.

☐ Bed & Breakfast

☐ Micro Market

All Applicants: Submit a menu or a list of food items that will be sold.

Will any wholesale business be done? ☒ No ☐ Yes If yes, what percentage of food sales will be wholesale?

☐ Less than 25%

☐ 25% or More AND:

☐ Restaurant items (meals) will be sold – Complete this application and also contact DATCP.

☐ NO restaurant items (meals) will be sold – Do NOT complete this application. Contact DATCP only.

### SECTION 2 FOOD PROCESSING

Will any food processing be done? ☐ No ☒ Yes

Processing is defined as assembling, grinding, cutting, mixing, baking, coating, stuffing, packing, bottling, grilling, canning, extracting, fermenting, distilling, pickling, freezing, drying, smoking, or packaging.

### SECTION 3 FOOD REQUIRING TEMPERATURE CONTROL

Will any food that requires temperature control be sold? ☐ No ☒ Yes

(includes dairy products such as milk, cheese, and ice cream, fish, shellfish, meat, poultry)

If yes, list the types of food items **CHEESE FISH MEAT Poultry Eggs Produce**

**SECTION 4 DETAILS OF OPERATION**

Will you have seating on site for dining? ☐ No ☒ Yes

Will you be doing any catering? ☐ No ☒ Yes

Will you be doing any delivery? ☐ No ☒ Yes

Will you have outdoor activities? ☐ No ☒ Yes - Check all that apply: ☒ Bar ☐ Cooking/Grilling ☒ Dining

Will you have a drive thru window? ☒ No ☐ Yes - Are hours different from inside? ☐ No ☐ Yes  
If Yes, provide drive thru hours: \_\_\_\_\_

Will scales or barcode scanners be used? ☒ No ☐ Yes - You must also apply for a Weights & Measures License.

**SECTION 5 ADDITIONAL SITES**

Where will food be prepared and/or sold?

☒ At a single site ☐ At multiple sites: How many? \_\_\_\_\_ (for example, a hotel with several dining rooms or bars)

If multiple sites, attach a Food Dealer Additional Site Addendum (ccl-foodadd) for each additional site.

**SECTION 6 CONSTRUCTION OR CHANGES**

Are you planning any construction, remodeling or equipment changes?

☐ No If No, SKIP to Section 8

☒ Yes If Yes, check all that apply: ☐ New construction of a building ☒ Renovation or remodeling  
☐ Construction changes to existing building ☐ Equipment changes only

Provide a brief description of the changes:

Start date:

Name, Address & Phone Number of Architect:

Name, Address & Phone Number of Contractor:

Cosmetic - Interior Design  
April 1, 2023  
ANDERSON ASTON  
2746 South 166th St NEW Berlin 53151  
N/A 262-786-4640

**SECTION 7 ALCOHOL BEVERAGES**

Are you applying for an alcohol beverage license?

☐ No If No, SKIP to Section 9

☒ Yes If YES, if your food license is approved prior to the alcohol license, when do you want the food license issued?  
☐ Immediately ☒ At the same time as the alcohol license

**SECTION 8 ACKNOWLEDGEMENTS & SIGNATURE**

You must initial each item confirming your understanding:

JS

I understand the Health Department must conduct an inspection and advise the License Division of their approval before the license may be issued.

JS

I understand I must obtain an occupancy permit from the Department of Neighborhood Services and an inspection may be required. Neighborhood Services must advise the License Division of their approval before the license may be issued.

JS

I understand the district alderperson will review and either support or object to my application. If he/she objects, I may appeal and be scheduled to appear before the Licenses Committee. The Licenses Committee will then make a recommendation to the Common Council. The Common Council must grant the license before it may be issued.

JS

I understand proof of payment for all license fees must be on file in the License Division before the license may be issued and the license must be issued and posted in my establishment prior to opening for business.

JS

I will not operate my food business until the license has been issued and posted in the establishment.

Signature of Sole Proprietor, Partner, or 20% Shareholder:

Signature of Additional Partner:



# **PUBLIC ENTERTAINMENT PREMISES LICENSE SUPPLEMENTAL APPLICATION**

Office of the City Clerk License Division  
200 E. Wells St. Room 105, Milwaukee, WI 53202  
(414) 286-2238 [www.milwaukee.gov/license](http://www.milwaukee.gov/license) e-mail address: [license@milwaukee.gov](mailto:license@milwaukee.gov)

**PREMISES ADDRESS:** 81-813 N. JEFFERSON STREET MILWAUKEE WI 53202

## **TYPES OF ENTERTAINMENT (CHECK ALL THAT APPLY)**

<input checked="" type="checkbox"/> Instrumental Musicians	<input type="checkbox"/> Battle of the Bands	<input type="checkbox"/> Dancing by Performers	<input checked="" type="checkbox"/> Amusement Machines How many? <u>5</u>
<input checked="" type="checkbox"/> Bands	<input checked="" type="checkbox"/> Comedy Acts	<input type="checkbox"/> Adult Entertainment/ Strippers/Erotic Dance	<input type="checkbox"/> Concerts Approx. # per year? _____
<input type="checkbox"/> Bowling Alley How many? _____	<input checked="" type="checkbox"/> Disc Jockey	<input type="checkbox"/> Wrestling	<input checked="" type="checkbox"/> Theatrical Performances Approx. # per year? <u>12</u>
<input type="checkbox"/> Pool Tables How many? _____	<input checked="" type="checkbox"/> Magic Shows	<input type="checkbox"/> Patron Contests	<input type="checkbox"/> Jukebox
<input type="checkbox"/> Motion Pictures (movies by admission) - How many? _____	<input checked="" type="checkbox"/> Poetry Readings	<input type="checkbox"/> Patrons Dancing	<input type="checkbox"/> Karaoke
<input type="checkbox"/> Other: _____			

*Entertainment Outdoor Closing Hours: 10:00pm Sunday-Thursday; 12:00am Friday & Saturday; unless a different time, either earlier or later, is established by the Common Council in its approval of the licensee's plan of operation.*

## **PROMOTERS/SOUND AMPLIFICATION**

Will promoters ever be used for any of the entertainment? ☒ No ☐ Yes If Yes, Describe: \_\_\_\_\_

At any time will sound amplification be used? ☒ No ☐ Yes If Yes, Describe: \_\_\_\_\_

## **LEGAL CAPACITY OF PREMISES**

NA (Call the Development Center at 414-286-8211 with questions.) Legal capacity determines the fee for your Public Entertainment Premises License. If you would like to request the license be approved with a lower capacity than that listed above, indicate the lower capacity here: \_\_\_\_\_. If approved, this lower capacity will print on your license and override the capacity listed on your Occupancy Permit.

## **ACKNOWLEDGEMENT/SIGNATURE**

I understand that after the license has been issued, a change to the plan of operation will require a written request to change and approval from the Common Council. I agree to inform the City Clerk within 10 days of any substantial changes in the information supplied in this application. I understand that I shall not willfully refuse to provide the services offered under this license, or add charges or require deposits not required of the general public because of race, color, sex, religion, national origin or ancestry, age, handicap, lawful source of income, marital status, sexual orientation, gender identity or expression, familial status or the fact that a person is now or has been a member of the military service, whether dressed in uniform or not; and shall not seek such information as a condition of employment, or penalize any employee or discriminate in the selection of personnel for training or promotion on the basis of such information.

I have knowledge of the City Ordinances currently regulating public entertainment, and understand that the license may be subject to suspension, non-renewal or revocation, if I violate any rule, law or regulation of the city of Milwaukee and State of Wisconsin.

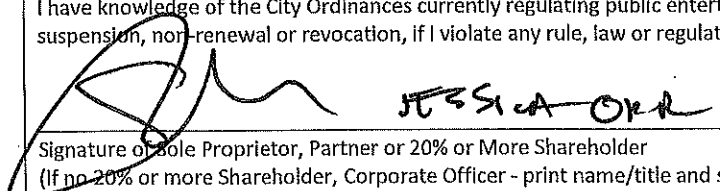
  
Signature of Sole Proprietor, Partner or 20% or More Shareholder  
(If no 20% or more Shareholder, Corporate Officer - print name/title and sign)

## **Office Use Only:**

Initials: (CR) Filed: 4/27/23 App: PEP351210

Only PEP? ☐ No ☐ Yes If Yes, ☐ Queue to MPD and ☐ Email Mgrs/Team Lead (must be heard w/in 60 days)

APRIL 26, 2023  
 ELECTRIC LINE MILWAUKEE LLC  
 DBA/ ELECTRIC LINE  
 311-813 N. JEFFERSON STREET  
 MILWAUKEE WI 53202  
 PHONE NUMBER - N/A  
 JESSICA ORR  
 646.469.1200

EAST WELLS STREET

OUTDOOR FURNITURE	
TABLES - 5 TABLES	
(L) 30" ROUND	
(W) 30" ROUND	
(H) 29" HEIGHT	
CHAIRS - 20 CHAIRS	
BACK-TOP TO BOTTOM	
(H) 34" (SEAT HEIGHT 18")	
(W) 17" ROUND	
PLANTERS - 6	
4 - 12" ROUND	
2 - 10" ROUND	
PARKING METERS -	
2	
SIGN POSTS -	
LIGHT POSTS - 1	
TREES - (2)	

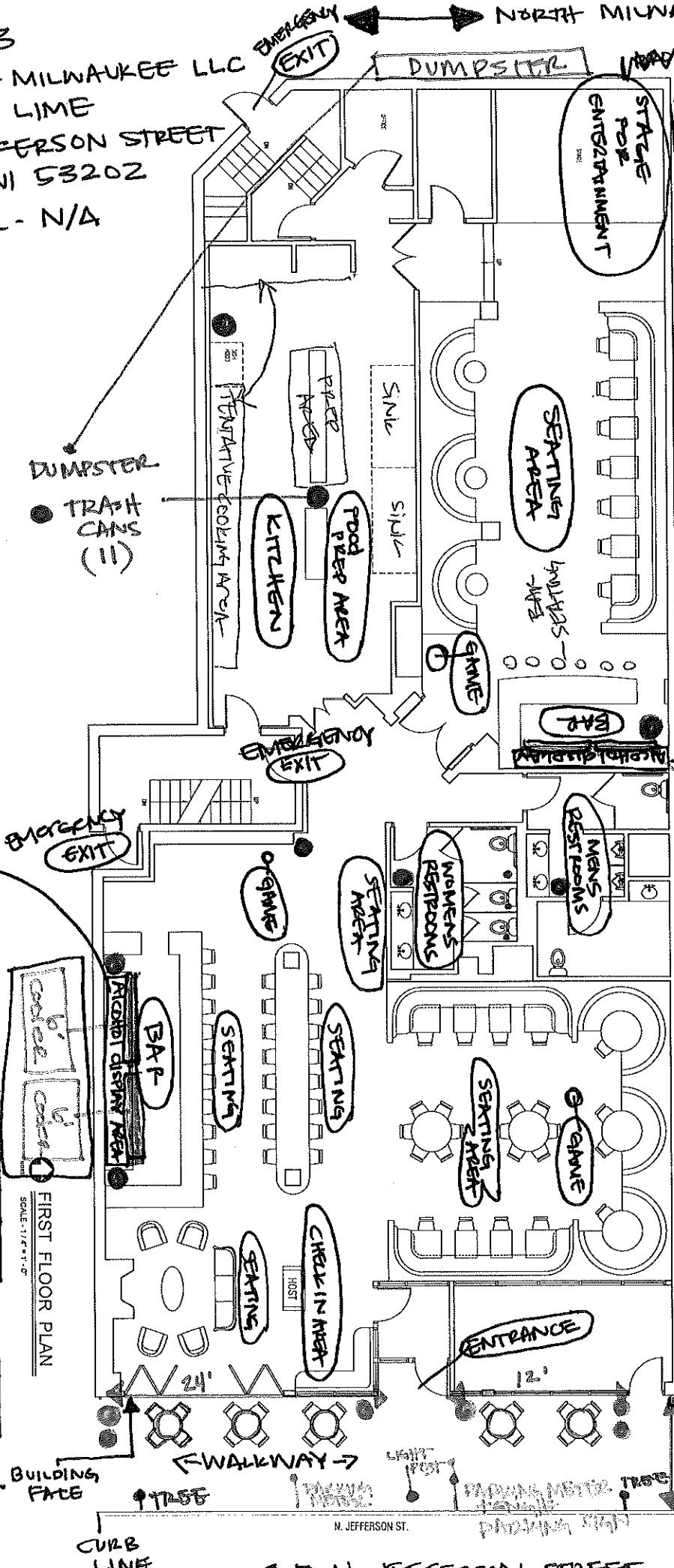

BUILDING DIMENSIONS:

TOTAL SQUARE FEET OFF PREMISE:  
 5596 sq. ft.

- EAST + WEST 120' LONG
- NORTH + SOUTH JEFFERSON ST. 36' Wide
- NORTH + SOUTH ALLEY (Milwaukee St) 45' Wide

120' X 36' X 45'

ALCOHOL DISPLAY 8' X 20"

(2) 4' Coolers

PROPERTY LINE

SIDEWALK SEATING AREA  
 36' X 15'

540 Sq. FT. SIDEWALK SPACE  
 10' WALKWAY FOR PEDESTRIANS

FIRST FLOOR PLAN  
 SCALE 1/8" = 1'-0"

BUILDING FACE

CURB LINE

N. JEFFERSON ST.

APRIL 26, 2023  
ELECTRIC LINE MILWAUKEE LLC  
DBA / ELECTRIC LINE  
311-83 N. JEFFERSON ST.  
MILWAUKEE WI 53202

PHONE NUMBER - N/A  
JESSICA ORR  
246-469-1200

ALLEY

MILWAUKEE STREET

ENTRY + EMERGENCY EXIT

GARBAGE CANS

7x9' FOOD COOLER

ENTRY EMERGENCY EXIT

20'x9' LIQUOR ROOM

11'x7' WALK IN COOLER FOR BEER

ADD TWO 2" PIPES TO HALLWAY THIS WILL LEAVE 50" HALLWAY FOR WALKING SPACE AND ADD AIR TO THE BASEMENT THIS IS NEEDED TO REMOVE AND ADD AIR TO THE BASEMENT

Food Entry Room

Entry Room

ENTRY BEER COOLER

N

BASEMENT  
LIQUOR, BEER +  
FOOD COOLERS

JEFFERSON STREET

SAINT

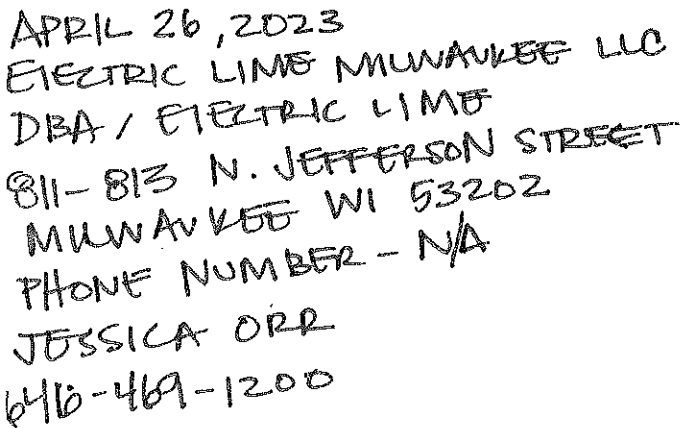

## OUTDOOR FURNITURE

TABLES - 5 COUNT  
(L) 30" ROUND  
(W) 30" ROUND  
(H) 29" HEIGHT

CHAIRS - 20 COUNT  
(H) 34" (SEAT HEIGHT 18")  
(W) 17" ROUND

PLANTERS - 6 COUNT  
4 - 12" ROUND  
2 - 10" ROUND

BUILDING DIMENSIONS - EAST + WEST = 120' LONG / NORTH + SOUTH 36' WIDE  
BUILDING SQUARE FEET - 5596 S.F. / NORTH + SOUTH 45' WIDE

SEASONAL PARKLET REQUEST  
 APRIL 26, 2023  
 METRIC LINE MILWAUKEE LLC  
 BA / METRIC LINE  
 311 - 813 N. JEFFERSON STREET  
 MILWAUKEE WI 53202  
 PHONE # NA  
 JESSICA ORR - 646.469.1200

ALLEY / MILWAUKEE ST.  
 NORTH + SOUTH LENGTH  
 45'

EAST + WEST  
 120' LONG

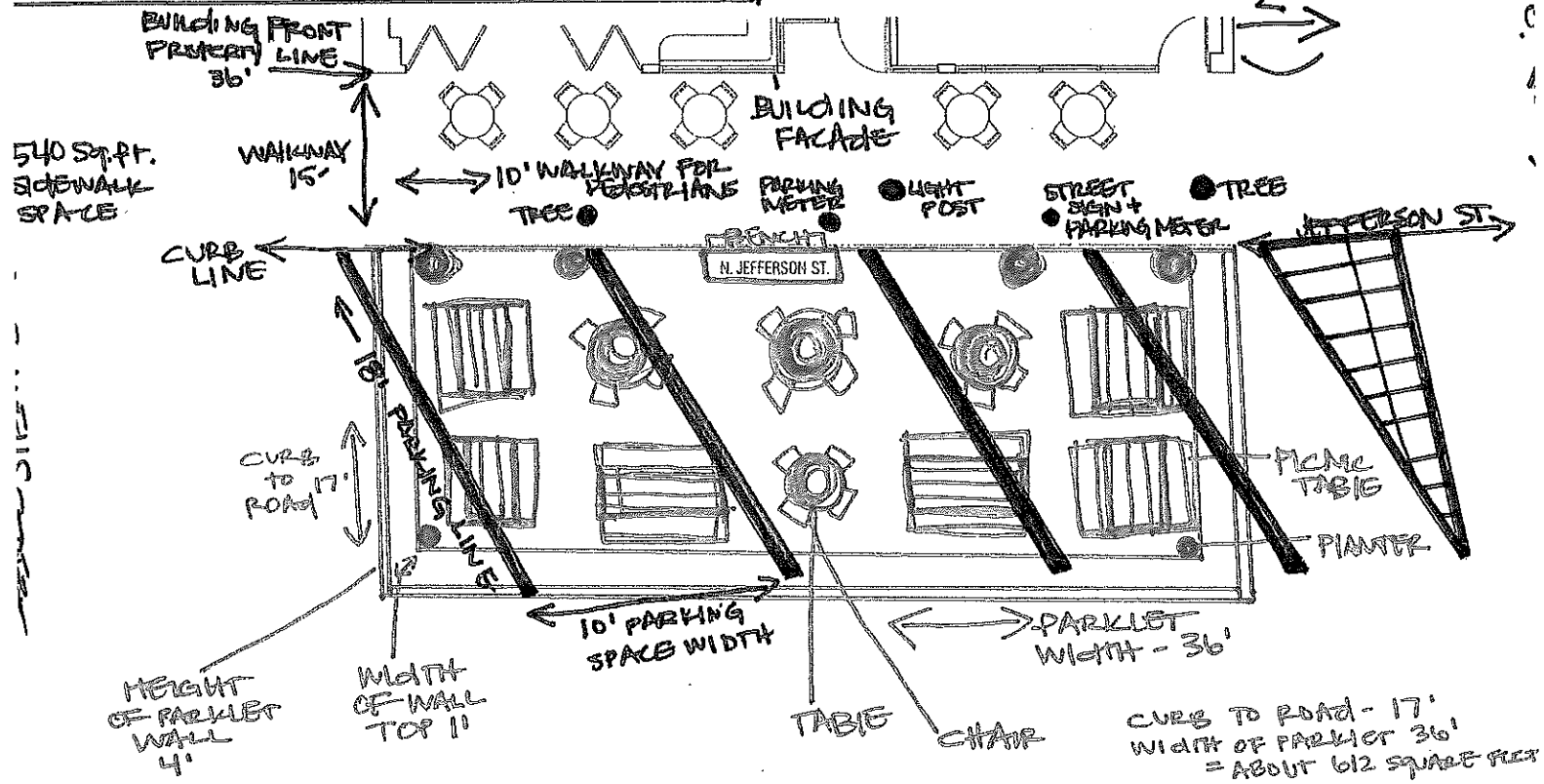



- 540 SQ. FT. OF SIDE WALK SPACE
- SIDEWALK SEATING - 5' X 36'
- PARKING METERS - 2
- SIGN POSTS - 1
- LIGHT POSTS - 1
- TREES - 2

- PARKLET DINING AREA:
- TABLE DIMENSIONS - (L) 30" ROUND (W) 30" ROUND (H) 29"
  - CHAIRS - (H) 34" / (W) 17"
  - BENCHES - (L) 96" / (H) 18" FOOTPRINT - 60"
  - PLANTERS - 12" ROUND
  - PICNIC TABLE DIMENSIONS - (L) 72" / (W) 29" / (H) 30"

copy of SD floor plan  
 with parklet overview

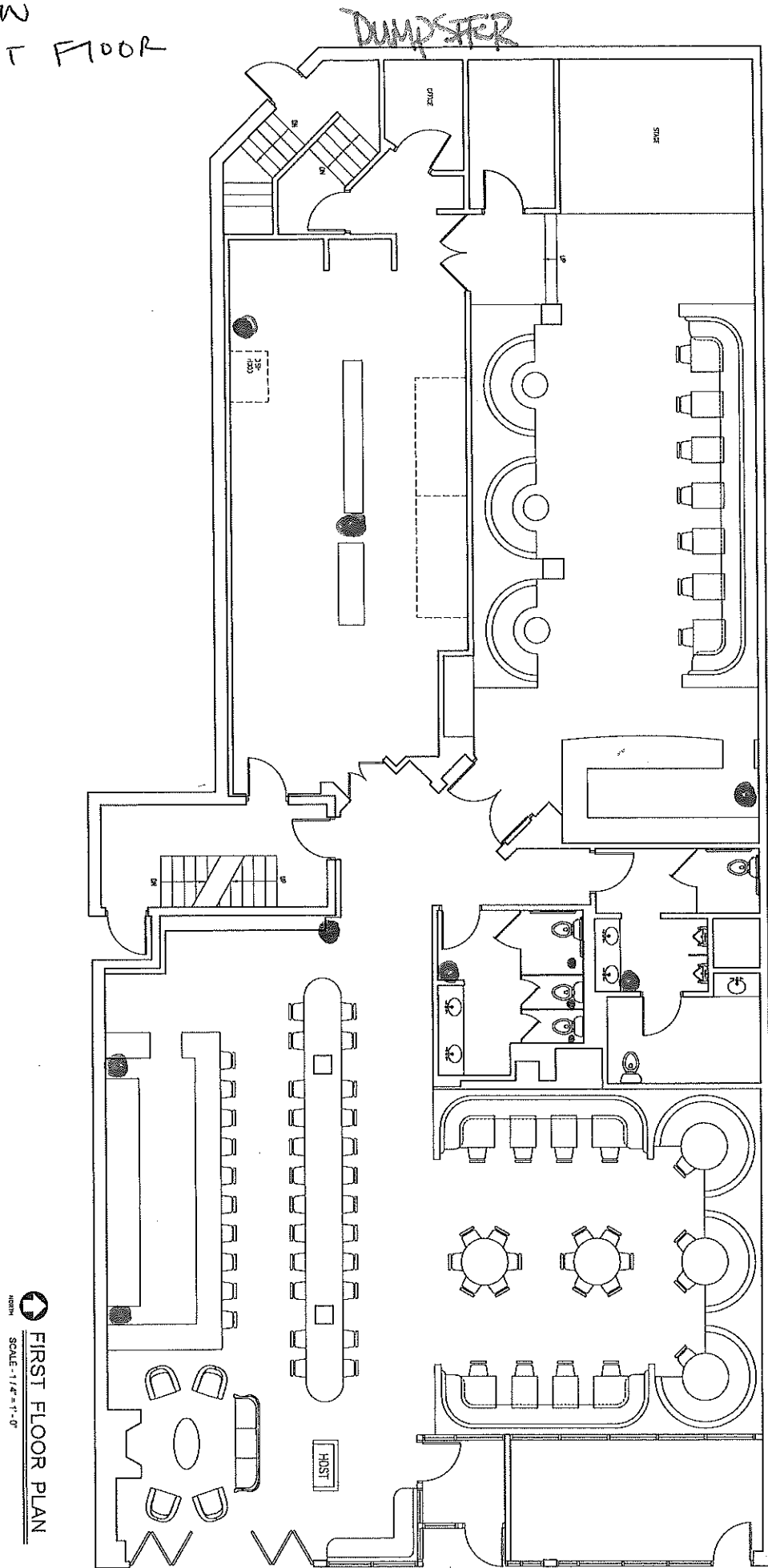
# OVERVIEW OF FIRST FLOOR





 FIRST FLOOR PLAN  
 SCALE - 1/4" = 1'-0"

GARBAGE LAYOUT

EXHIBIT A-1

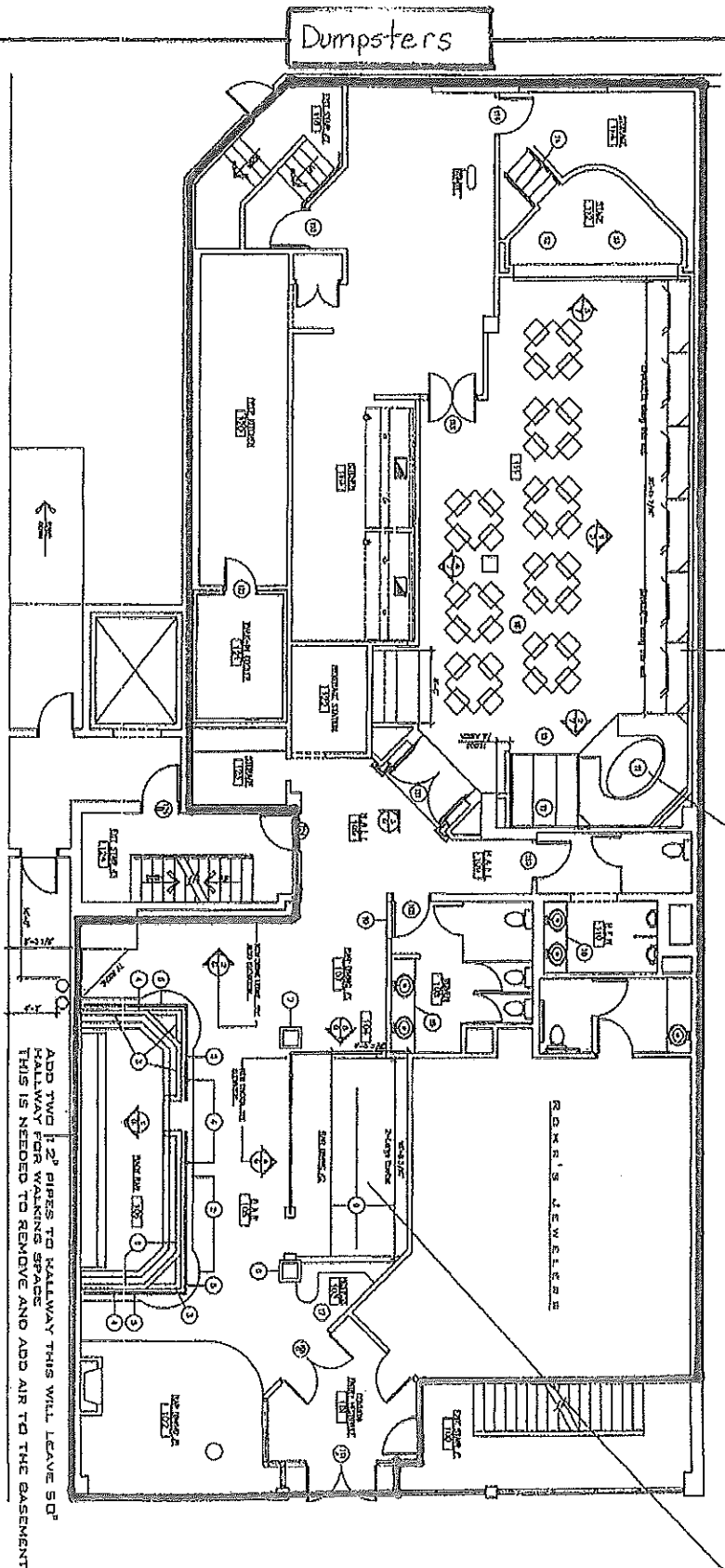
PREMISES



# ELECTRIC LIME

## SNACCIDENTS

**tres salsas + chips Vv^ 3**  
served with salsa verde, salsa roja, macha + tortilla chips  
(\*contains peanuts)

**electric beans Vv^ 7**  
refried beans, chihuahua cheese, house crema,  
cilantro + house chips  
add chicken 3 | asada 4 | shrimp 4 | pork 3 | trickin 3

**guacamole + chips Vv^ 11**  
house made guacamole + tortilla chips

**the beautiful pico the beautiful pico Vv^ 7**  
house made pico + tortilla chips

**queso + chips V 9**  
queso blanco + tortilla chips

**flour-power | "el duro jaliscense" Vv 7**  
flour "chicharron", cabbage, cucumbers, tomato,  
house crema, avocado, lime + chili powder

**walking taco Vv 7**  
doritos, chihuahua cheese, lettuce, refried beans, tomatoes,  
onions, house crema, cilantro + flour chicharron  
add chicken 3 | asada 4 | shrimp 4 | pork 3 | trickin 3

**street corn | "el elotero" V^ 7**  
steamed sweet corn, mayo, butter, queso cotija,  
house blend chili powder in a cup

**ceviche | aquachile ^ 15**  
shrimp, red onion, cucumber, avocado, chile serrano, orange,  
lime, cilantro + saladitas

**nachos | "totopos" Vv^ 11**  
beans, chihuahua cheese, lettuce, pico, guacamole,  
crema + pickled jalapeños  
add chicken 3 | asada 4 | shrimp 4 | pork 3 | trickin 3

**cholos in a blanket V^ 9**  
jalapeño, cream cheese, pepper jack cheese,  
garlic cilantro aioli + tortillas  
add chicken 3 | asada 4 | shrimp 4 | pork 3 | trickin 3

**quesadilla V 11**  
chihuahua, oaxaca, pepper jack cheese house blend + garlic  
cilantro aioli on a flour tortilla  
add chicken 3 | asada 4 | trickin 3 | pork 3 | trickin 3

## TORTAS

**mexico city street torta chilanga 11**  
beans, mayo, ham, carnitas, queso oaxaca, tomato, onion,  
guacamole, lettuce, crema + pickled jalapeños

**green torta Vv 7**  
telera, beans, queso fresco, avocado,  
pico de gallo + salsa verde

## SIDES

tortilla chips 3  
tortillas 3  
saladitas 2  
avocado 3

trickin 4  
rice 3  
guacamole 4

pico 4  
crema 2  
beans 3  
queso 4

## TACOS

**pollo a la parilla | grilled chicken ^ 5**  
gerber farms airchilled marinated chicken  
pico de gallo, queso fresco + salsa verde

**asada | steak ^ 5**  
100% grass-fed marinated grilled skirt steak  
cilantro, onions + salsa roja

**al pastor | marinated pork ^ 5**  
marinated pork skewered + roasted,  
onions, cilantro + pineapple

**carnitas | confit pork ^ 5**  
berkshire confit pork,  
cilantro, onions + salsa verde

**pescado | fish ^ 5**  
islandic cod lightly battered, mango jicama slaw,  
cilantro, pickled red onion, radish + garlic cilantro aioli

**cameron | gulf shrimp ^ 5**  
battered gulf shrimp, mango jicama slaw, cilantro,  
pickled red onion, radish + garlic cilantro aioli

**"papas" | potato & peppers Vv^ 4**  
red potatoes, sautéed onions, peppers, queso fresco +  
cilantro

**trickin | Vv^ 4**  
avocado lightly battered, cabbage, pico de gallo  
+ cilantro chipotle aioli

**bean + cheese | Vv^ 4**  
refried beans, queso fresco, house crema + cabbage  
choice of flour or corn tortillas  
"gringo" : lettuce, cheese, tomatoes, house crema

## ELECTRIC BOWLS + BURRITOS

**caesar salad bowl ^ 9**  
romaine, caesar dressing, garlic crouton + parmesan twille  
add asada 4 | chicken 3 | trickin 3 | pork 3 | shrimp 4

**taco salad bowl V^ 9**  
romaine, doritos, tomato, red onion, grilled corn + zesty vinaigrette  
add asada 4 | chicken 3 | trickin 3 | pork 3 | shrimp 4

**burrito bowl Vv^ 11**  
rice, beans, lettuce, pico de gallo, crema, guacamole, grilled corn,  
cilantro + queso chihuahua  
add asada 4 | chicken 3 | trickin 3 | pork 3 | shrimp 4

**burrito Vv^ 11**  
house blend cheese, beans, lettuce, pico + crema  
add asada 4 | chicken 3 | pork 3 | trickin 3 | shrimp 4

**surf + turf bowl ^ 17**  
100% grass-fed marinated grilled skirt steak + battered shrimp,  
rice, beans, lettuce, pico, crema, guacamole,  
grilled corn, cilantro + queso chihuahua

chef + operating owner Gabriel Garcia

V - vegetarian option v - vegan option ^ - gluten free option \*enjoying raw or undercooked meats, poultry, seafood or eggs may increase your risk of foodborne illness

# ELECTRIC LIME

## SOMETHING SWEET

don flan de ~~cajeta~~ V^ 7

house flan, pecans, ~~cajeta~~ + whipped cream

kitchen coffee 10

enjoy your meal tonight? buy a round of beers for the kitchen

## THIRST TRAP

### WINE

~~Lubanzi~~ Rosé 9

Archer ~~Roose~~ Bubbly 9

Bonterra Organic Young Red 9

~~Lubanzi~~ Chenin Blanc 11

### HARD SELTZERS

Untitled Art Blackberry Agave 8

Untitled Art Navel Orange 8

Untitled Art Pineapple Mango 8

Untitled Art Prickly Pear Guava 8

Untitled Art Blood Orange Pomegranate 8

Untitled Raspberry Lime 8

~~Topo Chico~~ Tangy Lemon Lime 6

~~Topo Chico~~ Exotic Pineapple 6

~~Topo Chico~~ Tropical Mango 6

~~Topo Chico~~ Strawberry Mango 6

### TAP BEER

~~Modelo~~ Especial Pilsner 7

~~Pacifico~~ Pilsner 7

Odell ~~Sippin~~ Pretty Fruited Sour 7

Half Acre Daisy Cutter Pale Ale 7

Estrella Jalisco Mexican Pilsner 7

Eagle Park Porter 7

### DOMESTIC BOTTLED BEER

Miller Lite 5

Miller High Life 5

Coors Light 5

Lakefront IPA 6

Lakefront ~~Riverwest~~ Stein 6

### IMPORTED BOTTLE BEER

Corona Extra 6

Dos Equis 6

Bohemia 6

Estrella 6 (can)

Victoria 6

~~Modelo~~ Especial 6

~~Modelo~~ Negra 6

~~Pacifico~~ Clara 6

### NON ALCOHOLIC

Fiji 5

Virgin Piña Colada 7

Mexican Coke 4

Mexico Sprite 4

Mexican Squirt 4

~~Topo Chico~~ 3

~~Jarritos~~ Lime 4

~~Jarritos~~ Mandarin 4

~~Jarritos~~ Tamarind 4

~~Jarritos~~ Pineapple 4

~~Mundet~~ Apple Soda 4

Ginger Ale 2

Coke 2

Diet Coke 2

Sprite 2

Cranberry 2

Orange Juice 3

Lemonade 2

**TODAY'S  
SOUP:  
TEQUILA**

ask your server

# THIRST TRAP

**PREMIUM FROZEN +**

**SMALL BATCH COCKTAILS**

single/pitcher

## **MARGARITA 10/33**

Cazadores Reposado, Fresh Squeezed  
Lime Juice, Triple Sec + Cane Sugar

## **HIBISCUS DAIQUIRI 10/33**

Bacardi, Fresh Squeezed Lime Juice,  
Cane Sugar + Hibiscus Tea

## **PINA COLADA 11/35**

Bacardi, Pineapple Juice,  
House Made Coconut Syrup,  
Fresh Squeezed Lime Juice + Chamomile Tea

## **RUMQUILA TWIST 10/33**

A Blend Of Our Frozen Margarita + Our  
Hibiscus Daiquiri

## **HENNY COLADA 13/61**

Hennessy, Pineapple Juice, House Made  
Coconut Syrup, Fresh Squeezed  
Lime Juice + Chamomile Tea

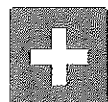

**ELECTRIC  
LIME**

### **MARGARITA 10/42**

Milagro Silver tequila, fresh lime,  
Triple Orange + agave syrup

### **PALOMA 10**

Teremana Blanco tequila, fresh lime,  
grapefruit oleo saccharum, Jamaica salt + Squir

### **HEY JACKASS 13**

Patron Silver Tequila, fresh lime,  
ginger syrup + seltzer

### **MATADOR 10**

Cazadores Reposado Tequila , Amaretto,  
fresh lime + pineapple juice

### **SUNRISE 10**

Casamigos Reposado Tequila, hibiscus grenadine,  
Fresh lime + fresh orange juice

### **VIDA MEZCAL 11**

Del Maguey Vida Mezcal, Chateau Aloe Liquor,  
salted cucumber syrup + fresh lime

### **DIABLA 13**

Banhez Mezcal Artesanal Fresno cordial,  
ginger syrup + lime

### **VERDITA SHOT 9**

Casamigos Blanco Tequila shot, fresh mint shot,  
cilantro, jalapeño + pineapple juice

### **ELECTRIC LIME 13**

tea-infused Patron, triple orange  
+ lavender syrup