

# TID 48 (Park East)

TID 48  
(Park East)  
Boundary

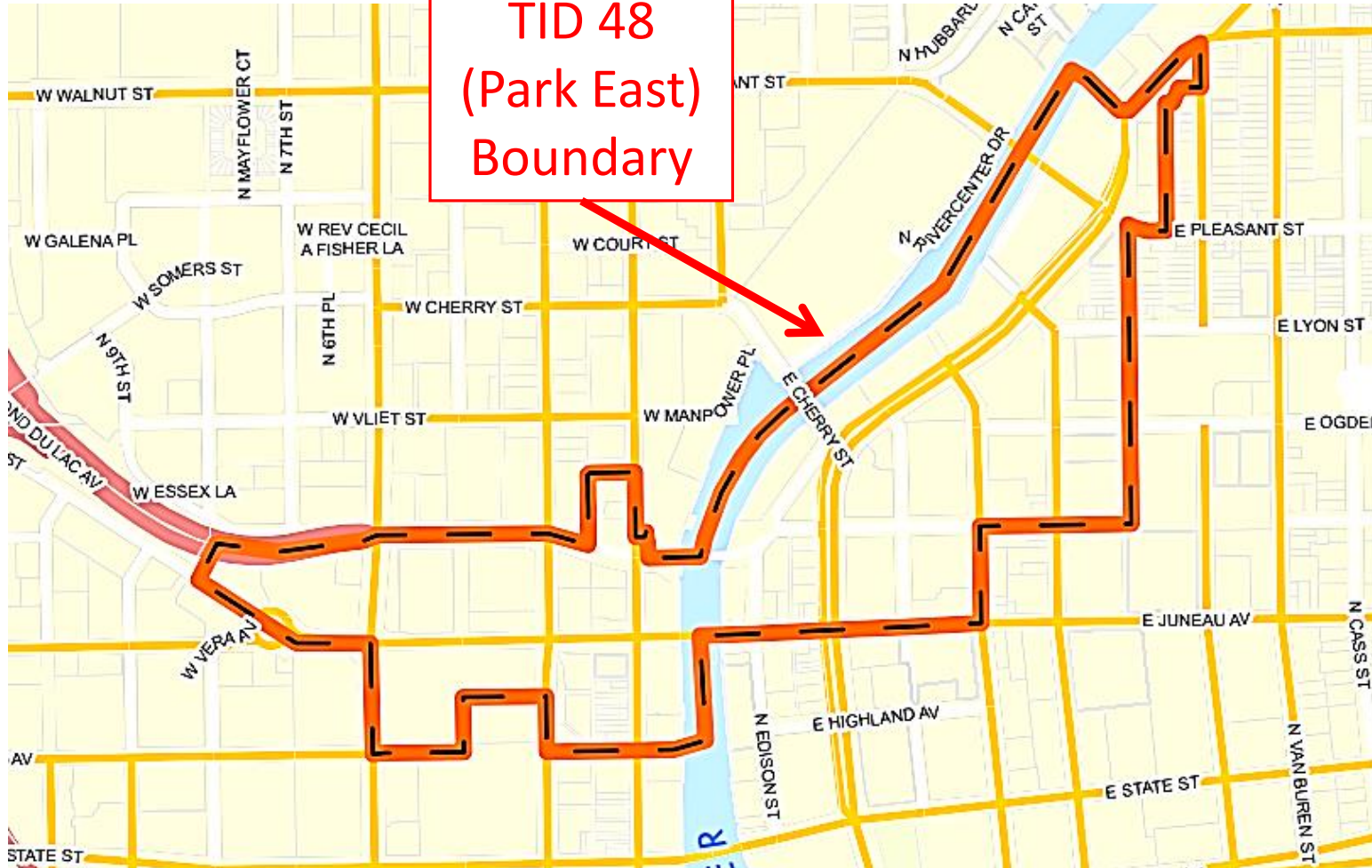

TID 48 (Park East)

Created: 2002

Base Value: \$45,325,600

2022 Value: \$363,102,800

Max Legal Life: 2029



# TID 48 (Park East)





# TID 48 (Park East)





This map shows the Milwaukee area, with the Milwaukee River flowing through it. A red line traces a path through the city, starting from the river, heading north, then west, and finally south. A scale bar indicates 1/2 mile.

## Administration (\$150k)

# Vel R. Phillips

- First African-American:
  - Secretary of State (WI)
  - Judge in WI
  - Milwaukee Common Council Alderperson
- First Woman:
  - Secretary of State (WI)
  - Judge in Milwaukee County
  - Milwaukee Common Council Alderperson
- First African-American Woman:
  - To graduate from the University of Wisconsin Law School
  - Elected to Democratic National Committee





# Vel R. Phillips Plaza

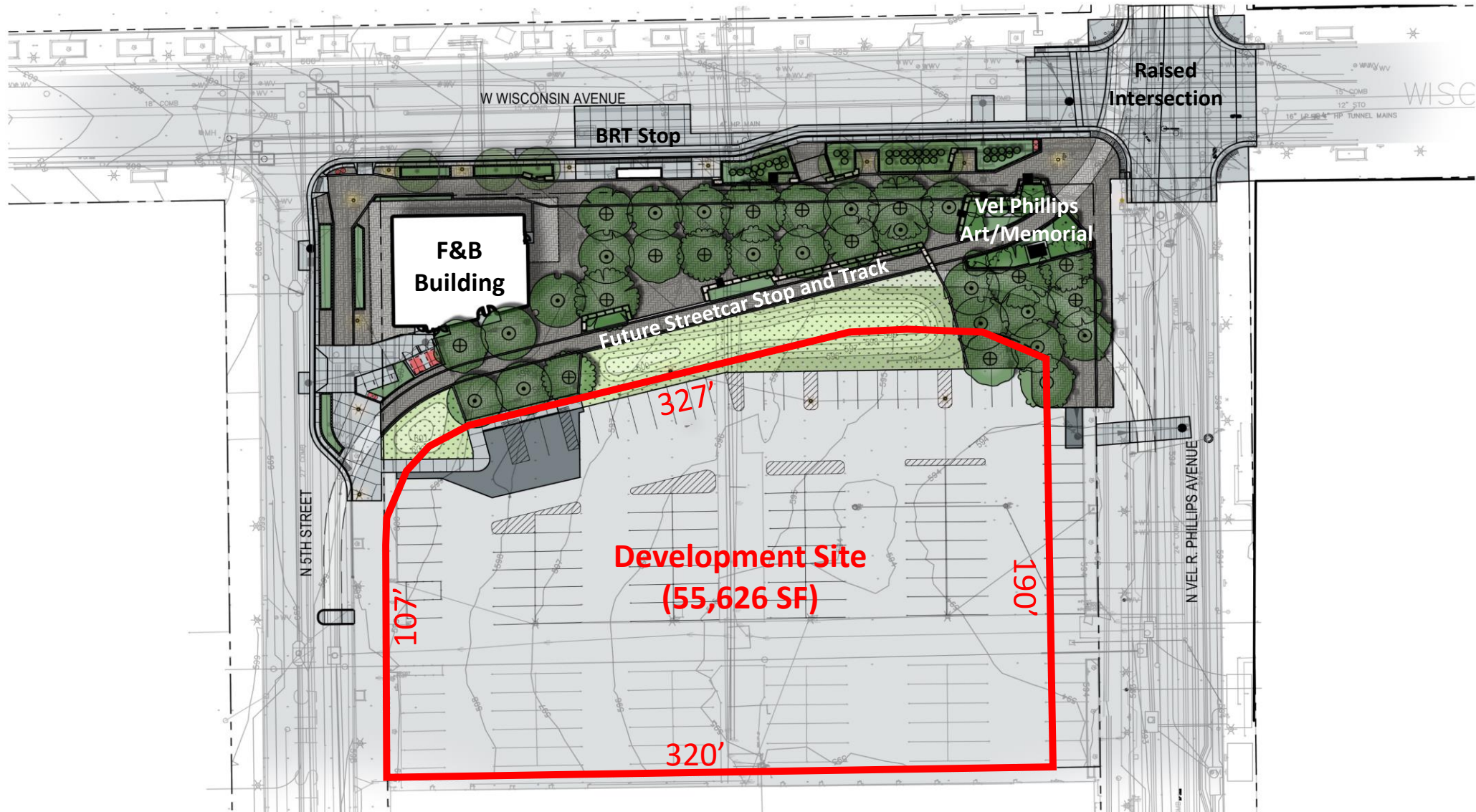

# Vel R. Phillips Plaza





# Vel R. Phillips Plaza

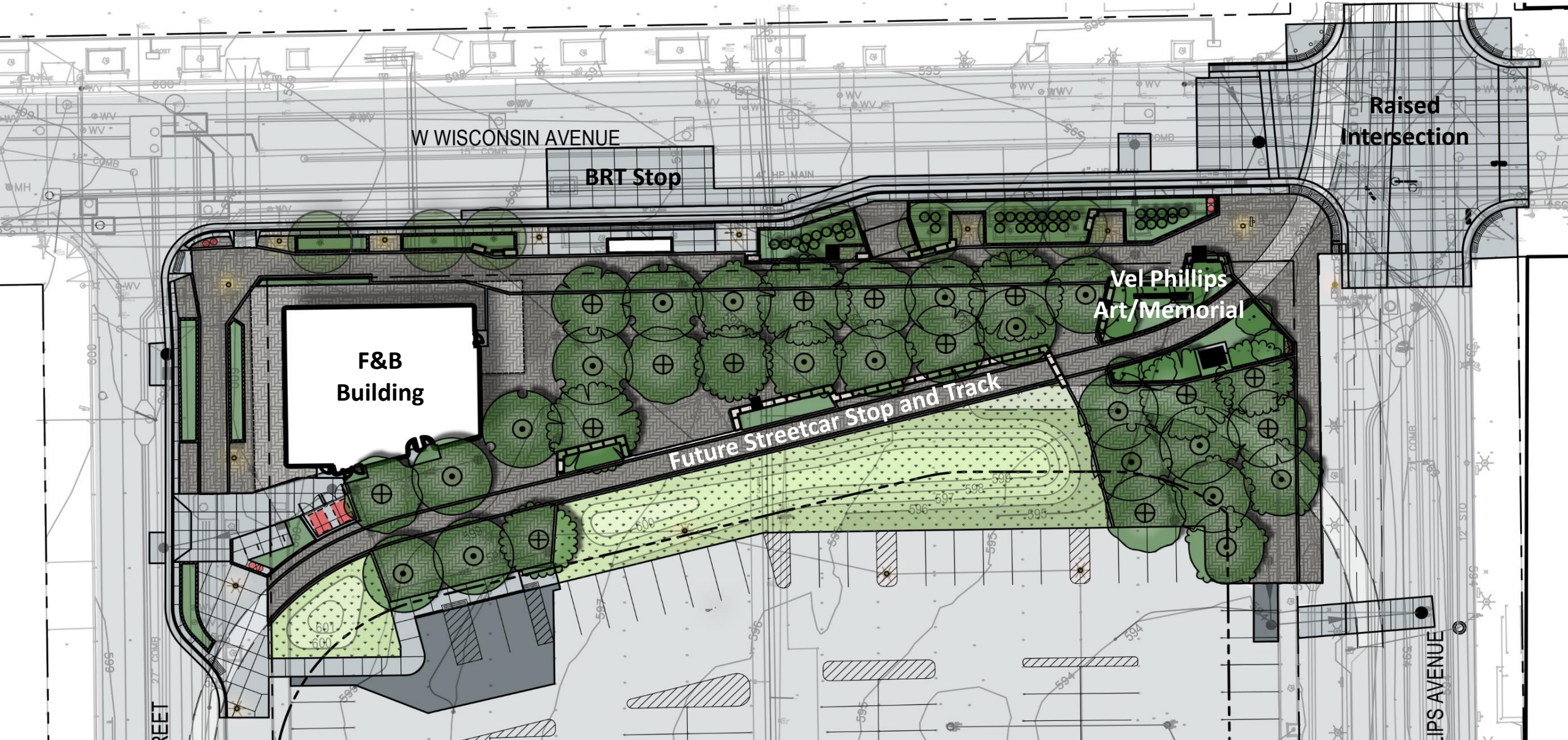



# Vel R. Phillips Plaza





# Vel R. Phillips Plaza





# Vel R. Phillips Plaza





# Vel R. Phillips Plaza





# Vel R. Phillips Plaza





# 401 West Wisconsin Development Site





# 401 West Wisconsin Development Site

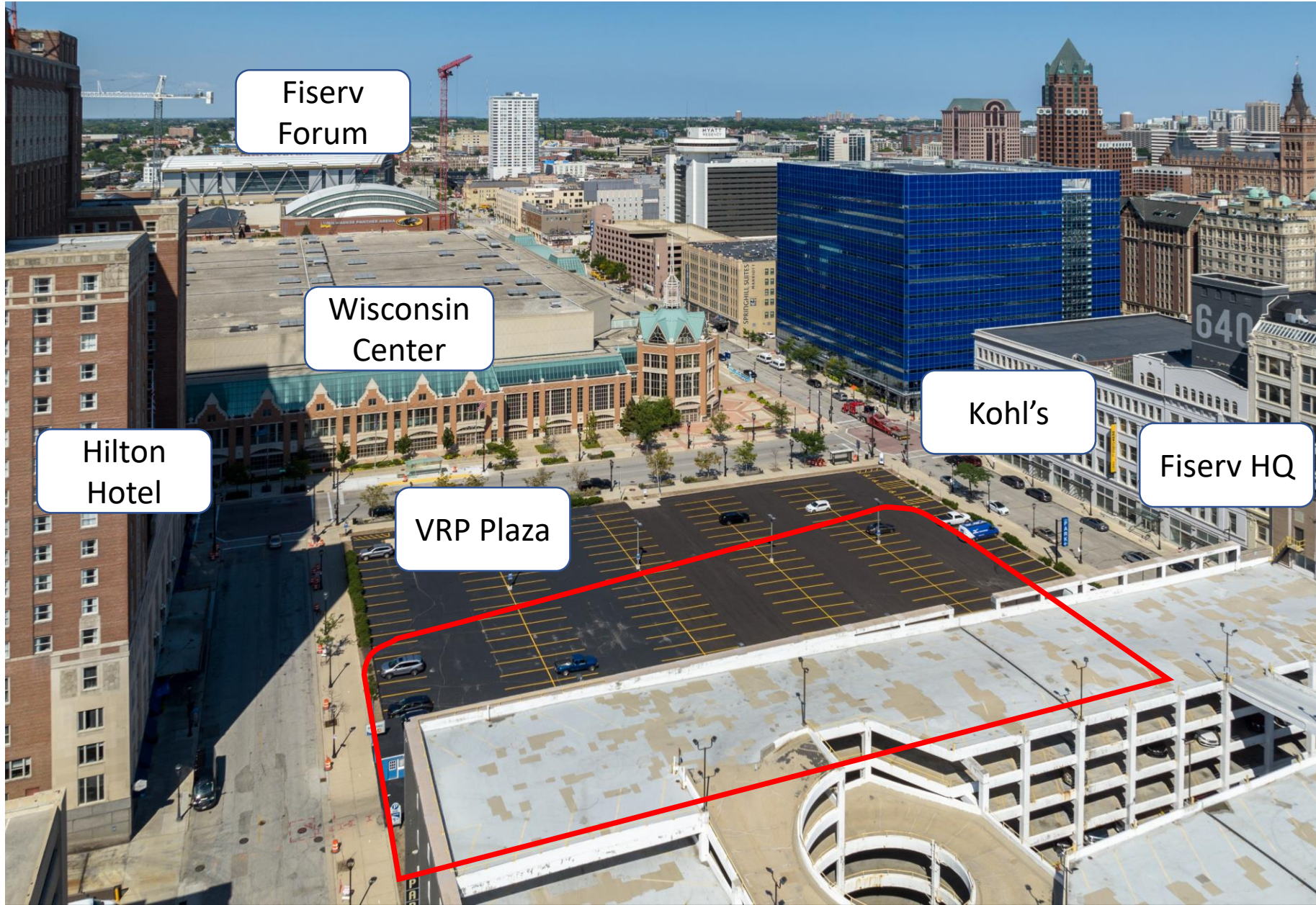



# TID 48 Amendment 5: Public Infrastructure

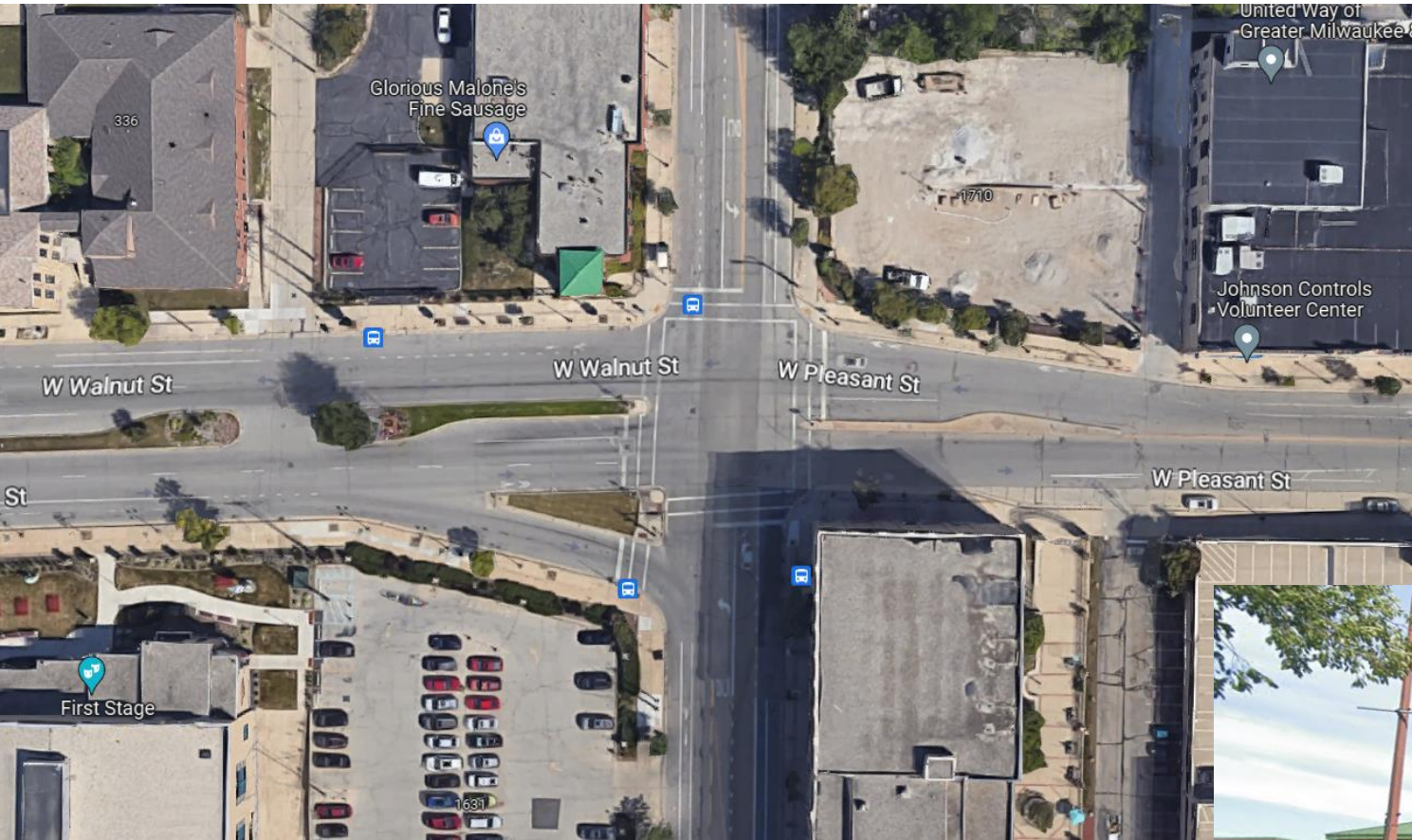



# TID 48 Amendment 5: Commercial Corridors





# TID 48 Amendment 5: Budget and Feasibility

Vel R. Phillips Plaza	\$15,750,000
Public Infrastructure	\$4,350,000
Commercial Corridor/Commercial Renovation Fund	\$500,000
Administration	\$150,000
<b>TID 48 Amend No. 5 Total</b>	<b>\$20,750,000</b>
Capital and Admin Costs to Date	\$43,791,166
<b>Total Project Costs</b>	<b>\$64,541,666</b>

Project Costs are able to pay off by 2024, Year 23 of the District