



**CITY OF MILWAUKEE  
OFFICE OF THE CITY CLERK**

Wednesday, December 21, 2022

**COMMITTEE MEETING NOTICE**

AD 04

SINGH, Ranjit, Agent  
Brick Wing LLC  
19315 Compton Ln  
Brookfield, WI 53045

You are requested to attend a hearing which is to be held in Room 301-B, Third Floor, City Hall or you may attend virtually using the link below.

**Wednesday, January 04, 2023 at 11:15 AM**

The access code is <https://meet.goto.com/294807589>. If you wish to call in: +1 (224) 501-3412 and use Access Code: 294-807-589.

Please see the enclosed best practices document for further instructions.

**Regarding:** Your Class B Tavern and Public Entertainment Premises License Applications Requesting Instrumental Musicians, Disc Jockey, Bands, Karaoke, Poetry Readings, Patron Contests, 100 Concerts, Comedy Acts, Dancing by Performers and Patrons Dancing as agent for "Brick Wing LLC" for "Brick Wing Event Hall" at 804 N MILWAUKEE St #Suite 100.

There is a possibility that your application may be denied for one or more of the following reasons: The recommendation of the committee regarding the application shall be based on evidence presented at the hearing. Per MCO 85-2.7-4, probative evidence concerning whether or not a new license should be granted may be presented on the following subjects: whether or not the applicant meets the municipal requirements, the appropriateness of the location and premises where the licensed premises is to be located and whether use of the premises for the purposes or activities permitted by the license would tend to facilitate a public or private nuisance or create undesirable neighborhood problems such as disorderly patrons, unreasonably loud noise, litter, and excessive traffic and parking congestion. Probative evidence relating to these matters may be taken from the plan of operation submitted with the license application, if any, but shall not include the content of any music. Evidence regarding the fitness of the location of the premises to be maintained as the principal place of business, including but not limited to whether there is an overconcentration of businesses of the type for which the license is sought; whether the proposal is consistent with any pertinent neighborhood business or development plans, or the location's proximity to areas where children are typically present. The applicant's record in operating similarly licensed premises; and whether or not the applicant has been charged with or convicted of any felony, misdemeanor, municipal offense or other offense, the circumstances of which substantially relate to the activity to be permitted by the license being applied for or any other factor which reasonably relates to the public health, safety or welfare may also be considered. See attached police report or correspondence.

**Notice for applicants with  
warrants or unpaid fines:**

**Proof of warrant satisfaction or payment of fines must be submitted at the hearing on the above date and time. Failure to comply with this requirement may result in a delay of the granting/denial of your application.**

Failure to appear at this meeting may result in the denial of your license. Individual applicants must appear only in person or by an attorney. Corporate or Limited Liability applicants must appear only by the agent designated on the application or by an attorney. Partnership applicants must appear by a partner listed on the application or by an attorney. If you wish to do so and at your own expense, you may be accompanied by an attorney of your choosing to represent you at this hearing.

You will be given an opportunity to speak on behalf of the application and to respond and challenge any charges or reasons given for the denial. No petitions can be accepted by the committee, unless the people who signed the petition are present at the committee hearing and willing to testify. You may present witnesses under oath and you may also confront and cross-examine opposing witnesses under oath. If you have difficulty with the English language, you should bring an interpreter with you, at your expense, so that you can answer questions and participate in your hearing.

You may examine the application file at this office during regular business hours prior to the hearing date. Inquiries regarding this matter may be directed to the person whose signature appears below. Limited parking for persons attending meetings in City Hall is available at reduced rates (5 hour limit) at the Milwaukee Center on the southwest corner of East Kilbourn and North Water Street. Parking tickets must be validated in the first floor information booth in City Hall.

PLEASE NOTE: Upon reasonable notice, efforts will be made to accommodate the needs of disabled individuals through sign language interpreters or other auxiliary aids. For additional information or to request this service, contact the Council Services Division ADA Coordinator at (414) 286-2998, Fax - (414) 286-3456, TDD - (414) 286-2025.

JIM OWCZARSKI, CITY CLERK

BY: \_\_\_\_\_

Jim Cooney  
License Division Manager

**If you have questions regarding this notice, please contact the License Division at (414) 286-2238.**

200 E. Wells Street, Room 105, City Hall, Milwaukee, WI 53202. [www.milwaukee.gov/license](http://www.milwaukee.gov/license)  
Phone: (414) 286-2238 Fax: (414) 286-3057 Email Address: [License@milwaukee.gov](mailto:License@milwaukee.gov)

Date: 10/25/2022  
Officer: PLUMLEY

City of Milwaukee Police Department  
90-5-1.5 Crime Prevention Survey  
Tavern Inspection

Name of Premise: Brick Wing  
Address: 800 N Milwaukee St #100  
Phone:

Owner: Ranjit SINGH  
Owner address: 19395 Compton Lane  
City State Zip: Brookfield WI 53045  
Owner Phone: 414-217-1611  
Owner email: [rana.2188@gmail.com](mailto:rana.2188@gmail.com)

Licensee/Agent: Ranjit SINGH  
Home Address: 19395 Compton Lane  
City State Zip: Brookfield WI 53045  
Phone: 414-217-1611  
Email:

Preferred contact: Phone

Location currently open: ☐ YES ☒ NO

Projected open date: 3/1/2023

Day's open: ☐S ☐M ☐T ☐W ☐Th ☐F ☐SA ☒ALL

Hours of Operation: Sun: 9A-2A ☐24 hours ☐Y ☒N  
Mon: 9A-2A  
Tue: 9A-2A  
Wed: 9A-2A  
Thu: 9A-2A  
Fri: 9A-230A  
Sat: 9A-230A

Premise Type: ☐ Tavern/Bar  
☐ Restaurant  
☒ Other: Event Hall

Licenses currently held:

Alcohol: ☐ Yes ☒ No Class: #:  
 Tobacco: ☐ Yes ☒ No #:  
 Food: ☐ Yes ☒ No #:  
 Extended Hours: ☐ Yes ☒ No #:  
 Secondhand Dealer: ☐ Yes ☒ No Type: #:  
 Other: ☐ Yes ☐ No Type: #:  
 Other: ☐ Yes ☐ No Type: #:

### Exterior Survey:

1. Is the area around the location clean? ☒ Yes ☐ No
2. What surrounds the location? (Check all the apply)
  - a. ☐ Park
  - b. ☐ School
  - c. ☐ Youth Center
  - d. ☐ Church
  - e. ☐ Tavern(s) If so, how many
  - f. ☐ Residential
  - g. ☒ Other businesses
  - h. ☐ Other:
3. Can you see from the outside of the location into the interior ☒ Yes ☐ No
4. Can you see the employees inside of the location from the outside ☒ Yes ☐ No
5. Are exterior windows free of signage ☒ Yes ☐ No
6. Is there a parking lot ☐ Yes ☒ No
7. Is the parking lot clean? ☐ Yes ☐ No
8. Off-Street parking ☐ Yes ☒ No
9. Is the parking lot well lit? ☐ Yes ☐ No
10. Valet Parking ☒ Yes ☐ No
  - a. Will this lot have a guard? ☐ Yes ☒ No
  - b. Will this lot have cameras? ☐ Yes ☒ No
11. Are there areas where a person could conceal themselves ☐ Yes ☒ No
12. Is there exterior lighting? ☒ Yes ☐ No. Does it appears to be adequate ☒ Yes ☐ No
13. Exterior Payphone? ☐ Yes ☒ No
14. Are there No Loitering Signs posted? ☒ Yes ☐ No
15. Are there exterior security cameras ☐ Yes ☒ No How Many:
16. Are the address numbers prominently displayed and easy to see ☒ Yes ☐ No

### Camera Survey:

17. Does this location have security cameras? ☐ Yes ☒ No
18. Are they in working order? ☐ Yes ☐ No
19. What format are the cameras?
  - a. Color ☐ Yes ☐ No
  - b. Digital ☐ Yes ☐ No
  - c. Recorded ☐ Yes ☐ No
20. How long is footage stored for later viewing:
21. Are there exterior cameras ☐ Yes ☐ No How many:
22. Are there interior cameras ☐ Yes ☐ No How many:
23. Do all employees know how to retrieve recorded digital images/footage? ☐ Yes ☐ No

24. Cameras located in parking lot ☐ Yes ☐ No How many

**Interior Survey:**

25. What is the planned capacity 260
26. What is the minimum number of employees That will be on premise 2
27. Is the storeowner willing to be a standing complainant regarding loitering? ☐ Yes ☒ No
- a. If yes have them fill out the standing complaint form and give them two of the commercial signs ☐ Yes ☐ No
28. Is the interior of the location neat and clean? ☒ Yes ☐ No
29. Does an interior camera face the entrance/exit? ☐ Yes ☐ No
30. Is there a lockable area that separates employees from customers? ☒ Yes ☐ No
31. Are emergency and non-emergency numbers posted near the phone? ☒ Yes ☐ No
32. Does the owner know how to contact their police district directly? ☒ Yes ☐ No
- a. Did you provide a district contact guide to the owner? ☒ Yes ☐ No

**Security**

33. How many security personnel are going to be employed: 0
34. How ill they be deployed: Interior Exterior
35. What days will they be deployed ☐ Mon ☐ Tue ☐ Wed ☐ Thu ☐ Fri ☐ Sat ☐ Sun
36. Will the security be managed by business ☐ or contracted ☐
37. Will they be armed ☐ Yes ☐ No
38. What type of security measures to be used:
- ☐ Wanding/metal detector
  - ☐ ID Scanner
  - ☐ Dress Code
  - ☐ Cover Charge
  - ☐ Age restriction
  - ☐ Other

**ADDITIONAL COMMENTS/RECOMMENDATIONS:**

This location will be used as an event space. The owner is currently working with a company to put surveillance cameras in the business. The owner is considering hiring private security special events.



# Concentration Map for 804 N Milwaukee St Suite #100

## Area of Interest (AOI) Information

Area : 21,862,585.55 ft<sup>2</sup>

Sep 15 2022 15:01:59 Central Daylight Time

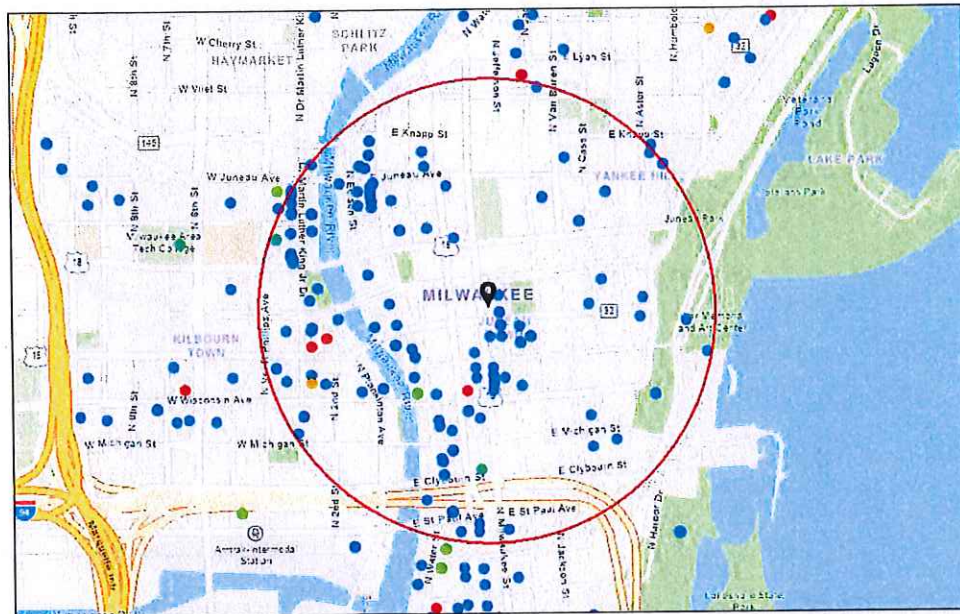

- Alcohol Licenses (active)
- Class A Fermented Malt Beverage
  - Class A Liquor and Malt
  - Class B Fermented Malt Beverage
  - Class B Tavern
  - Class C Wine Retailer

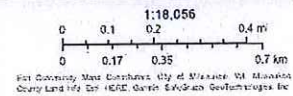



## Summary

Name	Count	Area(ft²)	Length(mi)
Alcohol Licenses	144		

## Alcohol Licenses

#	Legal Entity	Trade Name	Licensee	Address	License Type Name	Total Capacity	Expiration Date	Count
1	Uncle Bucks Red Star on 3rd, Inc	Uncle Bucks on 3rd	MICHAEL J VITUCCI, Agt	1125 N Dr Martin L King Jr DR	Class B Tavern License		2/6/2022, 6:00 PM	1
2	Tourist Convenience LLC	Racks Full of Snacks	AHMED K YAFAI, Agt	240 W Wells ST	Class A Malt & Class A Liquor License		11/28/2021, 6:00 PM	1
3	Mader's German Restaurant, Inc	Mader's German Restaurant	DANIEL J HAZARD, Agt	1037 N Dr Martin L King Jr DR	Class B Tavern License	370	11/21/2021, 6:00 PM	1
4	Button Block Holdings LLC	Homewood Suites Hotel	Tammy L.C. Fraley, Agt	500 N Water ST	Class B Tavern License		11/18/2021, 6:00 PM	1
5	The Brownstone LLC	The Brownstone	COREY L SMITH, Agt	524 N Water ST	Class B Tavern License		11/27/2021, 6:00 PM	1
6	JCTH, INC	CAFE AT THE PLAZA	BENJAMIN T CRICHTON, Agt	1007 N CASS ST	Class B Tavern License		11/23/2021, 6:00 PM	1
7	BOOBY JDK, LLC	McGillycuddy's Bar & Grill	ANDREW C DEUSTER, Agt	1133-37 N Water ST	Class B Tavern License	300	11/28/2021, 6:00 PM	1
8	MKE Water Street LLC	ELMNT Lounge	HABIB MANJEE, Agt	618 N WATER ST	Class B Tavern License		12/17/2021, 6:00 PM	1
9	Double Dragon MKE LLC	White Tail	NATHAN T TUSLER, Agt	1110 N Dr Martin L King Jr DR	Class B Tavern License	80	12/12/2021, 6:00 PM	1
10	OUZO CAFE	OUZO CAFE	NICKEY G PAPPAS, Agt	776 N MILWAUKEE ST	Class B Tavern License	40	11/22/2021, 6:00 PM	1
11	THE KING AND I RESTAURANT, INC	THE KING AND I RESTAURANT	DEREK E PHOUNGPHO L, Agt	830 N Dr Martin L King Jr DR	Class B Tavern License	240	12/20/2021, 6:00 PM	1
12	Tua Pasta LLC	Tua Pasta	Alvaro Nino de Guzman Ramirez, Agt	100 E WISCONSIN AV LL101	Class B Fermented Malt Beverage Retailer's License		12/28/2021, 6:00 PM	1
13	3CP LLC	Third Coast Provisions	Andrew H Miller, Agt	724 N Milwaukee ST	Class B Tavern License		1/19/2022, 6:00 PM	1
14	Carnivoras Inc	Carnevor	Joseph McLean, Agt	718 N Milwaukee ST	Class B Tavern License	99	1/25/2022, 6:00 PM	1
15	DEER CAMP, LLC	Deer Camp	Paul C Hackbarth, Agt	1023-1027 N Dr Martin L King Jr DR	Class B Tavern License		12/21/2021, 6:00 PM	1
16	Rogues Gallery, LLC	Rogues Gallery	Nathan S Showers, Agt	134 E Juneau AV	Class B Tavern License	290	1/19/2022, 6:00 PM	1
17	ALEM ETHIOPIAN RESTAURANT, LLC	ALEM ETHIOPIAN VILLAGE	MULU H HABTESILAS SIE, Agt	307 E WISCONSIN AV	Class B Tavern License	98	12/24/2021, 6:00 PM	1
18	Tua Pasta LLC	Tua Pasta	Alvaro Nino de Guzman Ramirez, Agt	100 E WISCONSIN AV LL101	Class C Wine Retailer's License		12/28/2021, 6:00 PM	1

19	Oak Barrel Public House LLC	Oak Barrel	ROBERT L WILTGEN, Agt	1033 N Dr Martin L King Jr DR	Class B Tavern License		1/29/2022, 6:00 PM	1
20	APARTMENT 720, LLC	APARTMENT 720	Tony T Skoufis, Agt	720 N MILWAUKEE ST	Class B Tavern License	299	1/24/2022, 6:00 PM	1
21	Smoke Shack Mke, LLC	Smoke Shack	David J Marcus, Agt	332 N Milwaukee ST	Class B Tavern License	91	2/6/2022, 6:00 PM	1
22	AJ Bombers MKE, LLC	AJ Bombers	David J Marcus, Agt	1245 N WATER ST	Class B Tavern License	160	2/6/2022, 6:00 PM	1
23	Fazzari & Company, LLC	San Giorgio Pizzeria Napoletana	GIORGIO G FAZZARI, Agt	838 N Dr Martin L King Jr DR	Class B Tavern License		1/1/2022, 6:00 PM	1
24	The Belmont Tavern, Inc	The Belmont Tavern	MICHAEL J VITUCCI, Agt	784 N Jefferson ST	Class B Tavern License	160	2/6/2022, 6:00 PM	1
25	MCR Milwaukee Tenant LLC	Courtyard by Marriott Milwaukee Downtown	Kerri Huelsbeck, Agt	300 W Michigan ST	Class B Tavern License		2/4/2022, 6:00 PM	1
26	WOMANS CLUB OF WISCONSIN	WOMANS CLUB OF WISCONSIN	Jennifer A Beck, Agt	813 E KILBOURN AV	Class B Tavern License	500	2/9/2022, 6:00 PM	1
27	GRANDVIEW MANAGEMENT, INC	ZILLI HOSPITALITY GROUP	ROBERT J ZILLI, Agt	910 E MICHIGAN ST	Class B Tavern License	450	2/6/2022, 6:00 PM	1
28	Milwaukee Athletic Club	Milwaukee Athletic Club	Maikel Correa, Agt	731 N WATER ST 190	Class B Tavern License		1/17/2022, 6:00 PM	1
29	CHINA GOURMET, INC	CHINA GOURMET RESTAURANT	ROBERT C TSAO, Agt	117 E WELLS ST	Class B Tavern License	165	1/17/2022, 6:00 PM	1
30	Milwaukee Art Museum, Inc	Milwaukee Art Museum	Michelle M McCue, Agt	700 N Art Museum DR	Class B Tavern License	2,133	1/17/2022, 6:00 PM	1
31	Levy @ Milwaukee Symphony	Levy @ Milwaukee Symphony	Amanda S Ridout, Agt	212 W WISCONSIN AV	Class B Tavern License		2/2/2022, 6:00 PM	1
32	LOWCOUNTRY MILWAUKEE INC	Lowcountry	Tyler E Mei, Agt	1114 N WATER ST	Class B Tavern License		2/7/2022, 6:00 PM	1
33	THE WICKED HOP, LLC	THE WICKED HOP	MILES E O'NEIL, Agt	343-45 N BROADWAY	Class B Tavern License	160	2/28/2022, 6:00 PM	1
34	Who's Milwaukee LLC	Who's on Third, Milwaukee's Pub	ROBERT L WILTGEN, Agt	1003&1007 N Dr Martin L King Jr DR	Class B Tavern License		3/2/2022, 6:00 PM	1
35	MILWAUKEE WATERFRONT DELI, INC	MILWAUKEE WATERFRONT DELI	JEREMIAH D PANDL, Agt	761 N WATER ST	Class B Tavern License		2/26/2022, 6:00 PM	1
36	Foot Paw LLC	Amilinda	Gregory R Leon, Agt	315 E Wisconsin AV	Class B Tavern License		3/2/2022, 6:00 PM	1
37	Pourman's LLC	Pourman's	BENJAMIN A HEBL, Agt	1127 N Water ST	Class B Tavern License	80	2/7/2022, 6:00 PM	1



38	STEE V GEE LLC	Sportclub Nomad	MICHAEL J EITEL, Agt	750 N Jefferson ST	Class B Tavern License		2/14/2022, 6:00 PM	1
39	Lucille's Dueling Piano Bar, LLC	Third Street Tavern	Jack Roman, Agt	1110 N Dr Martin L King Jr DR	Class B Tavern License	320	2/17/2022, 6:00 PM	1
40	Mojo MKE LLC	Mojo MKE	Todd M Wargula, Agt	134 E JUNEAU AV.	Class B Tavern License	239	2/21/2022, 6:00 PM	1
41	International Exports LLC	The Safe House	Michael L Swasey, Agt	779 N Front ST	Class B Tavern License	248	3/8/2022, 6:00 PM	1
42	Blazin Wings, Inc	Buffalo Wild Wings #407	Nicole M Kejo, Agt	1123 N WATER ST	Class B Tavern License	253	3/24/2022, 7:00 PM	1
43	M DE PALMA, LLC	MONICA'S ON ASTOR	MONICA J DE PALMA, Agt	1228 N ASTOR ST	Class B Tavern License	159	4/9/2022, 7:00 PM	1
44	BRUNCH MKE LLC	BRUNCH	Morgan K Schnabl, Agt	714 N MILWAUKEE ST	Class B Tavern License	160	4/15/2022, 7:00 PM	1
45	PABST THEATER CONCESSIONS, LLC	TURNER HALL BALLROOM	RICHARD J RYAN, Agt	1040 N VEL R PHILLIPS AV	Class B Tavern License	987	3/24/2022, 7:00 PM	1
46	Steakhouse Milwaukee LLC	Rare Steakhouse	Mark D Burish, Agt	833 E MICHIGAN ST	Class B Tavern License		4/16/2022, 7:00 PM	1
47	CHIPOTLE MEXICAN GRILL OF CO, LLC	CHIPOTLE MEXICAN GRILL #313	Brian J Bushaw, Agt	600 E OGDEN AV	Class B Tavern License	99	3/21/2022, 7:00 PM	1
48	Commerce Building Restaurant LLC	Doc's Commerce Smokehouse	Brian Atkinson, Agt	754 N VEL R PHILLIPS AV	Class B Tavern License		3/26/2022, 7:00 PM	1
49	Higbee's MKE LLC	District IV	PATSY SMITH-JAMES, Agt	628 N Water ST	Class B Tavern License	225	4/13/2022, 7:00 PM	1
50	NOBLE BEVERAGE MANAGEMENT, LLC	HYATT REGENCY MILWAUKEE	Colin C Walsh, Agt	333 W KILBOURN AV	Class B Tavern License	930	5/13/2022, 7:00 PM	1
51	Jay Squared LLC	The Box	Jamie A Berger, Agt	311 E Wisconsin AV	Class B Tavern License	270	4/11/2022, 7:00 PM	1
52	Kipper LLC	Fore Milwaukee	Timothy M Grogan, Agt	530 N Water ST	Class B Tavern License		4/11/2022, 7:00 PM	1
53	Olive Tree LLC	Convenience +	Jamal T Shawar, Agt	308 E Wisconsin AV	Class A Malt & Class A Liquor License		5/19/2022, 7:00 PM	1
54	MILWAUKEE SCHOOL OF ENGINEERING	MILWAUKEE SCHOOL OF ENGINEERING	Jeffrey LaTaille, Agt	1245 N BROADWAY	Class B Tavern License	2,759	5/18/2022, 7:00 PM	1
55	Milwaukee School of Engineering	Milwaukee School of Engineering	Jeffrey LaTaille, Agt	1000 N BROADWAY	Class B Tavern License	480	5/18/2022, 7:00 PM	1

56	MILWAUKEE SCHOOL OF ENGINEERING	MILWAUKEE SCHOOL OF ENGINEERING	Jeffrey LaTaille, Agt	1120 N BROADWAY	Class B Tavern License	208	5/18/2022, 7:00 PM	1
57	Milwaukee School of Engineering	Milwaukee School of Engineering	Jeffrey LaTaille, Agt	1025 N BROADWAY	Class B Tavern License		5/18/2022, 7:00 PM	1
58	Grandview Management Inc	Zilli Hospitality Group	ROBERT J ZILLI, Agt	910 N Dr Martin L King Jr DR	Class B Tavern License		5/25/2022, 7:00 PM	1
59	PPH Properties I LLC	Silk Exotic Gentlemen's Club	SCOTT A KRAHN, Agt	730 N Dr Martin L King Jr DR	Class B Tavern License	297	5/25/2022, 7:00 PM	1
60	ZARLETTI, LLC	ZARLETTI	BRIAN C ZARLETTI, Agt	741 N MILWAUKEE ST 1	Class B Tavern License		5/23/2022, 7:00 PM	1
61	Cheese Mart, Inc	Wisconsin Cheese Mart	KENNETH J MC NULTY, Agt	215 W Highland AV	Class B Tavern License	133	5/22/2022, 7:00 PM	1
62	V & V PARTNERS, LLC	BENIHANA	SABAH M LIDDAWYEH, Agt	850 N PLANKINTON AV	Class B Tavern License	180	5/17/2022, 7:00 PM	1
63	GRANDVIEW MANAGEMENT, INC	ZILLI LAKE & GARDENS	ROBERT J ZILLI, Agt	931 E WISCONSIN AV	Class B Tavern License	450	5/18/2022, 7:00 PM	1
64	WESTOWN ASSOCIATION OF MILW, INC	WESTOWN ASSOCIATION	STACIE J CALLIES, Agt	950 N Dr Martin L King Jr DR	Class B Tavern License		5/22/2022, 7:00 PM	1
65	The Loft Mini Mart LLC	The Loft Mini Mart	Larry J Courtney, Agt	823 N 2ND ST 007	Class A Malt & Class A Liquor License		5/19/2022, 7:00 PM	1
66	JSWD Wisconsin Venture I LLC	The Westin Milwaukee	Keith A Filipak, Agt	550 N Van Buren ST	Class B Tavern License		5/22/2022, 7:00 PM	1
67	12AM Management Group, LLC	Room Seven	Andre B Lewis, Agt	780 N Jefferson ST	Class B Tavern License	240	5/25/2022, 7:00 PM	1
68	Foltz Family Market, Inc	Foltz Family Market	Casey C Foltz, Agt	400 N WATER ST 6	Class B Tavern License		5/29/2022, 7:00 PM	1
69	HTWA MARKET PROJECT, LLC	MILWAUKEE PUBLIC MARKET	MICHAEL GARDNER, Agt	400 N WATER ST	Class B Tavern License	320	5/28/2022, 7:00 PM	1
70	MILWAUKEE TURNERS, INC	MILWAUKEE TURNERS	Emilio J De Torre, Agt	1034 N VEL R PHILLIPS AV	Class B Fermented Malt Beverage Retailer's License		5/23/2022, 7:00 PM	1
71	RIVER HOUSE RESTAURANT, INC	VagaBond	ROBERT C SCHMIDT, JR, Agt	1122 N EDISON ST	Class B Tavern License	150	6/1/2022, 7:00 PM	1
72	Wisconsin & Milwaukee Hotel, LLC	Milwaukee Marriott Downtown/Starbucks	Keith A Filipak, Agt	323 E Wisconsin AV	Class B Tavern License	312	5/23/2022, 7:00 PM	1
73	Truth Lounge, LLC	Truth Lounge	Tino K Bates, Agt	1111 N Martin L King DR	Class B Tavern License	90	5/25/2022, 7:00 PM	1

74	THIS IS IT, INC	THIS IS IT	GEORGE R SCHNEIDER, Agt	418 E WELLS ST	Class B Tavern License	160	6/29/2022, 7:00 PM	1
75	THE MILWAUKEE CLUB	THE MILWAUKEE CLUB	Molly J Schick, Agt	706 N JEFFERSON ST	Class B Tavern License	180	6/29/2022, 7:00 PM	1
76	CAPITAL GRILLE HOLDINGS, INC	THE CAPITAL GRILLE OF MILW #8027	Lindsey R FitzMaurice, Agt	310 W WISCONSIN AV 100	Class B Tavern License	200	6/18/2022, 7:00 PM	1
77	THIEF WINE, LLC	THIEF WINE SHOP & BAR	PHILIP M BILODEAU, Agt	400 N WATER ST	Class B Tavern License	42	6/29/2022, 7:00 PM	1
78	BRICK 3 PIZZA, LLC	BRICK 3 PIZZA	RICHARD J BARRETT, Agt	1107 N Martin L King Jr DR	Class B Tavern License	57	7/5/2022, 7:00 PM	1
79	Benelux Third Ward, LLC	Cafe Benelux	ERIC G WAGNER, Agt	346 N Broadway	Class B Tavern License	455	5/1/2022, 7:00 PM	1
80	MILWAUKEE COUNTY WAR MEMORIAL, INC	MILWAUKEE COUNTY WAR MEMORIAL CENTER	Laurieann Kildegaard, Agt	750 N LINCOLN MEMORIAL DR	Class B Tavern License	240	6/29/2022, 7:00 PM	1
81	ELSA'S ON THE PARK, LTD	ELSA'S ON THE PARK	KARL R KOPP, Agt	833 N JEFFERSON ST	Class B Tavern License	100	6/29/2022, 7:00 PM	1
82	MY OFFICE, INC	MY OFFICE	BRIAN J PETERSON, Agt	759-763 N MILWAUKEE ST	Class B Tavern License		6/29/2022, 7:00 PM	1
83	GRAND CONVENIENT, LLC	GRAND CONVENIENT STORE	AHMED K YAFAI, Agt	724 N Martin L King Jr DR	Class A Fermented Malt Beverage Retailer's License		6/13/2022, 7:00 PM	1
84	HB Milwaukee Inc	Old German Beer Hall	HANS WEISSGERBER, III, Agt	1009 N MARTIN L KING JR DR	Class B Tavern License	120	6/13/2022, 7:00 PM	1
85	First MKD, LLC	Hilton Garden Inn	Sarah I Frost, Agt	611 N BROADWAY	Class B Tavern License		6/15/2022, 7:00 PM	1
86	MARCUS HOTELS HOSPITALITY, LLC	Saint Kate-The Arts Hotel	CARRIE L AMAYA, Agt	139 E KILBOURN AV	Class B Tavern License		7/5/2022, 7:00 PM	1
87	VICTOR'S ON VAN BUREN, INC	VICTOR'S	VICTOR R JONES, Agt	1230 N VAN BUREN ST	Class B Tavern License	420	7/26/2022, 7:00 PM	1
88	WALGREEN CO	WALGREENS #1200	Nicole R Davis, Agt	275 W WISCONSIN AV 1108	Class A Malt & Class A Liquor License		7/27/2022, 7:00 PM	1
89	ARBED, LLC	MO'S IRISH PUB	JAMES A VASSALLO, Agt	142-44 W Wisconsin AV	Class B Tavern License	480	7/26/2022, 7:00 PM	1
90	MARCUS HOTELS HOSPITALITY, LLC	Pfister Hotel & Tower	CARRIE L AMAYA, Agt	424 E WISCONSIN AV	Class B Tavern License	419	7/29/2022, 7:00 PM	1
91	MP On Wheels Catering Service	MP On Wheels Catering Service	DULCE M ALARCON, SP	400 N WATER ST	Class B Tavern License	320	7/11/2022, 7:00 PM	1

92	PABST THEATER CONCESSIONS, LLC	THE PABST THEATER	Richard J Ryan, Agt	144 E WELLS ST	Class B Tavern License		7/5/2022, 7:00 PM	1
93	WA Cheese & Sausage Shoppe, Inc	WA Cheese & Sausage Shoppe	Mark S Lutz, Agt	400 N WATER ST 24	Class B Tavern License		6/29/2022, 7:00 PM	1
94	DJ ENTERPRISE S I, INC	GRACE CENTER	JOAN M GROH, Agt	250 E JUNEAU AV	Class B Tavern License	330	6/17/2022, 7:00 PM	1
95	FLANNERY'S PUB, INC	FLANNERY'S BAR & RESTAURANT	STEVEN W SMITH, Agt	425-29 E WELLS ST	Class B Tavern License	270	7/29/2022, 7:00 PM	1
96	Bollywood Grill, LLC	Bollywood Grill	MANJIT SINGH, Agt	1028-30 N Jackson ST	Class B Tavern License		7/21/2022, 7:00 PM	1
97	BUCKLEY'S KISKEAM INN, LLC	Buckley's	MICHAEL V BUCKLEY, Agt	801-09 N CASS ST	Class B Tavern License	65	7/29/2022, 7:00 PM	1
98	Fenix Milwaukee LLC	Rodizio Grill	Renan Utrera De Paula, Agt	777 N WATER ST	Class B Tavern License		7/5/2022, 7:00 PM	1
99	SAZAMA'S FINE CATERING, INC	SAZAMA'S FINE CATERING	TIMOTHY G HILBERT, Agt	929 N WATER ST	Class B Tavern License		8/30/2022, 7:00 PM	1
100	TACO MIKES LLC	Taco Mikes LLC	Michael P Holz, Agt	1001 N MARTIN L KING JR DR	Class B Tavern License		8/11/2022, 7:00 PM	1
101	BANQUET SERVICES, LLC	VILLA FILOMENA	JANICE E SANFILIPPO, Agt	1119 N MARSHALL ST	Class B Tavern License	299	7/28/2022, 7:00 PM	1
102	Art's Performing Center, LLC	Silk on Water	SCOTT A KRAHN, Agt	144 E Juneau AV	Class B Tavern License	80	7/25/2022, 7:00 PM	1
103	DOS BONITAS, LLC	CUBANITAS	MARTA C BIANCHINI, Agt	728 N MILWAUKEE ST	Class B Tavern License	50	7/25/2022, 7:00 PM	1
104	RIVERWALK COMMONS LLC	Riverwalk Commons	PAUL H SCHWARTZ, Agt	423 N WATER ST	Class B Tavern License		7/28/2022, 7:00 PM	1
105	Wild Rogues LLC	Elwood's Liquor & Tap	Nathan S Showers, Agt	1111 N Water ST	Class B Tavern License		7/25/2022, 7:00 PM	1
106	Sunstone Studios Inc	Sunstone Studios	Amber J Regan, Agt	127 E Wells ST	Class B Tavern License		8/1/2022, 7:00 PM	1
107	Central Standard LLC	Central Standard Craft Distillery	William P McQuillan, Agt	320 E Clybourn ST	Class B Fermented Malt Beverage Retailer's License		8/4/2022, 7:00 PM	1
108	MILWAUKEE BRAT HOUSE, LLC	MILWAUKEE BRAT HOUSE	SCOTT A SCHAEFER, Agt	1013 N Dr Martin L King Jr DR	Class B Tavern License	191	9/14/2022, 7:00 PM	1
109	Red Elephant LLC	Nicole's Third Ward Social	JACOB E DEHNE, Agt	333 N Broadway	Class B Tavern License		9/8/2022, 7:00 PM	1



110	ST. PAUL SEAFOOD, LLC	ST. PAUL FISH CO.	TIMOTHY G COLLINS, Agt	400 N WATER ST	Class B Tavern License		9/20/2022, 7:00 PM	1
111	Water Street Brewery Inc	Water Street Brewery	MATTHEW R SCHMIDT, Agt	1101 N WATER ST	Class B Tavern License	300	9/13/2022, 7:00 PM	1
112	DICK'S PIZZA, LLC	Electric Lime	ADAM D KIRCHNER, Agt	730 N MILWAUKEE ST	Class B Tavern License	330	8/29/2022, 7:00 PM	1
113	JSWD Commerce LLC	SpringHill Suites by Marriott Milwaukee Downtown	Benjamin A Risseuw, Agt	744 N VEL R PHILLIPS AV	Class B Tavern License	95	8/30/2022, 7:00 PM	1
114	Sirk Steak LLC	Mo's A Place for Steaks	JAMES A VASSALLO, Agt	720 N Plankinton AV	Class B Tavern License		9/2/2022, 7:00 PM	1
115	INDULGE WINE ROOMS, LLC	INDULGE	MARC R BIANCHINI, Agt	708 N MILWAUKEE ST	Class B Tavern License	60	8/30/2022, 7:00 PM	1
116	MEGA MARTS, LLC	METRO MARKET #371	ANTHONY M KUCHINSKY, Agt	1123 N VAN BUREN ST	Class B Tavern License	65	8/30/2022, 7:00 PM	1
117	Hotel Metro Operator, LLC	Hotel Metro	Andrew R Cordes, Agt	411 E Mason ST	Class B Tavern License	150	8/30/2022, 7:00 PM	1
118	MILWAUKEE REPERTORY THEATER, INC	MILWAUKEE REPERTORY THEATER	Melissa N Vartanian-Mikaelian, Agt	108 E WELLS ST	Class B Tavern License		9/7/2022, 7:00 PM	1
119	THE HARP IRISH PUB, INC	THE HARP	ROBERT C SCHMIDT, JR, Agt	113 E JUNEAU AV	Class B Tavern License	325	9/14/2022, 7:00 PM	1
120	WELLS-JEFFERSON CORPORATION	TAYLOR'S	DANIEL R TAYLOR, Agt	795 N JEFFERSON ST	Class B Tavern License	160	9/25/2022, 7:00 PM	1
121	BAR NONE MILWAUKEE, LLC	BAR NONE	AMY M BLADOW, Agt	1139 N WATER ST	Class B Tavern License	60	10/11/2022, 7:00 PM	1
122	SINCERESWAN, LLC	SWINGIN DOOR EXCHANGE	MICHELLE M SINCERE, Agt	219 E MICHIGAN ST	Class B Tavern License	80	10/10/2022, 7:00 PM	1
123	Drury Hotels Company, LLC	Drury Plaza Hotel - Milwaukee Downtown	Chris Palid, Agt	700 N Water ST	Class B Tavern License		10/2/2022, 7:00 PM	1
124	PTG Live Events LLC	The Riverside	Richard J Ryan, Agt	116 W Wisconsin AV	Class B Tavern License	2,480	7/29/2022, 7:00 PM	1
125	BRG 1000 Water St LLC	Room @ The Rumpus Room	CHRISTIAN M DAMIANO, Agt	1020 N Water ST	Class B Tavern License		9/21/2022, 7:00 PM	1
126	BRG 777 E Wisconsin LLC	Downtown Kitchen	CHRISTIAN M DAMIANO, Agt	777 E WISCONSIN AV	Class B Tavern License	483	9/21/2022, 7:00 PM	1
127	BARTOLOTTA CATERING - GRAIN EXCHANGE LLC	BARTOLOTTA CATERING - GRAIN EXCHANGE LLC	CHRISTIAN M DAMIANO, Agt	225 E MICHIGAN ST	Class B Tavern License	299	9/21/2022, 7:00 PM	1

128	BRG 1000 Water Street, LLC	Rumpus Room - A Bartolotta Gastropub	CHRISTIAN M DAMIANO, Agt	1030 N Water ST	Class B Tavern License	254	9/21/2022, 7:00 PM	1
129	TUDY-BART, LLC	BACCHUS-A BARTOLOTTA RESTAURANT	CHRISTIAN M DAMIANO, Agt	925 E WELLS ST	Class B Tavern License	200	9/21/2022, 7:00 PM	1
130	Charro Latino, LLC	The Garden/Lucid	SEAN A PLISS, Agt	725-729 N Milwaukee ST	Class B Tavern License	490	3/21/2022, 7:00 PM	1
131	LUKE'S OF MILWAUKEE, LTD	RED ROCK SALOON MILWAUKEE	JEFFREY A KOVACOVICH, JR, Agt	1225 N WATER ST	Class B Tavern License	390	9/24/2022, 7:00 PM	1
132	Artisan Ramen LLC	Artisan Ramen	Xiaoyu Liu, Agt	530 E Mason ST	Class B Tavern License	93	9/29/2022, 7:00 PM	1
133	REAL CHILI OF MILWAUKEE, INC	REAL CHILI	STEPHEN J KASTELIC, Agt	419 E WELLS ST	Class B Tavern License	80	10/2/2022, 7:00 PM	1
134	TRIPLE CROWN, INC	BUCK BRADLEY'S EATERY & SALOON	WALTER PAGET, Agt	1019 N Dr Martin L King Jr DR	Class B Tavern License	599	12/16/2021, 6:00 PM	1
135	HDS 777, LLC	The Sofie	DAVID J SAFINA, Agt	777 N JEFFERSON ST	Class B Tavern License		10/19/2022, 7:00 PM	1
136	UNIVERSITY CLUB OF MILWAUKEE	UNIVERSITY CLUB OF MILWAUKEE	JOSEPH G CORAGGIO, Agt	924 E WELLS ST	Class B Tavern License	150	7/9/2022, 7:00 PM	1
137	BREW CITY BAR B Q, INC	TRINITY THREE IRISH PUBS	ROBERT C SCHMIDT, JR, Agt	125 E JUNEAU AV	Class B Tavern License	833	10/16/2022, 7:00 PM	1
138	BW HOLDINGS, LLC	WARD'S HOUSE OF PRIME	BRIAN J WARD, Agt	540 E MASON ST	Class B Tavern License	260	11/1/2022, 7:00 PM	1
139	MIDAS HOSPITALITY, LLC	Aloft Milwaukee Downtown	Mathew W Meadows, Agt	1230 N Dr Martin L King Jr DR	Class B Tavern License		11/22/2022, 6:00 PM	1
140	Dubbel Dutch, LLC	Dubbel Dutch Hotel	Julianne M Kaufmann, Agt	817-819 N MARSHALL ST	Class B Tavern License		11/9/2022, 6:00 PM	1
141	JCTH, INC	CAFE AT THE PLAZA	BENJAMIN T CRICHTON, Agt	1007 N CASS ST	Class B Tavern License		11/23/2022, 6:00 PM	1
142	The Chalk House MKE Inc	The Loaded Slate	DOUGLAS L DAUL, Agt	1137 N Dr Martin L King Jr DR	Class B Tavern License	99	10/31/2022, 7:00 PM	1
143	MKE Events LLC	Red White and Blue	JACOB E DEHNE, Agt	1044 N Dr Martin L king Jr DR	Class B Tavern License	824	11/5/2022, 7:00 PM	1
144	3rd Street Market LLC	3rd St Market Hall	Jaime A Jacobs-Schroeder, Agt	275 W Wisconsin AV 100	Class B Tavern License		11/9/2022, 6:00 PM	1

Establishments within a 0.5 miles radius centered on area of interest.



Wednesday, December 21, 2022



# Notice of Public Hearing

Blank Notice

---

SINGH, Ranjit, Agent

Brick Wing Event Hall at 804 N MILWAUKEE St #Suite 100

Class B Tavern and Public Entertainment Premises License Applications Requesting Instrumental Musicians, Disc Jockey, Bands, Karaoke, Poetry Readings, Patron Contests, 100 Concerts P/Year, Comedy Acts, Dancing by Performers and Patrons Dancing

**Wednesday, January 04, 2023 at 11:15 AM**

To whom it may concern:

The above application has been made by the above named applicant(s). This requires approval from the Licenses Committee and the Common Council of the City of Milwaukee. The hearing before the Licenses Committee will take place on 1/4/2023 at 11:15 AM in Room 301-B, Third Floor, City Hall. This is a public hearing. Those wishing to view the proceeding are able to do so via the City Channel – Channel 25 on Spectrum Cable – or on the Internet at <http://city.milwaukee.gov/citychannel>. Those wishing to provide oral testimony via phone or internet are asked to contact the staff assistant, Yadira Melendez at (414) 286-2775 or [stasst5@milwaukee.gov](mailto:stasst5@milwaukee.gov) for necessary information. Please make such requests no later than one business day prior to the start of the meeting. You are not required to attend the hearing, but please see the information below if you would like to provide testimony. Once the Licenses Committee makes its recommendation, this recommendation is forwarded to the full Common Council for approval at its next regularly scheduled hearing.

---

## Important details for those wishing to provide information for the Licenses Committee to consider when making its recommendation:

1. The license application is scheduled to be heard at the above time. Due to other hearings running longer than scheduled, you may have to wait some time to provide your testimony.
2. You must appear in person and testify as to matters that you have personally experienced or seen. (You cannot provide testimony for your neighbor, parent or anyone else; this is considered hearsay and cannot be considered by the committee.)
3. No letters or petitions can be accepted by the committee (unless the person who wrote the letter or the persons who signed the petition are present at the committee hearing and willing to testify).
4. Persons opposed to the license application are given the opportunity to testify first; supporters may testify after the opponents have finished.
5. When you are called to testify, you will be sworn in and asked to give your name, and address. (If your first and/or last names are uncommon please spell them.)
6. You may then provide testimony.
  - a. Include only information relating to the above license application.
  - b. Include only information you have personally witnessed or seen.
  - c. Provide concise and relevant information detailing how this business has affected or may affect the peaceful enjoyment of your neighborhood.
  - d. If by the time you have the opportunity to testify, the information you wish to share has already been provided to the committee, you may state that you agree with the previous testimony. Redundant or repetitive testimony will not assist the committee in making its recommendation.
7. After giving your testimony, the members of the Licenses Committee and the licensee may ask questions regarding the testimony you have given or other factors relating to the license application.
8. Business Competition is not a valid basis for denial or non-renewal of a license.

**Please Note: If you have submitted an objection to the above application your objection cannot be considered by the committee unless you personally testify at the hearing.**

[illegible]



CURRENT OCCUPANT	758 N BROADWAY# 904	MILWAUKEE, WI 53202-4012
CURRENT OCCUPANT	758 N BROADWAY# 905	MILWAUKEE, WI 53202-3654
CURRENT OCCUPANT	758 N BROADWAY# 906	MILWAUKEE, WI 53202-4012
CURRENT OCCUPANT	758 N BROADWAY# 907	MILWAUKEE, WI 53202-4012
CURRENT OCCUPANT	758 N BROADWAY# 908	MILWAUKEE, WI 53202-4012
CURRENT OCCUPANT	758 N BROADWAY# 909	MILWAUKEE, WI 53202-4012
CURRENT OCCUPANT	758 N BROADWAY# 910	MILWAUKEE, WI 53202-3654
CURRENT OCCUPANT	758 N BROADWAY# 911	MILWAUKEE, WI 53202-4013
CURRENT OCCUPANT	769 N JEFFERSON ST# 201	MILWAUKEE, WI 53202-3722
CURRENT OCCUPANT	769 N JEFFERSON ST# 202	MILWAUKEE, WI 53202-3722
CURRENT OCCUPANT	769 N JEFFERSON ST# 301	MILWAUKEE, WI 53202-3730
CURRENT OCCUPANT	769 N JEFFERSON ST# 302	MILWAUKEE, WI 53202-3730
CURRENT OCCUPANT	773 N JEFFERSON ST# 1	MILWAUKEE, WI 53202-3707
CURRENT OCCUPANT	773 N JEFFERSON ST# 2	MILWAUKEE, WI 53202-3707
CURRENT OCCUPANT	773 N JEFFERSON ST# 3	MILWAUKEE, WI 53202-3707
CURRENT OCCUPANT	773 N JEFFERSON ST# 4	MILWAUKEE, WI 53202-3707
CURRENT OCCUPANT	773 N JEFFERSON ST# 5	MILWAUKEE, WI 53202-3707
CURRENT OCCUPANT	773 N JEFFERSON ST# 6	MILWAUKEE, WI 53202-3707
CURRENT OCCUPANT	780 N MILWAUKEE ST	MILWAUKEE, WI 53202-3705
CURRENT OCCUPANT	828 N MILWAUKEE ST# 1	MILWAUKEE, WI 53202-3606
CURRENT OCCUPANT	828 N MILWAUKEE ST# 10	MILWAUKEE, WI 53202-3606
CURRENT OCCUPANT	828 N MILWAUKEE ST# 11	MILWAUKEE, WI 53202-3606
CURRENT OCCUPANT	828 N MILWAUKEE ST# 12	MILWAUKEE, WI 53202-3606
CURRENT OCCUPANT	828 N MILWAUKEE ST# 14	MILWAUKEE, WI 53202-3606
CURRENT OCCUPANT	828 N MILWAUKEE ST# 15	MILWAUKEE, WI 53202-3606
CURRENT OCCUPANT	828 N MILWAUKEE ST# 16	MILWAUKEE, WI 53202-3606
CURRENT OCCUPANT	828 N MILWAUKEE ST# 17	MILWAUKEE, WI 53202-3606
CURRENT OCCUPANT	828 N MILWAUKEE ST# 2	MILWAUKEE, WI 53202-3606
CURRENT OCCUPANT	828 N MILWAUKEE ST# 3	MILWAUKEE, WI 53202-3606
CURRENT OCCUPANT	828 N MILWAUKEE ST# 4	MILWAUKEE, WI 53202-3606
CURRENT OCCUPANT	828 N MILWAUKEE ST# 5	MILWAUKEE, WI 53202-3606
CURRENT OCCUPANT	828 N MILWAUKEE ST# 6	MILWAUKEE, WI 53202-3606
CURRENT OCCUPANT	828 N MILWAUKEE ST# 7	MILWAUKEE, WI 53202-3606
CURRENT OCCUPANT	828 N MILWAUKEE ST# 8	MILWAUKEE, WI 53202-3606
CURRENT OCCUPANT	828 N MILWAUKEE ST# 9	MILWAUKEE, WI 53202-3606
CURRENT OCCUPANT	828 N MILWAUKEE ST# A	MILWAUKEE, WI 53202-3606
CURRENT OCCUPANT	828 N MILWAUKEE ST# B	MILWAUKEE, WI 53202-3606

Blank Notice

Total Records: 83

Radius 300.0 feet and Center of the Circle: 804 N Milwaukee St



## BUSINESS LICENSE PLAN OF OPERATION

ccl-busplan 5/12/2020

Office of the City Clerk License Division  
200 E. Wells St. Room 105, Milwaukee, WI 53202  
(414) 286-2238 www.milwaukee.gov/license e-mail address: [license@milwaukee.gov](mailto:license@milwaukee.gov)

### 1. Type of Business

Applying for: ☐ Extended Hours (12AM to 5AM) - If a food establishment, check all that apply: ☐ Delivery ☐ Drive Thru ☐ Dining Room  
☐ Self Service Laundry ☐ Massage Establishment ☐ Filling Station  
☒ Other (supplemental application for specific license also required)

Provide a detailed description of the type of business you plan on operating: Assembly Hall and event space for private corporate and co  
Cocktail lounge

Do you have any experience operating this type of business? ☐ No ☒ Yes If yes, explain: Hospitality + Event Coordinator

### 2. Business Operations

- a. Proposed Opening Date: March 2023
- b. Is this premise under construction? ☐ No ☒ Yes If yes, list estimated completion date: March, 2023
- c. Is this a franchise? ☒ No ☐ Yes
- d. Is this premises currently licensed? ☒ No ☐ Yes If yes, list type of license: \_\_\_\_\_
- e. Is the current licensee operating? ☐ No ☐ Yes If no, list date closed: N/A
- f. Do you have future plans for other businesses, licenses or permits at this location? ☒ No ☐ Yes  
If yes, explain: \_\_\_\_\_
- g. Have you previously held an Extended Hours License in Milwaukee? ☒ No ☐ Yes  
If yes, list address(es): \_\_\_\_\_
- h. Are other businesses operating in the same building? ☐ No ☒ Yes If yes, describe: commercial office for 3D Molecular D

### 3. Litter & Noise

- a. How are grounds kept clean? ☒ Sweep ☒ Pressure Wash ☒ Pick Up Litter ☐ Other: \_\_\_\_\_
- b. How often will grounds be cleaned? ☒ Daily ☒ Weekly ☒ As Needed ☐ Monthly ☐ Other: \_\_\_\_\_
- c. Grounds cleaned by: ☒ Licensee ☒ Building Owner ☒ Employees ☐ Hired Maintenance ☐ Other: \_\_\_\_\_
- d. How are noise issues prevented and/or addressed? ☐ Security ☒ Manager approaches customer(s) ☐ Call Police  
☐ Signs Posted ☒ Other: noise rules expressed in contract
- e. Will a sound amplification system be used? ☐ No ☒ Yes If yes, describe: speaker system for DJ's + Bands

### 4. Smoking & Sanitation

- a. Are there designated outdoor smoking areas? ☒ No ☐ Yes If yes, describe: \_\_\_\_\_
- b. Number of Garbage Cans: Inside: 10 Locations: bathrooms (6) warming kitchen (2) Bar (1) Lounge (1)  
Outside: 1 Locations: near entrance
- c. Is a crowd control barrier used? ☒ No ☐ Yes If yes, describe: \_\_\_\_\_
- d. How many restrooms are on the premises? 6
- e. Name of solid waste contractor: ☐ Advanced Disposal ☒ Waste Management ☐ Other: \_\_\_\_\_

## 5. Security

- a. Are there onsite parking spaces? ☒ No ☐ Yes If yes, how many? \_\_\_\_\_ and describe the parking security plan: \_\_\_\_\_
- b. Is there a loading zone? ☐ No ☒ Yes If yes, describe the loading area security plan: Digital Cameras installed to monitor alleyway activity and surrounding premise
- c. Will you have security personnel on premise? ☒ No ☐ Yes If yes, how many? \_\_\_\_\_ and answer the following:  
 What are their responsibilities? \_\_\_\_\_  
 Is security equipment used? ☐ No ☒ Yes If yes, describe Approx 6 Cameras (indoors and outdoor)  
 List their licensing, certification, or training credentials \_\_\_\_\_
- d. Will there be security cameras? ☐ No ☒ Yes If yes, how many? 6 and list locations: Front Entrance, side building, alley, indoors approx 3 through the suite space
- e. Will searches/identification checks be done upon entry? ☒ No ☐ Yes If yes, describe \_\_\_\_\_

## 6. Percentage of Sales (must total 100%)

Alcohol <u>40</u> %	Food _____ %	Secondhand Merchandise _____ %	Precious Metals & Gems _____ %
Entertainment <u>60</u> %	Cigarettes _____ %		
Pawnbroker Activity _____ %	Salvaged Materials _____ % (such as scrap metal)	Personal Services (such as tattoo, body piercing, salon, tailor, tanning, etc.) _____ %	Other _____ % Describe: _____

## 7. Businesses/Licenses on the Premises (check all that apply):

### Type 1

- ☐ Full Service Restaurant ☐ Cafe/Coffee Shop ☐ Deli or Fast Food Restaurant ☐ Private/Fraternal/Veterans Club
- ☐ Night Club ☐ Tavern ☒ Cocktail Lounge ☐ Teen Club
- ☒ Banquet Hall ☐ Sports Facility ☐ Bowling Alley
- ☐ Hotel/Motel: Number of Floors: \_\_\_\_\_ Number of Rooms: \_\_\_\_\_  
☐ Rooming House: Number of Floors: \_\_\_\_\_ Number of Rooms: \_\_\_\_\_

### Type 2

- ☐ Liquor Store ☐ Corner Store ☐ Supermarket ☐ Convenience Store
- ☐ Gas Station ☐ Amusement/Phonograph Distributor ☐ Recycling, Salvage or Towing
- ☐ Used Car Dealer ☐ Personal Service Establishment  
(such as tattoo business, hair salon, tailor, etc.) ☐ Recording Studio

What other licenses/permits will you hold at this location? (check all that apply)

- ☒ Occupancy Permit ☐ Cigarette & Tobacco ☐ Gas Station ☐ Extended Hours ☐ Class "B" Tavern ☐ Weights & Measures
- ☐ Secondhand Dealer ☐ Precious Metal & Gem ☐ Other: \_\_\_\_\_

## 8. Legal Capacity (only if a Type 1 premises in #7 above)

Capacity 260 (Call the Milwaukee Development Center at 414-286-8211 if you have questions.)



## 9. Premises Description

- a. Identify all area(s) of the premises that will be used in operating this business (include areas used only for storage):  
☒ 1<sup>st</sup> Floor ☐ 2<sup>nd</sup> Floor ☐ Basement Storage ☐ Patio ☐ Beer Garden ☐ Sidewalk Café ☐ Deck ☐ Rooftop  
☐ Other: Describe: 1st floor, south side of building, + patio, suite 100
- b. Describe Location: ☒ Major Thoroughfare ☐ Secondary Street ☐ Other: \_\_\_\_\_
- c. Nearest Major Cross Street: Milwaukee + Wells
- d. Describe Building: ☒ Free Standing Building ☐ Strip Mall ☒ Other: commercial
- e. Describe Premises Structure: ☐ Single Story ☒ Multi-Story - # of Stories 4 ☐ Other: \_\_\_\_\_
- f. Describe Surrounding Area: ☒ Commercial ☐ Residential ☐ Industrial ☐ Other: \_\_\_\_\_
- g. Building Owner Name: Bachan Singh Phone Number: 414-737-9567  
 Building Owner Address: 19315 Compton Lane Brookfield, WI 53045

## 10. Hours of Operation & Customers

Will customers be entering the premises? ☐ No ☒ Yes

Day of the Week	Proposed Hours of Operation:		Estimated Number of Customers expected each day	Potential Age Range of Customers	Class B Tavern Applicant Only: Age Restriction (If none, write 'None')
	Open Time (include a.m. or p.m.)	Close Time (include a.m. or p.m.)			
Sunday	9 AM	10 PM	100	all ages	none
Monday	9 AM	10 PM	100	all ages	none
Tuesday	9 AM	10 PM	100	all ages	none
Wednesday	9 AM	10 PM	100	all ages	none
Thursday	9 AM	2 AM	150	all ages	none
Friday	9 AM	2:30 AM	200	all ages	none
Saturday	9 AM	2:30 AM	200	all ages	none

An Extended Hours Establishment License is required for any convenience store, filling station, personal service establishment (such as tattoo, body piercing, salon, tailor, tanning, etc.), recording studio or restaurant which is open between the hours of 12:00 a.m. and 5:00 a.m.

Alcohol Establishments Permitted Hours of Operation: Class A: 8:00 am to 9:00 pm Sunday thru Saturday  
 Class B: 6:00 am to 2:00 am Sunday thru Thursday, 6:00 am to 2:30 am Friday & Saturday

Entertainment Outdoor Closing Hours: 10:00pm Sunday-Thursday; 12:00am Friday & Saturday; unless a different time, either earlier or later, is established by the Common Council in its approval of the licensee's plan of operation.

## 11. Signature(s)

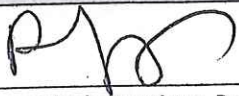
  
 Signature of Sole Proprietor, Partner, or 20% or more Shareholder  
 (If there are no 20% or more shareholders,  
 Corporate Officer-print name/title and sign)

\_\_\_\_\_  
 Signature of additional partner or 20% or more shareholder

See Application Information for a complete list of all required application forms.





# ALCOHOL BEVERAGE & PUBLIC ENTERTAINMENT PREMISES SUPPLEMENTAL APPLICATION

Office of the City Clerk License Division  
200 E. Wells St. Room 105, Milwaukee, WI 53202  
(414) 286-2238 e-mail address: license@milwaukee.gov [www.milwaukee.gov/license](http://www.milwaukee.gov/license)

Legal Entity Name: Brick Wing LLC

Premise Address: 804 N Milwaukee St, Milwaukee, WI 53202, Suite 100

## Proximity of Premises to Church, School, Daycare Center or Hospital

Is the building within 300 feet of any church, school, daycare center or hospital? ☒ No ☐ Yes

## "Service Bar Only" Designation

If applying for Class B or C license, are you applying for "Service Bar Only"? ☒ No ☐ Yes  
Service Bar Only means customers cannot sit at the bar. Alcohol is served to employees who serve patrons seated at tables.  
No stools, chairs or other articles of furniture shall be placed at the service bar for patrons to sit upon.

## Business Information

- a) Are you taking out this application for anyone that may not be eligible for a license? ☒ No ☐ Yes  
If yes, list their name and address: \_\_\_\_\_
- b) Will the agent, a partner or the individual licensee be conducting the day-to-day operations of the business? ☐ No ☒ Yes  
If no, list the name and address of the person(s) who will: \_\_\_\_\_
- Class B Applicants: If the agent, a partner or the individual licensee will not be conducting the day-to-day operations of the business, the person(s) listed above must obtain a Class B Managers license.
- c) Does anyone else have money invested or any other interest in this business? ☐ No ☒ Yes  
If yes, explain: Bachan Singh, Building Owner- initial remodel investment
- d) Have you made an agreement with anyone to repay any loan or any other payments based upon income from the business?  
☒ No ☐ Yes If yes, list name and address: \_\_\_\_\_

## Property Information (New & Transfer Applicants Only)

- a) Do you own or lease the building? ☐ Own ☒ Lease
- b) Who owns the fixtures (for example, coolers, etc.)? Bachan Singh, Building Owner
- c) Are you purchasing the stock and/or fixtures? ☒ No ☐ Yes If yes, amount paid \$ \_\_\_\_\_
- d) Total amount paid for business \$0.00
- e) Total amount paid for goodwill of the business \$0.00
- Goodwill comprises the reputation and customer relationships of an existing business. If the price you pay for the business exceeds the fair market value of all of the rest of the assets of the business, the excess may be considered goodwill.
- f) Have you made arrangements with the seller for payment of personal property taxes? ☒ No ☐ Yes

## Lease Information (New & Transfer Applicants who are leasing the premises only)

- a) Date lease begins August 1st, 2022 Ends July 31st, 2027
- b) Monthly rental \$6,000 (\$5,300)
- c) Do you have an option to renew the lease? ☐ No ☒ Yes
- d) Does your lease allow for assignment to another party without the consent of the owner? ☒ No ☐ Yes
- e) For what length of time have you been guaranteed occupancy (number of years)? 4 years 5

### Lease Information (Continued)

- f) In addition to paying the monthly rental, will you have to pay anything additional to the owner of the building to guarantee performance of the lease? ☒ No ☐ Yes If yes, explain \_\_\_\_\_
- g) Does the present owner or occupancy object to the granting of your license? ☒ No ☐ Yes  
If yes, explain \_\_\_\_\_

### Change of Agent Applicants Only

Have there been any changes to the floor plan since the last application was submitted? ☐ No ☒ Yes  
If no, a new floor plan is not required. If yes, submit a new floor plan and explain the change(s):  
\_\_\_\_\_

### Signature

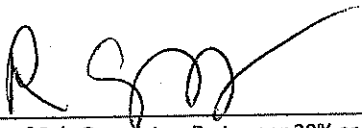

Signature of Sole Proprietor, Partner or 20% or More Shareholder  
(If no 20% or more Shareholder, Corporate Officer - print name/title and sign)

Note: All information contained in this application is subject to approval by the Common Council.  
Deviating from approved plan of operation will subject licensee to citations, and/or suspension or non-renewal of the license.  
Contact the License Division for information on how to request changes.

### New and transfer of premises applicants must submit the following:

- ☐ Detailed floor plan  
☐ If a restaurant, copy of the menu





# **PUBLIC ENTERTAINMENT PREMISES LICENSE SUPPLEMENTAL APPLICATION**

Office of the City Clerk License Division  
200 E. Wells St. Room 105, Milwaukee, WI 53202  
(414) 286-2238 [www.milwaukee.gov/license](http://www.milwaukee.gov/license) e-mail address: [license@milwaukee.gov](mailto:license@milwaukee.gov)

**PREMISES ADDRESS:** 804 N Milwaukee St Milwaukee, WI 53202, **Suite 100**

## **TYPES OF ENTERTAINMENT (CHECK ALL THAT APPLY)**

- |   |   |   |  |
|---|---|---|--|
| <input checked="" type="checkbox"/> Instrumental Musicians -                        | <input type="checkbox"/> Battle of the Bands          | <input checked="" type="checkbox"/> Dancing by Performers -             | <input type="checkbox"/> Amusement Machines<br>How many? _____                   |
| <input checked="" type="checkbox"/> Bands -   | <input checked="" type="checkbox"/> Comedy Acts -     | <input type="checkbox"/> Adult Entertainment/<br>Strippers/Erotic Dance | <input checked="" type="checkbox"/> Concerts -<br>Approx. # per year? <u>100</u> |
| <input type="checkbox"/> Bowling Alley<br>How many? _____                           | <input checked="" type="checkbox"/> Disc Jockey -     | <input type="checkbox"/> Wrestling                                      | <input type="checkbox"/> Theatrical Performances<br>Approx. # per year? _____    |
| <input type="checkbox"/> Pool Tables<br>How many? _____                             | <input type="checkbox"/> Magic Shows                  | <input checked="" type="checkbox"/> Patron Contests -                   | <input type="checkbox"/> Jukebox   |
| <input type="checkbox"/> Motion Pictures (movies by<br>admission) - How many? _____ | <input checked="" type="checkbox"/> Poetry Readings - | <input checked="" type="checkbox"/> Patrons Dancing -                   | <input checked="" type="checkbox"/> Karaoke -                                    |
| <input type="checkbox"/> Other: _____   |   |   |  |

Entertainment Outdoor Closing Hours: 10:00pm Sunday-Thursdays; 12:00am Friday & Saturday; unless a different time, either earlier or later, is established by the Common Council in its approval of the licensee's plan of operation.

## **PROMOTERS/SOUND AMPLIFICATION**

Will promoters ever be used for any of the entertainment? ☐ No ☒ Yes If Yes, Describe: Radio + marketing

At any time will sound amplification be used? ☐ No ☒ Yes If Yes, Describe: speakers for entertainment/ DJ's

## **LEGAL CAPACITY OF PREMISES**

260 (Call the Development Center at 414-286-8211 with questions.) Legal capacity determines the fee for your Public Entertainment Premises License. If you would like to request the license be approved with a lower capacity than that listed above, indicate the lower capacity here: \_\_\_\_\_. If approved, this lower capacity will print on your license and override the capacity listed on your Occupancy Permit.

## **ACKNOWLEDGEMENT/SIGNATURE**

I understand that after the license has been issued, a change to the plan of operation will require a written request to change and approval from the Common Council. I agree to inform the City Clerk within 10 days of any substantial changes in the information supplied in this application. I understand that I shall not willfully refuse to provide the services offered under this license, or add charges or require deposits not required of the general public because of race, color, sex, religion, national origin or ancestry, age, handicap, lawful source of income, marital status, sexual orientation, gender identity or expression, familial status or the fact that a person is now or has been a member of the military service, whether dressed in uniform or not; and shall not seek such information as a condition of employment, or penalize any employee or discriminate in the selection of personnel for training or promotion on the basis of such information.

I have knowledge of the City Ordinances currently regulating public entertainment, and understand that the license may be subject to suspension, non-renewal or revocation, if I violate any rule, law or regulation of the city of Milwaukee and State of Wisconsin.

Signature of Sole Proprietor, Partner or 20% or More Shareholder  
(If no 20% or more Shareholder, Corporate Officer - print name/title and sign)

## **Office Use Only:**

Initials: \_\_\_\_\_ Filed: \_\_\_\_\_ App: \_\_\_\_\_

Only PEP? ☐ No ☐ Yes If Yes, ☐ Queue to MPD and ☐ Email Mgrs/Team Lead (must be heard w/in 60 days)



Brick Wing LLC  
 Brick Wing Event Hall  
 804 N Milwaukee St, 100  
 Milwaukee WI, 53202  
 September 15th, 2022  
 Agent: Ranjit Singh

Milwaukee St.

Wells St

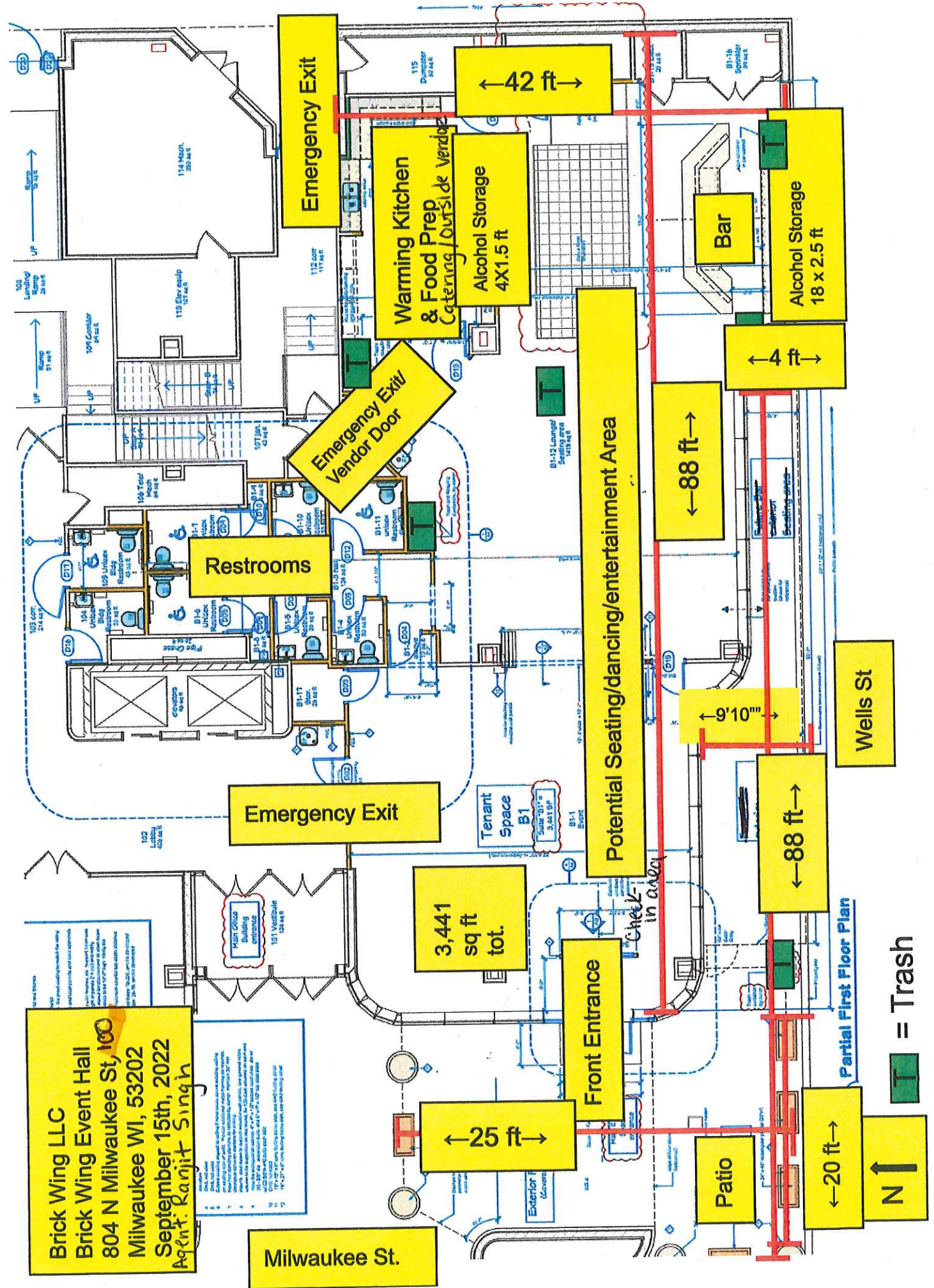

T = Trash

Partial First Floor Plan





OVER VIEW

