



**CITY OF MILWAUKEE  
OFFICE OF THE CITY CLERK**

Monday, August 22, 2022

**COMMITTEE MEETING NOTICE**

AD 03

LAGOS, Marcela E, Agent  
La Mendocina LLC  
4909 N Ardmore Av  
Whitefish Bay, WI 53217

You are requested to attend a hearing which is to be held in Room 301-B, Third Floor, City Hall on:

**Thursday, September 01, 2022 at 08:45 AM**

**Regarding:** Your Food Dealer License Application as agent for "La Mendocina LLC" for "La Mendocina" at 701 E KEEFE Av.

There is a possibility that your application may be denied for one or more of the following reasons: The recommendation of the committee regarding the application shall be based on evidence presented at the hearing. Per MCO 85-2.7-4, probative evidence concerning whether or not a new license should be granted may be presented on the following subjects: whether or not the applicant meets the municipal requirements, the appropriateness of the location and premises where the licensed premises is to be located and whether use of the premises for the purposes or activities permitted by the license would tend to facilitate a public or private nuisance or create undesirable neighborhood problems such as disorderly patrons, unreasonably loud noise, litter, and excessive traffic and parking congestion. Probative evidence relating to these matters may be taken from the plan of operation submitted with the license application, if any, but shall not include the content of any music. Evidence regarding the fitness of the location of the premises to be maintained as the principal place of business, including but not limited to whether there is an overconcentration of businesses of the type for which the license is sought; whether the proposal is consistent with any pertinent neighborhood business or development plans, or the location's proximity to areas where children are typically present. The applicant's record in operating similarly licensed premises; and whether or not the applicant has been charged with or convicted of any felony, misdemeanor, municipal offense or other offense, the circumstances of which substantially relate to the activity to be permitted by the license being applied for or any other factor which reasonably relates to the public health, safety or welfare may also be considered. See attached police report or correspondence.

**Notice for applicants with  
warrants or unpaid fines:**

**Proof of warrant satisfaction or payment of fines must be submitted at the hearing on the above date and time. Failure to comply with this requirement may result in a delay of the granting/denial of your application.**

Failure to appear at this meeting may result in the denial of your license. Individual applicants must appear only in person or by an attorney. Corporate or Limited Liability applicants must appear only by the agent designated on the application or by an attorney. Partnership applicants must appear by a partner listed on the application or by an attorney. If you wish to do so and at your own expense, you may be accompanied by an attorney of your choosing to represent you at this hearing.

You will be given an opportunity to speak on behalf of the application and to respond and challenge any charges or reasons given for the denial. No petitions can be accepted by the committee, unless the people who signed the petition are present at the committee hearing and willing to testify. You may present witnesses under oath and you may also confront and cross-examine opposing witnesses under oath. If you have difficulty with the English language, you should bring an interpreter with you, at your expense, so that you can answer questions and participate in your hearing.

You may examine the application file at this office during regular business hours prior to the hearing date. Inquiries regarding this matter may be directed to the person whose signature appears below.

Limited parking for persons attending meetings in City Hall is available at reduced rates (5 hour limit) at the Milwaukee Center on the southwest corner of East Kilbourn and North Water Street. Parking tickets must be validated in the first floor information booth in City Hall.

PLEASE NOTE: Upon reasonable notice, efforts will be made to accommodate the needs of disabled individuals through sign language interpreters or other auxiliary aids. For additional information or to request this service, contact the Council Services Division ADA Coordinator at (414) 286-2998, Fax - (414) 286-3456, TDD - (414) 286-2025.

**JIM OWCZARSKI, CITY CLERK**

BY: \_\_\_\_\_

**Jim Cooney  
License Division Manager**

**If you have questions regarding this notice, please contact the License Division at (414) 286-2238.**

200 E. Wells Street, Room 105, City Hall, Milwaukee, WI 53202. [www.milwaukee.gov/license](http://www.milwaukee.gov/license)  
Phone: (414) 286-2238 Fax: (414) 286-3057 Email Address: [License@milwaukee.gov](mailto:License@milwaukee.gov)



Monday, August 22, 2022



# Notice of Public Hearing

Blank Notice

---

LAGOS, Marcela E  
La Mendocina at 701 E KEEFE Av.  
Food Dealer License Application

**Thursday, September 01, 2022 at 08:45 AM**

To whom it may concern:

The above application has been made by the above named applicant(s). This requires approval from the Licenses Committee and the Common Council of the City of Milwaukee. The hearing before the Licenses Committee will take place virtually on 09/01/2022 at 08:45 AM. This is a public hearing. Those wishing to view the proceeding are able to do so via the City Channel – Channel 25 on Spectrum Cable – or on the Internet at <http://city.milwaukee.gov/citychannel>. Those wishing to provide oral testimony will be asked to do so by phone or internet and are asked to contact the staff assistant, Yadira Melendez at (414) 286-2775 or [stasst5@milwaukee.gov](mailto:stasst5@milwaukee.gov) for necessary information. Please make such requests no later than one business day prior to the start of the meeting. You are not required to attend the hearing, but please see the information below if you would like to provide testimony. Once the Licenses Committee makes its recommendation, this recommendation is forwarded to the full Common Council for approval at its next regularly scheduled hearing.

---

## Important details for those wishing to provide information for the Licenses Committee to consider when making its recommendation:

1. The license application is scheduled to be heard at the above time. Due to other hearings running longer than scheduled, you may have to wait some time to provide your testimony.
2. You must testify as to matters that you have personally experienced or seen. (You cannot provide testimony for your neighbor, parent or anyone else; this is considered hearsay and cannot be considered by the committee.)
3. No letters or petitions can be accepted by the committee (unless the person who wrote the letter or the persons who signed the petition are willing to testify).
4. Persons opposed to the license application are given the opportunity to testify first; supporters may testify after the opponents have finished.
5. When you are called to testify, you will be sworn in and asked to give your name, and address. (If your first and/or last names are uncommon please spell them.)
6. You may then provide testimony.
  - a. Include only information relating to the above license application.
  - b. Include only information you have personally witnessed or seen.
  - c. Provide concise and relevant information detailing how this business has affected or may affect the peaceful enjoyment of your neighborhood.
  - d. If by the time you have the opportunity to testify, the information you wish to share has already been provided to the committee, you may state that you agree with the previous testimony. Redundant or repetitive testimony will not assist the committee in making its recommendation.
7. After giving your testimony, the members of the Licenses Committee and the licensee may ask questions regarding the testimony you have given or other factors relating to the license application.
8. Business Competition is not a valid basis for denial or non-renewal of a license.

**Please Note:** If you have submitted an objection to the above application your objection cannot be considered by the committee unless you personally testify at the hearing.

OCCUPANT	MAIL ADDRESS	CITY STATE ZIP
CURRENT OCCUPANT	3446 N BOOTH ST	MILWAUKEE, WI 53212-1602
CURRENT OCCUPANT	3446A N BOOTH ST	MILWAUKEE, WI 53212-1602
CURRENT OCCUPANT	3448 N BOOTH ST	MILWAUKEE, WI 53212-1602
CURRENT OCCUPANT	3450 N BOOTH ST	MILWAUKEE, WI 53212-1602
CURRENT OCCUPANT	3452 N PIERCE ST	MILWAUKEE, WI 53212-1627
CURRENT OCCUPANT	3452A N PIERCE ST	MILWAUKEE, WI 53212-1627
CURRENT OCCUPANT	3455 N FRATNEY ST, 1	MILWAUKEE, WI 53212-1746
CURRENT OCCUPANT	3455 N FRATNEY ST, 2	MILWAUKEE, WI 53212-1746
CURRENT OCCUPANT	3455 N FRATNEY ST, 3	MILWAUKEE, WI 53212-1746
CURRENT OCCUPANT	3455 N FRATNEY ST, 4	MILWAUKEE, WI 53212-1746
CURRENT OCCUPANT	3455 N PIERCE ST	MILWAUKEE, WI 53212-1626
CURRENT OCCUPANT	3455A N PIERCE ST	MILWAUKEE, WI 53212-1626
CURRENT OCCUPANT	3456 N BOOTH ST	MILWAUKEE, WI 53212-1602
CURRENT OCCUPANT	3456 N PIERCE ST	MILWAUKEE, WI 53212-1627
CURRENT OCCUPANT	3456A N BOOTH ST	MILWAUKEE, WI 53212-1602
CURRENT OCCUPANT	3459 N FRATNEY ST	MILWAUKEE, WI 53212-1746
CURRENT OCCUPANT	3459 N PIERCE ST	MILWAUKEE, WI 53212-1626
CURRENT OCCUPANT	3459A N PIERCE ST	MILWAUKEE, WI 53212-1626
CURRENT OCCUPANT	3460 N BOOTH ST	MILWAUKEE, WI 53212-1602
CURRENT OCCUPANT	3460 N PIERCE ST	MILWAUKEE, WI 53212-1627
CURRENT OCCUPANT	3461 N FRATNEY ST	MILWAUKEE, WI 53212-1746
CURRENT OCCUPANT	3463 N PIERCE ST	MILWAUKEE, WI 53212-1626
CURRENT OCCUPANT	3465 N FRATNEY ST	MILWAUKEE, WI 53212-1746
CURRENT OCCUPANT	3465A N FRATNEY ST	MILWAUKEE, WI 53212-1746
CURRENT OCCUPANT	3466 N PIERCE ST	MILWAUKEE, WI 53212-1627
CURRENT OCCUPANT	3469 N FRATNEY ST	MILWAUKEE, WI 53212-1746
CURRENT OCCUPANT	3469 N PIERCE ST	MILWAUKEE, WI 53212-1626
CURRENT OCCUPANT	3470 N PIERCE ST	MILWAUKEE, WI 53212-1627
CURRENT OCCUPANT	3473 N FRATNEY ST	MILWAUKEE, WI 53212-1746
CURRENT OCCUPANT	3475 N PIERCE ST	MILWAUKEE, WI 53212-1626
CURRENT OCCUPANT	3476 N PIERCE ST	MILWAUKEE, WI 53212-1627
CURRENT OCCUPANT	3477 N FRATNEY ST	MILWAUKEE, WI 53212-1746
CURRENT OCCUPANT	3477A N FRATNEY ST	MILWAUKEE, WI 53212-1746
CURRENT OCCUPANT	3479 N PIERCE ST	MILWAUKEE, WI 53212-1626
CURRENT OCCUPANT	3479A N PIERCE ST	MILWAUKEE, WI 53212-1626
CURRENT OCCUPANT	3480 N PIERCE ST	MILWAUKEE, WI 53212-1627
CURRENT OCCUPANT	3480A N PIERCE ST	MILWAUKEE, WI 53212-1627
CURRENT OCCUPANT	3481 N FRATNEY ST	MILWAUKEE, WI 53212-1746
CURRENT OCCUPANT	3481 N PIERCE ST	MILWAUKEE, WI 53212-1626
CURRENT OCCUPANT	3483 N PIERCE ST	MILWAUKEE, WI 53212-1626
CURRENT OCCUPANT	3487 N FRATNEY ST	MILWAUKEE, WI 53212-1746
CURRENT OCCUPANT	3489 N FRATNEY ST	MILWAUKEE, WI 53212-1746
CURRENT OCCUPANT	3493 N FRATNEY ST	MILWAUKEE, WI 53212-1746
CURRENT OCCUPANT	3494 N PIERCE ST	MILWAUKEE, WI 53212-1627
CURRENT OCCUPANT	3495 N FRATNEY ST	MILWAUKEE, WI 53212-1746
CURRENT OCCUPANT	3497 N FRATNEY ST	MILWAUKEE, WI 53212-1746

CURRENT OCCUPANT	3499 N FRATNEY ST	MILWAUKEE, WI 53212-1746
CURRENT OCCUPANT	609 E KEEFE AVE	MILWAUKEE, WI 53212-1612
CURRENT OCCUPANT	613 E KEEFE AVE	MILWAUKEE, WI 53212-1612
CURRENT OCCUPANT	617 E KEEFE AVE	MILWAUKEE, WI 53212-1612
CURRENT OCCUPANT	621 E KEEFE AVE	MILWAUKEE, WI 53212-1612
CURRENT OCCUPANT	621A E KEEFE AVE	MILWAUKEE, WI 53212-1612
CURRENT OCCUPANT	625 E KEEFE AVE	MILWAUKEE, WI 53212-1612
CURRENT OCCUPANT	717 E KEEFE AVE	MILWAUKEE, WI 53212-1614
CURRENT OCCUPANT	721 E KEEFE AVE	MILWAUKEE, WI 53212-1614

Blank Notice

Total Records: 55

Radius 250.0 feet and Center of Circle: 701 E Keefe Av



## APPLICATION AMENDMENT

Office of the City Clerk License Division

200 E. Wells Street, Room 105, Milwaukee, WI 53202 (414) 286-2238

Date: 8-9-2022

To the License Division of the City of Milwaukee:

I, Marcela Lagos, wish to amend my answer(s) on the application for a  
(full legal name)Food dealer restaurant at 701 E. Keefe Ave Milwaukee WI  
(type of license) (premises address, if applicable) 53212

by adding or amending the following information (complete only those sections being amended):

1. Answer to Question(s) # \_\_\_\_\_ should be: \_\_\_\_\_
2. Agent should be (full legal name): \_\_\_\_\_ Also complete 3, 4, 5 & 6
3. Date of birth should be: \_\_\_\_\_
4. Home address should be (include city/state/zip): \_\_\_\_\_
5. Phone number should be (include area code): \_\_\_\_\_
6. Driver's License Number/State ID Number should be: \_\_\_\_\_
7. Corporation/LLC name should be (full legal name): \_\_\_\_\_
8. Business name should be: \_\_\_\_\_
9. Premises address should be (include city/state/zip): \_\_\_\_\_
10. Business phone number should be (include area code): \_\_\_\_\_
11. Mailing address should be (include city/state/zip): \_\_\_\_\_
12. Email address should be: \_\_\_\_\_
13. Recycling/Salvaging/Towing: Location where vehicle will be parked should be (include city/state/zip): \_\_\_\_\_
14. Class B Tavern: Age Distinction should be: \_\_\_\_\_
15. Other: Making uncooked pastries amending to change application to food dealer retail.  
(Check with the License Division before submitting "Other" amendments using this form.)

  
 Signature of Licensee (Individual, Partner, or Agent of Corp/LLC)
Office Use Only: Application #: FREST 340498 Date: 8/9/22 Initials: YD To LC: \_\_\_\_\_LC Email: ☐MPD ☐NS ☐HD Initials: \_\_\_\_\_

New Food # 341071

OFFICE OF THE CITY CLERK, LICENSE DIVISION  
CITY HALL, 200 E. WELLS ST, ROOM 105, MILWAUKEE, WI 53202  
(414) 286-2238 • [license@milwaukee.gov](mailto:license@milwaukee.gov) • [www.milwaukee.gov/license](http://www.milwaukee.gov/license)

Legal Entity Name (Individual, Partnership, Corp or LLC): La Mendocina LLC

Business Name: La Mendocina

Premises (Shared Kitchen) Address: 701 E. Keefe Ave Milwaukee, WI 53212

**BUSINESS OPERATIONS**

☐ Base for Mobile Vendor (Peddler) ☐ Base for Temporary Event ☒ Caterer ☐ Other: \_\_\_\_\_

**FOOD PROCESSING**

What type of food items will be sold?

☒ **Restaurant Items (meals):**  
MEALS include, but are not limited to, chicken, ribs, sandwiches, roasted corn, baked potatoes, hot dogs, brats, tacos, nachos w/ cheese and meat, French fries, cooked or deep fried vegetables/fruit, cooked cheese curds, corn dogs, egg rolls, salads.  
What percent of food items will be meals? 100 %

☐ **Retail Items (snacks and beverages):**  
RETAIL items include, but are not limited to, ice cream/soft serve, lemonade, snow cones, coffee, espresso, cappuccino, tea, fruit juice, smoothies, candy, dispensed soda, fruit cups, bakery, cookies, kettle corn, cotton candy, funnel cakes, fritters, tortilla chips w/ cheese.  
What percent of food items will be retail? \_\_\_\_\_ %

All Applicants: Submit a menu or a list of food items sold.

Will any food processing be done at the shared kitchen? ☐ No ☒ Yes  
Processing is defined as assembling, grinding, cutting, mixing, baking, coating, stuffing, packing, bottling, grilling, canning, extracting, fermenting, distilling, pickling, freezing, drying, smoking, or packaging.

Will any food that requires temperature control be sold? ☐ No ☒ Yes  
(includes dairy products such as milk, cheese, and ice cream, fish, shellfish, meat, poultry)

If yes, list the types of food items: Beef - Poultry - Vegetables

**PLAN OF OPERATION**

a. How are grounds kept clean? ☒ Sweep ☐ Pressure Wash ☐ Pick Up Litter ☐ Other: \_\_\_\_\_

b. How often will grounds be cleaned? ☒ Daily ☐ Weekly ☐ As Needed ☐ Monthly ☐ Other: \_\_\_\_\_

c. Grounds cleaned by: ☐ Licensee ☐ Building Owner ☒ Employees ☒ Hired Maintenance ☐ Other: \_\_\_\_\_

d. How are noise issues prevented and/or addressed? ☐ Security ☒ Call Police ☐ Signs Posted ☐ Other: \_\_\_\_\_

e. Will a sound amplification system be used? ☒ No ☐ Yes If yes, describe: \_\_\_\_\_

f. Number of Garbage Cans: Inside: 4 Locations: By prepping area and sinks  
Outside: 2 Locations: Two dumpster at back door

g. Name of solid waste contractor: ☐ Advanced Disposal ☒ Waste Management ☐ Other: \_\_\_\_\_

h. Is there a loading zone? ☐ No ☒ Yes Back door. Inside kitchen

i. Are there security cameras? ☐ No ☒ Yes If yes, how many? 3 and list locations: Inside Restaurant (2)

But I only use the  
kitchen

- La Mendocina LLC  
- 701 Keefe Ave  
- Milwaukee, WI 53212

License App  
7-23-22

(3)

ccf-foodsharedapp 4/18/19

## PREMISES DESCRIPTION

- a. Are other businesses operating in the same building? to ☒ Yes If Yes, Describe: Shared Kitchen
- b. Identify all area(s) of the premises that will be used in operating this business (include areas used only for storage):  
☒ 1<sup>st</sup> Floor ☐ 2<sup>nd</sup> Floor ☐ Basement Storage Other: Describe: \_\_\_\_\_
- c. Describe Location: ☐ Major Thoroughfare ☒ Secondary Street ☐ Other: Keefe Ave
- d. Nearest Major Cross Street: Humbolt
- e. Describe Building: ☒ Free Standing Building ☐ Strip Mall ☐ Other: \_\_\_\_\_
- f. Describe Premises Structure: ☒ Single Story ☐ Multi-Story - # of Stories \_\_\_\_\_ ☐ Other: \_\_\_\_\_
- g. Describe Surrounding Area: ☐ Commercial ☐ Residential ☒ Industrial ☐ Other: \_\_\_\_\_
- h. Building Owner Name: Bryan and Miriam Atusky Phone Number: 414 906-9000  
Building Owner Address: 701 E. Keefe Ave Milwaukee WI 53212

## SHARED KITCHEN AGREEMENT

SERVICES/FACILITIES (check all that will be used at the shared kitchen):

- |  |  |   |
|--|--|---|
| <input checked="" type="checkbox"/> Dry food storage             | <input checked="" type="checkbox"/> Handwashing facilities                   | <input checked="" type="checkbox"/> Refrigeration / frozen food storage |
| <input checked="" type="checkbox"/> Restroom facilities          | <input checked="" type="checkbox"/> Equipment / utensil storage              | <input type="checkbox"/> Warewashing facilities (3 compartment sink)    |
| <input type="checkbox"/> Chemical storage                        | <input checked="" type="checkbox"/> Facilities to prepare or package food    | <input checked="" type="checkbox"/> Utilities: electrical connection    |
| <input checked="" type="checkbox"/> Garbage / recycling disposal | <input checked="" type="checkbox"/> Potable water connection                 | <input type="checkbox"/> Peddlers: overnight parking                    |
| <input type="checkbox"/> Waste water tank disposal facilities    | <input type="checkbox"/> Waste water tank disposal facilities w/ grease trap |   |

## HOURS OF OPERATION AT THE SHARED KITCHEN

DAY OF WEEK	Start Time (Include am / pm)	End Time (Include am / pm)
Sunday	Closed	
Monday	Closed	
Tuesday	Closed	
Wednesday	Closed	
Thursday	12:00 pm	3:00 pm
Friday	8:00 am	2:00 pm
Saturday	<del>Closed</del>	

I, the shared kitchen user, will utilize the services/facilities at this kitchen during the days/times indicated above. I will notify the City Clerk's Office (License Division) prior to discontinuing use of the kitchen. I will maintain an updated schedule of use of the kitchen with the City Clerk's Office (License Division) and keep a written log of the dates/times I am actually at the kitchen. (Peddlers: I will report to the facility at least once each operating day for cleaning and servicing.)

Print Name(s):

Marcela Lagos  
Sole Proprietor, Partners or 20% or More Shareholder

Signature(s):

Lagos

Date:

7-23-22

## FOR COMPLETION BY THE SHARED KITCHEN OWNER

Kitchen Owner's Business Name:

The Riverwest Filling Station

I, the shared kitchen owner, acknowledge I have entered into an agreement with the user to utilize the services/facilities at this kitchen and agree to provide the user access to the kitchen on the days/times indicated above. I will maintain a written log of the dates/times the user is actually at the facility. I will promptly notify the City Clerk's Office (License Division) if this agreement is terminated or if the user fails to use the kitchen on the days/times they have indicated. I acknowledge that as the primary operator of the kitchen I am responsible for the maintenance and sanitation of the kitchen, and as such, I acknowledge I am responsible for maintaining the services/facilities being provided to the user in compliance with the Wisconsin Food Code.

Print Name:

Bryan Atusky

Signature:

Atusky

Date:

7/23/22



LAGOS  
HINDS  
SOUTH PARKING LOT

La Mendocina  
701 E. Keef Ave

7/25/20

30 FT

1200 sq ft  
40 ft

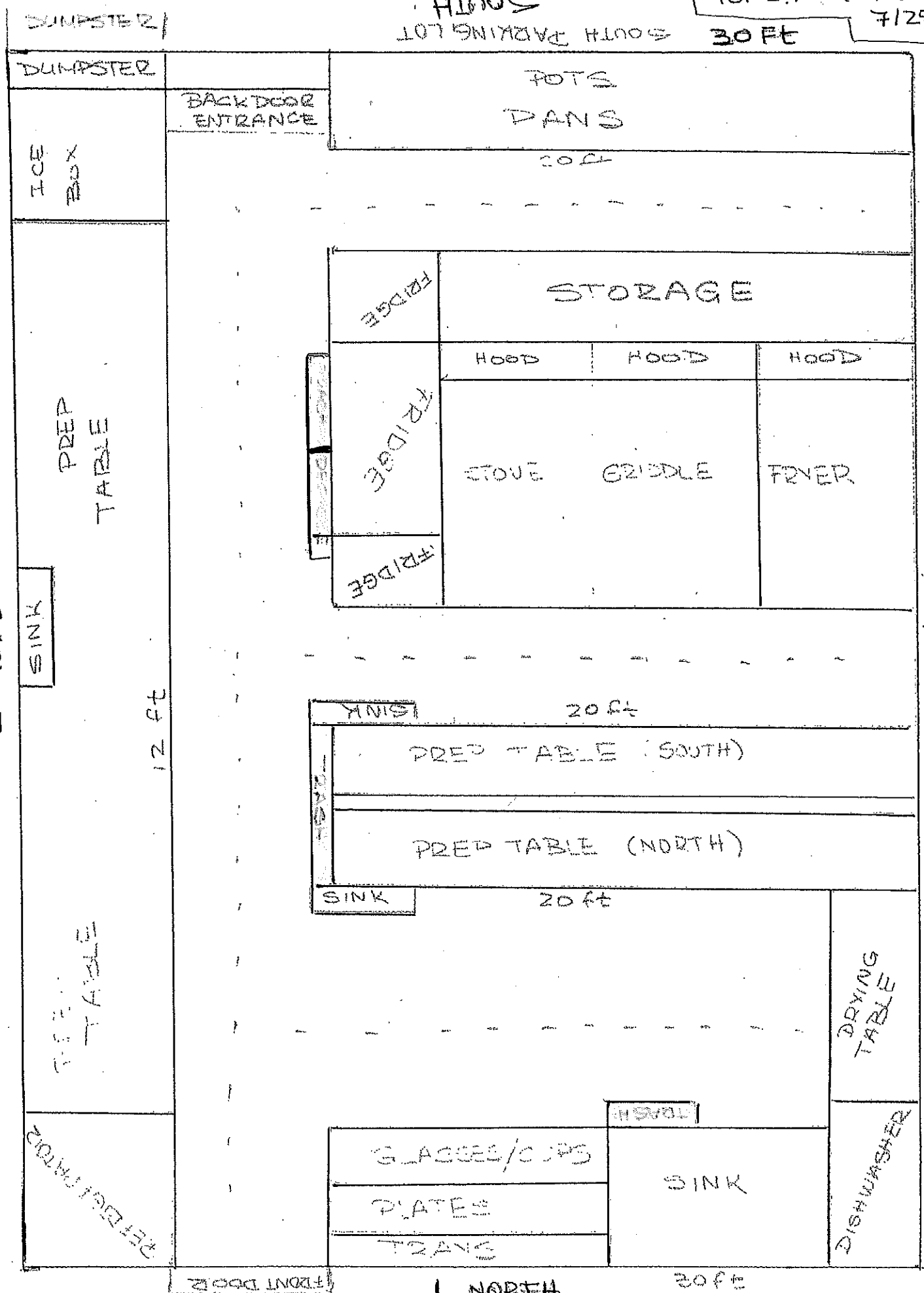

↓ NORTH  
KEEF ST



# Menu:

Beef Empanadas

Chicken Empanadas

Corn Empanadas

Spinach and Cheese Empanadas