



# Certificate of Appropriateness

Milwaukee Historic Preservation Commission/200 E. Wells Street/Milwaukee, WI 53202/phone 414-286-5712/fax 414-286-3004

<b>Property</b>	2563 N. 47TH ST.	N 47 <sup>th</sup> Bungalows HD
<b>Description of work</b>	Replace concrete portion of front steps to match existing.	
<b>Date issued</b>	5/24/2022	PTS ID 115263 COA: PORCH REPAIR

In accordance with the provisions of Section 320-21 (11) and (12) of the Milwaukee Code of Ordinances, the Milwaukee Historic Preservation Commission has issued a certificate of appropriateness for the work listed above. The work was found to be consistent with preservation guidelines. The following conditions apply to this certificate of appropriateness:

**If repointing is required during the project, use Type N mortar or softer.**

New mortar must match the original mortar in terms of color, texture, grain size, joint width, and joint finish/profile. The compressive strength of the repointing mortar shall be equal or less than the compressive strength of the original mortar and surrounding brick or stone. The replacement mortar shall contain approximately the same ingredient proportions of the original mortar. Mortar that is too hard is subject to premature failure and could damage the masonry. See the city's books *As Good As New* or *Good for Business*, Masonry Chapters, for more information. In most cases, this means a lime mortar with natural hydraulic cement rather than Portland cement. No joint of a width less than 3/8" may be cleaned of damaged/decomposed mortar with power disc grinders. No over-cutting of the joints is permitted. Remove decomposed mortar back into the wall 2.5 times the height of the joint before repointing. When installing new flashing at a masonry feature, the flashing must be stepped or cut into the mortar joints. The bricks may not be cut to install flashing at an angle.

New brick/stone/terra cotta must match as closely as possible the color texture, size, and finish of the original.

A sample panel of the masonry materials and their mortar must be reviewed and approved by HPC staff prior to general installation of the material. UNDER NO CIRCUMSTANCES SHALL UNPAINTED MASONRY BE PAINTED, BE GIVEN A WATERPROOFING TREATMENT, OR CLEANED BY ABRASIVE MEANS; THIS STATEMENT SUPERSEDES ANY OTHER WORDING IN THIS DOCUMENT INDICATING THE CONTRARY.

All work must be done in a craftsman-like manner, and must be completed within one year of the date this certificate was issued. Staff must approve any changes or additions to this certificate before work begins. Work that is not completed in accordance with this certificate may be subject to correction orders or citations. If you require technical assistance, please contact [HPC@milwaukee.gov](mailto:HPC@milwaukee.gov).

If permits are required, you are responsible for obtaining them from the Milwaukee Development Center. If you have questions about permit requirements, please consult the Development Center's web site, [www.milwaukee.gov/build](http://www.milwaukee.gov/build), or call (414) 286-8210.



City of Milwaukee Historic Preservation Staff

Copies to: Development Center, Ald. Russell Stamper II, Contractor

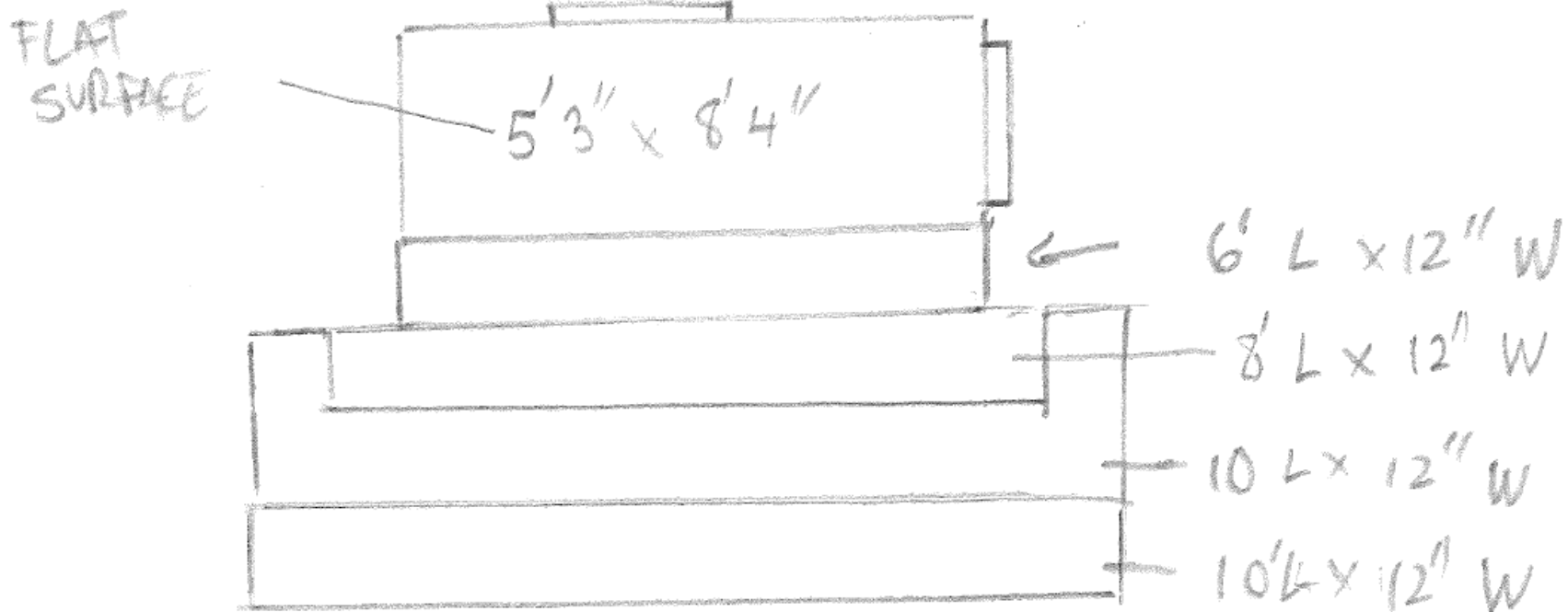

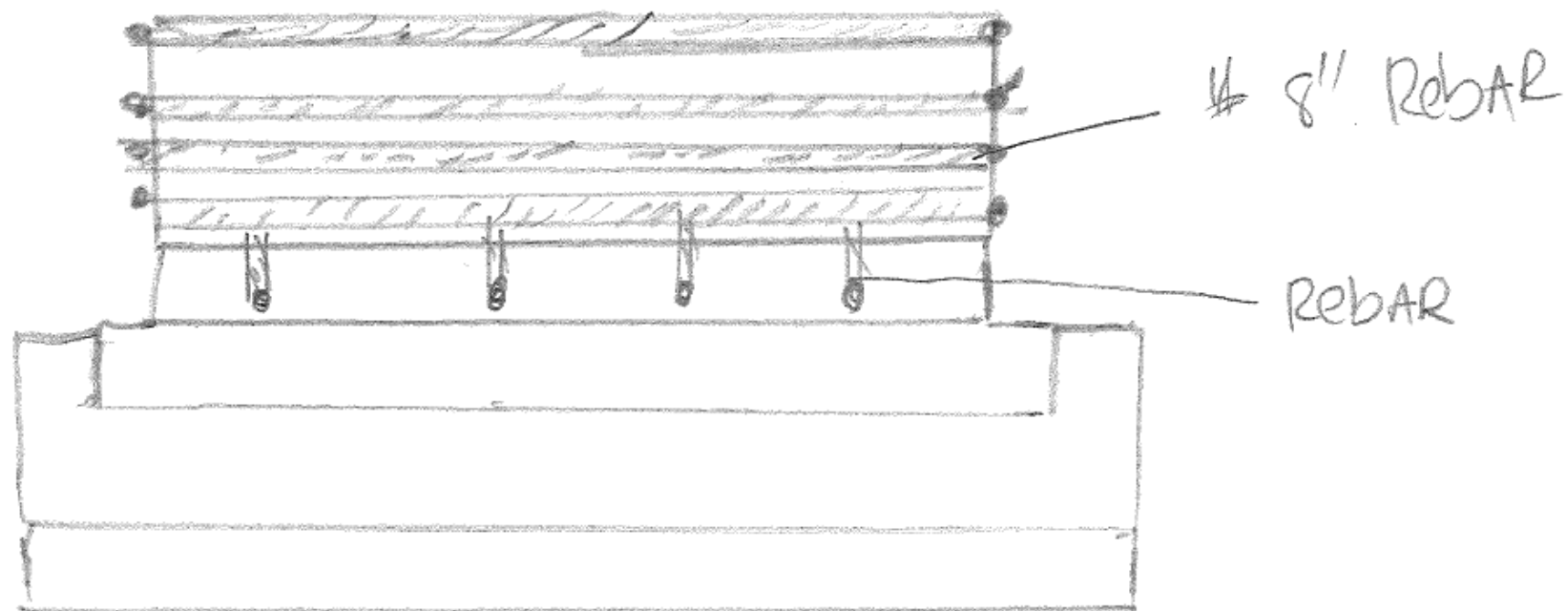

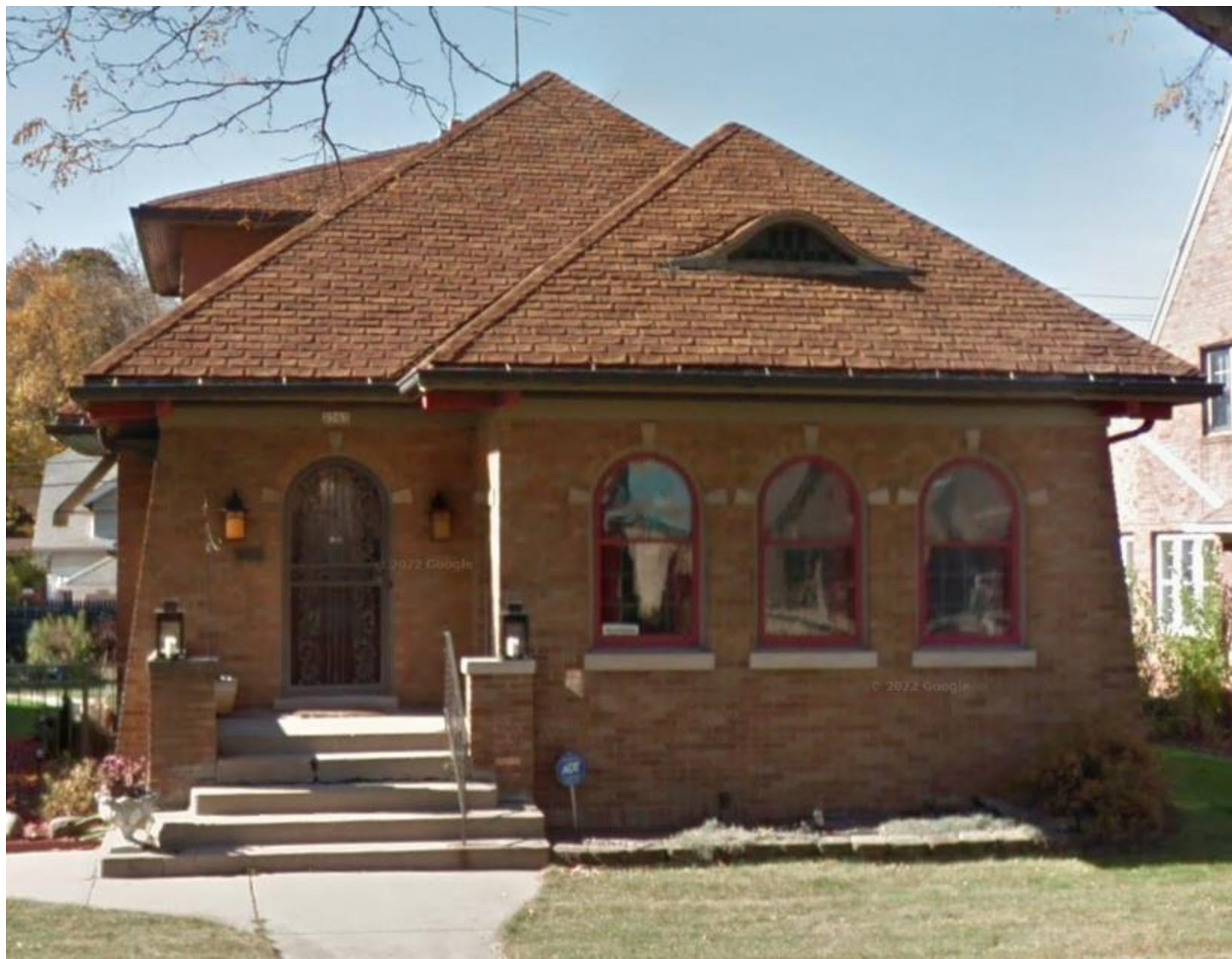

Current conditions