



# Certificate of Appropriateness

Milwaukee Historic Preservation Commission/841 N. Broadway/Milwaukee, WI 53202/phone 414-286-5722

**Property**

626 E. NORTH AV.

**Description of work**

American Legion Star was originally installed in Kilbourn Reservoir Park in 1941. Flowers were replaced with colored glass set into concrete in 2010. The art project proved unsuccessful. The colored glass units have failed with the stones separating from the concrete base and the surfaces crumbling. A different product will be used that has an even textured, colored granite granules surface. Primary colors will be used and the application should be brighter and more visible than the original stones.

**Date issued**

05/06/2022

CC File # 220093

PTS ID 115260 COA Reinstall American Legion Star Kilbourn Reservoir Park

In accordance with the provisions of Section 320-21 (11) and (12) of the Milwaukee Code of Ordinances, the Milwaukee Historic Preservation Commission has issued a certificate of appropriateness for the work listed above. The work was found to be consistent with preservation guidelines. The following conditions apply to this certificate of appropriateness:

Follow the manufacturer's instructions.

All work must be done in a craftsman-like manner, and must be completed within one year of the date this certificate was issued. Staff must approve any changes or additions to this certificate before work begins. Work that is not completed in accordance with this certificate may be subject to correction orders or citations. If you require technical assistance, please contact Carlen Hatala of the Historic Preservation staff as follows: Phone: (414) 286-5722 E-mail: carlen.hatala@milwaukee.gov.

If permits are required, you are responsible for obtaining them from the Milwaukee Development Center. If you have questions about permit requirements, please consult the Development Center's web site, [www.milwaukee.gov/build](http://www.milwaukee.gov/build), or call (414) 286-8210.



---

City of Milwaukee Historic Preservation Staff

Copies to: Development Center, Ald. Milele Coggs, Contractor

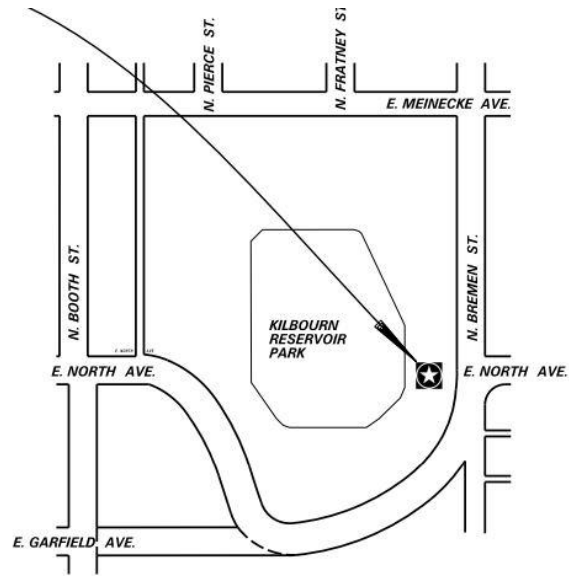

### LOCATION MAP

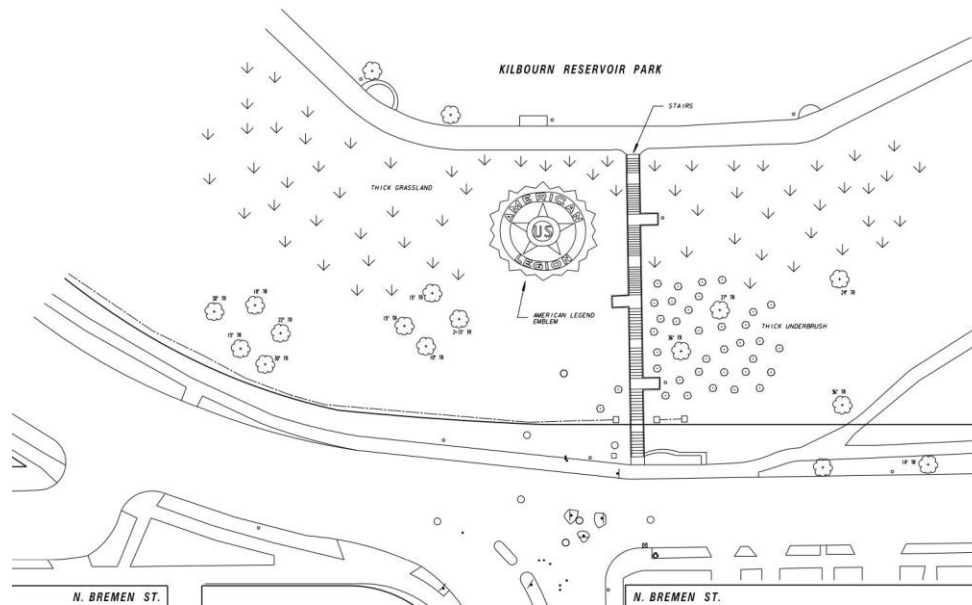



Current Condition

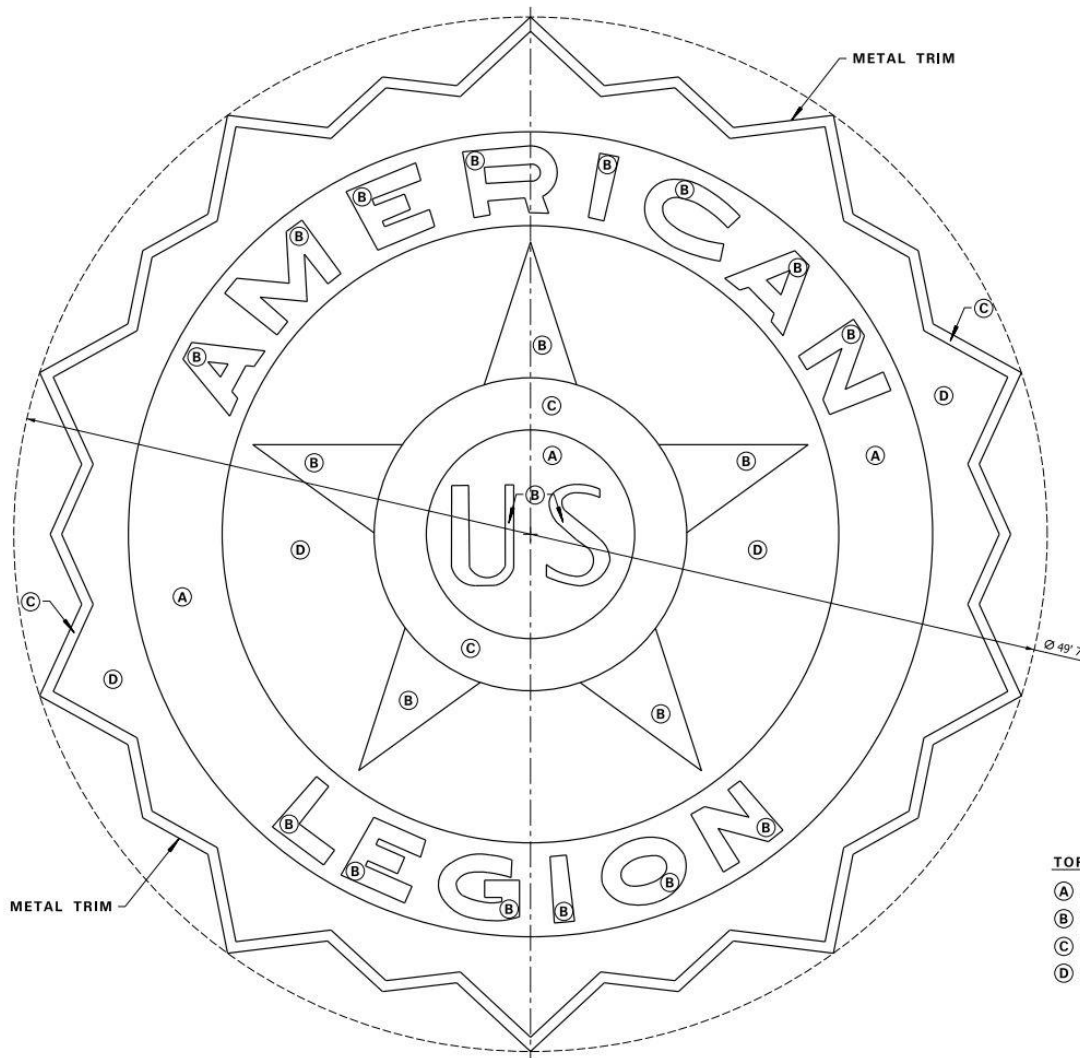

#### NOTES

FILL TRIM WITH CONCRETE TO A LEVEL, WORKABLE BASE LEAVING ENOUGH ROOM FOR QUARTZ TOP FINISH.

USE TORGINOL QUARTZ 25-A GRADE IN THE COLORS INDICATED ON THIS SHEET OR APPROVED EQUIVALENT PRODUCTS.

APPLY QUARTZ SYSTEM WITH RECOMMENDED BONDING AGENTS, PRIMERS, SEALERS, BASE COATS AND TOP COATS AS PER MANUFACTURER'S INSTRUCTIONS FOR UV-STABLE AND WEATHERPROOF COLORED QUARTZ FINISH.

REPLACE ANY DISTURBED VEGETATION, DAMAGED FENCING OR DAMAGED CONCRETE AFTER CONSTRUCTION TO ORIGINAL CONDITION PRIOR TO CONSTRUCTION.

#### TORGINOL QUARTZ

- A Q1110 - BLUE
- B Q1710 - YELLOW
- C Q1610 - RED
- D Q1430 - RAINFOREST

NO.	BY	REVISION	DATE
1	CKN		
2	CKN		
3	SA		
4	4/1/2002		
5	N/A		
6	WT450225100		
7	55-2022		

<b>Milwaukee Water Works</b> Department of Public Works		<b>Water Engineering</b> Department of Public Works	
<b>KILBOURN PARK IMPROVEMENTS</b>			
CONSTRUCTION PLAN			
DESIGNED BY: CKN CHECKED BY: SA DATE: 4/1/2002 SCALE: N/A PROJECT NO: WT450225100 OFFICIAL NOTICE: 55-2022	APPROVED: <i>[Signature]</i> DATE: <i>[Signature]</i> PROJECT NO: WT450225100 OFFICIAL NOTICE: 55-2022	DESIGNED BY: CKN CHECKED BY: SA DATE: 4/1/2002 SCALE: N/A PROJECT NO: WT450225100 OFFICIAL NOTICE: 55-2022	APPROVED: <i>[Signature]</i> DATE: <i>[Signature]</i> PROJECT NO: WT450225100 OFFICIAL NOTICE: 55-2022



# ■ QUARTZ™

TORGINOL® QUARTZ, is produced using some of the finest uniformly shaped and sized quartz granules on Earth. This unique product is brilliantly color-coated with an advanced resin system and high-quality colorfast pigments. QUARTZ is exceptionally resilient to harsh chemicals and UV rays, providing optimal durability and performance in the most demanding environments. QUARTZ can be applied to achieve many different textures and minimize slip and fall injuries.

## PHYSICAL PROPERTIES

<b>Hardness</b>	Mohs Scale of Hardness	6.5 - 7
<b>Bulk Density</b>	Aggregate Unit Weight (ASTM C29)	90 - 105 LB / FT <sup>3</sup>
<b>Specific Gravity</b>	Relative Density (ASTM C128-07a)	2.65
<b>Moisture Content</b>	Evaporable Moisture (ASTM C566-97)	< 0.5%
<b>Color (ΔE ≤ 0.5)</b>	Color Tolerance (ASTM D2244)	Pass
<b>Colorfastness / UV Stability</b>	Xenon Arc Light (ASTM G155)	Pass
<b>Weatherability</b>	Xenon Arc Light (ASTM G155)	Pass
<b>Melting Point</b>	Degrees Fahrenheit	3,100 ° F

## TYPICAL QUARTZ SYSTEM

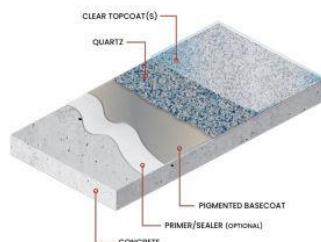

For best results, a clear topcoat is recommended to fully encapsulate QUARTZ and provide a durable wearing surface.

## SYSTEM COMPATIBILITY

Lab tested resin system compatibility:

- Epoxies
- Polyurethanes
- Polyureas
- Polyaspartics
- MMAs
- Waterborne resins
- Solvent-based resins
- And more...

DISCLAIMER: The information set forth in this Product Data Sheet represents typical properties of the product described; the information and the typical values are not specifications. Torginol, Inc. makes no representation or warranty concerning the products, expressed or implied, by this Product Data Sheet.



4617 South Taylor Drive  
Sheboygan, WI 53081 | USA  
(920) 694-4800  
service@torginol.com | www.torginol.com

## CHEMICAL ANALYSIS

Chemical	Percent, %
SiO <sub>2</sub> (Silicon Dioxide)	99.800
Al <sub>2</sub> O <sub>3</sub> (Aluminium Oxide)	0.040
Fe <sub>2</sub> O <sub>3</sub> (Iron Oxide)	0.015
TiO <sub>2</sub> (Titanium Dioxide)	< 0.010
CaO (Calcium Oxide)	< 0.010
MgO (Magnesium Oxide)	< 0.010
Na <sub>2</sub> O (Sodium Oxide)	< 0.010
K <sub>2</sub> O (Potassium Oxide)	< 0.010

## CHEMICAL RESISTANCE

*Liquid immersion for 18 hours in each chemical*

Chemical [Concentration %]	Reaction
Aluminum Sulfate [25%]	None
Ammonium Hydroxide [28%]	None
Chlorine Bleach [15%]	None
Hydrochloric Acid [100%]	None
Industrial Detergent [50%]	None
Mineral Spirits [100%]	None
Sodium Carbonate [40%]	None
Tricloro-s-triazene [10%]	None
Trisodium Phosphate [40%]	None
Water [100%]	None
Xylene [100%]	None

## COVERAGE RATE GUIDELINES

Quartz Grade	Coverage Area
40-5 Broadcast Grade	1/2 LB - 1 LB/SF (Double Broadcast)
25-A Trowel Grade	1 LB - 2 LB/SF (1/4" Thickness)
Coverage rates may vary depending on customer preferences and application techniques.	

This is the product that will be used to replace the colored glass

## PACKAGING

<b>Unit Packaging</b>	50 lb bags (22.68 kg) <i>Multi-wall kraft paper bags</i>
<b>Full Pallets</b>	49 bags 2,450 lb net weight 2,500 lb gross weight
<b>Full Truckloads</b>	833 bags / 17 pallets 41,650 lb net weight
<b>Freight / Shipping</b>	Class 50

## SYSTEM ADVANTAGES

- Superior colorfastness / UV stability
- Excellent abrasion and chemical resistance
- Optimal grain shape and size uniformity
- Perfect for heavy duty environments
- Outstanding slip-resistance qualities
- Customizable to complement any décor
- Lab-tested resin system compatibility
- Custom color matching & blending options
- Custom packaging & labeling options
- No minimum order quantities
- Over 60 in stock color styles

## GRADE PROFILE



### 40-S GRADE

<b>Grain Size</b>	40 Mesh
<b>Grain Shape</b>	Spherical
<b>Typical Application</b>	Broadcast



### 25-A GRADE

<b>Grain Size</b>	25 Mesh
<b>Grain Shape</b>	Angular
<b>Typical Application</b>	Trowel

## COLOR INDEX

Q1010 WHITE	Q1015 EGG SHELL	Q1020 BLACK	Q1110 BLUE	Q1115 COBALT	Q1120 NAVY	Q1130 SLATE	Q1140 TEAL	Q1150 ASPEN	Q1160 CAPRI
Q1210 IVORY	Q1215 BUTTER	Q1220 BEIGE	Q1230 CAPPUCCINO	Q1240 TAN	Q1250 TAUPE	Q1260 SIENNA	Q1270 BROWN	Q1280 BUFF	Q1290 TOFFEE
Q1310 ASH	Q1320 SMOKE	Q1330 GRAVEL	Q1340 CHARCOAL	Q1350 FLINT	Q1410 CLOVER	Q1420 VINEYARD	Q1430 RAINFOREST	Q1440 LEMONGRASS	Q1510 GINGER
Q1520 ORANGE	Q1610 RED	Q1620 CRIMSON	Q1630 BLUSH	Q1640 APRICOT	Q1650 BORDEAUX	Q1710 YELLOW	Q1720 MUSTARD	Q1810 PLUM	Q1820 LOGANBERRY
Q1000 NATURAL	Q3010 SILVER	Q3040 COPPER							

The colors selected are blue, rainforest (green), red and yellow.

WARNING: This product contains crystalline silica / quartz, which can cause silicosis (an occupational lung disease) and lung cancer. For detailed information on the potential health effects of crystalline silica / quartz, see the TORGINOL® QUARTZ - Safety Data Sheet.