



CITY OF MILWAUKEE
OFFICE OF THE CITY CLERK

Friday, December 17, 2021

COMMITTEE MEETING NOTICE

AD 07

PHULARA, Govind, Agent
CAPITOL KHAPTAD INC
2217 N 61st St
Milwaukee, WI 53213

You are requested to attend a virtual hearing to be held on:

Wednesday, January 05, 2022 at 02:20 PM

Regarding: Your Class A Fermented Malt Beverage Retailer's; Extended Hours Establishments (for food dealer only) and Food Dealer License Applications Requesting to Open at 12:00 AM Sun- Sat and to Close at 11:59 PM Sun - Thu and at 11:15 PM Fri & Sat as agent for "CAPITOL KHAPTAD INC" for "Capital Pantry" at 2483 W CAPITOL DR.

This meeting will be held via GoToMeeting. Please see the enclosed best practices document for further instructions. The access code is <https://global.gotomeeting.com/join/397740933> If you wish to call in, please call **+1 (408) 650-3123** and use Access Code: **397-740-933**

There is a possibility that your application may be denied for one or more of the following reasons: The recommendation of the committee regarding the application shall be based on evidence presented at the hearing. Per MCO 85-2.7-4, probative evidence concerning whether or not a new license should be granted may be presented on the following subjects: whether or not the applicant meets the municipal requirements, the appropriateness of the location and premises where the licensed premises is to be located and whether use of the premises for the purposes or activities permitted by the license would tend to facilitate a public or private nuisance or create undesirable neighborhood problems such as disorderly patrons, unreasonably loud noise, litter, and excessive traffic and parking congestion. Probative evidence relating to these matters may be taken from the plan of operation submitted with the license application, if any, but shall not include the content of any music. Evidence regarding the fitness of the location of the premises to be maintained as the principal place of business, including but not limited to whether there is an overconcentration of businesses of the type for which the license is sought; whether the proposal is consistent with any pertinent neighborhood business or development plans, or the location's proximity to areas where children are typically present. The applicant's record in operating similarly licensed premises; and whether or not the applicant has been charged with or convicted of any felony, misdemeanor, municipal offense or other offense, the circumstances of which substantially relate to the activity to be permitted by the license being applied for or any other factor which reasonably relates to the public health, safety or welfare may also be considered. See attached police report or correspondence.

Notice for applicants with warrants or unpaid fines:

Proof of warrant satisfaction or payment of fines must be submitted at the hearing on the above date and time. Failure to comply with this requirement may result in a delay of the granting/denial of your application.

Failure to attend this meeting may result in the denial of your license. Individual applicants and partnership applicants must attend or attend by an attorney. The agent or attorney for corporate or limited liability applicants must attend. If you wish to do so and at your own expense, you may be accompanied by an attorney of your choosing to represent you at this hearing.

You will be given an opportunity to speak on behalf of the application and to respond and challenge any charges or reasons given for the denial. No petitions can be accepted by the committee, unless the people who signed the petition attend the virtual hearing and are willing to testify. You may present witnesses under oath and you may also confront and cross-examine opposing witnesses under oath. If you have difficulty with the English language, you should request an interpreter attend the meeting with you, at your expense, so that you can answer questions and participate in your hearing.

PLEASE NOTE: Upon reasonable notice, efforts will be made to accommodate the needs of disabled individuals through sign language interpreters or other auxiliary aids. For additional information or to request this service, contact the Council Services Division ADA Coordinator at (414) 286-2998, Fax - (414) 286-3456, TDD - (414) 286-2025.

JIM OWCZARSKI, CITY CLERK

BY: _____

Jim Cooney
License Division Manager

If you have questions regarding this meeting, please contact the staff assistant, Yadira Melendez at (414) 286-2775 or stasst5@milwaukee.gov



**CITY OF MILWAUKEE
OFFICE OF THE CITY CLERK**

Friday, December 17, 2021

COMMITTEE MEETING NOTICE

AD 07

PHULARA, Govind, Agent
CAPITOL KHAPTAD INC
2483 W CAPITOL DR
Milwaukee, WI 53206

You are requested to attend a virtual hearing to be held on:

Wednesday, January 05, 2022 at 02:20 PM

Regarding: Your Class A Fermented Malt Beverage Retailer's; Extended Hours Establishments (for food dealer only) and Food Dealer License Applications Requesting to Open at 12:00 AM Sun- Sat and to Close at 11:59 PM Sun - Thu and at 11:15 PM Fri & Sat as agent for "CAPITOL KHAPTAD INC" for "Capital Pantry" at 2483 W CAPITOL DR.

This meeting will be held via GoToMeeting. Please see the enclosed best practices document for further instructions. The access code is <https://global.gotomeeting.com/join/397740933> If you wish to call in, please call **+1 (408) 650-3123** and use Access Code: **397-740-933**

There is a possibility that your application may be denied for one or more of the following reasons: The recommendation of the committee regarding the application shall be based on evidence presented at the hearing. Per MCO 85-2.7-4, probative evidence concerning whether or not a new license should be granted may be presented on the following subjects: whether or not the applicant meets the municipal requirements, the appropriateness of the location and premises where the licensed premises is to be located and whether use of the premises for the purposes or activities permitted by the license would tend to facilitate a public or private nuisance or create undesirable neighborhood problems such as disorderly patrons, unreasonably loud noise, litter, and excessive traffic and parking congestion. Probative evidence relating to these matters may be taken from the plan of operation submitted with the license application, if any, but shall not include the content of any music. Evidence regarding the fitness of the location of the premises to be maintained as the principal place of business, including but not limited to whether there is an overconcentration of businesses of the type for which the license is sought; whether the proposal is consistent with any pertinent neighborhood business or development plans, or the location's proximity to areas where children are typically present. The applicant's record in operating similarly licensed premises; and whether or not the applicant has been charged with or convicted of any felony, misdemeanor, municipal offense or other offense, the circumstances of which substantially relate to the activity to be permitted by the license being applied for or any other factor which reasonably relates to the public health, safety or welfare may also be considered. See attached police report or correspondence.

**Notice for applicants with
warrants or unpaid fines:**

Proof of warrant satisfaction or payment of fines must be submitted at the hearing on the above date and time. Failure to comply with this requirement may result in a delay of the granting/denial of your application.

Failure to attend this meeting may result in the denial of your license. Individual applicants and partnership applicants must attend or attend by an attorney. The agent or attorney for corporate or limited liability applicants must attend. If you wish to do so and at your own expense, you may be accompanied by an attorney of your choosing to represent you at this hearing.

You will be given an opportunity to speak on behalf of the application and to respond and challenge any charges or reasons given for the denial. No petitions can be accepted by the committee, unless the people who signed the petition attend the virtual hearing and are willing to testify. You may present witnesses under oath and you may also confront and cross-examine opposing witnesses under oath. If you have difficulty with the English language, you should request an interpreter attend the meeting with you, at your expense, so that you can answer questions and participate in your hearing.

PLEASE NOTE: Upon reasonable notice, efforts will be made to accommodate the needs of disabled individuals through sign language interpreters or other auxiliary aids. For additional information or to request this service, contact the Council Services Division ADA Coordinator at (414) 286-2998, Fax - (414) 286-3456, TDD - (414) 286-2025.

JIM OWCZARSKI, CITY CLERK

BY: _____

**Jim Cooney
License Division Manager**

If you have questions regarding this meeting, please contact the staff assistant, Yadira Melendez at (414) 286-2775 or stas5@milwaukee.gov

Roman, Carmen

From:
Sent: Tuesday, November 16, 2021 12:08 PM
To: License
Subject: 2483 w Capitol

Categories: CR working on

REDACTED RECORD

You don't often get email from ; is important

Hello, I'd like to object to the following store having extended hours, as i don't see how this helps our neighborhood, and might actually cause more issues. I live at . Thanks for your consideration.

MILWAUKEE POLICE DEPARTMENT
LICENSE INVESTIGATION UNIT

CRIMINAL RECORD/ORDINANCE VIOLATION/INCIDENTS
SYNOPSIS

DATE: 01/06/2020
LICENSE TYPE: AMALT
NEW:
RENEWAL: X

No. 319193
Application Date: 12/30/2020
Expiration Date:

License Location: 2483 W Capitol Dr
Business Name: Capitol Pantry

Licensee/Applicant: Benipal, Simranjeet S
(Last Name, First Name, MI)
Date of Birth: 12/28/1979

This report is written by Police Officer David NOVAK, assigned to the License Investigation Unit, Days.

The Milwaukee Police Department's investigation regarding this application revealed the following:

1. On 07/13/2009 at 4:44PM, the applicant was cited by Milwaukee Police Department at 408 W North Av for:

Charge: Sale Of Cigarettes To Minor/Underage
Finding: Guilty – Milwaukee Municipal Court
Sentence: \$160.00 Penalty
Date: 09/18/2009
Case#: 09112298

2. On 06/11/2011 at 1:08PM, the applicant was cited by Milwaukee Police Department at 408 W North Av for:

Charge1: Sale Of Cigarettes To Minor/Underage
Charge2: Cigarette and Tobacco License Required

Finding1-2: Guilty – Milwaukee Municipal Court

Sentence1: \$171.00 Penalty
Sentence2: \$113.00 Penalty

Date1-2: 08/04/2011

Case#1: 11078718
Case#2: 11078719

=====

3. On 07/13/2013 a 16 year old, working in conjunction with Milwaukee police on the Wisconsin WINS tobacco initiative, was able to purchase a cigar from the cashier at 2483 West Capitol Drive (Capitol Pantry). The applicant was cited.

Charge: Sale of Cigarettes to Minor/Underage
Finding: Guilty
Sentence: \$171.00 fine
Date: 09/06/2013
Case: 13075003

4. On 07/19/2014 a 17 year old, working in conjunction with Milwaukee police on the Wisconsin WINS Youth Tobacco Initiative, was able to purchase two Swisher Sweet brand cigars from the cashier at 2483 West Capitol Drive (Capitol Pantry). The officer discovered during his interaction with the clerk, Prabhjot Singh, that he did not possess a valid class D Operators license. The applicant was cited for Sale of Cigarettes to Minor/Underage and Responsible Person Required on Premises.

Charge 1: Sale of Cigarettes to Minor/Underage
2: Responsible Person Required on Premises
Finding 1: Guilty
2: Dismissed without prejudice
Sentence 1: \$260.00 fine
Date: 12/04/2014
Case 1: 14054149
2: 14054150

5. On 06/21/2018 officers conducted a license premise check at Capitol Pantry, 2483 W. Capitol Dr. Since this store has a Class A Malt Beverage license the officer asked to see the clerks Class D bartenders license. The clerk stated he did not have one and there were no other employees in the store. While the officers were on scene the applicant arrived stating he had just gone to McDonalds and thought it would be okay. The applicant was cited for Responsible Person on Premises Required.

Charge: Responsible Person on Premises Required
Finding: Guilty
Sentence: Fined \$378.00
Date: 08/06/2018
Case: 18058687

6. On 02/01/2019 at 9:38pm officers conducted a licensed premise check at Capitol Pantry, 2483 W. Capitol Dr. The clerk was identified as Sukhgander SINGH. The officers found that SINGH had been working since 10:00am and does not have a Class D Operator's license. The applicant arrived on scene and stated SINGH has taken the bartenders class but did not get his license yet. SINGH was issued a citation for Class D License Required.

7. On 05/04/2019 the applicant was cited in the City of Milwaukee at 3033 W. Lisbon Av for Sale of Cigarette to Minor/Underage.

Charge: Sale of Cigarette to Minor/Underage
Finding: Guilty
Sentence: Fined \$350.00
Date: 09/10/2019
Case: 19026298

8. On 01/13/2020 officers conducted a license premise check at Capitol Open Pantry, 2483 W. Capitol Dr. The officer conducted a walk through and found several expired Dairy and Meat products. The clerk provided his Class D Operator's license and the business licenses. The officer spoke with the applicant by phone and advised him of the expired products.

9. On 09/07/21 at 3:46pm, Milwaukee Police were dispatched to 2483 W. Capitol Drive for a personal injury accident complaint. Investigation revealed that a vehicle struck the business. A report was filed.

Item #9 added to Previous Premise

Date:11-21-21

Officer: C. Harris

City of Milwaukee Police Department
90-5-1.5 Crime Prevention Survey
Convenience Store/Liquor Store Inspection

Name of Premise: Capitol Pantry
Address: 2483 W. Capitol Dr. Milwaukee, WI 53209
Phone: 262-232-3775

Owner: Govind PHULARA
Owner address: 2217 N. 61st Street
City State Zip: Milwaukee, WI 53213
Owner Phone: 262-232-3775
Owner email: govindphulara3@gmail.com

Manager: same as owner
Home Address:
City State Zip:
Phone:
Email:

Preferred contact: same as owner

Location currently open: ☒ YES ☐ NO

Projected open date: currently open

Day's open: ☐S ☐M ☐T ☐W ☐Th ☐F ☐SA ☒ALL

Hours of Operation: Sun: ☐24 hours ☒Y ☐N
Mon:
Tue:
Wed:
Thu:
Fri:
Sat:

Premise Type: ☒Liquor Store
☒Convenience Store
☐Other:

Licenses currently held:

Alcohol: ☒ Yes ☐ No #: applied for (beer only)
Tobacco: ☒ Yes ☐ No #: applied for
Food: ☒ Yes ☐ No #: applied for
Extended Hours: ☒ Yes ☐ No #: applied for
Secondhand Dealer: ☐ Yes ☐ No Type: #:
Other: ☐ Yes ☐ No Type: #:
Other: ☐ Yes ☐ No Type: #:

Exterior Survey:

1. Is the area around the location clean? ☐ Yes ☐ No
2. What surrounds the location? (Check all the apply)
 - a. ☐ Park
 - b. ☐ School
 - c. ☐ Youth Center
 - d. ☐ Church
 - e. ☐ Tavern(s) If so, how many
 - f. ☒ Residential
 - g. ☒ Other businesses
 - h. ☒ Other: car wash
3. Can you see from the outside of the location into the interior ☒ Yes ☐ No
4. Can you see the employees inside of the location from the outside ☒ Yes ☐ No
5. Are exterior windows free of signage ☐ Yes ☒ No
6. Is there a parking lot ☒ Yes ☐ No
7. Is the parking lot clean? ☒ Yes ☐ No
8. Is the parking lot well lit? ☒ Yes ☐ No
9. Are there areas where a person could conceal themselves ☐ Yes ☒ No
10. Is there exterior lighting? ☒ Yes ☐ No. Does it appears to be adequate ☒ Yes ☐ No
11. Exterior Payphone? ☐ Yes ☒ No
12. Are there No Loitering Signs posted? ☐ Yes ☒ No
13. Are there exterior security cameras ☒ Yes ☐ No How Many: 3
14. Are the address numbers prominently displayed and easy to see ☐ Yes ☒ No

Camera Survey:

15. Does this location have security cameras? ☒ Yes ☐ No
16. Are they in working order? ☒ Yes ☐ No
17. What format are the cameras?
 - a. Color ☒ Yes ☐ No
 - b. Digital ☒ Yes ☐ No
 - c. VCR ☐ Yes ☐ No
 - d. Recorded ☒ Yes ☐ No
18. How long is footage stored for later viewing: N/A
19. Are there exterior cameras ☒ Yes ☐ No How many: 3
20. Are there interior cameras ☒ Yes ☐ No How many: 6
21. Do all employees know how to retrieve recorded digital images/footage? ☐ Yes ☒ No

Interior Survey:

22. Is the storeowner willing to be a standing complainant regarding loitering? ☒ Yes ☐ No
a. If yes have them fill out the standing complaint form and give them two of the commercial signs ☒ Yes ☐ No
23. Is the interior of the location neat and clean? ☒ Yes ☐ No
24. Does an interior camera face the entrance/exit? ☒ Yes ☐ No
25. Is there a lockable area that separates employees from customers? ☒ Yes ☐ No
26. Does the store sell single chore boy? ☐ Yes ☒ No
27. Does the store sell blunt wraps? ☒ Yes ☐ No
28. Does the store sell scales? ☐ Yes ☒ No
29. Does the store sell items that may be used as crack pipes? ☐ Yes ☒ No
a. Describe item
30. Does the store have an over abundance of sandwich baggies: ☐ Yes ☒ No
31. Does the owner understand that these items are often used for drug use? ☒ Yes ☐ No
32. Do the products in the store appear to be new and rotated often? ☒ Yes ☐ No
33. Are emergency and non-emergency numbers posted near the phone? ☐ Yes ☒ No
34. Does the owner know how to contact their police district directly? ☒ Yes ☐ No
a. Did you provide a district contact guide to the owner? ☒ Yes ☐ No

Complete this section if alcohol establishment is a convenience store:

(** Read full ordinance for all details "68-4.3 Convenience Food Stores")

All convenience food stores not exempted under sub. 3 shall:

1. Is the cash register located in a manner so that at the time of a sales transaction, the employee and customer are both visible from the sidewalk? ☒ Yes ☐ No **
2. Are the glass entrance and exit doors clear of any signs or advertisements with the exception of a sign which states that the cash register contains \$50 or less and that the safe is no accessible to employees? ☐ Yes ☒ No
3. Does the store maintain one of the following on the licensed premise:
 - a. A safe that was in use at the convenience food store on August 17, 1994? ☒ Yes ☐ No
 - b. A drop-safe or time release safe that weighs at least 500 pounds or which is attached to or set into the floor in a manner approved by the police department? ☒ Yes ☐ No
4. Is lighting provided for the store's parking area during all hours of darkness when employees or customers are on the premises at a minimum average of 2-foot candles per square foot, unless the store is not open for business after sunset and before sunrise? ☒ Yes ☐ No ☐ N/A
5. Are at least two high-resolution surveillance security cameras installed? ☒ Yes ☐ No
6. Are the security cameras in working order? ☒ Yes ☐ No
7. Does one camera show an overall view of the counter and register area? ☒ Yes ☐ No
8. Does one camera show a clear, identifiable, full frame image of the face of each person entering and leaving the store? ☐ Yes ☒ No
9. Are the camera views obstructed by fixtures or displays? ☐ Yes ☒ No
10. Is the recorded footage stored for at least 30 days? ☐ Yes ☐ No ☐ N/A
11. Do all store employees know how to record footage from the camera system to media capable of being transferred to police custody? ☐ Yes ☒ No

12. Are customer entrances/exits made of glass or other transparent material? ☒ Yes ☐ No
a. Exception: A store that does not have such doors on August 17, 1994 shall not be required to install such doors until the holder of the store's food dealer license changes.
13. Has the owner and their employees attended the Robbery Prevention Training within 120 days of ownership or employment? ☐ Yes ☒ No
a. Contact Community Outreach and Education at 935-7836 for schedule.

Sub 3. Exemptions. The requirements of this section do not apply to a convenience food store that conforms to either of the following descriptions:

- a-1. The store is located in an enclosed shopping structure, enclosed commercial building or hospital. A convenience food store is not in an enclosed structure or building if a customer can enter it directly from the outside.
Does store conform to a-1 ☐ Yes ☐ No
- a-2. The store physically separates employees from customers with a solid partition that bars a person from entering the employee area from the customer area, has a secure lock on the employee side of any door between the employee area and the customer, and conducts all transaction through a service window or similar arrangement.
Does store conform to a-2 ☒ Yes ☐ No
- a. At the commissioner's discretion, a convenience store may be exempted from any or all of the regulations specified in sub 2.
Does this location hold an exemption from the commissioner regarding any of the requirements of Sub 2? ☐ Yes ☐ No

ADDITIONAL COMMENTS/RECOMMENDATIONS:

I did not locate an exterior No Loitering sign. I did instruct Mr. PHULARA to install one and explained the importance of it.

At the time of the survey PHULARA informed me the business has a total of 16 cameras. At the time the other cameras were offline. He stated he will be resetting them.

The address numbers were not properly posted for the public to see. I instructed PHULARA to install more prominent numbers facing W. Capitol Dr.

PHULARA stated he will make himself more familiar with operating the cameras and update the footage storage to 30 days.

PHULARA will be provided the schedule to sign up for a Robbery prevention class.

I recommended PHULARA remove graffiti on the eastside exterior wall facing the alleyway.



Concentration Map

2483 W Capitol Dr

Area : 21,862,586.06 ft²

Nov 8 2021 14:24:11 Central Standard Time

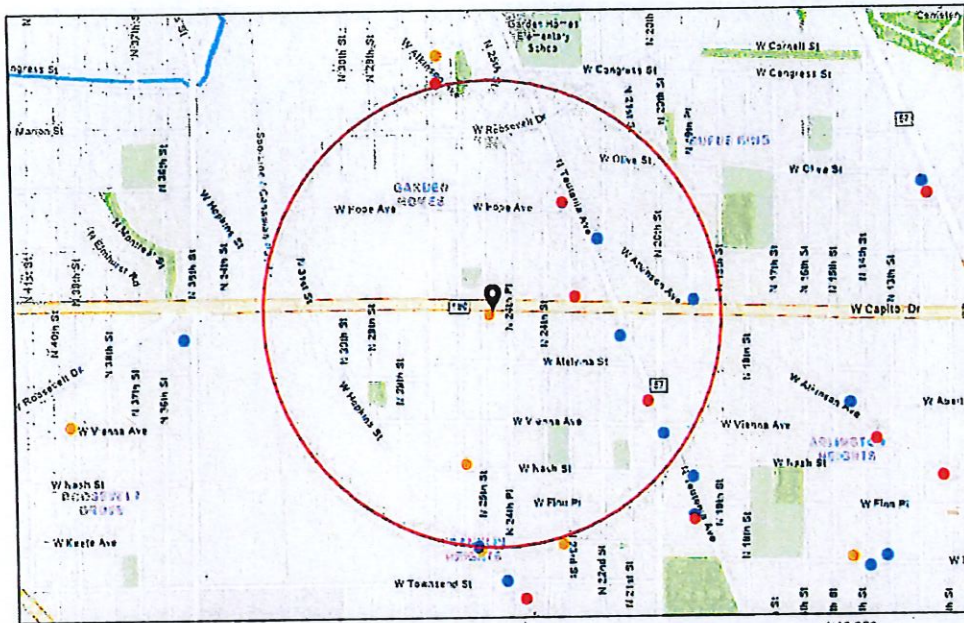

- Alcohol Licenses
- Class A Fermented Malt Beverage
 - Class A Liquor and Malt
 - Class B Tavern

1:118,056
0 0.1 0.2 0.4 mi
0 0.17 0.35 0.7 km
City of Milwaukee

Summary

Name	Count	Area(ft ²)	Length(mi)
Alcohol Licenses	10		

Alcohol Licenses

#	Legal Entity	Trade Name	Licensee	Address	License Type Name	Total Capacity	Expiration Date	Count
1	ANGEL FOOD MARKET	ANGEL FOOD MARKET	CHIDI P ONUKWUGH A, Agt	3700 N 26TH ST	Class A Fermented Malt Beverage Retailer's License		11/22/2021, 6:00 PM	1
2	Loves Supermarket II LLC	Loves Supermarket II LLC	HARJINDER S BRAICH, Agt	2305 W Atkinson AV	Class A Malt & Class A Liquor License		1/17/2022, 6:00 PM	1
3	Capitol Pantry, Inc.	Capitol Pantry	SIMRANJEET S BENIPAL, Agt	2483 W Capitol DR	Class A Fermented Malt Beverage Retailer's License		3/18/2022, 7:00 PM	1
4	B Brothers LLC	Blues Place	Timothy M Bea, Agt	3941 N TEUTONIA AV	Class B Tavern License		3/13/2022, 7:00 PM	1
5	Big Mans's Place LLC	Big Man's Place	Mary Stanley, Agt	1932 W Capitol DR	Class B Tavern License	76	3/27/2022, 7:00 PM	1
6	DRAKE, INC	TEUTONIA WINE & LIQUOR	BRYAN DRAKE, Agt	2232 W CAPITOL DR	Class A Malt & Class A Liquor License		6/29/2022, 7:00 PM	1
7	Bar 41 MKE LLC	Bar 41 MKE	Shamia Washington, Agt	4126 N Teutonia AV	Class B Tavern License		7/25/2022, 7:00 PM	1
8	Warren's Lounge	Warren's Lounge	Shirley M Harper, SP	2534 W Hopkins ST	Class B Tavern License	180	8/4/2022, 7:00 PM	1
9	SHANANIGAN S	SHANANIGAN S	CETTERY M GARDNER, SP	3751 N TEUTONIA AV	Class B Tavern License	70	9/23/2022, 7:00 PM	1
10	BLACKOUT HOLDINGS, LLC	Express Liquor	Jonte Marshall, Agt	3833 N TEUTONIA AV	Class A Malt & Class A Liquor License		9/19/2022, 7:00 PM	1

Establishments within a 0.5 miles radius centered on area of interest.



Friday, December 17, 2021



Notice of Public Hearing

Blank Notice

PHULARA, Govind

Capital Pantry at 2483 W CAPITOL DR.

Class A Fermented Malt Beverage Retailer's; Extended Hours Establishments (for food dealer only) and Food Dealer License Applications Requesting to Open at 12:00 AM Sun- Sat and to Close at 11:59 PM Sun - Thu and at 11:15 PM Fri & Sat

Wednesday, January 05, 2022 at 02:20 PM

To whom it may concern:

The above application has been made by the above named applicant(s). This requires approval from the Licenses Committee and the Common Council of the City of Milwaukee. The hearing before the Licenses Committee will take place virtually on 01/05/2022 at 02:20 PM. This is a public hearing. Those wishing to view the proceeding are able to do so via the City Channel – Channel 25 on Spectrum Cable – or on the Internet at <http://city.milwaukee.gov/citychannel>. Those wishing to provide oral testimony will be asked to do so by phone or internet and are asked to contact the staff assistant, Yadira Melendez at (414) 286-2775 or stasst5@milwaukee.gov for necessary information. Please make such requests no later than one business day prior to the start of the meeting. You are not required to attend the hearing, but please see the information below if you would like to provide testimony. Once the Licenses Committee makes its recommendation, this recommendation is forwarded to the full Common Council for approval at its next regularly scheduled hearing.

Important details for those wishing to provide information for the Licenses Committee to consider when making its recommendation:

1. The license application is scheduled to be heard at the above time. Due to other hearings running longer than scheduled, you may have to wait some time to provide your testimony.
2. You must testify as to matters that you have personally experienced or seen. (You cannot provide testimony for your neighbor, parent or anyone else; this is considered hearsay and cannot be considered by the committee.)
3. No letters or petitions can be accepted by the committee (unless the person who wrote the letter or the persons who signed the petition are willing to testify).
4. Persons opposed to the license application are given the opportunity to testify first; supporters may testify after the opponents have finished.
5. When you are called to testify, you will be sworn in and asked to give your name, and address. (If your first and/or last names are uncommon please spell them.)
6. You may then provide testimony.
 - a. Include only information relating to the above license application.
 - b. Include only information you have personally witnessed or seen.
 - c. Provide concise and relevant information detailing how this business has affected or may affect the peaceful enjoyment of your neighborhood.
 - d. If by the time you have the opportunity to testify, the information you wish to share has already been provided to the committee, you may state that you agree with the previous testimony. Redundant or repetitive testimony will not assist the committee in making its recommendation.
7. After giving your testimony, the members of the Licenses Committee and the licensee may ask questions regarding the testimony you have given or other factors relating to the license application.
8. Business Competition is not a valid basis for denial or non-renewal of a license.

Please Note: If you have submitted an objection to the above application your objection cannot be considered by the committee unless you personally testify at the hearing.

OCCUPANT	MAIL ADDRESS	CITY STATE ZIP
CURRENT OCCUPANT	2460 W CAPITOL DR	MILWAUKEE, WI 53206-1434
CURRENT OCCUPANT	2480 W CAPITOL DR	MILWAUKEE, WI 53206-1434
CURRENT OCCUPANT	2480 W CAPITOL DR, 1	MILWAUKEE, WI 53206-1434
CURRENT OCCUPANT	2480 W CAPITOL DR, 2	MILWAUKEE, WI 53206-1434
CURRENT OCCUPANT	2517 W CAPITOL DR, 1	MILWAUKEE, WI 53206-1409
CURRENT OCCUPANT	2517 W CAPITOL DR, 2	MILWAUKEE, WI 53206-1409
CURRENT OCCUPANT	2517 W CAPITOL DR, 3	MILWAUKEE, WI 53206-1409
CURRENT OCCUPANT	2517 W CAPITOL DR, 4	MILWAUKEE, WI 53206-1409
CURRENT OCCUPANT	2517 W CAPITOL DR, 5	MILWAUKEE, WI 53206-1409
CURRENT OCCUPANT	2517 W CAPITOL DR, 6	MILWAUKEE, WI 53206-1409
CURRENT OCCUPANT	2517 W CAPITOL DR, 7	MILWAUKEE, WI 53206-1409
CURRENT OCCUPANT	2517 W CAPITOL DR, 8	MILWAUKEE, WI 53206-1409
CURRENT OCCUPANT	2522 W CAPITOL DR, 1	MILWAUKEE, WI 53206-1410
CURRENT OCCUPANT	2522 W CAPITOL DR, 10	MILWAUKEE, WI 53206-1450
CURRENT OCCUPANT	2522 W CAPITOL DR, 11	MILWAUKEE, WI 53206-1450
CURRENT OCCUPANT	2522 W CAPITOL DR, 12	MILWAUKEE, WI 53206-1451
CURRENT OCCUPANT	2522 W CAPITOL DR, 12A	MILWAUKEE, WI 53206-1451
CURRENT OCCUPANT	2522 W CAPITOL DR, 14	MILWAUKEE, WI 53206-1451
CURRENT OCCUPANT	2522 W CAPITOL DR, 15	MILWAUKEE, WI 53206-1451
CURRENT OCCUPANT	2522 W CAPITOL DR, 16	MILWAUKEE, WI 53206-1451
CURRENT OCCUPANT	2522 W CAPITOL DR, 17	MILWAUKEE, WI 53206-1451
CURRENT OCCUPANT	2522 W CAPITOL DR, 19	MILWAUKEE, WI 53206-1461
CURRENT OCCUPANT	2522 W CAPITOL DR, 2	MILWAUKEE, WI 53206-1410
CURRENT OCCUPANT	2522 W CAPITOL DR, 20	MILWAUKEE, WI 53206-1461
CURRENT OCCUPANT	2522 W CAPITOL DR, 21	MILWAUKEE, WI 53206-1461
CURRENT OCCUPANT	2522 W CAPITOL DR, 22	MILWAUKEE, WI 53206-1461
CURRENT OCCUPANT	2522 W CAPITOL DR, 23	MILWAUKEE, WI 53206-1461
CURRENT OCCUPANT	2522 W CAPITOL DR, 24	MILWAUKEE, WI 53206-1461
CURRENT OCCUPANT	2522 W CAPITOL DR, 3	MILWAUKEE, WI 53206-1410
CURRENT OCCUPANT	2522 W CAPITOL DR, 4	MILWAUKEE, WI 53206-1410
CURRENT OCCUPANT	2522 W CAPITOL DR, 5	MILWAUKEE, WI 53206-1410
CURRENT OCCUPANT	2522 W CAPITOL DR, 6	MILWAUKEE, WI 53206-1410
CURRENT OCCUPANT	2522 W CAPITOL DR, 7	MILWAUKEE, WI 53206-1450
CURRENT OCCUPANT	2522 W CAPITOL DR, 8	MILWAUKEE, WI 53206-1450
CURRENT OCCUPANT	2522 W CAPITOL DR, 9	MILWAUKEE, WI 53206-1450
CURRENT OCCUPANT	3926 N 25TH ST	MILWAUKEE, WI 53206-1426
CURRENT OCCUPANT	3927 N 24TH PL	MILWAUKEE, WI 53206-1422
CURRENT OCCUPANT	3932 N 25TH ST	MILWAUKEE, WI 53206-1426
CURRENT OCCUPANT	3933 N 25TH ST	MILWAUKEE, WI 53206-1427
CURRENT OCCUPANT	3934 N 26TH ST	MILWAUKEE, WI 53206-1405
CURRENT OCCUPANT	3936 N 25TH ST	MILWAUKEE, WI 53206-1426
CURRENT OCCUPANT	3937 N 24TH PL	MILWAUKEE, WI 53206-1422
CURRENT OCCUPANT	3937 N 25TH ST	MILWAUKEE, WI 53206-1427
CURRENT OCCUPANT	3940 N 24TH PL	MILWAUKEE, WI 53206-1421
CURRENT OCCUPANT	3940 N 25TH ST	MILWAUKEE, WI 53206-1426
CURRENT OCCUPANT	3940 N 26TH ST	MILWAUKEE, WI 53206-1405

CURRENT OCCUPANT	3940A N 24TH PL	MILWAUKEE, WI 53206-1421
CURRENT OCCUPANT	3941 N 24TH PL	MILWAUKEE, WI 53206-1422
CURRENT OCCUPANT	3941 N 25TH ST	MILWAUKEE, WI 53206-1427
CURRENT OCCUPANT	3944 N 24TH PL	MILWAUKEE, WI 53206-1421
CURRENT OCCUPANT	3944 N 26TH ST	MILWAUKEE, WI 53206-1405
CURRENT OCCUPANT	3946 N 24TH PL	MILWAUKEE, WI 53206-1421
CURRENT OCCUPANT	3946 N 25TH ST	MILWAUKEE, WI 53206-1426
CURRENT OCCUPANT	3947 N 25TH ST	MILWAUKEE, WI 53206-1427
CURRENT OCCUPANT	3950 N 24TH PL	MILWAUKEE, WI 53206-1421
CURRENT OCCUPANT	3950 N 25TH ST	MILWAUKEE, WI 53206-1426
CURRENT OCCUPANT	3950 N 26TH ST	MILWAUKEE, WI 53206-1405
CURRENT OCCUPANT	3950A N 25TH ST	MILWAUKEE, WI 53206-1426
CURRENT OCCUPANT	3951 N 24TH PL	MILWAUKEE, WI 53206-1422
CURRENT OCCUPANT	3951 N 25TH ST	MILWAUKEE, WI 53206-1427
CURRENT OCCUPANT	3954 N 24TH PL	MILWAUKEE, WI 53206-1421
CURRENT OCCUPANT	3954 N 25TH ST	MILWAUKEE, WI 53206-1426
CURRENT OCCUPANT	3954 N 26TH ST	MILWAUKEE, WI 53206-1405
CURRENT OCCUPANT	3954A N 25TH ST	MILWAUKEE, WI 53206-1426
CURRENT OCCUPANT	3954A N 26TH ST	MILWAUKEE, WI 53206-1405
CURRENT OCCUPANT	3955 N 24TH PL	MILWAUKEE, WI 53206-1422
CURRENT OCCUPANT	3956 N 24TH PL	MILWAUKEE, WI 53206-1421
CURRENT OCCUPANT	3957 N 25TH ST	MILWAUKEE, WI 53206-1427
CURRENT OCCUPANT	3957A N 25TH ST	MILWAUKEE, WI 53206-1427
CURRENT OCCUPANT	3958 N 24TH PL	MILWAUKEE, WI 53206-1421
CURRENT OCCUPANT	3959 N 24TH PL	MILWAUKEE, WI 53206-1422
CURRENT OCCUPANT	3959A N 24TH PL	MILWAUKEE, WI 53206-1422
CURRENT OCCUPANT	3960 N 24TH PL	MILWAUKEE, WI 53206-1421
CURRENT OCCUPANT	3960 N 25TH ST	MILWAUKEE, WI 53206-1426
CURRENT OCCUPANT	3960 N 26TH ST	MILWAUKEE, WI 53206-1405
CURRENT OCCUPANT	3960A N 25TH ST	MILWAUKEE, WI 53206-1426
CURRENT OCCUPANT	3960A N 26TH ST	MILWAUKEE, WI 53206-1405
CURRENT OCCUPANT	3961 N 25TH ST	MILWAUKEE, WI 53206-1427
CURRENT OCCUPANT	4006 N 25TH ST	MILWAUKEE, WI 53209-6612

Blank Notice

Total Records: 79

Radius: 250.0 feet and Center of Circle: 2483 W Capitol Dr



BUSINESS LICENSE PLAN OF OPERATION

ccl-busplan 5/12/2020

Office of the City Clerk License Division
200 E. Wells St. Room 105, Milwaukee, WI 53202
(414) 286-2238 www.milwaukee.gov/license e-mail address: license@milwaukee.gov

1. Type of Business

- Applying for: ☒ Extended Hours (12AM to 5AM) - If a food establishment, check all that apply: ☐ Delivery ☐ Drive Thru ☐ Dining Room
☐ Self Service Laundry ☐ Massage Establishment ☐ Filling Station
☒ Other (supplemental application for specific license also required)

Provide a detailed description of the type of business you plan on operating:

GROCERY STORE (CONVENIENT STORE)

Do you have any experience operating this type of business? ☐ No ☒ Yes If yes, explain:

2. Business Operations

- a. Proposed Opening Date: 12/01/2021
b. Is this premise under construction? ☒ No ☐ Yes If yes, list estimated completion date: _____
c. Is this a franchise? ☒ No ☐ Yes
d. Is this premises currently licensed? ☐ No ☒ Yes If yes, list type of license: FOOD, CIG & TOBACCO, BEER, 24hr
e. Is the current licensee operating? ☐ No ☒ Yes If no, list date closed: _____
f. Do you have future plans for other businesses, licenses or permits at this location? ☒ No ☐ Yes
If yes, explain: _____
g. Have you previously held an Extended Hours License in Milwaukee? ☒ No ☒ Yes
If yes, list address(es): NO
h. Are other businesses operating in the same building? ☒ No ☐ Yes If yes, describe: _____

3. Litter & Noise

- a. How are grounds kept clean? ☒ Sweep ☐ Pressure Wash ☐ Pick Up Litter ☐ Other: _____
b. How often will grounds be cleaned? ☒ Daily ☐ Weekly ☐ As Needed ☐ Monthly ☐ Other: _____
c. Grounds cleaned by: ☐ Licensee ☐ Building Owner ☒ Employees ☐ Hired Maintenance ☐ Other: _____
d. How are noise issues prevented and/or addressed? ☐ Security ☒ Manager approaches customer(s) ☐ Call Police
☐ Signs Posted ☐ Other: _____
e. Will a sound amplification system be used? ☒ No ☐ Yes If yes, describe: _____

4. Smoking & Sanitation

- a. Are there designated outdoor smoking areas? ☒ No ☐ Yes If yes, describe: _____
b. Number of Garbage Cans: Inside: 1 Locations: INSIDE THE MAIN DOOR
Outside: 1 Locations: IN THE PARKING LOT
c. Is a crowd control barrier used? ☒ No ☐ Yes If yes, describe: _____
d. How many restrooms are on the premises? 3
e. Name of solid waste contractor: ☐ Advanced Disposal ☒ Waste Management ☐ Other: _____

5. Security

- a. Are there onsite parking spaces? ☐ No ☒ Yes If yes, how many? 16 and describe the parking security plan: FLOOD LIGHTS.
- b. Is there a loading zone? ☒ No ☐ Yes If yes, describe the loading area security plan: _____
- c. Will you have security personnel on premise? ☒ No ☐ Yes If yes, how many? _____ and answer the following:
What are their responsibilities? _____
Is security equipment used? ☐ No ☐ Yes If yes, describe _____
List their licensing, certification, or training credentials _____
- d. Will there be security cameras? ☐ No ☒ Yes If yes, how many? 10 and list locations: OUTSIDE (2)
COUNTER (2); AISLE 1 (2); AISLE 2 (2); BACK (1), FRONT (1)
- e. Will searches/identification checks be done upon entry? ☐ No ☐ Yes If yes, describe _____

6. Percentage of Sales (must total 100%)

Alcohol <u>20%</u> %	Food <u>60%</u> %	Secondhand Merchandise _____ %	Precious Metals & Gems _____ %
Entertainment _____ %	Cigarettes <u>10</u> %		
Pawnbroker Activity _____ %	Salvaged Materials _____ % (such as scrap metal)	Personal Services (such as tattoo, body piercing, salon, tailor, tanning, etc.) _____ %	Other <u>10</u> % Describe: <u>MISC. GROCERY</u>

7. Businesses/Licenses on the Premises (check all that apply):

Type 1

- ☐ Full Service Restaurant ☐ Cafe/Coffee Shop ☐ Deli or Fast Food Restaurant ☐ Private/Fraternal/Veterans Club
- ☐ Night Club ☐ Tavern ☐ Cocktail Lounge ☐ Teen Club
- ☐ Banquet Hall ☐ Sports Facility ☐ Bowling Alley
- ☐ Hotel/Motel: Number of Floors: _____ Number of Rooms: _____
Rooming House: Number of Floors: _____ Number of Rooms: _____

Type 2

- ☐ Liquor Store ☐ Corner Store ☐ Supermarket ☒ Convenience Store
- ☐ Gas Station ☐ Amusement/Phonograph Distributor ☐ Recycling, Salvage or Towing
- ☐ Used Car Dealer ☐ Personal Service Establishment (such as tattoo business, hair salon, tailor, etc.) ☐ Recording Studio

What other licenses/permits will you hold at this location? (check all that apply)

- ☒ Occupancy Permit ☒ Cigarette & Tobacco ☐ Gas Station ☐ Extended Hours ☒ Class "B" Tavern ☐ Weights & Measures
- ☐ Secondhand Dealer ☐ Precious Metal & Gem ☒ Other: LOTTERY.

8. Legal Capacity (only if a Type 1 premises in #7 above)

Capacity N/A (Call the Milwaukee Development Center at 414-286-8211 if you have questions.)

9. Premises Description

a. Identify all area(s) of the premises that will be used in operating this business (include areas used only for storage):

☒ 1st Floor ☐ 2nd Floor ☐ Basement Storage ☐ Patio ☐ Beer Garden ☐ Sidewalk Café ☐ Deck ☐ Rooftop

☐ Other: Describe: _____

b. Describe Location: ☒ Major Thoroughfare ☐ Secondary Street ☐ Other: _____

c. Nearest Major Cross Street: CAPITOL DRIVE

d. Describe Building: ☒ Free Standing Building ☐ Strip Mall ☐ Other: _____

e. Describe Premises Structure: ☒ Single Story ☐ Multi-Story - # of Stories _____ ☐ Other: _____

f. Describe Surrounding Area: ☐ Commercial ☒ Residential ☐ Industrial ☐ Other: _____

g. Building Owner Name: GOVIND PHULARA Phone Number: 262-232-3775

Building Owner Address: 2217 N 61ST ST MILWAUKEE WI 53213

10. Hours of Operation & Customers

Will customers be entering the premises? ☐ No ☒ Yes

Day of the Week	Proposed Hours of Operation:		Estimated Number of Customers expected each day	Potential Age Range of Customers	Class B Tavern Applicant Only: Age Restriction (If none, write 'None')
	Open Time (include a.m. or p.m.)	Close Time (include a.m. or p.m.)			
Sunday	12 A.M.	11:59 PM 11:59 P.M.	120	10-70+	GOVIND PHULARA
Monday	12 AM	11:59 PM	120		
Tuesday	12 AM	11:59 PM	120		
Wednesday	12 AM	11:59 PM	120		
Thursday	12 AM	11:59 PM	120		
Friday	12 AM	11:15 PM	120		
Saturday	12 AM	11:15 PM	120		

An Extended Hours Establishment License is required for any convenience store, filling station, personal service establishment (such as tattoo, body piercing, salon, tailor, tanning, etc.), recording studio or restaurant which is open between the hours of 12:00 a.m. and 5:00 a.m.

Alcohol Establishments Class A: 8:00 am to 9:00 pm Sunday thru Saturday
Permitted Hours of Operation: Class B: 6:00 am to 2:00 am Sunday thru Thursday, 6:00 am to 2:30 am Friday & Saturday

Entertainment Outdoor Closing Hours: 10:00pm Sunday-Thursday; 12:00am Friday & Saturday; unless a different time, either earlier or later, is established by the Common Council in its approval of the licensee's plan of operation.

11. Signature(s)

Govind Phulara

Signature of Sole Proprietor, Partner, or 20% or more Shareholder
(If there are no 20% or more shareholders,
Corporate Officer-print name/title and sign)

Signature of additional partner or 20% or more shareholder

See Application Information for a complete list of all required application forms.



ALCOHOL BEVERAGE & PUBLIC ENTERTAINMENT PREMISES SUPPLEMENTAL APPLICATION

Office of the City Clerk License Division
200 E. Wells St. Room 105, Milwaukee, WI 53202
(414) 286-2238 e-mail address: license@milwaukee.gov www.milwaukee.gov/license

Legal Entity Name: CAPITOL KHARTAD INC.

Premise Address: 2483 W. CAPITOL DR. MILWAUKEE WI 53206

Proximity of Premises to Church, School, Daycare Center or Hospital

Is the building within 300 feet of any church, school, daycare center or hospital? ☒ No ☐ Yes

"Service Bar Only" Designation

If applying for Class B or C license, are you applying for "Service Bar Only"? ☒ No ☐ Yes

Service Bar Only means customers cannot sit at the bar. Alcohol is served to employees who serve patrons seated at tables. No stools, chairs or other articles of furniture shall be placed at the service bar for patrons to sit upon.

Business Information

a) Are you taking out this application for anyone that may not be eligible for a license? ☒ No ☐ Yes

If yes, list their name and address: _____

b) Will the agent, a partner or the individual licensee be conducting the day-to-day operations of the business? ☐ No ☒ Yes

If no, list the name and address of the person(s) who will: _____

Class B Applicants: If the agent, a partner or the individual licensee will not be conducting the day-to-day operations of the business, the person(s) listed above must obtain a Class B Managers license.

c) Does anyone else have money invested or any other interest in this business? ☒ No ☐ Yes

If yes, explain: _____

d) Have you made an agreement with anyone to repay any loan or any other payments based upon income from the business?

☒ No ☐ Yes If yes, list name and address: _____

Property Information (New & Transfer Applicants Only)

a) Do you own or lease the building? ☒ Own ☒ Lease

b) Who owns the fixtures (for example, coolers, etc.)? APPLICANT

c) Are you purchasing the stock and/or fixtures? ☐ No ☒ Yes If yes, amount paid \$ _____

d) Total amount paid for business \$ 40,000.00

e) Total amount paid for goodwill of the business \$ 70,000.00

Goodwill comprises the reputation and customer relationships of an existing business. If the price you pay for the business exceeds the fair market value of all of the rest of the assets of the business, the excess may be considered goodwill.

f) Have you made arrangements with the seller for payment of personal property taxes? ☐ No ☒ Yes

Lease Information (New & Transfer Applicants who are leasing the premises only)

a) Date lease begins 11/01/2021 Ends 11/01/2030

b) Monthly rental \$ 1500

c) Do you have an option to renew the lease? ☐ No ☒ Yes

d) Does your lease allow for assignment to another party without the consent of the owner? ☒ No ☐ Yes

e) For what length of time have you been guaranteed occupancy (number of years)? 10 years

Lease Information (Continued)

- f) In addition to paying the monthly rental, will you have to pay anything additional to the owner of the building to guarantee performance of the lease? ☒ No ☐ Yes If yes, explain _____
- g) Does the present owner or occupancy object to the granting of your license? ☒ No ☐ Yes
If yes, explain _____

Change of Agent Applicants Only

Have there been any changes to the floor plan since the last application was submitted? ☒ No ☐ Yes
If no, a new floor plan is not required. If yes, submit a new floor plan and explain the change(s):

Signature

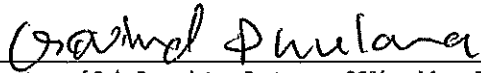

Signature of Sole Proprietor, Partner or 20% or More Shareholder
(If no 20% or more Shareholder, Corporate Officer - print name/title and sign)

Note: All information contained in this application is subject to approval by the Common Council.
Deviating from approved plan of operation will subject licensee to citations, and/or suspension or non-renewal of the license.
Contact the License Division for information on how to request changes.

New and transfer of premises applicants must submit the following:

- ☐ Detailed floor plan
☐ If a restaurant, copy of the menu

**FOOD DEALER LICENSE PLAN OF OPERATION**

OFFICE OF THE CITY CLERK, LICENSE DIVISION
CITY HALL, 200 E. WELLS ST, ROOM 105, MILWAUKEE, WI 53202
(414) 286-2238 • license@milwaukee.gov • www.milwaukee.gov/license

Legal Entity Name: CAPITOL KHAPTAD INC.

Premises Address: 2483 W. CAPITOL DR MILWAUKEE WI 53206

SECTION 1 TYPE OF BUSINESS

What will be the majority of your food sales? (check one)

☐ Restaurant Items (meals):

MEALS include, but are not limited to, chicken, ribs, sandwiches, roasted corn, baked potatoes, hot dogs, brats, tacos, nachos w/ cheese and meat, French fries, cooked or deep fried vegetables/fruit, cooked cheese curds, corn dogs, egg rolls, salads.

☒ Retail Items (snacks and beverages):

RETAIL items include, but are not limited to, ice cream/soft serve, lemonade, snow cones, coffee, espresso, cappuccino, tea, fruit juice, smoothies, candy, dispensed soda, fruit cups, bakery, cookies, kettle corn, cotton candy, funnel cakes, fritters, tortilla chips w/ cheese.

Will it be a convenience store? ☒ Yes ☐ No

A convenience store contains less than 5,000 square feet of retail space and has, as its primary business, the sale of basic food items and in addition, sells household products or is a filling station that sells basic food items and household products.

☐ Bed & Breakfast

☐ Micro Market

All Applicants: Submit a menu or a list of food items that will be sold.

Will any wholesale business be done? ☒ No ☐ Yes If yes, what percentage of food sales will be wholesale?

☐ Less than 25%

☐ 25% or More AND:

☐ Restaurant items (meals) will be sold – Complete this application and also contact DATCP.

☐ NO restaurant items (meals) will be sold - Do NOT complete this application. Contact DATCP only.

SECTION 2 FOOD PROCESSING

Will any food processing be done? ☒ No ☐ Yes

Processing is defined as assembling, grinding, cutting, mixing, baking, coating, stuffing, packing, bottling, grilling, canning, extracting, fermenting, distilling, pickling, freezing, drying, smoking, or packaging.

SECTION 3 FOOD REQUIRING TEMPERATURE CONTROL

Will any food that requires temperature control be sold? ☐ No ☒ Yes
(includes dairy products such as milk, cheese, and ice cream, fish, shellfish, meat, poultry)

If yes, list the types of food items: MILK, EGGS, CHEESE, FROZEN MEAT
ICE CREAM, FROZEN FAST FOOD

SECTION 4 DETAILS OF OPERATION

- Will you have seating on site for dining? ☒ No ☐ Yes
- Will you be doing any catering? ☒ No ☐ Yes
- Will you be doing any delivery? ☒ No ☐ Yes
- Will you have outdoor activities? ☒ No ☐ Yes - Check all that apply: ☐ Bar ☐ Cooking/Grilling ☐ Dining
- Will you have a drive thru window? ☒ No ☐ Yes - Are hours different from inside? ☐ No ☐ Yes
- If Yes, provide drive thru hours: _____
- Will scales or barcode scanners be used? ☒ No ☐ Yes - You must also apply for a Weights & Measures License.

SECTION 5 ADDITIONAL SITES

- Where will food be prepared and/or sold? NA
- ☐ At a single site ☐ At multiple sites: How many? _____ (for example, a hotel with several dining rooms or bars)
- If multiple sites, attach a Food Dealer Additional Site Addendum (ccl-foodadd) for each additional site.

SECTION 6 CONSTRUCTION OR CHANGES

- Are you planning any construction, remodeling or equipment changes?
- ☒ No If No, SKIP to Section 8
- ☐ Yes If Yes, check all that apply: ☐ New construction of a building ☐ Renovation or remodeling
- ☐ Construction changes to existing building ☐ Equipment changes only
- Provide a brief description of the changes: _____
- Start date: _____
- Name, Address & Phone Number of Architect: _____
- Name, Address & Phone Number of Contractor: _____

SECTION 7 ALCOHOL BEVERAGES

- Are you applying for an alcohol beverage license?
- ☐ No If No, SKIP to Section 8
- ☒ Yes If YES, if your food license is approved prior to the alcohol license, when do you want the food license issued?
- ☒ Immediately ☐ At the same time as the alcohol license

SECTION 8 ACKNOWLEDGEMENTS & SIGNATURE

You must initial each item confirming your understanding:

GP

I understand the Health Department must conduct an inspection and advise the License Division of their approval before the license may be issued.

GP

I understand I must obtain an occupancy permit from the Department of Neighborhood Services and an inspection may be required. Neighborhood Services must advise the License Division of their approval before the license may be issued.

GP

I understand the district alderperson will review and either support or object to my application. If he/she objects, I may appeal and be scheduled to appear before the Licenses Committee. The Licenses Committee will then make a recommendation to the Common Council. The Common Council must grant the license before it may be issued.

GP

I understand proof of payment for all license fees must be on file in the License Division before the license may be issued and the license must be issued and posted in my establishment prior to opening for business.

GP

I will not operate my food business until the license has been issued and posted in the establishment.

Signature of Sole Proprietor, Partner, or 20% Shareholder: Garvin Purbura

Signature of Additional Partner: _____

W. CAPITOL DR.
EASTBOUND LANE

Agent

Groind Philana

011812021

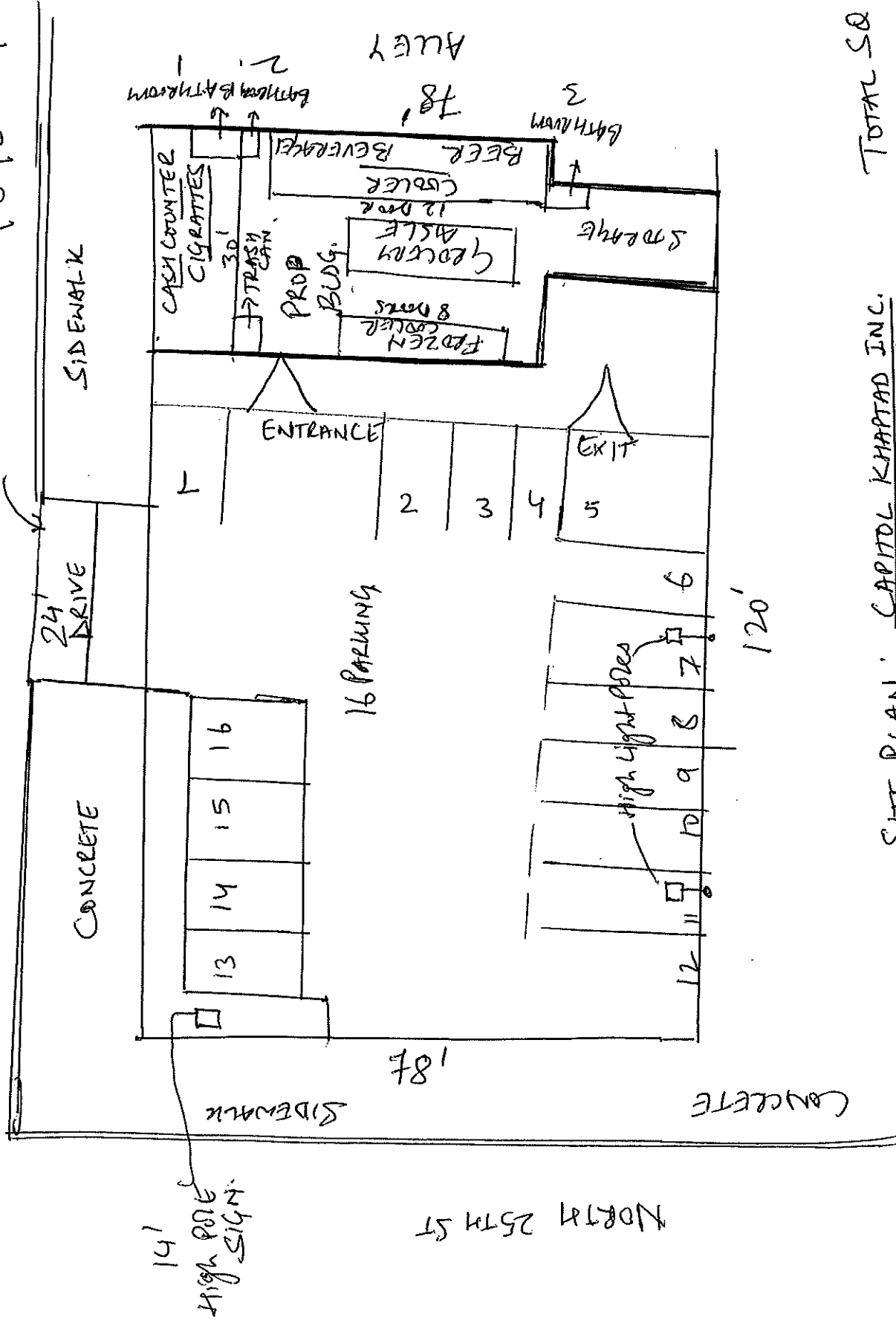

SITE PLAN: CAPITOL KHAPTAD INC.
D.B.A. CAPITAL PANTRY
2483 W. CAPITOL DR
MILWAUKEE WI 53206

TOTAL SQ FT. = 2340
16 PARKING.