



Certificate of Appropriateness

Milwaukee Historic Preservation Commission/200 E. Wells Street/Milwaukee, WI 53202/phone 414-286-5712/fax 414-286-3004

**Property
Description of
work**

2245 N Lake

Demolish and rebuild existing back porch in place. The existing railing, decking, skirting, stairs, framing and pergola will be removed. The ground beneath the deck will be graded and landscape fabric and stone will be installed for weed control and drainage. Six footings will be dug, set, and poured. Treated cedar deck and skirt framing and stair stringers will be installed. The skirting will be cedar lattice. 1x6 eased edge lpe decking, stair risers/treads and 1x fascia boards will be installed. Regal Railing 3' aluminum railing with 3/4" pickets in Yard Bronze color to be installed, to include two railings on the stairway. LED lights installed on railing.

Date issued

12/16/2021

PTS ID N/A

In accordance with the provisions of Section 320-21 (11) and (12) of the Milwaukee Code of Ordinances, the Milwaukee Historic Preservation Commission has issued a certificate of appropriateness for the work listed above. The work was found to be consistent with preservation guidelines. The following conditions apply to this certificate of appropriateness:

All finish wood must be smooth and free of knots and must be painted or treated with an opaque stain upon completion. Note: when new, bare wood is left exposed to the exterior elements for a period of only a week or two, the life of the paint job subsequently applied to it will be decreased. The use of a naturally decay-resistant wood species for exterior finish applications is required for porch areas. Using western white pine or Ponderosa pine is "at your own risk" because this wood has no natural decay resistance and can deteriorate in some exterior settings in just a few years.

Lighting: in accordance with page 111 of *Living with History*, do not install modern "garden lights."

All work must be done in a craftsman-like manner, and must be completed within one year of the date this certificate was issued. Staff must approve any changes or additions to this certificate before work begins. Work that is not completed in accordance with this certificate

may be subject to correction orders or citations. If you require technical assistance, please contact Historic Preservation staff as follows:
Phone: (414) 286-5712 E-mail: hpc@milwaukee.gov.

If permits are required, you are responsible for obtaining them from the Milwaukee Development Center. If you have questions about permit requirements, please consult the Development Center's web site, www.milwaukee.gov/permits, or call (414) 286-8210.

A handwritten signature in cursive script that reads "Jacqueline Drayer".

City of Milwaukee Historic Preservation

Copies to: Development Center, Ald. N. Kovac



Existing porch

Existing porch and approved drawings

* All aluminum railings will be installed w/ an LED integrated lighting system JM 9/28

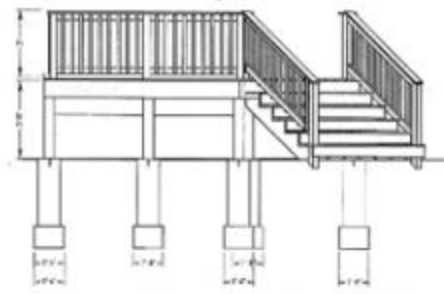

Proposed drawings

