



CITY OF MILWAUKEE  
OFFICE OF THE CITY CLERK

Thursday, September 15, 2022

COMMITTEE MEETING NOTICE

AD 04

PRASSAS, George S, Agent  
District 4 Social LLC  
233 E CHICAGO St  
Milwaukee, WI 53202

You are requested to attend a virtual hearing to be held on:

**Tuesday, September 27, 2022 at 03:40 PM**

**Regarding:** Your Class B Tavern, Public Entertainment Premises, Food Dealer and Sidewalk Dining License Applications Requesting 6 Amusement Machines as agent for "District 4 Social LLC" for "District 4 Social" at 233 E CHICAGO St.

This meeting will be held via GoToMeeting. Please see the enclosed best practices document for further instructions. The access code is <https://meet.goto.com/953593573>. If you wish to call in, please call [+1 \(872\) 240-3412](tel:+18722403412) and use Access Code: 953-593-573.

There is a possibility that your application may be denied for one or more of the following reasons: The recommendation of the committee regarding the application shall be based on evidence presented at the hearing. Per MCO 85-2.7-4, probative evidence concerning whether or not a new license should be granted may be presented on the following subjects: whether or not the applicant meets the municipal requirements, the appropriateness of the location and premises where the licensed premises is to be located and whether use of the premises for the purposes or activities permitted by the license would tend to facilitate a public or private nuisance or create undesirable neighborhood problems such as disorderly patrons, unreasonably loud noise, litter, and excessive traffic and parking congestion. Probative evidence relating to these matters may be taken from the plan of operation submitted with the license application, if any, but shall not include the content of any music. Evidence regarding the fitness of the location of the premises to be maintained as the principal place of business, including but not limited to whether there is an overconcentration of businesses of the type for which the license is sought; whether the proposal is consistent with any pertinent neighborhood business or development plans, or the location's proximity to areas where children are typically present. The applicant's record in operating similarly licensed premises; and whether or not the applicant has been charged with or convicted of any felony, misdemeanor, municipal offense or other offense, the circumstances of which substantially relate to the activity to be permitted by the license being applied for or any other factor which reasonably relates to the public health, safety or welfare may also be considered. See attached police report or correspondence.

**Notice for applicants with warrants or unpaid fines:**

**Proof of warrant satisfaction or payment of fines must be submitted at the hearing on the above date and time. Failure to comply with this requirement may result in a delay of the granting/denial of your application.**

Failure to attend this meeting may result in the denial of your license. Individual applicants and partnership applicants must attend or attend by an attorney. The agent or attorney for corporate or limited liability applicants must attend. If you wish to do so and at your own expense, you may be accompanied by an attorney of your choosing to represent you at this hearing.

You will be given an opportunity to speak on behalf of the application and to respond and challenge any charges or reasons given for the denial. No petitions can be accepted by the committee, unless the people who signed the petition attend the virtual hearing and are willing to testify. You may present witnesses under oath and you may also confront and cross-examine opposing witnesses under oath. If you have difficulty with the English language, you should request an interpreter attend the meeting with you, at your expense, so that you can answer questions and participate in your hearing.

PLEASE NOTE: Upon reasonable notice, efforts will be made to accommodate the needs of disabled individuals through sign language interpreters or other auxiliary aids. For additional information or to request this service, contact the Council Services Division ADA Coordinator at (414) 286-2998, Fax - (414) 286-3456, TDD - (414) 286-2025.

JIM OWCZARSKI, CITY CLERK

BY: \_\_\_\_\_

Jim Cooney  
License Division Manager

**If you have questions regarding this meeting, please contact the staff assistant, Yadira Melendez at (414) 286-2775 or [stas5@milwaukee.gov](mailto:stas5@milwaukee.gov)**



CITY OF MILWAUKEE  
OFFICE OF THE CITY CLERK

Thursday, September 15, 2022

COMMITTEE MEETING NOTICE

AD 04

PRASSAS, George S, Agent  
District 4 Social LLC  
1809 N CAMBRIDGE Ave #502  
Milwaukee, WI 53202

You are requested to attend a virtual hearing to be held on:

**Tuesday, September 27, 2022 at 03:40 PM**

**Regarding:** Your Class B Tavern, Public Entertainment Premises, Food Dealer and Sidewalk Dining License Applications Requesting 6 Amusement Machines as agent for "District 4 Social LLC" for "District 4 Social" at 233 E CHICAGO St.

This meeting will be held via GoToMeeting. Please see the enclosed best practices document for further instructions. The access code is <https://meet.goto.com/953593573>. If you wish to call in, please call [+1 \(872\) 240-3412](tel:+18722403412) and use Access Code: 953-593-573.

There is a possibility that your application may be denied for one or more of the following reasons: The recommendation of the committee regarding the application shall be based on evidence presented at the hearing. Per MCO 85-2.7-4, probative evidence concerning whether or not a new license should be granted may be presented on the following subjects: whether or not the applicant meets the municipal requirements, the appropriateness of the location and premises where the licensed premises is to be located and whether use of the premises for the purposes or activities permitted by the license would tend to facilitate a public or private nuisance or create undesirable neighborhood problems such as disorderly patrons, unreasonably loud noise, litter, and excessive traffic and parking congestion. Probative evidence relating to these matters may be taken from the plan of operation submitted with the license application, if any, but shall not include the content of any music. Evidence regarding the fitness of the location of the premises to be maintained as the principal place of business, including but not limited to whether there is an overconcentration of businesses of the type for which the license is sought; whether the proposal is consistent with any pertinent neighborhood business or development plans, or the location's proximity to areas where children are typically present. The applicant's record in operating similarly licensed premises; and whether or not the applicant has been charged with or convicted of any felony, misdemeanor, municipal offense or other offense, the circumstances of which substantially relate to the activity to be permitted by the license being applied for or any other factor which reasonably relates to the public health, safety or welfare may also be considered. See attached police report or correspondence.

**Notice for applicants with warrants or unpaid fines:** Proof of warrant satisfaction or payment of fines must be submitted at the hearing on the above date and time. Failure to comply with this requirement may result in a delay of the granting/denial of your application.

Failure to attend this meeting may result in the denial of your license. Individual applicants and partnership applicants must attend or attend by an attorney. The agent or attorney for corporate or limited liability applicants must attend. If you wish to do so and at your own expense, you may be accompanied by an attorney of your choosing to represent you at this hearing.

You will be given an opportunity to speak on behalf of the application and to respond and challenge any charges or reasons given for the denial. No petitions can be accepted by the committee, unless the people who signed the petition attend the virtual hearing and are willing to testify. You may present witnesses under oath and you may also confront and cross-examine opposing witnesses under oath. If you have difficulty with the English language, you should request an interpreter attend the meeting with you, at your expense, so that you can answer questions and participate in your hearing.

PLEASE NOTE: Upon reasonable notice, efforts will be made to accommodate the needs of disabled individuals through sign language interpreters or other auxiliary aids. For additional information or to request this service, contact the Council Services Division ADA Coordinator at (414) 286-2998, Fax - (414) 286-3456, TDD - (414) 286-2025.

JIM OWCZARSKI, CITY CLERK

BY: \_\_\_\_\_  
Jim Cooney  
License Division Manager

If you have questions regarding this meeting, please contact the staff assistant, Yadira Melendez at (414) 286-2775 or [stas5@milwaukee.gov](mailto:stas5@milwaukee.gov)

Date: 9/9/2022  
Officer: PLUMLEY

City of Milwaukee Police Department  
90-5-1.5 Crime Prevention Survey  
Tavern Inspection

Name of Premise: District 4 Social  
Address: 233 E Chicago St  
Phone:

Owner:  
Owner address:  
City State Zip:  
Owner Phone:  
Owner email:

Licensee/Agent: George S PRASSAS  
Home Address: 1809 N Cambridge Av #502  
City State Zip: Milwaukee WI 53202  
Phone: 773-909-1940  
Email: George@GP-Financialcom

Preferred contact: Phone

Location currently open:  YES  NO

Projected open date: 10/1/2022

Day's open: S M T W Th F SA ALL

Hours of Operation: Sun: 6A-2A 24 hours Y N  
Mon: 6A-2A  
Tue: 6A-2A  
Wed: 6A-2A  
Thu: 6A-2A  
Fri: 6A-230A  
Sat: 6A-230A

Premise Type: Tavern/Bar  
Restaurant  
Other:

Licenses currently held:

Alcohol:  Yes  No Class: BTAVN #: 209508  
 Tobacco:  Yes  No #:  
 Food:  Yes  No #: 16393  
 Extended Hours:  Yes  No #:  
 Secondhand Dealer:  Yes  No Type: #:  
 Other:  Yes  No Type: SD #: 1479  
 Other:  Yes  No Type: LZ #: 5526

**Exterior Survey:**

1. Is the area around the location clean?  Yes  No
2. What surrounds the location? (Check all the apply)
  - a.  Park
  - b.  School
  - c.  Youth Center
  - d.  Church
  - e.  Tavern(s) If so, how many
  - f.  Residential
  - g.  Other businesses
  - h.  Other:
3. Can you see from the outside of the location into the interior  Yes  No
4. Can you see the employees inside of the location from the outside  Yes  No
5. Are exterior windows free of signage  Yes  No
6. Is there a parking lot  Yes  No
7. Is the parking lot clean?  Yes  No
8. Off-Street parking  Yes  No
9. Is the parking lot well lit?  Yes  No
10. Valet Parking  Yes  No
  - a. Will this lot have a guard?  Yes  No
  - b. Will this lot have cameras?  Yes  No
11. Are there areas where a person could conceal themselves  Yes  No
12. Is there exterior lighting?  Yes  No. Does it appears to be adequate  Yes  No
13. Exterior Payphone?  Yes  No
14. Are there No Loitering Signs posted?  Yes  No
15. Are there exterior security cameras  Yes  No How Many:
16. Are the address numbers prominently displayed and easy to see  Yes  No

**Camera Survey:**

17. Does this location have security cameras?  Yes  No
18. Are they in working order?  Yes  No
19. What format are the cameras?
  - a. Color  Yes  No
  - b. Digital  Yes  No
  - c. Recorded  Yes  No
20. How long is footage stored for later viewing:
21. Are there exterior cameras  Yes  No How many:
22. Are there interior cameras  Yes  No How many:
23. Do all employees know how to retrieve recorded digital images/footage?  Yes  No

24. Cameras located in parking lot Yes No How many

**Interior Survey:**

25. What is the planned capacity 300
26. What is the minimum number of employees That will be on premise 1
27. Is the storeowner willing to be a standing complainant regarding loitering? Yes No  
a. If yes have them fill out the standing complaint form and give them two of the commercial signs Yes No
28. Is the interior of the location neat and clean? Yes No
29. Does an interior camera face the entrance/exit? Yes No
30. Is there a lockable area that separates employees from customers? Yes No
31. Are emergency and non-emergency numbers posted near the phone? Yes No
32. Does the owner know how to contact their police district directly? Yes No  
a. Did you provide a district contact guide to the owner? Yes No

**Security**

33. How many security personnel are going to be employed: 0
34. How ill they be deployed: Interior Exterior
35. What days will they be deployed MonTueWedThuFriSatSun
36. Will the security be managed by business or contracted
37. Will they be armed Yes No
38. What type of security measures to be used:  
Wanding/metal detector  
ID Scanner  
Dress Code  
Cover Charge  
Age restriction  
Other

**ADDITIONAL COMMENTS/RECOMMENDATIONS:**

Business is still under construction. Will be adding approximately 25 security cameras to the business. Business is considering private security for large events.



# NOTICE OF PUBLIC INTEREST

## New License Application Filed

BUSINESS OCCUPANT  
102 N WATER ST, 101  
MILWAUKEE, WI 53203-6056

Pursuant to Milwaukee Code of Ordinances, notice is hereby given that the following new retail establishment license application has been filed with the Office of the City Clerk-License Division:

<b>License Type(s):</b>	<b>Class B Tavern, Food Dealer - Restaurant, Public Entertainment Premises &amp; Sidewalk Dining</b>
<b>Applicant:</b>	<b>George S. Prassas, Agt. District 4 Social LLC</b>
<b>Business Name:</b>	<b>District 4 Social</b>
<b>Premise Address:</b>	<b>233 E Chicago St</b>

This applicant is filing new Class B Tavern, Food Dealer - Restaurant, Public Entertainment Premises, & Sidewalk Dining applications at this location.

A Class B Tavern license allows for the consumption of intoxicating liquors and fermented malt beverages on the licensed tavern premises.

A Food Dealer - Restaurant license allows for the sale and consumption of food and non alcoholic drink on the licensed premises.

A Public Entertainment Premises license allows entertainment such as floor shows, music exhibitions, dancing, cabaret acts, and theater performances provided that certain standards are complied with regarding proper dress code and conduct. The applicant has selected 6 Amusement Machines as the type of entertainment on the Public Entertainment Premises application.

A Sidewalk Dining Facility allows for consumption of food or beverages on the public right-of-way.

For more information regarding licensing please visit [www.milwaukee.gov/license](http://www.milwaukee.gov/license).

---

### HOW TO SUBMIT OBJECTIONS:

Written objections to the granting of the license based on the proposed operation of the license premises should be submitted immediately by any interested party to the Office of the City Clerk-License Division, City Hall, Room 105, 200 East Wells Street, Milwaukee, WI 53202, or via email to [license@milwaukee.gov](mailto:license@milwaukee.gov).

### WHAT TO SUBMIT IN OBJECTIONS:

Written objections must include the following information:

1. Name of the person objecting.
2. Contact information for the objector. (Mailing or Email address)
3. Information personally known to the objector that may form a basis for denial of the license application. Such information should relate to the manner in which the operation of the proposed premises will have an adverse impact on the health, safety, and welfare of the public and the neighborhood.

*Thursday, September 8, 2022*



# Concentration Map for 233 E Chicago St

## Area of Interest (AOI) Information

Area : 21,862,585.64 ft<sup>2</sup>

Sep 7 2022 15:00:28 Central Daylight Time

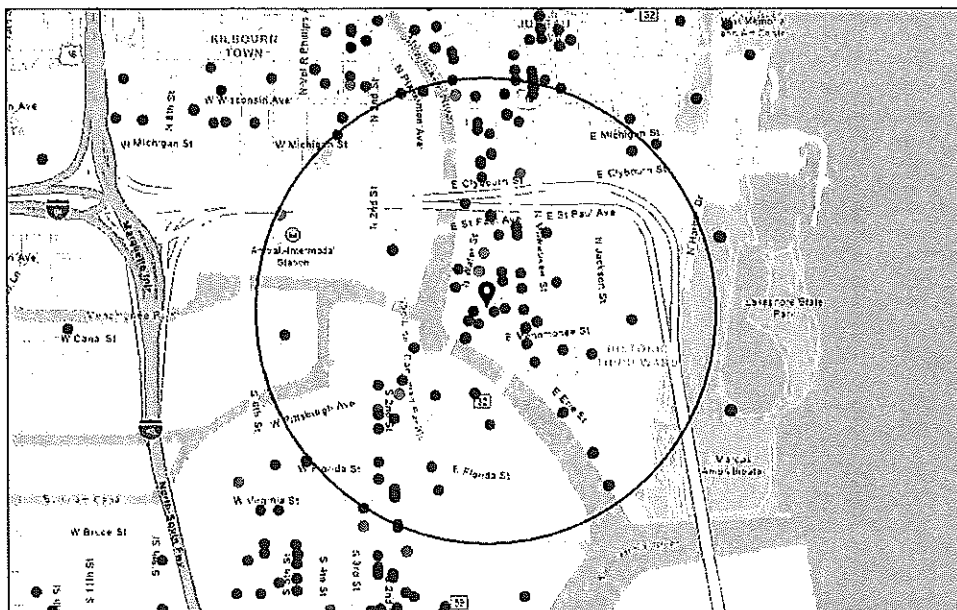

- Alcohol Licenses (active)
- Class A Fermented Malt Beverage
  - Class A Liquor and Malt
  - Class B Fermented Malt Beverage
  - Class B Tavern
  - Class C Wine Retailer

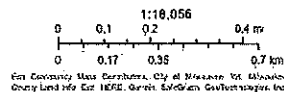

### Summary

Name	Count	Area(ft <sup>2</sup> )	Length(mi)
Alcohol Licenses	96		

### Alcohol Licenses



#	Legal Entity	Trade Name	Licensee	Address	License Type Name	Total Capacity	Expiration Date	Count
1	Giri Corporation	Stone Creek Coffee	Eric A Resch, Agt	422 N 5th ST	Class B Fermented Malt Beverage Retailer's License		11/29/2021, 6:00 PM	1
2	Shake Shack Wisconsin LLC	Shake Shack	ARI B DOMNITZ, Agt	220 E Buffalo ST 110	Class B Fermented Malt Beverage Retailer's License		11/26/2021, 6:00 PM	1
3	Button Block Holdings LLC	Homewood Suites Hotel	Tammy L.C. Fraley, Agt	500 N Water ST	Class B Tavern License		11/18/2021, 6:00 PM	1
4	The Brownstone LLC	The Brownstone	COREY L SMITH, Agt	524 N Water ST	Class B Tavern License		11/27/2021, 6:00 PM	1
5	Giri Corporation	Stone Creek Coffee	Eric A Resch, Agt	422 N 5th ST	Class C Wine Retailer's License		11/29/2021, 6:00 PM	1
6	Shake Shack Wisconsin LLC	Shake Shack	ARI B DOMNITZ, Agt	220 E Buffalo ST 110	Class C Wine Retailer's License		11/26/2021, 6:00 PM	1
7	CIRCLE K LLC	CIRCLE K PANTRY	ZIAD W KAID, Agt	130 N WATER ST	Class A Malt & Class A Liquor License		12/9/2021, 6:00 PM	1
8	Full of Beans LLC	Full of Beans Cafe	JoAnn R Hausknecht, Agt	184 S 2nd ST	Class B Fermented Malt Beverage Retailer's License		12/16/2021, 6:00 PM	1
9	TwoBirds LLC	Filament	Tyler T Curran, Agt	131 W SEEBOTH ST	Class B Tavern License		12/15/2021, 6:00 PM	1
10	CARNAL LLC	CLUB CHARLIES	CRAIG M BLOOMFIELD, Agt	320 E MENOMONEE ST	Class B Tavern License	128	12/14/2021, 6:00 PM	1
11	VINO THIRD WARD, LLC	VINO THIRD WARD	Julle L Peck, Agt	102C N WATER ST	Class B Tavern License	41	11/22/2021, 6:00 PM	1
12	MKE Water Street LLC	ELMNT Lounge	HABIB MANJEE, Agt	618 N WATER ST	Class B Tavern License		12/17/2021, 6:00 PM	1
13	The Xenia Group, LLC	Tied House	Ralph A Weber, Agt	124 N Water ST	Class B Tavern License		12/17/2021, 6:00 PM	1
14	Full of Beans LLC	Full of Beans Cafe	JoAnn R Hausknecht, Agt	184 S 2nd ST	Class C Wine Retailer's License		12/16/2021, 6:00 PM	1
15	NACAR LLC	Riverfront Pizzeria Bar & Grill	ARTURO NAPOLES CARRERA, Agt	509 E ERIE ST	Class B Tavern License	300	12/15/2021, 6:00 PM	1
16	Tua Pasta LLC	Tua Pasta	Alvaro Nino de Guzman Ramirez, Agt	100 E WISCONSIN AV LL101	Class B Fermented Malt Beverage Retailer's License		12/28/2021, 6:00 PM	1

17	Bowls LLC	Bowls	Andrew C Larson, Agt	207 W Freshwater WA	Class B Fermented Malt Beverage Retailer's License		12/3/2021, 6:00 PM	1
18	Carnivoras Inc	Carnevor	Joseph McLean, Agt	718 N Milwaukee ST	Class B Tavern License	99	1/25/2022, 6:00 PM	1
19	ALEM ETHIOPIAN RESTAURANT , LLC	ALEM ETHIOPIAN VILLAGE	MULU H HABTESILAS SIE, Agt	307 E WISCONSIN AV	Class B Tavern License	98	12/24/2021, 6:00 PM	1
20	COMPROV, INC	COMEDY SPORTZ	JOSHUA M LEFEVRE, Agt	420 S 1ST ST	Class B Tavern License	320	1/15/2022, 6:00 PM	1
21	Tua Pasta LLC	Tua Pasta	Alvaro Nino de Guzman Ramirez, Agt	100 E WISCONSIN AV LL101	Class C Wine Retailer's License		12/28/2021, 6:00 PM	1
22	Bowls LLC	Bowls	Andrew C Larson, Agt	207 W Freshwater WA	Class C Wine Retailer's License		12/3/2021, 6:00 PM	1
23	APARTMENT 720, LLC	APARTMENT 720	Tony T Skouflis, Agt	720 N MILWAUKEE ST	Class B Tavern License	299	1/24/2022, 6:00 PM	1
24	Joy DB LLC	DryBar	Joy N Vertz, Agt	241 N BROADWAY	Class B Tavern License	60	1/30/2022, 6:00 PM	1
25	ANACORP LLC	Cavas	Ana C Docta, Agt	401 E ERIE ST	Class B Tavern License		1/22/2022, 6:00 PM	1
26	Smoke Shack Mke, LLC	Smoke Shack	David J Marcus, Agt	332 N Milwaukee ST	Class B Tavern License	91	2/6/2022, 6:00 PM	1
27	Onesto MKE, LLC	Onesto	David J Marcus, Agt	221-223 N Broadway	Class B Tavern License	288	2/6/2022, 6:00 PM	1
28	Blue Bat Kitchen MKE, LLC	Blue Bat Kitchen	David J Marcus, Agt	249 N WATER ST	Class B Tavern License	240	2/6/2022, 6:00 PM	1
29	MCR Milwaukee Tenant LLC	Courtyard by Marriott Milwaukee Downtown	Kerri Huelsbeck, Agt	300 W Michigan ST	Class B Tavern License		2/4/2022, 6:00 PM	1
30	Camp Bar Inc	Campsite 131	Paul C Hackbarth, Agt	131 N Jackson ST	Class B Tavern License		2/9/2022, 6:00 PM	1
31	Indulge Wine Rooms LLC	Indulge Wine Room	MARC R BIANCHINI, Agt	158 N Broadway	Class B Tavern License	156	1/16/2022, 6:00 PM	1
32	STRAIGHT AHEAD, INC	CAROLINE'S	CAROL R RUBITSKY, Agt	401 S 2ND ST	Class B Tavern License	136	2/6/2022, 6:00 PM	1
33	THE WICKED HOP, LLC	THE WICKED HOP	MILES E O'NEIL, Agt	343-45 N BROADWAY	Class B Tavern License	160	2/28/2022, 6:00 PM	1
34	Foot Paw LLC	Amilinda	Gregory R Leon, Agt	315 E Wisconsin AV	Class B Tavern License		3/2/2022, 6:00 PM	1
35	Camp Bar Inc	Camp Bar	Paul C Hackbarth, Agt	525 E Menomonee ST	Class B Tavern License		3/27/2022, 7:00 PM	1

36	S&S Hospitality Concepts, LLC	Black Sheep	MICHAEL R SORGE, Agt	216 S 2nd ST	Class B Tavern License	160	1/19/2022, 6:00 PM	1
37	Gordo's Water Street, LLC	Toast	Gordon Goggin, Agt	231 S 2nd ST	Class B Tavern License	99	2/28/2022, 6:00 PM	1
38	CIELITO LINDO, LLC	CIELITO LINDO	LORENZO R LOPEZ, Agt	733-39 S 2ND ST	Class B Tavern License	198	3/3/2022, 6:00 PM	1
39	BRUNCH MKE LLC	BRUNCH	Morgan K Schnabl, Agt	714 N MILWAUKEE ST	Class B Tavern License	160	4/15/2022, 7:00 PM	1
40	SBB of Milwaukee Inc.	Stack'D Burger Bar	TREVOR M DANIELSEN, Agt	170 S 1st ST	Class B Tavern License		3/30/2022, 7:00 PM	1
41	Higbee's MKE LLC	District IV	PATSY SMITH-JAMES, Agt	628 N Water ST	Class B Tavern License	225	4/13/2022, 7:00 PM	1
42	Jay Squared LLC	The Box	Jamie A Berger, Agt	311 E Wisconsin AV	Class B Tavern License	270	4/11/2022, 7:00 PM	1
43	goRI Food Entertainment Inc	Char'd	Jongsoo Kim, Agt	222 E Erie ST 100	Class B Tavern License		5/9/2022, 7:00 PM	1
44	Hungry Sailor, Inc	Milwaukee Sail Loft	JEFFREY G REINBOLD, Agt	649 E Erie ST	Class B Tavern License	300	4/11/2022, 7:00 PM	1
45	Kipper LLC	Fore Milwaukee	Timothy M Grogan, Agt	530 N Water ST	Class B Tavern License		4/11/2022, 7:00 PM	1
46	Olive Tree LLC	Convenience +	Jamal T Shavar, Agt	308 E Wisconsin AV	Class A Malt & Class A Liquor License		5/19/2022, 7:00 PM	1
47	The North/South Club, Inc	North South Club	Marla R Poytinger, Agt	175 S Water ST	Class B Tavern License	299	5/30/2022, 7:00 PM	1
48	HY-VEE, INC.	Wahlburgers	Ross Grunwald, Agt	322 N BROADWAY 100	Class B Tavern License		5/2/2022, 7:00 PM	1
49	Memento LLC	Bavette	Karen E Bell, Agt	330 E Menomonee ST	Class B Tavern License		5/19/2022, 7:00 PM	1
50	Milwaukee Artist Resource Network Inc	Milwaukee Artist Resource Network	Malaquias E Montoya, Agt	191 N Broadway 102	Class B Tavern License	150	5/15/2022, 7:00 PM	1
51	Pritzlaff Events LLC	Pritzlaff / Aperitivo	Kendall G Breunig, Agt	311-333 N Plankinton AV	Class B Tavern License	915	5/20/2022, 7:00 PM	1
52	JSWD Wisconsin Venture I LLC	The Westin Milwaukee	Keith A Filipak, Agt	550 N Van Buren ST	Class B Tavern License		5/22/2022, 7:00 PM	1
53	MC ZAR'S, LLC	O'Lydia's Bar & Grill	Linda M Sackett, Agt	338 S 1ST ST	Class B Tavern License	150	6/4/2022, 7:00 PM	1
54	Foltz Family Market, Inc	Foltz Family Market	Casey C Foltz, Agt	400 N WATER ST 6	Class B Tavern License		5/29/2022, 7:00 PM	1

55	HTWA MARKET PROJECT, LLC	MILWAUKEE PUBLIC MARKET	MICHAEL GARDNER, Agt	400 N WATER ST	Class B Tavern License	320	5/28/2022, 7:00 PM	1
56	Kimpton Hotel & Restaurant Group LLC	Journeyman Hotel	Patrick J Gaskin, Agt	310 E Chicago ST	Class B Tavern License		6/15/2022, 7:00 PM	1
57	Wisconsin & Milwaukee Hotel, LLC	Milwaukee Marriott Downtown/Starbucks	Keith A Filipak, Agt	323 E Wisconsin AV	Class B Tavern License	312	5/23/2022, 7:00 PM	1
58	THIEF WINE, LLC	THIEF WINE SHOP & BAR	PHILIP M BILODEAU, Agt	400 N WATER ST	Class B Tavern License	42	6/29/2022, 7:00 PM	1
59	Benelux Third Ward, LLC	Cafe Benelux	ERIC G WAGNER, Agt	346 N Broadway	Class B Tavern License	455	5/1/2022, 7:00 PM	1
60	SCREAMING TUNA RESTAURANT, LLC	SCREAMING TUNA	Jeff T Bronstad, Agt	106 W SEEBOTH ST 102	Class B Tavern License	174	6/13/2022, 7:00 PM	1
61	First MKD, LLC	Hilton Garden Inn	Sarah I Frost, Agt	611 N BROADWAY	Class B Tavern License		6/15/2022, 7:00 PM	1
62	THE SALOON, LTD	JUST ART'S SALOON	ARTHUR R GUENTHER, Agt	181 S 2ND ST	Class B Tavern License	70	6/29/2022, 7:00 PM	1
63	JING'S CORPORATION	JING'S	JING WANG, Agt	207 E BUFFALO ST 168	Class B Fermented Malt Beverage Retailer's License	45	7/29/2022, 7:00 PM	1
64	HTWA - Catalano Square	HTWA - Catalano Square	Jack R Lemmon, Agt	138 N Broadway	Class B Tavern License		7/28/2022, 7:00 PM	1
65	JING'S CORPORATION	JING'S	JING WANG, Agt	207 E BUFFALO ST 168	Class C Wine Retailer's License	45	7/29/2022, 7:00 PM	1
66	Toro MKE, LLC	2A Wine Merchants	Robert M Levin, Agt	577 E Erie ST	Class B Tavern License		7/11/2022, 7:00 PM	1
67	MP On Wheels Catering Service	MP On Wheels Catering Service	DULCE M ALARCON, SP	400 N WATER ST	Class B Tavern License	320	7/11/2022, 7:00 PM	1
68	Levy Restaurants at Harley Davidson	Levy Restaurants at Harley Davidson	Dave Kash, Agt	401 W CANAL ST	Class B Tavern License	690	7/5/2022, 7:00 PM	1
69	WA Cheese & Sausage Shoppe, Inc	WA Cheese & Sausage Shoppe	Mark S Lutz, Agt	400 N WATER ST 24	Class B Tavern License		6/29/2022, 7:00 PM	1
70	The Loft on Broadway, LLC	The Loft on Broadway	MEI LYN NELSON, Agt	177 N BROADWAY 3rd Floor	Class B Tavern License		7/13/2022, 7:00 PM	1
71	Môrel Restaurant LLC	Morel Restaurant	Jonathan S Manyo, Agt	430 S 2nd ST	Class B Tavern License		7/16/2022, 7:00 PM	1
72	RIVERWALK COMMONS LLC	Riverwalk Commons	PAUL H SCHWARTZ, Agt	423 N WATER ST	Class B Tavern License		7/28/2022, 7:00 PM	1

73	Merriment Social LLC	Merriment Social	Andrew H Miller, Agt	240 E Pittsburgh AV	Class B Tavern License		8/4/2022, 7:00 PM	1
74	Central Standard LLC	Central Standard Craft Distillery	William P McQuillian, Agt	320 E Clybourn ST	Class B Fermented Malt Beverage Retailer's License		8/4/2022, 7:00 PM	1
75	Dan Dan LLC	Dan Dan	Daniel P Jacobs, Agt	360 E ERIE ST	Class B Tavern License	165	8/3/2022, 7:00 PM	1
76	Red Elephant LLC	Nicole's Third Ward Social	JACOB E DEHNE, Agt	333 N Broadway	Class B Tavern License		9/8/2022, 7:00 PM	1
77	ST. PAUL SEAFOOD, LLC	ST. PAUL FISH CO.	TIMOTHY G COLLINS, Agt	400 N WATER ST	Class B Tavern License		9/20/2022, 7:00 PM	1
78	Indulgence Chocolatiers LLC	Indulgence Chocolatiers	Julie A Waterman, Agt	211 S 2nd ST	Class B Tavern License		9/22/2022, 7:00 PM	1
79	MILWAUKEE CANDLE COMPANY, LLC	Glassnote Candle Bar	Kevin J Goudzwaard, Agt	524 S 2ND ST 2	Class B Tavern License		9/28/2022, 7:00 PM	1
80	Woori Corp	Kanpai	Changhun Kim, Agt	408 E Chicago ST	Class B Tavern License	99	9/3/2022, 7:00 PM	1
81	Sirk Steak LLC	Mo's A Place for Steaks	JAMES A VASSALLO, Agt	720 N Plankinton AV	Class B Tavern License		9/2/2022, 7:00 PM	1
82	Next Act Theatre, Inc.	Next Act Theatre	David A Ceccarini, Agt	255 S Water ST	Class B Tavern License		9/18/2022, 7:00 PM	1
83	INDULGE WINE ROOMS, LLC	INDULGE	MARC R BIANCHINI, Agt	708 N MILWAUKEE ST	Class B Tavern License	60	8/30/2022, 7:00 PM	1
84	The Explorium Brewpub Third Ward LLC	The Explorium Brewpub	Michael P Doble, Agt	143 W ST PAUL AV	Class B Tavern License		9/20/2022, 7:00 PM	1
85	Sweet Diner LLC	Sweet Diner	George S Prassas, Agt	239 E Chicago ST 103	Class B Tavern License		10/14/2022, 7:00 PM	1
86	SINCERESWAN, LLC	SWINGIN DOOR EXCHANGE	MICHELLE M SINCERE, Agt	219 E MICHIGAN ST	Class B Tavern License	80	10/10/2022, 7:00 PM	1
87	Caminobar LLC	Camino	CASEY A RATA CZAK, Agt	434 S 2nd ST	Class B Tavern License	48	10/12/2022, 7:00 PM	1
88	Drury Hotels Company, LLC	Drury Plaza Hotel - Milwaukee Downtown	Chris Palid, Agt	700 N Water ST	Class B Tavern License		10/2/2022, 7:00 PM	1
89	PTG Live Events LLC	The Riverside	Richard J Ryan, Agt	116 W Wisconsin AV	Class B Tavern License	2,480	7/29/2022, 7:00 PM	1
90	TUPELO HONEY HOSPITALITY CORPORATION	Tupelo Honey Cafe	Harper D Feltner, Agt	511 N BROADWAY 100	Class B Tavern License		7/11/2022, 7:00 PM	1

91	BRG ICC LLC	Bartolotta Catering & Events at the Italian Community Center	CHRISTIAN M DAMIANO, Agt	631 E Chicago ST	Class B Tavern License	598	9/21/2022, 7:00 PM	1
92	BARTOLOTTA CATERING - GRAIN EXCHANGE LLC	BARTOLOTTA CATERING - GRAIN EXCHANGE LLC	CHRISTIAN M DAMIANO, Agt	225 E MICHIGAN ST	Class B Tavern License	299	9/21/2022, 7:00 PM	1
93	Grand Royale LLC	Fauntleroy	Daniel P Jacobs, Agt	316 N MILWAUKEE ST	Class B Tavern License		9/14/2022, 7:00 PM	1
94	Shakersmilwaukee Inc	Shakers Cigar Bar and World Cafe	ROBERT G WEISS, Agt	422 S 2nd ST	Class B Tavern License	144	10/12/2022, 7:00 PM	1
95	Black Tuna LLC	Lucky Ginger	Soukvilay Sayavongsa, Agt	221 N Water ST	Class B Tavern License		8/15/2022, 7:00 PM	1
96	VINO THIRD WARD, LLC	VINO THIRD WARD	Julie L. Peck, Agt	102C N WATER ST	Class B Tavern License	41	11/22/2022, 6:00 PM	1

Establishments within a 0.5 miles radius centered on area of interest.



Thursday, September 15, 2022



# Notice of Public Hearing

Blank Notice

---

PRASSAS, George S  
District 4 Social at 233 E CHICAGO St.  
Class B Tavern, Public Entertainment Premises, Food Dealer and Sidewalk Dining License  
Applications Requesting 6 Amusement Machines

**Tuesday, September 27, 2022 at 03:40 PM**

To whom it may concern:

The above application has been made by the above named applicant(s). This requires approval from the Licenses Committee and the Common Council of the City of Milwaukee. The hearing before the Licenses Committee will take place virtually on 09/27/2022 at 03:40 PM. This is a public hearing. Those wishing to view the proceeding are able to do so via the City Channel – Channel 25 on Spectrum Cable – or on the Internet at <http://city.milwaukee.gov/citychannel>. Those wishing to provide oral testimony will be asked to do so by phone or internet and are asked to contact the staff assistant, Yadira Melendez at (414) 286-2775 or [stasst5@milwaukee.gov](mailto:stasst5@milwaukee.gov) for necessary information. Please make such requests no later than one business day prior to the start of the meeting. You are not required to attend the hearing, but please see the information below if you would like to provide testimony. Once the Licenses Committee makes its recommendation, this recommendation is forwarded to the full Common Council for approval at its next regularly scheduled hearing.

---

## Important details for those wishing to provide information for the Licenses Committee to consider when making its recommendation:

1. The license application is scheduled to be heard at the above time. Due to other hearings running longer than scheduled, you may have to wait some time to provide your testimony.
2. You must testify as to matters that you have personally experienced or seen. (You cannot provide testimony for your neighbor, parent or anyone else; this is considered hearsay and cannot be considered by the committee.)
3. No letters or petitions can be accepted by the committee (unless the person who wrote the letter or the persons who signed the petition are willing to testify).
4. Persons opposed to the license application are given the opportunity to testify first; supporters may testify after the opponents have finished.
5. When you are called to testify, you will be sworn in and asked to give your name, and address. (If your first and/or last names are uncommon please spell them.)
6. You may then provide testimony.
  - a. Include only information relating to the above license application.
  - b. Include only information you have personally witnessed or seen.
  - c. Provide concise and relevant information detailing how this business has affected or may affect the peaceful enjoyment of your neighborhood.
  - d. If by the time you have the opportunity to testify, the information you wish to share has already been provided to the committee, you may state that you agree with the previous testimony. Redundant or repetitive testimony will not assist the committee in making its recommendation.
7. After giving your testimony, the members of the Licenses Committee and the licensee may ask questions regarding the testimony you have given or other factors relating to the license application.
8. Business Competition is not a valid basis for denial or non-renewal of a license.

**Please Note: If you have submitted an objection to the above application your objection cannot be considered by the committee unless you personally testify at the hearing.**

















CURRENT OCCUPANT 254 E CHICAGO ST, 400 MILWAUKEE, WI 53202-5744  
CURRENT OCCUPANT 254 E CHICAGO ST, 401 MILWAUKEE, WI 53202-5744

Blank Notice

Total Records: 330

Radius 250.0 feet and Center of Circle: 233 E Chicago St



# BUSINESS LICENSE PLAN OF OPERATION

ccl-busplan 5/12/2020

Office of the City Clerk License Division  
200 E. Wells St. Room 105, Milwaukee, WI 53202  
(414) 286-2238 www.milwaukee.gov/license e-mail address: [license@milwaukee.gov](mailto:license@milwaukee.gov)

## 1. Type of Business

Applying for:  Extended Hours (12AM to 5AM) - If a food establishment, check all that apply:  Delivery  Drive Thru  Dining Room  
 Self Service Laundry  Massage Establishment  Filling Station  
 Other (supplemental application for specific license also required)

Provide a detailed description of the type of business you plan on operating:  
Restaurant, Bar, Service Bar, Games

Do you have any experience operating this type of business?  No  Yes If yes, explain: Sweet Diner LLC

## 2. Business Operations

- a. Proposed Opening Date: 10/15/22
- b. Is this premise under construction?  No  Yes If yes, list estimated completion date: \_\_\_\_\_
- c. Is this a franchise?  No  Yes
- d. Is this premises currently licensed?  No  Yes If yes, list type of license: \_\_\_\_\_
- e. Is the current licensee operating?  No  Yes If no, list date closed: 2015
- f. Do you have future plans for other businesses, licenses or permits at this location?  No  Yes  
If yes, explain: \_\_\_\_\_
- g. Have you previously held an Extended Hours License in Milwaukee?  No  Yes  
If yes, list address(es): \_\_\_\_\_
- h. Are other businesses operating in the same building?  No  Yes If yes, describe: Sweet Diner

## 3. Litter & Noise

- a. How are grounds kept clean?  Sweep  Pressure Wash  Pick Up Litter  Other: \_\_\_\_\_
- b. How often will grounds be cleaned?  Daily  Weekly  As Needed  Monthly  Other: \_\_\_\_\_
- c. Grounds cleaned by:  Licensee  Building Owner  Employees  Hired Maintenance  Other: \_\_\_\_\_
- d. How are noise issues prevented and/or addressed?  Security  Manager approaches customer(s)  Call Police  
 Signs Posted  Other: \_\_\_\_\_
- e. Will a sound amplification system be used?  No  Yes If yes, describe: speakers

## 4. Smoking & Sanitation

- a. Are there designated outdoor smoking areas?  No  Yes If yes, describe: \_\_\_\_\_
- b. Number of Garbage Cans: Inside: 8 Locations: BAR, KITCHEN, DISH AREA, BATHROOMS  
Outside: 4 Locations: REAR OF PREMISES
- c. Is a crowd control barrier used?  No  Yes If yes, describe: \_\_\_\_\_
- d. How many restrooms are on the premises? 2
- e. Name of solid waste contractor:  Advanced Disposal  Waste Management  Other: \_\_\_\_\_



## 5. Security

**(STAFF ONLY)**

- a. Are there onsite parking spaces?  No  Yes If yes, how many? 5 and describe the parking security plan: Exterior lighting
- b. Is there a loading zone?  No  Yes If yes, describe the loading area security plan: Exterior lighting
- c. Will you have security personnel on premise?  No  Yes If yes, how many? \_\_\_\_\_ and answer the following:  
 What are their responsibilities? \_\_\_\_\_  
 Is security equipment used?  No  Yes If yes, describe \_\_\_\_\_  
 List their licensing, certification, or training credentials \_\_\_\_\_
- d. Will there be security cameras?  No  Yes If yes, how many? \_\_\_\_\_ and list locations: \_\_\_\_\_
- e. Will searches/identification checks be done upon entry?  No  Yes If yes, describe \_\_\_\_\_

## 6. Percentage of Sales (must total 100%)

Alcohol <u>20</u> %	Food <u>80</u> %	Secondhand Merchandise _____ %	Precious Metals & Gems _____ %
Entertainment _____ %	Cigarettes _____ %	Personal Services (such as tattoo, body piercing, salon, tailor, tanning, etc.) _____ %	Other _____ % Describe: _____
Pawnbroker Activity _____ %	Salvaged Materials _____ % (such as scrap metal)		

## 7. Businesses/Licenses on the Premises (check all that apply):

### Type 1

- Full Service Restaurant     Cafe/Coffee Shop     Deli or Fast Food Restaurant     Private/Fraternal/Veterans Club
- Night Club     Tavern     Cocktail Lounge     Teen Club
- Banquet Hall     Sports Facility     Bowling Alley
- Hotel/Motel : Number of Floors: \_\_\_\_\_     Rooming House: Number of Floors: \_\_\_\_\_  
 Number of Rooms: \_\_\_\_\_    Number of Rooms: \_\_\_\_\_

### Type 2

- Liquor Store     Corner Store     Supermarket     Convenience Store
- Gas Station     Amusement/Phonograph Distributor     Recycling, Salvage or Towing
- Used Car Dealer     Personal Service Establishment  
 (such as tattoo business, hair salon, tailor, etc.)     Recording Studio

What other licenses/permits will you hold at this location? (check all that apply)

- Occupancy Permit     Cigarette & Tobacco     Gas Station     Extended Hours     Class "B" Tavern     Weights & Measures
- Secondhand Dealer     Precious Metal & Gem     Other: \_\_\_\_\_

## 8. Legal Capacity (only if a Type 1 premises in #7 above)

Capacity 300 (Call the Milwaukee Development Center at 414-286-8211 if you have questions.)

## 9. Premises Description

a. Identify all area(s) of the premises that will be used in operating this business (include areas used only for storage):

1<sup>st</sup> Floor  2<sup>nd</sup> Floor  Basement Storage  Patio  Beer Garden  Sidewalk Café  Deck  Rooftop

Other: Describe: \_\_\_\_\_

b. Describe Location:  Major Thoroughfare  Secondary Street  Other: \_\_\_\_\_

c. Nearest Major Cross Street: Water Street

d. Describe Building:  Free Standing Building  Strip Mall  Other: \_\_\_\_\_

e. Describe Premises Structure:  Single Story  Multi-Story - # of Stories \_\_\_\_\_  Other: \_\_\_\_\_

f. Describe Surrounding Area:  Commercial  Residential  Industrial  Other: Mixed residential/commercial

g. Building Owner Name: Nikon Chicago LLC Phone Number: 414 271 5200

Building Owner Address: 239 E. Chicago Street #101, Milwaukee WI 53202

## 10. Hours of Operation & Customers

Will customers be entering the premises?  No  Yes

Day of the Week	Proposed Hours of Operation:		Estimated Number of Customers expected each day	Potential Age Range of Customers	Class B Tavern Applicant Only: Age Restriction (If none, write 'None')
	Open Time (include a.m. or p.m.)	Close Time (include a.m. or p.m.)			
Sunday	6:00 a.m.	2:00 a.m.	300	10-65	None
Monday	6:00 a.m.	2:00 a.m.	300	10-65	None
Tuesday	6:00 a.m.	2:00 a.m.	300	10-65	None
Wednesday	6:00 a.m.	2:00 a.m.	300	10-65	None
Thursday	6:00 a.m.	2:00 a.m.	300	10-65	None
Friday	6:00 a.m.	2:30 a.m.	600	10-65	None
Saturday	6:00 a.m.	2:30 a.m.	600	10-65	None

An Extended Hours Establishment License is required for any convenience store, filling station, personal service establishment (such as tattoo, body piercing, salon, tailor, tanning, etc.), recording studio or restaurant which is open between the hours of 12:00 a.m. and 5:00 a.m.

Alcohol Establishments Permitted Hours of Operation: Class A: 8:00 am to 9:00 pm Sunday thru Saturday  
Class B: 6:00 am to 2:00 am Sunday thru Thursday, 6:00 am to 2:30 am Friday & Saturday

Entertainment Outdoor Closing Hours: 10:00pm Sunday-Thursday; 12:00am Friday & Saturday; unless a different time, either earlier or later, is established by the Common Council in its approval of the licensee's plan of operation.

## 11. Signature(s)

Signature of Sole Proprietor, Partner, or 20% or more Shareholder  
(If there are no 20% or more shareholders  
Corporate Officer-print name/title and sign)

Signature of additional partner or 20% or more shareholder

See Application Information for a complete list of all required application forms.



# ALCOHOL BEVERAGE & PUBLIC ENTERTAINMENT PREMISES SUPPLEMENTAL APPLICATION

Office of the City Clerk License Division  
200 E. Wells St. Room 105, Milwaukee, WI 53202  
(414) 286-2238 e-mail address: license@milwaukee.gov [www.milwaukee.gov/license](http://www.milwaukee.gov/license)

Legal Entity Name:	District 4 Social LLC
Premise Address:	233 E. Chicago Street
<b>Proximity of Premises to Church, School, Daycare Center or Hospital</b>	
Is the building within 300 feet of any church, school, daycare center or hospital? <input checked="" type="checkbox"/> No <input type="checkbox"/> Yes	
<b>"Service Bar Only" Designation</b>	
If applying for Class B or C license, are you applying for "Service Bar Only"? <input checked="" type="checkbox"/> No <input type="checkbox"/> Yes	
Service Bar Only means customers cannot sit at the bar. Alcohol is served to employees who serve patrons seated at tables. No stools, chairs or other articles of furniture shall be placed at the service bar for patrons to sit upon.	
<b>Business Information</b>	
a) Are you taking out this application for anyone that may not be eligible for a license? <input checked="" type="checkbox"/> No <input type="checkbox"/> Yes If yes, list their name and address: _____	
b) Will the agent, a partner or the individual licensee be conducting the day-to-day operations of the business? <input type="checkbox"/> No <input checked="" type="checkbox"/> Yes If no, list the name and address of the person(s) who will: _____	
Class B Applicants: If the agent, a partner or the individual licensee will not be conducting the day-to-day operations of the business, the person(s) listed above must obtain a Class B Managers license.	
c) Does anyone else have money invested or any other interest in this business? <input checked="" type="checkbox"/> No <input type="checkbox"/> Yes If yes, explain: _____	
d) Have you made an agreement with anyone to repay any loan or any other payments based upon income from the business? <input checked="" type="checkbox"/> No <input type="checkbox"/> Yes If yes, list name and address: _____	
<b>Property Information (New &amp; Transfer Applicants Only)</b>	
a) Do you own or lease the building? <input type="checkbox"/> Own <input checked="" type="checkbox"/> Lease	
b) Who owns the fixtures (for example, coolers, etc.)? <u>tenant</u>	
c) Are you purchasing the stock and/or fixtures? <input checked="" type="checkbox"/> No <input type="checkbox"/> Yes If yes, amount paid \$ _____	
d) Total amount paid for business \$ <u>NA</u>	
e) Total amount paid for goodwill of the business \$ <u>NA</u>	
Goodwill comprises the reputation and customer relationships of an existing business. If the price you pay for the business exceeds the fair market value of all of the rest of the assets of the business, the excess may be considered goodwill.	
f) Have you made arrangements with the seller for payment of personal property taxes? <input type="checkbox"/> No <input type="checkbox"/> Yes <u>NA</u>	
<b>Lease Information (New &amp; Transfer Applicants who are leasing the premises only)</b>	
a) Date lease begins <u>July 1, 2022</u> Ends <u>JUNE 30<sup>th</sup> 2031</u>	
b) Monthly rental \$ <u>10,671.00</u>	
c) Do you have an option to renew the lease? <input type="checkbox"/> No <input checked="" type="checkbox"/> Yes	
d) Does your lease allow for assignment to another party without the consent of the owner? <input checked="" type="checkbox"/> No <input type="checkbox"/> Yes	
e) For what length of time have you been guaranteed occupancy (number of years)? <u>10 years</u>	

**Lease Information (Continued)**

- f) In addition to paying the monthly rental, will you have to pay anything additional to the owner of the building to guarantee performance of the lease?  No  Yes If yes, explain \_\_\_\_\_
- g) Does the present owner or occupancy object to the granting of your license?  No  Yes  
If yes, explain \_\_\_\_\_

**Change of Agent Applicants Only**

Have there been any changes to the floor plan since the last application was submitted?  No  Yes  
If no, a new floor plan is not required. If yes, submit a new floor plan and explain the change(s):

\_\_\_\_\_

**Signature**

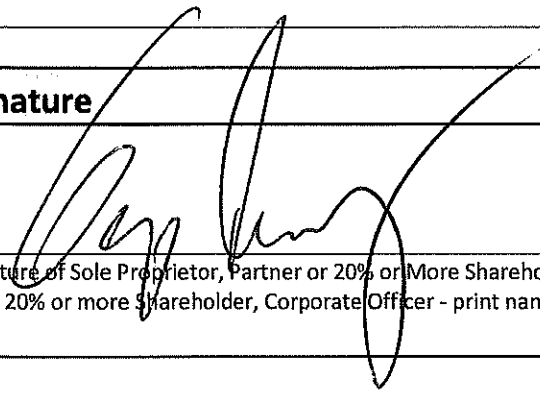

Signature of Sole Proprietor, Partner or 20% or More Shareholder  
(If no 20% or more Shareholder, Corporate Officer - print name/title and sign)

Note: All information contained in this application is subject to approval by the Common Council.  
Deviating from approved plan of operation will subject licensee to citations, and/or suspension or non-renewal of the license.  
Contact the License Division for information on how to request changes.

**New and transfer of premises applicants must submit the following:**

- Detailed floor plan
- If a restaurant, copy of the menu



# FOOD DEALER LICENSE PLAN OF OPERATION

OFFICE OF THE CITY CLERK, LICENSE DIVISION  
CITY HALL, 200 E. WELLS ST, ROOM 105, MILWAUKEE, WI 53202  
(414) 286-2238 • [license@milwaukee.gov](mailto:license@milwaukee.gov) • [www.milwaukee.gov/license](http://www.milwaukee.gov/license)

Legal Entity Name: District 4 social LLC

Premises Address: 233 E Chicago Street Milwaukee WI 53202

## SECTION 1 TYPE OF BUSINESS

What will be the majority of your food sales? (check one)

Restaurant Items (meals):  
MEALS include, but are not limited to, chicken, ribs, sandwiches, roasted corn, baked potatoes, hot dogs, brats, tacos, nachos w/ cheese and meat, French fries, cooked or deep fried vegetables/fruit, cooked cheese curds, corn dogs, egg rolls, salads.

Retail Items (snacks and beverages):  
RETAIL Items include, but are not limited to, ice cream/soft serve, lemonade, snow cones, coffee, espresso, cappuccino, tea, fruit juice, smoothies, candy, dispensed soda, fruit cups, bakery, cookies, kettle corn, cotton candy, funnel cakes, fritters, tortilla chips w/ cheese.

Will it be a convenience store?  Yes  No

A convenience store contains less than 5,000 square feet of retail space and has, as its primary business, the sale of basic food items and in addition, sells household products or is a filling station that sells basic food items and household products.

Bed & Breakfast

Micro Market

All Applicants: Submit a menu or a list of food items that will be sold.

Will any wholesale business be done?  No  Yes If yes, what percentage of food sales will be wholesale?

Less than 25%

25% or More AND:

Restaurant Items (meals) will be sold – Complete this application and also contact DATCP.

NO restaurant items (meals) will be sold - Do NOT complete this application. Contact DATCP only.

## SECTION 2 FOOD PROCESSING

Will any food processing be done?  No  Yes

Processing is defined as assembling, grinding, cutting, mixing, baking, coating, stuffing, packing, bottling, grilling, canning, extracting, fermenting, distilling, pickling, freezing, drying, smoking, or packaging.

## SECTION 3 FOOD REQUIRING TEMPERATURE CONTROL

Will any food that requires temperature control be sold?  No  Yes  
(includes dairy products such as milk, cheese, and ice cream, fish, shellfish, meat, poultry)

If yes, list the types of food items: Dairy products, fish, shell fish, meat, poultry

**SECTION 4 DETAILS OF OPERATION**

Will you have seating on site for dining?  No  Yes

Will you be doing any catering?  No  Yes

Will you be doing any delivery?  No  Yes

Will you have outdoor activities?  No  Yes - Check all that apply:  Bar  Cooking/Grilling  Dining

Will you have a drive thru window?  No  Yes - Are hours different from inside?  No  Yes

If Yes, provide drive thru hours: \_\_\_\_\_

Will scales or barcode scanners be used?  No  Yes - You must also apply for a Weights & Measures License.

**SECTION 5 ADDITIONAL SITES**

Where will food be prepared and/or sold?

At a single site  At multiple sites: How many? \_\_\_\_\_ (for example, a hotel with several dining rooms or bars)

If multiple sites, attach a Food Dealer Additional Site Addendum (ccl-foodadd) for each additional site.

**SECTION 6 CONSTRUCTION OR CHANGES**

Are you planning any construction, remodeling or equipment changes?

No If No, SKIP to Section 8

Yes If Yes, check all that apply:  New construction of a building  Renovation or remodeling

Construction changes to existing building  Equipment changes only

Provide a brief description of the changes: Build-out of restaurant for kitchen and dining

Start date: September 7, 2022

Name, Address & Phone Number of Architect: Antonio FaiZZa Assts. Ltd. 847-827-5644  
2363 Lechner Ln Des Plaines IL 60016

Name, Address & Phone Number of Contractor: Magnet Group 271-5200  
299 E Chicago Milwaukee WI 53202

**SECTION 7 ALCOHOL BEVERAGES**

Are you applying for an alcohol beverage license?

No If No, SKIP to Section 8

Yes If YES, if your food license is approved prior to the alcohol license, when do you want the food license issued?

Immediately  At the same time as the alcohol license

**SECTION 8 ACKNOWLEDGEMENTS & SIGNATURE**

You must initial each item confirming your understanding:

6.p. I understand the Health Department must conduct an inspection and advise the License Division of their approval before the license may be issued.

6.p. I understand I must obtain an occupancy permit from the Department of Neighborhood Services and an inspection may be required. Neighborhood Services must advise the License Division of their approval before the license may be issued.

6.p. I understand the district alderperson will review and either support or object to my application. If he/she objects, I may appeal and be scheduled to appear before the Licenses Committee. The Licenses Committee will then make a recommendation to the Common Council. The Common Council must grant the license before it may be issued.

6.p. I understand proof of payment for all license fees must be on file in the License Division before the license may be issued and the license must be issued and posted in my establishment prior to opening for business.

6.p. I will not operate my food business until the license has been issued and posted in the establishment.

Signature of Sole Proprietor, Partner, or 20% Shareholder: \_\_\_\_\_

Signature of Additional Partner: \_\_\_\_\_



# PUBLIC ENTERTAINMENT PREMISES LICENSE SUPPLEMENTAL APPLICATION

Office of the City Clerk License Division  
200 E. Wells St. Room 105, Milwaukee, WI 53202  
(414) 286-2238 [www.milwaukee.gov/license](http://www.milwaukee.gov/license) e-mail address: [license@milwaukee.gov](mailto:license@milwaukee.gov)

**PREMISES ADDRESS:** 233 E. Chicago Street

**TYPES OF ENTERTAINMENT (CHECK ALL THAT APPLY)**

- |   |  |   |   |
|---|--|---|---|
| <input type="checkbox"/> Instrumental Musicians                                     | <input type="checkbox"/> Battle of the Bands | <input type="checkbox"/> Dancing by Performers                          | <input checked="" type="checkbox"/> Amusement Machines<br>How many? <u>6</u>  |
| <input type="checkbox"/> Bands  | <input type="checkbox"/> Comedy Acts         | <input type="checkbox"/> Adult Entertainment/<br>Strippers/Erotic Dance | <input type="checkbox"/> Concerts<br>Approx. # per year? _____                |
| <input type="checkbox"/> Bowling Alley<br>How many? _____                           | <input type="checkbox"/> Disc Jockey         | <input type="checkbox"/> Wrestling                                      | <input type="checkbox"/> Theatrical Performances<br>Approx. # per year? _____ |
| <input type="checkbox"/> Pool Tables<br>How many? _____                             | <input type="checkbox"/> Magic Shows         | <input type="checkbox"/> Patron Contests                                | <input type="checkbox"/> Jukebox  |
| <input type="checkbox"/> Motion Pictures (movies by<br>admission) - How many? _____ | <input type="checkbox"/> Poetry Readings     | <input type="checkbox"/> Patrons Dancing                                | <input type="checkbox"/> Karaoke  |
| <input type="checkbox"/> Other: _____   |  |   |   |

*Entertainment Outdoor Closing Hours: 10:00pm Sunday-Thursdays; 12:00am Friday & Saturday; unless a different time, either earlier or later, is established by the Common Council in its approval of the licensee's plan of operation.*

**PROMOTERS/SOUND AMPLIFICATION**

Will promoters ever be used for any of the entertainment?  No  Yes If Yes, Describe: \_\_\_\_\_

At any time will sound amplification be used?  No  Yes If Yes, Describe: speakers

**LEGAL CAPACITY OF PREMISES**

300 (Call the Development Center at 414-286-8211 with questions.) Legal capacity determines the fee for your Public Entertainment Premises License. If you would like to request the license be approved with a lower capacity than that listed above, indicate the lower capacity here: \_\_\_\_\_. If approved, this lower capacity will print on your license and override the capacity listed on your Occupancy Permit.

**ACKNOWLEDGEMENT/SIGNATURE**

I understand that after the license has been issued, a change to the plan of operation will require a written request to change and approval from the Common Council. I agree to inform the City Clerk within 10 days of any substantial changes in the information supplied in this application. I understand that I shall not willfully refuse to provide the services offered under this license, or add charges or require deposits not required of the general public because of race, color, sex, religion, national origin or ancestry, age, handicap, lawful source of income, marital status, sexual orientation, gender identity or expression, familial status or the fact that a person is now or has been a member of the military service, whether dressed in uniform or not; and shall not seek such information as a condition of employment, or penalize any employee or discriminate in the selection of personnel for training or promotion on the basis of such information.

I have knowledge of the City Ordinances currently regulating public entertainment, and understand that the license may be subject to suspension, non-renewal or revocation, if I violate any rule, law or regulation of the city of Milwaukee and State of Wisconsin.

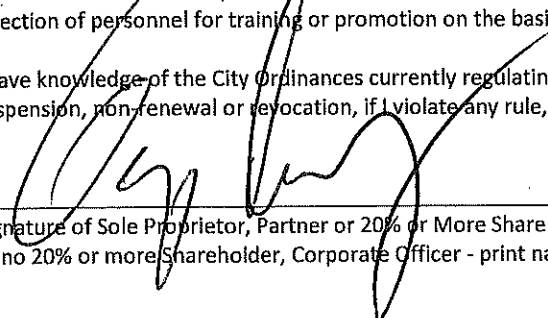

Signature of Sole Proprietor, Partner or 20% or More Shareholder  
(If no 20% or more Shareholder, Corporate Officer - print name/title and sign)

**Office Use Only:**  
Initials: \_\_\_\_\_ Filed: \_\_\_\_\_ App: \_\_\_\_\_  
Only PEP?  No  Yes If Yes,  Queue to MPD and  Email Mgrs/Team Lead (must be heard w/in 60 days)



# Sidewalk Dining Facility Supplemental Application

ccl-side1 2/21/18

Office of the City Clerk License Division  
200 E. Wells St. Room 105, Milwaukee, WI 53202  
(414) 286-2238 [www.milwaukee.gov/license](http://www.milwaukee.gov/license) e-mail address: [license@milwaukee.gov](mailto:license@milwaukee.gov)

Business Name: District 4 social Aldermanic District # 4

Premises Address: 233 E Chicago street Milwaukee WI 53202

## Business Operations

Check one:  I/we are also applying for Food/Alcohol license(s) at this time.  
 I/we currently hold Food/Alcohol license(s) AND ....  
 confirm that the Business Plan of Operation on file which was previously submitted with the Food and/or Alcohol application has not changed, except for the addition of this sidewalk dining facility.  
 have included a new Business Plan of Operation reflecting requested changes.

Sidewalk Dining Facility will operate from: Start Date: 3/15/2023 to End Date: 11/30/2023

Will any food preparation be done outdoors?  No  Yes  
If yes, describe: \_\_\_\_\_

Will any sidewalk dining facility improvements be physically attached to public structures?  No  Yes  
If yes, describe: \_\_\_\_\_

## Property Owner

Check one:  Applicant owns the property  
 Property owner's information/signature provided below (REQUIRED):  
Name: Nikon Chicago LLC Phone # (414)-271-5200  
Address: 239 E Chicago st #101 Milwaukee WI 53202  
Property Owner's Signature: \_\_\_\_\_

## Signature(s)

Signature of Sole Proprietor, Partner, or 20% or more shareholder  
(If there are no 20% or more shareholders, Corporate Officer-print name/title and sign) \_\_\_\_\_  
Signature of additional partner or 20% or more shareholder \_\_\_\_\_

### Office Use Only:

Initials \_\_\_\_\_ Filed \_\_\_\_\_ App # \_\_\_\_\_

Processing LS: Queue to:  HD  DNS  CC Email To:  DPW  Primary LS

Also:  holds  is applying for:  Food  Alcohol  Perm Ext



# CHICAGO STREET

TOTAL TRAVEL DIST. 115 FT

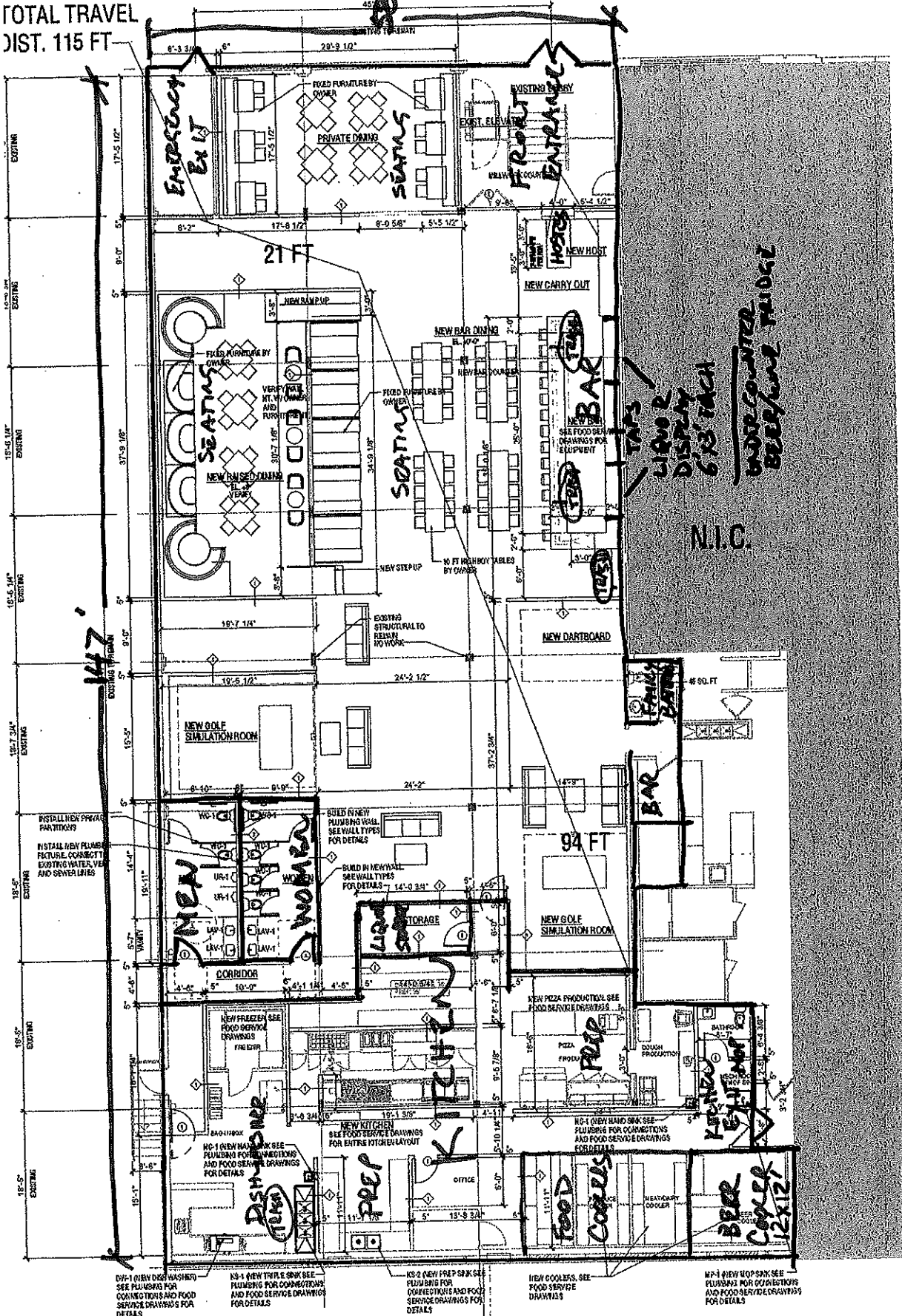

PROPOSED PLAN

SCALE: 1/8"=1'-0"



GEORGE PRASSAS AGENT FOR "DISTRICT 4 SOCIAL"  
 DISTRICT 4 SOCIAL  
 233 E CHICAGO STREET  
 SEPTEMBER 7, 2022

TOTAL SQUARE FOOTAGE = 8900 SF



CHICAGO STREET  
40'

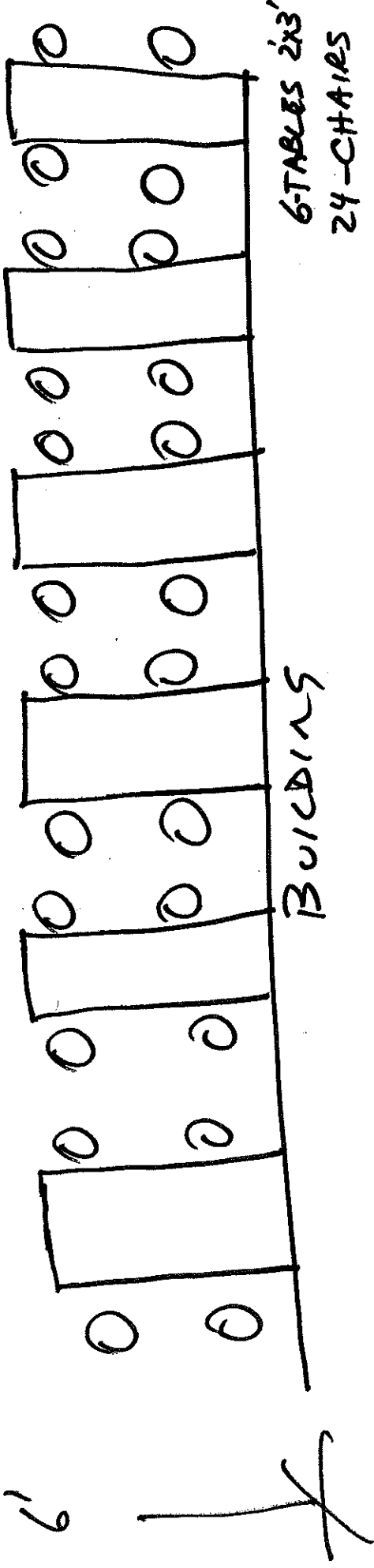
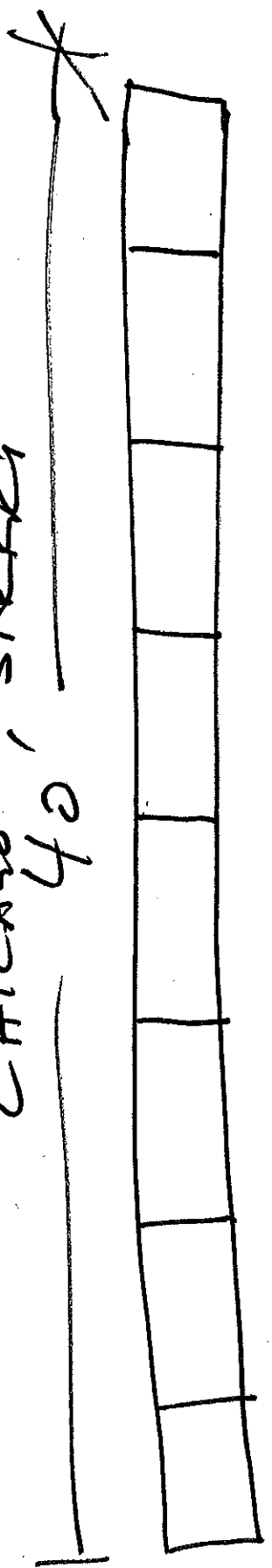

6 TABLES 2x3'  
24 CHAIRS

BUILDINGS

GEORGE PRASSAS ASST FOR "DISTRICT 4 SOCIAL"

DISTRICT 4 SOCIAL  
233 E CHICAGO STREET

SEPTEMBER 7, 2022

773-909-1940





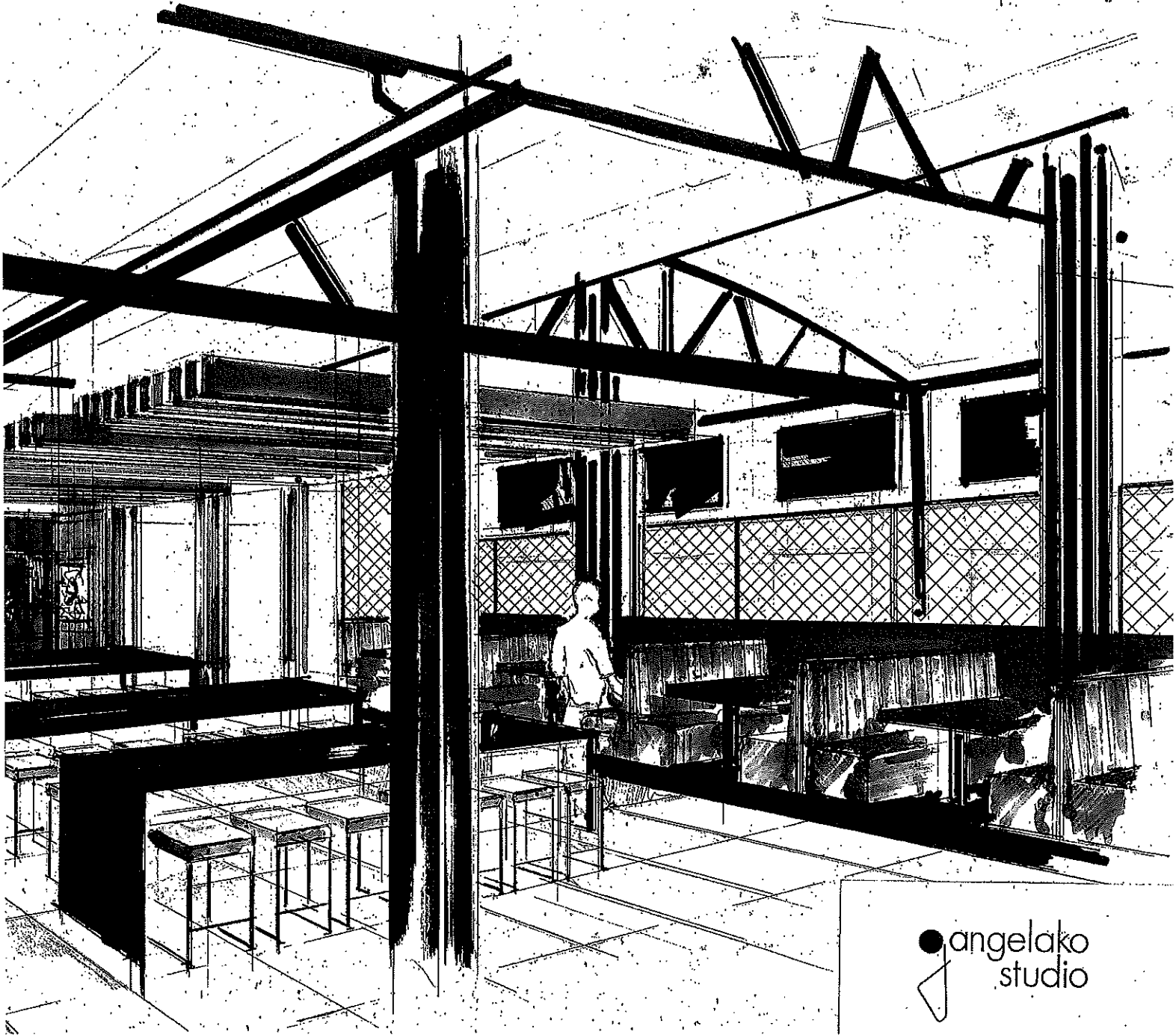

● angelako  
studio

## Crite, Yvette

---

**From:** Yianni <y@nikongrp.com>  
**Sent:** Wednesday, September 7, 2022 2:43 PM  
**To:** Crite, Yvette  
**Subject:** Fwd: District 4 social- Menu

You don't often get email from y@nikongrp.com. [Learn why this is important](#)

Begin forwarded message:

**From:** Yianni <y@nikongrp.com>  
**Date:** August 30, 2022 at 11:40:34 AM CDT  
**To:** David Halbrooks <dhalbrooks@msn.com>  
**Subject:** District 4 social- Menu

### STARTERS-

-Bavarian pretzel-  
House made pretzel served w/cheese sauce & grain mustard

-CHEESE CURDS-  
(Tempura-style "farmhouse")  
Served with Ketchup & Spicy Curd Sauce

-Honey comb RICOTTA-  
ricotta, honeycomb, ciabatta

-tower "O" onion rings-  
serves w/bbq sauce

-Pan-Fried Calamari-  
with Hot Cherry Peppers

-Chicken wings-  
Buffalo, BBQ, or Teriyaki. Your choice of Blue Cheese or Ranch

-Porkshank wings-  
Buffalo, BBQ, or Teriyaki. Your choice of Blue Cheese or Ranch

-Filet Mignon sliders-  
with seasoned Butter

-Baked Goat cheese-  
Crostinis, baked goat cheese & marinara

-garlic Parmesan bread STIX-

served with marinara

-House made mozzarella sticks-  
served with marinara

-HUMMUS PLATE-

Hummus with veggie stix served w/warmed seasoned pita

-Jalapeño pops-

cream cheese, bacon, cheddar, tomato & a side of ranch dressing and/or bbq sauce

-Elote dip-

chihuahua cheese, peppers, cream cheese, mayo, corn, chili powder, jalapeños and pico de gallo served with chips

-LOADED NACHOS-

(Thin flour tortilla chips) chihuahua cheese, refried beans, sour cream, guacamole pickled jalapeño with ground beef, chicken or shrimp.

-Chicken tenders-

served with our BBQ sauce & chipotle aioli or buffalo style with ranch & blue cheese

-House made Meatballs-

veal, pork & beef with crostinis, parmesan & marinara (served with red wine vinegar dressed greens)

-Burrata-

served with crostini, jam, sun-dried tomato, pesto, basil & balsamic drizzle

-crispy thin fries

-Parmasian fries

-Truffle fries

-Parmasian Truffle fries

-SALADS-

-CHICAGO ST-

mixed greens, mandarin oranges, avocado, bacon, red onions, gorgonzola & lemon poppy seed dressing

-CAESER-

romaine, croutons, parm & caesar dressing

-Blackened chicken Caesar-

the caesar with blackened chicken & sun- dried tomatoes

-ROMA GREENS-

romas, red onions, kalamata olives, feta & red wine vinaigrette

-PEAR & ARUGULA-

pickled red onions, gorgonzola, candied walnuts, dates, balsamic vinaigrette, ciabatta

-SESAME SOY-

mixed greens, almonds, bean sprouts, red peppers, carrot threads, mandarin oranges, red cabbage, wontons & sesame soy dressing

-BABY KALE COBB-

baby kale, diced romas, hard-boiled egg, bacon, crumbled gorgonzola , smoked house ham, avocado & ranch

-SOUTHWEST-

blackened chicken, romaine, roasted corn, avocado, black beans, pico de gallo, tortilla chips, jalapeno lime vinaigrette

-Crispy Chicken Tender salad-

iceburg, crispy chicken tenders, pico de gallo, corn, cheddar cheese, avocado, tortilla strips & chipotle dressing

-FILET MIGNON STEAK SALAD-

Peppery baby arugula, avocados, Sweet cherry tomatoes, cucumbers with a balsamic vinaigrette (with grainy AND dijon mustard to make it creamy)

-add filet mignon steak, chicken, blackened chicken, chx tenders, or shrimp to any salad

-SOUPS-

-Vegetable Minestrone

-French onion soup

-SANDWICHES-

Served with crispy thin Fries or dressed greens

-Crunchy Chicken Parmesan Sandwich-Buttermilk Brined Thigh, Fresh Mozzarella, Marinara Sauce and Parmesan Cheese on italian bread.

-MEATBALL-

House made meatballs, organic to tomato sauce, hot giardiniera, served on Italian bread

-The Burger-

8oz Patty, black sesame seed brioche bun Sharp Cheddar, Pickle, Red Onion and Dijonaise

-Big BLT sandwich-

Texas toast, Spicy Remolad mayo, Avocado spread, Pico de gallo, 8 pieces of bacon folded in half for height , mixed greens, Tomatoes

-Avocado Turkey Club-



lettuce, tomato, avocado, bacon, turkey , aioli on toasted multi grain

-BBQ Chx Breast sandwich-  
cheddar cheese, bacon with bbq sauce on a potato bun

-Grilled Shrimp tacos-  
FLOUR TORTILLAS, PICO DE GALLO, PURPLE CABBAGE, Carrot Threads, CHIPOTLE MAYONNAISE, picked red onions.

-CALZONES-

-Build Your Own Calzone  
Start with our Mozzarella and Organic Plum Tomato Sauce, Add in Your Toppings

-Cheese Calzone-  
Organic Tomato Sauce, Mozzarella, and Local Ricotta

-City side Calzone-  
Organic tomato sauce, Mozzarella, Chicken, and Hickory Bacon

-Meatball Calzone-  
Organic Tomato Sauce, Mozzarella, House-Made Meatballs, Caramelized Onions, and Local Ricotta

-VEGGIE calzone-  
Organic tomato sauce, portobellas, artichoke hearts, black olives, sun-dried tomatoes, mozzarella/provolone

-MEAT calzone-  
Organic tomato sauce, pepperoni, house smoked bacon, mozzarella/ provolone

-TURKEY calzone-  
turkey, bacon, cheddar, avocado & ranch

-SMOKED HAM & AVOCADO calzone-  
smoked house ham, avocado, cheddar, mozzarella/provolone & house made ranch

-DK Calzone-  
Organic tomato sauce, mozzarella, old school cup & curl pepperoni, house-made hot Italian sausage, roasted garlic, and local ricotta.

-Hawaiian Calzone-  
Organic Tomato Sauce, Mozzarella, Smoked House Ham, and Sweet Pineapples.

-PIZZAS-

-Build Your Own

Start with our Mozzarella and Organic Plum Tomato Sauce, Add in Your Toppings

-Cheese-

Organic Tomato Sauce, Mozzarella, and Post Oven Pecorino-Romano.

-GDD-

organic tomato sauce, Italian sausage, mushrooms, red onions and green pepper

-PORTO-

organic tomato sauce, pepperoni, sausage & bacon

-spicy pepperoni-

Organic tomato sauce, Old school cup & curl pepperoni, crushed red pepper

-MW-

Organic tomato sauce, Italian sausage & giardiniera

-hawaiian-

Organic tomato sauce, smoked house ham, pineapple and onion

-BBQ BACON-

Chicken, bacon, red onion and BBQ sauce,

-GARDEN-

Organic tomato sauce, bell peppers, onions, zucchini, eggplant, mozzarellas

-JN-

sautéed spinach, mushrooms, parmesan, truffle oil

-veggie-

Organic tomato sauce, Spinach, tomato, onion, green pepper, black olives and mushroom

-Margherita-

Organic tomato sauce, Buffalo mozzarella, basil and olive oil

-BBQ. CHX-

BBQ Sauce, Mozzarella, Chicken, Caramelized Onions, & Banana Peppers