



Milwaukee County GIS and Land Information Interactive Map



Search Analyze File

N

- Address
- Owner
- Tax Key
- Subdivision
- CSM
- Condo
- Intersection
- Coordinates
- Identify
- Poly-Identify
- Clear Selection
- What's New

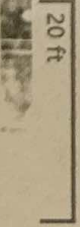

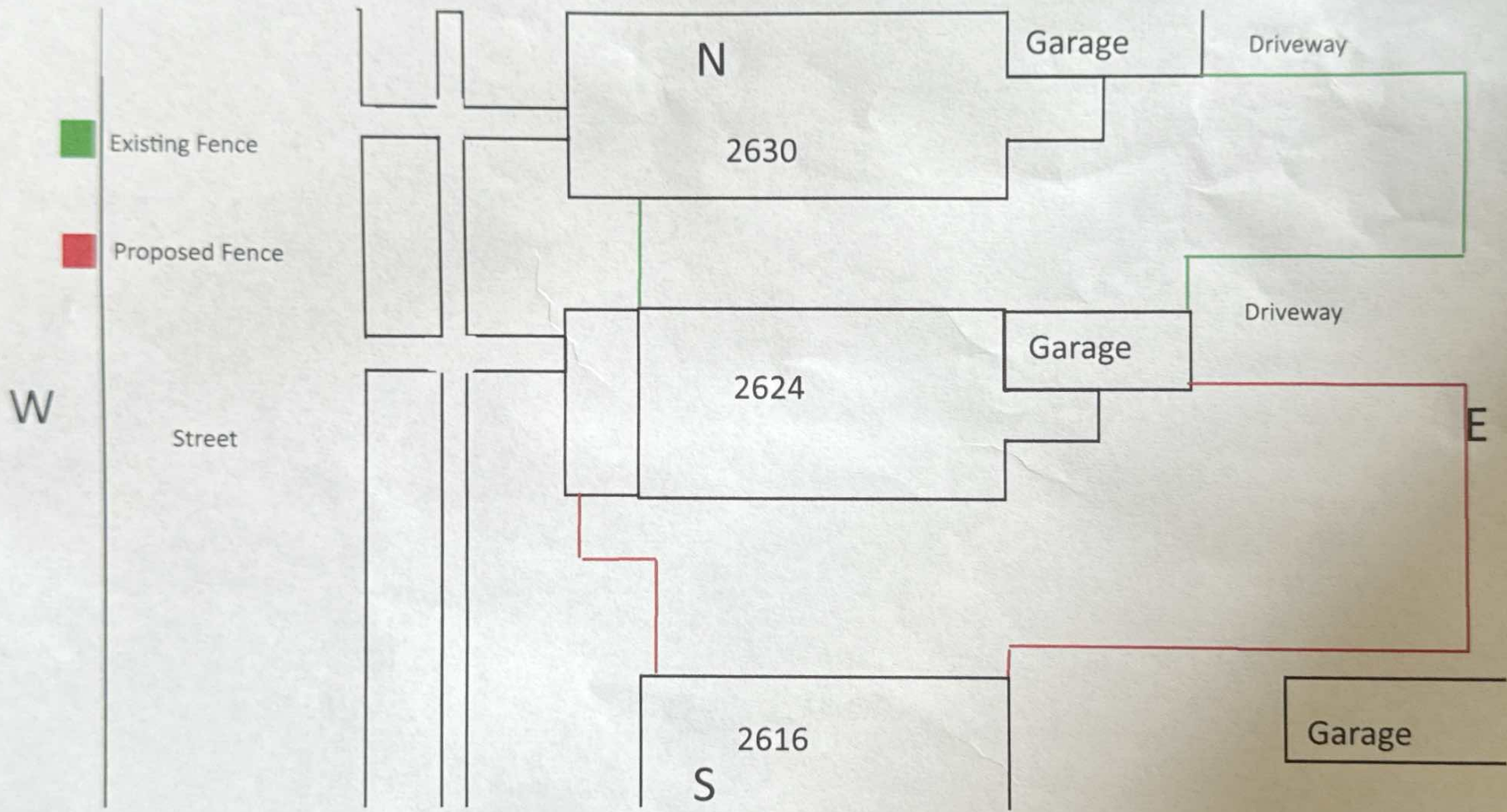



DEPARTMENT OF
NEIGHBORHOOD SERVICES

Residential Fence Permit Application
For 1 & 2 Family Homes

*Work is not authorized unless permit is validated at right.

Permit & Development Center
809 N. Broadway, Milwaukee, WI 53202 | (414) 286-8211 | milwaukee.gov/permits | DevelopmentCenterInfo@milwaukee.gov

Location (Exact street address - please print)	Circle correct use below:	Project cost	Code	Checked by:
2624 N Grant Blvd - 53210	One or two family?	\$8000.00		

Owner: CMC Holdings LLC.	Address: 1966 S. 6th St - 53204	Phone: 262-442-1006	E-mail: ccovsine@yahoo.com
Contractor:	Address:	Phone:	City license #:

Describe the fence project (Circle those that apply):	Provide a map of your property: Indicate which direction is north. Show the location of the proposed fence, the house, garage, neighbor's buildings, streets, alleys & sidewalks. Use the box below or a separate sheet, site plan or survey if necessary.
Material: wood metal chain-link plastic/vinyl other _____ Type: open picket lattice solid stockade other _____ Location & height: Front yard: 4' 5' 6' other _____ Side yard: 4' 5' 6' other _____ Back yard: 4' 5' 6' other _____ Near an intersection: driveway/street* alley/street* street/street* *see approval conditions below =>	

Permit check:

Tax key: _____

Zoning district: _____

Historic code: _____

Required appeals?

Board of Zoning Appeals
Case # _____
Approved

Standards & Appeals Comm
Case # _____
Approved

Historic Preservation Comm
COA dated _____

NOTE: Inspections are not required during or after construction of the fence.

- Approval conditions:**
- A fence located in the front yard may not exceed a height of 4', with limited exceptions.
 - A fence located in a side yard (between houses) may not exceed a height of 4', unless all portions of the fence higher than 4' are at least 50% open construction (e.g. lattice).
 - Solid fences placed near the intersection of two streets, a driveway with a street, or an alley with a street, shall be no more than 3' high. This applies within 10' of a driveway intersection, and within 15 to 25' of other intersections depending on the zoning district.
 - The fence must be built entirely on your property and shall not extend over lot lines.
 - Fences shall not be located within the street or alley (public) right-of-way unless the project meets all the applicable requirements of Ch 245 Milwaukee Code of Ordinances.
 - All fences shall be constructed in a workman-like manner and of approved fencing material. Plywood sheets, snow fence, chicken wire & plastic material less than 1/2" thick are prohibited.
 - All structural elements of the fence must face inwards (toward your property). Supports shall not face toward the street or neighboring property.
 - Solid fences 4' or more in height shall be properly anchored to a minimum depth of 30 inches.
 - All fences shall be uniform in color. Two colors are allowed if the fence is painted, stained or otherwise properly finished.
 - If the new fence is constructed parallel to and within 6' of an existing fence on the same lot, the existing fence shall be removed within 10 days of completion of the new fence.

When you provide a check as payment, you authorize us either to use information from your check to make a one-time electronic fund transfer from your account, or to process the payment as a check transaction. I attest that the above information accurately describes the property and the proposed work to be performed on it. I agree to comply with all City of Milwaukee and State of Wisconsin codes applicable to the occupancy and work stated above. No asbestos project, as defined in Ch. 66 of the Milwaukee Code of Ordinances, is included in the work performed under this permit. I understand that any falsification or misinformation may result in penalties prescribed in the Milwaukee Code of Ordinances.

Residential fence (7150).....\$25.00 IT & Training surcharge.....\$0.40 Permit processing fee.....\$10.00 Total fee.....\$35.40	We accept Visa, MasterCard, money orders, or checks payable to "City of Milwaukee" Applicant's signature: Date: 8/10/24
---	--

FEN. 24. 00754

\$ 35.40

1. CERTIFICATE OF APPROPRIATENESS (HRC)
2. Decide IF BOZA OR MODIFY Fence.
3. BOZA OR ISSUE PERMIT.