



## CERTIFICATE OF APPROPRIATENESS APPLICATION FORM

Incomplete applications will not be processed for Commission review.  
Please print legibly.

1. **HISTORIC NAME OF PROPERTY OR HISTORIC DISTRICT:** (if known)

**ADDRESS OF PROPERTY:**

2. **NAME AND ADDRESS OF OWNER:**

Name(s):

Address:

City:

State:

ZIP:

Email:

Telephone number (area code & number) Daytime:

Evening:

3. **APPLICANT, AGENT OR CONTRACTOR:** (if different from owner)

Name(s):

Address:

City:

State:

ZIP Code:

Email:

Telephone number (area code & number) Daytime:

Evening:

4. **ATTACHMENTS:** (Because projects can vary in size and scope, please call the HPC Office at 414-286-5712 for submittal requirements)

**A. REQUIRED FOR MAJOR PROJECTS:**

Photographs of affected areas & all sides of the building (annotated photos recommended)

Sketches and Elevation Drawings (1 full size and 1 reduced to 11" x 17" or 8 ½" x 11")  
A digital copy of the photos and drawings is also requested.

Material and Design Specifications (see next page)

**B. NEW CONSTRUCTION ALSO REQUIRES:**

Floor Plans (1 full size and 1 reduced to a maximum of 11" x 17")

Site Plan showing location of project and adjoining structures and fences

**PLEASE NOTE: YOUR APPLICATION CANNOT BE PROCESSED UNLESS  
BOTH PAGES OF THIS FORM ARE PROPERLY COMPLETED  
AND SIGNED.**

**5. DESCRIPTION OF PROJECT:**

Tell us what you want to do. Describe all proposed work including materials, design, and dimensions. Additional pages may be attached via email.

**6. SIGNATURE OF APPLICANT:**

Stephanie Engelking

Signature

Please print or type name

Date

This form and all supporting documentation MUST arrive by 4:00 pm (11:59 pm via email) on the deadline date established to be considered at the next Historic Preservation Commission Meeting. Any information not provided to staff in advance of the meeting will not be considered by the Commission during their deliberation. Please call if you have any questions and staff will assist you.

**Mail or Email Form to:**

Historic Preservation Commission  
City Clerk's Office  
841 N. Broadway, Rm. B1  
Milwaukee, WI 53202

**PHONE: (414) 286-5712 or 286-5722**

[hpc@milwaukee.gov](mailto:hpc@milwaukee.gov)

[www.milwaukee.gov/hpc](http://www.milwaukee.gov/hpc)

**Or click the SUBMIT button to automatically email this form for submission.**



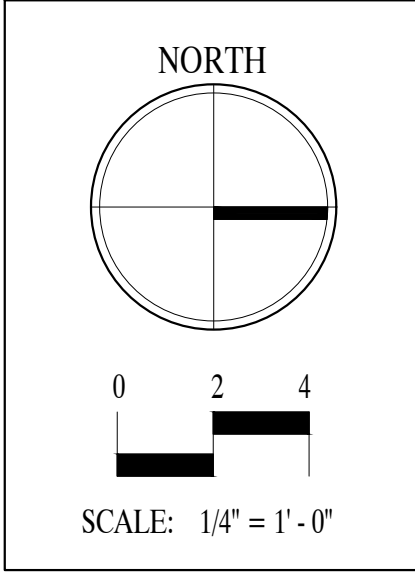
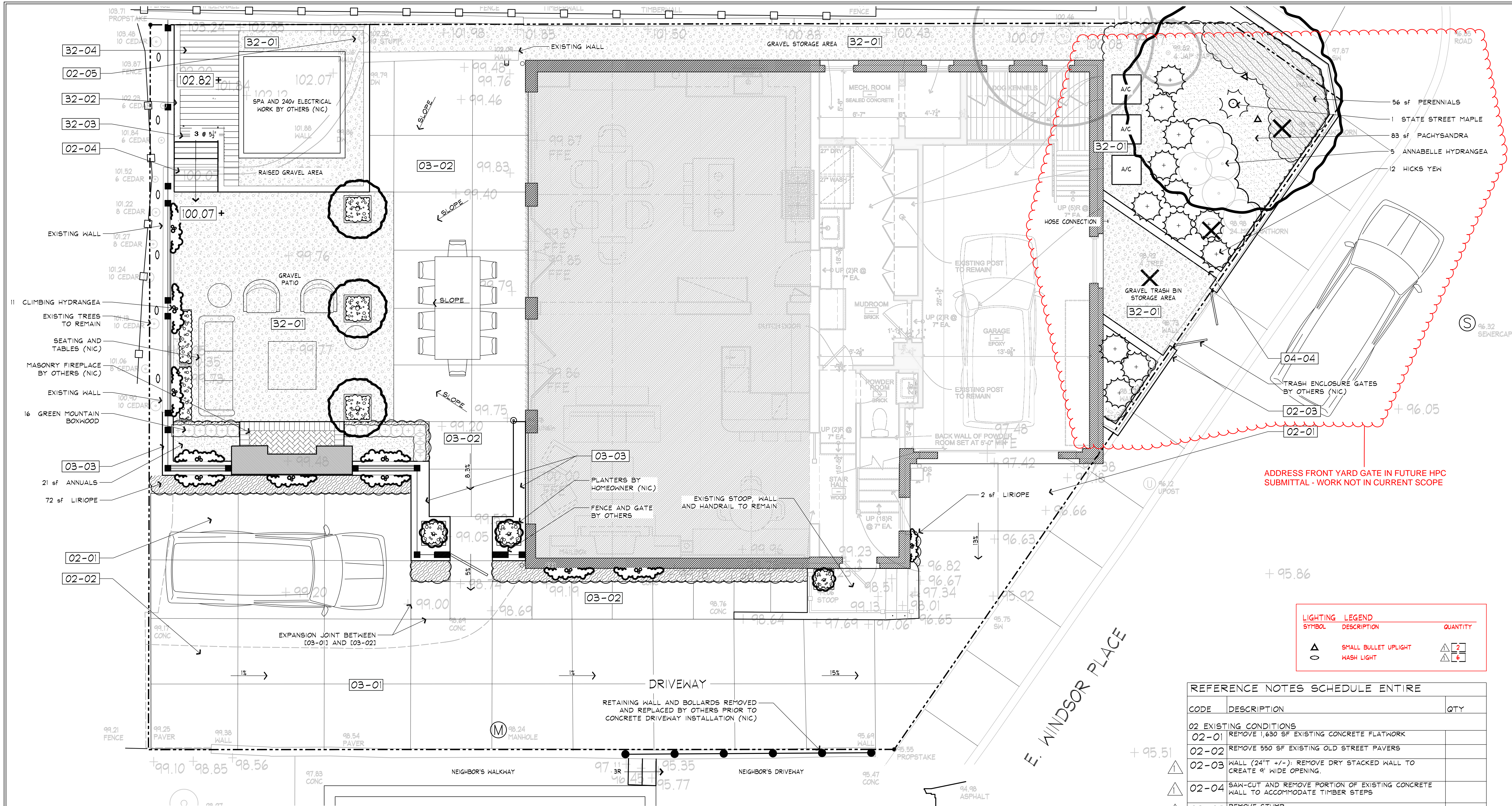

**WEISSMANN RESIDENCE**  
MILWAUKEE, WI  
2007 E. WINDSOR PLACE

ADDRESS FRONT YARD GATE IN FUTURE HPC SUBMITTAL - WORK NOT IN CURRENT SCOPE

LIGHTING LEGEND		
SYMBOL	DESCRIPTION	QUANTITY
⬮	SMALL BULLET UPLIGHT	2
⊙	WASH LIGHT	6

REFERENCE NOTES SCHEDULE ENTIRE

CODE	DESCRIPTION	QTY
02 EXISTING CONDITIONS		
02-01	REMOVE 1,630 SF EXISTING CONCRETE FLATWORK	
02-02	REMOVE 550 SF EXISTING OLD STREET PAVERS	
02-03	WALL (24" T +/-): REMOVE DRY STACKED WALL TO CREATE 9' WIDE OPENING.	
02-04	SAW-CUT AND REMOVE PORTION OF EXISTING CONCRETE WALL TO ACCOMMODATE TIMBER STEPS	
02-05	REMOVE STUMP	
03 CONCRETE		
03-01	CONCRETE DRIVEWAY, ANTIQUE FINISH, 5" THICK	1,062 SF
03-02	CONCRETE PATIO & WALKWAY, ANTIQUE FINISH, 4" THICK	526 SF
03-03	CONCRETE WALL WITH 1" +/- RADIUS TOP EDGES (9" T), TOP OF WALL FLUSH WITH INTERIOR COURTYARD PAVING, SEE DETAIL A	53 SF
04 MASONRY		
04-04	'UNLOCK' BRUSSELS DIMENSIONAL WALL TO RETAIN GRADE ON TWO SIDES PERPENDICULAR TO SIDEWALK, LIMESTONE COLOR (24" T +/-)	17 LF
32 SITE WORK		
32-01	PEA GRAVEL	1,120 SF
32-02	TIMBER WALL (6X6 TREATED PINE) TO RETAIN GRADE (2'-9" T)	56 LF
32-03	TIMBER STEPS (6X6 TREATED PINE) WITH 16.5" DEEP TREADS (3'-8" W)	7 LF
32-04	TIMBERS (6X6 TREATED PINE) LAID FLAT AS RAISED PATIO	37 SF

PLANT SCHEDULE ENTIRE

COMMON NAME	BOTANICAL NAME	QTY	REMARKS
DECIDUOUS TREES			
STATE STREET MAPLE	ACER MIYABEI 'MORTON' (SINGLE STEM)	1	
DECIDUOUS SHRUBS			
ANNABELLE HYDRANGEA	HYDRANGEA ARBORESCENS 'ANNABELLE'	5	
EVERGREEN SHRUBS			
HICKS YEW	TAXUS X MEDIA 'HICKSII'	12	
VINES			
CLIMBING HYDRANGEA	HYDRANGEA PETIOLARIS	11	
EVERGREEN SHRUB HEDGE			
GREEN MOUNTAIN BOXWOOD	BUXUS X 'GREEN MOUNTAIN' 'B'	16	HEDGE
ANNUALS			
ANNUALS	ANNUALS BEDDING	21 SF	ANNUALS NOT INCLUDED IN CONTRACT
GROUNDCOVERS			
PACHYSANDRA	PACHYSANDRA TERMINALIS	83 SF	
ORNAMENTAL GRASS			
LIRIOPE	LIRIOPE SPICATA	74 SF	
PERENNIALS			
PERENNIALS	PERENNIALS, MISC.	56 SF	30% PATRIOT HOSTA, 70% HUMMELO BETONY

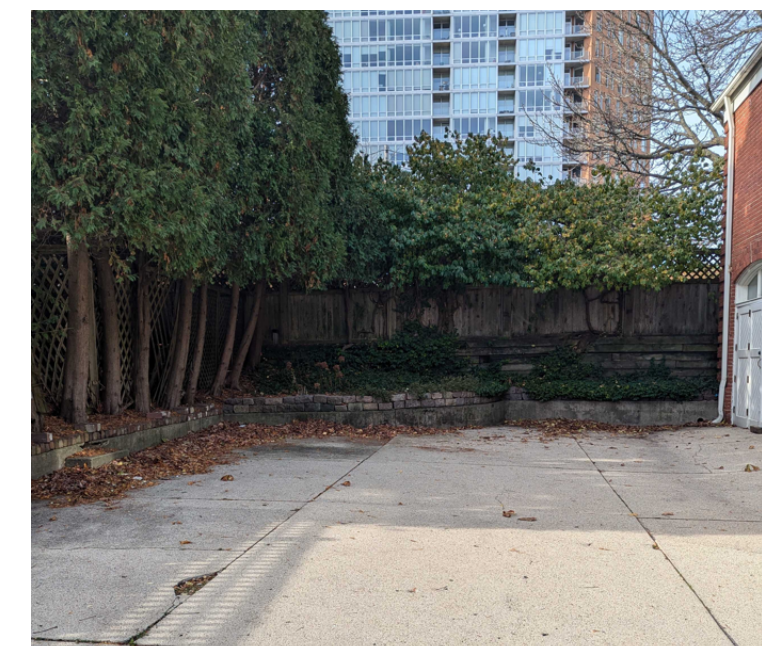
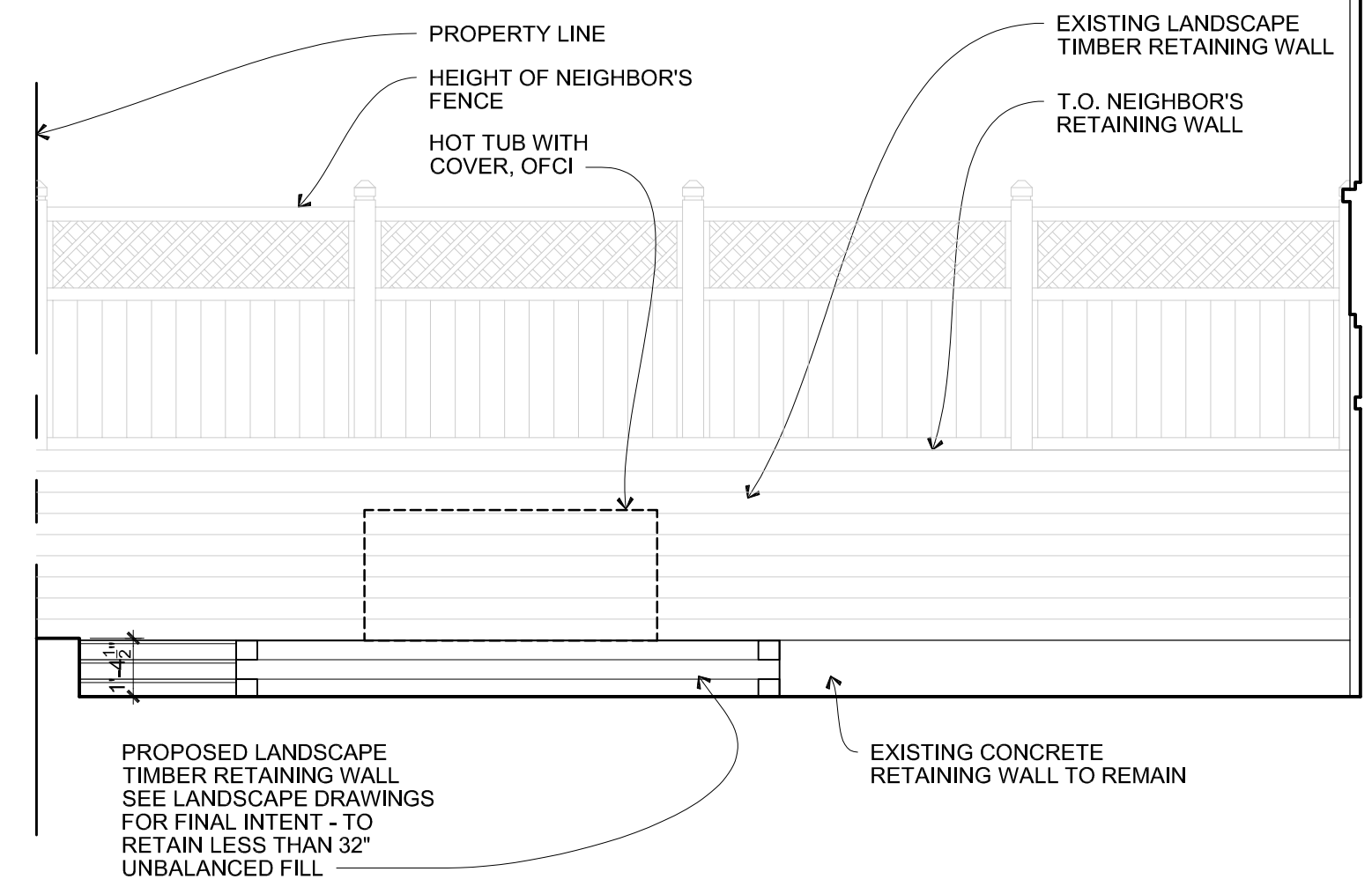

REVISIONS		
DATE	INIT	DESCRIPTION
7.8.25	JSC	HARDSCAPE



Landscape Architecture  
Contracting and Maintenance  
30088 North Skokie Highway  
Lake Bluff, Illinois 60044-1112  
847-689-0266  
FAX 847-689-0277

DATE	5.1.25
DESIGN	JSC
DRAFTED	JSC
SALESPERSON	JRK
CLIENT	WW

SHEET TITLE

LANDSCAPE  
PLAN

SHEET NUMBER  
L-03.1

JOB NUMBER  
24-165