



**CITY OF MILWAUKEE  
OFFICE OF THE CITY CLERK**

Thursday, December 18, 2025

**COMMITTEE MEETING NOTICE**

AD 06

NORFOLK, Nathan J, Agent  
WINE CONSORTIUM LLC  
1821 N MARTIN L KING JR DR  
MILWAUKEE, WI 53212

You are requested to attend a hearing which is to be held in Room 301-B, Third Floor, City Hall or you may attend virtually using the link below.

**Tuesday, January 06, 2026 at 01:25 PM**

The access code is <https://meet.goto.com/880736941>. Please see the enclosed best practices document for further instructions.

**Regarding:** Your Class B Tavern, Public Entertainment Premises and Food Dealer Licenses Application Requesting Instrumental Musicians, Disc Jockey, Bands, Karaoke, Poetry Readings and Patron Contests as agent for "WINE CONSORTIUM LLC" for "VINT" at 1821 N MARTIN L KING J

There is a possibility that your application may be denied for one or more of the following reasons: The recommendation of the committee regarding the application shall be based on evidence presented at the hearing. Per MCO 85-2.7-4, probative evidence concerning whether or not a new license should be granted may be presented on the following subjects: whether or not the applicant meets the municipal requirements, the appropriateness of the location and premises where the licensed premises is to be located and whether use of the premises for the purposes or activities permitted by the license would tend to facilitate a public or private nuisance or create undesirable neighborhood problems such as disorderly patrons, unreasonably loud noise, litter, and excessive traffic and parking congestion. Probative evidence relating to these matters may be taken from the plan of operation submitted with the license application, if any, but shall not include the content of any music. Evidence regarding the fitness of the location of the premises to be maintained as the principal place of business, including but not limited to whether there is an overconcentration of businesses of the type for which the license is sought; whether the proposal is consistent with any pertinent neighborhood business or development plans, or the location's proximity to areas where children are typically present. The applicant's record in operating similarly licensed premises; and whether or not the applicant has been charged with or convicted of any felony, misdemeanor, municipal offense or other offense, the circumstances of which substantially relate to the activity to be permitted by the license being applied for or any other factor which reasonably relates to the public health, safety or welfare may also be considered. See attached police report or correspondence.

**Notice for applicants with  
warrants or unpaid fines:**

**Proof of warrant satisfaction or payment of fines must be submitted at the hearing on the above date and time. Failure to comply with this requirement may result in a delay of the granting/denial of your application.**

Failure to appear at this meeting may result in the denial of your license. Individual applicants must appear only in person or by an attorney. Corporate or Limited Liability applicants must appear only by the agent designated on the application or by an attorney. Partnership applicants must appear by a partner listed on the application or by an attorney. If you wish to do so and at your own expense, you may be accompanied by an attorney of your choosing to represent you at this hearing.

You will be given an opportunity to speak on behalf of the application and to respond and challenge any charges or reasons given for the denial. No petitions can be accepted by the committee, unless the people who signed the petition are present at the committee hearing and willing to testify. You may present witnesses under oath and you may also confront and cross-examine opposing witnesses under oath. If you have difficulty with the English language, you should bring an interpreter with you, at your expense, so that you can answer questions and participate in your hearing.

You may examine the application file at this office during regular business hours prior to the hearing date. Inquiries regarding this matter may be directed to the person whose signature appears below.

Limited parking for persons attending meetings during normal business hours is available at reduced rates (5 hour limit) at the Milwaukee Center on the southwest corner of Kilbourn Avenue and Water Street. You must present a copy of the meeting notice to the parking cashier.

PLEASE NOTE: Upon reasonable notice, efforts will be made to accommodate the needs of disabled individuals through sign language interpreters or other auxiliary aids. For additional information or to request this service, contact the Council Services Division ADA Coordinator at (414) 286-2998, Fax - (414) 286-3456, TDD - (414) 286-2025.

**JIM OWCZARSKI, CITY CLERK**

BY:

**Jim Cooney  
License Division Manager**

**If you have questions regarding this notice, please contact the License Division at (414) 286-2238.**

200 E. Wells Street, Room 105, City Hall, Milwaukee, WI 53202. [www.milwaukee.gov/license](http://www.milwaukee.gov/license)  
Phone: (414) 286-2238 Fax: (414) 286-3057 Email Address: [License@milwaukee.gov](mailto:License@milwaukee.gov)





**CITY OF MILWAUKEE  
OFFICE OF THE CITY CLERK**

Thursday, December 18, 2025

**COMMITTEE MEETING NOTICE**

AD 06

NORFOLK, Nathan J, Agent  
WINE CONSORTIUM LLC  
2962 N PROSPECT AV,  
MILWAUKEE, WI 53211

You are requested to attend a hearing which is to be held in Room 301-B, Third Floor, City Hall or you may attend virtually using the link below.

**Tuesday, January 06, 2026 at 01:25 PM**

The access code is <https://meet.goto.com/880736941>. Please see the enclosed best practices document for further instructions.

**Regarding:** Your Class B Tavern, Public Entertainment Premises and Food Dealer Licenses Application Requesting Instrumental Musicians, Disc Jockey, Bands, Karaoke, Poetry Readings and Patron Contests as agent for "WINE CONSORTIUM LLC" for "VINT" at 1821 N MARTIN L KING JR DR.

There is a possibility that your application may be denied for one or more of the following reasons: The recommendation of the committee regarding the application shall be based on evidence presented at the hearing. Per MCO 85-2.7-4, probative evidence concerning whether or not a new license should be granted may be presented on the following subjects: whether or not the applicant meets the municipal requirements, the appropriateness of the location and premises where the licensed premises is to be located and whether use of the premises for the purposes or activities permitted by the license would tend to facilitate a public or private nuisance or create undesirable neighborhood problems such as disorderly patrons, unreasonably loud noise, litter, and excessive traffic and parking congestion. Probative evidence relating to these matters may be taken from the plan of operation submitted with the license application, if any, but shall not include the content of any music. Evidence regarding the fitness of the location of the premises to be maintained as the principal place of business, including but not limited to whether there is an overconcentration of businesses of the type for which the license is sought; whether the proposal is consistent with any pertinent neighborhood business or development plans, or the location's proximity to areas where children are typically present. The applicant's record in operating similarly licensed premises; and whether or not the applicant has been charged with or convicted of any felony, misdemeanor, municipal offense or other offense, the circumstances of which substantially relate to the activity to be permitted by the license being applied for or any other factor which reasonably relates to the public health, safety or welfare may also be considered. See attached police report or correspondence.

**Notice for applicants with  
warrants or unpaid fines:**

**Proof of warrant satisfaction or payment of fines must be submitted at the hearing on the above date and time. Failure to comply with this requirement may result in a delay of the granting/denial of your application.**

Failure to appear at this meeting may result in the denial of your license. Individual applicants must appear only in person or by an attorney. Corporate or Limited Liability applicants must appear only by the agent designated on the application or by an attorney. Partnership applicants must appear by a partner listed on the application or by an attorney. If you wish to do so and at your own expense, you may be accompanied by an attorney of your choosing to represent you at this hearing.

You will be given an opportunity to speak on behalf of the application and to respond and challenge any charges or reasons given for the denial. No petitions can be accepted by the committee, unless the people who signed the petition are present at the committee hearing and willing to testify. You may present witnesses under oath and you may also confront and cross-examine opposing witnesses under oath. If you have difficulty with the English language, you should bring an interpreter with you, at your expense, so that you can answer questions and participate in your hearing.

You may examine the application file at this office during regular business hours prior to the hearing date. Inquiries regarding this matter may be directed to the person whose signature appears below.

Limited parking for persons attending meetings during normal business hours is available at reduced rates (5 hour limit) at the Milwaukee Center on the southwest corner of Kilbourn Avenue and Water Street. You must present a copy of the meeting notice to the parking cashier.

PLEASE NOTE: Upon reasonable notice, efforts will be made to accommodate the needs of disabled individuals through sign language interpreters or other auxiliary aids. For additional information or to request this service, contact the Council Services Division ADA Coordinator at (414) 286-2998, Fax - (414) 286-3456, TDD - (414) 286-2025.

**JIM OWCZARSKI, CITY CLERK**

BY:

**Jim Cooney  
License Division Manager**

**If you have questions regarding this notice, please contact the License Division at (414) 286-2238.**

200 E. Wells Street, Room 105, City Hall, Milwaukee, WI 53202. [www.milwaukee.gov/license](http://www.milwaukee.gov/license)  
Phone: (414) 286-2238 Fax: (414) 286-3057 Email Address: [License@milwaukee.gov](mailto:License@milwaukee.gov)

# MILWAUKEE POLICE DEPARTMENT

## LICENSING

### CRIMINAL RECORD/ORDINANCE VIOLATION/INCIDENTS SYNOPSIS

**DATE:** 10/29/25

**LICENSE TYPE:** Class B Tavern

**NEW:** ☒

**RENEWAL:** ☐

**No. 385556**

**Application Date:**

**License Location:** 1821 N Martin L King Jr Dr

**Business Name:** Wine Consortium

**Licensee/Applicant:** Norfolk, Nathan J  
(Last Name, First Name, MI)

**Date of Birth:** 06/22/78

**Home Address:** 2962 N Prospect Ave

**City:** Milwaukee

**State:** WI **Zip Code:** 53211

**Home Phone:**

This report is written by Police Officer Penny Monreal, assigned to the License Investigation Unit, Days.

The Milwaukee Police Department's investigation regarding this application revealed the following:

1. On 10/14/17, Timothy M Cole (51% Shareholder) was charged with Implied Consent in North Shore Municipal Court. On 11/13/17, they were convicted and license was revoked for 1 year.

Date: 11/12/2025  
Officer: Gussie NELSON

City of Milwaukee Police Department  
90-5-1.5 Crime Prevention Survey  
Tavern Inspection

Name of Premise: Vint  
Address: 1821 N Dr. Martin Luther King Jr. Drive.  
Phone: 262-271-8501

Owner: Cole, Timothy M.  
Owner address: 6540 N Alberta Ct.  
City State Zip: Glendale, WI 53217  
Owner Phone: 262-271-8501  
Owner email: natenorfolk@gmail.com

Licensee/Agent: Norfolk, Nathan J.  
Home Address: 2962 N Prospect Ave.  
City State Zip: Milwaukee, WI 53211  
Phone: 262-271-8501  
Email: natenorfolk.com

Preferred contact: Nate Norfolk

Location currently open: ☐ YES ☒ NO

Projected open date: Soft opening

Day's open: ☒S ☒M ☒T ☒W ☒Th ☒F ☒SA ☒ALL

Hours of Operation: Sun: Closed ☐24 hours ☐Y ☒N  
Mon: 9am-2:30pm  
Tue: 9am-2:30pm  
Wed: 9am-2:30pm  
Thu: 9am-2:30pm  
Fri: 9am-2:30pm  
Sat: 9am-2:30pm

Premise Type: ☒Tavern/Bar  
☐Restaurant  
☐Other:

Licenses currently held: None

Alcohol: ☒ Yes ☐ No Class: #:   
 Tobacco: ☐ Yes ☒ No #:   
 Food: ☒ Yes ☐ No #:   
 Extended Hours: ☒ Yes ☐ No #:   
 Secondhand Dealer: ☐ Yes ☒ No Type: #:   
 Other: ☐ Yes ☐ No Type: #:   
 Other: ☐ Yes ☐ No Type: #:

### Exterior Survey:

1. Is the area around the location clean? ☒ Yes ☐ No
2. What surrounds the location? (Check all the apply)
  - a. ☐ Park
  - b. ☒ School
  - c. ☐ Youth Center
  - d. ☒ Church
  - e. ☒ Tavern(s) If so, how many
  - f. ☒ Residential
  - g. ☒ Other businesses
  - h. ☐ Other:
3. Can you see from the outside of the location into the interior ☐ Yes ☒ No
4. Can you see the employees inside of the location from the outside ☐ Yes ☒ No
5. Are exterior windows free of signage ☒ Yes ☐ No
6. Is there a parking lot ☐ Yes ☒ No
7. Is the parking lot clean? ☐ Yes ☐ No
8. Off-Street parking ☒ Yes ☐ No
9. Is the parking lot well lit? ☐ Yes ☐ No
10. Valet Parking ☐ Yes ☒ No
  - a. Will this lot have a guard? ☐ Yes ☐ No
  - b. Will this lot have cameras? ☐ Yes ☐ No
11. Are there areas where a person could conceal themselves ☒ Yes ☐ No
12. Is there exterior lighting? ☐ Yes ☒ No. Does it appears to be adequate ☒ Yes ☒ No
13. Exterior Payphone? ☐ Yes ☒ No
14. Are there No Loitering Signs posted? ☐ Yes ☒ No
15. Are the address numbers prominently displayed and easy to see ☒ Yes ☐ No

### Camera Survey:

16. Does this location have security cameras? ☐ Yes ☒ No
17. Are they in working order? ☐ Yes ☒ No
18. What format are the cameras?
  - a. Color ☐ Yes ☐ No
  - b. Digital ☐ Yes ☐ No
  - c. Recorded ☐ Yes ☐ No
19. How long is footage stored for later viewing: NO CAMERAS
20. Are there exterior cameras ☐ Yes ☒ No How many:
21. Are there interior cameras ☐ Yes ☒ No How many:
22. Do all employees know how to retrieve recorded digital images/footage? ☐ Yes ☒ No

**Interior Survey:**

23. What is the planned capacity OWNER IS UNSURE .
24. What is the minimum number of employees That will be on premise 2 TO 3
25. Is the storeowner willing to be a standing complainant regarding loitering? ☒ Yes ☐ No  
(not at this time, standing complaint form was left with agent if needed later)
- a. If yes have them fill out the standing complaint form and give them two of the commercial signs ☒ Yes ☐ No
26. Is the interior of the location neat and clean? ☒ Yes ☐ No
27. Does an interior camera face the entrance/exit? ☐ Yes ☒ No
28. Is there a lockable area that separates employees from customers? ☐ Yes ☒ No
29. Are emergency and non-emergency numbers posted near the phone? ☐ Yes ☒ No
30. Does the owner know how to contact their police district directly? ☒ Yes ☐ No
- a. Did you provide a district contact guide to the owner? ☒ Yes ☐ No

**Security**

31. How many security personnel are going to be employed: NONE
32. How will they be deployed: Interior 0 Exterior 0
33. What days will they be deployed ☐ Mon ☐ Tue ☐ Wed ☐ Thu ☐ Fri ☐ Sat ☐ Sun
34. Will the security be managed by business ☐ or contracted ☐
35. Will they be armed ☐ Yes ☐ No
36. What type of security measures to be used:
- ☐ Wandering /metal detector
  - ☐ ID Scanner
  - ☐ Dress Code
  - ☐ Cover Charge
  - ☐ Age restriction 40+
  - ☐ Other

**ADDITIONAL COMMENTS/RECOMMENDATIONS:**

- A lot of blind spots within the tavern as well as the outside.
- Will need more exterior cameras and lighting
- Need to install cameras, there are no cameras inside the establishment.
- Owner agreed to install fusus.



1821 N Martin L King Jr Dr

## Area of Interest (AOI) Information

Area : 21,862,585.64 ft<sup>2</sup>

Oct 13 2025 12:12:35 Central Daylight Time

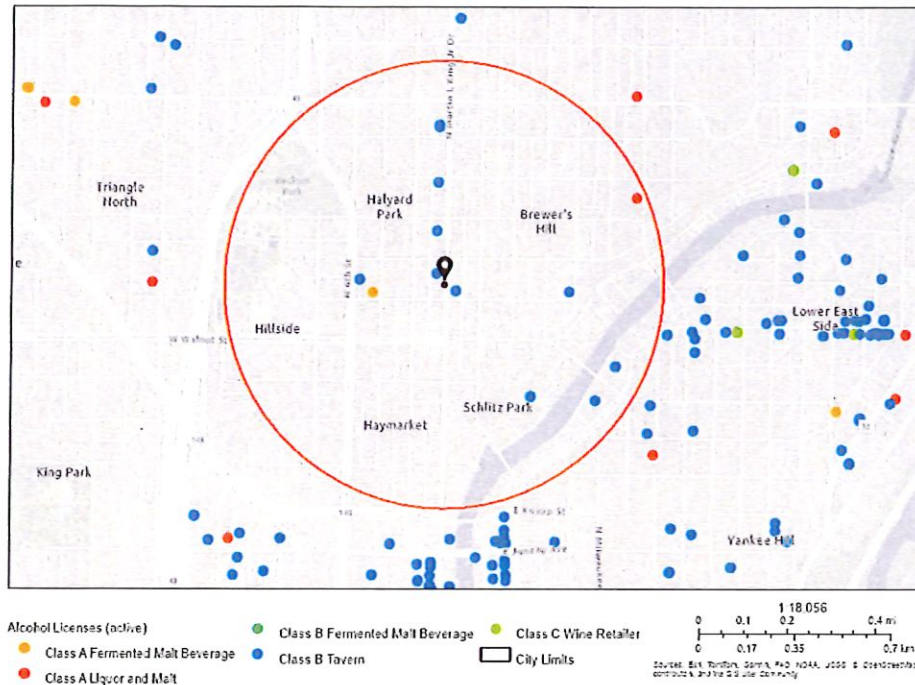



## Summary

Name	Count	Area(ft²)	Length(mi)
Alcohol Licenses	14		

## Alcohol Licenses

#	Legal Entity	Trade Name	Licensee	Address	License Type Name	Total Capacity	Expiration Date	Count
1	Mi Casa Su Cafe LLC	Mi Casa Su Cafe	Paul L Whigham, Agt	1839A N MARTIN L KING JR DR	Class B Tavern License		10/30/2025, 7:00 PM	1
2	Penny Saver, LLC	Penny Saver	Nayef M Azzam, Agt	510 W VINE ST	Class A Fermented Malt Beverage Retailer's License		11/20/2025, 6:00 PM	1
3	BRONZEVILLE KITCHEN & LOUNGE LLC	BRONZEVILLE KITCHEN & LOUNGE	Shana M Green, Agt	2053 N MARTIN L KING JR DR	Class B Tavern License		1/14/2026, 6:00 PM	1
4	GVA LLC	Pueblo Foods & Liquor	Viral Patel, Agt	2029-31 N Holton ST	Class A Malt & Class A Liquor License		1/19/2026, 6:00 PM	1
5	Uncle Wolfie's Breakfast Tavern LLC	Uncle Wolfie's Breakfast Tavern	Matthew A Schaefer, Agt	234 E Vine ST	Class B Tavern License		1/19/2026, 6:00 PM	1
6	Niche Book Bar LLC	Niche Book Bar	Cetonia P Weston-Roy, Agt	1937 N Martin L King Jr DR	Class B Tavern License	40	4/6/2026, 7:00 PM	1
7	PRIMETIME EVENTS LLC	The Tap Yard-Schlitz Park/The Tap Yard-Milwaukee	Nicholas E Marking, Agt	1555 N RIVERCENTE R DR	Class B Fermented Malt Beverage Retailer's License		5/11/2026, 7:00 PM	1
8	OTOD, LLC	Birch Restaurant	Kyle T Knall, Agt	459 E PLEASANT ST	Class B Tavern License		4/22/2026, 7:00 PM	1
9	Lakes Venture LLC	Fresh Thyme Market #701	William Andrew Kreuser, Agt	470 E Pleasant ST	Class B Tavern License		5/29/2026, 7:00 PM	1
10	Pepperpot on MLK, LLC	Pepperpot on MLK	Dwight A Jackson, Agt	2215 N MARTIN L KING JR DR	Class B Tavern License		6/1/2026, 7:00 PM	1
11	PRIMETIME EVENTS LLC	The Tap Yard-Schlitz Park/The Tap Yard-Milwaukee	Nicholas E Marking, Agt	1555 N RIVERCENTE R DR	Class B Tavern License		7/29/2026, 7:00 PM	1
12	Mai Bar LLC	Mai Bar	Kevin D Perkins, Agt	1840 N 6th ST	Class B Tavern License		7/29/2026, 7:00 PM	1
13	KISMET ACTIVATIONS LLC	Summer of '85	Julie Lukas, Agt	2213 N MARTIN L KING JR DR	Class B Tavern License		8/25/2026, 7:00 PM	1
14	MLK Dream MKE, LLC	Dream Lounge Social	Amy R Tucker, Agt	1806 N MARTIN L KING JR DR	Class B Tavern License		9/15/2026, 7:00 PM	1

Establishments within a 0.5 miles radius centered on area of interest.





Thursday, December 18, 2025



# Notice of Public Hearing

Blank Notice

---

NORFOLK, Nathan J, Agent  
Vint at 1821 N MARTIN L KING JR DR

Class B Tavern, Public Entertainment Premises and Food Dealer Licenses Application Requesting  
Instrumental Musicians, Disc Jockey, Bands, Karaoke, Poetry Readings and Patron Contests

**Tuesday, January 06, 2026 at 1:25 PM**

To whom it may concern:

The above application has been made by the above named applicant(s). This requires approval from the Licenses Committee and the Common Council of the City of Milwaukee. The hearing before the Licenses Committee will take place on 1/6/2026 at 1:25 PM in Room 301-B, Third Floor, City Hall. This is a public hearing. Those wishing to view the proceeding are able to do so via the City Channel – Channel 25 on Spectrum Cable – or on the Internet at <http://city.milwaukee.gov/citychannel>. Those wishing to provide oral testimony via internet are asked to contact the staff assistant, Yadira Melendez at (414) 286-2775 or [stasst5@milwaukee.gov](mailto:stasst5@milwaukee.gov) for necessary information. Please make such requests no later than one business day prior to the start of the meeting. You are not required to attend the hearing, but please see the information below if you would like to provide testimony. Once the Licenses Committee makes its recommendation, this recommendation is forwarded to the full Common Council for approval at its next regularly scheduled hearing.

---

## **Important details for those wishing to provide information for the Licenses Committee to consider when making its recommendation:**

1. The license application is scheduled to be heard at the above time. Due to other hearings running longer than scheduled, you may have to wait some time to provide your testimony.
2. You must appear in person and testify as to matters that you have personally experienced or seen. (You cannot provide testimony for your neighbor, parent or anyone else; this is considered hearsay and cannot be considered by the committee.)
3. No letters or petitions can be accepted by the committee (unless the person who wrote the letter or the persons who signed the petition are present at the committee hearing and willing to testify).
4. Persons opposed to the license application are given the opportunity to testify first; supporters may testify after the opponents have finished.
5. When you are called to testify, you will be sworn in and asked to give your name, and address. (If your first and/or last names are uncommon please spell them.)
6. You may then provide testimony.
  - a. Include only information relating to the above license application.
  - b. Include only information you have personally witnessed or seen.
  - c. Provide concise and relevant information detailing how this business has affected or may affect the peaceful enjoyment of your neighborhood.
  - d. If by the time you have the opportunity to testify, the information you wish to share has already been provided to the committee, you may state that you agree with the previous testimony. Redundant or repetitive testimony will not assist the committee in making its recommendation.
7. After giving your testimony, the members of the Licenses Committee and the licensee may ask questions regarding the testimony you have given or other factors relating to the license application.
8. Business Competition is not a valid basis for denial or non-renewal of a license.  
**Please Note: If you have submitted an objection to the above application your objection cannot be considered by the committee unless you personally testify at the hearing.**

OCCUPANT	MAIL ADDRESS	CITY STATE ZIP
CURRENT OCCUPANT	1736 N VEL R PHILLIPS AVE	MILWAUKEE# WI 53212-3604
CURRENT OCCUPANT	1740 N VEL R PHILLIPS AVE	MILWAUKEE# WI 53212-3604
CURRENT OCCUPANT	1744 N DR MARTIN LUTHER KING DR# 1	MILWAUKEE# WI 53212-3648
CURRENT OCCUPANT	1744 N DR MARTIN LUTHER KING DR# 2	MILWAUKEE# WI 53212-3648
CURRENT OCCUPANT	1744 N DR MARTIN LUTHER KING DR# 3	MILWAUKEE# WI 53212-3648
CURRENT OCCUPANT	1744 N DR MARTIN LUTHER KING DR# 4	MILWAUKEE# WI 53212-3648
CURRENT OCCUPANT	1744 N DR MARTIN LUTHER KING DR# 5	MILWAUKEE# WI 53212-3649
CURRENT OCCUPANT	1744 N DR MARTIN LUTHER KING DR# 6	MILWAUKEE# WI 53212-3649
CURRENT OCCUPANT	1744 N DR MARTIN LUTHER KING DR# 7	MILWAUKEE# WI 53212-3649
CURRENT OCCUPANT	1744 N DR MARTIN LUTHER KING DR# 8	MILWAUKEE# WI 53212-3649
CURRENT OCCUPANT	1756 N DR MARTIN LUTHER KING DR# 1	MILWAUKEE# WI 53212-3662
CURRENT OCCUPANT	1756 N DR MARTIN LUTHER KING DR# 2	MILWAUKEE# WI 53212-3662
CURRENT OCCUPANT	1756 N DR MARTIN LUTHER KING DR# 3	MILWAUKEE# WI 53212-3662
CURRENT OCCUPANT	1756 N DR MARTIN LUTHER KING DR# 4	MILWAUKEE# WI 53212-3662
CURRENT OCCUPANT	1756 N DR MARTIN LUTHER KING DR# 5	MILWAUKEE# WI 53212-3664
CURRENT OCCUPANT	1756 N DR MARTIN LUTHER KING DR# 6	MILWAUKEE# WI 53212-3664
CURRENT OCCUPANT	1756 N DR MARTIN LUTHER KING DR# 7	MILWAUKEE# WI 53212-3664
CURRENT OCCUPANT	1756 N DR MARTIN LUTHER KING DR# 8	MILWAUKEE# WI 53212-3664
CURRENT OCCUPANT	1806A N DR MARTIN LUTHER KING DR	MILWAUKEE# WI 53212-3640
CURRENT OCCUPANT	1806B N DR MARTIN LUTHER KING DR	MILWAUKEE# WI 53212-3640
CURRENT OCCUPANT	1808 N DR MARTIN LUTHER KING DR	MILWAUKEE# WI 53212-3640
CURRENT OCCUPANT	1809 N VEL R PHILLIPS AVE	MILWAUKEE# WI 53212-3609
CURRENT OCCUPANT	1812 N DR MARTIN LUTHER KING DR	MILWAUKEE# WI 53212-3640
CURRENT OCCUPANT	1814 N VEL R PHILLIPS AVE	MILWAUKEE# WI 53212-3610
CURRENT OCCUPANT	1815 N VEL R PHILLIPS AVE	MILWAUKEE# WI 53212-3609
CURRENT OCCUPANT	1816 N VEL R PHILLIPS AVE	MILWAUKEE# WI 53212-3610
CURRENT OCCUPANT	1816A N VEL R PHILLIPS AVE	MILWAUKEE# WI 53212-3610
CURRENT OCCUPANT	1817 N DR MARTIN LUTHER KING DR	MILWAUKEE# WI 53212-3673
CURRENT OCCUPANT	1818 N VEL R PHILLIPS AVE	MILWAUKEE# WI 53212-3610
CURRENT OCCUPANT	1819 N DR MARTIN LUTHER KING DR# 1	MILWAUKEE# WI 53212-3673
CURRENT OCCUPANT	1819 N DR MARTIN LUTHER KING DR# 2	MILWAUKEE# WI 53212-3673
CURRENT OCCUPANT	1820 N VEL R PHILLIPS AVE	MILWAUKEE# WI 53212-3610
CURRENT OCCUPANT	1821 N VEL R PHILLIPS AVE	MILWAUKEE# WI 53212-3609
CURRENT OCCUPANT	1821A N DR MARTIN LUTHER KING DR	MILWAUKEE# WI 53212-3673
CURRENT OCCUPANT	1822 N VEL R PHILLIPS AVE	MILWAUKEE# WI 53212-3610
CURRENT OCCUPANT	1824 N VEL R PHILLIPS AVE	MILWAUKEE# WI 53212-3610
CURRENT OCCUPANT	1826 N VEL R PHILLIPS AVE	MILWAUKEE# WI 53212-3610
CURRENT OCCUPANT	1826A N VEL R PHILLIPS AVE	MILWAUKEE# WI 53212-3610
CURRENT OCCUPANT	1827 N DR MARTIN LUTHER KING DR# 101	MILWAUKEE# WI 53212-3669
CURRENT OCCUPANT	1827 N DR MARTIN LUTHER KING DR# 201	MILWAUKEE# WI 53212-3669
CURRENT OCCUPANT	1827 N DR MARTIN LUTHER KING DR# 202	MILWAUKEE# WI 53212-3669
CURRENT OCCUPANT	1827 N DR MARTIN LUTHER KING DR# 203	MILWAUKEE# WI 53212-3669
CURRENT OCCUPANT	1827 N DR MARTIN LUTHER KING DR# 204	MILWAUKEE# WI 53212-3669
CURRENT OCCUPANT	1827 N DR MARTIN LUTHER KING DR# 205	MILWAUKEE# WI 53212-3669
CURRENT OCCUPANT	1827 N DR MARTIN LUTHER KING DR# 206	MILWAUKEE# WI 53212-3669
CURRENT OCCUPANT	1827 N DR MARTIN LUTHER KING DR# 207	MILWAUKEE# WI 53212-3669

CURRENT OCCUPANT	1827 N VEL R PHILLIPS AVE	MILWAUKEE# WI 53212-3609
CURRENT OCCUPANT	1828 N VEL R PHILLIPS AVE	MILWAUKEE# WI 53212-3610
CURRENT OCCUPANT	1833 N VEL R PHILLIPS AVE	MILWAUKEE# WI 53212-3609
CURRENT OCCUPANT	1835 N DR MARTIN LUTHER KING DR	MILWAUKEE# WI 53212-3673
CURRENT OCCUPANT	1837 N DR MARTIN LUTHER KING DR	MILWAUKEE# WI 53212-3673
CURRENT OCCUPANT	1839 N DR MARTIN LUTHER KING DR# C	MILWAUKEE# WI 53212-3673
CURRENT OCCUPANT	1839B N DR MARTIN LUTHER KING DR	MILWAUKEE# WI 53212-3673
CURRENT OCCUPANT	1846 N VEL R PHILLIPS AVE# 101	MILWAUKEE# WI 53212-3610
CURRENT OCCUPANT	1846 N VEL R PHILLIPS AVE# 102	MILWAUKEE# WI 53212-3610
CURRENT OCCUPANT	1846 N VEL R PHILLIPS AVE# 201	MILWAUKEE# WI 53212-3610
CURRENT OCCUPANT	1846 N VEL R PHILLIPS AVE# 202	MILWAUKEE# WI 53212-3610
CURRENT OCCUPANT	1846 N VEL R PHILLIPS AVE# 301	MILWAUKEE# WI 53212-3610
CURRENT OCCUPANT	1846 N VEL R PHILLIPS AVE# 302	MILWAUKEE# WI 53212-3610
CURRENT OCCUPANT	1846 N VEL R PHILLIPS AVE# 401	MILWAUKEE# WI 53212-3610
CURRENT OCCUPANT	1846 N VEL R PHILLIPS AVE# 402	MILWAUKEE# WI 53212-3610
CURRENT OCCUPANT	1846 N VEL R PHILLIPS AVE# 501	MILWAUKEE# WI 53212-3610
CURRENT OCCUPANT	1846 N VEL R PHILLIPS AVE# 502	MILWAUKEE# WI 53212-3610
CURRENT OCCUPANT	1849 N DR MARTIN LUTHER KING DR# 101	MILWAUKEE# WI 53212-3639
CURRENT OCCUPANT	224 W VINE ST# 101	MILWAUKEE# WI 53212-3936
CURRENT OCCUPANT	224 W VINE ST# 102	MILWAUKEE# WI 53212-3936
CURRENT OCCUPANT	224 W VINE ST# 201	MILWAUKEE# WI 53212-3936
CURRENT OCCUPANT	224 W VINE ST# 202	MILWAUKEE# WI 53212-3936
CURRENT OCCUPANT	231 W VINE ST# A	MILWAUKEE# WI 53212-3935
CURRENT OCCUPANT	231 W VINE ST# B	MILWAUKEE# WI 53212-3935
CURRENT OCCUPANT	233 W VINE ST# A	MILWAUKEE# WI 53212-3935
CURRENT OCCUPANT	233 W VINE ST# B	MILWAUKEE# WI 53212-3935
CURRENT OCCUPANT	235 W VINE ST	MILWAUKEE# WI 53212-3935
CURRENT OCCUPANT	237 W VINE ST	MILWAUKEE# WI 53212-3935
CURRENT OCCUPANT	239 W VINE ST	MILWAUKEE# WI 53212-3935
CURRENT OCCUPANT	314 W VINE ST# 1	MILWAUKEE# WI 53212-3606
CURRENT OCCUPANT	314 W VINE ST# 2	MILWAUKEE# WI 53212-3606
CURRENT OCCUPANT	314 W VINE ST# 3	MILWAUKEE# WI 53212-3606
CURRENT OCCUPANT	314 W VINE ST# 4	MILWAUKEE# WI 53212-3606
CURRENT OCCUPANT	314 W VINE ST# 5	MILWAUKEE# WI 53212-3606
CURRENT OCCUPANT	314 W VINE ST# 6	MILWAUKEE# WI 53212-3606
CURRENT OCCUPANT	314 W VINE ST# 7	MILWAUKEE# WI 53212-3606
CURRENT OCCUPANT	314 W VINE ST# 8	MILWAUKEE# WI 53212-3606
CURRENT OCCUPANT	335 W VINE ST	MILWAUKEE# WI 53212-3605
CURRENT OCCUPANT	339 W VINE ST	MILWAUKEE# WI 53212-3605

Blank Notice

Total Records: 85

Radius 250 feet and Center of the Circle: 1821 N MLK JR DR



## BUSINESS LICENSE PLAN OF OPERATION

ccl-busplan 5/12/2020

Office of the City Clerk License Division

200 E. Wells St. Room 105, Milwaukee, WI 53202

(414) 286-2238 www.milwaukee.gov/license e-mail address: [license@milwaukee.gov](mailto:license@milwaukee.gov)

### 1. Type of Business

Applying for: Extended Hours (12AM to 5AM) - If a food establishment, check all that apply: ☐ Delivery ☐ Drive Thru ☐ Dining Room

☐ Self Service Laundry ☐ Massage Establishment ☐ Filling Station

☒ Other (supplemental application for specific license also required)

Provide a detailed description of the type of business you plan on operating:

Wine bar with retail wine selections

Do you have any experience operating this type of business? ☐ No ☒ Yes If yes, explain: Over 20 years of combined experience in wine business

### 2. Business Operations

a. Proposed Opening Date: 02/01/2025

b. Is this premise under construction? ☒ No ☐ Yes If yes, list estimated completion date: \_\_\_\_\_

c. Is this a franchise? ☒ No ☐ Yes

d. Is this premises currently licensed? ☒ No ☐ Yes If yes, list type of license: \_\_\_\_\_

e. Is the current licensee operating? ☒ No ☐ Yes If no, list date closed: \_\_\_\_\_

f. Do you have future plans for other businesses, licenses or permits at this location? ☒ No ☐ Yes

If yes, explain: \_\_\_\_\_

g. Have you previously held an Extended Hours License in Milwaukee? ☒ No ☐ Yes

If yes, list address(es): \_\_\_\_\_

h. Are other businesses operating in the same building? ☒ No ☐ Yes If yes, describe: \_\_\_\_\_

### 3. Litter & Noise

a. How are grounds kept clean? ☒ Sweep ☐ Pressure Wash ☒ Pick Up Litter ☐ Other: \_\_\_\_\_

b. How often will grounds be cleaned? ☐ Daily ☒ Weekly ☐ As Needed ☐ Monthly ☐ Other: \_\_\_\_\_

c. Grounds cleaned by: ☒ Licensee ☒ Building Owner ☒ Employees ☐ Hired Maintenance ☐ Other: \_\_\_\_\_

d. How are noise issues prevented and/or addressed? ☐ Security ☒ Manager approaches customer(s) ☒ Call Police  
☒ Signs Posted ☐ Other: \_\_\_\_\_

e. Will a sound amplification system be used? ☐ No ☒ Yes If yes, describe: 200 watt public address system

### 4. Smoking & Sanitation

a. Are there designated outdoor smoking areas? ☒ No ☐ Yes If yes, describe: \_\_\_\_\_

b. Number of Garbage Cans: Inside: 3 Locations: Bathrooms and behind bar  
Outside: 1 Locations: Alley behind the building

c. Is a crowd control barrier used? ☒ No ☐ Yes If yes, describe: \_\_\_\_\_

d. How many restrooms are on the premises? 2

e. Name of solid waste contractor: ☐ Advanced Disposal ☒ Waste Management ☐ Other: \_\_\_\_\_



## 5. Security

- a. Are there onsite parking spaces? ☒ No ☐ Yes If yes, how many? \_\_\_\_\_ and describe the parking security plan: \_\_\_\_\_
- b. Is there a loading zone? ☒ No ☐ Yes If yes, describe the loading area security plan: \_\_\_\_\_
- c. Will you have licensed security on premise? ☒ No ☐ Yes If yes, how many? \_\_\_\_\_ and answer the following:  
What are their responsibilities? \_\_\_\_\_  
Describe equipment used \_\_\_\_\_  
List their License Number (s) \_\_\_\_\_
- d. Will there be security cameras? ☐ No ☒ Yes If yes, how many? 6 and list locations: front entrance, side entrance, 3 internal cameras: Front door, product wall, bathroom area
- e. Will searches/identification checks be done upon entry? ☐ No ☒ Yes If yes, describe to determine if guest is over 21

## 6. Percentage of Sales (must total 100%)

Alcohol <u>70</u> %	Food <u>20</u> % Cigarettes, Electronic Vape Devices, <u>0</u> % Tobacco Products _____ %	Secondhand Merchandise <u>0</u> %	Precious Metals & Gems <u>0</u> %
Entertainment <u>10</u> %			
Pawnbroker Activity <u>0</u> %	Salvaged Materials <u>0</u> % (such as scrap metal)	Personal Services (such as tattoo, body piercing, salon, tailor, tanning, etc.) <u>0</u> %	Other <u>0</u> % Describe: _____

## 7. Businesses/Licenses on the Premises (check all that apply):

### Type 1

- ☐ Full Service Restaurant ☐ Cafe/Coffee Shop ☐ Deli or Fast Food Restaurant ☐ Private/Fraternal/Veterans Club
- ☐ Night Club ☒ Tavern ☐ Cocktail Lounge ☐ Teen Club
- ☐ Banquet Hall ☐ Sports Facility ☐ Bowling Alley
- ☐ Hotel/Motel : Number of Floors: \_\_\_\_\_ Number of Rooms: \_\_\_\_\_  
☐ Rooming House: Number of Floors: \_\_\_\_\_ Number of Rooms: \_\_\_\_\_

### Type 2

- ☐ Liquor Store ☐ Corner Store ☐ Supermarket ☐ Convenience Store
- ☐ Gas Station ☐ Amusement/Phonograph Distributor ☐ Recycling, Salvage or Towing
- ☐ Used Car Dealer ☐ Personal Service Establishment  
(such as tattoo business, hair salon, tailor, etc.) ☐ Recording Studio

What other licenses/permits will you hold at this location? (check all that apply)

- ☒ Occupancy Permit ☐ Cigarette, Tobacco, ☐ Gas Station | Extended Hours ☒ Class "B" Tavern ☐ Weights & Measures  
Electronic Vape Products
- ☐ Secondhand Dealer ☐ Precious Metal & Gem ☐ Other: \_\_\_\_\_

## 8. Legal Capacity (only if a Type 1 premises in #7 above)

Capacity \_\_\_\_\_ (Call the Milwaukee Development Center at 414-286-8211 if you have questions.)

## 9. Premises Description

- a. Identify all area(s) of the premises that will be used in operating this business (include areas used only for storage):  
☒ 1<sup>st</sup> Floor ☐ 2<sup>nd</sup> Floor ☐ Basement Storage ☐ Patio ☐ Beer Garden ☐ Sidewalk Café ☐ Deck ☐ Rooftop  
☐ Other: Describe: \_\_\_\_\_
- b. Describe Location: ☒ Major Thoroughfare ☐ Secondary Street ☐ Other: \_\_\_\_\_
- c. Nearest Major Cross Street: Dr MLK Jr Dr and Vine St
- d. Describe Building: ☒ Free Standing Building ☐ Strip Mall ☐ Other: \_\_\_\_\_
- e. Describe Premises Structure: ☐ Single Story ☒ Multi-Story - # of Stories 2 ☐ Other: \_\_\_\_\_
- f. Describe Surrounding Area: ☒ Commercial ☒ Residential ☐ Industrial ☐ Other: \_\_\_\_\_
- g. Building Owner Name: Tina Chang Phone Number: (262) 780-0380  
 Building Owner Address: 1821 N Dr MLK Jr Dr

## 10. Hours of Operation & Customers

Will customers be entering the premises? ☐ No ☒ Yes

Day of the Week	Proposed Hours of Operation:		Estimated Number of Customers expected each day	Potential Age Range of Customers	Class B Tavern Applicant Only: Age Restriction (If none, write 'None')
	Open Time (include a.m. or p.m.)	Close Time (include a.m. or p.m.)			
Sunday	8 AM	1 AM	80	21-65	None
Monday	8 AM	1 AM	80	21-65	None
Tuesday	8 AM	1 AM	80	21-65	None
Wednesday	8 AM	1 AM	80	21-65	None
Thursday	8 AM	1 AM	80	21-65	None
Friday	8 AM	2:30 AM	300	21-65	None
Saturday	8 AM	2:30 AM	300	21-65	None

An Extended Hours Establishment License is required for any convenience store, filling station, personal service establishment (such as tattoo, body piercing, salon, tailor, tanning, etc.), recording studio or restaurant which is open between the hours of 12:00 a.m. and 5:00 a.m.

Alcohol Establishments Class A: 8:00 am to 9:00 pm Sunday thru Saturday  
 Permitted Hours of Operation: Class B: 6:00 am to 2:00 am Sunday thru Thursday, 6:00 am to 2:30 am Friday & Saturday

Entertainment Outdoor Closing Hours: 10:00pm Sunday-Thursday; 12:00am Friday & Saturday; unless a different time, either earlier or later, is established by the Common Council in its approval of the licensee's plan of operation.

## 11. Signature(s)

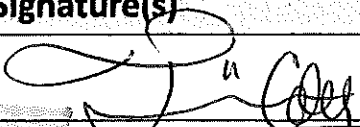
  
 Signature of Sole Proprietor, Partner, or 20% or more Shareholder  
 (If there are no 20% or more shareholders,  
 Corporate Officer-print name/title and sign)

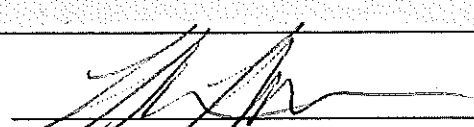
  
 Signature of additional partner or 20% or more shareholder

See Application Information for a complete list of all required application forms.



# ALCOHOL BEVERAGE & PUBLIC ENTERTAINMENT PREMISES SUPPLEMENTAL APPLICATION

Office of the City Clerk License Division  
200 E. Wells St. Room 105, Milwaukee, WI 53202  
(414) 286-2238 e-mail address: license@milwaukee.gov

Legal Entity Name: Wine Consortium LLC

Premise Address: 1821 N Dr MLK Jr Dr

## Proximity of Premises to Church, School, Daycare Center or Hospital

Is the building within 300 feet of any church, school, daycare center or hospital? ☒ No ☐ Yes

## "Service Bar Only" Designation

If applying for Class B or C license, are you applying for "Service Bar Only"? ☒ No ☐ Yes

Service Bar Only means customers cannot sit at the bar. Alcohol is served to employees who serve patrons seated at tables. No stools, chairs or other articles of furniture shall be placed at the service bar for patrons to sit upon.

## Business Information

a) Are you taking out this application for anyone that may not be eligible for a license? ☒ No ☐ Yes

If yes, list their name and address: \_\_\_\_\_

b) Will the agent, a partner or the individual licensee be conducting the day-to-day operations of the business? ☐ No ☒ Yes

If no, list the name and address of the person(s) who will: \_\_\_\_\_

Class B Applicants: If the agent, a partner or the individual licensee will not be conducting the day-to-day operations of the business, the person(s) listed above must obtain a Class B Managers license.

c) Does anyone else have money invested or any other interest in this business? ☒ No ☐ Yes

If yes, explain: \_\_\_\_\_

d) Have you made an agreement with anyone to repay any loan or any other payments based upon income from the business?

☒ No ☒ Yes If yes, list name and address: \_\_\_\_\_

## Property Information (New & Transfer Applicants Only)

a) Do you own or lease the building? ☐ Own ☒ Lease

b) Who owns the fixtures (for example, coolers, etc.)? Wine Consortium

c) Are you purchasing the stock and/or fixtures? ☒ No ☐ Yes If yes, amount paid \$ \_\_\_\_\_

d) Total amount paid for business \$ 0

e) Total amount paid for goodwill of the business \$ 0

Goodwill comprises the reputation and customer relationships of an existing business. If the price you pay for the business exceeds the fair market value of all of the rest of the assets of the business, the excess may be considered goodwill.

## Lease Information (New & Transfer Applicants who are leasing the premises only)

a) Date lease begins 01/01/2026 Ends 01/01/2031

b) Monthly rental \$ 5,000

c) Do you have an option to renew the lease? ☐ No ☒ Yes

d) Does your lease allow for assignment to another party without the consent of the owner? ☒ No ☐ Yes

e) For what length of time have you been guaranteed occupancy (number of years)? 5

### Lease Information (Continued)

- f) In addition to paying the monthly rental, will you have to pay anything additional to the owner of the building to guarantee performance of the lease? ☐ No ☒ Yes If yes, explain Energy, water, trash
- g) Does the present owner or occupant object to the granting of your license? ☒ No ☐ Yes  
If yes, explain \_\_\_\_\_

### Change of Agent Applicants Only

Have there been any changes to the floor plan since the last application was submitted? ☒ No ☐ Yes  
If no, a new floor plan is not required. If yes, submit a new floor plan and explain the change(s):  
\_\_\_\_\_

### Signature

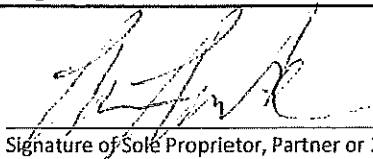

Signature of Sole Proprietor, Partner or 20% or More Shareholder  
(If no 20% or more Shareholder, Corporate Officer - print name/title and sign)

Note: All information contained in this application is subject to approval by the Common Council.  
Deviating from approved plan of operation will subject licensee to citations, and/or suspension or non-renewal of the license.  
Contact the License Division for information on how to request changes.

### New and transfer of premises applicants must submit the following:

- ☐ Detailed floor plan  
☐ If a restaurant, copy of the menu



**FOOD DEALER LICENSE PLAN OF OPERATION**

OFFICE OF THE CITY CLERK, LICENSE DIVISION  
CITY HALL, 200 E. WELLS ST, ROOM 105, MILWAUKEE, WI 53202  
(414) 286-2238 • [license@milwaukee.gov](mailto:license@milwaukee.gov) • [www.milwaukee.gov/license](http://www.milwaukee.gov/license)

Legal Entity Name: Wine Consortium LLC

Premises Address: 1821 N Doctor M.L.K. Jr Dr, Milwaukee, WI 53212

**SECTION 1 TYPE OF BUSINESS**

What will be the majority of your food sales? (check one)

☐ Restaurant Items (meals):

MEALS include, but are not limited to, chicken, ribs, sandwiches, roasted corn, baked potatoes, hot dogs, brats, tacos, nachos w/ cheese and meat, French fries, cooked or deep fried vegetables/fruit, cooked cheese curds, corn dogs, egg rolls, salads.

☒ Retail Items (snacks and beverages):

RETAIL items include, but are not limited to, ice cream/soft serve, lemonade, snow cones, coffee, espresso, cappuccino, tea, fruit juice, smoothies, candy, dispensed soda, fruit cups, bakery, cookies, kettle corn, cotton candy, funnel cakes, fritters, tortilla chips w/ cheese.

Will it be a convenience store? ☐ Yes ☒ No

A convenience store contains less than 7,500 square feet of retail space and has, as its primary business, the sale of basic food items and in addition, sells household products or is a filling station that sells basic food items and household products.

☐ Bed & Breakfast

☐ Micro Market

All Applicants: Submit a menu or a list of food items that will be sold.

Will any wholesale business be done? ☒ No ☐ Yes If yes, what percentage of food sales will be wholesale?

☐ Less than 25%

☐ 25% or More AND:

☐ Restaurant items (meals) will be sold – Complete this application and also contact DATCP.

☐ NO restaurant items (meals) will be sold - Do NOT complete this application. Contact DATCP only.

**SECTION 2 FOOD PROCESSING**

Will any food processing be done? ☐ No ☒ Yes

Processing is defined as assembling, grinding, cutting, mixing, baking, coating, stuffing, packing, bottling, grilling, canning, extracting, fermenting, distilling, pickling, freezing, drying, smoking, or packaging.

**SECTION 3 FOOD REQUIRING TEMPERATURE CONTROL**

Will any food that requires temperature control be sold? ☐ No ☒ Yes

(Includes dairy products such as milk, cheese, and ice cream, fish, shellfish, meat, poultry)

If yes, list the types of food items: cheese, cured meats, fruit

**SECTION 4 DETAILS OF OPERATION**

- Will you have seating on site for dining? ☐ No ☒ Yes
- Will you be doing any catering? ☒ No ☐ Yes
- Will you be doing any delivery? ☒ No ☐ Yes
- Will you have outdoor activities? ☒ No ☐ Yes - Check all that apply: ☐ Bar ☐ Cooking/Grilling ☐ Dining
- Will you have a drive thru window? ☒ No ☐ Yes - Are hours different from inside? ☐ No ☐ Yes
- If Yes, provide drive thru hours: \_\_\_\_\_
- Will scales or barcode scanners be used? ☐ No ☒ Yes - You must also apply for a Weights & Measures License.

**SECTION 5 ADDITIONAL SITES**

Where will food be prepared and/or sold?

- ☒ At a single site ☐ At multiple sites: How many? \_\_\_\_\_ (for example, a hotel with several dining rooms or bars)

If multiple sites, attach a Food Dealer Additional Site Addendum (ccl-foodadd) for each additional site.

**SECTION 6 CONSTRUCTION OR CHANGES**

Are you planning any construction, remodeling or equipment changes?

- ☒ No If No, SKIP to Section 7
- ☐ Yes If Yes, check all that apply: ☐ New construction of a building ☐ Renovation or remodeling  
☐ Construction changes to existing building ☐ Equipment changes only

Provide a brief description of the changes: \_\_\_\_\_

Start date: \_\_\_\_\_

Name, Address &amp; Phone Number of Architect: \_\_\_\_\_

Name, Address &amp; Phone Number of Contractor: \_\_\_\_\_

**SECTION 7 ALCOHOL BEVERAGES**

Are you applying for an alcohol beverage license?

- ☐ No If No, SKIP to Section 8
- ☒ Yes If YES, if your food license is approved prior to the alcohol license, when do you want the food license issued?  
☐ Immediately ☒ At the same time as the alcohol license

**SECTION 8 ACKNOWLEDGEMENTS & SIGNATURE**

You must initial each item confirming your understanding:

TC

I understand the Health Department must conduct an inspection and advise the License Division of their approval before the license may be issued.

TC

I understand I must obtain an occupancy permit from the Department of Neighborhood Services and an inspection may be required. Neighborhood Services must advise the License Division of their approval before the license may be issued.

TC

I understand the district alderperson will review and either support or object to my application. If he/she objects, I may appeal and be scheduled to appear before the Licenses Committee. The Licenses Committee will then make a recommendation to the Common Council. The Common Council must grant the license before it may be issued.

TC

I understand proof of payment for all license fees must be on file in the License Division before the license may be issued and the license must be issued and posted in my establishment prior to opening for business.

TC

I will not operate my food business until the license has been issued and posted in the establishment.

Signature of Sole Proprietor, Partner, or 20% Shareholder: \_\_\_\_\_

Signature of Additional Partner: \_\_\_\_\_



# PUBLIC ENTERTAINMENT PREMISES LICENSE SUPPLEMENTAL APPLICATION

Office of the City Clerk License Division  
200 E. Wells St. Room 105, Milwaukee, WI 53202  
(414) 286-2238 [www.milwaukee.gov/license](http://www.milwaukee.gov/license) e-mail address: [license@milwaukee.gov](mailto:license@milwaukee.gov)

**PREMISES ADDRESS:** 1821 N Dr Martin Luther King Jr Dr

## TYPES OF ENTERTAINMENT (CHECK ALL THAT APPLY)

- |   |   |   |   |
|---|---|---|---|
| <input checked="" type="checkbox"/> Instrumental Musicians                          | <input type="checkbox"/> Battle of the Bands        | <input type="checkbox"/> Dancing by Performers                          | <input type="checkbox"/> Amusement Machines<br>How many? _____                |
| <input checked="" type="checkbox"/> Bands   | <input type="checkbox"/> Comedy Acts                | <input type="checkbox"/> Adult Entertainment/<br>Strippers/Erotic Dance | <input type="checkbox"/> Concerts<br>Approx. # per year? _____                |
| <input type="checkbox"/> Bowling Alley<br>How many? _____                           | <input checked="" type="checkbox"/> Disc Jockey     | <input type="checkbox"/> Wrestling                                      | <input type="checkbox"/> Theatrical Performances<br>Approx. # per year? _____ |
| <input type="checkbox"/> Pool Tables<br>How many? _____                             | <input type="checkbox"/> Magic Shows                | <input checked="" type="checkbox"/> Patron Contests                     | <input type="checkbox"/> Jukebox  |
| <input type="checkbox"/> Motion Pictures (movies by<br>admission) - How many? _____ | <input checked="" type="checkbox"/> Poetry Readings | <input type="checkbox"/> Patrons Dancing                                | <input checked="" type="checkbox"/> Karaoke                                   |
| <input type="checkbox"/> Hookah Service   | <input type="checkbox"/> Other: _____               |   |   |

**Entertainment Outdoor Closing Hours:** 10:00pm Sunday-Thursday; 12:00am Friday & Saturday; unless a different time, either earlier or later, is established by the Common Council in its approval of the licensee's plan of operation.

## PROMOTERS/SOUND AMPLIFICATION

Will promoters ever be used for any of the entertainment? ☒ No ☐ Yes If Yes, Describe:

At any time will sound amplification be used? ☐ No ☒ Yes If Yes, Describe: 200 watt public address system

## LEGAL CAPACITY OF PREMISES

(Call the Development Center at 414-286-8211 with questions.) Legal capacity determines the fee for your Public Entertainment Premises License. If you would like to request the license be approved with a lower capacity than that listed above, indicate the lower capacity here: \_\_\_\_\_. If approved, this lower capacity will print on your license and override the capacity listed on your Occupancy Permit.

## ACKNOWLEDGEMENT/SIGNATURE

I understand that after the license has been issued, a change to the plan of operation will require a written request to change and approval from the Common Council. I agree to inform the City Clerk within 10 days of any substantial changes in the information supplied in this application. I understand that I shall not willfully refuse to provide the services offered under this license, or add charges or require deposits not required of the general public because of race, color, sex, religion, national origin or ancestry, age, handicap, lawful source of income, marital status, sexual orientation, gender identity or expression, familial status or the fact that a person is now or has been a member of the military service, whether dressed in uniform or not; and shall not seek such information as a condition of employment, or penalize any employee or discriminate in the selection of personnel for training or promotion on the basis of such information.

I have knowledge of the City Ordinances currently regulating public entertainment, and understand that the license may be subject to suspension, non-renewal or revocation, if I violate any rule, law or regulation of the city of Milwaukee and State of Wisconsin.

Signature of Sole Proprietor, Partner or 20% or More Shareholder  
(If no 20% or more Shareholder, Corporate Officer - print name/title and sign)

## Office Use Only:

Initials: \_\_\_\_\_ Filed: \_\_\_\_\_ App: \_\_\_\_\_

Only PEP? ☐ No ☐ Yes If Yes, ☐ Queue to MPD and ☐ Email Mgrs/Team Lead (must be heard w/in 60 days)



Pg 1  
10/09/2023  
Wine Consortium LLC  
Nate Norfolk  
VINT  
2821 N Dr MLK Jr Dr  
Milwaukee, WI 53212

Dr MLK Jr  
Drive

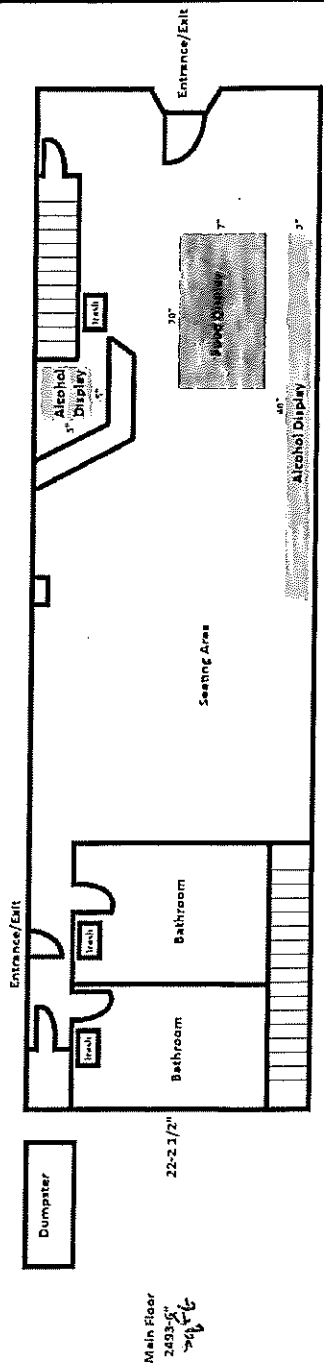





Pg 1  
10/09/2015  
Wine Consortium LLC  
Nate Norfolk  
VINT  
1121 N Dr MLK Jr Dr  
Milwaukee, WI 53212

Dr MLK Jr  
Drive

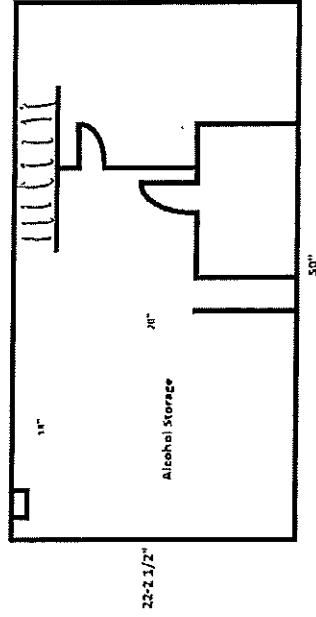

Basement  
1110-3 1/4"  
5/8/16

# Menu

Cheddar Cheese cubes

Cured Meats

Olives

Crackers

Almonds

Mustard