

JRUELDAGUTIERREZTED ON: 9/14/2021 2:47:25 PM

1" = 30'-0"

GP-SE-2020-41-03490

REV. 4

PROJECT # 20039 SHEET # 4

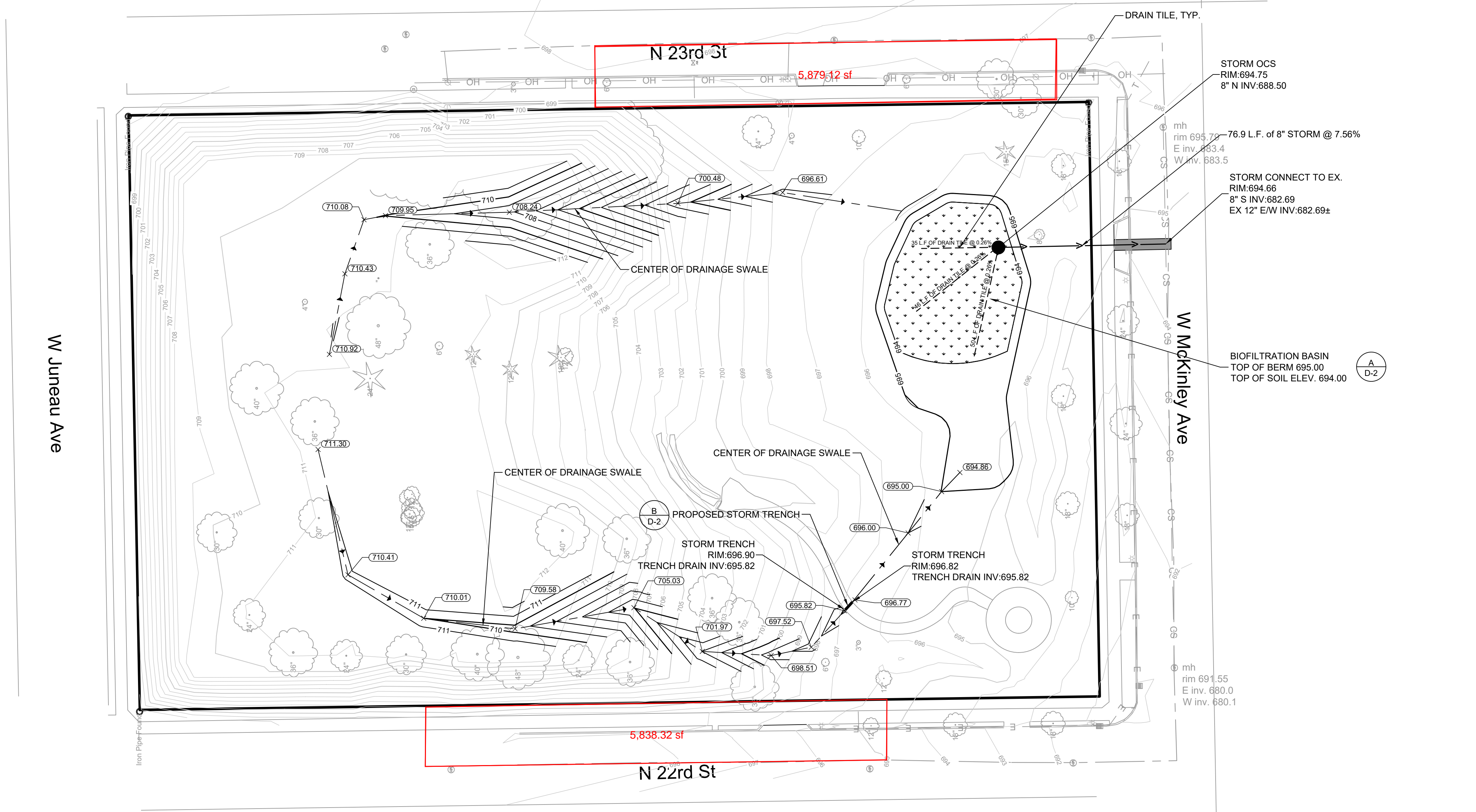
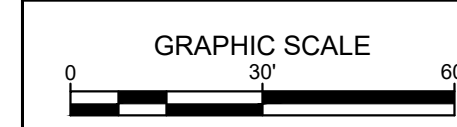
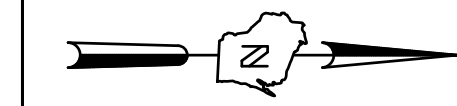

- LEGEND:**
- BIOFILTRATION ENGINEERED SOIL
 - PROPOSED STORM SEWER
 - PROPOSED DRAIN TILE
 - CENTER LINE OF SWALE WITH DRAINAGE ARROW DIRECTION
 - EXISTING CONTOUR
 - PROPOSED CONTOUR
 - PROPOSED CURB & GUTTER SPOT GRADE
T/C: TOP OF CURB GRADE
FL: FLOW LINE CURB GRADE
 - PROPOSED ASPHALT SPOT GRADE
 - EXISTING SURFACE SPOT GRADE (MATCH)

- GENERAL NOTES:**
1. THE UNDERGROUND UTILITY INFORMATION SHOWN ON THIS DRAWING IS BASED ON FIELD LOCATIONS AND/OR RECORDS FURNISHED BY MUNICIPALITIES AND UTILITY COMPANIES. THE LOCATION AND ACCURACY OF WHICH CANNOT BE GUARANTEED. THERE MAY BE ADDITIONAL UNDERGROUND UTILITY INSTALLATIONS WITHIN THE PROJECT AREA THAT ARE NOT SHOWN.
 2. VERIFY ACTUAL LOCATIONS AND INVERTS IN THE FIELD. ANY POTENTIAL ERRORS, OMISSIONS, OR DISCREPANCIES SHALL BE BROUGHT TO THE ATTENTION OF THE ENGINEER PRIOR TO PROCEEDING WITH CONSTRUCTION.
 3. WORK TO BE COMPLETED IS INDICATED IN BOLD TYPE LINES AND EXISTING CONDITIONS ARE INDICATED BY LIGHT TYPE LINES.
 4. ELECTRONIC CIVIL FILES ARE AVAILABLE UPON WRITTEN REQUEST. DO NOT USE ELECTRONIC CIVIL FILES TO LAYOUT FOUNDATIONS, COLUMN LINES, LIGHT POLES, OR OTHER NON CIVIL SITE WORK. REFER TO ARCHITECTURAL DRAWINGS FOR DIMENSIONS OF BUILDING AND ARCHITECTURAL FEATURES.
 5. DIMENSIONS ARE FROM FACE OF CURB OR EDGE OF PAVEMENT.
 6. WORK WITHIN THE PUBLIC RIGHT OF WAY, INCLUDING BUT NOT LIMITED TO DRIVEWAY OPENINGS, SIDEWALK AND RAMPS, PAVING, AND CURB AND GUTTER SHALL BE COMPLETED PER MUNICIPAL AND/OR COUNTY REQUIREMENTS AND STANDARDS.
 7. EARTHWORK SHALL BE IN ACCORDANCE WITH GEOTECHNICAL ENGINEER'S RECOMMENDATIONS.
 8. ALL UTILITIES WITHIN 5 FEET OF PAVED AREAS SHALL REQUIRE GRANULAR BACKFILL. SLURRY BACKFILL IS REQUIRED FOR ALL WORK IN PUBLIC RIGHT OF WAY.
 9. PRIVATE STORM INLETS IN PAVEMENT SHALL REQUIRE DRAIN TILE STUBS OF 10 FEET IN TWO DIRECTIONS FOR SUBDRAINAGE. RIM GRADE FOR STORM INLETS IN CURB AND GUTTER ARE FLOW LINE GRADES.
 10. PRIVATE STORM SEWER 12-INCH DIAMETER OR LARGER SHALL BE HDPE. BELOW 12-INCH DIAMETER SHALL BE PVC SDR-35 ASTM D3034. PRIVATE WATER MAIN SHALL BE CLASS 235 DR 18 PVC CONFORMING TO AWWA C-900. PRIVATE SANITARY SEWER SHALL BE PVC SDR-35 ASTM D3034.



CALL DIGGERS HOTLINE
1-800-242-8511
TOLL FREE

WE STRONGLY RECOMMEND THAT YOU REQUIRE MIN. 3 WORK DAYS NOTICE BEFORE YOU EXCAVATE
MILW. AREA 259-1181

THE UNDERGROUND UTILITY INFORMATION SHOWN ON THIS MAP IS BASED ON FIELD MARKINGS AND INFORMATION FURNISHED BY UTILITY COMPANIES AND THE LOCAL MUNICIPALITY. WHILE THIS INFORMATION IS BELIEVED TO BE RELIABLE, ITS ACCURACY AND COMPLETENESS CANNOT BE GUARANTEED.

REUSE OF DOCUMENTS
THIS DOCUMENT AND THE IDEAS AND DESIGNS INCORPORATED HEREIN IS AN INSTRUMENT OF PROFESSIONAL SERVICE AND IS NOT TO BE USED, IN WHOLE OR IN PART, FOR ANY OTHER PROJECT WITHOUT THE WRITTEN AUTHORIZATION OF THE MILWAUKEE METROPOLITAN SEWERAGE DISTRICT.

HORIZONTAL DATUM
NAD27 WISCONSIN STATE PLANE SOUTH ZONE COORDINATE SYSTEM
VERTICAL DATUM
NAVD 88(2011) NORTH AMERICAN VERTICAL DATUM OF 1988

DSGN JRG
DR JRG
CHK
APVD

This Design Prepared For FCPP By:
SIGMA GROUP
Single Source. Sound Solutions.
www.thismagroup.com
1300 West Canal Street
Milwaukee, WI 53233
Phone: 414-643-4200
Fax: 414-643-4210

REV. NO.	DATE	REVISION DESCRIPTION	BY	APVD



MILWAUKEE METROPOLITAN SEWERAGE DISTRICT
FRESH COAST PROTECTION PARTNERSHIP
LYNDEN HILLS BIOFILTRATION BASIN
1255 N 22ND ST
MILWAUKEE, WI 53205

DRAWING NO.: 4
SHEET: GRADING AND UTILITY PLAN
DATE: ---
PROJECT: 20039
FILE: 4 GRADING PLAN.DWG