



**UIHLEIN
WILSON**
ARCHITECTS

322 East Michigan Street
Milwaukee, WI 53202

telephone | 414.271.8899
facsimile | 414.271.8942
office@uihleין-wilson.com
www.uihlein-wilson.com

LETTER OF TRANSMITTAL

To: Tim Askin, Senior Planner
Historic Preservation Commission
City Clerk's Office
200 E. Wells St. Room B-4
Milwaukee, WI 53202

Date: October 19, 2017

Project: Milwaukee County Historical Center
Exterior Renovation and Exterior Grate Restoration

UWA PN: 16-118

Milwaukee County PN: O118-13449 / O247-16440

From: Debra R. Zins, AIA LEED^{AP}, CDT
Project Architect

We are sending you: Enclosed Under separate cover

Via: Mail Express courier Delivery service
 Hand Hold for pick-up email

Qty	Date	Item
E	10/19/17	COA application package: Milwaukee County Historical Society (MCHS) modified limestone dutchman repair

For your use For review and comment Reviewed as noted
 For approval For your information Per your request

Copies to:
Project File



CERTIFICATE OF APPROPRIATENESS APPLICATION FORM

Incomplete applications will not be processed for Commission review.
Please print legibly.

1. HISTORIC NAME OF PROPERTY OR HISTORIC DISTRICT: (if known)

Milwaukee County Historical Center

ADDRESS OF PROPERTY:

910 North Old World Third Street

2. NAME AND ADDRESS OF OWNER:

Name(s): Milwaukee County Historical Society

Address: 910 North Old World Third Street

City: Milwaukee

State: WI

ZIP: 53203

Email: _____

Telephone number (area code & number) Daytime: _____

Evening: _____

3. APPLICANT, AGENT OR CONTRACTOR: (if different from owner)

Name(s): Uihlein/Wilson Architects, Inc.

Address: 322 East Michigan St. Suite 400

City: Milwaukee

State: WI

ZIP Code: 53202

Email: debraz@uihleין-wilson.com

Telephone number (area code & number) Daytime: 414.271.8899

Evening: --

4. ATTACHMENTS: (Because projects can vary in size and scope, please call the HPC Office at 414-286-5712 for submittal requirements)

A. REQUIRED FOR MAJOR PROJECTS:

Photographs of affected areas (annotated photos recommended)

Section detail, not to scale.
A digital copy of the photos is also requested.

Material and Design Specifications

B. NEW CONSTRUCTION ALSO REQUIRES:

Floor Plans (1 full size and 1 reduced to a maximum of 11" x 17")

Site Plan showing location of project and adjoining structures and fences

**PLEASE NOTE: YOUR APPLICATION CANNOT BE PROCESSED UNLESS
BOTH PAGES OF THIS FORM ARE PROPERLY COMPLETED
AND SIGNED.**

5. DESCRIPTION OF PROJECT:

Tell us what you want to do. Describe all proposed work including materials, design, and dimensions. Additional pages may be attached.

MODIFICATION IN DIMENSIONS OF THE LIMESTONE DUTCHMAN REPAIR AT CORNICE GUTTER EDGING.

The limestone dutchman repair is being re-proposed as a more limited removal of only the severely-damaged limestone. This allows the original egg-and-dart and corduroy stone facing to be retained, as shown in the accompanying photographs.

As had been presented last January, decades ago this edging was severely damaged by the power-actuated fastening of the cornice gutter metal lining to the limestone. Subsequently, a cementitious fibrous material was applied over the damaged area. It was later painted to blend in with the surrounding area.

Presently, the original stone profile for the replacement dutchman has been field measured. In this field verification, the stone fabricator has judged that the condition of the egg-and-dart and corduroy stone facing is in good condition for the length of the west facade. Given that the west facade has the most intensive exposure to the elements, this modified dutchman repair will be made to the entire building perimeter; approximately 487 ft. and about 38 ft. above grade level.

METHOD.
 A single, horizontal sawcut will be made to remove the damaged cornice edging, as proposed. A new mortar joint is introduced.
 The width of the joint is dependent upon the sawcut, however it is to be anticipated to be between 1/4-inch and 3/8-inch.
 The type of mortar and color will be the same as the mortar type and color adopted at the balustrade above.
 This modification has been reviewed structurally and approved with the same level of fastening as previously engineered for the more extensive limestone dutchman repair. (All fasteners in stainless steel.)

6. SIGNATURE OF APPLICANT:

Signature

Debra R. Zins, AIA, LEED AP, CDT
Please print or type name

10/19/2017
Date

This form and all supporting documentation **MUST** arrive by 12:00 noon on the deadline date established to be considered at the next Historic Preservation Commission Meeting. Any information not provided to staff in advance of the meeting will not be considered by the Commission during their deliberation. Please call if you have any questions and staff will assist you.

Hand Deliver or Mail Form to:
 Historic Preservation Commission
 City Clerk's Office
 200 E. Wells St. Room B-4
 Milwaukee, WI 53202

PHONE: (414) 286-5722

FAX: (414) 286-3004

www.milwaukee.gov/hpc

Or click the SUBMIT button to automatically email this form for submission.

SUBMIT

ORIGINALLY PLANNED LIMESTONE DUTCHMAN EDGE

STONE DUTCHMAN EDGE

1 1/2" x 20ga STAINLESS
STEEL STRAP AT 1/4 POINTS
w/ (4) 1/4"dia STAINLESS
STEEL ELCO AGGREGATOR
CONCRETE ANCHOR w/ 1 1/2"
MIN EMBED, (2) EACH SIDE.
SINK STRAP FLUSH WITH
TOP OF STONE AS
REQUIRED TO INSTALL NEW
GUTTER FLASHING

DUTCHMAN
REPAIR

1/2"dia x 6" STAINLESS
STEEL THREADED ROD
CENTERED ON JOINT.
MORTAR-SET IN PRE-
DRILLED HOLES

EXISTING STONE CORNICE

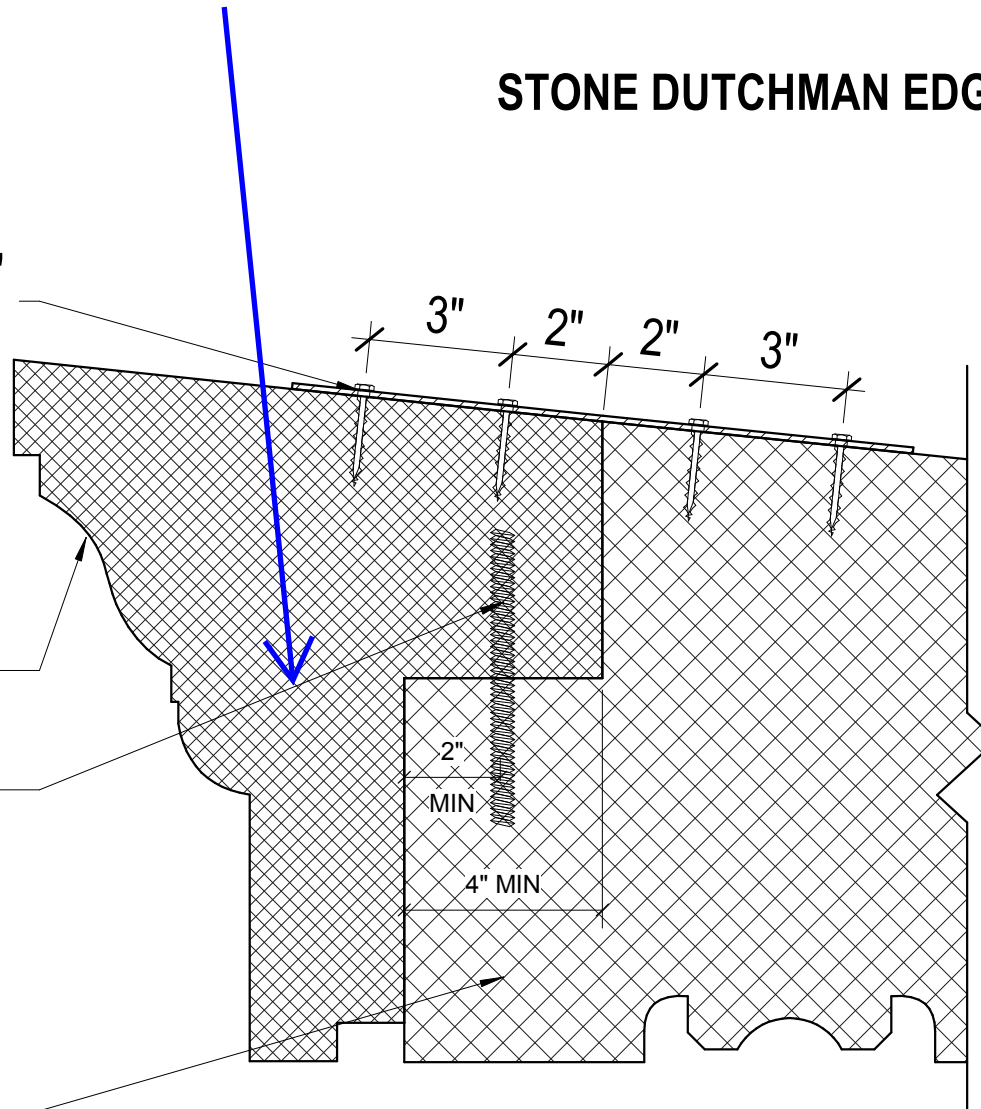

REVISED LIMESTONE DUTCHMAN EDGE

1 1/2" x 20ga STAINLESS
STEEL STRAP AT 1/4 POINTS
w/ (4) 1/4"dia STAINLESS
STEEL ELCO AGGREGATOR
CONCRETE ANCHOR w/ 1 1/2"
MIN EMBED, (2) EACH SIDE.
SINK STRAP FLUSH WITH
TOP OF STONE AS
REQUIRED TO INSTALL NEW
GUTTER FLASHING
NEW DUTCHMAN
REPAIR

1/2"dia x 6" STAINLESS
STEEL THREADED ROD
CENTERED ON JOINT.
MORTAR-SET IN PRE-
DRILLED HOLES

EXISTING STONE CORNICE
HIGHLIGHTED IN RED

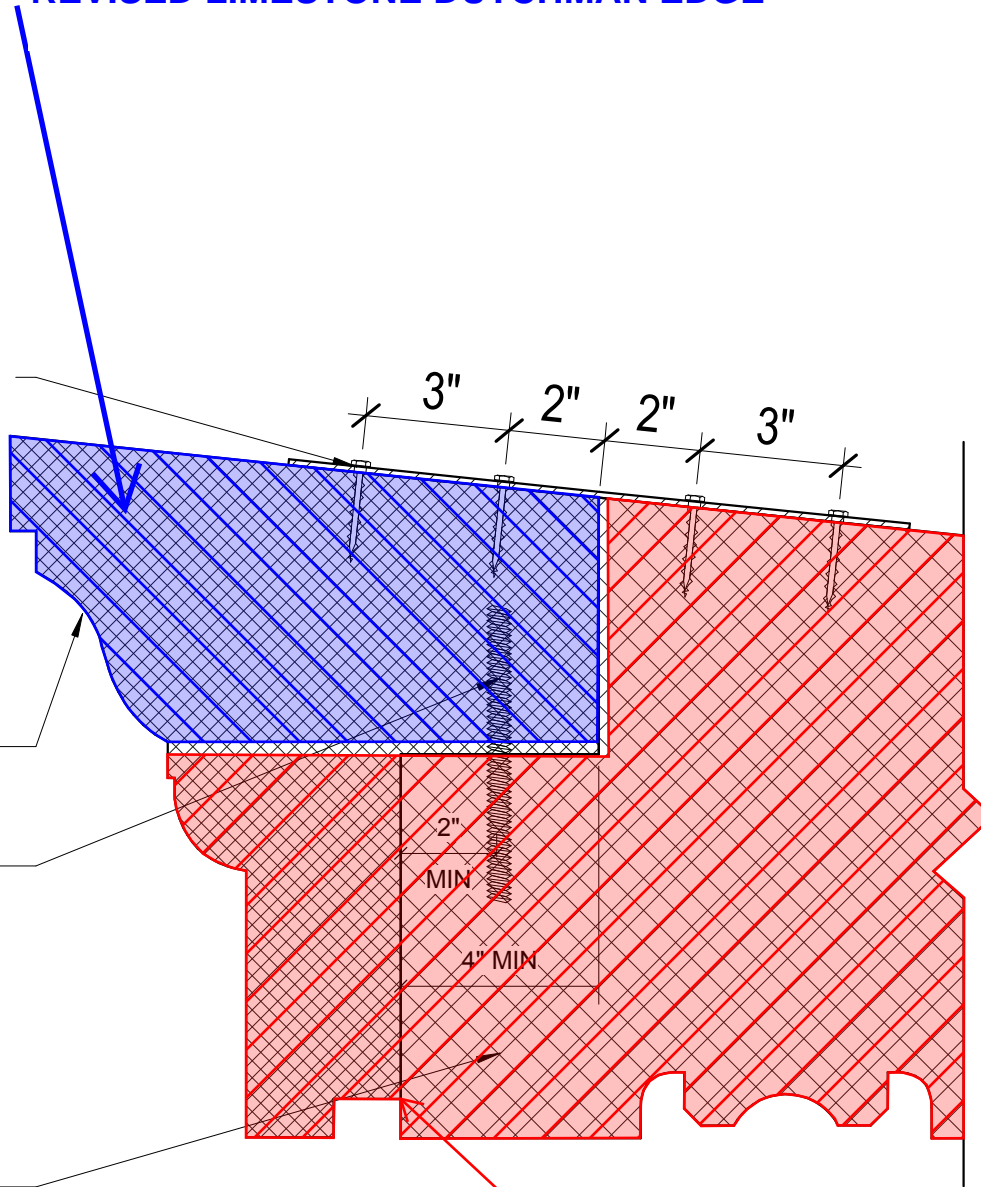

Disregard black line.
(Detail taken from original
Detail in drawings.)

④ CORNICE EDGE DUTCHMAN CONNECTOR SECTION
3" = 1'-0"



REVISED DUTCHMAN:
DAMAGED CORNICE GUTTER EDGE
TO BE REMOVED AND REPLACED
WITH LIMESTONE DUTCHMAN.

MODIFIED WIDTH TO BE
REMOVED

REVISED DUTCHMAN EDGE PERMITS THE
ORIGINAL FEATURES, EGG & DART
AND CORDUROY FINISHED STONE FACING,
TO BE RETAINED.

REMOVE DAMAGED
STONE EDGING

ORIGINAL STONE
CARVING TO REMAIN

NEW MORTAR JOINT
BETWEEN DUTCHMAN AND
EXISTING STONE.
SAWCUT WILL INFLUENCE
JOINT WIDTH (1/4" - 3/8")

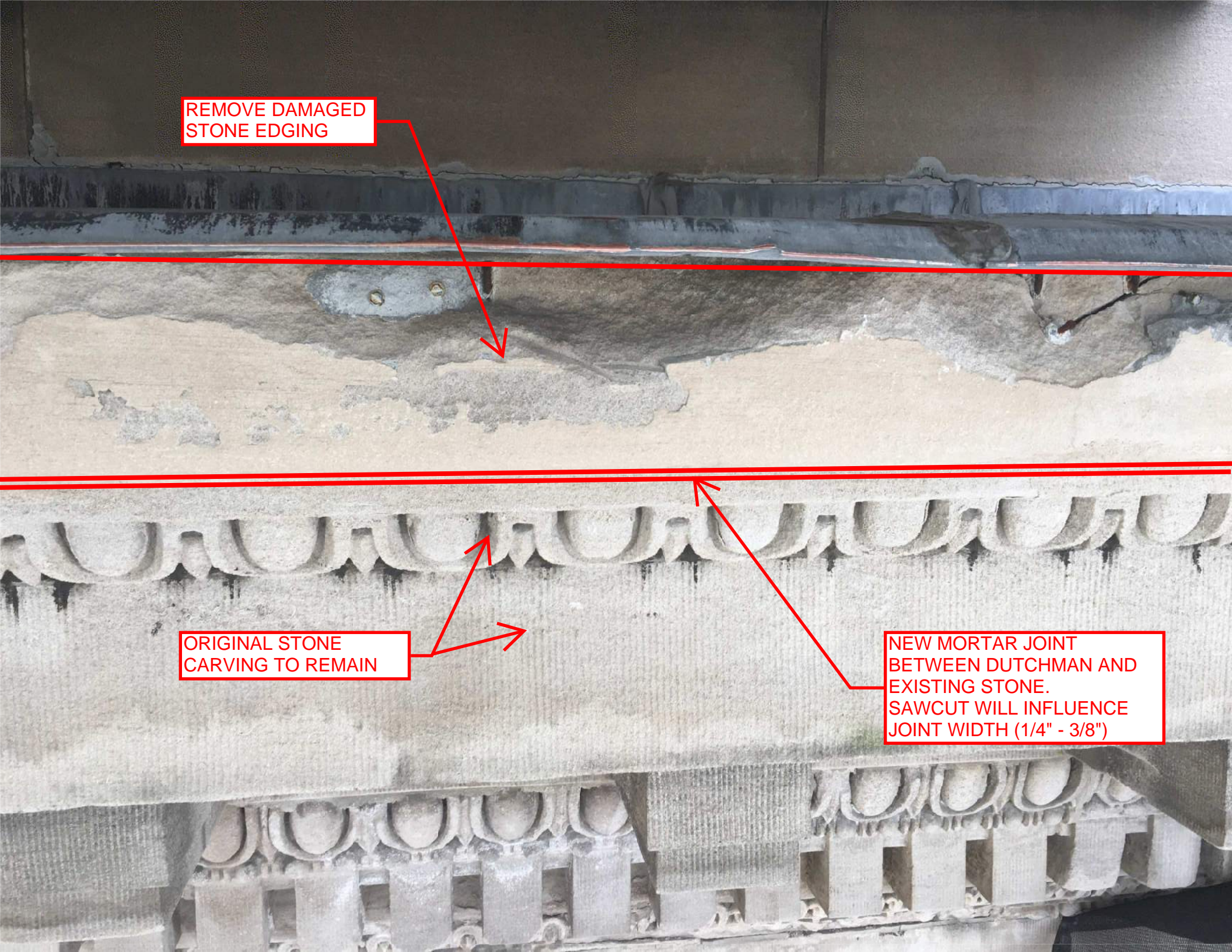

REMOVE PREVIOUSLY DAMAGED CORNICE EDGING.

