

CERTIFIED SURVEY MAP NO.

A DIVISION OF PART OF LOT 1 IN CERTIFIED SURVEY MAP NO. 7861 IN THE SOUTHEAST 1/4 OF THE SOUTHWEST 1/4 OF SECTION 20, TOWN 7 NORTH, RANGE 22 EAST, IN THE CITY OF MILWAUKEE, MILWAUKEE COUNTY, WISCONSIN

TAX KEY: 362-0431-000
ZONING: C9G

INTERIOR ANGLES

| | |
|---|--------------|
| A | 89°51'15" |
| B | 163°05'39.5" |
| C | 163°05'39.5" |
| D | 90°00'00" |
| E | 90°00'00" |
| F | 163°16'01" |
| G | 185°13'07" |
| H | 135°28'18" |

LEGEND

- CONCRETE MONUMENT WITH BRASS CAP
- FOUND 1" IRON PIPE
- SET 1.315" OUTSIDE DIA. IRON PIPE, 18" LONG, WEIGHING 1.68 LBS. PER LINEAL FOOT
- + CROSS CHISELED IN CONCRETE, FOUND EXCEPT AS NOTED

BEARINGS ARE REFERENCED TO GRID NORTH OF THE WISCONSIN COORDINATE SYSTEM, SOUTH ZONE (NAD27). THE SOUTH LINE OF THE SW 1/4 OF SECTION 20 HAS A BEARING OF N 88°57'51" E (DECEMBER, 2005 DATUM).

SEE SHEET 2 FOR EASEMENTS

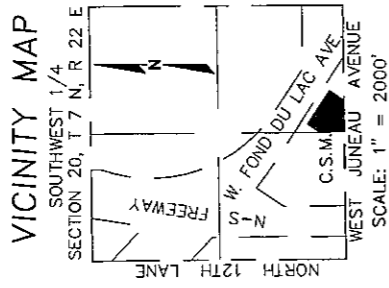

R.A. Smith National, Inc.

Beyond Surveying
and Engineering

16745 W. Bluemound Road, Brookfield WI 53005
262-781-1000 Fax 262-797-7373
www.rasmithnational.com

S:\5163318\dwg\CSR80\1\1.H.DWG\Model

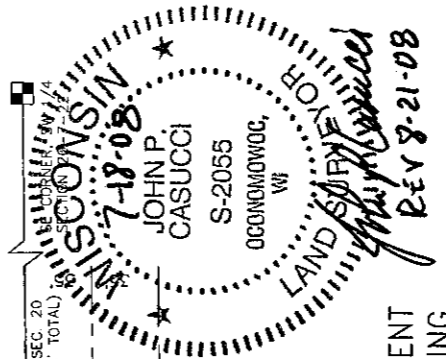
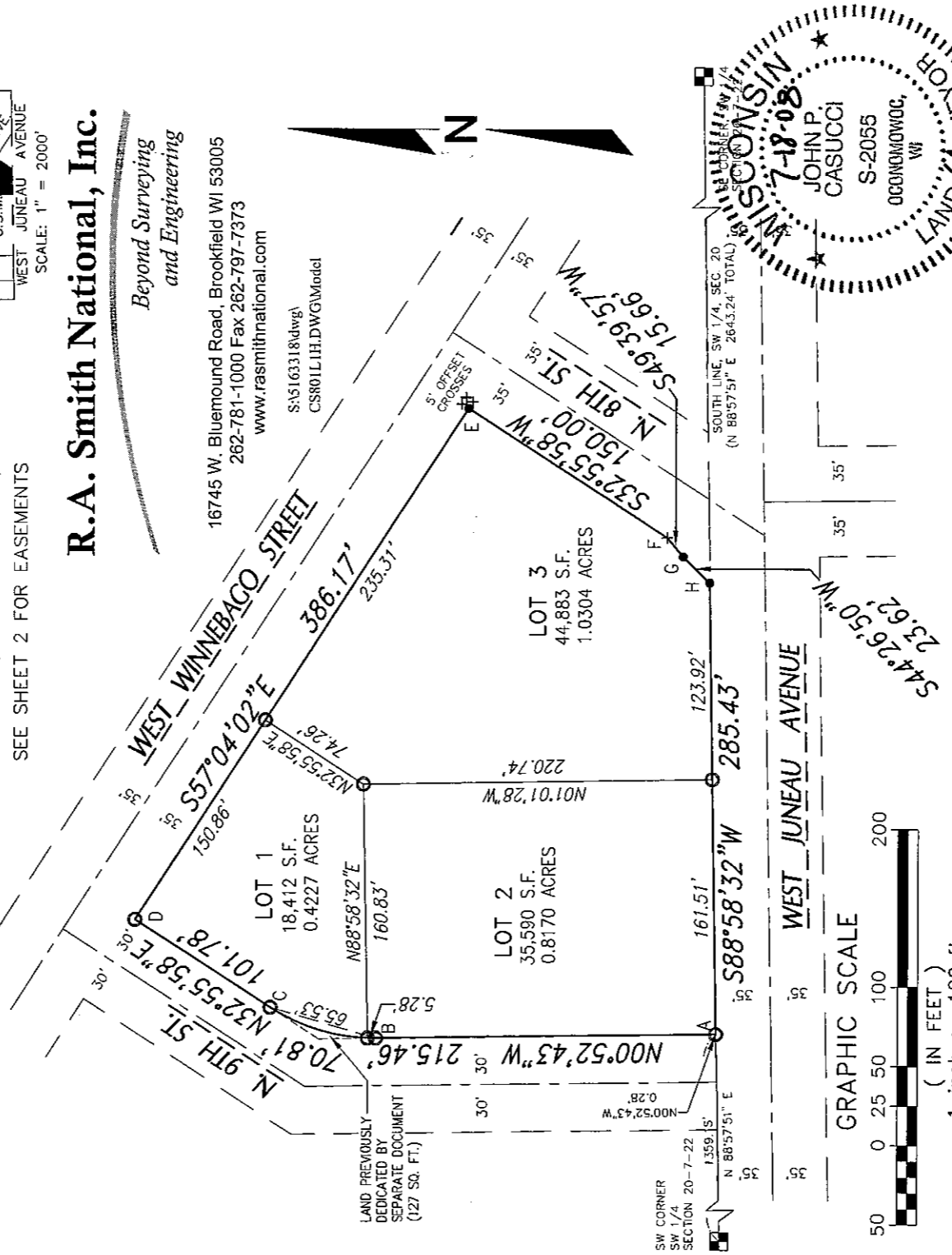

| LOT | ARC RADIUS | BEARING | CHORD | DELTA | DELTA/2 | TANGENT | TANGENT BEARING |
|-------|------------|---------|---------------|--------|-----------|-------------|-------------------------|
| TOTAL | 70.81' | 120.00' | N16°01'37.5"E | 69.79' | 33°48'41" | 16°54'20.5" | N00°52'43"W N32°55'58"E |
| 2 | 5.28' | 120.00' | N00°22'58"E | 5.28' | 2°31'22" | 1°15'41" | N00°52'43"W N01°38'39"E |
| 1 | 65.53' | 120.00' | N17°17'18.5"E | 64.72' | 31°17'19" | 15°38'39.5" | N01°38'39"E N32°55'58"E |

SHEET 1 OF 5 SHEETS

INFRASTRUCTURE SERVICES DIVISION

Mauro Lindholm 9/8/08
CENTRAL DRAFTING & RECORDS-MANAGER

M. Martin
ENGR. IN CHARGE ENVIRON. ENGR. 7/8/08

Jeffrey Plancher 9/9/08
CORRECT CITY ENGINEER

[Signature]
APPROVED

CERTIFIED SURVEY MAP NO. _____

A DIVISION OF PART OF LOT 1 IN CERTIFIED SURVEY MAP NO. 7861 IN THE SOUTHEAST 1/4 OF THE SOUTHWEST 1/4 OF SECTION 20, TOWN 7 NORTH, RANGE 22 EAST, IN THE CITY OF MILWAUKEE, MILWAUKEE COUNTY, WISCONSIN

R.A. Smith National, Inc.

*Beyond Surveying
and Engineering*

16745 W. Bluemound Road, Brookfield WI 53005
262-781-1000 Fax 262-797-7373
www.ra-smithnational.com

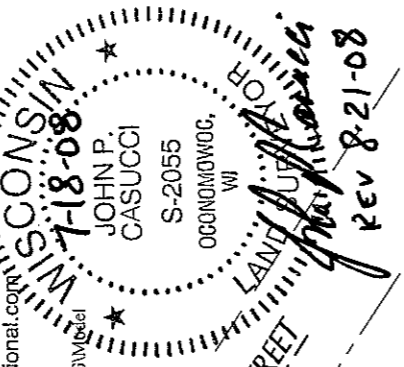

S:\S163318\dwg\1
CS8802L1.H.DWG\Map1.dwg

WEST WINNEBAGO STREET

LOT 1

N 9TH ST.

LOT 2

LOT 3

EASEMENT TO WISCONSIN
ELECTRIC POWER COMPANY
AND WISCONSIN TELEPHONE
COMPANY - DOC. NO.
3875202 (VAGUE DESC)

CITY UTILITY EASEMENT S.E.-2133
OCC. NO.'S 3810696 & 4001251

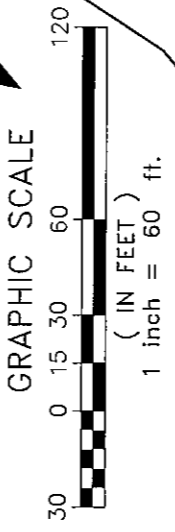

70.00'
134.95'
N32°55'58"E
(157.50')

N57°04'02"W
(17.73')
8.72'
21.45'
1.08'
3.05'
N32°55'58"E
(7.50')4.45'

217.05'

58.0'

WEST JUNEAU AVENUE

CERTIFIED SURVEY MAP NO. _____

A DIVISION OF PART OF LOT 1 IN CERTIFIED SURVEY MAP NO. 7861 IN THE SOUTHEAST 1/4 OF THE SOUTHWEST 1/4 OF SECTION 20, TOWN 7 NORTH, RANGE 22 EAST, IN THE CITY OF MILWAUKEE, MILWAUKEE COUNTY, WISCONSIN

SURVEYOR'S CERTIFICATE

STATE OF WISCONSIN }
 :SS
 WAUKESHA COUNTY }

I, JOHN P. CASUCCI, Registered Land Surveyor, do hereby certify:

THAT I have surveyed, divided and mapped a division of part of Lot 1 in Certified Survey Map No. 7861 in the Southeast 1/4 of the Southwest 1/4 of Section 20, Town 7 North, Range 22 East, in the City of Milwaukee, Milwaukee County, Wisconsin

Said lands are bounded and described as follows:

COMMENCING at the Southwest corner of the Southwest 1/4 of said Section 20; thence North 88°57'51" East along the south line of said Southwest 1/4 Section 1359.15 feet to a point; thence North 00°52'43" West 0.28 feet to the Southwest corner of Lot 1 in Certified Survey Map No. 7861 and the point of beginning of the lands to be described; thence North 00°52'43" West along the east line of North 9th Street 215.46 feet to a point; thence Northeasterly 70.81 feet along the arc of a curve whose center lies to the east, whose radius is 120.00 feet and whose chord bears North 16°01'37.5" East 69.79 feet to a point; thence North 32°55'58" East along the east line of North 9th Street 101.78 feet to a point on the southwest line of West Winnebago Street; thence South 57°04'02" East 386.17 feet along said southwest line to the west line of North 8th Street; thence South 32°55'58" West 150.00 feet along said west line to a point; thence South 44°26'50" West 23.62 feet along said west line to the north line of West Juneau Avenue; thence South 88°58'32" West 285.43 feet along said north line to the point of beginning. Containing 98,885 square feet or 2.2701 acres.

THAT I have made the survey, land division and map by the direction of BREWERY PROJECT LLC, owners of said lands.

THAT the map is a correct representation of all the exterior boundaries of the land surveyed and the land division thereof made.

THAT I have fully complied with Chapter 236 of the Wisconsin Statutes and Chapter 219 of the Milwaukee Municipal Code in surveying, dividing and mapping the same.

July 18, 2008
 DATED Rev 8-21-08

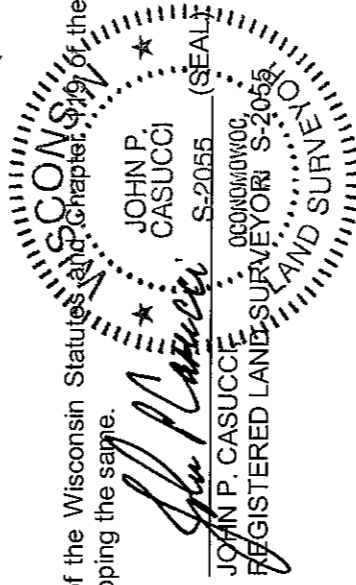

CERTIFIED SURVEY MAP NO. _____

A DIVISION OF PART OF LOT 1 IN CERTIFIED SURVEY MAP NO. 7861 IN THE SOUTHEAST 1/4 OF THE SOUTHWEST 1/4 OF SECTION 20, TOWN 7 NORTH, RANGE 22 EAST, IN THE CITY OF MILWAUKEE, MILWAUKEE COUNTY, WISCONSIN

OWNER'S CERTIFICATE

BREWERY PROJECT, LLC, a Wisconsin limited liability company, as owner, certifies that said company caused the land described on this map to be surveyed, divided, mapped and dedicated as represented on this map in accordance with the requirements of Chapter 119 of the Milwaukee Code of Ordinances.

IN consideration of the approval of the map by the Common Council of the City of Milwaukee and in accordance with Chapter 119 of the Milwaukee Code, the undersigned agrees:

- A. That all utility lines to provide electric power and telephone service and cable television or communications systems lines or cables to all lots in the Certified Survey Map shall be installed underground in easements provided therefore, where feasible.

THIS agreement shall be binding on the undersigned and assigns.

IN Witness Whereof BREWERY PROJECT, LLC, has caused these presents to be signed by JOHN W. KERSEY, its PRESIDENT this 2nd day of September, 2008.

BREWERY PROJECT, LLC

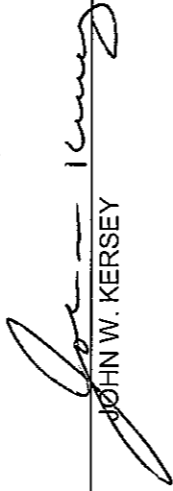

 JOHN W. KERSEY

STATE OF WISCONSIN }
 } :SS
 MILWAUKEE COUNTY }

PERSONALLY came before me this 2nd day of September, 2008, JOHN W. KERSEY, of BREWERY PROJECT, LLC, to me known as the person who executed the foregoing instrument, and to me known to be the PRESIDENT of said limited liability company and acknowledged that he executed the foregoing instrument as such officer as the deed of the Trust, by its authority.

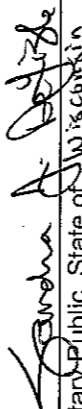

 Notary Public, State of Wisconsin
 My commission expires is permanent.

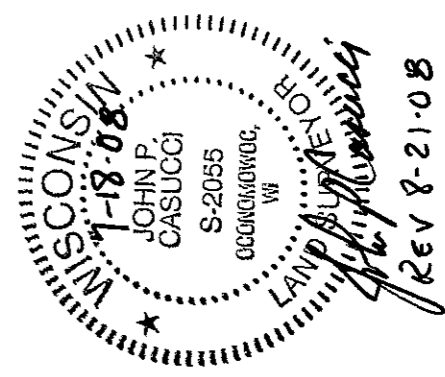
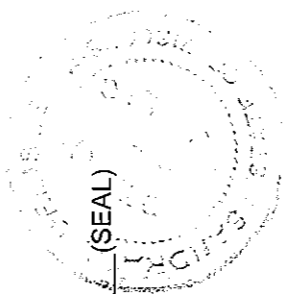



CERTIFIED SURVEY MAP NO. _____

A DIVISION OF PART OF LOT 1 IN CERTIFIED SURVEY MAP NO. 7861 IN THE SOUTHEAST 1/4 OF THE SOUTHWEST 1/4 OF SECTION 20, TOWN 7 NORTH, RANGE 22 EAST, IN THE CITY OF MILWAUKEE, MILWAUKEE COUNTY, WISCONSIN

COMMON COUNCIL CERTIFICATE OF APPROVAL

I certify that this Certified Survey Map was approved under Resolution File No. 080680 adopted by the Common Council of the City of Milwaukee on September 16, 2008.



RONALD D. LEONHARDT, CITY CLERK

TOM BARRETT, MAYOR

CERTIFICATE OF CITY TREASURER

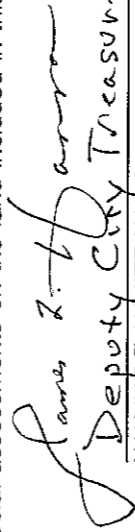
STATE OF WISCONSIN }
MILWAUKEE COUNTY }

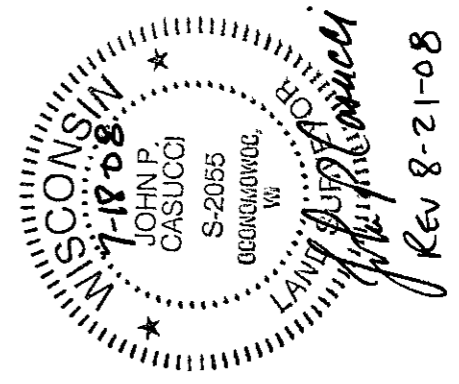
I, WAYNE F. WHITTOW, being the duly elected, qualified and acting City Treasurer of the City of Milwaukee, certify that in accordance with the records in the office of the City Treasurer of the City of Milwaukee there are no unpaid taxes or unpaid special assessments on the land included in this Certified Survey Map.

DATE 9/9/08

Deputy City Treasurer for
WAYNE F. WHITTOW, CITY TREASURER



THIS INSTRUMENT WAS DRAFTED BY JOHN P. CASUCCI,
REGISTERED LAND SURVEYOR S-2055