



CITY OF MILWAUKEE
OFFICE OF THE CITY CLERK

Monday, April 13, 2026

COMMITTEE MEETING NOTICE

AD 12

MIGUEL CUMPLIDO, Luis, Agent
EL MANANERO LLC
2700 S 48TH ST
MILWAUKEE, WI 53219

You are requested to attend a hearing which is to be held in Room 301-B, Third Floor, City Hall or you may attend virtually using the link below.

Tuesday, April 28, 2026 at 09:55 AM

The access code is <https://meet.goto.com/979258013>. Please see the enclosed best practices document for further instructions.

Regarding: Your Food Dealer and Food Peddler Licenses Application as agent for "EL MANANERO LLC" for "EL MANANERO" at 1601 W LINCOLN Av. 

There is a possibility that your application may be denied for one or more of the following reasons: The recommendation of the committee regarding the application shall be based on evidence presented at the hearing. Per MCO 85-2.7-4, probative evidence concerning whether or not a new license should be granted may be presented on the following subjects: whether or not the applicant meets the municipal requirements, the appropriateness of the location and premises where the licensed premises is to be located and whether use of the premises for the purposes or activities permitted by the license would tend to facilitate a public or private nuisance or create undesirable neighborhood problems such as disorderly patrons, unreasonably loud noise, litter, and excessive traffic and parking congestion. Probative evidence relating to these matters may be taken from the plan of operation submitted with the license application, if any, but shall not include the content of any music. Evidence regarding the fitness of the location of the premises to be maintained as the principal place of business, including but not limited to whether there is an overconcentration of businesses of the type for which the license is sought; whether the proposal is consistent with any pertinent neighborhood business or development plans, or the location's proximity to areas where children are typically present. The applicant's record in operating similarly licensed premises; and whether or not the applicant has been charged with or convicted of any felony, misdemeanor, municipal offense or other offense, the circumstances of which substantially relate to the activity to be permitted by the license being applied for or any other factor which reasonably relates to the public health, safety or welfare may also be considered. See attached police report or correspondence.

Notice for applicants with warrants or unpaid fines:

Proof of warrant satisfaction or payment of fines must be submitted at the hearing on the above date and time. Failure to comply with this requirement may result in a delay of the granting/denial of your application.

Failure to appear at this meeting may result in the denial of your license. Individual applicants must appear only in person or by an attorney. Corporate or Limited Liability applicants must appear only by the agent designated on the application or by an attorney. Partnership applicants must appear by a partner listed on the application or by an attorney. If you wish to do so and at your own expense, you may be accompanied by an attorney of your choosing to represent you at this hearing.

You will be given an opportunity to speak on behalf of the application and to respond and challenge any charges or reasons given for the denial. No petitions can be accepted by the committee, unless the people who signed the petition are present at the committee hearing and willing to testify. You may present witnesses under oath and you may also confront and cross-examine opposing witnesses under oath. If you have difficulty with the English language, you should bring an interpreter with you, at your expense, so that you can answer questions and participate in your hearing.

You may examine the application file at this office during regular business hours prior to the hearing date. Inquiries regarding this matter may be directed to the person whose signature appears below.

Limited parking for persons attending meetings during normal business hours is available at reduced rates (5 hour limit) at the Milwaukee Center on the southwest corner of Kilbourn Avenue and Water Street. You must present a copy of the meeting notice to the parking cashier.

PLEASE NOTE: Upon reasonable notice, efforts will be made to accommodate the needs of disabled individuals through sign language interpreters or other auxiliary aids. For additional information or to request this service, contact the Council Services Division ADA Coordinator at (414) 286-2998, Fax - (414) 286-3456, TDD - (414) 286-2025.

JIM OWCZARSKI, CITY CLERK

BY: _____

Jim Cooney
License Division Manager

If you have questions regarding this notice, please contact the License Division at (414) 286-2238.

200 E. Wells Street, Room 105, City Hall, Milwaukee, WI 53202. www.milwaukee.gov/license
Phone: (414) 286-2238 Fax: (414) 286-3057 Email Address: License@milwaukee.gov



WISCONSIN DEPARTMENT OF CORRECTIONS

Governor Tony Evers / Secretary

Division of Community Corrections / Region 3 Office

Date: 03/26/26
To: Milwaukee Common Council/Licensing Division
From: Agent Alejandro Gonzalez

It was brought to my attention that a client under our supervision, Luis Miguel Cumplido, has applied for a Food/PED Dealer's license from the City of Milwaukee. Client Luis Miguel Cumplido is currently on an Extended Supervision term that is scheduled to discharge on 06/07/27 for the offense of OWI (5th or 6th).

This letter is to inform you that such a licensure would not be in violation of their rules/conditions of supervision. If circumstances change, we will take measures appropriately, including action that may affect such licensure. We made this decision based in part, on the following information:

A - Residence Stability: Client has maintained residence stability Yes.

B - Reporting History: Client has maintained required contacts with agent Yes.

C - Police Contact: Client has had police contact while on supervision No.

D - Overall level of cooperation: has client complied with referrals and services designed to address criminogenic needs Yes.

**** DCC recommends license not be granted due the following: (check one)

- * License/employment has a direct nexus to committing offense.
- * License/employment would have a negative impact on the client based on specific treatment needs.
(HIPPA prohibits the disclosure of specific treatment needs)
- * Sex offenses.

In providing the information within this letter, the Department of Corrections assumes no liability for the Council's reliance on such information.

Sincerely,

P&P Agent

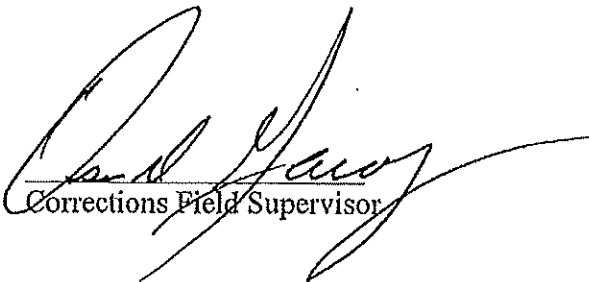
Corrections Field Supervisor

MILWAUKEE POLICE DEPARTMENT

LICENSING

CRIMINAL RECORD/ORDINANCE VIOLATION/INCIDENTS SYNOPSIS

DATE: 02/26/26

LICENSE TYPE: FOOD PED

NEW:

RENEWAL:

No. 390379 390380

Application Date:

License Location: 1601 W. Lincoln Ave.

Business Name: El Mananero

Licensee/Applicant: Cristobal Gutierrez, Mario
(Last Name, First Name, MI)

Date of Birth: 04/25/1991

Home Address: 2700 S. 48th St.

City: Milwaukee

State: WI **Zip Code:** 53219

Home Phone:

This report is written by Police Officer Carlos Felix, assigned to the License Investigation Unit, Days.

The Milwaukee Police Department's investigation regarding this application revealed the following:

The following items pertain to 1601W. Lincoln Ave., and the licensee.

1. On 01/31/17, the 33% Stockholder (Miguel Cumplido, Luis) was charged in Milwaukee County Court and found Guilty of OWI 1st. Sentence Forfeiture. Case C972873-6.
2. On 04/24/17, the 33% Stockholder (Miguel Cumplido, Luis) was charged in Milwaukee County Court and found Guilty of OWI 2nd. Sentence with a Forfeiture, Ignition Interlock 1-year, 10-Days at the House of Correction, and Driver's License Revoked for 1-year. Case 2020CT000374.
3. On 09/04/19, the 33% Stockholder (Miguel Cumplido, Luis) was charged in Milwaukee County Court and found Guilty of OWI 3rd. Sentence 90-Days at the House of Correction, Ignition Interlock 2-years, and Driver's License Revoked for 2-years. Case 2020CT000121.
4. On 03/14/23, the 33% Stockholder (Miguel Cumplido, Luis) was charged in Milwaukee County Court and found Guilty of OWI 4th. Sentence to 180-days at the House of Correction, Ignition Interlock 2-year, and Driver's License Revoked for 3-years. Case 2020CF001007.

5. On 05/05/23, the 33% Stockholder (Miguel Cumplido, Luis) was charged in Milwaukee County Court and found Guilty of OWI 5th. Sentence to 2-years in state prison and 3-years extended supervision. Case 2023CF001043.
6. On 02/27/26, an email was sent to the Department of Correction requesting the Probation or Parole status for the listed stockholder (Miguel Cumplido, Luis) be sent to the License Division with any objections to the license.



Monday, April 13, 2026



Notice of Public Hearing

Blank Notice

MIGUEL CUMPLIDO, Luis, Agent
EL Mananero at 1601 W LINCOLN Av
Food Dealer and Food Peddler Licenses Application

Tuesday, April 28, 2026 at 9:55 AM

To whom it may concern:

The above application has been made by the above named applicant(s). This requires approval from the Licenses Committee and the Common Council of the City of Milwaukee. The hearing before the Licenses Committee will take place on 4/28/2026 at 9:55 AM in Room 301-B, Third Floor, City Hall. This is a public hearing. Those wishing to view the proceeding are able to do so via the City Channel – Channel 25 on Spectrum Cable – or on the Internet at <http://city.milwaukee.gov/citychannel>. Those wishing to provide oral testimony via internet are asked to contact the staff assistant, Yadira Melendez at (414) 286-2775 or stasst5@milwaukee.gov for necessary information. Please make such requests no later than one business day prior to the start of the meeting. You are not required to attend the hearing, but please see the information below if you would like to provide testimony. Once the Licenses Committee makes its recommendation, this recommendation is forwarded to the full Common Council for approval at its next regularly scheduled hearing.

Important details for those wishing to provide information for the Licenses Committee to consider when making its recommendation:

1. The license application is scheduled to be heard at the above time. Due to other hearings running longer than scheduled, you may have to wait some time to provide your testimony.
2. You must appear in person and testify as to matters that you have personally experienced or seen. (You cannot provide testimony for your neighbor, parent or anyone else; this is considered hearsay and cannot be considered by the committee.)
3. No letters or petitions can be accepted by the committee (unless the person who wrote the letter or the persons who signed the petition are present at the committee hearing and willing to testify).
4. Persons opposed to the license application are given the opportunity to testify first; supporters may testify after the opponents have finished.
5. When you are called to testify, you will be sworn in and asked to give your name, and address. (If your first and/or last names are uncommon please spell them.)
6. You may then provide testimony.
 - a. Include only information relating to the above license application.
 - b. Include only information you have personally witnessed or seen.
 - c. Provide concise and relevant information detailing how this business has affected or may affect the peaceful enjoyment of your neighborhood.
 - d. If by the time you have the opportunity to testify, the information you wish to share has already been provided to the committee, you may state that you agree with the previous testimony. Redundant or repetitive testimony will not assist the committee in making its recommendation.
7. After giving your testimony, the members of the Licenses Committee and the licensee may ask questions regarding the testimony you have given or other factors relating to the license application.
8. Business Competition is not a valid basis for denial or non-renewal of a license.
Please Note: If you have submitted an objection to the above application your objection cannot be considered by the committee unless you personally testify at the hearing.

OCCUPANT	MAIL ADDRESS	CITY STATE ZIP
CURRENT OCCUPANT	1552 W LINCOLN AVE	MILWAUKEE, WI 53215-2664
CURRENT OCCUPANT	1552 W LINCOLN AVE# A	MILWAUKEE, WI 53215-2664
CURRENT OCCUPANT	1556A W LINCOLN AVE	MILWAUKEE, WI 53215-2664
CURRENT OCCUPANT	1559 W LINCOLN AVE	MILWAUKEE, WI 53215-2663
CURRENT OCCUPANT	1563 W LINCOLN AVE	MILWAUKEE, WI 53215-2663
CURRENT OCCUPANT	1563A W LINCOLN AVE	MILWAUKEE, WI 53215-2663
CURRENT OCCUPANT	1565A W LINCOLN AVE	MILWAUKEE, WI 53215-2663
CURRENT OCCUPANT	1567 W LINCOLN AVE	MILWAUKEE, WI 53215-2663
CURRENT OCCUPANT	1571A W LINCOLN AVE	MILWAUKEE, WI 53215-2663
CURRENT OCCUPANT	1571B W LINCOLN AVE	MILWAUKEE, WI 53215-2663
CURRENT OCCUPANT	1605 W LINCOLN AVE	MILWAUKEE, WI 53215-2637
CURRENT OCCUPANT	1605A W LINCOLN AVE	MILWAUKEE, WI 53215-2637
CURRENT OCCUPANT	1608 W LINCOLN AVE# 1	MILWAUKEE, WI 53215-2638
CURRENT OCCUPANT	1608 W LINCOLN AVE# 2	MILWAUKEE, WI 53215-2638
CURRENT OCCUPANT	1608 W LINCOLN AVE# 3	MILWAUKEE, WI 53215-2638
CURRENT OCCUPANT	1608 W LINCOLN AVE# 4	MILWAUKEE, WI 53215-2638
CURRENT OCCUPANT	1609 W LINCOLN AVE	MILWAUKEE, WI 53215-2637
CURRENT OCCUPANT	1609A W LINCOLN AVE	MILWAUKEE, WI 53215-2637
CURRENT OCCUPANT	1612A W LINCOLN AVE	MILWAUKEE, WI 53215-2638
CURRENT OCCUPANT	1617 W LINCOLN AVE	MILWAUKEE, WI 53215-2637
CURRENT OCCUPANT	1617A W LINCOLN AVE	MILWAUKEE, WI 53215-2637
CURRENT OCCUPANT	1618 W LINCOLN AVE	MILWAUKEE, WI 53215-2638
CURRENT OCCUPANT	1620 W LINCOLN AVE	MILWAUKEE, WI 53215-2638
CURRENT OCCUPANT	1620A W LINCOLN AVE	MILWAUKEE, WI 53215-2638
CURRENT OCCUPANT	1622 W LINCOLN AVE	MILWAUKEE, WI 53215-2638
CURRENT OCCUPANT	1624 W LINCOLN AVE	MILWAUKEE, WI 53215-2638
CURRENT OCCUPANT	1625 W LINCOLN AVE# 1	MILWAUKEE, WI 53215-2670
CURRENT OCCUPANT	1625 W LINCOLN AVE# 2	MILWAUKEE, WI 53215-2670
CURRENT OCCUPANT	1625 W LINCOLN AVE# 3	MILWAUKEE, WI 53215-2670
CURRENT OCCUPANT	1629A W LINCOLN AVE	MILWAUKEE, WI 53215-2637
CURRENT OCCUPANT	1631 W LINCOLN AVE	MILWAUKEE, WI 53215-2637
CURRENT OCCUPANT	2252 S 16TH ST	MILWAUKEE, WI 53215-2620
CURRENT OCCUPANT	2254 S 16TH ST	MILWAUKEE, WI 53215-2620
CURRENT OCCUPANT	2254 S 17TH ST	MILWAUKEE, WI 53215-2624
CURRENT OCCUPANT	2254 S 17TH ST# A	MILWAUKEE, WI 53215-2624
CURRENT OCCUPANT	2259 S 16TH ST	MILWAUKEE, WI 53215-2619
CURRENT OCCUPANT	2259A S 16TH ST	MILWAUKEE, WI 53215-2619
CURRENT OCCUPANT	2265 S 16TH ST# 1	MILWAUKEE, WI 53215-2619
CURRENT OCCUPANT	2265 S 16TH ST# 2	MILWAUKEE, WI 53215-2619
CURRENT OCCUPANT	2265 S 16TH ST# 3	MILWAUKEE, WI 53215-2619
CURRENT OCCUPANT	2265 S 16TH ST# 4	MILWAUKEE, WI 53215-2619
CURRENT OCCUPANT	2267 S 15TH PL	MILWAUKEE, WI 53215-2615
CURRENT OCCUPANT	2267A S 15TH PL	MILWAUKEE, WI 53215-2615
CURRENT OCCUPANT	2268 S 17TH ST	MILWAUKEE, WI 53215-2624
CURRENT OCCUPANT	2268 S 17TH ST# A	MILWAUKEE, WI 53215-2624
CURRENT OCCUPANT	2268 S 17TH ST# B	MILWAUKEE, WI 53215-2624

CURRENT OCCUPANT	2269 S 16TH ST	MILWAUKEE, WI 53215-2619
CURRENT OCCUPANT	2275 S 16TH ST	MILWAUKEE, WI 53215-2619
CURRENT OCCUPANT	2303 S 16TH ST# 1	MILWAUKEE, WI 53215-3061
CURRENT OCCUPANT	2303 S 16TH ST# 2	MILWAUKEE, WI 53215-3061
CURRENT OCCUPANT	2307 S 15TH PL	MILWAUKEE, WI 53215-3134
CURRENT OCCUPANT	2309 S 15TH PL	MILWAUKEE, WI 53215-3134
CURRENT OCCUPANT	2318 S 17TH ST	MILWAUKEE, WI 53215-3040
CURRENT OCCUPANT	2318A S 17TH ST	MILWAUKEE, WI 53215-3040
CURRENT OCCUPANT	2319 S 15TH PL	MILWAUKEE, WI 53215-3134
CURRENT OCCUPANT	2319 S 16TH ST	MILWAUKEE, WI 53215-3061
CURRENT OCCUPANT	2319A S 16TH ST	MILWAUKEE, WI 53215-3061
CURRENT OCCUPANT	2320 S 16TH ST	MILWAUKEE, WI 53215-3035
CURRENT OCCUPANT	2320A S 16TH ST	MILWAUKEE, WI 53215-3035
CURRENT OCCUPANT	2323 S 16TH ST	MILWAUKEE, WI 53215-3061
CURRENT OCCUPANT	2324 S 16TH ST	MILWAUKEE, WI 53215-3035
CURRENT OCCUPANT	2324 S 17TH ST	MILWAUKEE, WI 53215-3040
CURRENT OCCUPANT	2325 S 15TH PL	MILWAUKEE, WI 53215-3134
CURRENT OCCUPANT	2325A S 15TH PL	MILWAUKEE, WI 53215-3134
CURRENT OCCUPANT	2327 S 16TH ST	MILWAUKEE, WI 53215-3061
CURRENT OCCUPANT	2327A S 16TH ST	MILWAUKEE, WI 53215-3061
CURRENT OCCUPANT	2328 S 16TH ST	MILWAUKEE, WI 53215-3035
CURRENT OCCUPANT	2328 S 17TH ST	MILWAUKEE, WI 53215-3040
CURRENT OCCUPANT	2328A S 17TH ST	MILWAUKEE, WI 53215-3040
CURRENT OCCUPANT	2330 S 17TH ST	MILWAUKEE, WI 53215-3040
CURRENT OCCUPANT	2331 S 16TH ST# 1	MILWAUKEE, WI 53215-3061
CURRENT OCCUPANT	2331 S 16TH ST# 2	MILWAUKEE, WI 53215-3061
CURRENT OCCUPANT	2331 S 16TH ST# 3	MILWAUKEE, WI 53215-3061
CURRENT OCCUPANT	2331 S 16TH ST# 4	MILWAUKEE, WI 53215-3061
CURRENT OCCUPANT	2331 S 16TH ST# 5	MILWAUKEE, WI 53215-3061
CURRENT OCCUPANT	2332 S 16TH ST	MILWAUKEE, WI 53215-3035
CURRENT OCCUPANT	2333 S 15TH PL	MILWAUKEE, WI 53215-3134
CURRENT OCCUPANT	2333A S 15TH PL	MILWAUKEE, WI 53215-3134
CURRENT OCCUPANT	2335 S 16TH ST	MILWAUKEE, WI 53215-3061
CURRENT OCCUPANT	2335A S 16TH ST	MILWAUKEE, WI 53215-3061
CURRENT OCCUPANT	2336 S 16TH ST	MILWAUKEE, WI 53215-3035
CURRENT OCCUPANT	2336A S 16TH ST	MILWAUKEE, WI 53215-3035
CURRENT OCCUPANT	2337 S 15TH PL	MILWAUKEE, WI 53215-3134
CURRENT OCCUPANT	2337A S 15TH PL	MILWAUKEE, WI 53215-3134
CURRENT OCCUPANT	2338 S 16TH ST	MILWAUKEE, WI 53215-3035
CURRENT OCCUPANT	2338 S 17TH ST	MILWAUKEE, WI 53215-3040
CURRENT OCCUPANT	2338A S 17TH ST	MILWAUKEE, WI 53215-3040
CURRENT OCCUPANT	2340 S 17TH ST	MILWAUKEE, WI 53215-3040
CURRENT OCCUPANT	2341 S 16TH ST	MILWAUKEE, WI 53215-3061
CURRENT OCCUPANT	2344 S 16TH ST	MILWAUKEE, WI 53215-3035
CURRENT OCCUPANT	2344A S 16TH ST	MILWAUKEE, WI 53215-3035
CURRENT OCCUPANT	2345 S 15TH PL	MILWAUKEE, WI 53215-3134
CURRENT OCCUPANT	2345 S 16TH ST	MILWAUKEE, WI 53215-3061

CURRENT OCCUPANT 2345A S 15TH PL MILWAUKEE, WI 53215-3134

CURRENT OCCUPANT 2348 S 16TH ST MILWAUKEE, WI 53215-3035

Blank Notice

Total Records: 95

Radius 250 feet and Center of the Circle: 1601 W Lincoln Av



FOOD DEALER LICENSE APPLICATION FOR SHARED KITCHEN USERS

OFFICE OF THE CITY CLERK, LICENSE DIVISION
CITY HALL, 200 E. WELLS ST, ROOM 105, MILWAUKEE, WI 53202
(414) 286-2238 • license@milwaukee.gov • www.milwaukee.gov/license

Legal Entity Name (Individual, Partnership, Corp or LLC): El Mananero LLC

Business Name: EL Mananero

Premises (Shared Kitchen) Address: 1601 W Lincoln Ave - Milwaukee WI 53205

BUSINESS OPERATIONS

Base for Mobile Vendor (Peddler) Base for Temporary Event Caterer Other: _____

FOOD PROCESSING

What type of food items will be sold?

Restaurant Items (meals):
MEALS include, but are not limited to, chicken, ribs, sandwiches, roasted corn, baked potatoes, hot dogs, brats, tacos, nachos w/ cheese and meat, French fries, cooked or deep fried vegetables/fruit, cooked cheese curds, corn dogs, egg rolls, salads.
What percent of food items will be meals? _____ %

Retail Items (snacks and beverages):
RETAIL items include, but are not limited to, ice cream/soft serve, lemonade, snow cones, coffee, espresso, cappuccino, tea, fruit juice, smoothies, candy, dispensed soda, fruit cups, bakery, cookies, kettle corn, cotton candy, funnel cakes, fritters, tortilla chips w/ cheese.
What percent of food items will be retail? _____ %

All Applicants: Submit a menu or a list of food items sold.

Will any food processing be done at the shared kitchen? No Yes
Processing is defined as assembling, grinding, cutting, mixing, baking, coating, stuffing, packing, bottling, grilling, canning, extracting, fermenting, distilling, pickling, freezing, drying, smoking, or packaging.

Will any food that requires temperature control be sold? No Yes
(includes dairy products such as milk, cheese, and ice cream, fish, shellfish, meat, poultry)

If yes, list the types of food items: Cheese, milk, meat, Vegetable,

PLAN OF OPERATION

a. How are grounds kept clean? Sweep Pressure Wash Pick Up Litter Other: _____

b. How often will grounds be cleaned? Daily Weekly As Needed Monthly Other: _____

c. Grounds cleaned by: Licensee Building Owner Employees Hired Maintenance Other: _____

d. How are noise issues prevented and/or addressed? Security Call Police Signs Posted Other: _____

e. Will a sound amplification system be used? No Yes If yes, describe: _____

f. Number of Garbage Cans: Inside: 5 Locations: Bathrooms, Kitchen, Dining Room
Outside: 2 Locations: Rear side

g. Name of solid waste contractor: Advanced Disposal Waste Management Other: _____

h. Is there a loading zone? No Yes

i. Are there security cameras? No Yes If yes, how many? _____ and list locations: _____

PREMISES DESCRIPTION

- a. Are other businesses operating in the same building? No Yes If Yes, Describe: Taguerra El Campechano LLC
- b. Identify all area(s) of the premises that will be used in operating this business (include areas used only for storage):
 1st Floor 2nd Floor Basement Storage Other: Describe: _____
- c. Describe Location: Major Thoroughfare Secondary Street Other: Lincoln Ave
- d. Nearest Major Cross Street: Lincoln Ave
- e. Describe Building: Free Standing Building Strip Mall Other: _____
- f. Describe Premises Structure: Single Story Multi-Story - # of Stories 2 Other: _____
- g. Describe Surrounding Area: Commercial Residential Industrial Other: _____
- h. Building Owner Name: Emma Martinez Phone Number: 414-852-1803
 Building Owner Address: _____

SHARED KITCHEN AGREEMENT

SERVICES/FACILITIES (check all that will be used at the shared kitchen):

- Dry food storage
- Restroom facilities
- Chemical storage
- Garbage / recycling disposal
- Waste water tank disposal facilities
- Handwashing facilities
- Equipment / utensil storage
- Facilities to prepare or package food
- Potable water connection
- Waste water tank disposal facilities w/ grease trap
- Refrigeration / frozen food storage
- Warewashing facilities (3 compartment sink)
- Utilities: electrical connection
- Peddlers: overnight parking

HOURS OF OPERATION AT THE SHARED KITCHEN

DAY OF WEEK	Start Time (include am / pm)	End Time (include am / pm)
Sunday	4:00 pm	6:00 pm
Monday	4:00 pm	6:00
Tuesday	4:00 pm	6:00
Wednesday	4:00 pm	6:00
Thursday	4:00 pm	6:00
Friday	4:00 pm	6:00
Saturday	4:00 pm	6:00

I, the shared kitchen user, will utilize the services/facilities at this kitchen during the days/times indicated above. I will notify the City Clerk's Office (License Division) prior to discontinuing use of the kitchen. I will maintain an updated schedule of use of the kitchen with the City Clerk's Office (License Division) and keep a written log of the dates/times I am actually at the kitchen. (Peddlers: I will report to the facility at least once each operating day for cleaning and servicing.)

Print Name(s): MARIO ANTONIO CRISTOBAL GUTIERREZ
 Sole Proprietor, Partners or 20% or More Shareholder
 Signature(s): [Signature] Date: 02/11/26

FOR COMPLETION BY THE SHARED KITCHEN OWNER

Business Name: Taguerra El Campechano LLC

I, the shared kitchen owner, acknowledge I have entered into an agreement with the user to utilize the services/facilities at this kitchen and agree to provide the user access to the kitchen on the days/times indicated above. I will maintain a written log of the dates/times the user is actually at the facility. I will promptly notify the City Clerk's Office (License Division) if this agreement is terminated or if the user fails to use the kitchen on the days/times they have indicated. I acknowledge that as the primary operator of the kitchen I am responsible for the maintenance and sanitation of the kitchen, and as such, I acknowledge I am responsible for maintaining the services/facilities being provided to the user in compliance with the Wisconsin Food Code.

Print Name: Argelio Campechano
 Signature: [Signature] Date: 2/11/26



FOOD PEDDLER PLAN OF OPERATION

OFFICE OF THE CITY CLERK, LICENSE DIVISION

CITY HALL, 200 E. WELLS ST, ROOM 105, MILWAUKEE, WI 53202 •

(414) 286-2238 • license@milwaukee.gov • www.milwaukee.gov/license

Legal Entity: EL Mañanero LLC

Premises Address: 1601 W Lincoln Ave - Milwaukee WI 53215

1. Mobile Unit Description

Mobile Unit Type: Motorized Vehicle - includes a peddler truck, vehicle, or trailer that must be pulled by a motorized vehicle
 Pushed, Pedaled, or Pulled Vehicle - does not require a motorized vehicle to move from site to site
 Carried Container

Provide the following information:
 Color Orange Length 18 ft Width 8 ft Height 8 ft
 Make TRAVEL Model 2025 Year 2025
 License Plate Number (if applicable) _____ VIN (if applicable) 3J9T1FE225M057604

2. Food Operations

What type of food items will be sold?
 Restaurant Items (meals):
 MEALS include, but are not limited to, chicken, ribs, sandwiches, roasted corn, baked potatoes, hot dogs, brats, tacos, nachos w/ cheese and meat, french fries, cooked or deep fried vegetables/fruit, cooked cheese curds, corn dogs, egg rolls, salads.
 Retail Items (snacks and beverages):
 RETAIL items include, but are not limited to, ice cream/soft serve, lemonade, snow cones, coffee, espresso, cappuccino, tea, fruit juice, smoothies, candy, dispensed soda, fruit cups, bakery, cookies, kettle corn, cotton candy, funnel cakes, fritters, tortilla chips w/ cheese.

All Applicants: Submit a menu or a list of food items sold.

Will food processing be done on the mobile unit? No Yes

Processing includes assembling, grinding, cutting, mixing, baking, coating, stuffing, packing, bottling, grilling, canning, extracting, fermenting, distilling, pickling, freezing, drying, smoking, or packaging

Will food that requires temperature control be sold? No Yes Foods requiring temperature control include dairy products such as milk, cheese, and ice cream, fish, shellfish, meat, poultry
 If yes, list the food items: meat, cheese, vegetables

Do you intend to sell ice cream, popsicles, or other frozen confections? No Yes
 If yes, you must also obtain an Ice Cream Peddler License. Submit your Ice Cream Peddler License Application with this application. If anyone else will be operating the mobile unit, they must also obtain an Ice Cream Peddler License.

3. Litter & Noise

A. Who will be operating the cart/vehicle? Licensee Employees
 B. How will the area around the cart/vehicle be kept clean? Sweep Pick Up litter Garbage Cans Other _____
 C. How often will the area around the cart/vehicle be checked for litter? Hourly Daily/Nightly Other _____
 D. Who will keep the area around the cart/vehicle clean? Licensee Employees Other _____
 E. How will noise issues be addressed/prevented? By the cart operator Police will be called Other _____
 F. How will disruptive behaviors to surrounding neighbors be addressed/prevented? By the cart operator Police will be called
 Other _____

4. Service Base

Food peddlers must obtain a Food Dealer License for their service base. If you do not have a base, you must obtain a variance from the Health Dept.

Check one:

- I will obtain a food dealer license for my service base located in the City of Milwaukee.
- I will obtain a food dealer license for my service base located outside the city of Milwaukee in another WI municipality. I will submit copies of the base license and health inspection report completed within the previous 12 month period to the License Division.
- I will contact the City of Milwaukee Health Department to apply for a variance.

5. Affirmation of Understanding – License Needed to Operate & Requirements

Read and initial each item confirming your understanding:

- MACB Health Department inspection and approval is required before my license may be issued.
- MACB A license must be issued for my service base or a variance obtained before my Food Peddler License may be issued.
- MACB The license must be issued and posted on the mobile unit prior to operating
- MACB A current Food Peddler Itinerary must be on file with the License Division and at the service base.
- MACB I must keep a written log of all days I am at the service base, including the time I arrive and leave.



Signature of Sole Proprietor, Partner, or 20% or more Shareholder



Signature of Additional Partner

FOOD PEDDLER ITINERARY

Business Name: *El Mananero LLC*

List all Vending Location Addresses	Check the Location Type	Circle the Days of the Week at this Location	Start Time (include am/pm)	End Time (include am/pm)
<i>Murphy Ave and White St</i>	<input checked="" type="checkbox"/> Public Way <input type="checkbox"/> Event <input type="checkbox"/> Private Property <input type="checkbox"/> Seasonal Market	Sun Mon Tue Wed Thu Fri Sat	<i>5am</i>	<i>6pm</i>
	<input type="checkbox"/> Public Way <input type="checkbox"/> Event <input type="checkbox"/> Private Property <input type="checkbox"/> Seasonal Market	Sun Mon Tue Wed Thu Fri Sat		
	<input type="checkbox"/> Public Way <input type="checkbox"/> Event <input type="checkbox"/> Private Property <input type="checkbox"/> Seasonal Market	Sun Mon Tue Wed Thu Fri Sat		
	<input type="checkbox"/> Public Way <input type="checkbox"/> Event <input type="checkbox"/> Private Property <input type="checkbox"/> Seasonal Market	Sun Mon Tue Wed Thu Fri Sat		
	<input type="checkbox"/> Public Way <input type="checkbox"/> Event <input type="checkbox"/> Private Property <input type="checkbox"/> Seasonal Market	Sun Mon Tue Wed Thu Fri Sat		
	<input type="checkbox"/> Public Way <input type="checkbox"/> Event <input type="checkbox"/> Private Property <input type="checkbox"/> Seasonal Market	Sun Mon Tue Wed Thu Fri Sat		
	<input type="checkbox"/> Public Way <input type="checkbox"/> Event <input type="checkbox"/> Private Property <input type="checkbox"/> Seasonal Market	Sun Mon Tue Wed Thu Fri Sat		
	<input type="checkbox"/> Public Way <input type="checkbox"/> Event <input type="checkbox"/> Private Property <input type="checkbox"/> Seasonal Market	Sun Mon Tue Wed Thu Fri Sat		
	<input type="checkbox"/> Public Way <input type="checkbox"/> Event <input type="checkbox"/> Private Property <input type="checkbox"/> Seasonal Market	Sun Mon Tue Wed Thu Fri Sat		
	<input type="checkbox"/> Public Way <input type="checkbox"/> Event <input type="checkbox"/> Private Property <input type="checkbox"/> Seasonal Market	Sun Mon Tue Wed Thu Fri Sat		
	<input type="checkbox"/> Public Way <input type="checkbox"/> Event <input type="checkbox"/> Private Property <input type="checkbox"/> Seasonal Market	Sun Mon Tue Wed Thu Fri Sat		
	<input type="checkbox"/> Public Way <input type="checkbox"/> Event <input type="checkbox"/> Private Property <input type="checkbox"/> Seasonal Market	Sun Mon Tue Wed Thu Fri Sat		

SIGNATURE(S)

I understand that any changes I wish to make must be reported to the City Clerk (License Division) on an updated Itinerary form before any changes can be implemented. I will keep a copy of my current Itinerary on my mobile until and at my service base all times.

I understand that failure to maintain a current itinerary with the City Clerk (License Division) may result in progressive enforcement action including citation and permit suspension and/or revocation.

[Signature]
 Sole Proprietor, Partner, or 20% or more Shareholder

[Signature]
 Additional Partner

EL MANANEROLLE

1601 W LINCOLN AVE.
MILWAUKEE, WI 53215

AGENT: Mario A Cristobal
414-526-3787

Date 02/11/26

W LINCOLN AVE

Total SQ FT = 2400.-

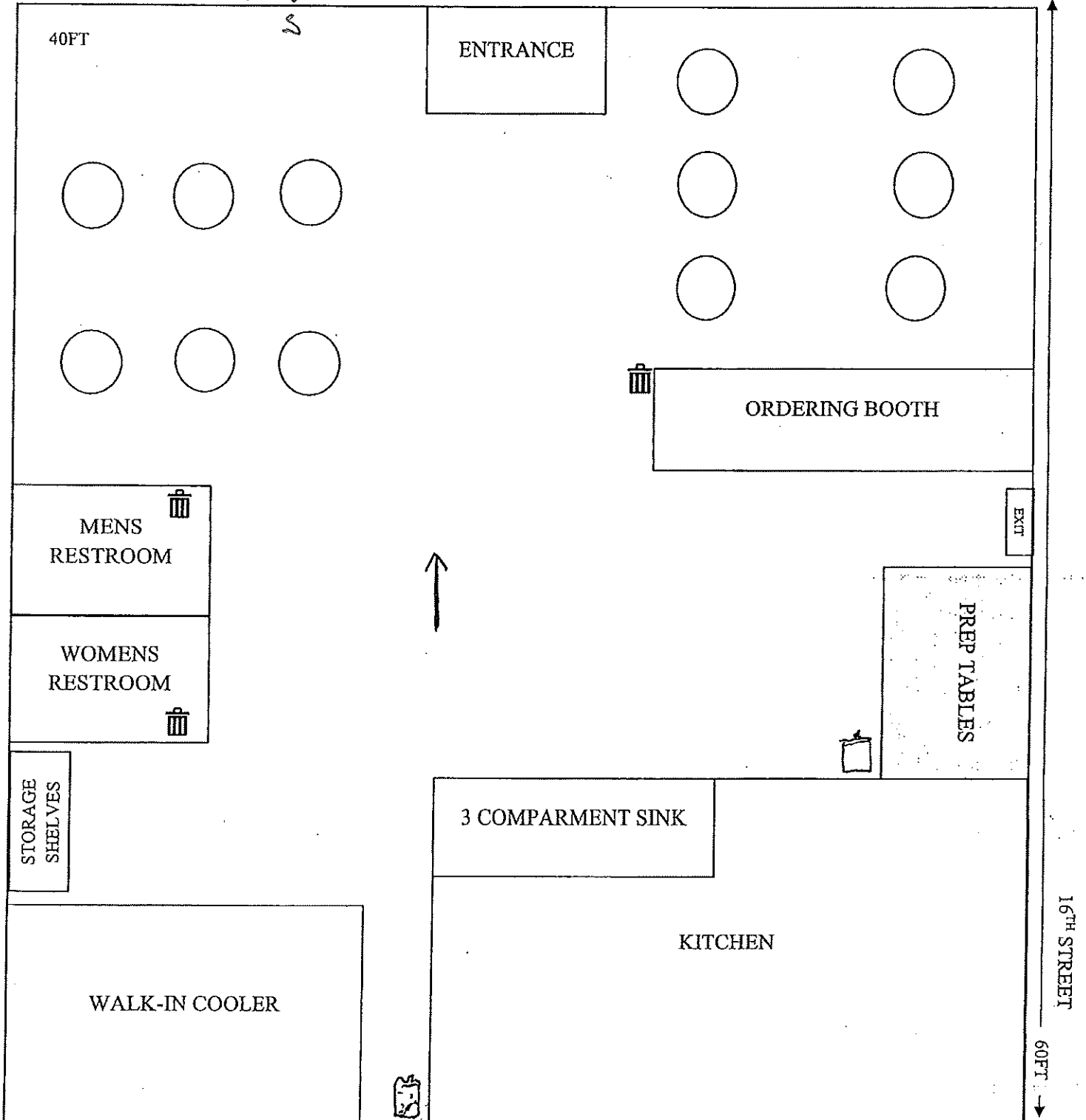

El nombre de...
1601 W Lincoln Ave - Milwaukee WI 53115

MENÚ

TACOS (\$3.00)

ASADA
PASTOR
BARBACOA
CABEZA
CHORIZO

ANTOJITOS

EMPANADAS \$4.00
QUESADILLAS FRITAS \$4.00
FLAUTAS LA ORDEN \$12.00
GARNACHAS \$4.00

BURRITOS (\$9.00)

ASADA
PASTOR
BARBACOA
CABEZA
CHORIZO

DINNER

CHILES RELLENOS
GUISADOS DE DIA

TORTAS (\$9.00)

ASADA
PASTOR
BARBACOA
POLLO
CHORIZO

BEBIDAS

HORCHATA GRANDE...\$4.00
JAMAICA CHICA...\$2.00
REFRESCOS EN LATA\$2.00
REFRESCOS DE BOTELLA\$3.00

TOSTADAS (\$4.00)

ASADA
POLLO

HORARIOS

5:00 AM – 12:00 PM

4:00PM – 12:00 AM