

**Exhibit A**  
**File No. 250250**  
**Minor Modification to a Detailed Planned Development known as**  
**Forest County Potawatomi Legacy District – Phase 1**  
**320 S. 19<sup>th</sup> Street**  
**June 9, 2025**

**Previous File History and Project Summary**

The Forest County Potawatomi Legacy District was rezoned from Industrial Heavy to a General Planned Development (GPD) in 2005 as File No. 050469, and has been modified and amended subsequently as File Nos. 070101, 110625 and 111295.

The casino, hotel, and parking areas (inclusive of surface lots and parking structure) were rezoned to a Detailed Planned Development (DPD – Phase 1) in 2005 as File No. 050468. Since then, the DPD – Phase 1 has been modified and amended as File Nos. 070100, 070842, 111296, 121720, and 130454.

A DPD – Phase 2 was also established for the biogas generation facility in 2011 as File No. 110626 and subsequently amended as File No. 120637.

**Minor Modification Summary**

This Minor Modification relates to the Phase 1 DPD, and more specifically the parking structure located at 320 S. 19<sup>th</sup> Street. Forest County Potawatomi Community of Wisconsin is updating the directional and wayfinding signage for the parking structure and dock area that serve the casino and hotel. These directional and wayfinding signs are consistent with the DPD – Phase 1 zoning. This Minor Modification will allow 4 Type A, face-lit channel letter wall signs on the parking structure as follows:

Sign Label	Location	Dimensions (approx.)	Sq. Footage (approx.)
A	North elevation – top of structure (W. Potawatomi Cir)	25' L x 2' 6 ¾" H	62.5
B	South elevation – top of structure (S. 19 <sup>th</sup> St)	25' L x 2' 6 ¾" H	62.5
C	East elevation – top of structure at entrance (S. 16 <sup>th</sup> St)	24' – 4" L x 2' 5" H	60
G	West elevation – second floor above structure entrance (S. 19 <sup>th</sup> St)	24' L x 2' 4" H	55.92

Each of the wall signs will be placed on a backer panel painted to match the pre-cast concrete parking structure, as shown in the attached drawings.

All other aspects of the DPD zoning remain unchanged.

**List of Attachments**

1. Vicinity map
2. Site photos
3. Drawings of Signs



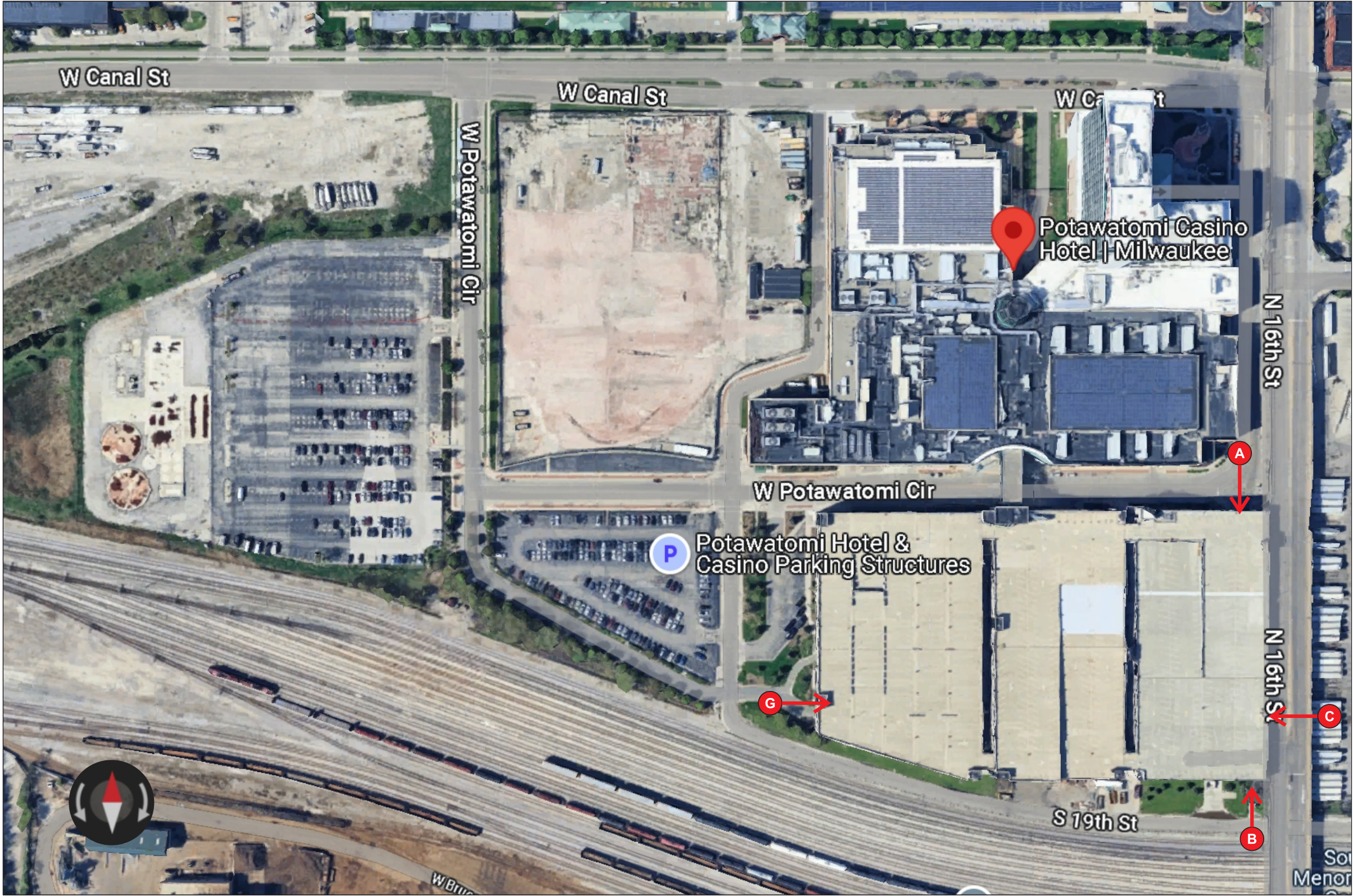

1 SIGN LOCATION MAP  
14 NOT TO SCALE

SignEffecttz™

1827 W. Glendale Ave. Milwaukee, WI 53209  
414.264.5504  
414.262.5564  
www.signeffecttz.com

Disclaimer:  
THIS IS AN ORIGINAL DESIGN CREATED BY SIGN EFFECTTZ. THE SUBMITTED DESIGN PROTECTED UNDER COPYRIGHT LAWS OF THE UNITED STATES CODE YOU AGREE NOT TO COPY PHOTOGRAPH MODIFY OR SHARE DIRECTLY OR INDIRECTLY ANY OF THE FOREGOING HELD BY YOU WITH ANY OTHER PARTY, NOR WILL YOU PERMIT ANY THIRD PARTY TO DO ANY OF THE FOREGOING WITHOUT THE WRITTEN CONSENT OF SIGN EFFECTTZ.  
  
THIS SIGN IS INTENDED TO BE INSTALLED IN ACCORDANCE WITH THE REQUIREMENTS OF ARTICLE 600 OF THE NEC AND/OR OTHER APPLICABLE LOCAL CODES. THIS INCLUDES PROPER GROUNDING AND BONDING OF THE SIGN

CUSTOMER:  
Potawatomi Casino | Hotel

PROJECT:  
2025 Parking Garage Exterior

SCOPE OF WORK:

PROJECT ADDRESS:  
Potawatomi Casino | Hotel  
1721 W Canal St.  
Milwaukee, WI 53233

BILLING ADDRESS:  
Potawatomi Casino | Hotel  
1721 W Canal St.  
Milwaukee, WI 53233

REV.	DESCRIPTION	DATE	INIT
01			
02			
03			
04			
05			
06			
07			
08			
09			
10			

PROJECT NOTES:  
DISCUSS OPTIONS TO RIGID BANNERS ON GARAGE EAST WALL.  
WILL TORCHES REMAIN? IF REFACING, PANELS OR GRAPHICS WOULD NEED TO AVOID THE BRACKETS HOLDING THE TORCHES.

Copyright © 2024 Sign Effecttz Inc. All Rights Reserved

SHEET SIZE: <b>B</b>	DEPT. CONCEPT	DATE OF ISSUE: 06/28/24
AUTHOR: AAE	CONCEPT DRAWING NO: <b>C 23986807_3.7</b>	
ACCT. MGR. JCB	SCALE: NOT TO SCALE	
	QUOTE: OPEN	
REV: 00	SIGN TYPE. PARKING	SHEET NO: <b>14</b>





1  
13  
SIGN LOCATION MAP  
NOT TO SCALE

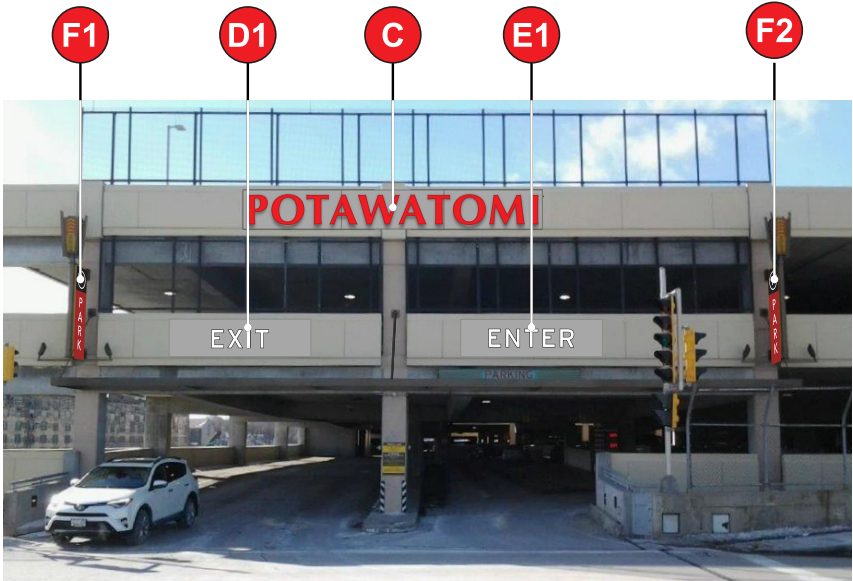

2  
13  
EAST GARAGE ELEV.  
NOT TO SCALE



3  
13  
NORTH GARAGE ELEV.  
NOT TO SCALE

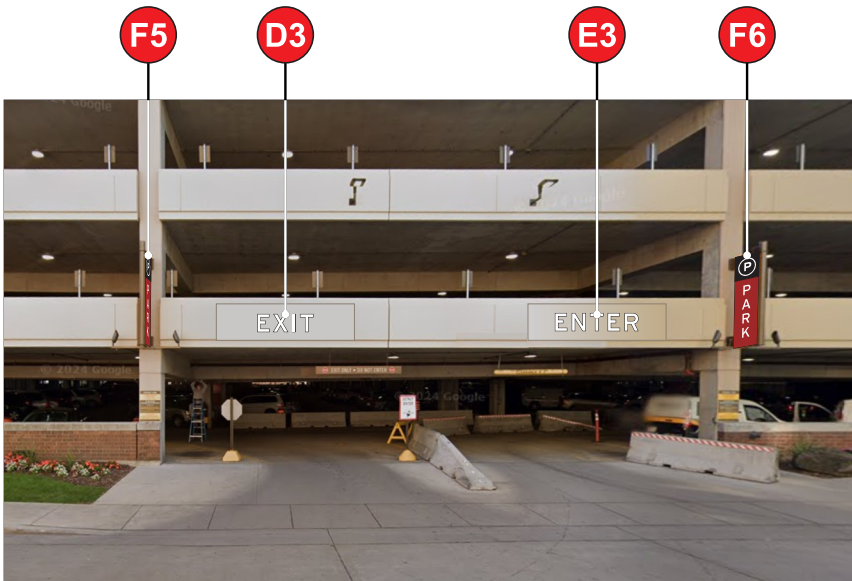

4  
13  
NORTH GARAGE ELEV.  
NOT TO SCALE

## SignEffecttz™

1827 W. Glendale Ave. Milwaukee, WI 53209  
414.264.5504  
414.262.5564  
www.signeffecttz.com

### Disclaimer:

THIS IS AN ORIGINAL DESIGN CREATED BY SIGN EFFECTTZ. THE SUBMITTED DESIGN PROTECTED UNDER COPYRIGHT LAWS OF THE UNITED STATES CODE YOU AGREE NOT TO COPY PHOTOGRAPH MODIFY OR SHARE DIRECTLY OR INDIRECTLY ANY OF THE FOREGOING HELD BY YOU WITH ANY OTHER PARTY, NOR WILL YOU PERMIT ANY THIRD PARTY TO DO ANY OF THE FOREGOING WITHOUT THE WRITTEN CONSENT OF SIGN EFFECTTZ.

THIS SIGN IS INTENDED TO BE INSTALLED IN ACCORDANCE WITH THE REQUIREMENTS OF ARTICLE 600 OF THE NEC AND/OR OTHER APPLICABLE LOCAL CODES. THIS INCLUDES PROPER GROUNDING AND BONDING OF THE SIGN

### CUSTOMER:

Potawatomi Casino | Hotel

### PROJECT:

2025 Parking Garage Exterior

### SCOPE OF WORK:

### PROJECT ADDRESS:

Potawatomi Casino | Hotel  
1721 W Canal St.  
Milwaukee, WI 53233

### BILLING ADDRESS:

Potawatomi Casino | Hotel  
1721 W Canal St.  
Milwaukee, WI 53233

REV.	DESCRIPTION	DATE	INIT
01	no blade signs at west entry	10/30/24	AE
02	presentation re-organized for permitting	04/30/25	AE
03	further detail on garage signs	05/27/25	AE
04			
05			
06			
07			
08			
09			
10			

### PROJECT NOTES:

DISCUSS OPTIONS TO RIGID BANNERS ON GARAGE EAST WALL.  
WILL TORCHES REMAIN? IF REFACING, PANELS OR GRAPHICS WOULD NEED TO AVOID THE BRACKETS HOLDING THE TORCHES.

Copyright © 2024 Sign Effecttz Inc. All Rights Reserved

SHEET SIZE:	DEPT.	DATE OF ISSUE:
B	CONCEPT	06/28/24
AUTHOR:	CONCEPT DRAWING NO:	
AAE	C 23986807_3.7	
ACCT. MGR.	SCALE:	NOT TO SCALE
JCB	QUOTE:	OPEN
REV:	SIGN TYPE:	SHEET NO:
03	PARKING	13



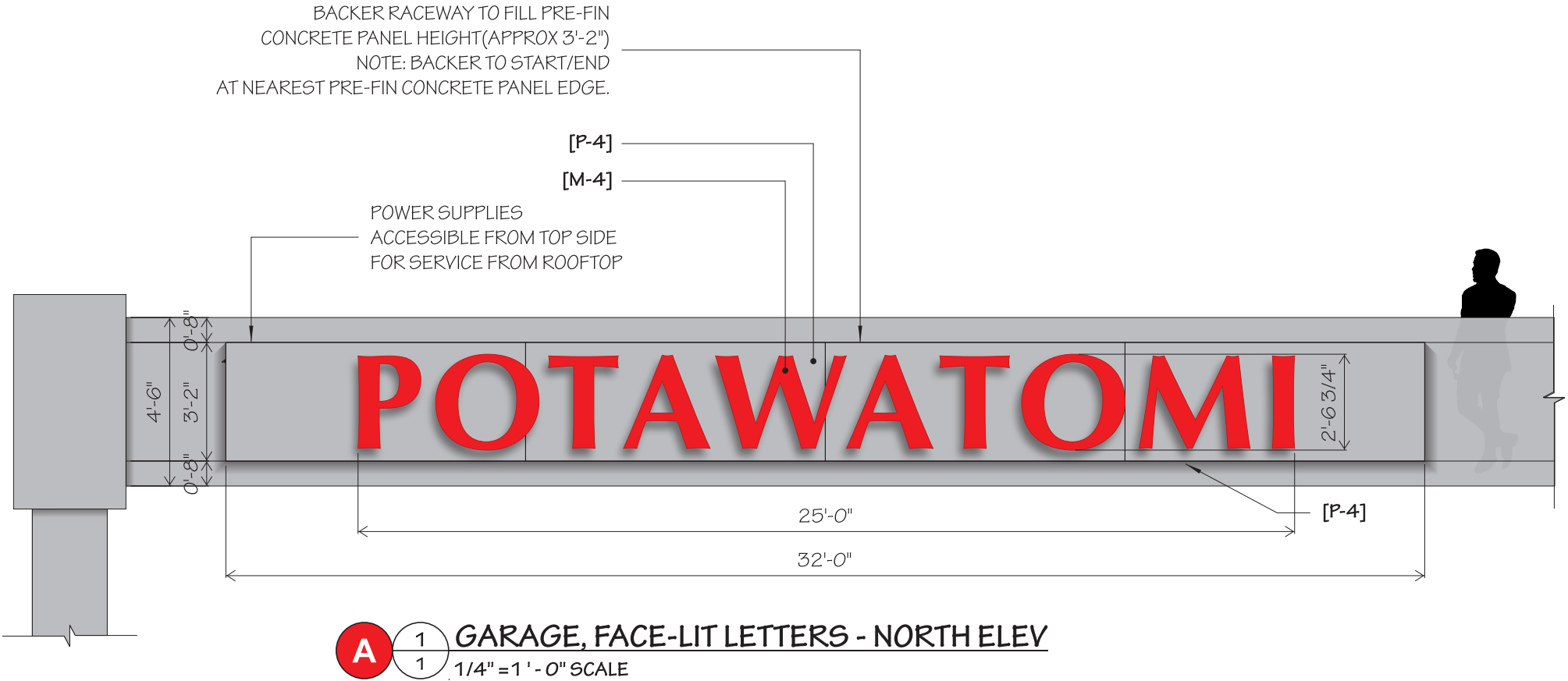

COLOR SCHEDULE:

- [M-1] - #7328 WHITE ACRYLIC
- [M-2] - RED TRIM CAP (JEWELITE)
- [M-3] - PRE-FINISHED "RED" ALUM RETURNS
- [M-4] - #2283 RED ACRYLIC FACES
- [P-4] - MATTHEWS CUSTOM PAINT TO CLOSELY MATCH PRE-CAST CONCRETE (SAMPLE REQ'D FOR APPROVAL)

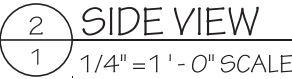
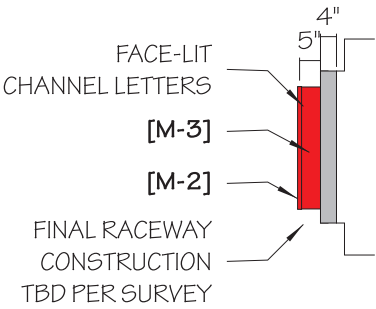

Bottom of sign to Grade is 57' to W. Potawatomi Circle  
Bottom of sign to Grade is 19' to N. 16th Street



1827 W. Glendale Ave. Milwaukee, WI 53209  
414.264.5504  
414.262.5564  
www.signeffecttz.com

**Disclaimer:**  
THIS IS AN ORIGINAL DESIGN CREATED BY SIGN EFFECTTZ. THE SUBMITTED DESIGN PROTECTED UNDER COPYRIGHT LAWS OF THE UNITED STATES CODE YOU AGREE NOT TO COPY PHOTOGRAPH MODIFY OR SHARE DIRECTLY OR INDIRECTLY ANY OF THE FOREGOING HELD BY YOU WITH ANY OTHER PARTY, NOR WILL YOU PERMIT ANY THIRD PARTY TO DO ANY OF THE FOREGOING WITHOUT THE WRITTEN CONSENT OF SIGN EFFECTTZ.  
  
THIS SIGN IS INTENDED TO BE INSTALLED IN ACCORDANCE WITH THE REQUIREMENTS OF ARTICLE 600 OF THE NEC AND/OR OTHER APPLICABLE LOCAL CODES. THIS INCLUDES PROPER GROUNDING AND BONDING OF THE SIGN

**CUSTOMER:**  
Potawatomi Casino | Hotel

**PROJECT:**  
2025 Parking Garage Exterior

**SCOPE OF WORK:**

**PROJECT ADDRESS:**  
Potawatomi Casino | Hotel  
1721 W Canal St.  
Milwaukee, WI 53233

**BILLING ADDRESS:**  
Potawatomi Casino | Hotel  
1721 W Canal St.  
Milwaukee, WI 53233

REV.	DESCRIPTION	DATE	INIT
01	backer panel raceway added	10/25/24	AE
02	presentation re-organized for permitting	04/30/25	AE
03			
04			
05			
06			
07			
08			
09			
10			

**PROJECT NOTES:**  
FIELD SURVEY RED'Q FOR RACEWAY SIZING AND BUILD-OUT.

Copyright © 2024 Sign Effecttz Inc. All Rights Reserved		
SHEET SIZE: <b>B</b>	DEPT. <b>CONCEPT</b>	DATE OF ISSUE: <b>06/28/24</b>
AUTHOR: <b>AAE</b>	CONCEPT DRAWING NO: <b>C 23986807_3.7</b>	
ACCT. MGR. <b>JCB</b>	SCALE: <b>AS NOTED</b>	
REV: <b>02</b>	SIGN TYPE: <b>PARKING</b>	QUOTE: <b>OPEN</b>
	SHEET NO: <b>1</b>	



POTAWATOMI™  
PARKING GARAGE 2025  
SOUTH GARAGE TOP FLOOR

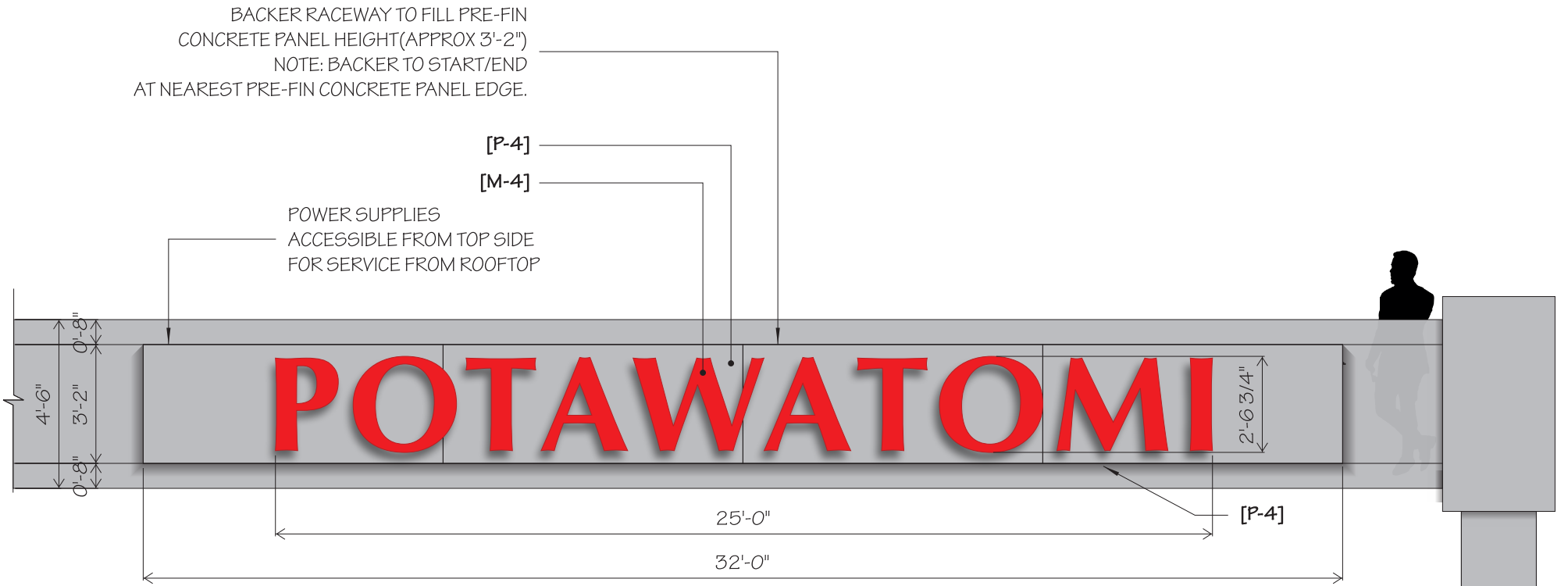

**B** 1 GARAGE, FACE-LIT LETTERS - SOUTH ELEV  
2 (1 REQ'D) 1/4" = 1' - 0" SCALE

COLOR SCHEDULE:

- [M-1] - #7328 WHITE ACRYLIC
- [M-2] - RED TRIM CAP (JEWELITE)
- [M-3] - PRE-FINISHED "RED" ALUM RETURNS
- [M-4] - #2283 RED ACRYLIC FACES
- [P-4] - MATTHEWS CUSTOM PAINT TO CLOSELY MATCH PRE-CAST CONCRETE (SAMPLE REQ'D FOR APPROVAL)

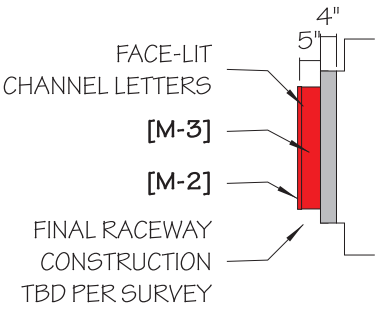

2 SIDE VIEW  
2 1/4" = 1' - 0" SCALE

Bottom of sign to Grade is 57' to S. 19th Street  
Bottom of sign to Grade is 19' to N. 16th Street



1827 W. Glendale Ave. Milwaukee, WI 53209

414.264.5504

414.262.5564

www.signeffecttz.com

**Disclaimer:**

THIS IS AN ORIGINAL DESIGN CREATED BY SIGN EFFECTTZ. THE SUBMITTED DESIGN PROTECTED UNDER COPYRIGHT LAWS OF THE UNITED STATES CODE YOU AGREE NOT TO COPY PHOTOGRAPH MODIFY OR SHARE DIRECTLY OR INDIRECTLY ANY OF THE FOREGOING HELD BY YOU WITH ANY OTHER PARTY, NOR WILL YOU PERMIT ANY THIRD PARTY TO DO ANY OF THE FOREGOING WITHOUT THE WRITTEN CONSENT OF SIGN EFFECTTZ.

THIS SIGN IS INTENDED TO BE INSTALLED IN ACCORDANCE WITH THE REQUIREMENTS OF ARTICLE 600 OF THE NEC AND/OR OTHER APPLICABLE LOCAL CODES. THIS INCLUDES PROPER GROUNDING AND BONDING OF THE SIGN

**CUSTOMER:**

Potawatomi Casino | Hotel

**PROJECT:**

2025 Parking Garage Exterior

**SCOPE OF WORK:**

**PROJECT ADDRESS:**

Potawatomi Casino | Hotel  
1721 W Canal St.  
Milwaukee, WI 53233

**BILLING ADDRESS:**

Potawatomi Casino | Hotel  
1721 W Canal St.  
Milwaukee, WI 53233

REV.	DESCRIPTION	DATE	INIT
01	backer panel raceway added	10/25/24	AE
02	"EXIT" and "ENTER" added	11/14/24	AE
03	presentation re-organized for permitting	04/30/25	AE
04			
05			
06			
07			
08			
09			
10			

**PROJECT NOTES:**

FIELD SURVEY RED'Q FOR RACEWAY SIZING AND BUILD-OUT.

Copyright © 2024 Sign Effecttz Inc. All Rights Reserved		
SHEET SIZE: <b>B</b>	DEPT. <b>CONCEPT</b>	DATE OF ISSUE: <b>06/28/24</b>
AUTHOR: <b>AAE</b>	CONCEPT DRAWING NO: <b>C 23986807_3.7</b>	
ACCT. MGR. <b>JCB</b>	SCALE: <b>AS NOTED</b>	
REV: <b>03</b>	SIGN TYPE. <b>PARKING</b>	QUOTE: <b>OPEN</b>
		SHEET NO: <b>2</b>



COLOR SCHEDULE:

- [M-1] - #7328 WHITE ACRYLIC
- [M-2] - RED TRIM CAP (JEWELITE)
- [M-3] - PRE-FINISHED "RED" ALUM RETURNS
- [M-4] - #2283 RED ACRYLIC FACES
- [P-4] - MATTHEWS CUSTOM PAINT TO CLOSELY MATCH PRE-CAST CONCRETE (SAMPLE REQ'D FOR APPROVAL)

Disclaimer:  
THIS IS AN ORIGINAL DESIGN CREATED BY SIGN EFFECTTZ. THE SUBMITTED DESIGN PROTECTED UNDER COPYRIGHT LAWS OF THE UNITED STATES CODE YOU AGREE NOT TO COPY PHOTOGRAPH MODIFY OR SHARE DIRECTLY OR INDIRECTLY ANY OF THE FOREGOING HELD BY YOU WITH ANY OTHER PARTY, NOR WILL YOU PERMIT ANY THIRD PARTY TO DO ANY OF THE FOREGOING WITHOUT THE WRITTEN CONSENT OF SIGN EFFECTTZ.

THIS SIGN IS INTENDED TO BE INSTALLED IN ACCORDANCE WITH THE REQUIREMENTS OF ARTICLE 600 OF THE NEC AND/OR OTHER APPLICABLE LOCAL CODES. THIS INCLUDES PROPER GROUNDING AND BONDING OF THE SIGN

CUSTOMER:  
Potawatomi Casino | Hotel

PROJECT:  
2025 Parking Garage Exterior

SCOPE OF WORK:

PROJECT ADDRESS:  
Potawatomi Casino | Hotel  
1721 W Canal St.  
Milwaukee, WI 53233

BILLING ADDRESS:  
Potawatomi Casino | Hotel  
1721 W Canal St.  
Milwaukee, WI 53233

REV.	DESCRIPTION	DATE	INIT
01	copy replaced w/ "Interstate" for dimensionals	10/03/24	AAE
02	single "POTAWATOMI" sign top wall, centered	10/30/24	AAE
03	"EXIT" and "ENTER" added	11/14/24	AE
04	presentation re-organized for permitting	04/30/25	AE
05			
06			
07			
08			
09			
10			

PROJECT NOTES:  
A.) FINAL SIZING TBD PER FIELD SURVEY.

Copyright © 2024 Sign Effecttz Inc. All Rights Reserved

SHEET SIZE.	DEPT.	DATE OF ISSUE:
B	CONCEPT	06/28/24
AUTHOR: AAE	CONCEPT DRAWING NO: C 23986807_3.7	
ACCT. MGR. JCB	SCALE: AS NOTED	
	QUOTE: OPEN	
REV: 04	SIGN TYPE. PARKING	SHEET NO: 3

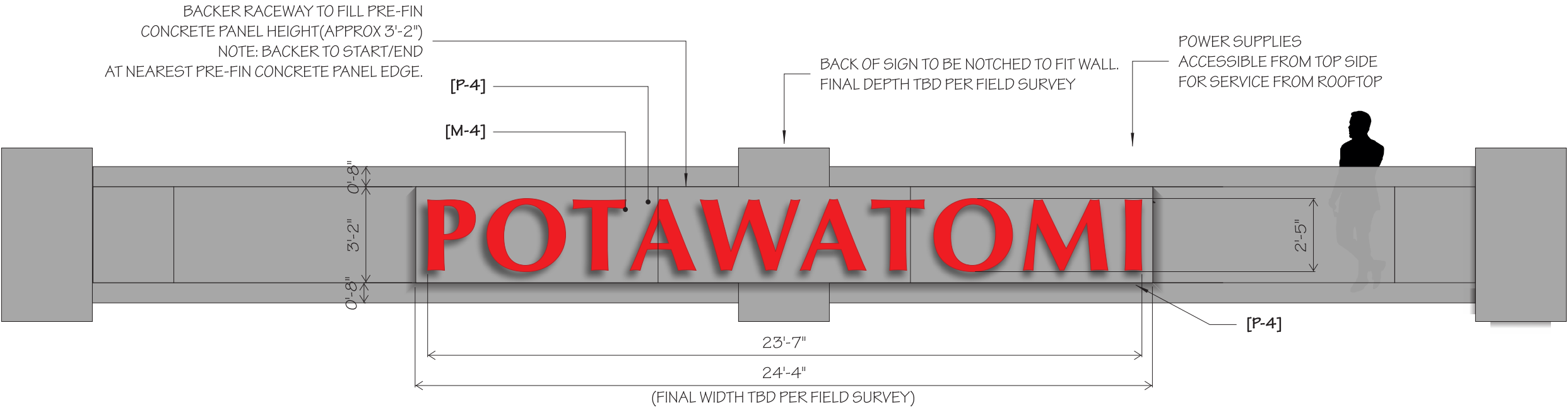

C 1 3 GARAGE, FACE-LIT LETTERS - EAST ELEV  
(1 REQ'D) 1/4" = 1' - 0" SCALE

Bottom of sign to Grade is 19' to N. 16th Street



COLOR SCHEDULE:

- [M-1] - #7328 WHITE ACRYLIC
- [M-2] - RED TRIM CAP (JEWELITE)
- [M-3] - PRE-FINISHED "RED" ALUM RETURNS
- [M-4] - #2283 RED ACRYLIC FACES
- [P-4] - MATTHEWS CUSTOM PAINT TO CLOSELY MATCH PRE-CAST CONCRETE (SAMPLE REQ'D FOR APPROVAL)



 1827 W. Glendale Ave. Milwaukee, WI 53209

 414.264.5504

 414.262.5564

 www.signeffecttz.com

Disclaimer:

THIS IS AN ORIGINAL DESIGN CREATED BY SIGN EFFECTTZ. THE SUBMITTED DESIGN PROTECTED UNDER COPYRIGHT LAWS OF THE UNITED STATES CODE YOU AGREE NOT TO COPY PHOTOGRAPH MODIFY OR SHARE DIRECTLY OR INDIRECTLY ANY OF THE FOREGOING HELD BY YOU WITH ANY OTHER PARTY. NOR WILL YOU PERMIT ANY THIRD PARTY TO DO ANY OF THE FOREGOING WITHOUT THE WRITTEN CONSENT OF SIGN EFFECTTZ.

THIS SIGN IS INTENDED TO BE INSTALLED IN ACCORDANCE WITH THE REQUIREMENTS OF ARTICLE 600 OF THE NEC AND/OR OTHER APPLICABLE LOCAL CODES. THIS INCLUDES PROPER GROUNDING AND BONDING OF THE SIGN

CUSTOMER:

Potawatomi Casino | Hotel

PROJECT:

2025 Parking Garage Exterior

SCOPE OF WORK:

PROJECT ADDRESS:

Potawatomi Casino | Hotel  
1721 W Canal St.  
Milwaukee, WI 53233

BILLING ADDRESS:

Potawatomi Casino | Hotel  
1721 W Canal St.  
Milwaukee, WI 53233

REV.	DESCRIPTION	DATE	INIT
01	similar to north garage entry	08/28/24	AAE
02	adjusted copy, color and branding	10/03/24	AAE
03	add sign types	10/30/24	AAE
04	"EXIT" and "ENTER" added	11/14/24	AE
05	presentation re-organized for permitting	04/30/25	AE
06			
07			
08			
09			
10			

PROJECT NOTES:

A.) FIELD SURVEY TO DETERMINE FINAL SIZES.

Copyright © 2024 Sign Effecttz Inc. All Rights Reserved		
SHEET SIZE: B	DEPT. CONCEPT	DATE OF ISSUE: 06/28/24
AUTHOR: AAE	CONCEPT DRAWING NO: C 23986807_3.7	
ACCT. MGR. JCB	SCALE: 1/4" = 1' - 0"	
REV: 05	SIGN TYPE. PARKING	QUOTE: OPEN
	SHEET NO: 6	

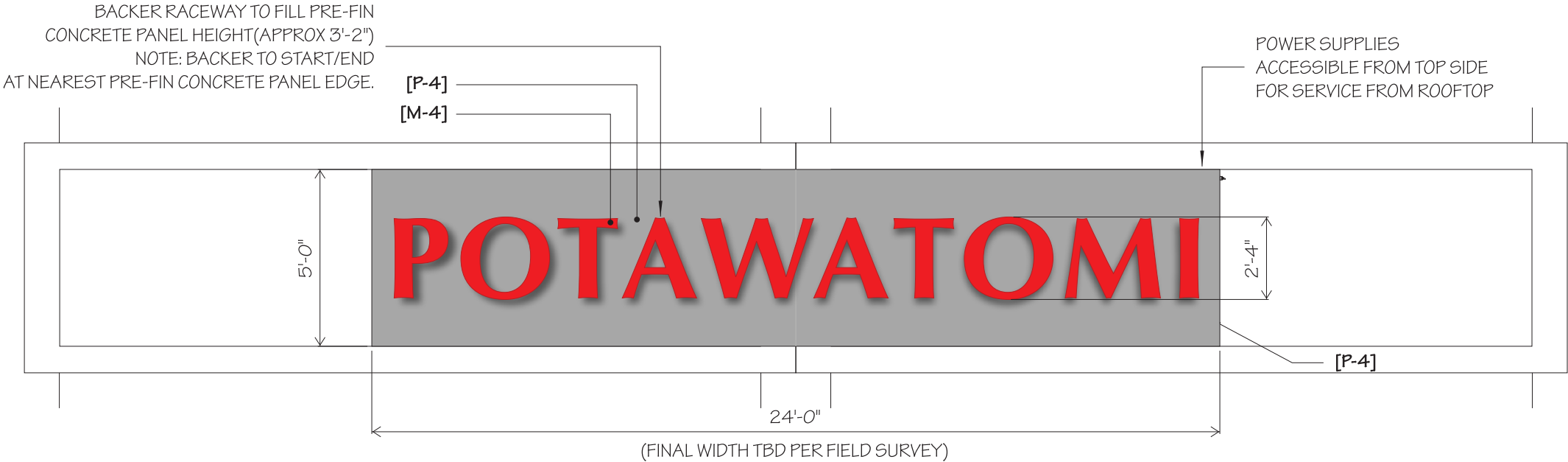

G

1

6

GARAGE, FACE-LIT "POTAWATOMI" LETTERS - WEST GARAGE

1/4" = 1' - 0" SCALE

Bottom of sign to Grade is 24'



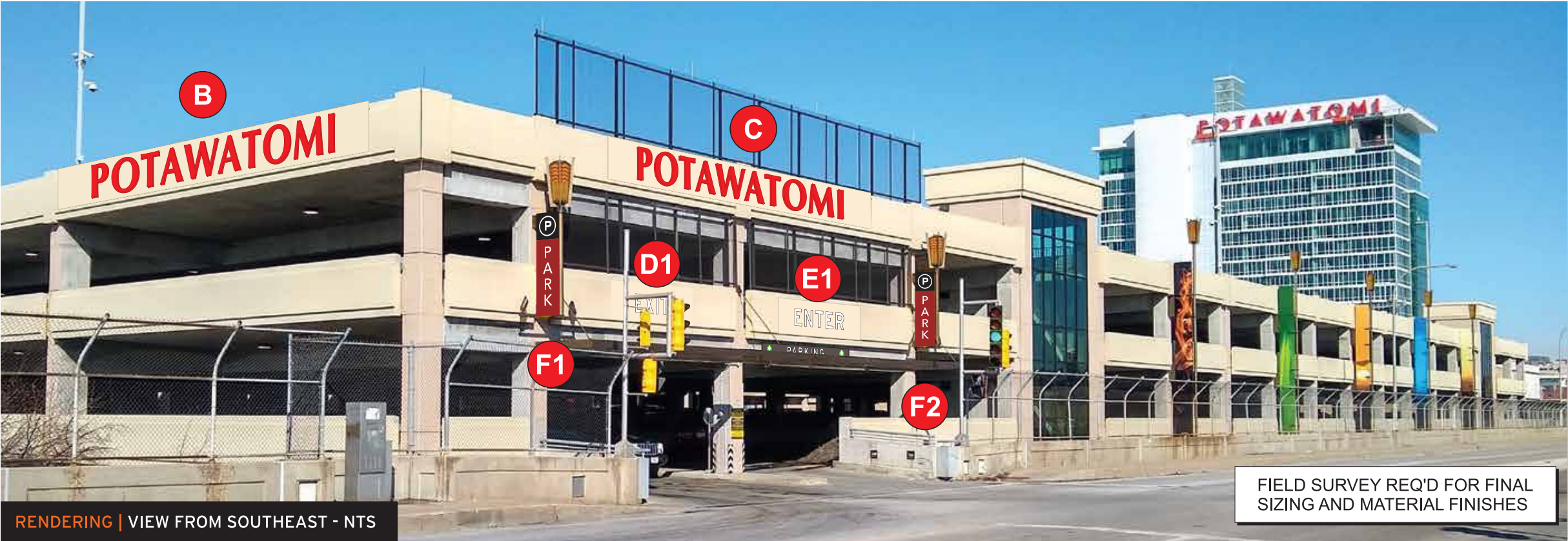



 1827 W. Glendale Ave. Milwaukee, WI 53209

 414.264.5504

 414.262.5564

 www.signeffecttz.com

Disclaimer:

THIS IS AN ORIGINAL DESIGN CREATED BY SIGN EFFECTTZ. THE SUBMITTED DESIGN PROTECTED UNDER COPYRIGHT LAWS OF THE UNITED STATES CODE YOU AGREE NOT TO COPY PHOTOGRAPH MODIFY OR SHARE DIRECTLY OR INDIRECTLY ANY OF THE FOREGOING HELD BY YOU WITH ANY OTHER PARTY. NOR WILL YOU PERMIT ANY THIRD PARTY TO DO ANY OF THE FOREGOING WITHOUT THE WRITTEN CONSENT OF SIGN EFFECTTZ.

THIS SIGN IS INTENDED TO BE INSTALLED IN ACCORDANCE WITH THE REQUIREMENTS OF ARTICLE 600 OF THE NEC AND/OR OTHER APPLICABLE LOCAL CODES. THIS INCLUDES PROPER GROUNDING AND BONDING OF THE SIGN

CUSTOMER:

Potawatomi Casino | Hotel

PROJECT:

2025 Parking Garage Exterior

SCOPE OF WORK:

PROJECT ADDRESS:

Potawatomi Casino | Hotel  
1721 W Canal St.  
Milwaukee, WI 53233

BILLING ADDRESS:

Potawatomi Casino | Hotel  
1721 W Canal St.  
Milwaukee, WI 53233

REV.	DESCRIPTION	DATE	INIT
01	copy replaced w/ "Interstate" for dimensionals	10/03/24	AAE
02	"PARKING" over exit, "ENTRANCE" over entry	10/30/24	AAE
03	"EXIT" and "ENTER" added	11/14/24	AE
04	presentation re-organized for permitting	04/30/25	AE
05			
06			
07			
08			
09			
10			

PROJECT NOTES:

A.) FINAL SIZING TBD PER FIELD SURVEY.

Copyright © 2024 Sign Effecttz Inc. All Rights Reserved

SHEET SIZE:	DEPT.	DATE OF ISSUE:
B	CONCEPT	06/28/24
AUTHOR:	CONCEPT DRAWING NO:	
AAE	C 23986807_3.7	
ACCT. MGR.	SCALE:	AS NOTED
JCB	QUOTE:	OPEN
REV:	SIGN TYPE:	SHEET NO:
04	PARKING	9



POTAWATOMI™  
PARKING GARAGE 2025  
PARKING EAST ELEVATION



 **SignEffecttz™**

 1827 W. Glendale Ave. Milwaukee, WI 53209  
 414.264.5504  
 414.262.5564  
 [www.signeffecttz.com](http://www.signeffecttz.com)

**Disclaimer:**  
THIS IS AN ORIGINAL DESIGN CREATED BY SIGN EFFECTTZ. THE SUBMITTED DESIGN PROTECTED UNDER COPYRIGHT LAWS OF THE UNITED STATES CODE YOU AGREE NOT TO COPY PHOTOGRAPH MODIFY OR SHARE DIRECTLY OR INDIRECTLY ANY OF THE FOREGOING HELD BY YOU WITH ANY OTHER PARTY. NOR WILL YOU PERMIT ANY THIRD PARTY TO DO ANY OF THE FOREGOING WITHOUT THE WRITTEN CONSENT OF SIGN EFFECTTZ.  
  
THIS SIGN IS INTENDED TO BE INSTALLED IN ACCORDANCE WITH THE REQUIREMENTS OF ARTICLE 600 OF THE NEC AND/OR OTHER APPLICABLE LOCAL CODES. THIS INCLUDES PROPER GROUNDING AND BONDING OF THE SIGN

**CUSTOMER:**  
Potawatomi Casino | Hotel

**PROJECT:**  
2025 Parking Garage Exterior

**SCOPE OF WORK:**

**PROJECT ADDRESS:**  
Potawatomi Casino | Hotel  
1721 W Canal St.  
Milwaukee, WI 53233  
  
**BILLING ADDRESS:**  
Potawatomi Casino | Hotel  
1721 W Canal St.  
Milwaukee, WI 53233

REV.	DESCRIPTION	DATE	INIT
01	copy replaced w/ "Interstate" for dimensionals	10/03/24	AAE
02	"PARKING" over exit, "ENTRANCE" over entry	10/30/24	AAE
03	"EXIT" and "ENTER" added	11/14/24	AE
04	presentation re-organized for permitting	04/30/25	AE
05			
06			
07			
08			
09			
10			

**PROJECT NOTES:**  
A.) FINAL SIZING TBD PER FIELD SURVEY.

Copyright © 2024 Sign Effecttz Inc. All Rights Reserved

SHEET SIZE: <b>B</b>	DEPT. <b>CONCEPT</b>	DATE OF ISSUE: <b>06/28/24</b>
AUTHOR: <b>AAE</b>	CONCEPT DRAWING NO: <b>C 23986807_3.7</b>	
ACCT. MGR. <b>JCB</b>	SCALE: <b>AS NOTED</b>	
REV: <b>04</b>	SIGN TYPE. <b>PARKING</b>	QUOTE: <b>OPEN</b>
		SHEET NO: <b>10</b>

FIELD SURVEY REQ'D FOR FINAL  
SIZING AND MATERIAL FINISHES





 1827 W. Glendale Ave. Milwaukee, WI 53209

 414.264.5504

 414.262.5564

 www.signeffecttz.com

Disclaimer:

THIS IS AN ORIGINAL DESIGN CREATED BY SIGN EFFECTTZ. THE SUBMITTED DESIGN PROTECTED UNDER COPYRIGHT LAWS OF THE UNITED STATES CODE YOU AGREE NOT TO COPY PHOTOGRAPH MODIFY OR SHARE DIRECTLY OR INDIRECTLY ANY OF THE FOREGOING HELD BY YOU WITH ANY OTHER PARTY. NOR WILL YOU PERMIT ANY THIRD PARTY TO DO ANY OF THE FOREGOING WITHOUT THE WRITTEN CONSENT OF SIGN EFFECTTZ.

THIS SIGN IS INTENDED TO BE INSTALLED IN ACCORDANCE WITH THE REQUIREMENTS OF ARTICLE 600 OF THE NEC AND/OR OTHER APPLICABLE LOCAL CODES. THIS INCLUDES PROPER GROUNDING AND BONDING OF THE SIGN

CUSTOMER:

Potawatomi Casino | Hotel

PROJECT:

2025 Parking Garage Exterior

SCOPE OF WORK:

PROJECT ADDRESS:

Potawatomi Casino | Hotel  
1721 W Canal St.  
Milwaukee, WI 53233

BILLING ADDRESS:

Potawatomi Casino | Hotel  
1721 W Canal St.  
Milwaukee, WI 53233

REV.	DESCRIPTION	DATE	INIT
01	copy replaced w/ "Interstate" for dimensionals	10/03/24	AAE
02	"PARKING" over exit, "ENTRANCE" over entry	10/30/24	AAE
03	"EXIT" and "ENTER" added	11/14/24	AE
04	presentation re-organized for permitting	04/30/25	AE
05			
06			
07			
08			
09			
10			

PROJECT NOTES:

A.) FINAL SIZING TBD PER FIELD SURVEY.

Copyright © 2024 Sign Effecttz Inc. All Rights Reserved

SHEET SIZE: B	DEPT. CONCEPT	DATE OF ISSUE: 06/28/24
AUTHOR: AAE	CONCEPT DRAWING NO: C 23986807_3.7	
ACCT. MGR. JCB	SCALE: AS NOTED	
	QUOTE: OPEN	
REV: 04	SIGN TYPE. PARKING	SHEET NO: 12