

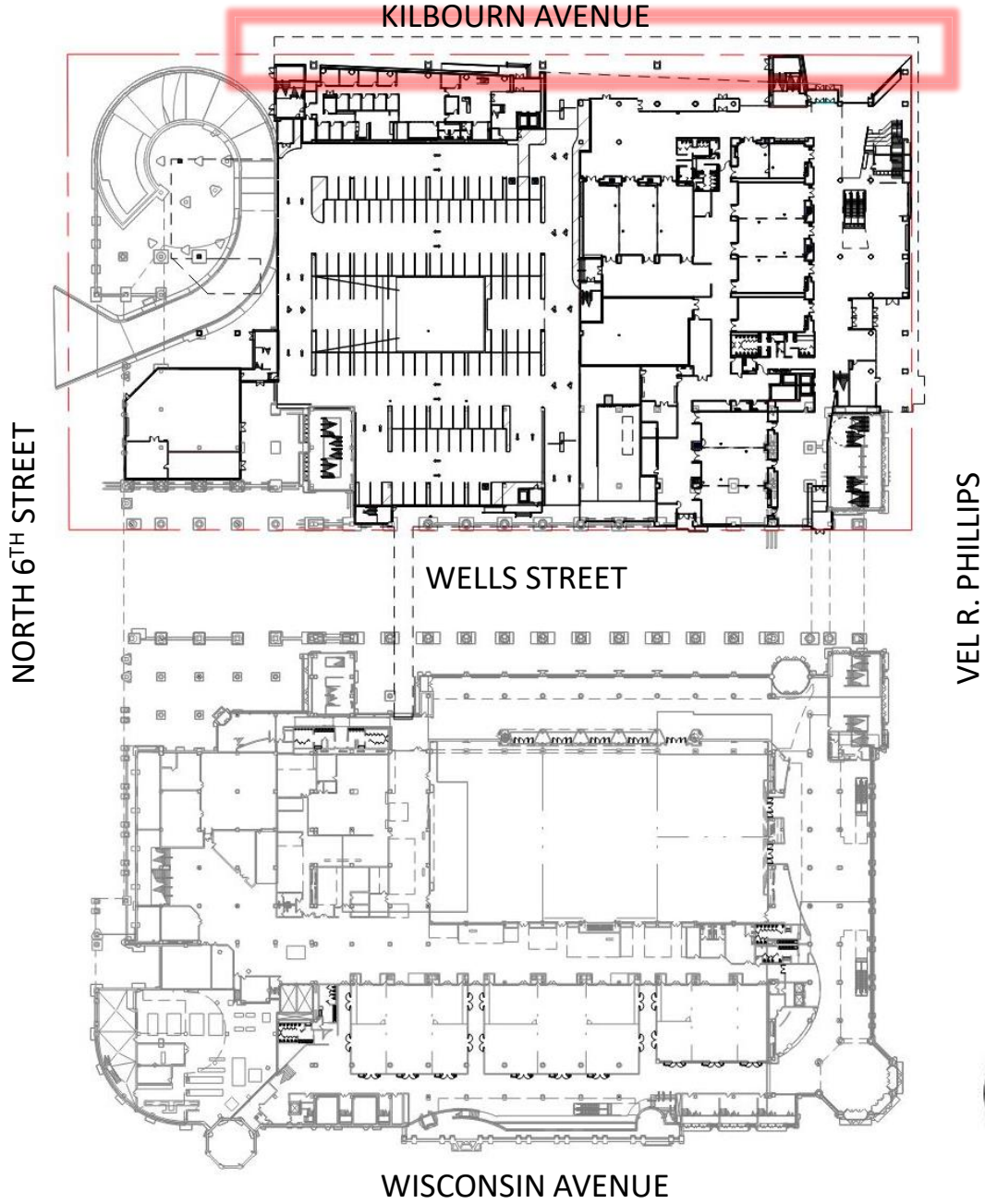

# WISCONSIN CENTER EXPANSION

PROPOSED AIR RIGHTS



KILBOURN AVENUE

NORTH 6TH STREET

WELLS STREET

VEL R. PHILLIPS

WISCONSIN AVENUE





NORTH ELEVATION

SOFFIT/BALCONY  
OVERHANG

EXHIBIT HALL FLOOR AND  
WALL OVERHANG

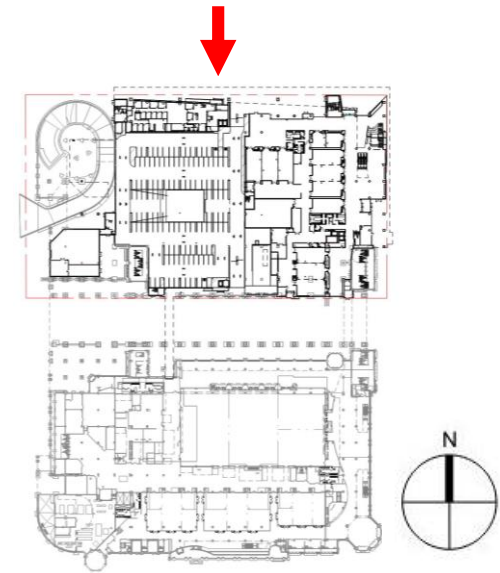

15'-0 1/2" TO CURB LINE

14'-2 7/8" OVER ROW

SOFFIT/BALCONY OVERHANG

EXHIBIT HALL FLOOR AND WALL OVERHANG

87'-0" FROM STREET LEVEL

9'-2 7/8" OVER ROW

37'-0 3/4" FROM STREET LEVEL

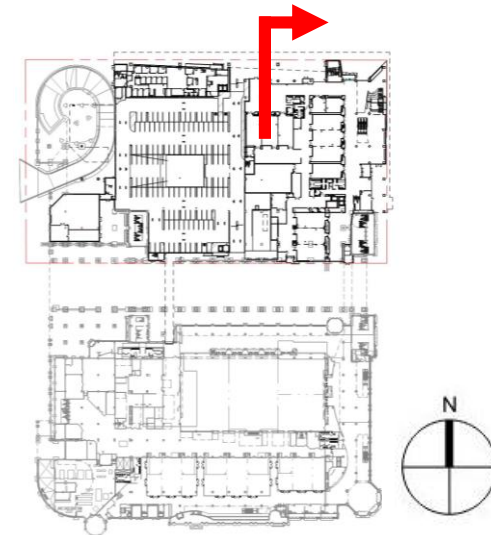
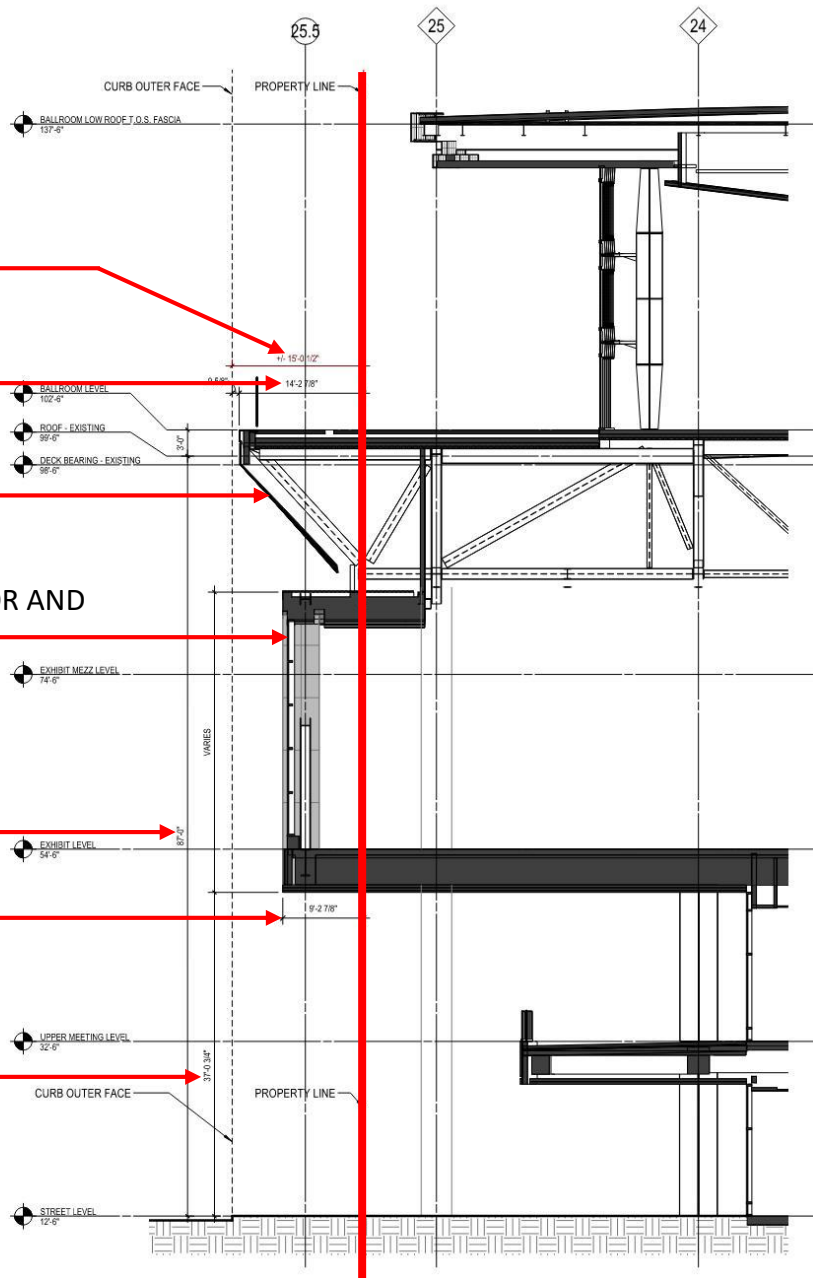



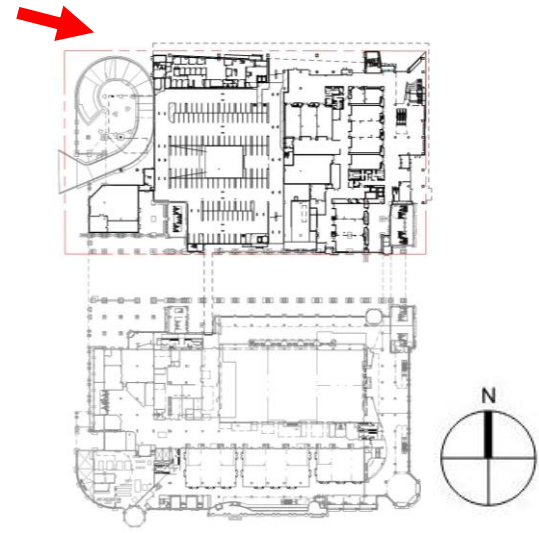

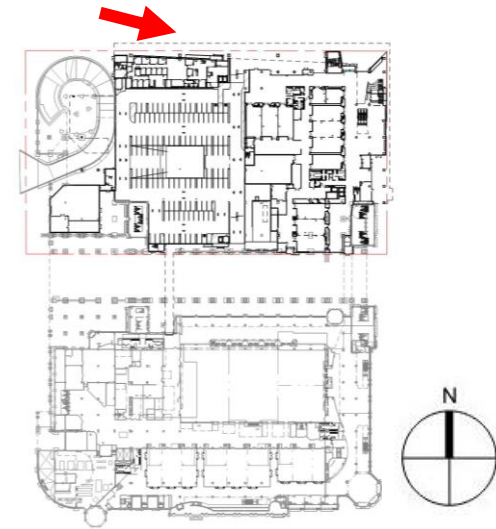



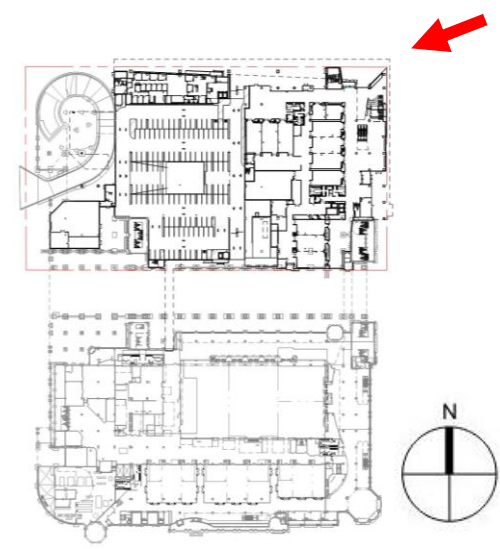

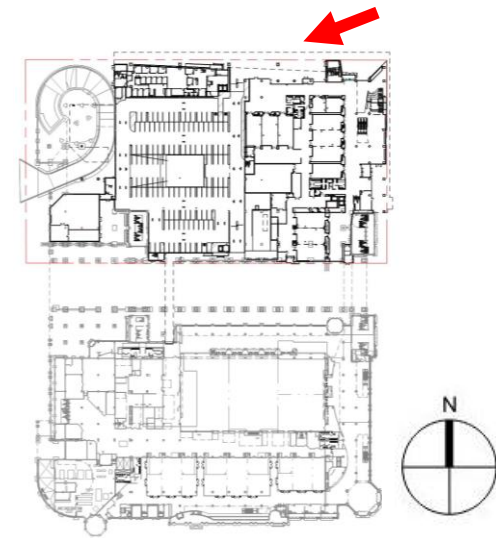



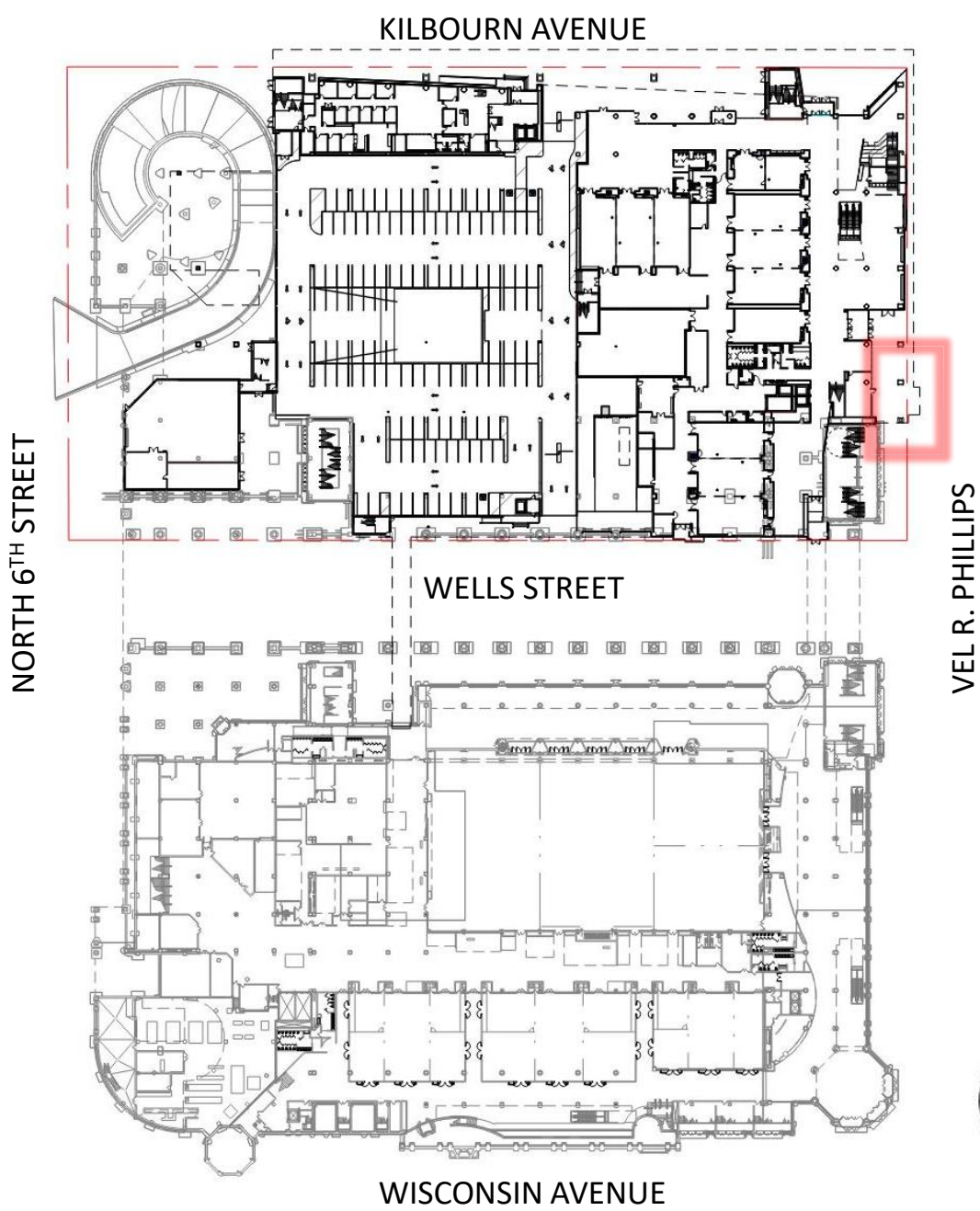

KILBOURN AVENUE

NORTH 6<sup>TH</sup> STREET

WELLS STREET

VEL R. PHILLIPS

WISCONSIN AVENUE



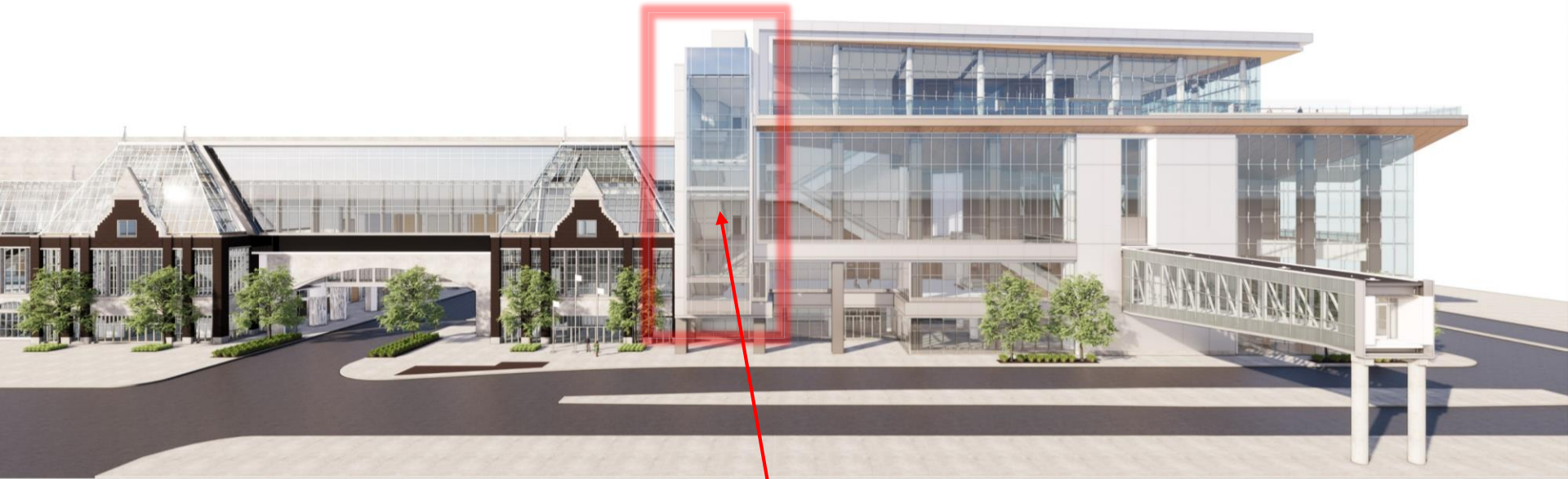

EAST ELEVATION

STAIR TOWER  
OVERHANG

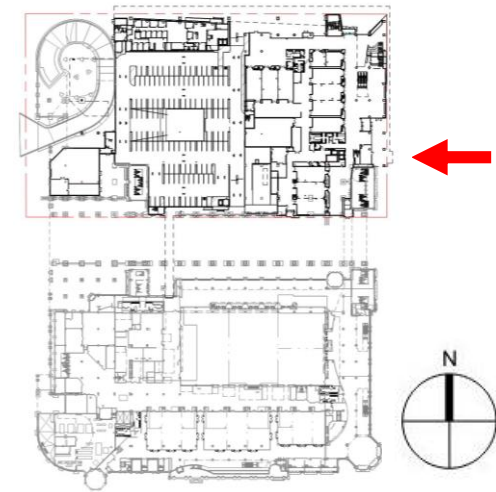

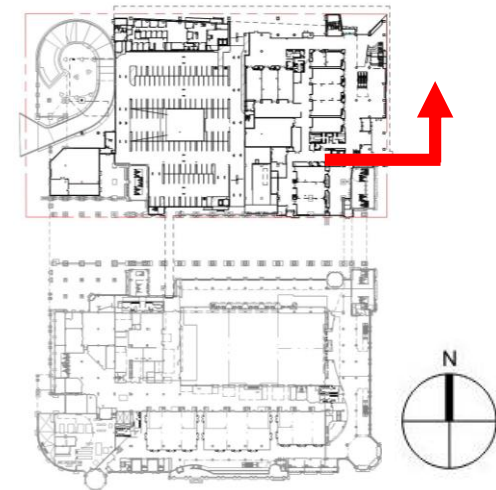
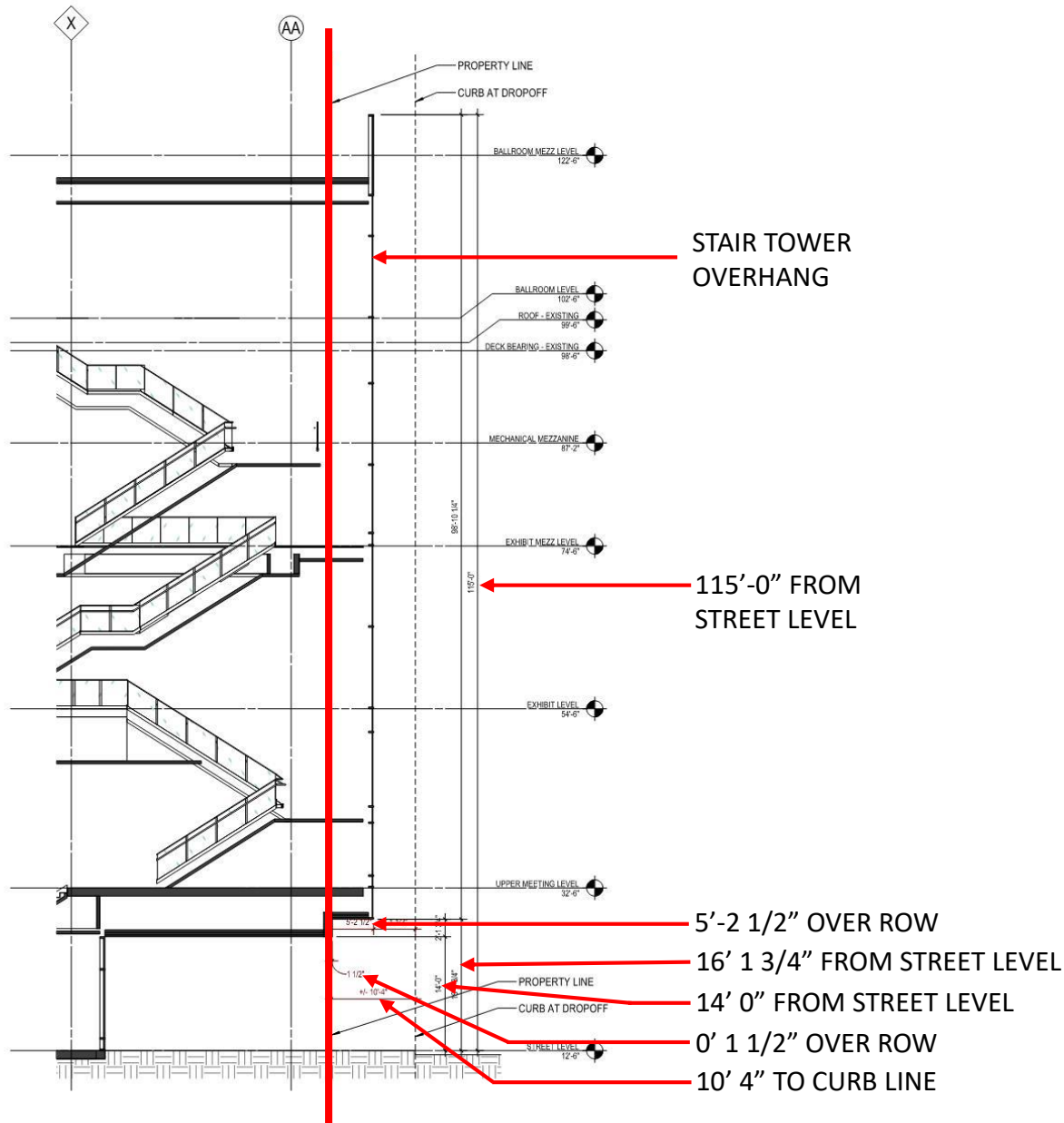

VEL R. PHILLIPS OVERHANGS  
WISCONSIN CENTER EXPANSION



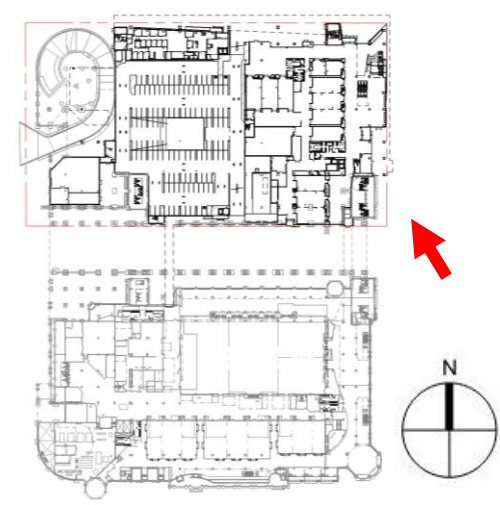

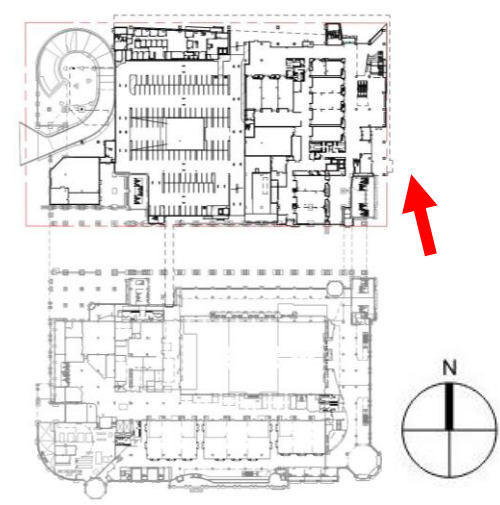



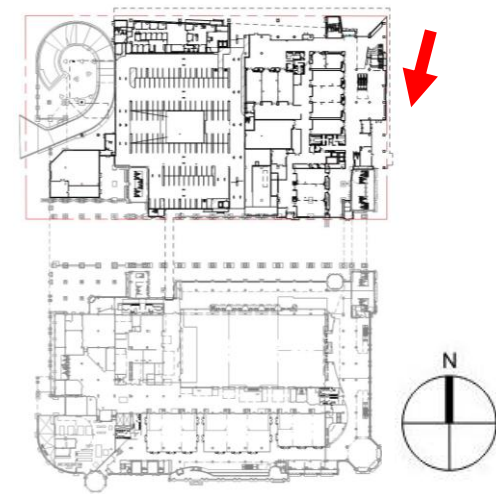



KILBOURN AVENUE

NORTH 6<sup>TH</sup> STREET

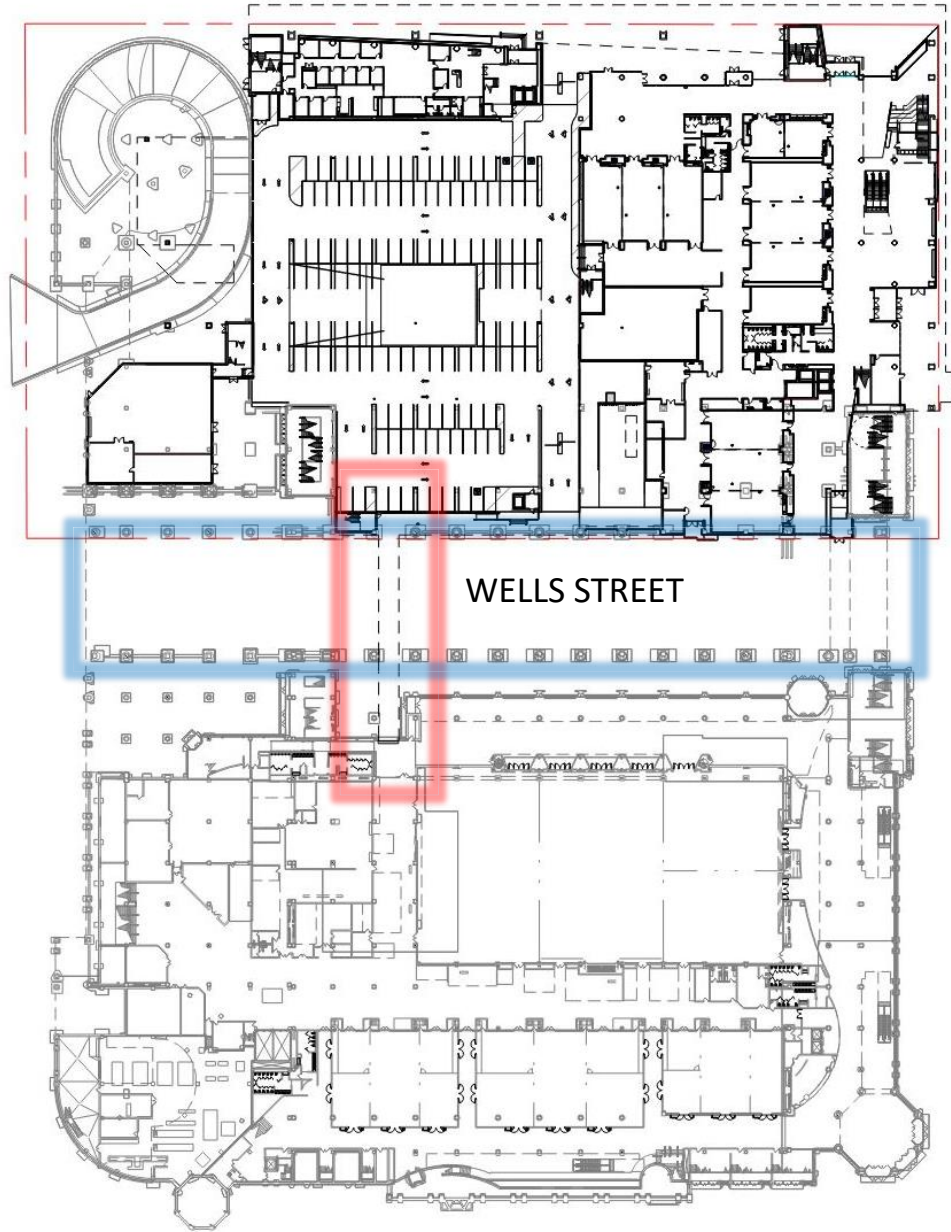

WELLS STREET

VEL R. PHILLIPS

WISCONSIN AVENUE





EXISTING EAST ELEVATION OVER WELLS STREET

ALL EXISTING WELLS STREET OVERHANGS TO REMAIN

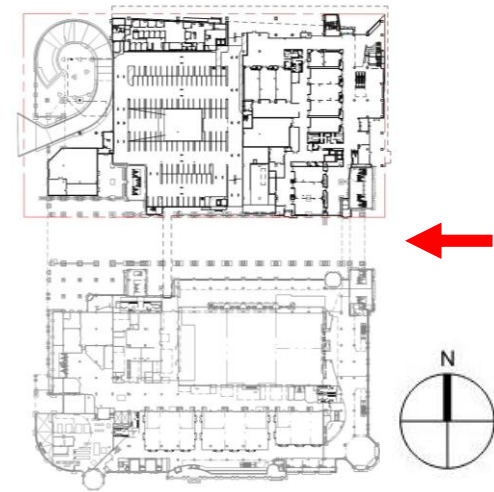

WELLS STREET OVERHANGS  
WISCONSIN CENTER EXPANSION



EXISTING WEST ELEVATION

ADDITION OF NEW BACK OF HOUSE SERVICE  
CORRIDOR FOR INTERNAL STAFF USE

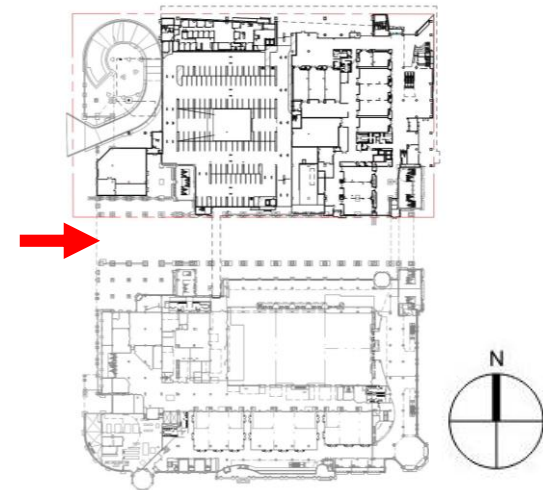





PROPOSED BACK OF HOUSE SERVICE CORRIDOR



EXISTING CONDITIONS LOOKING WEST

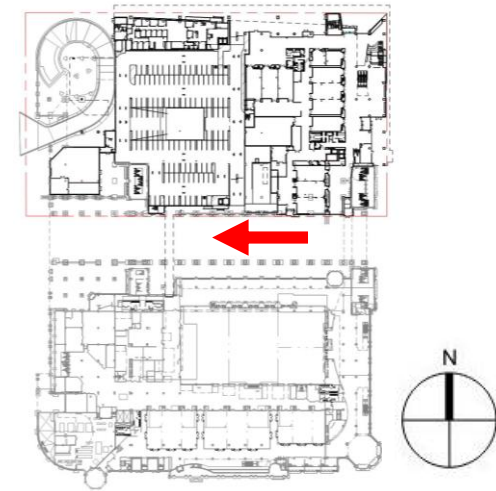

WELLS STREET OVERHANGS  
WISCONSIN CENTER EXPANSION



PROPOSED BACK OF HOUSE SERVICE CORRIDOR

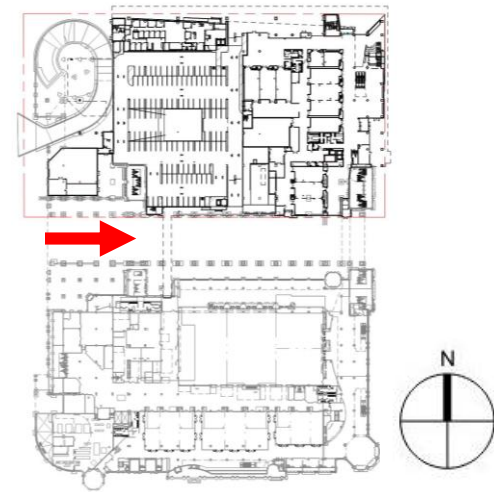

NORTH 6<sup>TH</sup> STREET

KILBOURN AVENUE

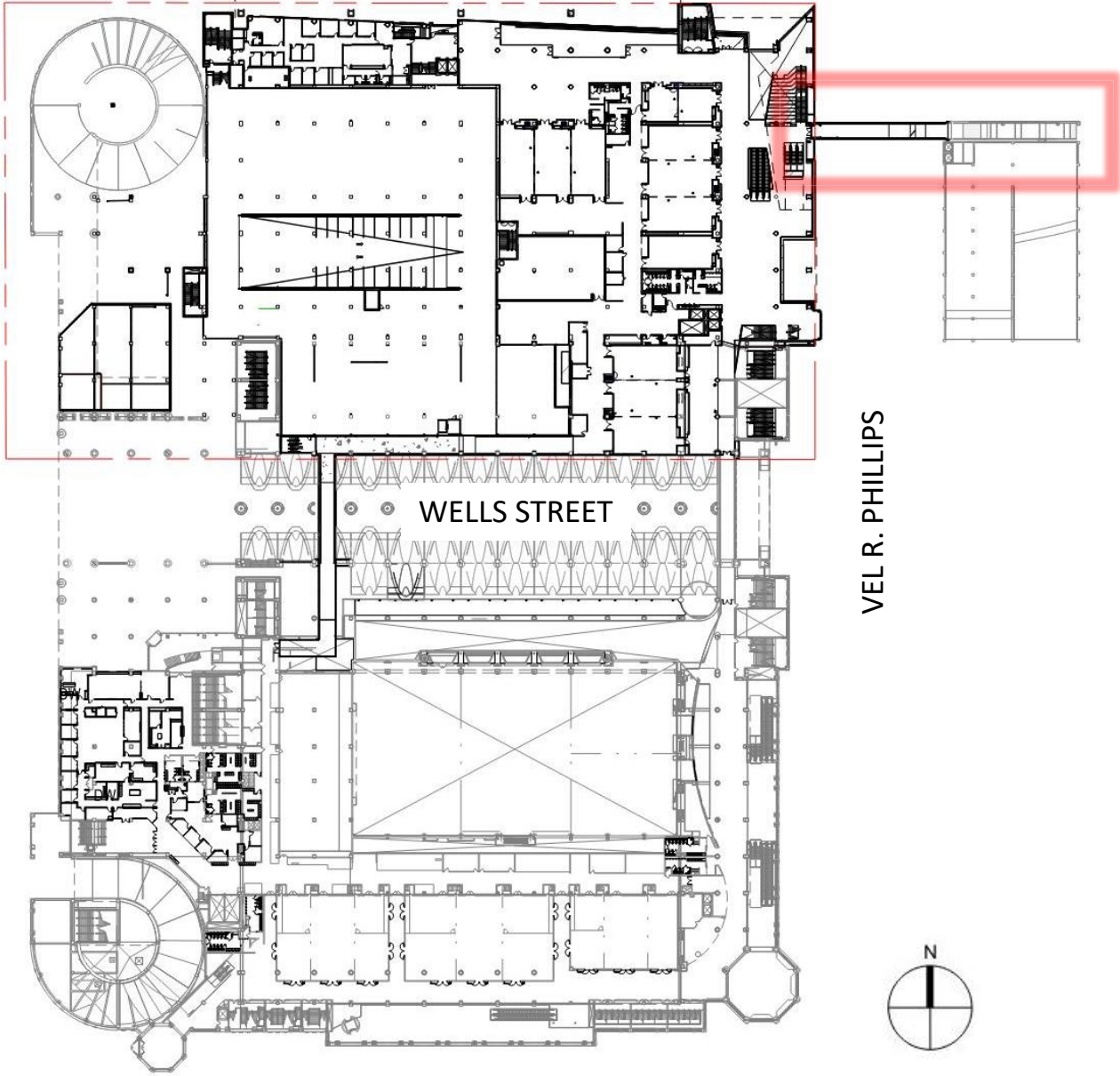

WELLS STREET

VEL R. PHILLIPS

WISCONSIN AVENUE





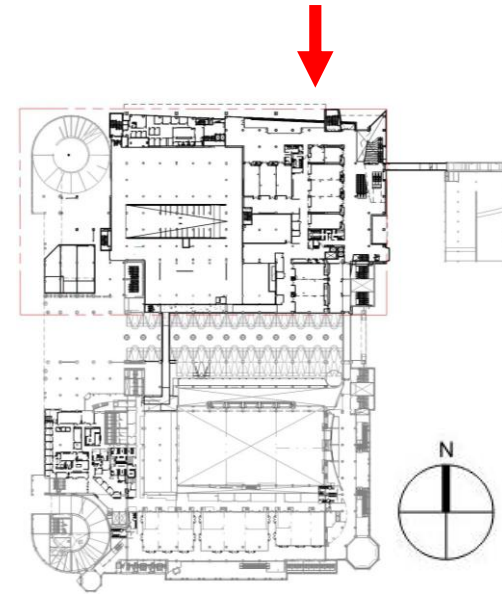

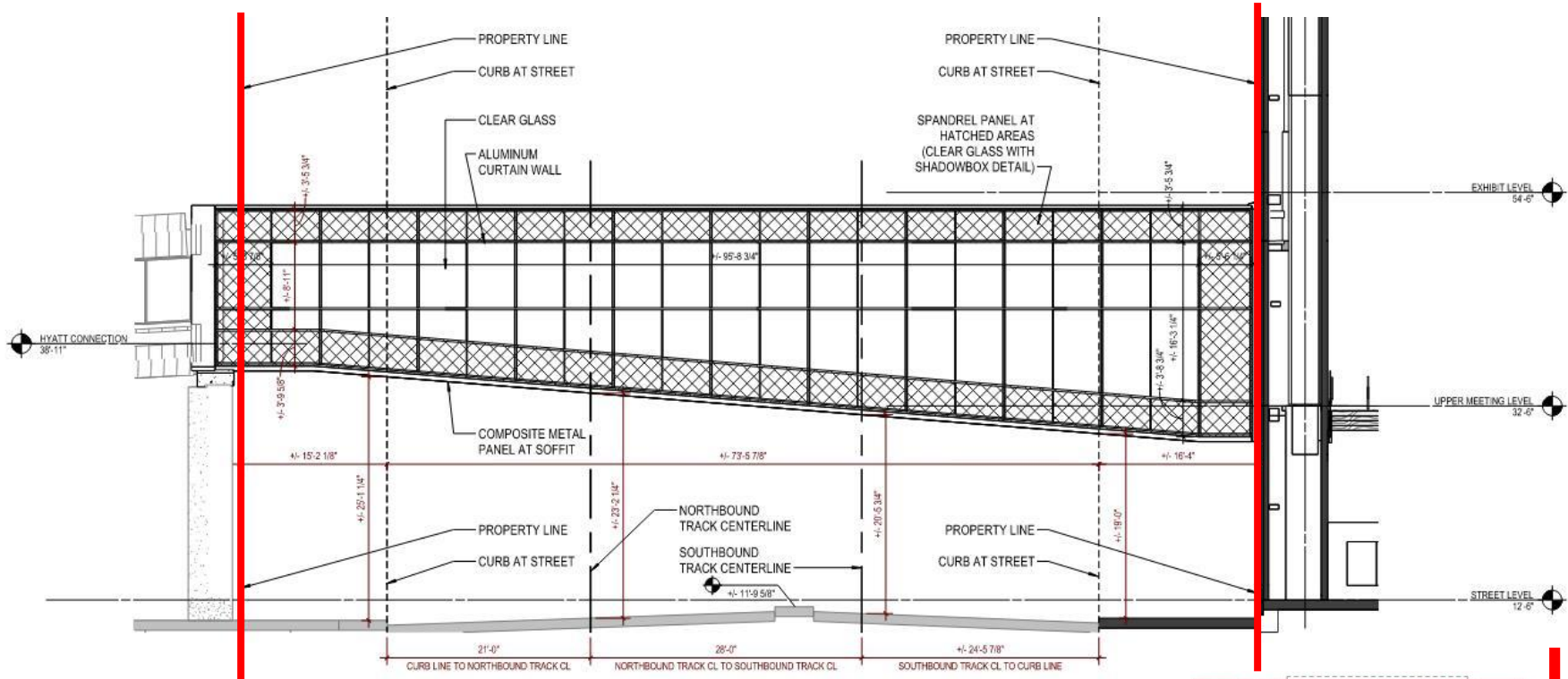

### ELEVATION VIEW OF SKYBRIDGE DESIGN AND DIMENSIONS

+23'-0" CLEAR AT CENTERLINE OF FUTURE NORTHBOUND TRAIN  
 +20'-0" CLEAR AT CENTERLINE OF FUTURE SOUTHBOUND TRAIN  
 (19'-0" CLEAR REQUIRED AT CENTERLINE)

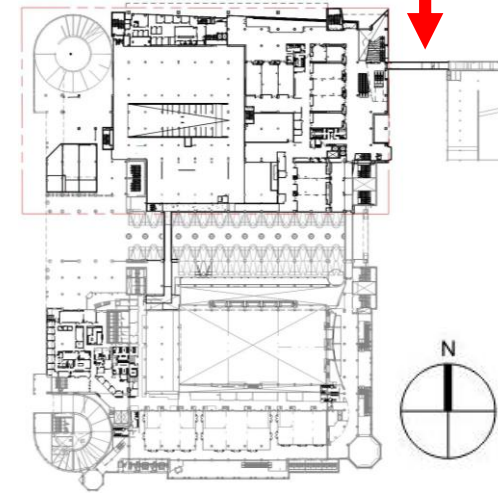

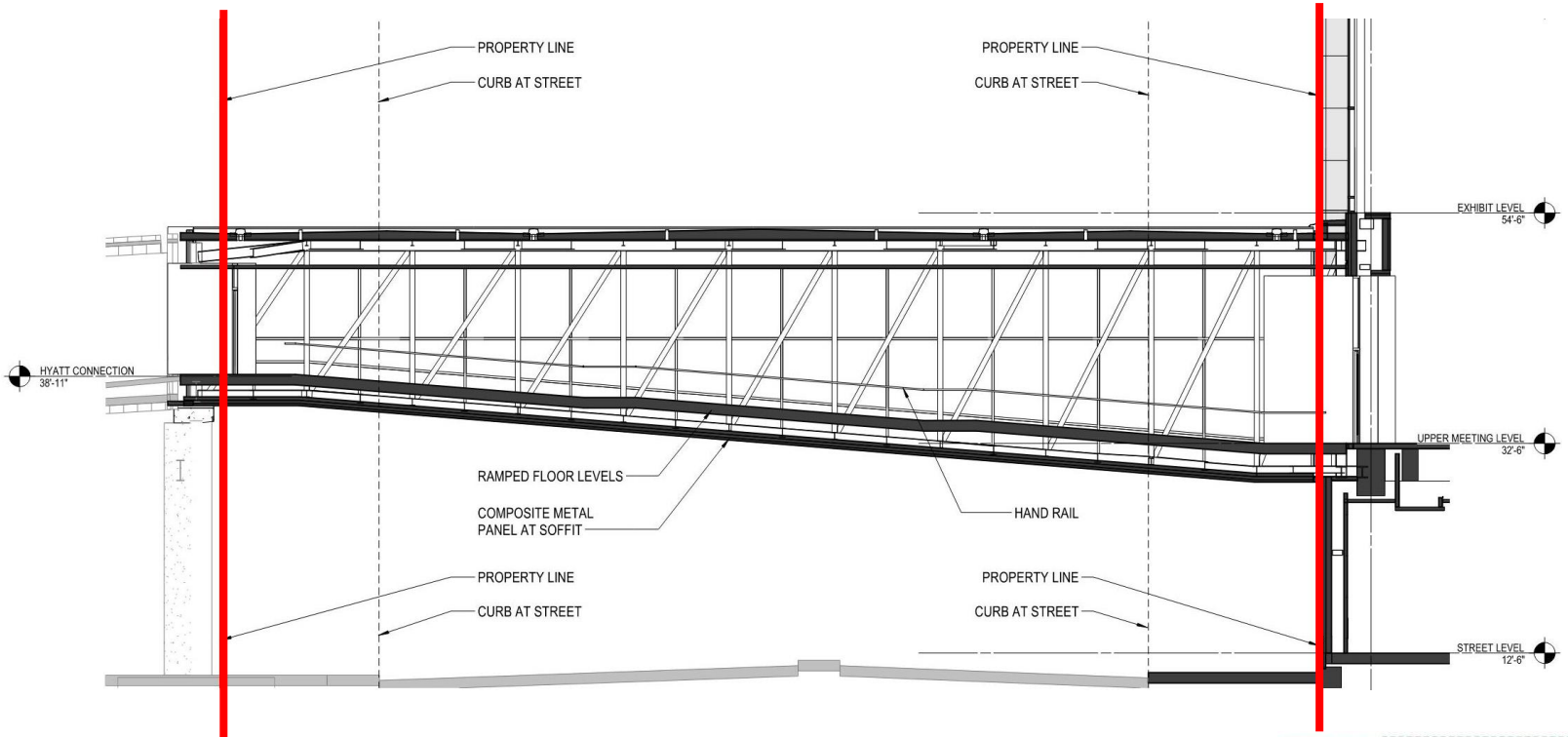

SECTION VIEW THROUGH THE SKYBRIDGE

APPROXIMATELY 6'-6" CHANGE IN ELEVATION FROM WISCONSIN CENTER TO THE EXISTING HYATT SKYWALK CONNECTION

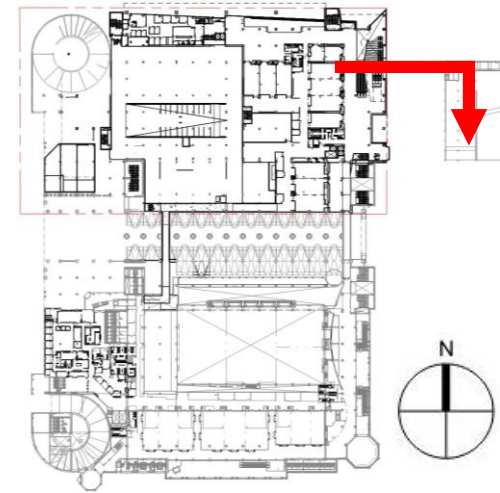



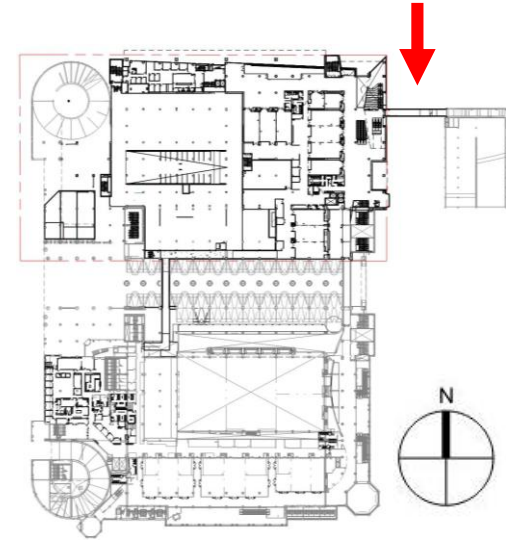

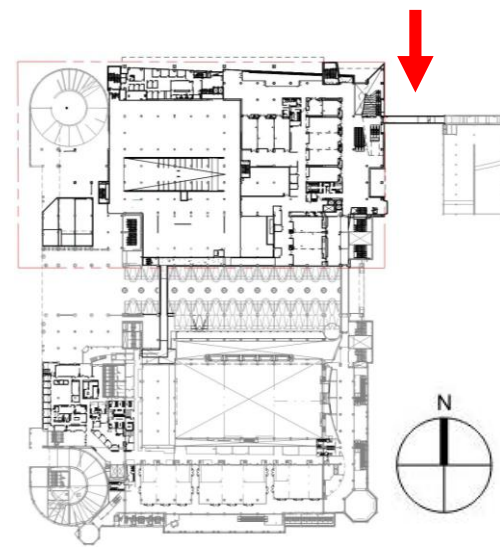



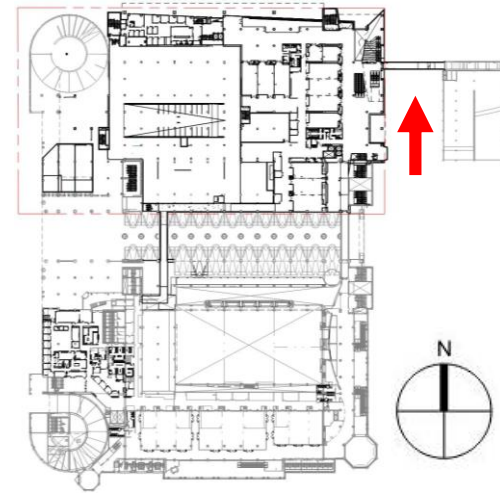





tvstdesign