

STAKING NOTES

1. ALL CURB RADI ARE 5 FEET UNLESS NOTED OTHERWISE.
2. ALL DIMENSIONS ARE MEASURED FROM FACE OF CURB AND FACE OF FINISHED STRUCTURE UNLESS NOTED OTHERWISE.
3. ALL DRIVE AISLES ARE 24' UNLESS NOTED OTHERWISE.
4. PARKING SPACES ARE 9' x 18'. HANDICAP SPACES ARE 8' x 18'.
5. TOPOGRAPHIC SURVEY WAS PROVIDED BY THE SITS GROUP DATED JULY 1, 2005. THE BASE SURVEY IS GIVEN ON SHEET C-2 OF THIS DRAWING SET. ALL EXISTING SITE CONDITIONS SHALL BE DETERMINED BY EXAMINATION OF THE SURVEY SHEET.

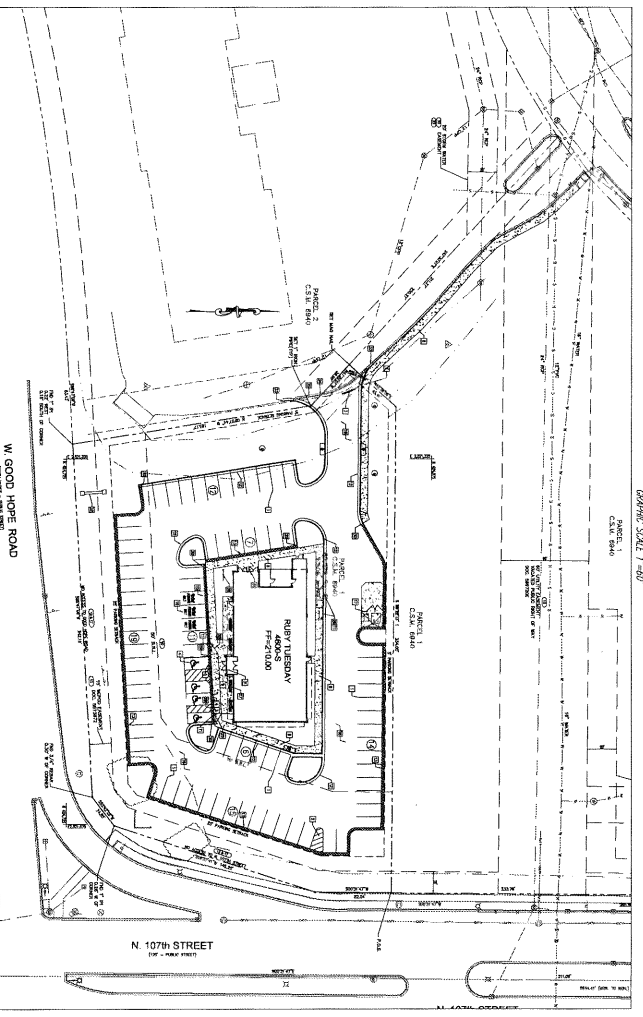

STAKING AND STRIPING KEYS

- (CONTRACTOR TO VERIFY ALL QUANTITIES PRIOR TO BID)
- 1 STRIPING (TYP)
 - 2 NO PARKING STRIPING (TYP. OF 3)
 - 3 STOP BAR (1-10) (TYP. OF 1)
 - 4 INTERNATIONAL HANDICAP SWMBL (TYP. OF 4)
 - 5 VAN ACCESSIBLE SIGN (TYP. OF 2)
 - 6 STOP SIGN
 - 7 RESERVED PARKING SIGN (TYP. OF 4)
 - 8 CONCRETE SIDEWALK (TYPE A); IT SHOULD BE NOTED THAT ALL SIDEWALK BEYOND RUBY TUESDAY PROPERTY SHALL BE DONE BY OTHERS.
 - 9 CONCRETE SIDEWALK (TYPE B)
 - 10 NOT USED
 - 11 CURB TRANSITION (1-8)
 - 12 CONCRETE CURB AND GUTTER (TYP)
 - 13 REVERSE CURB AND GUTTER (TYP)
 - 14 NOT USED
 - 15 WHEEL STOP (TYP. OF 8)
 - 16 TO CO PARKING (TYP. OF 3) (STRIPING AND SIGNAGE)
 - 17 BOLLARD (TYP. OF 2)
 - 18 BITUMINOUS PAVEMENT
 - 19 STANDARD PAVEMENT SECTION
 - 20 HEAVY DUTY PAVEMENT SECTION
 - 21 SIDEWALK RAMP (TYP. OF 4)
 - 22 BENCHES (TYP. OF 4) SEE LANDSCAPE DETAILS, SHEET L-3.
 - 23 NOT USED
 - 24 DEPRESSED CURB
 - 25 CONTRACTOR SHALL PROVIDE TRANSITION FROM REVERSE CUTTER TO STANDARD GUTTER PANEL (TYP. ALL LOCATIONS)
 - 26 WALL SIGNAGE REQUIREMENTS:
 - 27 A. ALLOWED SIGNAGE:
 - a. 2 WALL SIGNMENTS
 - b. EACH SIGN SHALL NOT EXCEED 20 SQ. FT. AND SHALL BE:
 - B. SIGNAGE RECOMMENDED - 2 WALL SIGNS
 - d. ONE SIGN N. 107TH ST. AREA = 20 SF
 - e. TOTAL SIGN AREA = 40 SF
 - 28 C. SIGN CONTRACTOR SHALL OBTAIN ALL SIGN PERMITS PRIOR TO CONSTRUCTION.
 - 29 D. ALL SIGNAGE MUST BE APPROVED BY THE ROUTE COMPANY E. ALL NEON TO BE REVIEWED BY THE ROUTE COMPANY.
 - 29 FRESHSTANDING SIGN:
 - A. ALLOWED SIGNAGE:
 - a. MAXIMUM AREA = 50 SF
 - b. MAXIMUM HEIGHT = 10 FT
 - B. SIGNAGE RECOMMENDED:
 - 1 FRESHSTANDING SIGN TO BE LOCATED AT THE INTERSECTION OF W. GOOD HOPE ROAD AND N. 107TH ST.
 - 30 THE PROPOSED CURB TO EXISTING CURB NINE & AT GRADE
 - 31 CONTRACTOR TO REMOVE APPROX. 60 LF. OF EX. CURB & GUTTER
 - 32 THE PROPOSED PAVEMENT INTO EXISTING PAVEMENT NINE & AT GRADE
 - 33 BICYCLE RACK

DATE: 9/1/05
 JOB NUMBER: W3290101
 FILE NAME: C-03 STAK 3590
 PLOTTED: 12/09/05
 DRAWN BY: WJE

GRAPHIC SCALE 1"=40'

STAKING AND STRIPING PLAN
 SHEET C-3
 3 OF 17

SITE DEVELOPMENT PLANS FOR:
RUBY TUESDAY RESTAURANT
 10831 W. PARK PLACE
 PARCEL 1
 MILWAUKEE COUNTY
 CITY OF MILWAUKEE, WISCONSIN



The **RBA** Group
 ENGINEERS • ARCHITECTS • PLANNERS
 764 Columbia Gateway Drive, Suite 205
 Columbia, Maryland 21046
 Phone (410) 312-0966, Fax (410) 312-0897

PLANS PREPARED FOR:
RUBY TUESDAY, INC
 10560 MAIN STREET
 SUITE 511
 FAIRFAX, VIRGINIA 22030
 (703) 383-5875