



CITY OF MILWAUKEE
OFFICE OF THE CITY CLERK

Tuesday, November 19, 2024

COMMITTEE MEETING NOTICE

AD 08

FLORES CAMPOS, Elizabeth V, Agent
Flautas Y Chilaquiles Los Villa LLC
3530 W National Av
Milwaukee, WI 53215

You are requested to attend a hearing which is to be held in Room 301-B, Third Floor, City Hall or you may attend virtually using the link below.

Tuesday, December 03, 2024 at 01:50 PM

The access code is <https://meet.goto.com/904159581>. Please see the enclosed best practices document for further instructions.

Regarding: Your Class B Tavern License Application as agent for "Flautas Y Chilaquiles Los Villa LLC" for "Flautas Y Chilaquiles Los Villa" at 3530 W National Av. 

There is a possibility that your application may be denied for one or more of the following reasons: The recommendation of the committee regarding the application shall be based on evidence presented at the hearing. Per MCO 85-2.7-4, probative evidence concerning whether or not a new license should be granted may be presented on the following subjects: whether or not the applicant meets the municipal requirements, the appropriateness of the location and premises where the licensed premises is to be located and whether use of the premises for the purposes or activities permitted by the license would tend to facilitate a public or private nuisance or create undesirable neighborhood problems such as disorderly patrons, unreasonably loud noise, litter, and excessive traffic and parking congestion. Probative evidence relating to these matters may be taken from the plan of operation submitted with the license application, if any, but shall not include the content of any music. Evidence regarding the fitness of the location of the premises to be maintained as the principal place of business, including but not limited to whether there is an overconcentration of businesses of the type for which the license is sought; whether the proposal is consistent with any pertinent neighborhood business or development plans, or the location's proximity to areas where children are typically present. The applicant's record in operating similarly licensed premises; and whether or not the applicant has been charged with or convicted of any felony, misdemeanor, municipal offense or other offense, the circumstances of which substantially relate to the activity to be permitted by the license being applied for or any other factor which reasonably relates to the public health, safety or welfare may also be considered. See attached police report or correspondence.

Notice for applicants with warrants or unpaid fines: Proof of warrant satisfaction or payment of fines must be submitted at the hearing on the above date and time. Failure to comply with this requirement may result in a delay of the granting/denial of your application.

Failure to appear at this meeting may result in the denial of your license. Individual applicants must appear only in person or by an attorney. Corporate or Limited Liability applicants must appear only by the agent designated on the application or by an attorney. Partnership applicants must appear by a partner listed on the application or by an attorney. If you wish to do so and at your own expense, you may be accompanied by an attorney of your choosing to represent you at this hearing.

You will be given an opportunity to speak on behalf of the application and to respond and challenge any charges or reasons given for the denial. No petitions can be accepted by the committee, unless the people who signed the petition are present at the committee hearing and willing to testify. You may present witnesses under oath and you may also confront and cross-examine opposing witnesses under oath. If you have difficulty with the English language, you should bring an interpreter with you, at your expense, so that you can answer questions and participate in your hearing.

You may examine the application file at this office during regular business hours prior to the hearing date. Inquiries regarding this matter may be directed to the person whose signature appears below.

Limited parking for persons attending meetings during normal business hours is available at reduced rates (5 hour limit) at the Milwaukee Center on the southwest corner of Kilbourn Avenue and Water Street. You must present a copy of the meeting notice to the parking cashier.

PLEASE NOTE: Upon reasonable notice, efforts will be made to accommodate the needs of disabled individuals through sign language interpreters or other auxiliary aids. For additional information or to request this service, contact the Council Services Division ADA Coordinator at (414) 286-2998, Fax - (414) 286-3456, TDD - (414) 286-2025.

JIM OWCZARSKI, CITY CLERK

BY: _____
Jim Cooney
License Division Manager

If you have questions regarding this notice, please contact the License Division at (414) 286-2238.

200 E. Wells Street, Room 105, City Hall, Milwaukee, WI 53202. www.milwaukee.gov/license
Phone: (414) 286-2238 Fax: (414) 286-3057 Email Address: License@milwaukee.gov



**CITY OF MILWAUKEE
OFFICE OF THE CITY CLERK**

Tuesday, November 19, 2024

COMMITTEE MEETING NOTICE

AD 08

FLORES CAMPOS, Elizabeth V, Agent
Flautas Y Chilaquiles Los Villa LLC
405 EMERSON AV
South Milwaukee, WI 53172

You are requested to attend a hearing which is to be held in Room 301-B, Third Floor, City Hall or you may attend virtually using the link below.

Tuesday, December 03, 2024 at 01:50 PM

The access code is <https://meet.goto.com/904159581>. Please see the enclosed best practices document for further instructions.

Regarding: Your Class B Tavern License Application as agent for "Flautas Y Chilaquiles Los Villa LLC" for "Flautas Y Chilaquiles Los Villa" at 3530 W National Av.

There is a possibility that your application may be denied for one or more of the following reasons: The recommendation of the committee regarding the application shall be based on evidence presented at the hearing. Per MCO 85-2.7-4, probative evidence concerning whether or not a new license should be granted may be presented on the following subjects: whether or not the applicant meets the municipal requirements, the appropriateness of the location and premises where the licensed premises is to be located and whether use of the premises for the purposes or activities permitted by the license would tend to facilitate a public or private nuisance or create undesirable neighborhood problems such as disorderly patrons, unreasonably loud noise, litter, and excessive traffic and parking congestion. Probative evidence relating to these matters may be taken from the plan of operation submitted with the license application, if any, but shall not include the content of any music. Evidence regarding the fitness of the location of the premises to be maintained as the principal place of business, including but not limited to whether there is an overconcentration of businesses of the type for which the license is sought; whether the proposal is consistent with any pertinent neighborhood business or development plans, or the location's proximity to areas where children are typically present. The applicant's record in operating similarly licensed premises; and whether or not the applicant has been charged with or convicted of any felony, misdemeanor, municipal offense or other offense, the circumstances of which substantially relate to the activity to be permitted by the license being applied for or any other factor which reasonably relates to the public health, safety or welfare may also be considered. See attached police report or correspondence.

Notice for applicants with warrants or unpaid fines:

Proof of warrant satisfaction or payment of fines must be submitted at the hearing on the above date and time. Failure to comply with this requirement may result in a delay of the granting/denial of your application.

Failure to appear at this meeting may result in the denial of your license. Individual applicants must appear only in person or by an attorney. Corporate or Limited Liability applicants must appear only by the agent designated on the application or by an attorney. Partnership applicants must appear by a partner listed on the application or by an attorney. If you wish to do so and at your own expense, you may be accompanied by an attorney of your choosing to represent you at this hearing.

You will be given an opportunity to speak on behalf of the application and to respond and challenge any charges or reasons given for the denial. No petitions can be accepted by the committee, unless the people who signed the petition are present at the committee hearing and willing to testify. You may present witnesses under oath and you may also confront and cross-examine opposing witnesses under oath. If you have difficulty with the English language, you should bring an interpreter with you, at your expense, so that you can answer questions and participate in your hearing.

You may examine the application file at this office during regular business hours prior to the hearing date. Inquiries regarding this matter may be directed to the person whose signature appears below.

Limited parking for persons attending meetings during normal business hours is available at reduced rates (5 hour limit) at the Milwaukee Center on the southwest corner of Kilbourn Avenue and Water Street. You must present a copy of the meeting notice to the parking cashier.

PLEASE NOTE: Upon reasonable notice, efforts will be made to accommodate the needs of disabled individuals through sign language interpreters or other auxiliary aids. For additional information or to request this service, contact the Council Services Division ADA Coordinator at (414) 286-2998, Fax - (414) 286-3456, TDD - (414) 286-2025.

JIM OWCZARSKI, CITY CLERK

BY: _____

Jim Cooney
License Division Manager

If you have questions regarding this notice, please contact the License Division at (414) 286-2238.

200 E. Wells Street, Room 105, City Hall, Milwaukee, WI 53202. www.milwaukee.gov/license
Phone: (414) 286-2238 Fax: (414) 286-3057 Email Address: License@milwaukee.gov

MILWAUKEE POLICE DEPARTMENT LICENSING

CRIMINAL RECORD/ORDINANCE VIOLATION/INCIDENTS SYNOPSIS

DATE: 11/05/24

LICENSE TYPE: Class B Tavern

NEW:

RENEWAL:

No. 373288

Application Date:

License Location: 3530 W National

Business Name: Fluatas Y Chilaquiles

Licensee/Applicant: Flores-Campos, Elizabeth V
(Last Name, First Name, MI)

Date of Birth: 12/13/86

Home Address: 8412 W. Morgan Av

City: Milwaukee

State: WI **Zip Code:** 53216

Home Phone:

This report is written by Police Officer Monreal, assigned to the License Investigation Unit, Days.

The Milwaukee Police Department's investigation regarding this application revealed the following:

1. On 03/14/19 the applicant was charged in Waukesha County with Theft – Moveable Property.

Charge: Theft
Finding: Guilty
Sentence: Fine
Date: 03/14/19
Case: 2019CF000381

Date: 11-13-24
Officer: PO Matthew Diener

City of Milwaukee Police Department
90-5-1.5 Crime Prevention Survey
Tavern Inspection

Name of Premise: Flautas y Chilaquiles
Address: 3520 W National Av
Phone: 414-210-3248

Owner: Elizabeth V FLORES-CAMPOS
Owner address: 405 Emerson Av
City State Zip: South Milwaukee, WI 53172
Owner Phone: 414-399-7441
Owner email: elizabethvf1896@gmail.com

Licensee/Agent: same
Home Address:
City State Zip:
Phone:
Email:

Preferred contact:

Location currently open: YES NO

Projected open date:

Day's open: S M T W Th F SA ALL

Hours of Operation: Sun: 10a-6p 24 hours Y N
Mon: 10a-9p
Tue: 10a-9p
Wed: 10a-9p
Thu: 10a-9p
Fri: 10a-9p
Sat: 10a-9p

Premise Type: Tavern/Bar
 Restaurant
 Other:

Licenses currently held:

Alcohol: Yes No Class: #:
Tobacco: Yes No #:
Food: Yes No #:
Other: Yes No Type: #:
Other: Yes No Type: #:

Exterior Survey:

1. Is the area around the location clean? Yes No
2. What surrounds the location? (Check all the apply)
 - a. Park
 - b. School
 - c. Youth Center
 - d. Church
 - e. Tavern(s) If so, how many
 - f. Residential
 - g. Other businesses
 - h. Other:
3. Can you see from the outside of the location into the interior Yes No
4. Can you see the employees inside of the location from the outside Yes No
5. Are exterior windows free of signage Yes No
6. Street parking Yes No
7. Is there a parking lot Yes No
8. Is the parking lot clean? Yes No
9. Is the parking lot well lit? Yes No
10. Valet Parking Yes No
 - a. Will this lot have a guard? Yes No
 - b. Will this lot have cameras? Yes No
11. Are there areas where a person could conceal themselves Yes No
12. Is there exterior lighting? Yes No. Does it appears to be adequate Yes No
13. Exterior Payphone? Yes No
14. Are there No Loitering Signs posted? Yes No
15. Are there exterior security cameras Yes No How Many:
16. Are the address numbers prominently displayed and easy to see Yes No

Camera Survey:

17. Does this location have security cameras? Yes No
18. Are they in working order? Yes No
19. What format are the cameras?
 - a. Color Yes No
 - b. Digital Yes No
 - c. VCR Yes No
 - d. Recorded Yes No
20. How long is footage stored for later viewing: 30 days
21. Are there exterior cameras Yes No How many: to be installed
22. Are there interior cameras Yes No How many: 4

23. Do all employees know how to retrieve recorded digital images/footage? Yes No
 24. Cameras located in parking lot Yes No How many

Interior Survey:

25. What is the planned/posted capacity 80
 26. What is the minimum number of employees that will be on premise 4-5
 27. Is the storeowner willing to be a standing complainant regarding loitering? Yes No
 a. If yes have them fill out the standing complaint form and give them two of the commercial signs Yes No
 28. Is the interior of the location neat and clean? Yes No
 29. Does an interior camera face the entrance/exit? Yes No
 30. Are emergency and non-emergency numbers posted near the phone? Yes No
 31. Does the owner know how to contact their police district directly? Yes No
 a. Did you provide a district contact guide to the owner? Yes No

Security

32. How many security personnel are going to be employed: N/A
 33. How will they be deployed: Interior Exterior
 34. What days will they be deployed Mon Tue Wed Thu Fri Sat Sun
 35. Will the security be managed by business or contracted
 36. Will they be armed Yes No
 37. What type of security measures will be used:
 Wanding/metal detector
 ID Scanner
 Dress Code
 Cover Charge
 Age restriction
 Other
 38. When at capacity, how will the overflow crowd be managed?
 39. Will a guard monitor the overflow crowd at all times? Yes No

ADDITIONAL COMMENTS/RECOMMENDATIONS:

Location is restaurant applying to serve beer/cocktails.



Area of Interest (AOI) Information

Area : 21,862,585.76 ft²

Oct 30 2024 14:42:51 Central Daylight Time

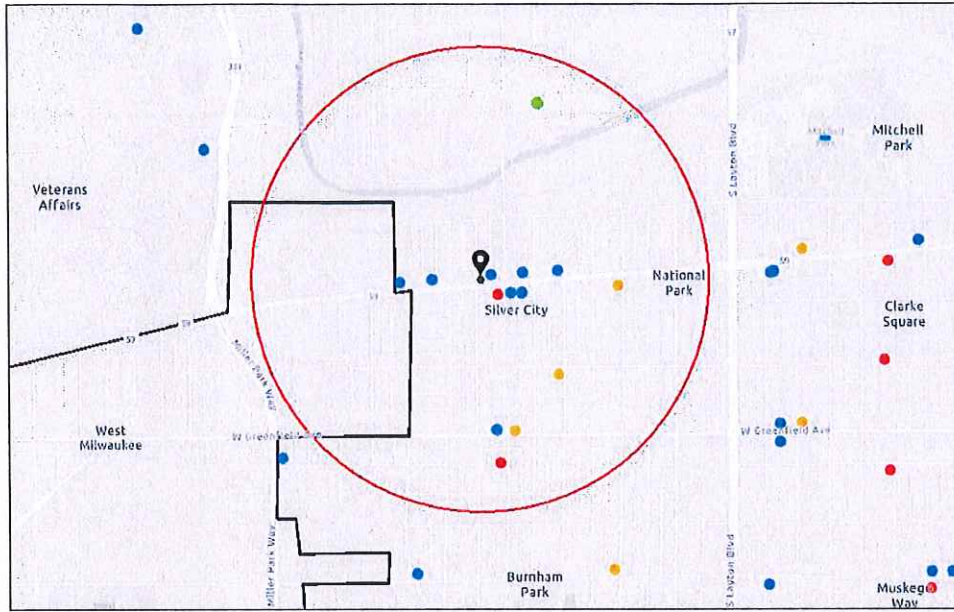

- Alcohol Licenses (active)
- Class A Fermented Malt Beverage
 - Class A Liquor and Malt
 - Class B Fermented Malt Beverage
 - Class B Tavern
 - Class C Wine Retailer
 - City Limits

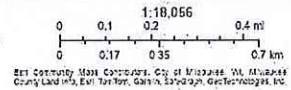

Summary

Name	Count	Area(ft ²)	Length(mi)
Alcohol Licenses	16		

Alcohol Licenses

#	Legal Entity	Trade Name	Licensee	Address	License Type Name	Total Capacity	Expiration Date	Count
1	Missy Sweets Lounge LLC	Missy Sweets Lounge	Melissa M Hoepfner, Agt	3412 W NATIONAL AV	Class B Tavern License		10/31/2024, 7:00 PM	1
2	THAI BARBECUE, LLC	THAI BAR-B-QUE	XAY CHAI, Agt	3417 W NATIONAL AV	Class B Tavern License		11/5/2024, 6:00 PM	1
3	Scott Beer & Food LLC	El Rincon Grocery	GURMUKH SINGH, Agt	1201 S 33rd ST	Class A Fermented Malt Beverage Retailer's License		12/11/2024, 6:00 PM	1
4	Forest Home Ave Chicken Palace LLC	Chicken Palace National	VALDEMAR ESCOBAR, Agt	3433 W National AV	Class B Tavern License	65	11/25/2024, 6:00 PM	1
5	FIRST STOP FOODS	FIRST STOP FOODS	ABDELMUNA M AASAD, SP	1330 S 35TH ST	Class A Fermented Malt Beverage Retailer's License		12/19/2024, 6:00 PM	1
6	PK PALACE, LLC	PK Palace	Rick K Vang, Agt	3730 W NATIONAL AV	Class B Tavern License		3/4/2025, 6:00 PM	1
7	National Grocery, LLC	National Grocery	Manpreet Singh, Agt	3501 W National AV	Class A Malt & Class A Liquor License		4/7/2025, 7:00 PM	1
8	Celebrity's Hall	Celebrity's Hall	Raul Varela-Rodriguez, SP	1329 S 35th ST	Class B Tavern License	91	4/4/2025, 7:00 PM	1
9	Milwaukee Nights Pub, LLC	Milwaukee Nights Pub	Samona McCann, Agt	3830 W NATIONAL AV	Class B Tavern License	80	3/25/2025, 7:00 PM	1
10	LEVA ENTERPRISE S SOUTH LLC	Orenda	Leticia C Munoz Hernandez, Agt	3514 W NATIONAL AV	Class B Tavern License		4/23/2025, 7:00 PM	1
11	Palermo Villa, Inc	Pizzeria 3301	Laurie Ann Fallucca, Agt	3301 W Canal ST	Class B Fermented Malt Beverage Retailer's License		4/7/2025, 7:00 PM	1
12	Palermo Villa, Inc	Pizzeria 3301	Laurie Ann Fallucca, Agt	3301 W Canal ST	Class C Wine Retailer's License		4/7/2025, 7:00 PM	1
13	MAMIE'S	MAMIE'S	DEBRA L MICKEY, SP	3300 W NATIONAL AV	Class B Tavern License	68	6/29/2025, 7:00 PM	1
14	ALDI, INC	ALDI #87	Matteo G Allred, Agt	1441 S 35TH ST	Class A Malt & Class A Liquor License		7/10/2025, 7:00 PM	1
15	National Beer & Food Mart, LLC	National Food	JASMINDER SINGH, Agt	3101 W National AV	Class A Fermented Malt Beverage Retailer's License		9/23/2025, 7:00 PM	1
16	THAI BARBECUE, LLC	THAI BAR-B-QUE	XAY CHAI, Agt	3417 W NATIONAL AV	Class B Tavern License		11/5/2025, 6:00 PM	1

Establishments within a 0.5 miles radius centered on area of interest.



Tuesday, November 19, 2024



Notice of Public Hearing

Blank Notice

FLORES CAMPOS, Elizabeth V, Agent
Flautas Y Chilaquiles Los Villa at 3530 W National Av
Class B Tavern License Application

Tuesday, December 03, 2024 at 1:50 PM

To whom it may concern:

The above application has been made by the above named applicant(s). This requires approval from the Licenses Committee and the Common Council of the City of Milwaukee. The hearing before the Licenses Committee will take place on 12/3/2024 at 1:50 PM in Room 301-B, Third Floor, City Hall. This is a public hearing. Those wishing to view the proceeding are able to do so via the City Channel – Channel 25 on Spectrum Cable – or on the Internet at <http://city.milwaukee.gov/citychannel>. Those wishing to provide oral testimony via internet are asked to contact the staff assistant, Yadira Melendez at (414) 286-2775 or stasst5@milwaukee.gov for necessary information. Please make such requests no later than one business day prior to the start of the meeting. You are not required to attend the hearing, but please see the information below if you would like to provide testimony. Once the Licenses Committee makes its recommendation, this recommendation is forwarded to the full Common Council for approval at its next regularly scheduled hearing.

Important details for those wishing to provide information for the Licenses Committee to consider when making its recommendation:

1. The license application is scheduled to be heard at the above time. Due to other hearings running longer than scheduled, you may have to wait some time to provide your testimony.
2. You must appear in person and testify as to matters that you have personally experienced or seen. (You cannot provide testimony for your neighbor, parent or anyone else; this is considered hearsay and cannot be considered by the committee.)
3. No letters or petitions can be accepted by the committee (unless the person who wrote the letter or the persons who signed the petition are present at the committee hearing and willing to testify).
4. Persons opposed to the license application are given the opportunity to testify first; supporters may testify after the opponents have finished.
5. When you are called to testify, you will be sworn in and asked to give your name, and address. (If your first and/or last names are uncommon please spell them.)
6. You may then provide testimony.
 - a. Include only information relating to the above license application.
 - b. Include only information you have personally witnessed or seen.
 - c. Provide concise and relevant information detailing how this business has affected or may affect the peaceful enjoyment of your neighborhood.
 - d. If by the time you have the opportunity to testify, the information you wish to share has already been provided to the committee, you may state that you agree with the previous testimony. Redundant or repetitive testimony will not assist the committee in making its recommendation.
7. After giving your testimony, the members of the Licenses Committee and the licensee may ask questions regarding the testimony you have given or other factors relating to the license application.
8. Business Competition is not a valid basis for denial or non-renewal of a license.
Please Note: If you have submitted an objection to the above application your objection cannot be considered by the committee unless you personally testify at the hearing.

OCCUPANT	MAIL ADDRESS	CITY STATE ZIP
CURRENT OCCUPANT	3503 W PIERCE ST	MILWAUKEE, WI 53215-1028
CURRENT OCCUPANT	3505 W PIERCE ST	MILWAUKEE, WI 53215-1028
CURRENT OCCUPANT	3507 W PIERCE ST	MILWAUKEE, WI 53215-1028
CURRENT OCCUPANT	3509 W PIERCE ST	MILWAUKEE, WI 53215-1028
CURRENT OCCUPANT	3509A W NATIONAL AVE	MILWAUKEE, WI 53215-1024
CURRENT OCCUPANT	3511 W NATIONAL AVE	MILWAUKEE, WI 53215-1024
CURRENT OCCUPANT	3512 W NATIONAL AVE	MILWAUKEE, WI 53215-1025
CURRENT OCCUPANT	3523 W NATIONAL AVE# 1	MILWAUKEE, WI 53215-1024
CURRENT OCCUPANT	3523 W NATIONAL AVE# 2	MILWAUKEE, WI 53215-1024
CURRENT OCCUPANT	3523 W NATIONAL AVE# 3	MILWAUKEE, WI 53215-1024
CURRENT OCCUPANT	3526 W NATIONAL AVE	MILWAUKEE, WI 53215-1025
CURRENT OCCUPANT	3526 W NATIONAL AVE# A	MILWAUKEE, WI 53215-1025
CURRENT OCCUPANT	3528 W NATIONAL AVE	MILWAUKEE, WI 53215-1025
CURRENT OCCUPANT	3602 W NATIONAL AVE	MILWAUKEE, WI 53215-1027
CURRENT OCCUPANT	3602A W NATIONAL AVE	MILWAUKEE, WI 53215-1027
CURRENT OCCUPANT	3605B W NATIONAL AVE	MILWAUKEE, WI 53215-1026
CURRENT OCCUPANT	3606 W NATIONAL AVE	MILWAUKEE, WI 53215-1027
CURRENT OCCUPANT	3606A W NATIONAL AVE	MILWAUKEE, WI 53215-1027
CURRENT OCCUPANT	3607 W NATIONAL AVE	MILWAUKEE, WI 53215-1026
CURRENT OCCUPANT	3610 W NATIONAL AVE	MILWAUKEE, WI 53215-1027
CURRENT OCCUPANT	3615 W NATIONAL AVE# 1	MILWAUKEE, WI 53215-1039
CURRENT OCCUPANT	3615 W NATIONAL AVE# 10	MILWAUKEE, WI 53215-1040
CURRENT OCCUPANT	3615 W NATIONAL AVE# 11	MILWAUKEE, WI 53215-1040
CURRENT OCCUPANT	3615 W NATIONAL AVE# 12	MILWAUKEE, WI 53215-1040
CURRENT OCCUPANT	3615 W NATIONAL AVE# 13	MILWAUKEE, WI 53215-1040
CURRENT OCCUPANT	3615 W NATIONAL AVE# 14	MILWAUKEE, WI 53215-1040
CURRENT OCCUPANT	3615 W NATIONAL AVE# 15	MILWAUKEE, WI 53215-1041
CURRENT OCCUPANT	3615 W NATIONAL AVE# 16	MILWAUKEE, WI 53215-1041
CURRENT OCCUPANT	3615 W NATIONAL AVE# 17	MILWAUKEE, WI 53215-1041
CURRENT OCCUPANT	3615 W NATIONAL AVE# 18	MILWAUKEE, WI 53215-1041
CURRENT OCCUPANT	3615 W NATIONAL AVE# 19	MILWAUKEE, WI 53215-1041
CURRENT OCCUPANT	3615 W NATIONAL AVE# 2	MILWAUKEE, WI 53215-1039
CURRENT OCCUPANT	3615 W NATIONAL AVE# 20	MILWAUKEE, WI 53215-1041
CURRENT OCCUPANT	3615 W NATIONAL AVE# 21	MILWAUKEE, WI 53215-1041
CURRENT OCCUPANT	3615 W NATIONAL AVE# 22	MILWAUKEE, WI 53215-1041
CURRENT OCCUPANT	3615 W NATIONAL AVE# 23	MILWAUKEE, WI 53215-1041
CURRENT OCCUPANT	3615 W NATIONAL AVE# 24	MILWAUKEE, WI 53215-1041
CURRENT OCCUPANT	3615 W NATIONAL AVE# 25	MILWAUKEE, WI 53215-1042
CURRENT OCCUPANT	3615 W NATIONAL AVE# 26	MILWAUKEE, WI 53215-1042
CURRENT OCCUPANT	3615 W NATIONAL AVE# 27	MILWAUKEE, WI 53215-1042
CURRENT OCCUPANT	3615 W NATIONAL AVE# 28	MILWAUKEE, WI 53215-1042
CURRENT OCCUPANT	3615 W NATIONAL AVE# 3	MILWAUKEE, WI 53215-1039
CURRENT OCCUPANT	3615 W NATIONAL AVE# 4	MILWAUKEE, WI 53215-1039
CURRENT OCCUPANT	3615 W NATIONAL AVE# 5	MILWAUKEE, WI 53215-1039
CURRENT OCCUPANT	3615 W NATIONAL AVE# 6	MILWAUKEE, WI 53215-1039
CURRENT OCCUPANT	3615 W NATIONAL AVE# 7	MILWAUKEE, WI 53215-1039

CURRENT OCCUPANT	3615 W NATIONAL AVE# 8	MILWAUKEE, WI 53215-1039
CURRENT OCCUPANT	3615 W NATIONAL AVE# 9	MILWAUKEE, WI 53215-1039
CURRENT OCCUPANT	703 S 35TH ST	MILWAUKEE, WI 53215-1036
CURRENT OCCUPANT	705 S 35TH ST	MILWAUKEE, WI 53215-1036
CURRENT OCCUPANT	707 S 35TH ST	MILWAUKEE, WI 53215-1036
CURRENT OCCUPANT	709 S 35TH ST	MILWAUKEE, WI 53215-1036
CURRENT OCCUPANT	723 S 35TH ST	MILWAUKEE, WI 53215-1036
CURRENT OCCUPANT	725 S 35TH ST	MILWAUKEE, WI 53215-1036
CURRENT OCCUPANT	727 S 35TH ST	MILWAUKEE, WI 53215-1036
CURRENT OCCUPANT	729 S 35TH ST	MILWAUKEE, WI 53215-1036
CURRENT OCCUPANT	733 S 35TH ST	MILWAUKEE, WI 53215-1036
CURRENT OCCUPANT	735 S 35TH ST	MILWAUKEE, WI 53215-1036
CURRENT OCCUPANT	736 S 36TH ST	MILWAUKEE, WI 53215-1017
CURRENT OCCUPANT	737 S 35TH ST	MILWAUKEE, WI 53215-1036
CURRENT OCCUPANT	737 S 36TH ST	MILWAUKEE, WI 53215-1016
CURRENT OCCUPANT	739 S 35TH ST	MILWAUKEE, WI 53215-1036
CURRENT OCCUPANT	740 S 36TH ST	MILWAUKEE, WI 53215-1017
CURRENT OCCUPANT	743 S 35TH ST	MILWAUKEE, WI 53215-1036
CURRENT OCCUPANT	743 S 36TH ST	MILWAUKEE, WI 53215-1016
CURRENT OCCUPANT	743A S 36TH ST	MILWAUKEE, WI 53215-1016
CURRENT OCCUPANT	744 S 36TH ST	MILWAUKEE, WI 53215-1017
CURRENT OCCUPANT	745 S 35TH ST	MILWAUKEE, WI 53215-1036
CURRENT OCCUPANT	747 S 35TH ST	MILWAUKEE, WI 53215-1036
CURRENT OCCUPANT	749 S 35TH ST	MILWAUKEE, WI 53215-1036
CURRENT OCCUPANT	800 S 36TH ST	MILWAUKEE, WI 53215-1019
CURRENT OCCUPANT	800 S 37TH ST	MILWAUKEE, WI 53215-1023
CURRENT OCCUPANT	803 S 36TH ST	MILWAUKEE, WI 53215-1018
CURRENT OCCUPANT	803 S 36TH ST# A	MILWAUKEE, WI 53215-1018
CURRENT OCCUPANT	804 S 36TH ST	MILWAUKEE, WI 53215-1019
CURRENT OCCUPANT	806 S 36TH ST	MILWAUKEE, WI 53215-1019
CURRENT OCCUPANT	806 S 37TH ST	MILWAUKEE, WI 53215-1023
CURRENT OCCUPANT	806A S 36TH ST	MILWAUKEE, WI 53215-1019
CURRENT OCCUPANT	807 S 36TH ST	MILWAUKEE, WI 53215-1018
CURRENT OCCUPANT	810 S 36TH ST	MILWAUKEE, WI 53215-1019
CURRENT OCCUPANT	810 S 37TH ST	MILWAUKEE, WI 53215-1023
CURRENT OCCUPANT	811 S 36TH ST	MILWAUKEE, WI 53215-1018
CURRENT OCCUPANT	813 S 36TH ST	MILWAUKEE, WI 53215-1018
CURRENT OCCUPANT	814 S 36TH ST	MILWAUKEE, WI 53215-1019
CURRENT OCCUPANT	814 S 37TH ST	MILWAUKEE, WI 53215-1023
CURRENT OCCUPANT	816 S 36TH ST	MILWAUKEE, WI 53215-1019
CURRENT OCCUPANT	817 S 36TH ST	MILWAUKEE, WI 53215-1018
CURRENT OCCUPANT	817A S 36TH ST	MILWAUKEE, WI 53215-1018
CURRENT OCCUPANT	818 S 36TH ST	MILWAUKEE, WI 53215-1019
CURRENT OCCUPANT	818 S 37TH ST	MILWAUKEE, WI 53215-1023
CURRENT OCCUPANT	818A S 36TH ST	MILWAUKEE, WI 53215-1019
CURRENT OCCUPANT	819 S 36TH ST	MILWAUKEE, WI 53215-1018
CURRENT OCCUPANT	819A S 36TH ST	MILWAUKEE, WI 53215-1018

CURRENT OCCUPANT	819B S 36TH ST	MILWAUKEE, WI 53215-1018
CURRENT OCCUPANT	819C S 36TH ST	MILWAUKEE, WI 53215-1018
CURRENT OCCUPANT	906 S 36TH ST# 1	MILWAUKEE, WI 53215-1412
CURRENT OCCUPANT	906 S 36TH ST# 2	MILWAUKEE, WI 53215-1412
CURRENT OCCUPANT	906 S 36TH ST# 3	MILWAUKEE, WI 53215-1412
CURRENT OCCUPANT	907 S 35TH ST# 1	MILWAUKEE, WI 53215-1405
CURRENT OCCUPANT	907 S 35TH ST# 2	MILWAUKEE, WI 53215-1405
CURRENT OCCUPANT	907 S 35TH ST# 3	MILWAUKEE, WI 53215-1405
CURRENT OCCUPANT	907 S 35TH ST# 4	MILWAUKEE, WI 53215-1405
CURRENT OCCUPANT	907 S 36TH ST	MILWAUKEE, WI 53215-1411
CURRENT OCCUPANT	907A S 36TH ST	MILWAUKEE, WI 53215-1411
CURRENT OCCUPANT	907B S 36TH ST	MILWAUKEE, WI 53215-1411
CURRENT OCCUPANT	909 S 36TH ST	MILWAUKEE, WI 53215-1411
CURRENT OCCUPANT	909A S 36TH ST	MILWAUKEE, WI 53215-1411
CURRENT OCCUPANT	915 S 35TH ST	MILWAUKEE, WI 53215-1405
CURRENT OCCUPANT	918 S 36TH ST	MILWAUKEE, WI 53215-1412
CURRENT OCCUPANT	918A S 36TH ST	MILWAUKEE, WI 53215-1412
CURRENT OCCUPANT	920 S 36TH ST	MILWAUKEE, WI 53215-1412
CURRENT OCCUPANT	921 S 35TH ST	MILWAUKEE, WI 53215-1405
CURRENT OCCUPANT	921A S 35TH ST	MILWAUKEE, WI 53215-1405
CURRENT OCCUPANT	922 S 36TH ST	MILWAUKEE, WI 53215-1412

Blank Notice

Total Records: 114

Radius 250 feet and Center of the Circle: 3530 W National Av



BUSINESS LICENSE PLAN OF OPERATION

ccl-busplan 5/12/2020

Office of the City Clerk License Division
200 E. Wells St. Room 105, Milwaukee, WI 53202
(414) 286-2238 www.milwaukee.gov/license e-mail address: license@milwaukee.gov

1. Type of Business

Applying for: Extended Hours (12AM to 5AM) - If a food establishment, check all that apply: Delivery Drive Thru Dining Room
 Self Service Laundry Massage Establishment Filling Station
 Other (supplemental application for specific license also required)

Provide a detailed description of the type of business you plan on operating: restaurant business (dinning room) With Alcohol

Do you have any experience operating this type of business? No Yes If yes, explain:

2. Business Operations

- a. Proposed Opening Date: 11-11-24.
- b. Is this premise under construction? No Yes If yes, list estimated completion date: _____
- c. Is this a franchise? No Yes
- d. Is this premises currently licensed? No Yes If yes, list type of license: restaurant food license
- e. Is the current licensee operating? No Yes If no, list date closed: closed
- f. Do you have future plans for other businesses, licenses or permits at this location? No Yes
If yes, explain: _____
- g. Have you previously held an Extended Hours License in Milwaukee? No Yes
If yes, list address(es): _____
- h. Are other businesses operating in the same building? No Yes If yes, describe: _____

3. Litter & Noise

- a. How are grounds kept clean? Sweep Pressure Wash Pick Up Litter Other: _____
- b. How often will grounds be cleaned? Daily Weekly As Needed Monthly Other: _____
- c. Grounds cleaned by: Licensee Building Owner Employees Hired Maintenance Other: _____
- d. How are noise issues prevented and/or addressed? Security Manager approaches customer(s) Call Police
 Signs Posted Other: _____
- e. Will a sound amplification system be used? No Yes If yes, describe: _____

4. Smoking & Sanitation

- a. Are there designated outdoor smoking areas? No Yes If yes, describe: _____
- b. Number of Garbage Cans: Inside: 2 Locations: kitchen
Outside: 2 Locations: on the back builder
- c. Is a crowd control barrier used? No Yes If yes, describe: _____
- d. How many restrooms are on the premises? 2
- e. Name of solid waste contractor: Advanced Disposal Waste Management Other: _____

5. Security

- a. Are there onsite parking spaces? No Yes If yes, how many? 8 and describe the parking security plan: lighting
- b. Is there a loading zone? No Yes If yes, describe the loading area security plan: _____
- c. Will you have licensed security on premise? No Yes If yes, how many? _____ and answer the following:
 What are their responsibilities? _____
 Describe equipment used _____
 List their License Number (s) _____
- d. Will there be security cameras? No Yes If yes, how many? 4 and list locations: outside & inside building
- e. Will searches/identification checks be done upon entry? No Yes If yes, describe _____

6. Percentage of Sales (must total 100%)

Alcohol <u>20</u> %	Food <u>80</u> % Cigarettes, Electronic Vape Devices, Tobacco Products _____ %	Secondhand Merchandise _____ %	Precious Metals & Gems _____ %
Entertainment _____ %	Pawnbroker Activity _____ %	Salvaged Materials _____ % (such as scrap metal)	Personal Services (such as tattoo, body piercing, salon, tailor, tanning, etc.) _____ %
		Other _____ % Describe: _____	

7. Businesses/Licenses on the Premises (check all that apply):

- Type 1**
- Full Service Restaurant Cafe/Coffee Shop Deli or Fast Food Restaurant Private/Fraternal/Veterans Club
- Night Club Tavern Cocktail Lounge Teen Club
- Banquet Hall Sports Facility Bowling Alley
- Hotel/Motel: Number of Floors: _____ Number of Rooms: _____
 Rooming House: Number of Floors: _____ Number of Rooms: _____

- Type 2**
- Liquor Store Corner Store Supermarket Convenience Store
- Gas Station Amusement/Phonograph Distributor Recycling, Salvage or Towing
- Used Car Dealer Personal Service Establishment (such as tattoo business, hair salon, tailor, etc.) Recording Studio

What other licenses/permits will you hold at this location? (check all that apply)

- Occupancy Permit Cigarette, Tobacco, Electronic Vape Products Gas Station Extended Hours Class "B" Tavern Weights & Measures
- Secondhand Dealer Precious Metal & Gem Other: _____

8. Legal Capacity (only if a Type 1 premises in #7 above)

Capacity 50 (Call the Milwaukee Development Center at 414-286-8211 if you have questions.)

9. Premises Description

- a. Identify all area(s) of the premises that will be used in operating this business (include areas used only for storage):
 1st Floor 2nd Floor Basement Storage Patio Beer Garden Sidewalk Café Deck Rooftop
 Other: Describe: _____
- b. Describe Location: Major Thoroughfare Secondary Street Other: _____
- c. Nearest Major Cross Street: _____
- d. Describe Building: Free Standing Building Strip Mall Other: _____
- e. Describe Premises Structure: Single Story Multi-Story - # of Stories 2 Other: _____
- f. Describe Surrounding Area: Commercial Residential Industrial Other: _____
- g. Building Owner Name: Home base Deals LLC Phone Number: 414 690 9826
 Building Owner Address: 806 mosquito wisconsin 53150

10. Hours of Operation & Customers

Will customers be entering the premises? No Yes

Day of the Week	Proposed Hours of Operation:		Estimated Number of Customers expected each day	Potential Age Range of Customers	Class B Tavern Applicant Only: Age Restriction (If none, write 'None')
	Open Time (include a.m. or p.m.)	Close Time (include a.m. or p.m.)			
Sunday	10:00 am	6:00 pm	0-80		
Monday	10:00 am	9:00 pm	↓		
Tuesday	10:00 am	9:00 pm			
Wednesday	10:00 am	9:00 pm			
Thursday	10:00 am	9:00 pm			
Friday	10:00 am	9:00 pm			
Saturday	10:00 am	9:00 pm		✓	

An Extended Hours Establishment License is required for any convenience store, filling station, personal service establishment (such as tattoo, body piercing, salon, taylor, tanning, etc.), recording studio or restaurant which is open between the hours of 12:00 a.m. and 5:00 a.m.

Alcohol Establishments Permitted Hours of Operation: Class A: 8:00 am to 9:00 pm Sunday thru Saturday
 Class B: 6:00 am to 2:00 am Sunday thru Thursday, 6:00 am to 2:30 am Friday & Saturday

Entertainment Outdoor Closing Hours: 10:00pm Sunday-Thursday; 12:00am Friday & Saturday; unless a different time, either earlier or later, is established by the Common Council in its approval of the licensee's plan of operation.

11. Signature(s)

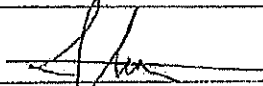

 Signature of Sole Proprietor, Partner, or 20% or more Shareholder
 (If there are no 20% or more shareholders,
 Corporate Officer-print name/title and sign)

 Signature of additional partner or 20% or more shareholder

See Application Information for a complete list of all required application forms.



ALCOHOL BEVERAGE & PUBLIC ENTERTAINMENT PREMISES SUPPLEMENTAL APPLICATION

Office of the City Clerk License Division
200 E. Wells St. Room 105, Milwaukee, WI 53202
(414) 286-2238 e-mail address: license@milwaukee.gov www.milwaukee.gov/license

Legal Entity Name: Flautas y Chilaquiles los Villa LLC.

Premise Address: 3530 W National Ave Milwaukee WI 53215.

Proximity of Premises to Church, School, Daycare Center or Hospital

Is the building within 300 feet of any church, school, daycare center or hospital? No Yes

"Service Bar Only" Designation

If applying for Class B or C license, are you applying for "Service Bar Only"? No Yes

Service Bar Only means customers cannot sit at the bar. Alcohol is served to employees who serve patrons seated at tables. No stools, chairs or other articles of furniture shall be placed at the service bar for patrons to sit upon.

Business Information

a) Are you taking out this application for anyone that may not be eligible for a license? No Yes

If yes, list their name and address: _____

b) Will the agent, a partner or the individual licensee be conducting the day-to-day operations of the business? No Yes

If no, list the name and address of the person(s) who will: _____

Class B Applicants: If the agent, a partner or the individual licensee will not be conducting the day-to-day operations of the business, the person(s) listed above must obtain a Class B Managers license.

c) Does anyone else have money invested or any other interest in this business? No Yes

If yes, explain: _____

d) Have you made an agreement with anyone to repay any loan or any other payments based upon income from the business?

No Yes If yes, list name and address: _____

Property Information (New & Transfer Applicants Only)

a) Do you own or lease the building? Own Lease

b) Who owns the fixtures (for example, coolers, etc.)? Flautas y Chilaquiles los Villa LLC

c) Are you purchasing the stock and/or fixtures? No Yes If yes, amount paid \$ _____

d) Total amount paid for business \$ _____

e) Total amount paid for goodwill of the business \$ _____

Goodwill comprises the reputation and customer relationships of an existing business. If the price you pay for the business exceeds the fair market value of all of the rest of the assets of the business, the excess may be considered goodwill.

f) Have you made arrangements with the seller for payment of personal property taxes? No Yes

Lease Information (New & Transfer Applicants who are leasing the premises only)

a) Date lease begins 03-01-24 Ends 03-01-26

b) Monthly rental \$ 3,500

c) Do you have an option to renew the lease? No Yes

d) Does your lease allow for assignment to another party without the consent of the owner? No Yes

e) For what length of time have you been guaranteed occupancy (number of years)? 2 yrs

Lease Information (Continued)

- f) In addition to paying the monthly rental, will you have to pay anything additional to the owner of the building to guarantee performance of the lease? No Yes If yes, explain _____
- g) Does the present owner or occupant object to the granting of your license? No Yes
If yes, explain _____

Change of Agent Applicants Only

Have there been any changes to the floor plan since the last application was submitted? No Yes
If no, a new floor plan is not required. If yes, submit a new floor plan and explain the change(s):

Signature

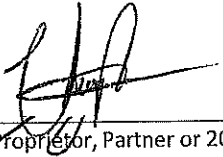

Signature of Sole Proprietor, Partner or 20% or More Shareholder
(If no 20% or more Shareholder, Corporate Officer - print name/title and sign)

Note: All information contained in this application is subject to approval by the Common Council.
Deviating from approved plan of operation will subject licensee to citations, and/or suspension or non-renewal of the license.
Contact the License Division for information on how to request changes.

New and transfer of premises applicants must submit the following:

- Detailed floor plan
- If a restaurant, copy of the menu

LEGEND AND NOTES-THIS SHEET

--- INDICATES ITEMS TO BE REMOVED

--- EXISTING WALLS TO REMAIN

① 3 3/4" STL. STUDS @ 16" O.C. W/ W/ 5/8" GIP. BOARD EACH FACE

② 4" STEEL STUDS AT 16" O.C. W/ 1/2" CEMENT BOARD AND FACED WITH STAINLESS STEEL SHEET. S.S. SHEET TO EXTEND MIN 18" AROUND HOOD.

③ EXTEND THE 2 HR RATED CEILING IN THIS AREA UNDER THE STAIRS.

④ SHORTEN BAR LOCATION AS SHOWN.

⑤ PROVIDE NEW INSULATED WOOD FRAMED WINDOWS TO MATCH EXISTING WINDOW SIZE AND DESIGN. PROVIDE U FACTOR .350 AND SHGC .60. LINTEL SHALL BE 2-2 X 10 STRUCTURAL SELECT.

⑥ REMOVE EXISTING LATH AND PLASTER AND ALL OTHER PREVIOUS CEILINGS UNDER THE FLOOR JOISTS. THE JOISTS SHALL BE CLEAN TO PROVIDE THE NEW 2 HR RATED CEILING SYSTEM. SEE DETAIL 1/A300.

⑦ PROVIDE 2 HR RATED SYSTEM ON THE STAIR WALLS. INSTALL THE SYSTEM ON THE RESTAURANT SIDE OF THE STAIR. INSTALL SYSTEM FM W15-2HR.

⑧ REMOVE DOORS AND FRAMES FOR 100A AND 100B AND REPLACE WITH LABEL 8 RATED DOORS AND FRAMES.

⑨ DEMOLISH AS NECESSARY EXISTING CONSTRUCTION OVER THE RESTROOMS TO ALLOW FOR THE INSTALLATION OF THE NEW RATED CEILING.

⑩ REPAIR EXISTING DINING FLOORING WHERE DAMAGED.

⑪ FRAME AROUND THE HOOD EXHAUST DUCTS.

⑫ SEE DETAIL 2/A500 FOR WORK STATION

⑬ REMOVE THE BACK BAR AND THE MIRROR. INSTALL THE RATED SYSTEM (IDENTIFIED IN ITEM 7 ABOVE) AND INSTALL BAR AND MIRROR BACK AS REQUIRED.

⑭ REMOVE THE WALL PANELING FROM THE EAST WALL.

⑮ ALL ILLEGAL MIRRORS IN THE BASEMENT SHALL BE REMOVED BY THE ELECTRICAL CONTRACTOR.

⑯ THE BAR EQUIPMENT SHALL BE DESIGNED AND LAYED OUT BY THE EQUIPMENT SUPPLIER TO SATISFY THE HEALTH DEPARTMENT REQUIREMENTS.

⑰ THE EXHAUST HOOD WILL BE ROUTED OVER THE RESTROOMS, THROUGH THE REAR (NORTH) WALL AND WILL BE INSTALLED UNDER THE NEW RATED CEILING.

⑱ PROVIDE EXHAUST FANS IN THE RESTROOMS AS RECD BY CODE

⑲ 2nd STORY FLOOR JOISTS ARE AS ORIGINALLY DESIGNED FOR THE BUILDING AND NO BEARING WALLS HAVE BEEN REMOVED.

DATE: 8-8-19
A100

△ REV: 12-2-19

△ REV: 8-18-19

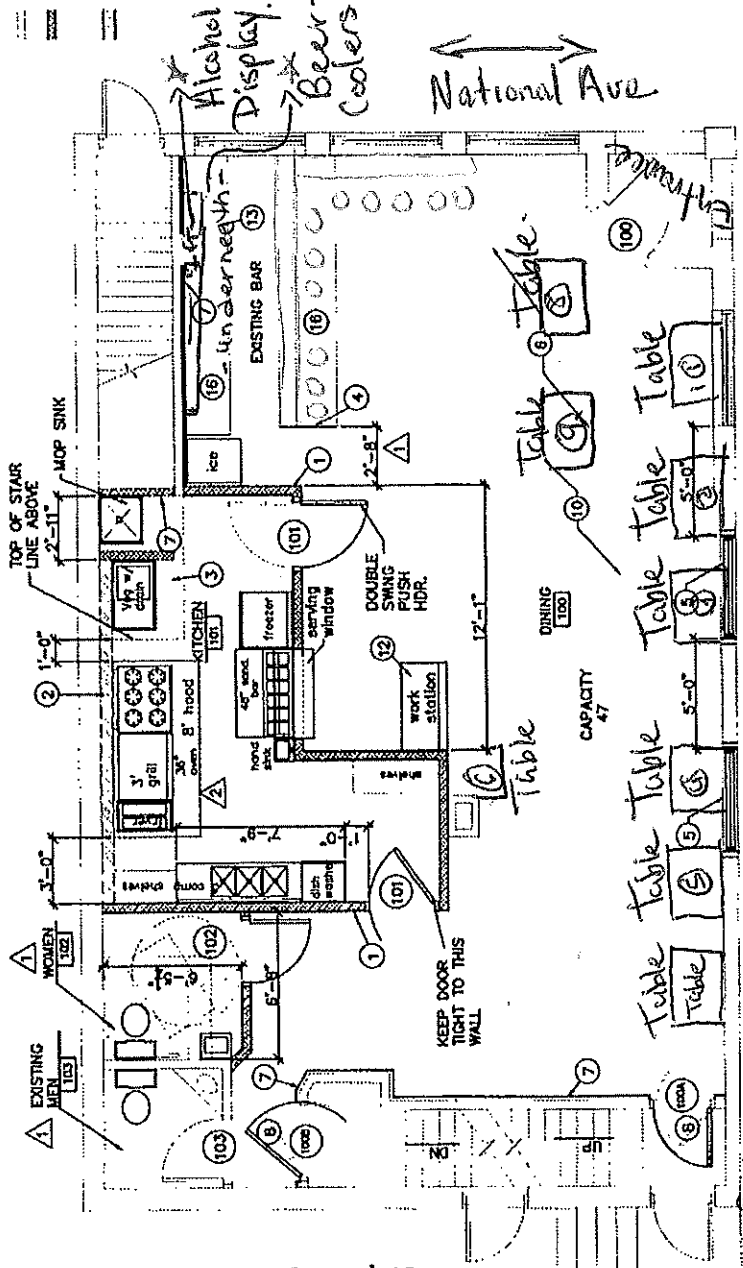

36th St. 6-21-19



FIRST FLOOR PLAN
3/16" = 1'-0"

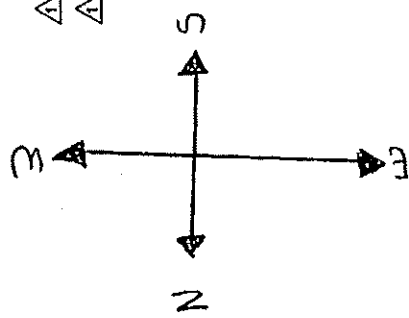

Parking Area & spots. 24.28 ft.

Total Sq foot. 1,130

Flautaw y Chilcaquiles los Villa LLC
Flautaw y Chilcaquiles Los Villa
3530 W National Ave, Milwaukee WI
53215
Elizabeth Flores Campos, Agent
10/30/2024

Drinks and cocktails

Beers, National & Imports.

Corona - 7⁰⁰
Modelo - 7⁰⁰
Negra modelo 7,50.
Indio 8⁰⁰

Coor light. 5⁰⁰
miller light 5⁰⁰.
Budgeiser. 5⁰⁰
Heineken 7⁰⁰.

Cocktails

- Mimosas 7⁶⁰.
- margaritas 8⁰⁰
- Palomas 8⁰⁰
- Piña Coladas 8⁰⁰.

Shots.

Patron 8⁰⁰.
Carralero 8⁰⁰.
Corzadores 8⁰⁰
100 Años 5⁰⁰