



CERTIFICATE OF APPROPRIATENESS APPLICATION FORM
Incomplete applications will not be processed for Commission review.
Please print legibly.

1. **HISTORIC NAME OF PROPERTY OR HISTORIC DISTRICT:** (if known)
Concordia Trust Property, Concordia Historic District
ADDRESS OF PROPERTY:
3215 West State Street

 2. **NAME AND ADDRESS OF OWNER:**
Name(s): Forest County Potawatomi Community
Address: 313 North 13th Street
City: Milwaukee State: WI ZIP: 53233
Email: jmeier@greenfirellc.net (Greenfire)
Telephone number (area code & number) Daytime: 414-290-9403 Evening:

 3. **APPLICANT, AGENT OR CONTRACTOR:** (if different from owner)
Name(s): Tim Hansmann, The Kubala Washatko Architects, Inc.
Address: W61 N617 Mequon Avenue
City: Cedarburg State: WI ZIP Code: 53012
Email: thansmann@tkwa.com
Telephone number (area code & number) Daytime: 262-377-6039 Evening:

 4. **ATTACHMENTS:** (Because projects can vary in size and scope, please call the HPC Office at 414-286-5712 for submittal requirements)
 - A. **REQUIRED FOR MAJOR PROJECTS:**
 - Photographs of affected areas & all sides of the building (annotated photos recommended)
 - Sketches and Elevation Drawings (1 full size and 1 reduced to 11" x 17" or 8 1/2" x 11")
A digital copy of the photos and drawings is also requested.
 - Material and Design Specifications (see next page)

 - B. **NEW CONSTRUCTION ALSO REQUIRES:**
 - Floor Plans (1 full size and 1 reduced to a maximum of 11" x 17")
 - Site Plan showing location of project and adjoining structures and fences
- PLEASE NOTE: YOUR APPLICATION CANNOT BE PROCESSED UNLESS BOTH PAGES OF THIS FORM ARE PROPERLY COMPLETED AND SIGNED.**

5. **DESCRIPTION OF PROJECT:**

Tell us what you want to do. Describe all proposed work including materials, design, and dimensions. Additional pages may be attached.

Replace a portion of the existing chain link fence with an aluminum picket fence to match the one recently added at the Wunder Hall parking lot on Campus along 33rd Street. The fence will be set back further than the current from the street in order to allow for a gate, and then will return to link up with the existing chain link fence.

6. **SIGNATURE OF APPLICANT:**

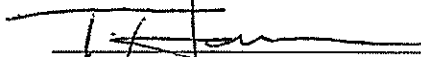
Signature

Tim Hansmann
Please print or type name

8/2/13
Date

This form and all supporting documentation **MUST** arrive by 12:00 noon on the deadline date established to be considered at the next Historic Preservation Commission Meeting. Any information not provided to staff in advance of the meeting will not be considered by the Commission during their deliberation. Please call if you have any questions and staff will assist you.

Hand Deliver or Mail Form to:
Historic Preservation Commission
City Clerk's Office
200 E. Wells St. Room B-4
Milwaukee, WI 53202

PHONE: (414) 286-5722

FAX: (414) 286-3004

www.milwaukee.gov/hpc

SUBMIT



Wgema Campus

South Parking Lot

Photos

South Parking Lot:



View from 33rd Street Looking East. Fence will be directly in front.



View from East edge Looking West. Fence will replace fence shown from building on right to a bit beyond edge of pavement on left.

- Adam Voltz
- Allen Washatko
- Ariel Steuer
- Chris Socha
- Erik Hancock
- Erin Lawrence
- Ethan Bartos
- Jim Read
- Joel Krueger
- Justin Racinowski
- Kirk Lundgren
- Leta Flom
- Mark Léfebvre
- Rich Hepner
- Tim Hansmann
- Tom Kubala
- Vicki Yurske
- Vince Micha
- Wayne Reckard



SECTION 32 31 19

DECORATIVE METAL FENCES AND GATES

PART 1 GENERAL

1.1 SUMMARY

- A. Section Includes:
 - 1. Decorative steel fences.
 - 2. Decorative aluminum fences.
- B. Related Sections:
 - 1. Applicable provisions of Section 31 02 00 – General Requirements for Sitework shall govern Work under this Section.
 - 2. Section 32 13 13 – Concrete Paving: Concrete for post foundations or sleeves for anchoring fence posts.

1.2 REFERENCES

- A. ASTM International
 - 1. ASTM A653 - Specification for Steel Sheet, Zinc-Coated (Galvanized) or Zinc-Iron Alloy Coated (Galvannealed) by the Hot-Dip Process.
 - 2. ASTM B221 - Standard Specification for Aluminum and Aluminum-Alloy Extruded Bars, Rods, Wire, Profiles, and Tubes.
 - 3. ASTM F2408 – Standard Specification for Ornamental Fences Employing Galvanized Steel Tubular Pickets.

1.3 SUBMITTALS

- A. Section 31 02 00 – General Requirements for Sitework: Requirements for submittals.
- B. Product Data: Submit manufacturer's data sheets on each product to be used, including:
 - 1. Preparation instructions and recommendations.
 - 2. Storage and handling requirements and recommendations.
 - 3. Installation methods.
- C. Shop Drawings:
 - 1. Indicate plan layout, spacing of components, post foundation dimensions, hardware anchorage, gates, and schedule of components.
- D. Manufacturer's Warranty.

1.4 DELIVERY, STORAGE AND HANDLING

- A. Store materials in a manner to ensure proper ventilation and drainage. Protecta gainst damage, weather, vandalism and theft.

1.5 WARRANTY

- A. Reference Section 31 02 00 – General Requirements for Sitework for additional warranty requirements.
- B. Finish: 10 years.

PART 2 PRODUCTS

2.1 MANUFACTURERS

- A. Decorative Metal Fences:
 - 1. Ameristar Fence Products, In.; Product: Montage Plus or Montage Plus Pet and Play 3" Air Space; Gate: TransPort II: www.ameristarfence.com.
 - 2. Substitutions: In accordance with Section 31 02 00 – General Requirements for Sitework.

2.2 FENCES

- A. Fences: Complete factory-fabricated system of posts and panels, accessories, fittings, and fasteners; finished with electrodeposition coating, and having the following performance characteristics:
 - 1. Capable of resisting vertical load, horizontall oad and infillp erformance requirements for fence categories defined in ASTM F2408.
- B. Electro-Deposition Coating: Multi-stage pretreatment/wash with zinc phosphate, followed by epoxy primer and acrylic topcoat.
 - 1. Total Coating Thickness: 2 mils, minimum.
- C. Steel: ASTM A653; yield strength 45,000 psi, minimum.
 - 1. Hot-dip galvanized; A653, G60.
 - 2. 62 percent recycled steel, minimum.
- D. Aluminum:
 - 1. Tubular Pickets, Rails and Posts: ASTM B221.
 - 2. Extrusions for Posts and Rails (Outer Channel): 6005-T5.
 - 3. Extrusions for Pickets and Rail (Inner Slide Channels): 6063-T5.

2.3 WELDED STEEL FENCE

- A. Provide fence meeting requirements for Industrial class as defined by ASTM F2408.

- B. Fence Panels: Fusion welded; 8 feet high by 8 feet long.
 - 1. Panel Style: Three rail.
 - 2. Attach panels to posts with manufacturer's standard panel brackets.
- C. Posts:
 - 1. Size: 2-1/2 inches square by 14 gage, with manufacturer's standard cap.
- D. Rails: Manufacturer's standard, double-wall steel channel 1-1/2 by 1-1/2 inch square by 14 gage with pre-punched picket holes.
 - 1. Picket Retaining Rods: 0.125 inch galvanized steel.
 - 2. Picket-to-Rail Intersection Seals: PVC grommets.
- E. Pickets: Steel tube.
 - 1. Spacing: 3.5 inch clear.
 - 2. Size: 3/4 inch square by 14 gage.
 - 3. Style: Square top pickets extend above top rail.
- F. Flexibility: Capable of following variable slope of up to 1:2.

2.4 GATES

- A. Swing Gates: 3.5 by 8 feet.
- B. Swing Gate Hardware:
 - 1. Hinges: Self-closing hinges by D & D Hardware, Model TCHD1-MK2
 - 2. Proximity Readers: Door King, Model: BKS 10.
 - 3. Provide emergency egress lockset or exit device.
 - 4. Magnetic Locks: Match existing.
 - 5. Electric Strikes: Match existing.
- C. Sliding Gates: 24 by 8 feet; with self-aligning internal ball-and-socket truck assembly, 10,000 pound static load rating.

2.5 GATE OPERATORS

- A. Slide gate operators to meet ASTM 2200-11 and be UL 325 compliant for class two operation.
 - 1. Operator to be Hy-Security DC 15 master slave operation.
 - a. Free exit loop by EMX.
 - b. Gate to be accessed by a keypad on a goose neck stand; Key Pad: Door King 1506.

2.6 ALUMINUM FENCE (GATE)

- A. Provide fence meeting requirements for Industrial class as defined by ASTM F2408.
- B. Material: ASTM B221 aluminum, 6063-T-6.

- C. Fence Panels: 7 feet high by 6 feet long.
 - 1. Panel Strength: Capable of supporting 300 pound load applied at midspan without deflection
 - 2. Attach panels to posts with manufacturer's standard panel brackets.
- D. Posts: Aluminum extrusions:
 - 1. Size: 3 inches square.
 - 2. Extrusion Wall: 0.120 inch thick.
- E. Rails: Aluminum extrusions.
 - 1. Double-walled aluminum U channel; outside cross-section dimensions of 2 by 5 inch square; interior guide channel forms lower limit of raceway for retaining rod.
 - 2. Effective Wall Thickness:
 - a. Top Wall of Outer Channel: 1.25 inch thick.
 - b. Side Wall: 1.25 inch thick.
 - 3. Enclosed Retaining Rod: 0.125 inch diameter galvanized steel with variable pitch connection system for high angle racking and elimination of external fasteners.
 - 4. Picket-to-Rail Intersection Seals: PVC grommets.
 - 5. Picket Holes: 4.715 inch on center.
- F. Pickets:
 - 1. Size: 1-3/4 inch square by 0.062 inch thick extruded aluminum tubing.
 - 2. Spacing: 4.715 inch on center.
 - 3. Style: Square top pickets extend above top rail.

2.7 FABRICATION

- A. Pickets, rails and posts shall be pre-cut to specified lengths. Rails shall be pre-punched to accept pickets.
- B. Insert pickets into the pre-punched holes in the rails and align to standard spacing using a specially calibrated alignment fixture. Aligned pickets and rails shall be joined at each picket-to-rail intersection by Ameristar's proprietary fusion welding process, thus completing the rigid panel assembly.
- C. Fence system shall be capable of meeting the vertical load, horizontal load, and infill performance requirements for Industrial weight fences under ASTM F2408.
- D. Gates shall be fabricated using fusion welded ornamental panel material and 1-3/4 inch square by 14-gage gate ends. All rail and upright intersections shall be joined by welding. All picket and rail intersections shall also be joined by welding.

2.8 FINISH

- A. Manufactured panels and posts shall be subjected to an inline electrode position coating (E-Coat) process consisting of a multi-stage pretreatment/wash (with zinc phosphate), followed by a duplex application of an epoxy primer and an acrylic topcoat. Minimum cumulative coating thickness of epoxy and acrylic shall be 2 mils (0.058 mm). Coated panels and posts shall be

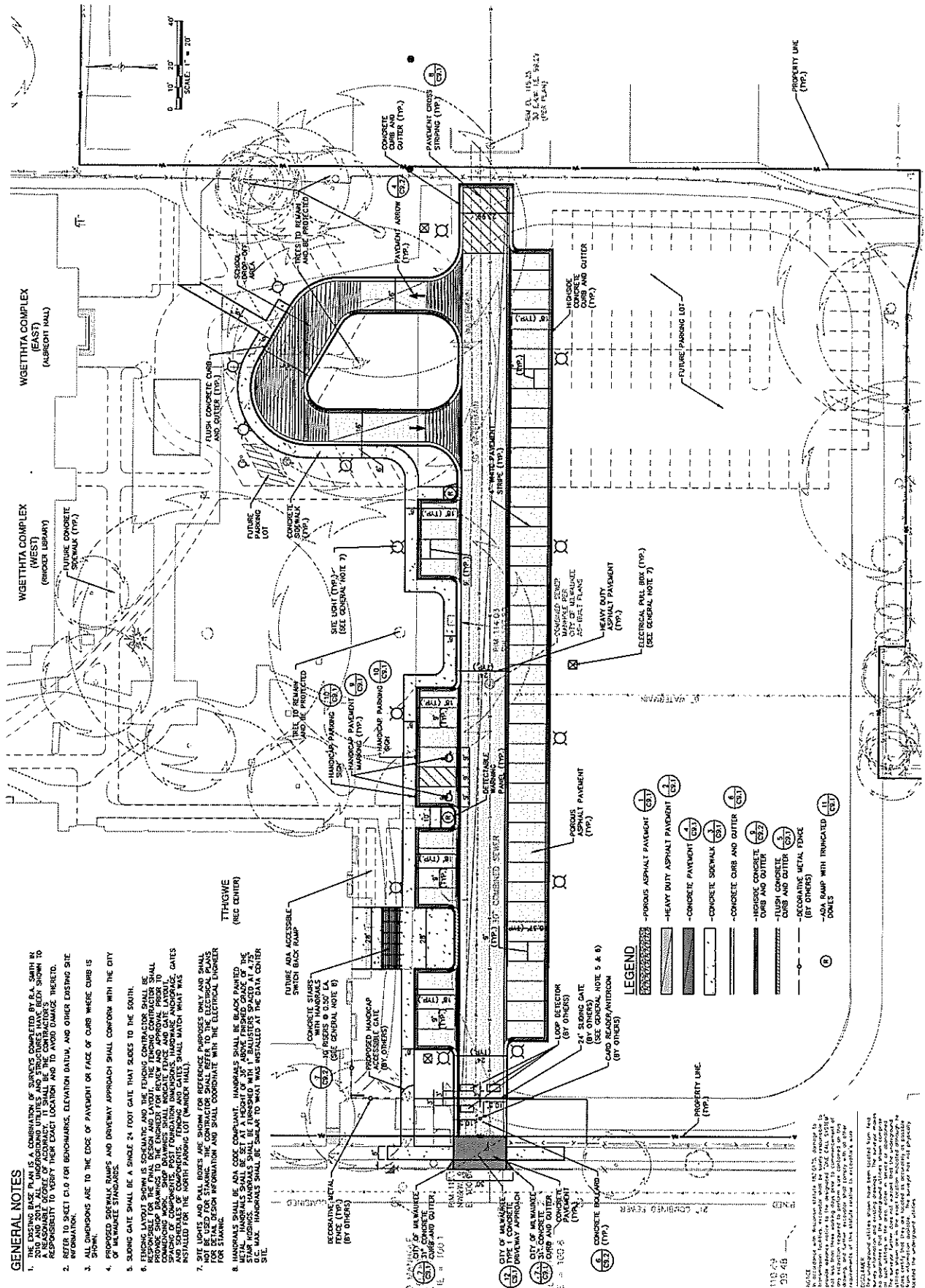

GENERAL NOTES

1. THIS PLAN IS A SUMMARY OF SERVICES COMPLETED BY R.A. SMITH NATIONAL AND IS NOT TO BE USED FOR CONSTRUCTION. THE CONTRACTOR SHALL BE RESPONSIBLE FOR VERIFYING THE EXACT LOCATION AND TO AVOID DAMAGE THEREOF.
2. REFER TO SHEET C1.0 FOR BENCHMARKS, ELEVATION DATUM, AND OTHER EXISTING SITE DATA.
3. ALL DIMENSIONS ARE TO THE EDGE OF PAVEMENT OR FACE OF CURB WHERE CURB IS SHOWN.
4. PROPOSED SIDEWALK RAMPS AND DRIVEWAY APPROACH SHALL CONFORM WITH THE CITY OF MILWAUKEE STANDARDS.
5. SLIDING GATE SHALL BE A SINGLE 24 FOOT GATE THAT SLIDES TO THE SOUTH.
6. FINISH LAYOUTS SHOW IS SCHEMATIC AND THE FINISH CONTRACTOR SHALL BE RESPONSIBLE FOR THE FINAL DESIGN AND LAYOUT. THE FINISH CONTRACTOR SHALL VERIFY THE EXISTING CONDITIONS AND PROVIDE THE FINISH CONTRACTOR WITH ALL NECESSARY INFORMATION TO COMPLETE THE WORK. THE FINISH CONTRACTOR SHALL VERIFY THE EXISTING CONDITIONS AND PROVIDE THE FINISH CONTRACTOR WITH ALL NECESSARY INFORMATION TO COMPLETE THE WORK.
7. SITE LIGHTS AND PAUL BOXES ARE SHOWN FOR REFERENCE PURPOSES ONLY AND SHALL NOT BE USED FOR STAGING. THE CONTRACTOR SHALL REFER TO THE ELECTRICAL PLANS FOR STAGING INFORMATION AND SHALL COORDINATE WITH THE ELECTRICAL ENGINEER FOR STAGING.
8. HANDRAILS SHALL BE ADA CODE COMPLIANT. HANDRAILS SHALL BE BLACK PAINTED METAL. HANDRAILS SHALL BE SET AT A HEIGHT OF 36" ABOVE FINISHED GRADE OF THE WALKWAY. HANDRAILS SHALL BE INSTALLED AT THE DATA CENTER.

LEGEND

- POROUS ASPHALT PAVEMENT (C3.1)
- HEAVY DUTY ASPHALT PAVEMENT (C3.2)
- CONCRETE PAVEMENT (C3.3)
- CONCRETE SIDEWALK (C3.4)
- CONCRETE CURB AND OUTER (C3.5)
- HEAVY DUTY ASPHALT PAVEMENT (C3.6)
- CONCRETE CURB AND OUTER (C3.7)
- CONCRETE SIDEWALK (C3.8)
- RECYCLING METAL FENCE (BY OTHERS)
- ADA RAMP WITH TRIMMED EDGES (C3.9)

NOTES:
 1. THE CONTRACTOR SHALL VERIFY THE EXISTING CONDITIONS AND PROVIDE THE FINISH CONTRACTOR WITH ALL NECESSARY INFORMATION TO COMPLETE THE WORK.
 2. THE CONTRACTOR SHALL VERIFY THE EXISTING CONDITIONS AND PROVIDE THE FINISH CONTRACTOR WITH ALL NECESSARY INFORMATION TO COMPLETE THE WORK.
 3. THE CONTRACTOR SHALL VERIFY THE EXISTING CONDITIONS AND PROVIDE THE FINISH CONTRACTOR WITH ALL NECESSARY INFORMATION TO COMPLETE THE WORK.