



CITY OF MILWAUKEE
OFFICE OF THE CITY CLERK

Thursday, August 30, 2018

COMMITTEE MEETING NOTICE

AD 05

ANDERSON, Darryl L, Agent
A'viands LLC
2900 N Menomonee River Pk

Milwaukee, WI 53222

You are requested to attend a hearing which is to be held in Room 301-B, Third Floor, City Hall on:

Tuesday, September 11, 2018 at 10:00 AM

Regarding: Your Class B Tavern and Public Entertainment Premises License Renewal Applications with Change of Agent as agent for "A'viands LLC" for "A'viands" at 2900 N Menomonee River Pk.

There is a possibility that your application may be denied for one or more of the following reasons: The recommendation of the committee regarding the application shall be based on evidence presented at the hearing. Per MCO 85-4-4, unless otherwise specified in the code, probative evidence concerning non-renewal, suspension or revocation may include evidence of the following: failure of the applicant to meet municipal qualifications, pending charges against or the conviction of any felony, misdemeanor, municipal offense or other offense, the circumstances of which substantially relate to the circumstances of the particular licensed or permitted activity, by the applicant or by any employee or other agent of the applicant. If the activities of the applicant involve a licensed premises, whether the premises tends to facilitate a public or private nuisance or has been the source of congregations of persons which have resulted in any of the following: disturbance of the peace; illegal drug activity; public drunkenness; drinking in public; harassment of passers-by; gambling; prostitution; sale of stolen goods; public urination; theft; assaults; battery; acts of vandalism including graffiti, excessive littering, loitering, illegal parking, loud noise at times when the licensed premise is open for business; traffic violations; curfew violations; lewd conduct; display of materials harmful to minors, pursuant to s. 106-9.6; or any other factor which reasonably relates to the public health, safety and welfare, or failure to comply with the approved plan of operation.

Notice for applicants with warrants or unpaid fines:

Proof of warrant satisfaction or payment of fines must be submitted at the hearing on the above date and time. Failure to comply with this requirement may result in a delay of the granting/denial of your application.

Failure to appear at this meeting may result in the denial of your license. Individual applicants must appear only in person or by an attorney. Corporate or Limited Liability applicants must appear only by the agent designated on the application or by an attorney. Partnership applicants must appear by a partner listed on the application or by an attorney. If you wish to do so and at your own expense, you may be accompanied by an attorney of your choosing to represent you at this hearing.

You will be given an opportunity to speak on behalf of the application and to respond and challenge any charges or reasons given for the denial. No petitions can be accepted by the committee, unless the people who signed the petition are present at the committee hearing and willing to testify. You may present witnesses under oath and you may also confront and cross-examine opposing witnesses under oath. If you have difficulty with the English language, you should bring an interpreter with you, at your expense, so that you can answer questions and participate in your hearing.

You may examine the application file at this office during regular business hours prior to the hearing date. Inquiries regarding this matter may be directed to the person whose signature appears below.

Limited parking for persons attending meetings in City Hall is available at reduced rates (5 hour limit) at the Milwaukee Center on the southwest corner of East Kilbourn and North Water Street. Parking tickets must be validated in the first floor information booth in City Hall.

PLEASE NOTE: Upon reasonable notice, efforts will be made to accommodate the needs of disabled individuals through sign language interpreters or other auxiliary aids. For additional information or to request this service, contact the Council Services Division ADA Coordinator at (414) 286-2998, Fax - (414) 286-3456, TDD - (414) 286-2025.

JIM OWCZARSKI, CITY CLERK

BY:

Jessica Celella

License Division Manager

If you have questions regarding this notice, please contact the License Division at (414) 286-2238.

200 E. Wells Street, Room 105, City Hall, Milwaukee, WI 53202. www.milwaukee.gov/license
Phone: (414) 286-2238 Fax: (414) 286-3057 Email Address: License@milwaukee.gov



Thursday, August 30, 2018



Notice of Public Hearing

ANDERSON, Darryl L, Agent
A'viands at 2900 N Menomonee River Pk
Class B Tavern and Public Entertainment Premises License Renewal Applications with Change of
Agent

Tuesday, September 11, 2018 at 10:00 AM

To whom it may concern:

The above application has been made by the above named applicant(s). This requires approval from the Licenses Committee and the Common Council of the City of Milwaukee. The hearing before the Licenses Committee will take place on 9/11/2018 at 10:00 AM, in Room 301-B, Third Floor, City Hall. If you wish, you may provide testimony at the hearing regarding the request; see below for further information. You are not required to attend the hearing. Once the Licenses Committee makes its recommendation, this recommendation is forwarded to the full Common Council for approval at its next regularly scheduled hearing. Please review the information below and if you have further questions regarding this process, please contact the License Division at (414) 286-2238.

Important details for those wishing to provide information for the Licenses Committee to consider when making its recommendation:

1. The license application is scheduled to be heard at the above time. Due to other hearings running longer than scheduled, you may have to wait some time to provide your testimony.
2. You must appear in person and testify as to matters that you have personally experienced or seen. (You cannot provide testimony for your neighbor, parent or anyone else; this is considered hearsay and cannot be considered by the committee.)
3. No letters or petitions can be accepted by the committee (unless the person who wrote the letter or the persons who signed the petition are present at the committee hearing and willing to testify).
4. Persons opposed to the license application are given the opportunity to testify first; supporters may testify after the opponents have finished.
5. When you are called to testify, you will be sworn in and asked to give your name, and address. (If your first and/or last names are uncommon please spell them.)
6. You may then provide testimony.
 - a. Include only information relating to the above license application.
 - b. Include only information you have personally witnessed or seen.
 - c. Provide concise and relevant information detailing how this business has affected or may affect the peaceful enjoyment of your neighborhood.
 - d. If by the time you have the opportunity to testify, the information you wish to share has already been provided to the committee, you may state that you agree with the previous testimony. Redundant or repetitive testimony will not assist the committee in making its recommendation.
7. After giving your testimony, the members of the Licenses Committee and the licensee may ask questions regarding the testimony you have given or other factors relating to the license application.
8. Business Competition is not a valid basis for denial or non-renewal of a license.
Please Note: If you have submitted an objection to the above application your objection cannot be considered by the committee unless you personally testify at the hearing.

OCCUPANT	MAIL ADDRESS	CITY, STATE ZIP
CURRENT OCCUPANT	3121 N 95TH ST	MILWAUKEE, WI 53222
CURRENT OCCUPANT	3134 N 96TH ST	MILWAUKEE, WI 53222
CURRENT OCCUPANT	9542 W BURLEIGH ST	MILWAUKEE, WI 53222
CURRENT OCCUPANT	9534 W BURLEIGH ST	MILWAUKEE, WI 53222
CURRENT OCCUPANT	9324 W BURLEIGH ST A	MILWAUKEE, WI 53222
CURRENT OCCUPANT	9322 W BURLEIGH ST	MILWAUKEE, WI 53222
CURRENT OCCUPANT	3104 N 93RD ST 1	MILWAUKEE, WI 53222
CURRENT OCCUPANT	3120A N 94TH ST	MILWAUKEE, WI 53222
CURRENT OCCUPANT	2811 N 91ST ST	MILWAUKEE, WI 53222
CURRENT OCCUPANT	2821 N 91ST ST	MILWAUKEE, WI 53222
CURRENT OCCUPANT	2843 N 91ST ST	MILWAUKEE, WI 53222
CURRENT OCCUPANT	2911 N 91ST ST	MILWAUKEE, WI 53222
CURRENT OCCUPANT	2925 N 91ST ST	MILWAUKEE, WI 53222
CURRENT OCCUPANT	2939 N 91ST ST	MILWAUKEE, WI 53222
CURRENT OCCUPANT	2951 N 91ST ST	MILWAUKEE, WI 53222
CURRENT OCCUPANT	2971 N 91ST ST	MILWAUKEE, WI 53222
CURRENT OCCUPANT	3000 N 92ND ST	MILWAUKEE, WI 53222
CURRENT OCCUPANT	3017 N 91ST ST	MILWAUKEE, WI 53222
CURRENT OCCUPANT	9405 W HADLEY ST	MILWAUKEE, WI 53222
CURRENT OCCUPANT	9805 W TOWER VIEW BLVD	MILWAUKEE, WI 53222
CURRENT OCCUPANT	3100 N MENOMONEE RIVER PKWY	MILWAUKEE, WI 53222
CURRENT OCCUPANT	9332 W BURLEIGH ST	MILWAUKEE, WI 53222
CURRENT OCCUPANT	3104 N 93RD ST 3	MILWAUKEE, WI 53222
CURRENT OCCUPANT	9218 W BURLEIGH ST 6	MILWAUKEE, WI 53222
CURRENT OCCUPANT	2800 N 92ND ST	MILWAUKEE, WI 53222
CURRENT OCCUPANT	9100 W HADLEY ST	MILWAUKEE, WI 53222
CURRENT OCCUPANT	2829 N 91ST ST	MILWAUKEE, WI 53222
CURRENT OCCUPANT	2834 N 92ND ST	MILWAUKEE, WI 53222
CURRENT OCCUPANT	2860 N 92ND ST	MILWAUKEE, WI 53222
CURRENT OCCUPANT	9125 W LOCUST ST	MILWAUKEE, WI 53222
CURRENT OCCUPANT	9100 W LOCUST ST	MILWAUKEE, WI 53222
CURRENT OCCUPANT	2909 N 91ST ST	MILWAUKEE, WI 53222
CURRENT OCCUPANT	3011 N 91ST ST	MILWAUKEE, WI 53222
CURRENT OCCUPANT	3029 N 91ST ST	MILWAUKEE, WI 53222
CURRENT OCCUPANT	9705 W TOWER VIEW BLVD	MILWAUKEE, WI 53222
CURRENT OCCUPANT	3038 N 92ND ST	MILWAUKEE, WI 53222
CURRENT OCCUPANT	2845 N 98TH ST	MILWAUKEE, WI 53222
CURRENT OCCUPANT	9520 W BURLEIGH ST	MILWAUKEE, WI 53222
CURRENT OCCUPANT	9510 W BURLEIGH ST	MILWAUKEE, WI 53222
CURRENT OCCUPANT	3120 N 95TH ST	MILWAUKEE, WI 53222
CURRENT OCCUPANT	9600 W BURLEIGH ST	MILWAUKEE, WI 53222
CURRENT OCCUPANT	9320 W BURLEIGH ST	MILWAUKEE, WI 53222
CURRENT OCCUPANT	9218 W BURLEIGH ST 4	MILWAUKEE, WI 53222
CURRENT OCCUPANT	3120 N 94TH ST	MILWAUKEE, WI 53222
CURRENT OCCUPANT	2774 N 92ND ST 1	MILWAUKEE, WI 53222
CURRENT OCCUPANT	2808 N 92ND ST	MILWAUKEE, WI 53222

CURRENT OCCUPANT	2815 N 91ST ST	MILWAUKEE, WI 53222
CURRENT OCCUPANT	2822 N 92ND ST	MILWAUKEE, WI 53222
CURRENT OCCUPANT	2855 N 91ST ST	MILWAUKEE, WI 53222
CURRENT OCCUPANT	2863 N 91ST ST	MILWAUKEE, WI 53222
CURRENT OCCUPANT	2965 N 91ST ST	MILWAUKEE, WI 53222
CURRENT OCCUPANT	9105 W CHAMBERS ST	MILWAUKEE, WI 53222
CURRENT OCCUPANT	3023 N 91ST ST	MILWAUKEE, WI 53222
CURRENT OCCUPANT	9541 W HADLEY ST	MILWAUKEE, WI 53222
CURRENT OCCUPANT	9503 W HADLEY ST	MILWAUKEE, WI 53222
CURRENT OCCUPANT	2805 N 92ND ST	MILWAUKEE, WI 53222
CURRENT OCCUPANT	2861 N COLONIAL DR	MILWAUKEE, WI 53222
CURRENT OCCUPANT	3054 N 92ND ST	MILWAUKEE, WI 53222
CURRENT OCCUPANT	2860 N MENOMONEE RIVER PKWY	MILWAUKEE, WI 53222
CURRENT OCCUPANT	2804 N 98TH ST	MILWAUKEE, WI 53222
CURRENT OCCUPANT	2814 N 98TH ST	MILWAUKEE, WI 53222
CURRENT OCCUPANT	3115 N ARGONNE DR	MILWAUKEE, WI 53222
CURRENT OCCUPANT	3105 N 93RD ST	MILWAUKEE, WI 53222
CURRENT OCCUPANT	3104 N 93RD ST 4	MILWAUKEE, WI 53222
CURRENT OCCUPANT	9218 W BURLEIGH ST 3	MILWAUKEE, WI 53222
CURRENT OCCUPANT	3123 N 94TH ST	MILWAUKEE, WI 53222
CURRENT OCCUPANT	3121 N 93RD ST	MILWAUKEE, WI 53222
CURRENT OCCUPANT	2764 N 92ND ST 3	MILWAUKEE, WI 53222
CURRENT OCCUPANT	2936 N 92ND ST	MILWAUKEE, WI 53222
CURRENT OCCUPANT	2944 N 92ND ST	MILWAUKEE, WI 53222
CURRENT OCCUPANT	2952 N 92ND ST	MILWAUKEE, WI 53222
CURRENT OCCUPANT	9131 W CHAMBERS ST	MILWAUKEE, WI 53222
CURRENT OCCUPANT	9231 W HADLEY ST	MILWAUKEE, WI 53222
CURRENT OCCUPANT	9609 W HADLEY ST	MILWAUKEE, WI 53222
CURRENT OCCUPANT	9217 W HADLEY ST	MILWAUKEE, WI 53222
CURRENT OCCUPANT	2839 N COLONIAL DR	MILWAUKEE, WI 53222
CURRENT OCCUPANT	9528 W BURLEIGH ST	MILWAUKEE, WI 53222
CURRENT OCCUPANT	9430 W BURLEIGH ST	MILWAUKEE, WI 53222
CURRENT OCCUPANT	3120 N ARGONNE DR	MILWAUKEE, WI 53222
CURRENT OCCUPANT	9422 W BURLEIGH ST	MILWAUKEE, WI 53222
CURRENT OCCUPANT	9410 W BURLEIGH ST	MILWAUKEE, WI 53222
CURRENT OCCUPANT	9324 W BURLEIGH ST	MILWAUKEE, WI 53222
CURRENT OCCUPANT	9218 W BURLEIGH ST 1	MILWAUKEE, WI 53222
CURRENT OCCUPANT	9218 W BURLEIGH ST 2	MILWAUKEE, WI 53222
CURRENT OCCUPANT	2764 N 92ND ST 1	MILWAUKEE, WI 53222
CURRENT OCCUPANT	2774 N 92ND ST 4	MILWAUKEE, WI 53222
CURRENT OCCUPANT	2809 N 91ST ST	MILWAUKEE, WI 53222
CURRENT OCCUPANT	2828 N 92ND ST	MILWAUKEE, WI 53222
CURRENT OCCUPANT	2837 N 91ST ST	MILWAUKEE, WI 53222
CURRENT OCCUPANT	2842 N 92ND ST	MILWAUKEE, WI 53222
CURRENT OCCUPANT	2850 N 92ND ST	MILWAUKEE, WI 53222
CURRENT OCCUPANT	2900 N 92ND ST	MILWAUKEE, WI 53222
CURRENT OCCUPANT	2920A N 92ND ST	MILWAUKEE, WI 53222

CURRENT OCCUPANT	2945 N 91ST ST	MILWAUKEE, WI 53222
CURRENT OCCUPANT	3043 N 91ST ST	MILWAUKEE, WI 53222
CURRENT OCCUPANT	9323 W HADLEY ST	MILWAUKEE, WI 53222
CURRENT OCCUPANT	9301 W HADLEY ST	MILWAUKEE, WI 53222
CURRENT OCCUPANT	3012 N 92ND ST	MILWAUKEE, WI 53222
CURRENT OCCUPANT	3028 N 92ND ST	MILWAUKEE, WI 53222
CURRENT OCCUPANT	2880 N MENOMONEE RIVER PKWY	MILWAUKEE, WI 53222
CURRENT OCCUPANT	3125 N COLONIAL DR	MILWAUKEE, WI 53222
CURRENT OCCUPANT	3115 N COLONIAL DR	MILWAUKEE, WI 53222
CURRENT OCCUPANT	9550 W BURLEIGH ST	MILWAUKEE, WI 53222
CURRENT OCCUPANT	3121 N 92ND ST	MILWAUKEE, WI 53222
CURRENT OCCUPANT	2774 N 92ND ST 3	MILWAUKEE, WI 53222
CURRENT OCCUPANT	2866 N 92ND ST	MILWAUKEE, WI 53222
CURRENT OCCUPANT	2871 N 91ST ST	MILWAUKEE, WI 53222
CURRENT OCCUPANT	2919 N 91ST ST	MILWAUKEE, WI 53222
CURRENT OCCUPANT	2931 N 91ST ST	MILWAUKEE, WI 53222
CURRENT OCCUPANT	2960 N 92ND ST	MILWAUKEE, WI 53222
CURRENT OCCUPANT	3003 N 91ST ST	MILWAUKEE, WI 53222
CURRENT OCCUPANT	2828 N COLONIAL DR	MILWAUKEE, WI 53222
CURRENT OCCUPANT	9415 W HADLEY ST	MILWAUKEE, WI 53222
CURRENT OCCUPANT	2853 N COLONIAL DR	MILWAUKEE, WI 53222
CURRENT OCCUPANT	2844 N 98TH ST	MILWAUKEE, WI 53222
CURRENT OCCUPANT	3100 N ARGONNE DR	MILWAUKEE, WI 53222
CURRENT OCCUPANT	3150 N 96TH ST	MILWAUKEE, WI 53222
CURRENT OCCUPANT	3110 N MENOMONEE RIVER PKWY	MILWAUKEE, WI 53222
CURRENT OCCUPANT	9700 W BURLEIGH ST	MILWAUKEE, WI 53222
CURRENT OCCUPANT	9416 W BURLEIGH ST	MILWAUKEE, WI 53222
CURRENT OCCUPANT	9404 W BURLEIGH ST	MILWAUKEE, WI 53222
CURRENT OCCUPANT	9218 W BURLEIGH ST 5	MILWAUKEE, WI 53222
CURRENT OCCUPANT	3122 N 93RD ST	MILWAUKEE, WI 53222
CURRENT OCCUPANT	2764 N 92ND ST 2	MILWAUKEE, WI 53222
CURRENT OCCUPANT	2774 N 92ND ST 2	MILWAUKEE, WI 53222
CURRENT OCCUPANT	2814 N 92ND ST	MILWAUKEE, WI 53222
CURRENT OCCUPANT	2914 N 92ND ST	MILWAUKEE, WI 53222
CURRENT OCCUPANT	2920 N 92ND ST	MILWAUKEE, WI 53222
CURRENT OCCUPANT	2959 N 91ST ST	MILWAUKEE, WI 53222
CURRENT OCCUPANT	3033 N 91ST ST	MILWAUKEE, WI 53222
CURRENT OCCUPANT	3055 N 91ST ST	MILWAUKEE, WI 53222
CURRENT OCCUPANT	2814 N COLONIAL DR	MILWAUKEE, WI 53222
CURRENT OCCUPANT	9551 W HADLEY ST	MILWAUKEE, WI 53222
CURRENT OCCUPANT	9619 W HADLEY ST	MILWAUKEE, WI 53222
CURRENT OCCUPANT	9425 W HADLEY ST	MILWAUKEE, WI 53222
CURRENT OCCUPANT	9309 W HADLEY ST	MILWAUKEE, WI 53222
CURRENT OCCUPANT	2822 N 98TH ST	MILWAUKEE, WI 53222
CURRENT OCCUPANT	9731 W TOWER VIEW BLVD	MILWAUKEE, WI 53222
CURRENT OCCUPANT	3020 N 92ND ST	MILWAUKEE, WI 53222
CURRENT OCCUPANT	3105 N 95TH ST	MILWAUKEE, WI 53222

CURRENT OCCUPANT	3125 N ARGONNE DR	MILWAUKEE, WI 53222
CURRENT OCCUPANT	9314A W BURLEIGH ST	MILWAUKEE, WI 53222
CURRENT OCCUPANT	9314 W BURLEIGH ST	MILWAUKEE, WI 53222
CURRENT OCCUPANT	9300 W BURLEIGH ST	MILWAUKEE, WI 53222
CURRENT OCCUPANT	3104 N 93RD ST 2	MILWAUKEE, WI 53222
CURRENT OCCUPANT	2764 N 92ND ST 4	MILWAUKEE, WI 53222
CURRENT OCCUPANT	2926 N 92ND ST	MILWAUKEE, WI 53222
CURRENT OCCUPANT	2966 N 92ND ST	MILWAUKEE, WI 53222
CURRENT OCCUPANT	3049 N 91ST ST	MILWAUKEE, WI 53222
CURRENT OCCUPANT	9527 W HADLEY ST	MILWAUKEE, WI 53222
CURRENT OCCUPANT	9515 W HADLEY ST	MILWAUKEE, WI 53222
CURRENT OCCUPANT	9331 W HADLEY ST	MILWAUKEE, WI 53222
CURRENT OCCUPANT	2775 N 92ND ST	MILWAUKEE, WI 53222
CURRENT OCCUPANT	2801 N COLONIAL DR	MILWAUKEE, WI 53222
CURRENT OCCUPANT	2825 N COLONIAL DR	MILWAUKEE, WI 53222
CURRENT OCCUPANT	2834 N 98TH ST	MILWAUKEE, WI 53222
CURRENT OCCUPANT	3048 N 92ND ST	MILWAUKEE, WI 53222

Total Records: 157

Radius: 250.0 feet and Center of Circle: 2900 N Menomonee River Pkwy

2018-2019 Plan of Operation for 2900 N MENOMONEE RIVER PK

1. Litter & Security Plans

How are the grounds kept clean? Sweep Pressure Wash Pick Up Litter Other: Maintenance Dept

How often will grounds be cleaned? Daily Weekly Other:

Who cleans the grounds? Licensee Building Owner Employees Hired Maintenance Other:

How are noise issues prevented and/or addressed? Security Manager approaches customer(s) Call Police Signs Posted Other:

Are there designated outdoor smoking areas? No Yes If Yes, Describe: Designated Area

Number of garbage cans: Inside 2 per floor Locations: Campus wide
 Outside 1 Locations: Loading Dock

Is a crowd control barrier used? No Yes If Yes, Describe:

Number of restrooms: 4 Name of solid waste contractor: Waste management

Are there parking spaces on the premises? No Yes If Yes, list number of spaces: 200 and describe security plans:
Security Personnel

Are there designated loading areas? No Yes If Yes, describe security plans:
Cameras

Do you have security personnel on the premise? No Yes If Yes, how many? 2 per shift
 AND What are their responsibilities? Campus Security
 What security equipment do they use? Radio & Flash Lights
 List their licensing, certification or training credentials: Retired MPD officers

Are there security cameras? No Yes If Yes, list all locations: Inside and outside

Are searches and/or identification checks conducted upon entry? No Yes If Yes, describe:

2. Percentage of Sales (must total 100%)

Alcohol 10 % Food Sales 90 % Entertainment _____ % Other _____ %

3. Businesses On The Premises (choose all that apply):

Restaurant Cafe/Coffee Shop Cocktail Lounge Convenience Store Night Club Liquor Store Tavern Sports Facility
 Hotel Banquet Hall Supermarket Private/Fraternal/Veterans' Club Other:

4. Hours of Operation and Age Restriction

Are there any changes to the current hours of operation or age restriction? No Yes If Yes, Describe:

Please Note: If you will be open earlier or later than the hours listed on your current license for even one event or holiday (for example, St. Patrick's Day, Brewers Opening Day, etc.) during the license period, this must be reported and printed on your license.
 Your hours of operation and age restriction are listed on your current license.

5. Floor Plan and Capacity

Are you requesting any changes to your capacity or floor plan*? No Yes If yes, describe: _____ and submit a new floor plan with this renewal application. A sample plan can be found online at www.milwaukee.gov/licenses under License Forms and Related Information.

Alcohol/Food Establishments: A "Permanent Extension of Premises Application" is required if you are adding any square footage to the licensed premises.

6. Sidewalk Dining: Fee:

Are there any changes to the sidewalk dining site plan? No Yes If Yes, submit an updated site plan with this application.

7. Food License: Fee:

Your current food license includes the following food operations: Are there any changes to your food operations as listed above? No Yes, if Yes, explain _____

8. Weights and Measures: Fee:

Number/Type of Devices:
 Are there any changes to the number or types of devices? No Yes
 If yes, contact our office for further instructions.

1. CURRENT APPROVED ENTERTAINMENT

The following types of entertainment have been approved for your current Public Entertainment Premises license:

Disc Jockey, Dancing by Performer(s), Patrons Dancing, Bands

2. ADDING ENTERTAINMENT

If applicable, check any entertainment you wish to add: **ONLY CHECK ENTERTAINMENT TYPE(S) YOU ARE ADDING. YOUR CURRENT APPROVED ENTERTAINMENT IS LISTED ABOVE.**

- | | | | |
|---|--|--|---|
| <input type="checkbox"/> Instrumental Musicians | <input type="checkbox"/> Bands | <input type="checkbox"/> Battle of the Bands | <input type="checkbox"/> Comedy Acts |
| <input type="checkbox"/> Disc Jockey | <input type="checkbox"/> Magic Shows | <input type="checkbox"/> Poetry Readings | <input type="checkbox"/> Dancing by Performers |
| <input type="checkbox"/> Jukebox | <input type="checkbox"/> Wrestling | <input type="checkbox"/> Patron Contests | <input type="checkbox"/> Patrons Dancing |
| <input type="checkbox"/> Adult Entertainment/
Strippers/Erotic Dance | <input type="checkbox"/> Karaoke | <input type="checkbox"/> Bowling Alley
How many? _____ | <input type="checkbox"/> Pool Tables
How many? _____ |
| <input type="checkbox"/> Motion Pictures (movies by admission)
How many screens? _____ | <input type="checkbox"/> Amusement Machines
How many? _____ | <input type="checkbox"/> Concerts
Approx. # per year? _____ | <input type="checkbox"/> Theatrical Performances
Approx. # per year? _____ |
| <input type="checkbox"/> Other: _____ | | | |

No entertainment changes can take place until approved by Common Council and a new license has been issued and posted on the premises.

3. REMOVING ENTERTAINMENT

If applicable, list any entertainment you wish to remove:

4. PROMOTERS/SOUND AMPLIFICATION

Will promoters ever be used for any of the entertainment? No Yes If Yes, Describe:

At any time will sound amplification be used? No Yes If Yes, Describe:

5. NOTARIZED SIGNATURE

I understand that after the license has been issued, a change to the plan of operation will require a written request to change and approval from the Common Council.

I agree to inform the City Clerk within 10 days of any substantial changes in the information supplied in this application.

I understand that I shall not willfully refuse to provide the services offered under this license, or add charges or require deposits not required of the general public because of race, color, sex, religion, national origin or ancestry, age, handicap, lawful source of income, marital status, sexual orientation, gender identity or expression, familial status or the fact that a person is now or has been a member of the military service, whether dressed in uniform or not; and shall not seek such information as a condition of employment, or penalize any employee or discriminate in the selection of personnel for training or promotion on the basis of such information.

I have knowledge of the City Ordinances currently regulating public entertainment, and understand that the license may be subject to suspension, non-renewal or revocation, if I violate any rule, law or regulation of the city of Milwaukee and State of Wisconsin.

SUBSCRIBED AND SWORN TO BEFORE ME

on 1 day of August, 2018

Sharon L. Roob
(Notary Public)
Commission Expires APRIL 5, 2022
Seal must be affixed.

Deaf Adams
Sole Proprietor, a Partner, or if a Corporation or LLC,
the Agent must sign

**Sharon L. Roob
Notary Public
State of Wisconsin**



**CITY OF MILWAUKEE
OFFICE OF THE CITY CLERK**

Thursday, August 30, 2018

COMMITTEE MEETING NOTICE

AD 05

ARMON, Maureen E, Agent
Tranquil Escape Day Spa, LLC
8125 W Capitol DR

Milwaukee, WI 53222

You are requested to attend a hearing which is to be held in Room 301-B, Third Floor, City Hall on:

Tuesday, September 11, 2018 at 10:00 AM

Regarding: Your Tattoo and Body Piercing License Application as agent  "Tranquil Escape Day Spa, LLC" for "Tranquil Escape Day Spa" at 8125 W Capitol DR.

There is a possibility that your application may be denied for one or more of the following reasons: The recommendation of the committee regarding the application shall be based on evidence presented at the hearing. Per MCO 85-2.7-4, probative evidence concerning whether or not a new license should be granted may be presented on the following subjects: whether or not the applicant meets the municipal requirements, the appropriateness of the location and premises where the licensed premises is to be located and whether use of the premises for the purposes or activities permitted by the license would tend to facilitate a public or private nuisance or create undesirable neighborhood problems such as disorderly patrons, unreasonably loud noise, litter, and excessive traffic and parking congestion. Probative evidence relating to these matters may be taken from the plan of operation submitted with the license application, if any, but shall not include the content of any music. Evidence regarding the fitness of the location of the premises to be maintained as the principal place of business, including but not limited to whether there is an overconcentration of businesses of the type for which the license is sought; whether the proposal is consistent with any pertinent neighborhood business or development plans, or the location's proximity to areas where children are typically present. The applicant's record in operating similarly licensed premises; and whether or not the applicant has been charged with or convicted of any felony, misdemeanor, municipal offense or other offense, the circumstances of which substantially relate to the activity to be permitted by the license being applied for or any other factor which reasonably relates to the public health, safety or welfare may also be considered.

Notice for applicants with warrants or unpaid fines:

Proof of warrant satisfaction or payment of fines must be submitted at the hearing on the above date and time. Failure to comply with this requirement may result in a delay of the granting/denial of your application.

Failure to appear at this meeting may result in the denial of your license. Individual applicants must appear only in person or by an attorney. Corporate or Limited Liability applicants must appear only by the agent designated on the application or by an attorney. Partnership applicants must appear by a partner listed on the application or by an attorney. If you wish to do so and at your own expense, you may be accompanied by an attorney of your choosing to represent you at this hearing.

You will be given an opportunity to speak on behalf of the application and to respond and challenge any charges or reasons given for the denial. No petitions can be accepted by the committee, unless the people who signed the petition are present at the committee hearing and willing to testify. You may present witnesses under oath and you may also confront and cross-examine opposing witnesses under oath. If you have difficulty with the English language, you should bring an interpreter with you, at your expense, so that you can answer questions and participate in your hearing.

You may examine the application file at this office during regular business hours prior to the hearing date. Inquiries regarding this matter may be directed to the person whose signature appears below.

Limited parking for persons attending meetings in City Hall is available at reduced rates (5 hour limit) at the Milwaukee Center on the southwest corner of East Kilbourn and North Water Street. Parking tickets must be validated in the first floor information booth in City Hall.

PLEASE NOTE: Upon reasonable notice, efforts will be made to accommodate the needs of disabled individuals through sign language interpreters or other auxiliary aids. For additional information or to request this service, contact the Council Services Division ADA Coordinator at (414) 286-2998, Fax - (414) 286-3456, TDD - (414) 286-2025.

JIM OWCZARSKI, CITY CLERK

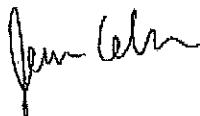

BY: _____

Jessica Celella

License Division Manager

If you have questions regarding this notice, please contact the License Division at (414) 286-2238.

200 E. Wells Street, Room 105, City Hall, Milwaukee, WI 53202. www.milwaukee.gov/license
Phone: (414) 286-2238 Fax: (414) 286-3057 Email Address: License@milwaukee.gov



CITY OF MILWAUKEE
OFFICE OF THE CITY CLERK

Thursday, August 30, 2018

COMMITTEE MEETING NOTICE

AD 05

ARMON, Maureen E, Agent
Tranquil Escape Day Spa, LLC
4211 N 78th St

Milwaukee, WI 53222

You are requested to attend a hearing which is to be held in Room 301-B, Third Floor, City Hall on:

Tuesday, September 11, 2018 at 10:00 AM

Regarding: Your Tattoo and Body Piercing License Application as agent for "Tranquil Escape Day Spa, LLC" for "Tranquil Escape Day Spa" at 8125 W Capitol DR.

There is a possibility that your application may be denied for one or more of the following reasons: The recommendation of the committee regarding the application shall be based on evidence presented at the hearing. Per MCO 85-2.7-4, probative evidence concerning whether or not a new license should be granted may be presented on the following subjects: whether or not the applicant meets the municipal requirements, the appropriateness of the location and premises where the licensed premises is to be located and whether use of the premises for the purposes or activities permitted by the license would tend to facilitate a public or private nuisance or create undesirable neighborhood problems such as disorderly patrons, unreasonably loud noise, litter, and excessive traffic and parking congestion. Probative evidence relating to these matters may be taken from the plan of operation submitted with the license application, if any, but shall not include the content of any music. Evidence regarding the fitness of the location of the premises to be maintained as the principal place of business, including but not limited to whether there is an overconcentration of businesses of the type for which the license is sought; whether the proposal is consistent with any pertinent neighborhood business or development plans, or the location's proximity to areas where children are typically present. The applicant's record in operating similarly licensed premises; and whether or not the applicant has been charged with or convicted of any felony, misdemeanor, municipal offense or other offense, the circumstances of which substantially relate to the activity to be permitted by the license being applied for or any other factor which reasonably relates to the public health, safety or welfare may also be considered.

Notice for applicants with warrants or unpaid fines:

Proof of warrant satisfaction or payment of fines must be submitted at the hearing on the above date and time. Failure to comply with this requirement may result in a delay of the granting/denial of your application.

Failure to appear at this meeting may result in the denial of your license. Individual applicants must appear only in person or by an attorney. Corporate or Limited Liability applicants must appear only by the agent designated on the application or by an attorney. Partnership applicants must appear by a partner listed on the application or by an attorney. If you wish to do so and at your own expense, you may be accompanied by an attorney of your choosing to represent you at this hearing.

You will be given an opportunity to speak on behalf of the application and to respond and challenge any charges or reasons given for the denial. No petitions can be accepted by the committee, unless the people who signed the petition are present at the committee hearing and willing to testify. You may present witnesses under oath and you may also confront and cross-examine opposing witnesses under oath. If you have difficulty with the English language, you should bring an interpreter with you, at your expense, so that you can answer questions and participate in your hearing.

You may examine the application file at this office during regular business hours prior to the hearing date. Inquiries regarding this matter may be directed to the person whose signature appears below.

Limited parking for persons attending meetings in City Hall is available at reduced rates (5 hour limit) at the Milwaukee Center on the southwest corner of East Kilbourn and North Water Street. Parking tickets must be validated in the first floor information booth in City Hall.

PLEASE NOTE: Upon reasonable notice, efforts will be made to accommodate the needs of disabled individuals through sign language interpreters or other auxiliary aids. For additional information or to request this service, contact the Council Services Division ADA Coordinator at (414) 286-2998, Fax - (414) 286-3456, TDD - (414) 286-2025.

JIM OWCZARSKI, CITY CLERK

BY: _____

Jessica Celella

License Division Manager

If you have questions regarding this notice, please contact the License Division at (414) 286-2238.

200 E. Wells Street, Room 105, City Hall, Milwaukee, WI 53202. www.milwaukee.gov/license
Phone: (414) 286-2238 Fax: (414) 286-3057 Email Address: License@milwaukee.gov



Thursday, August 30, 2018



Notice of Public Hearing

ARMON, Maureen E, Agent
Tranquil Escape Day Spa at 8125 W Capitol DR
Tattoo and Body Piercing License Application

Tuesday, September 11, 2018 at 10:00 AM

To whom it may concern:

The above application has been made by the above named applicant(s). This requires approval from the Licenses Committee and the Common Council of the City of Milwaukee. The hearing before the Licenses Committee will take place on 9/11/2018 at 10:00 AM, in Room 301-B, Third Floor, City Hall. If you wish, you may provide testimony at the hearing regarding the request; see below for further information. You are not required to attend the hearing. Once the Licenses Committee makes its recommendation, this recommendation is forwarded to the full Common Council for approval at its next regularly scheduled hearing. Please review the information below and if you have further questions regarding this process, please contact the License Division at (414) 286-2238.

Important details for those wishing to provide information for the Licenses Committee to consider when making its recommendation:

1. The license application is scheduled to be heard at the above time. Due to other hearings running longer than scheduled, you may have to wait some time to provide your testimony.
2. You must appear in person and testify as to matters that you have personally experienced or seen. (You cannot provide testimony for your neighbor, parent or anyone else; this is considered hearsay and cannot be considered by the committee.)
3. No letters or petitions can be accepted by the committee (unless the person who wrote the letter or the persons who signed the petition are present at the committee hearing and willing to testify).
4. Persons opposed to the license application are given the opportunity to testify first; supporters may testify after the opponents have finished.
5. When you are called to testify, you will be sworn in and asked to give your name, and address. (If your first and/or last names are uncommon please spell them.)
6. You may then provide testimony.
 - a. Include only information relating to the above license application.
 - b. Include only information you have personally witnessed or seen.
 - c. Provide concise and relevant information detailing how this business has affected or may affect the peaceful enjoyment of your neighborhood.
 - d. If by the time you have the opportunity to testify, the information you wish to share has already been provided to the committee, you may state that you agree with the previous testimony. Redundant or repetitive testimony will not assist the committee in making its recommendation.
7. After giving your testimony, the members of the Licenses Committee and the licensee may ask questions regarding the testimony you have given or other factors relating to the license application.
8. Business Competition is not a valid basis for denial or non-renewal of a license.
Please Note: If you have submitted an objection to the above application your objection cannot be considered by the committee unless you personally testify at the hearing.

OCCUPANT	MAIL ADDRESS	CITY, STATE ZIP
CURRENT OCCUPANT	3928 N 82ND ST	MILWAUKEE, WI 53222
CURRENT OCCUPANT	3935 N 82ND ST	MILWAUKEE, WI 53222
CURRENT OCCUPANT	8131 W CAPITOL DR	MILWAUKEE, WI 53222
CURRENT OCCUPANT	8105 W CAPITOL DR 4	MILWAUKEE, WI 53222
CURRENT OCCUPANT	8105 W CAPITOL DR 5	MILWAUKEE, WI 53222
CURRENT OCCUPANT	8105 W CAPITOL DR 3	MILWAUKEE, WI 53222
CURRENT OCCUPANT	3935 N 81ST ST	MILWAUKEE, WI 53222
CURRENT OCCUPANT	3949 N 82ND ST	MILWAUKEE, WI 53222
CURRENT OCCUPANT	3941 N 81ST ST	MILWAUKEE, WI 53222
CURRENT OCCUPANT	8105 W CAPITOL DR 2	MILWAUKEE, WI 53222
CURRENT OCCUPANT	8105 W CAPITOL DR 1	MILWAUKEE, WI 53222
CURRENT OCCUPANT	3929 N 81ST ST	MILWAUKEE, WI 53222
CURRENT OCCUPANT	3957 N 81ST ST	MILWAUKEE, WI 53222
CURRENT OCCUPANT	8123 W CAPITOL DR	MILWAUKEE, WI 53222
CURRENT OCCUPANT	3952 N 81ST ST	MILWAUKEE, WI 53222
CURRENT OCCUPANT	3951 N 81ST ST	MILWAUKEE, WI 53222
CURRENT OCCUPANT	3954 N 83RD ST	MILWAUKEE, WI 53222
CURRENT OCCUPANT	8105 W CAPITOL DR 6	MILWAUKEE, WI 53222
CURRENT OCCUPANT	3950 N 82ND ST	MILWAUKEE, WI 53222
CURRENT OCCUPANT	3929 N 82ND ST	MILWAUKEE, WI 53222
CURRENT OCCUPANT	3947 N 82ND ST	MILWAUKEE, WI 53222
CURRENT OCCUPANT	3948 N 83RD ST	MILWAUKEE, WI 53222
CURRENT OCCUPANT	3956 N 82ND ST	MILWAUKEE, WI 53222
CURRENT OCCUPANT	3934 N 82ND ST	MILWAUKEE, WI 53222
CURRENT OCCUPANT	3940 N 82ND ST	MILWAUKEE, WI 53222
CURRENT OCCUPANT	3944 N 82ND ST	MILWAUKEE, WI 53222
CURRENT OCCUPANT	3957 N 82ND ST	MILWAUKEE, WI 53222

Total Records: 27

Radius: 250.0 feet and Center of Circle: 8125 W Capitol Dr



BUSINESS LICENSE PLAN OF OPERATION

ccl-busplan 12/14/17

Office of the City Clerk License Division
200 E. Wells St. Room 105, Milwaukee, WI 53202
(414) 286-2238 www.milwaukee.gov/license e-mail address: license@milwaukee.gov

1. Type of Business

Applying for: Extended Hours (12AM to 5AM) - If a food establishment, check all that apply: Delivery Drive Thru Dining Room
 Self Service Laundry Massage Establishment Filling Station
 Other (supplemental application for specific license also required)

Provide a detailed description of the type of business you plan on operating:

Microblading

Do you have any experience operating this type of business? No Yes If yes, explain: *I currently own the Day Spa*

2. Business Operations

- a. Proposed Opening Date: *8/1/18*
- b. Is this premise under construction? No Yes If yes, list estimated completion date: _____
- c. Is this a franchise? No Yes
- d. Is this premises currently licensed? No Yes If yes, list type of license: *Day Spa, Esthetics, Manicuring*
- e. Is the current licensee operating? No Yes If no, list date closed: _____
- f. Do you have future plans for other businesses, licenses or permits at this location? No Yes
If yes, explain: _____
- g. Have you previously held an Extended Hours License in Milwaukee? No Yes
If yes, list address(es): _____
- h. Are other businesses operating in the same building? No Yes If yes, describe: *Esthetics & Manicuring*

3. Litter & Noise

- a. How are grounds kept clean? Sweep Pressure Wash Pick Up Litter Other: _____
- b. How often will grounds be cleaned? Daily Weekly As Needed Monthly Other: _____
- c. Grounds cleaned by: Licensee Building Owner Employees Hired Maintenance Other: _____
- d. How are noise issues prevented and/or addressed? Security Manager approaches customer(s) Call Police
 Signs Posted Other: *There is no noise / it's a relaxing environment for our clients*
- e. Will a sound amplification system be used? No Yes If yes, describe: _____

4. Smoking & Sanitation

- a. Are there designated outdoor smoking areas? No Yes If yes, describe: *Smoking is not allowed*
- b. Number of Garbage Cans: Inside: *6* Locations: *Kitchen, Bathroom, Retail area, 3 Treatment rooms*
Outside: *2* Locations: *Scav parking lot*
- c. Is a crowd control barrier used? No Yes If yes, describe: *NO crowd*
- d. How many restrooms are on the premises? *2*
- e. Name of solid waste contractor: Advanced Disposal Waste Management Other: *DPW*

5. Security

- a. Are there onsite parking spaces? No Yes If yes, indicate how many? 5 and describe the parking security plan: parking is for employee's only, signs posted, security cameras
- b. Is there a loading zone? No Yes If yes, describe the loading area security plan: _____
- c. Will you have security personnel on premise? No Yes If yes, how many? _____ and answer the following:
 What are their responsibilities? _____
 Is security equipment used? No Yes If yes, describe Security cameras inside + out
 List their licensing, certification, or training credentials _____
- d. Will there be security cameras? No Yes If yes, where? inside (5), outside (2)
- e. Will searches/identification checks be done upon entry? No Yes If yes, describe _____

6. Percentage of Sales (must total 100%)

Alcohol _____%	Food _____%	Secondhand Merchandise _____%	Precious Metals & Gems _____%
Entertainment _____%	Cigarettes _____%		
Pawnbroker Activity _____%	Salvaged Materials _____% (such as scrap metal)	Personal Services (such as <u>tattoo</u> , body piercing, salon, tailor, tanning, etc.) <u>50</u> %	Other <u>50</u> % Describe: <u>Spa Services</u>

7. Businesses/Licenses on the Premises (check all that apply):

Type 1

- Full Service Restaurant Cafe/Coffee Shop Deli or Fast Food Restaurant Private/Fraternal/Veterans Club
- Night Club Tavern Cocktail Lounge Teen Club
- Banquet Hall Sports Facility Bowling Alley
- Hotel/Motel : Number of Floors: _____ Rooming House: Number of Floors: _____
 Number of Rooms: _____ Number of Rooms: _____

Type 2

- Liquor Store Corner Store Supermarket Convenience Store
- Gas Station Amusement/Phonograph Distributor Recycling, Salvage or Towing
- Used Car Dealer Personal Service Establishment
 (such as tattoo business, hair salon, tailor, etc.) Recording Studio

What other licenses/permits will you hold at this location? (check all that apply)

- Occupancy Permit Cigarette & Tobacco Gas Station Extended Hours Class "B" Tavern Weights & Measures
- Secondhand Dealer Precious Metal & Gem Other: _____

8. Legal Capacity (only if a Type 1 premises in #7 above)

Capacity _____ (Call the Milwaukee Development Center at 414-286-8211 if you have questions.)

9. Premises Description

- a. Identify all area(s) of the premises that will be used in operating this business (include areas used only for storage):
 1st Floor 2nd Floor Basement Storage Patio Beer Garden Sidewalk Café Deck Rooftop
 Other: Describe: _____
- b. Describe Location: Major Thoroughfare Secondary Street Other: _____
- c. Nearest Major Cross Street: 82nd Street
- d. Describe Building: Free Standing Building Strip Mall Other: _____
- e. Describe Premises Structure: Single Story Multi-Story - # of Stories 2 Other: _____
- f. Describe Surrounding Area: Commercial Residential Industrial Other: _____
- g. Building Owner Name: Maura E. Adams Phone Number: 414-630-9620
 Business Owner Address: 4211 N. 178th St.

10. Hours of Operation & Customers

Will customers be entering the premises? No Yes

Day of the Week	Proposed Hours of Operation: <i>by applt only</i>		Estimated Number of Customers expected each day	Potential Age Range of Customers	Class B Tavern Applicant Only: Age Restriction (If none, write 'None')
	Open Time (include a.m. or p.m.)	Close Time (include a.m. or p.m.)			
Sunday	<u>9:00 a.m.</u>	<u>9:00 p.m.</u>	<u>3</u>	<u>21-85</u>	
Monday			<u>3</u>		
Tuesday			<u>6</u>		
Wednesday			<u>6</u>		
Thursday			<u>6</u>		
Friday			<u>6</u>		
Saturday			<u>10</u>		

An Extended Hours Establishment License is required for any convenience store, filling station, personal service establishment (such as tattoo, body piercing, salon, tailor, tanning, etc.), recording studio or restaurant which is open between the hours of 12:00 a.m. and 5:00 a.m.

Alcohol Establishments Class A: 8:00 am to 9:00 pm Sunday thru Saturday
 Permitted Hours of Operation: Class B: 6:00 am to 2:00 am Sunday thru Thursday, 6:00 am to 2:30 am Friday & Saturday

Entertainment Outdoor Closing Hours: 10:00pm Sunday-Thursday; 12:00am Friday & Saturday; unless a different time, either earlier or later, is established by the Common Council in its approval of the licensee's plan of operation.

11. Signature(s)

Maura E. Adams
 Signature of Sole Proprietor, Partner, or 20% or more Shareholder
 (If there are no 20% or more shareholders,
 Corporate Officer-print name/title and sign)

 Signature of additional partner or 20% or more shareholder

See Application Information for a complete list of all required application forms.



TATTOO & BODY PIERCING ESTABLISHMENT SUPPLEMENTAL APPLICATION

Office of the City Clerk License Division
200 E. Wells St. Room 105, Milwaukee, WI 53202
(414) 286-2238 e-mail address: license@milwaukee.gov www.milwaukee.gov/license

Legal Entity Name: Tranquil Escape Day spa, LLC
 Premise Address: 8125 W. Capitol Drive

SERVICES OFFERED (check all that apply)

TATTOO SERVICES		PIERCING SERVICES	
<input type="checkbox"/> Tattoo <input type="checkbox"/> Tattoo Removal <input type="checkbox"/> Permanent Makeup <input checked="" type="checkbox"/> Microblading	Other Body Art: <input type="checkbox"/> Scarification <input type="checkbox"/> Subdermal Implants <input type="checkbox"/> Braiding <input type="checkbox"/> Branding <input type="checkbox"/> Other:	<input type="checkbox"/> Body Piercing <input type="checkbox"/> Ear Piercing <input type="checkbox"/> Microdermals <input type="checkbox"/> Other:	

Will an ultrasonic device for equipment cleaning be onsite? Yes No

Describe the hand washing method used in procedure area(s)? Sink in treatment room

Number of Employees: <u>0</u>	Number of Tattooists: <u>1</u>	Number of Body Piercers: <u>0</u>	Number of Procedure Stations: <u>1</u>
----------------------------------	-----------------------------------	--------------------------------------	---

ACKNOWLEDGEMENT & SIGNATURES

I/we will not operate the business until the license has been issued and posted in the establishment.

Marcus Curran, Member
 Signature of Sole Proprietor, Partner, Agent or 20% or More Shareholder of Corporation or LLC

 Signature of Additional Partner(s)

Supporting Documentation

The following documentation must be available onsite for the preinspection.

APPLICANT Check only those items you are submitting with this application:	FOR HEALTH DEPARTMENT USE ONLY					
	Reviewed			Approved		
<input type="checkbox"/> Floor Plan	<input type="checkbox"/> Yes	<input type="checkbox"/> No	<input type="checkbox"/> NA	<input type="checkbox"/> Yes	<input type="checkbox"/> No	<input type="checkbox"/> NA
<input type="checkbox"/> Equipment List	<input type="checkbox"/> Yes	<input type="checkbox"/> No	<input type="checkbox"/> NA	<input type="checkbox"/> Yes	<input type="checkbox"/> No	<input type="checkbox"/> NA
<input type="checkbox"/> List of all finished materials	<input type="checkbox"/> Yes	<input type="checkbox"/> No	<input type="checkbox"/> NA	<input type="checkbox"/> Yes	<input type="checkbox"/> No	<input type="checkbox"/> NA
<input type="checkbox"/> Lighting Plan	<input type="checkbox"/> Yes	<input type="checkbox"/> No	<input type="checkbox"/> NA	<input type="checkbox"/> Yes	<input type="checkbox"/> No	<input type="checkbox"/> NA
<input type="checkbox"/> Sharps Disposal Plan	<input type="checkbox"/> Yes	<input type="checkbox"/> No	<input type="checkbox"/> NA	<input type="checkbox"/> Yes	<input type="checkbox"/> No	<input type="checkbox"/> NA
<input type="checkbox"/> Insect & Rodent Control Plan	<input type="checkbox"/> Yes	<input type="checkbox"/> No	<input type="checkbox"/> Yes	<input type="checkbox"/> No	<input type="checkbox"/> Yes	<input type="checkbox"/> No
<input type="checkbox"/> Standard Operating Procedures	<input type="checkbox"/> Yes	<input type="checkbox"/> No	<input type="checkbox"/> NA	<input type="checkbox"/> Yes	<input type="checkbox"/> No	<input type="checkbox"/> NA
<input type="checkbox"/> Infection Prevention & Control Plan	<input type="checkbox"/> Yes	<input type="checkbox"/> No	<input type="checkbox"/> NA	<input type="checkbox"/> Yes	<input type="checkbox"/> No	<input type="checkbox"/> NA
<input type="checkbox"/> Copies of Practitioner Licenses	<input type="checkbox"/> Yes	<input type="checkbox"/> No	<input type="checkbox"/> NA	<input type="checkbox"/> Yes	<input type="checkbox"/> No	<input type="checkbox"/> NA
<input type="checkbox"/> Facility Documents	<input type="checkbox"/> Yes	<input type="checkbox"/> No	<input type="checkbox"/> NA	<input type="checkbox"/> Yes	<input type="checkbox"/> No	<input type="checkbox"/> NA
<input type="checkbox"/> Copy of Initial Spore Results	<input type="checkbox"/> Yes	<input type="checkbox"/> No	<input type="checkbox"/> NA	<input type="checkbox"/> Yes	<input type="checkbox"/> No	<input type="checkbox"/> NA

Office Use Only

Filed		Initials		Application #		Paid	
MPD	CC	HD	NS	Granted		License #	

Approx 1660 sq. Ft.

Current layout

approx or

25'

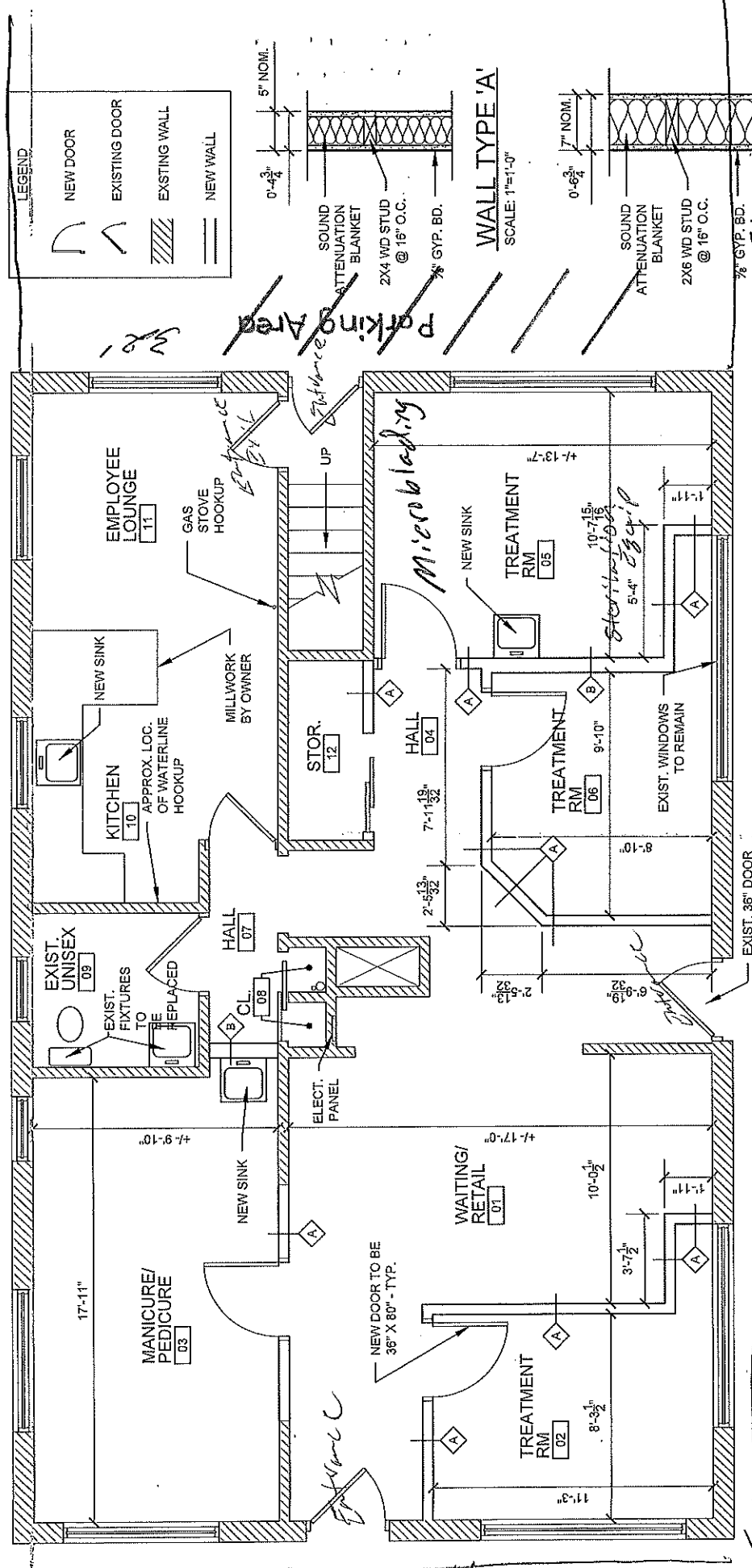

LEGEND

- NEW DOOR
- EXISTING DOOR
- EXISTING WALL
- NEW WALL

WALL TYPE 'A'
SCALE: 1"=1'-0"

0-4 3/4" 5" NOM.

SOUND ATTENUATION BLANKET
2X4 WD STUD @ 16" O.C.
3/8" GYP. BD.

WALL TYPE 'B'
SCALE: 1"=1'-0"

0-6 3/4" 7" NOM.

SOUND ATTENUATION BLANKET
2X6 WD STUD @ 16" O.C.
7/8" GYP. BD.

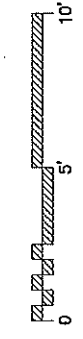

CONCEPTUAL FLOOR PLAN
SCALE: 1/4"=1'-0"



- DOOR INFO**
- SOLID CORE WD VENEER
 - CYLINDER W/ LEVER DOOR HARDWARE
 - LOCK LOCATIONS DETERMINED BY TENANT

W. Capitol Drive approx or
25' 25'
N. 2nd street

Tranquil Escape Day Spa, LLC

TRANQUIL ESCAPE DAY SPA REMODEL

CONCEPTUAL FLOOR PLAN

A101

DATE: 12/17/13
PROJECT #: 13-18
© 2013 GALBRAITH CARRAHAN ARCHITECTS, L.L.C.

9730 West Bluemound Road,
suite 1
Milwaukee, Wisconsin 53226
414.291.0772 phone
www.galbraithcarrahan.com



Maurven E. Harmon
6/22/18



**CITY OF MILWAUKEE
OFFICE OF THE CITY CLERK**

Thursday, August 30, 2018

COMMITTEE MEETING NOTICE

AD 05

BLAMER, John, Agent
Blamer's Auto Repair Inc
7605 W CENTER St

Milwaukee, WI 53222

You are requested to attend a hearing which is to be held in Room 301-B, Third Floor, City Hall on:

Tuesday, September 11, 2018 at 10:00 AM

Regarding: Your Recycling, Salvaging, or Towing Premises License Renewal application Adding Shareholder as agent for "Blamer's Auto Repair Inc" for "Blamer's Auto Repair" at 7605 W CENTER St.

There is a possibility that your application may be denied for one or more of the following reasons: The recommendation of the committee regarding the application shall be based on evidence presented at the hearing. Per MCO 85-4-4, unless otherwise specified in the code, probative evidence concerning non-renewal, suspension or revocation may include evidence of the following: failure of the applicant to meet municipal qualifications, pending charges against or the conviction of any felony, misdemeanor, municipal offense or other offense, the circumstances of which substantially relate to the circumstances of the particular licensed or permitted activity, by the applicant or by any employee or other agent of the applicant. If the activities of the applicant involve a licensed premises, whether the premises tends to facilitate a public or private nuisance or has been the source of congregations of persons which have resulted in any of the following: disturbance of the peace; illegal drug activity; public drunkenness; drinking in public; harassment of passers-by; gambling; prostitution; sale of stolen goods; public urination; theft; assaults; battery; acts of vandalism including graffiti, excessive littering, loitering, illegal parking, loud noise at times when the licensed premise is open for business; traffic violations; curfew violations; lewd conduct; display of materials harmful to minors, pursuant to s. 106-9.6; or any other factor which reasonably relates to the public health, safety and welfare, or failure to comply with the approved plan of operation.

Notice for applicants with warrants or unpaid fines: Proof of warrant satisfaction or payment of fines must be submitted at the hearing on the above date and time. Failure to comply with this requirement may result in a delay of the granting/denial of your application.

Failure to appear at this meeting may result in the denial of your license. Individual applicants must appear only in person or by an attorney. Corporate or Limited Liability applicants must appear only by the agent designated on the application or by an attorney. Partnership applicants must appear by a partner listed on the application or by an attorney. If you wish to do so and at your own expense, you may be accompanied by an attorney of your choosing to represent you at this hearing.

You will be given an opportunity to speak on behalf of the application and to respond and challenge any charges or reasons given for the denial. No petitions can be accepted by the committee, unless the people who signed the petition are present at the committee hearing and willing to testify. You may present witnesses under oath and you may also confront and cross-examine opposing witnesses under oath. If you have difficulty with the English language, you should bring an interpreter with you, at your expense, so that you can answer questions and participate in your hearing.

You may examine the application file at this office during regular business hours prior to the hearing date. Inquiries regarding this matter may be directed to the person whose signature appears below.

Limited parking for persons attending meetings in City Hall is available at reduced rates (5 hour limit) at the Milwaukee Center on the southwest corner of East Kilbourn and North Water Street. Parking tickets must be validated in the first floor information booth in City Hall.

PLEASE NOTE: Upon reasonable notice, efforts will be made to accommodate the needs of disabled individuals through sign language interpreters or other auxiliary aids. For additional information or to request this service, contact the Council Services Division ADA Coordinator at (414) 286-2998, Fax - (414) 286-3456, TDD - (414) 286-2025.

JIM OWCZARSKI, CITY CLERK

BY: _____
Jessica Celella
License Division Manager

If you have questions regarding this notice, please contact the License Division at (414) 286-2238.

200 E. Wells Street, Room 105, City Hall, Milwaukee, WI 53202. www.milwaukee.gov/license
Phone: (414) 286-2238 Fax: (414) 286-3057 Email Address: License@milwaukee.gov



Thursday, August 30, 2018



Notice of Public Hearing

BLAMER, John, Agent
Blamer's Auto Repair at 7605 W CENTER St
Recycling, Salvaging, or Towing Premises License Renewal Application Adding Shareholder

Tuesday, September 11, 2018 at 10:00 AM

To whom it may concern:

The above application has been made by the above named applicant(s). This requires approval from the Licenses Committee and the Common Council of the City of Milwaukee. The hearing before the Licenses Committee will take place on 9/11/2018 at 10:00 AM, in Room 301-B, Third Floor, City Hall. If you wish, you may provide testimony at the hearing regarding the request; see below for further information. You are not required to attend the hearing. Once the Licenses Committee makes its recommendation, this recommendation is forwarded to the full Common Council for approval at its next regularly scheduled hearing. Please review the information below and if you have further questions regarding this process, please contact the License Division at (414) 286-2238.

Important details for those wishing to provide information for the Licenses Committee to consider when making its recommendation:

1. The license application is scheduled to be heard at the above time. Due to other hearings running longer than scheduled, you may have to wait some time to provide your testimony.
2. You must appear in person and testify as to matters that you have personally experienced or seen. (You cannot provide testimony for your neighbor, parent or anyone else; this is considered hearsay and cannot be considered by the committee.)
3. No letters or petitions can be accepted by the committee (unless the person who wrote the letter or the persons who signed the petition are present at the committee hearing and willing to testify).
4. Persons opposed to the license application are given the opportunity to testify first; supporters may testify after the opponents have finished.
5. When you are called to testify, you will be sworn in and asked to give your name, and address. (If your first and/or last names are uncommon please spell them.)
6. You may then provide testimony.
 - a. Include only information relating to the above license application.
 - b. Include only information you have personally witnessed or seen.
 - c. Provide concise and relevant information detailing how this business has affected or may affect the peaceful enjoyment of your neighborhood.
 - d. If by the time you have the opportunity to testify, the information you wish to share has already been provided to the committee, you may state that you agree with the previous testimony. Redundant or repetitive testimony will not assist the committee in making its recommendation.
7. After giving your testimony, the members of the Licenses Committee and the licensee may ask questions regarding the testimony you have given or other factors relating to the license application.
8. Business Competition is not a valid basis for denial or non-renewal of a license.
Please Note: If you have submitted an objection to the above application your objection cannot be considered by the committee unless you personally testify at the hearing.

OCCUPANT	MAIL ADDRESS	CITY, STATE ZIP
CURRENT OCCUPANT	7621 W LORRAINE PL 4	MILWAUKEE, WI 53222
CURRENT OCCUPANT	7621 W LORRAINE PL 1	MILWAUKEE, WI 53222
CURRENT OCCUPANT	7621 W LORRAINE PL 7	MILWAUKEE, WI 53222
CURRENT OCCUPANT	7705 W CENTER ST 1	MILWAUKEE, WI 53222
CURRENT OCCUPANT	7706 W CENTER ST	MILWAUKEE, WI 53222
CURRENT OCCUPANT	7643 W CENTER ST 2	MILWAUKEE, WI 53222
CURRENT OCCUPANT	7621 W LORRAINE PL 3	MILWAUKEE, WI 53222
CURRENT OCCUPANT	7621 W LORRAINE PL 6	MILWAUKEE, WI 53222
CURRENT OCCUPANT	7615 W LORRAINE PL 2	MILWAUKEE, WI 53222
CURRENT OCCUPANT	2727 N 76TH ST 1	MILWAUKEE, WI 53222
CURRENT OCCUPANT	7623 W CENTER ST	MILWAUKEE, WI 53222
CURRENT OCCUPANT	7615 W LORRAINE PL 3	MILWAUKEE, WI 53222
CURRENT OCCUPANT	7646 W CENTER ST	MILWAUKEE, WI 53222
CURRENT OCCUPANT	7635 W CENTER ST	MILWAUKEE, WI 53222
CURRENT OCCUPANT	7631 W CENTER ST	MILWAUKEE, WI 53222
CURRENT OCCUPANT	7615 W LORRAINE PL 4	MILWAUKEE, WI 53222
CURRENT OCCUPANT	2727 N 76TH ST 2	MILWAUKEE, WI 53222
CURRENT OCCUPANT	7705 W CENTER ST 3	MILWAUKEE, WI 53222
CURRENT OCCUPANT	7643 W CENTER ST 4	MILWAUKEE, WI 53222
CURRENT OCCUPANT	7636 W CENTER ST	MILWAUKEE, WI 53222
CURRENT OCCUPANT	7635 W LORRAINE PL	MILWAUKEE, WI 53222
CURRENT OCCUPANT	2727 N 76TH ST 3	MILWAUKEE, WI 53222
CURRENT OCCUPANT	2711A N 76TH ST	MILWAUKEE, WI 53222
CURRENT OCCUPANT	7705 W CENTER ST 4	MILWAUKEE, WI 53222
CURRENT OCCUPANT	7704 W CENTER ST	MILWAUKEE, WI 53222
CURRENT OCCUPANT	7621 W LORRAINE PL 8	MILWAUKEE, WI 53222
CURRENT OCCUPANT	7615 W LORRAINE PL 1	MILWAUKEE, WI 53222
CURRENT OCCUPANT	2727 N 76TH ST 4	MILWAUKEE, WI 53222
CURRENT OCCUPANT	2711 N 76TH ST	MILWAUKEE, WI 53222
CURRENT OCCUPANT	7705 W CENTER ST 2	MILWAUKEE, WI 53222
CURRENT OCCUPANT	7643 W CENTER ST 3	MILWAUKEE, WI 53222
CURRENT OCCUPANT	7643 W CENTER ST 1	MILWAUKEE, WI 53222
CURRENT OCCUPANT	7636A W CENTER ST	MILWAUKEE, WI 53222
CURRENT OCCUPANT	7621 W LORRAINE PL 5	MILWAUKEE, WI 53222
CURRENT OCCUPANT	7621 W LORRAINE PL 2	MILWAUKEE, WI 53222

Total Records: 35

Radius: 250.0 feet and Center of Circle: 7605 W Center St



RECYCLING, SALVAGING OR TOWING PREMISES
LICENSE SUPPLEMENTAL RENEWAL APPLICATION

ccl-rstprenapp 2/23/18

Office of the City Clerk License Division
200 E. Wells St. Room 105, Milwaukee, WI 53202
(414) 286-2238 e-mail address: license@milwaukee.gov

Legal Entity Name: Blamer's Auto Repair Inc

Business Address: 7605 W CENTER ST

1. Current Approved Activities

The following types of business activities have been approved for your current license:

WASTE TIRES

2. Adding Activities

If applicable, check any activities you wish to ADD: ONLY CHECK ACTIVITIES YOU ARE ADDING. YOUR CURRENT APPROVED ACTIVITIES ARE LISTED ABOVE.

Non-Consensual Towing: Provide the address within the City of Milwaukee where vehicles will be towed:

- Junk/Valuable Metal: Dealing, Storing and/or Transporting; Removing and/or Recycling
Waste Tires: Dealing, Storing and/or Transporting; Removing and/or Recycling
Salvaged Motor Vehicle Parts: Dealing, Storing and/or Transporting; Removing and/or Recycling

No activity changes can take place until approved by Common Council and a new license has been issued and posted on the premises.

3. Removing Activities

If applicable, list any activities you wish to remove:

4. Additional Storage Yards

Are there changes to the additional storage yards? No Yes If yes list the address of any new yard or strike through any yard not in operation. Currently licensed yards are listed below.

5. Business Operations

1. Are there any changes to the current hours of operation (as shown on your license)? No Yes

2. If Yes, describe:

Do you understand that you must follow all recordkeeping, reporting and operating regulations in MCO 93-43-49? Yes No

Do you understand that all records and reports must be available to the Police Department upon request? Yes No

How many motor vehicles will be used in the business operations? Provide information for each vehicle on Page 2 (Reverse Side)

6. Signature

Handwritten signature of John Blamer
Signature of Sole Proprietor; a Partner; or if a Corporation or LLC, the Agent must sign



CITY OF MILWAUKEE
OFFICE OF THE CITY CLERK

Thursday, August 30, 2018

COMMITTEE MEETING NOTICE

AD 05

IYASELE, Theophilus O, Agent
Nigerian Community in Milwaukee, Inc
8310 W Appleton Av

Milwaukee, WI 53218

You are requested to attend a hearing which is to be held in Room 301-B, Third Floor, City Hall on:

Tuesday, September 11, 2018 at 10:00 AM

Regarding: Your Class B Special License Application Requesting October 6th and 7th, 2018 for "Nigerian Independence Day Celebration" as agent for "Nigerian Community in Milwaukee, Inc" for "Nigerian Community in Milwaukee" at 8310 W Appleton Av.

There is a possibility that your application may be denied for one or more of the following reasons: Possible denial because: the appropriateness of the location and site for which the license is sought and whether the event for which the license is sought will create undesirable neighborhood problems; the hours during which the event would be operated on the site and the likely effect of the event on the surrounding area; whether previous licenses granted to the same applicant or to other applicants for the same site have resulted in neighborhood problems including, but not limited to, complaints of loud music, noise, litter, disorderly assemblages, loitering or public urination; whether the applicant has been charged or convicted of any felony, misdemeanor, municipal offense or other offense, the circumstances of which substantially relate to the activity for which the license is sought; any other factors which reasonably relate to the public health, safety and welfare. Please be advised the public will be able to provide information to the committee in person. The committee will receive and consider evidence regarding the above mentioned criteria.

Notice for applicants with warrants or unpaid fines:

Proof of warrant satisfaction or payment of fines must be submitted at the hearing on the above date and time. Failure to comply with this requirement may result in a delay of the granting/denial of your application.

Failure to appear at this meeting may result in the denial of your license. Individual applicants must appear only in person or by an attorney. Corporate or Limited Liability applicants must appear only by the agent designated on the application or by an attorney. Partnership applicants must appear by a partner listed on the application or by an attorney. If you wish to do so and at your own expense, you may be accompanied by an attorney of your choosing to represent you at this hearing.

You will be given an opportunity to speak on behalf of the application and to respond and challenge any charges or reasons given for the denial. No petitions can be accepted by the committee, unless the people who signed the petition are present at the committee hearing and willing to testify. You may present witnesses under oath and you may also confront and cross-examine opposing witnesses under oath. If you have difficulty with the English language, you should bring an interpreter with you, at your expense, so that you can answer questions and participate in your hearing.

You may examine the application file at this office during regular business hours prior to the hearing date. Inquiries regarding this matter may be directed to the person whose signature appears below.

Limited parking for persons attending meetings in City Hall is available at reduced rates (5 hour limit) at the Milwaukee Center on the southwest corner of East Kilbourn and North Water Street. Parking tickets must be validated in the first floor information booth in City Hall.

PLEASE NOTE: Upon reasonable notice, efforts will be made to accommodate the needs of disabled individuals through sign language interpreters or other auxiliary aids. For additional information or to request this service, contact the Council Services Division ADA Coordinator at (414) 286-2998, Fax - (414) 286-3456, TDD - (414) 286-2025.

JIM OWCZARSKI, CITY CLERK

BY: _____

Jessica Celella
License Division Manager

If you have questions regarding this notice, please contact the License Division at (414) 286-2238.

200 E. Wells Street, Room 105, City Hall, Milwaukee, WI 53202. www.milwaukee.gov/license
Phone: (414) 286-2238 Fax: (414) 286-3057 Email Address: License@milwaukee.gov



Thursday, August 30, 2018



Notice of Public Hearing

IYASELE, Theophilus O, Agent
Nigerian Community in Milwaukee at 8310 W Appleton Av
Class B Special License Application Requesting October 6th and 7th, 2018 for "Nigerian
Independence Day Celebration"

Tuesday, September 11, 2018 at 10:00 AM

To whom it may concern:

The above application has been made by the above named applicant(s). This requires approval from the Licenses Committee and the Common Council of the City of Milwaukee. The hearing before the Licenses Committee will take place on 9/11/2018 at 10:00 AM, in Room 301-B, Third Floor, City Hall. If you wish, you may provide testimony at the hearing regarding the request; see below for further information. You are not required to attend the hearing. Once the Licenses Committee makes its recommendation, this recommendation is forwarded to the full Common Council for approval at its next regularly scheduled hearing. Please review the information below and if you have further questions regarding this process, please contact the License Division at (414) 286-2238.

Important details for those wishing to provide information for the Licenses Committee to consider when making its recommendation:

1. The license application is scheduled to be heard at the above time. Due to other hearings running longer than scheduled, you may have to wait some time to provide your testimony.
2. You must appear in person and testify as to matters that you have personally experienced or seen. (You cannot provide testimony for your neighbor, parent or anyone else; this is considered hearsay and cannot be considered by the committee.)
3. No letters or petitions can be accepted by the committee (unless the person who wrote the letter or the persons who signed the petition are present at the committee hearing and willing to testify).
4. Persons opposed to the license application are given the opportunity to testify first; supporters may testify after the opponents have finished.
5. When you are called to testify, you will be sworn in and asked to give your name, and address. (If your first and/or last names are uncommon please spell them.)
6. You may then provide testimony.
 - a. Include only information relating to the above license application.
 - b. Include only information you have personally witnessed or seen.
 - c. Provide concise and relevant information detailing how this business has affected or may affect the peaceful enjoyment of your neighborhood.
 - d. If by the time you have the opportunity to testify, the information you wish to share has already been provided to the committee, you may state that you agree with the previous testimony. Redundant or repetitive testimony will not assist the committee in making its recommendation.
7. After giving your testimony, the members of the Licenses Committee and the licensee may ask questions regarding the testimony you have given or other factors relating to the license application.
8. Business Competition is not a valid basis for denial or non-renewal of a license.
Please Note: If you have submitted an objection to the above application your objection cannot be considered by the committee unless you personally testify at the hearing.

OCCUPANT	MAIL ADDRESS	CITY, STATE ZIP
CURRENT OCCUPANT	8133 W HAMPTON AVE 7	MILWAUKEE, WI 53218
CURRENT OCCUPANT	8219 W APPLETON AVE 2	MILWAUKEE, WI 53218
CURRENT OCCUPANT	8141 W BECKETT AVE	MILWAUKEE, WI 53218
CURRENT OCCUPANT	8150 W BECKETT AVE	MILWAUKEE, WI 53218
CURRENT OCCUPANT	8109 W BECKETT AVE	MILWAUKEE, WI 53218
CURRENT OCCUPANT	8132 W BECKETT AVE 5	MILWAUKEE, WI 53218
CURRENT OCCUPANT	8133 W HAMPTON AVE 5	MILWAUKEE, WI 53218
CURRENT OCCUPANT	8235 W APPLETON AVE	MILWAUKEE, WI 53218
CURRENT OCCUPANT	8227 W APPLETON AVE 5	MILWAUKEE, WI 53218
CURRENT OCCUPANT	8227 W APPLETON AVE 4	MILWAUKEE, WI 53218
CURRENT OCCUPANT	8215 W APPLETON AVE	MILWAUKEE, WI 53218
CURRENT OCCUPANT	8149 W BECKETT AVE	MILWAUKEE, WI 53218
CURRENT OCCUPANT	8133 W BECKETT AVE	MILWAUKEE, WI 53218
CURRENT OCCUPANT	8129 W BECKETT AVE	MILWAUKEE, WI 53218
CURRENT OCCUPANT	8132 W BECKETT AVE 4	MILWAUKEE, WI 53218
CURRENT OCCUPANT	8133 W HAMPTON AVE 8	MILWAUKEE, WI 53218
CURRENT OCCUPANT	8133 W HAMPTON AVE 3	MILWAUKEE, WI 53218
CURRENT OCCUPANT	8227 W APPLETON AVE 1	MILWAUKEE, WI 53218
CURRENT OCCUPANT	8227 W APPLETON AVE 3	MILWAUKEE, WI 53218
CURRENT OCCUPANT	8219 W APPLETON AVE 5	MILWAUKEE, WI 53218
CURRENT OCCUPANT	8219 W APPLETON AVE 1	MILWAUKEE, WI 53218
CURRENT OCCUPANT	8163 W BECKETT AVE	MILWAUKEE, WI 53218
CURRENT OCCUPANT	8157 W BECKETT AVE	MILWAUKEE, WI 53218
CURRENT OCCUPANT	8147 W BECKETT AVE	MILWAUKEE, WI 53218
CURRENT OCCUPANT	8123 W BECKETT AVE	MILWAUKEE, WI 53218
CURRENT OCCUPANT	8113 W BECKETT AVE	MILWAUKEE, WI 53218
CURRENT OCCUPANT	8132 W BECKETT AVE 3	MILWAUKEE, WI 53218
CURRENT OCCUPANT	8133 W HAMPTON AVE 2	MILWAUKEE, WI 53218
CURRENT OCCUPANT	8173 W BECKETT AVE	MILWAUKEE, WI 53218
CURRENT OCCUPANT	8155 W BECKETT AVE	MILWAUKEE, WI 53218
CURRENT OCCUPANT	8162 W BECKETT AVE	MILWAUKEE, WI 53218
CURRENT OCCUPANT	8115 W BECKETT AVE	MILWAUKEE, WI 53218
CURRENT OCCUPANT	8132 W BECKETT AVE 2	MILWAUKEE, WI 53218
CURRENT OCCUPANT	8219 W APPLETON AVE 6	MILWAUKEE, WI 53218
CURRENT OCCUPANT	8167 W BECKETT AVE	MILWAUKEE, WI 53218
CURRENT OCCUPANT	8145 W BECKETT AVE	MILWAUKEE, WI 53218
CURRENT OCCUPANT	8164 W BECKETT AVE	MILWAUKEE, WI 53218
CURRENT OCCUPANT	8142 W BECKETT AVE	MILWAUKEE, WI 53218
CURRENT OCCUPANT	8132 W BECKETT AVE 1	MILWAUKEE, WI 53218
CURRENT OCCUPANT	8132 W BECKETT AVE 6	MILWAUKEE, WI 53218
CURRENT OCCUPANT	8133 W HAMPTON AVE 4	MILWAUKEE, WI 53218
CURRENT OCCUPANT	8133 W HAMPTON AVE 1	MILWAUKEE, WI 53218
CURRENT OCCUPANT	8227 W APPLETON AVE 6	MILWAUKEE, WI 53218
CURRENT OCCUPANT	8219 W APPLETON AVE 4	MILWAUKEE, WI 53218
CURRENT OCCUPANT	8219 W APPLETON AVE 3	MILWAUKEE, WI 53218
CURRENT OCCUPANT	8139 W BECKETT AVE	MILWAUKEE, WI 53218

CURRENT OCCUPANT	8135 W BECKETT AVE	MILWAUKEE, WI 53218
CURRENT OCCUPANT	8227 W APPLETON AVE 2	MILWAUKEE, WI 53218
CURRENT OCCUPANT	8169 W BECKETT AVE	MILWAUKEE, WI 53218
CURRENT OCCUPANT	8151 W BECKETT AVE	MILWAUKEE, WI 53218
CURRENT OCCUPANT	8131 W BECKETT AVE	MILWAUKEE, WI 53218
CURRENT OCCUPANT	8107 W BECKETT AVE	MILWAUKEE, WI 53218
CURRENT OCCUPANT	8132 W BECKETT AVE 7	MILWAUKEE, WI 53218
CURRENT OCCUPANT	8133 W HAMPTON AVE 6	MILWAUKEE, WI 53218

Total Records: 54

Radius: 250.0 feet and Center of Circle: 8310 W Appleton Ave

AD 5

277848
10/6 10/7/18

pd.

APPLICATION FOR TEMPORARY CLASS "B"/"CLASS B" RETAILER'S LICENSE

See Additional Information on reverse side. Contact the municipal clerk if you have questions.

FEE \$ 10.00

Application Date: 07/20/2018

Town Village City of MILWAUKEE

County of MILWAUKEE

The named organization applies for: (check appropriate box(es).)

- A Temporary Class "B" license to sell fermented malt beverages at picnics or similar gatherings under s. 125.26(6), Wis. Stats.
- A Temporary "Class B" license to sell wine at picnics or similar gatherings under s. 125.51(10), Wis. Stats.

at the premises described below during a special event beginning 10/06/2018 and ending 10/07/2018 and agrees to comply with all laws, resolutions, ordinances and regulations (state, federal or local) affecting the sale of fermented malt beverages and/or wine if the license is granted.

1. ORGANIZATION (check appropriate box) Bona fide Club Church Lodge/Society Veteran's Organization Fair Association

(a) Name NIGERIAN COMMUNITY IN MILWAUKEE, INC.

(b) Address 8310 W. APPLETON AVENUE, MILWAUKEE, WI 53218

(c) Date organized 6/24/1991 Town Village City

(d) If corporation, give date of incorporation 6/24/1991

(e) If the named organization is not required to hold a Wisconsin seller's permit pursuant to s. 77.54 (7m), Wis. Stats., check this box:

(f) Names and addresses of all officers:

President TOMI OLAPO

Vice President DIDACUS UDEOJI

Secretary VINCENT IYASELE

Treasurer ADEDAYO AKANDE

(g) Name and address of manager or person in charge of affair: THEOPHILUS IYASELE
W142N7288 OAKWOOD DR. MENOMONEE FALLS, WI 53051

2. LOCATION OF PREMISES WHERE BEER AND/OR WINE WILL BE SOLD:

(a) Street number 8310 W. APPLETON AVENUE

(b) Lot 9, 10, 11, 12, 13, 14, 15 Block 1

(c) Do premises occupy all or part of building? ALL

(d) If part of building, describe fully all premises covered under this application, which floor or floors, or room or rooms, license is to cover:

3. NAME OF EVENT

(a) List name of the event NIGERIAN INDEPENDENCE DAY CELEBRATION

(b) Dates of event 10/06/2018 & 10/07/2018

DECLARATION

The Officer(s) of the organization, individually and together, declare under penalties of law that the information provided in this application is true and correct to the best of their knowledge and belief.

Officer [Signature]

NIGERIAN COMMUNITY IN MILWAUKEE, INC.

Officer [Signature]

Officer _____ (Signature/date)

Date Filed with Clerk 07/20/2018

Officer _____ (Signature/date)

Date Reported to Council or Board 7/20/18

Date Granted by Council _____

License No. _____



CLASS "B" SPECIAL LICENSE AFFIRMATION OF UNDERSTANDING/ WAIVER

OFFICE OF THE CITY CLERK LICENSE DIVISION
200 E. WELLS ST. ROOM 105, MILWAUKEE, WI 53202
(414) 286-2238 LICENSE@MILWAUKEE.GOV

		Date of Application: <u>07/20/2018</u>
Event Dates:	Start Date: <u>10/05/2018</u>	End Date: <u>10/07/2018</u>
<p>I understand that a Class "B" Special license may be issued to an applicant who files the application after the filing deadline, provided the applicant affirms the applicant's understanding that, if a written objection is received, it may not be possible to conduct a hearing before the date for which the license is sought due to the late filing of the application.</p> <p>I hereby affirm my understanding that, if a written objection is received related to my application, it may not be possible to conduct a hearing before the date of the event for which the license is sought due to the late filing of my application.</p>		
<p><u>[Signature]</u> Signature of Officer/Manager/Person in Charge</p>		<p><u>07/20/2018</u> Date</p>
Phone #	<u>(414) 736-2498</u>	
Email Address	<u>TKIYASELE@WI.RR.COM</u>	

Office Use Only:

Filed _____ Initials _____ App# _____
 Copy Given to Manager: Date _____ Initials _____
 Paid _____ CC Approved _____ CC Denied _____
 Issued _____ Initials _____ Lic# _____



CITY OF MILWAUKEE
OFFICE OF THE CITY CLERK

Thursday, August 30, 2018

COMMITTEE MEETING NOTICE

AD 05

KAMERMAYER, Jeffrey P, Agent
KAM'S CORNER TAP, LLC
8340 W LISBON Av

MILWAUKEE, WI 53222

You are requested to attend a hearing which is to be held in Room 301-B, Third Floor, City Hall on:

Tuesday, September 11, 2018  10:00 AM

Regarding: Your Class B Tavern, Food Dealer, and Public Entertainment Premises License Renewal Applications as agent for "KAM'S CORNER TAP, LLC" for "KAM'S CORNER TAP" at 8340 W LISBON Av.

There is a possibility that your application may be denied for one or more of the following reasons: The recommendation of the committee regarding the application shall be based on evidence presented at the hearing. Per MCO 85-4-4, unless otherwise specified in the code, probative evidence concerning non-renewal, suspension or revocation may include evidence of the following: failure of the applicant to meet municipal qualifications, pending charges against or the conviction of any felony, misdemeanor, municipal offense or other offense, the circumstances of which substantially relate to the circumstances of the particular licensed or permitted activity, by the applicant or by any employee or other agent of the applicant. If the activities of the applicant involve a licensed premises, whether the premises tends to facilitate a public or private nuisance or has been the source of congregations of persons which have resulted in any of the following: disturbance of the peace; illegal drug activity; public drunkenness; drinking in public; harassment of passers-by; gambling; prostitution; sale of stolen goods; public urination; theft; assaults; battery; acts of vandalism including graffiti, excessive littering, loitering, illegal parking, loud noise at times when the licensed premise is open for business; traffic violations; curfew violations; lewd conduct; display of materials harmful to minors, pursuant to s. 106-9.6; or any other factor which reasonably relates to the public health, safety and welfare, or failure to comply with the approved plan of operation. See attached police report or correspondence.

Notice for applicants with warrants or unpaid fines:

Proof of warrant satisfaction or payment of fines must be submitted at the hearing on the above date and time. Failure to comply with this requirement may result in a delay of the granting/denial of your application.

Failure to appear at this meeting may result in the denial of your license. Individual applicants must appear only in person or by an attorney. Corporate or Limited Liability applicants must appear only by the agent designated on the application or by an attorney. Partnership applicants must appear by a partner listed on the application or by an attorney. If you wish to do so and at your own expense, you may be accompanied by an attorney of your choosing to represent you at this hearing.

You will be given an opportunity to speak on behalf of the application and to respond and challenge any charges or reasons given for the denial. No petitions can be accepted by the committee, unless the people who signed the petition are present at the committee hearing and willing to testify. You may present witnesses under oath and you may also confront and cross-examine opposing witnesses under oath. If you have difficulty with the English language, you should bring an interpreter with you, at your expense, so that you can answer questions and participate in your hearing.

You may examine the application file at this office during regular business hours prior to the hearing date. Inquiries regarding this matter may be directed to the person whose signature appears below.

Limited parking for persons attending meetings in City Hall is available at reduced rates (5 hour limit) at the Milwaukee Center on the southwest corner of East Kilbourn and North Water Street. Parking tickets must be validated in the first floor information booth in City Hall.

PLEASE NOTE: Upon reasonable notice, efforts will be made to accommodate the needs of disabled individuals through sign language interpreters or other auxiliary aids. For additional information or to request this service, contact the Council Services Division ADA Coordinator at (414) 286-2998, Fax - (414) 286-3456, TDD - (414) 286-2025.

JIM OW CZARSKI, CITY CLERK

BY:

Jessica Celella
License Division Manager

If you have questions regarding this notice, please contact the License Division at (414) 286-2238.

200 E. Wells Street, Room 105, City Hall, Milwaukee, WI 53202. www.milwaukee.gov/license
Phone: (414) 286-2238 Fax: (414) 286-3057 Email Address: License@milwaukee.gov

MILWAUKEE POLICE DEPARTMENT
LICENSE INVESTIGATION UNIT

CRIMINAL RECORD/ORDINANCE VIOLATION/INCIDENTS
SYNOPSIS

DATE: 08/09/2018
LICENSE TYPE: BTAVN
NEW:
RENEWAL: X

No. 278752
Application Date: 08/09/2018
Expiration Date:

License Location: 8340 W Lisbon Avenue
Business Name: Kam's Corner Tap

Aldermanic District:

Licensee/Applicant: Kamermayer, Jeff P

(Last Name, First Name, MI)

Date of Birth: 07/10/1967

Home Address: 4424 N 105th St

City: Wauwatosa

State: WI

Zip Code: 53225

Home Phone: (414) 875 - 0576

This report is written by Police Officer David NOVAK, assigned to the License Investigation Unit, Days.

The Milwaukee Police Department's investigation regarding this application revealed the following:

- The applicant's Wisconsin driver's license revealed the following convictions:

11/03/2008 Operating While Intoxicated (1st) Wauwatosa Municipal Court
=====

- On 11/06/10 at 8:28 pm, Milwaukee police conducted an Underage Tavern Sting at 8340 W Lisbon Avenue. Officers had a police aide, who is under the age of 21, entered the bar with the aide purchasing a Mikes Hard Lemonade in which the bartender sold without asking for ID. Police identified the bartender as Joseph Fiumefreddo who admitted to police to selling the drink because he thought the aide was over 21. During the investigation, the licensee Jeffrey Kamermayer arrived on scene and inquired as to what happened. Officers advised Kamermayer of what happened whom then became angry and stated, "I just sent every employee a text." Kamermayer further stated that "almost everyone should be carded because they are coming for us". Fiumefreddo was cited for sale to underage.

As to Fiumefreddo:

Charge: Sale of Alcohol to Underage Person
Finding: Guilty
Sentence: Fined \$171.00
Date: 12/30/10
Case: 10135676

2. On 01/29/11 at 8:52 pm, Milwaukee police were conducting Sales of Alcohol to Underage Persons and had a Milwaukee police aide, who is under the age of 21, enter 8430 W Lisbon Avenue in attempts to purchase alcohol. The police aide order two beers from the bartender, identified as Jenni Young, and was asked by Young for ID. The aide stated she didn't have any and when asked by Young for the aide's birthdate, the aide provided a false date. Young served the beer to the police aide. When questioned by police, Young stated that the girl looked older than 21. Young was cited for sale to underage.

As to Young:

Charge: Sale of Alcohol to Underage
Finding: Guilty
Sentence: Fined \$120.00
Date: 03/24/11
Case: 11022161

=====

3. On 09/15/2017 the applicant was cited for Operating While Intoxicated 2nd. He was convicted on 03/22/2018 and his license was revoked for 1 year plus 70 House of Corrections.



Thursday, August 30, 2018



Notice of Public Hearing

KAMERMAYER, Jeffrey P, Agent
KAM'S CORNER TAP at 8340 W LISBON Av
Class B Tavern, Food Dealer, and Public Entertainment Premises License Renewal Applications

Tuesday, September 11, 2018 at 10:00 AM

To whom it may concern:

The above application has been made by the above named applicant(s). This requires approval from the Licenses Committee and the Common Council of the City of Milwaukee. The hearing before the Licenses Committee will take place on 9/11/2018 at 10:00 AM, in Room 301-B, Third Floor, City Hall. If you wish, you may provide testimony at the hearing regarding the request; see below for further information. You are not required to attend the hearing. Once the Licenses Committee makes its recommendation, this recommendation is forwarded to the full Common Council for approval at its next regularly scheduled hearing. Please review the information below and if you have further questions regarding this process, please contact the License Division at (414) 286-2238.

Important details for those wishing to provide information for the Licenses Committee to consider when making its recommendation:

1. The license application is scheduled to be heard at the above time. Due to other hearings running longer than scheduled, you may have to wait some time to provide your testimony.
2. You must appear in person and testify as to matters that you have personally experienced or seen. (You cannot provide testimony for your neighbor, parent or anyone else; this is considered hearsay and cannot be considered by the committee.)
3. No letters or petitions can be accepted by the committee (unless the person who wrote the letter or the persons who signed the petition are present at the committee hearing and willing to testify).
4. Persons opposed to the license application are given the opportunity to testify first; supporters may testify after the opponents have finished.
5. When you are called to testify, you will be sworn in and asked to give your name, and address. (If your first and/or last names are uncommon please spell them.)
6. You may then provide testimony.
 - a. Include only information relating to the above license application.
 - b. Include only information you have personally witnessed or seen.
 - c. Provide concise and relevant information detailing how this business has affected or may affect the peaceful enjoyment of your neighborhood.
 - d. If by the time you have the opportunity to testify, the information you wish to share has already been provided to the committee, you may state that you agree with the previous testimony. Redundant or repetitive testimony will not assist the committee in making its recommendation.
7. After giving your testimony, the members of the Licenses Committee and the licensee may ask questions regarding the testimony you have given or other factors relating to the license application.
8. Business Competition is not a valid basis for denial or non-renewal of a license.
Please Note: If you have submitted an objection to the above application your objection cannot be considered by the committee unless you personally testify at the hearing.

OCCUPANT	MAIL ADDRESS	CITY, STATE ZIP
CURRENT OCCUPANT	3459 N 84TH ST	MILWAUKEE, WI 53222
CURRENT OCCUPANT	3457 N 83RD ST	MILWAUKEE, WI 53222
CURRENT OCCUPANT	3424 N 83RD ST	MILWAUKEE, WI 53222
CURRENT OCCUPANT	3456 N 84TH ST 1	MILWAUKEE, WI 53222
CURRENT OCCUPANT	8303 W KEEFE AVE	MILWAUKEE, WI 53222
CURRENT OCCUPANT	8403 W LISBON AVE 1	MILWAUKEE, WI 53222
CURRENT OCCUPANT	8407 W LISBON AVE 11	MILWAUKEE, WI 53222
CURRENT OCCUPANT	3439 N 84TH ST	MILWAUKEE, WI 53222
CURRENT OCCUPANT	8428 W LISBON AVE 3	MILWAUKEE, WI 53222
CURRENT OCCUPANT	8417 W KEEFE AVE	MILWAUKEE, WI 53222
CURRENT OCCUPANT	8319 W LISBON AVE	MILWAUKEE, WI 53222
CURRENT OCCUPANT	3440 N 84TH ST B	MILWAUKEE, WI 53222
CURRENT OCCUPANT	8350 W LISBON AVE 1	MILWAUKEE, WI 53222
CURRENT OCCUPANT	3455 N 83RD ST	MILWAUKEE, WI 53222
CURRENT OCCUPANT	3428 N 83RD ST 1	MILWAUKEE, WI 53222
CURRENT OCCUPANT	8407 W LISBON AVE 8	MILWAUKEE, WI 53222
CURRENT OCCUPANT	8423 W LISBON AVE	MILWAUKEE, WI 53222
CURRENT OCCUPANT	8317 W LISBON AVE	MILWAUKEE, WI 53222
CURRENT OCCUPANT	8338 W LISBON AVE 3	MILWAUKEE, WI 53222
CURRENT OCCUPANT	3427 N RIPON PL 2	MILWAUKEE, WI 53222
CURRENT OCCUPANT	3435 N 83RD ST	MILWAUKEE, WI 53222
CURRENT OCCUPANT	8233 W KEEFE AVE	MILWAUKEE, WI 53222
CURRENT OCCUPANT	8403 W LISBON AVE 3	MILWAUKEE, WI 53222
CURRENT OCCUPANT	8407 W LISBON AVE 12	MILWAUKEE, WI 53222
CURRENT OCCUPANT	8422 W LISBON AVE 2	MILWAUKEE, WI 53222
CURRENT OCCUPANT	8428 W LISBON AVE 1	MILWAUKEE, WI 53222
CURRENT OCCUPANT	8313 W LISBON AVE	MILWAUKEE, WI 53222
CURRENT OCCUPANT	3440 N 84TH ST A	MILWAUKEE, WI 53222
CURRENT OCCUPANT	8338 W LISBON AVE 1	MILWAUKEE, WI 53222
CURRENT OCCUPANT	8350 W LISBON AVE 3	MILWAUKEE, WI 53222
CURRENT OCCUPANT	3427 N 83RD ST	MILWAUKEE, WI 53222
CURRENT OCCUPANT	3433 N 83RD ST	MILWAUKEE, WI 53222
CURRENT OCCUPANT	3439 N 83RD ST	MILWAUKEE, WI 53222
CURRENT OCCUPANT	8403 W LISBON AVE 2	MILWAUKEE, WI 53222
CURRENT OCCUPANT	8403 W LISBON AVE 4	MILWAUKEE, WI 53222
CURRENT OCCUPANT	8403 W LISBON AVE 5	MILWAUKEE, WI 53222
CURRENT OCCUPANT	8416 W LISBON AVE 1	MILWAUKEE, WI 53222
CURRENT OCCUPANT	8409 W KEEFE AVE	MILWAUKEE, WI 53222
CURRENT OCCUPANT	8409A W KEEFE AVE	MILWAUKEE, WI 53222
CURRENT OCCUPANT	8403 W KEEFE AVE	MILWAUKEE, WI 53222
CURRENT OCCUPANT	8309 W LISBON AVE	MILWAUKEE, WI 53222
CURRENT OCCUPANT	8315 W LISBON AVE	MILWAUKEE, WI 53222
CURRENT OCCUPANT	8350 W LISBON AVE 4	MILWAUKEE, WI 53222
CURRENT OCCUPANT	8338 W LISBON AVE 2	MILWAUKEE, WI 53222
CURRENT OCCUPANT	3427 N RIPON PL 4	MILWAUKEE, WI 53222
CURRENT OCCUPANT	3429 N 83RD ST	MILWAUKEE, WI 53222

CURRENT OCCUPANT	3456 N 84TH ST 2	MILWAUKEE, WI 53222
CURRENT OCCUPANT	3463 N 83RD ST	MILWAUKEE, WI 53222
CURRENT OCCUPANT	8327 W KEEFE AVE	MILWAUKEE, WI 53222
CURRENT OCCUPANT	8321 W KEEFE AVE	MILWAUKEE, WI 53222
CURRENT OCCUPANT	8416 W LISBON AVE 2	MILWAUKEE, WI 53222
CURRENT OCCUPANT	8416 W LISBON AVE 3	MILWAUKEE, WI 53222
CURRENT OCCUPANT	8422 W LISBON AVE 3	MILWAUKEE, WI 53222
CURRENT OCCUPANT	8424 W LISBON AVE	MILWAUKEE, WI 53222
CURRENT OCCUPANT	3457 N 84TH ST	MILWAUKEE, WI 53222
CURRENT OCCUPANT	8415 W KEEFE AVE	MILWAUKEE, WI 53222
CURRENT OCCUPANT	3470 N 84TH ST	MILWAUKEE, WI 53222
CURRENT OCCUPANT	3427 N RIPON PL 3	MILWAUKEE, WI 53222
CURRENT OCCUPANT	3456 N 84TH ST 4	MILWAUKEE, WI 53222
CURRENT OCCUPANT	3461 N 83RD ST	MILWAUKEE, WI 53222
CURRENT OCCUPANT	8315 W KEEFE AVE	MILWAUKEE, WI 53222
CURRENT OCCUPANT	8317 W KEEFE AVE	MILWAUKEE, WI 53222
CURRENT OCCUPANT	8407 W LISBON AVE 9	MILWAUKEE, WI 53222
CURRENT OCCUPANT	8423A W LISBON AVE	MILWAUKEE, WI 53222
CURRENT OCCUPANT	8428 W LISBON AVE 2	MILWAUKEE, WI 53222
CURRENT OCCUPANT	3475 N 84TH ST	MILWAUKEE, WI 53222
CURRENT OCCUPANT	8307 W LISBON AVE	MILWAUKEE, WI 53222
CURRENT OCCUPANT	8350 W LISBON AVE 2	MILWAUKEE, WI 53222
CURRENT OCCUPANT	3427 N RIPON PL 1	MILWAUKEE, WI 53222
CURRENT OCCUPANT	3427 N RIPON PL 5	MILWAUKEE, WI 53222
CURRENT OCCUPANT	3437 N 83RD ST	MILWAUKEE, WI 53222
CURRENT OCCUPANT	3428 N 83RD ST 3	MILWAUKEE, WI 53222
CURRENT OCCUPANT	8235 W KEEFE AVE	MILWAUKEE, WI 53222
CURRENT OCCUPANT	8311 W KEEFE AVE	MILWAUKEE, WI 53222
CURRENT OCCUPANT	8301 W KEEFE AVE	MILWAUKEE, WI 53222
CURRENT OCCUPANT	8407 W LISBON AVE 7	MILWAUKEE, WI 53222
CURRENT OCCUPANT	8407 W LISBON AVE 10	MILWAUKEE, WI 53222
CURRENT OCCUPANT	8416 W LISBON AVE 4	MILWAUKEE, WI 53222
CURRENT OCCUPANT	8350 W LISBON AVE 5	MILWAUKEE, WI 53222
CURRENT OCCUPANT	3427 N RIPON PL 6	MILWAUKEE, WI 53222
CURRENT OCCUPANT	3426 N 83RD ST	MILWAUKEE, WI 53222
CURRENT OCCUPANT	3456 N 84TH ST 3	MILWAUKEE, WI 53222
CURRENT OCCUPANT	3428 N 83RD ST 2	MILWAUKEE, WI 53222
CURRENT OCCUPANT	8309 W KEEFE AVE	MILWAUKEE, WI 53222
CURRENT OCCUPANT	8403 W LISBON AVE 6	MILWAUKEE, WI 53222
CURRENT OCCUPANT	3439A N 84TH ST	MILWAUKEE, WI 53222
CURRENT OCCUPANT	8418 W LISBON AVE	MILWAUKEE, WI 53222
CURRENT OCCUPANT	8422 W LISBON AVE 1	MILWAUKEE, WI 53222

Total Records: 88

Radius: 250.0 feet and Center of Circle: 8340 W Lisbon Ave

2018-2019 Plan of Operation for 8340 W LISBON AV

1. Litter & Security Plans			
How are the grounds kept clean? <input checked="" type="checkbox"/> Sweep <input checked="" type="checkbox"/> Pressure Wash <input checked="" type="checkbox"/> Pick Up Litter <input checked="" type="checkbox"/> Other: <u>General Maintenance</u>			
How often will grounds be cleaned? <input checked="" type="checkbox"/> Daily <input type="checkbox"/> Weekly <input type="checkbox"/> Other:			
Who cleans the grounds? <input checked="" type="checkbox"/> Licensee <input checked="" type="checkbox"/> Building Owner <input checked="" type="checkbox"/> Employees <input type="checkbox"/> Hired Maintenance <input checked="" type="checkbox"/> Other: <u>Family</u>			
How are noise issues prevented and/or addressed? <input checked="" type="checkbox"/> Security <input checked="" type="checkbox"/> Manager approaches customer(s) <input type="checkbox"/> Call Police <input type="checkbox"/> Signs Posted <input type="checkbox"/> Other: <u>Always keeps an eye on outside, sidewalk, etc.</u>			
Are there designated outdoor smoking areas? <input type="checkbox"/> No <input checked="" type="checkbox"/> Yes If Yes, Describe: <u>By doors with bench & Ash tray</u>			
Number of garbage cans: Inside <u>6</u> Locations: <u>Behind bar, floor, stockroom, outside</u> Outside <u>3</u> Locations:			
Is a crowd control barrier used? <input checked="" type="checkbox"/> No <input type="checkbox"/> Yes If Yes, Describe:			
Number of restrooms: <u>2</u>		Name of solid waste contractor: <u>Varis on Pricing</u>	
Are there parking spaces on the premises? <input type="checkbox"/> No <input checked="" type="checkbox"/> Yes If Yes, list number of spaces: <u>10</u> and describe security plans: <u>17ish cameras on lot & premises / watch</u>			
Are there designated loading areas? <input type="checkbox"/> No <input checked="" type="checkbox"/> Yes If Yes, describe security plans: <u>Load off Lisbon Ave on back into parking lot</u>			
Do you have security personnel on the premise? <input type="checkbox"/> No <input checked="" type="checkbox"/> Yes If Yes, how many? <u>1</u> Sometimes AND What are their responsibilities? <u>Watch inside/out, stock, IO, etc.</u> What security equipment do they use? <u>Flashlight, cameras, common sense</u> List their licensing, certification or training credentials: <u>on the job & previous jobs in industry</u>			
Are there security cameras? <input type="checkbox"/> No <input checked="" type="checkbox"/> Yes If Yes, list all locations: <u>All over parking lot & interior of premises</u>			
Are searches and/or identification checks conducted upon entry? <input type="checkbox"/> No <input checked="" type="checkbox"/> Yes If Yes, describe: <u>Always if unknown customer and in general unless a regular</u>			
2. Percentage of Sales (must total 100%)			
Alcohol <u>80</u> %	Food Sales <u>20</u> %	Entertainment <u>—</u> %	Other <u>—</u> %
3. Businesses On The Premises (choose all that apply):			
<input type="checkbox"/> Restaurant <input type="checkbox"/> Cafe/Coffee Shop <input type="checkbox"/> Cocktail Lounge <input type="checkbox"/> Convenience Store <input type="checkbox"/> Night Club <input type="checkbox"/> Liquor Store <input checked="" type="checkbox"/> Tavern <input checked="" type="checkbox"/> Sports Facility <input type="checkbox"/> Hotel <input type="checkbox"/> Banquet Hall <input type="checkbox"/> Supermarket <input type="checkbox"/> Private/Fraternal/Veterans' Club <input type="checkbox"/> Other:			
4. Hours of Operation and Age Restriction			
Are there any changes to the current hours of operation or age restriction? <input checked="" type="checkbox"/> No <input type="checkbox"/> Yes If Yes, Describe:			
Please Note: If you will be open earlier or later than the hours listed on your current license for even one event or holiday (for example, St. Patrick's Day, Brewers Opening Day, etc.) during the license period, this must be reported and printed on your license. Your hours of operation and age restriction are listed on your current license.			
5. Floor Plan and Capacity			
Are you requesting any changes to your capacity or floor plan*? <input checked="" type="checkbox"/> No <input type="checkbox"/> Yes If yes, describe: _____ and submit a new floor plan with this renewal application. A sample plan can be found online at www.milwaukee.gov/licenses under License Forms and Related Information.			
Alcohol/Food Establishments: A "Permanent Extension of Premises Application" is required if you are adding any square footage to the licensed premises.			
6. Sidewalk Dining: Fee:			
Are there any changes to the sidewalk dining site plan? <input checked="" type="checkbox"/> No <input type="checkbox"/> Yes If Yes, submit an updated site plan with this application.			
7. Food License: FREST 10378 Fee: \$250.00		8. Weights and Measures: Fee:	
Your current food license includes the following food operations: DHS - PREPACK, Tavern Restaurant. Are there any changes to your food operations as listed above? <input checked="" type="checkbox"/> No <input type="checkbox"/> Yes, if Yes, explain _____		Number/Type of Devices: Are there any changes to the number or types of devices? <input checked="" type="checkbox"/> No <input type="checkbox"/> Yes If yes, contact our office for further instructions.	

1. CURRENT APPROVED ENTERTAINMENT

The following types of entertainment have been approved for your current Public Entertainment Premises license:

Patron Contests, Jukebox, Instrumental Musicians, 2 Pool Tables, 5 Amusement Machines, 2 Dart Boards and a Ping Pong Table

2. ADDING ENTERTAINMENT

If applicable, check any entertainment you wish to add: **ONLY CHECK ENTERTAINMENT TYPE(S) YOU ARE ADDING. YOUR CURRENT APPROVED ENTERTAINMENT IS LISTED ABOVE.**

- | | | | |
|---|--|--|--|
| <input type="checkbox"/> Instrumental Musicians | <input type="checkbox"/> Bands | <input type="checkbox"/> Battle of the Bands | <input type="checkbox"/> Comedy Acts |
| <input type="checkbox"/> Disc Jockey | <input type="checkbox"/> Magic Shows | <input type="checkbox"/> Poetry Readings | <input type="checkbox"/> Dancing by Performers |
| <input type="checkbox"/> Jukebox | <input type="checkbox"/> Wrestling | <input type="checkbox"/> Patron Contests | <input type="checkbox"/> Patrons Dancing |
| <input type="checkbox"/> Adult Entertainment/
Strippers/Erotic Dance | <input type="checkbox"/> Karaoke | <input type="checkbox"/> Bowling Alley | <input type="checkbox"/> Pool Tables |
| <input type="checkbox"/> Motion Pictures (movies by admission)
How many screens? _____ | <input type="checkbox"/> Amusement Machines
How many? _____ | How many? _____ | How many? _____ |
| <input type="checkbox"/> Other: <u>Some as above #1</u> | | <input type="checkbox"/> Concerts | <input type="checkbox"/> Theatrical Performances |
| | | Approx. # per year? _____ | Approx. # per year? _____ |

No entertainment changes can take place until approved by Common Council and a new license has been issued and posted on the premises.

3. REMOVING ENTERTAINMENT

If applicable, list any entertainment you wish to remove:

N/A

4. PROMOTERS/SOUND AMPLIFICATION

Will promoters ever be used for any of the entertainment? No Yes If Yes, Describe:

At any time will sound amplification be used? No Yes If Yes, Describe:

Just amps for singing enhances music

5. NOTARIZED SIGNATURE

I understand that after the license has been issued, a change to the plan of operation will require a written request to change and approval from the Common Council.

I agree to inform the City Clerk within 10 days of any substantial changes in the information supplied in this application.

I understand that I shall not willfully refuse to provide the services offered under this license, or add charges or require deposits not required of the general public because of race, color, sex, religion, national origin or ancestry, age, handicap, lawful source of income, marital status, sexual orientation, gender identity or expression, familial status or the fact that a person is now or has been a member of the military service, whether dressed in uniform or not; and shall not seek such information as a condition of employment, or penalize any employee or discriminate in the selection of personnel for training or promotion on the basis of such information.

I have knowledge of the City Ordinances currently regulating public entertainment, and understand that the license may be subject to suspension, non-renewal or revocation, if I violate any rule, law or regulation of the city of Milwaukee and State of Wisconsin.

SUBSCRIBED AND SWORN TO BEFORE ME

This 1st day of July, 2014

Shane S. [Signature]
(Clerk/Notary Public)

My Commission Expires May 21, 2018

*Notary Seal must be affixed.

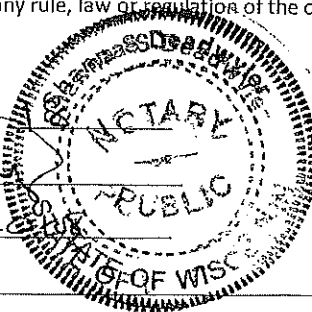

[Signature]

Sole Proprietor, a Partner, or if a Corporation or LLC, the Agent must sign



CITY OF MILWAUKEE
OFFICE OF THE CITY CLERK

Thursday, August 30, 2018

COMMITTEE MEETING NOTICE

AD 05

KIEFER, Judith C, Agent
PARK PLACE HOSPITALITY, LLC
11600 W PARK PI

MILWAUKEE, WI 53224

You are requested to attend a hearing which is to be held in Room 301-B, Third Floor, City Hall on:

Tuesday, September 11, 2018 at 10:00 AM

Regarding: Your Class B Tavern, Food Dealer, Public Entertainment Prelicense, and Hotel/Motel License Renewal Applications with Change of Agent as agent for "PARK PLACE HOSPITALITY, LLC" for "HILTON GARDEN INN" at 11600 W PARK PI.

There is a possibility that your application may be denied for one or more of the following reasons: The recommendation of the committee regarding the application shall be based on evidence presented at the hearing. Per MCO 85-4-4, unless otherwise specified in the code, probative evidence concerning non-renewal, suspension or revocation may include evidence of the following: failure of the applicant to meet municipal qualifications, pending charges against or the conviction of any felony, misdemeanor, municipal offense or other offense, the circumstances of which substantially relate to the circumstances of the particular licensed or permitted activity, by the applicant or by any employee or other agent of the applicant. If the activities of the applicant involve a licensed premises, whether the premises tends to facilitate a public or private nuisance or has been the source of congregations of persons which have resulted in any of the following: disturbance of the peace; illegal drug activity; public drunkenness; drinking in public; harassment of passers-by; gambling; prostitution; sale of stolen goods; public urination; theft; assaults; battery; acts of vandalism including graffiti, excessive littering, loitering, illegal parking, loud noise at times when the licensed premise is open for business; traffic violations; curfew violations; lewd conduct; display of materials harmful to minors, pursuant to s. 106-9.6; or any other factor which reasonably relates to the public health, safety and welfare, or failure to comply with the approved plan of operation.

Notice for applicants with warrants or unpaid fines:

Proof of warrant satisfaction or payment of fines must be submitted at the hearing on the above date and time. Failure to comply with this requirement may result in a delay of the granting/denial of your application.

Failure to appear at this meeting may result in the denial of your license. Individual applicants must appear only in person or by an attorney. Corporate or Limited Liability applicants must appear only by the agent designated on the application or by an attorney. Partnership applicants must appear by a partner listed on the application or by an attorney. If you wish to do so and at your own expense, you may be accompanied by an attorney of your choosing to represent you at this hearing.

You will be given an opportunity to speak on behalf of the application and to respond and challenge any charges or reasons given for the denial. No petitions can be accepted by the committee, unless the people who signed the petition are present at the committee hearing and willing to testify. You may present witnesses under oath and you may also confront and cross-examine opposing witnesses under oath. If you have difficulty with the English language, you should bring an interpreter with you, at your expense, so that you can answer questions and participate in your hearing.

You may examine the application file at this office during regular business hours prior to the hearing date. Inquiries regarding this matter may be directed to the person whose signature appears below.

Limited parking for persons attending meetings in City Hall is available at reduced rates (5 hour limit) at the Milwaukee Center on the southwest corner of East Kilbourn and North Water Street. Parking tickets must be validated in the first floor information booth in City Hall.

PLEASE NOTE: Upon reasonable notice, efforts will be made to accommodate the needs of disabled individuals through sign language interpreters or other auxiliary aids. For additional information or to request this service, contact the Council Services Division ADA Coordinator at (414) 286-2998, Fax - (414) 286-3456, TDD - (414) 286-2025.

JIM OW CZARSKI, CITY CLERK

BY: _____

Jessica Celella
License Division Manager

If you have questions regarding this notice, please contact the License Division at (414) 286-2238.

200 E. Wells Street, Room 105, City Hall, Milwaukee, WI 53202. www.milwaukee.gov/license
Phone: (414) 286-2238 Fax: (414) 286-3057 Email Address: License@milwaukee.gov



Thursday, August 30, 2018



Notice of Public Hearing

KIEFER, Judith C, Agent
HILTON GARDEN INN at 11600 W PARK PI
Class B Tavern, Food Dealer, Public Entertainment Premises, and Hotel/Motel License Renewal
Applications with Change of Agent

Tuesday, September 11, 2018 at 10:00 AM

To whom it may concern:

The above application has been made by the above named applicant(s). This requires approval from the Licenses Committee and the Common Council of the City of Milwaukee. The hearing before the Licenses Committee will take place on 9/11/2018 at 10:00 AM, in Room 301-B, Third Floor, City Hall. If you wish, you may provide testimony at the hearing regarding the request; see below for further information. You are not required to attend the hearing. Once the Licenses Committee makes its recommendation, this recommendation is forwarded to the full Common Council for approval at its next regularly scheduled hearing. Please review the information below and if you have further questions regarding this process, please contact the License Division at (414) 286-2238.

Important details for those wishing to provide information for the Licenses Committee to consider when making its recommendation:

1. The license application is scheduled to be heard at the above time. Due to other hearings running longer than scheduled, you may have to wait some time to provide your testimony.
2. You must appear in person and testify as to matters that you have personally experienced or seen. (You cannot provide testimony for your neighbor, parent or anyone else; this is considered hearsay and cannot be considered by the committee.)
3. No letters or petitions can be accepted by the committee (unless the person who wrote the letter or the persons who signed the petition are present at the committee hearing and willing to testify).
4. Persons opposed to the license application are given the opportunity to testify first; supporters may testify after the opponents have finished.
5. When you are called to testify, you will be sworn in and asked to give your name, and address. (If your first and/or last names are uncommon please spell them.)
6. You may then provide testimony.
 - a. Include only information relating to the above license application.
 - b. Include only information you have personally witnessed or seen.
 - c. Provide concise and relevant information detailing how this business has affected or may affect the peaceful enjoyment of your neighborhood.
 - d. If by the time you have the opportunity to testify, the information you wish to share has already been provided to the committee, you may state that you agree with the previous testimony. Redundant or repetitive testimony will not assist the committee in making its recommendation.
7. After giving your testimony, the members of the Licenses Committee and the licensee may ask questions regarding the testimony you have given or other factors relating to the license application.
8. Business Competition is not a valid basis for denial or non-renewal of a license.
Please Note: If you have submitted an objection to the above application your objection cannot be considered by the committee unless you personally testify at the hearing.

OCCUPANT	MAIL ADDRESS	CITY, STATE ZIP
CURRENT OCCUPANT	11400 W CALUMET RD	MILWAUKEE, WI 53224
CURRENT OCCUPANT	11234 W CALUMET RD	MILWAUKEE, WI 53224
CURRENT OCCUPANT	11404 W CALUMET RD	MILWAUKEE, WI 53224
CURRENT OCCUPANT	11330 W CALUMET RD	MILWAUKEE, WI 53224

Total Records: 4

Radius: 250.0 feet and Center of Circle: 11600 W Park PL

2018-2019 Plan of Operation for 11600 W PARK PL

1. Litter & Security Plans

How are the grounds kept clean? Sweep Pressure Wash Pick Up Litter Other:

How often will grounds be cleaned? Daily Weekly Other:

Who cleans the grounds? Licensee Building Owner Employees Hired Maintenance Other:

How are noise issues prevented and/or addressed? Security Manager approaches customer(s) Call Police Signs Posted Other:

Are there designated outdoor smoking areas? No Yes If Yes, Describe: 15 FEET FROM DOORS

Number of garbage cans: Inside 266 Locations: CUIS. AREAS, KITCHEN, SALER, PA, BSS
 Outside 1 Locations: AT DOORS

Is a crowd control barrier used? No Yes If Yes, Describe:

Number of restrooms: 190 Name of solid waste contractor:

Are there parking spaces on the premises? No Yes If Yes, list number of spaces: 400 and describe security plans:

Are there designated loading areas? No Yes If Yes, describe security plans: SECURITY ON PROPERTY

Do you have security personnel on the premise? No Yes If Yes, how many? 1 PER DAY

AND What are their responsibilities? MONITOR ENTIRE BUILDING

What security equipment do they use? WALKIE TALKIES, CAMERAS

List their licensing, certification or training credentials:

Are there security cameras? No Yes If Yes, list all locations: 1 over the bar area + 2 in Dining area

Are searches and/or identification checks conducted upon entry? No Yes If Yes, describe:

2. Percentage of Sales (must total 100%)

Alcohol 1.6% Food Sales 88.5% Entertainment 1% Other 8.9%

3. Businesses On The Premises (choose all that apply):

- Restaurant Cafe/Coffee Shop Cocktail Lounge Convenience Store Night Club Liquor Store Tavern Sports Facility
 Hotel Banquet Hall Supermarket Private/Fraternal/Veterans' Club Other:

4. Hours of Operation and Age Restriction

Are there any changes to the current hours of operation or age restriction? No Yes If Yes, Describe:

Please Note: If you will be open earlier or later than the hours listed on your current license for even one event or holiday (for example, St. Patrick's Day, Brewers Opening Day, etc.) during the license period, this must be reported and printed on your license. Your hours of operation and age restriction are listed on your current license.

5. Floor Plan and Capacity

Are you requesting any changes to your capacity or floor plan? No Yes If yes, describe: _____ and submit a new floor plan with this renewal application. A sample plan can be found online at www.onlinewaukee.gov/licenses under License Forms and Related information.

Alcohol/Food Establishments: A "Permanent Extension of Premises Application" is required if you are adding any square footage to the licensed premises.

6. Sidewalk Dining Fee:

Are there any changes to the sidewalk dining site plan? No Yes If Yes, submit an updated site plan with this application.

7. Food License: FREST 101119 and FOOD 8168 Fee: \$1,450.00

Your current food license includes the following food operations: DHS - COMPLEX, Sales \$200,001 - \$2,000,000, Tavern Restaurant AND No Processing, Hazardous Foods Sales <\$20,000. Are there any changes to your food operations as listed above? No Yes, if Yes, explain _____

8. Weights and Measures Fee:

Number/Type of Devices: Are there any changes to the number or types of devices? No Yes If yes, contact our office for further instructions.

1. CURRENT APPROVED ENTERTAINMENT

The following types of entertainment have been approved for your current Public Entertainment Primary license:
Disc Jockey, Karaoke, Patrons Dancing, Instrumental Musicians, 6 Amusement Machines, 4 Motion Pictures

2. ADDING ENTERTAINMENT

If applicable, check any entertainment you wish to add: **ONLY CHECK ENTERTAINMENT TYPE(S) YOU ARE ADDING. YOUR CURRENT APPROVED ENTERTAINMENT IS LISTED ABOVE.**

- | | | | |
|--|---|--|--|
| <input type="checkbox"/> Instrumental Musicians | <input type="checkbox"/> Bands | <input type="checkbox"/> Battle of the Bands | <input type="checkbox"/> Comedy Acts |
| <input type="checkbox"/> Disc Jockey | <input type="checkbox"/> Magic Shows | <input type="checkbox"/> Poetry Readings | <input type="checkbox"/> Dancing by Performers |
| <input type="checkbox"/> Jukebox | <input type="checkbox"/> Wrestling | <input type="checkbox"/> Patron Contests | <input type="checkbox"/> Patrons Dancing |
| <input type="checkbox"/> Adult Entertainment/
Strippers/Frantic Dance | <input type="checkbox"/> Karaoke | <input type="checkbox"/> Bowling Alley | <input type="checkbox"/> Pool Tables |
| <input type="checkbox"/> Motion Pictures | <input type="checkbox"/> Amusement Machines | How many? _____ | How many? _____ |
| How many screens? _____ | How many? _____ | <input type="checkbox"/> Concerts | <input type="checkbox"/> Theatrical Performances |
| <input type="checkbox"/> Other _____ | | Approx. \$ per year? _____ | Approx. \$ per year? _____ |

No entertainment changes can take place until approved by Common Council and a new license has been issued and posted on the premises.

3. REMOVING ENTERTAINMENT

If applicable, list any entertainment you wish to remove:

4. PROMOTERS/SOUND AMPLIFICATION

Will promoters ever be used for any of the entertainment? No Yes If Yes, Describe: _____

At any time will sound amplification be used? No Yes If Yes, Describe: SPEAKERS

5. NOTARIZED SIGNATURE

I understand that after the license has been issued, a change to the plan of operation will require a written request to change and approval from the Common Council.

I agree to inform the City Clerk within 10 days of any substantial changes in the information supplied in this application.

I understand that I shall not willfully refuse to provide the services offered under this license, or add charges or require deposits that required of the general public because of race, color, sex, religion, national origin or ancestry, age, handicap, lawful source of income, marital status, sexual orientation, gender identity or expression, familial status or the fact that a person is now or has been a member of the military service, whether dressed in uniform or not; and shall not seek such information as a condition of employment, or penalize any employee or discriminate in the selection of personnel for training or promotion on the basis of such information.

I have knowledge of the City Ordinances currently regulating public entertainment, and understand that the license may be subject to suspension, non-renewal or revocation, if I violate any rule, law or regulation of the city of Milwaukee and State of Wisconsin.

SUBSCRIBED AND SWORN TO BEFORE ME

This 19th day of June, 2018

Michelle J. Bahlmann
(Work/Notary Public)

My Commission Expires _____
*Notary Seal must be affixed.

[Signature]
Sole Proprietor, Partner, or Representative of LLC,
the Agent must sign

Michelle J. Bahlmann
Notary Public
State of Wisconsin
Commission Expires Jun 4, 2022



HOTEL & MOTEL LICENSE SUPPLEMENTAL RENEWAL APPLICATION

Office of the City Clerk License Division
200 E. Wells St. Room 105, Milwaukee, WI 53202
(414) 286-2298 e-mail address: license@milwaukee.gov www.milwaukee.gov/license

Legal Entity Name: **PARK PLACE HOSPITALITY, LLC**

Premises Address: **11600 W PARK PL**

MILWAUKEE COUNTY REPRESENTATIVE

Is the applicant (sole proprietor, partners, or agent of Corp/LLC) a resident of Milwaukee County? Yes No
If NO, a local representative (natural person) residing in Milwaukee County must be appointed.
Provide the person's name and street address. P.O. Boxes are not acceptable.

Name of Person: **HILLIARD ADLER**

Street Address (including city and zip code): **876 W. AUTUMN PATH LN,
BAYSIDE WI 53217**

PLAN OF OPERATION & FLOOR PLAN

Are there any changes to your current plan of operation or floor plan*? No Yes If yes, describe: _____

*If there are changes to the floor plan, a new floor plan must be submitted with this renewal application. A sample plan can be found online at www.milwaukee.gov/licenses under License Forms and Related Information.

HOURS OF OPERATION

Are there any changes to the current hours of operation?

NO
 YES

If Yes, describe changes: _____

Hours of operation are listed on your current license.

SIGNATURE

Signature of Sole Proprietor, or Part

Signature of LLC, the Agent must sign



**CITY OF MILWAUKEE
OFFICE OF THE CITY CLERK**

Wednesday, September 05, 2018

COMMITTEE MEETING NOTICE

AD 05

PANDYA, Ravi, Agent
Shree Capitol LLC
2672 N River Rd

River Grove, IL 60171

You are requested to attend a hearing which is to be held in Room 301-B, Third Floor, City Hall on:

Tuesday, September 11, 2018 at 10:00 AM

Regarding: Your Food Dealer License Application as agent for  "Shree Capitol LLC" for "Dunkin Donuts" at 7926 W. Capitol DR.

There is a possibility that your application may be denied for one or more of the following reasons: The recommendation of the committee regarding the application shall be based on evidence presented at the hearing. Per MCO 85-2.7-4, probative evidence concerning whether or not a new license should be granted may be presented on the following subjects: whether or not the applicant meets the municipal requirements, the appropriateness of the location and premises where the licensed premises is to be located and whether use of the premises for the purposes or activities permitted by the license would tend to facilitate a public or private nuisance or create undesirable neighborhood problems such as disorderly patrons, unreasonably loud noise, litter, and excessive traffic and parking congestion. Probative evidence relating to these matters may be taken from the plan of operation submitted with the license application, if any, but shall not include the content of any music. Evidence regarding the fitness of the location of the premises to be maintained as the principal place of business, including but not limited to whether there is an overconcentration of businesses of the type for which the license is sought; whether the proposal is consistent with any pertinent neighborhood business or development plans, or the location's proximity to areas where children are typically present. The applicant's record in operating similarly licensed premises; and whether or not the applicant has been charged with or convicted of any felony, misdemeanor, municipal offense or other offense, the circumstances of which substantially relate to the activity to be permitted by the license being applied for or any other factor which reasonably relates to the public health, safety or welfare may also be considered.

Notice for applicants with warrants or unpaid fines:

Proof of warrant satisfaction or payment of fines must be submitted at the hearing on the above date and time. Failure to comply with this requirement may result in a delay of the granting/denial of your application.

Failure to appear at this meeting may result in the denial of your license. Individual applicants must appear only in person or by an attorney. Corporate or Limited Liability applicants must appear only by the agent designated on the application or by an attorney. Partnership applicants must appear by a partner listed on the application or by an attorney. If you wish to do so and at your own expense, you may be accompanied by an attorney of your choosing to represent you at this hearing.

You will be given an opportunity to speak on behalf of the application and to respond and challenge any charges or reasons given for the denial. No petitions can be accepted by the committee, unless the people who signed the petition are present at the committee hearing and willing to testify. You may present witnesses under oath and you may also confront and cross-examine opposing witnesses under oath. If you have difficulty with the English language, you should bring an interpreter with you, at your expense, so that you can answer questions and participate in your hearing.

You may examine the application file at this office during regular business hours prior to the hearing date. Inquiries regarding this matter may be directed to the person whose signature appears below.

Limited parking for persons attending meetings in City Hall is available at reduced rates (5 hour limit) at the Milwaukee Center on the southwest corner of East Kilbourn and North Water Street. Parking tickets must be validated in the first floor information booth in City Hall.

PLEASE NOTE: Upon reasonable notice, efforts will be made to accommodate the needs of disabled individuals through sign language interpreters or other auxiliary aids. For additional information or to request this service, contact the Council Services Division ADA Coordinator at (414) 286-2998, Fax - (414) 286-3456, TDD - (414) 286-2025.

JIM OWCZARSKI, CITY CLERK

BY: _____

Jessica Celella

License Division Manager

If you have questions regarding this notice, please contact the License Division at (414) 286-2238.

200 E. Wells Street, Room 105, City Hall, Milwaukee, WI 53202. www.milwaukee.gov/license
Phone: (414) 286-2238 Fax: (414) 286-3057 Email Address: License@milwaukee.gov



**CITY OF MILWAUKEE
OFFICE OF THE CITY CLERK**

Wednesday, September 05, 2018

COMMITTEE MEETING NOTICE

AD 05

PANDYA, Ravi, Agent
Shree Capitol LLC
2770 Mayfield Dr

Park Ridge, IL 60068

You are requested to attend a hearing which is to be held in Room 301-B, Third Floor, City Hall on:

Tuesday, September 11, 2018 at 10:00 AM

Regarding: Your Food Dealer License Application as agent for "Shree Capitol LLC" for "Dunkin Donuts" at 7926 W Capitol DR.

There is a possibility that your application may be denied for one or more of the following reasons: The recommendation of the committee regarding the application shall be based on evidence presented at the hearing. Per MCO 85-2.7-4, probative evidence concerning whether or not a new license should be granted may be presented on the following subjects: whether or not the applicant meets the municipal requirements, the appropriateness of the location and premises where the licensed premises is to be located and whether use of the premises for the purposes or activities permitted by the license would tend to facilitate a public or private nuisance or create undesirable neighborhood problems such as disorderly patrons, unreasonably loud noise, litter, and excessive traffic and parking congestion. Probative evidence relating to these matters may be taken from the plan of operation submitted with the license application, if any, but shall not include the content of any music. Evidence regarding the fitness of the location of the premises to be maintained as the principal place of business, including but not limited to whether there is an overconcentration of businesses of the type for which the license is sought; whether the proposal is consistent with any pertinent neighborhood business or development plans, or the location's proximity to areas where children are typically present. The applicant's record in operating similarly licensed premises; and whether or not the applicant has been charged with or convicted of any felony, misdemeanor, municipal offense or other offense, the circumstances of which substantially relate to the activity to be permitted by the license being applied for or any other factor which reasonably relates to the public health, safety or welfare may also be considered.

Notice for applicants with warrants or unpaid fines:

Proof of warrant satisfaction or payment of fines must be submitted at the hearing on the above date and time. Failure to comply with this requirement may result in a delay of the granting/denial of your application.

Failure to appear at this meeting may result in the denial of your license. Individual applicants must appear only in person or by an attorney. Corporate or Limited Liability applicants must appear only by the agent designated on the application or by an attorney. Partnership applicants must appear by a partner listed on the application or by an attorney. If you wish to do so and at your own expense, you may be accompanied by an attorney of your choosing to represent you at this hearing.

You will be given an opportunity to speak on behalf of the application and to respond and challenge any charges or reasons given for the denial. No petitions can be accepted by the committee, unless the people who signed the petition are present at the committee hearing and willing to testify. You may present witnesses under oath and you may also confront and cross-examine opposing witnesses under oath. If you have difficulty with the English language, you should bring an interpreter with you, at your expense, so that you can answer questions and participate in your hearing.

You may examine the application file at this office during regular business hours prior to the hearing date. Inquiries regarding this matter may be directed to the person whose signature appears below.

Limited parking for persons attending meetings in City Hall is available at reduced rates (5 hour limit) at the Milwaukee Center on the southwest corner of East Kilbourn and North Water Street. Parking tickets must be validated in the first floor information booth in City Hall.

PLEASE NOTE: Upon reasonable notice, efforts will be made to accommodate the needs of disabled individuals through sign language interpreters or other auxiliary aids. For additional information or to request this service, contact the Council Services Division ADA Coordinator at (414) 286-2998, Fax - (414) 286-3456, TDD - (414) 286-2025.

JIM OWCZARSKI, CITY CLERK

BY: _____

Jessica Celella

License Division Manager

If you have questions regarding this notice, please contact the License Division at (414) 286-2238.

200 E. Wells Street, Room 105, City Hall, Milwaukee, WI 53202. www.milwaukee.gov/license
Phone: (414) 286-2238 Fax: (414) 286-3057 Email Address: License@milwaukee.gov



BUSINESS LICENSE PLAN OF OPERATION

ccl-busplan 12/14/17

Office of the City Clerk License Division
200 E. Wells St. Room 105, Milwaukee, WI 53202
(414) 286-2238 www.milwaukee.gov/license e-mail address: license@milwaukee.gov

1. Type of Business

Applying for: Extended Hours (12AM to 5AM) - If a food establishment, check all that apply: Delivery Drive Thru Dining Room
 Self Service Laundry Massage Establishment Filling Station
 Other (supplemental application for specific license also required)

Provide a detailed description of the type of business you plan on operating:

OPERATING A DUNKIN DONUTS COFFEE AND BAKERY SHOP WITH A DRIVE THRU.

Do you have any experience operating this type of business? No Yes If yes, explain: OPERATING 5 DUNKIN SHOPS IN WISC.

2. Business Operations

- a. Proposed Opening Date: 09/18/18
- b. Is this premise under construction? No Yes If yes, list estimated completion date: 09/03/18
- c. Is this a franchise? No Yes
- d. Is this premises currently licensed? No Yes If yes, list type of license: _____
- e. Is the current licensee operating? No Yes If no, list date closed: _____
- f. Do you have future plans for other businesses, licenses or permits at this location? No Yes
If yes, explain: _____
- g. Have you previously held an Extended Hours License in Milwaukee? No Yes
If yes, list address(es): 151 W Layton Ave, Milwaukee, Wisconsin,
- h. Are other businesses operating in the same building? No Yes If yes, describe: _____

3. Litter & Noise

- a. How are grounds kept clean? Sweep Pressure Wash Pick Up Litter Other: _____
- b. How often will grounds be cleaned? Daily Weekly As Needed Monthly Other: _____
- c. Grounds cleaned by: Licensee Building Owner Employees Hired Maintenance Other: _____
- d. How are noise issues prevented and/or addressed? Security Manager approaches customer(s) Call Police
 Signs Posted Other: _____
- e. Will a sound amplification system be used? No Yes If yes, describe: _____

4. Smoking & Sanitation

- a. Are there designated outdoor smoking areas? No Yes If yes, describe: _____
- b. Number of Garbage Cans: Inside: 6 Locations: SMALL GARBAGE BINS IN STORE FOR SMALL TRASH
Outside: 2 Locations: BEHIND THE STORE IN TRASH ENCLOSURE
- c. Is a crowd control barrier used? No Yes If yes, describe: _____
- d. How many restrooms are on the premises? 2
- e. Name of solid waste contractor: Advanced Disposal Waste Management Other: TOGO DISPOSAL, INC.

5. Security

- a. Are there onsite parking spaces? No Yes If yes, indicate how many? 36 and describe the parking security plan: SURVEILLANCE CAMERAS
- b. Is there a loading zone? No Yes If yes, describe the loading area security plan: _____
- c. Will you have security personnel on premise? No Yes If yes, how many? _____ and answer the following:
 What are their responsibilities? _____
 Is security equipment used? No Yes If yes, describe _____
 List their licensing, certification, or training credentials _____
- d. Will there be security cameras? No Yes If yes, where? INTERIOR AND EXTERIOR COVERING THE PREMESIS
- e. Will searches/identification checks be done upon entry? No Yes If yes, describe _____

6. Percentage of Sales (must total 100%)

Alcohol _____%	Food <u>100</u> %	Secondhand Merchandise _____%	Precious Metals & Gems _____%
Entertainment _____%	Cigarettes _____%	_____%	_____%
Pawnbroker Activity _____%	Salvaged Materials _____% (such as scrap metal)	Personal Services (such as tattoo, body piercing, salon, tailor, tanning, etc.) _____%	Other _____% Describe: _____

7. Businesses/Licenses on the Premises (check all that apply):

Type 1

- Full Service Restaurant Cafe/Coffee Shop Deli or Fast Food Restaurant Private/Fraternal/Veterans Club
- Night Club Tavern Cocktail Lounge Teen Club
- Banquet Hall Sports Facility Bowling Alley
- Hotel/Motel : Number of Floors: _____ Rooming House: Number of Floors: _____
 Number of Rooms: _____ Number of Rooms: _____

Type 2

- Liquor Store Corner Store Supermarket Convenience Store
- Gas Station Amusement/Phonograph Distributor Recycling, Salvage or Towing
- Used Car Dealer Personal Service Establishment
(such as tattoo business, hair salon, tailor, etc.) Recording Studio

What other licenses/permits will you hold at this location? (check all that apply)

- Occupancy Permit Cigarette & Tobacco Gas Station Extended Hours Class "B" Tavern Weights & Measures
- Secondhand Dealer Precious Metal & Gem Other: _____

8. Legal Capacity (only if a Type 1 premises in #7 above)

Capacity 50, NOT SURE (Call the Milwaukee Development Center at 414-286-8211 if you have questions.)

9. Premises Description

- a. Identify all area(s) of the premises that will be used in operating this business (include areas used only for storage):
 1st Floor 2nd Floor Basement Storage Patio Beer Garden Sidewalk Café Deck Rooftop
 Other: Describe: _____
- b. Describe Location: Major Thoroughfare Secondary Street Other: _____
- c. Nearest Major Cross Street: 76th street
- d. Describe Building: Free Standing Building Strip Mall Other: _____
- e. Describe Premises Structure: Single Story Multi-Story - # of Stories _____ Other: _____
- f. Describe Surrounding Area: Commercial Residential Industrial Other: _____
- g. Building Owner Name: Shree SARAS 1 LLC Phone Number: 847-863-5778
 Business Owner Address: 2672 N River Rd, River Grove, IL 60171

10. Hours of Operation & Customers

Will customers be entering the premises? No Yes

Day of the Week	Proposed Hours of Operation:		Estimated Number of Customers expected each day	Potential Age Range of Customers	Class B Tavern Applicant Only: Age Restriction (If none, write 'None')
	Open Time (include a.m. or p.m.)	Close Time (include a.m. or p.m.)			
Sunday	5 AM	10 PM	200	ALL	
Monday	5 AM	10 PM	200	ALL	
Tuesday	5 AM	10 PM	200	ALL	
Wednesday	5 AM	10 PM	200	ALL	
Thursday	5 AM	10 PM	200	ALL	
Friday	5 AM	10 PM	200	ALL	
Saturday	5 AM	10 PM	200	ALL	

An Extended Hours Establishment License is required for any convenience store, filling station, personal service establishment (such as tattoo, body piercing, salon, tailor, tanning, etc.), recording studio or restaurant which is open between the hours of 12:00 a.m. and 5:00 a.m.

Alcohol Establishments Class A: 8:00 am to 9:00 pm Sunday thru Saturday
 Permitted Hours of Operation: Class B: 6:00 am to 2:00 am Sunday thru Thursday, 6:00 am to 2:30 am Friday & Saturday

Entertainment Outdoor Closing Hours: 10:00pm Sunday-Thursday; 12:00am Friday & Saturday; unless a different time, either earlier or later, is established by the Common Council in its approval of the licensee's plan of operation.

11. Signature(s)



Signature of Sole Proprietor, Partner, or 20% or more Shareholder
 (If there are no 20% or more shareholders,
 Corporate Officer-print name/title and sign)

Signature of additional partner or 20% or more shareholder

See Application Information for a complete list of all required application forms.



FOOD DEALER LICENSE PLAN OF OPERATION

OFFICE OF THE CITY CLERK, LICENSE DIVISION
 CITY HALL, 200 E. WELLS ST, ROOM 105, MILWAUKEE, WI 53202
 (414) 286-2238 • license@milwaukee.gov • www.milwaukee.gov/license

Legal Entity Name:	Shree Capitol LLC
Premises Address:	7926 W Capitol Dr, Milwaukee, WI 53222
SECTION 1 TYPE OF BUSINESS	
Type of application (check one):	<input type="checkbox"/> taking over a currently operating business <input checked="" type="checkbox"/> starting a new business
Anticipated opening date?	<u>09/18/2018</u>
Check the type that best describes your business (check only one): See Food Dealer License information sheet for definitions.	
<input type="checkbox"/> Restaurant	<input type="checkbox"/> Bed & Breakfast
<input checked="" type="checkbox"/> Retail Establishment	<input type="checkbox"/> Base for Food Peddler
If retail, will it be a convenience store? <input type="checkbox"/> Yes <input checked="" type="checkbox"/> No	<input type="checkbox"/> Base for Temporary/Seasonal Food Stand
(Convenience Stores have less than 5,000 sq ft of retail space, primary business is the sale of basic food items, and in addition sells household products)	
In addition, will any wholesale business be done? <input type="checkbox"/> Yes <input checked="" type="checkbox"/> No	
If yes, what percentage of the business will be wholesale? <input type="checkbox"/> Less than 25% <input type="checkbox"/> 25% or More (Contact DATCP)*	
Will retail items be sold?	<input type="checkbox"/> No <input checked="" type="checkbox"/> Yes If Yes, indicate percentage of food sales <u>85</u> %
Will restaurant items be sold?	<input type="checkbox"/> No* <input checked="" type="checkbox"/> Yes If Yes, indicate percentage of food sales <u>15</u> %
* If you checked "25% or More" of the business will be wholesale and answered "No" to restaurant items being sold, do not continue completing this application. A City of Milwaukee License is not required. Contact DATCP only.	
SECTION 2 FOOD PROCESSING	
Will any food processing be done? <input type="checkbox"/> No <input checked="" type="checkbox"/> Yes <i>Processing is defined as assembling, grinding, cutting, mixing, baking, coating, stuffing, packing, bottling, grilling, canning, extracting, fermenting, distilling, pickling, freezing, drying, smoking, or packaging.</i>	
If Yes, check the types of food items:	
<input checked="" type="checkbox"/> SNACKS & BEVERAGES <i>includes, but is not limited to, ice cream/soft serve, lemonade, snow cones, coffee, espresso, cappuccino, tea, fruit juice, smoothies, candy, dispensed soda, fruit cups, bakery, cookies, popcorn, kettle corn, cotton candy, funnel cakes, fritters, tortilla chips w/ cheese</i>	
<input checked="" type="checkbox"/> MEALS <i>includes, but is not limited to, chicken, ribs, sandwiches, roasted corn, baked potatoes, hot dogs, brats, tacos, nachos w/ cheese and meat, French fries, cooked or deep fried vegetables/fruit, cooked cheese curds, corn dogs, egg rolls, salads</i>	
SECTION 3 FOOD REQUIRING TEMPERATURE CONTROL	
Will any food that requires temperature control be sold? <input type="checkbox"/> No <input checked="" type="checkbox"/> Yes (includes dairy products such as milk, cheese, and ice cream, fish, shellfish, meat, poultry)	
If yes, list the types of food items: <u>MILK, CREAM, CHEESE, EGGS, MEAT</u>	

SECTION 4 SHARED KITCHEN

Will you be sharing kitchen space with another operator?

 No If No, SKIP to Section 5 Yes If Yes, check one: I will rent space from another operator ("Shared Kitchen Agreement" is required) I will rent space to another operator (peddler/caterer)**SECTION 5 DETAILS OF OPERATION**

Answer the following questions:

Will you have seating on site for dining? No YesWill you be doing any catering? No YesWill you be doing any delivery? No YesWill you have outdoor activities? No YesIf Yes to outdoor activities, check all that apply: Bar Cooking/Grilling DiningWill you have a drive thru window? No YesIf Yes to drive thru, are hours different from inside? No Yes

If Yes, provide drive thru hours: _____

Will any scales or barcode scanners be used? No Yes

If Yes, a Weights & Measures application must be completed and a license obtained.

SECTION 6 ADDITIONAL SITES

Where will food be prepared and/or sold?

 At a single site At multiple sites (for example, a hotel with several dining rooms or bars) How many? _____

If multiple sites, attach a Food Dealer Additional Site Addendum (ccl-foodadd) for each additional site.

SECTION 7 CONSTRUCTION OR CHANGES

Are you planning any construction, remodeling or equipment changes?

 No If No, SKIP to Section 8 Yes If Yes, check all that apply: New construction of a building Construction changes to an existing building Renovation or remodeling Equipment changes only (installation or replacement)Provide a brief description of the changes: INTERIOR DEMOLISH AND REBUILD TO A DUNKIN DONUTSStart date: 04/2018Name, Address & Phone Number of Architect: VARI ARCHITECTS, PAUL MATYJA, 312-829-4788
824 N RACINE AVE, CHICAGO, IL 60642Name, Address & Phone Number of Contractor: ONE SOURCE CONSTRUCTION, MARK SCHNEIDER
3065 N 124TH ST, SUITE 202, BROOKFIELD, WI, 53005
PHONE NUMBER 262-784-1010

SECTION 8 ALCOHOL BEVERAGES

Are you applying for an alcohol beverage license?

No If No, SKIP to Section 9

Yes If YES, if your food license is approved prior to the alcohol beverage license, when do you want the food license issued? Immediately At the same time as the alcohol license

SECTION 9 ACKNOWLEDGEMENTS & SIGNATURE

You must initial each item confirming your understanding:

RP I understand the Health Department must conduct an inspection and advise the License Division of their approval before the license may be issued.

RP I understand I must obtain an occupancy permit from the Department of Neighborhood Services and an inspection may be required. Neighborhood Services must advise the License Division of their approval before the license may be issued.

RP I understand the district alderperson will review and either approve or deny my application. If denied, I may appeal and be scheduled to appear before the Licenses Committee. The Licenses Committee will then make a recommendation to the Common Council. The Common Council must grant the license before it may be issued.

RP I understand proof of payment for all license fees must be on file in the License Division before the license may be issued.

RP I understand the license must be issued and posted in my establishment prior to opening for business.

RP I will not operate my food business until the license has been issued and posted in the establishment.

Signature of sole proprietor, partner, agent or 20% shareholder: *Ravi Sandya*

Signature of additional partner(s): _____

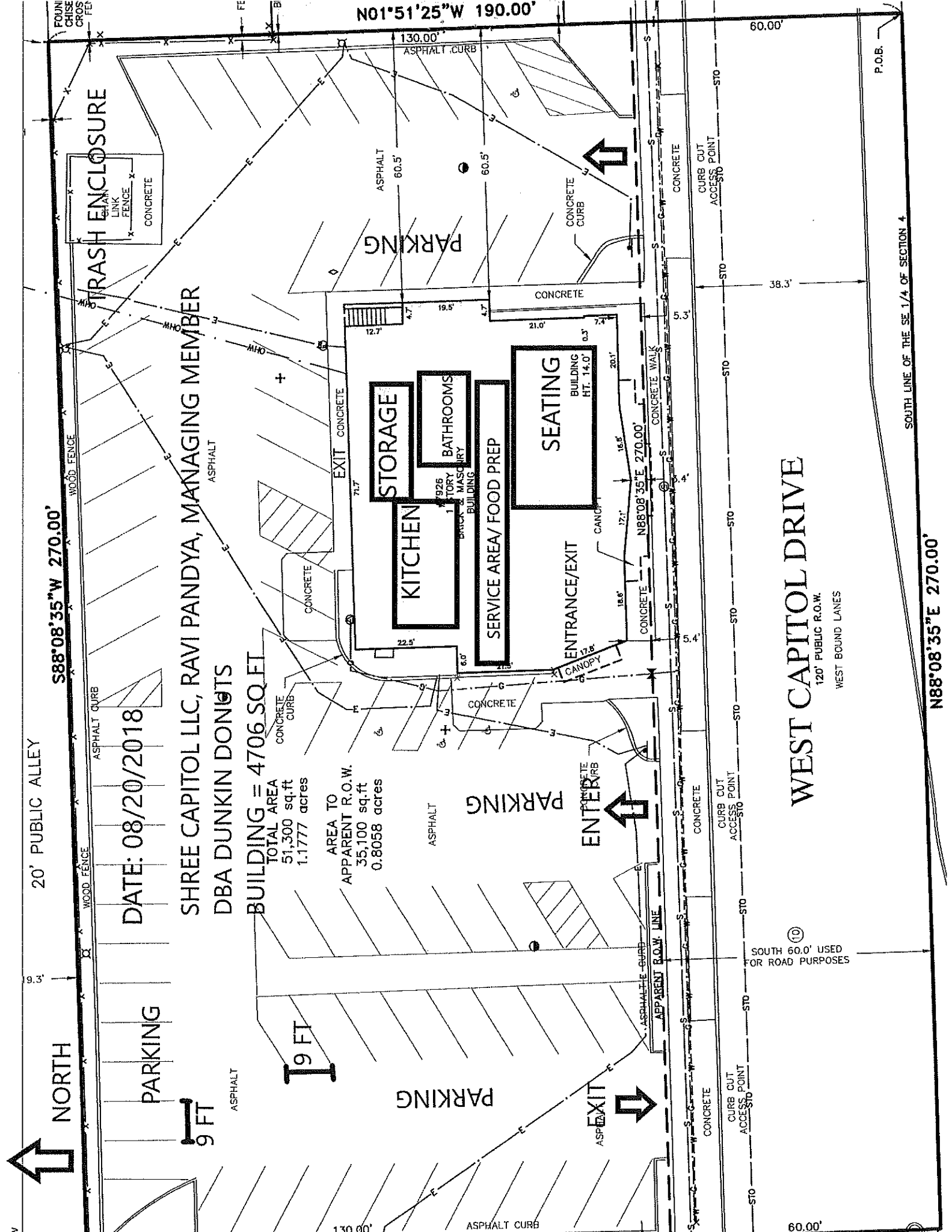

N01°51'25"W 190.00'

60.00'

P.O.B.

TRASH ENCLOSURE

PARKING

SHREE CAPITOL LLC, RAVI PANDYA, MANAGING MEMBER
DBA DUNKIN DONUTS

DATE: 08/20/2018

BUILDING = 4706 SQ.FT.
TOTAL AREA
51,300 sq.ft
1.1777 acres

AREA TO
APPARENT R.O.W.
35,100 sq.ft
0.8058 acres

STORAGE

BATHROOMS

SERVICE AREA/FOOD PREP

SEATING
BUILDING
HT. 14.0'

KITCHEN

ENTRANCE/EXIT

PARKING

ENTER

PARKING

EXIT

WEST CAPITOL DRIVE

120' PUBLIC R.O.W.
WEST BOUND LANES

SOUTH LINE OF THE SE 1/4 OF SECTION 4

N88°08'35"E 270.00'

20' PUBLIC ALLEY

S88°08'35"W 270.00'

NORTH

PARKING

9 FT

19 FT

130.00'

ASPHALT CURB

60.00'

⑩ SOUTH 60.0' USED FOR ROAD PURPOSES

STO

STO

STO

STO

STO

STO

STO

STO

STO

STO

STO

STO

STO

STO

STO

STO

STO

STO

STO

STO

STO

STO

STO

STO

STO

STO

STO

STO

STO

STO

STO

STO

STO

STO

STO

STO

STO

STO

STO

STO

STO

STO

STO

STO

STO

STO

STO

STO

STO

STO

STO

STO

STO

STO

STO

STO

STO

STO

STO

STO

STO

STO

STO

STO

STO

STO

STO

STO

STO

STO

STO

STO

STO

STO

STO

STO

STO

STO

STO

STO

STO

STO

STO

STO

STO

STO

STO

STO

STO

STO

STO

STO

STO

STO

STO

STO

STO

STO

STO

STO

STO

STO

STO

STO

STO

STO

STO

STO

STO

STO

STO

STO

STO

STO

STO

STO

STO

STO

STO

STO

STO

STO

STO

STO

STO

STO

STO

STO

STO

STO

STO

STO

STO

STO

STO

STO

STO

STO

STO

STO

STO

STO

STO

STO

STO

STO

STO

STO

STO

STO

STO

STO



**CITY OF MILWAUKEE
OFFICE OF THE CITY CLERK**

Thursday, August 30, 2018

COMMITTEE MEETING NOTICE

AD 05

PATEL, Kamlesh M, Agent
SPDK, INC
9330 W CAPITOL DR

MILWAUKEE, WI 53222

You are requested to attend a hearing which is to be held in Room 301-B, Third Floor, City Hall on:

Tuesday, September 11, 2018 at 10:00 AM

Regarding: Your Class A Malt & Class A Liquor and Food Dealer License Renewal Applications with Change of Stockholder and Weights & Measures License Renewal Application with Change of Agent and Stockholder as agent for "SPDK, INC" for "SUNRISE LIQUOR AND GIFTS" at 9330 W CAPITOL DR.

There is a possibility that your application may be denied for one or more of the following reasons: The recommendation of the committee regarding the application shall be based on evidence presented at the hearing. Per MCO 85-4-4, unless otherwise specified in the code, probative evidence concerning non-renewal, suspension or revocation may include evidence of the following: failure of the applicant to meet municipal qualifications, pending charges against or the conviction of any felony, misdemeanor, municipal offense or other offense, the circumstances of which substantially relate to the circumstances of the particular licensed or permitted activity, by the applicant or by any employee or other agent of the applicant. If the activities of the applicant involve a licensed premises, whether the premises tends to facilitate a public or private nuisance or has been the source of congregations of persons which have resulted in any of the following: disturbance of the peace; illegal drug activity; public drunkenness; drinking in public; harassment of passers-by; gambling; prostitution; sale of stolen goods; public urination; theft; assaults; battery; acts of vandalism including graffiti, excessive littering, loitering, illegal parking, loud noise at times when the licensed premise is open for business; traffic violations; curfew violations; lewd conduct; display of materials harmful to minors, pursuant to s. 106-9.6; or any other factor which reasonably relates to the public health, safety and welfare, or failure to comply with the approved plan of operation.

Notice for applicants with warrants or unpaid fines:

Proof of warrant satisfaction or payment of fines must be submitted at the hearing on the above date and time. Failure to comply with this requirement may result in a delay of the granting/denial of your application.

Failure to appear at this meeting may result in the denial of your license. Individual applicants must appear only in person or by an attorney. Corporate or Limited Liability applicants must appear only by the agent designated on the application or by an attorney. Partnership applicants must appear by a partner listed on the application or by an attorney. If you wish to do so and at your own expense, you may be accompanied by an attorney of your choosing to represent you at this hearing.

You will be given an opportunity to speak on behalf of the application and to respond and challenge any charges or reasons given for the denial. No petitions can be accepted by the committee, unless the people who signed the petition are present at the committee hearing and willing to testify. You may present witnesses under oath and you may also confront and cross-examine opposing witnesses under oath. If you have difficulty with the English language, you should bring an interpreter with you, at your expense, so that you can answer questions and participate in your hearing.

You may examine the application file at this office during regular business hours prior to the hearing date. Inquiries regarding this matter may be directed to the person whose signature appears below.

Limited parking for persons attending meetings in City Hall is available at reduced rates (5 hour limit) at the Milwaukee Center on the southwest corner of East Kilbourn and North Water Street. Parking tickets must be validated in the first floor information booth in City Hall.

PLEASE NOTE: Upon reasonable notice, efforts will be made to accommodate the needs of disabled individuals through sign language interpreters or other auxiliary aids. For additional information or to request this service, contact the Council Services Division ADA Coordinator at (414) 286-2998, Fax - (414) 286-3456, TDD - (414) 286-2025.

JIM OWCZARSKI, CITY CLERK

BY: _____

Jessica Ceella
License Division Manager

If you have questions regarding this notice, please contact the License Division at (414) 286-2238.

200 E. Wells Street, Room 105, City Hall, Milwaukee, WI 53202. www.milwaukee.gov/license
Phone: (414) 286-2238 Fax: (414) 286-3057 Email Address: License@milwaukee.gov



Thursday, August 30, 2018



Notice of Public Hearing

PATEL, Kamlesh M, Agent

SUNRISE LIQUOR AND GIFTS at 9330 W CAPITOL DR

Class A Malt & Class A Liquor and Food Dealer License Renewal Applications with Change of Stockholder and Weights & Measures License Renewal Application with Change of Agent and Stockholder

Tuesday, September 11, 2018 at 10:00 AM

To whom it may concern:

The above application has been made by the above named applicant(s). This requires approval from the Licenses Committee and the Common Council of the City of Milwaukee. The hearing before the Licenses Committee will take place on 9/11/2018 at 10:00 AM, in Room 301-B, Third Floor, City Hall. If you wish, you may provide testimony at the hearing regarding the request; see below for further information. You are not required to attend the hearing. Once the Licenses Committee makes its recommendation, this recommendation is forwarded to the full Common Council for approval at its next regularly scheduled hearing. Please review the information below and if you have further questions regarding this process, please contact the License Division at (414) 286-2238.

Important details for those wishing to provide information for the Licenses Committee to consider when making its recommendation:

1. The license application is scheduled to be heard at the above time. Due to other hearings running longer than scheduled, you may have to wait some time to provide your testimony.
2. You must appear in person and testify as to matters that you have personally experienced or seen. (You cannot provide testimony for your neighbor, parent or anyone else; this is considered hearsay and cannot be considered by the committee.)
3. No letters or petitions can be accepted by the committee (unless the person who wrote the letter or the persons who signed the petition are present at the committee hearing and willing to testify).
4. Persons opposed to the license application are given the opportunity to testify first; supporters may testify after the opponents have finished.
5. When you are called to testify, you will be sworn in and asked to give your name, and address. (If your first and/or last names are uncommon please spell them.)
6. You may then provide testimony.
 - a. Include only information relating to the above license application.
 - b. Include only information you have personally witnessed or seen.
 - c. Provide concise and relevant information detailing how this business has affected or may affect the peaceful enjoyment of your neighborhood.
 - d. If by the time you have the opportunity to testify, the information you wish to share has already been provided to the committee, you may state that you agree with the previous testimony. Redundant or repetitive testimony will not assist the committee in making its recommendation.
7. After giving your testimony, the members of the Licenses Committee and the licensee may ask questions regarding the testimony you have given or other factors relating to the license application.
8. Business Competition is not a valid basis for denial or non-renewal of a license.
Please Note: If you have submitted an objection to the above application your objection cannot be considered by the committee unless you personally testify at the hearing.

OCCUPANT	MAIL ADDRESS	CITY, STATE ZIP
CURRENT OCCUPANT	4010 N 94TH ST	MILWAUKEE, WI 53222
CURRENT OCCUPANT	4020 N 94TH ST	MILWAUKEE, WI 53222
CURRENT OCCUPANT	9401 W CAPITOL DR	MILWAUKEE, WI 53222
CURRENT OCCUPANT	9327 W CAPITOL DR	MILWAUKEE, WI 53222
CURRENT OCCUPANT	9321 W CAPITOL DR	MILWAUKEE, WI 53222
CURRENT OCCUPANT	9343 W CAPITOL DR	MILWAUKEE, WI 53222
CURRENT OCCUPANT	9307 W CAPITOL DR	MILWAUKEE, WI 53222
CURRENT OCCUPANT	4035 N 94TH ST	MILWAUKEE, WI 53222
CURRENT OCCUPANT	9329 W CAPITOL DR	MILWAUKEE, WI 53222
CURRENT OCCUPANT	9311 W CAPITOL DR 1	MILWAUKEE, WI 53222
CURRENT OCCUPANT	9311 W CAPITOL DR 4	MILWAUKEE, WI 53222
CURRENT OCCUPANT	9419 W CAPITOL DR	MILWAUKEE, WI 53222
CURRENT OCCUPANT	9333 W CAPITOL DR	MILWAUKEE, WI 53222
CURRENT OCCUPANT	9307 W CAPITOL DR 2	MILWAUKEE, WI 53222
CURRENT OCCUPANT	9311 W CAPITOL DR 2	MILWAUKEE, WI 53222
CURRENT OCCUPANT	4025 N 94TH ST	MILWAUKEE, WI 53222
CURRENT OCCUPANT	9423 W CAPITOL DR	MILWAUKEE, WI 53222
CURRENT OCCUPANT	9341 W CAPITOL DR	MILWAUKEE, WI 53222
CURRENT OCCUPANT	9311 W CAPITOL DR 3	MILWAUKEE, WI 53222
CURRENT OCCUPANT	9425 W CAPITOL DR	MILWAUKEE, WI 53222
CURRENT OCCUPANT	9409 W CAPITOL DR	MILWAUKEE, WI 53222
CURRENT OCCUPANT	4032 N 94TH ST	MILWAUKEE, WI 53222
CURRENT OCCUPANT	9335 W CAPITOL DR	MILWAUKEE, WI 53222
CURRENT OCCUPANT	9411 W CAPITOL DR	MILWAUKEE, WI 53222
CURRENT OCCUPANT	9403 W CAPITOL DR	MILWAUKEE, WI 53222
CURRENT OCCUPANT	9321A W CAPITOL DR	MILWAUKEE, WI 53222
CURRENT OCCUPANT	9417 W CAPITOL DR	MILWAUKEE, WI 53222

Total Records: 27

Radius: 250.0 feet and Center of Circle: 9330 W Capitol Dr

2018-2019 Plan of Operation for 9330 W CAPITOL DR

1. Litter & Security Plans			
How are the grounds kept clean? <input checked="" type="checkbox"/> Sweep <input type="checkbox"/> Pressure Wash <input checked="" type="checkbox"/> Pick Up Litter <input type="checkbox"/> Other:			
How often will grounds be cleaned? <input checked="" type="checkbox"/> Daily <input type="checkbox"/> Weekly <input type="checkbox"/> Other:			
Who cleans the grounds? <input type="checkbox"/> Licensee <input checked="" type="checkbox"/> Building Owner <input checked="" type="checkbox"/> Employees <input checked="" type="checkbox"/> Hired Maintenance <input type="checkbox"/> Other:			
How are noise issues prevented and/or addressed? <input type="checkbox"/> Security <input checked="" type="checkbox"/> Manager approaches customer(s) <input checked="" type="checkbox"/> Call Police <input checked="" type="checkbox"/> Signs Posted <input type="checkbox"/> Other:			
Are there designated outdoor smoking areas? <input checked="" type="checkbox"/> No <input type="checkbox"/> Yes If Yes, Describe:			
Number of garbage cans: Inside <u>4</u> Locations: <u>Various Areas</u> Outside <u>1</u> Locations: <u>Front door</u>			
Is a crowd control barrier used? <input checked="" type="checkbox"/> No <input type="checkbox"/> Yes If Yes, Describe:			
Number of restrooms:		Name of solid waste contractor:	
Are there parking spaces on the premises? <input type="checkbox"/> No <input checked="" type="checkbox"/> Yes If Yes, list number of spaces: <u>20</u> and describe security plans: <u>Cameras outside</u>			
Are there designated loading areas? <input type="checkbox"/> No <input checked="" type="checkbox"/> Yes If Yes, describe security plans:			
Do you have security personnel on the premise? <input checked="" type="checkbox"/> No <input type="checkbox"/> Yes If Yes, how many? _____ AND What are their responsibilities? _____ What security equipment do they use? _____ List their licensing, certification or training credentials: _____			
Are there security cameras? <input type="checkbox"/> No <input checked="" type="checkbox"/> Yes If Yes, list all locations: <u>16 Cameras</u>			
Are searches and/or identification checks conducted upon entry? <input checked="" type="checkbox"/> No <input type="checkbox"/> Yes If Yes, describe:			
2. Percentage of Sales (must total 100%)			
Alcohol <u>90</u> %	Food Sales <u>10</u> %	Entertainment _____ %	Other _____ %
3. Businesses On The Premises (choose all that apply):			
<input type="checkbox"/> Restaurant	<input type="checkbox"/> Cafe/Coffee Shop	<input type="checkbox"/> Cocktail Lounge	<input type="checkbox"/> Convenience Store
<input type="checkbox"/> Hotel	<input type="checkbox"/> Banquet Hall	<input type="checkbox"/> Supermarket	<input type="checkbox"/> Private/Fraternal/Veterans' Club
<input type="checkbox"/> Night Club	<input checked="" type="checkbox"/> Liquor Store	<input type="checkbox"/> Tavern	<input type="checkbox"/> Sports Facility
<input type="checkbox"/> Other:			
4. Hours of Operation and Age Restriction			
Are there any changes to the current hours of operation or age restriction? <input checked="" type="checkbox"/> No <input type="checkbox"/> Yes If Yes, Describe:			
Please Note: If you will be open earlier or later than the hours listed on your current license for even one event or holiday (for example, St. Patrick's Day, Brewers Opening Day, etc.) during the license period, this must be reported and printed on your license. Your hours of operation and age restriction are listed on your current license.			
5. Floor Plan and Capacity			
Are you requesting any changes to your capacity or floor plan*? <input checked="" type="checkbox"/> No <input type="checkbox"/> Yes If yes, describe: _____ and submit a new floor plan with this renewal application. A sample plan can be found online at www.milwaukee.gov/licenses under License Forms and Related Information.			
Alcohol/Food Establishments: A "Permanent Extension of Premises Application" is required if you are adding any square footage to the licensed premises.			
6. Sidewalk Dining: Fee:			
Are there any changes to the sidewalk dining site plan? <input checked="" type="checkbox"/> No <input type="checkbox"/> Yes If Yes, submit an updated site plan with this application.			
7. Food License: FOOD 8188 Fee: \$200.00		8. Weights and Measures: Fee:	
Your current food license includes the following food operations: No Processing, Hazardous Foods, Sales < \$20,000, Food Store. Are there any changes to your food operations as listed above? <input checked="" type="checkbox"/> No <input type="checkbox"/> Yes, if Yes, explain _____		Number/Type of Devices: <u>2</u> Are there any changes to the number or types of devices? <input checked="" type="checkbox"/> No <input type="checkbox"/> Yes If yes, contact our office for further instructions.	



**WEIGHTS & MEASURES BUSINESS LICENSE RENEWAL
SUPPLEMENTAL APPLICATION**

Office of the City Clerk License Division
200 E. Wells St. Room 105, Milwaukee, WI 53202
(414) 286-2238 license@milwaukee.gov www.milwaukee.gov/license

Legal Entity Name: **SPDK, INC**
Premises Address: **9330 W CAPITOL DR**

Device List

<u>Types & Quantities</u>	<u>Fees Due</u>
Scanners = Up to 3	\$130.00

Changes

Are you making changes to the Device List above?

- No If no, skip this section.
- Yes If yes, check the Add or Remove box and list the device type and quantity for each change:
(A list of device types can be found on the information sheet.)

- Add Remove Device Type: _____ Quantity: # _____
- Add Remove Device Type: _____ Quantity: # _____
- Add Remove Device Type: _____ Quantity: # _____
- Add Remove Device Type: _____ Quantity: # _____

If you are adding or removing devices, do not send payment for your devices with your renewal application. Your fees will be calculated (and prorated if needed to expire with other licenses) and an invoice generated. How would you like your invoice sent to you? Postal mail Email to: _____

Signature

Signature of Sole Proprietor; a Partner;
or if a Corporation or LLC, the Agent must sign: _____

Complete Reverse